



Texaco E & P

205 E. Bender Blvd.  
Hobbs NM 88240  
505 393 7191

NSL 3/10/99

February 15, 1999

NMOCD  
2040 South Pacheco  
Santa Fe, New Mexico 87505

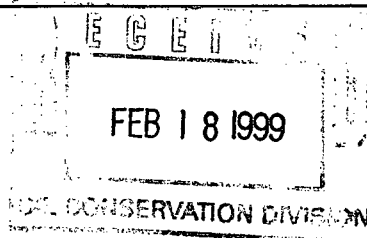

Attn: Mr. Michael Stogner

**Subject: Application for Non-Standard Location for the Texmack 6 State No. 1  
(Originally named Anderson Ranch Unit #1)  
3235' FNL, 1991' FWL, Section 6, T-16S, R-32E  
Lea County, New Mexico**

Dear Mr. Stogner:

Texaco Exploration and Production Inc. respectfully requests approval for a non-standard location for the TEXMACK 6 STATE NO. 1. The referenced well is non-standard by four feet as shown by the attached plat.

The Anderson Ranch Unit #1 was originally drilled in 1954 by Continental Oil Company. The well was drilled to a depth of 14,015' before being plugged back and cased to 12,609'. The Morrow was tested at 360 BCPD, 0 BWPD, and 5 MMCFD. This zone was produced for a short period prior to setting a CIBP and testing the Pennsylvania and the Wolfcamp in 1957. Following these tests, the well was plugged and approximately 5,000' of casing was recovered in October, 1957.

In March, 1960, Aztec Oil and Gas Company re-entered the well in order to test three intervals above 5,000'. No commercial production was found and the well was once again plugged in April, 1960.

The planned work involves re-entering the well, squeezing all existing perforations and tying the 7" casing string back to surface. The Morrow will then be perforated and tested. The Morrow is planned to be both acidized and fracture stimulated with a small sand fracture. If the Morrow is non-commercial, a CIBP will be set and the Atoka will be tested. The Atoka test includes an acid stimulation. Both zones will most likely also have bottom hole pressure build-ups of five days duration.

The initial portion of the work is planned to be completed using a drilling rig through reaching PBTD. A service rig will then be used for the remainder of the completion work.

Attached is a waiver from Chevron USA, the single offset operator. They have no objection to this re-entry.

If you have any questions concerning this application, please contact J. Denise Leake at (505) 397-0405.

Sincerely,

J. Denise Leake  
Engineering Assistant  
Texaco Exploration and Production Inc.

Cc: Mr. Chris Williams - NMOCD, Hobbs

DISTRICT I  
P. O. Box 1980, Hobbs, NM 88240

DISTRICT II  
P. O. Drawer DD, Artesia, NM 88210

DISTRICT III  
1000 Rio Brazos Rd., Aztec, NM 87410

DISTRICT IV  
P. O. Box 2088, Santa Fe, NM 87504-2088

State of New Mexico  
Energy, Minerals and Natural Resources Department

Form C-102  
Revised February 10, 1994

Instructions on back

OIL CONSERVATION DIVISION  
PO Box 2088  
Santa Fe, NM 87504-2088

Submit to Appropriate District Office

State Lease-4 copies  
Fee Lease-3 copies

☐ AMENDED REPORT

WELL LOCATION AND ACREAGE DEDICATION PLAT

1 API Number		2 Pool Code		3 Pool Name Anderson Ranch West (Penn)					
4 Property Code		5 Property Name Texmack "6" State						6 Well Number 1	
7 OGRID No. 22351		8 Operator Name Texaco Exploration & Production Inc.						9 Elevation 4383	
10 Surface Location									
UL or lot no. K	Section 6	Township 16-S	Range 32-E	Lot Idn 11	Feet from the 3228'	North/South line North	Feet from the 1987'	East/West line West	7 County Lea
11 Bottom Hole Location If Different From Surface									
UL or lot no.	Section	Township	Range	Lot Idn	Feet from the	North/South line	Feet from the	East/West line	7 County
12 Dedicated Acres 160		13 Joint or Infill		14 Consolidation Code		15 Order No.			

NO ALLOWABLE WILL BE ASSIGNED TO THIS COMPLETION UNTIL ALL INTERESTS HAVE BEEN CONSOLIDATED  
OR A NON-STANDARD UNIT HAS BEEN APPROVED BY THE DIVISION.

						<b>17 OPERATOR CERTIFICATION</b> I hereby certify that the information contained herein is true and complete to the best of my knowledge and belief. Signature: <i>J. Denise Leake</i> Printed Name: J. DENISE LEAKE Position: <i>Eng. Asst</i> Company: <i>Texaco</i> Date: <i>2-15 '99</i>	
<b>18 SURVEYOR CERTIFICATION</b> I hereby certify that the well location shown on this plat was plotted from field notes of actual surveys made by me or under my supervision, and that the same is true and correct to the best of my knowledge and belief. Date Surveyed: December 14, 1998 Signature & Seal of Professional Surveyor: <i>John S. Piper</i> Certificate No.: John S. Piper, PLS 7254						Sheet	

○ = Staked Location    ● = Producing Well    ⚡ = Injection Well    ⚙ = Water Supply Well    ⊕ = Plugged & Abandon Well  
⊙ = Found Section Corner, 2 or 3" Iron Pipe & GLO B.C.    ○ = Found 1/4 Section Corner, 1" Iron Pipe & GLO B.C.

ADDITIONAL INFORMATION ON THE LOCATION

State Plane Coordinates Northing 772,011.56		Easting 700,482.83	
Latitude 32°57'22.408"		Longitude 103°48'29.123"	
Zone East	North American Datum 1983 NAD	Combined Grid Factor 0.99976969	Coordinate File Texmack6.cr5
Drawing File TEXMK6_1.DWG		Field Book Lea County Field Book 19, Pages 3-9	



Texaco E &amp; P

205 E. Bender Blvd.  
Hobbs NM 88240  
505 393 7191

February 15, 1999

Chevron USA  
P.O. Box 1150  
Midland, TX 79702

**Subject:** Application for Non Standard Location approval for the Texmack 6 State No. 1  
(Originally named Anderson Ranch Unit #1)  
3235' FNL, 1991' FWL, Section 6, T-16S, R-32E  
Lea County, New Mexico

Dear Sirs:

Texaco Exploration and Production Inc. respectfully requests approval for a non-standard location for the TEXMACK 6 STATE NO. 1. The referenced well is non-standard by four feet as shown by the attached plat.

The Anderson Ranch Unit #1 was originally drilled in 1954 by Continental Oil Company. The well was drilled to a depth of 14,015' before being plugged back and cased to 12,609'. The Morrow was tested at 360 BCPD, 0 BWPD, and 5 MMCFD. This zone was produced for a short period prior to setting a CIBP and testing the Pennsylvania and the Wolfcamp in 1957. Following these tests, the well was plugged and approximately 5,000' of casing was recovered in October, 1957.

In March, 1960, Aztec Oil and Gas Company re-entered the well in order to test three intervals above 5,000'. No commercial production was found and the well was once again plugged in April, 1960.

The planned work involves re-entering the well, squeezing all existing perforations and tying the 7" casing string back to surface. The Morrow will then be perforated and tested. The Morrow is planned to be both acidized and fracture stimulated with a small sand fracture. If the Morrow is non-commercial, a CIBP will be set and the Atoka will be tested. The Atoka test includes an acid stimulation. Both zones will most likely also have bottom hole pressure build-ups of five days duration.

The initial portion of the work is planned to be completed using a drilling rig through reaching PBTD. A service rig will then be used for the remainder of the completion work.

If you have any questions concerning this application, please contact J. Denise Leake at (505) 397-0405.

Sincerely,

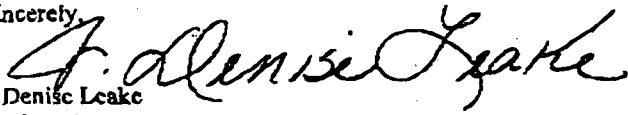
  
J. Denise Leake  
Engineering Assistant  
Texaco Exploration and Production, Inc.

CHEVRON USA HAS NO OBJECTION TO THE ABOVE PROPOSED RE-ENTRY .

Signed

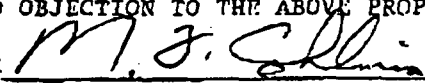

Title

ATTORNEY-IN-FACT

Date:

2/15/99



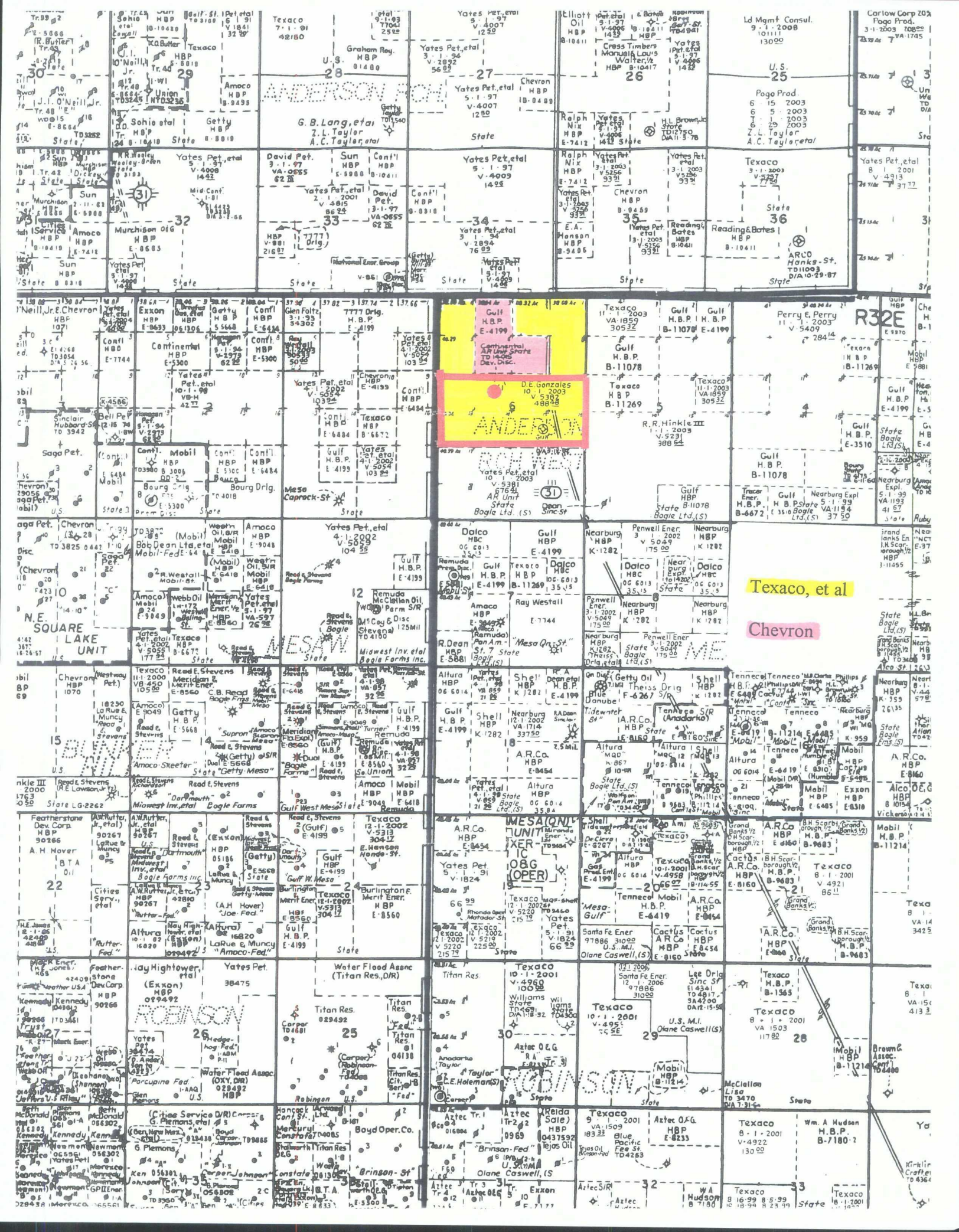

CMD :  
OG5SECTONGARD  
INQUIRE LAND BY SECTION02/19/99 15:10:59  
OGOMES -TPFQ  
PAGE NO: 1

Sec : 06 Twp : 16S Rng : 32E Section Type : LONG

12	4	5	11	3	6	10	2	7	1	8	9
40.32	38.00	40.29	40.00	38.04	40.00	40.00	38.32	40.00	38.60	40.00	40.00
CS	CS	CS	CS	CS	CS	CS	CS	CS	CS	CS	CS
V05382	0000	10/03	MULTI			MULTI			V05382	0000	10/03
DANIEL E GONZALES									DANIEL E GONZALES		
13			14			15			16		
40.36			40.00			40.00			40.00		
CS			CS			CS			CS		
V05382	0000	10/03	V05382	0000	10/03	V05382	0000	10/03	V05382	0000	10/03
DANIEL E GONZALES			DANIEL E GONZALES			DANIEL E GONZALES			DANIEL E GONZALES		

PF01 HELP  
PF07 BKWDPF02  
PF08 FWDPF03 EXIT  
PF09 PRINTPF04 GoTo  
PF10 SDIVPF05  
PF11PF06  
PF12

CMD :  
OG5SECTONGARD  
INQUIRE LAND BY SECTION02/19/99 15:11:11  
OGOMES -TPFQ  
PAGE NO: 2

Sec : 06 Twp : 16S Rng : 32E Section Type : LONG

17 40.39 CS V05381 0000 10/03 YATES PETROLEUM C	K 40.00 CS V05381 0000 10/03 YATES PETROLEUM C	J 40.00 CS V05381 0000 10/03 YATES PETROLEUM C	I 40.00 CS V05381 0000 10/03 YATES PETROLEUM C
18 40.42 CS V05381 0000 10/03 YATES PETROLEUM C	N 40.00 CS V05381 0000 10/03 YATES PETROLEUM C	O 40.00 CS V05381 0000 10/03 YATES PETROLEUM C	P 40.00 CS V05381 0000 10/03 YATES PETROLEUM C

PF01 HELP	PF02	PF03 EXIT	PF04 GoTo	PF05	PF06
PF07 BKWD	PF08 FWD	PF09 PRINT	PF10 SDIV	PF11	PF12



COUNTY Lea

POOL

West Anderson Ranch - Pennsylvanian Gas Anderson

TOWNSHIP 16 South

RANGE 32 East

NMPM

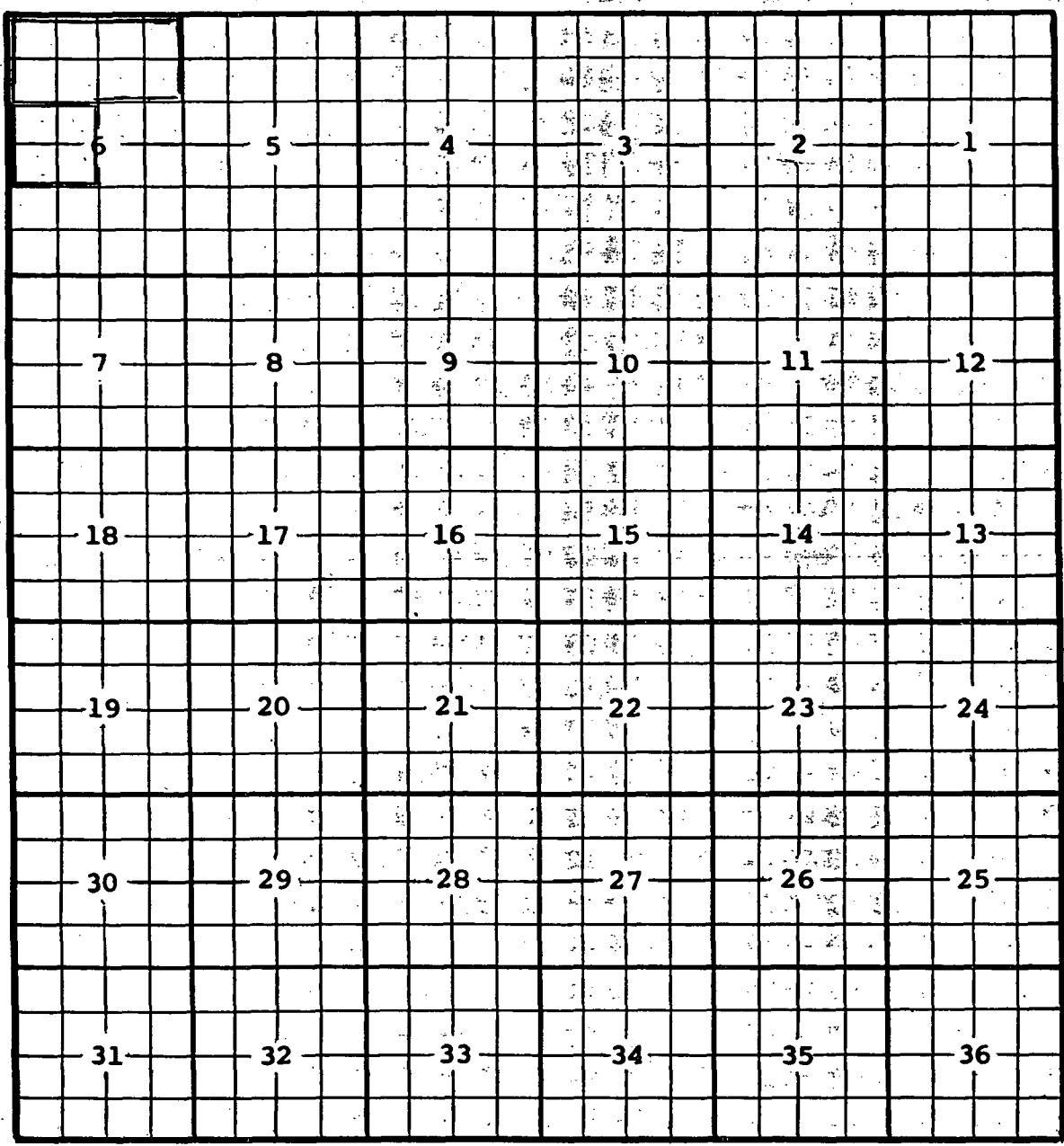

Description: Lots 11, 12, 13, & 14 Sec. 6 (R-958, 3-8-57)

Ext: Lots 1, 2, 3, 4, 5, 6, 7, and 8 sec. 6 (R-7917, 5-13-85)

\_\_\_\_\_  
\_\_\_\_\_  
\_\_\_\_\_  
\_\_\_\_\_  
\_\_\_\_\_  
\_\_\_\_\_  
\_\_\_\_\_  
\_\_\_\_\_  
\_\_\_\_\_  
\_\_\_\_\_

NSL - 4216



STATE OF NEW MEXICO  
ENERGY, MINERALS AND NATURAL RESOURCES DEPARTMENT

OIL CONSERVATION DIVISION  
HOBBS DISTRICT OFFICE

GOVERNOR

2/16/99

POST OFFICE BOX 1980  
HOBBS, NEW MEXICO 88241-1980  
(505) 393-6161

OIL CONSERVATION DIVISION  
P. O. BOX 2088  
SANTA FE, NEW MEXICO 87501

RE: Proposed:

MC \_\_\_\_\_  
DHC \_\_\_\_\_  
NSL X \_\_\_\_\_  
NSP \_\_\_\_\_  
SWD \_\_\_\_\_  
WFX \_\_\_\_\_  
PMX \_\_\_\_\_

Gentlemen:

I have examined the application for the:

Texaco E&P Inc      Texmack 6 State      #1-K-6-16s-32e  
Operator      Lease & Well No.      Unit      S-T-R

and my recommendations are as follows:

OK - they have talked to offsets and got approval.

Yours very truly,

*Chris Williams*

Chris Williams  
Supervisor, District 1

/ed