

HUMBLE OIL & REFINING COMPANY

MIDLAND, TEXAS 79701

PRODUCTION DEPARTMENT
SOUTHWESTERN DIVISION

E. C. BARFIELD
OPERATIONS MANAGER

April 2, 1970

MAIN OFFICE 000

APR 8 13
70

POST OFFICE BOX 1600

File No. 22-3

Request for Reallocation of Acreage to
New Mexico "V" State Well No. 5
Tubb Gas Well

*MUT 829
NSP
issue 5-7-70
place R-3742 in oblique*

New Mexico Oil Conservation Commission
P. O. Box 2088
Santa Fe, New Mexico

Attention: Mr. A. L. Porter, Secretary Director

Gentlemen:

Humble Oil & Refining Company respectfully requests reallocation of acreage dedicated to its New Mexico "V" State Well No. 5, Tubb Gas Well, located in Unit "M", Section 10, T-21-S, R-37-E, Lea County, New Mexico, to include the W/2 and SE/4 of SW/4 of Section 10, a total of 120 acres.

NMOCC Order No. R-3742 authorized Humble to form a standard 160-acre gas proration unit from two nonstandard units comprising the N/2 SW/4, SW/4 SW/4 and SE/4 SW/4 Section 10, to comprise the SW/4 of the Section, T-21-S, R-37-E, Lea County and dedicate the acreage to Humble's Nos. 5 and 11 New Mexico "V" State wells located in Units M and K, respectively.

Reallocation is necessary due to New Mexico "V" State Well No. 11, Unit K, Section 10, T-21-S, R-37-E, being reclassified from a Tubb Gas Well to a Tubb Oil Well effective December 1, 1969.

Very truly yours,

E. C. Barfield

DFL/hnf

cc: NMOCC, Hobbs, New Mexico
cc: Getty Oil Co., Box 249, Hobbs, New Mexico 88240
cc: Continental Oil Co., Box 460, Hobbs, New Mexico 88240
cc: Southland Royalty Co., 1405 Wilco Bldg., Midland, Texas 79701
cc: Aztec Oil & Gas Co., Box 847, Hobbs, New Mexico 88240
cc: Gulf Oil Co., Box 670, Hobbs, New Mexico 88240

Humble Les. No. 37722

State Les. No. B-935

NEW MEXICO OIL CONSERVATION COMMISSION
WELL LOCATION AND ACREAGE DEDICATION PLATForm C-102
Supersedes C-128
Effective 1-1-65

Federal Les. No. _____

All distances must be from the outer boundaries of the Section.

Operator Humble Oil & Refining Co.		Lease New Mexico "V" State		Well No. 5
Unit Letter M	Section 10	Township 21-S	Range 37-E	County Lea
Actual Footage Location of Well: 660 feet from the South line and 810 feet from the West line				
Ground Level Elev. 3458	Producing Formation Tubb	Pool Tubb Gas	Dedicated Acreage: 120 Acres	

1. Outline the acreage dedicated to the subject well by colored pencil or hachure marks on the plat below.
2. If more than one lease is dedicated to the well, outline each and identify the ownership thereof (both as to working interest and royalty).
3. If more than one lease of different ownership is dedicated to the well, have the interests of all owners been consolidated by communitization, unitization, force-pooling, etc?

☐ Yes ☐ No If answer is "yes," type of consolidation _____

If answer is "no," list the owners and tract descriptions which have actually been consolidated. (Use reverse side of this form if necessary.) _____

No allowable will be assigned to the well until all interests have been consolidated (by communitization, unitization, forced-pooling, or otherwise) or until a non-standard unit, eliminating such interests, has been approved by the Commission.

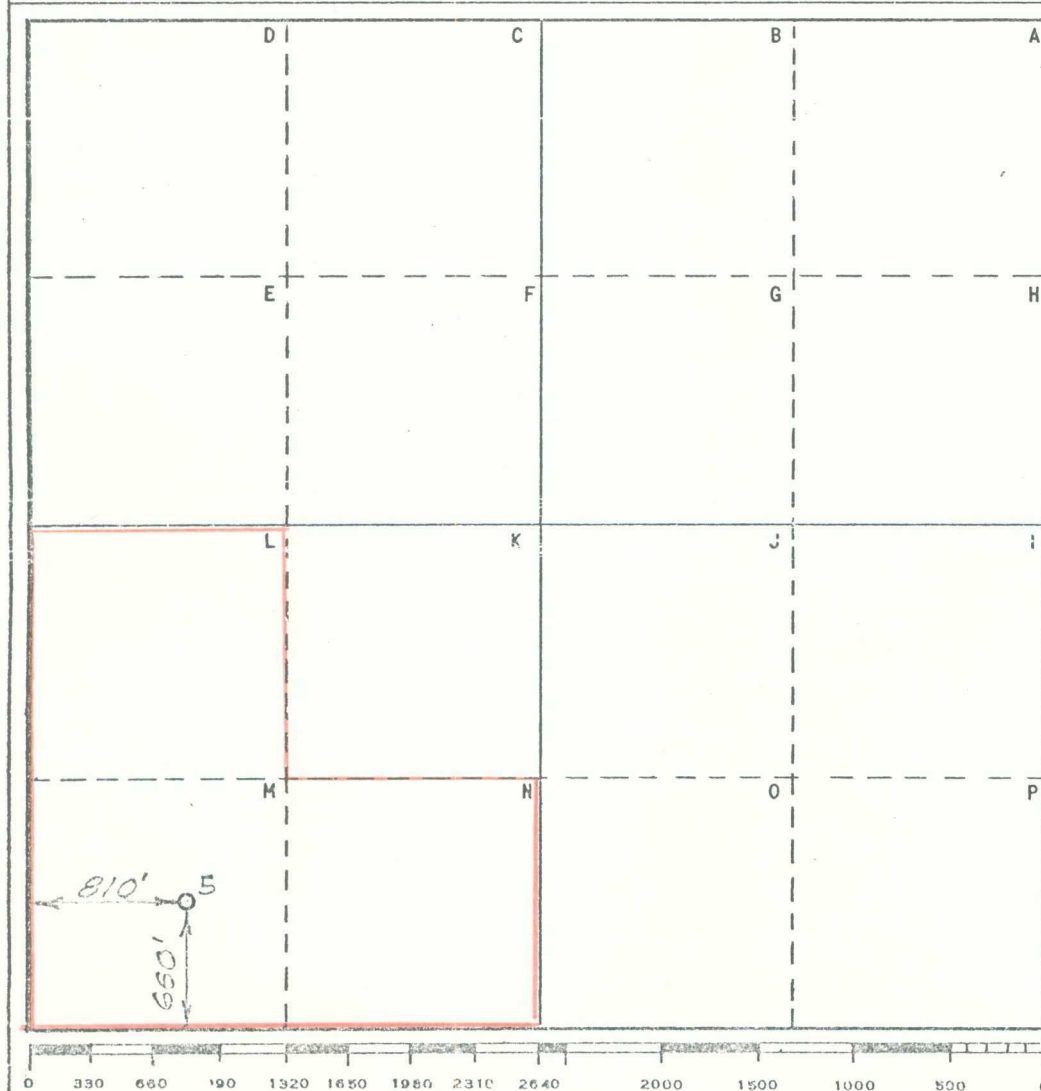

CERTIFICATION

I hereby certify that the information contained herein is true and complete to the best of my knowledge and belief.

H. L. Clemmer
Name Agent

Position

Company Humble Oil & Refining Co.
Box 1600 Midland, Texas

Date

12-1-69

I hereby certify that the well location shown on this plat was plotted from field notes of actual surveys made by me or under my supervision, and that the same is true and correct to the best of my knowledge and belief.

Date Surveyed

Registered Professional Engineer
and/or Land Surveyor

Certificate No.

_____ Miles _____ of _____, New Mexico

C.E. Sec. File No. _____

DFL

OIL CONSERVATION COMMISSION

P. O. BOX 2088

SANTA FE, NEW MEXICO 87501

June 1, 1970

C
O
P
Y

Humble Oil & Refining Company
Post Office Box 1600
Midland, Texas 79701

Attention: Mr. E. C. Barfield

Administrative Order NSP-829-A

Gentlemen:

Due to clerical error, Administrative Order NSP-829 incorrectly described the acreage comprising the 120-acre non-standard gas proration unit approved therein. Accordingly, the acreage description in the first paragraph of Administrative Order NSP-829 is hereby amended to read as follows:

LEA COUNTY, NEW MEXICO
TOWNSHIP 21 SOUTH, RANGE 37 EAST, NMPM
Section 10: W/2 SW/4 and SE/4 SW/4

This administrative order shall be effective May 7, 1970, nunc pro tunc.

Very truly yours,

A. L. PORTER, Jr.
Secretary-Director

ALP/GMH/esr

cc: Oil Conservation Commission - Hobbs
Oil & Gas Engineering Committee - Hobbs
State Land Office - Santa Fe
Proration Department, OCC - Santa Fe

No. 528769

RECEIPT FOR CERTIFIED MAIL—30¢ (plus postage)

SENT TO		POSTMARK OR DATE
Aztec Oil & Gas Company		
STREET AND NO.		
P. O. Box 847		
P.O., STATE AND ZIP CODE		
Hobbs, New Mexico 88240		
OPTIONAL SERVICES FOR ADDITIONAL FEES		
RETURN RECEIPT SERVICES	1. Shows to whom and date delivered	15¢
	With delivery to addressee only	65¢
	2. Shows to whom, date and where delivered	35¢
	With delivery to addressee only	85¢
	DELIVER TO ADDRESSEE ONLY	50¢
	SPECIAL DELIVERY (2 pounds or less)	45¢

POD Form 3800
July 1969**NO INSURANCE COVERAGE PROVIDED—
NOT FOR INTERNATIONAL MAIL**

(See other side)

★ GPO : 1969 O—358-312

No. 528770

RECEIPT FOR CERTIFIED MAIL—30¢ (plus postage)

SENT TO		POSTMARK OR DATE
Gulf Oil Company		
STREET AND NO.		
P. O. Box 670		
P.O., STATE AND ZIP CODE		
Hobbs, New Mexico 88240		
OPTIONAL SERVICES FOR ADDITIONAL FEES		
RETURN RECEIPT SERVICES	1. Shows to whom and date delivered	15¢
	With delivery to addressee only	65¢
	2. Shows to whom, date and where delivered	35¢
	With delivery to addressee only	85¢
	DELIVER TO ADDRESSEE ONLY	50¢
	SPECIAL DELIVERY (2 pounds or less)	45¢

POD Form 3800
July 1969**NO INSURANCE COVERAGE PROVIDED—
NOT FOR INTERNATIONAL MAIL**

(See other side)

★ GPO : 1969 O—358-312

No. 528766

RECEIPT FOR CERTIFIED MAIL—30¢ (plus postage)

SENT TO		POSTMARK OR DATE
Getty Oil Company		
STREET AND NO. P. O. Box 249		
P.O., STATE AND ZIP CODE Hobbs, New Mexico 88240		
OPTIONAL SERVICES FOR ADDITIONAL FEES		
RETURN RECEIPT SERVICES	1. Shows to whom and date delivered	15¢
	With delivery to addressee only	65¢
	2. Shows to whom, date and where delivered	35¢
	With delivery to addressee only	85¢
DELIVER TO ADDRESSEE ONLY		50¢
SPECIAL DELIVERY (2 pounds or less)		45¢

POD Form 3800
July 1969

NO INSURANCE COVERAGE PROVIDED—
NOT FOR INTERNATIONAL MAIL

(See other side)
★ GPO : 1969 O—358-312

No. 528767

RECEIPT FOR CERTIFIED MAIL—30¢ (plus postage)

SENT TO		POSTMARK OR DATE
Continental Oil Company		
STREET AND NO. P. O. Box 460		
P.O., STATE AND ZIP CODE Hobbs, New Mexico 88240		
OPTIONAL SERVICES FOR ADDITIONAL FEES		
RETURN RECEIPT SERVICES	1. Shows to whom and date delivered	15¢
	With delivery to addressee only	65¢
	2. Shows to whom, date and where delivered	35¢
	With delivery to addressee only	85¢
DELIVER TO ADDRESSEE ONLY		50¢
SPECIAL DELIVERY (2 pounds or less)		45¢

POD Form 3800
July 1969

NO INSURANCE COVERAGE PROVIDED—
NOT FOR INTERNATIONAL MAIL

(See other side)
★ GPO : 1969 O—358-312

No. 528768

RECEIPT FOR CERTIFIED MAIL—30¢ (plus postage)

SENT TO		POSTMARK OR DATE
Southland Royalty Co.		
STREET AND NO. 1405 Wilco Building		
P.O., STATE AND ZIP CODE Midland, Texas 79701		
OPTIONAL SERVICES FOR ADDITIONAL FEES		
RETURN RECEIPT SERVICES	1. Shows to whom and date delivered	15¢
	With delivery to addressee only	65¢
	2. Shows to whom, date and where delivered	35¢
	With delivery to addressee only	85¢
DELIVER TO ADDRESSEE ONLY		50¢
SPECIAL DELIVERY (2 pounds or less)		45¢

POD Form 3800
July 1969

NO INSURANCE COVERAGE PROVIDED—
NOT FOR INTERNATIONAL MAIL

(See other side)
★ GPO : 1969 O—358-312