

Atlantic Richfield Company

North American Producing Division
Permian District
Post Office Box 1610
Midland, Texas 79701
Telephone 915 682 8631

W. P. Tomlinson
District Engineer - West Area

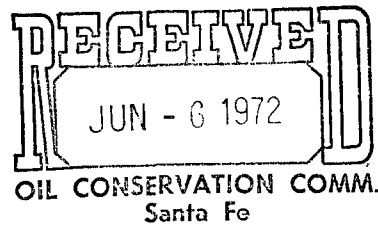

June 5, 1972

Mr. A. L. Porter
New Mexico Oil Conservation Commission
Santa Fe, New Mexico

Re: Request to substitute State 157 "A" No. 4 for
Well No. 2 in 160-acre standard Jalmat Gas Unit,
Lea County, New Mexico

Dear Mr. Porter:

The State 157 "A" Well No. 2 (Jalmat gas well) had a casing leak in March 1970. Attempts to return the well to flowing status have failed. The well was then temporarily abandoned and Form C-103 was submitted 2/26/71. We have now recompleted State 157 "A" No. 4 as a Jalmat gas well. We therefore request permission to substitute Well No. 4 for Well No. 2. State 157 "A" is a standard 160-acre gas proration unit and Well No. 4 is a standard well location. The gas unit is located in the SE/4 of Section 9, T-22S, R-36E. Well No. 4 is located 660' FEL and 1980' FSL of this section.

Very truly yours,

W. T. Porter

W. T. Porter

WTP/agp

cc: Mr. Joe Ramey - Hobbs, New Mexico

**NEW MEXICO OIL CONSERVATION COMMISSION
WELL LOCATION AND ACREAGE DEDICATION PLAT**

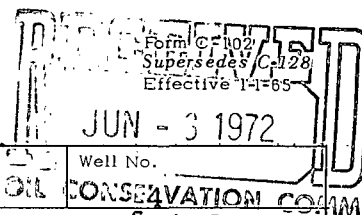

All distances must be from the outer boundaries of the Section.

Operator Atlantic Richfield Co.			Lease State 157 "A"		Well No. 4
Unit Letter I	Section 9	Township 22S	Range 36E	County Lea	
Actual Footage Location of Well:					
1980 feet from the South line and		660 feet from the East line			
Ground Level Elev: 3552'	Producing Formation Yates	Pool Jalmat	Dedicated Acreage: 160 Acres		

1. Outline the acreage dedicated to the subject well by colored pencil or hachure marks on the plat below.
2. If more than one lease is dedicated to the well, outline each and identify the ownership thereof (both as to working interest and royalty).
3. If more than one lease of different ownership is dedicated to the well, have the interests of all owners been consolidated by communitization, unitization, force-pooling, etc?

☐ Yes ☐ No If answer is "yes," type of consolidation _____

If answer is "no," list the owners and tract descriptions which have actually been consolidated. (Use reverse side of this form if necessary.) _____

No allowable will be assigned to the well until all interests have been consolidated (by communitization, unitization, forced-pooling, or otherwise) or until a non-standard unit, eliminating such interests, has been approved by the Commission.

R 36 E

T
22
S

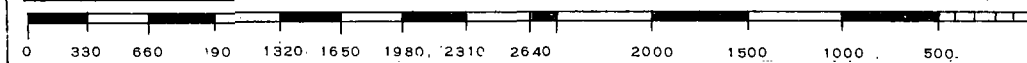
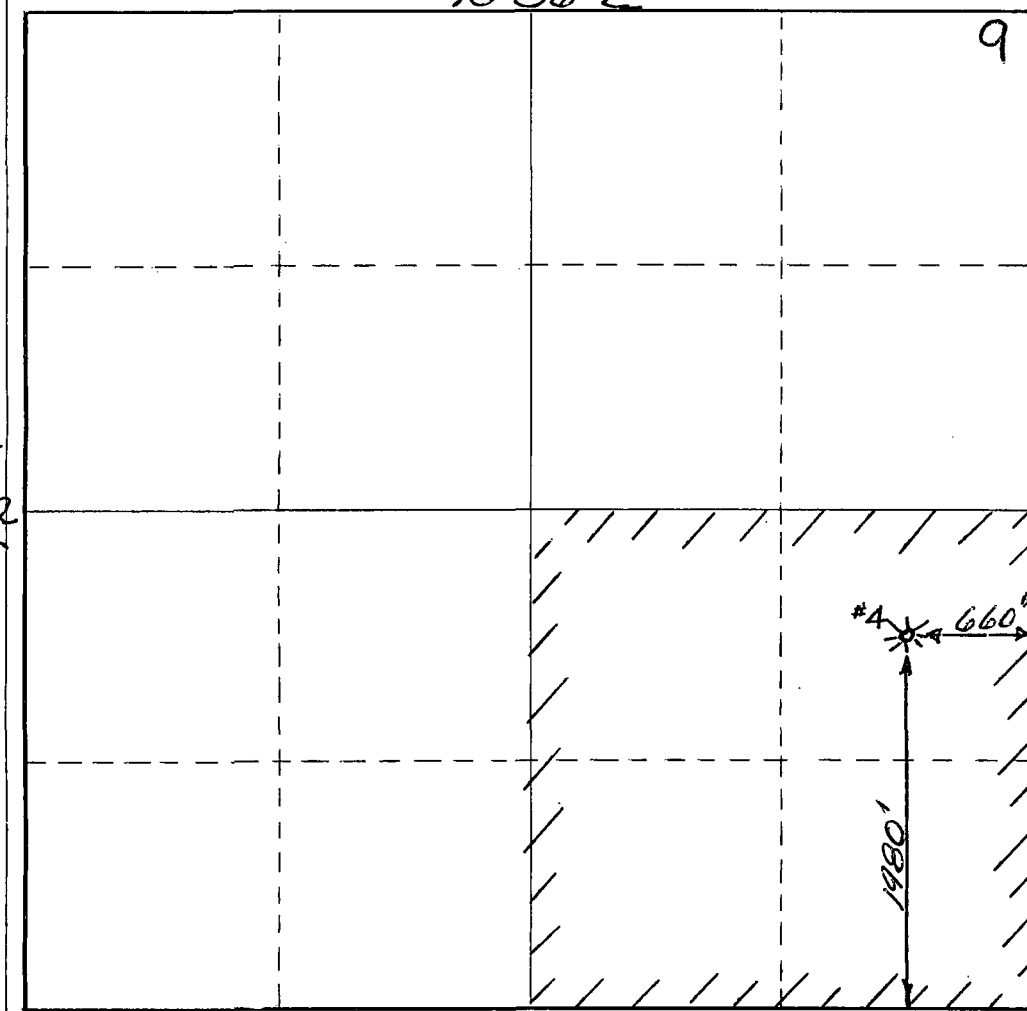

CERTIFICATION	
I hereby certify that the information contained herein is true and complete to the best of my knowledge and belief.	
<i>O. D. Bretches</i>	
Name	O. D. Bretches
Position	Dist. Drlg. Supv.
Company	Atlantic Richfield Co
Date	6/1/72
I hereby certify that the well location shown on this plat was plotted from field notes of actual surveys made by me or under my supervision, and that the same is true and correct to the best of my knowledge and belief.	
Date Surveyed	
Registered Professional Engineer and/or Land Surveyor	
Certificate No.	