

DATE IN <u>11/10/9</u>	SUSPENSE	ENGINEER <u>Brooks</u>	LOGGED IN <u>11/10/9</u>	TYPE <u>NSL</u>	APP NO. <u>0931427704</u>
------------------------	----------	------------------------	--------------------------	-----------------	---------------------------

ABOVE THIS LINE FOR DIVISION USE ONLY

NEW MEXICO OIL CONSERVATION DIVISION  
- Engineering Bureau -  
1220 South St. Francis Drive, Santa Fe, NM 87505



*Huntington*

*Ute Mountain Ute #105*

ADMINISTRATIVE APPLICATION CHECKLIST

*30-095-35020*

THIS CHECKLIST IS MANDATORY FOR ALL ADMINISTRATIVE APPLICATIONS FOR EXCEPTIONS TO DIVISION RULES AND REGULATIONS WHICH REQUIRE PROCESSING AT THE DIVISION LEVEL IN SANTA FE

*6115*

Application Acronyms:

- [NSL-Non-Standard Location] [NSP-Non-Standard Proration Unit] [SD-Simultaneous Dedication]  
[DHC-Downhole Commingling] [CTB-Lease Commingling] [PLC-Pool/Lease Commingling]  
[PC-Pool Commingling] [OLS - Off-Lease Storage] [OLM-Off-Lease Measurement]  
[WFX-Waterflood Expansion] [PMX-Pressure Maintenance Expansion]  
[SWD-Salt Water Disposal] [IPI-Injection Pressure Increase]  
[EOR-Qualified Enhanced Oil Recovery Certification] [PPR-Positive Production Response]

[1] TYPE OF APPLICATION - Check Those Which Apply for [A]

- [A] Location - Spacing Unit - Simultaneous Dedication  
☒ NSL ☐ NSP ☐ SD

Check One Only for [B] or [C]

- [B] Commingling - Storage - Measurement  
☐ DHC ☐ CTB ☐ PLC ☐ PC ☐ OLS ☐ OLM

- [C] Injection - Disposal - Pressure Increase - Enhanced Oil Recovery  
☐ WFX ☐ PMX ☐ SWD ☐ IPI ☐ EOR ☐ PPR

- [D] Other: Specify \_\_\_\_\_

[2] NOTIFICATION REQUIRED TO: - Check Those Which Apply, or Does Not Apply

- [A] ☐ Working, Royalty or Overriding Royalty Interest Owners  
[B] ☒ Offset Operators, Leaseholders or Surface Owner  
[C] ☐ Application is One Which Requires Published Legal Notice  
[D] ☒ Notification and/or Concurrent Approval by BLM or SLO  
U.S. Bureau of Land Management - Commissioner of Public Lands, State Land Office  
[E] ☐ For all of the above, Proof of Notification or Publication is Attached, and/or,  
[F] ☐ Waivers are Attached

[3] SUBMIT ACCURATE AND COMPLETE INFORMATION REQUIRED TO PROCESS THE TYPE OF APPLICATION INDICATED ABOVE.

[4] CERTIFICATION: I hereby certify that the information submitted with this application for administrative approval is **accurate** and **complete** to the best of my knowledge. I also understand that **no action** will be taken on this application until the required information and notifications are submitted to the Division.

Note: Statement must be completed by an individual with managerial and/or supervisory capacity.

Catherine Smith  
Print or Type Name

*Catherine Smith*  
Signature

Regulatory  
Title

11/9/09  
Date

csmith@huntingtonenergy.com  
e-mail Address



RECEIVED

2009 NOV 9 PM 3 01

November 6, 2009

New Mexico Oil Conservation Division  
1220 S. Saint Francis Dr.  
Santa Fe, NM 87505

Attn: Mr. Will Jones

RE: Non-Standard Location Application  
Ute Mountain Ute #105  
Sec 22-T32N-R14W  
San Juan Co., NM

Dear Mr. Jones:

Enclosed is the information necessary for Non-Standard Location approval for the above referenced well. If there is any additional information I may need, please contact me at (405) 840-9876 ext. 129.

Thank you!

Sincerely,

A handwritten signature in cursive script that reads 'Catherine Smith'.

Catherine Smith  
Regulatory

**Huntington Energy, L.L.C.**  
**908 N.W. 71<sup>st</sup> St.**  
**Oklahoma City, OK 73116**  
**(405) 840-9876 – Office    (405) 840-2011 - Fax**

**Ute Mountain Ute #105: Non-Standard Location**

**Location:     1635' FSL & 2230' FEL**  
**SE/4 Sec 22, T32N-R14W, San Juan County, NM**

The Application for Permit to Drill for the Ute Mountain Ute #105 has been approved by the Bureau of Land Management and the New Mexico Oil Conservation Division with a stipulation for non-standard location approval. The well is located 1635' FSL & 2230' FEL. The location is non-standard due to topography and archaeological issues. Per NMOCD location requirements, the well is less than 660' to the outer boundary of the quarter section. The permitted location is 410' from the west ¼ section line. Therefore, the UMU #105 will need a Non-Standard Location approval.

**Operators Affected:**

None.

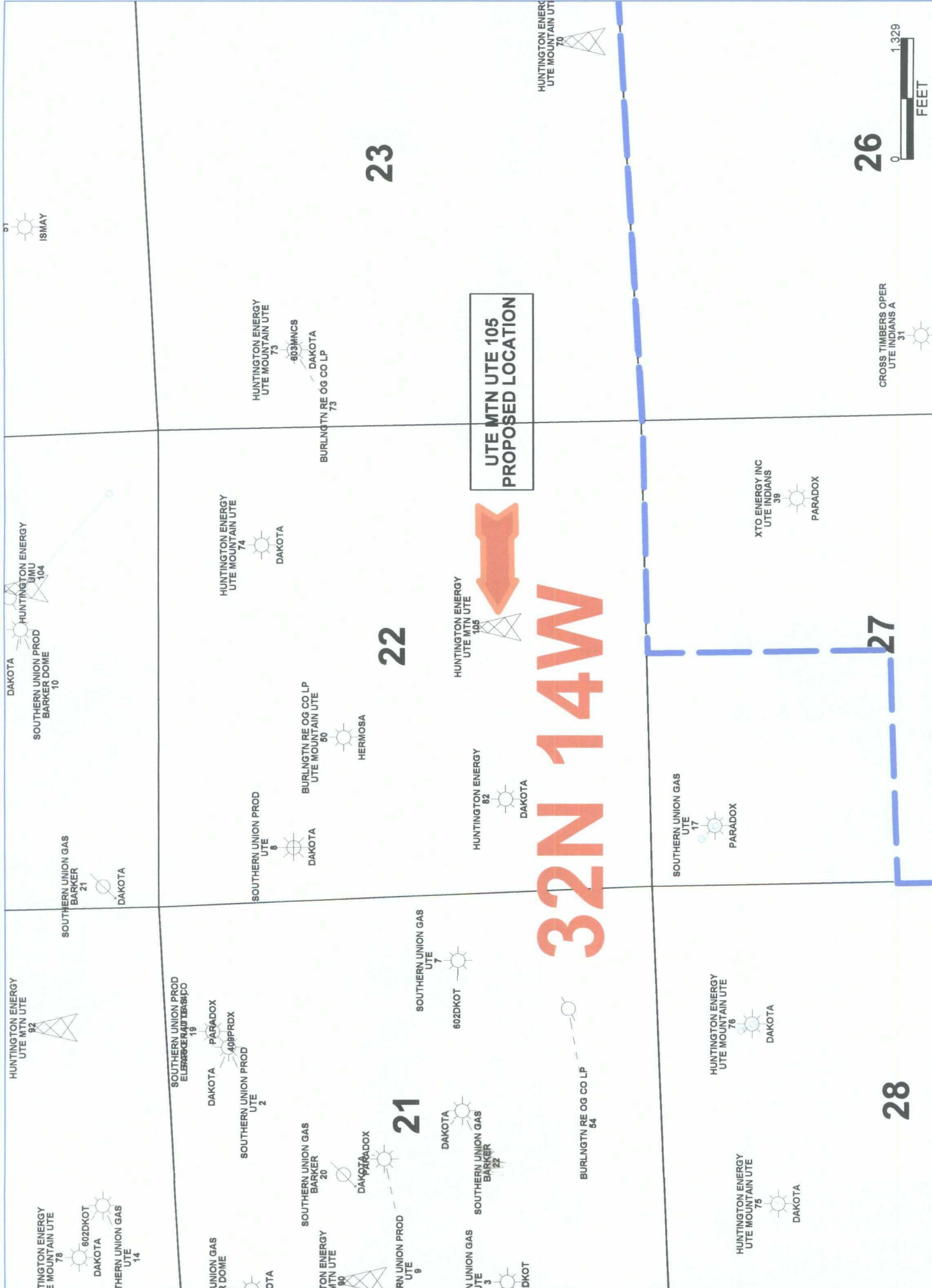

DISTRICT II  
1301 W. Grand Avenue, Artesia, N.M. 88210

DISTRICT III  
1000 Rio Brazos Rd., Aztec, N.M. 87410

DISTRICT IV  
1220 South St. Francis Dr., Santa Fe, NM 87505

## OIL CONSERVATION DIVISION

1220 South St. Francis Dr.  
Santa Fe, NM 87504-2088

APR 22 2009

☐ AMENDED REPORT

### Bureau of Land Management

## WELL LOCATION AND ACREAGE DEDICATION PLAT

<sup>1</sup> API Number <b>30-045-95020</b>		<sup>2</sup> Pool Code 715 <del>89</del> <b>20</b>	<sup>3</sup> Pool Name Barker Creek - Dakota
<sup>4</sup> Property Code 18725	<sup>5</sup> Property Name UTE MOUNTAIN UTE		<sup>6</sup> Well Number 105
<sup>7</sup> OGRIID No. 14538	<sup>8</sup> Operator Name BURLINGTON RESOURCES OIL & GAS COMPANY LP		<sup>9</sup> Elevation 6144

<sup>10</sup> Surface Location

UL or lot no.	Section	Township	Range	Lot Idn	Feet from the	North/South line	Feet from the	East/West line	County
J	22	32-N	14-W		1635	SOUTH	2230	EAST	SAN JUAN

<sup>11</sup> Bottom Hole Location If Different From Surface

UL or lot no.	Section	Township	Range	Lot Idn	Feet from the	North/South line	Feet from the	East/West line	County
---------------	---------	----------	-------	---------	---------------	------------------	---------------	----------------	--------

<sup>12</sup> Dedicated Acres SE-160	<sup>13</sup> Joint or Infill	<sup>14</sup> Consolidation Code	<sup>15</sup> Order No.
---	-------------------------------	----------------------------------	-------------------------

NO ALLOWABLE WILL BE ASSIGNED TO THIS COMPLETION UNTIL ALL INTERESTS HAVE BEEN CONSOLIDATED  
OR A NON-STANDARD UNIT HAS BEEN APPROVED BY THE DIVISION

# OPERATOR CERTIFICATION

I hereby certify that the information contained herein is true and complete to the best of my knowledge and belief, and that this organization either owns a working interest or unleased mineral interest in the land including the proposed bottom hole location or has a right to drill this well at this location pursuant to a contract with an owner of such a mineral or working interest, or to a voluntary pooling agreement or a compulsory pooling order heretofore entered by the division.

Catherine Smith 4/15/2009  
Signature Date  
Catherine Smith  
Printed Name

## 18 SURVEYOR CERTIFICATION

I hereby certify that the well location shown on this plat was plotted from field notes of actual surveys made by me or under my supervision, and that the same is true and correct to the best of my knowledge and belief.

APRIL 2 2009

Date of Survey \_\_\_\_\_  
Signature And Seal of Professional Surveyor \_\_\_\_\_

Certificate Number

**Brooks, David K., EMNRD**

---

**From:** Brooks, David K., EMNRD  
**Sent:** Monday, November 16, 2009 2:35 PM  
**To:** 'csmith@huntingtonenergy.com'  
**Subject:** Ute Mountain Ute Well No. 105; NSL Application

Dear Ms. Smith

We are in receipt of the referenced application for approval of a non-standard gas well location.

However, the application does not provide any information about notice given to offsetting operators or owners of this application. OCD Rule 15.13 [19.15.15.13 MMAC] requires that an application for NSL approval include a list of "affected persons" to whom notice has been given of the application (Subsection B of Rule 15.13) and a statement that notices have been given as required (Subsection C).

Please provide evidence of notice to the operator or working interest owners in the SW/4 of Section 22. If Huntington owns 100% of the operating rights in the SW/4 of Section 22, or if ownership of that tract is identical to the SE/4 of Section 22, please so advise us.

Sincerely  
David K. Brooks  
Legal Examiner  
505-476-3450

**Brooks, David K., EMNRD**

---

**From:** Cathy Smith [CSmith@huntingtonenergy.com]  
**Sent:** Monday, November 16, 2009 2:56 PM  
**To:** Brooks, David K., EMNRD  
**Subject:** RE: Ute Mountain Ute Well No. 105; NSL Application

David,

Huntington Energy is the offset operator. The SW/4 and SE/4 of Sec 22 have the same ownership – identical tract ownership.

Thank you!  
Cathy Smith

---

**From:** Brooks, David K., EMNRD [mailto:david.brooks@state.nm.us]  
**Sent:** Monday, November 16, 2009 3:35 PM  
**To:** Cathy Smith  
**Subject:** Ute Mountain Ute Well No. 105; NSL Application

Dear Ms. Smith

We are in receipt of the referenced application for approval of a non-standard gas well location.

However, the application does not provide any information about notice given to offsetting operators or owners of this application. OCD Rule 15.13 [19.15.15.13 MMAC] requires that an application for NSL approval include a list of “affected persons” to whom notice has been given of the application (Subsection B of Rule 15.13) and a statement that notices have been given as required (Subsection C).

Please provide evidence of notice to the operator or working interest owners in the SW/4 of Section 22. If Huntington owns 100% of the operating rights in the SW/4 of Section 22, or if ownership of that tract is identical to the SE/4 of Section 22, please so advise us.

Sincerely  
David K. Brooks  
Legal Examiner  
505-476-3450

Confidentiality Notice: This e-mail, including all attachments is for the sole use of the intended recipient(s) and may contain confidential and privileged information. Any unauthorized review, use, disclosure or distribution is prohibited unless specifically provided under the New Mexico Inspection of Public Records Act. If you are not the intended recipient, please contact the sender and destroy all copies of this message. -- This email has been scanned by the Sybari - Antigen Email System.

Confidentiality Notice: This e-mail,including all attachments is for the sole use of the intended recipient(s) and may contain confidential and privileged information. Any unauthorized review,use,disclosure or distribution is prohibited unless specifically provided under the New Mexico Inspection of Public Records Act. If you are not the intended recipient, please contact the sender and destroy all copies of this message.  
This email has been scanned using Webroot Email Security.

---

---

This inbound email has been scanned for malicious software and transmitted safely to you using Webroot Email Security.

---