

NM1 - 35

Draft
PERMITS,
RENEWALS, &
MODS
2009
Drawing

REVISIONS		
No.	Description	Date

KEY PLAN

SIGNATURE/SEAL

PROJECT
LEA LAND, LLC
OIL CONSERVATION
DIVISION
DISPOSAL AREA

LOCATION
LEA COUNTY
NEW MEXICO
PREPARED FOR
LEA LAND, LLC

DRAWING TITLE
GRADING PLAN

DRAFT

Project No.	99404
Drawn By	JRA
Checked By	SM
Date	05.27.2009
Scale	1" = 100'

Drawing No.
FIGURE 2

CARDINAL
ENGINEERING
1015 N. Broadway Ave., Suite 300
Oklahoma City, OK 73102
Phone 405.842.1066
Fax 405.843.4687

3226 Bart Conner Drive
Norman, OK 73072
Phone 405.579.0655
Fax 405.366.8540
<http://www.cardinalengineers.com>
CA# 2054, expiration date 06.30.2010

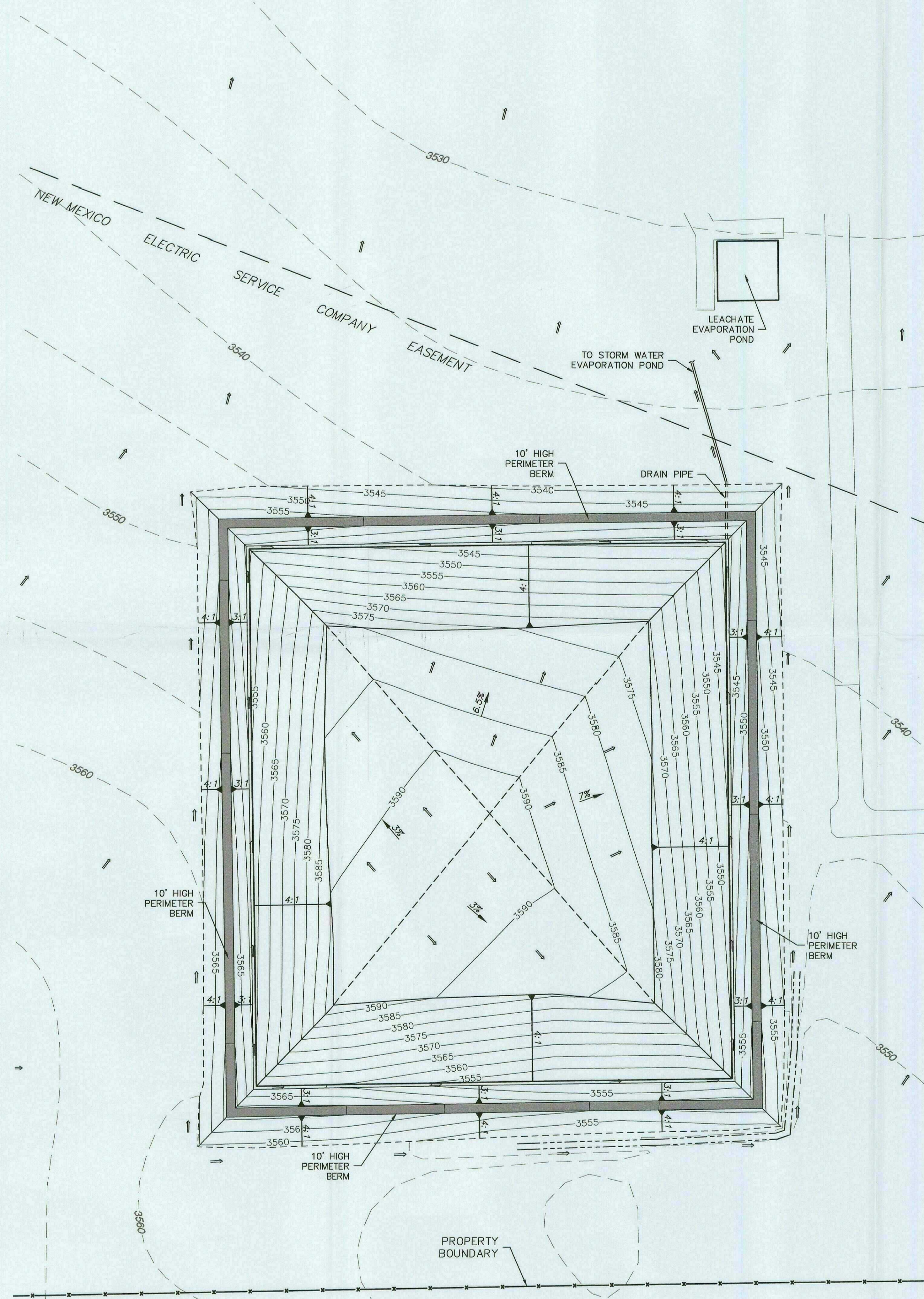

- NOTES:
- 1) ELEVATIONS ARE TOP INTERMEDIATE COVER.
 - 2) ELEVATIONS ARE APPROXIMATE.
 - 3) PERMANENT SOIL STABILIZATION WILL BE PROVIDED BY NATIVE GRASSES

LEGEND

- ~ TOP OF SLOPE
- ~ TOE OF SLOPE
- 3515 --- ~ EXISTING GROUND CONTOUR (5' INTERVAL)
- 3% ~ SURFACE GRADE
- ← ← ← ~ DRAINAGE FLOW DIRECTION ARROW