

Sec : 02 Twp : 30N Rng : 14W Section Type : NORMAL

D 40.00 CS VA1916 0001 RICHARDSON PRODUC C 02/01/04 A	C 40.00 CS VA1916 0001 RICHARDSON PRODUC C 02/01/04 A	B 40.00 CS E01545 0000 ROBERT HAMILTON & C 10/22/57	A 40.00 CS B11124 0044 CREDO PETROLEUM C C 03/21/54
E 40.00 CS E03149 0001 CREDO PETROLEUM C C 12/10/59	F 40.00 CS B11124 0037 EVKO DEVELOPMENT C 03/21/54	G 40.00 CS VA1916 0001 RICHARDSON PRODUC C 02/01/04	H 40.00 CS E03149 0001 CREDO PETROLEUM C C 12/10/59 A
L 40.00 CS VA1916 0001 RICHARDSON PRODUC 02/01/04	K 40.00 CS VA1916 0001 RICHARDSON PRODUC 02/01/04	J 40.00 CS E03149 0001 CREDO PETROLEUM C 12/10/59	I 40.00 CS VA1916 0001 RICHARDSON PRODUC 02/01/04
M 40.00 CS VA1916 0001 RICHARDSON PRODUC 02/01/04	N 40.00 CS VA1916 0001 RICHARDSON PRODUC 02/01/04 A	O 40.00 CS VA1916 0001 RICHARDSON PRODUC 02/01/04	P 40.00 CS VA1916 0001 RICHARDSON PRODUC 02/01/04

County SAN JUAN

POOL HARPER HILL FRUITLAND ^{SAND} PICTURED CLIFFS

TOWNSHIP

30 N

Range

14 W

NMPM

78160

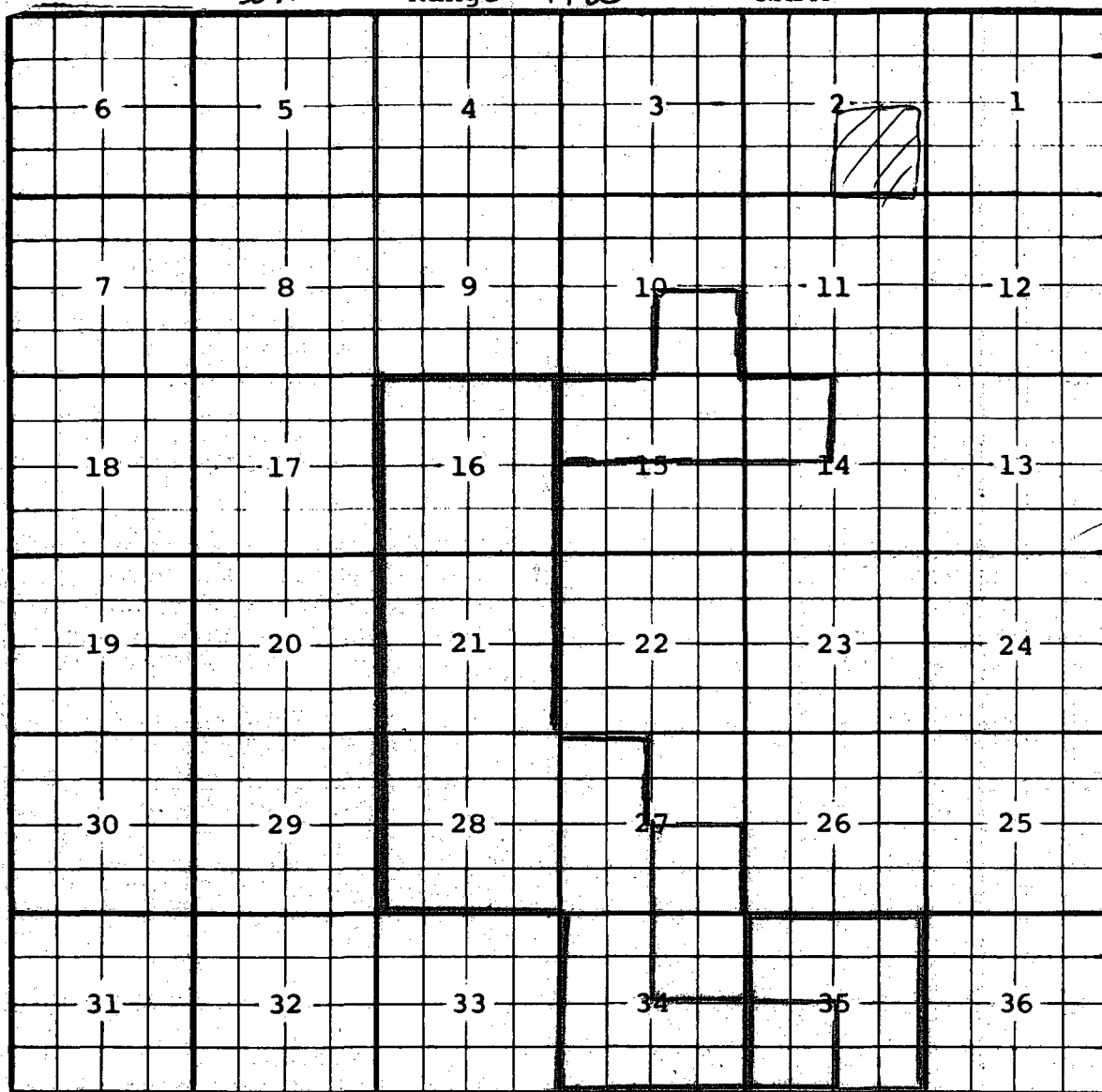

Ext: $N\frac{1}{2}$ & $SE\frac{1}{4}$ Sec. 35 (R-6180, 11-1-79) Ext: $SE\frac{1}{4}$ Sec. 27, $NE\frac{1}{4}$ Sec. 34,

$SW\frac{1}{4}$ Sec. 35 (R-6327, 5-1-80) REDESIGNATED (R-8769, 10/17/88)

Ext: All Sec. 16, All Sec. 21, $\frac{1}{2}$ Sec. 27, All Sec. 28, $SE\frac{1}{4}$ and $\frac{1}{2}$ Sec. 34 (R-11445, 9-5-00)

Ext: $SE\frac{1}{4}$ Sec. 10, $NO\frac{1}{4}$ Sec. 14, $N\frac{1}{2}$ Sec. 15 (R-11540, 2-26-01)

County San Juan Pool Corner - Fruitland SAND

75030

TOWNSHIP 30 North

Range 14 West

NMPM

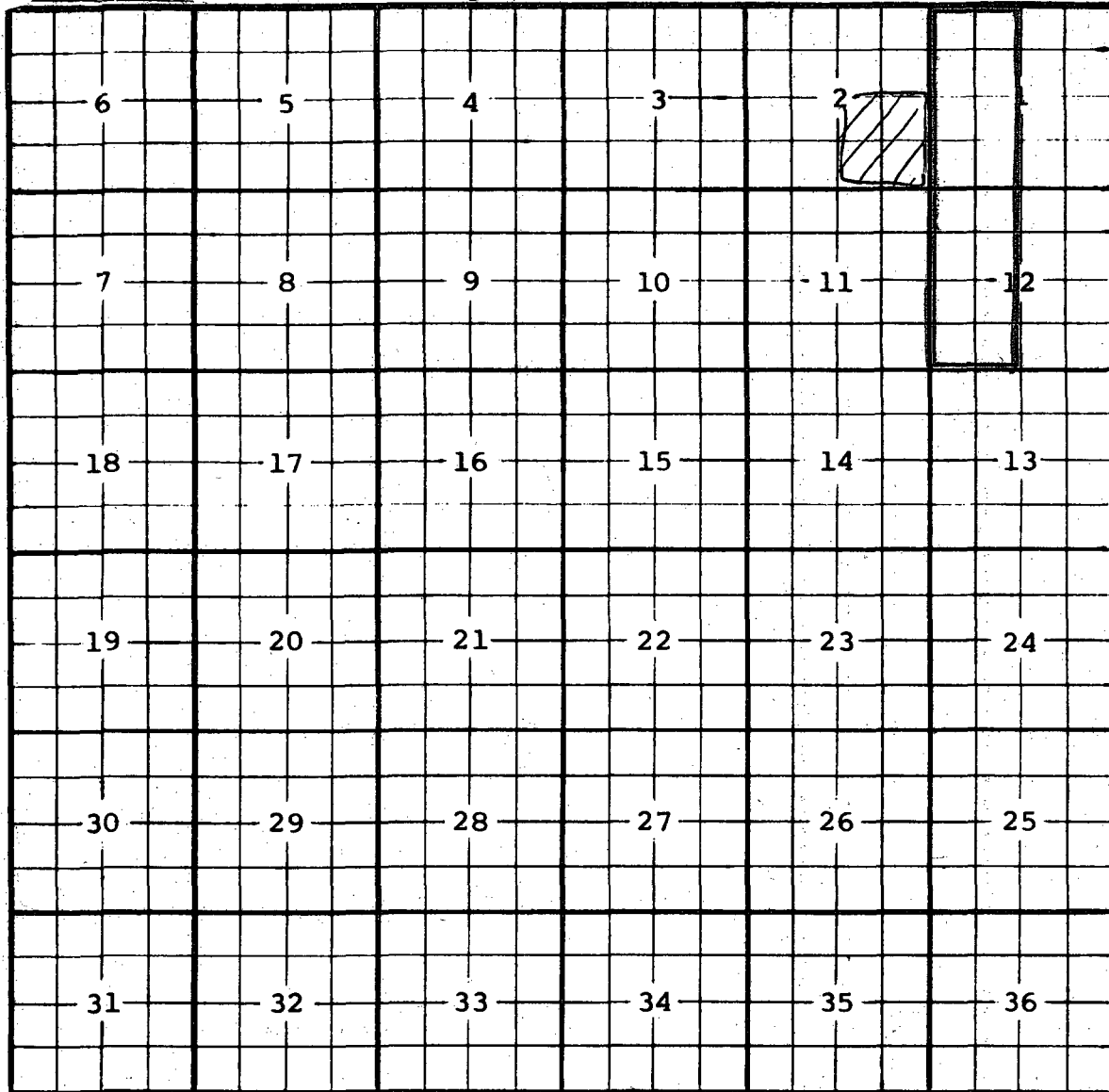

Description: $\frac{1}{2}$ Sec 1, $\frac{1}{2}$ Sec 12 (R-5596, 1-1-78)

REDESIGNATED (R-8069, 10/17/88)

STATE OF NEW MEXICO
ENERGY, MINERALS AND NATURAL RESOURCES DEPARTMENT
OIL CONSERVATION DIVISION

IN THE MATTER OF THE HEARING
CALLED BY THE OIL CONSERVATION
DIVISION FOR THE PURPOSE OF
CONSIDERING:

CASE NO. 9421
Order No. R-8769

IN THE MATTER OF THE HEARING
CALLED BY THE OIL CONSERVATION
DIVISION ON ITS OWN MOTION FOR
AN ORDER CONTRACTING THE VERTICAL
LIMITS AND REDESIGNATING CERTAIN
POOLS IN SAN JUAN AND RIO ARriba
COUNTIES, NEW MEXICO.

ORDER OF THE DIVISION

BY THE DIVISION:

This cause came on for hearing at 8:30 a.m. on July 6, 1988, at Farmington, New Mexico, before Examiner David R. Catanach.

NOW, on this 17th day of October, 1988, the Division Director, having considered the testimony, the record, and the recommendations of the Examiner, and being fully advised in the premises,

FINDS THAT:

(1) Due public notice having been given as required by law, the Division has jurisdiction of this cause and the subject matter thereof.

(2) Division Case Nos. 9421 and 9420 were consolidated at the time of the hearing for the purpose of testimony.

(3) By Order No. R-8768, entered in companion Case No. 9420, the Division has created and defined the Basin-Fruitland Coal Gas Pool with vertical limits comprising all coal seams within the equivalent of the stratigraphic interval from a depth of approximately 2450 feet to 2880 feet as shown on the Gamma Ray/Bulk Density Log from Amoco Production Company's Schneider Gas Com "B" Well No. 1 located 1110 feet from the South line and 1185 feet from the West line of Section 28, Township 32 North, Range 10 West, NMPM, San Juan County, New Mexico.

-2-

Case No. 9421
Order No. R-8769

(4) The proposed contraction of the vertical limits of the Mt. Nebo-Fruitland Pool in San Juan County, New Mexico, should be dismissed inasmuch as Division Order No. R-7588-B approved said contraction.

(5) There is need for the contraction of the vertical limits and the redesignation of the Aztec-Fruitland Pool, the North Aztec-Fruitland Pool, the Blanco-Fruitland Pool, the Conner-Fruitland Pool, the Crouch Mesa-Fruitland Pool, the Farmer-Fruitland Pool, the Flora Vista-Fruitland Pool, the Gallegos-Fruitland Pool, the South Gallegos Fruitland-Pictured Cliffs Pool, the Glades-Fruitland Pool, the Harper Hill Fruitland-Pictured Cliffs Pool, the Jasis Canyon-Fruitland Pool, the Kutz-Fruitland Pool, the West Kutz-Fruitland Pool, the North Los Pinos-Fruitland Pool, the South Los Pinos Fruitland-Pictured Cliffs Pool, the Ojo Fruitland-Pictured Cliffs Pool, the Pinon-Fruitland Pool, the North Pinon-Fruitland Pool, the Pump Mesa-Fruitland Pool, the Sedro Canyon-Fruitland Pool, the Twin Mounds Fruitland-Pictured Cliffs Pool, and the WAW Fruitland-Pictured Cliffs Pool, all in San Juan County, New Mexico, and the Cottonwood-Fruitland Pool and the La Jara-Fruitland Pool, both in Rio Arriba County, New Mexico, to include only the sandstone intervals.

IT IS THEREFORE ORDERED THAT:

(a) The vertical limits of the Aztec-Fruitland Pool in San Juan County, New Mexico, are hereby contracted to include only the sandstone interval of the Fruitland formation and said pool is hereby redesignated as the Aztec-Fruitland Sand Pool.

(b) The vertical limits of the North Aztec-Fruitland Pool in San Juan County, New Mexico, are hereby contracted to include only the sandstone interval of the Fruitland formation and said pool is hereby redesignated as the North Aztec-Fruitland Sand Pool.

(c) The vertical limits of the Blanco-Fruitland Pool in San Juan County, New Mexico, are hereby contracted to include only the sandstone interval of the Fruitland formation and said pool is hereby redesignated as the Blanco-Fruitland Sand Pool.

(d) The vertical limits of the Conner-Fruitland Pool in San Juan County, New Mexico, are hereby contracted to include only the sandstone interval of the Fruitland formation and said pool is hereby redesignated as the Conner-Fruitland Sand Pool.

(e) The vertical limits of the Cottonwood-Fruitland Pool in Rio Arriba County, New Mexico, are hereby contracted to include only the sandstone interval of the Fruitland formation and said pool is hereby redesignated as the Cottonwood-Fruitland Sand Pool.

(f) The vertical limits of the Crouch Mesa-Fruitland Pool in San Juan County, New Mexico, are hereby contracted to include only the sandstone interval of the Fruitland formation and said pool is hereby redesignated as the Crouch Mesa-Fruitland Sand Pool.

(g) The vertical limits of the Farmer-Fruitland Pool in San Juan County, New Mexico, are hereby contracted to include only the sandstone interval of the Fruitland formation and said pool is hereby redesignated as the Farmer-Fruitland Sand Pool.

(h) The vertical limits of the Flora Vista-Fruitland Pool in San Juan County, New Mexico, are hereby contracted to include only the sandstone interval of the Fruitland formation and said pool is hereby redesignated as the Flora Vista-Fruitland Sand Pool.

(i) The vertical limits of the Gallegos-Fruitland Pool in San Juan County, New Mexico, are hereby contracted to include only the sandstone interval of the Fruitland formation and said pool is hereby redesignated as the Gallegos-Fruitland Sand Pool.

(j) The vertical limits of the South Gallegos Fruitland-Pictured Cliffs Pool in San Juan County, New Mexico, are hereby contracted to include only the sandstone interval of the Fruitland formation and said pool is hereby redesignated as the South Gallegos Fruitland Sand-Pictured Cliffs Pool.

(k) The vertical limits of the Glades-Fruitland Pool in San Juan County, New Mexico, are hereby contracted to include only the sandstone interval of the Fruitland formation and said pool is hereby redesignated as the Glades-Fruitland Sand Pool.

(l) The vertical limits of the Harper Hill Fruitland-Pictured Cliffs Pool in San Juan County, New Mexico, are hereby contracted to include only the sandstone interval of the Fruitland formation and said pool is hereby redesignated as the Harper Hill Fruitland Sand-Pictured Cliffs Pool.

(m) The vertical limits of the Jasis Canyon-Fruitland Pool in San Juan County, New Mexico, are hereby contracted to include only the sandstone interval of the Fruitland formation and said pool is hereby redesignated as the Jasis Canyon-Fruitland Sand Pool.

(n) The vertical limits of the Kutz-Fruitland Pool in San Juan County, New Mexico, are hereby contracted to include only the sandstone interval of the Fruitland formation and said pool is hereby redesignated as the Kutz-Fruitland Sand Pool.

(o) The vertical limits of the West Kutz-Fruitland Pool in San Juan County, New Mexico, are hereby contracted to include only the sandstone interval of the Fruitland formation and said pool is hereby redesignated as the West Kutz-Fruitland Sand Pool.

(p) The vertical limits of the La Jara-Fruitland Pool in Rio Arriba County, New Mexico, are hereby contracted to include only the sandstone interval of the Fruitland formation and said pool is hereby redesignated as the La Jara-Fruitland Sand Pool.

(q) The vertical limits of the North Los Pinos-Fruitland Pool in San Juan County, New Mexico, are hereby contracted to include only the sandstone interval of the Fruitland formation and said pool is hereby redesignated as the North Los Pinos-Fruitland Sand Pool.

(r) The vertical limits of the South Los Pinos Fruitland-Pictured Cliffs Pool in San Juan County, New Mexico, are hereby contracted to include only the sandstone interval of the Fruitland formation and said pool is hereby redesignated as the South Los Pinos Fruitland Sand-Pictured Cliffs Pool.

(s) The proposed contraction of the vertical limits of the Mt. Nebo-Fruitland Pool in San Juan County, New Mexico, is hereby dismissed.

(t) The vertical limits of the Ojo Fruitland-Pictured Cliffs Pool in San Juan County, New Mexico, are hereby contracted to include only the sandstone interval of the Fruitland formation and said pool is hereby redesignated as the Ojo Fruitland Sand-Pictured Cliffs Pool.

-5-

Case No. 9421
Order No. R-8769

(u) The vertical limits of the Pinon-Fruitland Pool in San Juan County, New Mexico, are hereby contracted to include only the sandstone interval of the Fruitland formation and said pool is hereby redesignated as the Pinon-Fruitland Sand Pool.

(v) The vertical limits of the North Pinon-Fruitland Pool in San Juan County, New Mexico, are hereby contracted to include only the sandstone interval of the Fruitland formation and said pool is hereby redesignated as the North Pinon-Fruitland Sand Pool.

(w) The vertical limits of the Pump Mesa-Fruitland Pool in San Juan County, New Mexico, are hereby contracted to include only the sandstone interval of the Fruitland formation and said pool is hereby redesignated as the Pump Mesa-Fruitland Sand Pool.

(x) The vertical limits of the Sedro Canyon-Fruitland Pool in San Juan County, New Mexico, are hereby contracted to include only the sandstone interval of the Fruitland formation and said pool is hereby redesignated as the Sedro Canyon-Fruitland Sand Pool.

(y) The vertical limits of the Twin Mounds Fruitland-Pictured Cliffs Pool in San Juan County, New Mexico, are hereby contracted to include only the sandstone interval of the Fruitland formation and said pool is hereby redesignated as the Twin Mounds Fruitland Sand-Pictured Cliffs Pool.

(z) The vertical limits of the WAW Fruitland-Pictured Cliffs Pool in San Juan County, New Mexico, are hereby contracted to include only the sandstone interval of the Fruitland formation and said pool is hereby redesignated as the WAW Fruitland Sand-Pictured Cliffs Pool.

IT IS FURTHER ORDERED THAT:

(1) The effective date of this order and all contractions of vertical limits and redesignations included herein shall be November 1, 1988.

-6-

Case No. 9421

Order No. R-8769

DONE at Santa Fe, New Mexico, on the day and year
hereinabove designated.

STATE OF NEW MEXICO
OIL CONSERVATION DIVISION

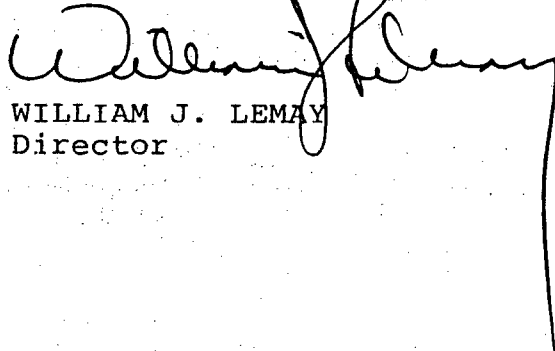
WILLIAM J. LEMAY
Director

S E A L

fd/

STATE OF NEW MEXICO
ENERGY, MINERALS AND NATURAL RESOURCES DEPARTMENT
OIL CONSERVATION DIVISION

CASE NO. 9421
ORDER NO. R-8769-A

IN THE MATTER OF THE HEARING CALLED
BY THE OIL CONSERVATION DIVISION ON
ITS OWN MOTION FOR AN ORDER CONTRACTING
THE VERTICAL LIMITS AND REDESIGNATING
CERTAIN POOLS IN SAN JUAN AND RIO ARriba
COUNTIES, NEW MEXICO.

NUNC PRO TUNC ORDER

BY THE DIVISION:

It appearing to the Division that Order No. R-8769 dated October 17, 1988,
does not correctly state the intended order of the Division,

IT IS THEREFORE ORDERED THAT:

(1) Decretory Paragraph (j) on page 3 of said Order No. R-8769 be and
the same is hereby amended to read as follows:

"(j) The vertical limits of the South Gallegos Fruitland-Pictured
Cliffs Pool in San Juan County, New Mexico, are hereby contracted
to include only the Pictured Cliffs formation and the sandstone
interval of the Fruitland formation and said pool is hereby
redesignated as the South Gallegos Fruitland Sand-Pictured Cliffs
Pool."

(2) Decretory Paragraph (l) on page 3 of said Order No. R-8769 be and
the same is hereby amended to read as follows:

"(l) The vertical limits of the Harper Hill Fruitland-Pictured Cliffs
Pool in San Juan County, New Mexico, are hereby contracted to
include only the Pictured Cliffs formation and the sandstone interval
of the Fruitland formation and said pool is hereby redesignated as the
Harper Hill Fruitland Sand-Pictured Cliffs Pool."

(3) Decretory Paragraph (r) on page 4 of said Order No. R-8769 be and the same is hereby amended to read as follows:

"(r) The vertical limits of the South Los Pinos Fruitland-Pictured Cliffs Pool in San Juan County, New Mexico, are hereby contracted to include only the Pictured Cliffs formation and the sandstone interval of the Fruitland formation and said pool is hereby redesignated as the South Los Pinos Fruitland Sand-Pictured Cliffs Pool."

(4) Decretory Paragraph (t) on page 4 of said Order No. R-8769 be and the same is hereby amended to read as follows:

"(t) The vertical limits of the Ojo Fruitland-Pictured Cliffs Pool in San Juan County, New Mexico, are hereby contracted to include only the Pictured Cliffs formation and the sandstone interval of the Fruitland formation and said pool is hereby redesignated as the Ojo Fruitland Sand-Pictured Cliffs Pool."

(5) Decretory Paragraph (y) on page 5 of said Order No. R-8769 be and the same is hereby amended to read as follows:

"(y) The vertical limits of the Twin Mounds Fruitland- Pictured Cliffs Pool in San Juan County, New Mexico, are hereby contracted to include only the Pictured Cliffs formation and the sandstone interval of the Fruitland formation and said pool is hereby redesignated as the Twin Mounds Fruitland Sand-Pictured Cliffs Pool."

(6) Decretory Paragraph (z) on page 5 of said Order No. R-8769 be and the same is hereby amended to read as follows:

"(z) The vertical limits of the WAW Fruitland-Pictured Cliffs Pool in San Juan County, New Mexico, are hereby contracted to include only the Pictured Cliffs formation and the sandstone interval of the Fruitland formation and said pool is hereby redesignated as the WAW Fruitland Sand-Pictured Cliffs Pool."

(7) The corrections set forth in this order be entered nunc pro tunc as of October 17, 1988.

(8) DONE at Santa Fe, New Mexico, on this 11th day of April, 1989.

STATE OF NEW MEXICO
OIL CONSERVATION DIVISION

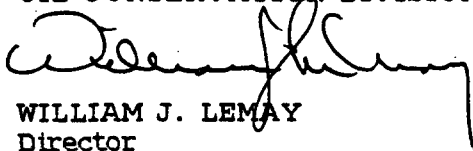
WILLIAM J. LEMAY
Director

S E A L

CMD : ONGARD 01/14/04 10:13:50
OG6C101 C101-APPLICATION FOR PERMIT TO DRILL OGOMES -TQGB

OGRID Idn : 19219 API Well No: 30 45 30759 APD Status(A/C/P): A
Opr Name, Addr: RICHARDSON OPERATING CO Aprvl/Cncl Date : 08-25-2003
4601 DTC BLVD
SUITE 470
DENVER,CO 80237-2558

Prop Idn: 24582 WF STATE 2 Well No: 3

U/L	Sec	Township	Range	Lot	Idn	North/South	East/West
-----	-----	----------	-------	-----	-----	-------------	-----------

---	---	-----	-----	-----	-----	-----	-----
-----	-----	-------	-------	-------	-------	-------	-------

Surface Locn :	N	2	30N	14W		FTG 1237 F S	FTG 1790 F W
----------------	---	---	-----	-----	--	--------------	--------------

OCD U/L :	N	API County : 45					
-----------	---	-----------------	--	--	--	--	--

Work typ(N/E/D/P/A) : N Well typ(O/G/M/I/S/W/C): G Cable/Rotary (C/R) : R
Lease typ(F/S/P/N/J/U/I): S Ground Level Elevation : 5955

State Lease No: Multiple Comp (S/M/C) : M
Prpsd Depth : 1850 Prpsd Frmtn : HRPR HILL FT SD PC/FCOAL (ABL8-25-03)

E0009: Enter data to modify record

PF01 HELP	PF02	PF03 EXIT	PF04 GoTo	PF05	PF06 CONFIRM
PF07	PF08	PF09 PRINT	PF10 C102	PF11 HISTORY	PF12

District I
1625 N. French Dr., Hobbs, NM 88240
District II
811 South First, Artesia, NM 88210
District III
1000 Rio Brazos Road, Aztec, NM 87410
District IV
1220 S. St. Francis Dr., Santa Fe, NM 87505

State of New Mexico
Energy Minerals and Natural Resources

Oil Conservation Division
1220 South St. Francis Dr.
Santa Fe, NM 87505

Form C-101
Revised March 17, 1999

Submit to appropriate District Office
State Lease - 6 Copies
Fee Lease - 5 Copies

☐ AMENDED REPORT

APPLICATION FOR PERMIT TO DRILL, RE-ENTER, DEEPEN, PLUGBACK, OR ADD A ZONE

¹ Operator Name and Address Richardson Operating Company (303) 830-8000 1700 Lincoln St., Suite 1700, Denver, Co. 80203		² OGRID Number 19219
³ Property Code 24582	⁴ Property Name WF State 2	⁵ API Number 30-045-30759
		⁶ Well No. 3

⁷Surface Location

UL or lot no.	Section	Township	Range	Lot kdn	Feet from the	North/South line	Feet from the	East/West line	County
N	2	30n	14w		1237	South	1790	West	SJ

⁸Proposed Bottom Hole Location If Different From Surface

UL or lot no.	Section	Township	Range	Lot kdn	Feet from the	North/South line	Feet from the	East/West line	County
Harper Hil Pic. Cliff						Basin Fruitlad Coal			

¹¹ Work Type Code N -	¹² Well Type Code G -	¹³ Cable/Rotary R	¹⁴ Lease Type Code S -	¹⁵ Ground Level Elevation 5955' -
¹⁶ Multiple Yes -	¹⁷ Proposed Depth 1,850'	¹⁸ Formation Lewis	¹⁹ Contractor	²⁰ Spud Date 9-25-01

²¹Proposed Casing and Cement Program

Hole Size	Casing Size	Casing weight/foot	Setting Depth	Sacks of Cement	Estimated TOC
8 - 3/4"	7"	20	120'	60 sx	Surface —
6 - 1/4"	4 - 1/2"	10.5	1,850'	180 sx	Surface —

²² Describe the proposed program. If this application is to DEEPEN or PLUG BACK, give the data on the present productive zone and proposed new productive zone.
Describe the blowout prevention program, if any. Use additional sheets if necessary.

Will use 2000# BOP and run logs and DST as appropriate.

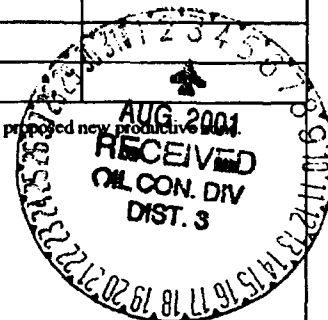

²³ I hereby certify that the information given above is true and complete to the best of my knowledge and belief. Signature: <i>Brian Wood</i>		OIL CONSERVATION DIVISION	
Printed name: Brian Wood		Approved by: <i>[Signature]</i>	
Title: Consultant		Title: DEPUTY OIL & GAS INSPECTOR, DIST. #3	
Date: August 2, 2001		Approval Date: AUG - 3 2001 Expiration Date: AUG - 3 2002	
Phone: (505) 466-8120		Conditions of Approval: Attached <input type="checkbox"/>	

State of New Mexico
Energy, Minerals & Mining Resources Department
OIL CONSERVATION DIVISION
2040 South Pacheco
Santa Fe, NM 87505

Form C - 102

☐ AMENDED REPORT

WELL LOCATION AND ACREAGE DEDICATION PLAT

APA Number 30-065-30759	Pool Code 71629 & 78160	Pool Name FRUIT. COAL & HARP. HILL PC
Property Code 24582	Property Name STATE 2	Well Number 3
OGRID No. 019219	Operator Name RICHARDSON OPERATING COMPANY	Elevation 5955'

Surface Location									
UL or Lot . N	Sec. . 2	Twp. 30 N.	Rge. .14 W.	Lot Idn.	Feet from>	North/South SOUTH	Feet from>	East/West WEST	County SAN JUAN

Bottom Hole Location If Different From Surface									
UL or Lot	Sec.	Twp.	Rge.	Lot Idn.	Feet from>	North/South	Feet from>	East/West	County
Dedication 160 PC 320 FC	Joint ?	Consolidation	Order No.						

NO ALLOWABLE WILL ASSIGNED TO THIS COMPLETION UNTIL ALL INTERESTS HAVE BEEN CONSOLIDATED
OR A NON-STANDARD UNIT HAS BEEN APPROVED BY THE DIVISION

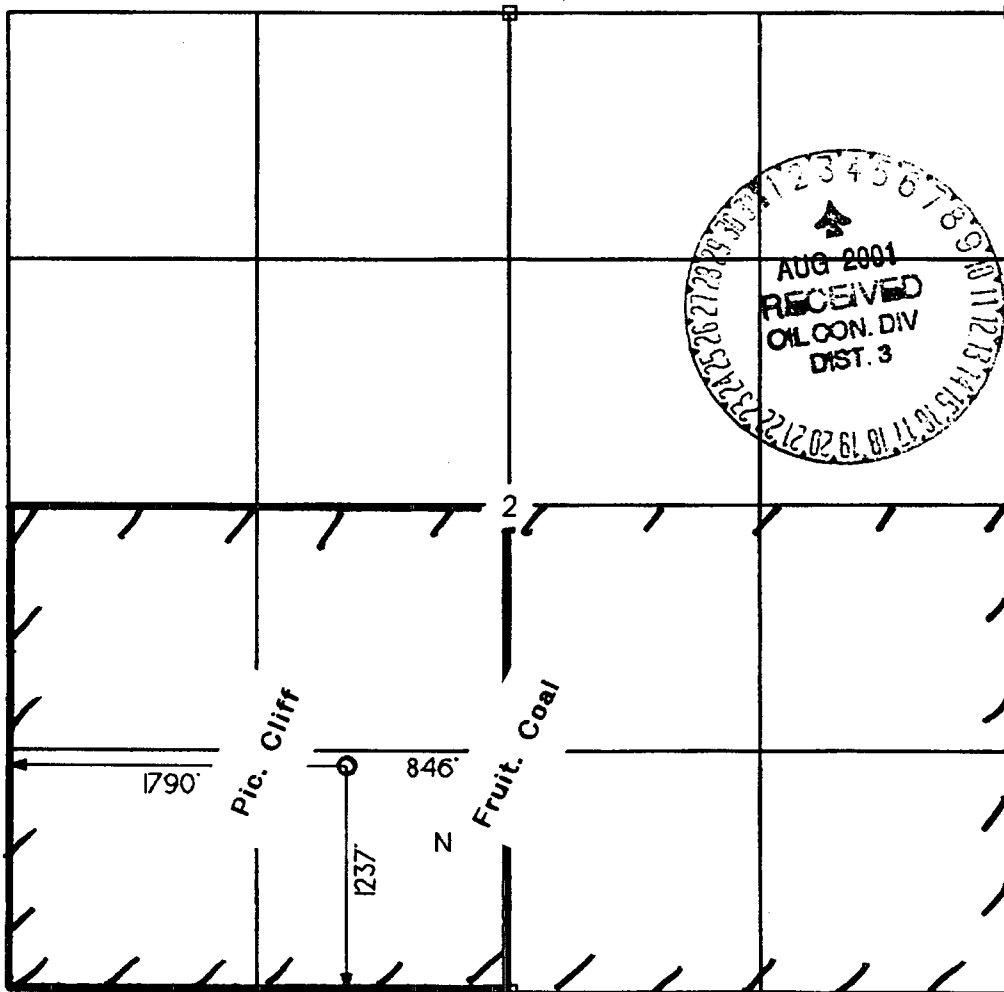

OPERATOR CERTIFICATION	
I hereby certify that the information contained herein is true and complete to the best of my knowledge and belief.	
Signature	<i>Brian Wood</i>
Printed Name	BRIAN WOOD
Title	CONSULTANT
Date	AUGUST 2, 2001
SURVEYOR CERTIFICATION	
I hereby certify that the well location on this plat was plotted from field notes of actual surveys made by me or under my supervision, and that the same is true and correct to the best of my belief.	
Date of Survey	
Signature and Seal of Professional Surveyor	<i>AL HUNTER</i>

Submit 3 Copies To Appropriate District
Office
District I
1625 N. French Dr., Hobbs, NM 88240
District II
1301 W. Grand Ave., Artesia, NM 88210
District III
1000 Rio Brazos Rd., Aztec, NM 87410
District IV
1220 S. St. Francis Dr., Santa Fe, NM
87505

State of New Mexico
Energy, Minerals and Natural Resources
OIL CONSERVATION DIVISION
1220 South St. Francis Dr.
Santa Fe, NM 87505

Form C-103
Revised March 25, 1999

SUNDRY NOTICES AND REPORTS ON WELLS (DO NOT USE THIS FORM FOR PROPOSALS TO DRILL OR TO DEEPEN OR PLUG BACK TO A DIFFERENT RESERVOIR. USE "APPLICATION FOR PERMIT" (FORM C-101) FOR SUCH PROPOSALS.)		WELL API NO. 30-045-30759
1. Type of Well: Oil Well <input type="checkbox"/> Gas Well <input checked="" type="checkbox"/> Other		5. Indicate Type of Lease STATE <input checked="" type="checkbox"/> FEE <input type="checkbox"/>
2. Name of Operator Richardson Operating Company		6. State Oil & Gas Lease No.
3. Address of Operator 3100 La Plata Highway, Farmington NM 87401		7. Lease Name or Unit Agreement Name: WF State 2
4. Well Location Unit Letter <u>N</u> : 1237 feet from the <u>South</u> line and <u>1790</u> feet from the <u>West</u> line Section <u>2</u> Township <u>30N</u> Range <u>14W</u> NMPM County <u>San Juan</u>		7. Well No. #3
10. Elevation (Show whether DR, RKB, RT, GR, etc.) 5955' GR		9. Pool name or Wildcat Basin Fruitland & Harper Hill PC

11. Check Appropriate Box to Indicate Nature of Notice, Report or Other Data

NOTICE OF INTENTION TO:		SUBSEQUENT REPORT OF:	
PERFORM REMEDIAL WORK <input type="checkbox"/>	PLUG AND ABANDON <input type="checkbox"/>	REMEDIAL WORK <input type="checkbox"/>	ALTERING CASING <input type="checkbox"/>
TEMPORARILY ABANDON <input type="checkbox"/>	CHANGE PLANS <input type="checkbox"/>	COMMENCE DRILLING OPNS. <input type="checkbox"/>	PLUG AND ABANDONMENT <input type="checkbox"/>
PULL OR ALTER CASING <input type="checkbox"/>	MULTIPLE COMPLETION <input type="checkbox"/>	CASING TEST AND CEMENT JOB <input type="checkbox"/>	
OTHER: Extension of APD <input checked="" type="checkbox"/>		OTHER: <input type="checkbox"/>	

12. Describe proposed or completed operations. (Clearly state all pertinent details, and give pertinent dates, including estimated date of starting any proposed work). SEE RULE 1103. For Multiple Completions: Attach wellbore diagram of proposed completion or recompletion.

Richardson Operating Company requests that APD expiration be extended for one year.

Apo Ext Exp 8-3-03

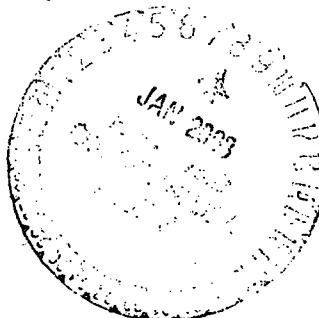

I hereby certify that the information above is true and complete to the best of my knowledge and belief.

SIGNATURE Drew Carnes TITLE Operations Manager DATE 1/7/03

Type or print name Drew Carnes Telephone No. (505) 564-3100
(This space for State use)

APPROVED BY [Signature] TITLE DEPUTY OIL & GAS INSPECTOR, MST. 63 DATE JAN - 8 2003
Conditions of approval, if any:



NEW MEXICO ENERGY, MINERALS and NATURAL RESOURCES DEPARTMENT

BILL RICHARDSON

Governor

Joanna Prukop

Cabinet Secretary

Lori Wrotenbery

Director

Oil Conservation Division

August 25, 2003

EXPIRATION NOTICE ON PERMIT TO DRILL

**RICHARDSON OPERATING CO
3100 LA PLATA HIGHWAY
FARMINGTON NM 87401**

**RE: WF STATE 2 #3 N-2-30N-14W
30-045-30759
Expired 8-3-03**

Gentlemen:

The permit to drill the referenced well has expired. Should you wish to drill this well in the future, you will have to submit a new application.

Sincerely,

**Frank T. Chavez
District Supervisor**

FTC/dj

cc: Well File

Submit 3 Copies To Appropriate District
Office
District I
1625 N. French Dr., Hobbs, NM 88240
District II
1301 W. Grand Ave., Artesia, NM 88210
District III
1000 Rio Brazos Rd., Aztec, NM 87410
District IV
1220 S. St. Francis Dr., Santa Fe, NM
87505

State of New Mexico
Energy, Minerals and Natural Resources

OIL CONSERVATION DIVISION
1220 South St. Francis Dr.
Santa Fe, NM 87505

Form C-103
Revised March 25, 1999

WELL API NO.
30-045-30759

5. Indicate Type of Lease

STATE ☒ FEE ☐

6. State Oil & Gas Lease No.

7. Lease Name or Unit Agreement Name:
WF State 2

7. Well No.

3

9. Pool name or Wildcat

Basin Fruitland & Harper Hill PC

SUNDRY NOTICES AND REPORTS ON WELLS

(DO NOT USE THIS FORM FOR PROPOSALS TO DRILL OR TO DEEPEN OR PLUG BACK TO A DIFFERENT RESERVOIR. USE "APPLICATION FOR PERMIT" (FORM C-101) FOR SUCH PROPOSALS.)

1. Type of Well:

Oil Well ☐ Gas Well ☒ Other

2. Name of Operator

Richardson Operating Company

3. Address of Operator

3100 La Plata Highway Farmington, NM 87401

4. Well Location

Unit Letter N : 1237 feet from the South line and 1790 feet from the West line

Section 2 Township 30N Range 14W NMPM County San Juan

10. Elevation (Show whether DR, RKB, RT, GR, etc.)
5955' GR

11. Check Appropriate Box to Indicate Nature of Notice, Report or Other Data

NOTICE OF INTENTION TO:

PERFORM REMEDIAL WORK ☐ PLUG AND ABANDON ☐

TEMPORARILY ABANDON ☐ CHANGE PLANS ☐

PULL OR ALTER CASING ☐ MULTIPLE COMPLETION ☐

OTHER:

SUBSEQUENT REPORT OF:

REMEDIAL WORK ☐ ALTERING CASING ☐

COMMENCE DRILLING OPNS. ☒ PLUG AND ABANDONMENT ☐

CASING TEST AND CEMENT JOB ☐

OTHER: ☐

12. Describe proposed or completed operations. (Clearly state all pertinent details, and give pertinent dates, including estimated date of starting any proposed work). SEE RULE 1103. For Multiple Completions: Attach wellbore diagram of proposed completion or reocompilation.

07/14/03 Spud 12 1/4" surface hole. Drill to 40'. Rig broke down.

08/13 to 08/14/03 Drill to 132'

08/15/03 Ran 3 Joints 8 5/8" 24 # J-55 Casing to 126. Mix and Pump 100 sx (118 Cu. Ft.) Class 'B' w/ 2% CaCl2, 1/4#/sk celloflake, 15.6 ppg. Circ 7 Bbl cement. WOC 12 hours.

08/16/03 NU and test BOP to 600 psi, test good. Test Surface Casing to 600 psi, test good. Drill 7 7/8" hole to 690'

08/17 to 08/19/2003 Drill 7 7/8" hole to 1800'; TD.

08/20/03 Ran 39 jts. 5 1/2" 17# J-55 casing; set at 1758'. Float collar at 1713'. Pump 175 sx (494 cu.ft.) Class 'B' cement w/ 3% metasilicate, 3#/sk gilsonite, 1/4#/sk celloflake; 11.4 ppg slurry lead. Pump 176 sx (208 cu.ft.) Class 'B' cement w/ 3#/sk gilsonite, 1/4#/sk celloflake; 15.6 ppg slurry. Circulated 6 Bbl good cement. Bumped plug to 700 psi, plug held.

I hereby certify that the information above is true and complete to the best of my knowledge and belief.

SIGNATURE



TITLE Operations Manager

DATE 08-26-03

Type or print name Drew Carnes

(This space for State use)

Telephone No. 505-564-3100

APPROVED BY



TITLE

DEPUTY OIL & GAS INSPECTOR, DIST. 3

DATE

AUG 27 2003

Conditions of approval, if any:

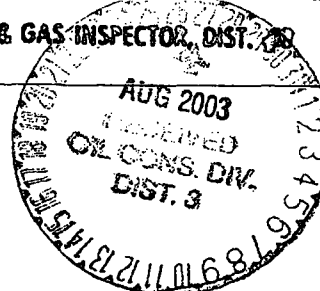

01/28/04 14:51:25
OGOMES -TPFW

API Well No : 30 45 32097 Eff Date : 01-14-2004 WC Status : N
Pool Idn : 71629 BASIN FRUITLAND COAL (GAS)
OGRID Idn : 19219 RICHARDSON OPERATING CO
Prop Idn : 24582 WF STATE 2

Well No : 004
GL Elevation: 5922

	U/L	Sec	Township	Range	North/South	East/West	Prop/Act (P/A)
	---	---	-----	-----	-----	-----	-----
B.H. Locn : J	2	30N	14W	FTG 2060 F S	FTG 2095 F E		
Lot Identifier:							
Dedicated Acre: 320.00							
Lease Type : S							
Type of consolidation (Comm, Unit, Forced Pooling - C/U/F/O) :							

M0025: Enter PF keys to scroll

```
PF01 HELP      PF02      PF03 EXIT      PF04 GoTo      PF05      PF06
PF07      PF08      PF09      PF10 NEXT-WC PF11 HISTORY PF12 NXTREC
```

CMD : ONGARD 01/28/04 14:51:53
OG6ACRE C102-DEDICATE ACREAGE OGOMES -TPFW
Page No : 1

API Well No : 30 45 32097 Eff Date : 01-14-2004
Pool Idn : 71629 BASIN FRUITLAND COAL (GAS)
Prop Idn : 24582 WF STATE 2 Well No : 004
Spacing Unit : 90485 OCD Order : Simultaneous Dedication:
Sect/Twp/Rng : 2 30N 14W Acreage : 320.00 Revised C102? (Y/N) :
Dedicated Land:

S	Base	U/L	Sec	Twp	Rng	Acreage	L/W	Ownership	Lot	Idn
	I	I	2	30N	14W	40.00	N	ST		
	J	J	2	30N	14W	40.00	N	ST		
	K	K	2	30N	14W	40.00	N	ST		
	L	L	2	30N	14W	40.00	N	ST		
	M	M	2	30N	14W	40.00	N	ST		
	N	N	2	30N	14W	40.00	N	ST		
	O	O	2	30N	14W	40.00	N	ST		
	P	P	2	30N	14W	40.00	N	ST		

E0005: Enter data to modify or PF keys to scroll

PF01 HELP	PF02	PF03 EXIT	PF04 GoTo	PF05	PF06 CONFIRM
PF07 BKWD	PF08 FWD	PF09	PF10 LAND	PF11 NXTSEC	PF12 RECONF

CMD : ONGARD 01/28/04 14:51:36
OG6IWCM INQUIRE WELL COMPLETIONS OGOMES -TPFW

API Well No : 30 45 32097 Eff Date : 01-14-2004 WC Status : N
Pool Idn : 78160 HARPER HILL FRUITLAND SAND PC (GAS)
OGRID Idn : 19219 RICHARDSON OPERATING CO
Prop Idn : 24582 WF STATE 2

Well No : 004
GL Elevation: 5922

	U/L	Sec	Township	Range	North/South	East/West	Prop/Act (P/A)
	---	---	-----	-----	-----	-----	-----
B.H. Locn	: J	2	30N	14W	FTG 2060 F S	FTG 2095 F E	

Lot Identifier:
Dedicated Acre: 160.00
Lease Type : S
Type of consolidation (Comm, Unit, Forced Pooling - C/U/F/O) :

PF01 HELP	PF02	PF03 EXIT	PF04 GoTo	PF05	PF06
PF07	PF08	PF09	PF10 NEXT-WC	PF11 HISTORY	PF12 NXTREC

CMD : ONGARD 01/28/04 14:51:43
OG6ACRE C102-DEDICATE ACREAGE OGOMES -TPFW
Page No : 1

API Well No : 30 45 32097 Eff Date : 01-14-2004
Pool Idn : 78160 HARPER HILL FRUITLAND SAND PC (GAS)
Prop Idn : 24582 WF STATE 2 Well No : 004
Spacing Unit : 90486 OCD Order : Simultaneous Dedication:
Sect/Twp/Rng : 2 30N 14W Acreage : 160.00 Revised C102? (Y/N) :
Dedicated Land:

S	Base	U/L	Sec	Twp	Rng	Acreage	L/W	Ownership	Lot	Idn
I	I		2	30N	14W	40.00	N	ST		
J	J		2	30N	14W	40.00	N	ST		
O	O		2	30N	14W	40.00	N	ST		
P	P		2	30N	14W	40.00	N	ST		

E0005: Enter data to modify or PF keys to scroll

PF01 HELP PF02 PF03 EXIT PF04 GoTo PF05 PF06 CONFIRM
PF07 BKWD PF08 FWD PF09 PF10 LAND PF11 NXTSEC PF12 RECONF