

DATE IN <u>2-22-10</u>	SUSPENSE	ENGINEER <u>RE</u>	LOGGED IN <u>2-22-10</u>	TYPE <u>PC</u>	PTF <u>W</u> APP NO. <u>1005345210</u>
------------------------	----------	--------------------	--------------------------	----------------	---

ABOVE THIS LINE FOR DIVISION USE ONLY

NEW MEXICO OIL CONSERVATION DIVISION

- Engineering Bureau -

1220 South St. Francis Drive, Santa Fe, NM 87505



Apache

Hansen State #3, 7,

ADMINISTRATIVE APPLICATION CHECKLIST

8, 9 & 11

THIS CHECKLIST IS MANDATORY FOR ALL ADMINISTRATIVE APPLICATIONS FOR EXCEPTIONS TO DIVISION RULES AND REGULATIONS WHICH REQUIRE PROCESSING AT THE DIVISION LEVEL IN SANTA FE

Application Acronyms:

[NSL-Non-Standard Location] [NSP-Non-Standard Proration Unit] [SD-Simultaneous Dedication]

[DHC-Downhole Commingling] [CTB-Lease Commingling] [PLC-Pool/Lease Commingling]

[PC-Pool Commingling] [OLS - Off-Lease Storage] [OLM-Off-Lease Measurement]

[WFX-Waterflood Expansion] [PMX-Pressure Maintenance Expansion]

[SWD-Salt Water Disposal] [IPI-Injection Pressure Increase]

[EOR-Qualified Enhanced Oil Recovery Certification] [PPR-Positive Production Response]

*5 wells
Leahs.*

[1] TYPE OF APPLICATION - Check Those Which Apply for [A]

[A] Location - Spacing Unit - Simultaneous Dedication

☐ NSL ☐ NSP ☐ SD

Check One Only for [B] or [C]

[B] Commingling - Storage - Measurement

☐ DHC ☐ CTB ☐ PLC ☒ PC ☐ OLS ☐ OLM

[C] Injection - Disposal - Pressure Increase - Enhanced Oil Recovery

☐ WFX ☐ PMX ☐ SWD ☐ IPI ☐ EOR ☐ PPR

[D] Other: Specify _____

2010 FEB 22 A 11:18
RECEIVED OCD

[2] NOTIFICATION REQUIRED TO: - Check Those Which Apply, or Does Not Apply

[A] ☐ Working, Royalty or Overriding Royalty Interest Owners

[B] ☐ Offset Operators, Leaseholders or Surface Owner

[C] ☐ Application is One Which Requires Published Legal Notice

[D] ☒ Notification and/or Concurrent Approval by BLM or SLO

U.S. Bureau of Land Management - Commissioner of Public Lands, State Land Office

[E] ☐ For all of the above, Proof of Notification or Publication is Attached, and/or,

[F] ☐ Waivers are Attached

PC-1220

[3] SUBMIT ACCURATE AND COMPLETE INFORMATION REQUIRED TO PROCESS THE TYPE OF APPLICATION INDICATED ABOVE.

[4] CERTIFICATION: I hereby certify that the information submitted with this application for administrative approval is **accurate** and **complete** to the best of my knowledge. I also understand that **no action** will be taken on this application until the required information and notifications are submitted to the Division.

Note: Statement must be completed by an individual with managerial and/or supervisory capacity.

Amber Cooke

Print or Type Name

Signature

Engineering Tech

Title

02/19/2010

Date

amber.cooke@apachecorp.com

e-mail Address

CDP

Unit A, Sec 16, T20S R37E



January 28, 2010

Richard Ezeanyim
New Mexico Oil Conservation Division
1220 South St. Francis Drive
Santa Fe, New Mexico 87505

Re: Administrative Approval to Surface Commingle
Hansen State #3, #7, #8, #9, #11
Sec 16, T20S, R37E
Lea County, New Mexico

Dear Mr. Ezeanyim,

Apache requests administrative approval to surface commingle the following existing wells, Hansen State #3, #7, #8, #9 and Hansen State #11, a new drill. The Hansen State #11 will be an Abo/Paddock/Tubb/Drinkard well.

All wells are located on the same State Lease A0-3071. All working, revenue and royalty interest ownerships are common in all wells except for the Hansen State #9. The oil and gas production from the Hansen State #9 will be separately and continuously metered prior to commingling with the other wells (which have identical interests).

The following are enclosed for your review of the proposed surface commingling:

1. C-107B.
2. Well information table and copies of C-102's for each well.
3. Proposed production facilities diagram.
4. Well location map.
5. Cover letter sent to affected parties.
6. List of all (affected) parties that get a revenue check from the oil and gas proceeds from any well included in this commingle - (RI, ORRI, WI owners).

If you need additional information or have any questions, please give me a call at (918) 491-4968.

Sincerely,

A handwritten signature in black ink that reads "Amber Cooke". The signature is written in a cursive, flowing style.

Amber Cooke
Engineering Technician

District I
1625 N. French Drive, Hobbs, NM 88240
District II
1301 W. Grand Ave, Artesia, NM 88210
District III
1000 Rio Brazos Road, Aztec, NM 87410
District IV
1220 S. St Francis Dr, Santa Fe, NM
87505

State of New Mexico
Energy, Minerals and Natural Resources Department

Form C-107-B
Revised June 10, 2003

OIL CONSERVATION DIVISION
1220 S. St Francis Drive
Santa Fe, New Mexico 87505

Submit the original
application to the Santa Fe
office with one copy to the
appropriate District Office.

APPLICATION FOR SURFACE COMMINGLING (DIVERSE OWNERSHIP)

OPERATOR NAME: Apache Corporation

OPERATOR ADDRESS: 6120 S Yale Ave, Suite 1500 Tulsa, OK 74136

APPLICATION TYPE:

☒ Pool Commingling ☐ Lease Commingling ☐ Pool and Lease Commingling ☐ Off-Lease Storage and Measurement (Only if not Surface Commingled)

LEASE TYPE: ☐ Fee ☒ State ☐ Federal

Is this an Amendment to existing Order? ☐ Yes ☒ No If "Yes", please include the appropriate Order No. _____
Have the Bureau of Land Management (BLM) and State Land office (SLO) been notified in writing of the proposed commingling
☒ Yes ☐ No

(A) POOL COMMINGLING
Please attach sheets with the following information

(1) Pool Names and Codes	Gravities / BTU of Non-Commingled Production	Calculated Gravities / BTU of Commingled Production		Calculated Value of Commingled Production	Volumes
See attachment					

- (2) Are any wells producing at top allowables? ☐ Yes ☒ No
(3) Has all interest owners been notified by certified mail of the proposed commingling? ☒ Yes ☐ No.
(4) Measurement type: ☒ Metering ☐ Other (Specify)
(5) Will commingling decrease the value of production? ☐ Yes ☒ No If "yes", describe why commingling should be approved

(B) LEASE COMMINGLING
Please attach sheets with the following information

- (1) Pool Name and Code.
(2) Is all production from same source of supply? ☐ Yes ☐ No
(3) Has all interest owners been notified by certified mail of the proposed commingling? ☐ Yes ☐ No
(4) Measurement type: ☐ Metering ☐ Other (Specify)

(C) POOL and LEASE COMMINGLING
Please attach sheets with the following information

- (1) Complete Sections A and E.

(D) OFF-LEASE STORAGE and MEASUREMENT
Please attached sheets with the following information

- (1) Is all production from same source of supply? ☐ Yes ☐ No
(2) Include proof of notice to all interest owners.

(E) ADDITIONAL INFORMATION (for all application types)
Please attach sheets with the following information

- (1) A schematic diagram of facility, including legal location.
(2) A plat with lease boundaries showing all well and facility locations. Include lease numbers if Federal or State lands are involved.
(3) Lease Names, Lease and Well Numbers, and API Numbers.

I hereby certify that the information above is true and complete to the best of my knowledge and belief.

SIGNATURE: Amber Cooke TITLE: Engineering Tech DATE: 2/17/2010

TYPE OR PRINT NAME Amber Cooke TELEPHONE NO.: 918.491.4968

E-MAIL ADDRESS: amber.cooke@apachecorp.com

Hansen State Lease

Monument; Abo (46970)

Eunice Monument; Grayburg-San Andres (23000)

Monument; Abo, Southeast (96764)

Monument; Paddock (47080)

Monument; Tubb (47090)

Wier; Drinkard (63840)

Pool Names and Codes	Gravities/BTU of Non-Commingled Production	Calculated Gravities/BTU of Commingled Production	Calculated Value of Commingled Production	Volumes
Monument; Abo (46970)	38 API, 1142 BTU	38 API, 1142 BTU		
Eunice Monument; Grayburg-San Andres (23000)	38 API, 1142 BTU			
Monument; Abo, Southeast (96764)	38 API, 1142 BTU			
Monument; Paddock (47080)	38 API, 1142 BTU			
Monument; Tubb (47090)	38 API, 1142 BTU			
Wier; Drinkard (63840)	38 API, 1142 BTU			

Hansen State Lease

Monument; Abo (46970)

Eunice Monument; Grayburg-San Andres (23000)

Monument; Abo, Southeast (96764)

Monument; Paddock (47080)

Monument; Tubb (47090)

Wier; Drinkard (63840)

Well No.	API	Location	Pool	Status	API Gravity
Hansen State #3	30-025-06126	A -16-20S-37E	Monument; Abo Eunice Monument; Grayburg-San Andres	Active	38
Hansen State #7	30-025-33967	B -16-20S-37E	Monument; Abo, Southeast	Active	38
Hansen State #8	30-025-34203	G -16-20S-37E	Eunice Monument; Grayburg-San Andres	Active	38
Hansen State #9	30-025-34286	H -16-20S-37E	Eunice Monument; Grayburg-San Andres	Active	38
Hansen State #11	30-025-39562	A -16-20S-37E	Monument; Abo, Southeast Monument; Paddock Monument; Tubb Wier; Drinkard	New Drill	38

District I
PO Box 1980, Hobbs, NM 88241-1980
District II
PO Drawer DD, Artesia, NM 88211-0719
District III
1000 Rio Brazos Rd., Aztec, NM 87410
District IV
PO Box 2088, Santa Fe, NM 87504-2088

State of New Mexico
Energy, Minerals & Natural Resources Department

OIL CONSERVATION DIVISION
PO Box 2088
Santa Fe, NM 87504-2088

Form C-102
Revised February 10, 1994
Instructions on back
Submit to Appropriate District Office
State Lease - 4 Copies
Fee Lease - 3 Copies

☐ AMENDED REPORT

WELL LOCATION AND ACREAGE DEDICATION PLAT

1 APT Number 30-025-06126		2 Pool Code 46970		3 Pool Name Monument: Abo		
4 Property Code 6398		5 Property Name HANSEN STATE			6 Well Number 3	
7 OGRID No. 014021		8 Operator Name MARATHON OIL Co			9 Elevation 3563'	

10 Surface Location

UL or lot no. A	Section 16	Township 20-S	Range 37-E	Lot Idn	Feet from the 600	North/South line North	Feet from the 990	East/West line EAST	County LEA
--------------------	---------------	------------------	---------------	---------	----------------------	---------------------------	----------------------	------------------------	---------------

11 Bottom Hole Location If Different From Surface

UL or lot no.	Section	Township	Range	Lot Idn	Feet from the	North/South line	Feet from the	East/West line	County

12 Dedicated Acres 40	13 Joint or Infill N	14 Consolidation Code	15 Order No.
--------------------------	-------------------------	-----------------------	--------------

NO ALLOWABLE WILL BE ASSIGNED TO THIS COMPLETION UNTIL ALL INTERESTS HAVE BEEN CONSOLIDATED
OR A NON-STANDARD UNIT HAS BEEN APPROVED BY THE DIVISION

16					17 OPERATOR CERTIFICATION I hereby certify that the information contained herein is true and complete to the best of my knowledge and belief.	
					Signature 	
					Printed Name KELLY COOK	
					Title 6/23/97	
18 SURVEYOR CERTIFICATION I hereby certify that the well location shown on this plat was plotted from field notes of actual surveys made by me or under my supervision, and that the same is true and correct to the best of my belief.						
Date of Survey						
Signature and Seal of Professional Surveyor:						
Certificate Number						

District I
1625 N. French Dr., Hobbs, NM 88240
District II
1301 W. Grand Avenue, Artesia, NM 88210
District III
1000 Rio Brazos Rd., Aztec, NM 87410
District IV
1220 S. St. Francis Dr., Santa Fe, NM 87505

State of New Mexico
Energy, Minerals & Natural Resources

OIL CONSERVATION DIVISION
1220 South St. Francis Dr.
Santa Fe, NM 87505

Form C-102
Revised October 12, 2005

Submit to Appropriate District Office
State Lease - 4 Copies
Fee Lease - 3 Copies

☐ AMENDED REPORT

WELL LOCATION AND ACREAGE DEDICATION PLAT

¹ API Number 30-025-06126		² Pool Code 23000	³ Pool Name Eunice Monument Grayburg San Andres
⁴ Property Code 006398	⁵ Property Name Hansen State		⁶ Well Number 3
⁷ OGRID No. 14021	⁸ Operator Name Marathon Oil Company		⁹ Elevation 3563'

¹⁰ Surface Location

UL or lot no.	Section	Township	Range	Lot. Idn	Feet from the	North/South line	Feet from the	East/West line	County
A	16	20-S	37-E		660	North	990	East	Lea

¹¹ Bottom Hole Location If Different From Surface

UL or lot no.	Section	Township	Range	Lot. Idn	Feet from the	North/South line	Feet from the	East/West line	County

¹² Dedicated Acres 40	¹³ Joint or Infill N	¹⁴ Consolidation Code	¹⁵ Order No.
-------------------------------------	------------------------------------	----------------------------------	-------------------------

NO ALLOWABLE WILL BE ASSIGNED TO THIS COMPLETION UNTIL ALL INTERESTS HAVE BEEN CONSOLIDATED OR A NON-STANDARD UNIT HAS BEEN APPROVED BY THE DIVISION

<div data-bbox="68 995 1015 1961" data-label="Form"> <table border="1"> <tr> <td>16</td> <td></td> <td></td> <td></td> </tr> <tr> <td></td> <td></td> <td></td> <td></td> </tr> <tr> <td></td> <td></td> <td></td> <td></td> </tr> <tr> <td></td> <td></td> <td></td> <td></td> </tr> </table> </div>	16																<div data-bbox="1015 995 1497 1961" data-label="Form"> <p>¹⁷ OPERATOR CERTIFICATION I hereby certify that the information contained herein is true and complete to the best of my knowledge and belief, and that this organization either owns a working interest or unleased mineral interest in the land including the proposed bottom hole location or has a right to drill this well at this location pursuant to a contract with an owner of such a mineral or working interest, or to a voluntary pooling agreement or a compulsory pooling order heretofore entered by the division.</p> <p><u>Charles E. Kendrix</u> 07/25/2007 Signature Date</p> <p>Charles E. Kendrix Printed Name</p> <p>Reg Compliance Rep</p> <p>¹⁸ SURVEYOR CERTIFICATION I hereby certify that the well location shown on this plat was plotted from field notes of actual surveys made by me or under my supervision, and that the same is true and correct to the best of my belief.</p> <p>Date of Survey Signature and Seal of Professional Surveyer:</p> <p>Certificate Number</p> </div>		
	16																		

District I
1625 N. French Dr., Hobbs, NM 88240
District II
1301 W. Grand Avenue, Artesia, NM 88210
District III
1000 Rio Brazos Rd., Aztec, NM 87410
District IV
1220 S. St. Francis Dr., Santa Fe, NM 87505

State of New Mexico
Energy, Minerals & Natural Resources Department
OIL CONSERVATION DIVISION
1220 South St. Francis Dr.
Santa Fe, NM 87505

Form C-102
Revised October 12, 2005
Submit to Appropriate District Office
State Lease - 4 Copies
Fee Lease - 3 Copies

☐ AMENDED REPORT

WELL LOCATION AND ACREAGE DEDICATION PLAT

¹ API Number 30-025-33967		² Pool Code 96764	³ Pool Name Monument; Abo, Southeast
⁴ Property Code 306601	⁵ Property Name Hansen State		⁶ Well Number 7
⁷ OGRID No. 873	⁸ Operator Name Apache Corporation		⁹ Elevation 3341'

¹⁰ Surface Location

UL or lot no.	Section	Township	Range	Lot Idn	Feet from the	North/South line	Feet from the	East/West line	County
B	16	T20S	R37E		330	North	1650	East	Lea

¹¹ Bottom Hole Location If Different From Surface

UL or lot no.	Section	Township	Range	Lot Idn	Feet from the	North/South line	Feet from the	East/West line	County
¹² Dedicated Acres 40	¹³ Joint or Infill	¹⁴ Consolidation Code		¹⁵ Order No.					

No allowable will be assigned to this completion until all interests have been consolidated or a non-standard unit has been approved by the division.

<div style="text-align: center;"> </div>	<p>¹⁷ OPERATOR CERTIFICATION I hereby certify that the information contained herein is true and complete to the best of my knowledge and belief, and that this organization either owns a working interest or unleased mineral interest in the land including the proposed bottom hole location or has a right to drill this well at this location pursuant to a contract with an owner of such a mineral or working interest, or to a voluntary pooling agreement or a compulsory pooling order.</p> <p><i>Amber Cooke</i> 02/19/2010 Signature Date</p> <p>Amber Cooke Printed Name</p>	
	<p>¹⁸ SURVEYOR CERTIFICATION I hereby certify that the well location shown on this plat was plotted from field notes of actual surveys made by me or under my supervision, and that the same is true and correct to the best of my belief.</p> <p>_____ Date of Survey</p> <p>_____ Signature and Seal of Professional Surveyor:</p>	
	<p>_____ Certificate Number</p>	

District I
1625 N. French Dr., Hobbs, NM 88240
District II
1301 W. Grand Avenue, Artesia, NM 88210
District III
1000 Rio Brazos Rd., Aztec, NM 87410
District IV
1220 S. St. Francis Dr., Santa Fe, NM 87505

State of New Mexico
Energy, Minerals & Natural Resources

Form C-102
Revised June 10, 2003

OIL CONSERVATION DIVISION
1220 South St. Francis Dr.
Santa Fe, NM 87505

Submit to Appropriate District Office
State Lease - 4 Copies
Fee Lease - 3 Copies

☐ AMENDED REPORT

WELL LOCATION AND ACREAGE DEDICATION PLAT

¹ API Number 30-025-34203	² Pool Code 23000	³ Pool Name Emice Monument Grayburg San Andres
⁴ Property Code 006398	⁵ Property Name Hansen State	⁶ Well Number 8
⁷ OGRID No. 01363	⁸ Operator Name Marathon Oil Company	⁹ Elevation 3354'

¹⁰ Surface Location

UL or lot no.	Section	Township	Range	Lot. Idn	Feet from the	North/South line	Feet from the	East/West line	County
G	16	20-S	37-E		1650'	North	1890'	East	Lea

¹¹ Bottom Hole Location If Different From Surface

UL or lot no.	Section	Township	Range	Lot. Idn	Feet from the	North/South line	Feet from the	East/West line	County

¹² Dedicated Acres 40	¹³ Joint or Infill N	¹⁴ Consolidation Code	¹⁵ Order No.
--	---	----------------------------------	-------------------------

NO ALLOWABLE WILL BE ASSIGNED TO THIS COMPLETION UNTIL ALL INTERESTS HAVE BEEN CONSOLIDATED OR A NON-STANDARD UNIT HAS BEEN APPROVED BY THE DIVISION

<p>16</p>	<p>¹⁷ OPERATOR CERTIFICATION</p> <p>I hereby certify that the information contained herein is true and complete to the best of my knowledge and belief.</p> <p><i>Charles E. Kendrick</i> Signature</p> <p>Charles E. Kendrick Printed Name</p> <p>Engineering Technician Title and E-mail Address</p> <p>cekendrix@marathonoil.com</p> <p>11/14/2005 Date</p>
	<p>¹⁸ SURVEYOR CERTIFICATION</p> <p>I hereby certify that the well location shown on this plat was plotted from field notes of actual surveys made by me or under my supervision, and that the same is true and correct to the best of my belief.</p> <p>Date of Survey</p> <p>Signature and Seal of Professional Surveyor:</p>
	<p>Certificate Number</p>

RECEIVED

District I

1625 N. French Dr., Hobbs, NM 88240

District II

1301 W. Grand Avenue, Artesia, NM 88210

District III

1000 Rio Brazos Blvd., El Paso, NM 88501

District IV

1220 S. St. Francis Dr., Santa Fe, NM 87505

State of New Mexico

Energy, Minerals & Natural Resources Department

OIL CONSERVATION DIVISION

1220 South St. Francis Dr.

Santa Fe, NM 87505

Form C-102

Revised October 12, 2005

Submit to Appropriate District Office

State Lease - 4 Copies

Fee Lease - 3 Copies

☐ AMENDED REPORT

WELL LOCATION AND ACREAGE DEDICATION PLAT

¹ API Number 30-025-34286	² Pool Code 23000	³ Pool Name Eunice Monument Grayburg San Andres
⁴ Property Code 6398	⁵ Property Name Hansen State	⁶ Well Number 9
⁷ OGRID No. 014021	⁸ Operator Name MARATHON OIL COMPANY	⁹ Elevation 3544'

¹⁰ Surface Location

UL or lot no.	Section	Township	Range	Lot Idn	Feet from the	North/South line	Feet from the	East/West line	County
11	16	20 S	37 E		2190	NORTH	460	EAST	LEA

¹¹ Bottom Hole Location If Different From Surface

UL or lot no.	Section	Township	Range	Lot Idn	Feet from the	North/South line	Feet from the	East/West line	County

¹² Dedicated Acres 40	¹³ Joint or Infill N	¹⁴ Consolidation Code	¹⁵ Order No.
-------------------------------------	------------------------------------	----------------------------------	-------------------------

No allowable will be assigned to this completion until all interests have been consolidated or a non-standard unit has been approved by the division.

¹⁶					¹⁷ OPERATOR CERTIFICATION I hereby certify that the information contained herein is true and complete to the best of my knowledge and belief, and that this organization either owns a working interest or unleased mineral interest in the land including the proposed bottom hole location or has a right to drill that well at this location pursuant to a contract with an owner of such a mineral or working interest, or to a voluntary pooling agreement or a compulsory pooling order heretofore entered by the division. Rick R. Schell 10-28-2008 Signature Date Rick R. Schell Printed Name
					¹⁸ SURVEYOR CERTIFICATION I hereby certify that the well location shown on this plat was plotted from field notes of actual surveys made by me or under my supervision, and that the same is true and correct to the best of my belief. Date of Survey Signature and Seal of Professional Surveyor.
					Certificate Number

District I

1625 N. French Dr., Hobbs, NM 88240
Phone:(505) 393-6161 Fax:(505) 393-0720

District II

1301 W. Grand Ave., Artesia, NM 88210
Phone:(505) 748-1283 Fax:(505) 748-9720

District III

1000 Rio Brazos Rd., Aztec, NM 87410
Phone:(505) 334-6175 Fax:(505) 334-6170

District IV

1220 S. St Francis Dr., Santa Fe, NM 87505
Phone:(505) 478-3470 Fax:(505) 478-3482

State of New Mexico**Energy, Minerals and Natural Resources****Oil Conservation Division****1220 S. St Francis Dr.****Santa Fe, NM 87505**

Form C-102
Permit 104438

WELL LOCATION AND ACREAGE DEDICATION PLAT

1. API Number 30-025-39562	2. Pool Code 96764	3. Pool Name MONUMENT, ABO, SOUTHEAST
4. Property Code 306601	5. Property Name HANSEN STATE	6. Well No. 011
7. OGRID No. 873	8. Operator Name APACHE CORP	9. Elevation 3548

10. Surface Location

UL - Lot	Section	Township	Range	Lot Idn	Feet From	N/S Line	Feet From	E/W Line	County
A	16	20S	37E	A	990	N	990	E	LEA

11. Bottom Hole Location If Different From Surface

UL - Lot	Section	Township	Range	Lot Idn	Feet From	N/S Line	Feet From	E/W Line	County
12. Dedicated Acres 40.00		13. Joint or Infill		14. Consolidation Code		15. Order No.			

NO ALLOWABLE WILL BE ASSIGNED TO THIS COMPLETION UNTIL ALL INTERESTS HAVE BEEN CONSOLIDATED OR A NON-STANDARD UNIT HAS BEEN APPROVED BY THE DIVISION

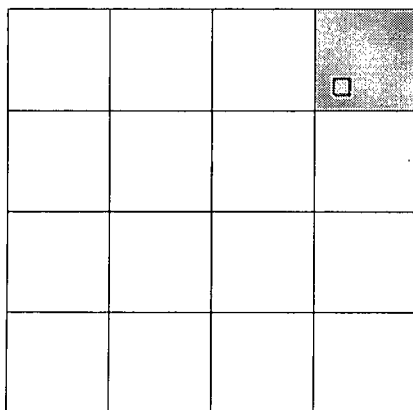
**OPERATOR CERTIFICATION**

I hereby certify that the information contained herein is true and complete to the best of my knowledge and belief, and that this organization either owns a working interest or undivided mineral interest in the land including the proposed bottom hole location(s) or has a right to drill this well at this location pursuant to a contract with an owner of such a mineral or working interest, or to a voluntary pooling agreement or a compulsory pooling order heretofore entered by the division.

E-Signed By: Lana Williams

Title: Engineering Tech

Date: 10/26/2009

SURVEYOR CERTIFICATION

I hereby certify that the well location shown on this plat was plotted from field notes of actual surveys made by me or under my supervision, and that the same is true and correct to the best of my belief.

Surveyed By: Gary Jones

Date of Survey: 10/22/2009

Certificate Number: 7977

District I
1425 N. French Dr., Hobbs, NM 88240
Phone:(505) 393-6161 Fax:(505) 393-0720

District II
1501 W. Grand Ave., Artesia, NM 88210
Phone:(505) 748-1283 Fax:(505) 748-9720

District III
1600 Rio Brazos Rd., Aztec, NM 87410
Phone:(505) 334-6178 Fax:(505) 334-6170

District IV
1220 S. St Francis Dr., Santa Fe, NM 87505
Phone:(505) 476-3470 Fax:(505) 476-3462

State of New Mexico
Energy, Minerals and Natural Resources
Oil Conservation Division
1220 S. St Francis Dr.
Santa Fe, NM 87505

Form C-102
Permit 104438

WELL LOCATION AND ACREAGE DEDICATION PLAT

1. API Number 30-025-39562	2. Pool Code 47080	3. Pool Name MONUMENT,PADDOCK
4. Property Code 306601	5. Property Name HANSEN STATE	6. Well No. 011
7. OGRID No. 873	8. Operator Name APACHE CORP	9. Elevation 3548

10. Surface Location

UL - Lot	Section	Township	Range	Lot Idn	Feet From	N/S Line	Feet From	E/W Line	County
A	16	20S	37E	A	990	N	990	E	LEA

11. Bottom Hole Location If Different From Surface

UL - Lot	Section	Township	Range	Lot Idn	Feet From	N/S Line	Feet From	E/W Line	County
12. Dedicated Acres 40.00	13. Joint or Infill	14. Consolidation Code	15. Order No.						

NO ALLOWABLE WILL BE ASSIGNED TO THIS COMPLETION UNTIL ALL INTERESTS HAVE BEEN CONSOLIDATED OR A NON-STANDARD UNIT HAS BEEN APPROVED BY THE DIVISION

			□

OPERATOR CERTIFICATION

I hereby certify that the information contained herein is true and complete to the best of my knowledge and belief, and that this organization either owns a working interest or unleased mineral interest in the land including the proposed bottom hole location(s) or has a right to drill this well at this location pursuant to a contract with an owner of such a mineral or working interest, or to a voluntary pooling agreement or a compulsory pooling order heretofore entered by the division.

E-Signed By: Lana Williams
Title: Engineering Tech
Date: 10/26/2009

SURVEYOR CERTIFICATION

I hereby certify that the well location shown on this plat was plotted from field notes of actual surveys made by me or under my supervision, and that the same is true and correct to the best of my belief.

Surveyed By: Gary Jones
Date of Survey: 10/22/2009
Certificate Number: 7977

District I
1625 N. French Dr., Hobbs, NM 88240
Phone:(505) 393-6181 Fax:(505) 393-6720

District II

1301 W. Grand Ave., Artesia, NM 88210
Phone:(505) 748-1283 Fax:(505) 748-9720

District III

1600 Rio Brazos Rd., Afton, NM 87410
Phone:(505) 334-6178 Fax:(505) 334-6179

District IV

1220 S. St Francis Dr., Santa Fe, NM 87505
Phone:(505) 478-3470 Fax:(505) 478-3462

State of New Mexico
Energy, Minerals and Natural Resources

Oil Conservation Division

1220 S. St Francis Dr.

Santa Fe, NM 87505

Form C-102
Permit 104438

WELL LOCATION AND ACREAGE DEDICATION PLAT

1. API Number 30-025-39562	2. Pool Code 47090	3. Pool Name MONUMENT;TUBB
4. Property Code 306601	5. Property Name HANSEN STATE	6. Well No. 011
7. OGRID No. 873	8. Operator Name APACHE CORP	9. Elevation 3548

10. Surface Location

UL - Lot A	Section 16	Township 20S	Range 37E	Lot Idn A	Feet From 990	N/S Line N	Feet From 990	E/W Line E	County LEA
---------------	---------------	-----------------	--------------	--------------	------------------	---------------	------------------	---------------	---------------

11. Bottom Hole Location If Different From Surface

UL - Lot	Section	Township	Range	Lot Idn	Feet From	N/S Line	Feet From	E/W Line	County
12. Dedicated Acres 80.00	13. Joint or Infill	14. Consolidation Code	15. Order No.						

NO ALLOWABLE WILL BE ASSIGNED TO THIS COMPLETION UNTIL ALL INTERESTS HAVE BEEN CONSOLIDATED OR A NON-STANDARD UNIT HAS BEEN APPROVED BY THE DIVISION

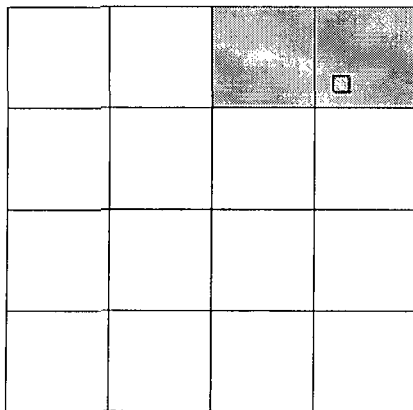

OPERATOR CERTIFICATION

I hereby certify that the information contained herein is true and complete to the best of my knowledge and belief, and that this organization either owns a working interest or unleased mineral interest in the land including the proposed bottom hole location(s) or has a right to drill this well at this location pursuant to a contract with an owner of such a mineral or working interest, or is a voluntary pooling agreement or a compulsory pooling order heretofore entered by the division.

E-Signed By: Lana Williams

Title: Engineering Tech

Date: 10/26/2009

SURVEYOR CERTIFICATION

I hereby certify that the well location shown on this plat was plotted from field notes of actual surveys made by me or under my supervision, and that the same is true and correct to the best of my belief.

Surveyed By: Gary Jones

Date of Survey: 10/22/2009

Certificate Number: 7977

District I

1625 N. French Dr., Hobbs, NM 88240
 Phone:(505) 393-6161 Fax:(505) 393-9720

District II

1301 W. Grand Ave., Artesia, NM 88210
 Phone:(505) 748-1283 Fax:(505) 748-9720

District III

1000 Rio Brazos Rd., Aztec, NM 87410
 Phone:(505) 334-6178 Fax:(505) 334-6179

District IV

1220 S. St Francis Dr., Santa Fe, NM 87505
 Phone:(505) 476-3470 Fax:(505) 476-3462

State of New Mexico
Energy, Minerals and Natural Resources

Form C-102
 Permit 104438

Oil Conservation Division
1220 S. St Francis Dr.
Santa Fe, NM 87505

WELL LOCATION AND ACREAGE DEDICATION PLAT

1. API Number 30-025-39562	2. Pool Code 63840	3. Pool Name WEIR, DRINKARD
4. Property Code 306601	5. Property Name HANSEN STATE	6. Well No. 011
7. OGRID No. 873	8. Operator Name APACHE CORP	9. Elevation 3548

10. Surface Location

UL - Lot	Section	Township	Range	Lot 16n	Feet From	N/S Line	Feet From	E/W Line	County
A	16	20S	37E	A	990	N	990	E	LEA

11. Bottom Hole Location If Different From Surface

UL - Lot	Section	Township	Range	Lot 16n	Feet From	N/S Line	Feet From	E/W Line	County
12. Dedicated Acres 40.00	13. Joint or Infill	14. Consolidation Code	15. Order No.						

NO ALLOWABLE WILL BE ASSIGNED TO THIS COMPLETION UNTIL ALL INTERESTS HAVE BEEN CONSOLIDATED OR A NON-STANDARD UNIT HAS BEEN APPROVED BY THE DIVISION

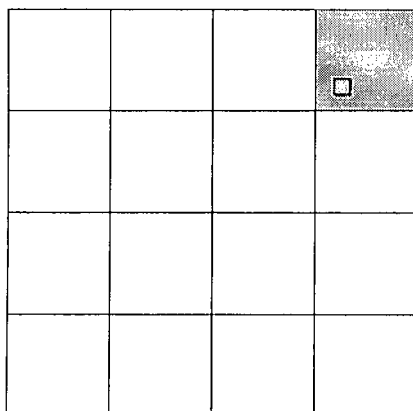
**OPERATOR CERTIFICATION**

I hereby certify that the information contained herein is true and complete to the best of my knowledge and belief, and that this organization either owns a working interest or leased mineral interest in the land including the proposed bottom hole location(s) or has a right to drill this well at this location pursuant to a contract with an owner of such a mineral or working interest, or to a voluntary pooling agreement or a compulsory pooling order heretofore entered by the division.

E-Signed By: Lana Williams
 Title: Engineering Tech
 Date: 10/26/2009

SURVEYOR CERTIFICATION

I hereby certify that the well location shown on this plat was plotted from field notes of actual surveys made by me or under my supervision, and that the same is true and correct to the best of my belief.

Surveyed By: Gary Jones
 Date of Survey: 10/22/2009
 Certificate Number: 7977

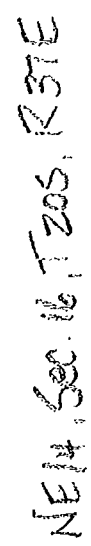
$$z \leftarrow 1$$

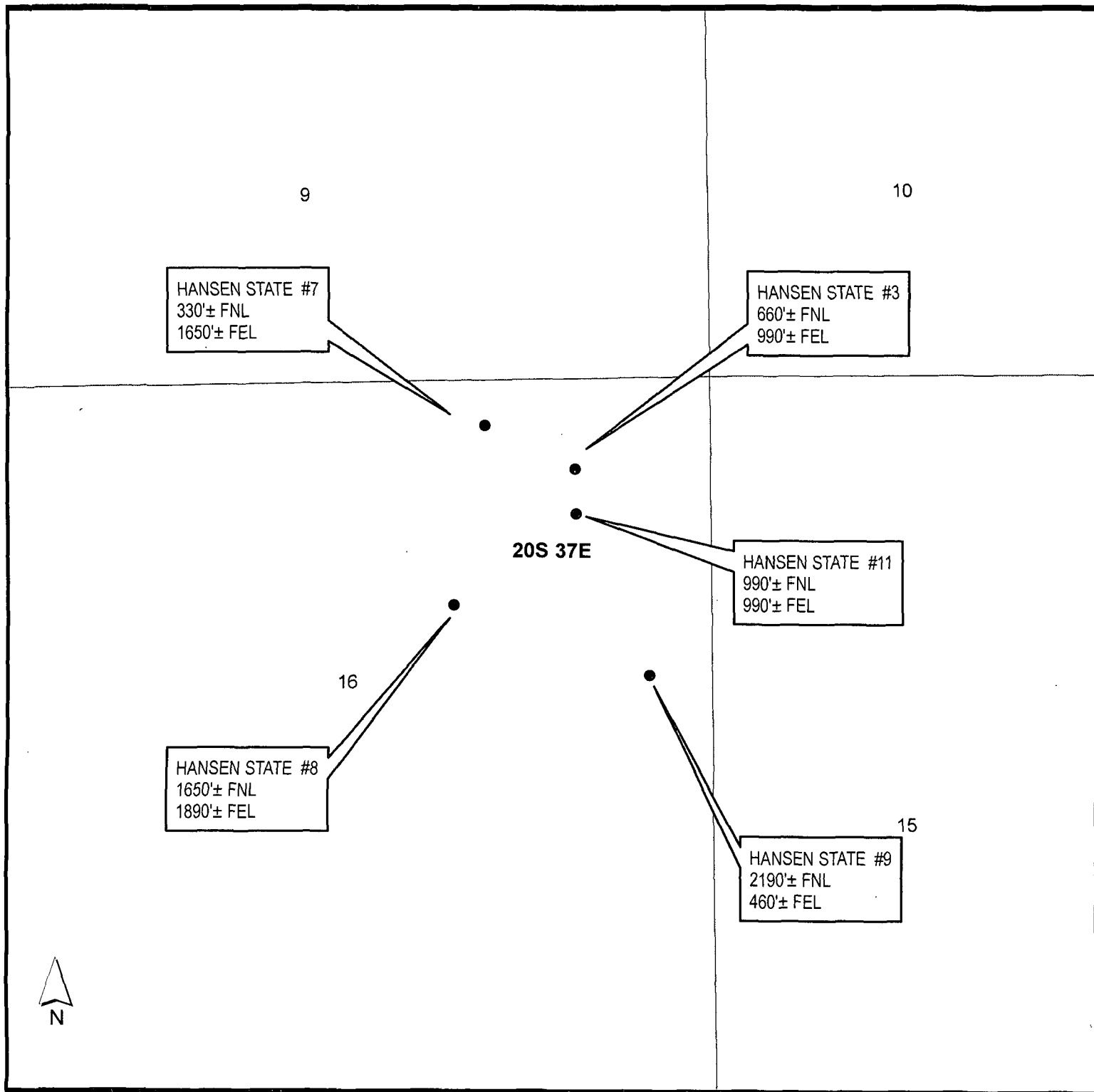

Well Plat

Hansen State #3, 30-025-06126; Hansen State #7, 30-025-33967;

Hansen State #8, 30-025-34203; Hansen State #9, 30-025-34286;

Hansen State #11, 30-025-39562

Sec 16

T-20-S, R-37-E, NMPB&M

Lea County, New Mexico



February 18, 2010

Royalty Interest Owners

Re: Administrative Approval to Surface Commingle
Hansen State Lease
Sec 16, T20S, R37E
Lea County, New Mexico

Attached please find an application for the approval to surface commingle the following lease that Apache Corporation has filed with the New Mexico Oil Conservation Division. The permit is to include the Monument; Abo, Eunice Monument; Grayburg-San Andres, Monument; Abo, Southeast, Monument; Paddock; Monument; Tubb and Wier; Drinkard pools.

If you need additional information or have any questions, please give me a call at (918) 491-4968.

Sincerely,

A handwritten signature in black ink that reads "Amber Cooke".

Amber Cooke
Apache Corporation
Engineering Technician

Attachment

Cc: New Mexico Oil Conservation Division
1220 South St Francis Dr
Santa Fe, New Mexico 87505

NOTICE OF NOTIFICATION

This is to certify that copies of the surface commingle application for the Hansen State Lease, Lea County, New Mexico, were sent Fedex to the parties listed below on February 19, 2010.

State Land Office
Commissioner of Public Lands
310 Old Santa Fe Trail
Santa Fe, NM 87504

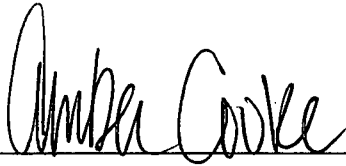
A handwritten signature in black ink, reading "Amber Cooke", is written over a horizontal line.

Amber Cooke
Production Engineer Technician