

District I
1625 N. French Dr., Hobbs, NM 88240

District II
1301 W. Grand Avenue, Artesia, NM 87003

District III
1000 Rio Brazos Road, Aztec, NM 87410

District IV
1220 S. St. Francis Dr., Santa Fe, NM 87505

State of New Mexico
Energy Minerals and Natural Resources

Oil Conservation Division
1220 South St. Francis Dr.
Santa Fe, NM 87505

Form C-141
Revised October 10, 2003

Submit 2 Copies to appropriate
District Office in accordance
with Rule 116 on back
side of form

RECEIVED
APR 09 2010
HOBBSUCD

Release Notification and Corrective Action

OPERATOR

☒ Initial Report ☐ Final Report

Name of Company Centurion Pipeline, LP	Contact Becky Moore, Compliance Coordinator	
Address P.O. Box 51790, Midland, TX 79710	Telephone No. 432-686-6805	
Facility Name Brahaney Gathering System	Facility Type Sweet Crude Oil Pipeline	
Surface Owner Centurion Pipeline, LP	Mineral Owner	Lease No.

LOCATION OF RELEASE

Unit Letter D	Section 04	Township 13-S	Range 38-E	Feet from the	North/South Line	Feet from the	East/West Line	County Lea
------------------	---------------	------------------	---------------	---------------	------------------	---------------	----------------	---------------

Latitude N33° 13' 28.83" Longitude W 103° 06' 36.37"

NATURE OF RELEASE

Type of Release Sweet Crude Oil	Volume of Release 150 bbls	Volume Recovered 120 bbls
Source of Release 8" dia. Steel transmission pipeline	Date and Hour of Occurrence 04/06/10 - hour unknown	Date and Hour of Discovery 4/6/10 @ 11:50 AM
Was Immediate Notice Given? <input checked="" type="checkbox"/> Yes <input type="checkbox"/> No <input type="checkbox"/> Not Required	If YES, To Whom? Geoffrey Leking - left voice mail message and verbal.	
By Whom? Albert Ochoa (left message)	Date and Hour 04/07/10 @ 10:30 AM (message) and @ 2:20 PM (verbal)	
Was a Watercourse Reached? <input type="checkbox"/> Yes <input checked="" type="checkbox"/> No	If YES, Volume Impacting the Watercourse. N/A	

If a Watercourse was Impacted, Describe Fully.* Not Applicable

Describe Cause of Problem and Remedial Action Taken.* Corrosion caused a leak on the 8" Brahaney Gathering System. Emergency Action response included immediate shut-in of the pipeline to stop the leak and a repair clamp installed. Vacuum trucks were called and a contract remediation company contacted to assist with initial emergency response and to initiate clean up. A one call was made to the State of NM 04/06/10. The site was initially secured from run off after free liquids were removed. Affected soil is being scrapped up and staged at the site. Initial delineation is in progress to determine appropriate clean up actions.

Describe Area Affected and Cleanup Action Taken.* Area affected at the source of the leak is apx. 300 ft x 300 ft. x 6 in. Estimated 38,300 cu. yds. contaminated soil is currently being excavated and stockpiled at the site. The depth to groundwater at this site is 48.41 ft. The clean up levels for TPH will be 100 ppm. The affected pipeline is in process of being replaced with 300' of new coated 8" steel pipeline. After initial C-141 remediation plans are approved and the clean up is complete, a final C-141 will be submitted and accompanied with a final report including lab analysis, pictures, and all associated closure documentation as required.

I hereby certify that the information given above is true and complete to the best of my knowledge and understand that pursuant to NMOCD rules and regulations all operators are required to report and/or file certain release notifications and perform corrective actions for releases which may endanger public health or the environment. The acceptance of a C-141 report by the NMOCD marked as "Final Report" does not relieve the operator of liability should their operations have failed to adequately investigate and remediate contamination that pose a threat to ground water, surface water, human health or the environment. In addition, NMOCD acceptance of a C-141 report does not relieve the operator of responsibility for compliance with any other federal, state, or local laws and/or regulations.

Signature: <i>Becky Moore</i>		OIL CONSERVATION DIVISION	
Printed Name: Becky Moore		ENV. ENGINEER: Approved by District Supervisor: <i>Geoffrey Leking</i>	
Title: Compliance Coordinator		Approval Date: 04/26/10	Expiration Date: 06/28/10
E-mail Address: Rebecca_Moore@oxy.com		Conditions of Approval: DELIVERABLE TO CLEAN UP. SUBMIT FINAL C-141 BY	
Date: 04/07/10 Phone: (432) 686-6805 (office)		Attached <input type="checkbox"/> IRP-10-4-2484	

* Attach Additional Sheets If Necessary

FGRL1011638154

LETTER OF TRANSMITTAL

RECEIVED
APR 14 2010
HOBBSOCD

ENVIRONMENTAL
PLUS, INC.



Date: April 13, 2010
To: **Mr. Geoffrey Leking**
Company Name: New Mexico Oil Conservation Division
Address: 1625 North French Drive
City / State / Zip: Hobbs, New Mexico 88240
From: David P. Duncan
CC: Ms. Becky Moore, Compliance Coordinator – Centurion Pipeline, L.P.
Project #: EPI Ref. #255016
Project Name: Brahaney Gathering System
Subject: **Remediation Proposal**

# of originals	# of copies	Description
1		Remediation Proposal – Brahaney Gathering System

Remarks

Dear Mr. Leking:

Enclosed is a bound copy of a *Remediation Proposal* for the above referenced site. Upon NMOCD approval, EPI will complete remedial phase of the project. Should you have any technical questions, concerns or need additional information, please contact me at (575) 394-3481 (office), (575) 441-7802 (cellular) or via email at dduncanepi@gmail.com Official communications/correspondence should be directed to Ms. Becky Moore, Compliance Coordinator, at (432) 686-6805 (office) or via e-mail at Rebecca_Moore@oxy.com.

Sincerely,

David P. Duncan
Civil Engineer
EPI Project Manager

P. O. Box 1558
Eunice, NM 88231
(575) 394-3481
Fax: (575) 394-2601

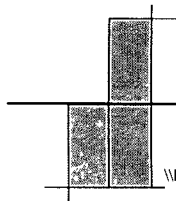

REMEDIATION PROPOSAL

BRAHANNEY GATHERING SYSTEM

EPI REF: #255016

UL-D (NW $\frac{1}{4}$ OF THE NW $\frac{1}{4}$) OF SECTION 04, T 13 S, R 38 E

~12 MILES EAST BY SOUTHEAST OF TATUM,

LEA COUNTY, NEW MEXICO

LATITUDE: N 33° 13' 28.83"

LONGITUDE: W 103° 06' 36.37"

APRIL 2010

PREPARED BY:

ENVIRONMENTAL PLUS, INC.
P.O. BOX 1558
2100 WEST AVENUE O
EUNICE, NEW MEXICO 88231

RECEIVED

APR 14 2010
HOBBSOCD

PREPARED FOR:

CENTURION PIPELINE, L.P.
6 DESTA DRIVE, SUITE 5050
P.O. BOX 51790
MIDLAND, TEXAS 79710



ENVIRONMENTAL PLUS, INC.
CONSULTING AND ENVIRONMENTAL REMEDIATION

13 April 2010

Mr. Geoffrey Leking
Environmental Engineer
New Mexico Oil Conservation Division
1625 North French Drive
Hobbs, New Mexico 88240

RECEIVED

APR 14 2010

HOBBS NM

RE: Remediation Proposal
Centurion Pipeline, L.P. – Brahaney Gathering System Release Area
UL-D (NW ¼ of the NW ¼) of Section 04, T 13 S, R 38 E
Longitude: N 33° 13' 28.83"; Latitude: W 103° 06' 36.37"
Lea County, New Mexico
EPI Ref. #255016

Mr. Leking:

On April 06, 2010 approximately 150 barrels of sweet crude oil were released from a corroded eight (8) inch diameter steel pipeline covering an area of approximately 39,300 square feet of grazing land. After initiating a One Call the same day, Environmental Plus, Inc., (EPI) arrived at the release site and commenced emergency remediation activities. Prior to EPI arrival, the pipeline had been immediately deactivated by Centurion Pipeline, L.P., personnel. Vacuum trucks removed approximately 120 barrels of sweet crude oil and transported the fluid to a Centurion Pipeline, L.P. tank battery for reclamation. A repair clamp was placed around the leak and the pipeline returned to service. This letter report documents results of delineation and preliminary remediation activities while providing a *Remediation Proposal*.

Site Background

The Site is located in UL-D (NW ¼ of the NW ¼) of Section 04, T 13 S, R 38 E at an approximate elevation of 3829 feet above mean sea level (amsl). The property is owned by Robert Sledge, 3141 Chimney, Abilene, Texas. A search for water wells was completed utilizing the New Mexico Office of the State Engineers website and a database maintained by the United States Geological Survey (USGS). One (1) well and no surface water features exist within a 1,000 feet radius of the Site (reference *Figure 2*). Groundwater data indicates average water depth is approximately 50 feet below ground surface (bgs). Based on available information, projected distance between impacted soil and groundwater is approximately 49 vertical feet. Utilizing this information, New Mexico Oil Conservation Division (NMOCD) Remedial Goals for this Site were determined as follows:

Parameter	Remedial Goal
Benzene	10 parts per million
BTEX	50 parts per million
TPH	100 parts per million

*Chloride residuals may not be capable of impacting local groundwater above NMWQCC Standards of 250 mg/L

ENVIRONMENTAL PLUS, INC.



Field Work

On April 06, 2010 EPI mobilized to an Emergency Response and started preventative remediation activities within the release area. Following natural slope of the ground, the crude sweet oil created a release area on the east side of pipeline ROW. After containment and removal of sweet crude oil, the steel pipeline was repaired and returned to service. From April 06-09, 2010 soil contaminated with petroleum products was scrapped from the ground, blended with existing soil and stockpiled within the release area. This procedure was necessary as it afforded an opportunity for aeration and drying while decreasing chances of deeper penetration of crude sweet oil products into the ground. Due to concerns about changing weather conditions, the stockpiled blended material is being transported to a state approved landfill for reclamation.

On 9 April, 2010 the existing steel pipeline was replaced with approximately 300-linear feet of eight (8) inch diameter tar coated and wrapped steel piping.

Soil samples were collected and analyzed in the field for TPH concentrations utilizing a Photoionization Detector (PID) calibrated for benzene detection. Due to the release being sweet crude oil, no field analyses were conducted for chloride concentrations.

Analytical Data

Field analyses of two (2) soil samples collected on April 07, 2010 indicate TPH concentrations below NMOCD Remedial Threshold Goals of 100 mg/Kg (reference *Figure #4* for locations). Similarly, analyses results indicate depth of impacted material is approximately six (6) to twelve (12) inches.

Table 2, *Summary of Soil Sample Field Analyses and Laboratory Analytical Results*, list the values of the field analyses results.

Site Remedial Proposal

EPI proposes continuing delineation of the release area via use of a backhoe or track hoe. Surface area and depth of excavation will be determined by extent of impacted material. Sidewalls and bottom of the excavation will be field analyzed primarily for TPH concentrations interspersed with random tests for chloride concentrations. Extreme care will be exerted when excavating or backfilling around the recently installed coated steel pipeline. Upon satisfactory field analyses results, soil samples collected will be sent to an independent laboratory for analytical verification of BTEX, TPH and chloride concentrations. With receipt of laboratory analytical results indicating sidewalls and bottom of excavation are below NMOCD parameters for BTEX, TPH and chloride concentrations, EPI will complete remedial activities. Impacted material is being transported to Environmental Plus, Inc., Landfarm (Permit No. NM-01-0013) for reclamation.

Following completion of excavation activities and disposal of impacted material, the excavation will be backfilled. As most of the excavation is in grazing areas, the excavation will be backfilled from bottom to original ground surface with clean top soil. Top soil procured from a nearby source will be free of rocks, large clumps and deleterious material.



The entire disturbed area is to be contoured to allow natural drainage and prevent wind/water erosion. These areas will be disked and drill seeded with a mixture approved by the property owner.

Upon approval of the *Remediation Proposal*, EPI will finalize remedial phase of the project. At conclusion of the project, a *Site Closure Report* will be submitted to NMOCD, Centurion Pipeline, L.P. and property owner.

Should you have any technical questions or concerns, please contact me at (575) 394-3481 (office), (575) 441-7802 (mobile) or via email at dduncanepi@gmail.com.

Official communications should be directed to Ms. Becky Moore, Compliance Coordinator, at (432) 686-6805 (office) or via email at Rebecca_Moore@oxy.com with correspondence addressed to:

Ms. Becky Moore
Compliance Coordinator
Centurion Pipeline, L.P.
6 Desta Drive, Ste. 5050
P.O. Box 51790
Midland, Texas 79710

Sincerely,

ENVIRONMENTAL PLUS, INC.,

David P. Duncan
Civil Engineer

Cc: Ms. Becky Moore, Compliance Coordinator – Centurion Pipeline, L.P.
Cody Miller, General Manager - EPI
Roger Boone, Operations Superintendent - EPI

Encl: Figure 1 – Area Map
Figure 2 – Site Location Map
Figure 3 – Site Map
Figure 4 – Soil Sample Locations
Table 1 – Well Data
Table 2 – Summary of Excavation Soil Sample Field Analysis and Laboratory Analytical Results
Attachment I – Site Photographs
Attachment II – Copy of Initial NMOCD Form C-141

FIGURES

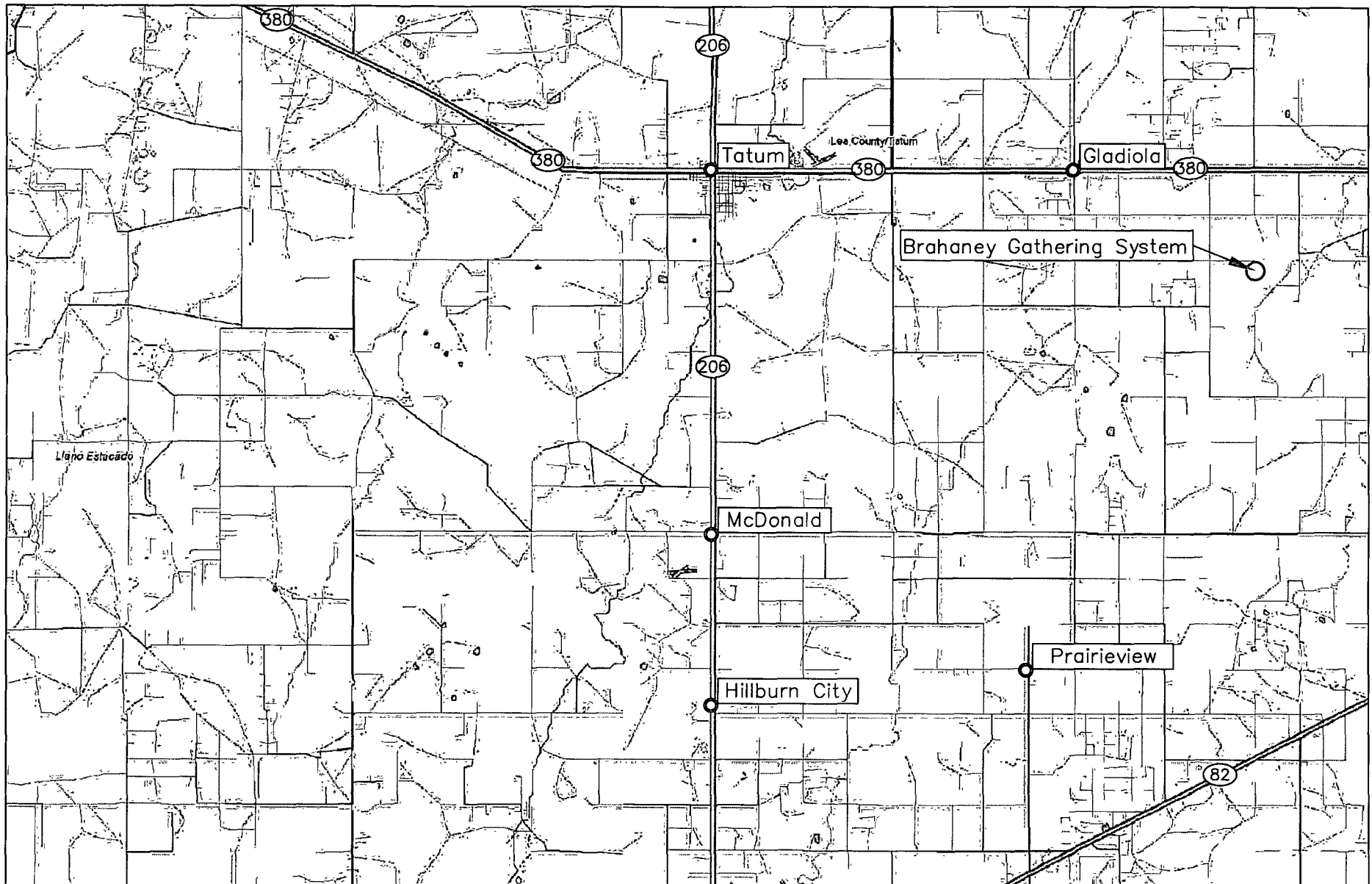

Figure 1
Area Map
Centurion Pipeline, L.P.
Brahaney Gathering System

Lea County, New Mexico
NW 1/4 of the NW 1/4, Sec. 4, T13S, R38E
N 33° 13' 28.83" W 103° 06' 36.37"
Elevation: 3,829 feet amsl

DWG By: D Dominguez
April 2010

REVISED:



SHEET
1 of 1

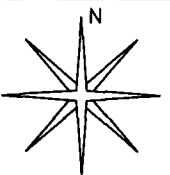

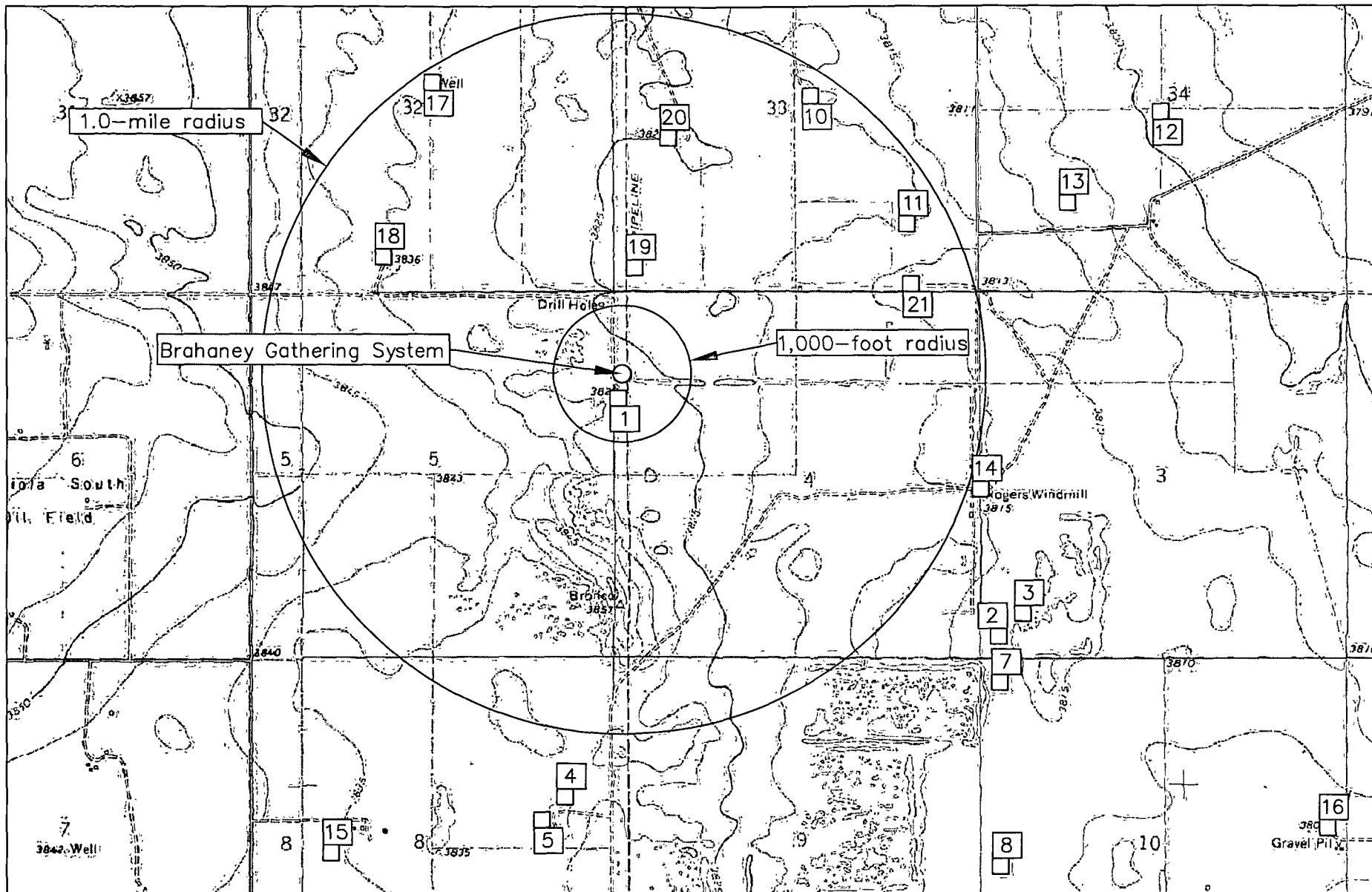
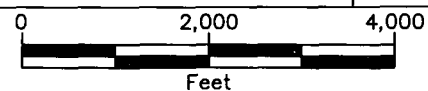

Figure 2
Site Location Map
Centurion Pipeline, L.P.
Brahaney Gathering System

Lea County, New Mexico
NW 1/4 of the NW 1/4, Sec. 4, T13S, R38E
N 33° 13' 28.83" W 103° 06' 36.37"
Elevation: 3,829 feet amsl

DWG By: D Dominguez
April 2010

REVISED:



SHEET
1 of 1

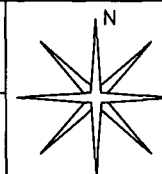

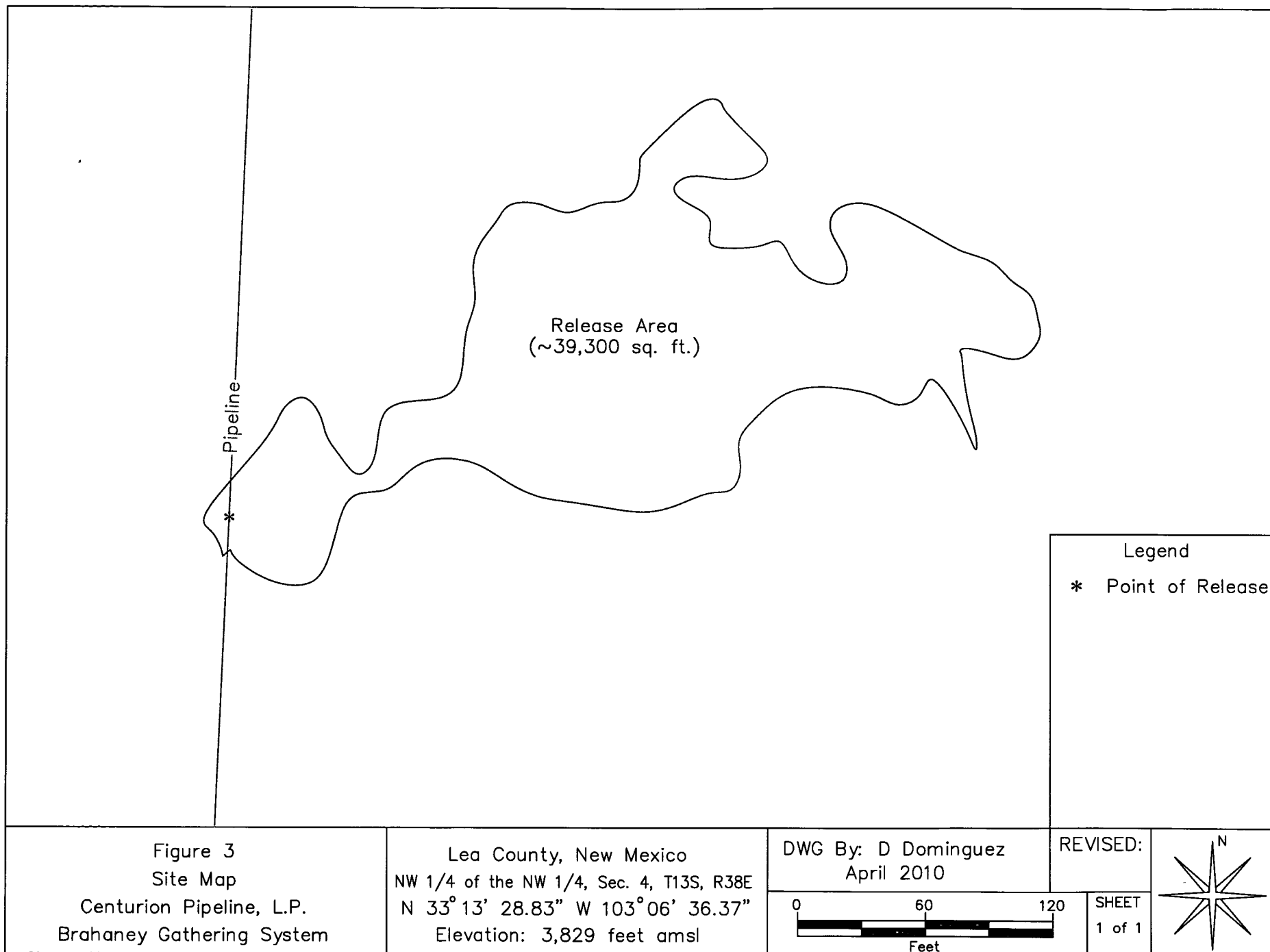

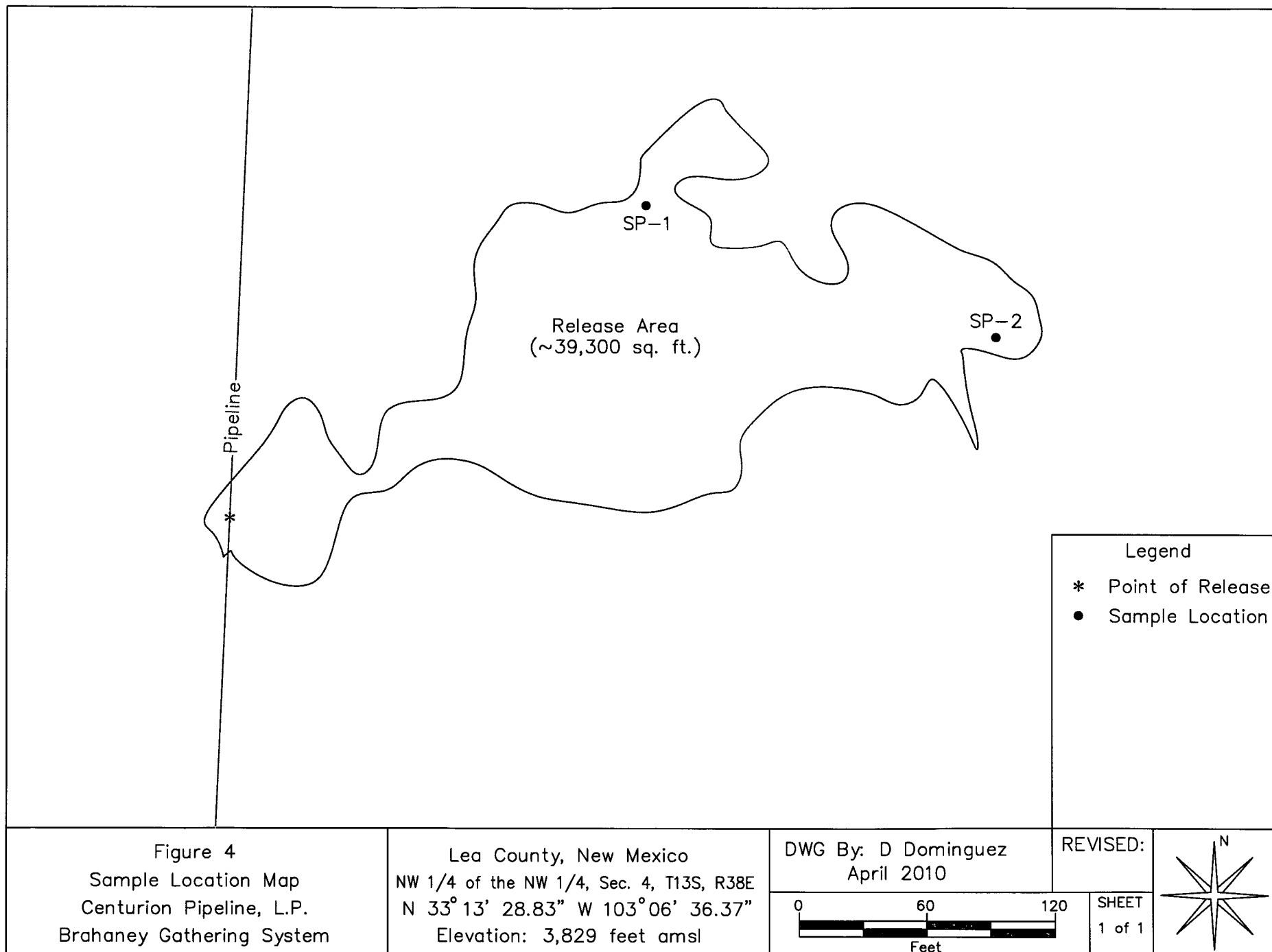

TABLES

TABLE 1

Well Data

Centurion Pipeline - Brahaney Gathering System (EPI Ref. # 255016)

Ref. #	Well Number	Diversion ^A	Owner	Use	Twsp	Rng	Sec	q4	q16	q64	Latitude	Longitude	Date Measured	Surface Elevation ^B	Depth to Water (ft bgs)
1	USGS #1				13S	38E	4	1	3	1			28-Mar-91	3,829	48.41
2	L 02807	3	ELMO TEAGUE	PRO	13S	38E	3	3	3	3	N33° 12' 51.37"	W103° 05' 32.57"	14-May-55	3,814	31
3	L 11094	3	PERL H HARRIS	STK	13S	38E	3	3	3		N33° 12' 54.58"	W103° 05' 28.60"	03-Sep-00	3,814	90
4	L 02853	3	RAYMOND C. KORNEGAY	DOM	13S	38E	8	2	4		N33° 12' 28.44"	W103° 06' 46.33"		3,835	60
5	L 11669	3	WESLEY D. HARRIS	DOM	13S	38E	8	2	4	3	N33° 12' 25.22"	W103° 06' 50.30"	05-Apr-05	3,835	100
7	L 00341 A S 2				13S	38E	10	1	1	1	N33° 12' 44.81"	W103° 05' 32.45"	30-Mar-04	3,814	100
8	L 00341 A S 3				13S	38E	10	3	1	1	N33° 12' 18.70"	W103° 05' 32.43"	08-Apr-04	3,814	100
10	L 01462 APPRO	3	EUGENE HODGE	DOM	12S	38E	33	2	3	3	N33° 14' 9.79"	W103° 06' 3.55"	12-Jun-52	3,820	32
11	L 10370	3	LARRY HODGE	DOM	12S	38E	33	4	4	1	N33° 13' 50.20"	W103° 05' 47.87"	30-Dec-93	3,820	36
12	L 06873		P. H HARRIS	DOM	12S	38E	34				N33° 14' 6.16"	W103° 05' 4.76"	13-Dec-71	3,799	42
13	L 10830	3	PEARL HARRIS	DOM	12S	38E	34	3			N33° 13' 53.35"	W103° 05' 20.57"	21-Jun-99	3,807	45
14	USGS #2				13S	38E	3	3	1	1			13-Mar-91	3,815	54.06
15	USGS #3				13S	38E	8	3	1	2			03-Jan-96	3,835	70.11
16	USGS #4				13S	38E	10	2	4	4			15-Feb-66	3,808	68.67
17	USGS #5				12S	38E	32	2	3	3			06-Feb-91	3,835	29.98
18	USGS #6				12S	38E	32	3	4	4			17-Mar-71	3,836	36.71
19	USGS #7				12S	38E	33	3	3	3			17-Mar-71	3,824	46.81
20	USGS #8				12S	38E	33	3	1	2			17-Mar-71	3,825	31.99
21	USGS #9				12S	38E	33	4	4	3			07-Feb-91	3,814	37.21
6	L 11925 POD1				13S	38E	9	3	3	1	33° 12' 5.60"	W103° 06' 34.58"	09-Jun-06	3,827	105
9	L 02952	3	L.B. TOWNSEND	DOM	13S	38E	10	4	4		N33° 12' 2.41"	W103° 04' 42.08"	30-Jul-55	3,805	65

* = Data obtained from the New Mexico Office of the State Engineer Website (<http://nmwrrs.ose.state.nm.us/nmwrrs/wellSurfaceDiversion.html>) and USGS Database

^A = In acre feet per annum

^B = Elevation interpolated from USGS topographical map based on referenced location

PRO = 72-12-1 Prospecting or development of natural resource

DOM = 72-12-1 Domestic one household

STK = 72-12-1 Livestock watering

quarters are 1=NW, 2=NE, 3=SW, 4=SE; quarters are biggest to smallest

Shaded area indicates wells not shown in Figure 2

TABLE 2
Summary of Excavation Soil Sample Field Analyses and Laboratory Analytical Results
Centurion Pipeline, L.P.
Project: Brahaney Gathering System (EPI Ref. #255016)

Sample I D	Depth (feet)	Soil Status	Sample Date	PID Field Analysis (ppm)	Field Chloride Analyses (mg/Kg)	Benzene (mg/Kg)	Toluene (mg/Kg)	Ethylbenzene (mg/Kg)	Total Xylenes (mg/Kg)	Total BTEX (mg/Kg)	GRH (C6-C10) (mg/Kg)	DRH (>C10-C28) (mg/Kg)	Total Petroleum Hydrocarbons (C6-C28) (mg/Kg)	Chloride (mg/Kg)
B11-1	1 0	In situ	6-Apr-10	34 9	--	--	--	--	--	--	--	--	--	--
B11-2	0 5	In situ	06-Apr-10	5 9	--	--	--	--	--	--	--	--	--	--
NMOCD Remedial Threshold Goals				100		10				50			100	250

Bolded values are in excess of NMOCD Remediation Threshold Goals
 -- = Not Analyzed, N/A = Not Applicable
 ND = Nondetectable
 SW = Soil samples collected from side walls, BH = Soil samples collected from bottom of excavation

ATTACHMENTS

**ATTACHMENT I
PHOTOGRAPHS**



Photograph No. 1 – Looking northerly at point of release



Photograph No. 2 – Looking southwesterly at free standing sweet crude oil



Photograph No. 3 – Looking northerly at sweet crude oil following a trail



Photograph No. 4 – Looking southerly at free standing sweet crude oil near point of release

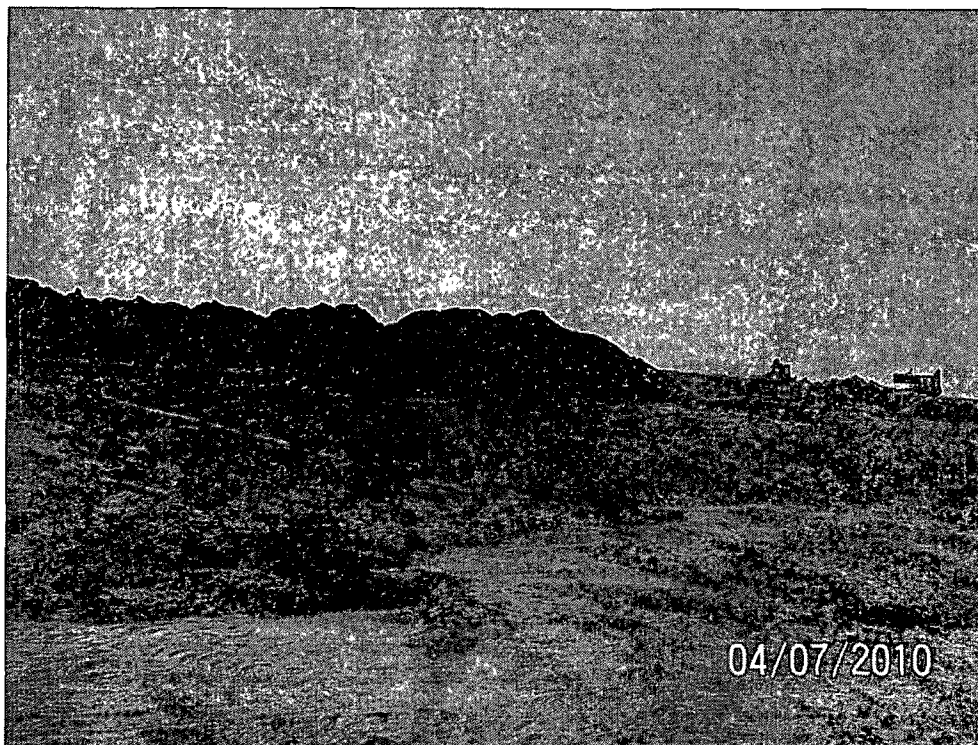

Photograph No. 5 – Looking at stockpiled blended impacted material and ROW excavation

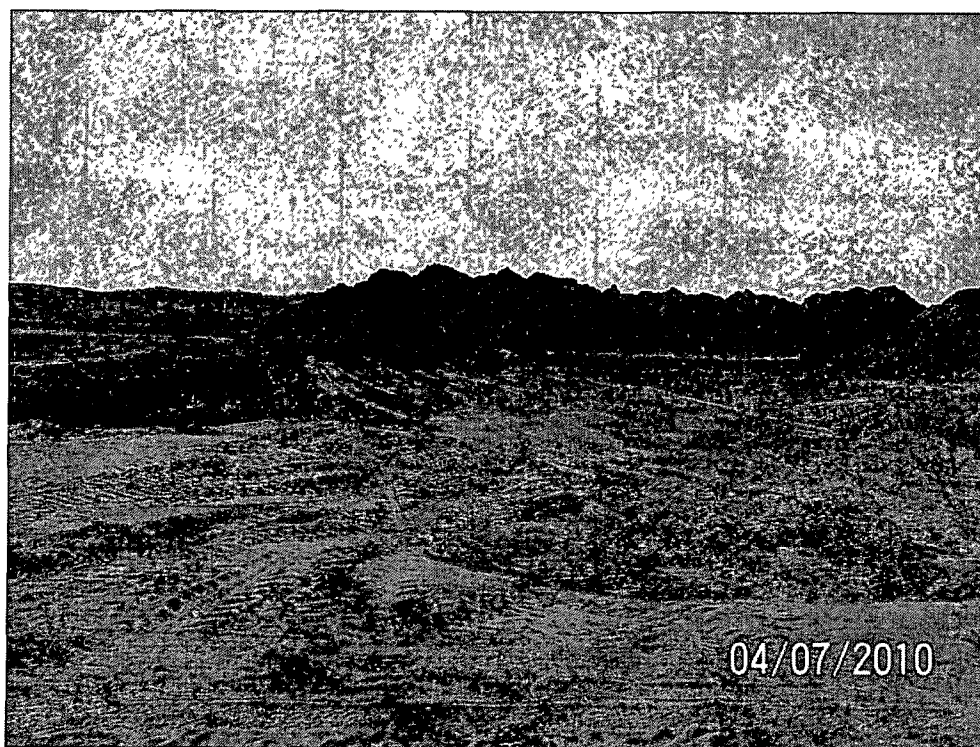

Photograph No. 6 – Looking at stockpiled blended impacted material

ATTACHMENT II
COPY OF INITIAL NMOCD FORM C-141

District I
1625 N. French Dr., Hobbs, NM 88240
District II
1301 W. Grand Avenue, Artesia, NM 88210
District III
1000 Rio Brazos Road, Aztec, NM 87410
District IV
1220 S. St. Francis Dr., Santa Fe, NM 87505

State of New Mexico
Energy Minerals and Natural Resources
Oil Conservation Division
1220 South St. Francis Dr.
Santa Fe, NM 87505

Form C-141
Revised October 10, 2003

Submit 2 Copies to appropriate
District Office in accordance
with Rule 116 on back
side of form

Release Notification and Corrective Action

OPERATOR

☒ Initial Report ☐ Final Report

Name of Company	Centurion Pipeline, LP	Contact	Becky Moore, Compliance Coordinator
Address	P.O. Box 51790, Midland, TX 79710	Telephone No.	432-686-6805
Facility Name	Brahaney Gathering System	Facility Type	Sweet Crude Oil Pipeline

Surface Owner	Robert Sledge	Mineral Owner		Lease No.	
---------------	---------------	---------------	--	-----------	--

LOCATION OF RELEASE

Unit Letter	Section	Township	Range	Feet from the	North/South Line	Feet from the	East/West Line	County
D	04	13-S	38-E					Lea

Latitude N33° 13' 28.83" Longitude W 103° 06' 36.37"

NATURE OF RELEASE

Type of Release	Sweet Crude Oil	Volume of Release	150 bbls	Volume Recovered	120 bbls
Source of Release	8" dia. Steel transmission pipeline	Date and Hour of Occurrence	04/06/10 - hour unknown	Date and Hour of Discovery	4/6/10 @ 11:50 AM
Was Immediate Notice Given?	<input checked="" type="checkbox"/> Yes <input type="checkbox"/> No <input type="checkbox"/> Not Required	If YES, To Whom?	Geoffrey Leking - left voice mail message and verbal.		
By Whom?	Becky Moore (left message)	Date and Hour	04/07/10 @ 10:30 AM (message) and @ 2:20 PM (verbal)		
Was a Watercourse Reached?	<input type="checkbox"/> Yes <input checked="" type="checkbox"/> No	If YES, Volume Impacting the Watercourse.	N/A		

If a Watercourse was Impacted, Describe Fully.* Not Applicable

Describe Cause of Problem and Remedial Action Taken.* Corrosion caused a leak on the 8" Brahaney Gathering System. Emergency Action response included immediate shut-in of the pipeline to stop the leak and a repair clamp installed. Vacuum trucks were called and a contract remediation company contacted to assist with initial emergency response and to initiate clean up. A one call was made to the State of NM 04/06/10. The site was initially secured from run off after free liquids were removed. Affected soil is being scrapped up and staged at the site. Initial delineation is in progress to determine appropriate clean up actions.

Describe Area Affected and Cleanup Action Taken.* Area affected at the source of the leak is apx. 300 ft x 300 ft. x 6 in. Estimated 1,667 cu. yds. contaminated soil is currently being excavated and stockpiled at the site. The depth to groundwater at this site is 48.41 ft. The clean up levels for TPH will be 100 ppm. The affected pipeline is in process of being replaced with 300' of new coated 8" steel pipeline. After initial C-141 remediation plans are approved and the clean up is complete, a final C-141 will be submitted and accompanied with a final report including lab analysis, pictures, and all associated closure documentation as required.

I hereby certify that the information given above is true and complete to the best of my knowledge and understand that pursuant to NMOCD rules and regulations all operators are required to report and/or file certain release notifications and perform corrective actions for releases which may endanger public health or the environment. The acceptance of a C-141 report by the NMOCD marked as "Final Report" does not relieve the operator of liability should their operations have failed to adequately investigate and remediate contamination that pose a threat to ground water, surface water, human health or the environment. In addition, NMOCD acceptance of a C-141 report does not relieve the operator of responsibility for compliance with any other federal, state, or local laws and/or regulations.

Signature: 		OIL CONSERVATION DIVISION	
Printed Name: Becky Moore		Approved by District Supervisor:	
Title: Compliance Coordinator		Approval Date:	Expiration Date:
E-mail Address: Rebecca_Moore@oxy.com		Conditions of Approval:	Attached <input type="checkbox"/>
Date: 04/07/10 Phone: (432) 686-6805 (office)			

* Attach Additional Sheets If Necessary