

OIL CONSERVATION DIVISION
RECEIVED
'92 NOV 9 AM 9 28

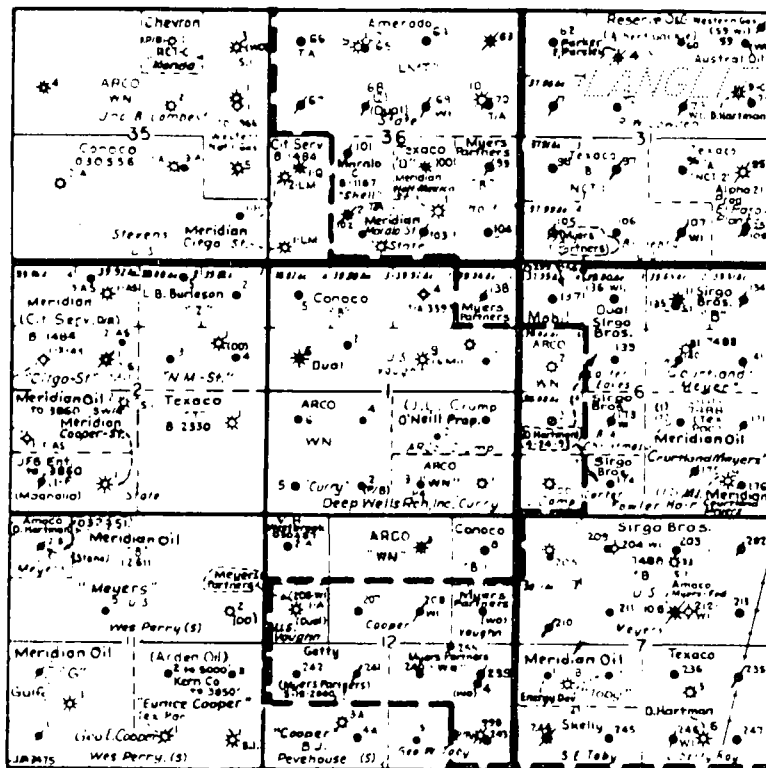

Waiver to Objection Forms _____

Simultaneous Dedication of Jalmat Gas Production
Frederick H. Curry WN #1 and #2 (existing)
Frederick H. Curry WN #6 (new)
Jalmat Gas Pool
S/2 Section 1, T24S, R36E
Lea County, New Mexico



- Meridian Oil Inc.
- ✓ Clayton W. Williams, Jr. —
- Marathon Oil Company
- ✓ Chevron USA —
- ✓ Doyle Hartman —
- ✓ Texaco Expl. & Prod. —
- Conoco, Inc.
- Amerada Hess Corp.
- Oxy USA Inc.
- ✓ Amoco Production Co. —
- ✓ Lewis B. Burleson Inc. —
- ✓ Kern Company —
- V. H. Westbrook

October 12, 1992

Unorthodox Well Location &
Simultaneous Dedication

Jalmat Gas Pool
Lea County, New Mexico

New Mexico Oil Conservation Division
P. O. Box 2088
Santa Fe, New Mexico 87504-2088

Attention: Mr. William J. LeMay, Director

Chevron U.S.A., as an offset operator, has no objection to ARCO Oil and Gas Company's application for an unorthodox gas well location for their Frederick H. Curry WN No. 6 in the subject pool. That location to be 1,980 feet FSL and 660 feet FWL, Section 1, T-24-S, R-36-E, Lea County, New Mexico. It is our further understanding that the 320 acres currently dedicated to the Frederick H. Curry WN Well Nos. 1 & 2 and comprising the S/2 of Section 1 will now be dedicated to all three wells.

Approved By: F. S. Godbold

Title: Engineering Supervisor, New Mexico Area

Representing: Chevron U.S.A

Date: October 12, 1992

Signed: *F. S. Godbold* / F. S. Godbold

Offset Operators:

Please indicate your approval for our request as detailed in the attached package by signing the waiver form below. Please return the signed waiver in the enclosed self-addressed envelope.

Thank you for your cooperation in this matter.

WAIVER TO OBJECTION

ARCO OIL AND GAS COMPANY

**Application for an
Unorthodox Jalmat Gas Well Location
Frederick H. Curry WN #6
and
Simultaneous Dedication of Jalmat Gas Production
Frederick H. Curry WN #1 and #2 (existing)
Frederick H. Curry WN #6 (new)
Jalmat Gas Pool
S/2 Section 1, T24S, R36E
Lea County, New Mexico**

I/We do hereby waive any objection to ARCO Oil and Gas Company's request for NMOCD Administrative Approval of an unorthodox well location for the Frederick H. Curry WN #6, and simultaneous dedication of Jalmat gas production from the Frederick H. Curry WN #1 and #2 to an existing 320-acre proration unit.

Signed:

Title:

Company:

Date:

Robert M. Val
Sr. Production Engr.
Texaco E & P Inc.
10-2-92

Offset Operators:

Please indicate your approval for our request as detailed in the attached package by signing the waiver form below. Please return the signed waiver in the enclosed self-addressed envelope.

Thank you for your cooperation in this matter.

WAIVER TO OBJECTION

ARCO OIL AND GAS COMPANY

**Application for an
Unorthodox Jalmat Gas Well Location**
Frederick H. Curry WN #6
and
Simultaneous Dedication of Jalmat Gas Production
Frederick H. Curry WN #1 and #2 (existing)
Frederick H. Curry WN #6 (new)
Jalmat Gas Pool
S/2 Section 1, T24S, R36E
Lea County, New Mexico

I/We do hereby waive any objection to ARCO Oil and Gas Company's request for NMOCD Administrative Approval of an unorthodox well location for the Frederick H. Curry WN #6, and simultaneous dedication of Jalmat gas production from the Frederick H. Curry WN #1 and #2 to an existing 320-acre proration unit.

Signed:

Title:

Company:

Date:



MGR. ESRA

AMOCO PRODUCTION

10/5/92

Offset Operators:

Please indicate your approval for our request as detailed in the attached package by signing the waiver form below. Please return the signed waiver in the enclosed self-addressed envelope.

Thank you for your cooperation in this matter.

WAIVER TO OBJECTION

ARCO OIL AND GAS COMPANY

Application for an Unorthodox Jalmat Gas Well Location

Frederick H. Curry WN #6

and

Simultaneous Dedication of Jalmat Gas Production

Frederick H. Curry WN #1 and #2 (existing)

Frederick H. Curry WN #6 (new)

Jalmat Gas Pool

S/2 Section 1, T24S, R36E

Lea County, New Mexico

I/We do hereby waive any objection to ARCO Oil and Gas Company's request for NMOCD Administrative Approval of an unorthodox well location for the Frederick H. Curry WN #6, and simultaneous dedication of Jalmat gas production from the Frederick H. Curry WN #1 and #2 to an existing 320-acre proration unit.

Signed:

Title:

Company:

Date:

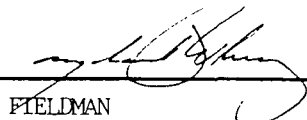
M. L. WIBERGE
FELDMAN
KERN CO. 3005 N. Big Spring, Midland, TX 79705
September 30, 1992

Offset Operators:

Please indicate your approval for our request as detailed in the attached package by signing the waiver form below. Please return the signed waiver in the enclosed self-addressed envelope.

Thank you for your cooperation in this matter.

WAIVER TO OBJECTION

ARCO OIL AND GAS COMPANY

**Application for an
Unorthodox Jalmat Gas Well Location
Frederick H. Curry WN #6
and
Simultaneous Dedication of Jalmat Gas Production
Frederick H. Curry WN #1 and #2 (existing)
Frederick H. Curry WN #6 (new)
Jalmat Gas Pool
S/2 Section 1, T24S, R36E
Lea County, New Mexico**

I/We do hereby waive any objection to ARCO Oil and Gas Company's request for NMOCD Administrative Approval of an unorthodox well location for the Frederick H. Curry WN #6, and simultaneous dedication of Jalmat gas production from the Frederick H. Curry WN #1 and #2 to an existing 320-acre proration unit.

Signed:

Title:

Company:

Date:

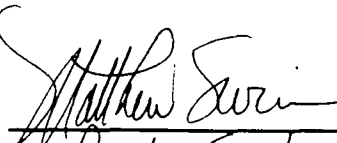

Prod. Supt.

Clayton W. Williams, Jr. Inc.

10-6-92

Offset Operators:

Please indicate your approval for our request as detailed in the attached package by signing the waiver form below. Please return the signed waiver in the enclosed self-addressed envelope.

Thank you for your cooperation in this matter.

WAIVER TO OBJECTION

ARCO OIL AND GAS COMPANY

**Application for an
Unorthodox Jalmat Gas Well Location**
Frederick H. Curry WN #6
and
Simultaneous Dedication of Jalmat Gas Production
Frederick H. Curry WN #1 and #2 (existing)
Frederick H. Curry WN #6 (new)
Jalmat Gas Pool
S/2 Section 1, T24S, R36E
Lea County, New Mexico

I/We do hereby waive any objection to ARCO Oil and Gas Company's request for NMOCD Administrative Approval of an unorthodox well location for the Frederick H. Curry WN #6, and simultaneous dedication of Jalmat gas production from the Frederick H. Curry WN #1 and #2 to an existing 320-acre proration unit.

Signed:

Title:

Company:

Date:

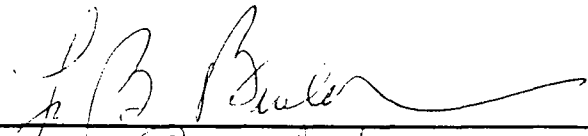

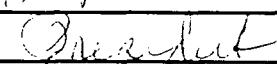

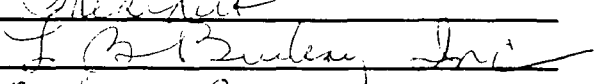

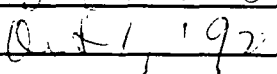

DOYLE HARTMAN

Oil Operator

500 N. MAIN

P.O. BOX 10426

MIDLAND, TEXAS 79702

(915) 684-4011

October 15, 1992

Certified Mail - Return Receipt Requested

Mr. William J. Lemay
State of New Mexico
Energy, Minerals & Natural Resources Department
Oil Conservation Division
P. O. Box 2088
Santa Fe, New Mexico 87504-2088

Re: ARCO Oil and Gas Company
Administrative Application for
Unorthodox Location and Simultaneous
Dedication
Jalmat (Gas) Pool
Frederick H. Curry WN No. 6
1980' FSL and 660' FWL
Section 1, T-24-S, R-36-E
Lea County, New Mexico

Gentlemen:

Reference is made to the attached notification from ARCO Oil and Gas Company dated September 28, 1992 and received by Hartman September 30, 1992, regarding ARCO's application for an unorthodox location and simultaneous dedication of the above-referenced well. The Frederick H. Curry WN No. 6 well, to be recompleted from the Langlie Mattix (7R-Qn-Gbg) to the Jalmat (Gas) pool, is located 1980' FSL and 660' FWL of Section 1, T-24-S, R-36-E and would be simultaneously dedicated along with ARCO's Frederick H. Curry WN Nos. 1 and 2 wells to the existing 320-acre non-standard Jalmat (Gas) proration unit consisting of the S/2 of Section 1, T-24-S, R-36-E, Lea County, New Mexico.

In light of the fact that ARCO's proposed recompletion does not directly offset us and we are not being encroached upon, we do not feel it is appropriate for us to object to ARCO's administrative request for a location consisting of 1980' FSL and 660' FWL of Section 1, T-24-S, R-37-E.

Mr. William J. Lemay
October 15, 1992
Page 2

Thank you for your consideration in this matter, and please let me know if you need anything further.

Very truly yours,

DOYLE HARTMAN

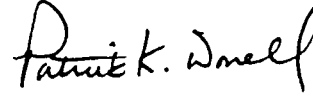
A handwritten signature in black ink, appearing to read "Patrick K. Worrell". The signature is fluid and cursive, with the first name "Patrick" and last name "Worrell" clearly distinguishable.

Patrick K. Worrell
Engineer

PKW/jg
Attachment

cc: Mr. Kevin D. Renfro
ARCO Oil and Gas Company
P. O. Box 1610
Midland, Texas 79702

Mr. James A. Davidson
P. O. Box 494
Midland, Texas 79702

Gallegos Law Firm
Attn: Mr. Gene Gallegos
141 East Palace Avenue
Santa Fe, New Mexico 87501

Mr. Daniel S. Nutter
105 E. Alicante
Santa Fe, New Mexico 87501

ARCO Oil and Gas Company
Western District
Post Office Box 1610
Midland, TX 79702
Telephone (915) 688-5200



September 28, 1992

Mr. William J. LeMay
New Mexico Oil Conservation Division
P. O. Box 2088
Santa Fe, New Mexico 87501

Mr. J. T. Sexton
New Mexico Oil Conservation Division
P. O. Box 1980
Hobbs, New Mexico 88240

RE: Application for Unorthodox Jalmat Gas Well Location & Simultaneous Dedication
Frederick H. Curry WN#6
S/2 Section 1, T24S, R36E, Lea County, New Mexico
Jalmat (Tansil/Yates/Seven Rivers) Gas Pool

Dear Mr. LeMay / Mr. Sexton:

ARCO Oil and Gas Company respectfully requests administrative approval for an unorthodox Jalmat gas well location for the Frederick H. Curry WN #6 well, located 1980' FSL, 660' FWL, Section 1, T-24S, R-36E in Lea County, New Mexico. The Frederick H. Curry WN #6 is a Langlie Mattix (Seven Rivers/Queen/Grayburg) oil well which ARCO is preparing to recomplete uphole to the Jalmat pool. At the same time, ARCO requests simultaneous dedication of the Jalmat gas production from the Frederick H. Curry WN #1 and #2 wells with the Jalmat gas production from the Frederick H. Curry WN #6 well. The Frederick H. Curry WN #1 and #2 are Jalmat gas wells that are currently dedicated to an existing 320-acre proration unit comprised of the S/2 of Section 1, T-24S, R-36E.

Attached are C-102 forms identifying both the existing and proposed configuration of the subject 320-acre Jalmat gas proration unit. Also attached is a list of offset operators and/or co-owners for this unit, and a land plat map of the surrounding area.

ARCO Oil and Gas Company believes approval of this request will be in the interest of conservation, will protect correlative rights, and will allow for a more complete recovery of Jalmat gas reserves from the subject acreage.

ARCO Oil and Gas Company is notifying the offset operators of this application by sending a copy of this application package, along with waiver to objection forms, by certified mail. If you need further information, please call me at (915) 688-5546.

Sincerely,

Kevin D. Renfro
Operations/Analytical Engineer

KDR:lrh

Attachments



SEP 30 1992

Simultaneous Dedication of Jalmat Gas Production
Frederick H. Curry WN #1 and #2 (existing)
Frederick H. Curry WN #6 (new)
Jalmat Gas Pool
S/2 Section 1, T24S, R36E
Lea County, New Mexico

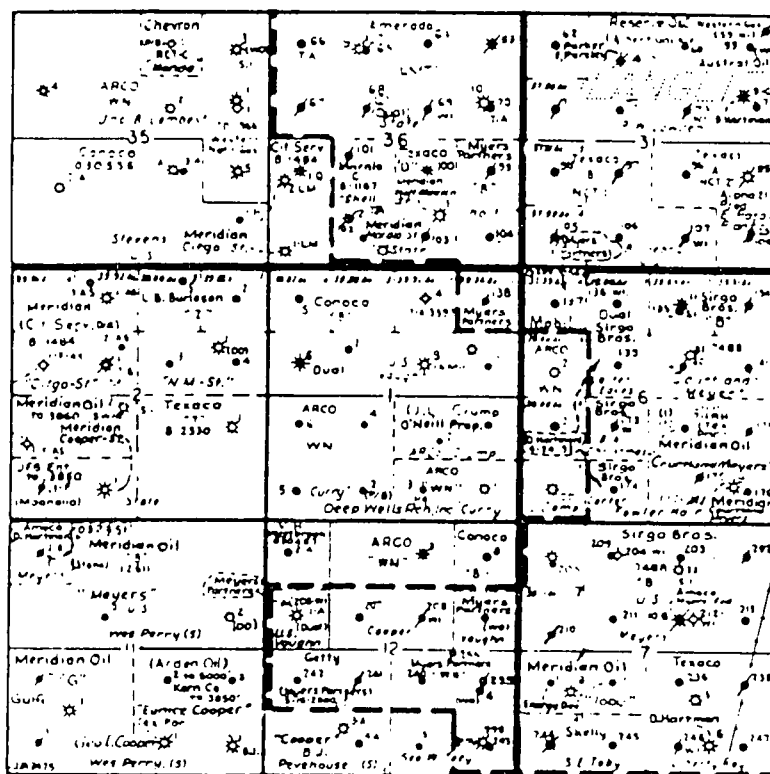

Meridian Oil Inc.
Clayton W. Williams, Jr.
Marathon Oil Company
Chevron USA
Doyle Hartman
Texaco Expl. & Prod.
Conoco, Inc.
Amerada Hess Corp.
Oxy USA Inc.
Amoco Production Co.
Lewis B. Burleson Inc.
Kern Company
V. H. Westbrook

Submit to Appropriate
District Office
State Lease - 4 copies
Fee Lease - 3 copies

State of New Mexico
Energy, Minerals and Natural Resources Department

Form C-102
Revised 1-1-89

OIL CONSERVATION DIVISION

P.O. Box 2088
Santa Fe, New Mexico 87504-2088

DISTRICT I
P.O. Box 1980, Hobbs, NM 88240

DISTRICT II
P.O. Drawer DD, Artesia, NM 88210

DISTRICT III
1000 Rio Brazos Rd., Aztec, NM 87410

WELL LOCATION AND ACREAGE DEDICATION PLAT

All Distances must be from the outer boundaries of the section

Operator Arco Oil and Gas Company			Lease Frederick H. Curry WN		Well No. #6
Unit Letter L	Section 1	Township T-24S	Range R-36E	County NMPM	Lea
Actual Footage Location of Well: 1980 feet from the South line and 660 feet from the West line Ground level Elev. Producing Formation Pool Dedicated Acreage: 3357' Tansill/Yates/7-Rivers Jalmat Gas 320 Acres					

- Outline the acreage dedicated to the subject well by colored pencil or hatchure marks on the plat below.
- If more than one lease is dedicated to the well, outline each and identify the ownership thereof (both as to working interest and royalty).
- If more than one lease of different ownership is dedicated to the well, have the interest of all owners been consolidated by communitization, unitization, force-pooling, etc.?
☐ Yes ☐ No If answer is "yes" type of consolidation _____
If answer is "no" list the owners and tract descriptions which have actually been consolidated. (Use reverse side of this form if necessary).
No allowable will be assigned to the well until all interests have been consolidated (by communitization, unitization, forced-pooling, or otherwise) or until a non-standard unit, eliminating such interest, has been approved by the Division.

OPERATOR CERTIFICATION

I hereby certify that the information contained herein is true and complete to the best of my knowledge and belief.

Signature

E.E. Gilson

Printed Name(s)

E.E. Gilson

Position

Engineering Tech.

Company

Arco Oil and Gas Co.

Date

September 29, 1992

SURVEYOR CERTIFICATION

I hereby certify that the well location shown on this plat was plotted from field notes of actual surveys made by me or under my supervision, and that the same is true and correct to the best of my knowledge and belief.

Date Surveyed

Signature & Seal of
Professional Surveyor

Certificate No.

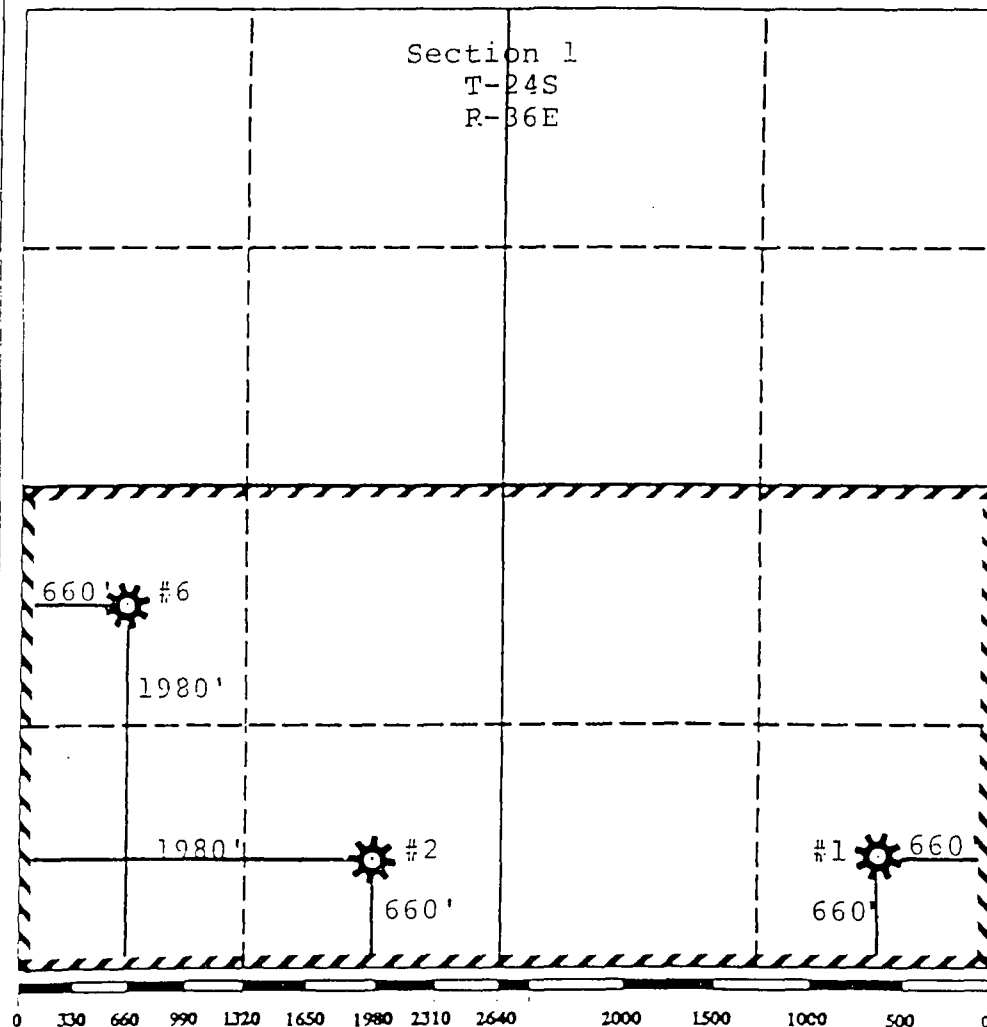

NEW MEXICO OIL CONSERVATION COMMISSION
WELL LOCATION AND ACREAGE DEDICATION PLAT

Form C-102
Supersedes C-101
Effective 1-1-6

All distances must be from the outer boundaries of the Section

Operator VARCO OIL & GAS COMPANY <i>Division of Atlantic Richfield Co.</i>			Lease Frederick H. Curry WN		Well No. 2
Unit Letter N	Section 1	Township 24 South	Range 36 East	County Lea	
Actual Footage Location of Well: 660 feet from the South line and 1980 feet from the West line					
Ground Level Elev. 3345	Producing Formation yates - 7 Rivers		Pool Langlie Mattix Jalmat	Dedicated Acreage 40 Acre Jalmat 320 Acre	

1. Outline the acreage dedicated to the subject well by colored pencil or hatchure marks on the plat below.
2. If more than one lease is dedicated to the well, outline each and identify the ownership thereof (both as to working interest and royalty).
3. If more than one lease of different ownership is dedicated to the well, have the interests of all owners been consolidated by communitization, unitization, force-pooling, etc?

☐ Yes ☐ No If answer is "yes," type of consolidation _____

If answer is "no," list the owners and tract descriptions which have actually been consolidated. (Use reverse side of this form if necessary.) _____

No allowable will be assigned to the well until all interests have been consolidated (by communitization, unitization, forced-pooling, or otherwise) or until a non-standard unit, eliminating such interests, has been approved by the Commission.

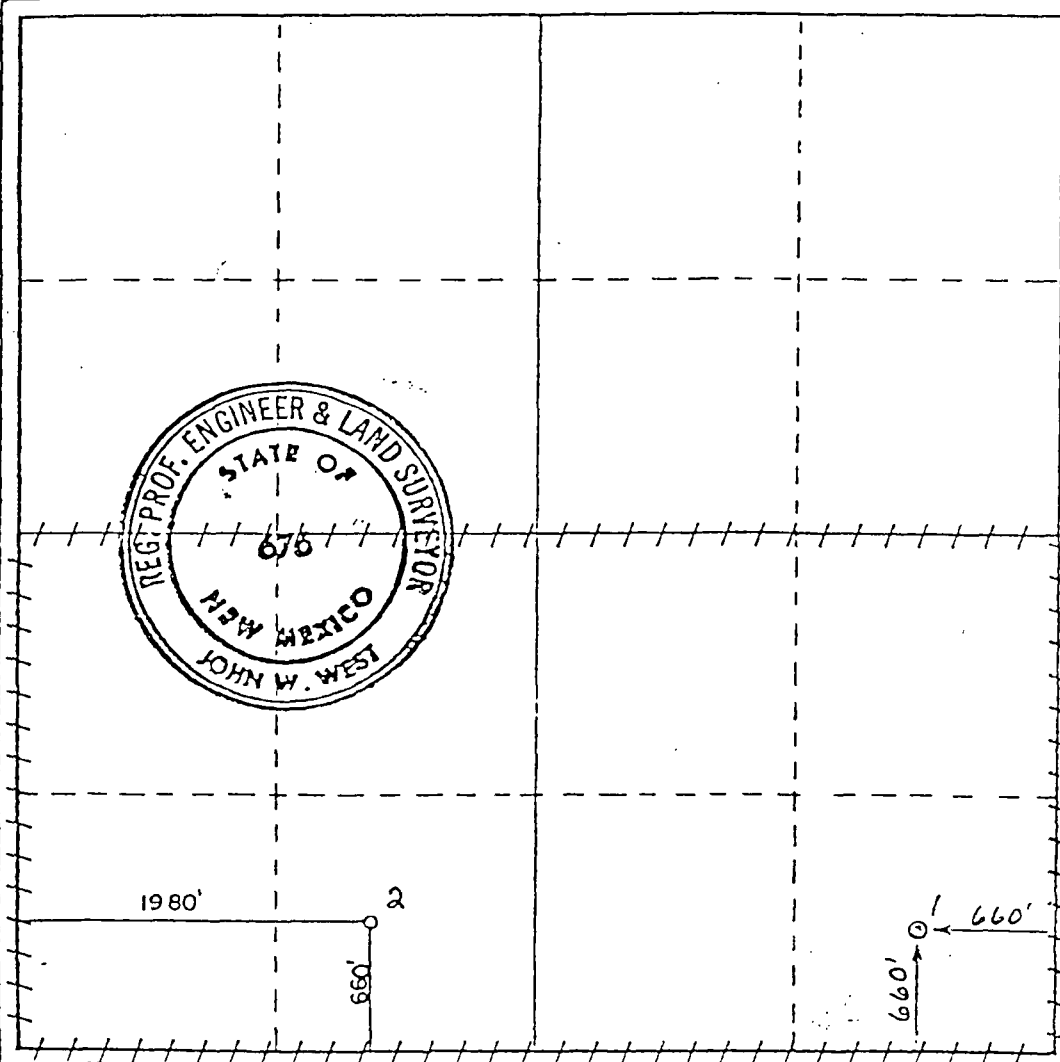

CERTIFICATION

I hereby certify that the information contained herein is true and complete to the best of my knowledge and belief.

Name *[Signature]*
Position
Dist. Dirg. Supt.
VARCO Oil and Gas Company
Division of Atlantic Richfield Company

Date
9/24/79

I hereby certify that the well location shown on this plat was plotted from field notes of actual surveys made by me or under my supervision, and that the same is true and correct to the best of my knowledge and belief.

Date Surveyed
September 12, 1979
Registered Professional Engineer and/or Land Surveyor

[Signature]
Certificate No. **John W. West** 67

Frederick Curry WR#6

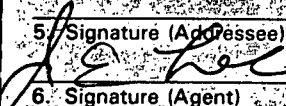
SENDER: <ul style="list-style-type: none"> • Complete items 1 and/or 2 for additional services. • Complete items 3 and 4a & b. • Print your name and address on the reverse of this form so that we can return this card to you. • Attach this form to the front of the mailpiece, or on the back if space does not permit. • Write "Return Receipt Requested" on the mailpiece next to the article number. 		I also wish to receive the following services (for an extra fee): 1. <input type="checkbox"/> Addressee's Address 2. <input type="checkbox"/> Restricted Delivery Consult postmaster for fee.	
3. Article Addressed to: <div style="border: 1px solid black; padding: 5px; text-align: center;"> Amerada Hess Corporation Attn: Regulatory Affairs 1200 Milam St. Houston, Texas 77002 </div>		4a. Article Number <div style="border: 1px solid black; padding: 5px; text-align: center;"> P 322 150 657 </div>	
		4b. Service Type <input type="checkbox"/> Registered <input type="checkbox"/> Insured <input checked="" type="checkbox"/> Certified <input type="checkbox"/> COD <input checked="" type="checkbox"/> Express Mail <input type="checkbox"/> Return Receipt for Merchandise	
		7. Date of Delivery <div style="border: 1px solid black; padding: 5px; text-align: center;"> OCT 01 1992 </div>	
5. Signature (Addressee) 		8. Addressee's Address (Only if requested and fee is paid)	
6. Signature (Agent)			

PS Form 3811, October 1990 U.S. GPO: 1990-273-881 **DOMESTIC RETURN RECEIPT**

Frederick Curry WR#6

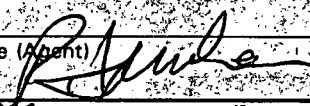
SENDER: <ul style="list-style-type: none"> • Complete items 1 and/or 2 for additional services. • Complete items 3 and 4a & b. • Print your name and address on the reverse of this form so that we can return this card to you. • Attach this form to the front of the mailpiece, or on the back if space does not permit. • Write "Return Receipt Requested" on the mailpiece next to the article number. 		I also wish to receive the following services (for an extra fee): 1. <input type="checkbox"/> Addressee's Address 2. <input type="checkbox"/> Restricted Delivery Consult postmaster for fee.	
3. Article Addressed to: <div style="border: 1px solid black; padding: 5px; text-align: center;"> Amoco Production Co. Attn: J. C. Allen - Rm. 3.248 P. O. Box 3092 Houston, Texas 77253 </div>		4a. Article Number <div style="border: 1px solid black; padding: 5px; text-align: center;"> P 322 150 655 </div>	
		4b. Service Type <input type="checkbox"/> Registered <input type="checkbox"/> Insured <input checked="" type="checkbox"/> Certified <input type="checkbox"/> COD <input type="checkbox"/> Express Mail <input type="checkbox"/> Return Receipt for Merchandise	
		7. Date of Delivery <div style="border: 1px solid black; padding: 5px; text-align: center;"> OCT 1 - 1992 </div>	
5. Signature (Addressee)		8. Addressee's Address (Only if requested and fee is paid)	
6. Signature (Agent) 			

PS Form 3811, October 1990 U.S. GPO: 1990-273-881 **DOMESTIC RETURN RECEIPT**

Frederick Curry W2 #6
SENDER:

- Complete items 1 and/or 2 for additional services.
- Complete items 3 and 4a & b.
- Print your name and address on the reverse of this form so that we can return this card to you.
- Attach this form to the front of the mailpiece, or on the back if space does not permit.
- Write "Return Receipt Requested" on the mailpiece next to the article number.

I also wish to receive the following services (for an extra fee):

1. ☐ Addressee's Address
2. ☒ Restricted Delivery

Consult postmaster for fee.

3. Article Addressed to:

Meridian Oil Inc.
Attn: Connie L. Malik
P. O. Box 51810
Midland, Texas 79710-1810

4a. Article Number

P 322 150 665

4b. Service Type

- ☐ Registered ☐ Insured
☒ Certified ☐ COD
☒ Express Mail ☐ Return Receipt for Merchandise

7. Date of Delivery

Oct 1 1992

5. Signature (Addressee)

8. Addressee's Address (Only if requested and fee is paid)

6. Signature (Agent)

PS Form 3811, October 1990

U.S. GPO: 1990-273-861

DOMESTIC RETURN RECEIPT

Frederick Curry W2 #6
SENDER:

- Complete items 1 and/or 2 for additional services.
- Complete items 3 and 4a & b.
- Print your name and address on the reverse of this form so that we can return this card to you.
- Attach this form to the front of the mailpiece, or on the back if space does not permit.
- Write "Return Receipt Requested" on the mailpiece next to the article number.

I also wish to receive the following services (for an extra fee):

1. ☐ Addressee's Address
2. ☒ Restricted Delivery

Consult postmaster for fee.

3. Article Addressed to:

Clayton W. Williams, Jr.
Attn: Matt Swierc
6 Desta Drive, Suite 3000
Midland, Texas 79705

4a. Article Number

P 322 150 664

4b. Service Type

- ☐ Registered ☐ Insured
☒ Certified ☐ COD
☒ Express Mail ☐ Return Receipt for Merchandise

7. Date of Delivery

9-30-92

5. Signature (Addressee)

8. Addressee's Address (Only if requested and fee is paid)

6. Signature (Agent)

PS Form 3811, October 1990

U.S. GPO: 1990-273-861

DOMESTIC RETURN RECEIPT

Frederick Curry W2 #6
SENDER:

- Complete items 1 and/or 2 for additional services.
- Complete items 3 and 4a & b.
- Print your name and address on the reverse of this form so that we can return this card to you.
- Attach this form to the front of the mailpiece, or on the back if space does not permit.
- Write "Return Receipt Requested" on the mailpiece next to the article number.

I also wish to receive the following services (for an extra fee):

1. ☐ Addressee's Address
2. ☐ Restricted Delivery

Consult postmaster for fee.

3. Article Addressed to:

Texaco Explo. & Prod. Inc.
Attn: J. A. Head
P. O. Box 728
Hobbs, New Mexico 88240

4a. Article Number

P 322 150 660

4b. Service Type

- ☐ Registered ☐ Insured
☒ Certified ☐ COD
☒ Express Mail ☐ Return Receipt for Merchandise

7. Date of Delivery

5. Signature (Addressee)

8. Addressee's Address (Only if requested and fee is paid)

6. Signature (Agent)

PS Form 3811, October 1990

U.S. GPO: 1990-273-861

DOMESTIC RETURN RECEIPT

SENDER:

- Complete items 1 and/or 2 for additional services.
- Complete items 3, and 4a & b.
- Print your name and address on the reverse of this form so that we can return this card to you.
- Attach this form to the front of the mailpiece, or on the back if space does not permit.
- Write "Return Receipt Requested" on the mailpiece next to the article number.

I also wish to receive the following services (for an extra fee):

1 ☐ Addressee's Address

2 ☐ Restricted Delivery

Consult postmaster for fee.

3. Article Addressed to:

Texaco Explo. & Prod. Inc.
Attn: R. S. Lane
P. O. Box 3109
Midland, Texas 79701

4a. Article Number

P 322 150 659

4b. Service Type

☐ Registered ☐ Insured

☒ Certified ☐ COD

☐ Express Mail ☐ Return Receipt for Merchandise

7. Date of Delivery SEP 30 1992

5. Signature (Addressee)

8. Addressee's Address (Only if requested and fee is paid)

6. Signature (Agent)

Rob Lane

PS Form 3811, October 1990

U.S. GPO: 1990-273-881

DOMESTIC RETURN RECEIPT

SENDER:

- Complete items 1 and/or 2 for additional services.
- Complete items 3, and 4a & b.
- Print your name and address on the reverse of this form so that we can return this card to you.
- Attach this form to the front of the mailpiece, or on the back if space does not permit.
- Write "Return Receipt Requested" on the mailpiece next to the article number.

I also wish to receive the following services (for an extra fee):

1 ☐ Addressee's Address

2 ☐ Restricted Delivery

Consult postmaster for fee.

3. Article Addressed to:

Lewis B. Burleson, Inc.
P. O. Box 2479
Midland, Texas 79702

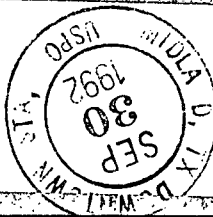

4a. Article Number

P 322 150 654

4b. Service Type

☐ Registered ☐ Insured

☒ Certified ☐ COD

☐ Express Mail ☐ Return Receipt for Merchandise

7. Date of Delivery

5. Signature (Addressee)

8. Addressee's Address (Only if requested and fee is paid)

6. Signature (Agent)

Abriel Burleson

PS Form 3811, October 1990

U.S. GPO: 1990-273-881

DOMESTIC RETURN RECEIPT

SENDER:

- Complete items 1 and/or 2 for additional services.
- Complete items 3, and 4a & b.
- Print your name and address on the reverse of this form so that we can return this card to you.
- Attach this form to the front of the mailpiece, or on the back if space does not permit.
- Write "Return Receipt Requested" on the mailpiece next to the article number.

I also wish to receive the following services (for an extra fee):

1 ☐ Addressee's Address

2 ☐ Restricted Delivery

Consult postmaster for fee.

3. Article Addressed to:

Marathon Oil
P. O. Box 552
Midland, Texas 79702

4a. Article Number

P 322 150 663

4b. Service Type

☐ Registered ☐ Insured

☒ Certified ☐ COD

☐ Express Mail ☐ Return Receipt for Merchandise

7. Date of Delivery

SEP 30 1992

5. Signature (Addressee)

8. Addressee's Address (Only if requested and fee is paid)

6. Signature (Agent)

Robert Conner

PS Form 3811, October 1990

U.S. GPO: 1990-273-881

DOMESTIC RETURN RECEIPT

SENDER: Complete items 1 and/or 2 for additional services. Complete items 3 and 4a & b. Print your name and address on the reverse of this form so that we can return this card to you. Attach this form to the front of the mailpiece, or on the back if space does not permit. Write "Return Receipt Requested" on the mailpiece next to the article number.		I also wish to receive the following services (for an extra fee): 1 <input type="checkbox"/> Addressee's Address 2 <input type="checkbox"/> Restricted Delivery Consult postmaster for fee.	
3. Article Addressed to: Chevron USA, Inc. Attn: A. W. Bohling P. O. Box 1150 Midland, Texas 79702		4a. Article Number P 322 150 662	
		4b. Service Type <input checked="" type="checkbox"/> Registered <input type="checkbox"/> Insured <input checked="" type="checkbox"/> Certified <input type="checkbox"/> COD <input type="checkbox"/> Express Mail <input type="checkbox"/> Return Receipt for Merchandise	
		7. Date of Delivery SEP 30 1992	
5. Signature (Addressee) 6. Signature (Agent)		8. Addressee's Address (Only if requested and fee is paid)	
PS Form 3811, October 1990 U.S. GPO: 1990-273-861 DOMESTIC RETURN RECEIPT			

SENDER: Complete items 1 and/or 2 for additional services. Complete items 3 and 4a & b. Print your name and address on the reverse of this form so that we can return this card to you. Attach this form to the front of the mailpiece, or on the back if space does not permit. Write "Return Receipt Requested" on the mailpiece next to the article number.		I also wish to receive the following services (for an extra fee): 1 <input type="checkbox"/> Addressee's Address 2 <input type="checkbox"/> Restricted Delivery Consult postmaster for fee.	
3. Article Addressed to: Doyle Hartman Attn: Patrick K. Worrell P. O. Box 10426 Midland, Texas 79702		4a. Article Number P 322 150 661	
		4b. Service Type <input checked="" type="checkbox"/> Registered <input type="checkbox"/> Insured <input checked="" type="checkbox"/> Certified <input type="checkbox"/> COD <input type="checkbox"/> Express Mail <input type="checkbox"/> Return Receipt for Merchandise	
		7. Date of Delivery 9-30-92	
5. Signature (Addressee) 6. Signature (Agent)		8. Addressee's Address (Only if requested and fee is paid)	
PS Form 3811, October 1990 U.S. GPO: 1990-273-861 DOMESTIC RETURN RECEIPT			

SENDER: Complete items 1 and/or 2 for additional services. Complete items 3 and 4a & b. Print your name and address on the reverse of this form so that we can return this card to you. Attach this form to the front of the mailpiece, or on the back if space does not permit. Write "Return Receipt Requested" on the mailpiece next to the article number.		I also wish to receive the following services (for an extra fee): 1 <input type="checkbox"/> Addressee's Address 2 <input type="checkbox"/> Restricted Delivery Consult postmaster for fee.	
3. Article Addressed to: Kern Company Attn: William G. Kern 3005 N. Big Spring Midland, Texas 79705		4a. Article Number P 322 150 653	
		4b. Service Type <input type="checkbox"/> Registered <input type="checkbox"/> Insured <input checked="" type="checkbox"/> Certified <input type="checkbox"/> COD <input type="checkbox"/> Express Mail <input type="checkbox"/> Return Receipt for Merchandise	
		7. Date of Delivery 9-30-92	
5. Signature (Addressee) 6. Signature (Agent)		8. Addressee's Address (Only if requested and fee is paid)	
PS Form 3811, October 1990 U.S. GPO: 1990-273-861 DOMESTIC RETURN RECEIPT			

OK ~~OK~~ 12/3/92

Waivers pending from Meridian, Marathon, Conoco, Omarada Hess, Oxy and U.H. Westbrook.

ARCO Oil and Gas Company
Western District
Post Office Box 1610
Midland, TX 79702
Telephone (915) 688-5200

OIL CONSERVATION DIVISION
RECEIVED
'92 OCT 2 PM 9 03



September 28, 1992

Mr. William J. LeMay
New Mexico Oil Conservation Division
P. O. Box 2088
Santa Fe, New Mexico 87501

Mr. J. T. Sexton
New Mexico Oil Conservation Division
P. O. Box 1980
Hobbs, New Mexico 88240

RE: Application for Unorthodox Jalmat Gas Well Location & Simultaneous Dedication
Frederick H. Curry WN#6
S/2 Section 1, T24S, R36E, Lea County, New Mexico
Jalmat (Tansill/Yates/Seven Rivers) Gas Pool

Dear Mr. LeMay / Mr. Sexton:

ARCO Oil and Gas Company respectfully requests administrative approval for an unorthodox Jalmat gas well location for the Frederick H. Curry WN #6 well, located 1980' FSL, 660' FWL, Section 1, T-24S, R-36E in Lea County, New Mexico. The Frederick H. Curry WN #6 is a Langlie Mattix (Seven Rivers/Queen/Grayburg) oil well which ARCO is preparing to recomplete uphole to the Jalmat pool. At the same time, ARCO requests simultaneous dedication of the Jalmat gas production from the Frederick H. Curry WN #1 and #2 wells with the Jalmat gas production from the Frederick H. Curry WN #6 well. The Frederick H. Curry WN #1 and #2 are Jalmat gas wells that are currently dedicated to an existing 320-acre proration unit comprised of the S/2 of Section 1, T-24S, R-36E.

Attached are C-102 forms identifying both the existing and proposed configuration of the subject 320-acre Jalmat gas proration unit. Also attached is a list of offset operators and/or co-owners for this unit, and a land plat map of the surrounding area.

ARCO Oil and Gas Company believes approval of this request will be in the interest of conservation, will protect correlative rights, and will allow for a more complete recovery of Jalmat gas reserves from the subject acreage.

ARCO Oil and Gas Company is notifying the offset operators of this application by sending a copy of this application package, along with waiver to objection forms, by certified mail. If you need further information, please call me at (915) 688-5546.

Sincerely,

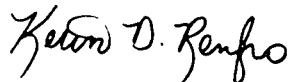

Kevin D. Renfro
Operations/Analytical Engineer

KDR:lrh

Attachments

Offset Operators:

Please indicate your approval for our request as detailed in the attached package by signing the waiver form below. Please return the signed waiver in the enclosed self-addressed envelope.

Thank you for your cooperation in this matter.

WAIVER TO OBJECTION

ARCO OIL AND GAS COMPANY

Application for an Unorthodox Jalmat Gas Well Location

Frederick H. Curry WN #6

and

Simultaneous Dedication of Jalmat Gas Production

Frederick H. Curry WN #1 and #2 (existing)

Frederick H. Curry WN #6 (new)

Jalmat Gas Pool

S/2 Section 1, T24S, R36E

Lea County, New Mexico

I/We do hereby waive any objection to ARCO Oil and Gas Company's request for NMOCD Administrative Approval of an unorthodox well location for the Frederick H. Curry WN #6, and simultaneous dedication of Jalmat gas production from the Frederick H. Curry WN #1 and #2 to an existing 320-acre proration unit.

Signed: _____

Title: _____

Company: _____

Date: _____

ARCO OIL AND GAS COMPANY
Application for an
Unorthodox Jalmat Gas Well Location
Frederick H. Curry WN #6

Simultaneous Dedication of Jalmat Gas Production
Frederick H. Curry WN #1 and #2 (existing)
Frederick H. Curry WN #6 (new)
Jalmat Gas Pool
S/2 Section 1, T24S, R36E
Lea County, New Mexico

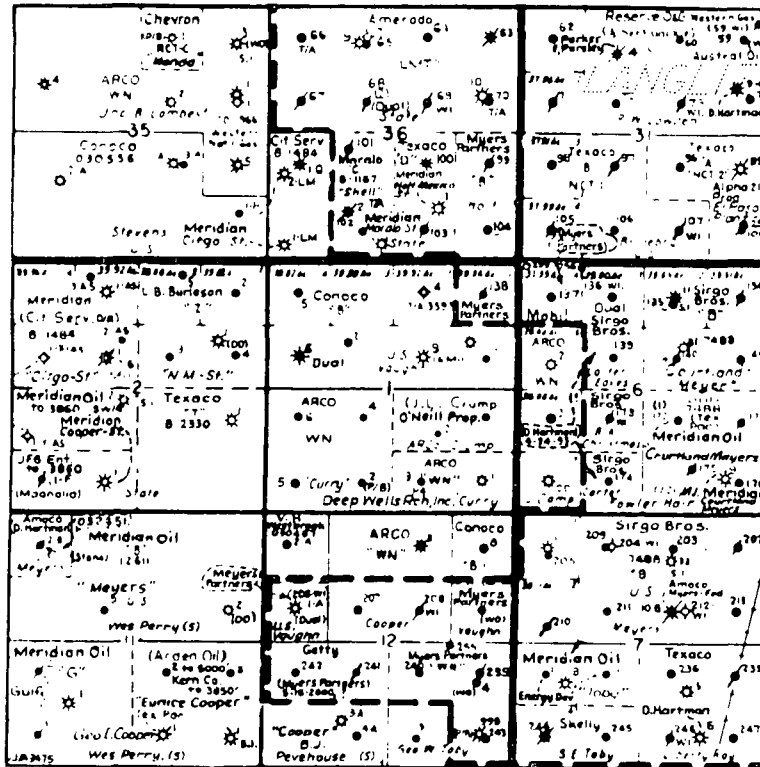

OFFSET OPERATORS

Meridian Oil Inc.
 Clayton W. Williams, Jr.
 Marathon Oil Company
 Chevron USA
 Doyle Hartman
 Texaco Expl. & Prod.
 Conoco, Inc.
 Amerada Hess Corp.
 Oxy USA Inc.
 Amoco Production Co.
 Lewis B. Burleson Inc.
 Kern Company
 V. H. Westbrook

Submit to Appropriate
District Office
State Lease - 4 copies
Fee Lease - 3 copies

State of New Mexico
Energy, Minerals and Natural Resources Department

Form C-102
Revised 1-1-89

OIL CONSERVATION DIVISION

P.O. Box 2088
Santa Fe, New Mexico 87504-2088

DISTRICT I
P.O. Box 1980, Hobbs, NM 88240

DISTRICT II
P.O. Drawer DD, Artesia, NM 88210

DISTRICT III
1000 Rio Brazos Rd., Aztec, NM 87410

WELL LOCATION AND ACREAGE DEDICATION PLAT

All Distances must be from the outer boundaries of the section

Operator Arco Oil and Gas Company			Lease Frederick H. Curry WN		Well No. #6
Unit Letter L	Section 1	Township T-24S	Range R-36E	County NMNM	Lea
Actual Footage Location of Well: 1980 feet from the South line and 660 feet from the West line					
Ground level Elev. 3357'		Producing Formation Tansill/Yates/7-Rivers		Pool Jalmat Gas	
					Dedicated Acreage: 320 Acres

1. Outline the acreage dedicated to the subject well by colored pencil or hatchure marks on the plat below.
2. If more than one lease is dedicated to the well, outline each and identify the ownership thereof (both as to working interest and royalty).
3. If more than one lease of different ownership is dedicated to the well, have the interest of all owners been consolidated by communitization, unitization, force-pooling, etc.?
☐ Yes ☐ No If answer is "yes" type of consolidation _____
If answer is "no" list the owners and tract descriptions which have actually been consolidated. (Use reverse side of this form if necessary.)
No allowable will be assigned to the well until all interests have been consolidated (by communitization, unitization, forced-pooling, or otherwise) or until a non-standard unit, eliminating such interest, has been approved by the Division.

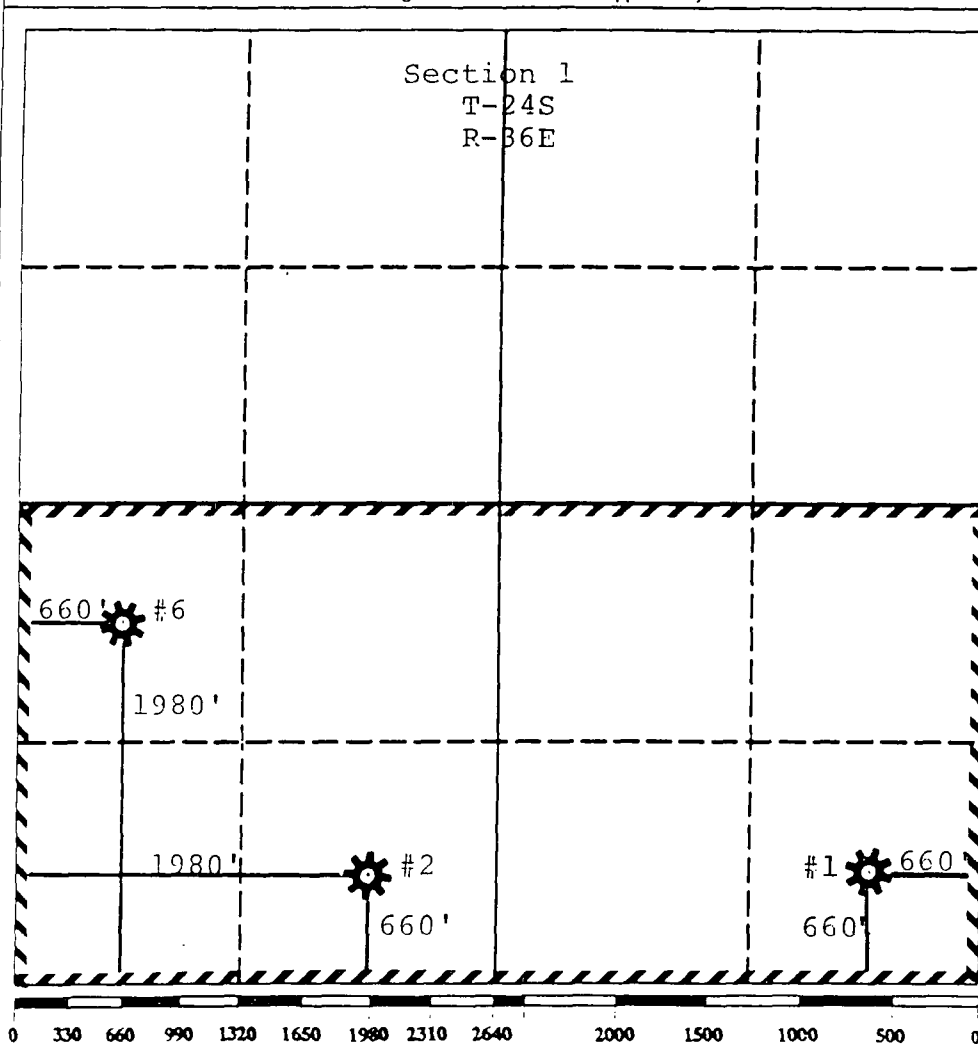

OPERATOR CERTIFICATION

I hereby certify that the information contained herein is true and complete to the best of my knowledge and belief.

Signature

Evelyn Gilson

Printed Name

E.E. Gilson

Position

Engineering Tech.

Company

Arco Oil and Gas Co.

Date

September 29, 1992

SURVEYOR CERTIFICATION

I hereby certify that the well location shown on this plat was plotted from field notes of actual surveys made by me or under my supervision, and that the same is true and correct to the best of my knowledge and belief.

Date Surveyed

Signature & Seal of
Professional Surveyor

Certificate No.

NEW MEXICO OIL CONSERVATION COMMISSION
WELL LOCATION AND ACREAGE DEDICATION PLAT

Form C-102
Supersedes C-1
Effective 1-1-6

All distances must be from the outer boundaries of the Section

Operator VARCO OIL & GAS COMPANY Division of Atlantic Richfield Co.			Lease Frederick H. Curry WN		Well No. 2
Unit Letter N	Section 1	Township 24 South	Range 36 East	County Lea	
Actual Footage Location of Well:					
660 feet from the South line and		1980 feet from the West line			
Ground Level Elev. 3345	Producing Formation yates-7 Rivers	Pool Langlie Mattix Talmat	Assigned Acreage 40 Acr Talmat 320 Acr		

1. Outline the acreage dedicated to the subject well by colored pencil or hachure marks on the plat below.
2. If more than one lease is dedicated to the well, outline each and identify the ownership thereof (both as to working interest and royalty).
3. If more than one lease of different ownership is dedicated to the well, have the interests of all owners been consolidated by communitization, unitization, force-pooling, etc?

☐ Yes ☐ No If answer is "yes," type of consolidation _____

If answer is "no," list the owners and tract descriptions which have actually been consolidated. (Use reverse side of this form if necessary.) _____

No allowable will be assigned to the well until all interests have been consolidated (by communitization, unitization, forced-pooling, or otherwise) or until a non-standard unit, eliminating such interests, has been approved by the Commission.

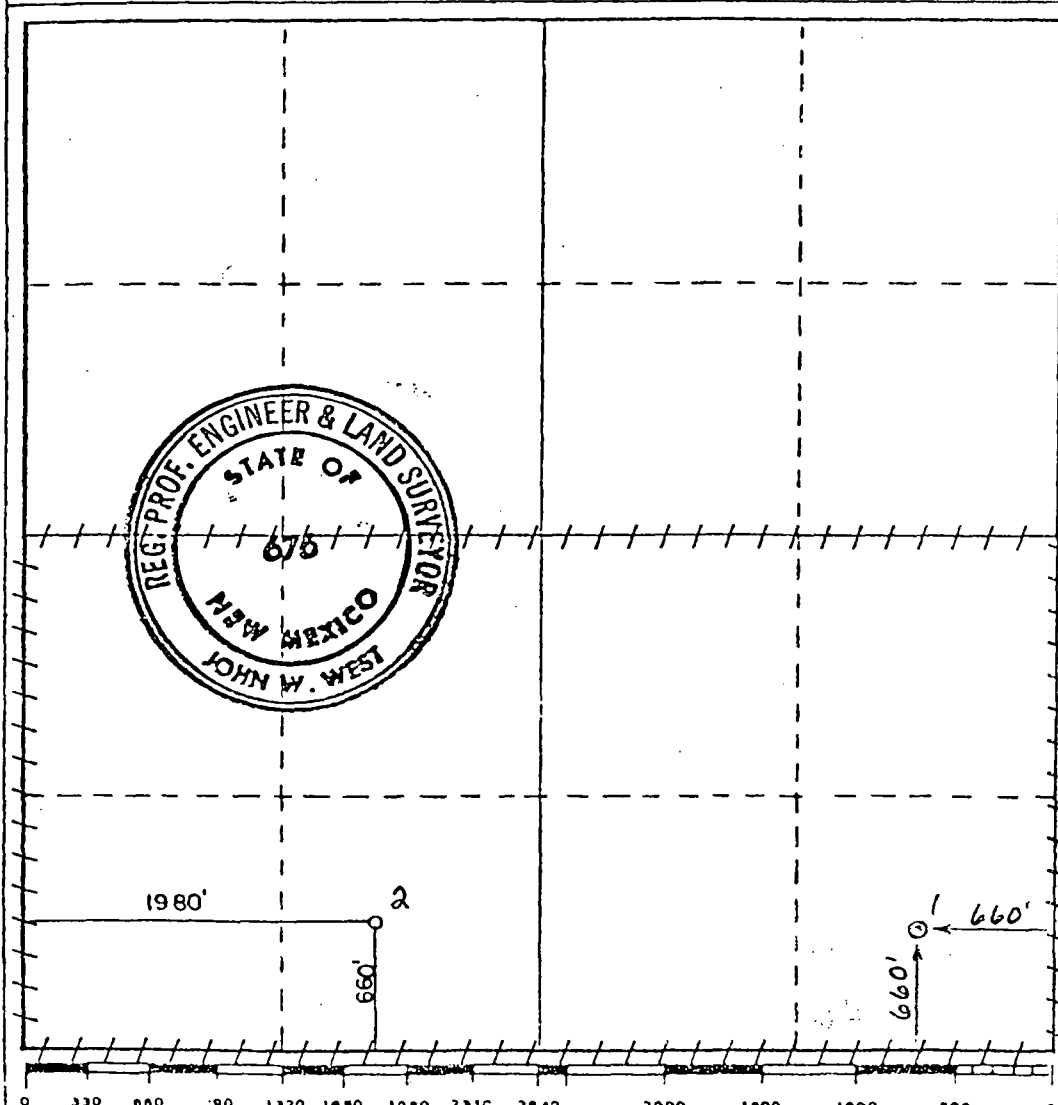

CERTIFICATION

I hereby certify that the information contained herein is true and complete to the best of my knowledge and belief.

Name *John W. West*
Position _____
Dist. Drlgr. Supt. _____
VARCO Oil and Gas Company
Division of Atlantic Richfield Company

Date
9/24/79

I hereby certify that the well location shown on this plat was plotted from field notes of actual surveys made by me or under my supervision, and that the same is true and correct to the best of my knowledge and belief.

Date Surveyed
September 12, 1979
Registered Professional Engineer
and/or Land Surveyor

John W. West
Certificate No. **John W. West** 67



STATE OF NEW MEXICO

ENERGY, MINERALS AND NATURAL RESOURCES DEPARTMENT

OIL CONSERVATION DIVISION
RECEIVED

OIL CONSERVATION DIVISION
HOBBS DISTRICT OFFICE

BRUCE KING
GOVERNOR

'92 OCT 5 PM 10 04

9-30-92

POST OFFICE BOX 1980
HOBBS, NEW MEXICO 88241-1980
(505) 393-6161

OIL CONSERVATION DIVISION
P. O. BOX 2088
SANTA FE, NEW MEXICO 87501

RE: Proposed:

MC _____
DHC _____
NSL X 185 _____
NSP _____
SWD _____
WFX _____
PMX _____

Gentlemen:

I have examined the application for the:

Arco oil & Gas Co. Frederick H. Curry wn
Operator Lease & Well No. Unit S-T/R

and my recommendations are as follows:

OK

Yours very truly,

Jerry Sexton
Jerry Sexton
Supervisor, District 1

/ed

OIL CONSERVATION DIVISION
RECEIVED
'92 OCT 14 PM 8 37

October 12, 1992

Unorthodox Well Location &
Simultaneous Dedication

Jalmat Gas Pool
Lea County, New Mexico

New Mexico Oil Conservation Division
P. O. Box 2088
Santa Fe, New Mexico 87504-2088

Attention: Mr. William J. LeMay, Director

Chevron U.S.A., as an offset operator, has no objection to ARCO Oil and Gas Company's application for an unorthodox gas well location for their Frederick H. Curry WN No. 6 in the subject pool. That location to be 1,980 feet FSL and 660 feet FWL, Section 1, T-24-S, R-36-E, Lea County, New Mexico. It is our further understanding that the 320 acres currently dedicated to the Frederick H. Curry WN Well Nos. 1 & 2 and comprising the S/2 of Section 1 will now be dedicated to all three wells.

Approved By: F. S. Godbold

Title: Engineering Supervisor, New Mexico Area

Representing: Chevron U.S.A

Date: October 12, 1992

Signed: *SPM [Signature]* FOR FSG

OIL CONSERVATION DIVISION
RECEIVED

'92 OCT 23 AM 9 15

DOYLE HARTMAN

Oil Operator

500 N. MAIN

P.O. BOX 10426

MIDLAND, TEXAS 79702

(915) 684-4011

October 15, 1992

Certified Mail - Return Receipt Requested

Mr. William J. Lemay
State of New Mexico
Energy, Minerals & Natural Resources Department
Oil Conservation Division
P. O. Box 2088
Santa Fe, New Mexico 87504-2088

Re: ARCO Oil and Gas Company
Administrative Application for
Unorthodox Location and Simultaneous
Dedication
Jalmat (Gas) Pool
Frederick H. Curry WN No. 6
1980' FSL and 660' FWL
Section 1, T-24-S, R-36-E
Lea County, New Mexico

Gentlemen:

Reference is made to the attached notification from ARCO Oil and Gas Company dated September 28, 1992 and received by Hartman September 30, 1992, regarding ARCO's application for an unorthodox location and simultaneous dedication of the above-referenced well. The Frederick H. Curry WN No. 6 well, to be recompleted from the Langlie Mattix (7R-Qn-Gbg) to the Jalmat (Gas) pool, is located 1980' FSL and 660' FWL of Section 1, T-24-S, R-36-E and would be simultaneously dedicated along with ARCO's Frederick H. Curry WN Nos. 1 and 2 wells to the existing 320-acre non-standard Jalmat (Gas) proration unit consisting of the S/2 of Section 1, T-24-S, R-36-E, Lea County, New Mexico.

In light of the fact that ARCO's proposed recompletion does not directly offset us and we are not being encroached upon, we do not feel it is appropriate for us to object to ARCO's administrative request for a location consisting of 1980' FSL and 660' FWL of Section 1, T-24-S, R-37-E.

Mr. William J. Lemay
October 15, 1992
Page 2

Thank you for your consideration in this matter, and please let me know if you need anything further.

Very truly yours,

DOYLE HARTMAN

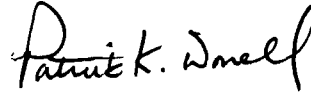
A handwritten signature in black ink that reads "Patrick K. Worrell". The signature is written in a cursive style with a large, stylized "P" and "W".

Patrick K. Worrell
Engineer

PKW/jg
Attachment

cc: Mr. Kevin D. Renfro
ARCO Oil and Gas Company
P. O. Box 1610
Midland, Texas 79702

Mr. James A. Davidson
P. O. Box 494
Midland, Texas 79702

Gallegos Law Firm
Attn: Mr. Gene Gallegos
141 East Palace Avenue
Santa Fe, New Mexico 87501

Mr. Daniel S. Nutter
105 E. Alicante
Santa Fe, New Mexico 87501

ARCO Oil and Gas Company
Western District
Post Office Box 1610
Midland, TX 79702
Telephone (915) 688-5200

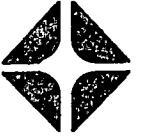

September 28, 1992

Mr. William J. LeMay
New Mexico Oil Conservation Division
P. O. Box 2088
Santa Fe, New Mexico 87501

Mr. J. T. Sexton
New Mexico Oil Conservation Division
P. O. Box 1980
Hobbs, New Mexico 88240

RE: Application for Unorthodox Jalmat Gas Well Location & Simultaneous Dedication
Frederick H. Curry WN#6
S/2 Section 1, T24S, R36E, Lea County, New Mexico
Jalmat (Tansill/Yates/Seven Rivers) Gas Pool

Dear Mr. LeMay / Mr. Sexton:

ARCO Oil and Gas Company respectfully requests administrative approval for an unorthodox Jalmat gas well location for the Frederick H. Curry WN #6 well, located 1980' FSL, 660' FWL, Section 1, T-24S, R-36E in Lea County, New Mexico. The Frederick H. Curry WN #6 is a Langlie Mattix (Seven Rivers/Queen/Grayburg) oil well which ARCO is preparing to recomplete uphole to the Jalmat pool. At the same time, ARCO requests simultaneous dedication of the Jalmat gas production from the Frederick H. Curry WN #1 and #2 wells with the Jalmat gas production from the Frederick H. Curry WN #6 well. The Frederick H. Curry WN #1 and #2 are Jalmat gas wells that are currently dedicated to an existing 320-acre proration unit comprised of the S/2 of Section 1, T-24S, R-36E.

Attached are C-102 forms identifying both the existing and proposed configuration of the subject 320-acre Jalmat gas proration unit. Also attached is a list of offset operators and/or co-owners for this unit, and a land plat map of the surrounding area.

ARCO Oil and Gas Company believes approval of this request will be in the interest of conservation, will protect correlative rights, and will allow for a more complete recovery of Jalmat gas reserves from the subject acreage.

ARCO Oil and Gas Company is notifying the offset operators of this application by sending a copy of this application package, along with waiver to objection forms, by certified mail. If you need further information, please call me at (915) 688-5546.

Sincerely,

Kevin D. Renfro
Operations/Analytical Engineer

KDR:lrh

Attachments



SEP 30 1992

Simultaneous Dedication of Jalmat Gas Production
Frederick H. Curry WN #1 and #2 (existing)
Frederick H. Curry WN #6 (new)
Jalmat Gas Pool
S/2 Section 1, T24S, R36E
Lea County, New Mexico

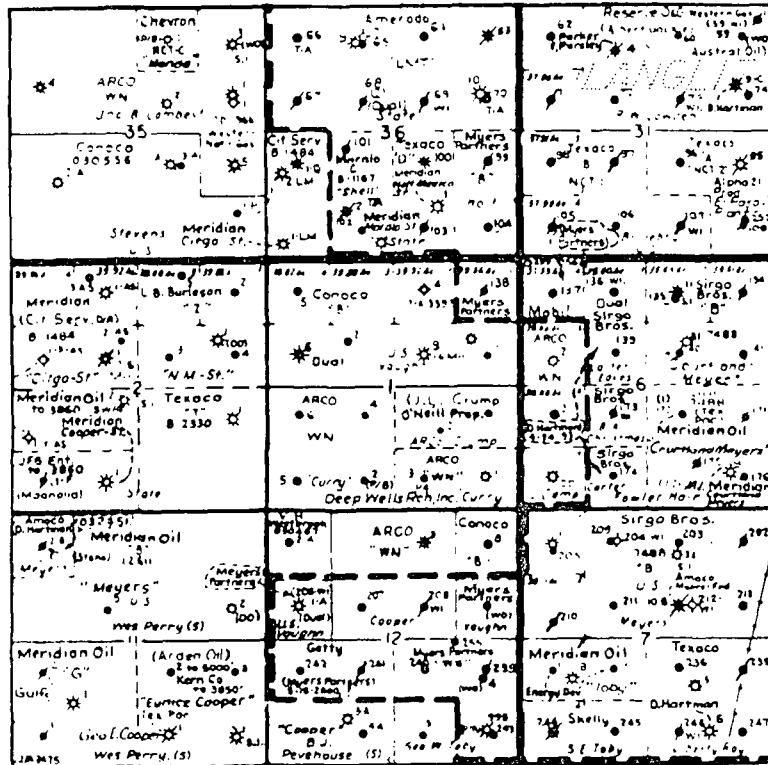

Meridian Oil Inc.
Clayton W. Williams, Jr.
Marathon Oil Company
Chevron USA
Doyle Hartman
Texaco Expl. & Prod.
Conoco, Inc.
Amerada Hess Corp.
Oxy USA Inc.
Amoco Production Co.
Lewis B. Burleson Inc.
Kern Company
V. H. Westbrook

Submit to Appropriate
District Office
State Lease - 4 copies
Fee Lease - 3 copies

State of New Mexico
Energy, Minerals and Natural Resources Department

Form C-102
Revised 1-1-89

OIL CONSERVATION DIVISION

DISTRICT I
P.O. Box 1980, Hobbs, NM 88240

P.O. Box 2088
Santa Fe, New Mexico 87504-2088

DISTRICT II
P.O. Drawer DD, Artesia, NM 88210

DISTRICT III
1000 Rio Brazos Rd., Aztec, NM 87410

WELL LOCATION AND ACREAGE DEDICATION PLAT

All Distances must be from the outer boundaries of the section

Operator Arco Oil and Gas Company			Lease Frederick H. Curry WN		Well No. #6
Unit Letter L	Section 1	Township T-24S	Range R-36E	County Lea	
Actual Footage Location of Well: 1980 feet from the South line and 660 feet from the West line					
Ground level Elev. 3357'	Producing Formation Tansill/Yates/7-Rivers			Pool Jalmat Gas	Dedicated Acreage: 320 Acres

- Outline the acreage dedicated to the subject well by colored pencil or hatchure marks on the plat below.
- If more than one lease is dedicated to the well, outline each and identify the ownership thereof (both as to working interest and royalty).
- If more than one lease of different ownership is dedicated to the well, have the interest of all owners been consolidated by communitization, unitization, force-pooling, etc.?
☐ Yes ☐ No If answer is "yes" type of consolidation _____
If answer is "no" list the owners and tract descriptions which have actually been consolidated. (Use reverse side of this form if necessary.)
No allowable will be assigned to the well until all interests have been consolidated (by communitization, unitization, forced-pooling, or otherwise) or until a non-standard unit, eliminating such interest, has been approved by the Division.

<p>Section 1 T-24S R-36E</p> <p>Well #6: 660' from West line, 1980' from South line.</p> <p>Well #2: 660' from West line, 1980' from South line.</p> <p>Well #1: 660' from West line, 660' from South line.</p>	OPERATOR CERTIFICATION I hereby certify that the information contained herein is true and complete to the best of my knowledge and belief. Signature: <u>Evelyn Gilson</u> Printed Name: <u>E.E. Gilson</u> Position: <u>Engineering Tech.</u> Company: <u>Arco Oil and Gas Co.</u> Date: <u>September 29, 1992</u>
	SURVEYOR CERTIFICATION I hereby certify that the well location shown on this plat was plotted from field notes of actual surveys made by me or under my supervision, and that the same is true and correct to the best of my knowledge and belief. Date Surveyed: _____ Signature & Seal of Professional Surveyor: _____ Certificate No.: _____

0 330 660 990 1320 1650 1980 2310 2640 2000 1500 1000 500 0

NEW MEXICO OIL CONSERVATION COMMISSION
WELL LOCATION AND ACREAGE DEDICATION PLAT

Form C-102
Supersedes C-
Effective 1-1-6

All distances must be from the outer boundaries of the Section

Operator VARCO OIL & GAS COMPANY Division of Atlantic Richfield Co.			Lease Frederick H. Curry WN		Well No. 2
Unit Letter N	Section 1	Township 24 South	Range 36 East	County Lea	
Actual Footage Location of Well: 660 feet from the South line and 1980 feet from the West line					
Ground Level Elev. 3345	Producing Formation yates-7 Rivers		Pool Langlie Mattix Talmat	Permitted Acreage 40 Acre Talmat 320 Acre	

1. Outline the acreage dedicated to the subject well by colored pencil or hachure marks on the plat below.
2. If more than one lease is dedicated to the well, outline each and identify the ownership thereof (both as to working interest and royalty).
3. If more than one lease of different ownership is dedicated to the well, have the interests of all owners been consolidated by communitization, unitization, force-pooling, etc?

☐ Yes ☐ No If answer is "yes," type of consolidation _____

If answer is "no," list the owners and tract descriptions which have actually been consolidated. (Use reverse side of this form if necessary.) _____

No allowable will be assigned to the well until all interests have been consolidated (by communitization, unitization, forced-pooling, or otherwise) or until a non-standard unit, eliminating such interests, has been approved by the Commission.

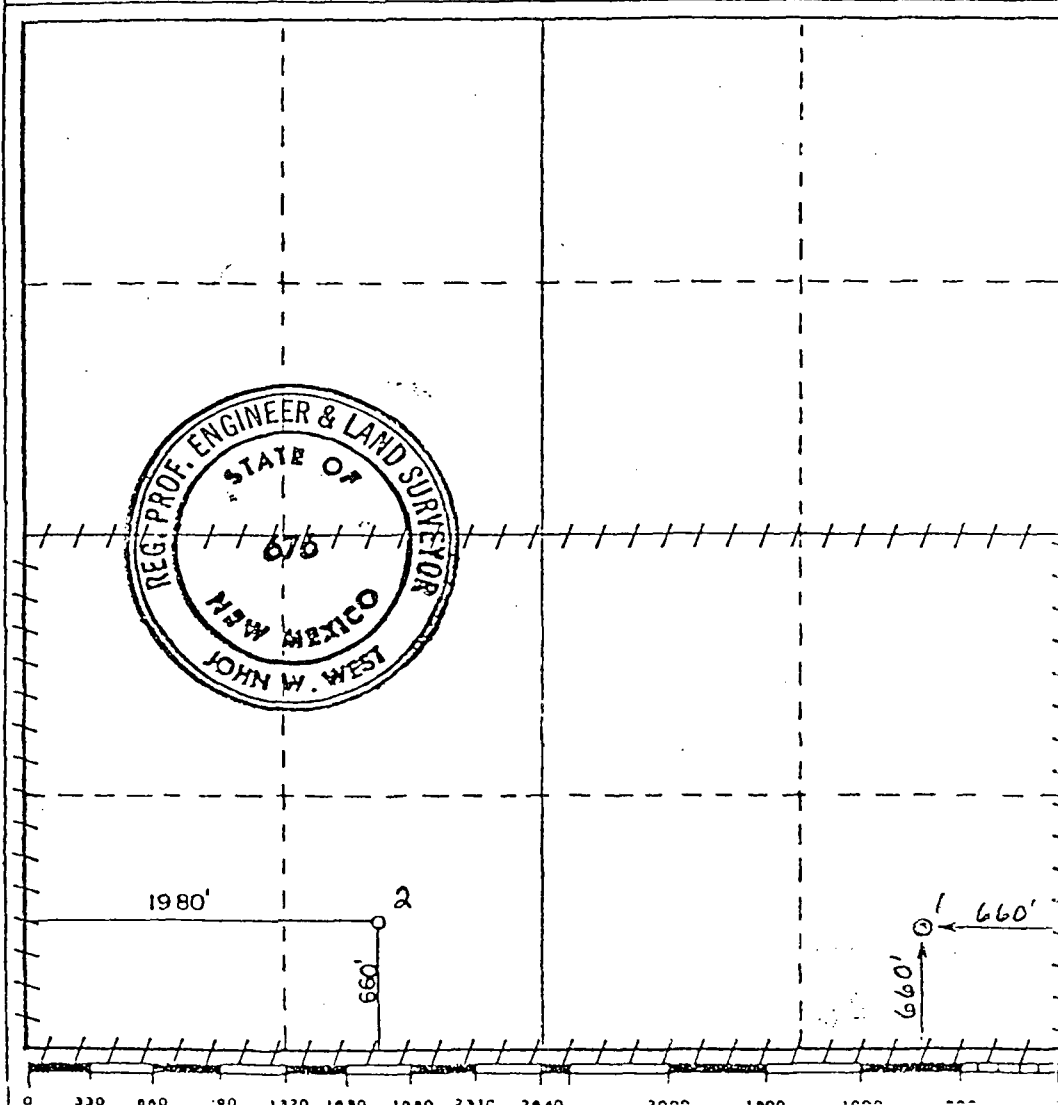

CERTIFICATION

I hereby certify that the information contained herein is true and complete to the best of my knowledge and belief.

Name *John W. West*
Position _____
Dist. Dir. Supt. _____
ARCO Oil and Gas Company
Division of Atlantic Richfield Company

Date
9/24/79

I hereby certify that the well location shown on this plat was plotted from field notes of actual surveys made by me or under my supervision, and that the same is true and correct to the best of my knowledge and belief.

Date Surveyed
September 12, 1979
Registered Professional Engineer and/or Land Surveyor

John W. West
Certificate No. **John W. West** 67