

PNRM 0611748275

C-103 Received 4-24-2006
DHC No. Assigned 4-27-2006

Order Number	API Number	Operator	County	
HOB-0143	30-025-06573	Apache Corporation	Lea	
Order Date	Well Name	Number	Location	
	East Blinebry Drinkard Unit	043	H UL	14 Sec
			215 T (+Dir)	37E R (+Dir)
		Oil %	Gas %	
Pool 1	06660	Blinebry Oil & Gas (Oil)	13%	3%
Pool 2	60240	Tubb Oil & Gas (Oil)	83%	82%
Pool 3	19190	Drinkard	4%	15%
Pool 4				
Comments: Work completed effective _____ Work cancelled effective _____ Supplement _____				

Posted to
RRDM
4-27-2006 (5)

DOWNHOLE COMMINGLE CALCULATIONS:

30-025-06573
HOB-0143

OPERATOR: Apache Corporation

PROPERTY NAME: East Blinebry Drinkard Unit

WNULSTR: 43-H, 14-21-37

06660	SECTION I:		ALLOWABLE AMOUNT	
	POOL NO. 1	<u>Blinebry Oil & Gas (Oil)</u>	<u>107</u>	<u>428</u> MCF 4000
60240	POOL NO. 2	<u>Tubb Oil & Gas (Oil)</u>	<u>142</u>	<u>284</u> MCF 2000
19190	POOL NO. 3	<u>Drinkard</u>	<u>142</u>	<u>852</u> MCF 6000

POOL NO. 4				MCF
		POOL TOTALS	<u>391</u>	<u>1564</u>

SECTION II:				
POOL NO. 1	<u>Blinebry Oil & Gas (Oil)</u>	<u>13%</u>		<u>Gas</u>
POOL NO. 2	<u>Tubb Oil & Gas (Oil)</u>	<u>83%</u>	$83\% \times 391 = 324.53$	<u>3%</u>
POOL NO. 3	<u>Drinkard</u>	<u>4%</u>		<u>82%</u>
POOL NO. 4				<u>15%</u>

	<u>OIL</u>	<u>GAS</u>
SECTION III:		
	$107 \div 83\% = 128.915 (129)$	
SECTION IV:		
	$129 \times 13\% = 16.77 (17)$	
	$129 \times 83\% = 107.07 (107)$	
	$129 \times 4\% = 5.16 (5)$	

UNITED STATES
DEPARTMENT OF THE INTERIOR
BUREAU OF LAND MANAGEMENTFORM APPROVED
OM B No. 1004-0137
Expires: March 31, 2007

SUNDRY NOTICES AND REPORTS ON WELLS

Do not use this form for proposals to drill or to re-enter an
abandoned well. Use Form 3160-3 (APD) for such proposals.

SUBMIT IN TRIPLICATE - Other instructions on reverse side.

1. Type of Well
☒ Oil Well ☐ Gas Well ☐ Other2. Name of Operator
Apache Corporation3a. Address 3b. Phone No. (include area code)
6120 South Yale, Suite 1500 Tulsa OK 74136-4224 (918)491-53624. Location of Well (Footage, Sec., T., R., M., or Survey Description)
1980' FNL & 660' FEL, Sec 14, T 21S, R 37E, Unit H

5. Lease Serial No.

LC 032096B

6. If Indian, Allottee or Tribe Name

7. If Unit or CA/Agreement, Name and/or No.

8. Well Name and No.

EBDU No. 43

9. API Well No.

30-025-06573

10. Field and Pool, or Exploratory Area

Blinebry O&G, Tubb O&G, Drinkard

11. County or Parish, State

Lea County, New Mexico

12. CHECK APPROPRIATE BOX(ES) TO INDICATE NATURE OF NOTICE, REPORT, OR OTHER DATA

TYPE OF SUBMISSION	TYPE OF ACTION			
<input type="checkbox"/> Notice of Intent	<input type="checkbox"/> Acidize	<input type="checkbox"/> Deepen	<input type="checkbox"/> Production (Start/Resume)	<input type="checkbox"/> Water Shut-Off
<input type="checkbox"/> Subsequent Report	<input type="checkbox"/> Alter Casing	<input type="checkbox"/> Fracture Treat	<input type="checkbox"/> Reclamation	<input type="checkbox"/> Well Integrity
<input type="checkbox"/> Final Abandonment Notice	<input type="checkbox"/> Casing Repair	<input type="checkbox"/> New Construction	<input type="checkbox"/> Recomplete	<input checked="" type="checkbox"/> Other Downhole
	<input type="checkbox"/> Change Plans	<input type="checkbox"/> Plug and Abandon	<input type="checkbox"/> Temporarily Abandon	Commingling
	<input type="checkbox"/> Convert to Injection	<input type="checkbox"/> Plug Back	<input type="checkbox"/> Water Disposal	

13. Describe Proposed or Completed Operation (clearly state all pertinent details, including estimated starting date of any proposed work and approximate duration thereof. If the proposal is to deepen directionally or recompleat horizontally, give subsurface locations and measured and true vertical depths of all pertinent markers and zones. Attach the Bond under which the work will be performed or provide the Bond No. on file with BLM/BIA. Required subsequent reports shall be filed within 30 days following completion of the involved operations. If the operation results in a multiple completion or recompleat in a new interval, a Form 3160-4 shall be filed once testing has been completed. Final Abandonment Notices shall be filed only after all requirements, including reclamation, have been completed, and the operator has determined that the site is ready for final inspection.)

Pursuant to OCD Division Order 11363

Pool Names: Blinebry O&G (Oil) 06660, Tubb O&G (Oil) 60240, Drinkard 19190

Perforations:

BLINEBRY 6487-6502, 20-30, 36, 44 & 6563'

TUBB 6270-80 & 6336-46' 2 JSPF

DRINKARD 5742, 64, 5827, 42, 5915, 27, 86 & 6013'

Allocation will be as follows: Test 23 BO x 273 MCF x 3 BW

Blinebry 3 BO 13% 8 MCF 3% 1 BW 33%

Tubb 19 BO 83% 224 MCF 82% 2 BW 67%

Drinkard 1 BO 4% 41 MCF 15% 0 BW 0%

Total 23 BO 100% 273 MCF 100% 3 BW 100%

Downhole commingling will not reduce the value of these pools. All ownership and percentages between the pools are identical.

14. I hereby certify that the foregoing is true and correct
Name (Printed/Typed)

Elaine Linton

Title Engineering Technician

Signature

Date 04/20/2006

THIS SPACE FOR FEDERAL OR STATE OFFICE USE

Approved by

Title

Date

Conditions of approval, if any, are attached. Approval of this notice does not warrant or certify that the applicant holds legal or equitable title to those rights in the subject lease which would entitle the applicant to conduct operations thereon.

Office

Title 18 U.S.C. Section 1001 and Title 43 U.S.C. Section 1212, make it a crime for any person knowingly and willfully to make to any department or agency of the United States any false, fictitious or fraudulent statements or representations as to any matter within its jurisdiction.

(Instructions on page 2)

NEW MEXICO OIL CONSERVATION COMMISSION
WELL LOCATION AND ACREAGE DEDICATION PLAT

Form C-102
Supersedes C-128
Effective 1-4-65

All distances must be from the outer boundaries of the Section

Operator CONOCO INC.			Lease Lockhart B-14 A		Well No. 1
Unit Letter H	Section 14	Township 21S	Range 37E	County Lea	
Actual Footage Location of Well: 1980 feet from the NORTH line and 660 feet from the EAST line					
Ground Level Elev.	Producing Formation Blinebry		Pool Blinebry		Dedicated Acreage: 40 Acres

1. Outline the acreage dedicated to the subject well by colored pencil or hachure marks on the plat below.
2. If more than one lease is dedicated to the well, outline each and identify the ownership thereof (both as to working interest and royalty).
3. If more than one lease of different ownership is dedicated to the well, have the interests of all owners been consolidated by communitization, unitization, force-pooling, etc?

☐ Yes ☐ No If answer is "yes," type of consolidation _____

If answer is "no," list the owners and tract descriptions which have actually been consolidated. (Use reverse side of this form if necessary.) _____

No allowable will be assigned to the well until all interests have been consolidated (by communitization, unitization, forced-pooling, or otherwise) or until a non-standard unit, eliminating such interests, has been approved by the Commission.

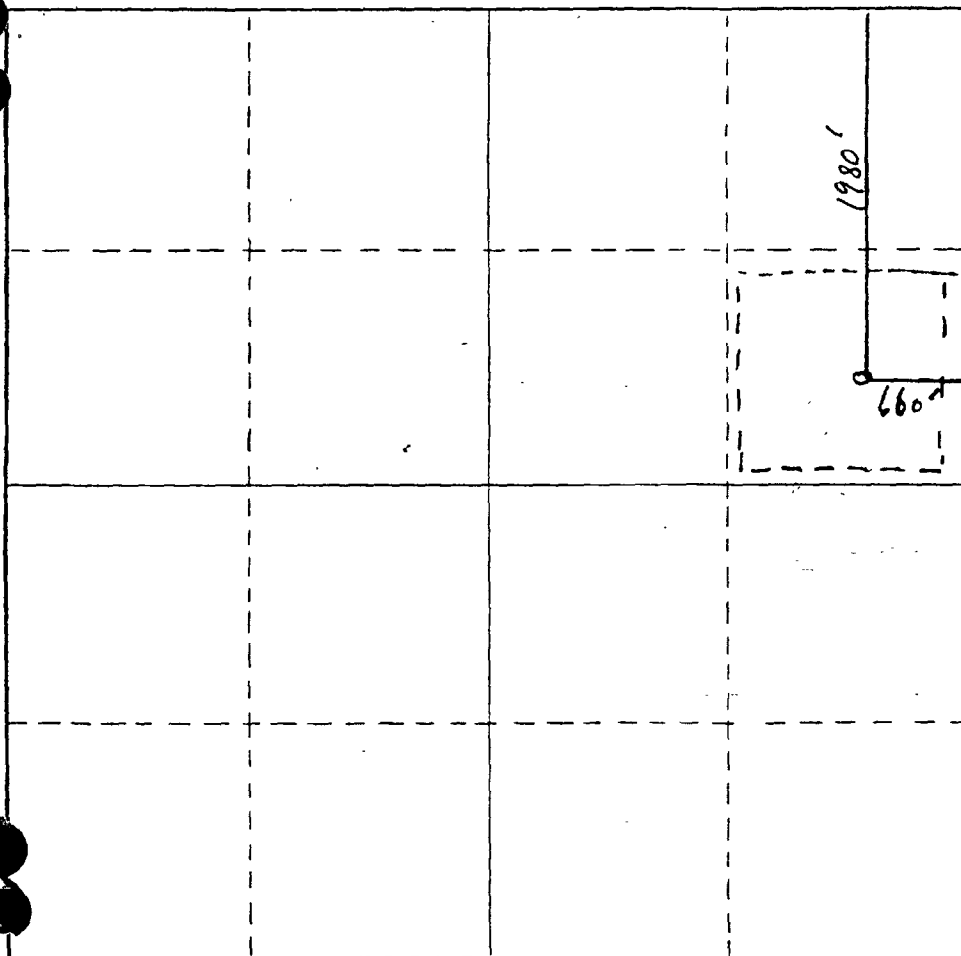

CERTIFICATION

I hereby certify that the information contained herein is true and complete to the best of my knowledge and belief.

Name [Signature]
Position Administrative Supervisor
Company CONOCO INC.
Date July 29, 1985

I hereby certify that the well location shown on this plat was plotted from field notes of actual surveys made by me or under my supervision, and that the same is true and correct to the best of my knowledge and belief.

Date Surveyed _____

Registered Professional Engineer and/or Land Surveyor _____

Certificate No. _____

0 330 660 990 1320 1650 1980 2310 2640 2970 3300 3630 3960 4290 4620 4950 5280 5610 5940 6270 6600

District I

1625 N. French Dr., Hobbs, NM 88240

District II

1625 N. French Dr., Hobbs, NM 88240

District III

1625 N. French Dr., Hobbs, NM 88240

District IV

1220 S. St. Francis Dr., Santa Fe, NM 87505

State of New Mexico

Energy, Minerals & Natural Resources Department

OIL CONSERVATION DIVISION

1220 South St. Francis Dr.

Santa Fe, NM 87505

Form C-102

Revised October 12, 2005

Submit to Appropriate District Office

State Lease - 4 Copies

Fee Lease - 3 Copies

☐ AMENDED REPORT

WELL LOCATION AND ACREAGE DEDICATION PLAT

¹ API Number 30-025-06573	² Pool Code 60240	³ Pool Name Tubb Oil & Gas (Oil)
⁴ Property Code 35023	⁵ Property Name East Blinebry Drinkard Unit	⁶ Well Number 43
⁷ OGRID No. 00873	⁸ Operator Name Apache Corporation	⁹ Elevation 3432' DF

¹⁰ Surface Location

UL or lot no.	Section	Township	Range	Lot Idn	Feet from the	North/South line	Feet from the	East/West line	County
H	14	21S	37E		1980	North	660	East	Lea

¹¹ Bottom Hole Location If Different From Surface

UL or lot no.	Section	Township	Range	Lot Idn	Feet from the	North/South line	Feet from the	East/West line	County

¹² Dedicated Acres 40	¹³ Joint or Infill	¹⁴ Consolidation Code	¹⁵ Order No.
-------------------------------------	-------------------------------	----------------------------------	-------------------------

No allowable will be assigned to this completion until all interests have been consolidated or a non-standard unit has been approved by the division.

	<p>¹⁷ OPERATOR CERTIFICATION I hereby certify that the information contained herein is true and complete to the best of my knowledge and belief, and that this organization either owns a working interest or unleased mineral interest in the land including the proposed bottom hole location or has a right to drill this well at this location pursuant to a contract with an owner of such a mineral or working interest, or to a voluntary pooling agreement or a compulsory pooling order heretofore entered by the division.</p> <p><i>Elaine Linton</i> 04/20/2006 Signature Date</p> <p>Elaine Linton Printed Name</p>

NEW MEXICO OIL CONSERVATION COMMISSION
Well Location and Acreage Dedication Plat

Section A.

Date May 2, 1958

Operator Continental Oil Company Lease Lockhart B-14 "A"
Well No. 1 Unit Letter H Section 14 Township 21S Range 37E NMPM
Located 1980 Feet From north Line, 660 Feet From East Line
County Lea G. L. Elevation 3422 Dedicated Acreage 40 Acres
Name of Producing Formation Drinkard Pool Drinkard

1. Is the Operator the only owner* in the dedicated acreage outlined on the plat below?
Yes X No .
2. If the answer to question one is "no," have the interests of all the owners been consolidated by communitization agreement or otherwise? Yes No . If answer is "yes," Type of Consolidation
3. If the answer to question two is "no," list all the owners and their respective interests below:

Owner

Land Description

Section. B

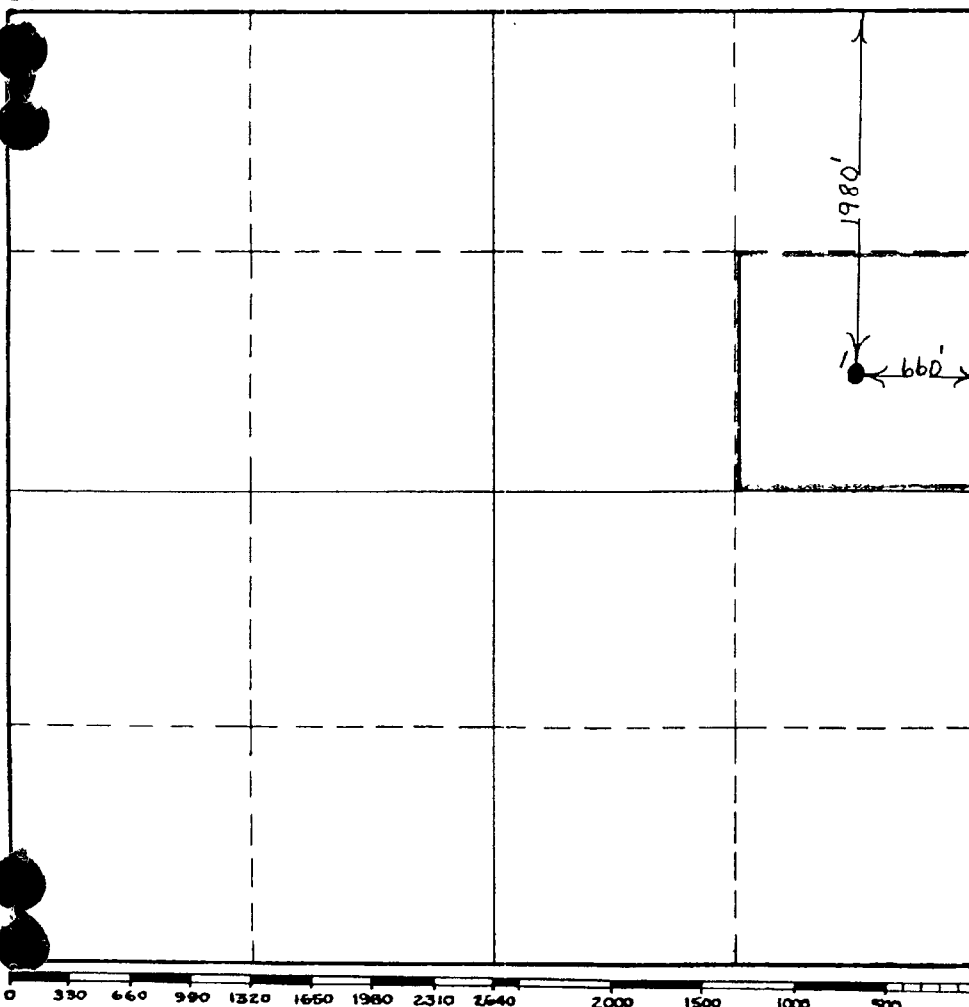

This is to certify that the information in Section A above is true and complete to the best of my knowledge and belief.

Continental Oil Company

(Operator)

[Signature]
(Representative)

Box 68, Eunice, New Mexico
Address

This is to certify that the well location shown on the plat in Section B was plotted from field notes of actual surveys made by me or under my supervision and that the same is true and correct to the best of my knowledge and belief.

Date Surveyed

Registered Professional
Engineer and/or Land Surveyor.

Certificate No.

(See instructions for completing this form on the reverse side)