

PNRM 0621550739

C-103 Received 7-31-2006

DHC No. Assigned 8-2-2006

	Order Number	API Number	Operator	County	
	HOB-0156	30-025-35614	Capataz Operating Inc.	Lea	
	Order Date	Well Name	Number	Location	
		Dukes	001	K UL	11 Sec
				20S T (+Dir)	38E R (+Dir)
			Oil %	Gas %	
Pool 1	33230	House BLinebry	11%	12%	
Pool 2	78760	House Tubb	33%	29%	
Pool 3	33250	House Drinkard	56%	59%	
Pool 4					
<div>Comments: Work completed effective _____ Work cancelled effective _____ Supplement _____</div>					

Posted to
RBDMA
8-3-2006

3

30-025-35614
HOB-0156

DOWNHOLE COMMINGLE CALCULATIONS:

OPERATOR: Capataz Operating Inc.

PROPERTY NAME: Dukes

WNULSTR: 1-K, 11-20-38

33230	SECTION I:		ALLOWABLE AMOUNT	
	POOL NO. 1	<u>House Blinebry</u>	<u>142</u> <u>284</u> MCF	2000
78960	POOL NO. 2	<u>House Tubb</u>	<u>142</u> <u>284</u> MCF	2000
33250	POOL NO. 3	<u>House Drinkard</u>	<u>142</u> <u>284</u> MCF	2000
	POOL NO. 4			

POOL TOTALS 426

852

MCF

SECTION II:
POOL NO. 1 House Blinebry

Oil

Gas

11%

12%

POOL NO. 2 House Tubb

33%

29%

POOL NO. 3 House Drinkard

$56\% \times 426 = 238.56$

59%

POOL NO. 4

OIL

GAS

SECTION III:

$$142 \div 56\% = 253.57 (254)$$

SECTION IV:

$$254 \times 11\% = 27.94 (28)$$

$$254 \times 33\% = 83.82 (84)$$

$$254 \times 56\% = 142.24 (142)$$

Submit 3 Copies to Appropriate District Office
District I
1625 N. French Dr., Hobbs, NM 88240
District II
1301 W. Grand Ave., Artesia, NM 88210
District III
1000 Rio Brazos Rd., Aztec, NM 87410
District IV
S. St. Francis Dr., Santa Fe, NM 87505

State of New Mexico
Energy, Minerals and Natural Resources

Form C-103
May 27, 2004

OIL CONSERVATION DIVISION
1220 South St. Francis Dr.
Santa Fe, NM 87505

WELL API NO.	30-025-35614
5. Indicate Type of Lease STATE <input type="checkbox"/> FEE <input checked="" type="checkbox"/>	
6. State Oil & Gas Lease No.	N/A
7. Lease Name or Unit Agreement Name	Dukes
8. Well Number	1
9. OGRID Number	3659
10. Pool name or Wildcat	House; Blinebry, Tubb, Drinkard

SUNDRY NOTICES AND REPORTS ON WELLS
(DO NOT USE THIS FORM FOR PROPOSALS TO DRILL OR TO DEEPEN OR PLUG BACK TO A DIFFERENT RESERVOIR. USE "APPLICATION FOR PERMIT" (FORM C-101) FOR SUCH PROPOSALS.)

1. Type of Well: Oil Well ☒ Gas Well ☐ Other

2. Name of Operator
Capataz Operating, Inc

3. Address of Operator PO Box 10549
Midland, TX 79702

4. Well Location
Unit Letter K : 1980 feet from the South line and 2105 feet from the West line
Section 11 Township 20S Range 38E NMPM County Lea

11. Elevation (Show whether DR, RKB, RT, GR, etc.)
3579 GR

Pit or Below-grade Tank Application ☐ or Closure ☐

Pit type Depth to Groundwater Distance from nearest fresh water well Distance from nearest surface water

Pit Liner Thickness: mil Below-Grade Tank: Volume bbls; Construction Material

12. Check Appropriate Box to Indicate Nature of Notice, Report or Other Data

NOTICE OF INTENTION TO:

PERFORM REMEDIAL WORK ☐ PLUG AND ABANDON ☐
TEMPORARILY ABANDON ☐ CHANGE PLANS ☐
PULL OR ALTER CASING ☐ MULTIPLE COMPL ☐

SUBSEQUENT REPORT OF:

REMEDIAL WORK ☐ ALTERING CASING ☐
COMMENCE DRILLING OPNS. ☐ P AND A ☐
CASING/CEMENT JOB ☐

OTHER: ☐ OTHER:DHC: Blinebry, Tubb, Drinkard ☒

13. Describe proposed or completed operations. (Clearly state all pertinent details, and give pertinent dates, including estimated date of starting any proposed work). SEE RULE 1103. For Multiple Completions: Attach wellbore diagram of proposed completion or recompletion.

Per R-11363

Pool Names: House; Blinebry (33230), House; Tubb (78760), House; Drinkard (33250)

Perforations:

Blinebry 5922-26, 56-62, 92-96, 6006-12, 18-27, 6050-57, 6121-29' 4 JSPF
Tubb 6740-49, 72, 72.5, 73, 75.5, 76, 80-85' 1 JSPF
Drinkard 6986-91, 7023-26' 1 JSPF

The allocation method will be as follows:

	Oil	%	Water	%	Gas	%
Blinebry	1	11	40	80	2	12
Tubb	3	33	4	8	5	29
Drinkard	5	56	6	12	10	59
	9	100	50	100	17	100

Downhole commingling will not reduce the value of the pools.
Ownership is the same for each of these pools.

DHC Order No. HOB-0156

I hereby certify that the information above is true and complete to the best of my knowledge and belief. I further certify that any pit or below-grade tank has been/will be constructed or closed according to NMOCD guidelines ☐, a general permit ☐ or an (attached) alternative OCD-approved plan ☐.

SIGNATURE TITLE Agent DATE 07/26/2006

or print name H Scott Davis
For State Use Only

E-mail address: Capataz1@sbcglobal.net Telephone No. (432)620-8820

APPROVED BY: PETROLEUM ENGINEER DATE
Conditions of Approval (if any):

AUG 02 2006

DISTRICT I
P. O. Box 1980
Hobbs, NM 88241-1980

State of New Mexico
Er Minerals, and Natural Resources Department

Form C-102
Revised 02-10-94
Instructions on back

DISTRICT II
P. O. Drawer DD
Artesia, NM 88211-0719

OIL CONSERVATION DIVISION
P. O. Box 2088
Santa Fe, New Mexico 87504-2088

Submit to the Appropriate
District Office
State Lease - 4 copies
Fee Lease - 3 copies

DISTRICT III
000 Rio Brazos Rd.
Aztec, NM 87410

☐ AMENDED REPORT

DISTRICT IV
P. O. Box 2088
Santa Fe, NM 87507-2088

WELL LOCATION AND ACREAGE DEDICATION PLAT

1 API Number 30-025-35614		2 Pool Code 33230		3 Pool Name House, Blinebry	
4 Property Code 28291		5 Property Name DUKES			6 Well Number 1
7 OGRID No. 3659		8 Operator Name CAPATAZ OPERATING INCORPORATED			9 Elevation 3579'

10 SURFACE LOCATION

UL or lot no. K	Section 11	Township 20 SOUTH	Range 38 EAST, N.M.P.M.	Lot Ida	Feet from the 1980'	North/South line SOUTH	Feet from the 2105	East/West line WEST	County LEA
--------------------	---------------	----------------------	----------------------------	---------	------------------------	---------------------------	-----------------------	------------------------	---------------

11 BOTTOM HOLE LOCATION IF DIFFERENT FROM SURFACE

UL or lot no.	Section	Township	Range	Lot Ida	Feet from the	North/South line	Feet from the	East/West line	County
---------------	---------	----------	-------	---------	---------------	------------------	---------------	----------------	--------

12 Dedicated Acres	13 Joint or Infill	14 Consolidation Code	15 Order No.
--------------------	--------------------	-----------------------	--------------

NO ALLOWABLE WELL BE ASSIGNED TO THIS COMPLETION UNTIL ALL INTERESTS HAVE BEEN
CONSOLIDATED OR A NON-STANDARD UNIT HAS BEEN APPROVED BY THE DIVISION

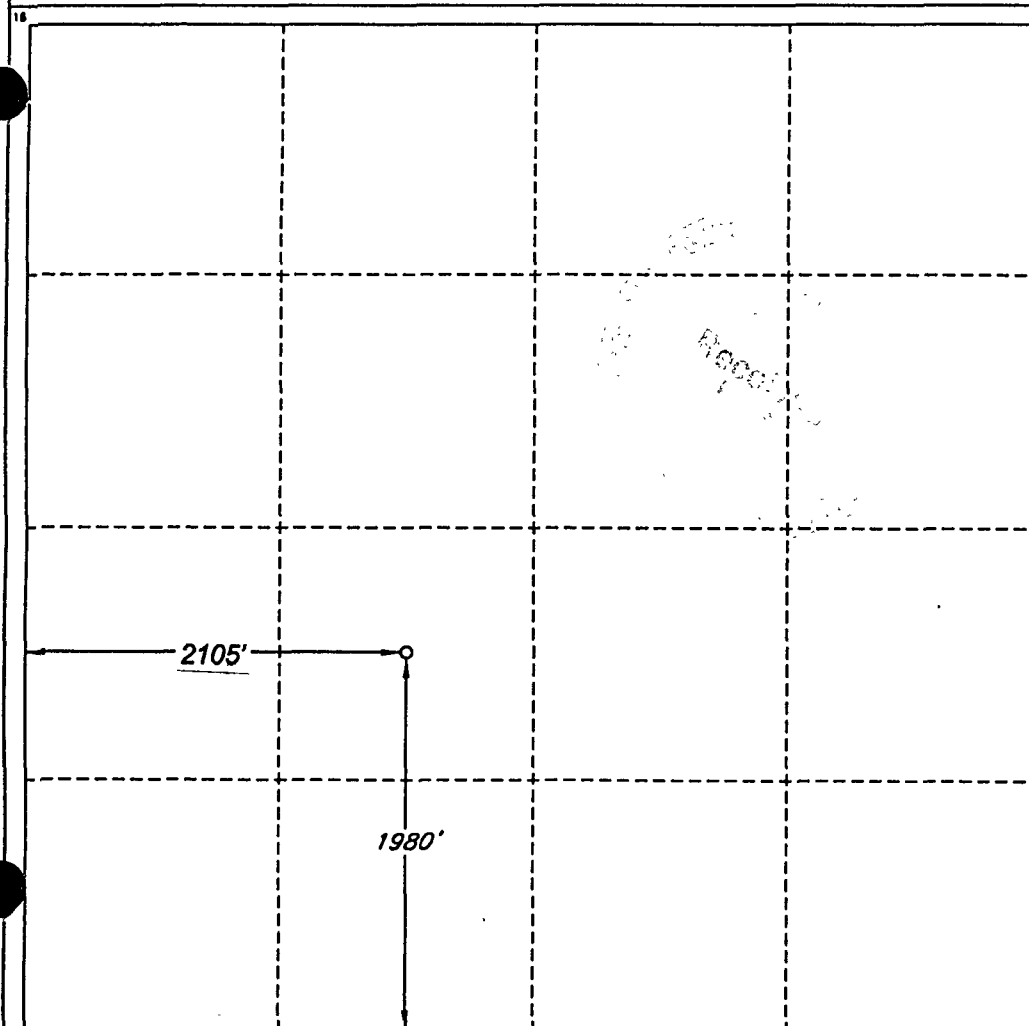

OPERATOR CERTIFICATION

I hereby certify that the information
contained herein is true and complete
to the best of my knowledge and belief.

Signature

Printed Name

H. Scott Davis

Title

Agent

Date

6-26-01

SURVEYOR CERTIFICATION

I hereby certify that the well
location shown on this plat was
plotted from field notes of actual
surveys made by me or under
my supervision, and that the
same is true and correct to the
best of my belief.

Date of Survey

JUNE 21, 2001

Signature and Seal of
Professional Surveyor

V. L. Bezner 6-25-01

Certificate No.

V. L. BEZNER R.P.S. #7920

JOB # 77124 / 70 SE / J.C.P.

DISTRICT I
P. O. Box 1980
Hobbs, NM 88241-1980

Er State of New Mexico
Minerals, and Natural Resources Department

Form C-102
Revised 02-10-94

Instructions on back

DISTRICT II
P. O. Drawer DD
Artesia, NM 88211-0719

OIL CONSERVATION DIVISION

P. O. Box 2088
Santa Fe, New Mexico 87504-2088

Submit to the Appropriate
District Office
State Lease - 4 copies
Fee Lease - 3 copies

DISTRICT III
1000 Rio Brazos Rd.
Aztec, NM 87410

☐ AMENDED REPORT

DISTRICT IV
P. O. Box 2088
Santa Fe, NM 87507-2088

WELL LOCATION AND ACREAGE DEDICATION PLAT

1 API Number 30-025-35614	2 Pool Code 78760	3 Pool Name House; Tubb
4 Property Code 28291	5 Property Name DUKES	6 Well Number 1
7 OGRID No. 3659	8 Operator Name CAPATAZ OPERATING INCORPORATED	9 Elevation 3579'

10 SURFACE LOCATION

UL or lot no. K	Section 11	Township 20 SOUTH	Range 38 EAST, N.M.P.M.	Lot Ida	Feet from the 1980'	North/South line SOUTH	Feet from the 21-05	East/West line WEST	County LEA
--------------------	---------------	----------------------	----------------------------	---------	------------------------	---------------------------	------------------------	------------------------	---------------

"BOTTOM HOLE LOCATION IF DIFFERENT FROM SURFACE

UL or lot no.	Section	Township	Range	Lot Ida	Feet from the	North/South line	Feet from the	East/West line	County
---------------	---------	----------	-------	---------	---------------	------------------	---------------	----------------	--------

12 Dedicated Acres	13 Joint or Infill	14 Consolidation Code	15 Order No.
--------------------	--------------------	-----------------------	--------------

NO ALLOWABLE WELL BE ASSIGNED TO THIS COMPLETION UNTIL ALL INTERESTS HAVE BEEN
CONSOLIDATED OR A NON-STANDARD UNIT HAS BEEN APPROVED BY THE DIVISION

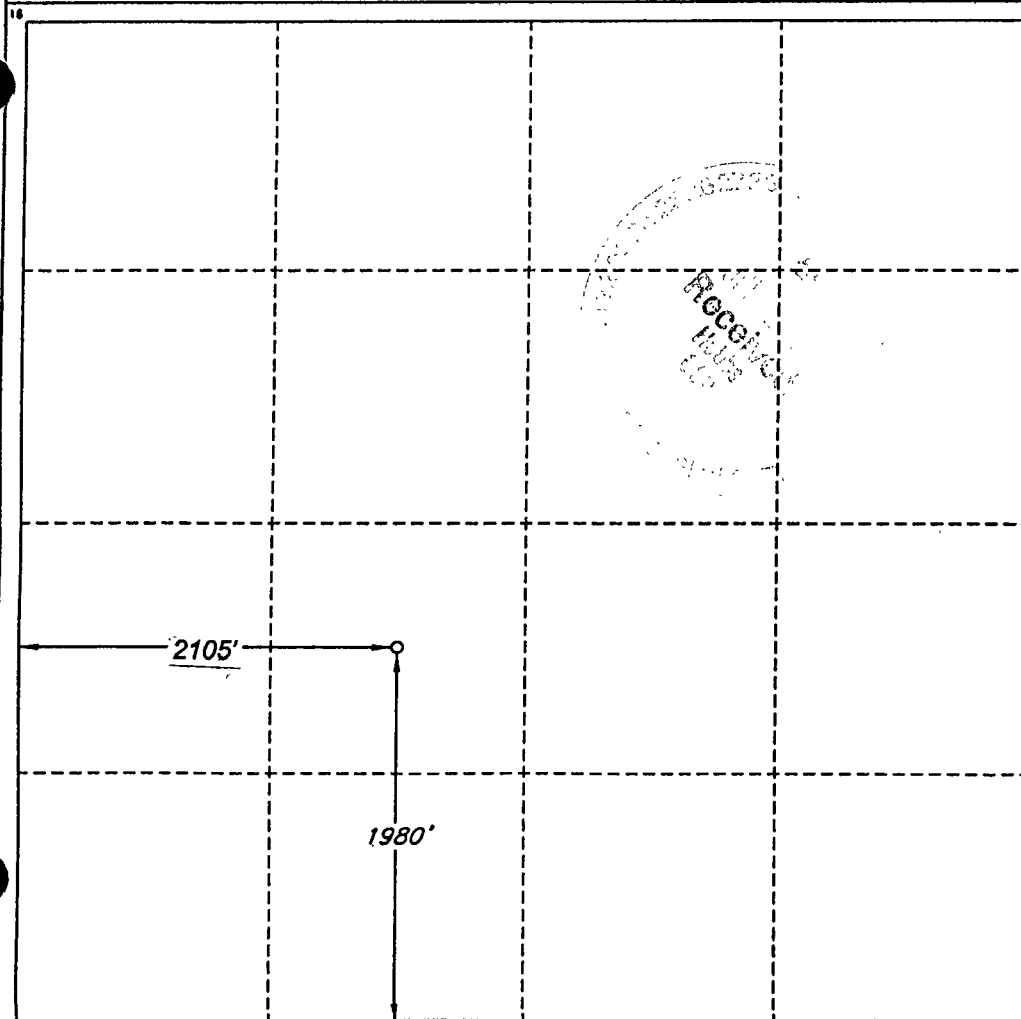

OPERATOR CERTIFICATION

I hereby certify that the information
contained herein is true and complete
to the best of my knowledge and belief.

Signature

Printed Name

H. Scott Davis

Title

Agent

Date

6-26-01

SURVEYOR CERTIFICATION

I hereby certify that the well
location shown on this plat was
plotted from field notes of actual
surveys made by me or under
my supervision, and that the
same is true and correct to the
best of my belief.

Date of Survey

JUNE 21, 2001

Signature and Seal of
Professional Surveyor

Certificate No.

V. L. BEZNER

R.P.S. #7920

JOB # 77124 / 70 SE / J.C.P.

DISTRICT I
P. O. Box 1980
Hobbs, NM 88241-1980

State of New Mexico
Minerals, and Natural Resources Department

Revised 02-10-9
Instructions on back

DISTRICT II
P. O. Drower DD
Artesia, NM 88211-0719

OIL CONSERVATION DIVISION
P. O. Box 2088
Santa Fe, New Mexico 87504-2088

Submit to the Appropriate
District Office
State Lease - 4 copies
Fee Lease - 3 copies

☐ AMENDED REPORT

DISTRICT III
1000 Rio Brazos Rd.
Aztec, NM 87410

DISTRICT IV
P. O. Box 2088
Santa Fe, NM 87507-2088

WELL LOCATION AND ACREAGE DEDICATION PLAT

1 API Number 30-025-35614	2 Pool Code 33250	3 Pool Name House, Drinkard
4 Property Code 28291	5 Property Name DUKES	6 Well Number 1
7 OGRID No. 3659	8 Operator Name CAPATAZ OPERATING INCORPORATED	9 Elevation 3579'

10 SURFACE LOCATION

UL or lot no.	Section	Township	Range	Lot Ida	Feet from the	North/South line	Feet from the	East/West line	County
K	11	20 SOUTH	38 EAST, N.M.P.M.		1980'	SOUTH	2105	WEST	LEA

11 BOTTOM HOLE LOCATION IF DIFFERENT FROM SURFACE

UL or lot no.	Section	Township	Range	Lot Ida	Feet from the	North/South line	Feet from the	East/West line	County

12 Dedicated Acres	13 Joint or Infill	14 Consolidation Code	15 Order No.
--------------------	--------------------	-----------------------	--------------

NO ALLOWABLE WELL BE ASSIGNED TO THIS COMPLETION UNTIL ALL INTERESTS HAVE BEEN CONSOLIDATED OR A NON-STANDARD UNIT HAS BEEN APPROVED BY THE DIVISION

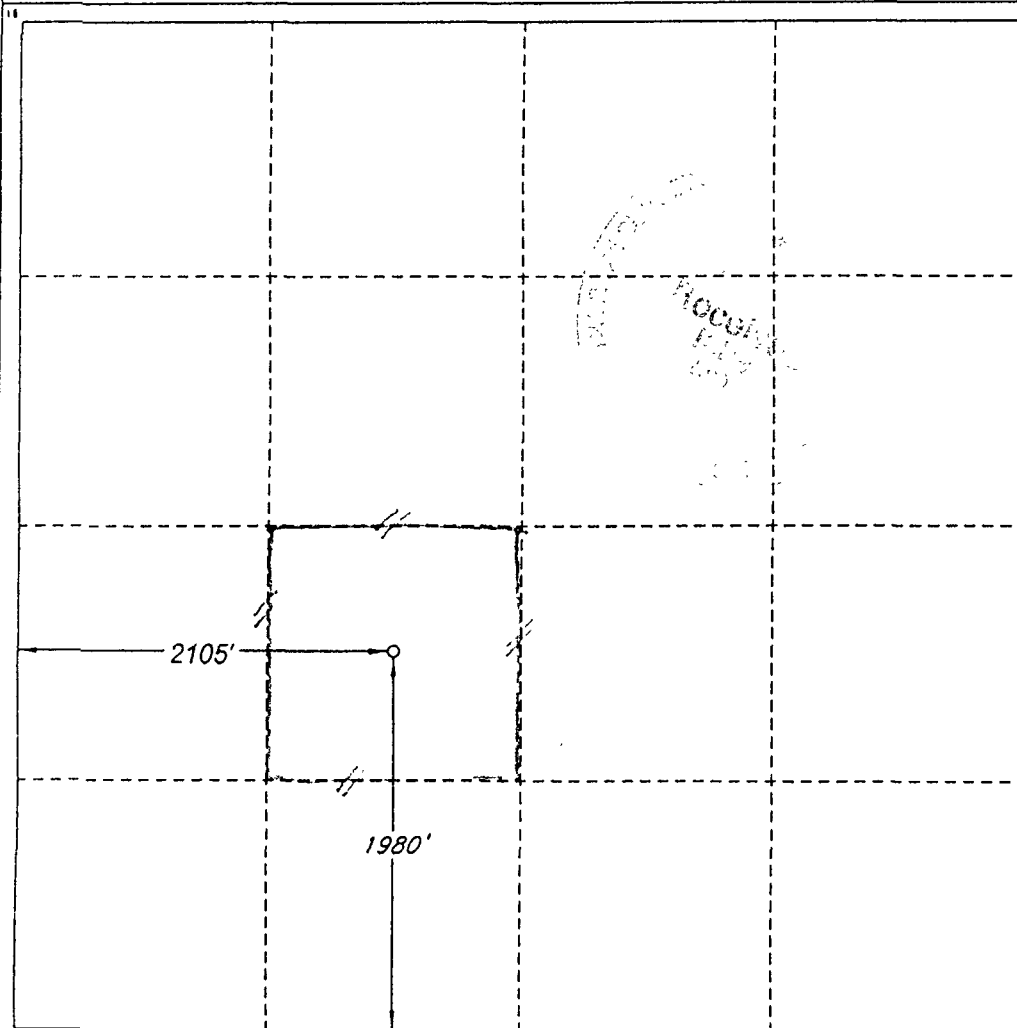

OPERATOR CERTIFICATION

I hereby certify that the information contained herein is true and complete to the best of my knowledge and belief

Signature

Printed Name

H. Scott Davis

Title

Agent

Date

6-26-01

SURVEYOR CERTIFICATION

I hereby certify that the well location shown on this plat was plotted from field notes of actual surveys made by me or under my supervision, and that the same is true and correct to the best of my belief.

Date of Survey

JUNE 21, 2001

Signature and Seal of Professional Surveyor

Certificate No.

V. L. BEZNER R.P.S. #7920

JOB # 77124 / 70 SE / JCP