

PNRM 0705741163

C-103 Received 2-2-2007
DHC No. Assigned 2-26-2007

Order Number		API Number	Operator		County			
HOB-0191		30-025-21878	John H. Hendrix Corp.		Lea			
Order Date		Well Name		Number	Location			
		Elmer C. Hill		002	P	26	215	37E
					UL	Sec	T (+Dir)	R (+Dir)
				Oil %	Gas %			
Pool 1	06660	Blinebry Oil+Gas (Oil)		50%	29%			
Pool 2	60240	Tubb Oil+Gas (Oil)		25%	40%			
Pool 3	19190	Drinkard		25%	31%			
Pool 4								
<div>Comments: Work completed effective _____ Work cancelled effective _____ Supplement _____</div>								

Posted to
RBDM2
2-26-2007

3

30-025-21878
HOB-0191

DOWNHOLE COMMINGLE CALCULATIONS:

OPERATOR: John H. Hendrix Corp,

PROPERTY NAME: Elmer C. Hill

WNULSTR: 2-P, 26-21-37

SECTION I:

POOL NO. 1 Blinebry Oil+Gas (Oil)

ALLOWABLE AMOUNT

107 428 MCF 4000

POOL NO. 2 Tubb Oil+Gas (Oil)

142 284 MCF 2000

POOL NO. 3 Drinkard

142 852 MCF 6000

POOL NO. 4 _____

POOL TOTALS 391

1564 MCF

SECTION II:

POOL NO. 1 Blinebry Oil+Gas (Oil)

(Oil)

50% X 391 = 195.50

(Gas)

29%

POOL NO. 2 Tubb Oil+Gas (Oil)

25%

40%

POOL NO. 3 Drinkard

25%

31%

POOL NO. 4 _____

OIL

GAS

SECTION III:

$107 \div 50\% = 214$

SECTION IV:

$214 \times 50\% = 107$ (107)

$214 \times 25\% = 53.50$ (54)

$214 \times 25\% = 53.50$ (53)

Submit 3 Copies to Appropriate District Office
District I
1625 N French Dr., Hobbs, NM 88240
District II
1301 W Grand Ave., Artesia, NM 88210
District III
1000 Rio Brazos Rd., Aztec, NM 87410
District IV
1000 S. St. Francis Dr., Santa Fe, NM 87505

State of New Mexico
Energy, Minerals and Natural Resources

Form C-103
May 27, 2004

OIL CONSERVATION DIVISION
1220 South St. Francis Dr.
Santa Fe, NM 87505

WELL API NO.	30-025-21878
5. Indicate Type of Lease STATE <input type="checkbox"/> FEE <input checked="" type="checkbox"/>	
6. State Oil & Gas Lease No.	
7. Lease Name or Unit Agreement Name Elmer C. Hill	
8. Well Number	2
9. OGRID Number	012024
10. Pool name or Wildcat Blinebry - Tubb and Drinkard	

SUNDRY NOTICES AND REPORTS ON WELLS (DO NOT USE THIS FORM FOR PROPOSALS TO DRILL OR TO DEEPEN OR PLUG BACK TO A DIFFERENT RESERVOIR. USE "APPLICATION FOR PERMIT" (FORM C-101) FOR SUCH PROPOSALS.)	
1. Type of Well: Oil Well <input checked="" type="checkbox"/> Gas Well <input type="checkbox"/> Other <input type="checkbox"/>	
2. Name of Operator John H. Hendrix Corporation	
3. Address of Operator P. O. Box 3040 Midland, TX 79702-3040	
4. Well Location Unit Letter <u>P</u> : <u>990</u> feet from the <u>South</u> line and <u>990</u> feet from the <u>East</u> line Section <u>26</u> Township <u>21S</u> Range <u>37E</u> NMPM County <u>Lea</u>	
11. Elevation (Show whether DR, RKB, RT, GR, etc.)	
Pit or Below-grade Tank Application <input type="checkbox"/> or Closure <input type="checkbox"/>	
Pit type _____ Depth to Groundwater _____ Distance from nearest fresh water well _____ Distance from nearest surface water _____	
Pit Liner Thickness: _____ mil Below-Grade Tank: Volume _____ bbls; Construction Material _____	

12. Check Appropriate Box to Indicate Nature of Notice, Report or Other Data

NOTICE OF INTENTION TO:

PERFORM REMEDIAL WORK ☐ PLUG AND ABANDON ☐
TEMPORARILY ABANDON ☐ CHANGE PLANS ☐
PULL OR ALTER CASING ☐ MULTIPLE COMPL ☐
OTHER: DHC ☒

SUBSEQUENT REPORT OF:

REMEDIAL WORK ☐ ALTERING CASING ☐
COMMENCE DRILLING OPNS. ☐ P AND A ☐
CASING/CEMENT JOB ☐
OTHER: ☐

13. Describe proposed or completed operations. (Clearly state all pertinent details, and give pertinent dates, including estimated date of starting any proposed work). SEE RULE 1103. For Multiple Completions: Attach wellbore diagram of proposed completion or recompletion.

THIS IS A REQUEST TO DHC BLINEBRY, TUBB AND DRINKARD IN THE SUBJECT WELL. SEE SUPPORTING DATA ON ATTACHED SHEET.

DHC Order No. HOB-0191



I hereby certify that the information above is true and complete to the best of my knowledge and belief. I further certify that any pit or below-grade tank has been/will be constructed or closed according to NMOCD guidelines ☐, a general permit ☐ or an (attached) alternative OCD-approved plan ☐.

SIGNATURE Ronnie H. Westbrook TITLE Vice President DATE 01/31/2007

For print name Ronnie H. Westbrook
For State Use Only

E-mail address: _____ Telephone No. (432)684-6631

APPROVED BY: Chris Williams OC DISTRICT SUPERVISOR/GENERAL MANAGER FEB 28 2007
TITLE _____ DATE _____
Conditions of Approval (if any): _____

ELMER C. HILL NO. 2

Unit P – 990' FSL & 990' FEL
Sec. 26, T21S – R37E , Lea County, NM

1. Division Order that established pre-approved pools. Order No. R-11363.
2. Pools to be commingled – Blinebry Oil & Gas (6660), Drinkard (19190),
Tubb Oil & Gas (60240)
3. Blinebry Perfs. – 5515 – 5832'
Tubb Perfs. – 6005 – 6243'
Drinkard Perfs. – 6393 – 6451'
4. All zones are intermediate crude and commingling will not reduce the value of the production.
5. Ownership between pools is identical.
6. Current production, production prior to TA or anticipated production:

Blinebry	2 BOPD	25 MCFPD
Tubb Oil & Gas	1 BOPD	34 MCFPD
Drinkard	1 BOPD	26 MCFPD
Total	4 BOPD	85 MCFPD

7. The proposed allocation to be as follows:

	<u>Oil %</u>	<u>Gas</u>
Blinebry Oil & Gas	50%	29%
Tubb Oil & Gas	25%	40%
Drinkard	25%	31%
Total	100%	100%

District I
1625 N. French Dr., Hobbs, NM 88240
District II
W. Grand Avenue, Artesia, NM 88210
District III
1000 Rio Brazos Rd., Aztec, NM 87410
District IV
1220 S. St. Francis Dr., Santa Fe, NM 87505

State of New Mexico
Energy, Minerals & Natural Resources Department
OIL CONSERVATION DIVISION
1220 South St. Francis Dr.
Santa Fe, NM 87505

Form C-102
Revised October 12, 2005
Submit to Appropriate District Office
State Lease - 4 Copies
Fee Lease - 3 Copies

☐ AMENDED REPORT

WELL LOCATION AND ACREAGE DEDICATION PLAT

* API Number 30-025-21878		* Pool Code 60240	* Pool Name Blinebry Oil & Gas
* Property Code 005186	* Property Name Elmer C. Hill		* Well Number 2
* OGRID No. 012024	* Operator Name John H. Hendrix Corporation		* Elevation 3379' GL

¹⁰ Surface Location

UL or lot no.	Section	Township	Range	Lot Idn	Feet from the	North/South line	Feet from the	East/West line	County
P	26	21S	37E		990	South	990	East	Lea

¹¹ Bottom Hole Location If Different From Surface

UL or lot no.	Section	Township	Range	Lot Idn	Feet from the	North/South line	Feet from the	East/West line	County
" Dedicated Acres 40	" Joint or Infill	" Consolidation Code		" Order No.					

No allowable will be assigned to this completion until all interests have been consolidated or a non-standard unit has been approved by the division.

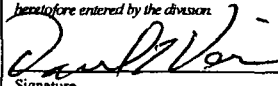
										¹⁷ OPERATOR CERTIFICATION <i>I hereby certify that the information contained herein is true and complete to the best of my knowledge and belief, and that this organization either owns a working interest or unleased mineral interest in the land including the proposed bottom hole location or has a right to drill this well at this location pursuant to a contract with an owner of such a mineral or working interest, or to a voluntary pooling agreement or a compulsory pooling order heretofore entered by the division.</i>  Signature 06/22/2006 Date Daniel L. Veirs Printed Name
										¹⁸ SURVEYOR CERTIFICATION <i>I hereby certify that the well location shown on this plat was plotted from field notes of actual surveys made by me or under my supervision, and that the same is true and correct to the best of my belief.</i> Date of Survey Signature and Seal of Professional Surveyor. Certificate Number

#2 990'

District I
1625 N. French Dr., Hobbs, NM 88240
District II
W. Grand Avenue, Artesia, NM 88210
District III
1000 Rio Brazos Rd., Aztec, NM 87410
District IV
1220 S. St. Francis Dr., Santa Fe, NM 87505

State of New Mexico
Energy, Minerals & Natural Resources Department
OIL CONSERVATION DIVISION
1220 South St. Francis Dr.
Santa Fe, NM 87505

Form C-102
Revised October 12, 2005
Submit to Appropriate District Office
State Lease - 4 Copies
Fee Lease - 3 Copies

☐ AMENDED REPORT

WELL LOCATION AND ACREAGE DEDICATION PLAT

' API Number 30-025-21878	' Pool Code 60240	' Pool Name Tubb Oil & Gas
' Property Code 005186	' Property Name Elmer C. Hill	' Well Number 2
' OGRID No. 012024	' Operator Name John H. Hendrix Corporation	' Elevation 3379' GL

¹⁰ Surface Location

UL or lot no.	Section	Township	Range	Lot Idn	Feet from the	North/South line	Feet from the	East/West line	County
P	26	21S	37E		990	South	990	East	Lea

¹¹ Bottom Hole Location If Different From Surface

UL or lot no.	Section	Township	Range	Lot Idn	Feet from the	North/South line	Feet from the	East/West line	County
" Dedicated Acres 40	" Joint or Infill	" Consolidation Code	" Order No.						

No allowable will be assigned to this completion until all interests have been consolidated or a non-standard unit has been approved by the division.

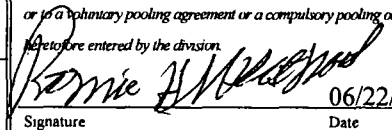
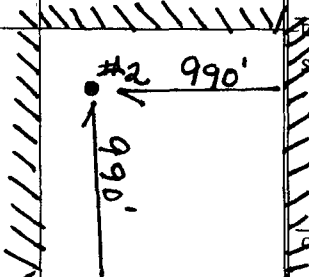
				¹⁷ OPERATOR CERTIFICATION I hereby certify that the information contained herein is true and complete to the best of my knowledge and belief, and that this organization either owns a working interest or unleased mineral interest in the land including the proposed bottom hole location or has a right to drill this well at this location pursuant to a contract with an owner of such a mineral or working interest, or to a voluntary pooling agreement or a compulsory pooling order heretofore entered by the division.  Signature 06/22/2006 Date Ronnie H. Westbrook Printed Name
				¹⁸ SURVEYOR CERTIFICATION I hereby certify that the well location shown on this plat was plotted from field notes of actual surveys made by me or under my supervision, and that the same is true and correct to the best of my belief. Date of Survey Signature and Seal of Professional Surveyor:  Certificate Number

Submit to Appropriate
District Office
State Lease - 4 copies
Fee Lease - 3 copies

State of New Mexico
Energy, Minerals and Natural Resources Department

Form C-102
Revised 1-1-89

OIL CONSERVATION DIVISION

P.O. Box 2088
Santa Fe, New Mexico 87504-2088

DISTRICT I
Box 1980, Hobbs, NM 88240

DISTRICT II
P.O. Drawer DD, Artesia, NM 88210

DISTRICT III
1000 Rio Brazos Rd., Aztec, NM 87410

WELL LOCATION AND ACREAGE DEDICATION PLAT

All Distances must be from the outer boundaries of the section

30-025-21878

Operator John H. Hendrix Corporation			Lease Elmer C. Hill		Well No. 2
Unit Letter P	Section 26	Township 21S	Range 37E	County Lea	
Actual Footage Location of Well: 990' feet from the South line and 990' feet from the East line					
Ground level Elev. 3379'		Producing Formation Drinkard		Pool Drinkard	
				Dedicated Acreage: 40 Acres	

- Outline the acreage dedicated to the subject well by colored pencil or hatchure marks on the plat below.
- If more than one lease is dedicated to the well, outline each and identify the ownership thereof (both as to working interest and royalty).
- If more than one lease of different ownership is dedicated to the well, have the interest of all owners been consolidated by communitization, unitization, force-pooling, etc.?
☐ Yes ☐ No If answer is "yes" type of consolidation _____
If answer is "no" list the owners and tract descriptions which have actually been consolidated. (Use reverse side of this form if necessary). _____
No allowable will be assigned to the well until all interests have been consolidated (by communitization, unitization, forced-pooling, or otherwise) or until a non-standard unit, eliminating such interest, has been approved by the Division.

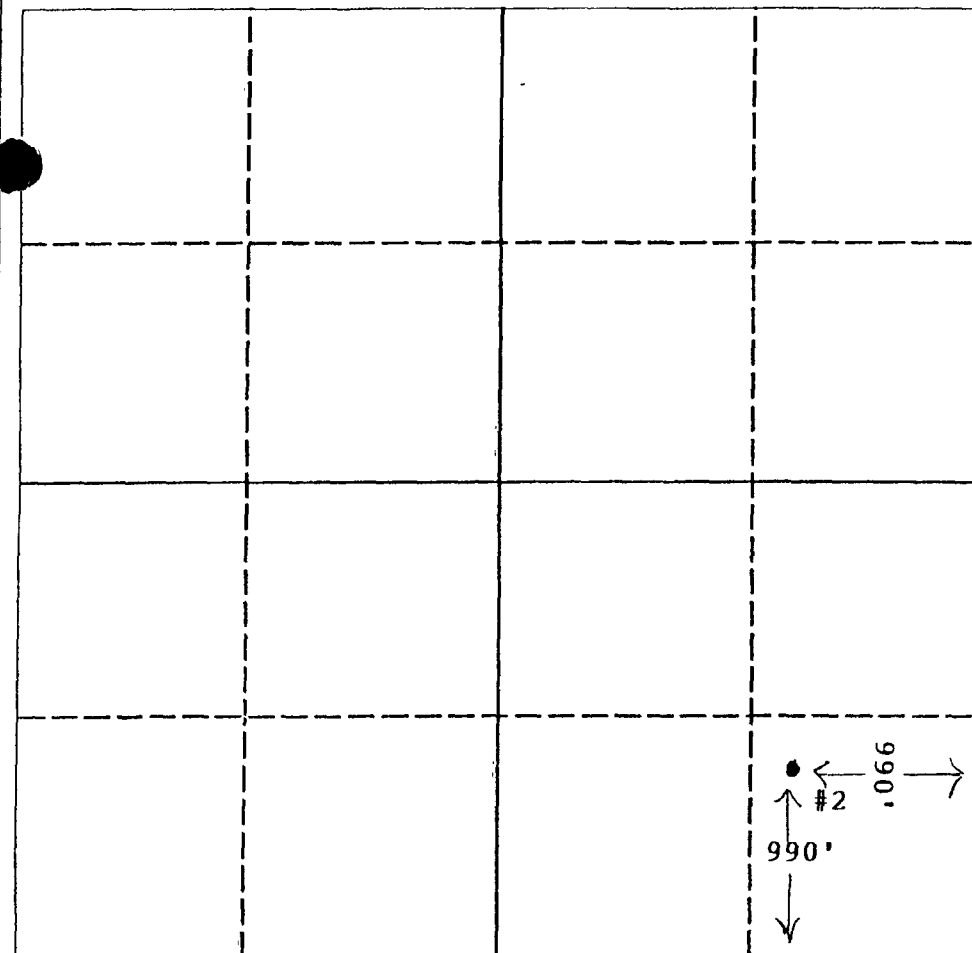

OPERATOR CERTIFICATION

I hereby certify that the information contained herein is true and complete to the best of my knowledge and belief.

Signature
Ronnie H. Westbrook
Printed Name
Ronnie H. Westbrook
Position
Vice-President
Company
John H. Hendrix Corporation
Date
April 2, 1991

SURVEYOR CERTIFICATION

I hereby certify that the well location shown on this plat was plotted from field notes of actual surveys made by me or under my supervision, and that the same is true and correct to the best of my knowledge and belief.

Date Surveyed
Signature & Seal of Professional Surveyor
Certificate No.

330 660 990 1320 1650 1980 2310 2640 2000 1500 1000 500 0