

PNRM 0816440899

C-103 Received 6-10-2008  
DHC No. Assigned 6-12-2008

	Order Number	API Number	Operator	County			
	HOB-247	30-025-12115	Chevron USA Inc.	Lea			
	Order Date	Well Name	Number	Location			
		H. P. Saunders	001	0 UL	7 Sec	225 T (+Dir)	38E R (+Dir)
			Oil %	Gas %			
Pool 1	06660	BLinebry Oil+ Gas (Oil)	39%	31%			
Pool 2	60240	Tubb Oil+ Gas (Oil)	42%	65%			
Pool 3	07900	Brunson Drinkard	19%	4%			
Pool 4							
<div>Comments: Work completed effective _____ Work cancelled effective _____</div>							

Posted to  
RBDMS  
6-12-2008

B

**DOWNHOLE COMMINGLE CALCULATIONS:**

30-025-12115  
HOB-247

OPERATOR: Chevron USA Inc.

PROPERTY NAME: H. P. Saunders

WNULSTR: 1-0, 7-22-38

**SECTION I:**

POOL NO. 1 B Linebry Oil + Gas (Oil) ALLOWABLE AMOUNT 107 428 MCF 4000

POOL NO. 2 Tubb Oil + Gas (Oil) 142 284 MCF 2000

POOL NO. 3 Brunson Drinkard Abo, South 142 852 MCF 6000

POOL NO. 4 \_\_\_\_\_ MCF

POOL TOTALS 391 1564

**SECTION II:**

POOL NO. 1 B Linebry Oil + Gas (Oil) (Oil) (Gas)  
39% 31%

POOL NO. 2 Tubb Oil + Gas (Oil) 42% X 391 = 164.22 65%

POOL NO. 3 Brunson Drinkard Abo, South 19% 4%

POOL NO. 4 \_\_\_\_\_

**OIL**

**GAS**

**SECTION III:**

$107 \div 42\% = 254.761 (255)$  \_\_\_\_\_

**SECTION IV:**

$255 \times 39\% = 99.45 (100)$  \_\_\_\_\_

$255 \times 42\% = 107.10 (107)$  \_\_\_\_\_

$255 \times 19\% = 48.45 (48)$  \_\_\_\_\_

Submit 3 Copies To Appropriate District Office:  
 District I  
 1625 N. French Dr., Hobbs, NM 88240  
 District II  
 1301 W. Grand Ave., Artesia, NM 88210  
 District III  
 1000 Rio Brazos Rd., Aztec, NM 87410  
 District IV  
 1220 S. St. Francis Dr., Santa Fe, NM 87505

State of New Mexico  
 Energy, Minerals and Natural Resources

Form C-103  
 May 27, 2004

OIL CONSERVATION DIVISION  
 1220 South St. Francis Dr.  
 Santa Fe, NM 87505

WELL API NO.

**30-025-12115**

5. Indicate Type of Lease

STATE ☐ FEE ☒

6. State Oil &amp; Gas Lease No.

7. Lease Name or Unit Agreement Name

**H.P. Saunders**

8. Well Number

**1**

9. OGRID Number

**4323**

10. Pool name or Wildcat

**Blinebry/Tubb/Drinkard**

SUNDRY NOTICES AND REPORTS ON WELLS  
 (DO NOT USE THIS FORM FOR PROPOSALS TO DRILL OR TO DEEPEN OR PLUG BACK TO A DIFFERENT RESERVOIR. USE "APPLICATION FOR PERMIT" (FORM C-101) FOR SUCH PROPOSALS.)

1. Type of Well: ☒ Oil Well ☐ Gas Well ☐ Other

2. Name of Operator

**Chevron U.S.A. Inc.**

3. Address of Operator

**15 Smith Road Midland, TX 79705**

4. Well Location

Unit Letter **O** : **330** feet from the **South** line and **2308** feet from the **East** line  
 Section **7** Township **22S** Range **38E** NMPM County **LEA**

11. Elevation (Show whether DR, RKB, RT, GR, etc.)

**3345'**Pit or Below-grade Tank Application ☐ or Closure ☐

Pit type \_\_\_\_\_ Depth to Groundwater \_\_\_\_\_ Distance from nearest fresh water well \_\_\_\_\_ Distance from nearest surface water \_\_\_\_\_

Pit Liner Thickness: \_\_\_\_\_ mil Below-Grade Tank: Volume \_\_\_\_\_ bbls; Construction Material \_\_\_\_\_

## 12. Check Appropriate Box to Indicate Nature of Notice, Report or Other Data

## NOTICE OF INTENTION TO:

PERFORM REMEDIAL WORK ☐ PLUG AND ABANDON ☐TEMPORARILY ABANDON ☐ CHANGE PLANS ☐PULL OR ALTER CASING ☐ MULTIPLE COMPL ☐OTHER: DHC Blinebry/Tubb/Brunson; Drinkard Abo, South ☒

## SUBSEQUENT REPORT OF:

REMEDIAL WORK ☐ ALTERING CASING ☐COMMENCE DRILLING OPNS. ☐ P AND A ☐CASING/CEMENT JOB ☐OTHER: ☐

13. Describe proposed or completed operations. (Clearly state all pertinent details, and give pertinent dates, including estimated date of starting any proposed work). SEE RULE 1103. For Multiple Completions: Attach wellbore diagram of proposed completion or recompletion.

UNDER THE PROVISION OF RULE 303C (5) IT IS PROPOSED TO DOWNHOLE COMMINGLE PRE-APPROVED PCOLS, BLINEBRY OIL & GAS (6660) (5700-5870'), TUBB OIL & GAS (60240) (6295-6460'), & BRUNSON; DRINKARD ABO, SOUTH (7900) (6500-7145') IN THE CAPTIONED WELL. PRODUCTION WILL BE ALLOCATED BACK TO THE THREE POOLS BASED ON THE PERCENTAGES SHOWN IN THE ATTACHED SUPPORT DATA.

DHC Order No. HOB-0247

I hereby certify that the information above is true and complete to the best of my knowledge and belief. I further certify that any pit or below-grade tank has been/will be constructed or closed according to NMOC guidelines ☐, a general permit ☐ or an (attached) alternative OCD-approved plan ☐.

SIGNATURE [Signature] TITLE PETR. ENGINEER DATE 5/16/2008

Type or print name  
 For State Use Only

E-mail address:

Telephone No.

APPROVED BY: [Signature]TITLE PETROLEUM ENGINEERDATE JUN 12 2008

Conditions of Approval (if any):

**Request for exemption to rule 303-A**  
**FOR WELLS LOCATED IN PRE-APPROVED POOLS OR AREAS**

**Operator**

Chevron U.S.A., Inc  
P. O. Box 1150  
Midland, TX 79702

**Lease Name and Well Number**

H.P. Saunders #1  
30-025-12115  
330' FSL & 2308' FEL, Unit Letter O  
Section 7, T22S, R38E  
Lea County, New Mexico

**Division Order**

Pre-approved Pools or Areas established by division order # R-11363

**Pools To Be Commingled In H.P. Saunders #1**

(6660) Blinebry Oil & Gas (OIL)  
(60240) Tubb Oil & Gas (OIL)  
(7900) Brunson Drinkard-Abo (OIL)

**Perforated Intervals**

Blinebry Oil & Gas (5700-5870')  
Tubb Oil & Gas (6295-6460')  
Brunson Drinkard-Abo (6500-7145')

**Location Plat**

Attached

**Well Test Report & Production Plots**

Attached.

**Product Characteristics And Value**

Previous commingling of these zones by Chevron and other operators in the area have shown that the produced fluids are compatible and commingling will not cause formation damage or producing problems. Also, the price received by Chevron for products from these zones is very similar, so value will not be adversely affected.

**Production Allocation**

<u>Pool</u>	<u>BOPD</u>	<u>BWPD</u>	<u>MCFPD</u>	<u>Remarks</u>
Blinebry	20	28	31	Calculated From Allocations %
Tubb	21	30	65	Calculated From Allocations %
Drinkard	10	1	4	Estimated IP, H.P. Saunders #1
<b>Totals</b>	<b>50</b>	<b>60</b>	<b>100</b>	

<u>Allocated %</u>	<u>Oil %</u>	<u>Water %</u>	<u>Gas %</u>	<u>Remarks</u>
Blinebry	39	48	31	Based off offset EUR
Tubb	42	50	65	Based off offset EUR
Drinkard	19	2	4	Based off production test
<b>Totals</b>	<b>100</b>	<b>100</b>	<b>100</b>	

**Ownership**

Ownership of all zones is identical so correlative rights will not be compromised

**State / Federal Land Notification**

This is a FEE lease

DATE IN	SUSPENSE	ENGINEER	LOGGED	TYPE
---------	----------	----------	--------	------

ABOVE THIS LINE FOR DIVISION USE ONLY

**NEW MEXICO OIL CONSERVATION DIVISION**

- Engineering Bureau -

**ADMINISTRATIVE APPLICATION COVERSHEET**

THIS COVERSHEET IS MANDATORY FOR ALL ADMINISTRATIVE APPLICATIONS FOR EXCEPTIONS TO DIVISION RULES AND REGULATIONS

**Application Acronyms:**

[NSP-Non-Standard Proration Unit] [NSL-Non-Standard Location]  
 [DD-Directional Drilling] [SD-Simultaneous Dedication]  
 [DHC-Downhole Commingling] [CTB-Lease Commingling] [PLC-Pool/Lease Commingling]  
 [PC-Pool Commingling] [OLS - Off-Lease Storage] [OLM-Off-Lease Measurement]  
 [WFX-Waterflood Expansion] [PMX-Pressure Maintenance Expansion]  
 [SWD-Salt Water Disposal] [IPI-Injection Pressure Increase]  
 [EOR-Qualified Enhanced Oil Recovery Certification] [PPR-Positive Production Response]

**[1] TYPE OF APPLICATION - Check Those Which Apply for [A]****[A] Location - Spacing Unit - Directional Drilling**
☐ NSL    ☐ NSP    ☐ DD    ☐ SD

Check One Only for [B] and [C]

**[B] Commingling - Storage - Measurement**
☒ DHC    ☐ CTB    ☐ PLC    ☐ PC    ☐ OLS    ☐ OLM
**[C] Injection - Disposal - Pressure Increase - Enhanced Oil Recovery**
☐ WFX    ☐ PMX    ☐ SWD    ☐ IPI    ☐ EOR    ☐ PPR
**[2] NOTIFICATION REQUIRED TO: - Check Those Which Apply, or ☒ Does Not Apply****[A] ☐ Working, Royalty or Overriding Royalty Interest Owners****[B] ☐ Offset Operators, Leaseholders or Surface Owner****[C] ☐ Application is One Which Requires Published Legal Notice****[D] ☐ Notification and/or Concurrent Approval by BLM or SLO**

U.S. Bureau of Land Management - Commissioner of Public Lands, State Land Office

**[E] ☐ For all of the above, Proof of Notification or Publication is Attached, and/or,****[F] ☐ Waivers are Attached****[3] INFORMATION / DATA SUBMITTED IS COMPLETE - Statement of Understanding**

I hereby certify that I, or personnel under my supervision, have read and complied with all applicable Rules and Regulations of the Oil Conservation Division. Further, I assert that the attached application for administrative approval is accurate and complete to the best of my knowledge and where applicable, verify that all interest (WI, RI, ORRI) is common. I understand that any omission of data, information or notification is cause to have the application package returned with no action taken.

Note: Statement must be completed by an individual with supervisory capacity

Lonnie Grohman

Print or Type Name

  
 Signature

Petro. Engineer

Title

5/16/2008

Date

**District I**  
1625 N. French Dr., Hobbs, NM 88240

**District II**  
811 South First, Artesia, NM 88210

**District III**  
1000 Rio Brazos Rd., Aztec, NM 87410

**District IV**  
2040 South Pacheco, Santa Fe, NM 87505

**State of New Mexico**  
**Energy, Minerals & Natural Resources Department**

**Form C-102**  
**Revised March 17, 1999**

# **OIL CONSERVATION DIVISION**

**2040 South Pacheco**  
**Santa Fe, NM 87505**

Submit to Appropriate District Office  
State Lease - 4 Copies  
Fee Lease - 3 Copies

☐ AMENDED REPORT

## **WELL LOCATION AND ACREAGE DEDICATION PLAT**

<sup>1</sup> API Number 30-025-12115	<sup>2</sup> Pool Code 6660	<sup>3</sup> Pool Name Blinberry Oil & Gas
<sup>4</sup> Property Code 2717	<sup>5</sup> Property Name H.P. Saunders	<sup>6</sup> Well Number 1
<sup>7</sup> OGRID No 4323	<sup>8</sup> Operator Name Chevron U.S.A., Inc.	<sup>9</sup> Elevation 3345'

### <sup>10</sup> Surface Location

UL or Lot No.	Section	Township	Range	Lot Idn	Feet from the	North/South line	Feet from the	East/West line	County
O	7	22S	38E		330	South	2308	East	Lea

### <sup>11</sup> Bottom Hole Location If Different From Surface

UL or Lot No.	Section	Township	Range	Lot Idn	Feet from the	North/South line	Feet from the	East/West line	County

<sup>12</sup> Dedicated Acres 40	<sup>13</sup> Joint or Infill	<sup>14</sup> Consolidation Code	<sup>15</sup> Order No.
-------------------------------------	-------------------------------	----------------------------------	-------------------------

**NO ALLOWABLE WILL BE ASSIGNED TO THIS COMPLETION UNTIL ALL INTERESTS HAVE BEEN CONSOLIDATED OR A NON-STANDARD UNIT HAS BEEN APPROVED BY THE DIVISION**

	<b>1</b> <b>OPERATOR CERTIFICATION</b>  <i>I hereby certify that the information contained herein is true and complete to the best of my knowledge and belief.</i>   Signature <b>Lonnie Grohman</b> Printed Name <b>Petr. Engineer</b> Date <b>5/16/2008</b>
	<b>1</b> <b>SURVEYOR CERTIFICATION</b>  <i>I hereby certify that the well location shown on this plat was plotted from field notes of actual surveys made by me or under my supervision, and that the same is true and correct to the best of my belief.</i>  Signature and Seal of Professional Surveyor  Certificate Number

District I  
1625 N. French Dr., Hobbs, NM 88240

District II  
811 South First, Artesia, NM 88210

District III  
1000 Rio Brazos Rd., Aztec, NM 87410

District IV  
2040 South Pacheco, Santa Fe, NM 87505

State of New Mexico  
Energy, Minerals & Natural Resources Department

Form C-102  
Revised March 17, 1999

# OIL CONSERVATION DIVISION

2040 South Pacheco  
Santa Fe, NM 87505

Submit to Appropriate District Office  
State Lease - 4 Copies  
Fee Lease - 3 Copies

☐ AMENDED REPORT

## WELL LOCATION AND ACREAGE DEDICATION PLAT

<sup>1</sup> API Number 30-025-12115	<sup>2</sup> Pool Code 60240	<sup>3</sup> Pool Name Tubb Oil & Gas
<sup>4</sup> Property Code 2717	<sup>5</sup> Property Name H.P. Saunders	<sup>6</sup> Well Number 1
<sup>7</sup> OGRID No. 4323	<sup>8</sup> Operator Name Chevron U.S.A., Inc.	<sup>9</sup> Elevation 3345'

### <sup>10</sup> Surface Location

UL or Lot No.	Section	Township	Range	Lot Idn	Feet from the	North/South line	Feet from the	East/West line	County
O	7	22S	38E		330	South	2308	East	Lea

### <sup>11</sup> Bottom Hole Location If Different From Surface

UL or Lot No	Section	Township	Range	Lot Idn	Feet from the	North/South line	Feet from the	East/West line	County
<sup>12</sup> Dedicated Acres 40	<sup>13</sup> Joint or Infill	<sup>14</sup> Consolidation Code	<sup>15</sup> Order No.						

NO ALLOWABLE WILL BE ASSIGNED TO THIS COMPLETION UNTIL ALL INTERESTS HAVE BEEN CONSOLIDATED OR A NON-STANDARD UNIT HAS BEEN APPROVED BY THE DIVISION

	<sup>1</sup> <b>OPERATOR CERTIFICATION</b>  <i>I hereby certify that the information contained herein is true and complete to the best of my knowledge and belief</i>   Signature <b>Lonnie Grohman</b> Printed Name <b>Petr. Engineer</b> Date <b>5/16/2008</b>
	<sup>1</sup> <b>SURVEYOR CERTIFICATION</b>  <i>I hereby certify that the well location shown on this plat was plotted from field notes of actual surveys made by me or under my supervision, and that the same is true and correct to the best of my belief.</i>  Signature and Seal of Professional Surveyor:   Certificate Number

**District I**  
1625 N. French Dr., Hobbs, NM 88240

**District II**  
811 South First, Artesia, NM 88210

**District III**  
1000 Rio Brazos Rd., Aztec, NM 87410

**District IV**  
2040 South Pacheco, Santa Fe, NM 87505

**State of New Mexico**  
**Energy, Minerals & Natural Resources Department**

**Form C-102**  
**Revised March 17, 1999**

# **OIL CONSERVATION DIVISION**

**2040 South Pacheco**  
**Santa Fe, NM 87505**

Submit to Appropriate District Office  
State Lease - 4 Copies  
Fee Lease - 3 Copies

☐ AMENDED REPORT

## **WELL LOCATION AND ACREAGE DEDICATION PLAT**

<sup>1</sup> API Number 30-025-12115		<sup>2</sup> Pool Code 7900		<sup>3</sup> Pool Name Brunson, Drinkard Abo, South	
<sup>4</sup> Property Code 2717		<sup>5</sup> Property Name H.P. Saunders			<sup>6</sup> Well Number 1
<sup>7</sup> OGRID No. 4323		<sup>8</sup> Operator Name Chevron U.S.A., Inc.			<sup>9</sup> Elevation 3345'

### <sup>10</sup> Surface Location

UL or Lot No.	Section	Township	Range	Lot Idn	Feet from the	North/South line	Feet from the	East/West line	County
O	7	22S	36E		330	South	2308	East	Lea

### <sup>11</sup> Bottom Hole Location If Different From Surface

UL or Lot No.	Section	Township	Range	Lot Idn	Feet from the	North/South line	Feet from the	East/West line	County

<sup>12</sup> Dedicated Acres 40	<sup>13</sup> Joint or Infill	<sup>14</sup> Consolidation Code	<sup>15</sup> Order No.
-------------------------------------	-------------------------------	----------------------------------	-------------------------

**NO ALLOWABLE WILL BE ASSIGNED TO THIS COMPLETION UNTIL ALL INTERESTS HAVE BEEN CONSOLIDATED OR A NON-STANDARD UNIT HAS BEEN APPROVED BY THE DIVISION**

	<b>1</b> <b>OPERATOR CERTIFICATION</b>  <i>I hereby certify that the information contained herein is true and complete to the best of my knowledge and belief</i>   Signature <b>Lonnie Grohman</b> Printed Name <b>Petr. Engineer</b> Date <b>5/16/2008</b>
	<b>1</b> <b>SURVEYOR CERTIFICATION</b>  <i>I hereby certify that the well location shown on this plat was plotted from field notes of actual surveys made by me or under my supervision, and that the same is true and correct to the best of my belief.</i>  Signature and Seal of Professional Surveyor  Certificate Number



# H.P. Saunders # 1

## Location:

S-07 T-22S R-38E, 2300 FSL & 300 FWL  
 Unit Letter: O  
 Field: Brunson South  
 County: Lea  
 State: NM  
 Area: Hobbs

## Well Info:

Spud Date: 9/9/1954  
 API: 30-025-12115  
 Cost Center: UCU862100  
 WBS#: FB3066  
 RefNO: FB3066  
 Lease: Fee

## Current Wellbore Diagram

## Elevations:

DF:  
 KB:  
 GL: 3345'

This wellbore diagram is based on the most recent information regarding wellbore configuration and equipment that could be found in the Midland Office well files and computer databases as of the update date below. Verify what is in the hole with the well file in the Eunice Field Office. Discuss w/ W&O Engineer, WQ Rep, OS, ALS, & FS prior to rigging up on well regarding any hazards or unknown issues pertaining to the well.

Quantity	Component	Length
15	2-3/8" J-55 4 7# tbg	462.62
1	Seat Nipple- Standard	1.1
	<b>Total</b>	<b>463.72</b>

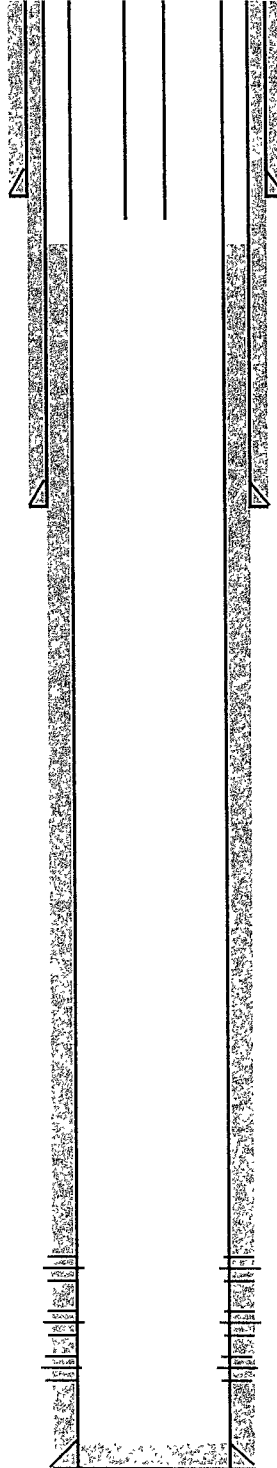

## Surface Casing

Size: 13 3/8" OD, 48#, s-40  
 Set @: 335'  
 With: 400 SKS  
 Hole Size: 17 1/4"  
 Circ: Yes  
 TOC @ Surface

## Intermediate Casing

Size: 8 5/8", 36# & 24#, J-55 LTC  
 Set @: 2899'  
 With: 1650 sks  
 Hole Size: 11"  
 Circ: Yes  
 TOC: Surface

## Perfs:

Drnkard 6500-6780' open  
 Drnkard 6913-7145' open

## Production Casing

Size: 5 1/2", 14, 15 5, & 17# J-55  
 Set @: 7157'  
 With: 1250 sks  
 Hole Size: 7 7/8"  
 TOC: 555'

PBTD: 7155'  
 TD: 7158'  
 Updated: 11-Jan-08  
 By: lgek

# H.P. Saunders # 1

## Location:

S-07 T-22S R-38E, 2300 FSL & 300 FWL  
 Unit Letter: O  
 Field: Brunson South  
 County: Lea  
 State: NM  
 Area: Hobbs

## Well Info:

Spud Date: 9/9/1954  
 API: 30-025-12115  
 Cost Center: UCU862100  
 WBS#: FB3066  
 RefNO: FB3066  
 Lease: Fee

## Proposed Wellbore Diagram

## Elevations:

DF:  
 KB:  
 GL: 3345'

This wellbore diagram is based on the most recent information regarding wellbore configuration and equipment that could be found in the Midland Office well files and computer databases as of the update date below. Verify what is in the hole with the well file in the Eunice Field Office. Discuss w/ WFO Engineer, WFO Rep. OS, ALS, & FS prior to rigging up on well regarding any hazards or unknown issues pertaining to the well.

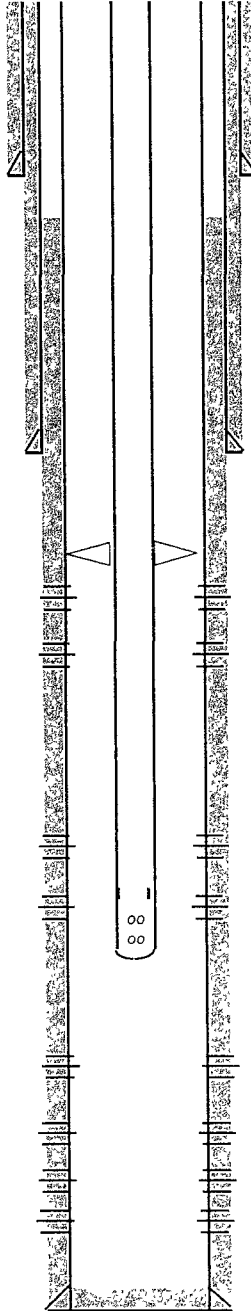

## Surface Casing

Size: 13 3/8" OD, 48#, s-40  
 Set @: 335'  
 With: 400 SKS  
 Hole Size: 17 1/4"  
 Circ: Yes  
 TOC @ Surface

## Intermediate Casing

Size: 8 5/8", 36# & 24#, J-55 LTC  
 Set @: 2899'  
 With: 1650 sks  
 Hole Size: 11"  
 Circ: Yes  
 TOC: Surface

## Perfs:

Blindbry	5700-05'	Proposed
Blindbry	5749-55'	Proposed
Blindbry	5760-68'	Proposed
Blindbry	5774-80'	Proposed
Blindbry	5812-22'	Proposed
Blindbry	5832-40'	Proposed
Blindbry	5850-60'	Proposed
Blindbry	5865-70'	Proposed

## Perfs:

Tubb	6295-6305'	Proposed
Tubb	6315-25'	Proposed
Tubb	6335-40'	Proposed
Tubb	6375-85'	Proposed
Tubb	6400-10'	Proposed
Tubb	6420-30'	Proposed
Tubb	6440-50'	Proposed
Tubb	6455-60'	Proposed

## Perfs.

Dnnkard	6500-02'	open
Dnnkard	6535-37'	open
Dnnkard	6585-87'	open
Dnnkard	6650-52'	open
Dnnkard	6738-40'	open
Dnnkard	6778-80'	Open
Dnnkard	6913-20'	open
Dnnkard	6934-64'	open
Dnnkard	7000-18'	open
Dnnkard	7054-76'	open
Dnnkard	7100-24'	open
Dnnkard	7138-45'	open

## Production Casing

Size: 5 1/2", 14, 15 5, & 17# J-55  
 Set @: 7157'  
 With: 1250 sks  
 Hole Size: 7 7/8"  
 TOC: 555'

PBTD: 7155'  
 TD: 7158'  
 Updated: 11-Jan-08  
 By: lgek

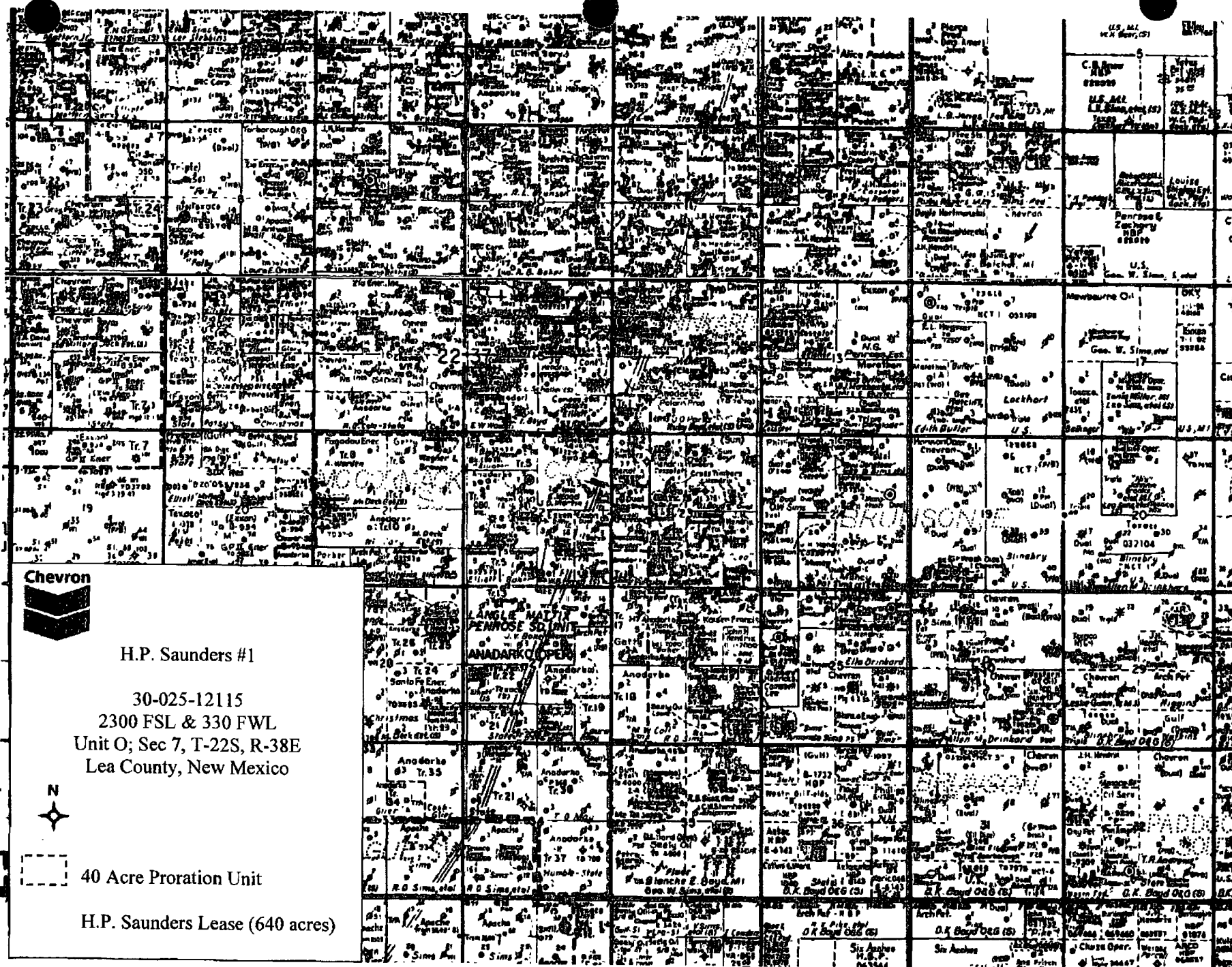

District I  
1625 N French Drive Hobbs NM 88240

District II  
1701 W Grand Avenue Artesia, NM 88210

District III  
1000 Rio Bravo Road Aztec NM 87410

Pools  
District IV  
1220 S St Francis Dr Santa Fe NM 87505

State of New Mexico  
Energy, Minerals and Natural Resources Department

Form C-107A  
Revised June 10, 2003

Oil Conservation Division  
1220 South St. Francis Dr.  
Santa Fe, New Mexico 87505

APPLICATION TYPE  
X Single Well  
\_\_\_ Establish Pre-Approved

EXISTING WELLBORE  
x Yes \_\_\_ No

APPLICATION FOR DOWNHOLE COMMINGLING

Chevron Corporation 15 Smith Road, Midland TX 79705  
Operator Address

H.P. Saunders #1 O-7-22S-38E Lea  
Lease Well No Unit Letter-Section-Township-Range County

OGRID No. \_\_\_ Property Code 2217 API No. 30-025-12115 Lease Type: \_\_\_ Federal \_\_\_ State X Fee

DATA ELEMENT	UPPER ZONE	INTERMEDIATE ZONE	LOWER ZONE
Pool Name	Bluebry Oil & Gas	Tubb Oil & Gas	Brunson Drinkard-Abo
Pool Code	6660	60240	7900
Top and Bottom of Pay Section (Perforated or Open-Hole Interval)	5700-5870' Perforated	6295-6460' Perforated	6500-7145' Perforated
Method of Production (Flowing or Artificial Lift)	Artificial Lift	Artificial Lift	Artificial Lift
Bottomhole Pressure (Note: Pressure data will not be required if the bottom perforation in the lower zone is within 150% of the depth of the top perforation in the upper zone)	n/a	n/a	n/a
Oil Gravity or Gas BTU (Degree API or Gas BTU)	36°	36°	36°
Producing, Shut-In or New Zone	New Zone	New Zone	Producing
Date and Oil/Gas/Water Rates of Last Production. (Note: For new zones with no production history, applicant shall be required to attach production estimates and supporting data.)	Date: Estimated Oil Gas 20 BBL 31 MCF	Date: Estimated Oil Gas 21 bbl 65 MCF	Date: Estimated Oil Gas 10 BBL 4 MCF
Fixed Allocation Percentage (Note: If allocation is based upon something other than current or past production, supporting data or explanation will be required.)	Oil Gas 45% 30%	Oil Gas 49% 63%	Oil Gas 6% 7%

ADDITIONAL DATA

Are all working, royalty and overriding royalty interests identical in all commingled zones? Yes X No \_\_\_  
If not, have all working, royalty and overriding royalty interest owners been notified by certified mail? Yes \_\_\_ No \_\_\_

Are all produced fluids from all commingled zones compatible with each other? Yes X No \_\_\_

Will commingling decrease the value of production? Yes \_\_\_ No X

If this well is on, or communitized with, state or federal lands, has either the Commissioner of Public Lands or the United States Bureau of Land Management been notified in writing of this application? Yes \_\_\_ No \_\_\_

MOCD Reference Case No. applicable to this well: \_\_\_\_\_

Attachments:

- C-102 for each zone to be commingled showing its spacing unit and acreage dedication.
- Production curve for each zone for at least one year. (If not available, attach explanation.)
- For zones with no production history, estimated production rates and supporting data.
- Data to support allocation method or formula.
- Notification list of working, royalty and overriding royalty interests for uncommon interest cases.
- Any additional statements, data or documents required to support commingling.

PRE-APPROVED POOLS

If application is to establish Pre-Approved Pools, the following additional information will be required:

- List of other orders approving downhole commingling within the proposed Pre-Approved Pools
- List of all operators within the proposed Pre-Approved Pools
- Proof that all operators within the proposed Pre-Approved Pools were provided notice of this application.
- Bottomhole pressure data.

I hereby certify that the information above is true and complete to the best of my knowledge and belief.

SIGNATURE Lonnie Grohman TITLE Petroleum Engineer DATE 5/30/2008

TYPE OR PRINT NAME Lonnie Grohman TELEPHONE NO. ( 432 ) 687-7420

E-MAIL ADDRESS lgck@chevron.com