

September 17, 1996

RECEIVED
OIL CONSERVATION DIVISION



Chevron

Administrative Application For
Simultaneous Dedication
Indian Basin
Upper Penn Gas Pool
Bogle Flats Unit Gas Com #10
1650' FSL and 1650' FWL
Section 3, T-22-S, R-23-E
Eddy County, New Mexico

100 SE-24 100 8 52

Chevron U.S.A. Production Company
P.O. Box 1150
Midland, TX 79702

State of New Mexico
Energy, Minerals & Natural Resources Dept.
Oil Conservation Division
2040 South Pacheco
Santa Fe, New Mexico 87505

Attn: Mr. William J. LeMay - Director

Dear Mr. LeMay:

Chevron U.S.A. is planning to drill the Bogle Flats Unit Gas Com #10 in the Upper Penn Gas Pool. The well will be located 1650' FSL and 1650' FWL in Section 3, T-22-S, R-23-E, Eddy County, New Mexico.

The captioned well will be located in a standard location as part of a 677-acre proration unit which comprises Section 3. Currently, only the Bogle Flats Unit Gas Com #1 is dedicated to this proration unit. We respectfully request that the Bogle Flats Unit Gas Com #10 be simultaneously dedicated to this same proration unit with the Bogle Flats Unit Gas Com #1.

A copy of this administrative application is being provided to our offset operators via Certified Mail. Attached is a commercial map, and Form C-102 plats which show the locations of the wells in the proration unit. Copies of the letters to our offset operators are also attached.

If you have any questions concerning this matter, please contact Craig Wright at (915) 687-7284.

Sincerely,

Craig A. Wright
Craig Wright
Petroleum Engineer

Attachments

cc: NMOCD - Hobbs, New Mexico
N. V. Mouser
J. K. Ripley
D. K. Owen
J. E. Baca
Well File

u:\gp_nm\hobbs_mo\in_basin\projects\bogle_10\ocdltr.doc

Bogle Flats Unit Gas Com
Well No. 10

**Administrative Application for
Simultaneous Dedication
Indian Basin
Upper Penn Gas Pool
1650' FSL and 1650' FWL
Section 3, T22S, R23E
Eddy County, New Mexico**

Working Interests In Wells Bogle Flats Unit

Eddy County, New Mexico
Chevron Federal / State Unit # 700265 & JV # 000857

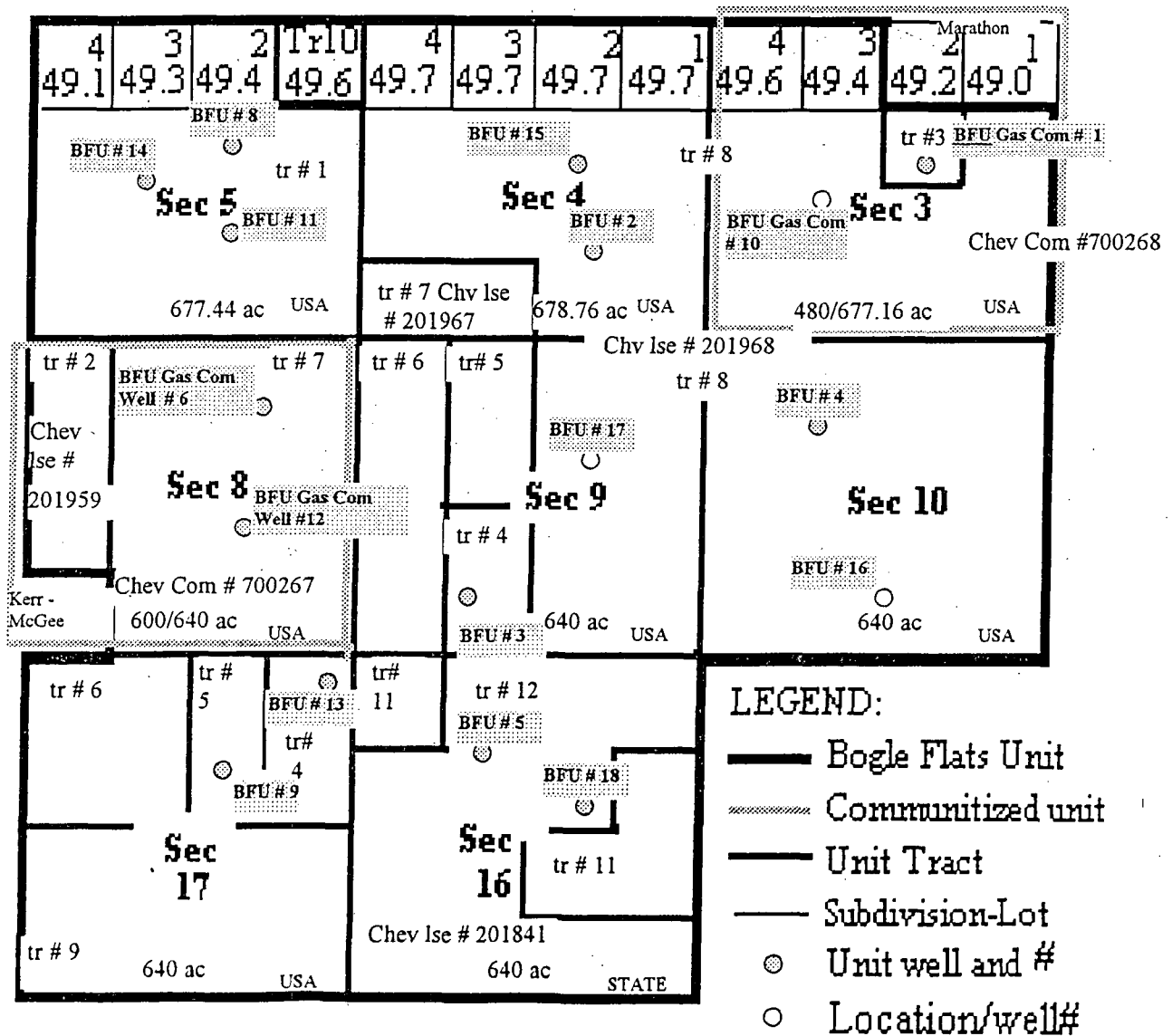

DISTRICT I
P.O. Box 1960, Hobbs, NM 88240

DISTRICT II
P.O. Drawer DD, Artesia, NM 88210

DISTRICT III
1000 Rio Brazos Rd., Aztec, NM 87410

State of New Mexico
Energy, Minerals and Natural Resources Department

Form C-102
Revised February 10, 1994
Instruction on back
Submit to Appropriate District Office
State Lease - 4 Copies
Fee Lease - 3 Copies

OIL CONSERVATION DIVISION

P.O. Box 2088
Santa Fe, New Mexico 87504-2088

☐ AMENDED REPORT

- SIMULTANEOUS DEDICATED
WELL LOCATION AND ACREAGE DEDICATION PLAT

API Number	Pool Code	Pool Name
	79040	INDIAN BASIN-UPPER PENN (PRO GAS)
Property Code	Property Name	Well Number
2587	BOGLE FLATS UNIT GAS COM	10
OGRI No.	Operator Name	Elevation
4323	CHEVRON U.S.A. INC.	4063'

Surface Location

UL or lot No.	Section	Township	Range	Lot Idn	Feet from the	North/South line	Feet from the	East/West line	County
K	3	22S	23E		1650	SOUTH	1650	WEST	EDDY

Bottom Hole Location If Different From Surface

UL or lot No.	Section	Township	Range	Lot Idn	Feet from the	North/South line	Feet from the	East/West line	County

Dedicated Acres	Joint or Infill	Consolidation Code	Order No.
677			

LOT 4	LOT 3	LOT 2	LOT 1
49.58	49.39	49.19	49.00
0 1			
<div><div>4064.1'</div><div>4062.2'</div><div>1650'</div><div>4065.2'</div><div>4058.2'</div><div>1650'</div></div>			
<div><div>OPERATOR CERTIFICATION</div><div>I hereby certify the the information contained herein is true and complete to the best of my knowledge and belief.</div><div><i>J. K. Ripley</i></div><div>Signature</div><div>J. K. RIPLEY</div><div>Printed Name</div><div>T.A.</div><div>Title</div><div>9/12/96</div><div>Date</div></div>			
<div><div>SURVEYOR CERTIFICATION</div><div>I hereby certify that the well location shown on this plat was plotted from field notes of actual surveys made by me or under my supervision, and that the same is true and correct to the best of my belief.</div><div>JANUARY 30, 1995</div><div>Date</div><div>SAW</div><div>Signature</div><div>No. 2-07-95</div><div>W.O. Nam, 11-0121</div><div>W.O. Nam</div><div>RONALD J. EIDSON</div><div>WEST, 676</div><div>J. EIDSON, 3239</div></div>			

16					17 OPERATOR CERTIFICATION I hereby certify that the information contained herein is true and complete to the best of my knowledge and belief. Tanya Kerley Signature Tanya Kerley Printed Name Office Assistant Title 9/23/96 Date
					18 SURVEYOR CERTIFICATION I hereby certify that the well location shown on this plat was plotted from field notes of actual surveys made by me or under my supervision, and that the same is true and correct to the best of my belief. Date of Survey Signature and Seal of Professional Surveyer: Certificate Number

CHEVRON U.S.A. INC.

Bogle Flats Unit Gas Com
Well No. 10

Administrative Application for
Simultaneous Dedication
Indian Basin
Upper Penn Gas Pool
1650' FSL and 1650' FWL
Section 3, T22S, R23E
Eddy County, New Mexico

OFFSET OPERATORS

Oryx
Box 2880
Dallas, Texas 75221-2880

Marathon
Box 552
Midland, Texas 79702

Kerr McGee
Box 25861
Oklahoma City, Oklahoma 73125



Chevron

September 17, 1996

Chevron U.S.A. Production Company
P.O. Box 1150
Midland, TX 79702

Administrative Application For
Simultaneous Dedication
Indian Basin
Upper Penn Gas Pool
Bogle Flats Unit Gas Com #10
1650' FSL and 1650' FWL
Section 3, T-22-S, R-23-E
Eddy County, New Mexico

Oryx
Box 2880
Dallas, Texas 75221-2880

New Mexico Operations Director:

Attached is a copy of an administrative application for NMOCD approval of a simultaneous dedication in the Upper Penn Gas Pool.

Chevron U.S.A. is planning to drill the Bogle Flats Unit Gas Com #10 in the Upper Penn Gas Pool. The well will be located 1650' FSL and 1650' FWL in Section 3, T-22-S, R-23-E, Eddy County, New Mexico. We have requested that the NMOCD approve the simultaneous dedication of this well with the Bogle Flats Unit Gas Com #1, which currently produces on a standard 677-acre proration unit. This proration unit comprises the entirety of Section 3.

If you have any questions concerning this matter, please contact Craig Wright at (915) 687-7284.

Sincerely,

Craig Wright
Petroleum Engineer

Attachments

cc: Well File

u:\gp_nm\hobbs_mo\in_basin\projects\bogle_10\ocdltr.doc



Chevron

September 17, 1996

Chevron U.S.A. Production Company
P.O. Box 1150
Midland, TX 79702

Administrative Application For
Simultaneous Dedication
Indian Basin
Upper Penn Gas Pool
Bogle Flats Unit Gas Com #10
1650' FSL and 1650' FWL
Section 3, T-22-S, R-23-E
Eddy County, New Mexico

Marathon
Box 552
Midland, Texas 79702

New Mexico Operations Director:

Attached is a copy of an administrative application for NMOCD approval of a simultaneous dedication in the Upper Penn Gas Pool.

Chevron U.S.A. is planning to drill the Bogle Flats Unit Gas Com #10 in the Upper Penn Gas Pool. The well will be located 1650' FSL and 1650' FWL in Section 3, T-22-S, R-23-E, Eddy County, New Mexico. We have requested that the NMOCD approve the simultaneous dedication of this well with the Bogle Flats Unit Gas Com #1, which currently produces on a standard 677-acre proration unit. This proration unit comprises the entirety of Section 3.

If you have any questions concerning this matter, please contact Craig Wright at (915) 687-7284.

Sincerely,

Craig Wright
Petroleum Engineer

Attachments

cc: Well File

u:\gp_nm\hobbs_mo\in_basin\projects\bogle_10\ocdltr.doc



Chevron U.S.A. Production Company
P.O. Box 1150
Midland, TX 79702

 UNIVERSITY OF MICHIGAN PRESS

OIL CONSERVATION COMMISSION

P. O. BOX 871

SANTA FE, NEW MEXICO

February 8, 1965

**Standard Oil Company of Texas
P. O. Box 1249
Houston, Texas 77001**

Attention: Mr. C. N. Segnar

Administrative Order NSP-696

Gentlemen:

Reference is made to your application for approval of a 677.16-acre non-standard gas proration unit in the Indian Basin-Upper Pennsylvanian Gas Pool consisting of the following acreage:

EDDY COUNTY, NEW MEXICO

TOWNSHIP 22 SOUTH, RANGE 23 EAST, NMPM

Section 3: All

It is understood that this unit is to be dedicated to your Bogle Flats Unit Well No. 1, located 1953 feet from the North line and 1650 feet from the East line of said Section 3.

By authority granted me under the provisions of Order No. R-2440 governing the Indian Basin-Upper Pennsylvanian Gas Pool, you are hereby authorized to operate the above-described acreage as a non-standard gas proration unit, with allowable to be assigned thereto in accordance with the pool rules, based upon the unit size of 677.16 acres.

Very truly yours,

**A. L. PORTER, Jr.
Secretary-Director**

ALP/JMD/esr

**cc: Oil Conservation Commission - Artesia
Oil & Gas Engineering Committee - Hobbs
Proration Department, OCC - Santa Fe**

CMD :
OG5SECT

ONGARD
INQUIRE LAND BY SECTION

10/16/96 16:13:34
OGOMES -EMD9
PAGE NO: 1

Sec : 03 Twp : 22S Rng : 23E Section Type : NORMAL

4 49.58 Federal owned U	3 49.39 Federal owned U	2 49.19 Federal owned	1 49.00 Federal owned
E 40.00 Federal owned U	F 40.00 Federal owned U	G 40.00 Federal owned U A	H 40.00 Federal owned U

PF01 HELP PF02 PF03 EXIT PF04 GoTo PF05 PF06
PF07 BKWD PF08 FWD PF09 PRINT PF10 SDIV PF11 PF12

89.58
89.39
178.97
89.19
268.16
89
357.16
32
677.16

89.39

89.19

89.00

49.58
49.39

11621

CMD :
OG5SECT

ONGARD
INQUIRE LAND BY SECTION

10/16/96 16:13:49
OGOMES -EMD9
PAGE NO: 2

Sec : 03 Twp : 22S Rng : 23E Section Type : NORMAL

L 40.00 Federal owned U	K 40.00 Federal owned U C	J 40.00 Federal owned U	I 40.00 Federal owned U
M 40.00 Federal owned U	N 40.00 Federal owned U	O 40.00 Federal owned U	P 40.00 Federal owned U

PF01 HELP	PF02	PF03 EXIT	PF04 GoTo	PF05	PF06
PF07 BKWD	PF08 FWD	PF09 PRINT	PF10 SDIV	PF11	PF12

CMD : . ONGARD 10/16/96 16:14:00
OG6CLOG C105-WELL COMPLETION OR RECOMP CASING LOG OGOMES -EMD9

OGRID Identifier : 4323 CHEVRON U S A INC
Prop Identifier : 2585 BOGLE FLATS UNIT
API Well Identifier : 30 15 28480 Well No : 010
Surface Locn - UL : K Sec : 3 Twp : 22S Range : 23E Lot Idn :
Multiple comp (S/M/C): N TVD Depth (Feet) : MVD Depth (Feet):
Spud Date : P/A Date :
Casing/Linear Record:

S Size Grade Weight Depth(ft) Depth(ft) Hole Size Cement ---- TOC ----
(inches) (lb/ft) Top-Liner Bot-Liner (inches) (Sacks) (feet) Code

E6927: Well is cancelled

PF01 HELP PF02 PF03 EXIT PF04 GoTo PF05 PF06 CONFIRM
PF07 PF08 PF09 COMMENT PF10 TLOG PF11 PF12

CMD : ONGARD 10/16/96 16:14:21
OG6C101 C101-APPLICATION FOR PERMIT TO DRILL OGOMES -EMD9

OGRID Idn : 4323 API Well No: 30 15 28480 APD Status(A/C/P): C
Opr Name, Addr: CHEVRON U S A INC Aprvl/Cncl Date : 04-13-1996
PO BOX J SECTION 975R
CONCORD,CA 94524

Prop Idn: 2585 BOGLE FLATS UNIT Well No: 10

	U/L	Sec	Township	Range	Lot	Idn	North/South	East/West
	---	---	-----	-----	-----	-----	-----	-----
Surface Locn : K	3	22S	23E				FTG 1650 F S	FTG 1650 F W
OCD U/L : K		API	County	15				

Work typ(N/E/D/P/A) : N Well typ(O/G/M/I/S/W/C): O Cable/Rotary (C/R) : R
Lease typ(F/S/P/N/J/U/I): F Ground Level Elevation : 4063

State Lease No: Multiple Comp (Y/N) : N
Prpsd Depth : 8100 Prpsd Frmtn : UPPER PENN

E6927: Well is cancelled

PF01 HELP	PF02	PF03 EXIT	PF04 GoTo	PF05	PF06 CONFIRM
PF07	PF08	PF09 PRINT	PF10 C102	PF11 HISTORY	PF12