

SD (SD) 10/2/96

SD-INDBS.3



Chevron

September 10, 1996

Chevron U.S.A. Production Company
P.O. Box 1150
Midland, TX 79702

Administrative Application For
Simultaneous Dedication
Indian Basin
Upper Penn Gas Pool
Bogle Flats #16
1980' FSL and 1815' FWL
Section 10, T-22-S, R-23-E
Eddy County, New Mexico

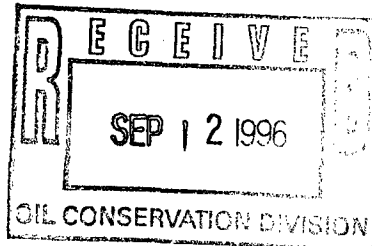

State of New Mexico
Energy, Minerals & Natural Resources Dept.
Oil Conservation Division
2040 South Pacheco
Santa Fe, New Mexico 87505

Attn: Mr. William J. LeMay - Director

Dear Mr. LeMay:

Chevron U.S.A. is planning to drill the Bogle Flats Unit #16 in the Upper Penn Gas Pool. The well will be located 1980' FSL and 1815' FWL in Section 10, T-22-S, R-23-E, Eddy County, New Mexico.

The captioned well will be located in a standard location as part of a 640-acre proration unit which comprises Section 10. Currently, only the Bogle Flats Unit #4 is dedicated to this proration unit. We respectfully request that the Bogle Flats Unit #16 be simultaneously dedicated to this same proration unit with the Bogle Flats Unit #4.

A copy of this administrative application is being provided to our offset operators via Certified Mail. Attached is a commercial map, and Form C-102 plats which show the locations of the wells in the proration unit. Copies of the letters to our offset operators are also attached.

If you have any questions concerning this matter, please contact Craig Wright at (915) 687-7284.

Sincerely,

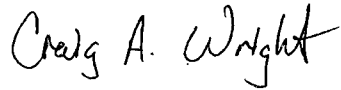
A handwritten signature in black ink that reads "Craig A. Wright". The signature is written in a cursive, flowing style.

C. A. Wright
Petroleum Engineer
Indian Basin, New Mexico

Attachments

cc: NMOCD - Hobbs, New Mexico
N. V. Mouser
J. K. Ripley
D. K. Owen
J. E. Baca
Well File

u:\gp_nm\hobbs_mo\in_basin\projects\bogle_16\ocdltr.doc

CHEVRON U.S.A. INC.
Bogle Flats Unit
Well No. 16

Administrative Application for
 Simultaneous Dedication
 Indian Basin
 Upper Penn Gas Pool
 1980' FSL and 1815' FWL
 Section 10, T22S, R23E
 Eddy County, New Mexico

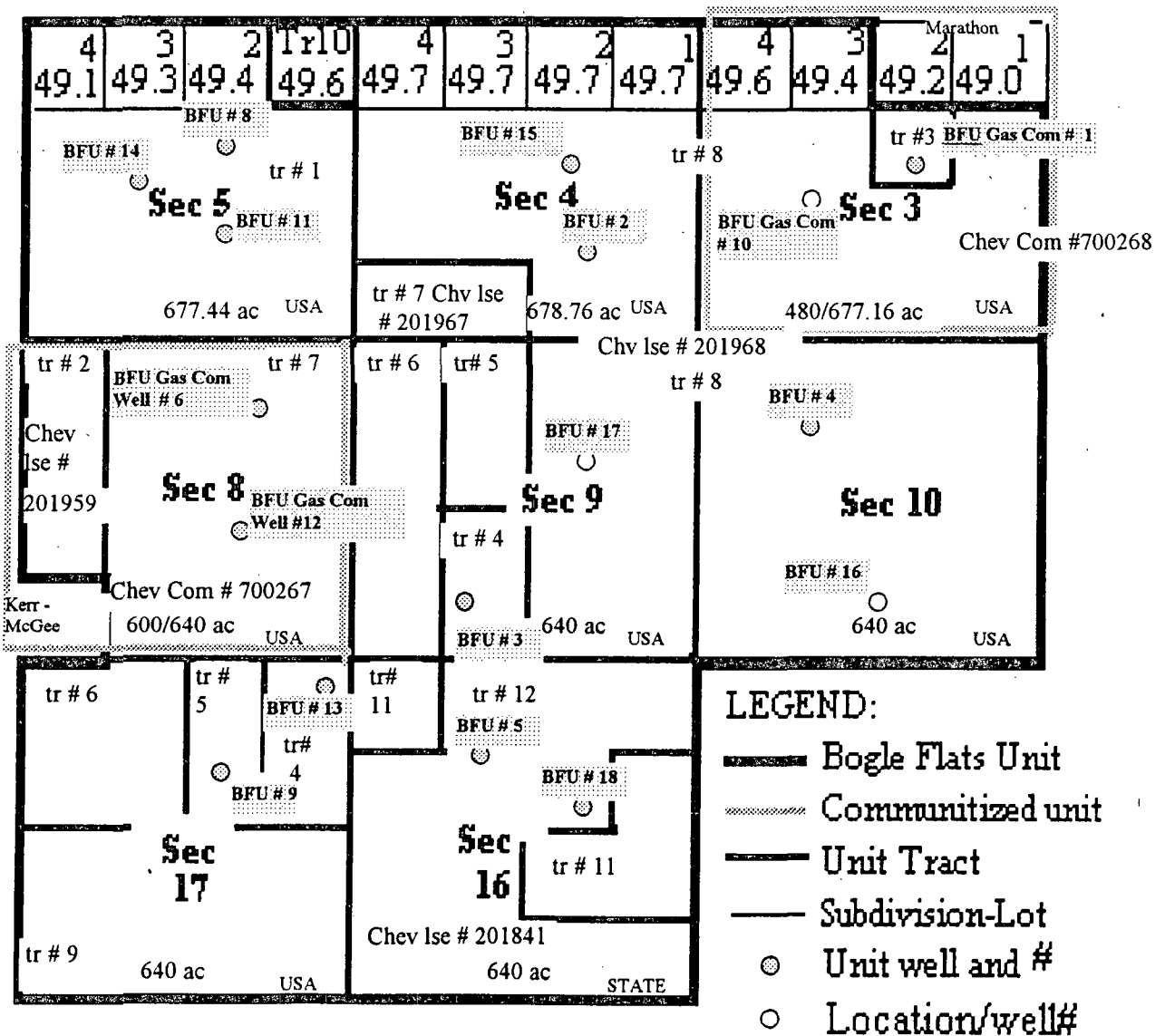

DISTRICT I
P.O. Box 1980, Hobbs, NM 88241-1980

State of New Mexico

Energy, Minerals and Natural Resources Department

Form C-102
Revised February 10, 1994
Submit to Appropriate District Office
State Lease - 4 Copies
Fee Lease - 3 Copies

DISTRICT II
P.O. Drawer DD, Artesia, NM 88211-0719

DISTRICT III
1000 Rio Brazos Rd., Aztec, NM 87410

DISTRICT IV
P.O. BOX 2088, SANTA FE, N.M. 87504-2088

OIL CONSERVATION DIVISION

P.O. Box 2088

Santa Fe, New Mexico 87504-2088

☐ AMENDED REPORT

WELL LOCATION AND ACREAGE DEDICATION PLAT

API Number	Pool Code 79040	Pool Name Indian Basin; Upper Penn (Probas)
Property Code 2585	Property Name BOGLE FLATS UNIT	Well Number 16
OGRID No. 4323	Operator Name CHEVRON U.S.A. INC.	Elevation 4033

Surface Location

UL or lot No. K	Section 10	Township 22 S	Range 23 E	Lot Idn	Feet from the 1980	North/South line SOUTH	Feet from the 1815	East/West line WEST	County EDDY
--------------------	---------------	------------------	---------------	---------	-----------------------	---------------------------	-----------------------	------------------------	----------------

Bottom Hole Location If Different From Surface

UL or lot No.	Section	Township	Range	Lot Idn	Feet from the	North/South line	Feet from the	East/West line	County
					Dedicated Acres	Joint or Infill	Consolidation Code	Order No.	

NO ALLOWABLE WILL BE ASSIGNED TO THIS COMPLETION UNTIL ALL INTERESTS HAVE BEEN CONSOLIDATED
OR A NON-STANDARD UNIT HAS BEEN APPROVED BY THE DIVISION

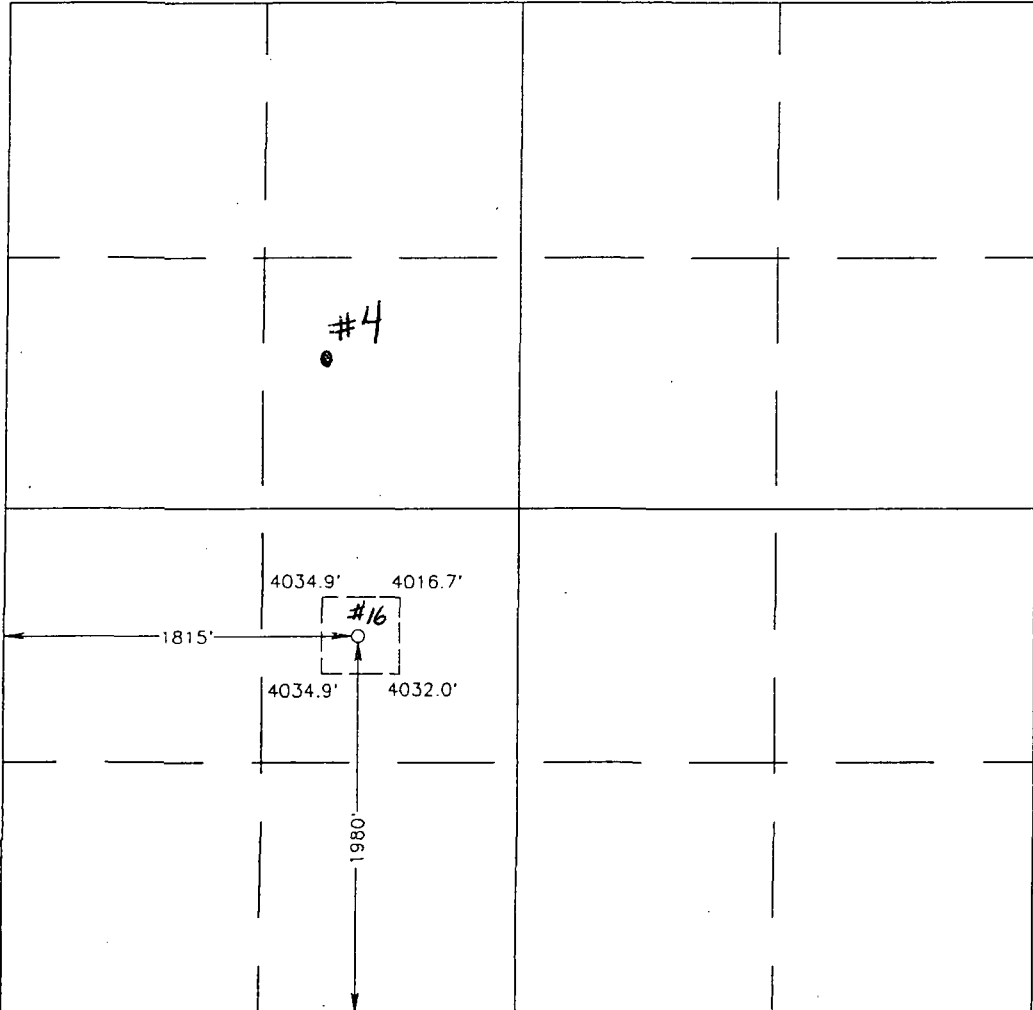
		OPERATOR CERTIFICATION I hereby certify the the information contained herein is true and complete to the best of my knowledge and belief. Signature <u>Tanya Kerley</u> Printed Name <u>Tanya Kerley</u> Title <u>Office Assistant</u> Date <u>9/10/96</u>	
		SURVEYOR CERTIFICATION I hereby certify that the well location shown on this plat was plotted from field notes of actual surveys made by me or under my supervision, and that the same is true and correct to the best of my belief. JANUARY 18, 1996 Date Surveyed Signature <u>[Signature]</u> DMCC Professional Surveyor W.O. Num <u>95-1-1979</u> Certificate No. <u>JOHN R. WEST 676</u> <u>RONALD E. EIDSON 3239</u> <u>EDSON 12641</u>	

District I
PO Box 1988, Hobbs, NM 88241-1988
District II
PO Drawer DD, Artesia, NM 88211-0719
District III
1000 Rio Brazos Rd., Aztec, NM 87410
District IV
PO Box 2088, Santa Fe, NM 87504-2088

State of New Mexico
Energy, Minerals & Natural Resources Department

OIL CONSERVATION DIVISION
PO Box 2088
Santa Fe, NM 87504-2088

Form C-102
Revised February 10, 1994
Instructions on back
Submit to Appropriate District Office
State Lease - 4 Copies
Fee Lease - 3 Copies

☐ AMENDED REPORT

WELL LOCATION AND ACREAGE DEDICATION PLAT

API Number 30-015-10576		Pool Code 79040	Pool Name Indian Basin; Upper Penn (Pro Gas)
Property Code 2585	Property Name Boyle Flats Unit		Well Number 4
OGRID No. 4323	Operator Name Chevron U.S.A. Inc.		Elevation

10 Surface Location

UL or lot no.	Section	Township	Range	Lot Idn	Feet from the	North/South line	Feet from the	East/West line	County
F	10	22S	23E		2100'	North	1650'	West	Eddy

11 Bottom Hole Location If Different From Surface

UL or lot no.	Section	Township	Range	Lot Idn	Feet from the	North/South line	Feet from the	East/West line	County

12 Dedic. Acres	13 Joint or Infill	14 Consolidation Code	15 Order No.

NO ALLOWABLE WILL BE ASSIGNED TO THIS COMPLETION UNTIL ALL INTERESTS HAVE BEEN CONSOLIDATED
OR A NON-STANDARD UNIT HAS BEEN APPROVED BY THE DIVISION

<p>16</p> <p>2100'</p> <p>1650'</p> <p>#4</p> <p>#16</p>	<p>17 OPERATOR CERTIFICATION</p> <p>I hereby certify that the information contained herein is true and complete to the best of my knowledge and belief.</p> <p>Signature Tanya Kerley</p> <p>Printed Name Tanya Kerley</p> <p>Title Office Assistant</p> <p>Date 9/10/96</p>
	<p>18 SURVEYOR CERTIFICATION</p> <p>I hereby certify that the well location shown on this plat was plotted from field notes of actual surveys made by me or under my supervision, and that the same is true and correct to the best of my belief.</p> <p>Date of Survey</p> <p>Signature and Seal of Professional Surveyor:</p>
	<p>Certificate Number</p>

CHEVRON U.S.A. INC.
Bogle Flats Unit
Well No. 16

**Administrative Application for
Simultaneous Dedication
Indian Basin
Upper Penn Gas Pool
1980' FSL and 1815' FWL
Section 10, T22S, R23E
Eddy County, New Mexico**

OFFSET OPERATORS

**Oryx
Box 2880
Dallas, Texas 75221-2880**

**Marathon
Box 552
Midland, Texas 79702**

**Kerr McGee
Box 25861
Oklahoma City, Oklahoma 73125**

September 10, 1996



Chevron

Chevron U.S.A. Production Company
P.O. Box 1150
Midland, TX 79702

Simultaneous Dedication
Indian Basin
Bogle Flats
Upper Penn Gas Pool
Eddy County, New Mexico

Kerr McGee
Box 25861
Oklahoma City, OK 73125

New Mexico Operations Director:

Attached is a copy of an administrative application for NMOCD approval of a simultaneous dedication in the Upper Penn Gas Pool.

Chevron U.S.A. is planning to drill the Bogle Flats Unit #16 in the Upper Penn Gas Pool. The well will be located 1980' FSL and 1815' FWL in Section 10, T22S, R23E, Eddy County, New Mexico. We have requested that the NMOCD approve the simultaneous dedication of this well with the Bogle Flats Unit #4, which currently produces on a standard 640 acre proration unit. This proration unit comprises the entirety of Section 10.

If you have any questions about the application, please contact Craig Wright at (915) 687-7284.

Sincerely,

A handwritten signature in cursive script that reads "Craig A. Wright".

C. A. Wright
Petroleum Engineer
Indian Basin, New Mexico

Attachments

cc: Well File

u:\gp_nm\hobbs_mo\in_basin\projects\bogle_16\ocdltr.doc



Chevron

September 10, 1996

Chevron U.S.A. Production Company
P.O. Box 1150
Midland, TX 79702

Simultaneous Dedication
Indian Basin
Bogle Flats
Upper Penn Gas Pool
Eddy County, New Mexico

Marathon
Box 552
Midland, Texas 79702

New Mexico Operations Director:

Attached is a copy of an administrative application for NMOCD approval of a simultaneous dedication in the Upper Penn Gas Pool.

Chevron U.S.A. is planning to drill the Bogle Flats Unit #16 in the Upper Penn Gas Pool. The well will be located 1980' FSL and 1815' FWL in Section 10, T22S, R23E, Eddy County, New Mexico. We have requested that the NMOCD approve the simultaneous dedication of this well with the Bogle Flats Unit #4, which currently produces on a standard 640 acre proration unit. This proration unit comprises the entirety of Section 10.

If you have any questions about the application, please contact Craig Wright at (915) 687-7284.

Sincerely,

C. A. Wright
Petroleum Engineer
Indian Basin, New Mexico

Attachments

cc: Well File

u:\gp_nm\hobbs_mo\in_basin\projects\bogle_16\ocdltr.doc



Chevron

September 10, 1996

Chevron U.S.A. Production Company
P.O. Box 1150
Midland, TX 79702

**Simultaneous Dedication
Indian Basin
Bogle Flats
Upper Penn Gas Pool
Eddy County, New Mexico**

**Oryx
Box 2880
Dallas, Texas 75221-2880**

New Mexico Operations Director:

Attached is a copy of an administrative application for NMOCD approval of a simultaneous dedication in the Upper Penn Gas Pool.

Chevron U.S.A. is planning to drill the Bogle Flats Unit #16 in the Upper Penn Gas Pool. The well will be located 1980' FSL and 1815' FWL in Section 10, T22S, R23E, Eddy County, New Mexico. We have requested that the NMOCD approve the simultaneous dedication of this well with the Bogle Flats Unit #4, which currently produces on a standard 640 acre proration unit. This proration unit comprises the entirety of Section 10.

If you have any questions about the application, please contact Craig Wright at (915) 687-7284.

Sincerely,

**C. A. Wright
Petroleum Engineer
Indian Basin, New Mexico**

Attachments

cc: Well File

u:\gp_nm\hobbs_mo\in_basin\projects\bogle_16\ocdltr.doc