

District I  
1625 N. French Dr , Hobbs, NM 88240  
District II  
1301 W Grand Avenue, Artesia, NM 88210  
District III  
1000 Rio Brazos Road, Aztec, NM 87410  
District IV  
1220 S St Francis Dr., Santa Fe, NM 87505

State of New Mexico  
Energy Minerals and Natural Resources

Oil Conservation Division  
1220 South St. Francis Dr.  
Santa Fe, NM 87505

RECEIVED

Form C-141  
Revised October 10, 2003

Submit 2 Copies to appropriate  
District Office in accordance  
with Rule 116 on back  
side of form

HOBBSOCD

Release Notification and Corrective Action

OPERATOR

☐ Initial Report ☒ Final Report

Name of Company: Targa Midstream Services L P	Contact: James Lingnau 575.394.2534, Chuck Tolsma 575.631.6026
Address: PO Box 1909 Eunice, NM 88231	Telephone No. (575) 394-2534
Facility Name: Eunice Gas Plant	Facility Type: Natural Gas Processing

Surface Owner: Apache Corp.	Mineral Owner:	Lease No.
-----------------------------	----------------	-----------

LOCATION OF RELEASE

Unit Letter	Section 29	Township 21S	Range 37E	Feet from the	North/South Line	Feet from the	East/West Line	County  Lea
-------------	---------------	-----------------	--------------	---------------	------------------	---------------	----------------	-------------------

Latitude 32.44346N Longitude 103.18439

NATURE OF RELEASE

Type of Release: Natural Gas and liquid from a 4 inch gathering line with 12 psi flowing 100MCFD.	Volume of Release: Approximately 6 Barrels of liquid and 13.15mcf of natural gas by calculation.	Volume Recovered NONE
Source of Release: Natural gas 4 inch gathering line with a .25 inch hole from corrosion.	Date and Hour of Occurrence: 5AM January 19, 2010	Date and Hour of Discovery 1:45 PM January 19,2010
Was Immediate Notice Given? <input checked="" type="checkbox"/> Yes <input type="checkbox"/> No <input type="checkbox"/> Not Required	If YES, To Whom? Larry Johnson OCD in Hobbs by phone and to OCD on call phone	
By Whom? Roger Holland	Date and Hour 2PM January 19,2010	
Was a Watercourse Reached? <input type="checkbox"/> Yes <input checked="" type="checkbox"/> No	If YES, Volume Impacting the Watercourse.	

If a Watercourse was Impacted, Describe Fully.\*

Describe Cause of Problem and Remedial Action Taken. \*

4 inch natural gas gathering line developed .25 inch hole from corrosion. Line was excavated and leak repaired. Contaminated soil will be excavated and disposed of in an OCD approved landfarm.

Describe Area Affected and Cleanup Action Taken.\*

The area affected was excavated and soil contamination disposed of. Area was cleaned and sampled to insure compliance with OCD guidelines.

I hereby certify that the information given above is true and complete to the best of my knowledge and understand that pursuant to NMOCD rules and regulations all operators are required to report and/or file certain release notifications and perform corrective actions for releases which may endanger public health or the environment. The acceptance of a C-141 report by the NMOCD marked as "Final Report" does not relieve the operator of liability should their operations have failed to adequately investigate and remediate contamination that pose a threat to ground water, surface water, human health or the environment. In addition, NMOCD acceptance of a C-141 report does not relieve the operator of responsibility for compliance with any other federal, state, or local laws and/or regulations.

Signature: <i>Don Embrey</i>	OIL CONSERVATION DIVISION	
Printed Name: Don Embrey	Approved by District Supervisor <i>L. Johnson</i>	
Title Training Specialist	ENVIRONMENTAL ENGINEER	
E-mail Address: dembrey@targaresources.com	Approval Date: <u>6-28-2010</u>	Expiration Date: <u>      </u>
Date: June 21, 2010 Phone: (432) 688-0546	Conditions of Approval: <u>      </u>	Attached <input type="checkbox"/> <i>IRP 10-2-2412</i>

\* Attach Additional Sheets If Necessary

*WLS 801795414-7*  
*P WLS 101 795414-7*

District I  
1625 N French Dr, Hobbs, NM 88240  
District II  
1301 W Grand Avenue, Artesia, NM 88210  
District III  
1000 Rio Brazos Road, Aztec, NM 87410  
District IV  
1220 S St Francis Dr, Santa Fe, NM 87505

State of New Mexico  
Energy Minerals and Natural Resources

Oil Conservation Division  
1220 South St. Francis Dr.  
Santa Fe, NM 87505

Form C-141  
Revised October 10, 2003

Submit 2 Copies to appropriate  
District Office in accordance  
with Rule 116 on back  
side of form

Release Notification and Corrective Action

OPERATOR

☐ Initial Report ☒ Final Report

Name of Company: Targa Midstream Services L P	Contact: James Lingnau 575.394.2534, Chuck Tolsma 575.631.6026
Address: PO Box 1909 Eunice, NM 88231	Telephone No. (575) 394-2534
Facility Name: Eunice Gas Plant	Facility Type: Natural Gas Processing

Surface Owner: Apache Corp.	Mineral Owner:	Lease No.
-----------------------------	----------------	-----------

LOCATION OF RELEASE

Unit Letter	Section 29	Township 21S	Range 37E	Feet from the	North/South Line	Feet from the	East/West Line	County Lea
-------------	---------------	-----------------	--------------	---------------	------------------	---------------	----------------	---------------

Latitude 32.44346N Longitude 103.18439

NATURE OF RELEASE

Type of Release Natural Gas and liquid from a 4 inch gathering line with 12 psi flowing 000MCFD.	Volume of Release Approximately 6 Barrels of liquid and 13 15mcf of natural gas by calculation.	Volume Recovered NONE
Source of Release: Natural gas 4 inch gathering line with a .25 inch hole from corrosion.	Date and Hour of Occurrence 5AM January 19, 2010	Date and Hour of Discovery 1.45 PM January 19, 2010
Was Immediate Notice Given? <input checked="" type="checkbox"/> Yes <input type="checkbox"/> No <input type="checkbox"/> Not Required	If YES, To Whom? Larry Johnson OCD in Hobbs by phone and to OCD on call phone	
By Whom? Roger Holland	Date and Hour 2PM January 19, 2010	
Was a Watercourse Reached? <input type="checkbox"/> Yes <input checked="" type="checkbox"/> No	If YES, Volume Impacting the Watercourse.	

If a Watercourse was Impacted, Describe Fully.\*

Describe Cause of Problem and Remedial Action Taken \*

4 inch natural gas gathering line developed 25 inch hole from corrosion Line was excavated and leak repaired Contaminated soil will be excavated and disposed of in an OCD approved landfarm.

Describe Area Affected and Cleanup Action Taken.\*

The area affected was excavated and soil contamination disposed of. Area was cleaned and sampled to insure compliance with OCD guidelines.

I hereby certify that the information given above is true and complete to the best of my knowledge and understand that pursuant to NMOCD rules and regulations all operators are required to report and/or file certain release notifications and perform corrective actions for releases which may endanger public health or the environment. The acceptance of a C-141 report by the NMOCD marked as "Final Report" does not relieve the operator of liability should their operations have failed to adequately investigate and remediate contamination that pose a threat to ground water, surface water, human health or the environment. In addition, NMOCD acceptance of a C-141 report does not relieve the operator of responsibility for compliance with any other federal, state, or local laws and/or regulations

Signature: <i>Don Embrey</i>	OIL CONSERVATION DIVISION	
Printed Name: Don Embrey	Approved by District Superintendent <i>Johnson</i>	
Title: Training Specialist	Approval Date: 6-28-2010	Expiration Date: _____
E-mail Address: dembrey@targaresources.com	Conditions of Approval: _____	Attached <input type="checkbox"/>
Date: June 21, 2010 Phone: (432) 688-0546	IRP 10-2-2412	

\* Attach Additional Sheets If Necessary

nclw

District I  
1625 N. French Dr., Hobbs, NM 88240  
District II  
1301 W. Grand Avenue, Artesia, NM 88210  
District III  
1000 Rio Brazos Road, Aztec, NM 87410  
District IV  
1220 S. St. Francis Dr., Santa Fe, NM 87505

State of New Mexico  
Energy Minerals and Natural Resources

Oil Conservation Division  
1220 South St. Francis Dr.  
Santa Fe, NM 87505

RECEIVED

Form C-141  
Revised October 10, 2003

FEB 25 2010  
HOBSOCD  
Submit 2 Copies to appropriate District Office in accordance with Rule 116 on back side of form

Release Notification and Corrective Action

OPERATOR

☒ Initial Report ☐ Final Report

Name of Company: Targa Midstream Services L P	Contact: James Lingnau 575.394.2534, Chuck Tolsma 575.631.6026	
Address: PO Box 1909 Eunice, NM 88231	Telephone No. (575) 394-2534	
Facility Name: Eunice Gas Plant	Facility Type: Natural Gas Processing	
Surface Owner: Apache Corp.	Mineral Owner:	Lease No.

LOCATION OF RELEASE

Unit Letter	Section 29	Township 21S	Range 37E	Feet from the	North/South Line	Feet from the	East/West Line	County  Lea
-------------	---------------	-----------------	--------------	---------------	------------------	---------------	----------------	-------------------

Latitude 32.44346N Longitude 103.18439

NATURE OF RELEASE

Type of Release Natural Gas and liquid from a 4 inch gathering line with 12 psi flowing 100MCFD.	Volume of Release: Approximately 6 Barrels of liquid and 13.15mcf of natural gas by calculation.	Volume Recovered: NONE
Source of Release: Natural gas 4 inch gathering line with a .25 inch hole from corrosion.	Date and Hour of Occurrence: 5AM January 19, 2010	Date and Hour of Discovery 1:45 PM January 19, 2010
Was Immediate Notice Given? <input checked="" type="checkbox"/> Yes <input type="checkbox"/> No <input type="checkbox"/> Not Required	If YES, To Whom? Larry Johnson OCD in Hobbs by phone and to OCD on call phone	
By Whom? Roger Holland	Date and Hour 2PM January 19, 2010	
Was a Watercourse Reached? <input type="checkbox"/> Yes <input checked="" type="checkbox"/> No	If YES. Volume Impacting the Watercourse	

If a Watercourse was Impacted, Describe Fully.\*

Describe Cause of Problem and Remedial Action Taken. \*

4 inch natural gas gathering line developed .25 inch hole from corrosion. Line was excavated and leak repaired. Contaminated soil will be excavated and disposed of in an OCD approved landfarm.

Describe Area Affected and Cleanup Action Taken.\*

The area affected will be excavated and soil contamination disposed of. Area will be cleaned and sampled to insure compliance with OCD guidelines.

I hereby certify that the information given above is true and complete to the best of my knowledge and understand that pursuant to NMOCD rules and regulations all operators are required to report and/or file certain release notifications and perform corrective actions for releases which may endanger public health or the environment. The acceptance of a C-141 report by the NMOCD marked as "Final Report" does not relieve the operator of liability should their operations have failed to adequately investigate and remediate contamination that pose a threat to ground water, surface water, human health or the environment. In addition, NMOCD acceptance of a C-141 report does not relieve the operator of responsibility for compliance with any other federal, state, or local laws and/or regulations.

Signature <i>Don Embrey</i>	OIL CONSERVATION DIVISION <i>L. Johnson</i>	
Printed Name: Don Embrey	Approved by District Supervisor ENVIRONMENTAL ENGINEER	
Title: Training Specialist	Approval Date: 2.1.10	Expiration Date: 4.1.10
E-mail Address: dembrey@targaresources.com	Conditions of Approval.	Attached <input type="checkbox"/>
Date: January 25, 2010 Phone: (432) 688-0546		IRP # 10.2.2412

\* Attach Additional Sheets If Necessary

## APACHE 4"

SAMPLE DATE	SAMPLE I.D.	SOIL STATUS	TPH GRO	TPH DRO	CHLORIDE
3/10/2010	#1	In Situ	<10	16.9	<16
3/10/2010	#2	Excavated	<10	380	<16
3/10/2010	#3	Excavated	<10	224	<16
3/10/2010	#4	Excavated	<10	528	<16
3/10/2010	#5	Excavated	<10	121	<16
6/11/2010	#2	In Situ	<10	23.5	<16
6/11/2010	#3	In Situ	<10	37.7	<16
6/11/2010	#4	In Situ	<10	<10	<16
6/11/2010	#5	In Situ	<10	<10	<16

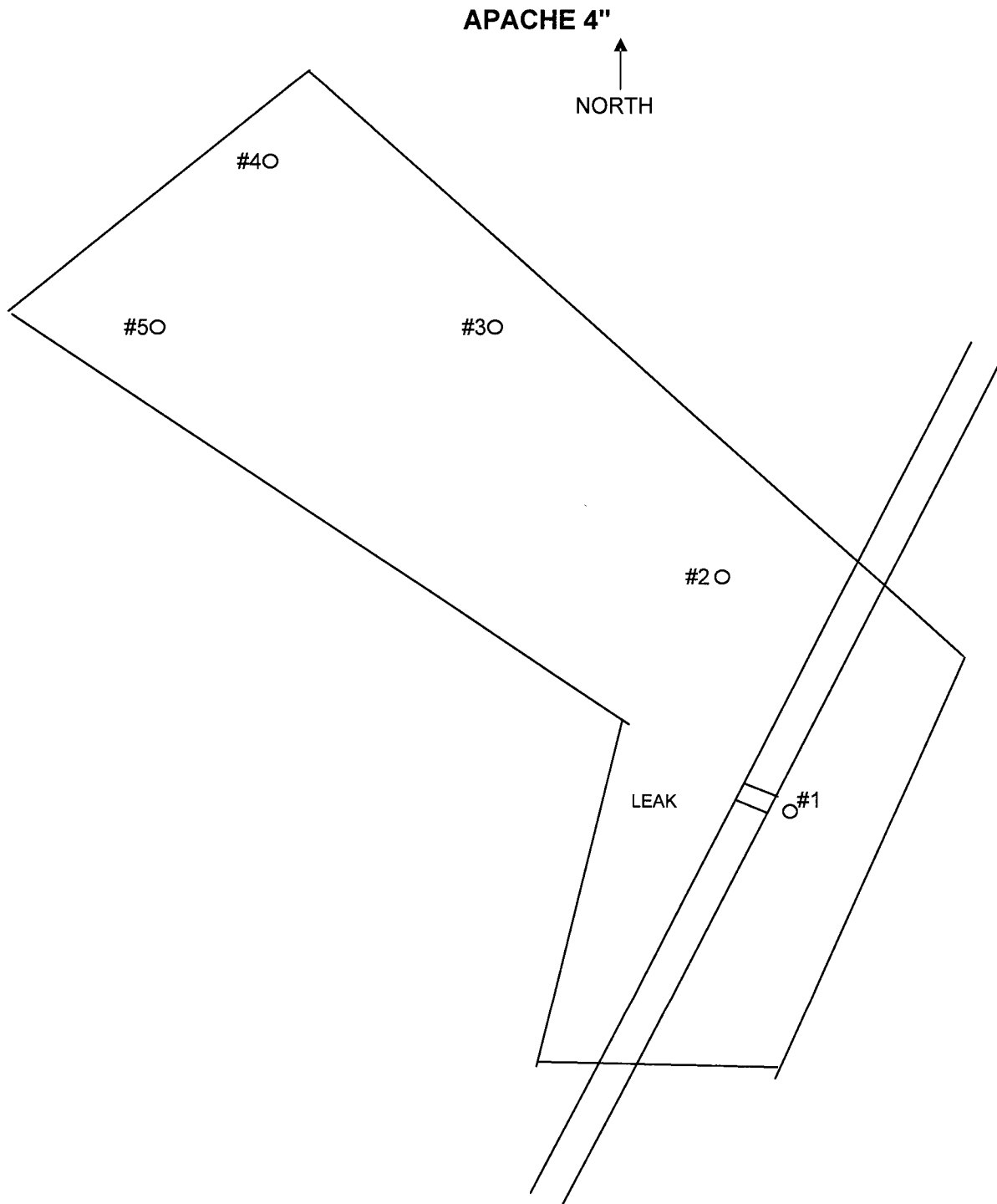

5/21/2010



# ARDINAL LABORATORIES

PHONE (575) 393-2326 • 101 E. MARLAND • HOBBS, NM 88240

---

June 15, 2010

Roger Holland  
Targa Resources  
P.O. Box 1929  
Eunice, NM 88231

Re: Apache 4"

Enclosed are the results of analyses for sample number H20080, received by the laboratory on 06/10/10 at 10:30 am.

Cardinal Laboratories is accredited through Texas NELAP for:

Method SW-846 8021	Benzene, Toluene, Ethyl Benzene, and Total Xylenes
Method SW-846 8260	Benzene, Toluene, Ethyl Benzene, and Total Xylenes
Method TX 1005	Total Petroleum Hydrocarbons

Certificate number T104704398-08-TX. Accreditation applies to solid and chemical materials and non-potable water matrices.

Cardinal Laboratories is accredited through the State of Colorado Department of Public Health and Environment for:

Method EPA 552.2	Haloacetic Acids (HAA-5)
Method EPA 524.2	Total Trihalomethanes (TTHM)
Method EPA 524.2	Regulated VOCs (V2, V3)

Accreditation applies to public drinking water matrices.

Total Number of Pages of Report: 3 (includes Chain of Custody)

Sincerely,

Celey D. Keene  
Laboratory Director

---

This report conforms with NELAP requirements.

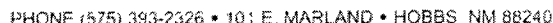

Sampling Date: 06/10/10  
Sample Type: SOIL  
Sample Condition: INTACT @ 17°C  
Sample Received By: JH  
Analyzed By: AB

\*Analyses performed on 1:4 w:v aqueous extracts. Reported on wet weight.

Date 12/15/10

PLEASE NOTE: **Liability and Damages.** Cardinal's liability and client's exclusive remedy for any claim arising, whether based in contract or tort, shall be limited to the amount paid by client for analysis. All claims, including those for negligence and any other cause whatsoever shall be deemed waived unless made in writing and received by Cardinal within thirty (30) days after completion of the applicable service. In no event shall Cardinal be liable for incidental or consequential damages, including, without limitation, business interruptions, loss of use or loss of profits incurred by client or its subsidiaries, affiliates or successors arising out of or related to the performance of services hereunder by Cardinal, regardless of whether such claim is based upon any of the above-stated reasons or otherwise. Results apply only to the samples identified above. This report shall not be reproduced except in full with written approval of Cardinal Laboratories.



# **CARDINAL LABORATORIES**

101 East Marland, Hobbs, NM 88240

(505) 393-2326 FAX (505) 393-2476

## **CHAIN-OF-CUSTODY AND ANALYSIS REQUEST**

Company Name: <u>TARGA</u>				<b>BILL TO</b>				<b>ANALYSIS REQUEST</b>											
Project Manager: <u>Roger Holland</u>				P.O. #:															
Address: <u>Box 1929</u>				Company:															
City: <u>Eunice</u> State: <u>NM</u> Zip: <u>88231</u>				Attn:															
Phone #: <u>575-394-2516</u> Fax #: <u>575-394-1514</u>				Address:															
Project #: _____ Project Owner:				City:															
Project Name: <u>Apache 4"</u>				State: _____ Zip: _____															
Project Location: <u>Eunice Field</u>				Phone #:															
Sampler Name: <u>Roger Holland</u>				Fax #:															
FOR LAB USE ONLY																			
Lab I.D.	Sample I.D.	(G)RAB OR (C)OMP	# CONTAINERS	MATRIX				PRESERV		SAMPLING		<u>TPH</u> <u>Chlorides</u>							
				GROUNDWATER	WASTEWATER	SOIL	OIL	SLUDGL	OTHER	ACID/BASE	ICE / COOL					OTHER	DATE	TIME	
<u>H20050</u>													<u>6/10/10</u>	<u>6:30 PM</u>					
<u>2</u>	<u>Re-Sample</u>																		
<u>3</u>	<u>Re-Sample</u>																		
<u>4</u>	<u>Re-Sample</u>																		
<u>5</u>	<u>Re-Sample</u>																		

PLEASE NOTE: Liability and Exclusions: Cardinal Laboratories and its subsidiaries and affiliates shall not be liable for any claim arising out of or from the use of the amount paid by the client for the analysis. A claim, including those which arise out of or from the use of the amount paid by the client for the analysis, shall be filed with Cardinal within 90 days after completion of the analysis. No claim shall be considered or handled by Cardinal, including without limitation, business interruption, loss of use or loss of profits incurred by client, its subsidiaries, or affiliates, or any third party, unless it is stated in writing and signed by Cardinal, regardless of whether such claim is based upon any of the above stated reasons or otherwise.

Relinquished By: _____	Date: _____	Received By: _____	Phone Result: <input type="checkbox"/> Yes <input type="checkbox"/> No	Add'l Phone #: _____
	Time: _____		Fax Result: <input type="checkbox"/> Yes <input type="checkbox"/> No	Add'l Fax #: _____
REMARKS:				
Relinquished By: <u>[Signature]</u>	Date: <u>6/10/10</u>	Received By: <u>[Signature]</u>		
	Time: <u>12:30 PM</u>			
Delivered By: (Circle One)	Sample Condition	CHECKED BY: _____		
Sampler - UPS - Bus - Other:	Cool Intact	(Initials)		
	<input type="checkbox"/> Yes <input type="checkbox"/> No			

† Cardinal cannot accept verbal changes. Please fax written changes to 505-393-2476

#25





# ARDINAL LABORATORIES

PHONE (575) 393-2326 • 101 E. MARLAND • HOBBS, NM 88240

---

March 12, 2010

Roger Holland  
Targa Resources  
P.O. Box 1929  
Eunice, NM 88231

Re: Apache 4"

Enclosed are the results of analyses for sample number II19414, received by the laboratory on 03/10/10 at 12:15 pm.

Cardinal Laboratories is accredited through Texas NELAP for:

Method SW-846 8021	Benzene, Toluene, Ethyl Benzene, and Total Xylenes
Method SW-846 8260	Benzene, Toluene, Ethyl Benzene, and Total Xylenes
Method TX 1005	Total Petroleum Hydrocarbons

Certificate number T104704398-08-TX. Accreditation applies to solid and chemical materials and non-potable water matrices.

Cardinal Laboratories is accredited through the State of Colorado Department of Public Health and Environment for:

Method EPA 552.2	Haloacetic Acids (HAA-5)
Method EPA 524.2	Total Trihalomethanes (TTHM)
Method EPA 524.2	Regulated VOCs (V2, V3)

Accreditation applies to public drinking water matrices.

Total Number of Pages of Report: 3 (includes Chain of Custody)

Sincerely,

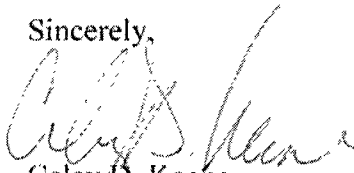

Celey D. Keene  
Laboratory Director

---

This report conforms with NELAP requirements.



PHONE (575) 393-2326 • 101 E. MARLAND • HOBBS, NM 88240

ANALYTICAL RESULTS FOR  
TARGA RESOURCES  
ATTN: ROGER HOLLAND  
P.O. BOX 1929  
EUNICE, NM 88231  
FAX TO: (575) 394-1514

Receiving Date: 03/10/10  
Reporting Date: 03/12/10  
Project Number: NOT GIVEN  
Project Name: APACHE 4"  
Project Location: EUNICE FIELD

Sampling Date: 03/10/10  
Sample Type: SOIL  
Sample Condition: INTACT @ 10<sup>11</sup>C  
Sample Received By: JH  
Analyzed By: AB/HM

LAB NUMBER	SAMPLE ID	GRO (C <sub>6</sub> -C <sub>10</sub> ) (mg/kg)	DRO (>C <sub>10</sub> -C <sub>29</sub> ) (mg/kg)	*Cl <sup>-</sup> (mg/kg)
		03/11/10	03/11/10	03/11/10
H19414-1	1 APACHE 4"	<10.0	16.9	< 16
H19414-2	2 APACHE 4"	<10.0	380	< 16
H19414-3	3 APACHE 4"	<10.0	224	< 16
H19414-4	4 APACHE 4"	<10.0	528	< 16
H19414-5	5 APACHE 4"	<10.0	121	< 16
Quality Control		415	470	500
True Value QC		500	500	500
% Recovery		83.0	94.0	100
Relative Percent Difference		0.1	2.6	< 0.1

METHODS: TPH GRO & DRO: EPA SW-846 8015 M; Cl<sup>-</sup>: Std. Methods 4500-Cl<sup>-</sup>B

\*Analyses performed on 1:4 w/v aqueous extracts. Reported on wet weight.

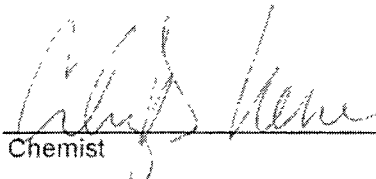
  
Chemist

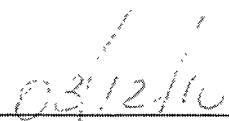
  
Date

60-64

H19414 TCL TARGA

**PLEASE NOTE: Liability and Damages.** Cardinal's liability and client's exclusive remedy for any claim arising, whether based in contract or tort, shall be limited to the amount paid by client for analyses. All claims, including those for negligence and any other cause whatsoever shall be deemed waived unless made in writing and received by Cardinal within thirty (30) days after completion of the applicable service. In no event shall Cardinal be liable for incidental or consequential damages, including, without limitation, business interruptions, loss of use, or loss of profits incurred by client, its subsidiaries, affiliates or successors arising out of or related to the performance of services hereunder by Cardinal, regardless of whether such claim is based upon any of the above-stated reasons or otherwise. Results relate only to the samples identified above. This report shall not be reproduced except in full with written approval of Cardinal Laboratories.



# CARDINAL LABORATORIES

101 East Marland, Hobbs, NM 88240

(575) 393-2326 Fax (575) 393-2476

Page \_\_\_\_ of \_\_\_\_

<b>Company Name:</b> <u>Targa Resources</u> <b>Project Manager:</b> <u>Roger Holland</u> <b>Address:</b> <u>P.O. Box 1929</u> <b>City:</b> <u>Funter</u> <b>State:</b> <u>NM</u> <b>Zip:</b> <u>88231</u> <b>Phone #:</b> <u>575-631-1094</u> <b>Fax #:</b> <u>575-394-1514</u> <b>Project #:</b> _____ <b>Project Owner:</b> _____ <b>Project Name:</b> <u>Apache 4"</u> <b>Project Location:</b> <u>Funter Field</u> <b>Sampler Name:</b> <u>Roger Holland</u>				<b>BILL TO</b> <b>P.O. #:</b> _____ <b>Company:</b> _____ <b>Attn:</b> _____ <b>Address:</b> _____ <b>City:</b> _____ <b>State:</b> _____ <b>Zip:</b> _____ <b>Phone #:</b> _____ <b>Fax #:</b> _____		<b>ANALYSIS REQUEST</b>											
<small>FOR LAB USE ONLY</small> <b>Lab I.D.</b>		<b>Sample I.D.</b>		<small>(GIRAB OR C) OR NP</small> <b># CONTAINERS</b>	<b>MATRIX</b> GROUNDWATER WASTEWATER SOIL OIL SLUDGE OTHER	<b>PRESERV.</b> ACID/BASE ICE / COOL OTHER	<b>SAMPLING</b> DATE TIME	T.P.H. Chlorides									
HA414-1 - 2 - 3 - 4 - 5		Apache 4" " " " " " " " "					3/10/10 11:00 AM										

PLEASE NOTE: Liability and Damages: Cardinal Laboratory and its clients exclude remedy for any claim arising whether based in contract or tort, shall be limited to the amount paid by the client for the analysis. All claims, including those for negligence and any other cause whatsoever shall be deemed waived unless made in writing and received by Cardinal within 30 days after completion of the applicable service. In no event shall Cardinal be liable for incidental or consequential damages, including without limitation, business interruptions, loss of use or loss of profits incurred by client or its subsidiaries, affiliates or subcontractors, arising out of or related to the performance or non-performance hereunder by Cardinal, regardless of whether such claim is based upon any of the above stated reasons or otherwise.

Terms and Conditions: Interest will be charged on all accounts more than 30 days past due at the rate of 24% per annum from the original date of invoice, and all costs of collections, including attorney's fee.

<b>Sampler Relinquished:</b> <u>[Signature]</u> <b>Date:</b> <u>3/10/10</u> <b>Time:</b> <u>12:00 PM</u>		<b>Received By:</b> <u>[Signature]</u> <b>Date:</b> <u>3/10/10</u> <b>Time:</b> <u>12:15</u>		<b>Phone Result:</b> <input type="checkbox"/> <b>No</b> <b>Add'l Phone #:</b> _____ <b>Fax Result:</b> <input type="checkbox"/> <b>No</b> <b>Add'l Fax #:</b> _____ <b>REMARKS:</b>	
<b>Relinquished By:</b> <u>[Signature]</u>		<b>Received By:</b> <u>[Signature]</u>		results email	
<b>Delivered By: (Circle One)</b> Sampler - UPS - Bus - Other:		<b>Temp:</b> <u>10°C</u> <b>Sample Condition:</b> Cool Intact <input type="checkbox"/> Yes <input type="checkbox"/> No		<b>CHECKED BY:</b> <u>[Signature]</u>	

† Cardinal cannot accept verbal changes. Please fax written changes to 575-393-2476.

# 46