

DATE IN 6-10-10	SUSPENSE	ENGINEER WJ	LOGGED IN 6-10-10	TYPE SWD	APP NO. 1016155772
------------------------	----------	--------------------	--------------------------	-----------------	---------------------------

ABOVE THIS LINE FOR DIVISION USE ONLY

NEW MEXICO OIL CONSERVATION DIVISION

- Engineering Bureau -

1220 South St. Francis Drive, Santa Fe, NM 87505



XTO

Salty Dog SWD #2

ADMINISTRATIVE APPLICATION CHECKLIST

30-045-30812

THIS CHECKLIST IS MANDATORY FOR ALL ADMINISTRATIVE APPLICATIONS FOR EXCEPTIONS TO DIVISION RULES AND REGULATIONS WHICH REQUIRE PROCESSING AT THE DIVISION LEVEL IN SANTA FE

Application Acronyms:

[NSL-Non-Standard Location] **[NSP-Non-Standard Proration Unit]** **[SD-Simultaneous Dedication]**
[DHC-Downhole Commingling] **[CTB-Lease Commingling]** **[PLC-Pool/Lease Commingling]**
[PC-Pool Commingling] **[OLS - Off-Lease Storage]** **[OLM-Off-Lease Measurement]**
[WFX-Waterflood Expansion] **[PMX-Pressure Maintenance Expansion]**
[SWD-Salt Water Disposal] **[IPI-Injection Pressure Increase]**
[EOR-Qualified Enhanced Oil Recovery Certification] **[PPR-Positive Production Response]**

Fed

[1] TYPE OF APPLICATION - Check Those Which Apply for [A]

[A] Location - Spacing Unit - Simultaneous Dedication
☐ NSL ☐ NSP ☐ SD

Check One Only for [B] or [C]

[B] Commingling - Storage - Measurement
☐ DHC ☐ CTB ☐ PLC ☐ PC ☐ OLS ☐ OLM

[C] Injection - Disposal - Pressure Increase - Enhanced Oil Recovery
☐ WFX ☐ PMX ☒ SWD ☐ IPI ☐ EOR ☐ PPR

[D] Other: Specify _____

SWD-811
SWD-811-A

2388'-3475'

1300 psi
= 0.5 grad
?

[2] NOTIFICATION REQUIRED TO: - Check Those Which Apply, or ☐ Does Not Apply

[A] ☐ Working, Royalty or Overriding Royalty Interest Owners
[B] ☒ Offset Operators, Leaseholders or Surface Owner
[C] ☒ Application is One Which Requires Published Legal Notice
[D] ☒ Notification and/or Concurrent Approval by BLM or SLO
U.S. Bureau of Land Management - Commissioner of Public Lands, State Land Office
[E] ☒ For all of the above, Proof of Notification or Publication is Attached, and/or,
[F] ☐ Waivers are Attached

[3] SUBMIT ACCURATE AND COMPLETE INFORMATION REQUIRED TO PROCESS THE TYPE OF APPLICATION INDICATED ABOVE.

[4] CERTIFICATION: I hereby certify that the information submitted with this application for administrative approval is **accurate** and **complete** to the best of my knowledge. I also understand that **no action** will be taken on this application until the required information and notifications are submitted to the Division.

Note: Statement must be completed by an individual with managerial and/or supervisory capacity.

Diane Jaramillo
Print or Type Name

Diane Jaramillo
Signature

Supervisor, Accounting/Engineering Techs
Title
Diane_Jaramillo@xtoenergy.com

5-11-10
Date

e-mail Address



RECEIVED OCD

2010 JUN 10 A 11: 22

382 Road 3100 Aztec, New Mexico 87410

Phone: (505) 333-3100 FAX: (505) 333-3280

May 13, 2010

State of New Mexico
Oil Conservation Division
Mr. William Jones
1220 South Saint Francis Drive
Santa Fe, New Mexico 87505

Re: Salt Water Disposal Application
Salty Dog No. 2 Well
Section 5, Township 29 North, Range 14 West, NMPM
San Juan County, New Mexico

Dear Mr. Jones:

XTO Energy Inc. is requesting approval to add additional Mesaverde perforations from 3,252' to 3,475'. The additional perforations will significantly increase the daily disposal capacity of this well. Richardson Operating Company was previously authorized to inject from 2,200' to 3,580', as per Administrative Order SWD-811, dated September 13, 2001. Enclosed please find one original and one copy of the complete Salt Water Disposal Application. A copy has been furnished to the Aztec OCD Office and the Farmington BLM Office.

This well was completed in the Blanco Mesaverde field on January 6, 2002. XTO owns the surface where this well is located.

There is only one well which penetrates the injection zone within one half mile of the Salty Dog No. 2 location. The plugged and abandoned Pubco-Carr Russell Federal No. 1 well is located in the NE/4NE/4 of Section 8, T29N, R14W. The five wells within the area of review are Fruitland Coal wells operated by XTO Energy. Pertinent well records are attached.

Information from the State Engineer's Office in Aztec indicates there are no shallow fresh water wells within one half mile of the Salty Dog No. 2 location.

Should you require further documentation please feel free to call my office @ 505-333-3100 or e-mail Diane_Jaramillo@xtoenergy.com and I will be happy to furnish any additional information.

Mr. Alexander Bridge is the engineer in charge should you need clarification of engineering data and is available at the number listed above.

Yours truly,

A handwritten signature in black ink, appearing to read 'Diane Jaramillo', written over a horizontal line.

Diane Jaramillo
Supervisor, Engineering Techs/Accounting

CC: Aztec OCD
BLM – Farmington

List of Exhibits to Application for Authorization to Inject C-108:

- Exhibit 1 Injection Well Data Sheet
- Exhibit 2 Well and Lease Plat – 2 mile radius
 - Each track listed contained in the one-half mile AOR and the owners affected in each track
 - Tabulation of data on all wells within the AOR
- Exhibit 3 Operations Plan
- Exhibit 4 Wellbore Diagram
- Exhibit 5 Survey Plat and Well Pad
- Exhibit 6 Water Analysis: Mesaverde
- Exhibit 7 Water Analysis: Fruitland Coal and Pictured Cliffs
- Exhibit 8 Notification to Conoco/Phillips
 - Notification to Western Gas Resources
 - Notification to Bureau of Land Management
- Exhibit 9 Affidavit of Publication from the Daily Times newspaper
- Exhibit 10 Well Records – Pubco-Carr Russell Federal No. 1

APPLICATION FOR AUTHORIZATION TO INJECT

- I. PURPOSE: _____ Secondary Recovery _____ Pressure Maintenance ☒ Disposal _____ Storage
Application qualifies for administrative approval? _____ Yes _____ No
- II. OPERATOR: XTO Energy, Inc.
ADDRESS: 382 CR 3100, Aztec, NM 87410
CONTACT PARTY: Alexander Bridge PHONE: 505-333-3100
- III. WELL DATA: Complete the data required on the reverse side of this form for each well proposed for injection.
Additional sheets may be attached if necessary.
- IV. Is this an expansion of an existing project? _____ Yes ☒ No
If yes, give the Division order number authorizing the project: _____
- V. Attach a map that identifies all wells and leases within two miles of any proposed injection well with a one-half mile radius circle drawn around each proposed injection well. This circle identifies the well's area of review.
- VI. Attach a tabulation of data on all wells of public record within the area of review which penetrate the proposed injection zone. Such data shall include a description of each well's type, construction, date drilled, location, depth, record of completion, and a schematic of any plugged well illustrating all plugging detail.
- VII. Attach data on the proposed operation, including:
1. Proposed average and maximum daily rate and volume of fluids to be injected;
 2. Whether the system is open or closed;
 3. Proposed average and maximum injection pressure;
 4. Sources and an appropriate analysis of injection fluid and compatibility with the receiving formation if other than reinjected produced water; and,
 5. If injection is for disposal purposes into a zone not productive of oil or gas at or within one mile of the proposed well, attach a chemical analysis of the disposal zone formation water (may be measured or inferred from existing literature, studies, nearby wells, etc.).
- *VIII. Attach appropriate geologic data on the injection zone including appropriate lithologic detail, geologic name, thickness, and depth. Give the geologic name, and depth to bottom of all underground sources of drinking water (aquifers containing waters with total dissolved solids concentrations of 10,000 mg/l or less) overlying the proposed injection zone as well as any such sources known to be immediately underlying the injection interval.
- IX. Describe the proposed stimulation program, if any.
- *X. Attach appropriate logging and test data on the well. (If well logs have been filed with the Division, they need not be resubmitted).
- *XI. Attach a chemical analysis of fresh water from two or more fresh water wells (if available and producing) within one mile of any injection or disposal well showing location of wells and dates samples were taken.
- XII. Applicants for disposal wells must make an affirmative statement that they have examined available geologic and engineering data and find no evidence of open faults or any other hydrologic connection between the disposal zone and any underground sources of drinking water.
- XIII. Applicants must complete the "Proof of Notice" section on the reverse side of this form.
- XIV. Certification: I hereby certify that the information submitted with this application is true and correct to the best of my knowledge and belief.
- NAME: Alexander Bridge TITLE: Production Engineer
SIGNATURE: Alexander C. Bridge DATE: 05/13/2010
E-MAIL ADDRESS: Alexander_Bridge@xtoenergy.com
- * If the information required under Sections VI, VIII, X, and XI above has been previously submitted, it need not be resubmitted. Please show the date and circumstances of the earlier submittal: _____

III. WELL DATA

A. The following well data must be submitted for each injection well covered by this application. The data must be both in tabular and schematic form and shall include:

- (1) Lease name; Well No.; Location by Section, Township and Range; and footage location within the section.
- (2) Each casing string used with its size, setting depth, sacks of cement used, hole size, top of cement, and how such top was determined.
- (3) A description of the tubing to be used including its size, lining material, and setting depth.
- (4) The name, model, and setting depth of the packer used or a description of any other seal system or assembly used.

Division District Offices have supplies of Well Data Sheets which may be used or which may be used as models for this purpose. Applicants for several identical wells may submit a "typical data sheet" rather than submitting the data for each well.

B. The following must be submitted for each injection well covered by this application. All items must be addressed for the initial well. Responses for additional wells need be shown only when different. Information shown on schematics need not be repeated.

- (1) The name of the injection formation and, if applicable, the field or pool name.
- (2) The injection interval and whether it is perforated or open-hole.
- (3) State if the well was drilled for injection or, if not, the original purpose of the well.
- (4) Give the depths of any other perforated intervals and detail on the sacks of cement or bridge plugs used to seal off such perforations.
- (5) Give the depth to and the name of the next higher and next lower oil or gas zone in the area of the well, if any.

XIV. PROOF OF NOTICE

All applicants must furnish proof that a copy of the application has been furnished, by certified or registered mail, to the owner of the surface of the land on which the well is to be located and to each leasehold operator within one-half mile of the well location.

Where an application is subject to administrative approval, a proof of publication must be submitted. Such proof shall consist of a copy of the legal advertisement which was published in the county in which the well is located. The contents of such advertisement must include:

- (1) The name, address, phone number, and contact party for the applicant;
- (2) The intended purpose of the injection well; with the exact location of single wells or the Section, Township, and Range location of multiple wells;
- (3) The formation name and depth with expected maximum injection rates and pressures; and,
- (4) A notation that interested parties must file objections or requests for hearing with the Oil Conservation Division, 1220 South St. Francis Dr., Santa Fe, New Mexico 87505, within 15 days.

NO ACTION WILL BE TAKEN ON THE APPLICATION UNTIL PROPER PROOF OF NOTICE HAS BEEN SUBMITTED.

NOTICE: Surface owners or offset operators must file any objections or requests for hearing of administrative applications within 15 days from the date this application was mailed to them.

INJECTION WELL DATA SHEET

OPERATOR: XTO Energy, Inc.WELL NAME & NUMBER: Salty Dog No. 2WELL LOCATION: 1495' FSL & 1477' FEL UNIT LETTER J SECTION 5 TOWNSHIP 29N RANGE 14WWELLBORE SCHEMATICWELL CONSTRUCTION DATA
Surface Casing

Hole Size: 9 3/4 Casing Size: 8 5/8, 24#

Cemented with: 110 sx. or 130 ft³

Top of Cement: Surface Method Determined: _____

Intermediate Casing

Hole Size: _____ Casing Size: _____

Cemented with: _____ sx. or _____ ft³

Top of Cement: _____ Method Determined: _____

Production Casing

Hole Size: 6 3/4 Casing Size: 5 1/2, 15.5#

Cemented with: 165 + 177 sx. or 549 ft³

Top of Cement: 970' Method Determined: CBL

Total Depth: 3,616'Injection Interval

Current MV perfs: 2,388' - 3,096' To perforated _____

Proposed MV perfs: 2,388' - 3,475' To perforated _____

(Perforated or Open Hole; indicate which)

INJECTION WELL DATA SHEET

Tubing Size: 2 7/8", 6.4#, J-55 Lining Material: None

Type of Packer: 5 1/2" x 2 7/8"

Packer Setting Depth: 2,310'

Other Type of Tubing/Casing Seal (if applicable): N/A

Additional Data

1. Is this a new well drilled for injection? _____ Yes _____ X No

If no, for what purpose was the well originally drilled? _____

2. Name of the Injection Formation: Mesaverde

3. Name of Field or Pool (if applicable): Blanco Mesaverde

4. Has the well ever been perforated in any other zone(s)? List all such perforated intervals and give plugging detail, i.e. sacks of cement or plug(s) used. Yes

Squeeze holes @ 915'. Squeezed with 222 sx cement 01/11/02. Circ cement to surface.

5. Give the name and depths of any oil or gas zones underlying or overlying the proposed injection zone in this area: _____

Pictured Cliffs 800'

Gallup 5000'

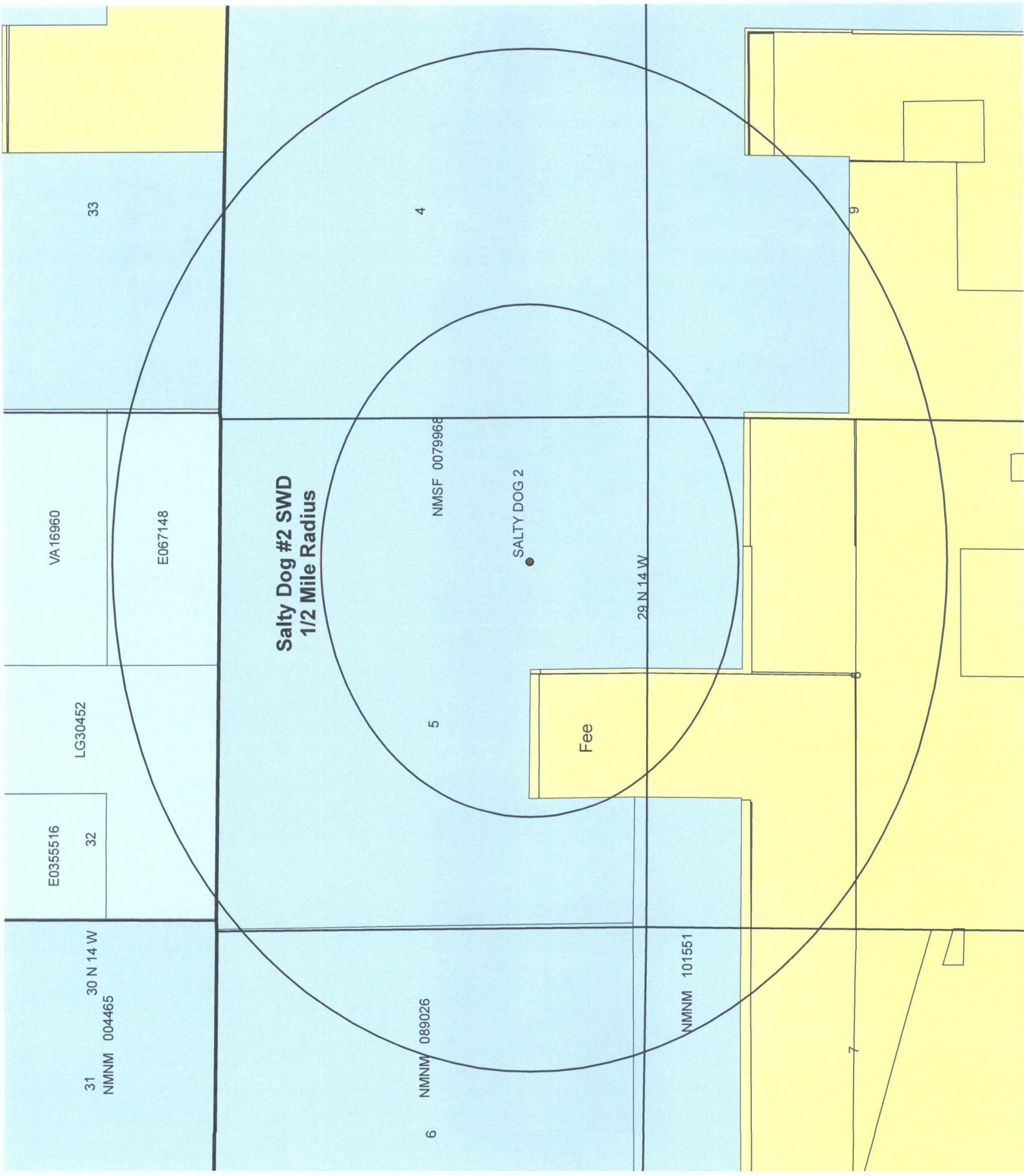

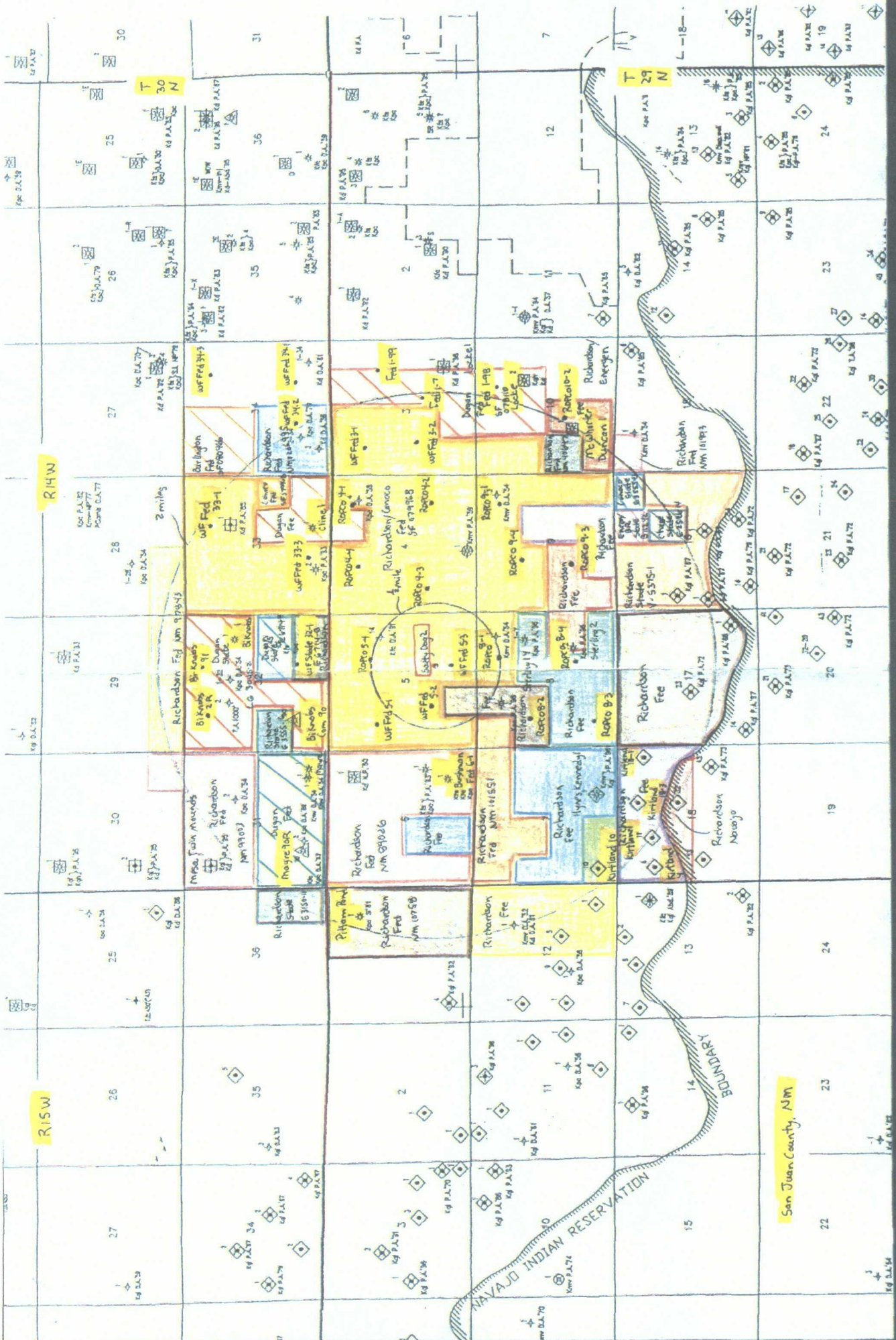

R 14 W

R 15 W

San Juan County, NM

DETERMINATION - APPROVAL - CERTIFICATION

Pursuant to the authority vested in the Secretary of the Interior, under Section 17(j) of the Mineral Leasing Act of 1920, as amended (74 Stat. 784; 30 U.S.C. 226(j)), and delegated to the authorized officer, of the Bureau of Land Management, I do hereby:

- A. Determine that the Federal lease or leases as to the lands committed to the attached agreement cannot be independently developed and operated in conformity with the well-spacing program established for the field or area in which said lands are located, and that consummation and approval of the agreement will be in the public interest.
- B. Approve the attached communitization agreement covering: SW $\frac{1}{4}$ of Section 5, T. 29 N., R. 14 W., San Juan County, New Mexico, as to natural gas and associated liquid hydrocarbons producible from the Pictured Cliffs formation. This approval will become invalid *ab initio* by the Authorized officer should then public interest requirements under section 3105.2-3(e) not be met.
- C. Certify and determine that the drilling, producing, rental, minimum royalty and royalty requirements of the Federal lease or leases committed to said agreement are hereby established, altered, changed, or revoked to conform with the terms and conditions of the agreement.
- D. Approval of this agreement does not warrant or certify that the applicant and other working interest owners thereof hold legal or equitable title to the leases which are committed hereto.

Approved: January 4, 2001

Lucy Bee
Legal Instruments Examiner
Petroleum Management Team

Effective: March 4, 2000

Contract No.: Com. Agr. NMNM 103035

201000001

COMMUNITIZATION AGREEMENT

CONTRACT NO. NMM 103035

THIS AGREEMENT, entered into as of the date shown in Section 10 hereof, is by and between the parties subscribing, ratifying or consenting hereto, such parties being hereinafter referred to as "parties hereto."

2011 FEB 23
070 FARMINGTON, NM

WITNESSETH:

WHEREAS, the Act of February 25, 1920 (41 Stat. 437), as amended and supplemented, authorizes communitization or drilling agreements communitizing or pooling a Federal oil and gas lease, or any portion thereof, with other lands, whether or not owned by the United States, when separate tracts under such Federal lease cannot be independently developed and operated in conformity with an established well-spacing program for the field or area and such communitization or pooling is determined to be in the public interest; and

WHEREAS, the parties hereto own working, royalty or other leasehold interests, or operating rights under the oil and gas leases and lands subject to this agreement which cannot be independently developed and operated in conformity with the well-spacing program established for the field or area in which said lands are located; and

WHEREAS, the parties hereto desire to communitize and pool their respective mineral interests in lands subject to this agreement for the purpose of developing and producing communitized substances in accordance with the terms and conditions of this agreement:

NOW, THEREFORE, in consideration of the premises and the mutual advantages to the parties hereto, it is mutually covenanted and agreed by and between the parties hereto as follows:

1. The lands covered by this agreement (hereinafter referred to as "communitized area") are described as follows:

TOWNSHIP 29 NORTH, RANGE 14 WEST, NMPM
Section 5: SW/4
San Juan County, New Mexico

containing 160.00 acres, more or less, and this agreement shall include only the Pictured Cliffs formation underlying said lands and the natural gas and associated liquid hydrocarbons, hereinafter referred to as "communitized substances", producible from such formations.

2. Attached hereto, and made a part of this agreement for all purposes, is Exhibit B, designating the operator of the communitized area and showing the acreage, percentage and ownership of oil and gas interests in all lands within the communitized area, and the authorization, if any, for communitizing or pooling any patented or fee lands within the communitized area.

3. All matters of operation shall be governed by the operator under and pursuant to the terms and provisions of this agreement. A successor operator may be designated by the owners of the working interest in the communitized area, and four executed copies of a designation of successor operator shall be filed with the Authorized Officer.
4. Operator shall furnish the Secretary of the Interior, or his authorized representative, with a log and history of any well drilled on the communitized area, monthly reports of operations, statements of oil and gas sales and royalties and such other reports as are deemed necessary to compute monthly the royalty due the United States, as specified in the applicable oil and gas regulations.
5. The communitized area shall be developed and operated as an entirety, with the understanding and agreement between the parties hereto that all communitized substances produced therefrom shall be allocated among the leaseholds comprising said area in the proportion that the acreage interest of each leasehold bears to the entire acreage interest committed to this agreement.

All proceeds, 8/8ths, attributed to unleased Federal, State or fee land included within the CA area are to be placed in an interest earning escrow or trust account by the designated operator until the land is leased or ownership is established.

6. The royalties payable on communitized substances allocated to the individual leases comprising the communitized area and the rentals provided for in said leases shall be determined and paid on the basis prescribed in each of the individual leases. Payments of rentals under the terms of leases subject to this agreement shall not be affected by this agreement except as provided for under the terms and provisions of said leases or as may herein be otherwise provided. Except as herein modified and changed, the oil and gas leases subject to this agreement shall remain in full force and effect as originally made and issued. It is agreed that for any Federal lease bearing a sliding- or step-scale rate of royalty, such rate shall be determined separately as to production from each communitization agreement to which such lease may be committed, and separately as to any noncommunitized lease production, provided, however, as to leases where the rate of royalty for gas is based on total lease production per day, such rate shall be determined by the sum of all communitized production allocated to such a lease plus any noncommunitized lease production.
7. There shall be no obligation on the lessees to offset any well or wells completed in the same formation as covered by this agreement on separate component tracts into which the communitized area is now or may hereinafter be divided, nor shall any lessee be required to measure separately communitized substances by reason of the diverse ownership thereof, but the lessees hereto shall not be released from their obligation to protect said communitized area from drainage of communitized substances by a well or wells which may be drilled offsetting said area.

8. The commencement, completion, continued operation, or production of a well or wells for communitized substances on the communitized area shall be construed and considered as the commencement, completion, continued operation, or production on each and all of the lands within and comprising said communitized area, and operations or production pursuant to this agreement shall be deemed to be operations or production as to each lease committed hereto.
9. Production of communitized substances and disposal thereof shall be in conformity with allocation, allotments, and quotas made or fixed by any duly authorized person or regulatory body under applicable Federal or State statutes. This agreement shall be subject to all applicable Federal and State laws or executive orders, rules and regulations, and no party hereto shall suffer a forfeiture or be liable in damages for failure to comply with any of the provisions of this agreement if such compliance is prevented by, or if such failure results from, compliance with any such laws, orders, rules or regulations.
10. The date of this agreement is MAR - 4 2000, and it shall become effective as of this date or from the onset of production of communitized substances, whichever is earlier upon execution by the necessary parties, notwithstanding the date of execution, and upon approval by the Secretary of the Interior or by his duly authorized representative, and shall remain in force and effect as to the Pictured Cliffs formation for a period of 2 years and for as long as communitized substances are, or can be, produced from the communitized area in paying quantities: Provided, that prior to production in paying quantities from the communitized area and upon fulfillment of all requirements of the Secretary of the Interior, or his duly authorized representative, with respect to any dry hole or abandoned well, this agreement may be terminated at any time by mutual agreement of the parties hereto. This agreement shall not terminate upon cessation of production if, within 60 days thereafter, reworking or drilling operations on the communitized area are commenced and are thereafter conducted with reasonable diligence during the period of nonproduction. The 2 year term of this agreement will not in itself serve to extend the term of any Federal lease which would otherwise expire during said period.
11. The covenants herein shall be construed to be covenants running with the land with respect to the communitized interests of the parties hereto and their successors in interests until this agreement terminates and any grant, transfer or conveyance of any such land or interest subject hereto, whether voluntary or not, shall be and hereby is conditioned upon the assumption of all obligations hereunder by the grantee, transferee, or other successor in interest, and as to Federal land shall be subject to approval by the Secretary of the Interior, or his duly authorized representative.
12. It is agreed between the parties hereto that the Secretary of the Interior, or his duly authorized representative, shall have the right of supervision over all fee and State mineral operations within the communitized area to the extent necessary to monitor production and measurement, and assure that no avoidable loss of hydrocarbons occurs in which the United States has an interest pursuant to applicable oil and gas regulations of the Department of the Interior relating to such production and measurement.
13. This agreement shall be binding upon the parties hereto and shall extend to and be binding upon their respective heirs, executors, administrators, successors and assigns.

14. This agreement may be executed in any number of counterparts, no one of which needs to be executed by all parties, or may be ratified or consented to by separate instrument, in writing, specifically referring hereto, and shall be binding upon all parties who have executed such a counterpart, ratification or consent hereto with the same force and effect as if all parties had signed the same document.
15. **Nondiscrimination:** In connection with the performance of work under this agreement, the operator agrees to comply with all of the provisions of Section 202(1) to (7) inclusive, of Executive Order 11246 (30 F.R. 12319), as amended, which are hereby incorporated by reference in this agreement.

IN WITNESS WHEREOF, the parties hereto have executed this agreement as of the day and year first above written and have set opposite their respective names the date of execution.

RICHARDSON OPERATING COMPANY

Cathleen Colby
Cathleen Colby, Attorney-in-Fact

Executed January 26, 2000

RICHARDSON PRODUCTION COMPANY

Cathleen Colby
Cathleen Colby, Attorney-in-Fact

Executed January 26, 2000

CONOCO, INC.

Terri G. King
Terri G. King, Attorney-in-Fact
WWT

Executed 8 Feb, 2000

STATE OF COLORADO)
) ss.
COUNTY OF DENVER)

The foregoing instrument was acknowledged before me this 26 day of January, 2000, by Cathleen Colby, as Attorney-in-Fact on behalf of RICHARDSON PRODUCTION COMPANY and RICHARDSON OPERATING COMPANY.

My commission expires:

8-24-02

Cheris O'Shea
Notary Public

STATE OF TEXAS)
) ss.
COUNTY OF HARRIS)

The foregoing instrument was acknowledged before me this 8th day of February, 2000, by Terri G. King, the Attorney-in-Fact of CONOCO, INC., a Delaware corporation, on behalf of said corporation.

My commission expires:

Vicki R. Westby
Notary Public

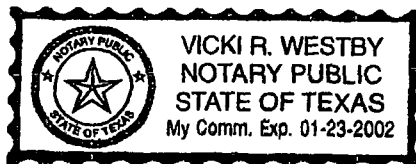

EXHIBIT A

Plat of communitized area covering SW/4 Section 5, Township 29 North, Range 14 West, NMPM, Pictured Cliffs Field, San Juan County, New Mexico.

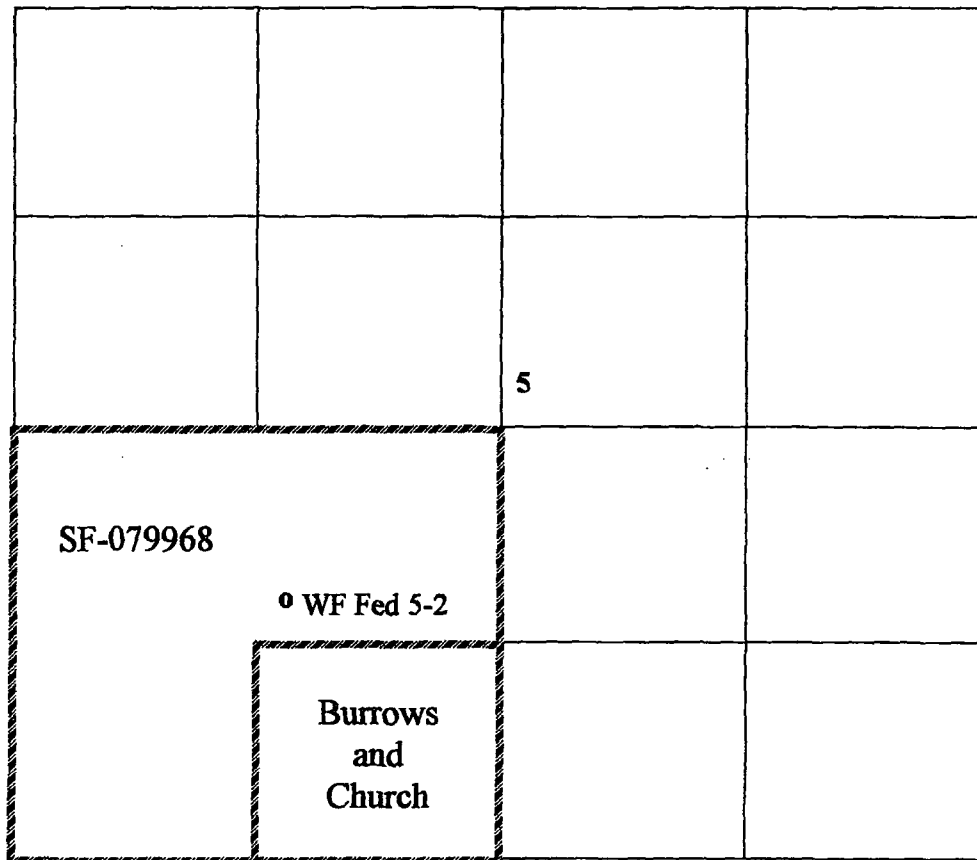

EXHIBIT B

To Communitization Agreement dated _____, embracing:

Township 29 North, Range 14 West, NMPM

Section 5: SW/4

San Juan County, New Mexico

Operator of Communitized Area: Richardson Operating Company

DESCRIPTION OF LEASES COMMITTED

Tract No. 1.

Lease Serial No.:	USA NMSF-079968	47313000
Lease Date:	July 1, 1951	
Lease Term:	5 years	
Lessor:	United States of America	
Original Lessee:	Mrs. Emma T. Russell	
Present Lessee:	100% Conoco, Inc.	
Description of Land Committed:	<u>Township 29 North, Range 14 West, NMPM</u> Section 5: N/2SW/4, SW/4SW/4	
Number of Acres:	120.00 gross, 120.00 net	
Royalty Rate:	12.5%	
Name and Percent ORRI Owners:	2.00% Conoco, Inc. 2.25% Hanson-McBride Petroleum Company 2.25% Paul Slayton .25% John N. Eddy .25% Nathan C. Greer	
Name and Percent WI Owners:	100% Richardson Production Company	

Tract No. 2

Lease Date:	April 7, 1997
Lease Term:	5 years

WF Federal 5-2 Well

Lessor: Eva Thompson Burrows, a widow 47310 001
Original Lessee: Richardson Production Company
Present Lessee: 100% Richardson Production Company
Description of Land Committed: Township 29 North, Range 14 West, NMPM
Section 5: SE/4SW/4
Number of Acres: 40.00 gross, 20.00 net
Royalty Rate: 12.5%
Name and Percent ORRI Owners: None
Name and Percent WI Owners: 100% Richardson Production Company

Tract No. 3

Lease Date: April 4, 1997
Lease Term: 5 years
Lessor: Anne Burrows Church, a widow 47310 002
Original Lessee: Richardson Production Company
Present Lessee: 100% Richardson Production Company
Description of Land Committed: Township 29 North, Range 14 West, NMPM
Section 5: SE/4SW/4
Number of Acres: 40.00 gross, 20.00 net
Royalty Rate: 12.5%
Name and Percent ORRI Owners: None
Name and Percent WI Owners: 100% Richardson Production Company

RECAPITULATION

<u>Tract No.</u>	<u>No. of Acres Committed</u>	<u>Percentage of Interest in Communitized Area</u>
1	120.00	75.00%
2	20.00	12.50%
3	<u>20.00</u>	<u>12.50%</u>
	160.00	100.00%

DETERMINATION - APPROVAL - CERTIFICATION

Pursuant to the authority vested in the Secretary of the Interior, under Section 17(j) of the Mineral Leasing Act of 1920, as amended (74 Stat. 784; 30 U.S.C. 226(j)), and delegated to the authorized officer, of the Bureau of Land Management, I do hereby:

- A. Determine that the Federal lease or leases as to the lands committed to the attached agreement cannot be independently developed and operated in conformity with the well-spacing program established for the field or area in which said lands are located, and that consummation and approval of the agreement will be in the public interest.
- B. Approve the attached communitization agreement covering: NW¼ of Section 8, T. 29 N., R. 14 W., San Juan County, New Mexico, as to natural gas and associated liquid hydrocarbons producible from the Pictured Cliffs formation. This approval will become invalid *ab initio* by the Authorized officer should then public interest requirements under section 3105.2-3(e) not be met.
- C. Certify and determine that the drilling, producing, rental, minimum royalty and royalty requirements of the Federal lease or leases committed to said agreement are hereby established, altered, changed, or revoked to conform with the terms and conditions of the agreement.
- D. Approval of this agreement does not warrant or certify that the applicant and other working interest owners thereof hold legal or equitable title to the leases which are committed hereto.

Approved: November 8, 2002

Lucy Bee
Legal Instruments Examiner
Petroleum Management Team

Effective: September 26, 2001

Contract No.: Com. Agr. **NMNM 104912**

39 685 001

COMMUNITIZATION AGREEMENT

CONTRACT NO. _____

THIS AGREEMENT, entered into as of the date shown in Section 10 hereof, is by and between the parties subscribing, ratifying or consenting hereto, such parties being hereinafter referred to as "parties" hereto." 21

RECEIVED
070 FARMINGTON, NM

WITNESSETH:

WHEREAS, the Act of February 25, 1920 (41 Stat. 437), as amended and supplemented, authorizes communitization or drilling agreements communitizing or pooling a Federal oil and gas lease, or any portion thereof, with other lands, whether or not owned by the United States, when separate tracts under such Federal lease cannot be independently developed and operated in conformity with an established well-spacing program for the field or area and such communitization or pooling is determined to be in the public interest; and

WHEREAS, the parties hereto own working, royalty or other leasehold interests, or operating rights under the oil and gas leases and lands subject to this agreement which cannot be independently developed and operated in conformity with the well-spacing program established for the field or area in which said lands are located; and

WHEREAS, the parties hereto desire to communitize and pool their respective mineral interests in lands subject to this agreement for the purpose of developing and producing communitized substances in accordance with the terms and conditions of this agreement:

NOW, THEREFORE, in consideration of the premises and the mutual advantages to the parties hereto, it is mutually covenanted and agreed by and between the parties hereto as follows:

1. The lands covered by this agreement (hereinafter referred to as "communitized area") are described as follows:

TOWNSHIP 29 NORTH, RANGE 14 WEST, NMPM
Section 8: NW/4
San Juan County, New Mexico

containing 160.00 acres, more or less, and this agreement shall include only the Pictured Cliffs formation underlying said lands and the natural gas and associated liquid hydrocarbons, hereinafter referred to as "communitized substances", producible from such formations.

2. Attached hereto, and made a part of this agreement for all purposes, are Exhibit A and B, designating the operator of the communitized area and showing the acreage, percentage and ownership of oil and gas interests in all lands within the communitized area, and the authorization, if any, for communitizing or pooling any patented or fee lands within the communitized area.

3. All matters of operation shall be governed by the operator and pursuant to the terms and provisions of this agreement. A successor operator may be designated by the owners of the working interest in the communitized area, and four executed copies of a designation of successor operator shall be filed with the Authorized Officer.
4. Operator shall furnish the Secretary of the Interior, or his authorized representative, with a log and history of any well drilled on the communitized area, monthly reports of operations, statements of oil and gas sales and royalties and such other reports as are deemed necessary to compute monthly the royalty due the United States, as specified in the applicable oil and gas regulations.
5. The communitized area shall be developed and operated as an entirety, with the understanding and agreement between the parties hereto that all communitized substances produced therefrom shall be allocated among the leaseholds comprising said area in the proportion that the acreage interest of each leasehold bears to the entire acreage interest committed to this agreement.

All proceeds, 8/8ths, attributed to unleased Federal, State or fee land included within the CA area are to be placed in an interest earning escrow or trust account by the designated operator until the land is leased or ownership is established.

6. The royalties payable on communitized substances allocated to the individual leases comprising the communitized area and the rentals provided for in said leases shall be determined and paid on the basis prescribed in each of the individual leases. Payments of rentals under the terms of leases subject to this agreement shall not be affected by this agreement except as provided for under the terms and provisions of said leases or as may herein be otherwise provided. Except as herein modified and changed, the oil and gas leases subject to this agreement shall remain in full force and effect as originally made and issued. It is agreed that for any Federal lease bearing a sliding- or step-scale rate of royalty, such rate shall be determined separately as to production from each communitization agreement to which such lease may be committed, and separately as to any noncommunitized lease production, provided, however, as to leases where the rate of royalty for gas is based on total lease production per day, such rate shall be determined by the sum of all communitized production allocated to such a lease plus any noncommunitized lease production.
7. There shall be no obligation on the lessees to offset any well or wells completed in the same formation as covered by this agreement on separate component tracts into which the communitized area is now or may hereinafter be divided, nor shall any lessee be required to measure separately communitized substances by reason of the diverse ownership thereof, but the lessees hereto shall not be released from their obligation to protect said communitized area from drainage of communitized substances by a well or wells which may be drilled offsetting said area.

8. The commencement, completion, continued operation, or production of a well or wells for communitized substances on the communitized area shall be construed and considered as the commencement, completion, continued operation, or production on each and all of the lands within and comprising said communitized area, and operations or production pursuant to this agreement shall be deemed to be operations or production as to each lease committed hereto.
9. Production of communitized substances and disposal thereof shall be in conformity with allocation, allotments, and quotas made or fixed by any duly authorized person or regulatory body under applicable Federal or State statutes. This agreement shall be subject to all applicable Federal and State laws or executive orders, rules and regulations, and no party hereto shall suffer a forfeiture or be liable in damages for failure to comply with any of the provisions of this agreement if such compliance is prevented by, or if such failure results from, compliance with any such laws, orders, rules or regulations.
10. The date of this agreement is SEP 26 2001, and it shall become effective as of this date or from the onset of production of communitized substances, whichever is earlier upon execution by the necessary parties, notwithstanding the date of execution, and upon approval by the Secretary of the Interior or by his duly authorized representative, and shall remain in force and effect as to the Pictured Cliffs formation for a period of 2 years and for as long as communitized substances are, or can be, produced from the communitized area in paying quantities: Provided, that prior to production in paying quantities from the communitized area and upon fulfillment of all requirements of the Secretary of the Interior, or his duly authorized representative, with respect to any dry hole or abandoned well, this agreement may be terminated at any time by mutual agreement of the parties hereto. This agreement shall not terminate upon cessation of production if, within 60 days thereafter, reworking or drilling operations on the communitized area are commenced and are thereafter conducted with reasonable diligence during the period of nonproduction. The 2 year term of this agreement will not in itself serve to extend the term of any Federal lease which would otherwise expire during said period.
11. The covenants herein shall be construed to be covenants running with the land with respect to the communitized interests of the parties hereto and their successors in interests until this agreement terminates and any grant, transfer or conveyance of any such land or interest subject hereto, whether voluntary or not, shall be and hereby is conditioned upon the assumption of all obligations hereunder by the grantee, transferee, or other successor in interest, and as to Federal land shall be subject to approval by the Secretary of the Interior, or his duly authorized representative.
12. It is agreed between the parties hereto that the Secretary of the Interior, or his duly authorized representative, shall have the right of supervision over all fee and State mineral operations within the communitized area to the extent necessary to monitor production and measurement, and assure that no avoidable loss of hydrocarbons occurs in which the United States has an interest pursuant to applicable oil and gas regulations of the Department of the Interior relating to such production and measurement.
13. This agreement shall be binding upon the parties hereto and shall extend to and be binding upon their respective heirs, executors, administrators, successors and assigns.

14. This agreement may be executed in any number of countries, no one of which needs to be executed by all parties, or may be ratified or consented to by separate instrument, in writing, specifically referring hereto, and shall be binding upon all parties who have executed such a counterpart, ratification or consent hereto with the same force and effect as if all parties had signed the same document.
15. Nondiscrimination: In connection with the performance of work under this agreement, the operator agrees to comply with all of the provisions of Section 202(1) to (7) inclusive, of Executive Order 11246 (30 F.R. 12319), as amended, which are hereby incorporated by reference in this agreement.

IN WITNESS WHEREOF, the parties hereto have executed this agreement as of the day and year first above written and have set opposite their respective names the date of execution.

RICHARDSON OPERATING COMPANY

Cathleen Colby *new*
Cathleen Colby, Attorney-in-Fact

Executed October 3, 2001

RICHARDSON PRODUCTION COMPANY

Cathleen Colby *new*
Cathleen Colby, Attorney-in-Fact

Executed October 3, 2001

STATE OF COLORADO)
) ss.
COUNTY OF DENVER)

The foregoing instrument was acknowledged before me this 3rd day of October, 2001 by Cathleen Colby, as Attorney-in-Fact on behalf of RICHARDSON PRODUCTION COMPANY and RICHARDSON OPERATING COMPANY.

My commission expires:

10-31-02

Dawn Marie Hupler
Notary Public

EXHIBIT A

Plat of communitized area covering NW/4 Section 8, Township 29 North, Range 14 West,
NMPM, Pictured Cliffs Field, San Juan County, New Mexico.

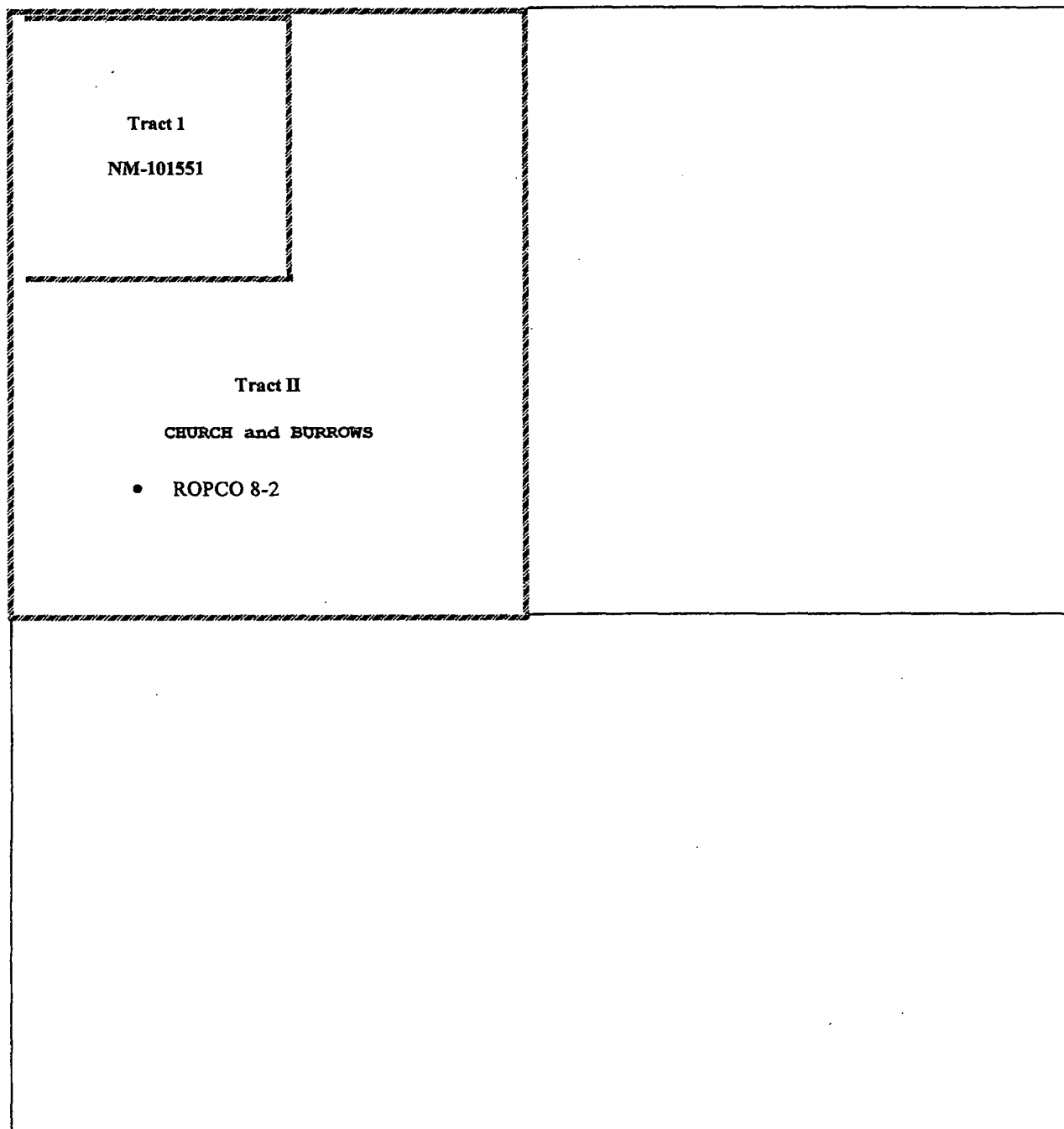

EXHIBIT B

To Communitization Agreement dated _____, embracing:

Township 29 North, Range 14 West, NMPM
Section 8: NW/4
San Juan County, New Mexico

Operator of Communitized Area: Richardson Operating Company

DESCRIPTION OF LEASES COMMITTED

Tract No. I

Lease Serial No.: USA NM 101551 / 47325 000
Lease Date: December 1, 1998
Lease Term: 10 years
Lessor: United States of America /
Present Lessee: 100% Richardson Production Company /
Description of Land Committed: Township 29 North, Range 14 West, NMPM
Section 8: NW/4NW/4 /
Number of Acres: 40.00 gross, 40.00 net /
Royalty Rate: 12.5%
Name and Percent ORRI Owners: None
Name and Percent WI Owners: 100% Richardson Production Company /

Tract No. II

Lease Serial No.: Fee 47317 001
Lease Date: April 14, 1998
Lease Term: 5 years
Lessor: Anne Burrows Church, a widow (50%)

Present Lessee:	100% Richardson Production Company ✓
Description of Land Committed:	<u>Township 29 North, Range 14 West, NMPM</u> ✓ Section 8: S/2NW/4, NE/4NW/4
Number of Acres:	120.00 gross, 60.000 net ✓
Royalty Rate:	12.5%
Name and Percent ORRI Owners:	NONE
Name and Percent WI Owners:	100% Richardson Production Company ✓
Pooling Clause:	Lease contains a provision authorizing pooling in accordance with the requirement of the agreement. ✓
Lease Serial No.:	Fee ✓
Lease Date:	April 14, 1998 47317 002
Lease Term:	5 years
Lessor:	Eva Thompson Burrows, a widow (50%)
Present Lessee:	100% Richardson Production Company ✓
Description of Land Committed:	<u>Township 29 North, Range 14 West, NMPM</u> ✓ Section 8: S/2NW/4, NE/4NW/4 ✓
Number of Acres:	120.00 gross, 60.000 net ✓
Royalty Rate:	12.5%
Name and Percent ORRI Owners:	NONE
Name and Percent WI Owners:	100% Richardson Production Company ✓
Pooling Clause:	Lease contains a provision authorizing pooling in accordance with the requirement of the agreement.

RECAPITULATION

<u>Tract No.</u>	<u>No. of Acres Committed</u>	<u>Percentage of Interest in Communitized Area</u>
1	40.000	25.000%
2	<u>120.000</u>	<u>75.000%</u>
	160.00	100.000%

**DEPARTMENT OF THE INTERIOR
BUREAU OF LAND MANAGEMENT
CASE RECORDATION
(MASS) Serial Register Page**

RunDate/Time: 02/19/09 02:12 PM

Page 1 of 3

01 02-25-1920;041STAT0437;30USC226
Case Type 311111: O&G LSE NONCOMP PUB LAND
Commodity 459: OIL & GAS L
Case Disposition: AUTHORIZED

Total Acres
2,523.720

Serial Number
NMSF-- 0 079968

Name & Address

CONOCOPHILLIPS CO	PO BOX 7500
CONOCOPHILLIPS CO	PO BOX 7500
LANCE OIL & GAS CO	1099 18TH ST #1200
RICHARDSON OPERATING CO	6400 S FIDDLER'S GREEN #1330
XTO ENERGY INC	810 HOUSTON ST #2000

BARTLESVILLE OK 74005
BARTLESVILLE OK 74005
DENVER CO 802021955
GREENWOOD VILLAGE CO 80111
FT WORTH TX 761026298

LESSEE	100.000000000
OPERATING RIGHTS	0.000000000
OPERATING RIGHTS	0.000000000
OPERATING RIGHTS	0.000000000
OPERATING RIGHTS	0.000000000

Serial Number: NMSF-- 0 079968

Int Rel % Interest

Serial Number: NMSF-- 0 079968

Mer Twp	Rng	Sec	S	T	SNr	Suff	Subdivision	District/Resource Area	County	Mgmt Agency
23	0290N	0140W	003	ALIC			S2NW,N2SW,SWSW;	FARMINGTON FO	SAN JUAN	BUREAU OF LAND MGMT
23	0290N	0140W	003	LOT:			3,4;	FARMINGTON FO	SAN JUAN	BUREAU OF LAND MGMT
23	0290N	0140W	004	ALIC			S2N2,S2;	FARMINGTON FO	SAN JUAN	BUREAU OF LAND MGMT
23	0290N	0140W	004	LOT:			1,2,3,4;	FARMINGTON FO	SAN JUAN	BUREAU OF LAND MGMT
23	0290N	0140W	005	ALIC			S2N2,N2SW,SWSW,SE;	FARMINGTON FO	SAN JUAN	BUREAU OF LAND MGMT
23	0290N	0140W	005	LOT:			1-4;	FARMINGTON FO	SAN JUAN	BUREAU OF LAND MGMT
23	0290N	0140W	008	ALIC			N2NE;	FARMINGTON FO	SAN JUAN	BUREAU OF LAND MGMT
23	0290N	0140W	009	ALIC			N2NE,SENE,NW,E2SE;	FARMINGTON FO	SAN JUAN	BUREAU OF LAND MGMT
23	0290N	0140W	010	ALIC			W2NW;	FARMINGTON FO	SAN JUAN	BUREAU OF LAND MGMT
23	0300N	0140W	033	ALIC			N2,N2SW,NESE;	FARMINGTON FO	SAN JUAN	BUREAU OF LAND MGMT
23	0300N	0140W	033	LOT:			3,4;	FARMINGTON FO	SAN JUAN	BUREAU OF LAND MGMT

Relinquished/Withdrawn Lands

23 0300N 0140W 720	FF	SENE REJ;
--------------------	----	-----------

FARMINGTON FO	SAN JUAN	BUREAU OF LAND
---------------	----------	----------------

Serial Number: NMSF-- 0 079968

Act Date Code Action

01/21/1948	124	APLN RECD
05/01/1951	237	LEASE ISSUED
05/23/1951	126	APLN REJ/DEN IN PART
07/01/1951	496	FUND CODE
07/01/1951	530	RLTY RATE - 12 1/2%
07/01/1951	868	EFFECTIVE DATE
11/27/1958	102	NOTICE SENT-PROD STATUS
10/19/1963	909	BOND ACCEPTED
06/10/1970	246	LEASE COMMITTED TO CA
05/03/1976	246	LEASE COMMITTED TO CA
06/01/1984	246	LEASE COMMITTED TO CA
04/23/1986	140	ASGN FILED
04/23/1986	932	TRF OPER RGTS FILED
08/04/1986	139	ASGN APPROVED
08/04/1986	933	TRF OPER RGTS APPROVED
08/11/1986	963	CASE MICROFILMED
04/04/1988	974	AUTOMATED RECORD VERIF
02/12/1990	575	APD FILED
06/26/1990	575	APD FILED

Action Remarks

05;145003
EFF 09/27/63;ES0085
SW631;
SRM1116;
NMNM76324;
MESA PETRO/OPER LTD
EFF 05/01/86;
EFF 05/01/86;
CNUM 103,398 AD
GLC/CB

Serial Number: NMSF-- 0 079968
Pending Office

**NO WARRANTY IS MADE BY BLM
FOR USE OF THE DATA FOR
PURPOSES NOT INTENDED BY BLM**

**DEPARTMENT OF THE INTERIOR
BUREAU OF LAND MANAGEMENT
CASE RECORDATION
(MASS) Serial Register Page**

RunDate/Time: 02/19/09 02:12 PM

Page 2 of 3

01 02-25-1920;041STAT0437;30USC226

Case Type 311111: O&G LSE NONCOMP PUB LAND

**Total Acres
2,523.720**

**Serial Number
NMSF-- 0 079968**

Commodity 459: OIL & GAS L

Case Disposition: AUTHORIZED

06/26/1990	575	APD FILED	(1)	
06/26/1990	575	APD FILED	(2)	
06/28/1990	575	APD FILED		
06/29/1990	575	APD FILED		
07/20/1990	575	APD FILED		
08/01/1990	576	APD APPROVED	30 FC FEDERAL COM	JC
08/01/1990	576	APD APPROVED	36 FC FEDERAL	JC
08/06/1990	575	APD FILED		
08/24/1990	576	APD APPROVED	31 FC FED COM	CLB
09/19/1990	576	APD APPROVED	14 FC FEDERAL	JC
05/16/1991	577	APD WDN/TERM/CANC	32 FC FED COM	CMG
05/16/1991	577	APD WDN/TERM/CANC	33 FC FED COM	CMG
05/16/1991	577	APD WDN/TERM/CANC	34 FC FED COM	CMG
05/16/1991	577	APD WDN/TERM/CANC	35 FC FED COM	CMG
05/20/1991	140	ASGN FILED	MESA OPER/CONOCO INC	
05/20/1991	932	TRF OPER RGTS FILED	MESA OPER/CONOCO INC	
07/26/1991	933	TRF OPER RGTS APPROVED	EFF 06/01/91;	
07/26/1991	974	AUTOMATED RECORD VERIF		SSP/AMR
07/31/1991	139	ASGN APPROVED	EFF 06/01/91;	
07/31/1991	974	AUTOMATED RECORD VERIF		ST/KRP
10/07/1991	577	APD WDN/TERM/CANC	30 FC FED COM	CLB
10/07/1991	577	APD WDN/TERM/CANC	31 FC FED COM	CLB
10/07/1991	577	APD WDN/TERM/CANC	36 FC FED	CLB
03/02/1992	932	TRF OPER RGTS FILED	MESA OPER LTD/CONOCO	
04/23/1992	933	TRF OPER RGTS APPROVED	EFF 04/01/92;	
04/23/1992	974	AUTOMATED RECORD VERIF		ST/JS
10/05/1992	646	MEMO OF LAST PROD-ACTUAL		
12/31/1995	235	EXTENDED	THRU 12/31/97;	
12/31/1995	522	CA TERMINATED	SW-631;	
02/08/1996	643	PRODUCTION DETERMINATION	/1/	
02/08/1996	647	MEMO OF LAST PROD-ALLOC	/1/NMNM74067;	
04/25/1996	643	PRODUCTION DETERMINATION	/1/	
04/25/1996	647	MEMO OF LAST PROD-ALLOC	/1/NMNM75930;	
05/01/1996	522	CA TERMINATED	NMNM75930;	
10/14/1997	932	TRF OPER RGTS FILED	CONOCO/RICHARDSON	
11/14/1997	933	TRF OPER RGTS APPROVED	EFF 11/01/97;	
11/14/1997	974	AUTOMATED RECORD VERIF	ANN	
03/04/2000	246	LEASE COMMITTED TO CA	NMNM103035	
03/09/2000	575	APD FILED	RICHARDSON OPER CO	
03/11/2000	246	LEASE COMMITTED TO CA	RICHARDSON OPER CO	
03/28/2000	575	APD FILED	RICHARDSON OPER CO	
05/22/2000	575	APD FILED	RICHARDSON OPER CO	
05/24/2000	576	APD APPROVED	1 WF FEDERAL 3	
05/24/2000	576	APD APPROVED	2 WF FEDERAL 3	
08/14/2000	575	APD FILED	/2/RICHARDSON OPER CO	
08/14/2000	575	APD FILED	RICHARDSON OPER CO	

**NO WARRANTY IS MADE BY BLM
FOR USE OF THE DATA FOR
PURPOSES NOT INTENDED BY BLM**

**DEPARTMENT OF THE INTERIOR
BUREAU OF LAND MANAGEMENT
CASE RECORDATION
(MASS) Serial Register Page**

RunDate/Time: 02/19/09 02:12 PM

Page 3 of 3

01 02-25-1920;041STAT0437;30USC226

Case Type 311111: O&G LSE NONCOMP PUB LAND

Total Acres
2,523.720

Serial Number
NMSF-- 0 079968

Commodity 459: OIL & GAS L

Case Disposition: AUTHORIZED

08/15/2000	576	APD APPROVED	1 WF FEDERAL 5
09/02/2000	246	LEASE COMMITTED TO CA	NMNM104847
09/21/2000	575	APD FILED	RICHARDSON OPER CO
09/26/2000	575	APD FILED	RICHARDSON OPER CO
10/05/2000	575	APD FILED	RICHARDSON OPER CO
10/12/2000	575	APD FILED	RICHARDSON OPER CO
11/02/2000	575	APD FILED	RICHARDSON OPER CO
11/13/2000	575	APD FILED	RICHARDSON OPER CO
11/16/2000	576	APD APPROVED	3 WF FEDERAL 33
11/30/2000	575	APD FILED	RICHARDSON OPER CO(1;
11/30/2000	575	APD FILED	RICHARDSON OPER CO(2;
11/30/2000	575	APD FILED	RICHARDSON OPER CO(3;
01/08/2001	246	LEASE COMMITTED TO CA	NMNM103036
01/31/2001	576	APD APPROVED	4 ROPCO 5
06/13/2001	246	LEASE COMMITTED TO CA	NMNM103096
04/11/2002	246	LEASE COMMITTED TO CA	NMNM110461;
06/12/2002	246	LEASE COMMITTED TO CA	NMNM108218
01/16/2003	817	MERGER RECOGNIZED	CONOCO/CONOCOPHILLIPS
04/09/2003	650	HELD BY PROD - ACTUAL	
05/30/2003	643	PRODUCTION DETERMINATION	/1/
05/30/2003	658	MEMO OF 1ST PROD-ACTUAL	/1/SF079968;WF FED 1R
01/09/2004	246	LEASE COMMITTED TO CA	NMNM108219
01/09/2004	246	LEASE COMMITTED TO CA	NMNM108220
01/13/2004	246	LEASE COMMITTED TO CA	NMNM108224
01/26/2004	899	TRF OF ORR FILED	GREER TRST/RICHARDSON
07/28/2004	932	TRF OPER RGTS FILED	CONOCO/RICHARDSON OPE
08/19/2004	933	TRF OPER RGTS APPROVED	EFF 08/01/04;
08/19/2004	974	AUTOMATED RECORD VERIF	JLV
10/14/2004	246	LEASE COMMITTED TO CA	NMNM108261
10/14/2004	932	TRF OPER RGTS FILED	RICHARDSON/LANCE OIL
12/08/2004	933	TRF OPER RGTS APPROVED	EFF 11/01/04;
12/08/2004	974	AUTOMATED RECORD VERIF	MV
03/16/2005	246	LEASE COMMITTED TO CA	NMNM108217
05/05/2005	246	LEASE COMMITTED TO CA	NMNM110596
08/23/2005	246	LEASE COMMITTED TO CA	NMNM108222;ROPCO 8 #1
08/24/2005	246	LEASE COMMITTED TO CA	NMNM108221;ROPCO 8 #1
05/23/2007	932	TRF OPER RGTS FILED	LANCE O&G/XTO ENERG;1
06/15/2007	899	TRF OF ORR FILED	1
07/25/2007	933	TRF OPER RGTS APPROVED	EFF 06/01/07;
07/25/2007	974	AUTOMATED RECORD VERIF	MV

Line Nr Remarks

Serial Number: NMSF-- 0 079968

0002	NMSF079968 HELD BY ALLOCATED PROD FROM NMNM76324.
0003	08/19/04-LESSEE-CONOCOPHILLIPS CO ES0048 NW
0004	12/08/2004 LANCE BONDED TRANSFEREE WYB000112/NW

**NO WARRANTY IS MADE BY BLM
FOR USE OF THE DATA FOR
PURPOSES NOT INTENDED BY BLM**

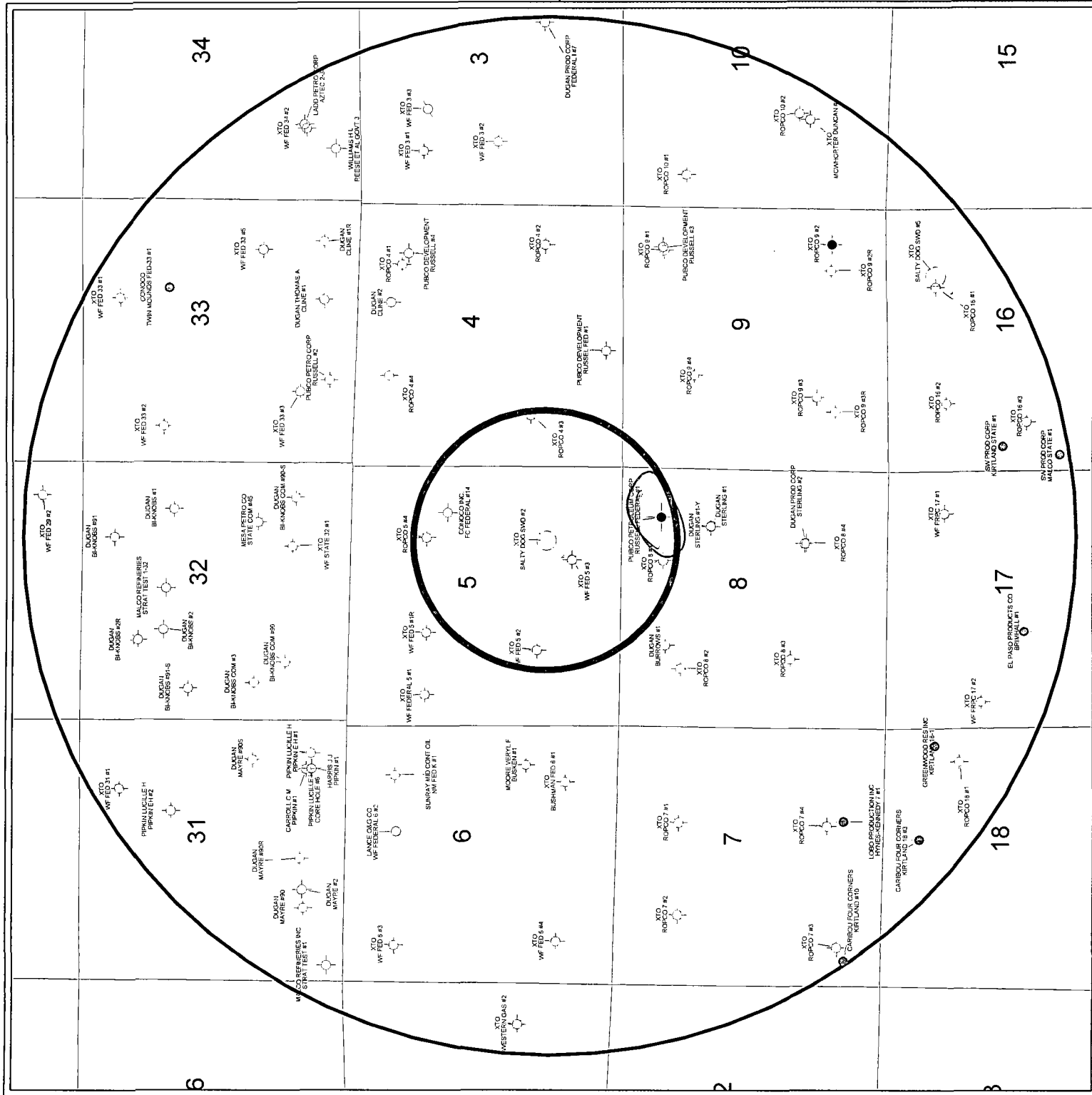

XTO ENERGY INC.

SALTY DOG #2 SWD

SEC. 5: T29N-R14W

SAN JUAN COUNTY, NM

1/2 MILE & 2 MILE RADIUS



POSTED WELL DATA

Operator
Well Label

WELL SYMBOLS

- Gas Well
- Dry Hole
- Injection Well
- Plugged and Abandoned
- Abandoned Well
- Temporarily Abandoned
- Oil Well

May 3, 2010

WELL NAME	API	LOCATION	FOOTAGES	FORMATION	DATE DRILLED	DEPTH	COMPLETION	TYPE	OPERATOR
ROPCO 4 #3	3004530394	L-4-29-14W	1830 FSL & 1060 FWL	Twin Mounds FR Sand-PC/ Basin Fruitland Coal	3/10/2001	1040'	12/5/2001	PGW	XTO ENERGY, INC
ROPCO 5 #4	3004530415	G-5-29N-14W	1520 FNL & 1420 FEL	Twin Mounds FR Sand-PC/ Basin Fruitland Coal	2/12/2001	940'	3/9/2001 3/13/2001	PGW	XTO ENERGY, INC
ROPCO 8 #1	3004530346	B-8-29N-14W	850 FNL & 1850 FEL	Twin Mounds FR Sand-PC	7/18/2001	900'	7/1/2002	PGW	XTO ENERGY, INC
WF Federal 5 #2	3004529853	K-5-29N-14W	1655 FSL & 1750 FWL	Twin Mounds FR Sand-PC/ Basin Fruitland Coal	1/14/2000	860'	3/11/2000	PGW	XTO ENERGY, INC
WF Federal 5 #3	3004529852	O-5-29N-14W	975 FSL & 1855 FEL	Twin Mounds FR Sand-PC/ Basin Fruitland Coal	3/9/2000	843'	9/3/2000 10/25/2006	PGW	XTO ENERGY, INC
FC Federal #14	3004528267	H-5-29N-14W	1920 FNL & 930 FEL	Basin Fruitland Coal	9/30/1990	971'	N/A	Dry Hole	Conoco Inc.
Russell Federal #1	3004508622	A-8-29N-14W	790 FNL & 990 FEL	Twin Mounds FR Sand-PC	8/9/1954	3386'	8/25/1954	AB	Pubco Petroleum Corp.

XTO ENERGY INC.
OPERATIONS PLAN
SALTY DOG #2

I. Location: Section 5, Township 29 North, Range 14 West, NMPM
1495' FSL and 1477' FEL
San Juan County, NM

Field: Blanco Mesaverde
Elevation: 5297'
Surface: Fee – XTO Energy, Inc.
Minerals: Federal NMSF-079968

II. Geology:	<u>Formation Tops</u>	<u>Depth</u>
	Fruitland Coal	684 feet
	Pictured Cliffs	698 feet
	Lewis Shale	883 feet
	Charca	1690 feet
	Cliff House	2267 feet
	Menefee	2300 feet
	Point Lookout	3231 feet
	Total Depth	3616 feet

Estimated depths of anticipated water, oil, gas and other mineral bearing formations which are expected to be encountered:

Water and gas:	684 feet	Fruitland Coal
	698 feet	Pictured Cliffs

Water:	2267 feet	Cliff House
	3231 feet	Point Lookout

- A. Logging Program: Induction/GR and Density Logs at TD
- B. The maximum expected bottom hole pressure is 400 psi. This pressure will be contained as specified in III B. and C. below. No overpressured zones are expected in this well. No H₂S zones are anticipated in this well.

III. Surface Csg: 8-5/8" 24#, J-55 Csg @ 251', hole cemented with 110 sx with CL B cmt. Circ cmt to surf.

Production Csg: 5-1/2" 15.5#, K-55 Csg @ 3,612'. Cmt'd w/165 sx CL B

Cmt with 2% metasilicated (12.5 ppg, 2.06 cuft/sx). Tailed in with 177 sx CL B cmt with 3#/sx gilsonite & ¼#/sx celloflake (15.6 ppg, 1.18 cuft/sx). Circ 8 bbls cmt to surf.

Stimulation: Perforated MV as follows: 2,388'-2,395', 2,464'-2,472', 2,478'-2,484', 2,556'-2,566', 2,730'-2,738', 2,790'-2,807', 2,914'-2,954', 3,088'-3,096' w/4 SPF, (120 Deg phasing, 0.38" dia, 21" pene). Acidize with 2,500 gals 7.5% HCL w/550 ball sealers 1.35g, ISDP 1,145 psig, 5" SIP - 948 psig. 10" SIP - 907 psig, 15" SIP - 866 psig.

IV. Proposed Stimulation: Perforate MV as follows: 3,252' - 3,276', 3,360' - 3,370', 3,438' - 3,442', 3,468' - 3,475' w/4 SPF, (120 Deg phasing, 0.49" EHD, 24.14" pene). Acidize MV perfs from 3,252' - 3,475' w/3,000 gal 15% HCL and 270 rubber ball sealers.

V. Operations: Average Daily Rate: 1,000 bwpd
Maximum Daily Rate: 1,500 bwpd
System is closed:
Average Injection Pressure: 1,000 psi
Maximum Injection Pressure: 1,300 psi

Tubing: 2-7/8" 6.5#, J-55 Tbg, EOT @ ±2,310'. Baker 5-1/2" x 2-7/8 Lok-Set Pkr ±@ 2,310'.

The final perforated interval will span from 2,388' - 3,475'.

Source of water to be injected is from Fruitland Coal and Pictured Cliffs wells in the area. Representative samples of this water are included in this report.

A water sample from the Mesaverde taken from the Stella Needs A Com #1E well, located in the NE/4SW/4 of Section 36, Township 30 North, Range 14 West, is also included in this report.

Geological data from the disposal zone is presented in Administrative Order SWD-595.

There are no fresh water wells within one mile of this location.

Examination of available geologic and engineering data reveals no evidence of open faults or any other hydrologic connection between the disposal zone and any underground sources of drinking water.



XTO - Wellbore Diagram

Well Name: Salty Dog SWD 02

API/UWI 30045308120000	E/W Dist (ft) 1,477.0	E/W Ref FEL	N/S Dist (ft) 1,495.0	N/S Ref FSL	Location T29N-R14W-S05	Field Name Blanco Mesaverde	County San Juan	State New Mexico
Well Configuration Type Vertical	XTO ID B 701165	Orig KB Elev (ft) 5,304.00	Gr Elev (ft) 5,297.00	KB-Grd (ft) 7.00	Spud Date 12/13/2001	PBTD (All) (ftKB) Original Hole - 3573.0	Total Depth (ftKB) 3,616.0	Method Of Production SWD

Well Config: Vertical - Original Hole, 5/10/2010 1:56:25 PM

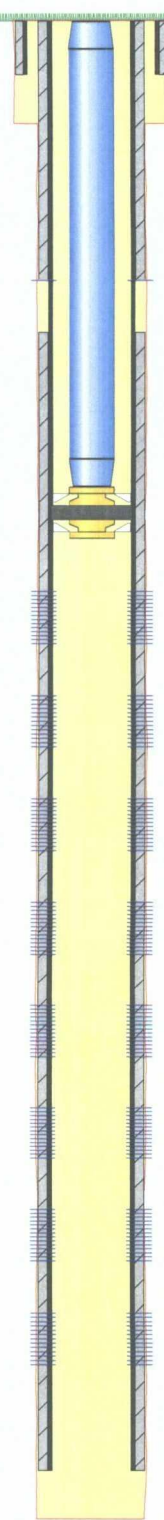
Schematic - Actual		Incl	ftKB (TVD)	ftKB (MD)	Zone	Top (ftKB)	Btm (ftKB)							
					Pictured Cliffs	698.0	883.0							
					Chacra	1,690.0	2,267.0							
					Mesaverde	2,388.0	3,573.0							
		Casing Strings												
					Casing Description	OD (in)	Wt (lbs/ft)	String Grade	Top Connection	Set Depth (ftKB)				
					Surface	8 5/8	24.00	J-55		258.0				
					Casing Description	OD (in)	Wt (lbs/ft)	String Grade	Top Connection	Set Depth (ftKB)				
					Production	5 1/2	15.50	K-55		3,612.0				
					Cement									
					Description	Type	String							
					Surface Casing Cement	casing	Surface, 258.0ftKB							
					Comment									
					110 sx cmt. Circ to surf.									
					Description	Type	String							
					Cement Squeeze	casing	Production, 3,612.0ftKB							
					Comment									
					Sqz holes @ 915'. Sqz w/222 sx cmt. Circ cmt to surf. 01/11/02									
					Description	Type	String							
					Production Casing Cement	casing	Production, 3,612.0ftKB							
					Comment									
					342 sx cmt. Circ 8 bbls cmt to surf. TOC @ 970' by CBL 01/10/02.									
					Perforations									
					Date	Top (ftKB)	Btm (ftKB)	Shot Dens (shots/ft)	Hole Diameter (in)	Phasing (°)	Curr... Status	Zone		
					1/11/2002	915.0	915.0	2.0	0.380					
					2/8/2002	2,388.0	2,398.0	4.0	0.380	120		Mesaverde		
					2/8/2002	2,464.0	2,472.0	4.0	0.380	120		Mesaverde		
					2/8/2002	2,478.0	2,484.0	4.0	0.380	120		Mesaverde		
					2/8/2002	2,556.0	2,566.0	4.0	0.380	120		Mesaverde		
					2/8/2002	2,730.0	2,738.0	4.0	0.380	120		Mesaverde		
					2/8/2002	2,790.0	2,807.0	4.0	0.380	120		Mesaverde		
					2/8/2002	2,914.0	2,954.0	4.0	0.380	120		Mesaverde		
					2/8/2002	3,088.0	3,096.0	4.0	0.380	120		Mesaverde		
					Tubing Strings									
					Tubing Description	Run Date		Set Depth (ftKB)						
					Tubing - Production	2/8/2002		2,310.0						
					Tubing Components									
					Item Description	Jts	Model	OD (in)	Wt (lbs/ft)	Gra...	Top Thread	Len (ft)	Top (ftKB)	Btm (ftKB)
					Tubing		T&C Upset	2 7/8	6.50	J-55		2,300.00	7.0	2,307.0
					Packer			2 7/8				3.00	2,307.0	2,310.0
					Rods									
					Rod Description	Run Date		String Length (ft)		Set Depth (ftKB)				
					Rod Components									
					Item Description	Jts	Model	OD (in)	Grade	Len (ft)	Top (ftKB)	Btm (ftKB)		
					Stimulations & Treatments									
					Frac Start Date	Top Perf (ft)	Bottom Pe...	V (slurry) (...	Total Prop...	AIR (b...	ATP (psi)	MTP (psi)	ISIP (psi)	
					2/9/2002	2388	3096							
					Comment									
					A. MV perms fr/2,388' - 3,096' dwn 2-7/8" tbg w/2,500 gal 7.5% HCl & 550 1.35 SG rubber BS									

Top (MD):698,
Des:Pictured Cliffs

Top (MD):1,690,
Des:Chacra

Top (MD):2,388,
Des:Mesaverde

PBTD,
3,573

TD,
3,616

PBTD,
3,573

TD,
3,616

XTO ENERGY, INC.
SALTY DOG SWD #2
PROPOSED CONFIGURATION

KB: 5,304'
 GL: 5,297'
 CORR: 7'

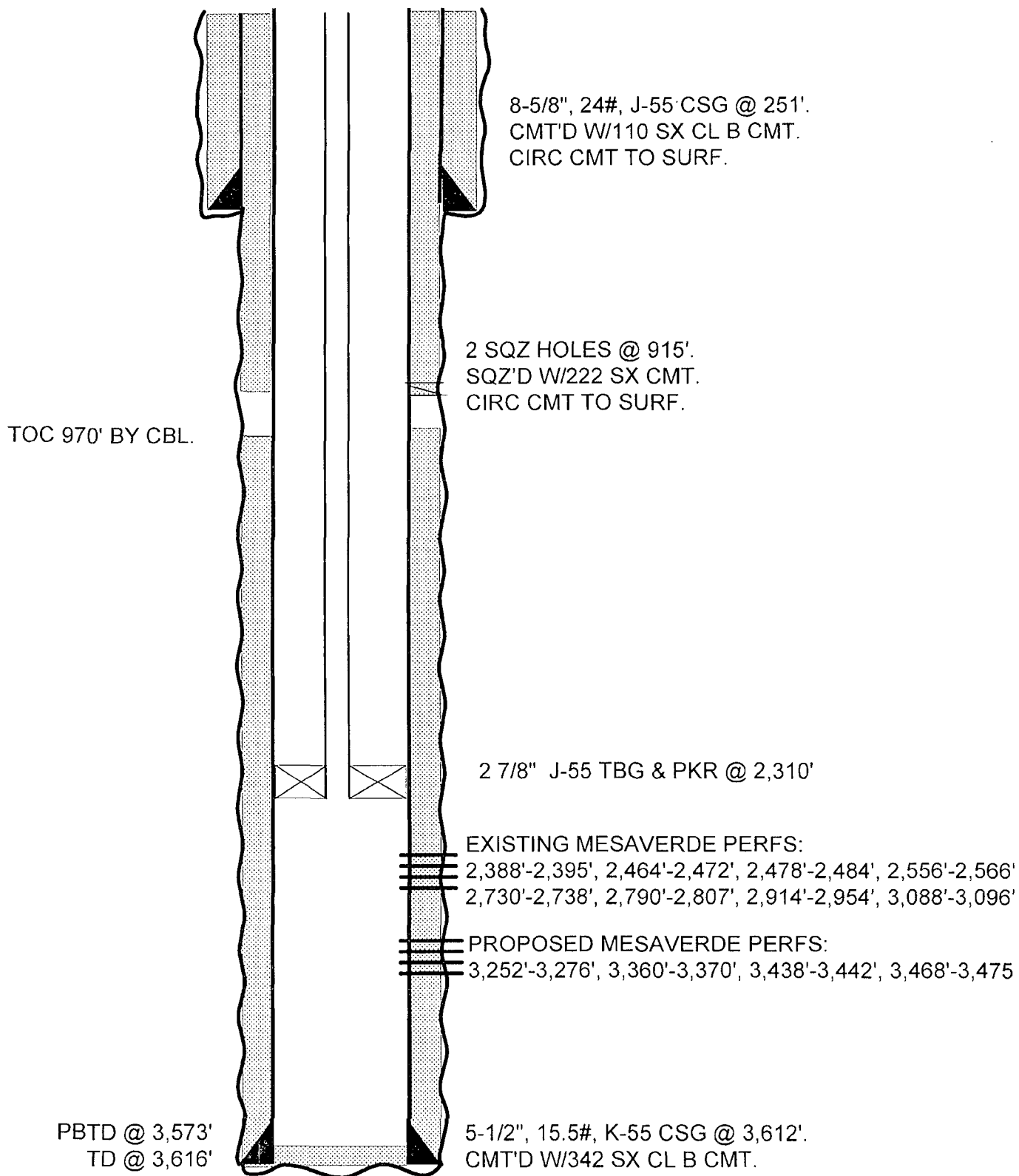



XTO - Well History

Well Name: **Salty Dog SWD 02**

API/UWI 30045308120000	Location T29N-R14W-S05	Field Name Blanco Mesaverde	Permit Number	State New Mexico	Well Configuration Type Vertical
Original KB Elevation (ft) 5,304.00	Ground Elevation (ft) 5,297.00	KB-Ground Distance (ft) 7.00	Spud Date 12/13/2001	Rig Release Date	Total Depth (ftKB) 3,616.0

Jobs DRILLING 12/13/2001

Start Date 12/13/2001	End Date 2/12/2002	Primary Job Type / Initial Job Type Drilling Original & Initial Completion	Total Field Estimated Cost
--------------------------	-----------------------	---	----------------------------

12/13/2001 00:00 - 12/13/2001 00:00

Operation Summary # 1

Roughneck Well Service spud 9-3/4" hole @ 08:00.

Remarks # 2

Construction Summary # 3

12/14/2001 00:00 - 12/14/2001 00:00

Operation Summary # 1

TD 9-3/4" hole @ 260'. TIH 8-5/8", 24#, J-55 csg & set @ 251' (GL). Cmt csg w/100 sx cl B cmt. Circ 11 bbls cmt to surf.

Remarks # 2

Construction Summary # 3

12/15/2001 00:00 - 12/15/2001 00:00

Operation Summary # 1

Begin drlg 6-3/4" hole.

Remarks # 2

Construction Summary # 3

1/4/2002 00:00 - 1/4/2002 00:00

Operation Summary # 1

TD 6-3/4" hole @ 3,616'.

Remarks # 2

Construction Summary # 3

1/7/2002 00:00 - 1/7/2002 00:00

Operation Summary # 1

RIH bull nose GS, 1 jt 5-1/2" csg, FC & 90 jts 5-1/2", 15.5#, K-55, LT&C csg. Set csg @ 3,612'. FC @ 3,573'. Cmt csg w/165 sx cl B cmt (2.06 cuft/sk, 12.5ppg) w/2% sodium mescalite, 3# gilsonite, & 1/4# celloflake. Tail in w/177 sx cl B cmt (1.18 cuft/sk, 15.6 ppg) w/3# gilsonite, & 1/4# celloflake. Circ 8 bbls cmt to surf.

Remarks # 2

Construction Summary # 3

1/8/2002 00:00 - 1/8/2002 00:00

Operation Summary # 1

MIRU Schlumberger. Ran CNL log. RDMO.

Remarks # 2

Construction Summary # 3

1/10/2002 00:00 - 1/10/2002 00:00

Operation Summary # 1

MIRU Schlumberger. Ran CBL log. TOC @ 970'.

Remarks # 2

Construction Summary # 3

1/11/2002 00:00 - 1/11/2002 00:00

Operation Summary # 1

RIH w/CIBP. Set CIBP @ 930'. Perf sqz holes @ 915' (0.38" EHD, 2 SPF, 2 ttl holes). MIRU PU. TIH model "R" pkr & 23 jts 2-3/8" tbq. Set pkr @ 750'. Pmp 222 sx Cl B cmt w/2 % CaCl2. Circ cmt.

Remarks # 2

Construction Summary # 3



XTO - Well History

Well Name: Salty Dog SWD 02

API/UWI 30045308120000	Location T29N-R14W-S05	Field Name Blanco Mesaverde	Permit Number	State New Mexico	Well Configuration Type Vertical
Original KB Elevation (ft) 5,304.00	Ground Elevation (ft) 5,297.00	KB-Ground Distance (ft) 7.00	Spud Date 12/13/2001	Rig Release Date	Total Depth (ftKB) 3,616.0

1/12/2002 00:00 - 1/12/2002 00:00

Operation Summary # 1

TOH tbg & pkr. TIH 4-3/4" bit & 2-3/8" tbg. Tg cmt @ 835'. DO cmt to CIBP @ 930'. PT csg & sqz holes to 1,000 psig. Tst OK. Begin DO CIBP.

Remarks # 2

Construction Summary # 3

1/15/2002 00:00 - 1/15/2002 00:00

Operation Summary # 1

DO CIBP @ 930'. TOH tbg & BHA.

Remarks # 2

Construction Summary # 3

2/6/2002 00:00 - 2/6/2002 00:00

Operation Summary # 1

MIRU Schlumberger. Ran reservoir saturation log. RDMO.

Remarks # 2

Construction Summary # 3

2/8/2002 00:00 - 2/8/2002 00:00

Operation Summary # 1

MIRU Schlumberger. RIH 4" perf gun. Perf MV as follows: 2,388' - 2,398', 2,464' - 2,472', 2,478' - 2,484', 2,556' - 2,566', 2,730' - 2,738', 2,790' - 2,807', 2,914' - 2,954, and 3,088' - 3,096' (4 SPF, 0.38" EHD, 120 deg, 428 ttl holes). RDMO. TIH 5-1/2" x 2-7/8" pkr & 2-7/8", 6.5#, J-55 tbg. Set pkr @ 2,310' per state sundry.

Remarks # 2

Construction Summary # 3

2/9/2002 00:00 - 2/9/2002 00:00

Operation Summary # 1

MIRU BJ acid. EIR @ 1,650 psig. A. w/2,500 gal 7.5% HCl. Drop 550 1.35 SG ball sealers. ISIP 1,145 psig. 5" 948 psig. 10" 907 psig. 15" 866 psig. RDMO.

Remarks # 2

Construction Summary # 3

3/1/2002 00:00 - 3/1/2002 00:00

Operation Summary # 1

Performed Step Rate Test. BHP sensors @ 2,954'. Max TP 2,464.13 psig @ 6.572 BPM IR. Max IR 7.629 BPM @ 2,262.70 psig BHP.

Remarks # 2

Construction Summary # 3

Jobs Well Maintenance 3/15/2002

Start Date 3/15/2002	End Date 3/15/2002	Primary Job Type / Initial Job Type RWTI	Total Field Estimated Cost
-------------------------	-----------------------	---	----------------------------

3/15/2002 00:00 - 3/15/2002 00:00

Operation Summary # 1

MAOP increased to 1,050 psig (prev 440 psig).

Remarks # 2

Construction Summary # 3

Jobs TESTING 11/21/2002

Start Date 11/21/2002	End Date 11/21/2002	Primary Job Type / Initial Job Type Test/Log/Profile	Total Field Estimated Cost
--------------------------	------------------------	---	----------------------------

11/21/2002 00:00 - 11/21/2002 00:00

Operation Summary # 1

Performed Step Rate Test. BHP sensor @ 2,900'. Max TP 2,607.61 psig @ 11.75 BPM IR. Max IR 11.75 BPM.

Remarks # 2

Construction Summary # 3



XTO - Well History

Well Name: Salty Dog SWD 02

API/UWI 30045308120000	Location T29N-R14W-S05	Field Name Blanco Mesaverde	Permit Number	State New Mexico	Well Configuration Type Vertical
Original KB Elevation (ft) 5,304.00	Ground Elevation (ft) 5,297.00	KB-Ground Distance (ft) 7.00	Spud Date 12/13/2001	Rig Release Date	Total Depth (ftKB) 3,616.0

Jobs Well Maintenance 12/1/2002

Start Date 12/1/2002	End Date 12/1/2002	Primary Job Type / Initial Job Type RWTI	Total Field Estimated Cost
-------------------------	-----------------------	---	----------------------------

12/1/2002 00:00 - 12/1/2002 00:00

Operation Summary # 1

MAOP increased to 1,300 psig (prev 1,050 psig).

Remarks # 2

Construction Summary # 3

Jobs Well Maintenance 6/14/2007

Start Date 6/14/2007	End Date 6/14/2007	Primary Job Type / Initial Job Type MIT	Total Field Estimated Cost
-------------------------	-----------------------	--	----------------------------

6/14/2007 00:00 - 6/14/2007 00:00

Operation Summary # 1

Met Monica Kuehling w/ N.M. OCD on location to PT pkr. MIRU H&M Precision pmp trk. PT csg to 380 psig w/11 gals 2 % KCL wtr. Press held @ 380 psig for 30". RDMO H&M pmp trk.

Remarks # 2

Construction Summary # 3

Jobs TESTING 8/12/2008

Start Date 8/12/2008	End Date 8/15/2008	Primary Job Type / Initial Job Type Test/Log/Profile	Total Field Estimated Cost
-------------------------	-----------------------	---	----------------------------

8/12/2008 00:00 - 8/12/2008 00:00

Operation Summary # 1

SITP 520 psig, SICP 260 psig. Phoenix Services LLC SL trk. RU 5K lub. RIH w/2.347" GR to donut. POH. RIH w/1.906" GR to 3,510'. POH. RU ppg tee. RIH w/XTO tandem 3,500 psig BHP gauges (#5436 & #5437) to 2,310'. Hung off & left gauges in to monitor well. MV perfs fr/2,388' - 3,096'. RDMO SL trk.

Remarks # 2

Construction Summary # 3

8/13/2008 00:00 - 8/13/2008 00:00

Operation Summary # 1

MIRU Superior Well Services pmp trk. Monica Kuehling w/NMOCD on loc & witnessed operations. SITP 500 psig. SICP 650 psig. SIBHP 0 psig. EIR dwn tbq. Ppd Step Rate Test as follows: 1st step 0.5 BPM @ ave TP 1,065 psig, SICP 670 psig, SIHBP 0 psig for 16 min. 2nd step 1.0 BPM @ ave TP 1,200 psig, SICP 670 psig, SIHBP 0 psig for 22 min. 3rd step 1.5 BPM @ ave TP 1,235 psig, SICP 670 psig, SIHBP 0 psig for 20 min. 4th step 2.0 BPM @ ave TP 1,335 psig, SICP 670 psig, SIHBP 0 psig for 20 min. 5th step 2.5 BPM @ ave TP 1,440 psig, SICP 670 psig, SIHBP 0 psig for 20 min. 6th step 3.0 BPM @ ave TP 1,520 psig, SICP 670 psig, SIHBP 0 psig for 20 min. 7th step 3.5 BPM @ ave TP 1,635 psig, SICP 670 psig, SIHBP 0 psig for 20 min. 8th step 4.0 BPM @ ave TP 1,770 psig, SICP 670 psig, SIHBP 0 psig for 20 min. Pmp trk transmission overheating. SD step rate test. ISIP 1,240 psig. 5" SIP 1,123 psig. 10" SIP 1,082 psig. 15" SIP 1,044 psig. Ppd ttl 356 BPW. SWI. RDMO pmp trk.

Remarks # 2

Construction Summary # 3

8/15/2008 00:00 - 8/15/2008 00:00

Operation Summary # 1

SITP 600 psig, SICP 480 psig. MI Phoenix Serv. POH w/tandem BHP gauges fr/2310' making gradient stops. RDMO Phoenix Serv SL trailer (trailer RU on well for 3 days).

Remarks # 2

Construction Summary # 3

Jobs Well Maintenance 7/1/2009

Start Date 7/1/2009	End Date 7/1/2009	Primary Job Type / Initial Job Type RWTI	Total Field Estimated Cost
------------------------	----------------------	---	----------------------------

7/1/2009 10:00 - 7/1/2009 10:01

Operation Summary # 1

SITP 461. SICP 0. Std inj dwn tbq at 10:00 A.M. 07/01/09. Inj press 1,125 psig. Inj rate 1,125 BPD.

Remarks # 2

Construction Summary # 3

State of New Mexico
Energy, Minerals & Mining Resources Department
OIL CONSERVATION DIVISION
2040 South Pacheco
Santa Fe, NM 87505

Form C - 102

☐ AMENDED REPORT

WELL LOCATION AND ACREAGE DEDICATION PLAT

APA Number	Pool Code	Pool Name
Property Code	Property Name SALTY DOG	Well Number 2
OGHD No.	Operator Name RICHARDSON OPERATING COMPANY	Elevation 5297'

Surface Location								
UL or Lot J	Sec. 5	Twp. 29 N.	Rge. 14 W.	Lot Id.	Feet from North/South 1495	Feet from East/West 1477	East/West EAST	County SAN JUAN

Bottom Hole Location if Different From Surface								
UL or Lot	Sec.	Twp.	Rge.	Lot Id.	Feet from North/South	Feet from East/West	East/West	County

Dedication	Joint ?	Consolidation	Order No.
------------	---------	---------------	-----------

NO ALLOWABLE WELL ASSIGNED TO THIS COMPLETION UNTIL ALL INTERESTS HAVE BEEN CONSOLIDATED
OR A NON-STANDARD UNIT HAS BEEN APPROVED BY THE DIVISION

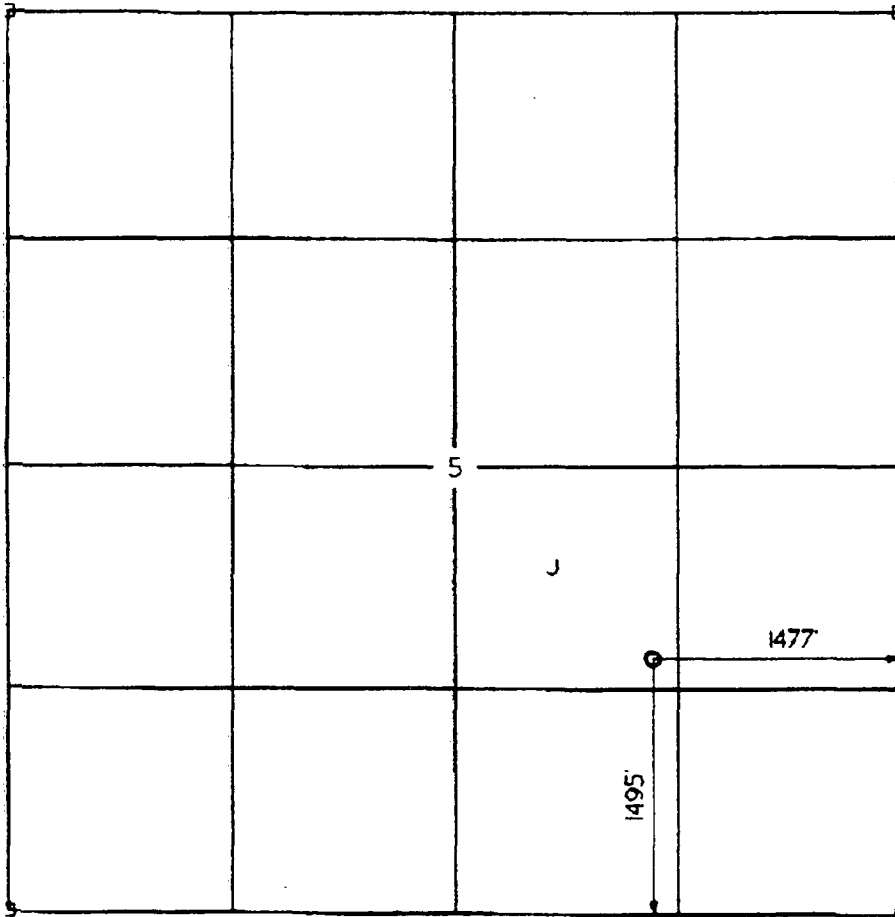

OPERATOR CERTIFICATION
I hereby certify that the information contained herein is true and complete to the best of my knowledge and belief.

Signature

Printed Name

Title

Date

SURVEYOR CERTIFICATION

I hereby certify that the well location on this plat was plotted from field notes of actual surveys made by me or under my supervision, and that the same is true and correct to the best of my belief.

Date of Survey

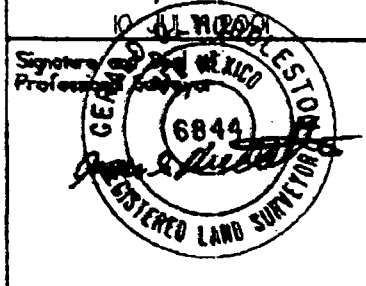

Dugan Production Corp.

COMPANY OF NORTH AMERICA

Stella Needs A Com No. 1 - Conversion to SWD

API WATER ANALYSIS

Company: DUGAN PROD.

W.C.N.A. Sample No.: S106695

Field:

Legal Description:

Well: STELLA NEEDS A COM #1E

Lease or Unit:

Depth:

Water.B/D:

Formation: POINT LOOKOUT/MESA VERDE

Sampling Point: SWAB

State: N.M.

Sampled By: J. ALEXANDER

County:

Date Sampled: 04/24/95

Type of Water(Produced,Supply, ect.):

PROPERTIES

pH: 6.30

Iron, Fe(total): 250

Specific Gravity: 1.050

Sulfide as H₂S: 0

Resistivity (ohm-meter): .13

Total Hardness:

Temperature: 78F

(see below)

DISSOLVED SOLIDS

CATIONS	mg/l	me/l
Sodium, Na:	20470	: 890
Calcium, Ca:	2084	: 104
Magnesium, Mg:	170	: 14
Barium, Ba:	N/A	: N/A
Potassium, K:		:

Sample(ml): 1.0 ml of EDTA: 5.20
Sample(ml): 1.0 ml of EDTA: .70

ANIONS	mg/l	me/l
Chloride, Cl:	31905	: 900
Sulfate, SO ₄ :	3750	: 78
Carbonate, CO ₃ :		:
Bicarbonate, HCO ₃ :	1830	: 30

Sample(ml): 1.0 ml of AgNO₃: 1.80
Sample(ml): 1.0 ml of H₂SO₄:
Sample(ml): 1.0 ml of H₂SO₄: .30

Total Dissolved

Solids (calculated): 60209

Total Hardness: 5900

Sample(ml): 1.0 ml of EDTA:

REMARKS AND RECOMMENDATIONS:

WATER PATTERNS-me/l

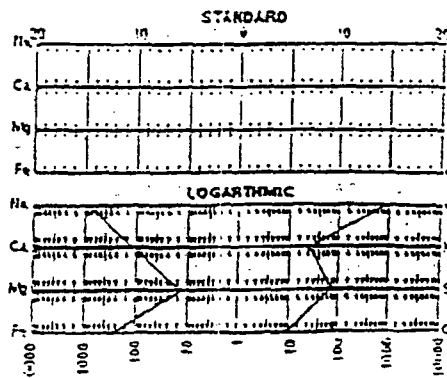

Analyst: DC
Date Analyzed: 4/24/95

BJ SERVICES COMPANY

WATER ANALYSIS #FW01W266

FARMINGTON LAB

GENERAL INFORMATION

OPERATOR:	RICHARDSON OPERATING	DEPTH:	
WELL:	BUSHMAN FEDERAL 6-1	DATE SAMPLED:	10/19/98
FIELD:	SEC06/T29N/R14W	DATE RECEIVED:	10/20/98
SUBMITTED BY:	BRAD SALZMAN	COUNTY:	SAN JUAN
WORKED BY	:D. SHEPHERD	FORMATION:	PC/PC
PHONE NUMBER:		STATE:	NM

SAMPLE DESCRIPTION

SAMPLE FOR ANALYSIS

PHYSICAL AND CHEMICAL DETERMINATIONS

SPECIFIC GRAVITY:	1.015	@ 74°F	PH:	7.49
RESISTIVITY (MEASURED):	0.280	ohms @ 76°F		
IRON (FE++) :	0 ppm	SULFATE:	39 ppm	
CALCIUM:	158 ppm	TOTAL HARDNESS	710 ppm	
MAGNESIUM:	77 ppm	BICARBONATE:	1,719 ppm	
CHLORIDE:	12,574 ppm	SODIUM CHLORIDE (Calc)	20,685 ppm	
SODIUM+POTASS:	8,493 ppm	TOT. DISSOLVED SOLIDS:	23,536 ppm	
H2S: NO TRACE		POTASSIUM (PPM):	110 PPM	

REMARKS

SAMPLED FROM SEPERATOR

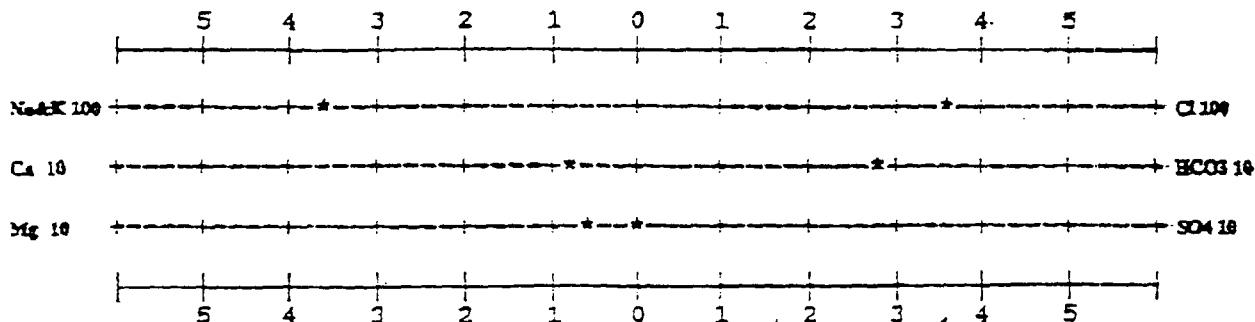
STIFF TYPE PLOT (IN MEQ/L)

ANALYST

D. SHEPHERD



382 Road 3100 Aztec, New Mexico 87410
Phone: (505) 333-3100 FAX: (505) 333-3280

May 13, 2010

State of New Mexico
Oil Conservation Division
Mr. William Jones
1220 South Saint Francis Drive
Santa Fe, New Mexico 87505

RECEIVED

MAY 14 2010

Bureau of Land Management
Farmington Field Office

Re: Salt Water Disposal Application
Salty Dog No. 2 Well
Section 5, Township 29 North, Range 14 West, NMPM
San Juan County, New Mexico

Dear Mr. Jones:

XTO Energy Inc. is requesting approval to add additional Mesaverde perforations from 3,252' to 3,475'. The additional perforations will significantly increase the daily disposal capacity of this well. Richardson Operating Company was previously authorized to inject from 2,200' to 3,580', as per Administrative Order SWD-811, dated September 13, 2001. Enclosed please find one original and one copy of the complete Salt Water Disposal Application. A copy has been furnished to the Aztec OCD Office and the Farmington BLM Office.

This well was completed in the Blanco Mesaverde field on January 6, 2002. XTO owns the surface where this well is located.

There is only one well which penetrates the injection zone within one half mile of the Salty Dog No. 2 location. The plugged and abandoned Pubco-Carr-Russell Federal No. 1 well is located in the NE/4NE/4 of Section 8, T29N, R14W. The five wells within the area of review are Fruitland Coal wells operated by XTO Energy. Pertinent well records are attached.

Information from the State Engineer's Office in Aztec indicates there are no shallow fresh water wells within one half mile of the Salty Dog No. 2 location.

Should you require further documentation please feel free to call my office @ 505-333-3100 or e-mail Diane_Jaramillo@xtoenergy.com and I will be happy to furnish any additional information.

Mr. Alexander Bridge is the engineer in charge should you need clarification of engineering data and is available at the number listed above.

Yours truly,

A handwritten signature in black ink, appearing to read 'Diane Jaramillo'.

Diane Jaramillo
Supervisor, Engineering Techs/Accounting

CC: Aztec OCD
BLM – Farmington



382 Road 3100 Aztec, New Mexico 87410
Phone: (505) 333-3100 FAX: (505) 333-3280

May 13, 2010

Conoco/Phillips
Burlington Resources Oil & Gas LP
3401 East 30th
Farmington, NM 87402

Re: XTO Energy, Inc. Application for Authorization to Inject
Salty Dog No. 2
NW/4SE/4, Section 5, T29N-R14W
San Juan County, New Mexico

To Whom It May Concern:

As a leasehold owner within one-half mile of the proposed Salty Dog No. 2 disposal well, you are being notified of our Application for Authorization to Inject request to add additional Mesaverde perforations from 3,252' to 3,475'. Richardson Operating Company was previously authorized to inject from 2,200' to 3,580', as per Administrative Order SWD-811, dated September 13, 2001. XTO seeks to dispose of water produced from the Fruitland Coal and Pictured Cliffs formations into the Mesaverde formation.

Interested parties must file objections or requests for hearing with the NM Oil Conservation Division, 1220 South Saint Francis Dr., Santa Fe, NM 87505 within 15 days.

Additional information may be obtained by contacting Alexander Bridge, 382 CR 3100, Aztec, NM 87410, (505) 333-3100.

Yours truly,

A handwritten signature in black ink, appearing to read 'Diane Jaramillo', is written over a horizontal line.

Diane Jaramillo
Supervisor, Accounting/Engineering Techs

SENDER: COMPLETE THIS SECTION

- ☐ Complete items 1, 2, and 3. Also complete item 4 if Restricted Delivery is desired.
- ☐ Print your name and address on the reverse so that we can return the card to you.
- ☐ Attach this card to the back of the mailpiece, or on the front if space permits.

1. Article Addressed to:

Conoco/Phillips
Burlington Resources Oil & Gas
3401 EAST 30th
FARMINGTON, NM 87402

COMPLETE THIS SECTION ON DELIVERY

A. Signature

[Signature]

- ☐ Agent
☐ Addressee

B. Received by (Printed Name)

[Signature]

C. Date of Delivery

5-17-10

- D. Is delivery address different from item 1? ☐ Yes
If YES, enter delivery address below: ☐ No

3. Service Type

- ☐ Certified Mail ☐ Express Mail
☒ Registered ☐ Return Receipt for Merchandise
☐ Insured Mail ☐ C.O.D.

4. Restricted Delivery? (Extra Fee) ☐ Yes

7008 0150 0003 4774 0497

PS Form 3811, February 2004

Domestic Return Receipt

102595-02-M-1540

02-M-1540

Conoco/Phillips
Burlington Resources Oil & Gas LP
3401 East 30th
Farmington, NM 87402

XTO Energy, Inc.
382 CR 3100
Aztec, New Mexico 87410

U.S. Postal Service™

CERTIFIED MAIL™ RECEIPT

(Domestic Mail Only; No Insurance Coverage Provided)

For delivery information visit our website at www.usps.com

OFFICIAL USE

Postage	\$
Certified Fee	
Return Receipt Fee (Endorsement Required)	
Restricted Delivery Fee (Endorsement Required)	
Total Postage & Fees	\$

Postmark
Here

Sent To	Conoco Phillips B206
Street, Apt. No., or PO Box No.	3401 E 30th
City, State, ZIP+4	FARMINGTON, NM 87402

7008 0150 0003 4774 0497

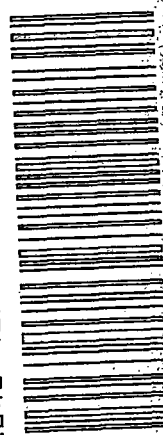



382 Road 3100 Aztec, New Mexico 87410
Phone: (505) 333-3100 FAX: (505) 333-3280

May 13, 2010

Western Gas Resources
1099 18th Street, Suite 1200
Denver, CO 80202

Re: XTO Energy, Inc. Application for Authorization to Inject
Salty Dog No. 2
NW/4SE/4, Section 5, T29N-R14W
San Juan County, New Mexico

To Whom It May Concern:

As a leasehold owner within one-half mile of the proposed Salty Dog No. 2 disposal well, you are being notified of our Application for Authorization to Inject request to add additional Mesaverde perforations from 3,252' to 3,475'. Richardson Operating Company was previously authorized to inject from 2,200' to 3,580', as per Administrative Order SWD-811, dated September 13, 2001. XTO seeks to dispose of water produced from the Fruitland Coal and Pictured Cliffs formations into the Mesaverde formation.

Interested parties must file objections or requests for hearing with the NM Oil Conservation Division, 1220 South Saint Francis Dr., Santa Fe, NM 87505 within 15 days.

Additional information may be obtained by contacting Alexander Bridge, 382 CR 3100, Aztec, NM 87410, (505) 333-3100.

Yours truly,

A handwritten signature in black ink, appearing to read 'Diane Jaramillo', is written over a horizontal line.

Diane Jaramillo
Supervisor, Accounting/Engineering Techs

SENDER: COMPLETE THIS SECTION

- Complete items 1, 2, and 3. Also complete item 4 if Restricted Delivery is desired.
- Print your name and address on the reverse so that we can return the card to you.
- Attach this card to the back of the mailpiece, or on the front if space permits.

1. Article Addressed to:

Western Gas Resources
1099 18th St, Suite 1200
Denver, CO 80202

2. Article Number:
7008 0150 0003 4774 0503

PS Form 3811, February 2004

COMPLETE THIS SECTION ON DELIVERY

A. Signature: *[Signature]*
☒ Agent
☐ Addressee

B. Received by (Printed Name): *DANIEL CORONA*
C. Date of Delivery: *5/17/10*

D. Is delivery address different from item 1? ☐ Yes
If YES, enter delivery address below: ☐ No

3. Service Type:
☒ Certified Mail ☐ Express Mail **FWD**
☐ Registered ☐ Return Receipt for Merchandise
☐ Insured Mail ☐ C.O.D.

4. Restricted Delivery? (Extra Fee) ☐ Yes

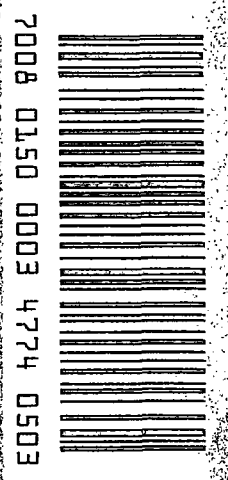

Western Gas Resources
1099 18th Street, Suite 1200
Denver, CO 80202

XTO Energy, Inc.
382 CR 3100
Aztec, New Mexico 87410

U.S. Postal ServiceTM
CERTIFIED MAILTM RECEIPT
(Domestic Mail Only; No Insurance Coverage Provided)

For delivery information visit our website at www.usps.com

OFFICIAL USE

Postage	\$
Certified Fee	
Return Receipt Fee (Endorsement Required)	
Restricted Delivery Fee (Endorsement Required)	
Total Postage & Fees	\$

Postmark
Here

Sent To: *Western Gas Resources*
Street, Apt. No., or PO Box No.: *1099 18 St, Suite 1200*
City, State, ZIP+4: *Denver, CO 80202*

AFFIDAVIT OF PUBLICATION

Ad No. 64577

STATE OF NEW MEXICO County of San Juan:

CONNIE PRUITT, being duly sworn says:
That she is the ADVERTISING DIRECTOR of
THE DAILY TIMES, a daily newspaper of
general circulation published in English at
Farmington, said county and state, and that
the hereto attached Legal Notice was
published in a regular and entire issue of the
said DAILY TIMES, a daily newspaper duly
qualified for the purpose within the meaning of
Chapter 167 of the 1937 Session Laws of the
State of New Mexico for publication and
appeared in the Internet at The Daily Times
web site on the following day(s):

Wednesday, May 12, 2010

And the cost of the publication is \$63.66

Connie Pruitt

ON 6/8/10 CONNIE PRUITT
appeared before me, whom I know personally
to be the person who signed the above
document.

Christine Sellers

My Commission Expires - 11/05/11

COPY OF PUBLICATION

Public Notice
XTO Energy, Inc.
is applying with
the New Mexico
Oil Conservation
Division
(NMOCD) for ap-
proval to add ad-
ditional
Mesaverde perfor-
ations from 3,252'
to 3,475' in the
Salty Dog #2 SWD
well. The Salty
Dog #2 SWD well
is located at 1,495'
FSL & 1,477' FEL,
Sec 5, T29N-R14W,
San Juan County,
NM. Currently,
the well disposes
of produced water
from oil and gas
wells into the
Mesaverde forma-
tion at a depth of
2,388' to 3,096'. Af-
ter the proposed
perforations are
added, the well
will dispose of wa-
ter produced from
oil and gas wells
into the
Mesaverde forma-
tion at a depth of
2,388' to 3,475' at a
maximum rate of
1,500 barrels of
water per day and
a maximum pres-
sure of 1,300 psi.
Interested parties
must file objec-
tions or requests
for hearing with
the NM Oil Con-
servation Division,
1220, South Saint
Francis Drive,
Santa Fe, NM
87505, within 15
days. Additional
information can
be obtained by
contacting
Alexander Bridge,
382 CR 3100, Az-
tec, NM 87410,
(505) 333-3100.

Legal No. 64577
published in The
Daily Times on
May 12, 2010.

Rubco-Carr-Russel Federal #1

Sec 8, T29N-R14W
790' FNL & 990' FEL
Plugged 1/26/60

GL: 5,332.4'

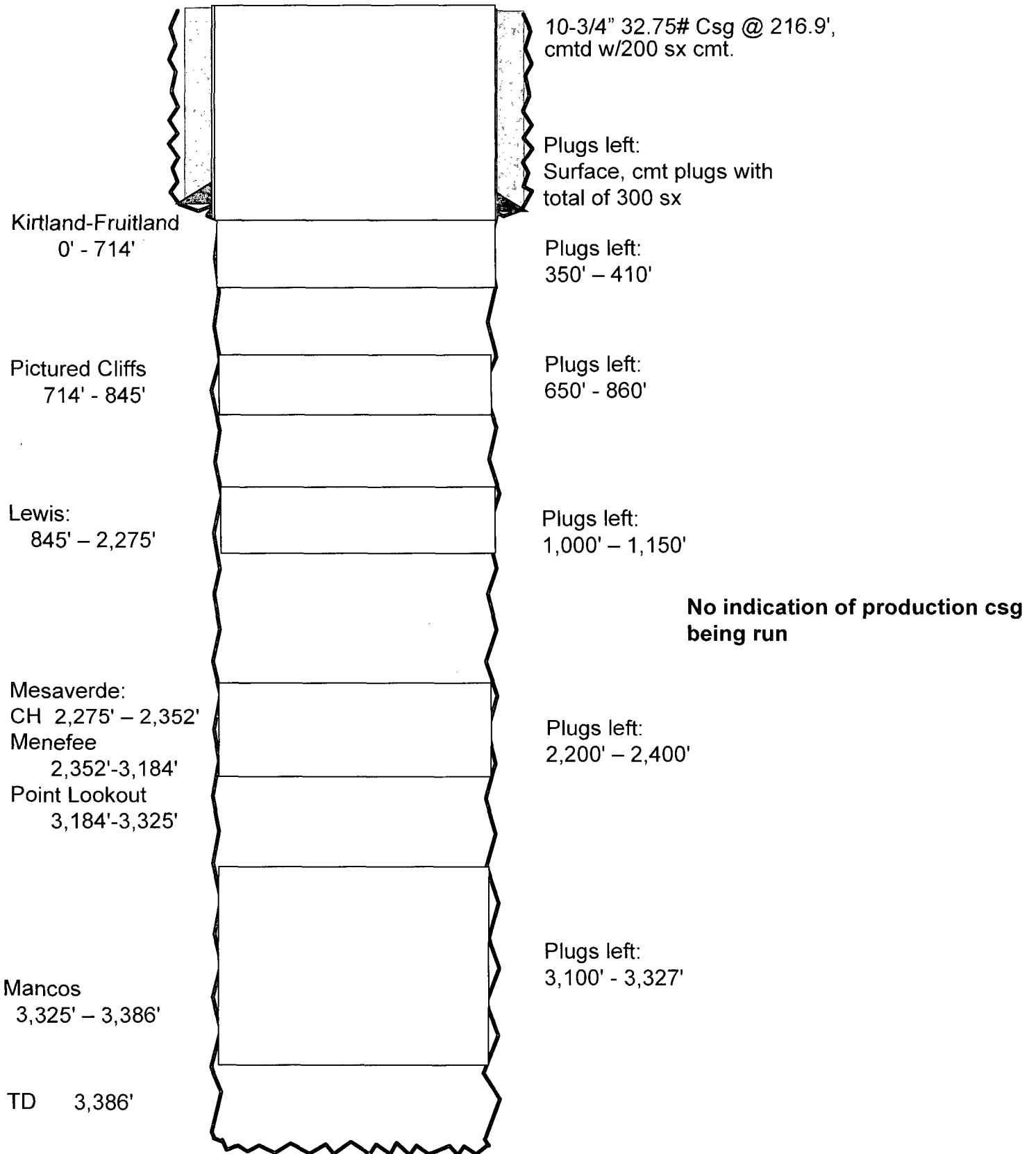

Form 9-381a
(Feb. 1951)

To: Cathy 1-303-930-8009
From: Ken at CHouse 334-9471

(SUBMIT IN TRIPLICATE)

UNITED STATES
DEPARTMENT OF THE INTERIOR
GEOLOGICAL SURVEY

Land Office

Lease No.

Unit

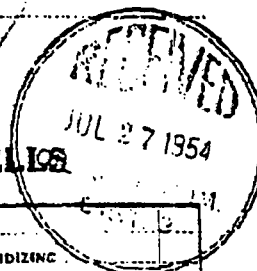

SUNDRY NOTICES AND REPORTS ON WELLS

NOTICE OF INTENTION TO DRILL	<input checked="" type="checkbox"/>	SUBSEQUENT REPORT OF WATER SHUT-OFF
NOTICE OF INTENTION TO CHANGE PLANS	<input type="checkbox"/>	SUBSEQUENT REPORT OF SHOOTING OR ACIDIZING
NOTICE OF INTENTION TO TEST WATER SHUT-OFF	<input type="checkbox"/>	SUBSEQUENT REPORT OF ALTERING CASING
NOTICE OF INTENTION TO RE-DRILL, OR REPAIR WELL	<input type="checkbox"/>	SUBSEQUENT REPORT OF RE-DRILLING OR REPAIR
NOTICE OF INTENTION TO SHOOT OR ACIDIZE	<input type="checkbox"/>	SUBSEQUENT REPORT OF ABANDONMENT
NOTICE OF INTENTION TO PULL OR ALTER CASING	<input type="checkbox"/>	SUPPLEMENTARY WELL HISTORY
NOTICE OF INTENTION TO ABANDON WELL	<input type="checkbox"/>	

(INDICATE ABOVE BY CHECKING NAME, NATURE OF REPORT, NOTICE, OR OTHER DATA)

July 27, 1954

Petro-Cart Russell Federal

Well No. 1 is located 100 ft. from $\begin{pmatrix} N \\ 6 \end{pmatrix}$ line and 100 ft. from $\begin{pmatrix} E \\ W \end{pmatrix}$ line of sec. 1

Section 6 (Of Sec. and Range) T4N (Top) R4E (Range) S4E (Meridian)

Town of New Mexico (Name) C. H. Jones (County or subdivision) New Mexico (State or Territory)

The elevation of the ~~surface~~ ^{ground level} above sea level is 5332.4 ft.

DETAILS OF WORK

(State names of and estimated depths to objective sands, show clearly, with line, and length of proposed sections, indicate important points, and all other important proposed work)

It is proposed to drill with rotary tools to the top of the ~~surface~~ ^{base}, estimated to be at a depth of 3000 feet. It is proposed to core and drill stem test the Pictured Cliff formation and several possible zones in the Mesaverde formation. Tentative casing program as follows:

10-3/4" surface casing 2500 feet
Production string

Drilling Unit: NE 1/4 of Section 8 - ~~Blind~~ Mesaverde lease.

A Blanket Drilling Bond has heretofore been filed and approved by the Commission.

I understand that this plan of work must receive approval in writing by the Geological Survey before operations may be commenced.

Company Petro Development, Inc.

Address Post Office Box 1366

Albuquerque, New Mexico

By *Charles D. Carlson, Jr.*

Title Vice-President

Company PUBCO DEVELOPMENT CO.

Tract PUBCO-CARR-RUSSELL FEDERAL. Well No. 1

Sec. 8 T. 29 N R. 14 W N.M.P.M.

LOCATION 790 feet from north line; 890 feet from east line.

Elevation: 6852.4 OL

San Juan County

New Mexico

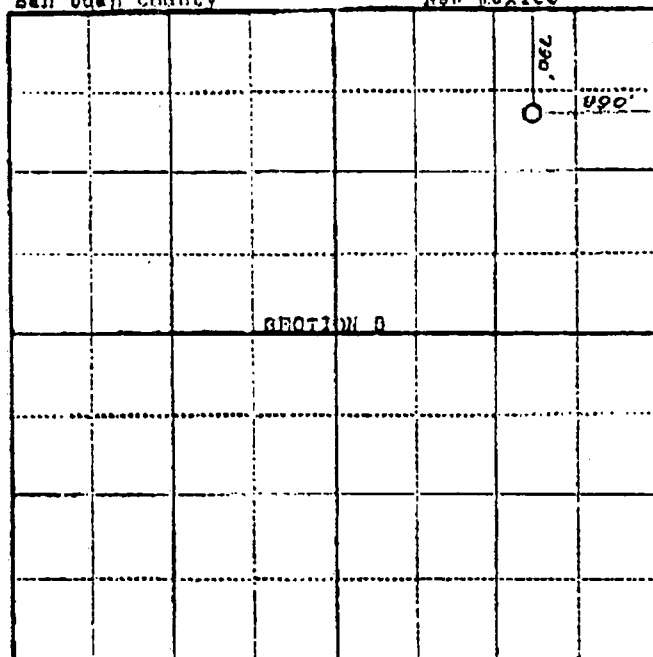

Scale—4 inches equal 1 mile.

This is to certify that the above plat was prepared from field notes of actual surveys made by me or under my supervision and that the same are true and correct to the best of my knowledge and belief.

Stephen H. Kinney

STEPHEN H. KINNEY
Registered Professional
Engineer and Land Surveyor

Surveyed July 19, 1954.

Seal:

RECEIVED

JUL 23 1954

U. S. GEOLOGICAL SURVEY
FARMINGTON, N. M.

Budget Bureau No. 42-R-845.2
Approved October 12-11-50.

Form 9-500

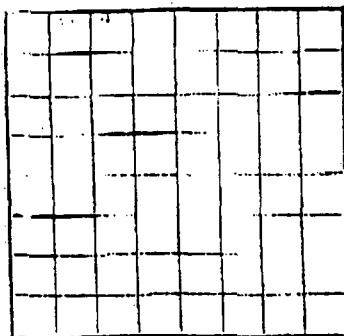

LOCATE WELL CORRECTLY

U. S. LAND OFFICE
SERIAL NUMBER
LEASE OR PERMIT NO. PROSPECT

UNITED STATES
DEPARTMENT OF THE INTERIOR
GEOLOGICAL SURVEY

LOG OF OIL OR GAS WELL

Company Pulao-Carr Address Box 844, Aztec, New Mexico
Lessor or Tract Russell-Federal Field Twin Mounds County New Mexico
Well No. 1 Sec. 8 T. 29N R. 11W of N.M.P.M. Meridian San Juan
Location 1700 ft. N of Line and 990 ft. E of Line of San Juan (Insert data relative to road)
The information given herewith is a complete and correct record of the well and all work done thereon
so far as can be determined from all available records.
Signed Bill A. Street District Geologist

Date August 30, 1951
The summary on this page is for the condition of the well at above date.

Commenced drilling 8-9, 19 51 Finished drilling 8-25, 19 54
OIL OR GAS SANDS OR ZONES
(Denoted gas by G)

No. 1, from None to to No. 4, from to to
No. 2, from to to No. 5, from to to
No. 3, from to to No. 6, from to to

IMPORTANT WATER SANDS

No. 1, from to to No. 3, from to to
No. 2, from to to No. 4, from to to

CASING RECORD

Size casing	Weight per foot	Threads per inch	Make	Amount	Kind of shoe	Cut and pulled from	Perforated		Purpose
							From—	To—	
10 3/4	32.75	8	Steel	216.00	Howe				

MUDDING AND CEMENTING RECORD

Size casing	Where set	Number sacks of cement	Mud used	Mud gravity	Amount of mud used
10 3/4	216.90	200	Howe		

MARK

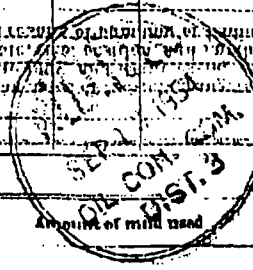

FOLD

PLUGS AND ADAPTERS

Heaving plug Material Length Depth set

Adapters Material Size

SHOOTING RECORD

Size	Shot used	Explosive used	Quantity	Date	Depth shot	Depth cleared out

TOOLS USED

Rotary tools were used from foot to foot, and from foot to foot

Cable tools were used from foot to foot, and from foot to foot

DATES

....., 1900 Put to producing, 1900

The production for the first 24 hours was barrels of fluid of which% was oil;%
solution; 8-26% water; and% sediment. Gravity, 2-26 54

If gas well, cu. ft. per 24 hours Gallons gasoline per 1,000 cu. ft. of gas

Rock pressure, lbs. per sq. in.

EMPLOYEES

....., Driller Driller

....., Driller Driller

Banner Drilg Co

J. L. Capeland

F. H. Capeland

FORMATION RECORD

FROM	TO	TOTAL FEET	FORMATION
0	724	724	Kirtland-Fruitland
724	845	131	Pictured Cliffs
845	2275	1430	Lewis
2275	2352	77	Mesaverde-Cliffhouse
2352	3184	832	Menefee
3184	3325	141	Point Lookout
3325	3386 TD	61	Mancos

LOGSHEET (OVER)

REVISION

10-42000-1

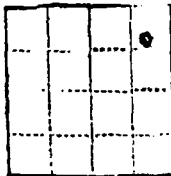
Budget Bureau No. 42 10000
Approved 11-31-60Form 9-581a
(Feb. 1961)

(SUBMIT IN TRIPLICATE)

 UNITED STATES
DEPARTMENT OF THE INTERIOR
GEOLOGICAL SURVEY
Land Office Santa FeLease No. SE 079969Unit

SUNDRY NOTICES AND REPORTS ON WELLS

NOTICE OF INTENTION TO DRILL.....	SUBSEQUENT REPORT OF WATER SHUT-OFF.....	
NOTICE OF INTENTION TO CHANGE PLANS.....	SUBSEQUENT REPORT OF SHOOTING ON ACIDIZING.....	
NOTICE OF INTENTION TO TEST WATER SHUT-OFF.....	SUBSEQUENT REPORT OF ALTERING CASING.....	
NOTICE OF INTENTION TO RE-DRILL OR REPAIR WELL.....	SUBSEQUENT REPORT OF RE-DRILLING OR REPAIR.....	
NOTICE OF INTENTION TO SHOOT ON ACIDIZE.....	SUBSEQUENT REPORT OF ABANDONMENT.....	
NOTICE OF INTENTION TO PULL OR ALTER CASING.....	SUPPLEMENTARY WELL HISTORY.....	
NOTICE OF INTENTION TO ABANDON WELL.....		

(INDICATE ABOVE BY CHECK MARK, NATURE OF REPORT, NOTICE, OR OTHER NOTE)

Santa Fe, New Mexico, January 28, 1960

Pudco Corporation Federal

Well No. 1 is located 50 ft. from N line and 270 ft. from E line of sec. 1
Section 1 (Twp. and Sec. No.) 62N (Twp.) 10E (Range) R. 10 E. T. 11 N. (Meridians)

2nd Quarter Area (Field) 50N 10E (County or Subdivision) New Mexico (State or Territory)
The elevation of the drill hole above sea level is 3325 ft.

DETAILS OF WORK

(State names of well expected depths to objective sands, show steel, weights, and loss of proposed casing; indicate mud (or other) cementing points, and all other important proposed work)

It is proposed to plug Pudco Corporation #1 to 3300, delay to 70 and 100 information indicate a dry hole to 10.

DEPT #1 100-110 Plugged 11210 IS 10, 20, 30, 40, 50, 60, 70, 80, 90, 100, 110, 120, 130, 140, 150, 160, 170, 180, 190, 200, 210, 220, 230, 240, 250, 260, 270, 280, 290, 300, 310, 320, 330, 340, 350, 360, 370, 380, 390, 400, 410, 420, 430, 440, 450, 460, 470, 480, 490, 500, 510, 520, 530, 540, 550, 560, 570, 580, 590, 600, 610, 620, 630, 640, 650, 660, 670, 680, 690, 700, 710, 720, 730, 740, 750, 760, 770, 780, 790, 800, 810, 820, 830, 840, 850, 860, 870, 880, 890, 900, 910, 920, 930, 940, 950, 960, 970, 980, 990, 1000, 1010, 1020, 1030, 1040, 1050, 1060, 1070, 1080, 1090, 1100, 1110, 1120, 1130, 1140, 1150, 1160, 1170, 1180, 1190, 1200, 1210, 1220, 1230, 1240, 1250, 1260, 1270, 1280, 1290, 1300, 1310, 1320, 1330, 1340, 1350, 1360, 1370, 1380, 1390, 1400, 1410, 1420, 1430, 1440, 1450, 1460, 1470, 1480, 1490, 1500, 1510, 1520, 1530, 1540, 1550, 1560, 1570, 1580, 1590, 1600, 1610, 1620, 1630, 1640, 1650, 1660, 1670, 1680, 1690, 1700, 1710, 1720, 1730, 1740, 1750, 1760, 1770, 1780, 1790, 1800, 1810, 1820, 1830, 1840, 1850, 1860, 1870, 1880, 1890, 1900, 1910, 1920, 1930, 1940, 1950, 1960, 1970, 1980, 1990, 2000, 2010, 2020, 2030, 2040, 2050, 2060, 2070, 2080, 2090, 2100, 2110, 2120, 2130, 2140, 2150, 2160, 2170, 2180, 2190, 2200, 2210, 2220, 2230, 2240, 2250, 2260, 2270, 2280, 2290, 2300, 2310, 2320, 2330, 2340, 2350, 2360, 2370, 2380, 2390, 2400, 2410, 2420, 2430, 2440, 2450, 2460, 2470, 2480, 2490, 2500, 2510, 2520, 2530, 2540, 2550, 2560, 2570, 2580, 2590, 2600, 2610, 2620, 2630, 2640, 2650, 2660, 2670, 2680, 2690, 2700, 2710, 2720, 2730, 2740, 2750, 2760, 2770, 2780, 2790, 2800, 2810, 2820, 2830, 2840, 2850, 2860, 2870, 2880, 2890, 2900, 2910, 2920, 2930, 2940, 2950, 2960, 2970, 2980, 2990, 3000, 3010, 3020, 3030, 3040, 3050, 3060, 3070, 3080, 3090, 3100, 3110, 3120, 3130, 3140, 3150, 3160, 3170, 3180, 3190, 3200, 3210, 3220, 3230, 3240, 3250, 3260, 3270, 3280, 3290, 3300, 3310, 3320, 3330, 3340, 3350, 3360, 3370, 3380, 3390, 3400, 3410, 3420, 3430, 3440, 3450, 3460, 3470, 3480, 3490, 3500, 3510, 3520, 3530, 3540, 3550, 3560, 3570, 3580, 3590, 3600, 3610, 3620, 3630, 3640, 3650, 3660, 3670, 3680, 3690, 3700, 3710, 3720, 3730, 3740, 3750, 3760, 3770, 3780, 3790, 3800, 3810, 3820, 3830, 3840, 3850, 3860, 3870, 3880, 3890, 3900, 3910, 3920, 3930, 3940, 3950, 3960, 3970, 3980, 3990, 4000, 4010, 4020, 4030, 4040, 4050, 4060, 4070, 4080, 4090, 4100, 4110, 4120, 4130, 4140, 4150, 4160, 4170, 4180, 4190, 4200, 4210, 4220, 4230, 4240, 4250, 4260, 4270, 4280, 4290, 4300, 4310, 4320, 4330, 4340, 4350, 4360, 4370, 4380, 4390, 4400, 4410, 4420, 4430, 4440, 4450, 4460, 4470, 4480, 4490, 4500, 4510, 4520, 4530, 4540, 4550, 4560, 4570, 4580, 4590, 4600, 4610, 4620, 4630, 4640, 4650, 4660, 4670, 4680, 4690, 4700, 4710, 4720, 4730, 4740, 4750, 4760, 4770, 4780, 4790, 4800, 4810, 4820, 4830, 4840, 4850, 4860, 4870, 4880, 4890, 4900, 4910, 4920, 4930, 4940, 4950, 4960, 4970, 4980, 4990, 5000, 5010, 5020, 5030, 5040, 5050, 5060, 5070, 5080, 5090, 5100, 5110, 5120, 5130, 5140, 5150, 5160, 5170, 5180, 5190, 5200, 5210, 5220, 5230, 5240, 5250, 5260, 5270, 5280, 5290, 5300, 5310, 5320, 5330, 5340, 5350, 5360, 5370, 5380, 5390, 5400, 5410, 5420, 5430, 5440, 5450, 5460, 5470, 5480, 5490, 5500, 5510, 5520, 5530, 5540, 5550, 5560, 5570, 5580, 5590, 5600, 5610, 5620, 5630, 5640, 5650, 5660, 5670, 5680, 5690, 5700, 5710, 5720, 5730, 5740, 5750, 5760, 5770, 5780, 5790, 5800, 5810, 5820, 5830, 5840, 5850, 5860, 5870, 5880, 5890, 5900, 5910, 5920, 5930, 5940, 5950, 5960, 5970, 5980, 5990, 6000, 6010, 6020, 6030, 6040, 6050, 6060, 6070, 6080, 6090, 6100, 6110, 6120, 6130, 6140, 6150, 6160, 6170, 6180, 6190, 6200, 6210, 6220, 6230, 6240, 6250, 6260, 6270, 6280, 6290, 6300, 6310, 6320, 6330, 6340, 6350, 6360, 6370, 6380, 6390, 6400, 6410, 6420, 6430, 6440, 6450, 6460, 6470, 6480, 6490, 6500, 6510, 6520, 6530, 6540, 6550, 6560, 6570, 6580, 6590, 6600, 6610, 6620, 6630, 6640, 6650, 6660, 6670, 6680, 6690, 6700, 6710, 6720, 6730, 6740, 6750, 6760, 6770, 6780, 6790, 6800, 6810, 6820, 6830, 6840, 6850, 6860, 6870, 6880, 6890, 6900, 6910, 6920, 6930, 6940, 6950, 6960, 6970, 6980, 6990, 7000, 7010, 7020, 7030, 7040, 7050, 7060, 7070, 7080, 7090, 7100, 7110, 7120, 7130, 7140, 7150, 7160, 7170, 7180, 7190, 7200, 7210, 7220, 7230, 7240, 7250, 7260, 7270, 7280, 7290, 7300, 7310, 7320, 7330, 7340, 7350, 7360, 7370, 7380, 7390, 7400, 7410, 7420, 7430, 7440, 7450, 7460, 7470, 7480, 7490, 7500, 7510, 7520, 7530, 7540, 7550, 7560, 7570, 7580, 7590, 7600, 7610, 7620, 7630, 7640, 7650, 7660, 7670, 7680, 7690, 7700, 7710, 7720, 7730, 7740, 7750, 7760, 7770, 7780, 7790, 7800, 7810, 7820, 7830, 7840, 7850, 7860, 7870, 7880, 7890, 7900, 7910, 7920, 7930, 7940, 7950, 7960, 7970, 7980, 7990, 8000, 8010, 8020, 8030, 8040, 8050, 8060, 8070, 8080, 8090, 8100, 8110, 8120, 8130, 8140, 8150, 8160, 8170, 8180, 8190, 8200, 8210, 8220, 8230, 8240, 8250, 8260, 8270, 8280, 8290, 8300, 8310, 8320, 8330, 8340, 8350, 8360, 8370, 8380, 8390, 8400, 8410, 8420, 8430, 8440, 8450, 8460, 8470, 8480, 8490, 8500, 8510, 8520, 8530, 8540, 8550, 8560, 8570, 8580, 8590, 8600, 8610, 8620, 8630, 8640, 8650, 8660, 8670, 8680, 8690, 8700, 8710, 8720, 8730, 8740, 8750, 8760, 8770, 8780, 8790, 8800, 8810, 8820, 8830, 8840, 8850, 8860, 8870, 8880, 8890, 8900, 8910, 8920, 8930, 8940, 8950, 8960, 8970, 8980, 8990, 9000, 9010, 9020, 9030, 9040, 9050, 9060, 9070, 9080, 9090, 9100, 9110, 9120, 9130, 9140, 9150, 9160, 9170, 9180, 9190, 9200, 9210, 9220, 9230, 9240, 9250, 9260, 9270, 9280, 9290, 9300, 9310, 9320, 9330, 9340, 9350, 9360, 9370, 9380, 9390, 9400, 9410, 9420, 9430, 9440, 9450, 9460, 9470, 9480, 9490, 9500, 9510, 9520, 9530, 9540, 9550, 9560, 9570, 9580, 9590, 9600, 9610, 9620, 9630, 9640, 9650, 9660, 9670, 9680, 9690, 9700, 9710, 9720, 9730, 9740, 9750, 9760, 9770, 9780, 9790, 9800, 9810, 9820, 9830, 9840, 9850, 9860, 9870, 9880, 9890, 9900, 9910, 9920, 9930, 9940, 9950, 9960, 9970, 9980, 9990, 10000

DEPT #1 100-110 Plugged 11210 IS 10, 20, 30, 40, 50, 60, 70, 80, 90, 100, 110, 120, 130, 140, 150, 160, 170, 180, 190, 200, 210, 220, 230, 240, 250, 260, 270, 280, 290, 300, 310, 320, 330, 340, 350, 360, 370, 380, 390, 400, 410, 420, 430, 440, 450, 460, 470, 480, 490, 500, 510, 520, 530, 540, 550, 560, 570, 580, 590, 600, 610, 620, 630, 640, 650, 660, 670, 680, 690, 700, 710, 720, 730, 740, 750, 760, 770, 780, 790, 800, 810, 820, 830, 840, 850, 860, 870, 880, 890, 900, 910, 920, 930, 940, 950, 960, 970, 980, 990, 1000, 1010, 1020, 1030, 1040, 1050, 1060, 1070, 1080, 1090, 1100, 1110, 1120, 1130, 1140, 1150, 1160, 1170, 1180, 1190, 1200, 1210, 1220, 1230, 1240, 1250, 1260, 1270, 1280, 1290, 1300, 1310, 1320, 1330, 1340, 1350, 1360, 1370, 1380, 1390, 1400, 1410, 1420, 1430, 1440, 1450, 1460, 1470, 1480, 1490, 1500, 1510, 1520, 1530, 1540, 1550, 1560, 1570, 1580, 1590, 1600, 1610, 1620, 1630, 1640, 1650, 1660, 1670, 1680, 1690, 1700, 1710, 1720, 1730, 1740, 1750, 1760, 1770, 1780, 1790, 1800, 1810, 1820, 1830, 1840, 1850, 1860, 1870, 1880, 1890, 1900, 1910, 1920, 1930, 1940, 1950, 1960, 1970, 1980, 1990, 2000, 2010, 2020, 2030, 2040, 2050, 2060, 2070, 2080, 2090, 2100, 2110, 2120, 2130, 2140, 2150, 2160, 2170, 2180, 2190, 2200, 2210, 2220, 2230, 2240, 2250, 2260, 2270, 2280, 2290, 2300, 2310, 2320, 2330, 2340, 2350, 2360, 2370, 2380, 2390, 2400, 2410, 2420, 2430, 2440, 2450, 2460, 2470, 2480, 2490, 2500, 2510, 2520, 2530, 2540, 2550, 2560, 2570, 2580, 2590, 2600, 2610, 2620, 2630, 2640, 2650, 2660, 2670, 2680, 2690, 2700, 2710, 2720, 2730, 2740, 2750, 2760, 2770, 2780, 2790, 2800, 2810, 2820, 2830, 2840, 2850, 2860, 2870, 2880, 2890, 2900, 2910, 2920, 2930, 2940, 2950, 2960, 2970, 2980, 2990, 3000, 3010, 3020, 3030, 3040, 3050, 3060, 3070, 3080, 3090, 3100, 3110, 3120, 3130, 3140, 3150, 3160, 3170, 3180, 3190, 3200, 3210, 3220, 3230, 3240, 3250, 3260, 3270, 3280, 3290, 3300, 3310, 3320, 3330, 3340, 3350, 3360, 3370, 3380, 3390, 3400, 3410, 3420, 3430, 3440, 3450, 3460, 3470, 3480, 3490, 3500, 3510, 3520, 3530, 3540, 3550, 3560, 3570, 3580, 3590, 3600, 3610, 3620, 3630, 3640, 3650, 3660, 3670, 3680, 3690, 3700, 3710, 3720, 3730, 3740, 3750, 3760, 3770, 3780, 3790, 3800, 3810, 3820, 3830, 3840, 3850, 3860, 3870, 3880, 3890, 3900, 3910, 3920, 3930, 3940, 3950, 3960, 3970, 3980, 3990, 4000, 4010, 4020, 4030, 4040, 4050, 4060, 4070, 4080, 4090, 4100, 4110, 4120, 4130, 4140, 4150, 4160, 4170, 4180, 4190, 4200, 4210, 4220, 4230, 4240, 4250, 4260, 4270, 4280, 4290, 4300, 4310, 4320, 4330, 4340, 4350, 4360, 4370, 4380, 4390, 4400, 4410, 4420, 4430, 4440, 4450, 4460, 4470, 4480, 4490, 4500, 4510, 4520, 4530, 4540, 4550, 4560, 4570, 4580, 4590, 4600, 4610, 4620, 4630, 4640, 4650, 4660, 4670, 4680, 4690, 4700, 4710, 4720, 4730, 4740, 4750, 4760, 4770, 4780, 4790, 4800, 4810, 4820, 4830, 4840, 4850, 4860, 4870, 4880, 4890, 4900, 4910, 4920, 4930, 4940, 4950, 4960, 4970, 4980, 4990, 5000, 5010, 5020, 5030, 5040, 5050, 5060, 5070, 5080, 5090, 5100, 5110, 5120, 5130, 5140, 5150, 5160, 5170, 5180, 5190, 5200, 5210, 5220, 5230, 5240, 5250, 5260, 5270, 5280, 5290, 5300, 5310, 5320, 5330, 5340, 5350, 5360, 5370, 5380, 5390, 5400, 5410, 5420, 5430, 5440, 5450, 5460, 5470, 5480, 5490, 5500, 5510, 5520, 5530, 5540, 5550, 5560, 5570, 5580, 5590, 5600, 5610, 5620, 5630, 5640, 5650, 5660, 5670, 5680, 5690, 5700, 5710, 5720, 5730, 5740, 5750, 5760, 5770, 5780, 5790, 5800, 5810, 5820, 5830, 5840, 5850, 5860, 5870, 5880, 5890, 5900, 5910, 5920, 5930, 5940, 5950, 5960, 5970, 5980, 5990, 6000, 6010, 6020, 6030, 6040, 6050, 6060, 6070, 6080, 6090, 6100, 6110, 6120, 6130, 6140, 6150, 6160, 6170, 6180, 6190, 6200, 6210, 6220, 6230, 6240, 6250, 6260, 6270, 6280, 6290, 6300, 6310, 6320, 6330, 6340, 6350, 6360, 6370, 6380, 6390, 6400, 6410, 6420, 6430, 6440, 6450, 6460, 6470, 6480, 6490, 6500, 6510, 6520, 6530, 6540, 6550, 6560, 6570, 6580, 6590, 6600, 6610, 6620, 6630, 6640, 6650, 6660, 6670, 6680, 6690, 6700, 6710, 6720, 6730, 6740, 6750, 6760, 6770, 6780, 6790, 6800, 6810, 6820, 6830, 6840, 6850, 6860, 6870, 6880, 6890, 6900, 6910, 6920, 6930, 6940, 6950, 6960, 6970, 6980, 6990, 7000, 7010, 7020, 7030, 7040, 7050, 7060, 7070, 7080, 7090, 7100, 7110, 7120, 7130, 7140, 7150, 7160, 7170, 7180, 7190, 7200, 7210, 7220, 7230, 7240, 7250, 7260, 7270, 7280, 7290, 7300, 7310, 7320, 7330, 7340, 7350, 7360, 7370, 7380, 7390, 7400, 7410, 7420, 7430, 7440, 7450, 7460, 7470, 7480, 7490, 7500, 7510, 7520, 7530, 7540, 7550, 7560, 7570, 7580, 7590, 7600, 7610, 7620, 7630, 7640, 7650, 7660, 7670, 7680, 7690, 7700, 7710, 7720, 7730, 7740, 7750, 7760, 7770, 7780, 7790, 7800, 7810, 7820, 7830, 7840, 7850, 7860, 7870, 7880, 7890, 7900, 7910, 7920, 7930, 7940, 7950, 7960, 7970, 7980, 7990, 8000, 8010, 8020, 8030, 8040, 8050, 8060, 8070, 8080, 8090, 8100, 8110, 8120, 8130, 8140, 8150, 8160, 8170, 8180, 8190, 8200, 8210, 8220, 8230, 8240, 8250, 8260, 8270, 8280, 8290, 830

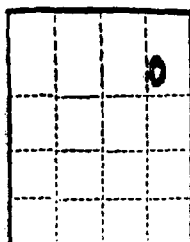

(SUBMIT IN TRIPLICATE)

UNITED STATES
DEPARTMENT OF THE INTERIOR
GEOLOGICAL SURVEY

Land Office Santa Fe

Lease No. ST 079968

Unit _____

RECEIVED

JAN 27 1960

SUNDRY NOTICES AND REPORTS ON WELLS

NOTICE OF INTENTION TO DRILL	SUBSEQUENT REPORT OF WATER SHUT-OFF	
NOTICE OF INTENTION TO CHANGE PLANS	SUBSEQUENT REPORT OF SHOOTING OR ACIDIZING	
NOTICE OF INTENTION TO TEST WATER SHUT-OFF	SUBSEQUENT REPORT OF ALTERING CASING	
NOTICE OF INTENTION TO RE-DRILL OR REPAIR WELL	SUBSEQUENT REPORT OF RE-DRILLING OR REPAIR	
NOTICE OF INTENTION TO SHOOT OR ACIDIZE	SUBSEQUENT REPORT OF ABANDONMENT	XX
NOTICE OF INTENTION TO PULL OR ALTER CASING	SUPPLEMENTARY WELL HISTORY	
NOTICE OF INTENTION TO ABANDON WELL		

(INDICATE ABOVE BY CHECK MARK NATURE OF REPORT, NOTICE, OR OTHER DATA)

Astec, New Mexico January 26, 19 60

Fusco Carr-Russell Federal
Well No. 1 is located 790 ft. from (N) line and 950 ft. from (E) line of sec. _____

Section 8 20N 14W E.M.P.M.
(1/4 Sec. and Sec. No.) (Twp.) (Range) (Meridian)
Twin Mounds Area San Juan New Mexico
(Field) (County or Subdivision) (State or Territory)

The elevation of the Ground ~~surface~~ above sea level is 5332.4 ft.

DETAILS OF WORK

(State names of and expected depths to objective sands; show sizes, weights, and lengths of proposed casings; indicate mudlogging jobs, cementing points, and all other important proposed work)

Flugging has been accomplished as verbally approved by Mr. Phil McGrath, U.S.G.S. on August 26, 1954.

Plugs Left: 3327-3100
2400-2200
1150-1000
860-650
410-350
Surface

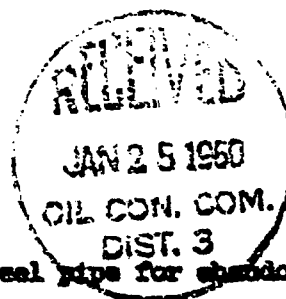

Total, 300 sec, spotted by Howco; installed 8" of 4" OD steel pipe for abandonment marker; pits filled and location cleaned up.

I understand that this plan of work must receive approval in writing by the Geological Survey before operations may be commenced.

Company FUSCO PETROLEUM CORPORATION

Address 106 West Chuska

Astec, New Mexico

By S. E. McNeill, Jr.
Title Mgr. Prod. Dept.

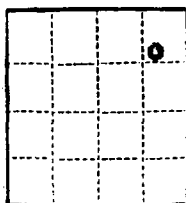

(SUBMIT IN TRIPPLICATE)

UNITED STATES
DEPARTMENT OF THE INTERIOR
GEOLOGICAL SURVEY

Land Office Santa Fe
Lease No. SP 079968
Unit _____

SUNDRY NOTICES AND REPORTS ON WELLS

NOTICE OF INTENTION TO DRILL.....	SUBSEQUENT REPORT OF WATER SHUT-OFF.....
NOTICE OF INTENTION TO CHANGE PLANS.....	SUBSEQUENT REPORT OF SHOOTING OR ACIDIZING.....
NOTICE OF INTENTION TO TEST WATER SHUT-OFF.....	SUBSEQUENT REPORT OF ALTERING CASING.....
NOTICE OF INTENTION TO RE-DRILL OR REPAIR WELL.....	SUBSEQUENT REPORT OF RE-DRILLING OR REPAIR.....
NOTICE OF INTENTION TO SHOOT OR ACIDIZE.....	SUBSEQUENT REPORT OF ABANDONMENT.....
NOTICE OF INTENTION TO PULL OR ALTER CASING.....	SUPPLEMENTARY WELL HISTORY.....
NOTICE OF INTENTION TO ABANDON WELL.....	

(INDICATE ABOVE BY CHECK MARK NATURE OF REPORT, NOTICE, OR OTHER DATA)

Astec, New Mexico January 26, 1960

Pubco Carr-Russell Federal
Well No. 1 is located 790 ft. from [N] line and 990 ft. from [E] line of sec. 8

Section 8 29N 14W E.M.P.M.
(2 Sec. and Sec. No.) (Twp.) (Range) (Meridian)
Twin Wards Area San Juan New Mexico
(Field) (County or Subdivision) (State or Territory)

The elevation of the Ground surface above sea level is 2332.4 ft.

DETAILS OF WORK

(State names of and expected depths to objective sands; show sizes, weights, and lengths of proposed casings; indicate mudding jobs, cementing points, and all other important proposed work)

It is proposed to plug Pubco Carr-Russell #1; TD 3326; E-log to TD and DET information indicate a dry hole to TD.

DET #1: 727-773 Pictured Cliffs If 15', FF 60', Paip 215, rec. 150' all, Gcm. No gts.

DET #2: 2932-2963 Menafee If 30', FF 180, Paip 1170, rec. 365' wcm, no gas or oil.

CORE ANALYSIS: 724-772 water productive, Pictured Cliff; 3223-3227 water productive Menafee.

Plugs to be run as designated by Mr. Phil McGrath, U.S.G.S., 8-26-54; 3327-3100, 2400-2200, 1150-1000, 860-650, 410-350, 300 smx.

I understand that this plan of work must receive approval in writing by the Geological Survey before operations may be commenced.

Company PUBCO PETROLEUM CORPORATION

Address 108 West Chuska

Astec, New Mexico

By H. E. Maxwell, Jr.

Title Mgr. Prod. Dept.

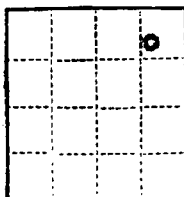

(SUBMIT IN TRIPLICATE)

UNITED STATES
DEPARTMENT OF THE INTERIOR
GEOLOGICAL SURVEY

Land Office Santa Fe
Lease No. BF 079968
Unit _____

RECEIVED

JAN 17 1960

SUNDRY NOTICES AND REPORTS ON WELLS

NOTICE OF INTENTION TO DRILL		SUBSEQUENT REPORT OF WATER SHUT-OFF	
NOTICE OF INTENTION TO CHANGE PLANS		SUBSEQUENT REPORT OF SHOOTING OR ACIDIZING	
NOTICE OF INTENTION TO TEST WATER SHUT-OFF		SUBSEQUENT REPORT OF ALTERING CASING	
NOTICE OF INTENTION TO RE-DRILL OR REPAIR WELL		SUBSEQUENT REPORT OF RE-DRILLING OR REPAIR	
NOTICE OF INTENTION TO SHOOT OR ACIDIZE		SUBSEQUENT REPORT OF ABANDONMENT	XX
NOTICE OF INTENTION TO PULL OR ALTER CASING		SUPPLEMENTARY WELL HISTORY	
NOTICE OF INTENTION TO ABANDON WELL			

(INDICATE ABOVE BY CHECK MARK NATURE OF REPORT, NOTICE, OR OTHER DATA)

Artec, New Mexico January 26, 1960

Pueco Carr-Russell Federal
Well No. 1 is located 790 ft. from [N] line and 990 ft. from [E] line of sec. _____

NE 1/4, Section 8 29N 14W T.M.P.M.
(1/4 Sec. and Sec. No.) (Twp.) (Range) (Meridian)
Twin Knolls Area San Juan New Mexico
(Field) (County or Subdivision) (State or Territory)

The elevation of the Ground ~~center~~ above sea level is 5332.4 ft.

DETAILS OF WORK

(State names of and expected depths to objective sands; show sizes, weights, and lengths of proposed casings; indicate mudding jobs, cementing points, and all other important proposed work)

Plugging has been accomplished as verbally approved by Mr. Phil McGrath, U.S.G.S. on August 26, 1954.

Plugs left: 3327-3100
2400-2200
1150-1000
860-650
410-350
Surface

Total, 300 seg, spotted by Howco; installed 8' of 4" OD steel pipe for abandonment marker; pits filled and location cleaned up.

I understand that this plan of work must receive approval in writing by the Geological Survey before operations may be commenced.

Company PUECO PETROLEUM CORPORATION

Address 106 West Chuska

Artec, New Mexico

By H. E. Maxwell, Jr.
Title Mgr. Prod. Dept.

Jones, William V., EMNRD

From: Jones, William V., EMNRD
Sent: Monday, June 28, 2010 2:39 PM
To: 'Diane_Jaramillo@xtoenergy.com'
Cc: Ezeanyim, Richard, EMNRD; Hayden, Steven, EMNRD
Subject: Disposal application from XTO Energy Inc. : Salty Dog #2 30-045-30812 Menefee and Point Lookout

Hello Diane:

Would you please create, scan, and email a "After Conversion" wellbore diagram? The application has the diagram as the well currently exists, but I can't find a diagram showing the well after the new perfs are added – be sure the tubing is still showing.

Regards,

William V Jones, P.E.

Engineering, Oil Conservation Division
1220 South St. Francis Drive, Santa Fe, NM 87505
Tel 505.476.3448 ~ Fax 505.476.3462



Injection Permit Checklist (06/24/2010)

Case SWD 811-B WFX PMX IPI Permit Date 6/28/10 UIC Qtr (A/M/H)
 # Wells 1 Well Name: Sally DOG #2
 API Num: (30-) 045-30812 Spud Date: 1/5/02 New/Old: N (UIC primacy March 7, 1982)
 Footages 1495 FSL/471 FEL Unit J Sec 5 Tsp 29N Rge 14W County Southern
 Operator: XTO Energy INC Contact DIANE JARAMILLO
 Operator Address: 382 CR300, AZTEC, NM 87410 Alexander Bridge
 OGRID: 9380 RULE 5.9 Compliance (Wells) 6/3230 (Finan Assur) OK IS 5.9 OK? OK
 Well File Reviewed ✓ Current Status: SWD

General Location: ✓
 Diagrams: Before Conversion ✓ After Conversion ✓ Logs in Imaging File: ✓

Planned Work to Well: Deepen by 1000'

	Sizes Hole.....Pipe	Setting Depths	Cement Sx or Cf	Cement Top and Determination Method
Existing Surface	<u>9 3/4 x 5 1/8</u>	<u>251</u>	<u>110</u>	<u>CIRC</u> <u>SQZED</u>
Existing Intern				
New Existing LongSt	<u>6 3/4 x 5 1/2</u>	<u>3612</u>	<u>15/17</u>	<u>CIRC</u> (orig TO C=970 CBL)

 DV Tool ✓ ✓ Open Hole ✓ Total Depth 3612 Deviated Hole? NO

Intervals: Amend SWD-811-A

	Depths, Ft.	Formation	Producing?
Formation Above	<u>2267</u>	<u>CLIFF HOUSE</u>	
Formation Above	<u>550</u>	<u>PC</u>	
Injection TOP:	<u>2388</u>	<u>Monofe</u>	Max. PSI <u>470</u> Open Hole? <u>✓</u> Perfs? <u>✓</u>
Injection BOTTOM:	<u>3475</u>	<u>PLD</u>	Tubing Size <u>27/8</u> Packer Depth <u>2310</u>
Formation Below	<u>5000</u>	<u>Gallie</u>	
Formation Below			

Sensitive Areas: Section Reel Cliff House Salt Deposits
Relash Area (R-T-T-P) Polash Lessee Noticed? (WIPP?) Noticed?
 Fresh Water: Depths: ? Formation --- Wells? NO Analysis? --- Affirmative Statement ✓
 Disposal Fluid Sources: FRC/PC Analysis? ✓
 Disposal Interval Production Potential/Testing: OK Analysis Off 5 MILES

Notice: Newspaper(Y/N) ✓ Surface Owner XTO Mineral Owner(s) BLM
 RULE 26.7(A) Affected Parties: COPALUMPS, WESTERN Gas, BUREAU OF LANDS, CHURCH?

Area of Review: Adequate Map (Y/N) ✓ and Well List (Y/N) ✓
 Active Wells 0 Num Repairs --- Producing in Injection Interval in AOR ---
 P&A Wells 1 Num Repairs 0 All Wellbore Diagrams Included? ✓

Questions/Required Work: Substant about mineral control of Monofe/PLD
ESP Fee Lines (ESW S2.5) (NE NWS2.8)
Perf: SWAB/analyze

Request Sent --- Reply: ---