

DATE IN 6-8-10	SUSPENSE 7/16/10 6-8-10	ENGINEER W.P.	LOGGED IN 6-8-10	TYPE SWP	APP NO. 1015929196
----------------	----------------------------	---------------	------------------	----------	--------------------

ABOVE THIS LINE FOR DIVISION USE ONLY

NEW MEXICO OIL CONSERVATION DIVISION

- Engineering Bureau -

1220 South St. Francis Drive, Santa Fe, NM 87505



OGX Resources
RECEIVED

Perkins 2010-11-1

ADMINISTRATIVE APPLICATION CHECKLIST

30-015-23849

THIS CHECKLIST IS MANDATORY FOR ALL ADMINISTRATIVE APPLICATIONS FOR EXCEPTIONS TO DIVISION RULES AND REGULATIONS WHICH REQUIRE PROCESSING AT THE DIVISION LEVEL IN SANTA FE

Application Acronyms:

[NSL-Non-Standard Location] [NSP-Non-Standard Proration Unit] [SD-Simultaneous Dedication]
 [DHC-Downhole Commingling] [CTB-Lease Commingling] [PLC-Pool/Lease Commingling]
 [PC-Pool Commingling] [OLS - Off-Lease Storage] [OLM-Off-Lease Measurement]
 [WFX-Waterflood Expansion] [PMX-Pressure Maintenance Expansion]
 [SWD-Salt Water Disposal] [IPI-Injection Pressure Increase]
 [EOR-Qualified Enhanced Oil Recovery Certification] [PPR-Positive Production Response]

[1] TYPE OF APPLICATION - Check Those Which Apply for [A]

- [A] Location - Spacing Unit - Simultaneous Dedication
☐ NSL ☐ NSP ☐ SD

Check One Only for [B] or [C]

- [B] Commingling - Storage - Measurement
☐ DHC ☐ CTB ☐ PLC ☐ PC ☐ OLS ☐ OLM

- [C] Injection - Disposal - Pressure-Increase - Enhanced Oil Recovery
☐ WFX ☐ PMX ☒ SWD ☐ IPI ☐ EOR ☐ PPR

- [D] Other: Specify _____

[2] NOTIFICATION REQUIRED TO: - Check Those Which Apply, or ☐ Does Not Apply

- [A] ☐ Working, Royalty or Overriding Royalty Interest Owners
 [B] ☒ Offset Operators, Leaseholders or Surface Owner
 [C] ☒ Application is One Which Requires Published Legal Notice
 [D] ☐ Notification and/or Concurrent Approval by BLM or SLO
U.S. Bureau of Land Management - Commissioner of Public Lands, State Land Office
 [E] ☒ For all of the above, Proof of Notification or Publication is Attached, and/or,
 [F] ☐ Waivers are Attached

[3] SUBMIT ACCURATE AND COMPLETE INFORMATION REQUIRED TO PROCESS THE TYPE OF APPLICATION INDICATED ABOVE.

[4] **CERTIFICATION:** I hereby certify that the information submitted with this application for administrative approval is **accurate** and **complete** to the best of my knowledge. I also understand that **no action** will be taken on this application until the required information and notifications are submitted to the Division.

Note: Statement must be completed by an individual with managerial and/or supervisory capacity.

Ann E Ritchie
Print or Type Name

Signature

Regulatory Agent
Title

6/3/10
Date

ann.wtor@gmail.com
e-mail Address

APPLICATION FOR AUTHORIZATION TO INJECT

- I. PURPOSE: ☒ Secondary Recovery ☐ Pressure Maintenance ☒ Disposal ☐ Storage
Application qualifies for administrative approval? ☒ Yes ☐ No
- II. OPERATOR: OGX Resources, LLC
ADDRESS: c/o P.O. Box 953, Midland, TX 79702
CONTACT PARTY: Ann Ritchie, Regulatory Agent PHONE: 432/684-6381
- III. WELL DATA: Complete the data required on the reverse side of this form for each well proposed for injection.
Additional sheets may be attached if necessary.
- IV. Is this an expansion of an existing project? ☐ Yes ☒ No
If yes, give the Division order number authorizing the project: _____
- V. Attach a map that identifies all wells and leases within two miles of any proposed injection well with a one-half mile radius circle drawn around each proposed injection well. This circle identifies the well's area of review.
- VI. Attach a tabulation of data on all wells of public record within the area of review which penetrate the proposed injection zone. Such data shall include a description of each well's type, construction, date drilled, location, depth, record of completion, and a schematic of any plugged well illustrating all plugging detail.
- VII. Attach data on the proposed operation, including:
1. Proposed average and maximum daily rate and volume of fluids to be injected;
 2. Whether the system is open or closed;
 3. Proposed average and maximum injection pressure;
 4. Sources and an appropriate analysis of injection fluid and compatibility with the receiving formation if other than reinjected produced water; and,
 5. If injection is for disposal purposes into a zone not productive of oil or gas at or within one mile of the proposed well, attach a chemical analysis of the disposal zone formation water (may be measured or inferred from existing literature, studies, nearby wells, etc.).
- *VIII. Attach appropriate geologic data on the injection zone including appropriate lithologic detail, geologic name, thickness, and depth. Give the geologic name, and depth to bottom of all underground sources of drinking water (aquifers containing waters with total dissolved solids concentrations of 10,000 mg/l or less) overlying the proposed injection zone as well as any such sources known to be immediately underlying the injection interval.
- IX. Describe the proposed stimulation program, if any.
- *X. Attach appropriate logging and test data on the well. (If well logs have been filed with the Division, they need not be resubmitted).
- *XI. Attach a chemical analysis of fresh water from two or more fresh water wells (if available and producing) within one mile of any injection or disposal well showing location of wells and dates samples were taken.
- XII. Applicants for disposal wells must make an affirmative statement that they have examined available geologic and engineering data and find no evidence of open faults or any other hydrologic connection between the disposal zone and any underground sources of drinking water.
- XIII. Applicants must complete the "Proof of Notice" section on the reverse side of this form.
- XIV. Certification: I hereby certify that the information submitted with this application is true and correct to the best of my knowledge and belief.
- NAME: Ann E. Ritchie TITLE: Regulatory Agent
SIGNATURE:  DATE: 5/26/10
E-MAIL ADDRESS: ann.wtor@gmail.com
- * If the information required under Sections VI, VIII, X, and XI above has been previously submitted, it need not be resubmitted.
Please show the date and circumstances of the earlier submittal: _____

III. WELL DATA

A. The following well data must be submitted for each injection well covered by this application. The data must be both in tabular and schematic form and shall include:

- (1) Lease name; Well No.; Location by Section, Township and Range; and footage location within the section.
- (2) Each casing string used with its size, setting depth, sacks of cement used, hole size, top of cement, and how such top was determined.
- (3) A description of the tubing to be used including its size, lining material, and setting depth.
- (4) The name, model, and setting depth of the packer used or a description of any other seal system or assembly used.

Division District Offices have supplies of Well Data Sheets which may be used or which may be used as models for this purpose. Applicants for several identical wells may submit a "typical data sheet" rather than submitting the data for each well.

B. The following must be submitted for each injection well covered by this application. All items must be addressed for the initial well. Responses for additional wells need be shown only when different. Information shown on schematics need not be repeated.

- (1) The name of the injection formation and, if applicable, the field or pool name.
- (2) The injection interval and whether it is perforated or open-hole.
- (3) State if the well was drilled for injection or, if not, the original purpose of the well.
- (4) Give the depths of any other perforated intervals and detail on the sacks of cement or bridge plugs used to seal off such perforations.
- (5) Give the depth to and the name of the next higher and next lower oil or gas zone in the area of the well, if any.

XIV. PROOF OF NOTICE

All applicants must furnish proof that a copy of the application has been furnished, by certified or registered mail, to the owner of the surface of the land on which the well is to be located and to each leasehold operator within one-half mile of the well location.

Where an application is subject to administrative approval, a proof of publication must be submitted. Such proof shall consist of a copy of the legal advertisement which was published in the county in which the well is located. The contents of such advertisement must include:

- (1) The name, address, phone number, and contact party for the applicant;
- (2) The intended purpose of the injection well; with the exact location of single wells or the Section, Township, and Range location of multiple wells;
- (3) The formation name and depth with expected maximum injection rates and pressures; and,
- (4) A notation that interested parties must file objections or requests for hearing with the Oil Conservation Division, 1220 South St. Francis Dr., Santa Fe, New Mexico 87505, within 15 days.

NO ACTION WILL BE TAKEN ON THE APPLICATION UNTIL PROPER PROOF OF NOTICE HAS BEEN SUBMITTED.

NOTICE: Surface owners or offset operators must file any objections or requests for hearing of administrative applications within 15 days from the date this application was mailed to them.

INJECTION WELL DATA SHEET

OPERATOR: OGX Resources, LLCWELL NAME & NUMBER: Perkins #1WELL LOCATION: 1980' FNL & 1980' FEL G 30 26S 29E
FOOTAGE LOCATION UNIT LETTER SECTION TOWNSHIP RANGEWELLBORE SCHEMATICWELL CONSTRUCTION DATASurface CasingHole Size: 12-1/4" Casing Size: 8-5/8" @ 420'Cemented with: 300 sx. or ft³Top of Cement: Surface Method Determined: Circulated
Intermediate CasingHole Size: Casing Size: Cemented with: sx. or ft³Top of Cement: Method Determined:
Production CasingHole Size: 7-7/8" Casing Size: 5-1/2" @ 4220'Cemented with: 750 sx. Class C or will circulate cmt to surface ft³Top of Cement: Method Determined: Total Depth: 4220'Injection Interval2750 feet to 4230' Perf d

(Perforated or Open Hole; indicate which)

INJECTION WELL DATA SHEET

Tubing Size: 2-7/8" Lining Material: Plastic Coated

Type of Packer: Lok-Set

Packer Setting Depth: 2700' +/- (50' above top perf)

Other Type of Tubing/Casing Seal (if applicable):

Additional Data

1. Is this a new well drilled for injection? Yes X No

If no, for what purpose was the well originally drilled? Producer (was Dry Hole)

2. Name of the Injection Formation: Delaware

3. Name of Field or Pool (if applicable): Cherry Canyon

4. Has the well ever been perforated in any other zone(s)? List all such perforated intervals and give plugging detail, i.e. sacks of cement or plug(s) used. No

5. Give the name and depths of any oil or gas zones underlying or overlying the proposed injection zone in this area: N/A

OGX Resources, LLC

Perkins, Well #1

Section 30, T26S, R29E 1980' FNL & 1980' FEL

Eddy County, New Mexico

ATTACHMENT A

III. Well Data

Section A:

1. Lease Name: Perkins, Well #1
2. Casing & Cement: Completion, Data Sheet w/wellbore attached
3. Tubing: 2 3/8" w/Baker AD-1 Tension packer set approx. 70-80' above top perforation @ 2750'.

Section B:

1. Injection formation: Delaware
Pool: Undesignated; Delaware
2. Injection Interval: Delaware/Cherry Canyon formation from 2750-4230'
Well currently P & A.
3. Original purpose of well: Drilled for production oil/gas.
4. No other perforated intervals.
5. Next High oil/gas zone: none
Next Lower oil/gas zone: Bone Springs 5200+

IV. This is not an expansion of an existing project.

V. Map attached with 2 mile radius

VI. Tabulation of wells within 1/2 mile radius attached, along with map.

VII. Operation Data:

1. Proposed average daily injection volume: 1000 bbls/day
Proposed maximum daily injection volume: 4000 bbls/day

OGX Resources, LLC

2. The well will operate within a closed system.
3. Proposed average daily injection pressure: 750 psi.
Proposed maximum daily injection pressure: 875 psi (.25/ft to current top perf)
4. Sources of injection water will be OGX Resources, LLC offsetting production from the Bone Springs and Morrow formations.
5. Chlorides are as listed on the attached water analysis from offsetting wells enclosed in this application.

VIII. Geological Data:

Statement: The Proposed injection zone is the Delaware Canyon which is a sandstone. Generally the pay thickness ranges from 80-200' is within the Delaware Sand formation, solution gas drive. This zone has historically taken produced formation water at relatively low pressures and is a common zone for waterflood and injection. There is no known source of drinking water underlying the proposed injection interval.

IX: Stimulation Program: At this time there is no further stimulation program proposed for this injection interval.

X. Logs: the log for this well was submitted to the Oil Conservation Division with the initial C-108 filing on 6-3-10.

XI: The fresh water is estimated to be at approximately 300-400'.

XII: Statement: To the best of current knowledge of this area there is no evidence of open faults or other hydrologic connection between the injection zone and any underground sources of drinking water.

XIII: Proof of Notice: Newspaper notice and certification of publication attached, originals submitted 6-3-10.

XIV: Certification: Attachment, along with copies of certified mailing receipts.

 6-28-10

OGX Resources
Perkins #1 SWD
Sec. 30, T26S, R29E
Eddy County, New Mexico

Lithology of Proposed Injection Intervals

Bell Canyon (2738' – 3586')

Gray to white very fine grained sandstones and siltstones. Moderately sorted with calcareous cement. Sometimes unconsolidated.

Shales are dark brown to black, occasionally carbonaceous with some pyrite flecks.

Cherry Canyon (3586' – TD 4286')

Gray to translucent white, very fine to fine grained sandstones. Moderately to well sorted with calcareous cement, sometimes friable.

Limestones in Manzanita section occur 3730' to 3780'. They are light brown to cream, dense, very finely crystalline and slightly dolomitic.

CURRENT WELLBORE

Spud: 7/08/81

API: 30-015-23849

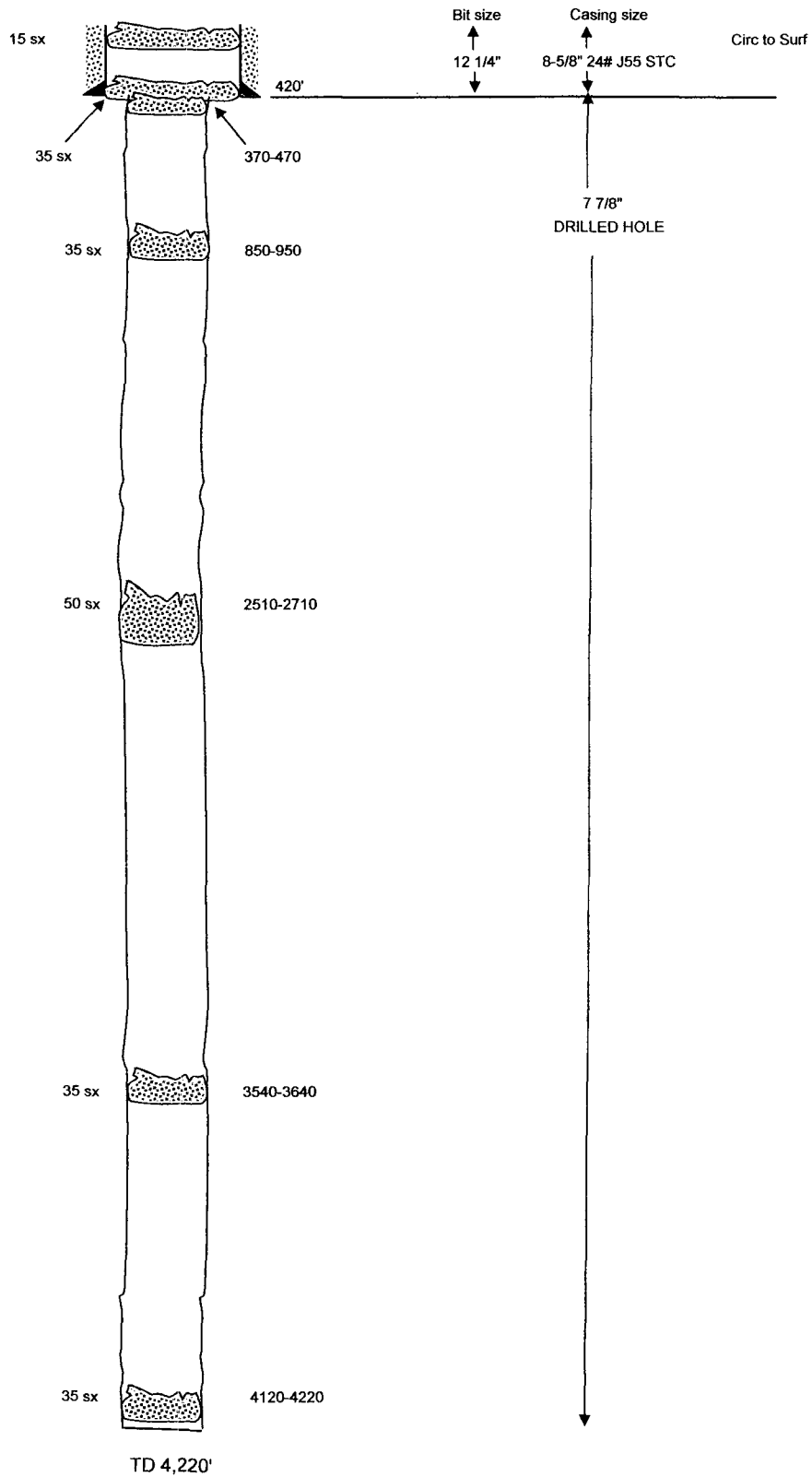

PROPOSED WELLBORE

Spud: 7/08/81

API: 30-015-23849

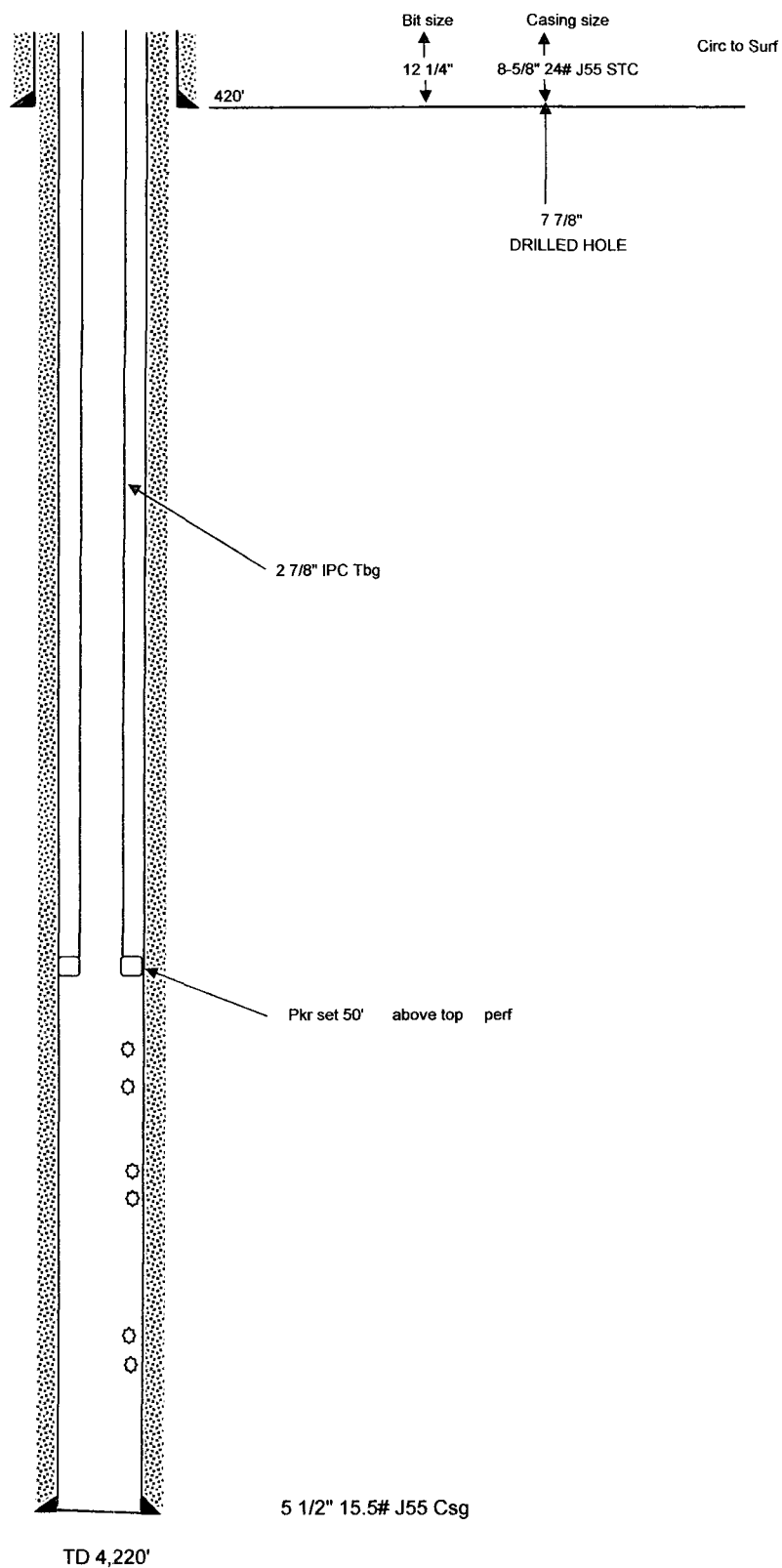

NO. OF COPIES RECEIVED	
DISTRIBUTION	
SANTA FE	1
FILE	1 ✓
U.S.G.S.	2
LAND OFFICE	
OPERATOR	

Form C-105
Revised 11-1-81

NEW MEXICO OIL CONSERVATION COMMISSION
WELL COMPLETION OR RECOMPLETION REPORT AND LOG

5a. Indicate Type of Lease	
State <input type="checkbox"/>	Fee <input checked="" type="checkbox"/>
5. State Oil & Gas Lease No.	

10. TYPE OF WELL	
OIL WELL <input type="checkbox"/>	GAS WELL <input type="checkbox"/>
b. TYPE OF COMPLETION	
NEW WELL <input checked="" type="checkbox"/>	WORK OVER <input type="checkbox"/>
DEEPEN <input type="checkbox"/>	PLUG BACK <input type="checkbox"/>
DIFF. RESVR. <input type="checkbox"/>	OTHER <input type="checkbox"/>

7. Unit Agreement Name
8. Farm or Lease Name
Perkins
9. Well No.
1
10. Field and Pool, or Wildcat
Wildcat (Cherry Canyon)

2. Name of Operator	
Orla Petco, Inc. /	
3. Address of Operator	
c/o Box 953, Midland, Texas 79702	
4. Location of Well	
UNIT LETTER G LOCATED 1980 FEET FROM THE N LINE AND 1980 FEET FROM E	
THE LINE OF SEC. 30 TWP. 26S RGE. 29E NMPM	

OCT 30 1981

O. C. D.

ARTESIA, OFFICE

12. County
Eddy

15. Date Spudded	16. Date T.D. Reached	17. Date Compl. (Ready to Prod.)	18. Elevations (DF, RKB, RT, GR, etc.)
7-7-81	7-25-81	Dry Hole RA 7-28-81	2923 ft.
20. Total Depth	21. Plug Back T.D.	22. If Multiple Compl., How Many	23. Intervals Drilled By
4220			Rotary Tools

19. Elev. Casinghead
25. Was Directional Survey Made
Yes

24. Producing Interval(s), of this completion - Top, Bottom, Name
None

26. Type Electric and Other Logs Run
Neutron & Dual Laterolog

27. Was Well Cored
no

28. CASING RECORD (Report all strings set in well)					
CASING SIZE	WEIGHT LB./FT.	DEPTH SET	HOLE SIZE	CEMENTING RECORD	AMOUNT PULLED
8 5/8"	24#	420	10 3/4"	300 sx C1 C 2% CaCl	none

29. LINER RECORD				30. TUBING RECORD			
SIZE	TOP	BOTTOM	SACKS CEMENT	SCREEN	SIZE	DEPTH SET	PACKER SET
none						None	

31. Perforation Record (Interval, size and number)
None

32. ACID, SHOT, FRACTURE, CEMENT SQUEEZE, ETC.	
DEPTH INTERVAL	AMOUNT AND KIND MATERIAL USED
None	

33. PRODUCTION							
Date First Production		Production Method (Flowing, gas lift, pumping - Size and type pump)				Well Status (Prod. or Shut-in)	
Date of Test	Hours Tested	Choke Size	Prod'n. For Test Period	Oil - Bbl.	Gas - MCF	Water - Bbl.	Gas - Oil Ratio
Flow Tubing Press.	Casing Pressure	Calculated 24-Hour Rate	Oil - Bbl.	Gas - MCF	Water - Bbl.	Oil Gravity - API (Corr.)	

34. Disposition of Gas (Sold, used for fuel, vented, etc.)	Test Witnessed By
--	-------------------

35. List of Attachments

36. I hereby certify that the information shown on both sides of this form is true and complete to the best of my knowledge and belief.			
SIGNED	<i>Orla Petco</i>	TITLE	Agent
		DATE	10-27-81

NO. OF COPIES RECEIVED	
DISTRIBUTION	
SANTA FE	1
FILE	1
U.S.G.S.	
LAND OFFICE	
OPERATOR	

NEW MEXICO OIL CONSERVATION COMMISSION

JUL 30 1981

O. C. D.

ARTESIA, OFFICE

Form C-103
Supersedes Old
C-102 and C-103
Effective 1-1-65

SUNDRY NOTICES AND REPORTS ON WELLS

(DO NOT USE THIS FORM FOR PROPOSALS TO DRILL OR TO DEEPEN OR PLUG BACK TO A DIFFERENT RESERVOIR. USE "APPLICATION FOR PERMIT -" (FORM C-101) FOR SUCH PROPOSALS.)

1. OIL WELL <input checked="" type="checkbox"/> GAS WELL <input type="checkbox"/> OTHER- <u>30-015-23849</u>	5a. Indicate Type of Lease State <input type="checkbox"/> Fee <input checked="" type="checkbox"/>
2. Name of Operator <u>Orla Petco, Inc.</u>	5. State Oil & Gas Lease No.
3. Address of Operator <u>c/o Box 953, Midland, Texas 79702</u>	7. Unit Agreement Name
4. Location of Well UNIT LETTER <u>G</u> <u>1980</u> FEET FROM THE <u>North</u> LINE AND <u>1980</u> FEET FROM THE <u>East</u> LINE, SECTION <u>30</u> TOWNSHIP <u>26S</u> RANGE <u>29E</u> NMPM.	8. Farm or Lease Name <u>Perkins</u>
	9. Well No. <u>1</u>
	10. Field and Pool, or Wildcat <u>Wildcat Cherry Canyon</u>
15. Elevation (Show whether DF, RT, GR, etc.) <u>2923 GL</u>	12. County <u>Eddy</u>

16. Check Appropriate Box To Indicate Nature of Notice, Report or Other Data	
NOTICE OF INTENTION TO:	SUBSEQUENT REPORT OF:
PERFORM REMEDIAL WORK <input type="checkbox"/>	REMEDIAL WORK <input type="checkbox"/>
TEMPORARILY ABANDON <input type="checkbox"/>	COMMENCE DRILLING OPNS. <input type="checkbox"/>
PULL OR ALTER CASING <input type="checkbox"/>	CASING TEST AND CEMENT JOB <input type="checkbox"/>
OTHER <input type="checkbox"/>	OTHER <input type="checkbox"/>
PLUG AND ABANDON <input type="checkbox"/>	ALTERING CASING <input type="checkbox"/>
CHANGE PLANS <input type="checkbox"/>	PLUG AND ABANDONMENT <input checked="" type="checkbox"/>

17. Describe proposed or completed Operations (Clearly state all pertinent details, and give pertinent dates, including estimated date of starting any proposed work) SEE RULE 1103.

7-27-81: Plug and abandoned well with the following plugs:

Plug #1 - 35 sx - 4120 - 4220'
Plug #2 - 35 sx - 3540 - 3640'
Plug #3 - 50 sx - 2510 - 2710'
Plug #4 - 35 sx - 850 - 950'
Plug #5 - 35 sx - 370 - 470'
Plug #6 - 15 sx - surface

Final plug down at 11:30 pm.

18. I hereby certify that the information above is true and complete to the best of my knowledge and belief.

SIGNED Paul Fletcher TITLE Agent DATE 7-28-81

APPROVED BY Mrs. S. W. P. P. TITLE OIL AND GAS DATE MAR 16 1982

CONDITIONS OF APPROVAL, IF ANY:

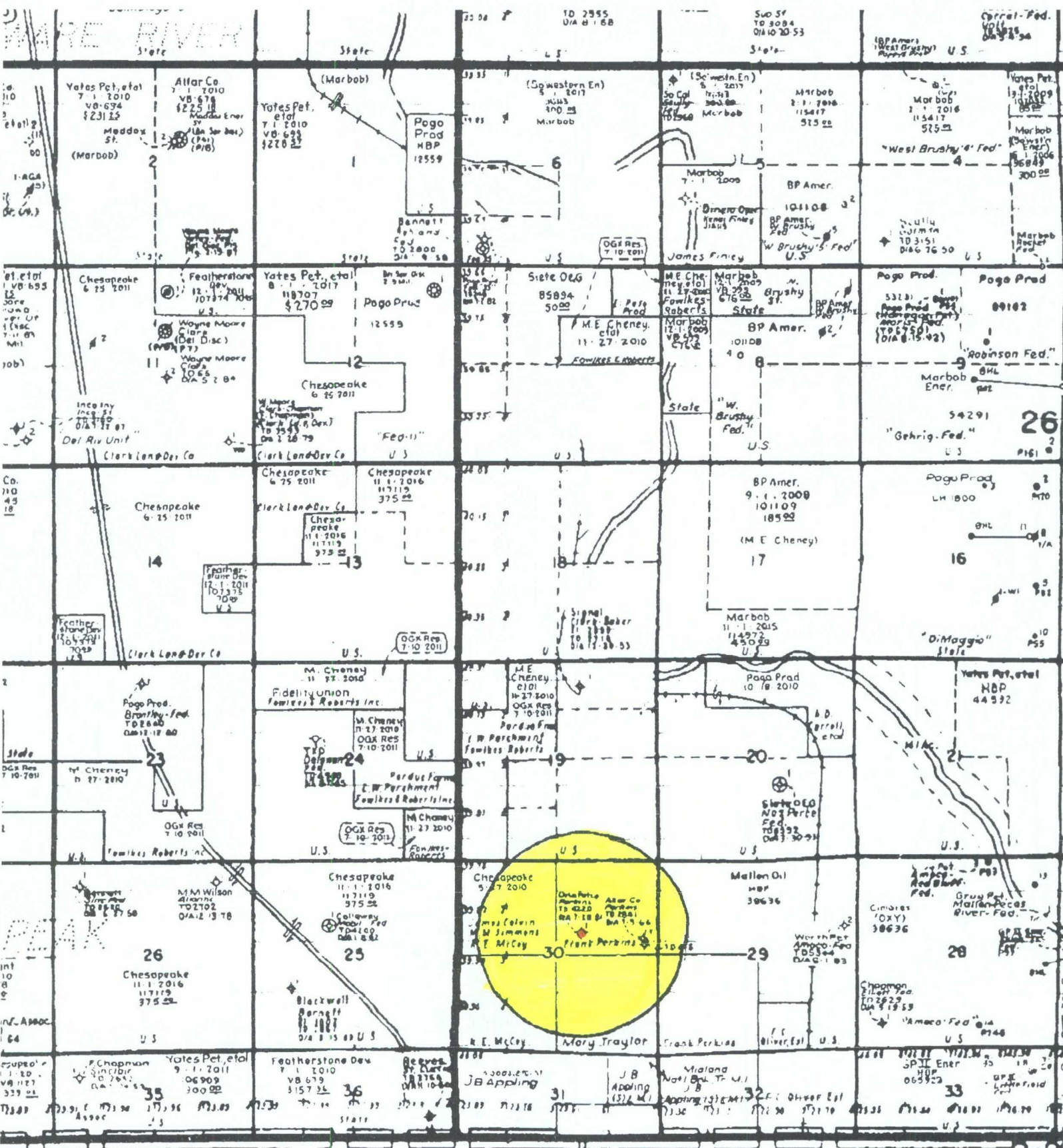

CULBERSON, East

DEEVES North

OGX RESOURCES, LLC
 PERKINS #1 SWD
 1980' FNL & 1980' FEL, G-30-T26S-R29E
 EDDY COUNTY, NEW MEXICO
 1/2-MILE RADIUS

CULBERSON, East

REEVES North

OGX RESOURCES, LLC

PERKINS #1 SWD

1980' FNL & 1980' FEL, G-30-T26S-R29E

EDDY COUNTY, NEW MEXICO

1/2-MILE RADIUS



RECEIVED

NO. OF COPIES RECEIVED	5
DISTRIBUTION	
SANTA FE	
FILE	
U.S.G.S.	
LAND OFFICE	
OPERATOR	2

MAY 27 1966
NEW MEXICO OIL CONSERVATION COMMISSION
WELL COMPLETION OR RECOMPLETION REPORT AND LOG
ARTESIA, OFFICE

Form C-105
Revised 1-1-65

5a. Indicate Type of Lease	
State <input type="checkbox"/>	Fee <input checked="" type="checkbox"/>
5. State Oil & Gas Lease No.	

1a. TYPE OF WELL					Abandoned lost hole						
b. TYPE OF COMPLETION					OTHER						
NEW WELL <input type="checkbox"/> WORK OVER <input type="checkbox"/> DEEPEN <input type="checkbox"/> PLUG BACK <input type="checkbox"/> DIFF. RESVR. <input type="checkbox"/> OTHER					8. Farm or Lease Name						
2. Name of Operator					Perkins						
THE ALLAR COMPANY 30-01S-10780					9. Well No.						
3. Address of Operator					1						
c/o Oil Reports & Gas Services, Box 763, Hobbs, N.Mex.					10. Field and Pool, or Wildcat						
4. Location of Well					Wildcat						
UNIT LETTER H LOCATED 2318 FEET FROM THE North LINE AND 330 FEET FROM					12. County						
THE East LINE OF SEC. 30 TWP. 26S RGE. 29E NMPM											
15. Date Spudded		16. Date T.D. Reached		17. Date Compl. (Ready to Prod.)		18. Elevations (DF, RKB, RT, GR, etc.)		19. Elev. Casinghead			
4-4-66		4-11-66		Abandoned 5-6-66		2933 GL		None			
20. Total Depth		21. Plug Back T.D.		22. If Multiple Compl., How Many		23. Intervals Drilled By		Rotary Tools Cable Tools			
395'						→		X			
24. Producing Interval(s), of this completion -- Top, Bottom, Name								25. Was Directional Survey Made			
Dry and abandoned								No			
26. Type Electric and Other Logs Run								27. Was Well Cored			
None								No			
28. CASING RECORD (Report all strings set in well)											
CASING SIZE		WEIGHT LB./FT.		DEPTH SET		HOLE SIZE		CEMENTING RECORD		AMOUNT PULLED	
8-5/8"		24#		395		11"		None		195'	
29. LINER RECORD											
SIZE		TOP		BOTTOM		SACKS CEMENT		SCREEN		30. TUBING RECORD	
None										SIZE DEPTH SET PACKER SET	
										None	
31. Perforation Record (Interval, size and number)						32. ACID, SHOT, FRACTURE, CEMENT SQUEEZE, ETC.					
None						DEPTH INTERVAL		AMOUNT AND KIND MATERIAL USED			
						None					
33. PRODUCTION											
Date First Production				Production Method (Flowing, gas lift, pumping -- Size and type pump)				Well Status (Prod. or Shut-in)			
None											
Date of Test		Hours Tested		Choke Size		Prod'n. For Test Period		Oil -- Bbl.		Gas -- MCF	
						→					
Flow Tubing Press.		Casing Pressure		Calculated 24-Hour Rate		Oil -- Bbl.		Gas -- MCF		Water -- Bbl.	
				→							
34. Disposition of Gas (Sold, used for fuel, vented, etc.)										Test Witnessed By	
35. List of Attachments											
36. I hereby certify that the information shown on both sides of this form is true and complete to the best of my knowledge and belief.											
SIGNED				TITLE				DATE			
Shaham J				President				5-27-66			

WELLBORE SCHEMATIC

Well Name & No.: The Allar Company Perkins 1

Field: Wildcat

Location: 2318' FNL & 330' FEL, Sec 30, T26S, R29E

County: Eddy State: NM API #: 30 015 10780

GR Elev: 2933.0 Spud Date: 04/04/66

KB: _____ Compl. Date: 5/6/1966 (Dry)

KB Elev: _____ P & A Date: 05/27/66

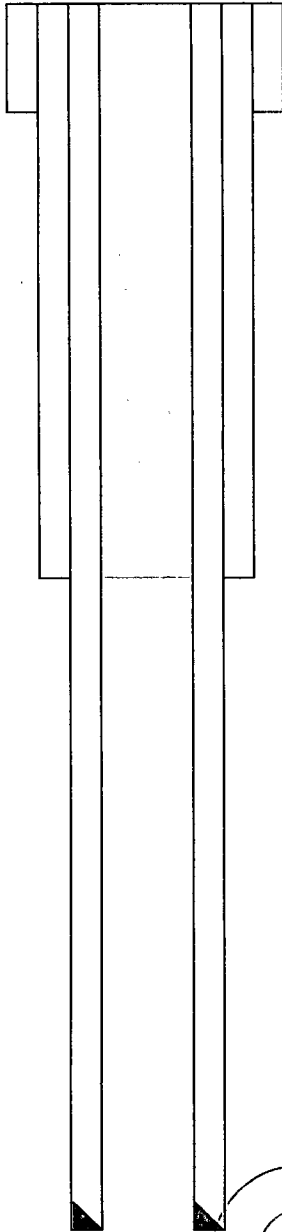

8 5/8" 24# csg
Set @ 395'

TD: 395', PBTD:

WELL HISTORY

4/4/66: Spud

Well P&A 5/27/66 (Dry)

Hole filled from TD to surf w/heavy mixed mud

Skidded 25' north for new hole (1-Y)

Ditch from new hole to slush pit over abandoned hole;
cavings used to completely plug the hole

Recovered 195' of 8-5/8" csg, leaving 200' in hole

*All info per Sundries on OCD web site

NO. OF COPIES RECEIVED	5
DISTRIBUTION	
SANTA FE	1
FILE	1-
U.S.G.S.	
LAND OFFICE	
OPERATOR	3

NEW MEXICO OIL CONSERVATION COMMISSION

Form C-103
Supersedes Old
C-102 and C-103
Effective 1-1-65

<p align="center">SUNDRY NOTICES AND REPORTS ON WELLS (DO NOT USE THIS FORM FOR PROPOSALS TO DRILL OR TO DEEPEN OR PLUG BACK TO A DIFFERENT RESERVOIR. USE "APPLICATION FOR PERMIT -" (FORM C-101) FOR SUCH PROPOSALS.)</p>		<p>5a. Indicate Type of Lease State <input type="checkbox"/> Fee <input checked="" type="checkbox"/></p> <p>5. State Oil & Gas Lease No.</p>
<p>1. OIL WELL <input type="checkbox"/> GAS WELL <input type="checkbox"/> OTHER- Dry Hole</p>	<p>7. Unit Agreement Name</p>	
<p>2. Name of Operator The Ailar Company ✓ 30-015-10836</p>	<p>8. Farm or Lease Name Perkins</p>	
<p>3. Address of Operator c/o Oil Reports & Gas Services, Box 763, Hobbs, New Mexico</p>	<p>9. Well No. 1-Y</p>	
<p>4. Location of Well UNIT LETTER H , 2293 FEET FROM THE North LINE AND 330 FEET FROM East LINE, SECTION 30 TOWNSHIP 26 S RANGE 29 E NMPM.</p>	<p>10. Field and Pool, or Wildcat Wildcat (Del.)</p>	
<p>15. Elevation (Show whether DF, RT, GR, etc.) 2933 GL</p>		<p>12. County Eddy</p>

16. Check Appropriate Box To Indicate Nature of Notice, Report or Other Data

NOTICE OF INTENTION TO:		SUBSEQUENT REPORT OF:	
PERFORM REMEDIAL WORK <input type="checkbox"/>	PLUG AND ABANDON <input type="checkbox"/>	REMEDIAL WORK <input type="checkbox"/>	ALTERING CASING <input type="checkbox"/>
TEMPORARILY ABANDON <input type="checkbox"/>	CHANGE PLANS <input type="checkbox"/>	COMMENCE DRILLING OPNS. <input type="checkbox"/>	PLUG AND ABANDONMENT <input checked="" type="checkbox"/>
PULL OR ALTER CASING <input type="checkbox"/>	OTHER <input type="checkbox"/>	CASING TEST AND CEMENT JOBS <input type="checkbox"/>	

17. Describe Proposed or Completed Operations (Clearly state all pertinent details, and give pertinent dates, including estimated date of starting any proposed work) SEE RULE 1103.

Plugged and abandoned 7/11 to 7/12/66 as follows:

50 sacks at total depth, 2841; 25 sack plug @ 2048'
25 sacks at 462 feet
8 5/8" casing cemented at 424 left in hole
10 sacks at surface with regulation marker
Mud between all plugs.

Above operations were witnessed by Mr. Dick Stamets.

Location is cleared and levelled and ready for inspection.

RECEIVED

AUG 17 1966

OIL & GAS

RECEIVED

AUG 17 1966

OIL & GAS

18. I hereby certify that the information above is true and complete to the best of my knowledge and belief.

SIGNED **A. L. Smith** TITLE **Agent** DATE **August 11, 1966**

APPROVED BY **[Signature]** TITLE **OIL AND GAS INSPECTOR** DATE **DEC 27 1966**

CONDITIONS OF APPROVAL, IF ANY:

NO. OF COPIES RECEIVED	5
DISTRIBUTION	
SANTA FE	1
FILE	1-
U.S.G.S.	2
LAND OFFICE	
OPERATOR	

Form C-105
Revised 1-1-65

NEW MEXICO OIL CONSERVATION COMMISSION
WELL COMPLETION OR RECOMPLETION REPORT AND LOG

30-015-10836

RECEIVED

5a. Indicate Type of Lease	
State <input type="checkbox"/>	Fee <input checked="" type="checkbox"/>
5. State Oil & Gas Lease No.	

1a. TYPE OF WELL
OIL WELL ☐ GAS WELL ☐ DRY ☒ OTHER ☐ **AUG 12 1966**

b. TYPE OF COMPLETION
NEW WELL ☒ WORK OVER ☐ DEEPEN ☐ PLUG BACK ☐ DIFF. RESVR. ☐ OTHER ☐ **C.C.C.**

2. Name of Operator
The Allar Company ✓

3. Address of Operator
c/o Oil Reports & Gas Services, Box 763, Hobbs, New Mexico

4. Location of Well
UNIT LETTER **H** LOCATED **2293** FEET FROM THE **North** LINE AND **330** FEET FROM

7. Unit Agreement Name

8. Farm or Lease Name
Perkins

9. Well No.
1-Y

10. Field and Pool, or Wildcat
Wildcat

4. Location of Well
THE **East** LINE OF SEC. **30** TWP. **26 S** RGE. **29 E** NMPM

12. County
Eddy

15. Date Spudded 5/9/66	16. Date T.D. Reached 7/9/66	17. Date Compl. (Ready to Prod.) 7/9/66 (dry)	18. Elevations (DF, RKB, RT, CR, etc.) 2933 GL	19. Elev. Casinghead
-----------------------------------	--	---	--	----------------------

20. Total Depth 2841	21. Plug Back T.D.	22. If Multiple Compl., How Many	23. Intervals Drilled By Rotary Tools Cable Tools 0 - TD
--------------------------------	--------------------	----------------------------------	--

24. Producing Interval(s), of this completion — Top, Bottom, Name
None - P & A 7/12/66

25. Was Directional Survey Made
No

26. Type Electric and Other Logs Run
None

27. Was Well Cored
No

28. CASING RECORD (Report all strings set in well)					
CASING SIZE	WEIGHT LB./FT.	DEPTH SET	HOLE SIZE	CEMENTING RECORD	AMOUNT PULLED
10"	32#	200	12"	Mudded	200
8 5/8"	24#	424	10"	50 sx	none
7"	20#	1578	8"	Mudded	1578

29. LINER RECORD					30. TUBING RECORD		
SIZE	TOP	BOTTOM	SACKS CEMENT	SCREEN	SIZE	DEPTH SET	PACKER SET

31. Perforation Record (Interval, size and number)	32. ACID, SHOT, FRACTURE, CEMENT SQUEEZE, ETC.	
	DEPTH INTERVAL	AMOUNT AND KIND MATERIAL USED

33. PRODUCTION

Date First Production	Production Method (Flowing, gas lift, pumping — Size and type pump)	Well Status (Prod. or Shut-in)
Date of Test	Hours Tested	Choke Size
Flow Tubing Press.	Casing Pressure	Calculated 24-Hour Rate

34. Disposition of Gas (Sold, used for fuel, vented, etc.)

Test Witnessed By

35. List of Attachments

36. I hereby certify that the information shown on both sides of this form is true and complete to the best of my knowledge and belief.

SIGNED *H. L. Smith* TITLE Agent DATE August 11, 1966

WELLBORE SCHEMATIC

Well Name & No.: The Allar Company Perkins 1

Field: Wildcat

Location: 2318' FNL & 330' FEL, Sec 30, T26S, R29E

County: Eddy State: NM API #: 30 015 10780

GR Elev: 2933.0 Spud Date: 04/04/66

KB: Compl. Date: 5/6/1966 (Dry)

KB Elev: P & A Date: 05/27/66

WELL HISTORY

4/4/66: Spud

Well P&A 5/27/66 (Dry)

Hole filled from TD to surf w/heavy mixed mud

Skidded 25' north for new hole (1-Y)

Ditch from new hole to slush pit over abandoned hole;
cavings used to completely plug the hole

Recovered 195' of 8-5/8" csg, leaving 200' in hole

*All info per Sundries on OCD web site

8 5/8" 24# csg
Set @ 395'

TD: 395', PBTD:

WELLBORE SCHEMATIC

Well Name & No.: The Allar Company Perkins 1-Y
Field: Wildcat (Delaware)
Location: 2293' FNL & 330' FEL, Sec 30, T26S, R29E
County: Eddy State: NM API #: 30 015 10836
GR Elev: 2933.0 Spud Date: 05/09/66
KB: Compl. Date: 7/9/1966 (Dry)
KB Elev: P & A Date: 07/12/66

WELL HISTORY

5/9/66: Spud

Well P&A 7/12/66 (Dry)
Plug #1 - 50 sx cmt @ TD (2841')
Plug #2 - 25 sx cmt @ 2048'
Plug #3 - 25 sx cmt @ 462'
Plug #4 - 8-5/8" csg cmt'd @ 424'; left in hole
Plug #5 - 10 sx cmt @ surface w/marker
Mud between all plugs.

*All info per Sundries on OCD web site

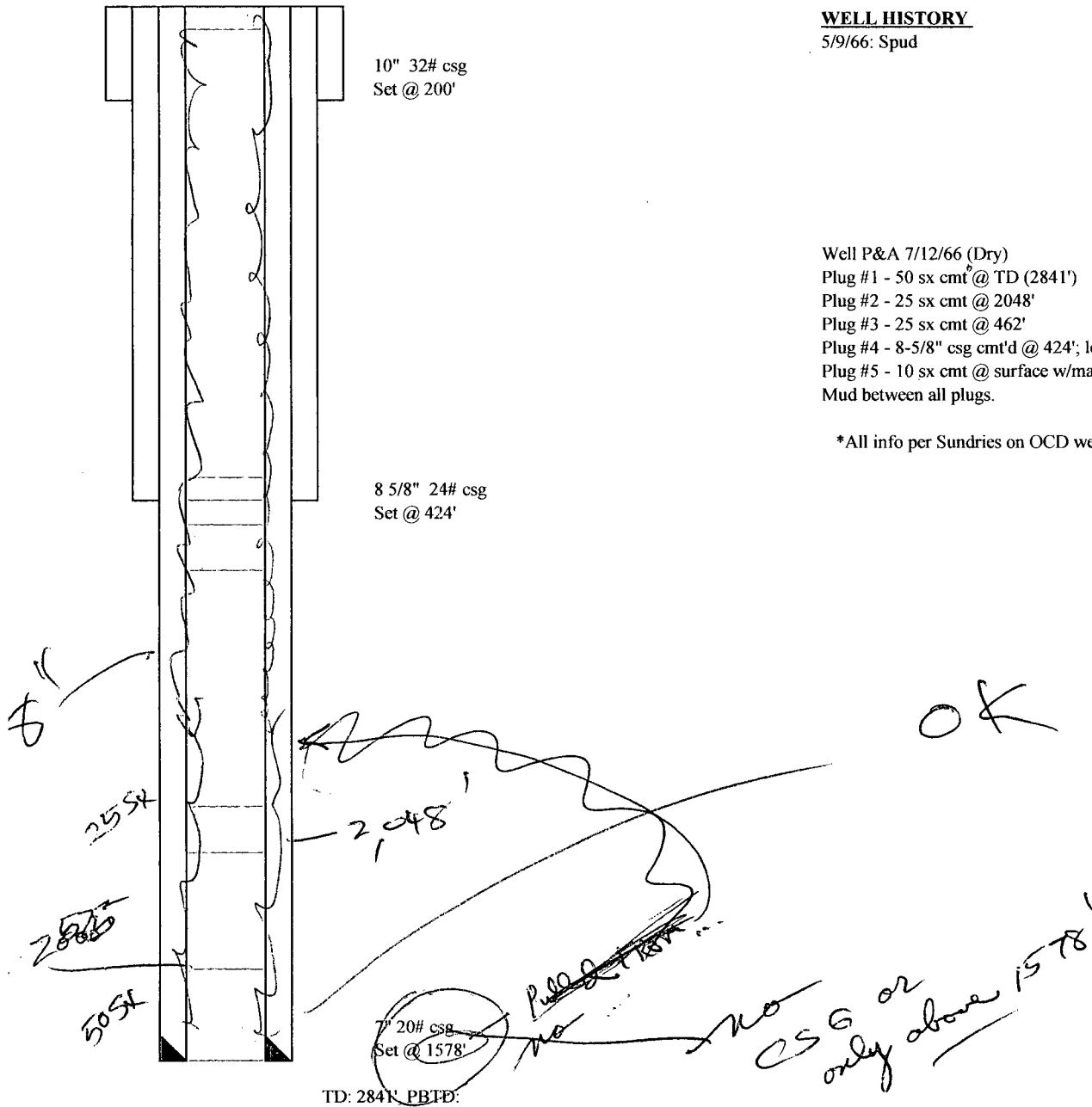

OGX Resources, LLC
Sec. 30, T26S, R29E
Perkins Well #1: C-108 Application Filing
Eddy County, New Mexico

New Mexico Oil Conservation Division:

Available geologic and engineering data have been examined and no evidence of open faults or hydrological connection between the disposal zone and any underground sources of drinking water has been found.



William E. Hardie, Geologist
OGX Resources, LLC

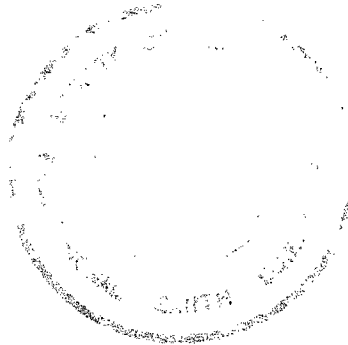

original submitted to OCD Santa Fe 6-3-10

Scanned with
CamScanner 5/29/21



New Mexico Office of the State Engineer

Water Column/Average Depth to Water

No records found.

Basin/County Search:

County: Eddy

PLSS Search:

Section(s): 30

Township: 26S

Range: 29E

The data is furnished by the NMOSE/ISC and is accepted by the recipient with the expressed understanding that the OSE/ISC make no warranties, expressed or implied, concerning the accuracy, completeness, reliability, usability, or suitability for any particular purpose of the data.

BEST COPY
AVAILABLE

Schlumberger

COMPENSATED NEUTRON FORMATION DENSITY

COUNTY	EDDY	FIELD	WILDCAT	LOCATION	PERKINS #1	WELL	PERKINS #1	COMPANY	ORLA PETCO, INC.	
COMPANY <u>ORLA PETCO, INC.</u>										
WELL <u>PERKINS #1</u>										
FIELD <u>WILDCAT Cherry Canyon</u>										
COUNTY <u>EDDY</u> STATE <u>NEW MEXICO</u>										
LOCATION	1980' FNL & 1980' FEL, (7)								Other Services: DLL	
API SERIAL NO.	SEC	TWP.	RANGE							
	30	26-S	29-E							
Permanent Datum: <u>G.L.</u> ; Elev.: <u>2923</u>										
Log Measured From <u>K.B.</u> <u>12</u> Ft. Above Perm. Datum										
Drilling Measured From <u>K.B.</u>										
Elev.: K.B. <u>2935</u>										
D.F. <u>2923</u>										
G.L. <u>2923</u>										
Date	7-25-81									
Run No.	ONE									
Depth-Driller	4275									
Depth-Logger	4268									
Btm. Log Interval	4267									
Top Log Interval	SURF									
Casing-Driller	8 5/8 @ 450 @ @ @									
Casing-Logger	420									
Bit Size	7.875									
Type Fluid in Hole	GEL CHEM									
Dens.	10.2		35							
pH	8		ml		ml		ml		ml	
Source of Sample	FLOWLINE									
Rm @ Meas. Temp.	.050 @ 82 F @ °F @ °F @ °F									
Rmf @ Meas. Temp.	@ °F @ °F @ °F @ °F									
Rmc @ Meas. Temp.	@ °F @ °F @ °F @ °F									
Source: Rmf Rmc										
Rm @ BHT	.043 @ 99 F @ °F @ °F @ °F									
Circulation Stopped	0200									
Logger on Bottom	0800									
Max. Rec. Temp.	97 °F °F °F °F									
Equip. Location	8141 RSWL									
Recorded By	PINISETTI									
Witnessed By	KENNEDY									

FOLD HERE

Submitted to OGD-
Santa Fe
6-3-10

Affidavit of Publication

NO. 21193

STATE OF NEW MEXICO

County of Eddy:

Gary D Scott

being duly sworn, says that he is the **Publisher**

of the Artesia Daily Press, a daily newspaper of general circulation, published in English at Artesia, said county and county and state, and that the hereto attached

Legal Notice

was published in a regular and entire issue of the said Artesia Daily Press, a daily newspaper duly qualified for that purpose within the meaning of Chapter 167 of the 1937 Session Laws of the state of New Mexico for

1 Consecutive week/days on the same

day as follows:

First Publication May 26, 2010

Second Publication

Third Publication

Fourth Publication

Fifth Publication

Subscribed and sworn to before me this

28th Day of MAY 2010



OFFICIAL SEAL
Danny Scott
NOTARY PUBLIC-STATE OF NEW MEXICO

My commission expires: 3/18/2014

Danny Scott
Danny Scott
Notary Public, Eddy County, New Mexico

Copy of Publication:

LEGAL NOTICE

NOTICE OF INJECTION APPLICATION
OGX Resources, LLC
c/o P.O. Box 953
Midland, TX 79702 will
file the New Mexico
Conservation Division
Form C-108
Application for
Authorization to Inject
with the NMCD seeking
administrative
approval for non-commercial water injection/disposal into their Perkins No. 1 well, 1980 FNL & 1980 FEL of Sec 30, T26S, R29E in Eddy County, NM.

The proposed injection interval is from 2750-4230'. The proposed maximum surface pressure is 875 psi with maximum injection rate of 4000 bbls water per day. The injection water will be sourced from the Cherry Canyon Formation. All interested parties opposing the application must file objection with the New Mexico Oil Conservation Division, 1220 South St. Francis Drive, Santa Fe, NM 87505 within 15 days of this notice. Additional information can be obtained by contacting Ann Ritchie, Regulatory Agent, OGX Resources, LLC, c/o P.O. Box 953, Midland, TX 79702, (432) 684-6381.

Published in the Artesia Daily Press, Artesia, NM, May 26, 2010. Legal No. 21193.

original submitted to
OCD Santa Fe 6-3-10.

June 3, 2010

New Mexico Oil Conservation Division
Engineering Bureau
1220 South St. Francis Drive
Santa Fe, NM 87505

Re: Certified Mailings to Land Owners
OGX Resources, LLC
Perkins #1 SWD
API No. 32-015-23849

Dear Sirs/Madam:

Copies of this application were mailed to the surface owners via Certified Mail the same day as this submission, Thursday, June 3, 2010. Copies of the unprocessed certified receipts are attached.

Sincerely,

A handwritten signature in black ink, appearing to read "Ann E. Ritchie", written in a cursive style.

Ann E. Ritchie
Regulatory Agent
OGX Resources, LLC
c/o PO Box 953
Midland, TX 79702

June 14, 2010

RECEIVED OCD

2010 JUN 17 P 1:22

Engineering Bureau
New Mexico Oil Conservation Division
1220 South St. Francis
Santa Fe, NM 87505

Re: Administrative Application for Waterflood Expansion
OGX Resources, LLC
Perkins #1

Dear Sir/Madam:

Enclosed please find an amended offset operator listing for the above referenced SWD application. These operators were notified by copy of the application, data sheet and map on June 14, 2010.

If you have questions or require additional information, please feel free to contact me at 432-684-6381.

Sincerely,



Ann E Ritchie
Regulatory Agent
OGX Resources, LLC
c/o P.O. Box 953
Midland, TX 79702
ann.wtor@gmail.com

Enclosures

OGX RESOURCES, LLC
PERKINS #1
SWD APPLICATION, FORM C-108

AMENDED

OPERATORS WITHIN ONE HALF MILE RADIUS

1. CHESAPEAKE OPERATING INC	PO Box 18496	OKLAHOMA CITY, OK 73154
2. OXY USA	PO Box 4294	HOUSTON, TX 77210
3. CIMAREX ENERGY CO.	600 N MARIENFELD STE 600	MIDLAND, TX 79701
4. BUREAU OF LAND MANAGEMENT	PO Box 27115	SANTA FE, NM 87502-0115

A COPY OF THE OCD FORM C-108 DATA SHEET & MAP HAVE BEEN SENT BY CERTIFIED MAIL TO THE ABOVE PARTIES ON JUNE 14, 2010.

SURFACE OWNERS ARE AS FOLLOWS:

1. CAROL GENE LEONARD AND HUSBAND, GARY C LEONARD	202 N CONCHO	SAN ANGELO, TX 76950
2. FRANK T PERKINS	314 CROSSING COURT	KELLER, TX 76950
3. MARY ELIZABETH VANDERHIDER	5214 WEST RIDGE PLACE	HOUSTON, TX 77041

A COPY OF THE OCD FORM C-108 DATA SHEET & MAP HAVE BEEN SENT BY CERTIFIED MAIL TO THE ABOVE PARTIES ON JUNE 3, 2010.

*and June 14, 2010
agr*



ANN E. RITCHIE, REGULATORY AGENT

OGX RESOURCES, LLC
c/o PO Box 953
MIDLAND, TX 79702

7009 1680 0000 1709 7908

U.S. Postal Service™	
CERTIFIED MAIL™ RECEIPT	
(Domestic Mail Only; No Insurance Coverage Provided)	
For delivery information visit our website at www.usps.com	
HOUSTON TX 77210	
OFFICIAL USE	
Postage	\$ 0.44
Certified Fee	\$2.80
Return Receipt Fee (Endorsement Required)	\$2.30
Restricted Delivery Fee (Endorsement Required)	\$0.00
Total Postage & Fees	\$ 5.54

Sent To OXY USA

Street, Apt. No., or PO Box No. PO Box 4294

City, State, ZIP+4 HOUSTON TX 77210

PS Form 3800, August 2006 See Reverse for Instructions

7009 1680 0000 1709 7922

U.S. Postal Service™	
CERTIFIED MAIL™ RECEIPT	
(Domestic Mail Only; No Insurance Coverage Provided)	
For delivery information visit our website at www.usps.com	
SANTA FE NM 87502	
OFFICIAL USE	
Postage	\$ 0.44
Certified Fee	\$2.80
Return Receipt Fee (Endorsement Required)	\$2.30
Restricted Delivery Fee (Endorsement Required)	\$0.00
Total Postage & Fees	\$ 5.54

Sent To BLM

Street, Apt. No., or PO Box No. PO Box 27115

City, State, ZIP+4 SANTA FE NM 87502-0115

PS Form 3800, August 2006 See Reverse for Instructions

7009 1680 0000 1709 7915

U.S. Postal Service™	
CERTIFIED MAIL™ RECEIPT	
(Domestic Mail Only; No Insurance Coverage Provided)	
For delivery information visit our website at www.usps.com	
MIDLAND TX 79701	
OFFICIAL USE	
Postage	\$ 0.44
Certified Fee	\$2.80
Return Receipt Fee (Endorsement Required)	\$2.30
Restricted Delivery Fee (Endorsement Required)	\$0.00
Total Postage & Fees	\$ 5.54

Sent To CIMAREX ENERGY Co

Street, Apt. No., or PO Box No. 600 N MARIENFELD STE 600

City, State, ZIP+4 MIDLAND TX 79701

PS Form 3800, August 2006 See Reverse for Instructions

U.S. Postal Service
CERTIFIED MAIL RECEIPT
(Domestic Mail Only; No Insurance Coverage Provided)

For delivery information visit our website at www.usps.com

OFFICIAL USE

Postage	\$
Certified Fee	
Return Receipt Fee (Endorsement Required)	
Restricted Delivery Fee (Endorsement Required)	
Total Postage & Fees	\$

Postmark
Here

Sent To **CAROL GENE LEONARD**
Street, Apt. No.,
or PO Box No. **202 N COUCHO**
City, State, ZIP+4 **SAN ANGELO TX 76950**

PS Form 3800, August 2006

See Reverse for Instructions

7009 1680 0000 1709 7878
7009 1680 0000 1709 7878

LLC

2

U.S. Postal Service
CERTIFIED MAIL RECEIPT
(Domestic Mail Only; No Insurance Coverage Provided)

For delivery information visit our website at www.usps.com

OFFICIAL USE

Postage	\$
Certified Fee	
Return Receipt Fee (Endorsement Required)	
Restricted Delivery Fee (Endorsement Required)	
Total Postage & Fees	\$

Postmark
Here

Sent To **FRANK T PERKINS**
Street, Apt. No.,
or PO Box No. **314 CROSSING CT**
City, State, ZIP+4 **KELLER TX 76950**

See Reverse for Instructions

7009 1680 0000 1709 7885
7009 1680 0000 1709 7885

U.S. Postal Service
CERTIFIED MAIL RECEIPT
(Domestic Mail Only; No Insurance Coverage Provided)

For delivery information visit our website at www.usps.com

OFFICIAL USE

Postage	\$
Certified Fee	
Return Receipt Fee (Endorsement Required)	
Restricted Delivery Fee (Endorsement Required)	
Total Postage & Fees	\$

Postmark
Here

Sent To **MARY ELIZABETH VANDERHOEK**
Street, Apt. No.,
or PO Box No. **5214 WEST RIDGE PLACE**
City, State, ZIP+4 **HOUSTON TX 77041**

PS Form 3800, August 2006

See Reverse for Instructions

7009 1680 0000 1709 7892
7009 1680 0000 1709 7892

CERTIFIED MAIL

JURCES, LLC
X 953
TX 79702

U.S. Postal Service
CERTIFIED MAIL RECEIPT
(Domestic Mail Only; No Insurance Coverage Provided)

For delivery information visit our website at www.usps.com

OFFICIAL USE

Postage	\$ \$0.44
Certified Fee	\$2.80
Return Receipt Fee (Endorsement Required)	\$0.00
Restricted Delivery Fee (Endorsement Required)	\$0.00
Total Postage & Fees	\$ \$3.24

Sent To: *Chesapeake Operating, Inc.*
Street, Apt. No., or PO Box No.: *P.O. Box 18496*
City, State, ZIP+4: *OKLAHOMA CITY OK 73154*

PS Form 3800, August 2006 See Reverse for Instructions

U.S. Postal Service
CERTIFIED MAIL RECEIPT
(Domestic Mail Only; No Insurance Coverage Provided)

For delivery information visit our website at www.usps.com

OFFICIAL USE

Postage	\$ \$0.44
Certified Fee	\$2.80
Return Receipt Fee (Endorsement Required)	\$0.00
Restricted Delivery Fee (Endorsement Required)	\$0.00
Total Postage & Fees	\$ \$3.24

Sent To: *Dky USA*
Street, Apt. No., or PO Box No.: *P.O. Box 4294*
City, State, ZIP+4: *Houston, TX 77210*

PS Form 3800, August 2006 See Reverse for Instructions

U.S. Postal Service
CERTIFIED MAIL RECEIPT
(Domestic Mail Only; No Insurance Coverage Provided)

For delivery information visit our website at www.usps.com

OFFICIAL USE

Postage	\$ \$0.44
Certified Fee	\$2.80
Return Receipt Fee (Endorsement Required)	\$0.00
Restricted Delivery Fee (Endorsement Required)	\$0.00
Total Postage & Fees	\$ \$3.24

Sent To: *Carol G. + Gary C. Leonard*
Street, Apt. No., or PO Box No.: *202 N. Concho*
City, State, ZIP+4: *San Angelo, TX 76903*

PS Form 3800, August 2006 See Reverse for Instructions

U.S. Postal Service
CERTIFIED MAIL RECEIPT
(Domestic Mail Only; No Insurance Coverage Provided)

For delivery information visit our website at www.usps.com

OFFICIAL USE

Postage	\$ \$0.44
Certified Fee	\$2.80
Return Receipt Fee (Endorsement Required)	\$0.00
Restricted Delivery Fee (Endorsement Required)	\$0.00
Total Postage & Fees	\$ \$3.24

Sent To: *MARY E. Vanderhider*
Street, Apt. No., or PO Box No.: *5214 West Ridge Place*
City, State, ZIP+4: *Houston, TX 77041*

PS Form 3800, August 2006 See Reverse for Instructions

U.S. Postal Service
CERTIFIED MAIL RECEIPT
(Domestic Mail Only; No Insurance Coverage Provided)

For delivery information visit our website at www.usps.com

OFFICIAL USE

Postage	\$ \$0.44
Certified Fee	\$2.80
Return Receipt Fee (Endorsement Required)	\$0.00
Restricted Delivery Fee (Endorsement Required)	\$0.00
Total Postage & Fees	\$ \$3.24

Sent To: *Bureau of Land Management*
Street, Apt. No., or PO Box No.: *P.O. Box 27115*
City, State, ZIP+4: *Santa Fe N.M. 87502-0115*

PS Form 3800, August 2006 See Reverse for Instructions

U.S. Postal Service
CERTIFIED MAIL RECEIPT
(Domestic Mail Only; No Insurance Coverage Provided)

For delivery information visit our website at www.usps.com

OFFICIAL USE

Postage	\$ \$0.44
Certified Fee	\$2.80
Return Receipt Fee (Endorsement Required)	\$0.00
Restricted Delivery Fee (Endorsement Required)	\$0.00
Total Postage & Fees	\$ \$3.24

Sent To: *Cimarex Energy Co.*
Street, Apt. No., or PO Box No.: *600 N. Maricopa, Ste. 600*
City, State, ZIP+4: *Midland, TX 79701*

PS Form 3800, August 2006 See Reverse for Instructions

U.S. Postal Service
CERTIFIED MAIL RECEIPT
(Domestic Mail Only; No Insurance Coverage Provided)

For delivery information visit our website at www.usps.com

OFFICIAL USE

Postage	\$ \$0.44
Certified Fee	\$2.80
Return Receipt Fee (Endorsement Required)	\$0.00
Restricted Delivery Fee (Endorsement Required)	\$0.00
Total Postage & Fees	\$ \$3.24

Sent To: *FRANK T. Perkins*
Street, Apt. No., or PO Box No.: *314 Crossing Court*
City, State, ZIP+4: *Keller, TX 76248*

PS Form 3800, August 2006 See Reverse for Instructions

6-30-10
2nd
mailing

U.S. Postal Service
CERTIFIED MAIL RECEIPT
 (Domestic Mail Only, No Insurance Coverage Provided)

For delivery information visit our website at www.usps.com

KELLER TX 76248

Postage \$ \$0.44

Certified Fee \$2.80

Return Receipt Fee (Endorsement Required) \$0.00

Restricted Delivery Fee (Endorsement Required) \$0.00

Total Postage & Fees \$ \$3.24

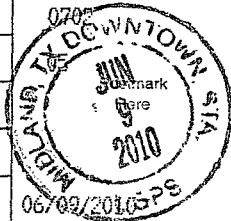

Sent To **FRANK T PERKINS**
 Street, Apt. No., or PO Box No. **314 CROSSING CT**
 City, State, ZIP+4 **KELLER TX 76248**

PS Form 3800, August 2005 See Reverse for Instructions

U.S. Postal Service
CERTIFIED MAIL RECEIPT
 (Domestic Mail Only, No Insurance Coverage Provided)

For delivery information visit our website at www.usps.com

HOUSTON TX 77041

Postage \$ \$0.44

Certified Fee \$2.80

Return Receipt Fee (Endorsement Required) \$2.30

Restricted Delivery Fee (Endorsement Required) \$0.00

Total Postage & Fees \$ \$5.54

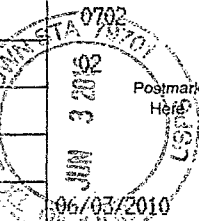

Sent To **MARY ELIZABETH VANDERHOER**
 Street, Apt. No., or PO Box No. **5214 WEST RIDGE PLACE**
 City, State, ZIP+4 **HOUSTON TX 77041**

PS Form 3800, August 2005 See Reverse for Instructions

U.S. Postal Service
CERTIFIED MAIL RECEIPT
 (Domestic Mail Only, No Insurance Coverage Provided)

For delivery information visit our website at www.usps.com

MIDLAND TX 79701

Postage \$ \$0.44

Certified Fee \$2.80

Return Receipt Fee (Endorsement Required) \$2.30

Restricted Delivery Fee (Endorsement Required) \$0.00

Total Postage & Fees \$ \$5.54

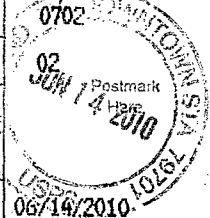

Sent To **CIMAREX ENERGY Co**
 Street, Apt. No., or PO Box No. **600 N MARIENFELD STE 600**
 City, State, ZIP+4 **MIDLAND TX 79701**

PS Form 3800, August 2005 See Reverse for Instructions

U.S. Postal Service
CERTIFIED MAIL RECEIPT
 (Domestic Mail Only, No Insurance Coverage Provided)

For delivery information visit our website at www.usps.com

SAN ANGELO TX 76903

Postage \$ \$0.44

Certified Fee \$2.80

Return Receipt Fee (Endorsement Required) \$0.00

Restricted Delivery Fee (Endorsement Required) \$0.00

Total Postage & Fees \$ \$3.24

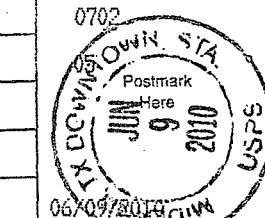

Sent To **CAROL GENE LEONARD**
 Street, Apt. No., or PO Box No. **202 N CONCHO**
 City, State, ZIP+4 **SAN ANGELO TX 76903**

PS Form 3800, August 2005 See Reverse for Instructions

U.S. Postal Service
CERTIFIED MAIL RECEIPT
 (Domestic Mail Only, No Insurance Coverage Provided)

For delivery information visit our website at www.usps.com

SANTA FE NM 87502

Postage \$ \$0.44

Certified Fee \$2.80

Return Receipt Fee (Endorsement Required) \$2.30

Restricted Delivery Fee (Endorsement Required) \$0.00

Total Postage & Fees \$ \$5.54

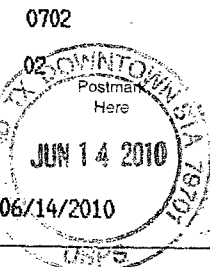

Sent To **BLM**
 Street, Apt. No., or PO Box No. **PO Box 27115**
 City, State, ZIP+4 **SANTA FE NM 87502-0115**

PS Form 3800, August 2005 See Reverse for Instructions

U.S. Postal Service
CERTIFIED MAIL RECEIPT
 (Domestic Mail Only, No Insurance Coverage Provided)

For delivery information visit our website at www.usps.com

HOUSTON TX 77210

Postage \$ \$0.44

Certified Fee \$2.80

Return Receipt Fee (Endorsement Required) \$2.30

Restricted Delivery Fee (Endorsement Required) \$0.00

Total Postage & Fees \$ \$5.54

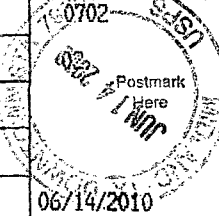

Sent To **OXY USA**
 Street, Apt. No., or PO Box No. **PO Box 4294**
 City, State, ZIP+4 **HOUSTON TX 77210**

PS Form 3800, August 2005 See Reverse for Instructions

1st certified mailing

7009 1680 0000 1709 8721

U.S. Postal Service
CERTIFIED MAIL - RECEIPT
(Domestic Mail Only; No Insurance Coverage Provided)

For delivery information visit our website at www.usps.com
OKLAHOMA CITY OK 73154

Postage	\$	\$0.44
Certified Fee		\$2.80
Return Receipt Fee (Endorsement Required)		\$2.30
Restricted Delivery Fee (Endorsement Required)		\$0.00
Total Postage & Fees	\$	\$5.54

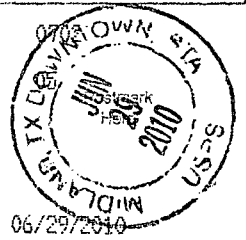

Sent To Chesapeake Operating, Inc.
Street, Apt. No.,
or PO Box No. P.O. Box 18496
City, State, ZIP+4 Oklahoma City, OK 73154
PS Form 3800, August 2006 See Reverse for Instructions

Jones, William V., EMNRD

Conrad

From: Jones, William V., EMNRD
Sent: Friday, July 02, 2010 11:46 AM
To: 'Ann Ritchie'
Cc: Ezeanyim, Richard, EMNRD; Dade, Randy, EMNRD; Gray, Darold, EMNRD
Subject: Disposal application from OGX Resources, LLC: Perkins #1 30-015-23849 Delaware

Hello Ms. Ritchie:

Reviewed this application and have a couple questions and requests.

- a. Please send the proof of notice to Chesapeake – I couldn't find it.
- b. Is there any Fresh Water sands in this area? Any wells or windmills within a mile? IF so, send water analysis.
- c. What waste "waters" will be disposed into this well? What formations? Send water analysis of these waters?
- d. Please identify all separate "identically owned tracts" wholly or partially contained in the ½ mile area of review and list the "affected persons" within each tract.
- e. Apparently all tracts are leased over the Delaware depths – is this correct?

Release 7/16/10

Thank You,

William V Jones, P.E.
Engineering, Oil Conservation Division
1220 South St. Francis Drive, Santa Fe, NM 87505
Tel 505.476.3448 ~ Fax 505.476.3462



June 29, 2010

Richard Ezeanyim, Engineering
New Mexico Oil Conservation Division
1220 South St. Francis Drive
Santa Fe, NM 87505

RECEIVED OCD

2010 JUL -6 P 1:10

Re: OGX Resources, LLC, Perkins, Well #1; Section 30, T26S, R29E, Eddy County, New Mexico
C-108 Injection Application: Additional Data Submittal

Dear Mr. Ezeanyim,

As per our phone conversation, the proposed injection data sheet was not included in the application as submitted to your office on June 3, 2010. Please see enclosed "Attachment A" which includes all the data for the C-108 Items VII through XI, which were not included in the initial filing. I have also enclosed the new certified mailing receipts as we have re-submitted the data to the affected parties, along with the 2 mile radius map and water analysis from area producing wells. There are no fresh water wells within 1 mile of the applied for well.

The above documentation is submitted within a copy of the entire filing, as it should have been submitted to you initially.

The source of the injection water will be produced area formation water from the Delaware and Bone Springs formations from OGX area producing wells.

Please let me know if you need further information or documentation in order to consider and approve this injection filing. Thank you.

Yours truly,



Ann E. Ritchie, Regulatory Agent
OGX Resources, LLC
c/o P.O. Box 953
Midland, TX 79702
(432) 684-6381; ann.wtor@gmail.com

Attachments

Injection Permit Checklist (06/24/2010)

Case _____ R- _____ SWD 1230 WFX _____ PMX _____ IPI _____ Permit Date _____ UIC Qtr _____

Wells 1 Well Name: PERKINS #1

API Num: (30-) 015-23849 Spud Date: 7/8/81 New/Old: 0 (UIC primacy March 7, 1982)

Footages 1980 FNL/1980 FEL Unit G Sec 30 Tsp 26S Rge 29E County Eddy

Operator: OGX Resources, LLC Contact Anna RITCHE

Operator Address: 4000 RITCHE PO. BOX 753, MIDLAND TX 79702

OGRID: 247055 RULE 5.9 Compliance (Wells) 0/23 (Finan Assur) 0/2 IS 5.9 OK? OK

Well File Reviewed ✓ Current Status: Dry Hole PLUGGED w/o CSG

General Location: 2 mi N. of State Line Just N. of Red BLUFF Res.

Diagrams: Before Conversion ✓ After Conversion ✓ Elogs in Imaging File: _____

Planned Work to Well: Re-entry Run 5 1/2"

	Sizes Hole.....Pipe	Setting Depths	Cement Sx or Cf	Cement Top and Determination Method
Existing <u>✓</u> Surface	<u>12 1/4 8 5/8</u>	<u>420'</u>	<u>300</u>	<u>CIRC</u>
Existing <u>✓</u> Intern				
New <u>✓</u> Existing <u>✓</u> LongSt	<u>7 7/8 5 1/2</u>	<u>4220</u>	<u>750</u>	

DV Tool _____ Liner _____ Open Hole _____ Total Depth 4220 Deviated Hole? _____

Intervals:	Depths, Ft.	Formation	Producing?
Formation Above	<u>2740</u>	<u>TOP Del.</u>	
Formation Above	<u>3590</u>	<u>TOP chng</u>	
Injection TOP:	<u>2750</u>	<u>chng</u>	Max. PSI <u>550</u> Open Hole? <u>✓</u> Perfs? <u>✓</u>
Injection BOTTOM:	<u>4230</u>	<u>chng</u>	Tubing Size <u>2 7/8</u> Packer Depth <u>2700</u>
Formation Below			
Formation Below			

Sensitive Areas: Capitan Reef Chalk House Salt Depths 350 884

Potash Area (R 111 P) _____ Potash Lessee _____ Noticed? _____ (WIPP2) _____ Noticed? _____

Fresh Water: Depths _____ Formation _____ Wells? _____ Analysis? _____ Affirmative Statement ✓

Disposal Fluid Sources: _____ Analysis? _____

Disposal Interval Production Potential/Testing: _____ Analysis _____

5/26/10 ✓ Notice Newspaper(Y/N) _____ Surface Owner ✓ Mineral Owner(s) ✓

RULE 26.7(A) Affected Parties: OGX / Cimatrix / BLU / Chng

Area of Review: Adequate Map (Y/N) ✓ and Well List (Y/N) ✓

Active Wells 0 Num Repairs ✓ Producing in Injection Interval in AOR ✓

P&A Wells 1 Num Repairs 0 All Wellbore Diagrams Included? ✓

Questions/Required Work: NOTICE: are all the "operator" the only "affected parties"?

Send designated Proof of NOTICE

Request Sent _____ Reply: _____