

GW - 028

MONITORING REPORT

Annual GW Monitoring Rep

MAPS

(Feb 2011)

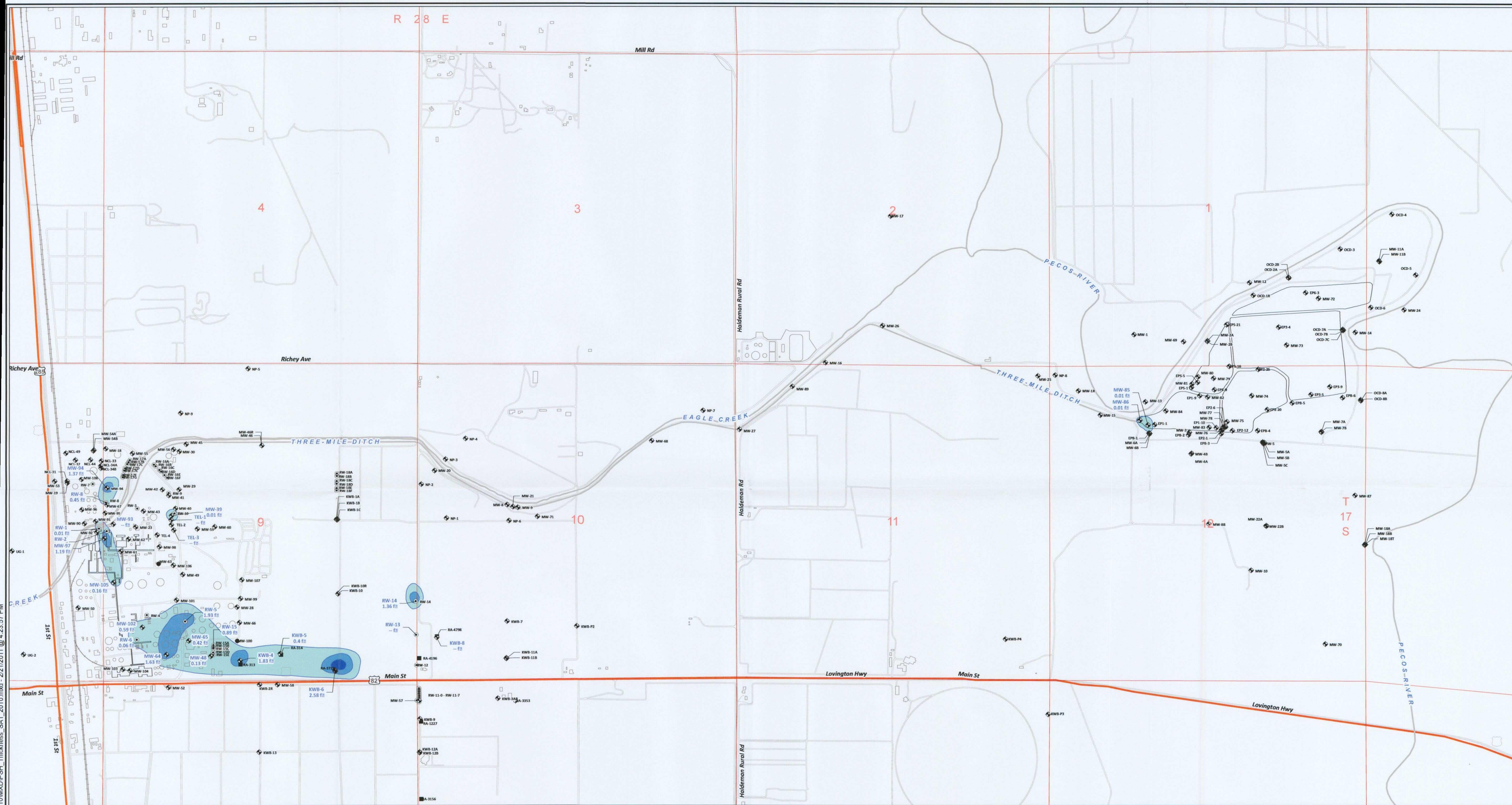

LEGEND:

PSH THICKNESS

- 0 - 1 FOOT
- 1 - 2 FEET
- 2 - 3 FEET
- >3 FEET

- MONITORING WELL
- RECOVERY WELL
- IRRIGATION WELL
- ABANDONED WELL

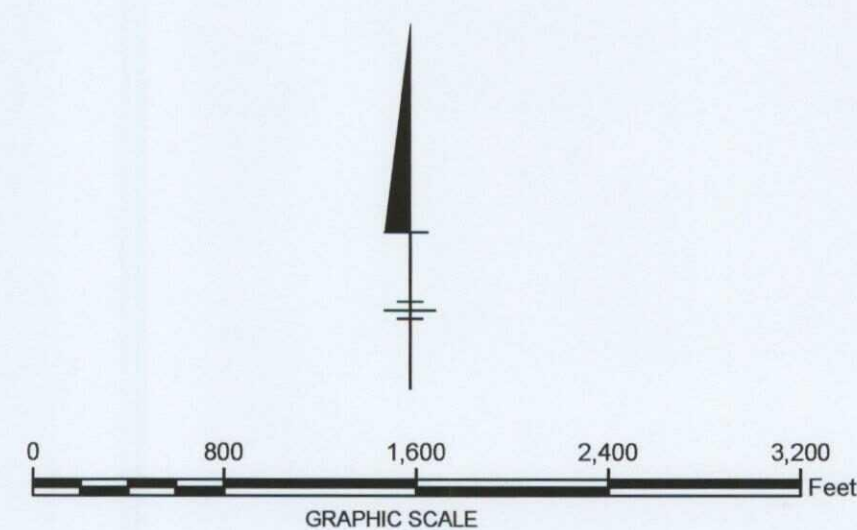

NAVAJO REFINING COMPANY
ARTESIA REFINERY, EDDY COUNTY, NEW MEXICO
2010 ANNUAL GROUNDWATER REPORT

PHASE SEPARATED HYDROCARBON
THICKNESS ISOPLETHS (FEET)
FIRST SEMI-ANNUAL EVENT 2010



FIGURE

7