

DATE 2/30/04	SUSPENSE 2/19/04	ENGINEER WJS	LOGGED IN LR	TYPE NSL	APP NO. PLR0403434377
-----------------	---------------------	-----------------	-----------------	-------------	--------------------------

ABOVE THIS LINE FOR DIVISION USE ONLY

NEW MEXICO OIL CONSERVATION DIVISION

- Engineering Bureau -

1220 South St. Francis Drive, Santa Fe, NM 87505



ADMINISTRATIVE APPLICATION CHECKLIST

THIS CHECKLIST IS MANDATORY FOR ALL ADMINISTRATIVE APPLICATIONS FOR EXCEPTIONS TO DIVISION RULES AND REGULATIONS WHICH REQUIRE PROCESSING AT THE DIVISION LEVEL IN SANTA FE

Application Acronyms:

[NSL-Non-Standard Location] [NSP-Non-Standard Proration Unit] [SD-Simultaneous Dedication]
 [DHC-Downhole Commingling] [CTB-Lease Commingling] [PLC-Pool/Lease Commingling]
 [PC-Pool Commingling] [OLS - Off-Lease Storage] [OLM-Off-Lease Measurement]
 [WFX-Waterflood Expansion] [PMX-Pressure Maintenance Expansion]
 [SWD-Salt Water Disposal] [IPI-Injection Pressure Increase]
 [EOR-Qualified Enhanced Oil Recovery Certification] [PPR-Positive Production Response]

- [1] TYPE OF APPLICATION - Check Those Which Apply for [A]
 [A] Location - Spacing Unit - Simultaneous Dedication
☒ NSL ☐ NSP ☐ SD

Check One Only for [B] or [C]

- [B] Commingling - Storage - Measurement
☐ DHC ☐ CTB ☐ PLC ☐ PC ☐ OLS ☐ OLM
 [C] Injection - Disposal - Pressure Increase - Enhanced Oil Recovery
☐ WFX ☐ PMX ☐ SWD ☐ IPI ☐ EOR ☐ PPR

- [D] Other: Specify _____

- [2] NOTIFICATION REQUIRED TO: - Check Those Which Apply, or ☐ Does Not Apply

- [A] ☒ Working, Royalty or Overriding Royalty Interest Owners
 [B] ☒ Offset Operators, Leaseholders or Surface Owner
 [C] ☐ Application is One Which Requires Published Legal Notice
 [D] ☐ Notification and/or Concurrent Approval by BLM or SLO
U.S. Bureau of Land Management - Commissioner of Public Lands, State Land Office
 [E] ☒ For all of the above, Proof of Notification or Publication is Attached, and/or,
 [F] ☐ Waivers are Attached

- [3] SUBMIT ACCURATE AND COMPLETE INFORMATION REQUIRED TO PROCESS THE TYPE OF APPLICATION INDICATED ABOVE.

- [4] CERTIFICATION: I hereby certify that the information submitted with this application for administrative approval is **accurate** and **complete** to the best of my knowledge. I also understand that **no action** will be taken on this application until the required information and notifications are submitted to the Division.

Note: Statement must be completed by an individual with managerial and/or supervisory capacity.

Paul Lehrman

Print or Type Name

Signature

Landman

Title

1/26/04

Date

plehrman@digii.net
 e-mail Address

RECEIVED
 JAN 30 2004
 Oil Conservation Division
 1220 S. St. Francis Drive
 Santa Fe, NM 87505

**REQUEST FOR ADMINISTRATIVE APPROVAL FOR NON-STANDARD LOCATION
FOR RICHARDSON OPERATING COMPANY**

WF FRPC 17 #2

**1975' FNL & 575 FWL, SECTION 17, TOWNSHIP 29 NORTH, RANGE 14 WEST, NMPM,
SAN JUAN COUNTY, NEW MEXICO**

- 2
- 1) The referenced well is located on Fee surface, Fee minerals. The proposed location is non-standard because of proximity to large areas of wetlands. According to NMOCD rules well locations depending on formation drilled must be 660' from the section/quarter section lines. The well location is 575' from the West Section line of Section 17. Therefore the WF FRPC 17 #2 location is approximately 85' too far West. Richardson controls the Pictured Cliffs rights in the NW/4 of Section 17.
 - 2) A C-102 (Exhibit "A") is attached showing the well location and the proration unit for the proposed Pictured Cliffs well. Application for Permit to Drill (APD) (C-101) for this well was submitted to the State of New Mexico via E-Permitting on January 23, 2004. A copy is attached to this application. The West Kutz PC (Gas) will be a new completion in this pool.
 - 3) A map (Exhibit "B") is attached showing the adjoining spacing units and existing Pictured Cliffs wells. Richardson controls the PC rights in the offsetting spacing units, with the exception of those unleased mineral owners below.
 - 4) Certified letters have been sent to unleased mineral owners to notify them of our intentions. Copies of the letters are attached to this application.
 - 5) Existing land use concerns, specifically existing large areas of wetlands, force a non-standard location exception for this action. It would not be feasible to build a legal location to drill this Pictured Cliffs well without damaging large areas of wetlands.
 - 6) Archaeology is not an issue with this well.
 - 7) Directional drilling is not feasible for such a shallow completion.
 - 8) A non-standard location is requested because of topography, i.e. surface conditions (wetlands).
 - 9) I hereby certify that notice was sent to the following offset operators, leaseholders or unleased mineral owners which adjoin the applicant's spacing unit.

Virginia Murray
New Mexico State Highway Dept.
Charles E. and Leila H. Beavers, Trustees
G. D. Crawford c/o Kim Hunt
Madge Manning
Annabel Davis
Dora Hunt
Betty Lou McMullen, Trustee
Robert L. Goodwin
Edmund J. Goodwin
Barbara J. Sebastian
Charlie Johnson
Glen D. Johnson
J. Kenneth and Jonell Vaughan
Karen Hollingsworth
Richard and Nina Hatch
Glenn and Bonita Hoyle

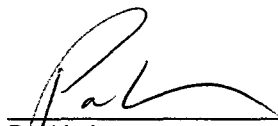
Paul Lehrman
Richardson Operating Company
January 26, 2004

State of New Mexico
Energy, Minerals & Mining Resources Department
OIL CONSERVATION DIVISION
2040 South Pacheco
Santa Fe, NM 87505

Form C - 102

☐ AMENDED REPORT

WELL LOCATION AND ACREAGE DEDICATION PLAT

APA Number 30-045-	Pool Code 86620	Pool Name Twin Mounds Fruitland Sand PC (Gas)
Property Code	Property Name WF FRPC 17	Well Number 2
OGED No. 19219	Operator Name RICHARDSON OPERATING COMPANY	Elevation 5160'

Surface Location

TL or Lot	Sec.	Twp.	Rgn.	Lot Blk.	Feet from	North/South	Feet from	East/West	County
E	17	29 N.	14 W.		1975'	North	575'	West	SAN JUAN

Bottom Hole Location if Different From Surface

TL or Lot	Sec.	Twp.	Rgn.	Lot Blk.	Feet from	North/South	Feet from	East/West	County

Dedication	Joint ?	Consolidation	Order No.

NO ALLOWABLE WILL ASSIGNED TO THIS COMPLETION UNTIL ALL INTERESTS HAVE BEEN CONSOLIDATED
OR A NON-STANDARD UNIT HAS BEEN APPROVED BY THE DIVISION

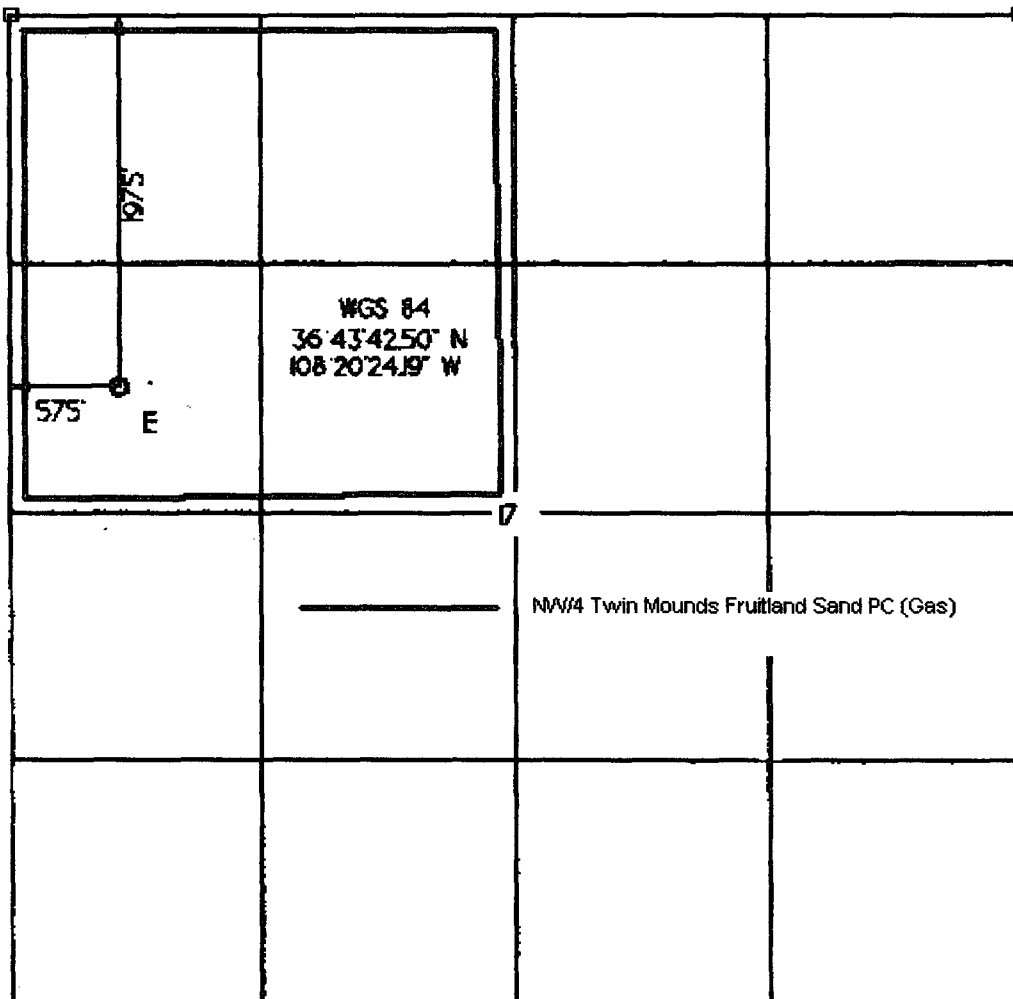

NW/4 Twin Mounds Fruitland Sand PC (Gas)

OPERATOR CERTIFICATION

I hereby certify that the information contained herein is true and complete to the best of my knowledge and belief.

Signature

Paul Lehrman

Printed Name

Paul Lehrman

Title

Landman

Date

1/23/04

SURVEYOR CERTIFICATION

I hereby certify that the well location on this plat was plotted from field notes or actual surveys made by me or under my supervision, and that the same is true and correct to the best of my belief.

Date of Survey

rev: 01/14/04

Signature and Seal of Professional Surveyor



District I

1625 N. French Dr., Hobbs, NM 88240

District II

1301 W. Grand Ave., Artesia, NM 88210

District III

1000 Rio Brazos Rd., Aztec, NM 87410

District IV

1220 S. St Francis Dr., Santa Fe, NM 87505

State of New Mexico
Energy, Minerals and Natural Resources

Form C-

Oil Conservation Division

1220 S. St Francis Dr.

Santa Fe, NM 87505

APPLICATION FOR PERMIT TO DRILL

Operator Name and Address RICHARDSON OPERATING CO 3100 La Plata Highway Farmington, NM 87401		OGRID Number 19219
		API Number 30-045-32140
Property Code 33345	Property Name WF FRPC 17	Well No. 002

Surface Location

UL or Lot E	Section 17	Township 29N	Range 14W	Lot Idn 2	Feet From 1975	N/S Line N	Feet From 575	E/W Line W	County San Juan
----------------	---------------	-----------------	--------------	--------------	-------------------	---------------	------------------	---------------	--------------------

Proposed Pools

TWIN MOUNDS FRUITLAND SAND PC (GAS) 86620

Work Type New Well	Well Type GAS	Cable/Rotary	Lease Type Private	Ground Level Elevation 5160
Multiple N	Proposed Depth 1100	Formation Pictured Cliffs Formation	Contractor	Spud Date 05/01/2004

Proposed Casing and Cement Program

Type	Hole Size	Casing Size	Casing Weight/ft	Setting Depth	Sacks of Cement	Estimated TOC
Surf	8.75	7	20	120	60	0
Prod	6.25	4.5	10.5	1100	175	0

Proposed Blowout Prevention Program

Type	Working Pressure	Test Pressure	Manufacturer
Double Ram	2000	1000	

I hereby certify that the information given above is true and complete to the best of my knowledge and belief.

Electronically Signed By: Anne Jones

Title:

Date: 01/23/2004

Phone: 505-564-8115

OIL CONSERVATION DIVISION

Electronically Approved By:

Title:

Approval Date:

Expiration Date:

Conditions of Approval:

There are conditions. See Attached.

District I

1625 N. French Dr., Hobbs, NM 88240

District II

1301 W. Grand Ave., Artesia, NM 88210

District III

1000 Rio Brazos Rd., Aztec, NM 87410

District IV

1220 S. St Francis Dr., Santa Fe, NM 87505

State of New Mexico
Energy, Minerals and Natural Resources

Form C-

Oil Conservation Division

1220 S. St Francis Dr.

Santa Fe, NM 87505

WELL LOCATION AND ACREAGE DEDICATION PLAT

API Number 30-045-32140	Pool Name TWIN MOUNDS FRUITLAND SAND PC (GAS)	Pool Code 86620
Property Code 33345	Property Name WF FRPC 17	Well No. 002
OGRID No. 19219	Operator Name RICHARDSON OPERATING CO	Elevation 5160

Surface And Bottom Hole Location

UL or Lot E	Section 17	Township 29N	Range 14W	Lot Idn 2	Feet From 1975	N/S Line N	Feet From 575	E/W Line W	County San Juan
Dedicated Acres 150.99		Joint or Infill		Consolidation Code		Order No.			

OPERATOR CERTIFICATION

I hereby certify that the information contained herein is true and complete to the best of my knowledge and belief.

Electronically Signed By: Anne Jones

Title:

Date: 01/23/2004

SURVEYOR CERTIFICATION

I hereby certify that the well location shown on this plat was plotted from field notes of actual surveys made by me or under my supervision, and that the same is true and correct to the best of my belief.

Electronically Signed By: GERALD HUDDLESTON

Date of Survey: 01/14/2004

Certificate Number: 6844

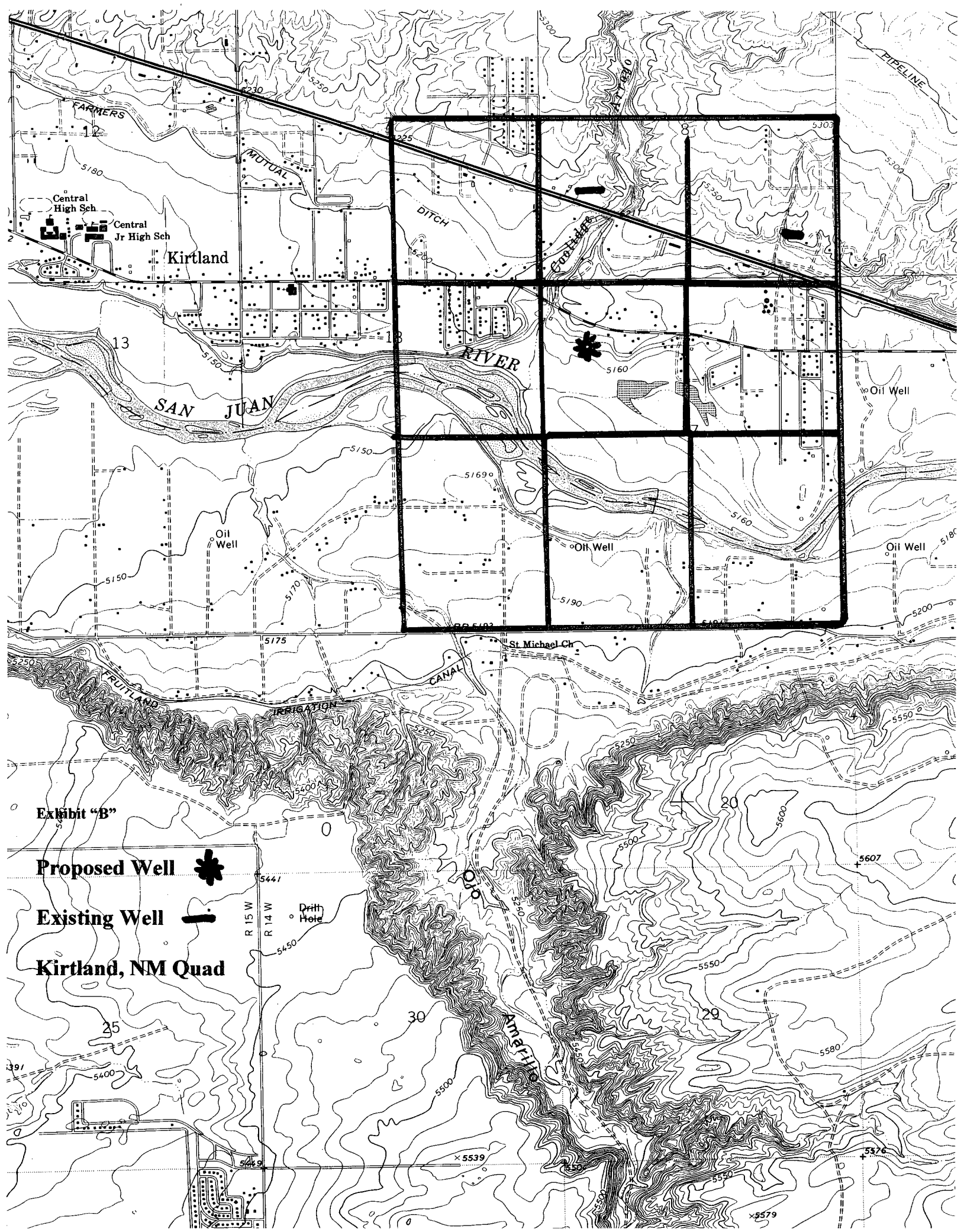

Exhibit "B"

Proposed Well



Existing Well



Kirtland, NM Quad

RICHARDSON PRODUCTION COMPANY

501 Airport Drive, Suite 119

Phone (505) 564-8115

FARMINGTON, NM 87401

FAX (505) 564-8334

January 23, 2004

Certified Mail

Return Receipt Requested

Article No. 7002 3150 0002 0908 7163

Ms. Virginia Murray

P.O. Box 3238

Farmington, NM 87499

RE: Non-Standard Location Application
Proposed Pictured Cliffs Well
Richardson WF FRPC 17 #2
Township 29 North, Range 14 West, NMPM
1975' FNL & 575' FWL
Section 17: NW/4
San Juan County, New Mexico

Dear Ms. Murray:

As required by New Mexico Oil Conservation Division (NMOCD) Rules, this letter will serve to notify you of the following non-standard location application for a well. This letter is a notice only. No action is required on your part unless you have questions or objections. Any objections must be filed in writing within 20 days of receipt of the application by the NMOCD.

Richardson Operating Company is applying to the NMOCD for a non-standard location for its proposed Richardson Operating WF FRPC 17 #2 well in the Pictured Cliffs formation. The minimum distance from quarter section lines required by NMOCD rules is 660'. Due to existing surface conditions (topography), the well is approximately 85' to far West. A legal location is not physically possible.

Well Name:	WF FRPC 17 #2
Proposed Producing Zone:	Pictured Cliffs
Acreage Dedication:	NW/4 of Section 17, T29N, R14W, NMPM, San Juan Co., NM
Location:	1975' FNL & 575' FWL, Section 17, T29N, R14W, NMPM, San Juan Co., NM
Applicant's Name:	Richardson Operating Company
Applicant's Address:	3100 La Plata Highway, Farmington, New Mexico 87401
Applicant's Phone No.	505/564-8115

Submittal Information: Application for a non-standard location will be filed with the NMOCD. If they determine the application complies with the regulations, it will be approved. Any questions can be submitted to the New Mexico Oil Conservation Division, whose address is 1220 South St. Francis Drive, Santa Fe, New Mexico 87505. Their phone number is 505/476-3440.

Thank you for your consideration in this matter.

Please call me at 505/564-8115 (Richardson's Land Office) if you have any questions.

Sincerely,

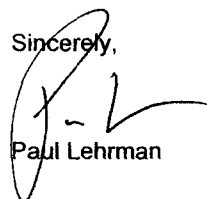

Paul Lehrman

2. Article Number (Transfer from service label) 7002 3150 0002 0908 7163	
1. Article Addressed to: Ms. Virginia Murray P.O. Box 3238 Farm, NM 87499	
■ Complete items 1, 2, and 3. Also complete item 4 if Restricted Delivery is desired. ■ Print your name and address on the reverse so that we can return the card to you. ■ Attach this card to the back of the mailpiece, or on the front if space permits.	
SENDER: COMPLETE THIS SECTION COMPLETE THIS SECTION ON DELIVERY A. Signature <input checked="" type="checkbox"/> X B. Received by (Printed Name) _____ C. Date of Delivery _____ D. Is delivery address different from item 1? <input type="checkbox"/> Yes <input type="checkbox"/> No If YES, enter delivery address below: _____ 3. Service Type <input checked="" type="checkbox"/> Certified Mail <input type="checkbox"/> Registered <input type="checkbox"/> Insured Mail <input type="checkbox"/> Express Mail <input checked="" type="checkbox"/> Return Receipt for Merchandise <input type="checkbox"/> C.O.D. 4. Restricted Delivery? (Extra Fee) <input type="checkbox"/> Yes <input type="checkbox"/> No	



U.S. Postal Service™ CERTIFIED MAIL™ RECEIPT (Domestic Mail Only; No Insurance Coverage Provided) For delivery information visit our website at www.usps.com	
OFFICIAL USE	
Postage \$	Postmark Here
Certified Fee	
Return Receipt Fee (Endorsement Required)	
Restricted Delivery Fee (Endorsement Required)	
Total Postage & Fees \$	
Sent To <u>Ms. Virginia Murray</u> Street, Apt. No., or PO Box No. <u>P.O. Box 3238</u> City, State, ZIP+4 <u>Farm, NM 87499</u>	
PS Form 3800, June 2002 See Reverse for Instructions	

RICHARDSON PRODUCTION COMPANY

501 Airport Drive, Suite 119

Phone (505) 564-8115

FARMINGTON, NM 87401

FAX (505) 564-8334

January 23, 2004

Certified Mail
Return Receipt Requested
Article No. 7002 3150 0002 0908 7170

New Mexico State Highway Dept.
P.O. Box 1149
Santa Fe, NM 87504-1149

RE: Non-Standard Location Application
Proposed Pictured Cliffs Well
Richardson WF FRPC 17 #2
Township 29 North, Range 14 West, NMPM
1975' FNL & 575' FWL
Section 17: NW/4
San Juan County, New Mexico

Gentlemen:

As required by New Mexico Oil Conservation Division (NMOCD) Rules, this letter will serve to notify you of the following non-standard location application for a well. This letter is a notice only. No action is required on your part unless you have questions or objections. Any objections must be filed in writing within 20 days of receipt of the application by the NMOCD.

Richardson Operating Company is applying to the NMOCD for a non-standard location for its proposed Richardson Operating WF FRPC 17 #2 well in the Pictured Cliffs formation. The minimum distance from quarter section lines required by NMOCD rules is 660'. Due to existing surface conditions (topography), the well is approximately 85' to far West. A legal location is not physically possible.

Well Name:	WF FRPC 17 #2
Proposed Producing Zone:	Pictured Cliffs
Acreage Dedication:	NW/4 of Section 17, T29N, R14W, NMPM, San Juan Co., NM
Location:	1975' FNL & 575' FWL, Section 17, T29N, R14W, NMPM, San Juan Co., NM
Applicant's Name:	Richardson Operating Company
Applicant's Address:	3100 La Plata Highway, Farmington, New Mexico 87401
Applicant's Phone No.	505/564-8115

Submittal Information: Application for a non-standard location will be filed with the NMOCD. If they determine the application complies with the regulations, it will be approved. Any questions can be submitted to the New Mexico Oil Conservation Division, whose address is 1220 South St. Francis Drive, Santa Fe, New Mexico 87505. Their phone number is 505/476-3440.

Thank you for your consideration in this matter.

Please call me at 505/564-8115 (Richardson's Land Office) if you have any questions.

Sincerely,

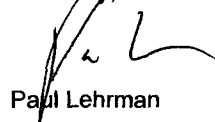

Paul Lehrman

PLACE STICKER AT TOP OF ENVELOPE TO THE RIGHT
OF THE RETURN ADDRESS; FOLD AT DOTTED LINE

CERTIFIED MAIL™

PS Form 3800, June 2002 See Reverse for Instructions

Sent To: *New Mexico State Highway Dept.*
 Street, Apt. No., or PO Box No. *P.O. Box 1149*
 City, State, ZIP+4 *Santa Fe, NM 87504*

7002 3150 0002 U7UB 1470
 7002 3150 0002 0908 7170

Postage \$	
Certified Fee	
Return Receipt Fee (Endorsement Required)	
Restricted Delivery Fee (Endorsement Required)	
Total Postage & Fees \$	

Postmark Here

OFFICIAL USE

For delivery information visit our website at www.usps.com

U.S. Postal Service™ CERTIFIED MAIL™ RECEIPT
 (Domestic Mail Only; No Insurance Coverage Provided)

PS Form 3811, August 2001 Domestic Return Receipt 2ACPRI-03-Z-0985

2. Article Number (Transfer from service label) **7002 3150 0002 0908 7170**

1. Article Addressed to:

New Mexico State Highway Dept.
P.O. Box 1149
Santa Fe, NM 87504

SENDER: COMPLETE THIS SECTION

- Complete items 1, 2, and 3. Also complete item 4 if Restricted Delivery is desired.
- Print your name and address on the reverse so that we can return the card to you.
- Attach this card to the back of the mailpiece, or on the front if space permits.

1. Article Addressed to:

A. Signature ☒ X

B. Received by (Printed Name) _____

C. Date of Delivery _____

D. Is delivery address different from item 1? ☐ Yes ☐ No

E. If YES, enter delivery address below: _____

3. Service Type

☐ Certified Mail ☐ Registered ☐ Insured Mail ☐ Restricted Delivery? (Extra Fee) ☐ Yes ☐ No

☐ Express Mail ☒ Return Receipt for Merchandise

4. Restricted Delivery? (Extra Fee) ☐ Yes ☐ No

COMPLETE THIS SECTION ON DELIVERY

RICHARDSON PRODUCTION COMPANY

501 Airport Drive, Suite 119

Phone (505) 564-8115

FARMINGTON, NM 87401

FAX (505) 564-8334

January 26, 2004

Certified Mail

Return Receipt Requested

Article No. 7002 3150 0002 0908 7187

Charles E. & Leila H. Beavers, Trustees
P.O. Box 3
Kirtland, NM 87417

RE: Non-Standard Location Application
Proposed Pictured Cliffs Well
Richardson WF FRPC 17 #2
Township 29 North, Range 14 West, NMPM
1975' FNL & 575' FWL
Section 17: NW/4
San Juan County, New Mexico

Dear Mr. & Mrs. Beavers:

As required by New Mexico Oil Conservation Division (NMOCD) Rules, this letter will serve to notify you of the following non-standard location application for a well. This letter is a notice only. No action is required on your part unless you have questions or objections. Any objections must be filed in writing within 20 days of receipt of the application by the NMOCD.

Richardson Operating Company is applying to the NMOCD for a non-standard location for its proposed Richardson Operating WF FRPC 17 #2 well in the Pictured Cliffs formation. The minimum distance from quarter section lines required by NMOCD rules is 660'. Due to existing surface conditions (topography), the well is approximately 85' to far West. A legal location is not physically possible.

Well Name:	WF FRPC 17 #2
Proposed Producing Zone:	Pictured Cliffs
Acreage Dedication:	NW/4 of Section 17, T29N, R14W, NMPM, San Juan Co., NM
Location:	1975' FNL & 575' FWL, Section 17, T29N, R14W, NMPM, San Juan Co., NM
Applicant's Name:	Richardson Operating Company
Applicant's Address:	3100 La Plata Highway, Farmington, New Mexico 87401
Applicant's Phone No.	505/564-8115

Submittal Information: Application for a non-standard location will be filed with the NMOCD. If they determine the application complies with the regulations, it will be approved. Any questions can be submitted to the New Mexico Oil Conservation Division, whose address is 1220 South St. Francis Drive, Santa Fe, New Mexico 87505. Their phone number is 505/476-3440.

Thank you for your consideration in this matter.

Please call me at 505/564-8115 (Richardson's Land Office) if you have any questions.

Sincerely,

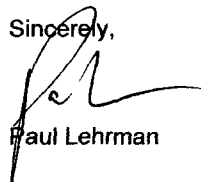

Paul Lehrman



7187 7187
0908 0908
0002 0002
3150 3150
7002 7002

U.S. Postal Service™ CERTIFIED MAIL™ RECEIPT (Domestic Mail Only; No Insurance Coverage Provided)	
For delivery information visit our website at www.usps.com	
OFFICIAL USE	
Postage	\$
Certified Fee	
Return Receipt Fee (Endorsement Required)	
Restricted Delivery Fee (Endorsement Required)	
Total Postage & Fees	\$
Sent To <i>Charles E. and Leile H. Beavers</i> Street, Apt. No., or PO Box No. <i>P.O. Box 3</i> City, State, ZIP+4 <i>Kirtland, NM 87417</i>	
PS Form 3800, June 2002 See Reverse for Instructions	

SENDER: COMPLETE THIS SECTION <ul style="list-style-type: none"> Complete items 1, 2, and 3. Also complete item 4 if Restricted Delivery is desired. Print your name and address on the reverse so that we can return the card to you. Attach this card to the back of the mailpiece, or on the front if space permits. <p>1. Article Addressed to:</p> <p><i>Charles E. and Leile H. Beavers,</i> <i>Trustees</i> <i>P.O. Box 3</i> <i>Kirtland, NM</i> <i>87417</i></p> <p>2. Article Number (Transfer from service label)</p>	COMPLETE THIS SECTION ON DELIVERY <p>A. Signature <input type="checkbox"/> Agent <input type="checkbox"/> Addressee</p> <p>X</p> <p>B. Received by (Printed Name) C. Date of Delivery</p> <p>D. Is delivery address different from item 1? <input type="checkbox"/> Yes <input type="checkbox"/> No If YES, enter delivery address below:</p> <p>3. Service Type</p> <table border="0"> <tr> <td><input checked="" type="checkbox"/> Certified Mail</td> <td><input type="checkbox"/> Express Mail</td> </tr> <tr> <td><input type="checkbox"/> Registered</td> <td><input type="checkbox"/> Return Receipt for Merchandise</td> </tr> <tr> <td><input type="checkbox"/> Insured Mail</td> <td><input type="checkbox"/> C.O.D.</td> </tr> </table> <p>4. Restricted Delivery? (Extra Fee) <input type="checkbox"/> Yes</p>	<input checked="" type="checkbox"/> Certified Mail	<input type="checkbox"/> Express Mail	<input type="checkbox"/> Registered	<input type="checkbox"/> Return Receipt for Merchandise	<input type="checkbox"/> Insured Mail	<input type="checkbox"/> C.O.D.
<input checked="" type="checkbox"/> Certified Mail	<input type="checkbox"/> Express Mail						
<input type="checkbox"/> Registered	<input type="checkbox"/> Return Receipt for Merchandise						
<input type="checkbox"/> Insured Mail	<input type="checkbox"/> C.O.D.						

7002 3150 0002 0908 7187

Domestic Return Receipt

2ACPRI-03-Z-0985

PS Form 3811, August 2001

RICHARDSON PRODUCTION COMPANY

501 Airport Drive, Suite 119

Phone (505) 564-8115

FARMINGTON, NM 87401

FAX (505) 564-8334

January 26, 2004

Certified Mail

Return Receipt Requested

Article No. 7002 3150 0002 0908 7194

G.D. Crawford, Trustee c/o Kim Hunt
838 NM 516
Flora vista, NM 87415

RE: Non-Standard Location Application
Proposed Pictured Cliffs Well
Richardson WF FRPC 17 #2
Township 29 North, Range 14 West, NMPM
1975' FNL & 575' FWL
Section 17: NW/4
San Juan County, New Mexico

Gentlemen:

As required by New Mexico Oil Conservation Division (NMOCD) Rules, this letter will serve to notify you of the following non-standard location application for a well. This letter is a notice only. No action is required on your part unless you have questions or objections. Any objections must be filed in writing within 20 days of receipt of the application by the NMOCD.

Richardson Operating Company is applying to the NMOCD for a non-standard location for its proposed Richardson Operating WF FRPC 17 #2 well in the Pictured Cliffs formation. The minimum distance from quarter section lines required by NMOCD rules is 660'. Due to existing surface conditions (topography), the well is approximately 85' to far West. A legal location is not physically possible.

Well Name:	WF FRPC 17 #2
Proposed Producing Zone:	Pictured Cliffs
Acreage Dedication:	NW/4 of Section 17, T29N, R14W, NMPM, San Juan Co., NM
Location:	1975' FNL & 575' FWL, Section 17, T29N, R14W, NMPM, San Juan Co., NM
Applicant's Name:	Richardson Operating Company
Applicant's Address:	3100 La Plata Highway, Farmington, New Mexico 87401
Applicant's Phone No.	505/564-8115

Submittal Information: Application for a non-standard location will be filed with the NMOCD. If they determine the application complies with the regulations, it will be approved. Any questions can be submitted to the New Mexico Oil Conservation Division, whose address is 1220 South St. Francis Drive, Santa Fe, New Mexico 87505. Their phone number is 505/476-3440.

Thank you for your consideration in this matter.

Please call me at 505/564-8115 (Richardson's Land Office) if you have any questions.

Sincerely,

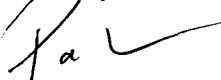

Paul Lehrman

PS Form 3800, June 2002 See Reverse for Instructions

Sent To: G.D. Crawford, Trustee
c/o Kim Hunt
838 NM 516
Flora Vista, NM 87415

City, State, ZIP+4

Street, Apt. No.,
or PO Box No.

Postage	\$
Certified Fee	
Return Receipt Fee (Endorsement Required)	
Restricted Delivery Fee (Endorsement Required)	
Total Postage & Fees	\$

Postmark
Here

U.S. Postal ServiceTM CERTIFIED MAILTM RECEIPT

(Domestic Mail Only; No Insurance Coverage Provided)

For delivery information visit our website at www.usps.com[®]

OFFICIAL USE

7002 3150 0002 0908 7194



SENDER: COMPLETE THIS SECTION		COMPLETE THIS SECTION ON DELIVERY	
<p>■ Complete items 1, 2, and 3. Also complete item 4 if Restricted Delivery is desired.</p> <p>■ Print your name and address on the reverse so that we can return the card to you.</p> <p>■ Attach this card to the back of the mailpiece, or on the front if space permits.</p>		<p>A. Signature X <input type="checkbox"/> Agent <input type="checkbox"/> Addressee</p>	
<p>1. Article Addressed to:</p> <p>G.D. Crawford, Trustee c/o Kim Hunt 838 NM 516 Flora Vista, NM 87415</p>		<p>B. Received by (Printed Name)</p>	<p>C. Date of Delivery</p>
<p>2. Article Number (Transfer from service label)</p> <p>7002 3150 0002 0908 7194</p>		<p>D. Is delivery address different from item 1? <input type="checkbox"/> Yes if YES, enter delivery address below: <input type="checkbox"/> No</p>	
<p>3. Service Type</p> <p><input checked="" type="checkbox"/> Certified Mail <input type="checkbox"/> Express Mail <input type="checkbox"/> Registered <input type="checkbox"/> Return Receipt for Merchandise <input type="checkbox"/> Insured Mail <input type="checkbox"/> C.O.D.</p>		<p>4. Restricted Delivery? (Extra Fee) <input type="checkbox"/> Yes</p>	

PS Form 3811, August 2001

Domestic Return Receipt

2ACPRI-03-Z-0985

RICHARDSON PRODUCTION COMPANY

501 Airport Drive, Suite 119

Phone (505) 564-8115

FARMINGTON, NM 87401

FAX (505) 564-8334

January 26, 2004

Certified Mail
Return Receipt Requested
Article No. 7002 3150 0002 0908 7354

Madge Manning c/o Jack Manning
P.O. Box 266
Kirtland, NM 87417

RE: Non-Standard Location Application
Proposed Pictured Cliffs Well
Richardson WF FRPC 17 #2
Township 29 North, Range 14 West, NMPM
1975' FNL & 575' FWL
Section 17: NW/4
San Juan County, New Mexico

Dear Ms. Manning:

As required by New Mexico Oil Conservation Division (NMOCD) Rules, this letter will serve to notify you of the following non-standard location application for a well. This letter is a notice only. No action is required on your part unless you have questions or objections. Any objections must be filed in writing within 20 days of receipt of the application by the NMOCD.

Richardson Operating Company is applying to the NMOCD for a non-standard location for its proposed Richardson Operating WF FRPC 17 #2 well in the Pictured Cliffs formation. The minimum distance from quarter section lines required by NMOCD rules is 660'. Due to existing surface conditions (topography), the well is approximately 85' to far West. A legal location is not physically possible.

Well Name:	WF FRPC 17 #2
Proposed Producing Zone:	Pictured Cliffs
Acreage Dedication:	NW/4 of Section 17, T29N, R14W, NMPM, San Juan Co., NM
Location:	1975' FNL & 575' FWL, Section 17, T29N, R14W, NMPM, San Juan Co., NM
Applicant's Name:	Richardson Operating Company
Applicant's Address:	3100 La Plata Highway, Farmington, New Mexico 87401
Applicant's Phone No.	505/564-8115

Submittal Information: Application for a non-standard location will be filed with the NMOCD. If they determine the application complies with the regulations, it will be approved. Any questions can be submitted to the New Mexico Oil Conservation Division, whose address is 1220 South St. Francis Drive, Santa Fe, New Mexico 87505. Their phone number is 505/476-3440.

Thank you for your consideration in this matter.

Please call me at 505/564-8115 (Richardson's Land Office) if you have any questions.

Sincerely,

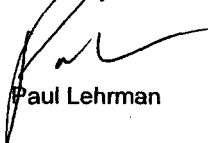

Paul Lehrman



7002 3150 0002 0908 7354
7002 3150 0002 0908 7354

U.S. Postal ServiceTM
CERTIFIED MAILTM RECEIPT
(Domestic Mail Only; No Insurance Coverage Provided)

For delivery information visit our website at www.usps.com

OFFICIAL USE

Postage	\$
Certified Fee	
Return Receipt Fee (Endorsement Required)	
Restricted Delivery Fee (Endorsement Required)	
Total Postage & Fees	\$

Postmark
Here

Sent To
Street, Apt. No.,
or PO Box No. *Madge Manning c/o Jack Manning*
City, State, ZIP+4 *P.O. Box 266*
Karoland, NM 87417

PS Form 3800, June 2002

See Reverse for Instructions

SENDER: COMPLETE THIS SECTION

- Complete items 1, 2, and 3. Also complete item 4 if Restricted Delivery is desired.
- Print your name and address on the reverse so that we can return the card to you.
- Attach this card to the back of the mailpiece, or on the front if space permits.

1. Article Addressed to:

Madge Manning
c/o Jack Manning
P.O. Box 266
Karoland, NM 87417

2. Article Number
(Transfer from service label)

7002 3150 0002 0908 7354

PS Form 3811, August 2001

Domestic Return Receipt

COMPLETE THIS SECTION ON DELIVERY

A. Signature ☐ Agent
X ☐ Addressee

B. Received by (Printed Name) C. Date of Delivery

D. Is delivery address different from item 1? ☐ Yes
if YES, enter delivery address below: ☐ No

3. Service Type
☒ Certified Mail ☐ Express Mail
☐ Registered ☒ Return Receipt for Merchandise
☐ Insured Mail ☐ C.O.D.

4. Restricted Delivery? (Extra Fee) ☐ Yes

2ACPRI-03-Z-0985

RICHARDSON PRODUCTION COMPANY

501 Airport Drive, Suite 119

Phone (505) 564-8115

FARMINGTON, NM 87401

FAX (505) 564-8334

January 26, 2004

Certified Mail

Return Receipt Requested

Article No. 7002 3150 0002 0908 7361

Annabel Davis

2710 Eastridge Ct.

Farmington, NM 87401

RE: Non-Standard Location Application
Proposed Pictured Cliffs Well
Richardson WF FRPC 17 #2
Township 29 North, Range 14 West, NMPM
1975' FNL & 575' FWL
Section 17: NW/4
San Juan County, New Mexico

Dear Ms. Davis:

As required by New Mexico Oil Conservation Division (NMOCD) Rules, this letter will serve to notify you of the following non-standard location application for a well. This letter is a notice only. No action is required on your part unless you have questions or objections. Any objections must be filed in writing within 20 days of receipt of the application by the NMOCD.

Richardson Operating Company is applying to the NMOCD for a non-standard location for its proposed Richardson Operating WF FRPC 17 #2 well in the Pictured Cliffs formation. The minimum distance from quarter section lines required by NMOCD rules is 660'. Due to existing surface conditions (topography), the well is approximately 85' to far West. A legal location is not physically possible.

Well Name:	WF FRPC 17 #2
Proposed Producing Zone:	Pictured Cliffs
Acreage Dedication:	NW/4 of Section 17, T29N, R14W, NMPM, San Juan Co., NM
Location:	1975' FNL & 575' FWL, Section 17, T29N, R14W, NMPM, San Juan Co., NM
Applicant's Name:	Richardson Operating Company
Applicant's Address:	3100 La Plata Highway, Farmington, New Mexico 87401
Applicant's Phone No.	505/564-8115

Submittal Information: Application for a non-standard location will be filed with the NMOCD. If they determine the application complies with the regulations, it will be approved. Any questions can be submitted to the New Mexico Oil Conservation Division, whose address is 1220 South St. Francis Drive, Santa Fe, New Mexico 87505. Their phone number is 505/476-3440.

Thank you for your consideration in this matter.

Please call me at 505/564-8115 (Richardson's Land Office) if you have any questions.

Sincerely,

Paul Lehrman

PLACE STICKER AT TOP OF ENVELOPE TO THE RIGHT
OF THE RETURN ADDRESS. FOLD AT DOTTED LINE

CERTIFIED MAIL™

7002 3150 0002 0908 7361
7002 3150 0002 0908 7361
7002 3150 0002 0908 7361
7002 3150 0002 0908 7361

U.S. Postal Service™
CERTIFIED MAIL™ RECEIPT
(Domestic Mail Only; No Insurance Coverage Provided)

For delivery information visit our website at www.usps.com

OFFICIAL USE

Postage	\$	Postmark Here
Certified Fee		
Return Receipt Fee (Endorsement Required)		
Restricted Delivery Fee (Endorsement Required)		
Total Postage & Fees	\$	

Sent To
Annabel Davis
 Street, Apt. No.,
 or PO Box No. *2710 Eastridge Ct.*
 City, State, ZIP+4 *Farm. NM 87411*

PS Form 3800, June 2002

See Reverse for Instructions

SENDER: COMPLETE THIS SECTION

- Complete items 1, 2, and 3. Also complete item 4 if Restricted Delivery is desired.
- Print your name and address on the reverse so that we can return the card to you.
- Attach this card to the back of the mailpiece, or on the front if space permits.

1. Article Addressed to:

Annabel Davis
2710 Eastridge Ct.
Farm. NM
87411

2. Article Number
(Transfer from service label)

7002 3150 0002 0908 7361

COMPLETE THIS SECTION ON DELIVERY

A. Signature ☐ Agent
X ☐ Addressee

B. Received by (Printed Name) C. Date of Delivery

D. Is delivery address different from item 1? ☐ Yes
 If YES, enter delivery address below: ☐ No

3. Service Type
☒ Certified Mail ☐ Express Mail
☐ Registered ☒ Return Receipt for Merchandise
☐ Insured Mail ☐ C.O.D.

4. Restricted Delivery? (Extra Fee) ☐ Yes

RICHARDSON PRODUCTION COMPANY

501 Airport Drive, Suite 119

Phone (505) 564-8115

FARMINGTON, NM 87401

FAX (505) 564-8334

January 26, 2004

Certified Mail
Return Receipt Requested
Article No. 7002 3150 0002 0908 7408

Dora Hunt
1400 W. Tennessee Ave.
Denver, CO 80223

RE: Non-Standard Location Application
Proposed Pictured Cliffs Well
Richardson WF FRPC 17 #2
Township 29 North, Range 14 West, NMPM
1975' FNL & 575' FWL
Section 17: NW/4
San Juan County, New Mexico

Dear Ms. Hunt:

As required by New Mexico Oil Conservation Division (NMOCD) Rules, this letter will serve to notify you of the following non-standard location application for a well. This letter is a notice only. No action is required on your part unless you have questions or objections. Any objections must be filed in writing within 20 days of receipt of the application by the NMOCD.

Richardson Operating Company is applying to the NMOCD for a non-standard location for its proposed Richardson Operating WF FRPC 17 #2 well in the Pictured Cliffs formation. The minimum distance from quarter section lines required by NMOCD rules is 660'. Due to existing surface conditions (topography), the well is approximately 85' to far West. A legal location is not physically possible.

Well Name:	WF FRPC 17 #2
Proposed Producing Zone:	Pictured Cliffs
Acreage Dedication:	NW/4 of Section 17, T29N, R14W, NMPM, San Juan Co., NM
Location:	1975' FNL & 575' FWL, Section 17, T29N, R14W, NMPM, San Juan Co., NM
Applicant's Name:	Richardson Operating Company
Applicant's Address:	3100 La Plata Highway, Farmington, New Mexico 87401
Applicant's Phone No.	505/564-8115

Submittal Information: Application for a non-standard location will be filed with the NMOCD. If they determine the application complies with the regulations, it will be approved. Any questions can be submitted to the New Mexico Oil Conservation Division, whose address is 1220 South St. Francis Drive, Santa Fe, New Mexico 87505. Their phone number is 505/476-3440.

Thank you for your consideration in this matter.

Please call me at 505/564-8115 (Richardson's Land Office) if you have any questions.

Sincerely,

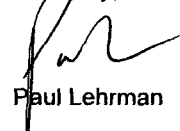

Paul Lehrman

SENDER: COMPLETE THIS SECTION

- Complete items 1, 2, and 3. Also complete item 4 if Restricted Delivery is desired.
- Print your name and address on the reverse so that we can return the card to you.
- Attach this card to the back of the mailpiece, or on the front if space permits.

1. Article Addressed to:

Dora Hunt
1400 W. Tennessee Ave.
Denver, Co 80223

2. Article Number

(Transfer from service label)

7002 3150 0002 0908 7408

PS Form 3811, August 2001

Domestic Return Receipt

2ACPRI-03-Z-0985

COMPLETE THIS SECTION ON DELIVERY

A. Signature

X

☐ Agent

☐ Addressee

B. Received by (Printed Name)

C. Date of Delivery

D. Is delivery address different from item 1? ☐ Yes
if YES, enter delivery address below: ☐ No

3. Service Type

☒ Certified Mail

☐ Express Mail

☐ Registered

☒ Return Receipt for Merchandise

☐ Insured Mail

☐ C.O.D.

4. Restricted Delivery? (Extra Fee)

☐ Yes

PLACE STICKER AT TOP OF ENVELOPE TO THE RIGHT OF THE RETURN ADDRESS, FOLD AT DOTTED LINE.
CERTIFIED MAIL™

U.S. Postal Service™

CERTIFIED MAIL™ RECEIPT

(Domestic Mail Only; No Insurance Coverage Provided)

For delivery information visit our website at www.usps.com

OFFICIAL USE

Postage

\$

Certified Fee

Return Receipt Fee
(Endorsement Required)

Restricted Delivery Fee
(Endorsement Required)

Total Postage & Fees

\$

Postmark
Here

Sent To

Dora Hunt

Street, Apt. No.,
or PO Box No.

1400 W. Tennessee Ave.

City, State, ZIP+4

Denver Co 80223

PS Form 3800, June 2002

See Reverse for Instructions

RICHARDSON PRODUCTION COMPANY

501 Airport Drive, Suite 119

Phone (505) 564-8115

FARMINGTON, NM 87401

FAX (505) 564-8334

January 26, 2004

Certified Mail
Return Receipt Requested
Article No. 7002 3150 0002 0908 7378

Betty Lou McMullen, Trustee
#6 CR 6331
Kirtland, NM 87417

RE: Non-Standard Location Application
Proposed Pictured Cliffs Well
Richardson WF FRPC 17 #2
Township 29 North, Range 14 West, NMPM
1975' FNL & 575' FWL
Section 17: NW/4
San Juan County, New Mexico

Dear Ms. McMullen:

As required by New Mexico Oil Conservation Division (NMOCD) Rules, this letter will serve to notify you of the following non-standard location application for a well. This letter is a notice only. No action is required on your part unless you have questions or objections. Any objections must be filed in writing within 20 days of receipt of the application by the NMOCD.

Richardson Operating Company is applying to the NMOCD for a non-standard location for its proposed Richardson Operating WF FRPC 17 #2 well in the Pictured Cliffs formation. The minimum distance from quarter section lines required by NMOCD rules is 660'. Due to existing surface conditions (topography), the well is approximately 85' to far West. A legal location is not physically possible.

Well Name:	WF FRPC 17 #2
Proposed Producing Zone:	Pictured Cliffs
Acreage Dedication:	NW/4 of Section 17, T29N, R14W, NMPM, San Juan Co., NM
Location:	1975' FNL & 575' FWL, Section 17, T29N, R14W, NMPM, San Juan Co., NM
Applicant's Name:	Richardson Operating Company
Applicant's Address:	3100 La Plata Highway, Farmington, New Mexico 87401
Applicant's Phone No.	505/564-8115

Submittal Information: Application for a non-standard location will be filed with the NMOCD. If they determine the application complies with the regulations, it will be approved. Any questions can be submitted to the New Mexico Oil Conservation Division, whose address is 1220 South St. Francis Drive, Santa Fe, New Mexico 87505. Their phone number is 505/476-3440.

Thank you for your consideration in this matter.

Please call me at 505/564-8115 (Richardson's Land Office) if you have any questions.

Sincerely,

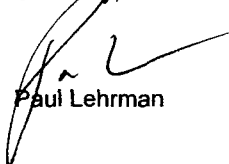

Paul Lehrman

SENDER: COMPLETE THIS SECTION		COMPLETE THIS SECTION ON DELIVERY	
<p>■ Complete items 1, 2, and 3. Also complete item 4 if Restricted Delivery is desired.</p> <p>■ Print your name and address on the reverse so that we can return the card to you.</p> <p>■ Attach this card to the back of the mailpiece, or on the front if space permits.</p>		<p>A. Signature X <input type="checkbox"/> Agent <input type="checkbox"/> Addressee</p>	
<p>1. Article Addressed to:</p> <p style="text-align: center;">Beth Lov McMullen, Trustee #6 CR 6331 Kittland, NM 87417</p>		<p>B. Received by (Printed Name) C. Date of Delivery</p>	
		<p>D. Is delivery address different from item 1? <input type="checkbox"/> Yes If YES, enter delivery address below: <input type="checkbox"/> No</p>	
		<p>3. Service-Type <input checked="" type="checkbox"/> Certified Mail <input type="checkbox"/> Express Mail <input type="checkbox"/> Registered <input checked="" type="checkbox"/> Return Receipt for Merchandise <input type="checkbox"/> Insured Mail <input type="checkbox"/> C.O.D. </p>	
<p>2. Article Number (Transfer from service label)</p>		<p>4. Restricted Delivery? (Extra Fee) <input type="checkbox"/> Yes</p>	
		<p style="text-align: center;">7002 3150 0002 0908 7378</p>	

PS Form 3811, August 2001

Domestic Return Receipt

2ACPRI-03-Z-0985

PS Form 3800, June 2002 See Reverse for Instructions

Sent To: Beth Lov McMullen, Trustee
#6 CR 6331
Kittland, NM 87417

City, State, ZIP+4

Street, Apt. No., or PO Box No.

\$	Postage
	Certified Fee
	Return Receipt Fee (Endorsement Required)
	Restricted Delivery Fee (Endorsement Required)
	Total Postage & Fees

Postmark Here

OFFICIAL USE

For delivery information visit our website at www.usps.com

U.S. Postal Service™

CERTIFIED MAIL™ RECEIPT

(Domestic Mail Only; No Insurance Coverage Provided)



7002 3150 0002 0908 7378
 7002 3150 0002 0908 7378

RICHARDSON PRODUCTION COMPANY

501 Airport Drive, Suite 119

Phone (505) 564-8115

FARMINGTON, NM 87401

FAX (505) 564-8334

January 26, 2004

Certified Mail

Return Receipt Requested

Article No. 7002 3150 0002 0908 7392

Robert L. Goodwin
21701 Eagle Mtn. Road
Buckeye, AZ 85326

RE: Non-Standard Location Application
Proposed Pictured Cliffs Well
Richardson WF FRPC 17 #2
Township 29 North, Range 14 West, NMPM
1975' FNL & 575' FWL
Section 17: NW/4
San Juan County, New Mexico

Dear Mr. Goodwin:

As required by New Mexico Oil Conservation Division (NMOCD) Rules, this letter will serve to notify you of the following non-standard location application for a well. This letter is a notice only. No action is required on your part unless you have questions or objections. Any objections must be filed in writing within 20 days of receipt of the application by the NMOCD.

Richardson Operating Company is applying to the NMOCD for a non-standard location for its proposed Richardson Operating WF FRPC 17 #2 well in the Pictured Cliffs formation. The minimum distance from quarter section lines required by NMOCD rules is 660'. Due to existing surface conditions (topography), the well is approximately 85' to far West. A legal location is not physically possible.

Well Name:	WF FRPC 17 #2
Proposed Producing Zone:	Pictured Cliffs
Acreage Dedication:	NW/4 of Section 17, T29N, R14W, NMPM, San Juan Co., NM
Location:	1975' FNL & 575' FWL, Section 17, T29N, R14W, NMPM, San Juan Co., NM
Applicant's Name:	Richardson Operating Company
Applicant's Address:	3100 La Plata Highway, Farmington, New Mexico 87401
Applicant's Phone No.	505/564-8115

Submittal Information: Application for a non-standard location will be filed with the NMOCD. If they determine the application complies with the regulations, it will be approved. Any questions can be submitted to the New Mexico Oil Conservation Division, whose address is 1220 South St. Francis Drive, Santa Fe, New Mexico 87505. Their phone number is 505/476-3440.

Thank you for your consideration in this matter.

Please call me at 505/564-8115 (Richardson's Land Office) if you have any questions.

Sincerely,



Paul Lehrman

SENDER: COMPLETE THIS SECTION		COMPLETE THIS SECTION ON DELIVERY	
<ul style="list-style-type: none"> Complete items 1, 2, and 3. Also complete item 4 if Restricted Delivery is desired. Print your name and address on the reverse so that we can return the card to you. Attach this card to the back of the mailpiece, or on the front if space permits. 		<p>A. Signature X <input type="checkbox"/> Agent <input type="checkbox"/> Addressee</p> <p>B. Received by (Printed Name) C. Date of Delivery</p> <p>D. Is delivery address different from item 1? <input type="checkbox"/> Yes if YES, enter delivery address below: <input type="checkbox"/> No</p>	
<p>1. Article Addressed to:</p> <p style="text-align: center;">Robert L. Goodwin 21701 Eagle Mountain Rd Buckeye, AZ 85326</p>		<p>3. Service Type</p> <p><input checked="" type="checkbox"/> Certified Mail <input type="checkbox"/> Express Mail <input type="checkbox"/> Registered <input checked="" type="checkbox"/> Return Receipt for Merchandise <input type="checkbox"/> Insured Mail <input type="checkbox"/> C.O.D.</p>	
<p>2. Article Number (Transfer from service label) <u>7002 3150 0002 0908 7392</u></p>		<p>4. Restricted Delivery? (Extra Fee) <input type="checkbox"/> Yes</p>	

PS Form 3811, August 2001

Domestic Return Receipt

2ACPRI-03-Z-0985

PLACE STICKER AT TOP OF ENVELOPE TO THE RIGHT OF THE RETURN ADDRESS. FOLD AT DOTTED LINE.
CERTIFIED MAIL™

U.S. Postal Service™	
CERTIFIED MAIL™ RECEIPT	
(Domestic Mail Only; No Insurance Coverage Provided)	
For delivery information visit our website at www.usps.com	
OFFICIAL USE	
Postage	\$
Certified Fee	
Return Receipt Fee (Endorsement Required)	
Restricted Delivery Fee (Endorsement Required)	
Total Postage & Fees	\$
<p>Sent To <u>Robert L. Goodwin</u></p> <p>Street, Apt. No., or PO Box No. <u>21701 Eagle Mountain Rd</u></p> <p>City, State, ZIP+4 <u>Buckeye, AZ 85326</u></p>	

7002 3150 0002 0908 7392

7002 3150 0002 0908 7392

PS Form 3800, June 2002

See Reverse for Instructions

RICHARDSON PRODUCTION COMPANY

501 Airport Drive, Suite 119

Phone (505) 564-8115

FARMINGTON, NM 87401

FAX (505) 564-8334

January 26, 2004

Certified Mail
Return Receipt Requested
Article No. 7002 3150 0002 0908 7385

Edmund J. Goodwin
404 Pecan Place
Brentwood, CA 94513

RE: Non-Standard Location Application
Proposed Pictured Cliffs Well
Richardson WF FRPC 17 #2
Township 29 North, Range 14 West, NMPM
1975' FNL & 575' FWL
Section 17: NW/4
San Juan County, New Mexico

Dear Mr. Goodwin:

As required by New Mexico Oil Conservation Division (NMOCD) Rules, this letter will serve to notify you of the following non-standard location application for a well. This letter is a notice only. No action is required on your part unless you have questions or objections. Any objections must be filed in writing within 20 days of receipt of the application by the NMOCD.

Richardson Operating Company is applying to the NMOCD for a non-standard location for its proposed Richardson Operating WF FRPC 17 #2 well in the Pictured Cliffs formation. The minimum distance from quarter section lines required by NMOCD rules is 660'. Due to existing surface conditions (topography), the well is approximately 85' to far West. A legal location is not physically possible.

Well Name:	WF FRPC 17 #2
Proposed Producing Zone:	Pictured Cliffs
Acreage Dedication:	NW/4 of Section 17, T29N, R14W, NMPM, San Juan Co., NM
Location:	1975' FNL & 575' FWL, Section 17, T29N, R14W, NMPM, San Juan Co., NM
Applicant's Name:	Richardson Operating Company
Applicant's Address:	3100 La Plata Highway, Farmington, New Mexico 87401
Applicant's Phone No.	505/564-8115

Submittal Information: Application for a non-standard location will be filed with the NMOCD. If they determine the application complies with the regulations, it will be approved. Any questions can be submitted to the New Mexico Oil Conservation Division, whose address is 1220 South St. Francis Drive, Santa Fe, New Mexico 87505. Their phone number is 505/476-3440.

Thank you for your consideration in this matter.

Please call me at 505/564-8115 (Richardson's Land Office) if you have any questions.

Sincerely,



Paul Lehrman

PLACE STICKER AT TOP OF ENVELOPE TO THE RIGHT
OF THE RETURN ADDRESS. FOLD AT DOTTED LINE

CERTIFIED MAIL™

7002 3150 0002 0908 7385
7002 3150 0002 0908 7385

U.S. Postal Service™
CERTIFIED MAIL™ RECEIPT
(Domestic Mail Only; No Insurance Coverage Provided)

For delivery information visit our website at www.usps.com

OFFICIAL USE

Postage	\$
Certified Fee	
Return Receipt Fee (Endorsement Required)	
Restricted Delivery Fee (Endorsement Required)	
Total Postage & Fees	\$

Postmark
Here

Sent To Edmund T. Goodwin
 Street, Apt. No.,
 or PO Box No. 404 Pecan Place
 City, State, ZIP+4 Brentwood, CA 94513

PS Form 3800, June 2002 See Reverse for Instructions

SENDER: COMPLETE THIS SECTION		COMPLETE THIS SECTION ON DELIVERY	
<ul style="list-style-type: none"> Complete items 1, 2, and 3. Also complete item 4 if Restricted Delivery is desired. Print your name and address on the reverse so that we can return the card to you. Attach this card to the back of the mailpiece, or on the front if space permits. 		<p>A. Signature <input type="checkbox"/> Agent <input checked="" type="checkbox"/> Addressee</p> <p>X</p>	
<p>1. Article Addressed to:</p> <p><u>Edmund T. Goodwin</u> <u>404 Pecan Place</u> <u>Brentwood, CA</u> <u>94513</u></p>		<p>B. Received by (Printed Name)</p> <p>C. Date of Delivery</p>	
<p>2. Article Number (Transfer from service label)</p> <p>7002 3150 0002 0908 7385</p>		<p>D. Is delivery address different from item 1? <input type="checkbox"/> Yes if YES, enter delivery address below: <input type="checkbox"/> No</p>	
<p>PS Form 3811, August 2001</p>		<p>3. Service Type</p> <p><input checked="" type="checkbox"/> Certified Mail <input type="checkbox"/> Express Mail <input type="checkbox"/> Registered <input checked="" type="checkbox"/> Return Receipt for Merchandise <input type="checkbox"/> Insured Mail <input type="checkbox"/> C.O.D.</p> <p>4. Restricted Delivery? (Extra Fee) <input type="checkbox"/> Yes</p>	

Domestic Return Receipt

2ACPRI-03-Z-0985

RICHARDSON PRODUCTION COMPANY

501 Airport Drive, Suite 119

Phone (505) 564-8115

FARMINGTON, NM 87401

FAX (505) 564-8334

January 26, 2004

Certified Mail

Return Receipt Requested

Article No. 7002 3150 0002 0908 7279

Barbara J. Sebastian

4160 Pinon Vista

Farmington, NM 87401

RE: Non-Standard Location Application
Proposed Pictured Cliffs Well
Richardson WF FRPC 17 #2
Township 29 North, Range 14 West, NMPM
1975' FNL & 575' FWL
Section 17: NW/4
San Juan County, New Mexico

Dear Ms. Sebastian:

As required by New Mexico Oil Conservation Division (NMOCD) Rules, this letter will serve to notify you of the following non-standard location application for a well. This letter is a notice only. No action is required on your part unless you have questions or objections. Any objections must be filed in writing within 20 days of receipt of the application by the NMOCD.

Richardson Operating Company is applying to the NMOCD for a non-standard location for its proposed Richardson Operating WF FRPC 17 #2 well in the Pictured Cliffs formation. The minimum distance from quarter section lines required by NMOCD rules is 660'. Due to existing surface conditions (topography), the well is approximately 85' to far West. A legal location is not physically possible.

Well Name:	WF FRPC 17 #2
Proposed Producing Zone:	Pictured Cliffs
Acreage Dedication:	NW/4 of Section 17, T29N, R14W, NMPM, San Juan Co., NM
Location:	1975' FNL & 575' FWL, Section 17, T29N, R14W, NMPM, San Juan Co., NM
Applicant's Name:	Richardson Operating Company
Applicant's Address:	3100 La Plata Highway, Farmington, New Mexico 87401
Applicant's Phone No.	505/564-8115

Submittal Information: Application for a non-standard location will be filed with the NMOCD. If they determine the application complies with the regulations, it will be approved. Any questions can be submitted to the New Mexico Oil Conservation Division, whose address is 1220 South St. Francis Drive, Santa Fe, New Mexico 87505. Their phone number is 505/476-3440.

Thank you for your consideration in this matter.

Please call me at 505/564-8115 (Richardson's Land Office) if you have any questions.

Sincerely,

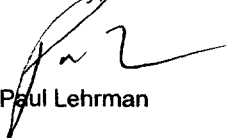

Paul Lehrman

PLACE STICKER AT TOP OF ENVELOPE TO THE RIGHT
OF THE RETURN ADDRESS, FOLD AT DOTTED LINE

CERTIFIED MAIL™

7002 3150 0002 0908 7279

U.S. Postal Service™
CERTIFIED MAIL™ RECEIPT
(Domestic Mail Only; No Insurance Coverage Provided)

For delivery information visit our website at www.usps.com

OFFICIAL USE

Postage	\$
Certified Fee	
Return Receipt Fee (Endorsement Required)	
Restricted Delivery Fee (Endorsement Required)	
Total Postage & Fees	\$

Postmark
Here

Sent To Barbara J. Sebastian
 Street, Apt. No.,
 or PO Box No. 4160 Pinon Vista
 City, State, ZIP+4 Farm. NM 87401

PS Form 3800, June 2002

See Reverse for Instructions

SENDER: COMPLETE THIS SECTION

- Complete items 1, 2, and 3. Also complete item 4 if Restricted Delivery is desired.
- Print your name and address on the reverse so that we can return the card to you.
- Attach this card to the back of the mailpiece, or on the front if space permits.

1. Article Addressed to:

Barbara J. Sebastian
4160 Pinon Vista
Farm. NM 87401

2. Article Number

(Transfer from service label)

7002 3150 0002 0908 7279

PS Form 3811, August 2001

Domestic Return Receipt

COMPLETE THIS SECTION ON DELIVERY

A. Signature

X

☐ Agent

☐ Addressee

B. Received by (Printed Name)

C. Date of Delivery

D. Is delivery address different from item 1? ☐ Yes
 If YES, enter delivery address below: ☐ No

3. Service Type

☒ Certified Mail

☐ Express Mail

☐ Registered

☒ Return Receipt for Merchandise

☐ Insured Mail

☐ C.O.D.

4. Restricted Delivery? (Extra Fee)

☐ Yes

2ACPRI-03-Z-0985

RICHARDSON PRODUCTION COMPANY

501 Airport Drive, Suite 119

Phone (505) 564-8115

FARMINGTON, NM 87401

FAX (505) 564-8334

January 26, 2004

Certified Mail
Return Receipt Requested
Article No. 7002 3150 0002 0908 7286

Charlie Johnson
505 Dayton Ave.
Newberg, OR 97132

RE: Non-Standard Location Application
Proposed Pictured Cliffs Well
Richardson WF FRPC 17 #2
Township 29 North, Range 14 West, NMPM
1975' FNL & 575' FWL
Section 17: NW/4
San Juan County, New Mexico

Dear Mr. Johnson:

As required by New Mexico Oil Conservation Division (NMOCD) Rules, this letter will serve to notify you of the following non-standard location application for a well. This letter is a notice only. No action is required on your part unless you have questions or objections. Any objections must be filed in writing within 20 days of receipt of the application by the NMOCD.

Richardson Operating Company is applying to the NMOCD for a non-standard location for its proposed Richardson Operating WF FRPC 17 #2 well in the Pictured Cliffs formation. The minimum distance from quarter section lines required by NMOCD rules is 660'. Due to existing surface conditions (topography), the well is approximately 85' to far West. A legal location is not physically possible.

Well Name:	WF FRPC 17 #2
Proposed Producing Zone:	Pictured Cliffs
Acreage Dedication:	NW/4 of Section 17, T29N, R14W, NMPM, San Juan Co., NM
Location:	1975' FNL & 575' FWL, Section 17, T29N, R14W, NMPM, San Juan Co., NM
Applicant's Name:	Richardson Operating Company
Applicant's Address:	3100 La Plata Highway, Farmington, New Mexico 87401
Applicant's Phone No.	505/564-8115

Submittal Information: Application for a non-standard location will be filed with the NMOCD. If they determine the application complies with the regulations, it will be approved. Any questions can be submitted to the New Mexico Oil Conservation Division, whose address is 1220 South St. Francis Drive, Santa Fe, New Mexico 87505. Their phone number is 505/476-3440.

Thank you for your consideration in this matter.

Please call me at 505/564-8115 (Richardson's Land Office) if you have any questions.

Sincerely,

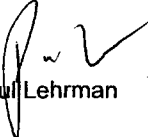
Paul Lehrman



7002 3150 0002 0908 7286
7002 3150 0002 0908 7286

U.S. Postal Service™
CERTIFIED MAIL™ RECEIPT
(Domestic Mail Only; No Insurance Coverage Provided)

For delivery information visit our website at www.usps.com

OFFICIAL USE

Postage	\$
Certified Fee	
Return Receipt Fee (Endorsement Required)	
Restricted Delivery Fee (Endorsement Required)	
Total Postage & Fees	\$

Postmark
Here

Sent To	
Charlie Johnson	
Street, Apt. No., or PO Box No. 505 Dayton Ave	
City, State, ZIP+4 Newburg, OR 97132	

PS Form 3800, June 2002 See Reverse for Instructions

SENDER: COMPLETE THIS SECTION

- Complete items 1, 2, and 3. Also complete item 4 if Restricted Delivery is desired.
- Print your name and address on the reverse so that we can return the card to you.
- Attach this card to the back of the mailpiece, or on the front if space permits.

1. Article Addressed to:

Charlie Johnson
505 Dayton Ave.
Newburg, OR 97132

2. Article Number

(Transfer from service lab)

7002 3150 0002 0908 7286

COMPLETE THIS SECTION ON DELIVERY

A. Signature

X

☐ Agent

☐ Addressee

B. Received by (Printed Name)

C. Date of Delivery

D. Is delivery address different from item 1? ☐ Yes

If YES, enter delivery address below: ☐ No

3. Service Type

☒ Certified Mail

☐ Express Mail

☐ Registered

☐ Return Receipt for Merchandise

☐ Insured Mail

☐ C.O.D.

4. Restricted Delivery? (Extra Fee)

☐ Yes

RICHARDSON PRODUCTION COMPANY

501 Airport Drive, Suite 119

Phone (505) 564-8115

FARMINGTON, NM 87401

FAX (505) 564-8334

January 26, 2004

Certified Mail

Return Receipt Requested

Article No. 7002 3150 0002 0908 7309

Glen D. Johnson
505 Dayton Ave.
Newberg, OR 97132

RE: Non-Standard Location Application
Proposed Pictured Cliffs Well
Richardson WF FRPC 17 #2
Township 29 North, Range 14 West, NMPM
1975' FNL & 575' FWL
Section 17: NW/4
San Juan County, New Mexico

Dear Mr. Johnson:

As required by New Mexico Oil Conservation Division (NMOCD) Rules, this letter will serve to notify you of the following non-standard location application for a well. This letter is a notice only. No action is required on your part unless you have questions or objections. Any objections must be filed in writing within 20 days of receipt of the application by the NMOCD.

Richardson Operating Company is applying to the NMOCD for a non-standard location for its proposed Richardson Operating WF FRPC 17 #2 well in the Pictured Cliffs formation. The minimum distance from quarter section lines required by NMOCD rules is 660'. Due to existing surface conditions (topography), the well is approximately 85' to far West. A legal location is not physically possible.

Well Name:	WF FRPC 17 #2
Proposed Producing Zone:	Pictured Cliffs
Acreage Dedication:	NW/4 of Section 17, T29N, R14W, NMPM, San Juan Co., NM
Location:	1975' FNL & 575' FWL, Section 17, T29N, R14W, NMPM, San Juan Co., NM
Applicant's Name:	Richardson Operating Company
Applicant's Address:	3100 La Plata Highway, Farmington, New Mexico 87401
Applicant's Phone No.	505/564-8115

Submittal Information: Application for a non-standard location will be filed with the NMOCD. If they determine the application complies with the regulations, it will be approved. Any questions can be submitted to the New Mexico Oil Conservation Division, whose address is 1220 South St. Francis Drive, Santa Fe, New Mexico 87505. Their phone number is 505/476-3440.

Thank you for your consideration in this matter.

Please call me at 505/564-8115 (Richardson's Land Office) if you have any questions.

Sincerely,



Paul Lehrman

SENDER: COMPLETE THIS SECTION		COMPLETE THIS SECTION ON DELIVERY	
<ul style="list-style-type: none"> Complete items 1, 2, and 3. Also complete item 4 if Restricted Delivery is desired. Print your name and address on the reverse so that we can return the card to you. Attach this card to the back of the mailpiece, or on the front if space permits. 		<p>A. Signature <input type="checkbox"/> Agent <input type="checkbox"/> Addressee</p> <p>X</p>	
<p>1. Article Addressed to:</p> <p style="text-align: center;">Glen D. Johnson 505 Dayton Ave Newburg, OR 97132</p>		<p>B. Received by (Printed Name)</p>	<p>C. Date of Delivery</p>
		<p>D. Is delivery address different from item 1? <input type="checkbox"/> Yes if YES, enter delivery address below: <input type="checkbox"/> No</p>	
		<p>3. Service-Type</p> <p><input type="checkbox"/> Certified Mail <input type="checkbox"/> Express Mail <input type="checkbox"/> Registered <input checked="" type="checkbox"/> Return Receipt for Merchandise <input type="checkbox"/> Insured Mail <input type="checkbox"/> C.O.D.</p>	
<p>2. Article Number (Transfer from service label)</p>		<p>4. Restricted Delivery? (Extra Fee) <input type="checkbox"/> Yes</p>	
		<p style="text-align: center;">7002 3150 0002 0908 7309</p>	

PS Form 3811, August 2001 Domestic Return Receipt 2ACPRI-03-Z-0985

PS Form 3800, June 2002 See Reverse for Instructions

Sent To: Glen D. Johnson
 Street, Apt. No., or PO Box No.: 505 Dayton Ave
 City, State, ZIP+4: Newburg, OR 97132

Postage	\$
Certified Fee	
Return Receipt Fee (Endorsement Required)	
Restricted Delivery Fee (Endorsement Required)	
Total Postage & Fees	\$

Postmark Here

U.S. Postal ServiceTM CERTIFIED MAILTM RECEIPT (Domestic Mail Only: No Insurance Coverage Provided)

For delivery information visit our website at www.usps.com

OFFICIAL USE

7002 3150 0002 0908 7309
 7002 3150 0002 0908 7309



RICHARDSON PRODUCTION COMPANY

501 Airport Drive, Suite 119

Phone (505) 564-8115

FARMINGTON, NM 87401

FAX (505) 564-8334

January 26, 2004

Certified Mail
Return Receipt Requested
Article No. 7002 3150 0002 0908 7316

J. Kenneth and Jonell Vaughan
#4 CR 6313
Kirtland, NM 87417

RE: Non-Standard Location Application
Proposed Pictured Cliffs Well
Richardson WF FRPC 17 #2
Township 29 North, Range 14 West, NMPM
1975' FNL & 575' FWL
Section 17: NW/4
San Juan County, New Mexico

Dear Mr. and Mrs. Vaughan:

As required by New Mexico Oil Conservation Division (NMOCD) Rules, this letter will serve to notify you of the following non-standard location application for a well. This letter is a notice only. No action is required on your part unless you have questions or objections. Any objections must be filed in writing within 20 days of receipt of the application by the NMOCD.

Richardson Operating Company is applying to the NMOCD for a non-standard location for its proposed Richardson Operating WF FRPC 17 #2 well in the Pictured Cliffs formation. The minimum distance from quarter section lines required by NMOCD rules is 660'. Due to existing surface conditions (topography), the well is approximately 85' to far West. A legal location is not physically possible.

Well Name:	WF FRPC 17 #2
Proposed Producing Zone:	Pictured Cliffs
Acreage Dedication:	NW/4 of Section 17, T29N, R14W, NMPM, San Juan Co., NM
Location:	1975' FNL & 575' FWL, Section 17, T29N, R14W, NMPM, San Juan Co., NM
Applicant's Name:	Richardson Operating Company
Applicant's Address:	3100 La Plata Highway, Farmington, New Mexico 87401
Applicant's Phone No.	505/564-8115

Submittal Information: Application for a non-standard location will be filed with the NMOCD. If they determine the application complies with the regulations, it will be approved. Any questions can be submitted to the New Mexico Oil Conservation Division, whose address is 1220 South St. Francis Drive, Santa Fe, New Mexico 87505. Their phone number is 505/476-3440.

Thank you for your consideration in this matter.

Please call me at 505/564-8115 (Richardson's Land Office) if you have any questions.

Sincerely,

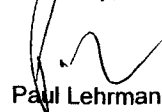

Paul Lehrman



7316 0908 0002 3150 7002
7316 0908 0002 3150 7002

U.S. Postal ServiceTM
CERTIFIED MAILTM RECEIPT
(Domestic Mail Only; No Insurance Coverage Provided)

For delivery information visit our website at www.usps.com

OFFICIAL USE

Postage	\$	Postmark Here
Certified Fee		
Return Receipt Fee (Endorsement Required)		
Restricted Delivery Fee (Endorsement Required)		
Total Postage & Fees	\$	

Sent To
J. Kenneth & Donell Vaughan
Street, Apt. No.,
or PO Box No. #4 CR 6313
City, State, ZIP+4 Kirtland, NM 87417

PS Form 3800, June 2002 See Reverse for Instructions

SENDER: COMPLETE THIS SECTION	COMPLETE THIS SECTION ON DELIVERY
<ul style="list-style-type: none">■ Complete items 1, 2, and 3. Also complete item 4 if Restricted Delivery is desired.■ Print your name and address on the reverse so that we can return the card to you.■ Attach this card to the back of the mailpiece, or on the front if space permits.	<p>A. Signature X <input type="checkbox"/> Agent <input type="checkbox"/> Addressee</p> <p>B. Received by (Printed Name) C. Date of Delivery</p> <p>D. Is delivery address different from item 1? <input type="checkbox"/> Yes If YES, enter delivery address below: <input type="checkbox"/> No</p>
<p>1. Article Addressed to:</p> <p>J. Kenneth & Donell Vaughan #4 CR 6313 Kirtland, NM 87417</p>	<p>3. Service Type <input checked="" type="checkbox"/> Certified Mail <input type="checkbox"/> Express Mail <input type="checkbox"/> Registered <input checked="" type="checkbox"/> Return Receipt for Merchandise <input type="checkbox"/> Insured Mail <input type="checkbox"/> C.O.D.</p> <p>4. Restricted Delivery? (Extra Fee) <input type="checkbox"/> Yes</p>
<p>2. Article Number (Transfer from service label)</p>	
7002 3150 0002 0908 7316	
PS Form 3811, August 2001	Domestic Return Receipt 2ACPRI-03-2-0985

RICHARDSON PRODUCTION COMPANY

501 Airport Drive, Suite 119

Phone (505) 564-8115

FARMINGTON, NM 87401

FAX (505) 564-8334

January 26, 2004

Certified Mail
Return Receipt Requested
Article No. 7002 3150 0002 0908 7323

Karen Hollingsworth
#6 CR 6317
Kirtland, NM 87417

RE: Non-Standard Location Application
Proposed Pictured Cliffs Well
Richardson WF FRPC 17 #2
Township 29 North, Range 14 West, NMPM
1975' FNL & 575' FWL
Section 17: NW/4
San Juan County, New Mexico

Dear Ms. Hollingsworth:

As required by New Mexico Oil Conservation Division (NMOCD) Rules, this letter will serve to notify you of the following non-standard location application for a well. This letter is a notice only. No action is required on your part unless you have questions or objections. Any objections must be filed in writing within 20 days of receipt of the application by the NMOCD.

Richardson Operating Company is applying to the NMOCD for a non-standard location for its proposed Richardson Operating WF FRPC 17 #2 well in the Pictured Cliffs formation. The minimum distance from quarter section lines required by NMOCD rules is 660'. Due to existing surface conditions (topography), the well is approximately 85' to far West. A legal location is not physically possible.

Well Name:	WF FRPC 17 #2
Proposed Producing Zone:	Pictured Cliffs
Acreage Dedication:	NW/4 of Section 17, T29N, R14W, NMPM, San Juan Co., NM
Location:	1975' FNL & 575' FWL, Section 17, T29N, R14W, NMPM, San Juan Co., NM
Applicant's Name:	Richardson Operating Company
Applicant's Address:	3100 La Plata Highway, Farmington, New Mexico 87401
Applicant's Phone No.	505/564-8115

Submittal Information: Application for a non-standard location will be filed with the NMOCD. If they determine the application complies with the regulations, it will be approved. Any questions can be submitted to the New Mexico Oil Conservation Division, whose address is 1220 South St. Francis Drive, Santa Fe, New Mexico 87505. Their phone number is 505/476-3440.

Thank you for your consideration in this matter.

Please call me at 505/564-8115 (Richardson's Land Office) if you have any questions.

Sincerely,

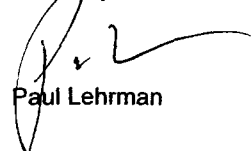

Paul Lehrman

PLACE STICKER AT TOP OF ENVELOPE TO THE RIGHT
OF THE RETURN ADDRESS, FOLD AT DOTTED LINE

CERTIFIED MAIL™

7323 0908 0002 3150 0002 0908 7323

U.S. Postal Service™
CERTIFIED MAIL™ RECEIPT
 (Domestic Mail Only; No Insurance Coverage Provided)

For delivery information visit our website at www.usps.com

OFFICIAL USE

Postage	\$
Certified Fee	
Return Receipt Fee (Endorsement Required)	
Restricted Delivery Fee (Endorsement Required)	
Total Postage & Fees	\$

Postmark Here

Sent To Karen Hollingsworth
 Street, Apt. No.,
 or PO Box No. 6 CR 6317
 City, State, ZIP+4 Kirtland, NM 87417

PS Form 3800, June 2002 See Reverse for Instructions

SENDER: COMPLETE THIS SECTION		COMPLETE THIS SECTION ON DELIVERY	
<p>■ Complete items 1, 2, and 3. Also complete item 4 if Restricted Delivery is desired.</p> <p>■ Print your name and address on the reverse so that we can return the card to you.</p> <p>■ Attach this card to the back of the mailpiece, or on the front if space permits.</p>		<p>A. Signature <input type="checkbox"/> Agent <input type="checkbox"/> Addressee</p> <p>X</p>	
<p>1. Article Addressed to:</p> <p><u>Karen Hollingsworth</u> <u>6 CR 6317</u> <u>Kirtland, NM</u> <u>87417</u></p>		<p>B. Received by (Printed Name)</p>	<p>C. Date of Delivery</p>
<p>2. Article Number (Transfer from service label) <u>7002 3150 0002 0908 7323</u></p>		<p>D. Is delivery address different from item 1? <input type="checkbox"/> Yes if YES, enter delivery address below: <input type="checkbox"/> No</p>	
<p>3. Service Type</p> <p><input checked="" type="checkbox"/> Certified Mail <input type="checkbox"/> Express Mail <input type="checkbox"/> Registered <input checked="" type="checkbox"/> Return Receipt for Merchandise <input type="checkbox"/> Insured Mail <input type="checkbox"/> C.O.D.</p>		<p>4. Restricted Delivery? (Extra Fee) <input type="checkbox"/> Yes</p>	

RICHARDSON PRODUCTION COMPANY

501 Airport Drive, Suite 119

Phone (505) 564-8115

FARMINGTON, NM 87401

FAX (505) 564-8334

January 26, 2004

Certified Mail

Return Receipt Requested

Article No. 7002 3150 0002 0908 7330

Richard and Nina Hatch

#6 CR 6319

Kirtland, NM 87417

RE: Non-Standard Location Application
Proposed Pictured Cliffs Well
Richardson WF FRPC 17 #2
Township 29 North, Range 14 West, NMPM
1975' FNL & 575' FWL
Section 17: NW/4
San Juan County, New Mexico

Dear Mr. & Mrs. Hatch:

As required by New Mexico Oil Conservation Division (NMOCD) Rules, this letter will serve to notify you of the following non-standard location application for a well. This letter is a notice only. No action is required on your part unless you have questions or objections. Any objections must be filed in writing within 20 days of receipt of the application by the NMOCD.

Richardson Operating Company is applying to the NMOCD for a non-standard location for its proposed Richardson Operating WF FRPC 17 #2 well in the Pictured Cliffs formation. The minimum distance from quarter section lines required by NMOCD rules is 660'. Due to existing surface conditions (topography), the well is approximately 85' to far West. A legal location is not physically possible.

Well Name:	WF FRPC 17 #2
Proposed Producing Zone:	Pictured Cliffs
Acreage Dedication:	NW/4 of Section 17, T29N, R14W, NMPM, San Juan Co., NM
Location:	1975' FNL & 575' FWL, Section 17, T29N, R14W, NMPM, San Juan Co., NM
Applicant's Name:	Richardson Operating Company
Applicant's Address:	3100 La Plata Highway, Farmington, New Mexico 87401
Applicant's Phone No.	505/564-8115

Submittal Information: Application for a non-standard location will be filed with the NMOCD. If they determine the application complies with the regulations, it will be approved. Any questions can be submitted to the New Mexico Oil Conservation Division, whose address is 1220 South St. Francis Drive, Santa Fe, New Mexico 87505. Their phone number is 505/476-3440.

Thank you for your consideration in this matter.

Please call me at 505/564-8115 (Richardson's Land Office) if you have any questions.

Sincerely,

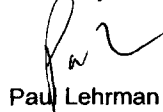

Paul Lehrman



7002 3150 0002 0908 7330
 7002 3150 0002 0908 7330
 7002 3150 0002 0908 7330

U.S. Postal Service™	
CERTIFIED MAIL™ RECEIPT	
(Domestic Mail Only; No Insurance Coverage Provided)	
For delivery information visit our website at www.usps.com	
OFFICIAL USE	
Postage	\$
Certified Fee	
Return Receipt Fee (Endorsement Required)	
Restricted Delivery Fee (Endorsement Required)	
Total Postage & Fees	\$
Postmark Here	
Sent To	
Richard & Nina Hatch	
Street, Apt. No., or PO Box No. 45 CR 6319	
City, State, ZIP+4 Kirtland NM 87417	
PS Form 3800, June 2002	
See Reverse for Instructions	

SENDER: COMPLETE THIS SECTION		COMPLETE THIS SECTION ON DELIVERY	
<ul style="list-style-type: none"> Complete items 1, 2, and 3. Also complete item 4 if Restricted Delivery is desired. Print your name and address on the reverse so that we can return the card to you. Attach this card to the back of the mailpiece, or on the front if space permits. 		A. Signature X <input type="checkbox"/> Agent <input type="checkbox"/> Addressee	
1. Article Addressed to: Richard M. Hatch and Nina L. Hatch 45 CR 6319 Kirtland, NM 87417		B. Received by (Printed Name) C. Date of Delivery	
2. Article Number (Transfer from service label) 7002 3150 0002 0908 7330		D. Is delivery address different from item 1? <input type="checkbox"/> Yes <input type="checkbox"/> No if YES, enter delivery address below:	
3. Service Type <input checked="" type="checkbox"/> Certified Mail <input type="checkbox"/> Express Mail <input type="checkbox"/> Registered <input checked="" type="checkbox"/> Return Receipt for Merchandise <input type="checkbox"/> Insured Mail <input type="checkbox"/> C.O.D.		4. Restricted Delivery? (Extra Fee) <input type="checkbox"/> Yes	

RICHARDSON PRODUCTION COMPANY

501 Airport Drive, Suite 119

Phone (505) 564-8115

FARMINGTON, NM 87401

FAX (505) 564-8334

January 26, 2004

Certified Mail
Return Receipt Requested
Article No. 7002 3150 0002 0908 7347

Glenn & Bonita Hoyle
415 CR 6100
Kirtland, NM 87417

RE: Non-Standard Location Application
Proposed Pictured Cliffs Well
Richardson WF FRPC 17 #2
Township 29 North, Range 14 West, NMPM
1975' FNL & 575' FWL
Section 17: NW/4
San Juan County, New Mexico

Dear Mr. & Mrs. Hoyle:

As required by New Mexico Oil Conservation Division (NMOCD) Rules, this letter will serve to notify you of the following non-standard location application for a well. This letter is a notice only. No action is required on your part unless you have questions or objections. Any objections must be filed in writing within 20 days of receipt of the application by the NMOCD.

Richardson Operating Company is applying to the NMOCD for a non-standard location for its proposed Richardson Operating WF FRPC 17 #2 well in the Pictured Cliffs formation. The minimum distance from quarter section lines required by NMOCD rules is 660'. Due to existing surface conditions (topography), the well is approximately 85' to far West. A legal location is not physically possible.

Well Name:	WF FRPC 17 #2
Proposed Producing Zone:	Pictured Cliffs
Acreage Dedication:	NW/4 of Section 17, T29N, R14W, NMPM, San Juan Co., NM
Location:	1975' FNL & 575' FWL, Section 17, T29N, R14W, NMPM, San Juan Co., NM
Applicant's Name:	Richardson Operating Company
Applicant's Address:	3100 La Plata Highway, Farmington, New Mexico 87401
Applicant's Phone No.	505/564-8115

Submittal Information: Application for a non-standard location will be filed with the NMOCD. If they determine the application complies with the regulations, it will be approved. Any questions can be submitted to the New Mexico Oil Conservation Division, whose address is 1220 South St. Francis Drive, Santa Fe, New Mexico 87505. Their phone number is 505/476-3440.

Thank you for your consideration in this matter.

Please call me at 505/564-8115 (Richardson's Land Office) if you have any questions.

Sincerely,

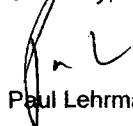

Paul Lehrman

SENDER: COMPLETE THIS SECTION

- Complete items 1, 2, and 3. Also complete item 4 if Restricted Delivery is desired.
- Print your name and address on the reverse so that we can return the card to you.
- Attach this card to the back of the mailpiece, or on the front if space permits.

1. Article Addressed to:

Glenn + Bonita Hoyle
415 CR 6100
Kirtland, NM
87417

2. Article Number

(Transfer from service label)

7002 3150 0002 0908 7347

COMPLETE THIS SECTION ON DELIVERY

A. Signature

X

☐ Agent

☐ Addressee

B. Received by (Printed Name)

C. Date of Delivery

- D. Is delivery address different from item 1?** ☐ Yes
If YES, enter delivery address below: ☐ No

3. Service Type

☒ Certified Mail

☐ Express Mail

☐ Registered

☒ Return Receipt for Merchandise

☐ Insured Mail

☐ C.O.D.

4. Restricted Delivery? (Extra Fee)

☐ Yes

PS Form 3811, August 2001

Domestic Return Receipt

2ACPRI-03-Z-0985



7002 3150 0002 0908 7347
7002 3150 0002 0908 7347
7002 3150 0002 0908 7347

U.S. Postal ServiceTM

CERTIFIED MAILTM RECEIPT

(Domestic Mail Only; No Insurance Coverage Provided)

For delivery information visit our website at www.usps.com

OFFICIAL USE

Postage \$

Certified Fee

Return Receipt Fee
(Endorsement Required)

Restricted Delivery Fee
(Endorsement Required)

Total Postage & Fees \$

Postmark
Here

Sent To

Glenn + Bonita Hoyle

Street, Apt. No.,
or PO Box No.

415 CR 6100

City, State, ZIP+4

Kirtland, NM 87417

PS Form 3800, June 2002

See Reverse for Instructions