



NEW MEXICO ENERGY, MINERALS and NATURAL RESOURCES DEPARTMENT

GARY E. JOHNSON
Governor
Jennifer A. Salisbury
Cabinet Secretary

Lori Wrotenbery
Director
Oil Conservation Division

December 3, 2001

Markwest Resources, Inc.
c/o Permits West, Inc.
37 Verano Loop
Santa Fe, New Mexico 87505
Attention: Brian Wood
brian@permitswest.com

Administrative Order NSL-4671

Dear Mr. Wood:

Reference is made to the following: (i) your application on behalf of the operator, Markwest Resources, Inc. ("Markwest") that was submitted to the New Mexico Oil Conservation Division ("Division") on November 13, 2001 (*Division application reference No. pKRV0-131857228*); and (ii) the Division's records in Aztec and Santa Fe, including the files on Division Administrative Orders NSL-2986 and NSL-2986-A: all concerning Markwest's request for an exception to the well location requirements provided within the "*Special Rules and Regulations for the Basin-Dakota Pool*," as promulgated by Division Order No. R-10987-B, dated June 30, 2000, as amended by Division Order No. R-10987-B (1), dated August 10, 2000. The E/2 of Section 23, Township 27 North, Range 11 West, NMPM, San Juan County, New Mexico is to be dedicated to Markwest's proposed well in order to form a standard 320-acre stand-up gas spacing and proration unit for the Basin-Dakota Pool (71629).

The application has been duly filed under the provisions of Division Rules 104.F and 605.B.

By the authority granted me under the provisions of Division Rule 104.F (2), the following described well to be drilled at an unorthodox gas well location in Section 23 is hereby approved:

Scott Federal "23" Well No. 1
1645' FNL & 360' FEL (Unit H).

Further, the aforementioned well and spacing unit will be subject to all existing rules, regulations, policies, and procedures applicable to prorated gas pools in Northwest, New Mexico.

Sincerely,

Lori Wrotenbery
Director

LW/MES/kv

cc: New Mexico Oil Conservation Division - Aztec
U. S. Bureau of Land Management - Farmington



NEW MEXICO ENERGY, MINERALS and NATURAL RESOURCES DEPARTMENT

GARY E. JOHNSON

Governor

BETTY RIVERA

Cabinet Secretary

December 23, 2002

Lori Wrotenbery

Director

Oil Conservation Division

Markwest Resources, Inc.
c/o Permits West, Inc.
37 Verano Loop
Santa Fe, New Mexico 87505
Attention: Brian Wood
brian@permitswest.com

Administrative Order NSL-4671-A (SD)

Dear Mr. Wood:

Reference is made to the following: (i) your application on behalf of the operator, MarkWest Resources, Inc. ("MarkWest"), submitted to the New Mexico Oil Conservation Division ("Division") on December 2, 2002 (*Division application reference No. pKRV0-233730891*); and (ii) the Division's records in Aztec and Santa Fe: all concerning MarkWest's request for an exception to the well location requirements provided within the "*Special Rules and Regulations for the Basin-Dakota Pool*," as promulgated by Division Order No. R-10987-B, issued in Case No. 12290 and dated June 30, 2000, as amended by Division Orders No. R-10987-B (1), dated August 10, 2000, and R-10987-B (2), dated January 29, 2002, for a non-standard infill gas well location within an existing standard 320-acre stand-up gas spacing and proration unit for the Basin-Dakota Pool (71599) comprising the E/2 of Section 23, Township 27 North, Range 11 West, NMPM, San Juan County, New Mexico.

This unit is currently dedicated to MarkWest's Scott Federal "23-27-11" Well No. 1 (API No. 30-045-30892), located at an unorthodox gas well location (approved by Division Administrative Order NSL-4671, dated December 3, 2001) 1645 feet from the North line and 360 feet from the East line (Unit H) of Section 23.

The application has been duly filed under the provisions of Division Rules 104.F and 605.B.

By the authority granted me under the provisions of Division Rule 104.F (2), the following described well to be drilled at an unorthodox infill gas well location in Section 23 is hereby approved:

Scott Federal Well No. 233
285' FSL & 1370' FEL (Unit O).

Further, the aforementioned Scott Federal "23-27-11" Well No. 1 and Scott Federal Well No. 233 and existing Dakota gas spacing and proration unit will be subject to all existing rules, regulations,

Administrative Order NSL-4671-A(SD)

Markwest Resources, Inc.

December 23, 2002

Page 2

policies, and procedures applicable to prorated gas pools in Northwest, New Mexico.

Sincerely,

A handwritten signature in black ink, appearing to read "Lori Wrotenbery / MES". The signature is fluid and cursive, with a large, stylized "L" and "W".

Lori Wrotenbery
Director

LW/MES/kv

cc: New Mexico Oil Conservation Division – Aztec
U. S. Bureau of Land Management – Farmington
File: NSL-4671 /

CMD : ONGARD 03/08/04 14:58:55
OG6IWCM INQUIRE WELL COMPLETIONS OGOMES -TQGW

API Well No : 30 45 30892 Eff Date : 02-04-2004 WC Status : A
Pool Idn : 71599 BASIN DAKOTA (PRORATED GAS)
OGRID Idn : 167067 XTO ENERGY, INC.
Prop Idn : 32629 SCOTT FEDERAL 27 11 23

Well No : 001
GL Elevation: 6133

	U/L	Sec	Township	Range	North/South	East/West	Prop/Act (P/A)
	---	---	-----	-----	-----	-----	-----
B.H. Locn : H	23	27N	11W	FTG 1645	F N FTG 360	F E	P

Lot Identifier:
Dedicated Acre: 320.00
Lease Type : F
Type of consolidation (Comm, Unit, Forced Pooling - C/U/F/O) :

E6317: No more recs. for this api well no.

PF01 HELP	PF02	PF03 EXIT	PF04 GoTo	PF05	PF06
PF07	PF08	PF09	PF10 NEXT-WC	PF11 HISTORY	PF12 NXTREC

CMD : ONGARD 03/08/04 14:59:00
OG6ACRE C102-DEDICATE ACREAGE OGOMES -TQGW
Page No : 1

API Well No : 30 45 30892 Eff Date : 02-04-2004
Pool Idn : 71599 BASIN DAKOTA (PRORATED GAS)
Prop Idn : 32629 SCOTT FEDERAL 27 11 23 Well No : 001
Spacing Unit : 58423 OCD Order : Simultaneous Dedication:
Sect/Twp/Rng : 23 27N 11W Acreage : 320.00 Revised C102? (Y/N) :
Dedicated Land:

S	Base	U/L	Sec	Twp	Rng	Acreage	L/W	Ownership	Lot	Idn
A	23	27N	11W	40.00	N	FD				
B	23	27N	11W	40.00	N	FD				
C	23	27N	11W	40.00	N	FD				
D	23	27N	11W	40.00	N	FD				
E	23	27N	11W	40.00	N	FD				
F	23	27N	11W	40.00	N	FD				
G	23	27N	11W	40.00	N	FD				
H	23	27N	11W	40.00	N	FD				

E0005: Enter data to modify or PF keys to scroll

PF01 HELP	PF02	PF03 EXIT	PF04 GoTo	PF05	PF06 CONFIRM
PF07 BKWD	PF08 FWD	PF09	PF10 LAND	PF11 NXTSEC	PF12 RECONF

CMD : ONGARD 03/08/04 14:59:11
OG6IPRD INQUIRE PRODUCTION BY POOL/WELL OGOMES -TQGW
Page No: 1

OGRID Identifier : 167067 XTO ENERGY, INC.
Pool Identifier : 71599 BASIN DAKOTA (PRORATED GAS)
API Well No : 30 45 30892 Report Period - From : 01 2000 To : 01 2004

API Well No			Property Name				Prodn. Days		Production Volumes			Well	
							MM/YY	Prod	Gas	Oil	Water	Stat	
30	45	30892	SCOTT	FEDERAL	27	11	07	03	31	4728	29		F
30	45	30892	SCOTT	FEDERAL	27	11	08	03	31	4229		38	F
30	45	30892	SCOTT	FEDERAL	27	11	09	03	30	3525	32	60	F
30	45	30892	SCOTT	FEDERAL	27	11	10	03	31	4372	8	40	F
30	45	30892	SCOTT	FEDERAL	27	11	11	03	30	1922	16		F
30	45	30892	SCOTT	FEDERAL	27	11	12	03	31	3555	15	43	F

Reporting Period Total (Gas, Oil) :	22331	100	181
-------------------------------------	-------	-----	-----

M0025: Enter PF keys to scroll

PF01	HELP	PF02		PF03	EXIT	PF04	GoTo	PF05		PF06	CONFIRM
PF07	BKWD	PF08	FWD	PF09		PF10	NXTPOOL	PF11	NXTOGD	PF12	

CMD : ONGARD 03/08/04 14:59:14
OG6IPRD INQUIRE PRODUCTION BY POOL/WELL OGOMES -TQGW
Page No: 1

OGRID Identifier : 167067 XTO ENERGY, INC.
Pool Identifier : 71599 BASIN DAKOTA (PRORATED GAS)
API Well No : 30 45 30892 Report Period - From : 01 2000 To : 01 2004

API Well No	Property Name	Prodn. Days MM/YY Prod	Production Volumes Gas Oil Water	Well Stat
30 45 30892	SCOTT FEDERAL 27 11	07 03 31	4728 29	F
30 45 30892	SCOTT FEDERAL 27 11	08 03 31	4229 38	F
30 45 30892	SCOTT FEDERAL 27 11	09 03 30	3525 60	F
30 45 30892	SCOTT FEDERAL 27 11	10 03 31	4372 40	F
30 45 30892	SCOTT FEDERAL 27 11	11 03 30	1922 16	F
30 45 30892	SCOTT FEDERAL 27 11	12 03 31	3555 15 43	F

Reporting Period Total (Gas, Oil) : 22331 100 181

M0001: This is the last page

PF01 HELP PF02 PF03 EXIT PF04 GoTo PF05 PF06 CONFIRM
PF07 BKWD PF08 FWD PF09 PF10 NXTPOOL PF11 NXTOGD PF12

UNITED STATES
DEPARTMENT OF THE INTERIOR
BUREAU OF LAND MANAGEMENT

APPLICATION FOR PERMIT TO DRILL OR DEEPEN

1a. TYPE OF WORK

DRILL ☒DEEPEN ☐

b. TYPE OF WELL

OIL
WELL ☐GAS
WELL ☒OTHER ☐SINGLE
ZONE ☒MULTIPLE
ZONE ☐

2. NAME OF OPERATOR

MarkWest Resources, Inc.

(303) 290-8700

3. ADDRESS AND TELEPHONE NO.

155 Inverness Dr. W, Suite 200, Englewood, Co. 80112

4. LOCATION OF WELL (Report location clearly and in accordance with any State requirements)

At surface

1645' FNL & 360' FEL

At proposed prod. zone

Same

14. DISTANCE IN MILES AND DIRECTION FROM NEAREST TOWN OR POST OFFICE*

10 air miles SSE of Bloomfield

15. DISTANCE FROM PROPOSED*

LOCATION TO NEAREST

PROPERTY OR LEASE LINE, FT.

(Also to nearest drlg. unit line, if any)

1,645'

18. DISTANCE FROM PROPOSED LOCATION*

TO NEAREST WELL, DRILLING COMPLETED,

OR APPLIED FOR, ON THIS LEASE, FT.

39'

16. NO. OF ACRES IN LEASE

2,560

19. PROPOSED DEPTH

6,470'

17. NO. OF ACRES ASSIGNED

TO THIS WELL

320

20. ROTARY OR CABLE TOOLS

Rotary

21. ELEVATIONS (Show whether DF, RT, GR, etc.)

6,133' ungraded

22. APPROX. DATE WORK WILL START*

Dec. 1, 2001

PROPOSED CASING AND CEMENTING PROGRAM

SIZE OF HOLE	GRADE SIZE OF CASING	WEIGHT PER FOOT	SETTING DEPTH	QUANTITY OF CEMENT
12-1/4"	K-55 8-5/8"	24	320' 160'	≈ 176 cu. ft. & to surface
7-7/8"	N-80 4-1/2"	11.6	6,470'	≈ 2,046 cu. ft. & to surface

This action is subject to technical and
procedural review pursuant to 43 CFR 3165.3
and appeal pursuant to 43 CFR 3165.4.

On sited with Bill Liese. Archaeology consultant: CASA

Only other well in quarter-quarter is a MarkWest well.

Will apply for NSL (due to terrain) from OCD.

cc: BLM, OCD (via BLM), Pippin, Stowe

IN ABOVE SPACE DESCRIBE PROPOSED PROGRAM: If proposal is to deepen, give data on present productive zone and proposed new productive zone. If proposal is to drill or deepen directionally, give pertinent data on subsurface locations and measured and true vertical depths. Give blowout prevention program, if any.

24. SIGNED [Signature] CONSULTANT (505) 466-8120 10-28-01

SIGNED

TITLE

DATE

(This space for Federal or State office use)

PERMIT NO.

APPROVAL DATE

12/17/01

Application approval does not warrant or certify that the applicant holds legal or equitable title to those rights in the subject lease which would entitle the applicant to conduct operations thereon
CONDITIONS OF APPROVAL, IF ANY:

APPROVED BY

TITLE

AFM

DATE

12/17/01

See Instructions On Reverse Side

MOC

DISTRICT I
1625 N. French Dr., Hobbs, N.M. 88240

DISTRICT II
811 South First, Artesia, N.M. 88210

DISTRICT III
1000 Rio Brazos Rd., Aztec, N.M. 87410

DISTRICT IV
2040 South Pacheco, Santa Fe, NM 87505

State of New Mexico
Energy, Minerals & Natural Resources Department

Form C-102
Revised August 15, 2000

Submit to Appropriate District Office
State Lease - 4 Copies
Fee Lease - 3 Copies

OIL CONSERVATION DIVISION

2040 South Pacheco
Santa Fe, NM 87505

☐ AMENDED REPORT

WELL LOCATION AND ACREAGE DEDICATION PLAT

*API Number 30-045-30892		*Pool Code 71599	*Pool Name BASIN DAKOTA
*Property Code 29140	*Property Name SCOTT FEDERAL 27-11-23		*Well Number #29140
*OGRD No. 193195	*Operator Name MARKWEST RESOURCES, INC.		*Elevation 6133'

¹⁰ Surface Location

UL or lot no.	Section	Township	Range	Lot Idn	Feet from the	North/South line	Feet from the	East/West line	County
H	23	27-N	11-W		1645'	NORTH	360'	EAST	SAN JUAN

¹¹ Bottom Hole Location If Different From Surface

UL or lot no.	Section	Township	Range	Lot Idn	Feet from the	North/South line	Feet from the	East/West line	County
*Dedicated Acres 3.26			*Joint or Infill		*Consolidation Code		*Order No. NSL 4671		

NO ALLOWABLE WILL BE ASSIGNED TO THIS COMPLETION UNTIL ALL INTERESTS HAVE BEEN CONSOLIDATED
OR A NON-STANDARD UNIT HAS BEEN APPROVED BY THE DIVISION

16 CALC'D SEC. CORNER N 00-01 W 20 LINKS WITNESS CORNER FD 2 1/2" BC G.L.O. 1913	S 89-52-00 W	5297.48'	SEC. CORNER FD 2 1/2" BC G.L.O. 1913	1645' 2848.36' S 00-15-03 W 1003'
DEC 2001		LAT. 36°33.8'N LONG. 107°57.9'W	964' 321' 360'	CALC'D CORNER S 00-01 E 2.7 CHAINS WITNESS CORNER FD 2 1/2" BC G.L.O. 1913
23				

17 OPERATOR CERTIFICATION

I hereby certify that the information contained herein is true and complete to the best of my knowledge and belief.

Brian Wood
Signature

Printed Name
BRIAN WOOD

Title
CONSULTANT

Date
OCT. 28, 2001

18 SURVEYOR CERTIFICATION

I hereby certify that the well location shown on this plat was plotted from field notes of actual surveys made by me or under my supervision, and that the same is true and correct to the best of my belief.

7-11
Date of Survey

[Signature]
Signature and Seal of Professional Surveyor

ROSA RUSH
NEW MEXICO
REGISTERED PROFESSIONAL LAND SURVEYOR
8894

Certificate Number

UNITED STATES
DEPARTMENT OF THE INTERIOR
BUREAU OF LAND MANAGEMENT

SUNDRY NOTICES AND REPORTS ON WELLS

Do not use this form for proposals to drill or to deepen or reentry to a different reservoir.
Use "APPLICATION FOR PERMIT—" for such proposals

SUBMIT IN TRIPLICATE

1. Type of Well

☐ Oil Well ☒ Gas Well ☐ Other

2. Name of Operator

Markwest Resources, Inc. 155 Inverness Drive #200

3. Address and Telephone No.

Englewood Colorado 80112 303-925-9283

4. Location of Well (Footage, Sec., T., R., M., or Survey Description)

1645' FNL & 360' FEL Sec. 23-27N-11W

FORM APPROVED

Budget Bureau No. 1004-0135

Expires: March 31, 1993

5. Lease Designation and Serial No.

NMSF-078089

6. If Indian, Allottee or Tribe Name

na

7. If Unit or CA, Agreement Designation

NA

8. Well Name and No.

Scott Fed. 27-11 23-1

9. API Well No.

30-045-30842

10. Field and Pool, or Exploratory Area

Basin Dakota

11. County or Parish, State

San Juan, NM

12. CHECK APPROPRIATE BOX(s) TO INDICATE NATURE OF NOTICE, REPORT, OR OTHER DATA

TYPE OF SUBMISSION

- ☐ Notice of Intent
☒ Subsequent Report
☐ Final Abandonment Notice

TYPE OF ACTION

- ☐ Abandonment
☐ Recompletion
☐ Plugging Back
☐ Casing Repair
☐ Altering Casing
☒ Other Status

- ☐ Change of Plans
☐ New Construction
☐ Non-Routine Fracturing
☐ Water Shut-Off
☐ Conversion to Injection
☐ Dispose Water

(Note: Report results of multiple completion in Well Completion or Recompletion Report and Log form.)

13. Describe Proposed or Completed Operations (Clearly state all pertinent details, and give pertinent dates, including estimated date of starting any proposed work. If well is directionally drilled, give subsurface locations and measured and true vertical depths for all markers and zones pertinent to this work.)*

1-23-02 Spudded well @ 1:00 PM, drilled to TD w/ 12-1/4" Bit. Ran 8-5/8", 23#, J-55 csg @ 378'. Cmt w/ 260 sx class "B" cmt, 2% CACL2, & w/4# Celo Flake/sx circ. 14 bbls to surf. Csg to 500 PSI.

RECEIVED
2002 FEB 22 PM 12:16
070 FARMINGTON, NM

14. I hereby certify that the foregoing is true and correct

Signed

Title

Operator Representative

Date

2-7-02

(This space for Federal or State office use)

Approved by

Title

Conditions of approval, if any:

Date

FEB 26 2002

FARMINGTON FIELD OFFICE

Title 18 U.S.C. Section 1001, makes it a crime for any person knowingly and willfully to make to any department or agency of the United States any false, fictitious or fraudulent statements or representations as to any matter within its jurisdiction.

*See Instruction on Reverse Side

UNITED STATES
DEPARTMENT OF THE INTERIOR
BUREAU OF LAND MANAGEMENT

Sundry Notices and Reports on Wells

<p>1. Type of Well: GAS</p> <hr/> <p>2. Name of Operator: Mark West Resources</p> <hr/> <p>3. Address & Phone No. of Operator: 155 Innerness Dr. West, Englewood, CO 80112-5000 800-730-8388</p> <hr/> <p>4. Location of Well, Footage, Sec, T, R, M: 1645' FNL & 360' FEL Sec. 23, T-27-N, R-11-W, NMPM</p> <hr/>	<p>5. Lease Number: NMSF-078089</p> <p>6. If Indian, All. or Tribe Name:</p> <p>7. Unit Agreement Name:</p> <p>8. Well Name & Number: SCOTT FED. 27-11 #23-1</p> <p>9. API Well No.: <i>07</i> 30-045-30842</p> <p>10. Field and Pool: BASIN DAKOTA</p> <p>11. County and State: San Juan County, New Mexico</p> <hr/> <p>12. CHECK APPROPRIATE BOX TO INDICATE NATURE OF NOTICE, REPORT, OTHER DATA:</p> <table border="0" style="width: 100%;"> <tr> <td style="width: 33%;">Type of Submission:</td> <td style="width: 33%;">Type of Action:</td> <td style="width: 33%;"></td> </tr> <tr> <td><input type="checkbox"/> Notice of Intent</td> <td><input type="checkbox"/> Abandonment</td> <td><input type="checkbox"/> Change of Plans</td> </tr> <tr> <td><input checked="" type="checkbox"/> Subsequent Report</td> <td><input type="checkbox"/> Recompletion</td> <td><input type="checkbox"/> New Construction:</td> </tr> <tr> <td><input type="checkbox"/> Final Abandonment</td> <td><input type="checkbox"/> Plugging Back</td> <td><input type="checkbox"/> Non-Routine Fracing</td> </tr> <tr> <td></td> <td><input type="checkbox"/> Casing Repair</td> <td><input type="checkbox"/> Water Shut Off</td> </tr> <tr> <td></td> <td><input type="checkbox"/> Altering Casing</td> <td><input type="checkbox"/> Conversion to Injection</td> </tr> <tr> <td></td> <td><input checked="" type="checkbox"/> Other (Set 4-1/2" Csg)</td> <td></td> </tr> </table>	Type of Submission:	Type of Action:		<input type="checkbox"/> Notice of Intent	<input type="checkbox"/> Abandonment	<input type="checkbox"/> Change of Plans	<input checked="" type="checkbox"/> Subsequent Report	<input type="checkbox"/> Recompletion	<input type="checkbox"/> New Construction:	<input type="checkbox"/> Final Abandonment	<input type="checkbox"/> Plugging Back	<input type="checkbox"/> Non-Routine Fracing		<input type="checkbox"/> Casing Repair	<input type="checkbox"/> Water Shut Off		<input type="checkbox"/> Altering Casing	<input type="checkbox"/> Conversion to Injection		<input checked="" type="checkbox"/> Other (Set 4-1/2" Csg)	
Type of Submission:	Type of Action:																					
<input type="checkbox"/> Notice of Intent	<input type="checkbox"/> Abandonment	<input type="checkbox"/> Change of Plans																				
<input checked="" type="checkbox"/> Subsequent Report	<input type="checkbox"/> Recompletion	<input type="checkbox"/> New Construction:																				
<input type="checkbox"/> Final Abandonment	<input type="checkbox"/> Plugging Back	<input type="checkbox"/> Non-Routine Fracing																				
	<input type="checkbox"/> Casing Repair	<input type="checkbox"/> Water Shut Off																				
	<input type="checkbox"/> Altering Casing	<input type="checkbox"/> Conversion to Injection																				
	<input checked="" type="checkbox"/> Other (Set 4-1/2" Csg)																					

13. Describe Proposed or Completed Operations:

1/23/02: Finished drilling 7-7/8" hole to TD 6496'. Ran 4-1/2", 11.6#, N-80 csg. & set @ 6496' w/float collar @ 6478'. Pumped 70 bbls foamed mud, 10 bbls foamed water spacer, 20 bbls foamed superflusn, 10 bbls foamed water, 1088 sx foamed cmt w/HES foamed super "H" cmt w/22# blended silicalite, 0.1% Diacel LWL, & 0.15% Versaset (used 120,000 cf N2), mixed base slurry @ 13#/gal & 1.57 cf/sx & foamed to 8.5#/gal & 2.70 cf/sx. Compressive strength of the foamed cmt is 1150 psi @ 48 hrs. Tail w/132 sx super "H" cmt w/22# blended silicalite, 0.1% Diacel LWL, & 0.15% versaset (without N2). 13#/gal & 1.57 cf/sx. Circ. 60 bbls foamed cmt through choke. WOC

14. I hereby certify that the foregoing is true and correct

Signed: *Paul M. Lippin* Title: Petroleum Engineer

Date: 3/7/02

(This space for Federal or State office use)

APPROVED BY: _____ Title: _____

DATE: MAR 13 2002

CONDITION OF APPROVAL, IF ANY:

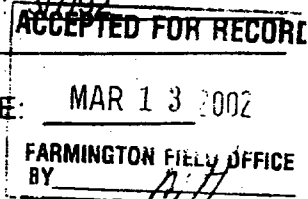

District I
1625 N. French Dr., Hobbs, NM 88240
District II
1301 W. Grand Avenue, Artesia, NM 88210
District III
1000 Rio Brazos Rd., Aztec, NM 87410
District IV
1220 S. St. Francis Dr., Santa Fe, NM 87505

State of New Mexico
Energy, Minerals & Natural Resources

Form C-104
Reformatted July 20, 2001

Oil Conservation Division
1220 South St. Francis Dr.
Santa Fe, NM 87505

Submit to Appropriate District Office
5 Copies

☐ AMENDED REPORT

I. REQUEST FOR ALLOWABLE AND AUTHORIZATION TO TRANSPORT

1 Operator name and Address MARK WEST RESOURCES 155 INNVERNESS DRIVE WEST, SUITE 200 ENGLEWOOD, CO 80112		2 OGRID Number 193195
		3 Reason for Filing Code/ Effective Date NW
4 ADE Number 30 - 045-30892	5 Pool Name BASIN DAKOTA	6 Pool Code 71599
7 Property Code	8 Property Name SCOTT FED. 27-11 23	9 Well Number 23-1

II. 10 Surface Location

11 Lot no. H	Section 23	Township 27N	Range 11W	East from the 1645'	North/South NORHT	East from the 360'	East/West line EAST	County SAN JAUN
------------------------	----------------------	------------------------	---------------------	-------------------------------	-----------------------------	------------------------------	-------------------------------	---------------------------

11 Bottom Hole Location

UL or lot no.	Section	Township	Range	Lot Idn	Feet from the	North/South line	Feet from the	East/West line	County
12 Filing Code F	13 Reasoning F	14 Case	15 C 120 Permit Number	16 C 120 Effective Date	17 C 120 Expiration Date				

III. Oil and Gas Transporters

18 Transporter OGRID	19 Transporter Name and Address	20 POD	21 O/G	22 POD ULSTR Location and Description
009018	MARK WEST RESOURCES 155 INNVERNESS DR. WEST ENGLEWOOD, CO 80112 GIANT REFINING CO. P.O. BOX 12999 SCOTTSDALE, AZ 85267	2831543	G	
		2831543	O	

IV. Produced Water

23 POD 2831543	24 POD ULSTR Location and Description
--------------------------	--

V. Well Completion Data

25 Spud Date 1/23/02	26 Ready Date 3/8/02	27 TD 6496'	28 PRTD 6478'	29 Perforations 6310'-6464'	30 DHC MC
31 Hole Size	32 Casing & Tubing Size	33 Depth Set	34 Sacks Cement		
12-1/4"	8-5/8" 23# J-55	378'	260		
7-7/8"	4-1/2" 11.6# N-80	6496'	1220		
	2-3/8" 4.7# J-55	6367'	N/A		

VI. Well Test Data

35 Date New Oil	36 Gas Delivery Date	37 Test Date	38 Test Length	39 Tbg. Pressure	40 Csg. Pressure
41 Choke Size	42 Oil	43 Water	44 Gas	45 AOF	46 Test Method

47 I hereby certify that the rules of the Oil Conservation Division have been complied with and that the information given above is true and complete to the best of my knowledge and belief.

Signature: *Paul M. Pippin*

Printed name: PAUL M. PIPPIN
505 327 4573

Title: PETROLEUM ENGINEER

Date: 3/8/02 Phone: 505-327-4573

OIL CONSERVATION DIVISION

Approved by: *[Signature]*

Title: *[Signature]*

Approval Date: *MAI 10 2002*

UNITED STATES
DEPARTMENT OF THE INTERIOR
BUREAU OF LAND MANAGEMENT

WELL COMPLETION OR RECOMPLETION REPORT AND LOG

FORM APPROVED
OMB NO. 1004-0137
Expires: November 30, 2000

1a. Type of Well ☐ Oil Well ☒ Gas Well ☐ Dry ☐ Other
b. Type of Completion: ☐ New Well ☐ Work Over ☐ Deepen ☐ Plug Back ☐ Other

2. Name of Operator **MARK WEST RESOURCES**

3. Address **155 INVERNESS DR. WEST
ENGLEWOOD, CO 80112** 3a. Phone No. (include area code) **800 730-2392**

4. Location of Well (Report location clearly and in accordance with Federal requirements)*
At surface **1645' FNL + 360' FEL**
At top prod. interval reported below **SAME**
At total depth **SAME**

5. Lease Serial No. **NMSF-078089**
6. If Indian, Allottee or Tribe Name
7. Unit or CA Agreement Name and No.
8. Lease Name and Well No. **SCOTT FED. 27-11 #23-1**
9. API Well No. **30-045-30892**
10. Field and Pool, or Exploratory **BASIN DAKOTA**
11. Sec., T., R., M., on Block and Survey or Area **23-27N-11W**
12. County or Parish **SAN JUAN** 13. State **NM**
14. Date Spudded **1-23-02** 15. Date T.D. Reached **2-3-02** 16. Date Completed ☐ D & A ☒ Ready to Prod. **3-8-02**
17. Elevations (DF, RKB, RT, GL)* **6133' GL
6145' KB**

18. Total Depth: MD **6496'** TVD **6465'** 19. Plug Back T.D.: MD **6465'** TVD **6465'** 20. Depth Bridge Plug Set: MD **6465'** TVD **6465'**

21. Type Electric & Other Mechanical Logs Run (Submit copy of each) **IND/GR, DENSITY/NEUTRON**
22. Was well cored? ☒ No ☐ Yes (Submit analysis)
Was DST run? ☒ No ☐ Yes (Submit report)
Directional Survey? ☐ No ☒ Yes (Submit copy)

23. Casing and Liner Record (Report all strings set in well)

Hole Size	Size/Grade	WT (#/ft.)	Top (MD)	Bottom (MD)	Stage Cementer Depth	No. of Sk. & Type of Cement	Slurry Vol. (BBL)	Cement Top*	Amount Pulled
12 1/4"	878 J-55	23#	0	378'	-	260	55	SURFACE	0
7 7/8"	4 1/2" N-80	11.6#	0	6496'	-	1088 W/N2 TAIL 132	525 37	SURFACE (CIRC. 60 BBL) (CAT)	0

24. Tubing Record

Size	Depth Set (MD)	Packer Depth (MD)	Size	Depth Set (MD)	Packer Depth (MD)	Size	Depth Set (MD)	Packer Depth (MD)
2 3/8"	6367'	-						

25. Producing Intervals

Formation	Top	Bottom	Perforated Interval	Size	No. Holes	Perf. Status
A) DAKOTA	6306'	6500'	6310'-6464'	0.30	28	OPEN
B)						
C)						
D)						

26. Perforation Record

27. Acid, Fracture, Treatment, Cement Squeeze, Etc.

Depth Interval	Amount and Type of Material
6310' - 6464'	1000 GAL 15% HCL ACID & 70 PERF BALLS FRAC w/ 72,000# SUPER LC 20/40 SAND IN 70 QUALITY N2 FORM

28. Production - Interval A

Date First Produced	Test Date	Hours Tested	Test Production	Oil BBL	Gas MCF	Water BBL	Oil Gravity Corr. API	Gas Gravity	Production Method
			→						

Choke Size **2 3/8"** Tbg. Press. **SI** Csg. Press. **SI** 24 Hr. Rate **→** Oil BBL **→** Gas MCF **→** Water BBL **→** Gas : Oil Ratio **→** Well Status **WAITING ON PIPELINE**

28a. Production - Interval B

Date First Produced	Test Date	Hours Tested	Test Production	Oil BBL	Gas MCF	Water BBL	Oil Gravity Corr. API	Gas Gravity	Production Method
			→						

Choke Size **2 3/8"** Tbg. Press. **SI** Csg. Press. **SI** 24 Hr. Rate **→** Oil BBL **→** Gas MCF **→** Water BBL **→** Gas : Oil Ratio **→** Well Status **→**

(See instructions and spaces for additional data on reverse side)

ACCEPTED FOR RECORD
MAR 13 2002
FARMINGTON FIELD OFFICE
BY **[Signature]**

SCOTT FED 27-11 23-1 DK

H 23 27 11

28b. Production - Interval C

Date First Produced	Test Date	Hours Tested	Test Production	Oil BBL	Gas MCF	Water BBL	Oil Gravity Corr. API	Gas Gravity	Production Method
			→						
Choke Size	Tbg. Press. Flwg. SI	Csg. Press.	24 Hr. Rate	Oil BBL	Gas MCF	Water BBL	Gas : Oil Ratio	Well Status	
			→						

28c. Production - Interval D

Date First Produced	Test Date	Hours Tested	Test Production	Oil BBL	Gas MCF	Water BBL	Oil Gravity Corr. API	Gas Gravity	Production Method
			→						
Choke Size	Tbg. Press. Flwg. SI	Csg. Press.	24 Hr. Rate	Oil BBL	Gas MCF	Water BBL	Gas : Oil Ratio	Well Status	
			→						

29. Disposition of Gas (Sold, used for fuel, vented, etc.)

WILL BE SOLD

30. Summary of Porous Zones (Include Aquifers):

Show all important zones of porosity and contents thereof: Cored intervals and all drill-stem tests, including depth interval tested, cushion used, time tool open, flowing and shut-in pressures and recoveries.

31. Formation (Log) Markers

Formation	Top	Bottom	Descriptions, Contents, etc.	Name	Top Meas. Depth
OJO ALAMO	740'	856'	SAND WATER		
KIRTLAND	856'	1505'	SHALE	KIRTLAND	856'
FRUITLAND	1505'	1837'	SAND, COAL, GAS		
PICTURED CLIFFS	1837'	2046'	SAND, GAS	PICTURED CLIFFS	1837'
MESAVERDE	3524'	4622'	SAND, WATER		
GALLUP	5376'	6015'	SAND,	GALLUP	5376'
DAKOTA	6306'		SAND, GAS	DAKOTA	6306'

32. Additional remarks (include plugging procedure):

33. Circle enclosed attachments:

1. Electrical/Mechanical Logs (1 full set req'd.) 2. Geologic Report 3. DST Report 4. Directional Survey
5. Sundry Notice for plugging and cement verification 6. Core Analysis 7. Other:

34. I hereby certify that the foregoing and attached information is complete and correct as determined from all available records (see attached instructions)*

Name (please print) PAUL M. PIPPIN Title PETROLEUM ENGINEER

Signature Paul M. Pippin Date 3/11/02

Title 18 U.S.C. Section 1001 and Title 43 U.S.C. Section 1212, make it a crime for any person knowingly and willfully to make to any department or agency of the United States any false, fictitious or fraudulent statements or representations as to any matter within its jurisdiction.

505 327 4573

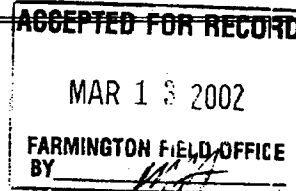

UNITED STATES
DEPARTMENT OF THE INTERIOR
BUREAU OF LAND MANAGEMENT

FORM APPROVED
OMB NO. 1004-0135
Expires: November 30, 2000

SUNDRY NOTICES AND REPORTS ON WELLS
Do not use this form for proposals to drill or to re-enter an abandoned well. Use form 3160-3 (APD) for such proposals.

SUBMIT IN TRIPLICATE - Other instructions on reverse side.

1. Type of Well <input type="checkbox"/> Oil Well <input checked="" type="checkbox"/> Gas Well <input type="checkbox"/> Other		5. Lease Serial No. NMSF-078089	
2. Name of Operator MARKWEST RESOURCES, INC		6. If Indian, Allottee or Tribe Name	
3a. Address 155 INVERNESS DRIVE WEST, SUITE 200 ENGLEWOOD, CO 80112		7. If Unit or CA/Agreement, Name and/or No.	
3b. Phone No. (include area code) Ph: 303.925.9283 Fx: 303.290.9309		8. Well Name and No. SCOTT FED 27-11 #23-1	
4. Location of Well (Footage, Sec., T., R., M., or Survey Description) Sec 23 T27N R11W SENE 1645FNL 360FEL		9. API Well No. 30-045-30892	
		10. Field and Pool, or Exploratory BASIN DAKOTA	
		11. County or Parish, and State SAN JUAN COUNTY, NM	

12. CHECK APPROPRIATE BOX(ES) TO INDICATE NATURE OF NOTICE, REPORT, OR OTHER DATA

TYPE OF SUBMISSION	TYPE OF ACTION			
<input type="checkbox"/> Notice of Intent	<input type="checkbox"/> Acidize	<input type="checkbox"/> Deepen	<input type="checkbox"/> Production (Start/Resume)	<input type="checkbox"/> Water Shut-Off
<input checked="" type="checkbox"/> Subsequent Report	<input type="checkbox"/> Alter Casing	<input type="checkbox"/> Fracture Treat	<input type="checkbox"/> Reclamation	<input type="checkbox"/> Well Integrity
<input type="checkbox"/> Final Abandonment Notice	<input type="checkbox"/> Casing Repair	<input type="checkbox"/> New Construction	<input type="checkbox"/> Recomplete	<input checked="" type="checkbox"/> Other
	<input type="checkbox"/> Change Plans	<input type="checkbox"/> Plug and Abandon	<input type="checkbox"/> Temporarily Abandon	
	<input type="checkbox"/> Convert to Injection	<input type="checkbox"/> Plug Back	<input type="checkbox"/> Water Disposal	

13. Describe Proposed or Completed Operation (clearly state all pertinent details, including estimated starting date of any proposed work and approximate duration thereof. If the proposal is to deepen directionally or recompleat horizontally, give subsurface locations and measured and true vertical depths of all pertinent markers and zones. Attach the Bond under which the work will be performed or provide the Bond No. on file with BLM/BIA. Required subsequent reports shall be filed within 30 days following completion of the involved operations. If the operation results in a multiple completion or recompleat in a new interval, a Form 3160-4 shall be filed once testing has been completed. Final Abandonment Notices shall be filed only after all requirements, including reclamation, have been completed, and the operator has determined that the site is ready for final inspection.)

Previous Sundry Notices were sent in with the incorrect API # 30-045-30842.

Please correct all your records to reflect the "Correct API #30-045-30892".

14. I hereby certify that the foregoing is true and correct. Electronic Submission #11850 verified by the BLM Well Information System For MARKWEST RESOURCES, INC, sent to the Farmington Committed to AFMSS for processing by Matthew Halbert on 06/18/2002 ()	
Name (Printed/Typed) CINDY BUSH	Title AUTHORIZED REPRESENTATIVE
Signature (Electronic Submission)	Date 06/07/2002

THIS SPACE FOR FEDERAL OR STATE OFFICE USE

Approved By _____	Title _____	Date _____
Conditions of approval, if any, are attached. Approval of this notice does not warrant or certify that the applicant holds legal or equitable title to those rights in the subject lease which would entitle the applicant to conduct operations thereon.		
Office _____		
Title 18 U.S.C. Section 1001 and Title 43 U.S.C. Section 1212, make it a crime for any person knowingly and willfully to make to any department or agency of the United States any false, fictitious or fraudulent statements or representations as to any matter within its jurisdiction.		

**** ORIGINAL ** ORIGINAL ** ORIGINAL ** ORIGINAL ** ORIGINAL ** ORIGINAL ** ORIGINAL ****

RECEIVED

District I
1625 N. French Dr., Hobbs, NM 88240
District II
811 South First, Artesia, NM 88210
District III
1000 Rio Brazos Road, Aztec, NM 87410
District IV
2040 South Pacheco, Santa Fe, NM 87505

State of New Mexico
Energy Minerals and Natural Resources

Form C-104A
August 11, 2000

Oil Conservation Division
2040 South Pacheco
Santa Fe, NM 87505

Submit 1 copy of the final affected wells
list along with 2 copies of this form per
number of wells on that list to
appropriate District Office

Change of Operator

Previous Operator Information:

OGRID: 193195
Name: MarkWest Resources, Inc.
Address: 155 Inverness Drive West
Address: Suite 200
City, State, Zip: Denver, Co 80112-5000

New Operator Information:

Effective Date: July 1, 2003
New Ogrid: 167067
New Name: XTO Energy Inc.
Address: 2700 Farmington Avenue
Address: Suite 1, Bldg. K
City, State, Zip: Farmington, NM 87401

I hereby certify that the rules of the Oil Conservation Division have been complied with and that the information on this form and the attached list of wells is true and complete to the best of my knowledge and belief.

New Operator

Signature: Edwin S. Ryan, Jr.

Printed name: EDWIN S. RYAN, JR.

Title: XTO ENERGY INC.

Date: 6-30-03 Phone: 505-564-6700



Previous operator complete below:

Previous Operator: MarkWest Resources, Inc.

Previous OGRID: 193195

Signature: F. J. Witsell

Printed Name: Fred Witsell

NMOCD Approval

Signature: [Signature]
Printed Name: SUPERVISOR DISTRICT #3

District: JUL 14 2003

Date:

District I
1625 N. French Dr., Hobbs, NM 88240
District II
811 South First, Artesia, NM 88210

District III
1000 Rio Brazos Rd., Aztec, NM 87410

District IV
1220 S. St. Francis Dr., Santa Fe, NM 87505

State of New Mexico
Energy, Minerals & Natural Resources Department

OIL CONSERVATION DIVISION

1220 South St. Francis Dr.
Santa Fe, NM 87505

Form C-102
Revised August 15, 2000

Submit to Appropriate District Office
FEB 2004
RECEIVED
OIL CONS. DIV.
DIST. 3

State Lease - 4 Copies
Fee Lease - 3 Copies

AMENDED REPORT

WELL LOCATION AND ACREAGE DEDICATION PLAT

¹ API Number 30-045-30892	² Pool Code 71599	BASIN DAKOTA
⁴ Property Code	³ Property Name SCOTT FEDERAL 27-11-23	⁶ Well Number 201
⁷ OGRID No. 167067	⁸ Operator Name XTO ENERGY INC.	⁹ Elevation 6133' GR

¹⁰ Surface Location

UL or lot no. H	Section 23	Township 27N	Range 11W	Lot Idn	Feet from the 1645	North/South line NORTH	Feet from the 360	East/West line EAST	County SAN JUAN
---------------------------	----------------------	------------------------	---------------------	---------	------------------------------	----------------------------------	-----------------------------	-------------------------------	---------------------------

¹¹ Bottom Hole Location If Different From Surface

UL or lot no.	Section	Township	Range	Lot Idn	Feet from the	North/South line	Feet from the	East/West line	County
Dedicated Acreage NW/4 144.79	¹³ Joint or Infill	¹⁴ Consolidation Code	¹⁵ Order No.						

NO ALLOWABLE WILL BE ASSIGNED TO THIS COMPLETION UNTIL ALL INTERESTS HAVE BEEN CONSOLIDATED OR A NON-STANDARD UNIT HAS BEEN APPROVED BY THE DIVISION

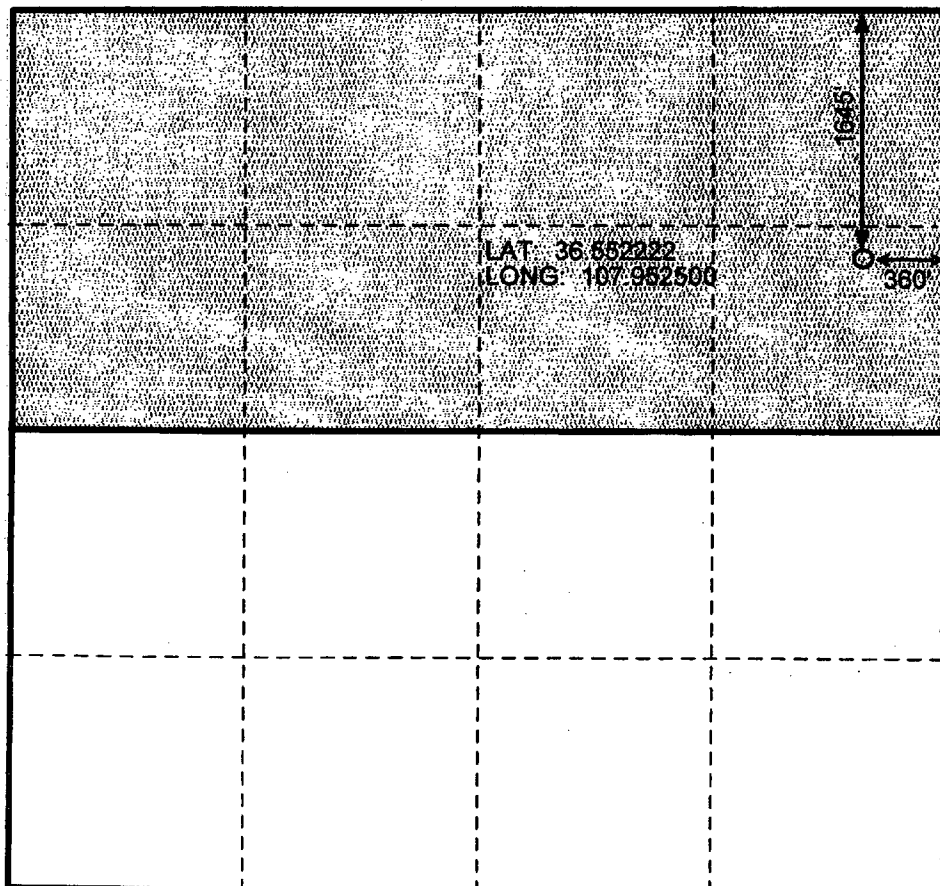

OPERATOR CERTIFICATION

I hereby certify that the information contained herein is true and complete to the best of my knowledge and belief

Holly C. Perkins
Signature

HOLLY C. PERKINS

Printed Name

REGULATORY SPECIALIST

Title

FEBRUARY 2, 2004

Date

SURVEYOR CERTIFICATION

I hereby certify that the well location shown on this plat was plotted from field notes of actual surveys made by me or under my supervision, and that the same is true and correct to the best of my belief.

JULY 11, 2001

Date of Survey

Signature and Seal of Professional Surveyor:
Original Signed by Roy A. Rush

8894

Certificate Number

CMD : ONGARD 03/08/04 15:01:09
OG6C101 C101-APPLICATION FOR PERMIT TO DRILL OGOMES -TQGW

OGRID Idn : 193195 API Well No: 30 45 31194 APD Status(A/C/P): C
Opr Name, Addr: MARKWEST RESOURCES INC Aprvl/Cncl Date : 06-26-2003
155 INVERNESS DRIVE WEST
SUITE 200
ENGLEWOOD, CO 80112-5004

Prop Idn: 29140 SCOTT FEDERAL 27 11 23 Well No: 233

	U/L	Sec	Township	Range	Lot	Idn	North/South	East/West
Surface Locn	: O	23	27N	11W			FTG 285 F S	FTG 1370 F E
OCD U/L	: O		API County	: 45				

Work typ(N/E/D/P/A) : N Well typ(O/G/M/I/S/W/C): G Cable/Rotary (C/R) : R
Lease typ(F/S/P/N/J/U/I): F Ground Level Elevation : 6440

State Lease No: Multiple Comp (S/M/C) : S
Prpsd Depth : 6775 Prpsd Frmtn : ~~BASIN DAKOTA (ABAND LOC 6-26-03)~~

E6927: Well is cancelled

PF01 HELP	PF02	PF03 EXIT	PF04 GoTo	PF05	PF06 CONFIRM
PF07	PF08	PF09 PRINT	PF10 C102	PF11 HISTORY	PF12

UNITED STATES
DEPARTMENT OF THE INTERIOR
BUREAU OF LAND MANAGEMENT

APPLICATION FOR PERMIT TO DRILL OR REENTER

FORM APPROVED
OMB No. 1004-0136
Expires November 30, 2000

RECEIVED

2002 SEP -3 PM 3:00

5. Lease Serial No.
NMSF-078089

6. If Indian, Allottee or Tribe Name

N/A

7. If Unit or CA Agreement, Name and No.

N/A

8. Lease Name and Well No.

SCOTT FEDERAL #233

9. API Well No.

30-045- 31194

10. Field and Pool, or Exploratory

BASIN DAKOTA

11. Sec., T., R., M., or Blk. and Survey or Area

023-27n-11w NMPM

12. County or Parish

SAN JUAN

13. State

NM

1a. Type of Work: ☒ DRILL ☐ REENTER

1b. Type of Well: ☐ Oil Well ☒ Gas Well ☐ Other ☒ Single Zone ☐ Multiple Zone

2. Name of Operator

MARKWEST RESOURCES, INC.

3a. Address **155 INVERNESS DR., SUITE 200
ENGLEWOOD, CO. 80112**

3b. Phone No. (include area code)
(303) 290-8700

4. Location of Well (Report location clearly and in accordance with any State requirements)

At surface **285' FSL & 1370' FEL**

At proposed prod. zone **SAME**

14. Distance in miles and direction from nearest town or post office*

11 AIR MILES S OF BLOOMFIELD

5. Distance from proposed*
location to nearest
property or lease line, ft.

285'

16. No. of Acres in lease

2,500

17. Spacing Unit dedicated to this well

320 ACRES (E2)

18. Distance from proposed location*
to nearest well, drilling, completed,
applied for, on this lease, ft.

741'

19. Proposed Depth

6,775'

20. BLM/BIA Bond No. on file

KA6084 (BLM - NATIONWIDE)

21. Elevations (Show whether DF, KDB, RT, GL, etc.)

6,440' GL

22. Approximate date work will start*

JANUARY 6, 2003

23. Estimated duration

3 WEEKS

24. Attachments

The following, completed in accordance with the requirements of Onshore Oil and Gas Order No. 1, shall be attached to this form:

1. Well plat certified by a registered surveyor.
2. A Drilling Plan.
3. A Surface Use Plan (if the location is on National Forest System Lands, the SUPO shall be filed with the appropriate Forest Service Office).

4. Bond to cover the operations unless covered by an existing bond on file (see Item 20 above).
5. Operator certification.
6. Such other site specific information and/or plans as may be required by the authorized officer.

Comments

On site inspector: Roger Herrera
Archaeology report: CASA 02-83 (dated 8-8-02)

DRILLING OPERATIONS AUTHORIZED ARE
SUBJECT TO COMPLIANCE WITH ATTACHED
"GENERAL REQUIREMENTS".

This action is subject to technical and
procedural review pursuant to 43 CFR 3165.3
and appeal pursuant to 43 CFR 3165.4

cc:BLM (&OCD), Pippin, Stowe

25. Signature

[Signature]

Name (Printed/Typed)

BRIAN WOOD

Date

8-17-02

Title

CONSULTANT

PHONE: 505 466-8120

FAX: 505 466-9682

Approved by (Signature)

[Signature]
David J. Monklewicz

Name (Printed/Typed)

Date

MAR 12 2003

Title

Office

Application approval does not warrant or certify the the applicant holds legal or equitable title to those rights in the subject lease which would entitle the applicant to conduct operations thereon.

Conditions of approval, if any, are attached.

Title 18 U.S.C. Section 1001 and Title 43 U.S.C. Section 1212, make it a crime for any person knowingly and willfully to make to any department or agency of the United States any false, fictitious or fraudulent statements or representations as to any matter within its jurisdiction.

HOLD C104 FOR *NLS*

WMOCD

DISTRICT I
1635 N. French Dr., Hobbs, N.M. 88240

DISTRICT II
811 South First, Artesia, N.M. 88210

DISTRICT III
1000 Rio Brazos Rd., Aztec, N.M. 87410

DISTRICT IV
2040 South Pacheco, Santa Fe, NM 87505

State of New Mexico
Energy, Minerals & Natural Resources Department

Form C-102
Revised August 15, 2000

Submit to Appropriate District Office
State Lease - 4 Copies
Fee Lease - 3 Copies

OIL CONSERVATION DIVISION
2040 South Pacheco
Santa Fe, NM 87505

☐ AMENDED REPORT

WELL LOCATION AND ACREAGE DEDICATION PLAT

¹ API Number 30-045-31194	² Pool Code 71599	³ Pool Name BASIN DAKOTA
⁴ Property Code 29140	⁵ Property Name SCOTT FEDERAL	⁶ Well Number 233
⁷ OGED No. 193195	⁸ Operator Name MARKWEST RESOURCES, INC.	⁹ Elevation 6440'

¹⁰ Surface Location

UL or lot no.	Section	Township	Range	Lot Idn	Feet from the	North/South line	Feet from the	East/West line	County
0	23	27-N.	11-W		285'	SOUTH	1370'	EAST	SAN JUAN

¹¹ Bottom Hole Location If Different From Surface

UL or lot no.	Section	Township	Range	Lot Idn	Feet from the	North/South line	Feet from the	East/West line	County
¹² Dedicated Acres 320			¹³ Joint or Infill		¹⁴ Consolidation Code		¹⁵ Order No.		

NO ALLOWABLE WILL BE ASSIGNED TO THIS COMPLETION UNTIL ALL INTERESTS HAVE BEEN CONSOLIDATED
OR A NON-STANDARD UNIT HAS BEEN APPROVED BY THE DIVISION

<div>16</div>	<div>17 OPERATOR CERTIFICATION</div> <p>I hereby certify that the information contained herein is true and complete to the best of my knowledge and belief.</p> <p>Signature: <u>Brian Wood</u></p> <p>Printed Name: <u>BRIAN WOOD</u></p> <p>Title: <u>CONSULTANT</u></p> <p>Date: <u>AUG. 26, 2002</u></p>
	<div>18 SURVEYOR CERTIFICATION</div> <p>I hereby certify that the well location shown on this plat was plotted from field notes of actual surveys made by me or under my supervision, and that the same is true and correct to the best of my belief.</p> <p>Date of Survey: <u>JUN 26 2002</u></p> <p>Signature and Seal of Professional Surveyor: <u>DAVID A. JOHNSON</u></p> <p>Certificate Number: <u>14827</u></p>

RECEIVED
FD 2 1/2" GLO BC 1913
2002 SEP - 3 PM 3:20
070 FARMINGTON, NM

FD 2 1/2" GLO BC 1913
S 89-54-58 W 5281.6'
1271'
1032'
1370'
285'
49'
N 00-04-23 W 2633.4'

UNITED STATES
DEPARTMENT OF THE INTERIOR
BUREAU OF LAND MANAGEMENT

FORM APPROVED
OMB NO. 1004-0135
Expires: November 30, 2000

SUNDRY NOTICES AND REPORTS ON WELLS
Do not use this form for proposals to drill or to re-enter an abandoned well. Use form 3160-3 (APD) for such proposals.

SUBMIT IN TRIPLICATE - Other instructions on reverse side.

5. Lease Serial No. NMSF078089
6. If Indian, Allottee or Tribe Name
7. If Unit or CA/Agreement, Name and/or No.
8. Well Name and No. SCOTT FEDERAL 233
9. API Well No. 30-045-31194-00-X1
10. Field and Pool, or Exploratory BASIN DAKOTA
11. County or Parish, and State SAN JUAN COUNTY, NM

1. Type of Well <input type="checkbox"/> Oil Well <input checked="" type="checkbox"/> Gas Well <input type="checkbox"/> Other	
2. Name of Operator MARKWEST RESOURCES INC	Contact: CINDY BUSH E-Mail: cbush@markwest.com
3a. Address 155 INVERNESS DRIVE WEST ENGLEWOOD, CO 80111	3b. Phone No. (include area code) Ph: 303.925.9283 Fx: 303.290.9309
4. Location of Well (Footage, Sec., T., R., M., or Survey Description) Sec 23 T27N R11W SWSE 285FSL 1370FEL	

12. CHECK APPROPRIATE BOX(ES) TO INDICATE NATURE OF NOTICE, REPORT, OR OTHER DATA

TYPE OF SUBMISSION	TYPE OF ACTION			
<input checked="" type="checkbox"/> Notice of Intent	<input type="checkbox"/> Acidize	<input type="checkbox"/> Deepen	<input type="checkbox"/> Production (Start/Resume)	<input type="checkbox"/> Water Shut-Off
<input type="checkbox"/> Subsequent Report	<input type="checkbox"/> Alter Casing	<input type="checkbox"/> Fracture Treat	<input type="checkbox"/> Reclamation	<input type="checkbox"/> Well Integrity
<input type="checkbox"/> Final Abandonment Notice	<input type="checkbox"/> Casing Repair	<input type="checkbox"/> New Construction	<input type="checkbox"/> Recomplete	<input checked="" type="checkbox"/> Other Change to Original A PD
	<input type="checkbox"/> Change Plans	<input type="checkbox"/> Plug and Abandon	<input type="checkbox"/> Temporarily Abandon	
	<input type="checkbox"/> Convert to Injection	<input type="checkbox"/> Plug Back	<input type="checkbox"/> Water Disposal	

13. Describe Proposed or Completed Operation (clearly state all pertinent details, including estimated starting date of any proposed work and approximate duration thereof. If the proposal is to deepen directionally or recompleat horizontally, give subsurface locations and measured and true vertical depths of all pertinent markers and zones. Attach the Bond under which the work will be performed or provide the Bond No. on file with BLM/BIA. Required subsequent reports shall be filed within 30 days following completion of the involved operations. If the operation results in a multiple completion or recompleat in a new interval, a Form 3160-4 shall be filed once testing has been completed. Final Abandonment Notices shall be filed only after all requirements, including reclamation, have been completed, and the operator has determined that the site is ready for final inspection.)

MarkWest Resources Inc, will not be drilling this well, please withdraw the Application to Drill.

14. I hereby certify that the foregoing is true and correct. Electronic Submission #23594 verified by the BLM Well Information System For MARKWEST RESOURCES INC, sent to the Farmington Committed to AFMSS for processing by Adrienne Garcia on 06/26/2003 (03AXG1451SE)	
Name (Printed/Typed) CINDY BUSH	Title AUTHORIZED REPRESENTATIVE
Signature (Electronic Submission)	Date 06/24/2003

THIS SPACE FOR FEDERAL OR STATE OFFICE USE

Approved By JIM LOVATO	Title PETROLEUM ENGINEER	Date 06/26/2003
Conditions of approval, if any, are attached. Approval of this notice does not warrant or certify that the applicant holds legal or equitable title to those rights in the subject lease which would entitle the applicant to conduct operations thereon.		Office Farmington

Title 18 U.S.C. Section 1001 and Title 43 U.S.C. Section 1212, make it a crime for any person knowingly and willfully to make to any department or agency of the United States any false, fictitious or fraudulent statements or representations as to any matter within its jurisdiction.

**** BLM REVISED ** BLM REVISED ** BLM REVISED ** BLM REVISED ** BLM REVISED ****

UNITED STATES
DEPARTMENT OF THE INTERIOR
BUREAU OF LAND MANAGEMENTFORM APPROVED
OMB NO. 1004-0135
Expires: November 30, 2000**SUNDRY NOTICES AND REPORTS ON WELLS**
*Do not use this form for proposals to drill or to re-enter an abandoned well. Use form 3160-3 (APD) for such proposals.*5. Lease Serial No.
NMSF078089

6. If Indian, Allottee or Tribe Name

7. If Unit or CA/Agreement, Name and/or No.

SUBMIT IN TRIPLICATE - Other instructions on reverse side.

1. Type of Well

☐ Oil Well ☒ Gas Well ☐ Other2. Name of Operator
MARKWEST RESOURCES INCContact: CINDY BUSH
E-Mail: cbush@markwest.com8. Well Name and No.
SCOTT FEDERAL 2339. API Well No.
30-045-31194-00-X13a. Address
155 INVERNESS DRIVE WEST
ENGLEWOOD, CO 801113b. Phone No. (include area code)
Ph: 303.925.9283
Fx: 303.290.930910. Field and Pool, or Exploratory
BASIN DAKOTA

4. Location of Well (Footage, Sec., T., R., M., or Survey Description)

Sec 23 T27N R11W SWSE 285FSL 1370FEL

11. County or Parish, and State
SAN JUAN COUNTY, NM**12. CHECK APPROPRIATE BOX(ES) TO INDICATE NATURE OF NOTICE, REPORT, OR OTHER DATA**

TYPE OF SUBMISSION	TYPE OF ACTION			
<input type="checkbox"/> Notice of Intent	<input type="checkbox"/> Acidize	<input type="checkbox"/> Deepen	<input type="checkbox"/> Production (Start/Resume)	<input type="checkbox"/> Water Shut-Off
<input checked="" type="checkbox"/> Subsequent Report	<input type="checkbox"/> Alter Casing	<input type="checkbox"/> Fracture Treat	<input type="checkbox"/> Reclamation	<input type="checkbox"/> Well Integrity
<input type="checkbox"/> Final Abandonment Notice	<input type="checkbox"/> Casing Repair	<input type="checkbox"/> New Construction	<input type="checkbox"/> Recomplete	<input checked="" type="checkbox"/> Other
	<input type="checkbox"/> Change Plans	<input type="checkbox"/> Plug and Abandon	<input type="checkbox"/> Temporarily Abandon	
	<input type="checkbox"/> Convert to Injection	<input type="checkbox"/> Plug Back	<input type="checkbox"/> Water Disposal	

13. Describe Proposed or Completed Operation (clearly state all pertinent details, including estimated starting date of any proposed work and approximate duration thereof. If the proposal is to deepen directionally or recompleat horizontally, give subsurface locations and measured and true vertical depths of all pertinent markers and zones. Attach the Bond under which the work will be performed or provide the Bond No. on file with BLM/BIA. Required subsequent reports shall be filed within 30 days following completion of the involved operations. If the operation results in a multiple completion or recompleat in a new interval, a Form 3160-4 shall be filed once testing has been completed. Final Abandonment Notices shall be filed only after all requirements, including reclamation, have been completed, and the operator has determined that the site is ready for final inspection.)

MarkWest Resources Inc, will not be drilling this well, please withdraw the Application to Drill.



14. I hereby certify that the foregoing is true and correct.

Electronic Submission #23594 verified by the BLM Well Information System
For MARKWEST RESOURCES INC, sent to the Farmington
Committed to AFMSS for processing by Adrienne Garcia on 06/26/2003 (03AXG1451SE)

Name (Printed/Typed) CINDY BUSH

Title AUTHORIZED REPRESENTATIVE

Signature (Electronic Submission)

Date 06/24/2003

THIS SPACE FOR FEDERAL OR STATE OFFICE USE

Approved By

/s/ Jim Lovato

Title

JUN 26 2003
Date

Conditions of approval, if any, are attached. Approval of this notice does not warrant or certify that the applicant holds legal or equitable title to those rights in the subject lease which would entitle the applicant to conduct operations thereon.

Office

Title 18 U.S.C. Section 1001 and Title 43 U.S.C. Section 1212, make it a crime for any person knowingly and willfully to make to any department or agency of the United States any false, fictitious or fraudulent statements or representations as to any matter within its jurisdiction.

**** BLM REVISED ** BLM REVISED ** BLM REVISED ** BLM REVISED ** BLM REVISED ******NMOCD**

District I
1625 N. French Dr., Hobbs, NM 88240
District II
811 South First, Artesia, NM 88210
District III
1000 Rio Brazos Road, Aztec, NM 87410
District IV
2040 South Pacheco, Santa Fe, NM 87505

State of New Mexico
Energy Minerals and Natural Resources

Form C-104A
August 11, 2000

Oil Conservation Division
2040 South Pacheco
Santa Fe, NM 87505

Submit 1 copy of the final affected wells
list along with 2 copies of this form per
number of wells on that list to
appropriate District Office

Change of Operator

Previous Operator Information:

OGRID: 193195
Name: MarkWest Resources, Inc.
Address: 155 Inverness Drive West
Address: Suite 200
City, State, Zip: Denver, Co 80112-5000

New Operator Information:

Effective Date: July 1, 2003
New Ogrid: 167067
New Name: XTO Energy Inc.
Address: 2700 Farmington Avenue
Address: Suite 1, Bldg.K
City, State, Zip: Farmington, NM 87401

I hereby certify that the rules of the Oil Conservation Division have been complied with and that the information on this form and the attached list of wells is true and complete to the best of my knowledge and belief.

New Operator

Signature: Edwin S. Ryan, Jr.

Printed name: EDWIN S. RYAN, JR.

Title: XTO ENERGY INC.

Date: 6-30-03

Phone: 505-564-6700

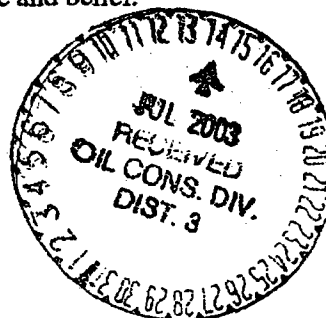

Previous operator complete below:

Previous Operator: MarkWest Resources, Inc.

Previous OGRID: 193195

Signature: F. J. Witsell

Printed

Name: Fred Witsell

NMOCD Approval

Signature: [Signature]

Printed

Name: SUPERVISOR DISTRICT #3

District: JUL 14 2003

Date:

Well No : 005
GL Elevation: 6396

	U/L	Sec	Township	Range	North/South	East/West	Prop/Act (P/A)
	---	---	---	---	-----	-----	-----
B.H. Locn	:	K 23	27N	11W	FTG 1450 F S	FTG 1850 F W	
Lot Identifier:							
Dedicated Acre:							
Lease Type	:	F					
Type of consolidation (Comm, Unit, Forced Pooling - C/U/F/O)	:						

```
PF01  HELP          PF02          PF03  EXIT          PF04  GoTo          PF05          PF06
PF07          PF08          PF09          PF10  NEXT-WC    PF11  HISTORY    PF12  NXTREC
```

5-USGS

1-WU

1-D

1-F

(SUBMIT IN TRIPLICATE)

UNITED STATES
DEPARTMENT OF THE INTERIOR
GEOLOGICAL SURVEY

Budget Bureau No. 42-R358.4
Approval expires 12-31-60.

Land Office

Lease No. SF-078089

Unit

Hancock Federal

RECEIVED

SUNDRY NOTICES AND REPORTS ON WELLS JAN 2 1962

NOTICE OF INTENTION TO DRILL.....XX	SUBSEQUENT REPORT OF WATER SHUT-OFF.....CON. COM.
NOTICE OF INTENTION TO CHANGE PLANS.....	SUBSEQUENT REPORT OF SHOOTING OR ACIDIZING.....DIST. S
NOTICE OF INTENTION TO TEST WATER SHUT-OFF.....	SUBSEQUENT REPORT OF ALTERING CASING.....
NOTICE OF INTENTION TO RE-DRILL OR REPAIR WELL.....	SUBSEQUENT REPORT OF RE-DRILLING OR REPAIR.....
NOTICE OF INTENTION TO SHOOT OR ACIDIZE.....	SUBSEQUENT REPORT OF ABANDONMENT.....
NOTICE OF INTENTION TO PULL OR ALTER CASING.....	SUPPLEMENTARY WELL HISTORY.....
NOTICE OF INTENTION TO ABANDON WELL.....	

(INDICATE ABOVE BY CHECK MARK NATURE OF REPORT, NOTICE, OR OTHER DATA)

December 27, 1961

Well No. 5 is located 1450 ft. from N line and 1850 ft. from W line of sec. 23

NE/4 Sec. 23
(1/4 Sec. and Sec. No.)

27N
(Twp.)

11E
(Range)

NMPN
(Meridian)

Basin Dakota
(Field)

San Juan
(County or Subdivision)

New Mexico
(State or Territory)

The elevation of the derrick floor above sea level is 6396 ft. G.L.

DETAILS OF WORK

(State names of and expected depths to objective sands; show sizes, weights, and lengths of proposed casings; indicate mudding jobs, cementing points, and all other important proposed work)

Propose to drill with rotary tools to an approximate depth of 1750 feet or to test the Dakota formation. Casing program will be as follows:

10 3/4" 32.75# surface casing set at approximately 200 feet with 150 sx cement.
4 1/2" 10.50# set at total depth with 450 sx cement or cement to cover the Gallup formation.

A 2W tool will be placed for the protection of the Pictured Cliffs formation.

Will perforate and sand water frac the Dakota formation.

I understand that this plan of work must receive approval in writing by the Geological Survey before operations may be commenced.

Company Southwest Production Company

Address 207 Petr. Club Plaza

Farmington, New Mexico

By

Title Assistant Supt.

NEW MEXICO OIL CONSERVATION COMMISSION

Well Location and Acreage Dedication Plat

Section A.

Date 12/27/61

Operator SOUTHWEST PRODUCTION COMPANY Lease Hantock Federal SF-078009
 Well No. 5 Unit Letter K Section 23 Township 27 NORTH Range 11 WEST, NMPM
 Located 1450 Feet From the SOUTH Line 1850 Feet From the WEST Line
 County SAN JUAN G. L. Elevation 6396.0 Dedicated Acreage 3/320 Acres
 Name of Producing Formation Dakota Pool Basin Dakota

1. Is the Operator the only owner in the dedicated acreage outlined on the plat below?
 Yes X No _____
2. If the answer to question one is "no", have the interests of all the owners been consolidated by communitization agreement or otherwise? Yes _____ No _____. If answer is "yes", Type of Consolidation _____

3. If the answer to question two is "no", list all the owners and their respective interests below:

Owner

Land Description



Section B.

This is to certify that the information in Section A above is true and complete to the best of my knowledge and belief.

Southwest Production Company

(Operator)

(Representative)

207 Petr. Club Plaza

(Address)

Farmington, N. M.

Ref: GLO plat dated 19 July 1915

Note: All distances must be from outer boundaries of section.

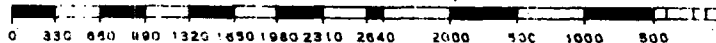
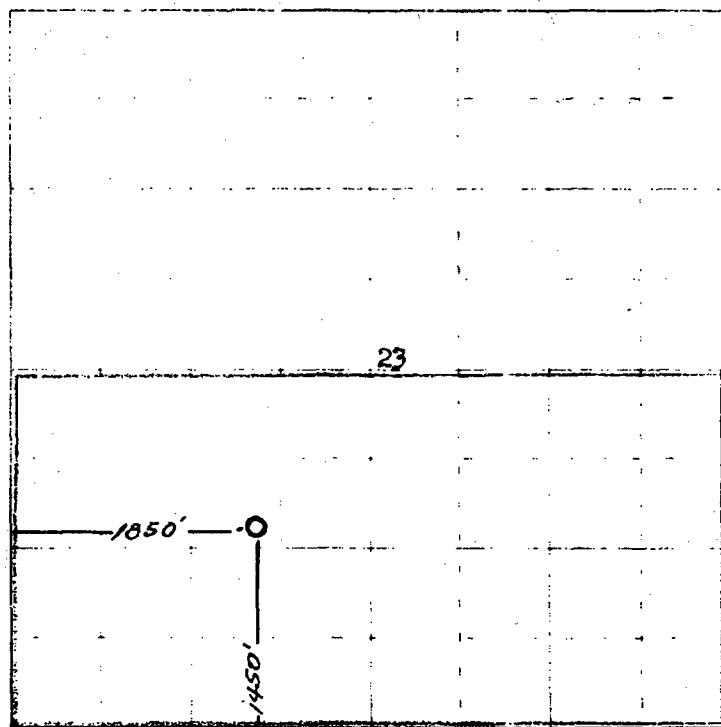

Scale 4 inches equal 1 mile

This is to certify that the above plat was prepared from field notes of actual surveys made by me or under my supervision and that the same are true and correct to the best of my knowledge and belief.

Date Surveyed 20 December 1961

James P. Leese
 Registered Professional Engineer and/or Land Surveyor
 San Juan Engineering Company
 James P. Leese N. Mex. Reg. No. 1463

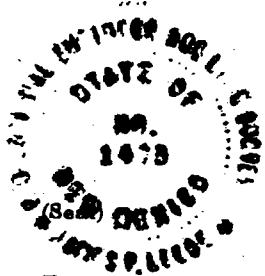

Farmington, New Mexico

4-UBGS
1-WD
1-D
1-F

Form 9-881a
(Feb. 1961)

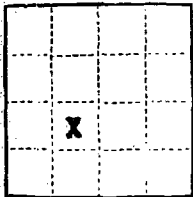

(SUBMIT IN TRIPLICATE)

UNITED STATES
DEPARTMENT OF THE INTERIOR
GEOLOGICAL SURVEY

SWP-95

Budget Bureau No. 42-R558.1
Appl. expires 12-31-60.

Land Office

Lease No. **SF-078089**

Unit

Hancock Federal



SUNDRY NOTICES AND REPORTS ON WELLS JAN 11 1962

NOTICE OF INTENTION TO DRILL.....	SUBSEQUENT REPORT OF WATER SHUT-OFF.....
NOTICE OF INTENTION TO CHANGE PLANS.....	SUBSEQUENT REPORT OF SHOOTING OR ACIDIZING.....
NOTICE OF INTENTION TO TEST WATER SHUT-OFF.....	SUBSEQUENT REPORT OF ALTERING CASING.....
NOTICE OF INTENTION TO RE-DRILL OR REPAIR WELL.....	SUBSEQUENT REPORT OF RE-DRILLING OR REPAIR.....
NOTICE OF INTENTION TO SHOOT OR ACIDIZE.....	SUBSEQUENT REPORT OF ABANDONMENT.....
NOTICE OF INTENTION TO PULL OR ALTER CASING.....	SUPPLEMENTARY WELL HISTORY.....
NOTICE OF INTENTION TO ABANDON WELL.....	

(INDICATE ABOVE BY CHECK MARK NATURE OF REPORT, NOTICE, OR OTHER DATA)

1-8-62, 19

Well No. **5** is located **1450** ft. from **N** line and **1850** ft. from **E** line of sec. **23**

NE/4 SW/4 Sec. 23
(1/4 Sec. and Sec. No.)

27N
(Twp.)

11W
(Range)

NMPM
(Meridian)

Basin Dakota
(Field)

San Juan
(County or Subdivision)

New Mexico
(State or Territory)

The elevation of the derrick floor above sea level is **6396** ft. **G.L.**

DETAILS OF WORK

(State names of and expected depths to objective sands; show sizes, weights, and lengths of proposed casings; indicate mudding jobs, cementing points, and all other important proposed work)

- 1-3-62 - Spudded in 13 3/4" surface hole. Ran & Set 8 jts. (205')
10 3/4" surface casing 32.75# Lone Star set @ 193' w/150
sx HA-5 2% gel, plug down @ 2:00 AM.
1-6-62 - WOC 10 hrs. Pressure test w/750# for 30 minutes, held O.K.
Drilling.

I understand that this plan of work must receive approval in writing by the Geological Survey before operations may be commenced.

Company **Southwest Production Company**

Address **207 Petr. Club Plaza**

Farmington, New Mexico

Original signed at
Carl W. Smith

By

Title **Superintendent**

NEW MEXICO OIL CONSERVATION COMMISSION
SANTA FE, NEW MEXICO

Form C-110
Revised 7/1/55

(File the original and 4 copies with the appropriate district office)

CERTIFICATE OF COMPLIANCE AND AUTHORIZATION
TO TRANSPORT OIL AND NATURAL GAS

Company or Operator Southwest Production Company Lease Hancock Federal

Well No. 5 Unit Letter K S 23 T 27NR 11W Pool Basin-Dakota

County San Juan Kind of Lease (State, Fed. or Patented) Fed. SF-078089

If well produces oil or condensate, give location of tanks: Unit K S 23 T 27N R 11W

Authorized Transporter of Oil or Condensate McWood Corporation

Address 364 Petr. Building, Abilene, Texas
(Give address to which approved copy of this form is to be sent)

Authorized Transporter of Gas El Paso Natural Gas Company

Address P. O. Box 990, Farmington, New Mexico Date Connected _____
(Give address to which approved copy of this form is to be sent)

If Gas is not being sold, give reasons and also explain its present disposition:

Waiting on pipeline connection

Reasons for Filing: (Please check proper box) New Well (x)

Change in Transporter of (Check One): Oil () Dry Gas () C'head () Condensate ()

Change in Ownership () Other ()

Remarks: (Give explanation below)



The undersigned certifies that the Rules and Regulations of the Oil Conservation Commission have been complied with.

Executed this the 12th day of February 19 62

By Original signed By Carl W. Smith

Approved FEB 14 1962 19 62

Title Superintendent

OIL CONSERVATION COMMISSION
Original Signed By
By A. R. KENDRICK

Company Southwest Production Company

Address 207 Petr. Club Plaza

Title PERMIT ENGINEER DIST. NO. 3

Farmington, New Mexico

NEW MEXICO OIL CONSERVATION COMMISSION
Santa Fe, New Mexico(Form C-104)
Revised 7/1/57REQUEST FOR ~~WELL~~ - (GAS) ALLOWABLENew Well
~~RECEIVED~~

This form shall be submitted by the operator before an initial allowable will be assigned to any completed Oil or Gas well. Form C-104 is to be submitted in QUADRUPLICATE to the same District Office to which Form C-101 was sent. The allowable will be assigned effective 7:00 A.M. on date of completion or recompletion, provided this form is filed during calendar month of completion or recompletion. The completion date shall be that date in the case of an oil well when new oil is delivered into the stock tanks. Gas must be reported on 15.025 psia at 60° Fahrenheit.

Farmington, New Mexico 2/13/62
(Place) (Date)

WE ARE HEREBY REQUESTING AN ALLOWABLE FOR A WELL KNOWN AS:

Southwest Production Co. Hancock Federal, Well No. 5, in NE 1/4 SW 1/4
(Company or Operator) (Lease)K, Sec. 23, T. 27N, R. 11W, NMPM, Basin-Dakota, Pool
Unit Letter

San Juan

County. Date Spudded 1/6/62 Date Drilling Completed 1/18/62
Elevation 6396' G.L. Total Depth 6740 PROD CO 6665

Please indicate location:

D	C	B	A
E	F	G	H
L	K	J	I
M	N	O	P

Top Oil/Gas Pay 6615 Name of Prod. Form. Dakota

PRODUCING INTERVAL -

Perforations 6615-33 w/ 4BPF
Open Hole Depth Casing Shoe Depth Tubing 6627

OIL WELL TEST -

Natural Prod. Test: bbls. oil, bbls. water, hrs, Choke Size

Test After Acid or Fracture Treatment (after recovery of volume of oil equal to volume of load oil used): bbls. oil, bbls. water in hrs, min. Choke Size

GAS WELL TEST -

Natural Prod. Test: MCF/Day; Hours flowed Choke Size

Tubing, Casing and Cementing Record

Size	Feet	S&W
10 3/4" @	193	150
4 1/2" @	6739	425
1 1/2" tbg. @	6627	

Method of Testing (pitot, back pressure, etc.):

Test After Acid or Fracture Treatment: 3913 MCF/Day; Hours flowed 3

Choke Size 3/4" Method of Testing: Choke

Acid or Fracture Treatment (Give amounts of materials used, such as acid, water, oil, and sand): 40,000# 20-40 sd 35,000 gds. gelled wtr.

Casing Tubing Date first new Press. 1227 Press. 313 oil run to tanks

Oil Transporter

Gas Transporter El Paso Natural Gas Company

Remarks:

I hereby certify that the information given above is true and complete to the best of my knowledge.

Approved FEB 11 1962, 19

Southwest Production Company

(Company or Operator)

Original signed By

By: Carl W. Smith

(Signature)

OIL CONSERVATION COMMISSION

Original Signed By

By: A. R. KENDRICK

Title PETROLEUM ENGINEER DIST. NO. 3

Title Superintendent

Send Communications regarding well to:

Name Southwest Production Company

Address 207 Petr. Club Plaza, Farmington, N.M.

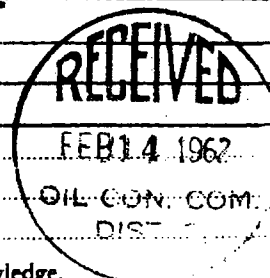

Budget Bureau No. 12-RMA
Approval symbol 3-21-60
U. S. LAND OFFICE 541-95
SERIAL NUMBER SE-078089
LEASE OR PERMIT TO PROSPECT

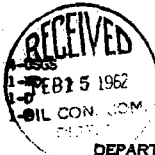

UNITED STATES
DEPARTMENT OF THE INTERIOR
GEOLOGICAL SURVEY

LOG OF OIL OR GAS WELL

LOCATE WELL CORRECTLY

Company Southwest Production Company Address 207 Petr. Club Plaza, Farmington, N.M.
Lessor or Tract Hancock Federal Field San Juan State New Mexico
Well No. 5 Sec. 23 T. 27N R. 11W Meridian TSPM County San Juan
Location 1430 ft. N. of S. Line and 1850 ft. E. of A. Line of Section 23 Elevation 6396 G.L.
(County Seat, Section 16 and 36)

The information given herewith is a complete and correct record of the well and all work done thereon
so far as can be determined from all available records. Original signed by
Signed Carl W. Smith

Date February 12, 1962 Title Superintendent

The summary on this page is for the condition of the well at above date.

Commenced drilling January 6, 1962 Finished drilling January 16, 1962

XXX OR GAS SANDS OR ZONES
(Denote gas by G)

No. 1, from 661' to 33 No. 4, from to
No. 2, from to No. 5, from to
No. 3, from to No. 6, from to

IMPORTANT WATER SANDS

No. 1, from to No. 3, from to
No. 2, from to No. 4, from to

CASING RECORD

Size casing	Weight per foot	Threads per foot	Make	Amount	Kind of shoe	Cut and pulled from	Corroded		Purpose
							From	To	
10 3/4"	22.75	100	100	200'					Surface
4 1/2"	10.50	100	100	573'			6415	6613	Production
1 1/2"	non-spare	the landed a 5627'	KB	1/28/62					

MUDDING AND CEMENTING RECORD

Size casing	Where set	Number sacks of cement	Method used	Mud gravity	Amount of mud used
10 3/4"	193' KB	150	BA-5 2% gel pump plug		
4 1/2"	6739' KB	1st stage w/ 200	50/50 peroxide 4% gel, 100	ex best w/ 1%	
		halad 2% plug down 11:20 p.m.	2nd stage w/ 125	ex 50/50	
		peroxide 4% gel, plug down 6 11:43 p.m.	18th	1W tool at 2265	

PLUGS AND ADAPTERS

Heaving plug—Material Length Depth set
Adapters—Material Size

SHOOTING RECORD

Size	Shell used	Explosive used	Quantity	Date	Depth shot	Depth cleaned out

TOOLS USED

Rotary tools were used from -0- feet to 6740 feet, and from feet to feet
Cable tools were used from feet to feet, and from feet to feet

DATES

Tested 2/1, 1962 Put to producing , 19

The production for the first 24 hours was barrels of fluid of which % was oil; %
emulsion; % water; and % sediment. Gravity, °Bé.

If gas well, cu. ft. per 24 hours 3,912 MCF Gallons gasoline per 1,000 cu. ft. of gas
Rock pressure, lbs. per sq. in. 5,337 AOF, SICP < TP 2022# After 8 days
3 hr. flowing pressure, tbq. 313# csg. 1227#

EMPLOYEES

Ira Armstrong, Driller S. H. Roberson, Driller
C. B. Cagle, Driller , Driller

FORMATION RECORD

FROM-	TO-	TOTAL FEET	FORMATION
			Electric Log Tops:
			Pictured Cliffs 2042
			Lewis 2234
			Cliff House 2960
			Point Lookout 4450
			Mancos 4712
			Gallup 5597
			Greenhorn 6450
			Graneros 6505
			Dakota 6613
			T.D. 6740'
			C.O.T.D. 6665'

[illegible]

16-43004-3 U. S. GOVERNMENT PRINTING OFFICE

It is of the greatest importance to have a complete history of the well. Please state in detail the dates of redrilling, together with the reasons for the work and its results. If there were any changes made in the casing, state fully, and if any casing was "sidetracked" or left in the well, give its size and location. If the well has been dynamited, give date, size, position, and number of shots. If plugs or bridges were put in to test for water, state kind of material used, position, and results of pumping or bailing.

CO4 M- 2004
Vol. 2 - 2004

817752

4-USGS

1-WD

1-D

1-F

Form 9-331a
(Feb. 1951)

SWP-95

Budget Bureau No. 42-65584
Approval expires 12-31-60.

(SUBMIT IN TRIPLICATE)

UNITED STATES
DEPARTMENT OF THE INTERIOR
GEOLOGICAL SURVEY

Land Office

Lease No **SF-078089**

Unit

Hancock Federal

SUNDRY NOTICES AND REPORTS ON WELLS

NOTICE OF INTENTION TO DRILL	SUBSEQUENT REPORT OF WATER SHUT-OFF	
NOTICE OF INTENTION TO CHANGE PLANS	SUBSEQUENT REPORT OF SHOOTING OR ACIDIZING	
NOTICE OF INTENTION TO TEST WATER SHUT-OFF	SUBSEQUENT REPORT OF ALTERING CASING	
NOTICE OF INTENTION TO RE-DRILL OR REPAIR WELL	SUBSEQUENT REPORT OF RE-DRILLING OR REPAIR	
NOTICE OF INTENTION TO SHOOT OR ACIDIZE	SUBSEQUENT REPORT OF ABANDONMENT	
NOTICE OF INTENTION TO PULL OR ALTER CASING	SUPPLEMENTARY WELL HISTORY	X
NOTICE OF INTENTION TO ABANDON WELL		

(INDICATE ABOVE BY CHECK MARK NATURE OF REPORT, NOTICE, OR OTHER DATA)

February 12, 1962

Well No. **5** is located **1450** ft. from **N** line and **1850** ft. from **W** line of sec. **23****NELSW** Sec. **23**
(1/2 Sec. and 1/2 Sec. No.)**27N**
(Twp.)**11W**
(Range)**10WPM**
(Meridian)**Basin-Dakota**
(Field)**San Juan**
(County or Subdivision)**New Mexico**
(State or Territory)The elevation of the derrick floor above sea level is **6396** ft. G.L.

DETAILS OF WORK

(State names of and expected depths to objective sands; show sizes, weights, and lengths of proposed casings; indicate mudlogging jobs, cementing points, and all other important proposed work)

1/26/62 Moved on completion tools, drld. DV tools @ 2265, CO to 6665.
 1/27/62 Tested csg. w/ 3500#. Ran correlation log & perf. 6615-6633 w/
 48PF. SWF w/ 40,000# 20-40 sd. 35,900 gals gelled wtr. BDP 2400#, TP
 3300-2600, ATP 2800#, inj rate 33.3 BPM. Shut well in 2 1/2 hrs. pressure
 dropped to -0- ran 201 jts. 1 1/2" non-upset tbg, washed out 30' sand, landed
 tbg @ 6627.45'KB. Opened well next morning, would not flow, pulled swab
 twice, well kicked off. Cleaning well, prep to S.I. for gauge.

I understand that this plan of work must receive approval in writing by the Geological Survey before operations may be commenced.

Company **Southwest Production Company**Address **207 Petr. Club Plaza**
Farmington, New MexicoOriginal signed by
Carl W. Smithx Title **Superintendent**

G.P. 1-2040

4-USGS

1-ND

1-D

1-F

SNP-95

Form 9-331a
(Feb. 1961)Budget Bureau No. 42-R3584
Approval expires 12-31-60.

Land Office

Lease No. SF-078029

Unit

Hancock Federal

(SUBMIT IN TRIPLICATE)

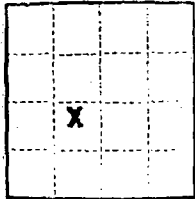
UNITED STATES
DEPARTMENT OF THE INTERIOR
GEOLOGICAL SURVEY

SUNDRY NOTICES AND REPORTS ON WELLS

NOTICE OF INTENTION TO DRILL	SUBSEQUENT REPORT OF WATER SHUT-OFF
NOTICE OF INTENTION TO CHANGE PLANS	SUBSEQUENT REPORT OF SHOOTING OR ACIDIZING
NOTICE OF INTENTION TO TEST WATER SHUT-OFF	SUBSEQUENT REPORT OF ALTERING CASING
NOTICE OF INTENTION TO RE-DRILL OR REPAIR WELL	SUBSEQUENT REPORT OF RE-DRILLING OR REPAIR
NOTICE OF INTENTION TO SHOOT OR ACIDIZE	SUBSEQUENT REPORT OF ABANDONMENT
NOTICE OF INTENTION TO PULL OR ALTER CASING	SUPPLEMENTARY WELL HISTORY
NOTICE OF INTENTION TO ABANDON WELL	

(INDICATE ABOVE BY CHECK MARK NATURE OF REPORT, NOTICE, OR OTHER DATA)

February 9, 1962

Well No. 5 is located 1450 ft. from [N] line and 1850 ft. from [W] line of sec. 23

NE 1/4 Sec. 23 27 N 11 W NMPN
(1/4 Sec. and Sec. No.) (Twp.) (Range) (Meridian)Basin-Dakota San Juan New Mexico
(Field) (County or Subdivision) (State or Territory)

The elevation of the derrick floor above sea level is 6396 ft. G.L.

DETAILS OF WORK

(State names of and expected depths to objective sands; show sizes, weights, and lengths of proposed casings; indicate mudding jobs, cementing points, and all other important proposed work)

1/18/62--T.D. 6740

Ran 212 fts 4 1/2" 10.50# Lone Star csg. set @ 6739' KB.
 Float collar @ 6693, DV tool @ 2265; 1st stage cemented w/
 200 sx 50/50 pozmix 4% gel, 100 sx neat w/ 1% halad #9,
 plug down @ 11:20 p.m. 2nd stage w/125 sx 50/50 pozmix 4%
 gel, plug down 11:45 p.m. 18th W.O.C.

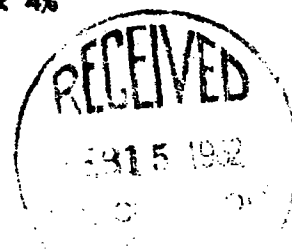

I understand that this plan of work must receive approval in writing by the Geological Survey before operations may be commenced.

Company Southwest Production Company

Address 207 Petr. Club Plaza

Farmington, New Mexico

Original signed by
Carl W. SmithBy
Title Superintendent

GSC - 1194

6-OCC
1-F

NEW MEXICO OIL CONSERVATION COMMISSION
SANTA FE, NEW MEXICO

SWP-95
Form C-110
Revised 7/1/55

(File the original and 4 copies with the appropriate district office)

CERTIFICATE OF COMPLIANCE AND AUTHORIZATION
TO TRANSPORT OIL AND NATURAL GAS

Company or Operator Southwest Production Company Lease Hancock Federal

Well No. 5 Unit Letter K S 23 T 27N R 11W Pool Basin Dakota

County San Juan Kind of Lease (State, Fed. or Patented) Fed. SF-073089

If well produces oil or condensate, give location of tanks: Unit K S 23 T 27N R 11W

Authorized Transporter of Oil or Condensate Industrial Oil Company

Address P. O. Box 15032, Salt Lake City, Utah

(Give address to which approved copy of this form is to be sent)

Authorized Transporter of Gas El Paso Natural Gas Company

Address P. O. Box 990, Farmington, New Mexico Date Connected _____

(Give address to which approved copy of this form is to be sent)

If Gas is not being sold, give reasons and also explain its present disposition:

Reasons for Filing: (Please check proper box) New Well ()

Change in Transporter of (Check One): Oil () Dry Gas () C'head () Condensate (X)

Change in Ownership () Other ()

Remarks: _____ (Give explanation below)

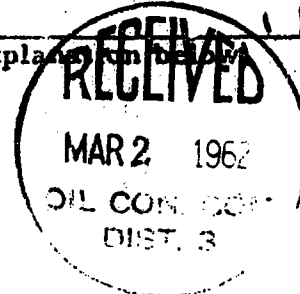

The undersigned certifies that the Rules and Regulations of the Oil Conservation Commission have been complied with.

Executed this the 2nd day of March 19 62

Original signed by
Carl W. Smith

By _____

Approved MAR 2 1962 19 _____

Title Superintendent

OIL CONSERVATION COMMISSION

Company Southwest Production Company

By _____

Address 207 Petr. Club Plaza

Title PETROLEUM ENGINEER DIST. NO. 3

Farmington, New Mexico

NUMBER OF COPIES RECEIVED	
DISTRIBUTION	
SANTA FE	
FILE	
U.S.G.S.	
LAND OFFICE	
TRANSPORTER	OIL GAS
PRODUCTION OFFICE	
OPERATOR	

NEW MEXICO OIL CONSERVATION COMMISSION
SANTA FE, NEW MEXICO
CERTIFICATE OF COMPLIANCE AND AUTHORIZATION
TO TRANSPORT OIL AND NATURAL GAS

FORM C-113
 (Rev. 7-60)

FILE THE ORIGINAL AND 4 COPIES WITH THE APPROPRIATE OFFICE

Company or Operator Southwest Production Company				Lease Hancock Federal		Well No. 5	
Unit Letter K	Section 23	Township 27N	Range 11W	County San Juan			
Pool Basin Dakota				Kind of Lease (State, Fed Fee) Federal SF-078089			
If well produces oil or condensate give location of tanks			Unit Letter K	Section 23	Township 27N	Range 11W	
Authorized transporter of oil <input type="checkbox"/> or condensate <input checked="" type="checkbox"/> M. & H. Trucking Company				Address (give address to which approved copy of this form is to be sent) P. O. Box 1995, Farmington, New Mexico			
Is Gas Actually Connected? Yes <input type="checkbox"/> No <input type="checkbox"/>							
Authorized transporter of casing head gas <input type="checkbox"/> or dry gas <input type="checkbox"/>			Date Connected	Address (give address to which approved copy of this form is to be sent)			

If gas is not being sold, give reasons and also explain its present disposition:

REASON(S) FOR FILING (please check proper box)

New Well ☐
 Change in Transporter (check one)
 Oil ☐ Dry Gas ☐
 Casing head gas ☐ Condensate ☒

Change in Ownership ☐
 Other (explain below)

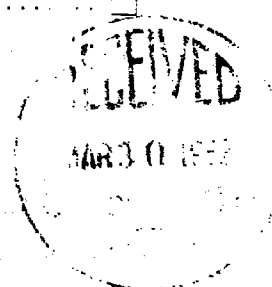

Remarks

The undersigned certifies that the Rules and Regulations of the Oil Conservation Commission have been complied with.

Executed this the 30th day of March, 19 62

OIL CONSERVATION COMMISSION		By
Approved by		Original signed by Carl W. Smith
Title		Superintendent
Title	Supervisor Dist # 3	Company Southwest Production Company
Date		Address 207 Petr. Club Plaza, Farmington, New Mexico

NUMBER OF COPIES RECEIVED	
DISTRIBUTION	
SANTA FE	
FILE	
U.S.G.S.	
LAND OFFICE	
TRANSPORTER	OIL
	GAS
PRODUCTION OFFICE	
OPERATOR	

NEW MEXICO OIL CONSERVATION COMMISSION
SANTA FE, NEW MEXICO

CERTIFICATE OF COMPLIANCE AND AUTHORIZATION TO TRANSPORT OIL AND NATURAL GAS

FORM C-110
(Rev. 7-60)

FILE THE ORIGINAL AND 4 COPIES WITH THE APPROPRIATE OFFICE

Company or Operator: Southwest Production Company				Lease: Hancock Federal		Well No. 5	
Unit Letter K	Section 23	Township 27 N	Range 11 W	County San Juan			
Pool Basin Dakota				Kind of Lease (State, Fed, Fee) Federal SF-078089			
If well produces oil or condensate give location of tanks			Unit Letter K	Section 23	Township 27 N	Range 11 W	
Authorized transporter of oil <input type="checkbox"/> or condensate <input checked="" type="checkbox"/> Lamar Trucking Company				Address (give address to which approve copy of this form is to be sent) P. O. Box 1528, Farmington, New Mexico			
Is Gas Actually Connected? Yes <input type="checkbox"/> No <input type="checkbox"/>							
Authorized transporter of casing head gas <input type="checkbox"/> or dry gas <input type="checkbox"/>			Date Connected	Address (give address to which approve copy of this form is to be sent)			

If gas is not being sold, give reasons and also explain its present disposition:

REASON(S) FOR FILING (please check proper box)

New Well ☐
Change in Transporter (check one)
Oil ☐ Dry Gas ☐
Casing head gas ☐ Condensate ☒

Change in Ownership ☐
Other (explain below)

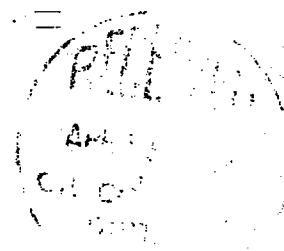

Remarks

The undersigned certifies that the Rules and Regulations of the Oil Conservation Commission have been complied with.

Executed this the 18th day of April, 1962.

OIL CONSERVATION COMMISSION		By Original signature Carl W. Smith
Approved by A. R. B. Smith	Title Superintendent	
Title PETROLEUM ENGINEER	Company Southwest Production Company	
Date APR 11 1962	Address 207 Petr. Club Plaza, Farmington, N.M.	

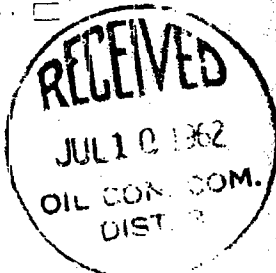
NUMBER OF COPIES RECEIVED DISTRIBUTION		NEW MEXICO OIL CONSERVATION COMMISSION SANTA FE, NEW MEXICO			FORM C-110 (Rev. 7-60)	
CERTIFICATE OF COMPLIANCE AND AUTHORIZATION TO TRANSPORT OIL AND NATURAL GAS		FILE THE ORIGINAL AND 4 COPIES WITH THE APPROPRIATE OFFICE				
Company or Operator Southwest Production Company			Lease Hancock Federal		Well No. 5	
Unit Letter K	Section 23	Township 27N	Range 11W	County San Juan		
Pool Basin Dakota			Kind of Lease (State, Fed Fee) Federal F-078089			
If well produces oil or condensate give location of tanks		Unit Letter K	Section 23	Township 27N	Range 11W	
Authorized transporter of oil <input type="checkbox"/> or condensate <input checked="" type="checkbox"/> Industrial Oil Company			Address (give address to which approved copy of this form is to be sent) P. O. Box 15032, Salt Lake City, Utah			
Is Gas Actually Connected? Yes _____ No _____						
Authorized transporter of casing head gas <input type="checkbox"/> or dry gas <input type="checkbox"/>		Date Connected	Address (give address to which approved copy of this form is to be sent)			
If gas is not being sold, give reasons and also explain its present disposition:						
REASON(S) FOR FILING (please check proper box)						
New Well <input type="checkbox"/> Change in Ownership <input type="checkbox"/> Change in Transporter (check one) Oil <input type="checkbox"/> Dry Gas <input type="checkbox"/> Casing head gas <input type="checkbox"/> Condensate <input checked="" type="checkbox"/>						
						
Remarks						
The undersigned certifies that the Rules and Regulations of the Oil Conservation Commission have been complied with.						
Executed this the <u>5th</u> day of <u>July</u> , 19 <u>62</u> .						
OIL CONSERVATION COMMISSION			By Original signed by Carl W. Smith			
Approved by Original Signed by W. B. Smith			Title Superintendent			
Title DIST. NO. 3			Company Southwest Production Company			
Date JUL 10 1962			Address 207 Petr. Club Plaza Farmington, New Mexico			

NUMBER OF COPIES RECEIVED _____ DISTRIBUTION _____ SANTA FE _____ FILL _____ U.S.C.S. _____ LAND OFFICE _____ TRANSPORTER _____ PRODUCTION OFFICE _____ OPERATOR _____		NEW MEXICO OIL CONSERVATION COMMISSION SANTA FE, NEW MEXICO SWP-95 CERTIFICATE OF COMPLIANCE AND AUTHORIZATION TO TRANSPORT OIL AND NATURAL GAS			FORM C-110 (Rev. 7-60)	
FILE THE ORIGINAL AND 4 COPIES WITH THE APPROPRIATE OFFICE						
Company or Operator Southwest Production Company			Lease Hancock Federal		Well No. 5	
Unit Letter K	Section 23	Township 27 N	Range 11 W	County San Juan		
Pool Basin Dakota			Kind of Lease (State, Fed, Fee) Federal SF-078089			
If well produces oil or condensate give location of tanks		Unit Letter K	Section 23	Township 27 N	Range 11 W	
Authorized transporter of oil <input type="checkbox"/> or condensate <input checked="" type="checkbox"/> La Mar Trucking, Inc.			Address (give address to which approved copy of this form is to be sent) P. O. Box 1528, Farmington, New Mexico			
Is Gas Actually Connected? Yes <input checked="" type="checkbox"/> No <input type="checkbox"/>						
Authorized transporter of casing head gas <input type="checkbox"/> or dry gas <input type="checkbox"/>		Date Connected	Address (give address to which approved copy of this form is to be sent)			
If gas is not being sold, give reasons and also explain its present disposition:						
REASON(S) FOR FILING (please check proper box)						
New Well <input type="checkbox"/> Change in Ownership <input type="checkbox"/> Change in Transporter (check one) Other (explain below) Oil <input type="checkbox"/> Dry Gas <input type="checkbox"/> Casing head gas <input type="checkbox"/> Condensate... <input checked="" type="checkbox"/>						
Remarks						
The undersigned certifies that the Rules and Regulations of the Oil Conservation Commission have been complied with.						
Executed this the <u>29th</u> day of <u>November</u> , 19 <u>62</u> .						
OIL CONSERVATION COMMISSION			By			
Approved by Original Signed By A. R. KENDRICK			Original signed by Carl W. Smith			
Title PETROLEUM ENGINEER DIST. NO. 3			Title Superintendent			
Date NOV 30 1962			Company Southwest Production Company			
			Address 207 Petr. Club Plaza Farmington, New Mexico			

NUMBER OF COPIES RECEIVED	
SANTA FE	
FILE	
U.S.C.S.	
LAND OFFICE	
TRANSPORTER	C.O.L.
OPERATION OFFICE	G.A.S.
OPERATOR	

5-000 NEW MEXICO OIL CONSERVATION COMMISSION
1-F SANTA FE, NEW MEXICO

FORM C-110
(Rev. 7-60)

CERTIFICATE OF COMPLIANCE AND AUTHORIZATION TO TRANSPORT OIL AND NATURAL GAS

FILE THE ORIGINAL AND 4 COPIES WITH THE APPROPRIATE OFFICE

Company or Operator Beta Development Co.				Lease Hancock Federal	Well No. 5
Unit Letter K	Section 23	Township 27N	Range 11W	County Sar Juan	
Pool Basin Dakota				Kind of Lease (State, Fed, Fee) Federal	

If well produces oil or condensate give location of tanks	Unit Letter K	Section 23	Township 27N	Range 11W
--	-------------------------	----------------------	------------------------	---------------------

Authorized transporter of oil <input type="checkbox"/> or condensate <input checked="" type="checkbox"/>	Address (give address to which approved copy of this form is to be sent)
La Mar Trucking, Inc.	P. O. Box 1528, Farmington, N. M.

Is Gas Actually Connected? Yes ☒ No ☐

Authorized transporter of casing head gas <input type="checkbox"/> or dry gas <input checked="" type="checkbox"/>	Date Connected	Address (give address to which approved copy of this form is to be sent)
El Paso Natural Gas Company		P. O. Box 990, Farmington, N. M.

If gas is not being sold, give reasons and also explain its proposed disposition:
INLAND CORPORATION PURCHASED ALL THE ASSETS OF BOTH LA MAR TRUCKING, INC. AND INLAND INC. THIS PURCHASE INCLUDED N. M. PERMIT 670 WHICH HAS BEEN TRANSFERRED TO INLAND CORPORATION.

CLYDE C. LEAH
INLAND CORPORATION REASON(S) FOR FILING (please check proper box)

<input type="checkbox"/> New Well	<input checked="" type="checkbox"/> Change in Ownership
<input type="checkbox"/> Change in Transporter (check one)	<input type="checkbox"/> Other (explain below)
<input type="checkbox"/> Oil	<input type="checkbox"/> Dry Gas
<input type="checkbox"/> Casing head gas	<input type="checkbox"/> Condensate

Remarks
Filed to change ownership from Southwest Production Co. to Beta Development Co., effective September 1, 1963.

The undersigned certifies that the Rules and Regulations of the Oil Conservation Commission have been complied with.
 Executed this the **18th** day of **September**, 19 **63**

OIL CONSERVATION COMMISSION	By Original signed by: John T. Hampton
Approved by	Title Manager
Title Supervisor	Company Beta Development Co.
Date Sept 18 1963	Address 234 Penn. Club Plaza Farmington, N. M.

3-000
1-F

NEW MEXICO OIL CONSERVATION COMMISSION

Supersedes Oil
Conservation
Commission
Effective 1-1-68

DATE OF COMPLETION	3
DISTRIBUTION	
SANTA FE	
FILE	1
U.S.G.S.	
LAND OFFICE	
OPERATOR	

State Oil & Gas Lease No.	SF-078089
---------------------------	-----------

<p>SUNDRY NOTICES AND REPORTS ON WELLS</p> <p>DO NOT USE THIS FORM FOR PROPOSALS TO DRILL OR TO DEEPEN OR PLUG BACK TO A DIFFERENT RESERVOIR. USE "APPLICATION FOR PERMIT -" (FORM C-101) FOR SUCH PROPOSALS.</p>		
<p>1. OIL <input type="checkbox"/> GAS <input checked="" type="checkbox"/> WELL <input type="checkbox"/> OTHER <input type="checkbox"/></p>		2. Field Agreement Name
<p>3. Name of Operator</p> <p>Beta Development Co.</p>		4. Name of Lessee
<p>5. Address of Operator</p> <p>234 Petroleum Club Plaza, Farmington, New Mexico</p>		6. Well No.
<p>7. Location of Well</p> <p>K 1450 FEET FROM THE South LINE AND 1850 FEET FROM West LINE, SECTION 23 TOWNSHIP 27 N RANGE 11 W NMPM.</p>		8. Field and Section or Wildcat
<p>9. Elevation (Show whether DF, RT, GR, etc.)</p> <p>6396' GR</p>		10. County
		San Juan

Check Appropriate Box To Indicate Nature of Notice, Report or Other Data

NOTICE OF INTENTION TO:		SUBSEQUENT REPORT OF:	
PERFORM REMEDIAL WORK <input checked="" type="checkbox"/>	PLUG AND ABANDON <input type="checkbox"/>	REMEDIAL WORK <input type="checkbox"/>	ALTERING CASING <input type="checkbox"/>
TEMPORARILY ABANDON <input type="checkbox"/>	CHANGE PLANS <input type="checkbox"/>	COMMENCE DRILLING OPNS. <input type="checkbox"/>	PLUG AND ABANDONMENT <input type="checkbox"/>
WELL OR ALTER CASING <input type="checkbox"/>		CASING TEST AND CEMENT JOB <input type="checkbox"/>	
		OTHER <input type="checkbox"/>	

11. Describe Proposed or Completed Operations (Clearly state all pertinent details, and give pertinent dates, including estimated date of starting any proposed work) SEE RULE 103.

Repair casing leaks w/packer and Kem-Pac chemicals, as follows:

Rig up workover rig, circulate out mud, sand and shale to T.D. Circulate until hole is clean. POH. Run Baker Model "D" production packer on wire line. Set packer just below Greenhorn section w/bump out plug to keep any water or Kem-Pac material from getting below packer. GIH w/tbg., Model "D" locator and tail pipe. Spot Kem-Pac above Model "D", set tail pipe down on bump out plug, run tail pipe through Model "D" and land locator seals in packer. Flange up well head, swab well in and re-acidize if necessary.



12. I hereby certify that the information above is true and complete to the best of my knowledge and belief.

Original signed by:
JOHN T. HAMPTON

SIGNED _____ TITLE **Manager** DATE **December 21, 1966**

APPROVED BY Emory C. Lawler TITLE Sup. Dist. Eng. DATE 12-23-66

CONDITIONS OF APPROVAL, IF ANY:

UNITED STATES
DEPARTMENT OF THE INTERIOR
GEOLOGICAL SURVEY

SUBMIT IN TRIPLICATE*
(Other instructions on re-
verse side)

Form approved
Budget Bureau No. 42-R1424.
LEASE DESIGNATION AND SERIAL NO.

SF-078089

6 IF INDIAN, ALLOTTEE OR TRIBE NAME

SUNDRY NOTICES AND REPORTS ON WELLS

(Do not use this form for proposals to drill or to deepen or plug back to a different reservoir.
Use "APPLICATION FOR PERMIT" for such proposals.)

1. OIL WELL <input type="checkbox"/> GAS WELL <input checked="" type="checkbox"/> OTHER <input type="checkbox"/>		7. UNIT AGREEMENT NAME	
2. NAME OF OPERATOR Beta Development Co.		8. FARM OR LEASE NAME Hancock Federal	
3. ADDRESS OF OPERATOR 234 Petroleum Club Plaza, Farmington, New Mexico		9. WELL NO. 5	
4. LOCATION OF WELL (Report location clearly and in accordance with any State requirements.* See also space 17 below.) At surface 1450/S 1850/W		10. FIELD AND POOL, OR WILDCAT Basin Dakota	
14. PERMIT NO.		11. SEC., T., R., M., OR BLK. AND SURVEY OR AREA 23-27N-11W NMDM	
15. ELEVATIONS (Show whether DF, RT, GR, etc.) 6396' GR		12. COUNTY OR PARISH San Juan	
		13. STATE New Mexico	

16. Check Appropriate Box To Indicate Nature of Notice, Report, or Other Data

NOTICE OF INTENTION TO:

SUBSEQUENT REPORT OF:

TEST WATER SHUT-OFF <input type="checkbox"/>	PULL OR ALTER CASING <input type="checkbox"/>	WATER SHUT-OFF <input type="checkbox"/>	REPAIRING WELL <input checked="" type="checkbox"/>
FRACTURE TREAT <input type="checkbox"/>	MULTIPLE COMPLETE <input type="checkbox"/>	FRACTURE TREATMENT <input type="checkbox"/>	ALTERING CASING <input type="checkbox"/>
SHOOT OR ACIDIZE <input type="checkbox"/>	ABANDON* <input type="checkbox"/>	SHOOTING OR ACIDIZING <input type="checkbox"/>	ABANDONMENT* <input type="checkbox"/>
REPAIR WELL <input type="checkbox"/>	CHANGE PLANS <input type="checkbox"/>	(Other) <input type="checkbox"/>	

(NOTE: Report results of multiple completion on Well Completion or Recompletion Report and Log form.)

17. DESCRIBE PROPOSED OR COMPLETED OPERATIONS (Clearly state all pertinent details, and give pertinent dates, including estimated date of starting any proposed work. If well is directionally drilled, give subsurface locations and measured and true vertical depths for all markers and zones pertinent to this work.)*

- 1-4-67 Rigged up work over unit, latched onto tbq, tbq stuck on bottom. Circ. w/wtr @ 1800#. Broke circ w/hot oil @ 2800#. Circ. hot oil around stuck tbq., worked loose in 11 hrs. Circ. out approx. 3500' drlg mud, sand and shale. CO to 6665'. Circ. on bottom 2 hrs to clean hole. POH.
- 1-5-67 Ran junk ring to 6660'. Ran Baker Model "D" packer on wire line & set @ 6520'. Ran 1-1/2" tbq w/Baker locator assembly and 5' of tail pipe. Stopped tbq @ 6515'. Spotted 97 bbls oil w/Kem-Pac chemicals behind tbq. Flushed tbq w/13 bbls oil, slacked tbq off. Pushed bump out plug out of packer. Set locator in packer w/6000#, set 10,000# on donut. Ran 197 jts 6518' 1-1/2" non-upset tbq. Rigged down blow out preventor, rigged up to swab. Swabbed 9 hrs. Released rig @ 8 AM. 6th
- 1-6-67 Blowing well.
- 1-7-67 Blowing well.
- 1-8-67 Hooked up and put back on line.

RECEIVED

JAN 16 1967

U. S. GEOLOGICAL SURVEY
FARMINGTON, N. M.

18. I hereby certify that the foregoing is true and correct

SIGNED Original signed by: D. E. BAXTER TITLE Superintendent DATE Jan. 16, 1967
(This space for Federal or State office use)

APPROVED BY _____ TITLE _____ DATE _____
CONDITIONS OF APPROVAL, IF ANY: _____

*See Instructions on Reverse Side

UNITED STATES
DEPARTMENT OF THE INTERIOR
GEOLOGICAL SURVEY

SUBMIT IN TRIPPLICATE*
(Other instructions on reverse side)

Form approved
Budget Bureau No. 42-R1424
LEASE DESIGNATION AND SERIAL NO.

SUNDRY NOTICES AND REPORTS ON WELLS

(Do not use this form for proposals to drill or to deepen or plug back to a different reservoir.
Use "APPLICATION FOR PERMIT—" for such proposals.)

1. ☐ OIL WELL ☐ GAS WELL ☒ OTHER

2. NAME OF OPERATOR
Beta Development Co.

3. ADDRESS OF OPERATOR
125 Petroleum plaza Farmington, New Mexico 87401

4. LOCATION OF WELL (Report location clearly and in accordance with any State requirements.*
See also space 17 below.)
At surface
1,450' /SL and 1,850' /WL

14. PERMIT NO.

15. ELEVATIONS (Show whether DF, RT, GR, etc.)
6396 GL

SF-078089

6. INDIAN, ALLOTTEE OR TRIBE NAME

7. UNIT AGREEMENT NAME

8. FARM OR LEASE NAME
Hancock Federal

9. WELL NO.
5

10. FIELD AND POOL, OR WILDCAT
Basin Dakota

11. SEC., T., R., M., OR BLK. AND SURVEY OR AREA
23-27N-11W

12. COUNTY OR PARISH
San Juan

13. STATE
New Mexico

16. Check Appropriate Box To Indicate Nature of Notice, Report, or Other Data

NOTICE OF INTENTION TO:		SUBSEQUENT REPORT OF:	
TEST WATER SHUT-OFF <input type="checkbox"/>	PULL OR ALTER CASING <input type="checkbox"/>	WATER SHUT-OFF <input type="checkbox"/>	REPAIRING WELL <input type="checkbox"/>
FRACTURE TREAT <input type="checkbox"/>	MULTIPLE COMPLETE <input type="checkbox"/>	FRACTURE TREATMENT <input type="checkbox"/>	ALTERING CASING <input type="checkbox"/>
SHOOT OR ACIDIZE <input type="checkbox"/>	ABANDON* <input type="checkbox"/>	SHOOTING OR ACIDIZING <input type="checkbox"/>	ABANDONMENT* <input type="checkbox"/>
REPAIR WELL <input checked="" type="checkbox"/>	CHANGE PLANS <input type="checkbox"/>	(Other) <input type="checkbox"/>	(Other) <input type="checkbox"/>

(NOTE: Report results of multiple completion on Well Completion or Recompletion Report and Log form)

17. DESCRIBE PROPOSED OR COMPLETED OPERATIONS (Clearly state all pertinent details, and give pertinent dates, including estimated date of starting any proposed work. If well is directionally drilled, give subsurface locations and measured and true vertical depths for all markers and zones pertinent to this work.)*

Rid up workover rig, install B.O.P. pull $1\frac{1}{2}$ " tubing, pick up string of 2 $3\frac{3}{8}$ " tubing for working string, set R-1 plug in model "D" packer at 6520', circulate out drilling mud and Kempac chemicals, POH, GIH W/ full bore packer, set packer 30' above model "D" W/ plug, test plug, packer and tubing string to 2,500#, release packer come up hole, find bottom and top holes in $4\frac{1}{2}$ " casing. As there is a 2 stage collar @ 2265', pull packer up and set @ 2200; squeeze approximately 450 sacks reg. cement with 6% gel and 2% calcium chloride, hold squeeze pressure until no flow back, release packer circulate out, POH with packer, WOC 8 to 12 hrs. trip in with 3 $7\frac{7}{8}$ " bit on tubing, drill cement out of casing, test squeeze to 1500#, retrieve R-1 plug, lay 2 $3\frac{3}{8}$ " tubing down, run $1\frac{1}{2}$ " string land in model "D" packer, swab well off.

18. I hereby certify that the foregoing is true and correct

SIGNED *D. E. Warr*

TITLE **Superintendent**

DATE **9-6-77**

(This space for Federal or State office use)

APPROVED BY _____
CONDITIONS OF APPROVAL, IF ANY:

TITLE _____

RECEIVED

SEP 6 1977

*See Instructions on Reverse Side

GEOLOGICAL SURVEY

OIL CONSERVATION DIVISION

P. O. BOX 2088

SANTA FE, NEW MEXICO 87501

Form C-104
Revised 10-1-78REQUEST FOR ALLOWABLE
AND
AUTHORIZATION TO TRANSPORT OIL AND NATURAL GAS

NO. OF COPIES REQUIRED	
DISTRIBUTION	
SANTA FE	
FILE	
U.S.G.S.	
LAND OFFICE	
TRANSPORTER	OIL
	NATURAL GAS
OPERATOR	
PRODUCTION OFFICE	

Beta Development Company

Address

238 Petroleum Plaza Farmington, NM 87401

Reason(s) for filing (Check proper box)

New Well	<input type="checkbox"/>	Change in Transporter of:	
Recompletion	<input type="checkbox"/>	Oil	<input type="checkbox"/>
Change in Ownership	<input type="checkbox"/>	Casinghead Gas	<input type="checkbox"/>
		Dry Gas	<input type="checkbox"/>
		Condensate	<input checked="" type="checkbox"/>

Other (Please explain)

If change of ownership give name
and address of previous owner

DESCRIPTION OF WELL AND LEASE

Lease Name	Well No.	Pool Name, including Formation	Kind of Lease	Lease No.
Hancock Federal	5	Basin Dakota	State, Federal or Fee Federal	1045-05
Location				
Unit Letter	K	1450 Feet From The South Line and 1850 Feet From The West		
Line of Section	23	Township 27N	Range 11W	NMPM, San Juan County

DESIGNATION OF TRANSPORTER OF OIL AND NATURAL GAS

Name of Authorized Transporter of Oil <input type="checkbox"/> or Condensate <input checked="" type="checkbox"/>	Address (Give address to which approved copy of this form is to be sent)
Giant Refinery Inc.	P. O. Box 256 Farmington, NM 87401
Name of Authorized Transporter of Casinghead Gas <input type="checkbox"/> or Dry Gas <input checked="" type="checkbox"/>	Address (Give address to which approved copy of this form is to be sent)
El Paso Natural Gas Company	P. O. Box 990 Farmington, NM 87401
If well produces oil or liquids, give location of tanks.	Unit Sec. Twp. Rge.
	K 23 27N 11W
Is gas actually connected?	When

If this production is commingled with that from any other lease or pool, give commingling order number

COMPLETION DATA

Designate Type of Completion - (X)	Oil Well	Gas Well	New Well	Workover	Deepen	Plug Back	Same Res'v.	Diff. Res'v.
Date Spudded	Date Compl. Ready to Prod.	Total Depth	P.B.T.D.					
Elevations (DF, RAB, RT, GR, etc.)	Name of Producing Formation	Top Oil/Gas Pay	Tubing Depth					
Perforations	Depth Casing Shoe							

TUBING, CASING, AND CEMENTING RECORD

HOLE SIZE	CASING & TUBING SIZE	DEPTH SET	SACKS CEMENT

TEST DATA AND REQUEST FOR ALLOWABLE
OIL WELL

(Test must be after recovery of total volume of load oil and must be equal to or exceed top allowable for this depth or be for full 24 hours)

Date First New Oil Run To Tanks	Date of Test	Producing Method (Flow, pump, gas lift, etc.)	
Length of Test	Tubing Pressure	Casing Pressure	Choke Size
Actual Prod. During Test	Oil - Bbls.	Water - Bbls.	Gas - MCF

GAS WELL

Actual Prod. Test - MCF/D	Length of Test	Bbls. Condensate/MMCF	Gravity of Condensate
Testing Method (spot, back pr.)	Tubing Pressure (Shut-in)	Casing Pressure (Shut-in)	Choke Size

CERTIFICATE OF COMPLIANCE

I hereby certify that the rules and regulations of the Oil Conservation Division have been complied with and that the information given above is true and complete to the best of my knowledge and belief.



(Signature)

Production Manager

(Title)

March 23, 1982

(Date)

OIL CONSERVATION DIVISION

APPROVED

APR 2 1982

Original Signed by CHARLES G. GILBERT

BY

DEPUTY OIL & GAS INSPECTOR, NM

TITLE

This form is to be filed in compliance with RULE 1108.

If this is a request for allowable for a newly drilled or deepened well, this form must be accompanied by a tabulation of the deviation tests taken on the well in accordance with RULE 111.

All sections of this form must be filled out completely for all wells on new and recompleted wells.

Fill out only Sections I, II, III, and VI for changes of owner, well name or number, or transporter or other such change of condition.

Form 5160-5
(November 1983)
(Formerly 9-331)

UNITED STATES
DEPARTMENT OF THE INTERIOR
BUREAU OF LAND MANAGEMENT

SUBMIT IN TRIPLICATE*
(Other instructions on re-
verse side)

Form approved.
Budget Bureau No. 1004-0135
Expires August 31, 1985

5. LEASE DESIGNATION AND SERIAL NO.

SF-078089

6. IF INDIAN, ALLOTTEE OR TRIBE NAME

7. UNIT AGREEMENT NAME

8. FARM OR LEASE NAME

Hancock Federal

9. WELL NO.

54

10. FIELD AND POOL, OR WILDCAT

Basin Dakota

11. SEC., T., R., N., OR S.E. AND
SURVEY OR AREA

Sec. 23, T-27N, R-11W

12. COUNTY OR PARISH 13. STATE

San Juan

New Mexico

14. PERMIT NO.

15. ELEVATIONS (Show whether DP, BT, OR, etc.)

6396' G.L.

16. Check Appropriate Box To Indicate Nature of Notice, Report, or Other Data

NOTICE OF INTENTION TO:

SUBSEQUENT REPORT OF:

TEST WATER SHUT-OFF

PULL OR ALTER CASING

WATER SHUT-OFF

REPAIR NO. WELL

FRACTURE TREAT

MULTIPLE COMPLETION

FRACTURE TREATMENT

ALTERING CASING

SHOOT OR ACIDIZE

ABANDON*

SHOOTING OR ACIDIZING

ABANDONMENT*

REPAIR WELL

CHANGE PLANT

(Other)

(Other)

(NOTE: Report results of multiple completion on Well
Completion or Recompletion Report and Log form.)

17. Describe in detail the work done, including pertinent details and give pertinent dates, including estimated date of starting any
project, and give substantial completion and estimated and true vertical depths for all markers and issues per-
tinent to this work.

Well developed hole in csg in 1967, repaired no damage to formation, developed 2nd
hole in 1977, repaired with approx. 30% damages. In Jan. 1981 developed 3rd hole, now
dead due to holes in csg.

Well History: 10-3/4" csg, set at 193' with cement circulated 4 1/2" casing set @ 6740'
with 2 stage at 2265' cement tops (calculated) @ 5400' and 1800' respectively.

Propose to P & A in this manner: rig up trip tubing replace bad tubing, spot 25 sx
plug into Dakota perf. @ 6615 to 6633' and 50' above packer @ (6470' 25 X 1.16 X 11.2)
= 280' fill, circ. hole with 9.5# mud, spot 10 sx plug 60' below and 70' above Gallup
@ 5597' (10 X 1.16 X 11.2) = 130' fill, perf top M. V. section 2960 to 3020', pump
35 sx plug 60' below & 60' above M.V. top (35 X 1.16 X 2.95) = 120' 10 sx plug 60' below
P. C. @ 2092 and 50' above Fruitland @ 1757' (25 X 1.16 X 11.2) = 325' shoot csg @ 1100'
recover 20 sx plug 50' in and 50' out casing stub, 30 sx plug 50' below and 50' above
Fruitland @ 1857 (30 X 1.16 X 2.95) = 102', spot 30 sx plug 50' above and 50' below Ojo
Alamo @ 1095' (30 X 1.16 X 2.95) = 102' spot 50 sx plug 50' in and 50' out base of surface
set dry hole marker w/10 sx plug at surface.

18. I hereby certify that the foregoing is true and correct

SIGNED

TITLE

Asst. Supt.

(This space for Federal or State office use)

APPROVED BY

TITLE

CONDITIONS OF APPROVAL, IF ANY

DATE April 9, 1985

DATE

*See Instructions on Reverse Side

ABANDONED WELL

WORKSHEET

OPERATOR Beta Development
 WELL NO. HAWK Fed #5 LOCATED 31 1/4 S 23 1/4 E 27 N R. 11 W
 LEASE NO. SF 078089 FIELD Basin Dakota State NM
 T. D. 6740' HOLE SIZE: Surface 16 3/4" Set at 193'

P.D.T.D. 6665' Interr. _____ Set at _____

Long Str. 4 1/2" Set at 6737'

Plugs: from to w/sx ft

from	to	w/sx	ft	Perfs at:	from	to
5'	243'	1.3	1	Surf.	1.3	Surf.
243'	438'	1.35	10	Inter.	2435'	1800'
438'	5547'	1.35 to 1.3	1	Long str.	6740'	5400'
5547'	6470'	1.3	1	Perfs at:	from	to
6470'	6520'	1.3	1		6615'	6633'
6520'	6547'	1.3	1			
6547'	6567'	1.3	1			
6567'	6587'	1.3	1			
6587'	6607'	1.3	1			
6607'	6627'	1.3	1			
6627'	6647'	1.3	1			
6647'	6665'	1.3	1			
6665'	6685'	1.3	1			
6685'	6705'	1.3	1			
6705'	6725'	1.3	1			
6725'	6740'	1.3	1			
6740'	6760'	1.3	1			
6760'	6780'	1.3	1			
6780'	6800'	1.3	1			
6800'	6820'	1.3	1			
6820'	6840'	1.3	1			
6840'	6860'	1.3	1			
6860'	6880'	1.3	1			
6880'	6900'	1.3	1			
6900'	6920'	1.3	1			
6920'	6940'	1.3	1			
6940'	6960'	1.3	1			
6960'	6980'	1.3	1			
6980'	7000'	1.3	1			
7000'	7020'	1.3	1			
7020'	7040'	1.3	1			
7040'	7060'	1.3	1			
7060'	7080'	1.3	1			
7080'	7100'	1.3	1			
7100'	7120'	1.3	1			
7120'	7140'	1.3	1			
7140'	7160'	1.3	1			
7160'	7180'	1.3	1			
7180'	7200'	1.3	1			
7200'	7220'	1.3	1			
7220'	7240'	1.3	1			
7240'	7260'	1.3	1			
7260'	7280'	1.3	1			
7280'	7300'	1.3	1			
7300'	7320'	1.3	1			
7320'	7340'	1.3	1			
7340'	7360'	1.3	1			
7360'	7380'	1.3	1			
7380'	7400'	1.3	1			
7400'	7420'	1.3	1			
7420'	7440'	1.3	1			
7440'	7460'	1.3	1			
7460'	7480'	1.3	1			
7480'	7500'	1.3	1			
7500'	7520'	1.3	1			
7520'	7540'	1.3	1			
7540'	7560'	1.3	1			
7560'	7580'	1.3	1			
7580'	7600'	1.3	1			
7600'	7620'	1.3	1			
7620'	7640'	1.3	1			
7640'	7660'	1.3	1			
7660'	7680'	1.3	1			
7680'	7700'	1.3	1			
7700'	7720'	1.3	1			
7720'	7740'	1.3	1			
7740'	7760'	1.3	1			
7760'	7780'	1.3	1			
7780'	7800'	1.3	1			
7800'	7820'	1.3	1			
7820'	7840'	1.3	1			
7840'	7860'	1.3	1			
7860'	7880'	1.3	1			
7880'	7900'	1.3	1			
7900'	7920'	1.3	1			
7920'	7940'	1.3	1			
7940'	7960'	1.3	1			
7960'	7980'	1.3	1			
7980'	8000'	1.3	1			
8000'	8020'	1.3	1			
8020'	8040'	1.3	1			
8040'	8060'	1.3	1			
8060'	8080'	1.3	1			
8080'	8100'	1.3	1			
8100'	8120'	1.3	1			
8120'	8140'	1.3	1			
8140'	8160'	1.3	1			
8160'	8180'	1.3	1			
8180'	8200'	1.3	1			
8200'	8220'	1.3	1			
8220'	8240'	1.3	1			
8240'	8260'	1.3	1			
8260'	8280'	1.3	1			
8280'	8300'	1.3	1			
8300'	8320'	1.3	1			
8320'	8340'	1.3	1			
8340'	8360'	1.3	1			
8360'	8380'	1.3	1			
8380'	8400'	1.3	1			
8400'	8420'	1.3	1			
8420'	8440'	1.3	1			
8440'	8460'	1.3	1			
8460'	8480'	1.3	1			
8480'	8500'	1.3	1			
8500'	8520'	1.3	1			
8520'	8540'	1.3	1			
8540'	8560'	1.3	1			
8560'	8580'	1.3	1			
8580'	8600'	1.3	1			
8600'	8620'	1.3	1			
8620'	8640'	1.3	1			
8640'	8660'	1.3	1			
8660'	8680'	1.3	1			
8680'	8700'	1.3	1			
8700'	8720'	1.3	1			
8720'	8740'	1.3	1			
8740'	8760'	1.3	1			
8760'	8780'	1.3	1			
8780'	8800'	1.3	1			
8800'	8820'	1.3	1			
8820'	8840'	1.3	1			
8840'	8860'	1.3	1			
8860'	8880'	1.3	1			
8880'	8900'	1.3	1			
8900'	8920'	1.3	1			
8920'	8940'	1.3	1			
8940'	8960'	1.3	1			
8960'	8980'	1.3	1			
8980'	9000'	1.3	1			
9000'	9020'	1.3	1			
9020'	9040'	1.3	1			
9040'	9060'	1.3	1			
9060'	9080'	1.3	1			
9080'	9100'	1.3	1			
9100'	9120'	1.3	1			
9120'	9140'	1.3	1			
9140'	9160'	1.3	1			
9160'	9180'	1.3	1			
9180'	9200'	1.3	1			
9200'	9220'	1.3	1			
9220'	9240'	1.3	1			
9240'	9260'	1.3	1			
9260'	9280'	1.3	1			
9280'	9300'	1.3	1			
9300'	9320'	1.3	1			
9320'	9340'	1.3	1			
9340'	9360'	1.3	1			
9360'	9380'	1.3	1			
9380'	9400'	1.3	1			
9400'	9420'	1.3	1			
9420'	9440'	1.3	1			
9440'	9460'	1.3	1			
9460'	9480'	1.3	1			
9480'	9500'	1.3	1			
9500'	9520'	1.3	1			
9520'	9540'	1.3	1			
9540'	9560'	1.3	1			
9560'	9580'	1.3	1			
9580'	9600'	1.3	1			
9600'	9620'	1.3	1			
9620'	9640'	1.3	1			
9640'	9660'	1.3	1			
9660'	9680'	1.3	1			
9680'	9700'	1.3	1			
9700'	9720'	1.3	1			
9720'	9740'	1.3	1			
9740'	9760'	1.3	1			
9760'	9780'	1.3	1			
9780'	9800'	1.3	1			
9800'	9820'	1.3	1			
9820'	9840'	1.3	1			
9840'	9860'	1.3	1			
9860'	9880'	1.3	1			
9880'	9900'	1.3	1			
9900'	9920'	1.3	1			
9920'	9940'	1.3	1			
9940'	9960'	1.3	1			
9960'	9980'	1.3	1			
9980'	10000'	1.3	1			

1/20 SX
 squeezed
 here in 1977
 DARK grey
 255X 29 C. ft.
 225 SX TOTAL

FORMATION:	Top	Base
Surface	16 3/4"	113'
Op.	113'	1015'
Kittling	1015'	1357'
Freitling	1357'	2042'
P. 1.	2042'	2254'
P. 2.	2254'	2472'
P. 3.	2472'	2743'
P. 4.	2743'	3214'
P. 5.	3214'	6737'

GL 6396'

193'

vio 988'

Tim 995'

Hand 857'

OC 2042'

CS 2234'

San W. ede 2970'

1.14 House

SAV 4460'

20

nos 4772'

allup 5547'

Dakota 6613'

Form 3160-5
(November 1983)
(Formerly 9-331)

UNITED STATES
DEPARTMENT OF THE INTERIOR
BUREAU OF LAND MANAGEMENT

SUBMIT IN TRIPPLICATE*
(Other instructions on re-
verse side)

Form approved.
Budget Bureau No. 1004-0135
Expires August 31, 1985

SUNDRY NOTICES AND REPORTS ON WELLS

(Do not use this form for proposals to drill or to deepen or plug back to a different reservoir.
Use "APPLICATION FOR PERMIT—" for such proposals.)

1. OIL WELL <input type="checkbox"/> GAS WELL <input checked="" type="checkbox"/> OTHER <input type="checkbox"/>		5. LEASE DESIGNATION AND SERIAL NO. SF-078089	
2. NAME OF OPERATOR Beta Development Company		6. IF INDIAN, ALLOTTEE OR TRIBE NAME	
3. ADDRESS OF OPERATOR 238 Petroleum Plaza, Farmington, NM 87401		7. UNIT AGREEMENT NAME	
4. LOCATION OF WELL (Report location clearly and in accordance with any State requirements. See also space 17 below.) At surface 1450' FSL and 1850' FWL		8. FARM OR LEASE NAME Hancock Federal	
14. PERMIT NO.		9. WELL NO. 5	
15. ELEVATIONS (Show whether DF, RT, GR, etc.) 6396' G.L.		10. FIELD AND POOL, OR WILDCAT Basin Dakota	
16. Check Appropriate Box To Indicate Nature of Notice, Report, or Other Data		11. SEC., T., R. M., OR BLK. AND SURVEY OR AREA Sec. 23, T-27N, R-11W	
		12. COUNTY OR PARISH San Juan	
		13. STATE New Mexico	

16. Check Appropriate Box To Indicate Nature of Notice, Report, or Other Data			
NOTICE OF INTENTION TO:		SUBSEQUENT REPORT OF:	
TEST WATER SHUT-OFF <input type="checkbox"/>	PULL OR ALTER CASING <input type="checkbox"/>	WATER SHUT-OFF <input type="checkbox"/>	REPAIRING WELL <input type="checkbox"/>
FRACTURE TREAT <input type="checkbox"/>	MULTIPLE COMPLETE <input type="checkbox"/>	FRACTURE TREATMENT <input type="checkbox"/>	ALTERING CASING <input type="checkbox"/>
SHOOT OR ACIDIZE <input type="checkbox"/>	ABANDON* <input type="checkbox"/>	SHOOTING OR ACIDIZING <input type="checkbox"/>	ABANDONMENT* <input checked="" type="checkbox"/>
REPAIR WELL <input type="checkbox"/>	CHANGE PLANS <input type="checkbox"/>	(Other) <input type="checkbox"/>	(Other) <input type="checkbox"/>
(Note: Report results of multiple completion on Well Completion or Recompletion Report and Log form.)			
17. DESCRIBE PROPOSED OR COMPLETED OPERATIONS (Clearly state all pertinent details, and give pertinent dates, including estimated date of starting any proposed work. If well is directionally drilled, give subsurface locations and measured and true vertical depths for all markers and zones pertinent to this work.)			

8-19-85 Move in rig, rig up, fish 1½" tubing out of hole (1 day), replace 3 bad jt's
Spot 30 sx plug 6420-6633 circulate hole with 9.5# mud
Spot 10 sx plug @ 5547-5677, squeeze 30 sx plug into Mesa Verde @ 2958-3020'
Spot 10 sx plug in casing 2940-3070'
Spot 25 sx plug 1707 to 2092'
Shoot casing and recover 1072' 4½" casing
Trip in hole with tubing, spot 50 sacks plug in casing stub and over
Ojo Alamo.
Spot 50 sx plug @ 142 to 242'
Spot 10 sx surface plug and install dry hole marker
Clean up location 8-23-85.

RECEIVED
AUG 27 1985
OIL CON. DIV.
DIST. 3

18. I hereby certify that the foregoing is true and correct		APPROVED	
SIGNED <u>John B. Thelitz</u>	TITLE Asst. Superintendent	DATE August 22	1985
(This space for Federal or State office use)			
APPROVED BY _____	TITLE _____		
CONDITIONS OF APPROVAL, IF ANY:			

*See Instructions on Reverse Side

AUG 26 1985
John B. Thelitz
AREA MANAGER
FARMINGTON RESOURCE AREA

Title 18 U.S.C. Section 1001, makes it a crime for any person knowingly and willfully to make to any department or agency of the United States any false, fictitious or fraudulent statements or representations as to any matter within its jurisdiction.