

SHELL OIL COMPANY

WESTERN DIVISION
P. O. BOX 1509
MIDLAND, TEXAS 79704

September 21, 1967

Re: Application for Exception
to Rule 309-A

New Mexico Oil Conservation Commission
P. O. Box 2088
Santa Fe, New Mexico 87501

014 116

Gentlemen:

Shell Oil Company hereby makes application for administrative approval to commingle before marketing production from the Hodges-Federal "A" (Section 27, T-8-S, R-30-E) and Hodges-Federal "B" (W/2, Section 34, T-8-S, R-30-E) Leases, Cato Field, Chaves County, New Mexico.

We propose to commingle the two leases without separately metering production from each lease as both leases are filed under State No. NM-3519 and royalty interests are common throughout. Allocation of production from each well and each lease will be based on monthly well tests.

All wells produce from the same formation with similar gravity; therefore, no change in the commercial value of the production is anticipated.

Attached for your consideration are a lease plat, schematic diagram of the proposed installation, and letters from all parties owning an interest in the leases and the purchaser of the production consenting to the proposed commingling. If additional information is required, please contact this office.

Yours very truly,

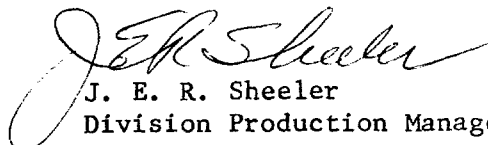
J. E. R. Sheeler
Division Production Manager

RJC:CW

Attachments

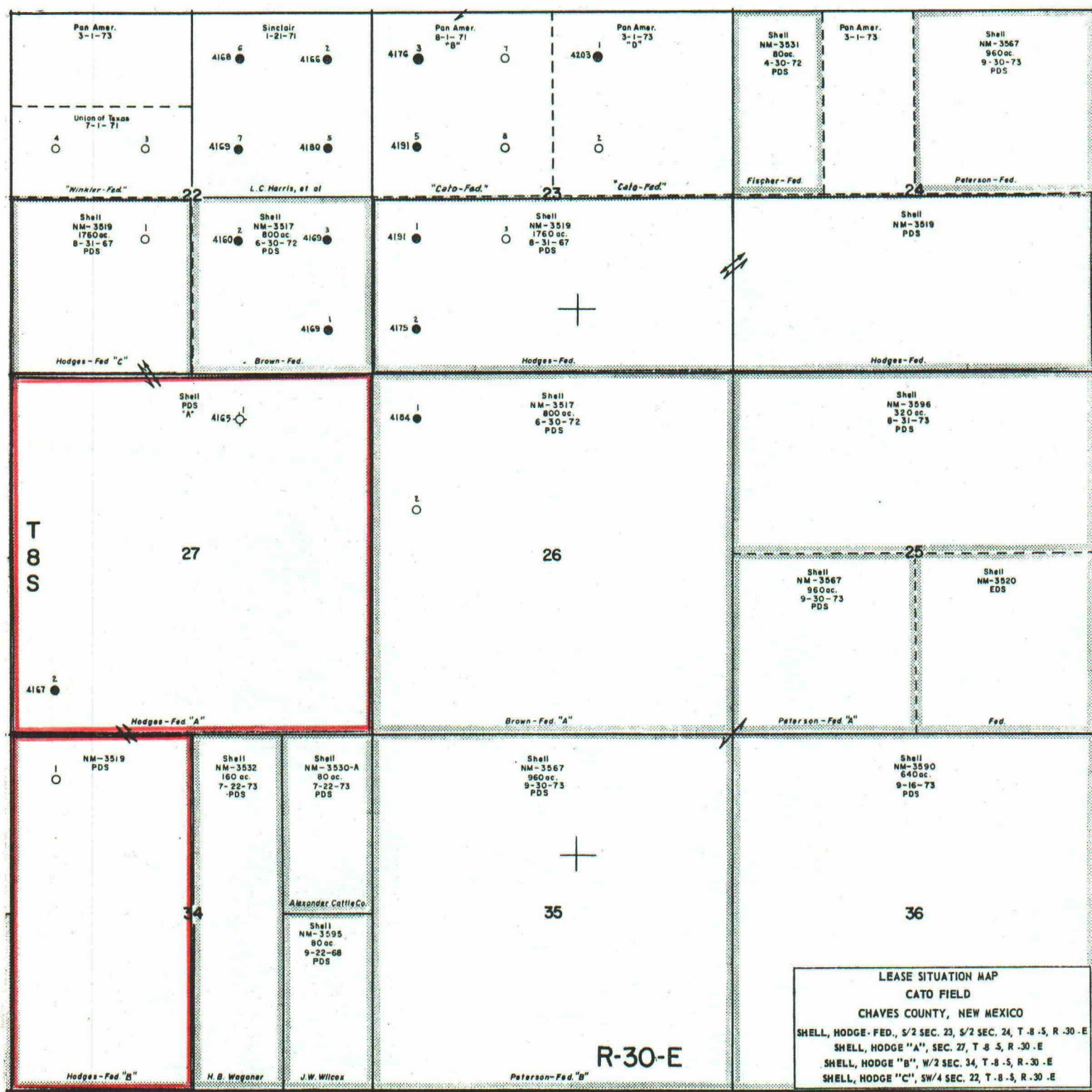

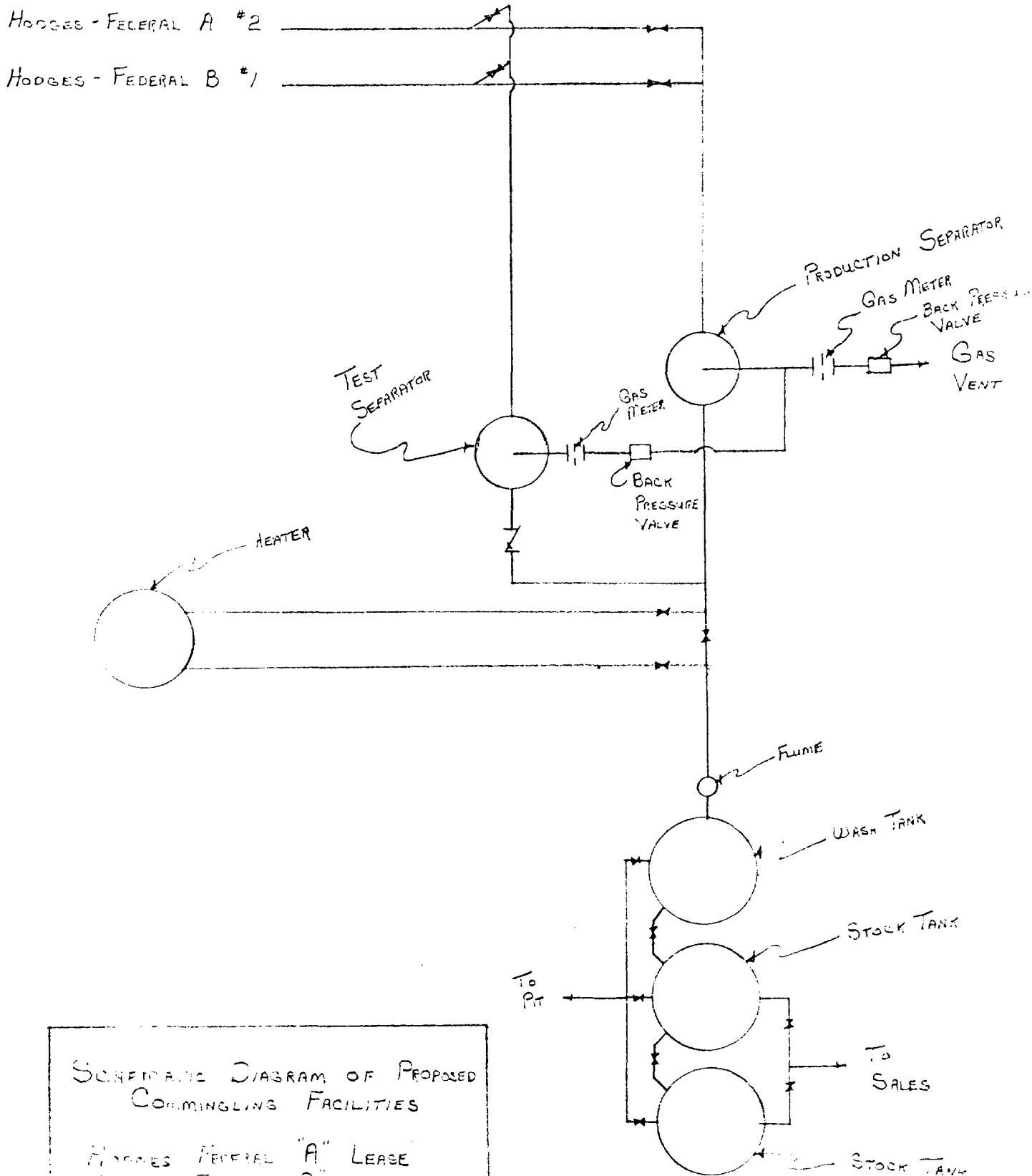

SCHEMATIC DIAGRAM OF PROPOSED
COMMINGLING FACILITIES

HODGES FEDERAL "A" LEASE
HODGES FEDERAL "B" LEASE

CATO FIELD

CHARLES COUNTY, NEW MEXICO

Mu 3-1092

September 7, 1967

Address reply to:
414 Mid America Bldg.
Midland, Texas 79701

Shell Oil Company
Houston-Midland Raw Material Supply
Box 1509
Midland, Texas 79701

Reference: Hodges Federal B
Hodges Federal A
Cato (San Andres)
Chaves County, N.M.

Gentlemen:

Scurlock Oil Company presently is the purchaser of production from referenced lease. This letter is intended to advise you that we have no objections to your commingling the production from these two leases into common tankage.

Please let us know if we can assist you in any way.

Very truly yours,

SCURLOCK OIL COMPANY

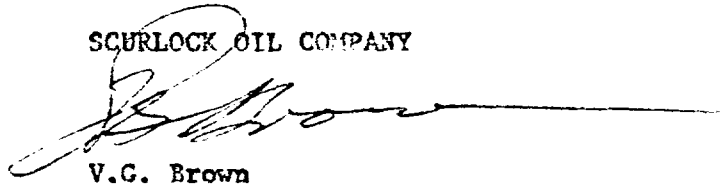
A handwritten signature in dark ink, appearing to read 'V.G. Brown', is written over the typed name. The signature is fluid and cursive, with a long horizontal stroke extending to the right.

V.G. Brown

VGB/k1 (3)

cc/Houston



UNITED STATES
DEPARTMENT OF THE INTERIOR
GEOLOGICAL SURVEY

Drawer 1857
Roswell, New Mexico 88201

September 13, 1967

Shell Oil Company
P.O. Box 1509
Midland, Texas 79701

Attention: Mr. J. E. R. Sheeler

Gentlemen:

Your application of August 30, 1967, to the Bureau of Land Management, Santa Fe, New Mexico requesting approval to commingle production on Federal leasehold New Mexico 022636 has been referred to this office.

Your application advises that Shell has designated various portions of lease New Mexico 022636 as the Hodge-Federal, Hodge-Federal A, B, and C and you are requesting approval to commingle San Andres production from these portions of the leasehold. Although Shell has given the lease separate designations, it still remains one Federal lease and approval to commingle production from a single formation on one Federal leasehold is not required.

This office has no objection to commingling San Andres production from the portions of leasehold New Mexico 022636 Shell has designated as the Hodge-Federal and Hodge-Federal A, B, and C.

Sincerely yours,

BILLY J. SHOGER
Acting Oil and Gas Supervisor



SHELL OIL COMPANY

WESTERN DIVISION

P. O. BOX 1509

MIDLAND, TEXAS 79704

August 30, 1967

Re: Hodge-Federal Lease, S 1/2
Section 23 and S 1/2 Section 24
Hodge-Federal "A" Lease, Section 27
Hodge-Federal "B" Lease W 1/2 Section 24
Hodge-Federal "C" Lease SW 1/4 Section 22
T-8-S, R-30-E
Chaves County, New Mexico

Mr. Emmett D. White (Blanche White)
P. O. Box 146
Roswell, New Mexico 88201

Dear Mr. White:

Shell Oil Company proposes to commingle production from the subject leases into a common tank battery. All of the leases are filed under State No. N.M. 3519 and U.S.G.S. Serial No. N.M. 022636 with common royalty interests throughout. The leases have been given separate designations within Shell Oil Company for convenience in well nomenclature.

All wells produce from the same pool with similar gravities; therefore, no change in the commercial value of the production is anticipated.

In order to support Shell's application to the New Mexico Oil Conservation Commission for approval to commingle this production, we would appreciate your indicating your approval in the space provided below and returning two copies to this office.

Yours very truly,

ORIGINAL SIGNED
BY J. E. R. SHEELER

J. E. R. Sheeler
Division Production Manager

RJC:GW

APPROVED:

By: 

Title : _____

Date: 9/1/67

100-2-110-20

SHELL OIL COMPANY

WESTERN DIVISION
P.O. BOX 1809
MIDLAND, TEXAS 79704
August 22, 1967



Re: Application for Lease, 1/1/67
Section 24, T1N, R1E, S10W, 44N
Hedge-Edwards, 1/1/67, Section 24
Hedge-Edwards, 1/1/67, Section 24
Hedge-Edwards, 1/1/67, Section 24
1-2-2, 2-30-2
Hedge County, New Mexico

Dear Sirs: (Hedge-Edwards & Co.)
Enclosed for you are two copies of a
lease application for the above described land.

Very truly yours,

Shell Oil Company proposes to lease the above described land for the purpose of exploring for and producing oil and gas thereon. The lease is being given with no known existing interests thereon. The lease has been given with no known existing interests within the Shell Oil Company for completion in the near future.

The lease is being given for the purpose of exploring for and producing oil and gas thereon. The lease is being given for the purpose of exploring for and producing oil and gas thereon.

In order to support this application to the New Mexico State Land Office, you are requested to provide this information. Please indicate your interest in the above described land and return two copies of this letter.

Yours very truly,

J. H. ...

Enclosed for you are two copies of a lease application for the above described land.

Very truly yours,

J. H. ...

Enclosed for you are two copies of a lease application for the above described land.

Very truly yours,

J. H. ...

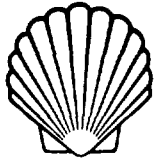

SHELL OIL COMPANY

WESTERN DIVISION
P. O. BOX 1509
MIDLAND, TEXAS 79704

August 30, 1967

Re: Hodge-Federal Lease, S 1/2
Section 23 and S 1/2 Section 24
Hodge-Federal "A" Lease, Section 27
Hodge-Federal "B" Lease W 1/2 Section 24
Hodge-Federal "C" Lease SW 1/4 Section 22
T-8-S, R-30-E
Chaves County, New Mexico

The Blanco Company
Blanco Oil Company
P. O. Box 1150
Roswell, New Mexico 88201

Gentlemen:

Shell Oil Company proposes to commingle production from the subject leases into a common tank battery. All of the leases are filed under State No. N.M. 3519 and U.S.G.S. Serial No. N.M. 022636 with common royalty interests throughout. The leases have been given separate designations within Shell Oil Company for convenience in well nomenclature.

All wells produce from the same pool with similar gravities; therefore, no change in the commercial value of the production is anticipated.

In order to support Shell's application to the New Mexico Oil Conservation Commission for approval to commingle this production, we would appreciate your indicating your approval in the space provided below and returning two copies to this office.

Yours very truly,
ORIGINAL SIGNED
By J. E. R. SHEELER

J. E. R. Sheeler
Division Production Manager

RJC:CW

APPROVED:

THE BLANCO COMPANY

By:

Title: President

Date: 9-1-67

SHELL OIL COMPANY

WESTERN DIVISION
P. O. BOX 1502
HOUSTON, TEXAS 77001

January 1, 1961



Dear Sirs:
Enclosed for you are two copies of a letterhead memorandum dated and captioned as above. This memorandum was prepared by the Houston Office of the Western Division of the Shell Oil Company, and is being furnished to you for your information and guidance.
Very truly yours,
J. H. [Signature]

Very truly yours,
J. H. [Signature]
J. H. [Signature]
J. H. [Signature]

The following information was obtained from a review of the records of the Western Division of the Shell Oil Company, and is being furnished to you for your information and guidance. This information was obtained from a review of the records of the Western Division of the Shell Oil Company, and is being furnished to you for your information and guidance.

The following information was obtained from a review of the records of the Western Division of the Shell Oil Company, and is being furnished to you for your information and guidance. This information was obtained from a review of the records of the Western Division of the Shell Oil Company, and is being furnished to you for your information and guidance.

Very truly yours,
J. H. [Signature]

Very truly yours,
J. H. [Signature]

~~CONFIDENTIAL~~

Very truly yours,
J. H. [Signature]

Very truly yours,
J. H. [Signature]

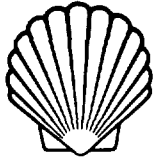

SHELL OIL COMPANY

WESTERN DIVISION
P. O. BOX 1509
MIDLAND, TEXAS 79704

August 30, 1967

Re: Hodge⁵ Federal Lease, S 1/2
Section 23 and S 1/2 Section 24
Hodge⁵ Federal "A" Lease, Section 27
Hodge⁵ Federal "B" Lease W 1/2 Section 34
Hodge⁵ Federal "C" Lease SW 1/4 Section 22
T-8-S, R-30-E
Chaves County, New Mexico

Mr. L. B. Hodge⁵
P. O. Box ~~671~~ 489
Roswell, New Mexico 88201

Dear Mr. Hodge⁵:

Shell Oil Company proposes to commingle production from the subject leases into a common tank battery. All of the leases are filed under State No. N.M. 3519 and U.S.G.S Serial No. N.M. 022636 with common royalty interests throughout. The leases have been given separate designations within Shell Oil Company for convenience in well nomenclature.

All wells produce from the same pool with similar gravities; therefore, no change in the commercial value of the production is anticipated.

In order to support Shell's application to the New Mexico Oil Conservation Commission for approval to commingle this production, we would appreciate your indicating your approval in the space provided below and returning two copies to this office.

Yours very truly,
ORIGINAL SIGNED
By J. E. R. SHEELER

J. E. R. Sheeler
Division Production Manager

RJC:CW

APPROVED:

By: L. B. Hodge

Title: _____

Date: 9-1-67

L. B. Hodge⁵
P. O. Box 489
Roswell, N. M. 88201

SHELL OIL COMPANY

WESTERN DIVISION
P.O. BOX 1809
MIDLAND, TEXAS 79704

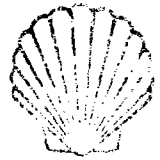

March 11, 1967

Mr. J. B. Shearer
Western Division
P.O. Box 1809
Midland, Texas 79704
Dear Mr. Shearer:

Enclosed for you are two copies of a letterhead memorandum (LHM) dated and captioned as above.

Very truly yours,

Shell Oil Company proposes to construct a new production well in the Permian Basin, Texas, and to operate the same. The proposed well is located in the Permian Basin, Texas, and is situated on the land owned by the Permian Basin Production Company. The proposed well is to be drilled and operated in accordance with the provisions of the Permian Basin Production Company's operating agreement. The proposed well is to be drilled and operated in accordance with the provisions of the Permian Basin Production Company's operating agreement. The proposed well is to be drilled and operated in accordance with the provisions of the Permian Basin Production Company's operating agreement.

All wells produce from the same pool with similar geology. Therefore, no change in the commercial value of the production is anticipated.

In view of the fact that the proposed well is situated on the land owned by the Permian Basin Production Company, and that the proposed well is to be drilled and operated in accordance with the provisions of the Permian Basin Production Company's operating agreement, it is recommended that the proposed well be drilled and operated in accordance with the provisions of the Permian Basin Production Company's operating agreement.

Very truly yours,
J. B. Shearer
Western Division

J. B. Shearer
Western Division

Enclosed for you are two copies of a letterhead memorandum (LHM) dated and captioned as above.

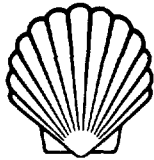

SHELL OIL COMPANY

WESTERN DIVISION
P. O. BOX 1509
MIDLAND, TEXAS 79704

August 30, 1967

Re: Hodge-Federal Lease, S 1/2
Section 23 and S 1/2 Section 24
Hodge-Federal "A" Lease, Section 27
Hodge-Federal "B" Lease W 1/2 Section 24
Hodge-Federal "C" Lease SW 1/4 Section 22
T-8-S, R-30-E
Chaves County, New Mexico

Mr. L. H. Tyson
401 Wilkinson Foster Building
Midland, Texas 79701

Dear Mr. Tyson:

Shell Oil Company proposes to commingle production from the subject leases into a common tank battery. All of the leases are filed under State No. N.M. 3519 and U.S.G.S. Serial No. N.M. 022636 with common royalty interests throughout. The leases have been given separate designations within Shell Oil Company for convenience in well nomenclature.

All wells produce from the same pool with similar gravities; therefore, no change in the commercial value of the production is anticipated.

In order to support Shell's application to the New Mexico Oil Conservation Commission for approval to commingle this production, we would appreciate your indicating your approval in the space provided below and returning two copies to this office.

Yours very truly,

ORIGINAL SIGNED
By J. E. R. SHEELER

J. E. R. Sheeler
Division Production Manager

RJC:CW

APPROVED:

By: _____

Title: _____

Date: _____

YHAFMOD JIC 1342

WESTERN DIVISION
500 BOLLING
WASHINGTON, D.C. 20340
1964



1. The purpose of this document is to provide information regarding the activities of the Western Division, U.S. Army, in the field of international relations. This document is intended for the use of the Western Division, U.S. Army, and its constituent organizations. It is not to be distributed outside the Western Division, U.S. Army, without the approval of the Western Division, U.S. Army, and its constituent organizations.

2. The Western Division, U.S. Army, is the largest and most active of the three major divisions of the U.S. Army. It is responsible for the training and equipping of the U.S. Army's combat forces, and for the maintenance of the U.S. Army's combat readiness.

3. The Western Division, U.S. Army, is composed of the following organizations:

4. The Western Division, U.S. Army, is the largest and most active of the three major divisions of the U.S. Army. It is responsible for the training and equipping of the U.S. Army's combat forces, and for the maintenance of the U.S. Army's combat readiness. The Western Division, U.S. Army, is composed of the following organizations:

5. The Western Division, U.S. Army, is the largest and most active of the three major divisions of the U.S. Army. It is responsible for the training and equipping of the U.S. Army's combat forces, and for the maintenance of the U.S. Army's combat readiness. The Western Division, U.S. Army, is composed of the following organizations:

6. The Western Division, U.S. Army, is the largest and most active of the three major divisions of the U.S. Army. It is responsible for the training and equipping of the U.S. Army's combat forces, and for the maintenance of the U.S. Army's combat readiness. The Western Division, U.S. Army, is composed of the following organizations:

7. The Western Division, U.S. Army, is the largest and most active of the three major divisions of the U.S. Army. It is responsible for the training and equipping of the U.S. Army's combat forces, and for the maintenance of the U.S. Army's combat readiness. The Western Division, U.S. Army, is composed of the following organizations:

8. The Western Division, U.S. Army, is the largest and most active of the three major divisions of the U.S. Army. It is responsible for the training and equipping of the U.S. Army's combat forces, and for the maintenance of the U.S. Army's combat readiness. The Western Division, U.S. Army, is composed of the following organizations:

9. The Western Division, U.S. Army, is the largest and most active of the three major divisions of the U.S. Army. It is responsible for the training and equipping of the U.S. Army's combat forces, and for the maintenance of the U.S. Army's combat readiness. The Western Division, U.S. Army, is composed of the following organizations:

10. The Western Division, U.S. Army, is the largest and most active of the three major divisions of the U.S. Army. It is responsible for the training and equipping of the U.S. Army's combat forces, and for the maintenance of the U.S. Army's combat readiness. The Western Division, U.S. Army, is composed of the following organizations:

11. The Western Division, U.S. Army, is the largest and most active of the three major divisions of the U.S. Army. It is responsible for the training and equipping of the U.S. Army's combat forces, and for the maintenance of the U.S. Army's combat readiness. The Western Division, U.S. Army, is composed of the following organizations:

12. The Western Division, U.S. Army, is the largest and most active of the three major divisions of the U.S. Army. It is responsible for the training and equipping of the U.S. Army's combat forces, and for the maintenance of the U.S. Army's combat readiness. The Western Division, U.S. Army, is composed of the following organizations:

13. The Western Division, U.S. Army, is the largest and most active of the three major divisions of the U.S. Army. It is responsible for the training and equipping of the U.S. Army's combat forces, and for the maintenance of the U.S. Army's combat readiness. The Western Division, U.S. Army, is composed of the following organizations:

14. The Western Division, U.S. Army, is the largest and most active of the three major divisions of the U.S. Army. It is responsible for the training and equipping of the U.S. Army's combat forces, and for the maintenance of the U.S. Army's combat readiness. The Western Division, U.S. Army, is composed of the following organizations: