

SHELL OIL COMPANY

WESTERN DIVISION
P. O. BOX 1509
MIDLAND, TEXAS 79701

December 5, 1967

Subject: Application for
Exception to Rule 309-B

CTE-179

MAIN OFFICE UNIT

New Mexico Oil Conservation Commission
P. O. Box 2088
Santa Fe, New Mexico 87501

'67 DEC 7 AM 8 34

Gentlemen:

Shell Oil Company hereby makes application for administrative approval to commingle before marketing production from the Amco Federal (S 1/2, NW 1/4, and W 1/2 of NE 1/4, Section 33, T-8-S, R-30-E) and Amco Federal "A" (N 1/2 Section 4, T-9-S, R-30-E) Leases, Cato Field, Chaves County, New Mexico.

We propose to commingle the two leases without separately metering production from each lease as both leases are filed under State No. NM 3513 and royalty interests are common throughout. Allocation of production from each well and each lease will be based on monthly well tests.

All wells produce from the same zone with similar gravities; therefore, no change in the commercial value of the production is anticipated.

Attached for your consideration are a lease plat, schematic diagram of the proposed installation, and letters from all parties owning an interest in the leases and the purchaser of the production consenting to the proposed commingling. If additional information is required, please contact this office.

Yours very truly,

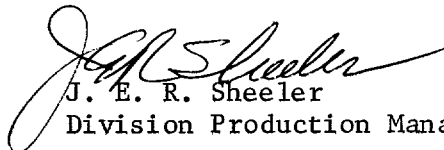
J. E. R. Sheeler
Division Production Manager

Attachments

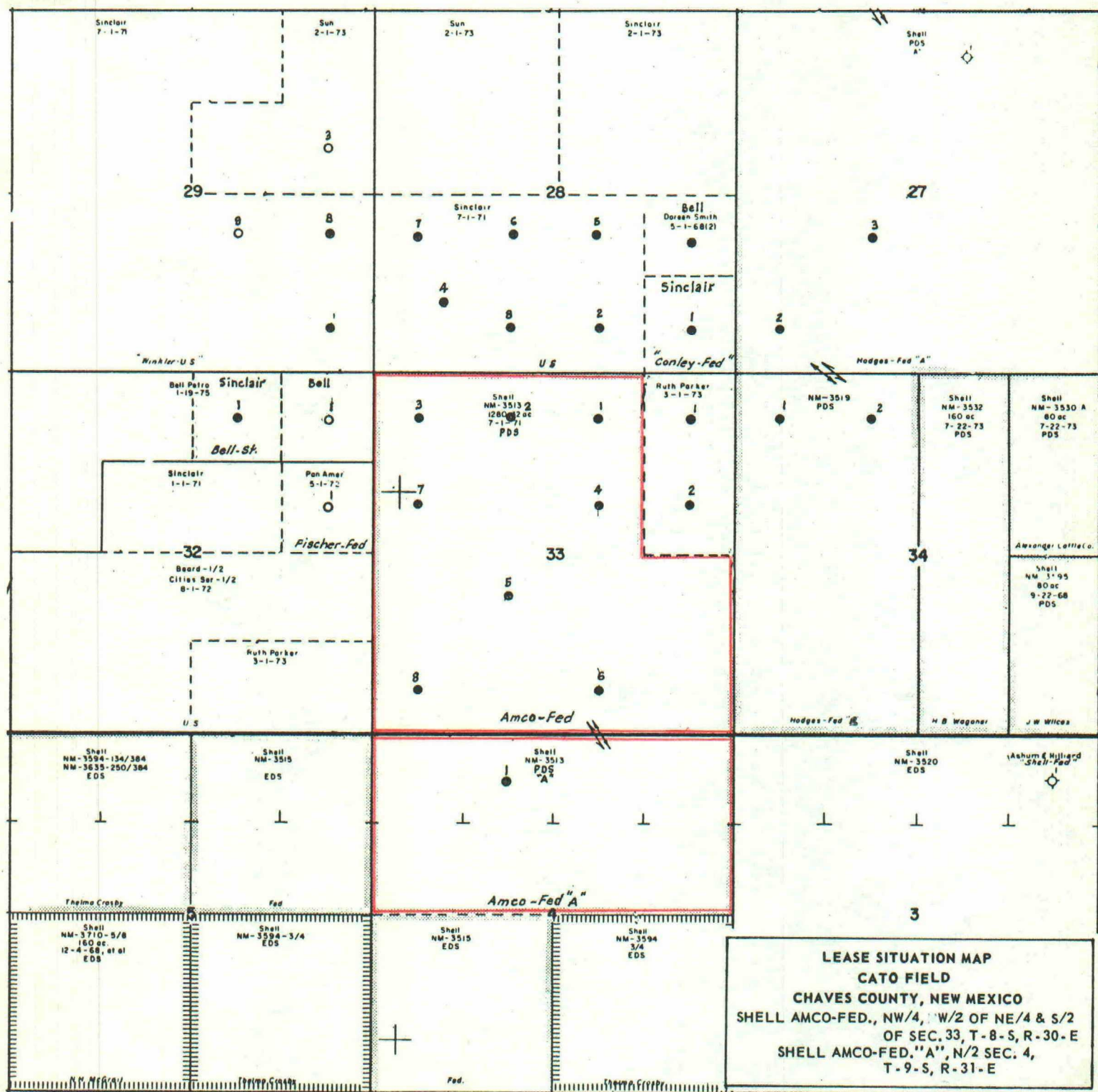

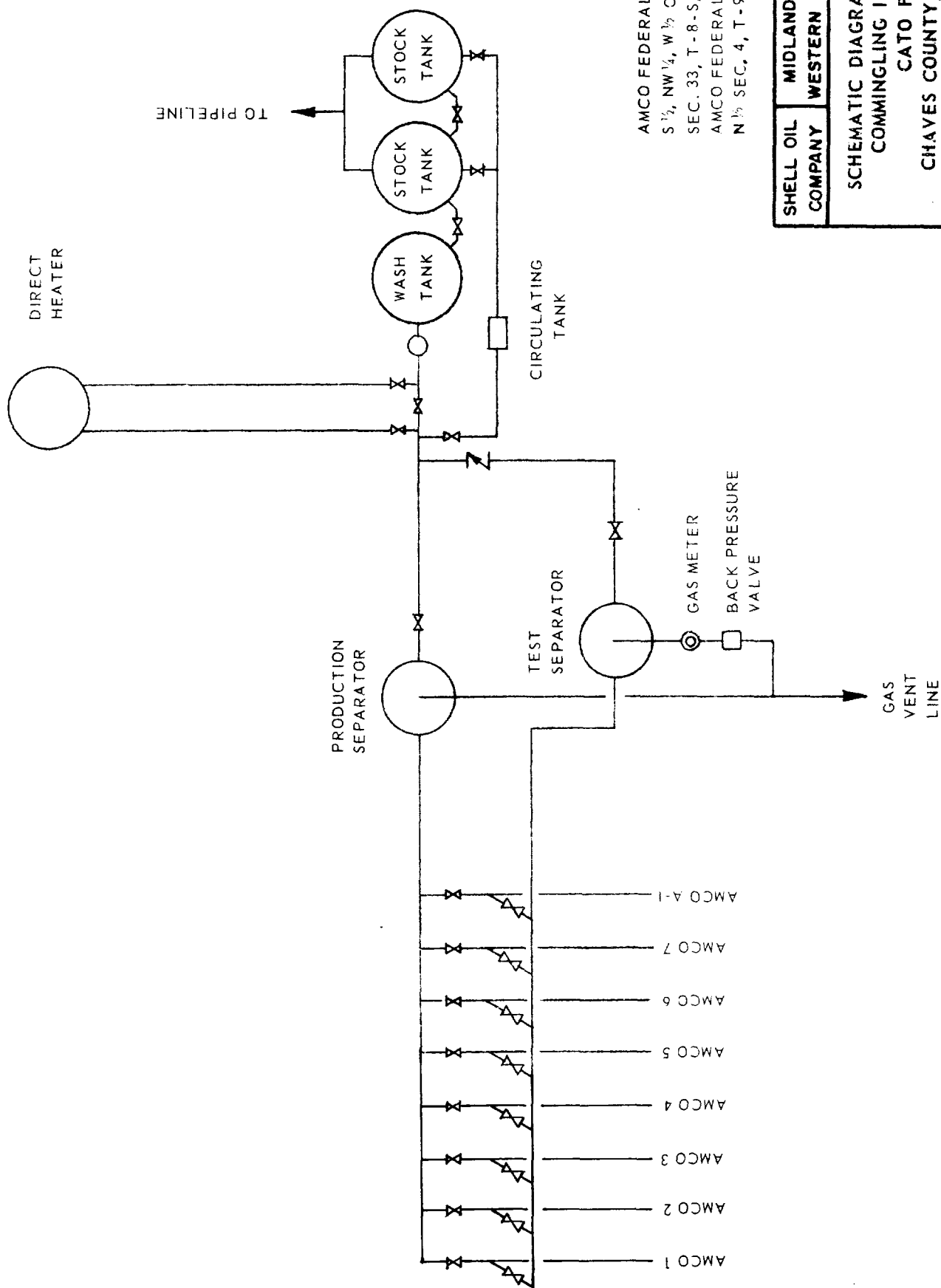

AMCO FEDERAL LEASE
 S $\frac{1}{2}$, NW $\frac{1}{4}$, W $\frac{1}{2}$ OF NE $\frac{1}{4}$
 SEC. 33, T-8-S, R-30-E
 AMCO FEDERAL "A" LEASE
 N $\frac{1}{2}$ SEC. 4, T-9-S, R-30-E

SHELL OIL COMPANY	MIDLAND AREA WESTERN DIVISION	PRODUCTION DEPARTMENT
SCHEMATIC DIAGRAM OF PROPOSED COMMINGLING INSTALLATION CATO FIELD CHAVES COUNTY, NEW MEXICO		
Des: R. J. C.	Date: 12-5-67	
Scale: NONE	Dwg. No. 3056 - A	

[illegible]



UNITED STATES
DEPARTMENT OF THE INTERIOR
GEOLOGICAL SURVEY

Drawer 1857
Roswell, New Mexico 88201

November 29, 1967

Shell Oil Company
P. O. Box 1509
Midland, Texas 79701

Attention: Mr. J. E. R. Sheeler

Gentlemen:

Your letter of November 20, 1967, requests approval to commingle production on Federal lease New Mexico 0155254-A.

Your letter advises that Shell has designated certain portions of lease New Mexico 0155254-A as the Amco Federal and Amco Federal "A" and you are requesting approval to commingle San Andres production from these portions of the lease. Although Shell has given the lease separate designations, it still remains one Federal lease and approval to commingle production from a single formation on one Federal lease is not required.

This office has no objection to commingling San Andres production from the portions of lease New Mexico 0155254-A Shell has designated as the Amco Federal and Amco Federal "A".

Sincerely yours,

CARL C. TRAYWICK
Acting Oil and Gas Supervisor

WESTERN DIVISION	
DEC 4 1967	
Product	
412	
413	
414	
415	
416	
417	
418	
419	
420	
421	
422	
423	
424	
425	
426	
427	
428	
429	
430	
431	
432	
433	
434	
435	
436	
437	
438	
439	
440	
441	
442	
443	
444	
445	
446	
447	
448	
449	
450	
451	
452	
453	
454	
455	
456	
457	
458	
459	
460	
461	
462	
463	
464	
465	
466	
467	
468	
469	
470	
471	
472	
473	
474	
475	
476	
477	
478	
479	
480	
481	
482	
483	
484	
485	
486	
487	
488	
489	
490	
491	
492	
493	
494	
495	
496	
497	
498	
499	
500	

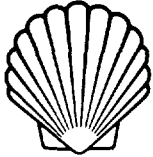

SHELL OIL COMPANY

WESTERN DIVISION
P. O. BOX 1509
MIDLAND, TEXAS 79701

December 5, 1967

Subject: Application for
Exception to Rule 309-B

New Mexico Oil Conservation Commission
P. O. Box 2088
Santa Fe, New Mexico 87501

Gentlemen:

MAIN OFFICE 040

Shell Oil Company hereby makes application for administrative approval to commingle before marketing production from the Amco Federal (S 1/2, NW 1/4, and W 1/2 of NE 1/4, Section 33, T-8-S, R-30-E) and Amco Federal "A" (N 1/2 Section 4, T-9-S, R-30-E) Leases, Cato Field, Chaves County, New Mexico.

67 DEC 7 AM 8 34

We propose to commingle the two leases without separately metering production from each lease as both leases are filed under State No. NM 3513 and royalty interests are common throughout. Allocation of production from each well and each lease will be based on monthly well tests.

All wells produce from the same zone with similar gravities; therefore, no change in the commercial value of the production is anticipated.

Attached for your consideration are a lease plat, schematic diagram of the proposed installation, and letters from all parties owning an interest in the leases and the purchaser of the production consenting to the proposed commingling. If additional information is required, please contact this office.

Yours very truly,

J. E. R. Sheeler
Division Production Manager

Attachments

SHELL OIL COMPANY

WESTERN DIVISION
P.O. BOX 1000
MIDLAND, TEXAS 79701



Dear Mr. [Name]:

Enclosed for you are two copies of a report on the progress of our research and development work in the field of [Topic].

We are pleased to inform you that our research and development work in the field of [Topic] has been completed. The results of our work are set forth in the report enclosed for you.

Sincerely,
[Name]

21 DEC 7 4 18 PM '68

Enclosed for you are two copies of a report on the progress of our research and development work in the field of [Topic]. The report contains a detailed description of the work that has been done and the results that have been obtained. It also contains a list of references and a list of figures.

We are pleased to inform you that our research and development work in the field of [Topic] has been completed. The results of our work are set forth in the report enclosed for you. The report contains a detailed description of the work that has been done and the results that have been obtained. It also contains a list of references and a list of figures.

We are pleased to inform you that our research and development work in the field of [Topic] has been completed. The results of our work are set forth in the report enclosed for you. The report contains a detailed description of the work that has been done and the results that have been obtained. It also contains a list of references and a list of figures.

We are pleased to inform you that our research and development work in the field of [Topic] has been completed. The results of our work are set forth in the report enclosed for you. The report contains a detailed description of the work that has been done and the results that have been obtained. It also contains a list of references and a list of figures.

Very truly yours,
[Name]

[Signature]

Enclosed for you are two copies of a report on the progress of our research and development work in the field of [Topic].

Enclosed for you are two copies of a report on the progress of our research and development work in the field of [Topic].

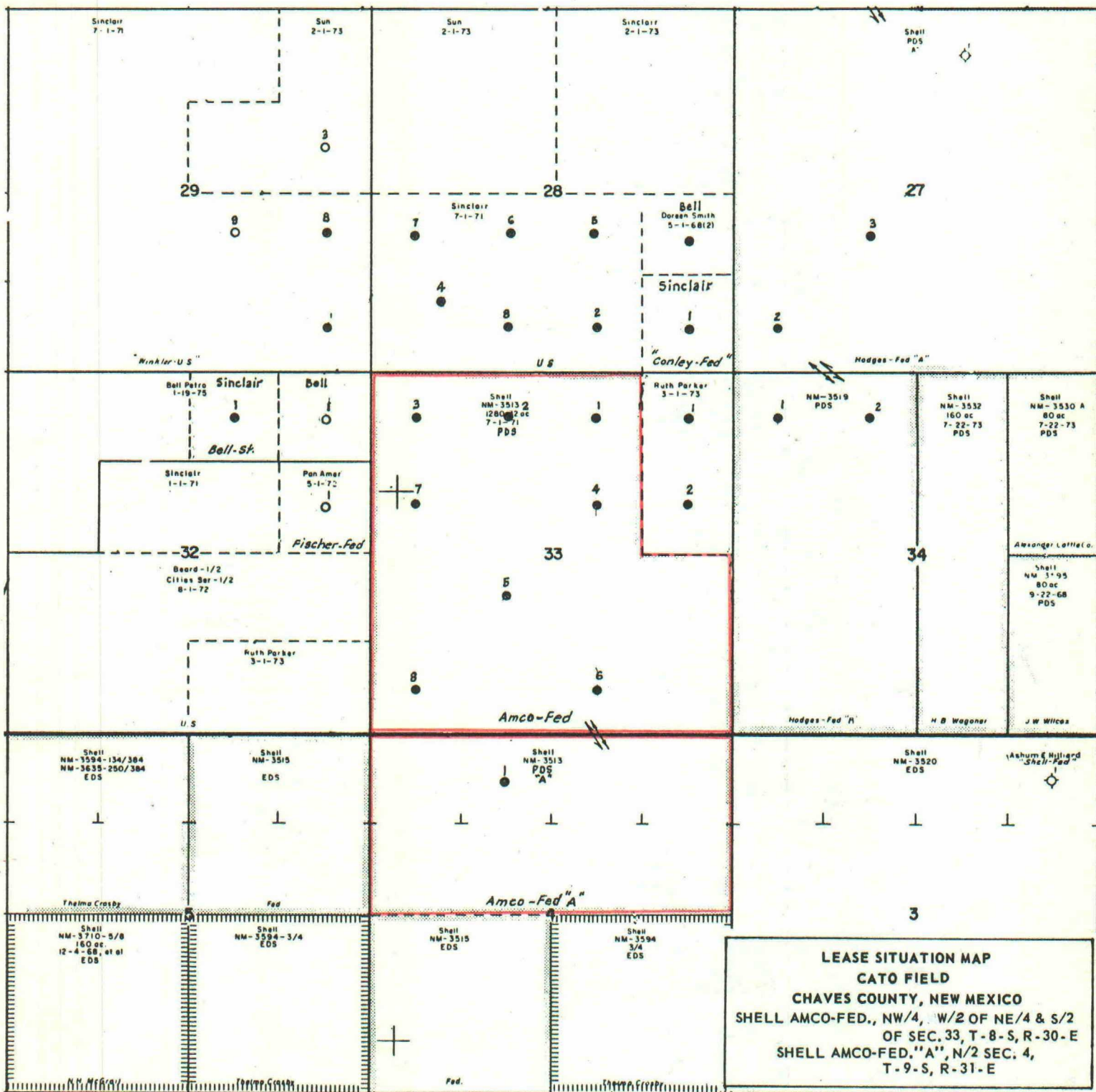

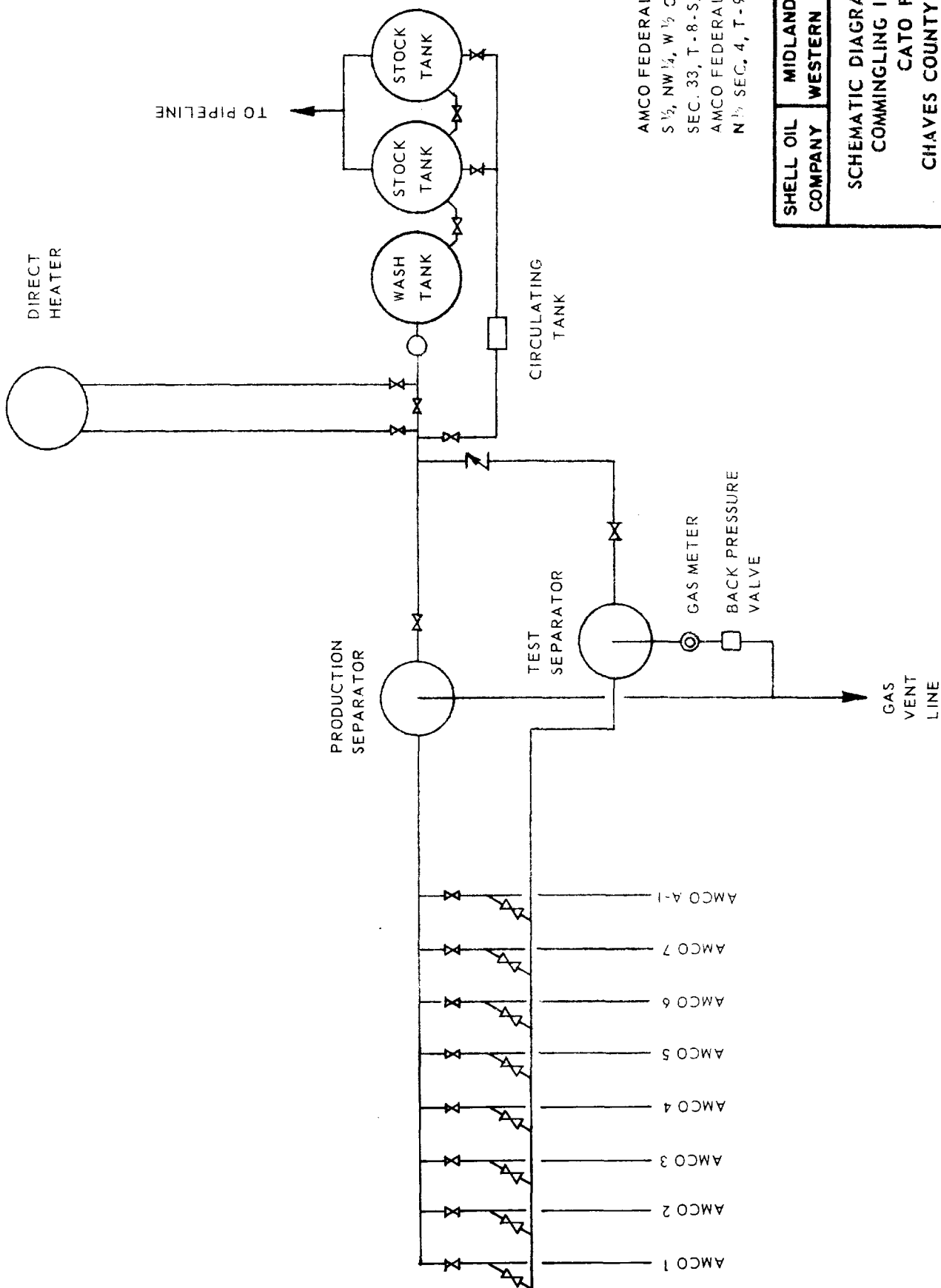

AMCO FEDERAL LEASE
 S 1/2, NW 1/4, W 1/2 OF NE 1/4
 SEC. 33, T-8-S, R-30-E
 AMCO FEDERAL "A" LEASE
 N 1/2 SEC. 4, T-9-S, R-30-E

SHELL OIL COMPANY	MIDLAND AREA WESTERN DIVISION	PRODUCTION DEPARTMENT
SCHEMATIC DIAGRAM OF PROPOSED COMMINGLING INSTALLATION		
CATO FIELD		
CHAVES COUNTY, NEW MEXICO		
Des: R. J. C.	Date: 12-5-67	
Scale: NONE	Dwg. No. 3056-A	

1/130
Plo handle
PR 22