

CODES OF SERVICE

This is a fast message unless its deferred character is indicated by the proper symbol.

WESTERN UNION TELEGRAM

W. P. MARSHALL
CHAIRMAN OF THE BOARD

R. W. McFALL
PRESIDENT

STAMPS	
DL	Day Letter
NL	Night Letter
LT	International Letter Telegram

The filing time shown in the date line on domestic telegrams is LOCAL TIME at point of origin. Time of receipt is LOCAL TIME at point of destination.

LA027 NSC165

1968 MAY 20 AM 10

(1055)

NS FWA173 PD 2 EXTRA=FAX FORT WORTH TEX 20 1049A CDT=
DAN S NUTTER, CHIEF ENGINEER, OIL CONSERVATION COMMISSION=
ROOM 206 STATE LAND OFFICE BLDG SANTA FE NMEX=

AS TRUSTEE FOR THE OVERRIDING ROYALTY INT UNDER
STATE OF NEW MEXICO LSES NOS E-881, B-2516 AND K-5636
WE HAVE NO OBJECTION TO COMINGLING OF PROD FROM
SHENANDOANS STATE CITY WELL WITH THE AFORENAMED PROPERTIES
AND THE ALLOCATION OF PROD TO SHENANDOANS STATE CITY WELL
ON THE BASIS OF A MONTHLY PROD TEST=

R E CRAWFORD TRUST DEPT THE FIRST NATIONAL BANK
OF FT WORTH=

MAIN OFFICE 010

02 MAY 20 AM 10 09

MAIN OFFICE 010

02 MAY 20 AM 10 21

2

SHENANDOAH OIL CORPORATION

1018 COMMERCE BUILDING
FORT WORTH, TEXAS 76102

B. J. KELLENBERGER
PRESIDENT

TELEPHONE
ED 2-7381

May 27, 1969

Mr. Guyton B. Hayes
Commissioner of Public Lands
State of New Mexico
P. O. Box 1148
Santa Fe, New Mexico 87501

Mr. A. L. Porter, Jr.
Secretary-Director, Oil Conservation Comm.
P. O. Box 2088
Santa Fe, New Mexico 87501

Re: Shenandoah Flood No. 1
Request for Amendment of CTB 185
to Include S/2 NW/4 Sec. 9,
T17S-R33E, Lea County, New Mexico

Gentlemen:

This CTB-185 designation is in accordance with designation made in your letter of May 20, 1968. Attached hereto is up to date plat that shows all properties connected to this commingled battery as of this date, and which you will note also includes the 80 acres, S/2 NW/4 Sec. 9, T17S-R33E, which is the subject of this amendment request.

In connection with our request for commingling permit CTB-185 to include the S/2 NW/4 of Section 9, we wish to advise you as follows:

- (1) Attached hereto as Exhibit "A" is a plat which shows the location of said leases, well, flow lines and common tankage.
- (2) Attached hereto as Exhibit "B" is a list of the lease area by State Lease number and legal description, representing that all royalties therefrom are paid to the State of New Mexico, and there is no difference in ownership between said leases as to royalty or working interest thereunder, with the exception of an overriding royalty in the SW/4 NE/4 Section 8, T17S-R33E; and relative to this overriding royalty you have heretofore been furnished a telegram from the Trust Department of the Fort Worth National Bank of Fort Worth, Texas, waiving any objection to the commingling of production from such 40-acre tract.
- (3) All wells currently being produced by Shenandoah on these leases produce from a single common reservoir, being the Grayburg-San Andres formation.

May 27, 1969

- (4) The purpose for this request for commingling is to achieve a reduction in the cost of operation.
- (5) The State "A" producing wells 1, 5, and 7, along with the Aztec-State 1, 2, 3 and 4 and the State "C" 1-Y and the State D-2 wells are being produced into the one common tank battery that is located approximately 660' North of the State "A" 6-W injection well (See plat).
- (6) Shenandoah, at this date, has set 5½" O.D. casing in its State A-8 producing well located 990' FWL and 2310' FNL of Section 9, T17S-R33E. Enclosed herewith is a copy of Form C-102, Well location and Acreage Dedication Plat, covering this operation.

The royalty payable to the State of New Mexico will not be changed in any manner as a result of your approval of this application.

It is therefore requested that Commingling Permit CTB-185 be amended so as to include the 80 acres described in paragraph (6) above, so that Commingling Permit CTB-185 will now include the following acreage: As to State of New Mexico Lease E-881, W/2 SW/4 and SE/2 SW/4 Section 8; as to State of New Mexico Lease B-2516, N/2 NW/4 and NW/4 NE/4 Section 7; and S/2 NW/4, SW/4 NE/4 and N/2 NW/4 Section 8; and S/2 NW/4 Section 9; and as to State of New Mexico Lease K-5636, NE/4 NE/4 Section 7.

Very truly yours,



T. P. Bates
Vice President - Secondary Recovery

TPB:anc

Encl.

WELL LOCATION AND ACREAGE DEDICATION PLAT

Supplemental Form
Effective 1-1-65

All distances must be from the outer boundaries of the Section.

Operator Shenandoah Oil Corporation			Lease State # <u>AW</u>		Well No. 8
Unit Letter E	Section 9	Township 17 South	Range 33 East	County Lea	
Actual Footage Location of Well: 2310 feet from the North line and 990 feet from the West line					
Ground Level Elev. 4199	Producing Formation		Pool		Dedicated Acreage: 40 Acres

1. Outline the acreage dedicated to the subject well by colored pencil or hatchure marks on the plat below.
2. If more than one lease is dedicated to the well, outline each and identify the ownership thereof (both as to working interest and royalty).
3. If more than one lease of different ownership is dedicated to the well, have the interests of all owners been consolidated by communitization, unitization, force-pooling, etc?

☐ Yes ☒ No If answer is "yes," type of consolidation _____

If answer is "no," list the owners and tract descriptions which have actually been consolidated. (Use reverse side of this form if necessary.) _____

No allowable will be assigned to the well until all interests have been consolidated (by communitization, unitization, forced-pooling, or otherwise) or until a non-standard unit, eliminating such interests, has been approved by the Commission.

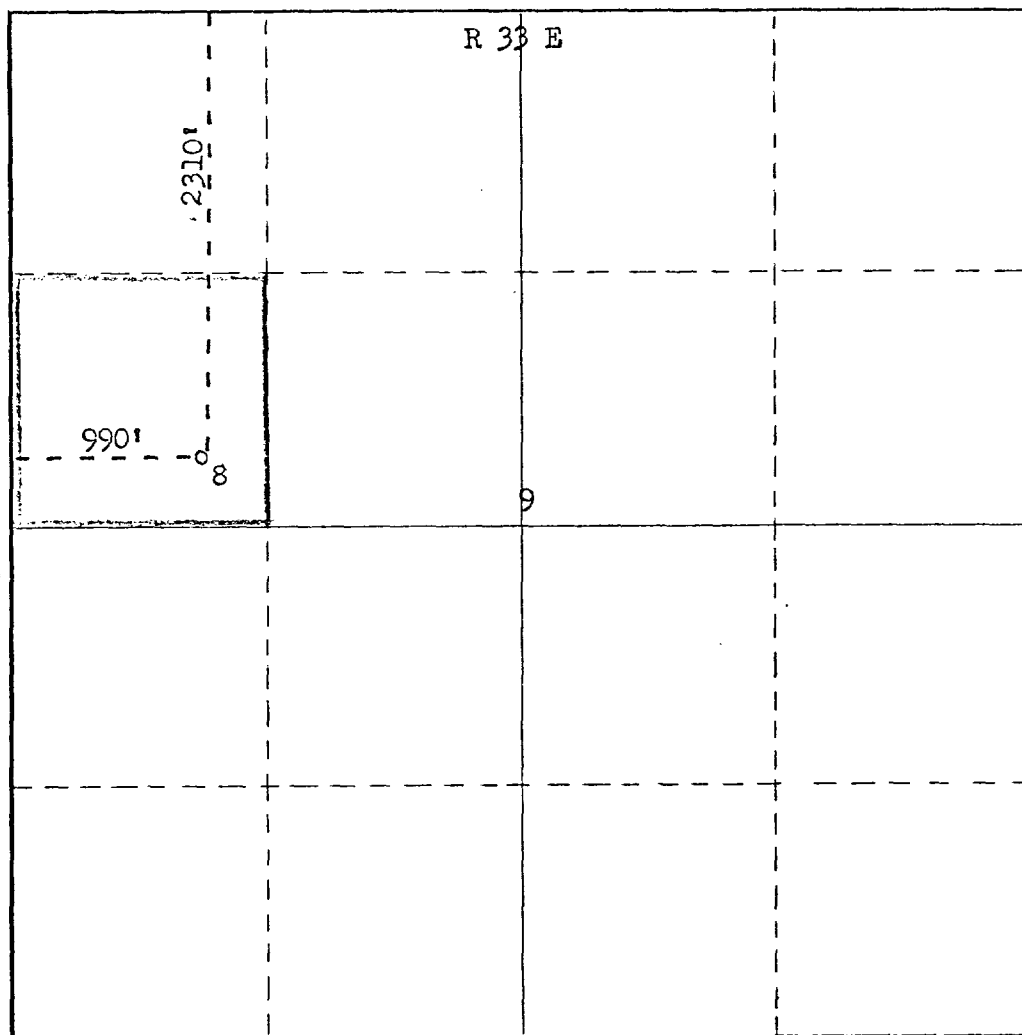

CERTIFICATION

I hereby certify that the information contained herein is true and complete to the best of my knowledge and belief.

Name
T. R. ...
Position
Vice President
Company
Shenandoah Oil Corp.
Date
May 26, 1969

I hereby certify that the well location shown on this plat was plotted from field notes of actual surveys made by me or under my supervision, and that the same is true and correct to the best of my knowledge and belief.

Date Surveyed
May, 5, 1969
Registered Professional Engineer and/or Land Surveyor
James H. ...
Certificate No.
N.M.L.S.No. 542

0 330 660 990 1320 1650 1980 2310 2640 2000 1500 1000 500

SIENANDOAH OIL CORPORATION
PRODUCING WELLS
MONTH April, 1969

MAY 22 12 29 PM '69

MAY 29 PM 3 43

Lease	Well No.	Well Location	Bbls. Oil Produced	Bbls. Water Produced	% Water Produced
Aztec	1	L 8-17-33	1,815	2,610	59
	2	M 8-17-33	1,850	0	0
	3	N 8-17-33	800	1,380	63
	4	N 8-17-33	1,150	0	0
State "A"	1	B 7-17-33	30	90	75
	5	F 8-17-33	1,300	570	30
State "A"	7	A 7-17-33	1,700	420	20
State "C"	1Y	G 8-17-33	1,467	1,260	46
State "D"	2	D 8-17-33	60	60	50
State "E"	1	A 8-17-33	105	25	19
Phillips State	1	E 16-17-33	0	0	0
	3	F 16-17-33	1,374	210	13
	4	C 16-17-33	600	120	17
	5	L 16-17-33	597	1,230	67
	6	K 16-17-33	324	0	0
	7	N 16-17-33	177	0	0
TOTALS			13,349	7,975	37

LARGE FORMAT
EXHIBIT HAS
BEEN REMOVED
AND IS LOCATED
IN THE NEXT FILE

EXHIBIT "B"

Description	Interest Covered by Lease	Acres		Burdens	Entire Royalty Payable to
		Gross	Net		
New Mexico E-881					
Insofar as said lease covers:	Full	120.00	120.00	*	St. of New Mexico
<u>T-17-S, R-33-E</u>					
Sec. 8: <u>W/2 SW/4 & SE/4 SW/4</u>					
Down to depth of 4600'					
New Mexico B-2516					
Insofar as said lease covers:	Full	121.33	121.33	*	St. of New Mexico
<u>T-17-S, R-33-E</u>					
Sec. 7: <u>NW/4 NW/4, NW/4 NE/4 & NE/4 NW/4</u>					
Down to depth of 5000'					
Sec. 8: <u>SW/4 NE/4, down to depth of 4600'</u>	Full	80.00	80.00	None	St. of New Mexico
Sec. 8: <u>S/2 NW/4, down to depth of 5000'</u>	Full	80.00	80.00	*	
Sec. 8: <u>N/2 NW/4, down to depth of 4600'</u>	Full	80.00	80.00	None	
Sec. 9: <u>S/2 NW/4, down to depth of 5000'</u>	Full	80.00	80.00	None	
New Mexico K-5636					
Insofar as said lease covers:	Full	40.00	40.00	*	St. of New Mexico
<u>T-17-S, R-33-E</u>					
Sec. 7: <u>NE/4 NE/4</u>					

MAIN OFFICE
AM
6
PM 8 21

June 5, 1969

Shenandoah Oil Corporation
1018 Commerce Building
Fort Worth, Texas 76102

Re: Shenandoah Flood No. 1
Request for Amendment of
CTB 185 to Include
S/2 NW/4, Sec. 9, T-17S, R-33E,
Lea County, New Mexico

Gentlemen:

The State Land Office has no objection to your request for commingling permit CTB-185 to include the S/2NW/4 of Section 9, Township 17 South, Range 33 East, Lea County, New Mexico, as per your request of May 27, 1969.

The Commissioner of Public Lands reserves the right to withdraw approval of this request if at any time, in his discretion, he deems this operation to be adverse to the best interests of the State of New Mexico.

Very truly yours,

TED BILBERRY, Director
Oil and Gas Department

TB:ML:v
cc: Oil Conservation Commission
Santa Fe, New Mexico

C
O
P
Y

12 8 19 2 11 11 11

11 11 11 11 11

11 11 11 11 11

11 11 11 11 11
11 11 11 11 11
11 11 11 11 11

11 11 11 11 11
11 11 11 11 11
11 11 11 11 11
11 11 11 11 11
11 11 11 11 11

11 11 11 11 11
11 11 11 11 11
11 11 11 11 11
11 11 11 11 11
11 11 11 11 11

11 11 11 11 11
11 11 11 11 11
11 11 11 11 11
11 11 11 11 11
11 11 11 11 11

11 11 11 11 11

11 11 11 11 11
11 11 11 11 11
11 11 11 11 11

11 11 11 11 11
11 11 11 11 11
11 11 11 11 11
11 11 11 11 11
11 11 11 11 11