



PC N/K

3.10.96

18 52

January 16, 1996

New Mexico Oil Conservation Division
2040 South Pacheco
PO Box 6429
Santa Fe, NM 87505

Attn: Mr. William J. LeMay
Division Director, New Mexico Conservation Division

**Re: Amendments to PC-554 and PC-582
Administrative Approval to Surface Commingle
Addition of Wantz - Abo formation to Prev. Orders
Baker "B" #17
Section 10, Tws. 22S, Rng. 37E
Lea County, New Mexico**

Dear Mr. LeMay,

Texaco Exploration and Production Inc. respectfully requests approval to administratively amend surface commingle orders PC-554 and PC-582 (both are attached) to include the Wantz - Abo formation. Texaco spudded the Baker "B" #17 December 9, 1995, and is currently testing production in the Wantz - Abo interval. It is anticipated that the new well will produce approximately 10 BOPD and 500 MCFPD. Texaco will continue to test production from commingled zones on a monthly basis and allocate using the subtraction method. The subject well is located in Unit Letter N, Section 10, Township 22S, Range 37E, Lea County, New Mexico.

Common working interest and royalties apply to all commingled zones on this Fee lease. Therefore, Texaco believes that the interests of applicable partners and royalty holders will be protected.

Attached is a plat of the subject well, a diagram of the Baker "B" facility installation, and other supporting data to this application. Please contact me at (505) 397-0426 if you have any questions concerning this application.

Thank you for your consideration of this proposal.

Sincerely,

Darrell J. Carriger
Engineering Assistant
Texaco E & P Inc.
Hobbs Operating Unit

DJC/s

Attachments

cc: Mr. Jerry Sexton Hobbs NMOCD District Supervisor

file

Daily Production Value

The following table displays the value of daily non-commingled production based on December 1995 oil prices and current well test data.

	BOPD	°API Gravity	Current \$/BBL	Daily Total value (\$)
Current lease production	14	38.6	\$17.47	\$244.58
Wantz-Abo production	10	39.4	\$17.63	\$176.30
Total	24			\$420.88

The following table displays the value of daily commingled production based on December 1995 oil prices and current well test data. ° API is calculated by taking a weighted average of the production.

	BOPD	°API Gravity	Current \$/BBL	Daily Total value (\$)
Commingled prod.	24	38.93	\$17.54	420.96
Total	24			\$420.96

Daily production will increase in value approximately 8¢/Day once production is commingled.

62700 Wantz Abo
 24170 S EUNIK SA
 6600 BUNTSKY C+G
 60240 TUBB Oil + GAS
 19190 DRINKARD

BAKER "B" FACILITY INSTALLATION

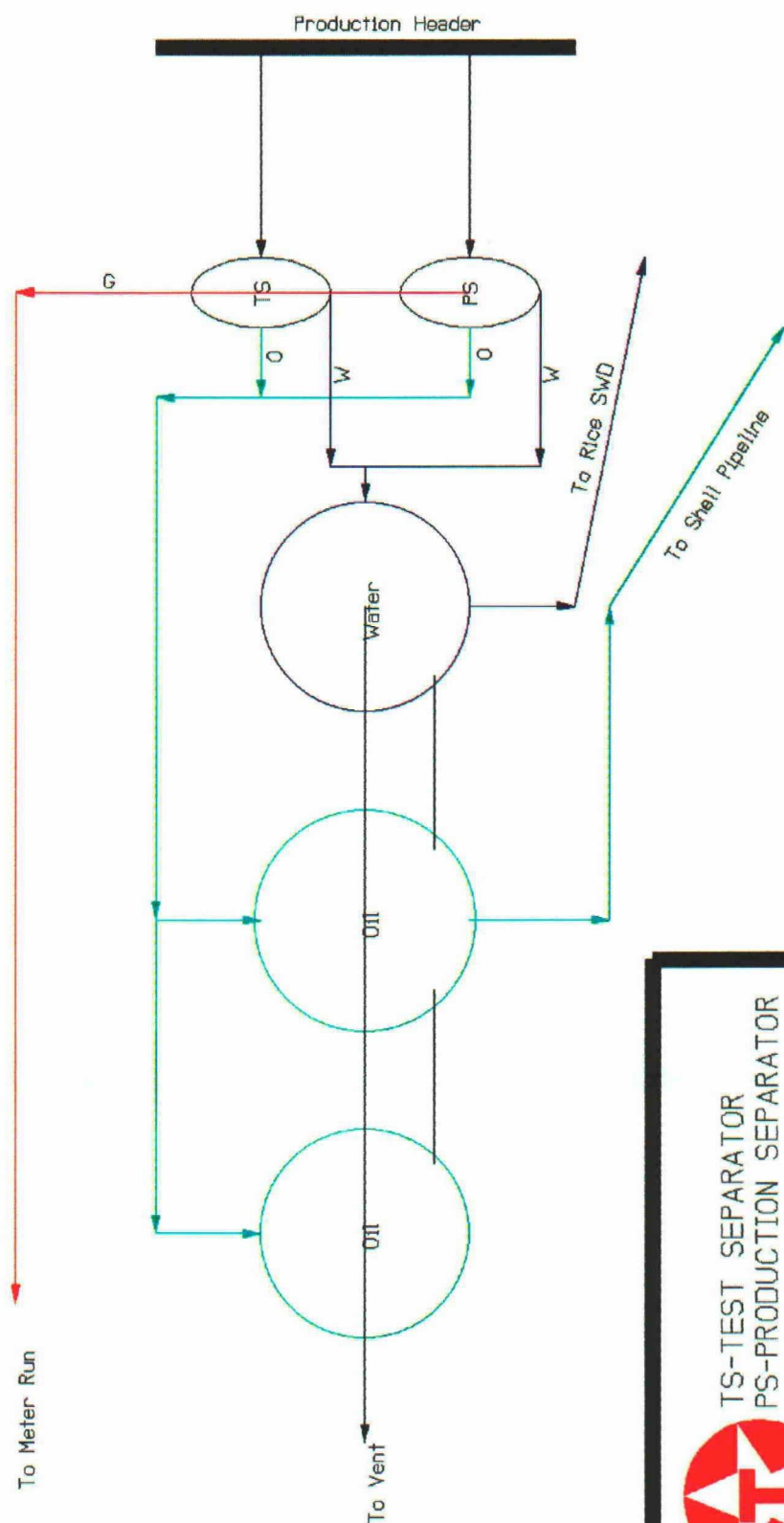

DUC 1/10/96



TS-TEST SEPARATOR
PS-PRODUCTION SEPARATOR

DISTRICT I
P. O. Box 1980, Hobbs, NM 88240

DISTRICT II
P. O. Drawer DD, Artesia, NM 88210

DISTRICT III
1000 Rio Brazos Rd., Aztec, NM 87410

DISTRICT IV
P. O. Box 2088, Santa Fe, NM 87504-2088

State of New Mexico
Energy, Minerals and Natural Resources Department

OIL CONSERVATION DIVISION

P.O. Box 2088
Santa Fe, NM 87504-2088

COPY

Form C-102
Revised February 10, 1994
Instructions on back
Submit to Appropriate District Office

State Lease-4 copies
Fee Lease-3 copies

WELL LOCATION AND ACREAGE DEDICATION PLAT

☐ AMENDED REPORT

¹ API Number		² Pool Code		³ Pool Name	
				Drinkard & Wantz ABO	
⁴ Property Code		⁵ Property Name			⁶ Well Number
10886		Baker "B"			17
⁷ OGRID No.		⁸ Operator Name			⁹ Elevation
22351		TEXACO EXPLORATION & PRODUCTION, INC.			3409'

¹⁰ Surface Location									
UL or lot no.	Section	Township	Range	Lot Idn	Feet from the	North/South line	Feet from the	East/West line	⁷ County
N	10	22-S	37-E		400'	South	1700'	West	Lea

¹¹ Bottom Hole Location If Different From Surface									
UL or lot no.	Section	Township	Range	Lot Idn	Feet from the	North/South line	Feet from the	East/West line	⁷ County
¹² Dedicated Acres		¹³ Joint or Infill		¹⁴ Consolidation Code		¹⁵ Order No.			
40									

NO ALLOWABLE WILL BE ASSIGNED TO THIS COMPLETION UNTIL ALL INTERESTS HAVE BEEN CONSOLIDATED
OR A NON-STANDARD UNIT HAS BEEN APPROVED BY THE DIVISION.

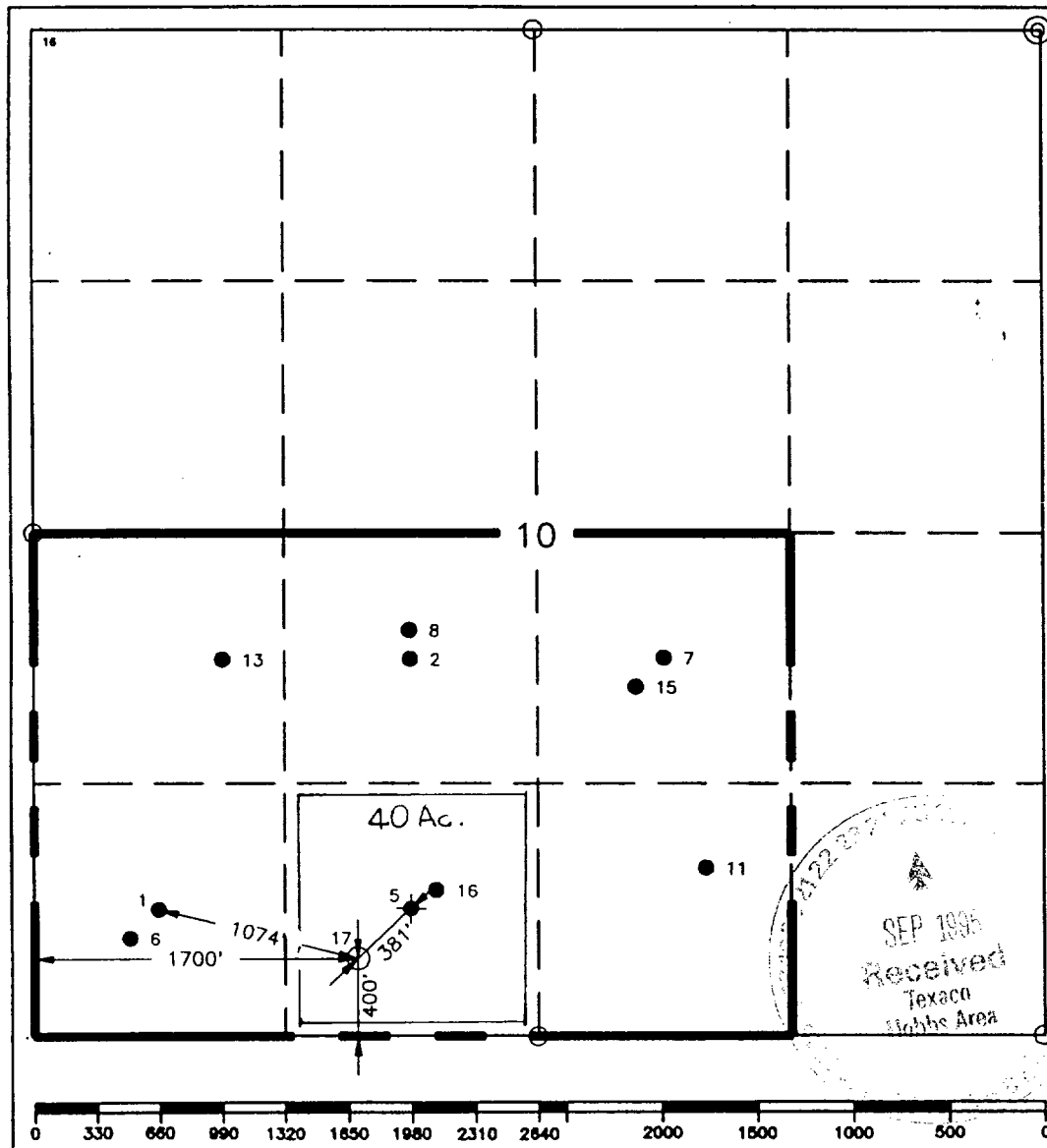

¹⁰ OPERATOR CERTIFICATION	
I hereby certify that the information contained herein is true and complete to the best of my knowledge and belief.	
Signature	<i>C. Wade Howard</i>
Printed Name	C. Wade Howard
Position	Engineer's Assistant
Company	Texaco Expl. & Prod. Inc.
Date	September 22, 1995
¹⁶ SURVEYOR CERTIFICATION	
I hereby certify that the well location shown on this plat was plotted from field notes of actual surveys made by me or under my supervision and that the same is true and correct to the best of my knowledge and belief.	
Date Surveyed	September 19, 1995
Signature & Seal of Professional Surveyor	<i>John S. Piper</i>
Certificate No.	7254 John S. Piper
Sheet	