

MURPHY H. BAXTER
507 MIDLAND NATIONAL BANK BUILDING
MIDLAND, TEXAS

August 2, 1963

149

Oil Conservation Commission
P. O. Box 871
Santa Fe, New Mexico

Re: Application for Administrative
Approval for Conversion of Two
Wells to Water Injection,
Maljamar Field, Lea County, New Mexico

Gentlemen:

As provided in the Oil Conservation Commission Order No. R-2156 and Rule 701 of the OCC Rules & Regulations, Murphy H. Baxter as an Operator requests administrative approval for the conversion of the following two wells which are located in the project area:

Baxter - State 18-13, Well No. 2, located in Unit L
of Section 18;

Baxter - State 18-13, Well No. 8, located in Unit N
of Section 18;

all in Township 17 South, Range 33 East, N.M.P.M., Lea County,
New Mexico.

Attached to this letter is a plat of the project area showing all producing and injection wells on the subject leases and also on all offset leases.

The Baxter-State 18-B Well No. 5, which is an east offset to the proposed water injection well, Baxter-State 18-13 Well No. 8, has experienced a substantial response to water injection. This well tested 30 barrels of oil per day during March, 1963, and tested 64 barrels of oil per day during July, 1963. Form C-116 for the above tests are attached to this letter.

The Baxter-State 18-13 Well No. 1, which is an east offset to the proposed water injection well, Baxter-State 18-13 Well No. 2, has

Oil Conservation Commission

Application for Water Injection

Page 2

experienced a response to water injection. This well tested 8 barrels per day during March, 1963, and then tested 15 barrels per day during July, 1963. Form C-116 for the above tests are attached to this letter.

Waivers for the conversion of the two proposed injection wells have been mailed to the offset Operators and to the State Engineer. The waivers, upon their return, will be forwarded to the Secretary-Director of the Oil Conservation Commission.

It is respectfully requested that permission to convert State 18-13 Wells No. 2 and 8 to water injection be granted at this time as these wells will complement the present water injection pattern and will increase ultimate recovery.

Respectfully submitted,

MURPHY H. BAXTER

By: W. U. Sumner
W. U. Sumner
Engineer

WUS/ph

Attachments

NEW MEXICO OIL CONSERVATION COMMISSION

GAS-OIL RATIO REPORT

OPERATOR.....MURPHY H. BAXTER.....POOL.....MALJAMAR FIELD.....
ADDRESS.....507 MIDLAND NAT'L BANK BUILDING.....MONTH OF.....MARCH....., 19.....63
SCHEDULED TEST.....COMPLETION TEST.....SPECIAL TEST.....X.....(Check One)
(See Instructions on Reverse Side)

Lease	Well No.	Date of Test	Producing Method	Choke Size	Test Hours	Daily Allowable Bbls.	Production During Test			GOR Cu. Ft. Per Bbl.
							Water Bbls.	Oil Bbls.	Gas MCF	
State 18-B	5	3/5/63	P	--	24	20	21	30	77	2567
State 18-13	1	3/10/63	F	18/64	24	20	0	8	26	3250

No well will be assigned an allowable greater than the amount of oil produced on the official test.

During gas-oil ratio test, each well shall be produced at a rate not exceeding the top unit allowable for the pool in which well is located by more than 25 percent. Operator is encouraged to take advantage of this 25 percent tolerance in order that well can be assigned increased allowables when authorized by the Commission.

Gas volumes must be reported in MCF measured at a pressure base of 15.025 psia and a temperature of 60 degrees F. Specific gravity base will be 0.60.

Mail original and one copy of this report to the district office of the New Mexico Oil Conservation Commission. In accordance with Rule 301 and Appropriate Pool Rules.

(I certify that the information given is true and complete to the best of my knowledge.)

Date.....August 2, 1963.....

MURPHY H. BAXTER

Company

By.....

PETROLEUM ENGINEER

Title

NEW MEXICO OIL CONSERVATION COMMISSION

GAS-OIL RATIO REPORT

OPERATOR.....MURPHY H. BAXTER..... POOL.....MALJAMAR FIELD.....
ADDRESS.....507 MIDLAND NAT'L BANK BUILDING..... MONTH OF.....JULY....., 19 63
SCHEDULED TEST..... COMPLETION TEST..... SPECIAL TEST.....X..... (Check One)
(See Instructions on Reverse Side)

Lease	Well No.	Date of Test	Producing Method	Choke Size	Test Hours	Daily Allowable Bbls.	Production During Test			GOR Cu. Ft. Per Bbl.
							Water Bbls.	Oil Bbls.	Gas MCF	
State 18-13	1	7/15/63	F	18/64	24	16	0	15	50	3330
State 18-B	5	7/6/63	P	--	24	35	34	64	77	1203

No well will be assigned an allowable greater than the amount of oil produced on the official test.

During gas-oil ratio test, each well shall be produced at a rate not exceeding the top unit allowable for the pool in which well is located by more than 25 percent. Operator is encouraged to take advantage of this 25 percent tolerance in order that well can be assigned increased allowables when authorized by the Commission.

Gas volumes must be reported in MCF measured at a pressure base of 15.025 psia and a temperature of 60 degrees F. Specific gravity base will be 0.60.

Mail original and one copy of this report to the district office of the New Mexico Oil Conservation Commission. In accordance with Rule 301 and Appropriate Pool Rules.

(I certify that the information given is true and complete to the best of my knowledge.)

Date.....August 2, 1963.....

MURPHY H. BAXTER
Company

By.....*W. U. Sumner*.....

PETROLEUM ENGINEER
Title

MURPHY H. BAXTER
507 MIDLAND NATIONAL BANK BUILDING
MIDLAND, TEXAS

August 7, 1963

Oil Conservation Commission
P. O. Box 871
Santa Fe, New Mexico

Re: Application for Administrative
Approval for Conversion of Two
Wells to Water Injection,
Maljamar Field, Lea County, New Mexico

Gentlemen:

Attached are copies of waivers from offset Operators for the conversion of two wells to water injection in the Maljamar Field, Lea County, New Mexico. The waiver from the State Engineer has not been received as of this date.

If there is any additional information you may need concerning the above application, please let us know.

Yours very truly,

W. U. Sumner

WUS/ph

Attachments -

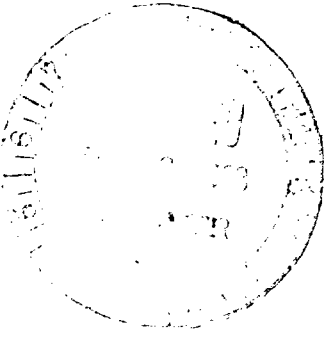

MURPHY H. BAXTER
507 MIDLAND NATIONAL BANK BUILDING
MIDLAND, TEXAS

August 2, 1963

18

Great Western Drilling Company
P. O. Box 1659
Midland, Texas

Gentlemen:

Enclosed is an application to the New Mexico Oil Conservation Commission for converting two wells on our State 18-13 Lease to water injection in the Maljamar Field, Lea County, New Mexico.

If you have no objection to the enclosed application, please sign below and return one copy to the above address.

Yours very truly,

W. U. Sumner
W. U. Sumner

We have no objection to the conversion to water injection of the two wells given below:

Baxter - State 18-13 Well No. 2, located
in Unit L of Section 18;

Baxter - State 18-13 Well No. 8, located
in Unit N of Section 18;

all in Township 17 South, Range 33 East, N.M.P.M., Lea County, New Mexico.

GREAT WESTERN DRILLING COMPANY

By: *E. A. Lewis*

Date: *Aug 5, 1963*

MURPHY H. BAXTER
507 MIDLAND NATIONAL BANK BUILDING
MIDLAND, TEXAS

August 2, 1963



Zapata Petroleum Corporation
P. O. Box 3195
Midland, Texas

Gentlemen:

Enclosed is an application to the New Mexico Oil Conservation Commission for converting two wells on our State 18-13 Lease to water injection in the Maljamar Field, Lea County, New Mexico.

If you have no objection to the enclosed application, please sign below and return one copy to the above address.

Yours very truly,

A handwritten signature in cursive script, appearing to read "W. U. Summer".

W. U. Summer

We have no objection to the conversion to water injection of the two wells given below:

Baxter - State 18-13 Well No. 2, located
in Unit L of Section 18;

Baxter - State 18-13 Well No. 8, located
in Unit N of Section 18;

all in Township 17 South, Range 33 East, N.M.P.M., Lea
County, New Mexico.

PENNZOIL COMPANY
SUCCESSOR BY MERGER TO
ZAPATA PETROLEUM CORPORATION

By:

A handwritten signature in cursive script, appearing to read "Kenneth R. Huddleston".

Date: 8-5-63



STATE OF NEW MEXICO

STATE ENGINEER OFFICE

SANTA FE

S. E. REYNOLDS
STATE ENGINEER

August 19, 1963

ADDRESS CORRESPONDENCE TO:
STATE CAPITOL
SANTA FE, N. M.

Mr. A. L. Porter, Jr.
Secretary-Director
Oil Conservation Commission
Santa Fe, New Mexico

Dear Mr. Porter:

Reference is made to the application of Murphy H. Baxter for administrative approval to convert two wells to water injection, Maljamar Field, Lea County, New Mexico which was submitted on August 2, 1963. I have reviewed the application and the schematic drawing of the casing program in the two subject wells. Mr. Baxter has informed me, by telegram, that the top of the cement on the oil string on the Baxter State 18-13 Well No. 8 is 2850 feet.

In view of the fact that the sketch shows that injection will be down tubing under a packer set well below the top of the cement surrounding the oil string, it appears that no threat of contamination to the waters which may exist in the area will occur. Therefore, this office offers no objection to the granting of this application.

Very truly yours,

S. E. Reynolds
State Engineer

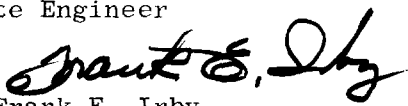
By: 
Frank E. Irby
Chief
Water Rights Division

FEI/ma
cc-Murphy H. Baxter
F. H. Hennighausen

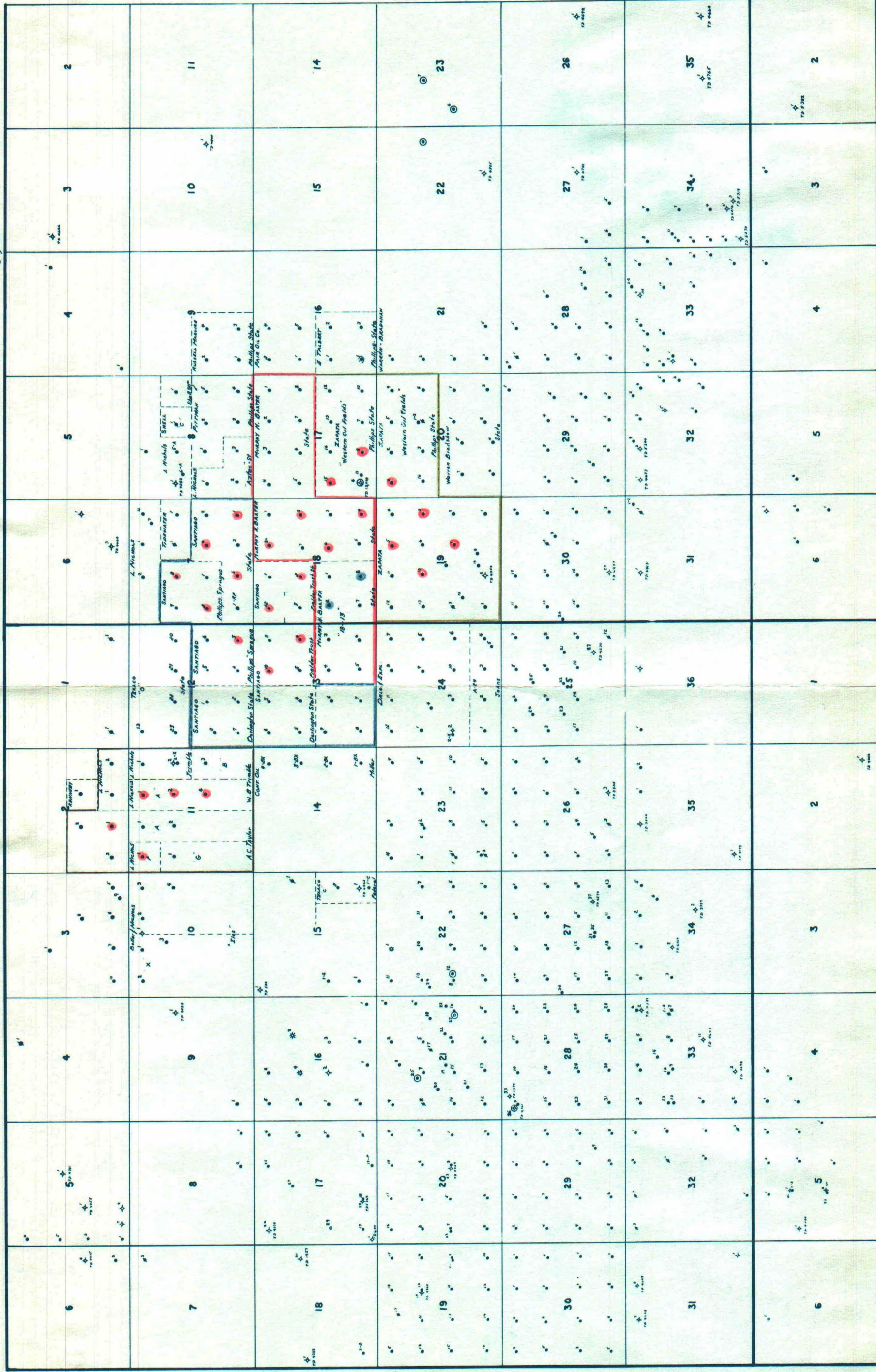

MALJAMAR FIELD, LEA COUNTY, NEW MEXICO

5.015: 1" = 2.000"

Injection Skill
Proposed Injection Skill