

MURPHY H. BAXTER
1126 VAUGHN BUILDING
MIDLAND, TEXAS 79704

MAIN OFFICE OCC

April 15, 1964

1964 APR 15 AM 8:33

WEX - 173

See pg 1

Oil Conservation Commission
P. O. Box 2088
Santa Fe, New Mexico

Re: Application for Administration Approval
for Conversion of One Well to Water
Injection, Maljamar Field, Lea County,
New Mexico

Gentlemen:

As provided in the Oil Conservation Commission Order No. R-2156 and Rule 701 of the OCC Rules and Regulations, Murphy H. Baxter as an Operator requests administration approval for the conversion of the Baxter-State 17 Well No. 6, located in Unit F of Section 17, Township 17 South, Range 33 East, N.M.P.M., Lea County, New Mexico.

Attached to this letter is a plat of the project area showing all producing and injection wells on the subject lease and also on all offset leases.

The above well is offset by a producing well which has experienced response from the waterflood as indicated by the attached Form C-116.

A schematic diagram of the proposed injection well is attached which shows the casing and top of cement presently in the well and the proposed tubing and packer arrangement to be used on converting to injection.

A copy of this application has been sent to the offset operator, Pennzoil Company, Midland, Texas.

It is respectfully requested that permission to convert our State 17 Well No. 6 to water injection be granted at this time as this well will complement the present established waterflood pattern and will increase ultimate recovery.

Respectfully submitted,

MURPHY H. BAXTER

By: W. U. Sumner
Engineer

Attachments

cc - State Engineer Office, P. O. Box 1069, Santa Fe, New Mexico

NEW MEXICO OIL CONSERVATION COMMISSION

MAIN OFFICE OCC

GAS-OIL RATIO REPORT

1964 APR 15 AM 6:33

OPERATOR.....MURPHY H. BAXTER.....POOL.....MALJAMAR.....
ADDRESS.....1126 VAUGHN BLDG., MIDLAND, TEXAS.....MONTH OF.....MARCH....., 1964
SCHEDULED TEST.....COMPLETION TEST.....SPECIAL TEST.....X.....(Check One)
(See Instructions on Reverse Side)

Lease	Well No.	Date of Test	Producing Method	Choke Size	Test Hours	Daily Allowable Bbls.	Production During Test			GOR Cu. Ft. Per Bbl.
							Water Bbls.	Oil Bbls.	Gas MCF	
STATE 17	5	3/2/64	P	-	24	9	0	5.52	18	3260

No well will be assigned an allowable greater than the amount of oil produced on the official test.

During gas-oil ratio test, each well shall be produced at a rate not exceeding the top unit allowable for the pool in which well is located by more than 25 percent. Operator is encouraged to take advantage of this 25 percent tolerance in order that well can be assigned increased allowables when authorized by the Commission.

Gas volumes must be reported in MCF measured at a pressure base of 15.025 psia and a temperature of 60 degrees F. Specific gravity base will be 0.60.

Mail original and one copy of this report to the district office of the New Mexico Oil Conservation Commission. In accordance with Rule 301 and Appropriate Pool Rules.

(I certify that the information given is true and complete to the best of my knowledge.)

Date.....APRIL 15, 1964.....

MURPHY H. BAXTER
Company

By.....

PETROLEUM ENGINEER
Title

NEW MEXICO OIL CONSERVATION COMMISSION

MAIN OFFICE OCC
GAS-OIL RATIO REPORT

1964 APR 15 AM 8:33

OPERATOR.....MURPHY H. BAXTER.....POOL.....MALJAMAR.....
ADDRESS.....1126 VAUGHN BLDG., MIDLAND, TEXAS.....MONTH OF.....APRIL....., 1964
SCHEDULED TEST.....COMPLETION TEST.....SPECIAL TEST.....X.....(Check One)
(See Instructions on Reverse Side)

Lease	Well No.	Date of Test	Producing Method	Choke Size	Test Hours	Daily Allowable Bbls.	Production During Test			GOR Cu. Ft. Per Bbl.
							Water Bbls.	Oil Bbls.	Gas MCF	
STATE 17	5	4/7/64	P	-	24	9	0	8.41	16	1900

No well will be assigned an allowable greater than the amount of oil produced on the official test.

During gas-oil ratio test, each well shall be produced at a rate not exceeding the top unit allowable for the pool in which well is located by more than 25 percent. Operator is encouraged to take advantage of this 25 percent tolerance in order that well can be assigned increased allowables when authorized by the Commission.

Gas volumes must be reported in MCF measured at a pressure base of 15.025 psia and a temperature of 60 degrees F. Specific gravity base will be 0.60.

Mail original and one copy of this report to the district office of the New Mexico Oil Conservation Commission. In accordance with Rule 301 and Appropriate Pool Rules.

(I certify that the information given is true and complete to the best of my knowledge.)

Date.....APRIL 15, 1964.....

MURPHY H. BAXTER
Company

By.....*[Signature]*.....

PETROLEUM ENGINEER
Title

Baxter - State 17 Well No. 6

MAIN OFFICE OCC

1964 APR 16 AM 8:33

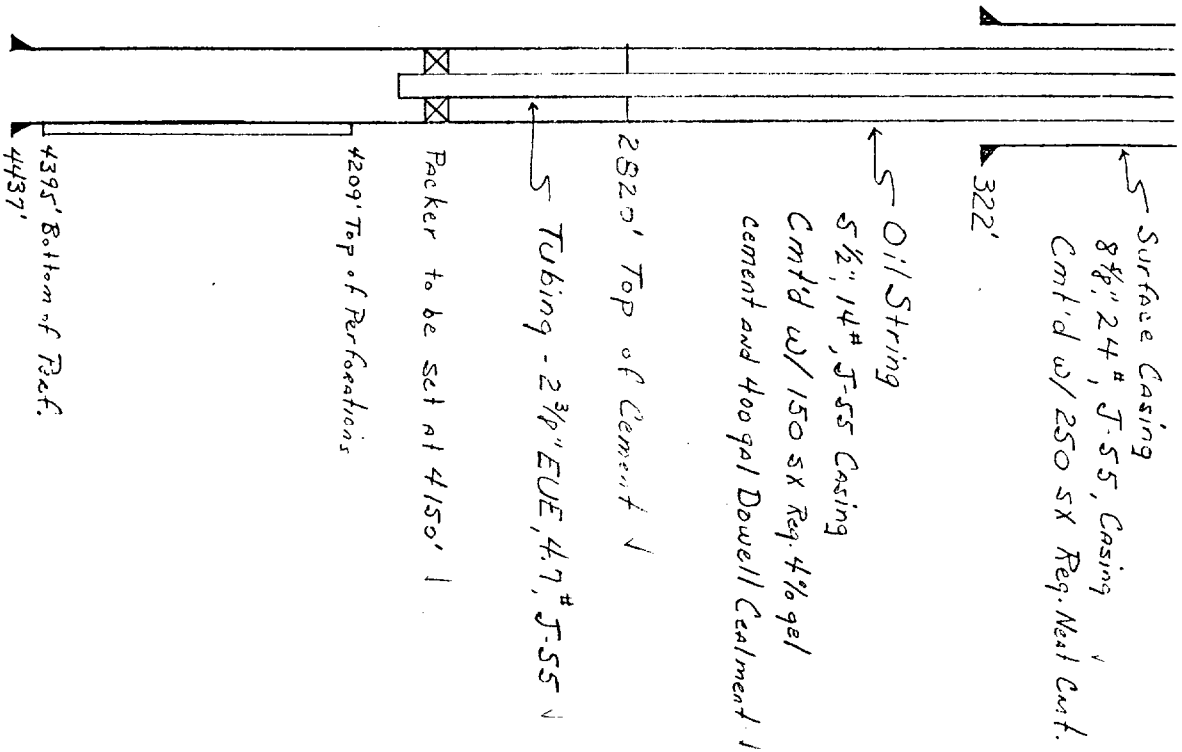

Murphy H. Baxter

Schematic Drawing of
Proposed Injection Well

State 17 No. 6 Unit "F" Sec. 17

T-17-S, R-33-E, Lea County

Maljamar (S-Go) Field

Date: April 14, 1964



STATE ENGINEER OFFICE

1904 APR 15 STATE OF NEW MEXICO

STATE ENGINEER OFFICE

SANTA FE

S. E. REYNOLDS
STATE ENGINEER

April 16, 1964

ADDRESS CORRESPONDENCE TO:
STATE CAPITOL
SANTA FE, N. M.

Mr. A. L. Porter, Jr.
Secretary-Director
Oil Conservation Commission
Santa Fe, New Mexico

Dear Mr. Porter:

Reference is made to the application of Murphy H. Baxter which seeks administrative approval to convert his Baxter= State 17 Well No. 6 located in Unit F of Sec. 17, T. 17 S., R. 33 West in the Maljamar Field to water injection.

The diagrammatic sketch showing the casing and top of cement and the proposed tubing and packer arrangement to be used is slightly confusing in that the cement top appears to be in the annulus between the casing and the tubing. However, I assume that the top of the cement designated at 2820 feet is in the annulus between the casing and the bore-wall. If my assumption concerning the cement is correct, then this office offers no objection to the granting of the application.

FEI/ma
cc-Murphy H. Baxter
F. H. Hennighausen

Yours truly,

S. E. Reynolds
State Engineer

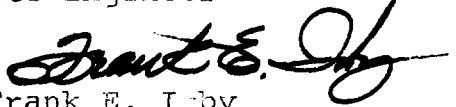
By: 
Frank E. Iby
Chief
Water Rights Div.

323

33 E

175

173

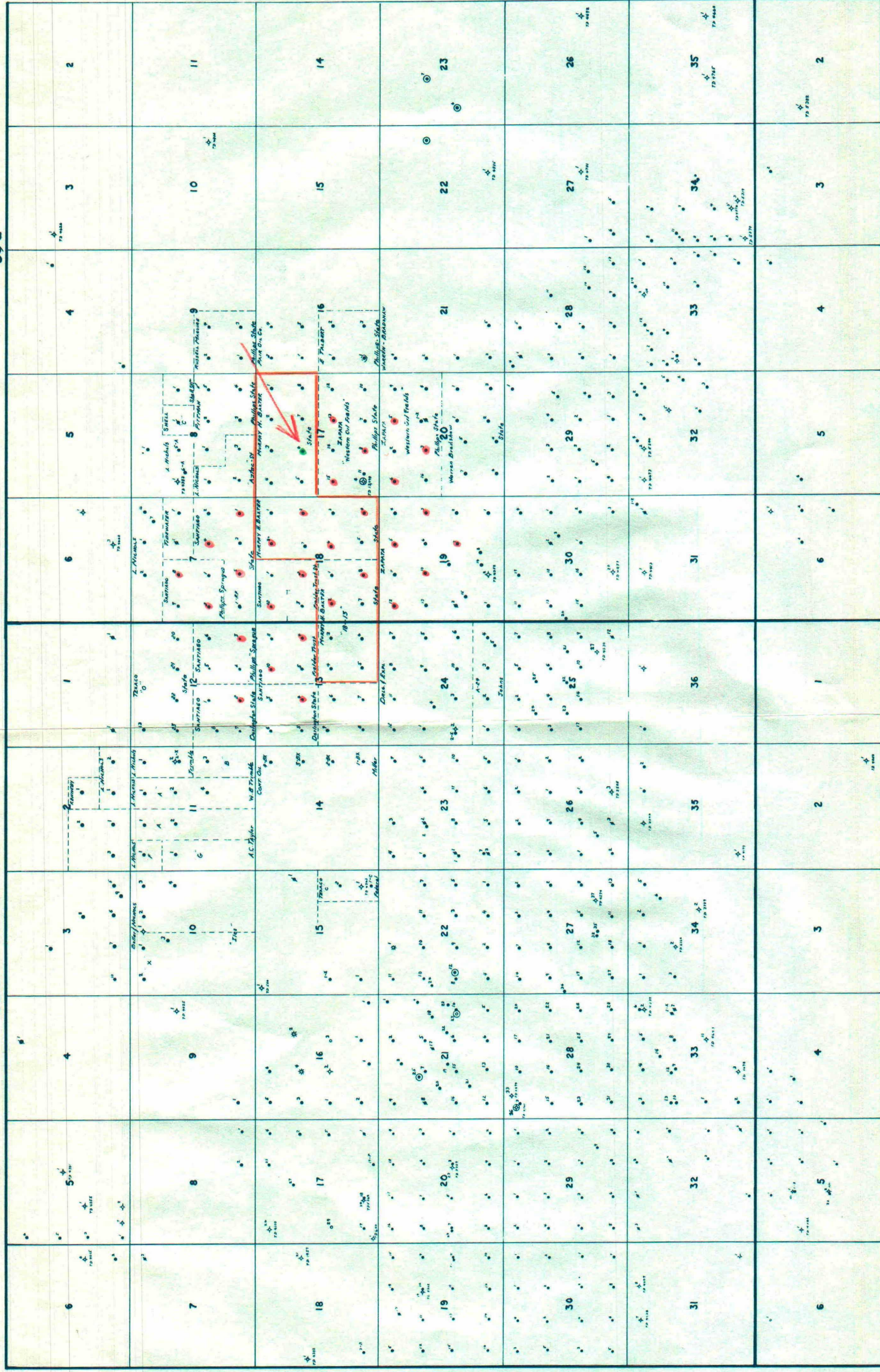

MALJAMAR FIELD, LEA COUNTY, NEW MEXICO

Proposed Injection Well

Injection Wells