

FORTSON OIL COMPANY
3325 W. WADLEY, SUITE 213
MIDLAND, TEXAS 79707

January 11, 1994

Mr. Ben Stone
Oil Conservation Commission of New Mexico (2)
P.O. Box 2088
Santa Fe, New Mexico 87501

NOTICE OF APPLICATION FOR
SALT WATER DISPOSAL WELL
BIG EDDY UNIT WELL NO. 117
EDDY COUNTY, NEW MEXICO

Gentlemen:

Per our conversation, Fortson Oil Company respectfully requests authority to dispose of salt water down the subject well into a porous formation not productive of hydrocarbons in this area.

Information supporting this application is presented on Forms 3160-5, C-102 and a C-108. The original of 3160-5 + 5 copies was sent to BLM in Carlsbad, New Mexico, and we have attached the approved copy.

A copy of this letter and attachments are being sent by certified mail to the surface owner, offset operators and County Clerk as their notice of this application.

If any further information is needed, please call, Judy Dixon at (915) 520-4347.

Yours very truly,

FORTSON OIL COMPANY

Judy Dixon
Production Technician

JWDixon
Attachments

cc: NMOCD- Drawer DD, Artesia, NM 88210 (w/attach)
BLM - Box 1778, Carlsbad, NM 88221-1778 (w/attach)
Offset Operators (w/Forms 3160-5, C-102, C-108)
County Clerk (w/Forms 3160-5, C-102, C-108)
Regulatory Files

OPERATOR'S COPY

Form 3160-5
(June 1990)

UNITED STATES
DEPARTMENT OF THE INTERIOR
BUREAU OF LAND MANAGEMENT

FORM APPROVED
Budget Bureau No. 1004-0135
Expires: March 31, 1993

SUNDRY NOTICES AND REPORTS ON WELLS

Do not use this form for proposals to drill or to deepen or reentry to a different reservoir.
Use "APPLICATION FOR PERMIT—" for such proposals

5. Lease Designation and Serial No.
LC-069159-A

6. If Indian, Allottee or Tribe Name

SUBMIT IN TRIPLICATE

1. Type of Well

☒ Oil Well ☐ Gas Well ☐ Other

2. Name of Operator

FORTSON OIL COMPANY

3. Address and Telephone No.

3325 W. Wadley, Suite 213, Midland, TX 79707 (915) 520-4347

4. Location of Well (Footage, Sec., T., R., M., or Survey Description)

330' FSL & 330' FWL Section 25, T22S, R28E, Unit M

7. If Unit or CA, Agreement Designation

Big Eddy Unit

8. Well Name and No.

Big Eddy Unit #117

9. API Well No.

30-015-27261

10. Field and Pool, or Exploratory Area

E. Herradura Bend (Delaware)

11. County or Parish, State

Eddy Co, NM

12. CHECK APPROPRIATE BOX(s) TO INDICATE NATURE OF NOTICE, REPORT, OR OTHER DATA

TYPE OF SUBMISSION	TYPE OF ACTION	
<input checked="" type="checkbox"/> Notice of Intent	<input type="checkbox"/> Abandonment	<input type="checkbox"/> Change of Plans
<input type="checkbox"/> Subsequent Report	<input type="checkbox"/> Recompletion	<input type="checkbox"/> New Construction
<input type="checkbox"/> Final Abandonment Notice	<input type="checkbox"/> Plugging Back	<input type="checkbox"/> Non-Routine Fracturing
	<input type="checkbox"/> Casing Repair	<input type="checkbox"/> Water Shut-Off
	<input type="checkbox"/> Altering Casing	<input checked="" type="checkbox"/> Conversion to Injection
	<input type="checkbox"/> Other	<input type="checkbox"/> Dispose Water

(Note: Report results of multiple completion on Well Completion or Recompletion Report and Log form.)

13. Describe Proposed or Completed Operations (Clearly state all pertinent details, and give pertinent dates, including estimated date of starting any proposed work. If well is directionally drilled, give subsurface locations and measured and true vertical depths for all markers and zones pertinent to this work.)*

1. Rig Up Workover Rig
2. POH w/tubing if any, lay down.
3. Move in 2-3/8" work string from Forklift Enterprise in Hobbs
4. Set pkr above perms 2950-58, 2968-72
5. Load back side. Hook to tubing, establish inj. rate and pressure.
6. If rate and pressure falls into the required inj. range, POH w/pkr. If necessary addize to Lower injection pressure.
7. RIH w/lok-set inj. pkr & 2-3/8" salta lined tubing.
8. Hook up to disposal system

14. I hereby certify that the foregoing is true and correct

Signed [Signature] Title Production Technician Date 12/15/93

(This space for Federal or State office use)

Approved by [Signature] Title Retroleum Engineer Date 1/5/94

Conditions of approval, if any:

Injection Interval Subject to

Like Approval
by State

Title 18 U.S.C. Section 1001, makes it a crime for any person knowingly and willfully to make to any department or agency of the United States any false, fictitious or fraudulent statements or representations as to any matter within its jurisdiction.

*See Instruction on Reverse Side

RECEIVED
DEC 16 9 51 AM '93
OCT 17 1993

State Well

Big Eddy Lease # 117
SW 25-22S-28E

GL 3125

11 3/4" e 448

CMTD w/ 370 SKS
CIRC w/ 180 SKS

5 1/2" 14 + 15.5 IAF

e 6484

FC e 6387

DV e 4497

8 5/8" CSG @ 2670 (CIRC. CAT TO SURF)

CIRC CMT on 1st Stage
TC 2nd Stage ± 2450'

CIBP 3050

Perfs 2950-58 (33 holes)
2968-72 (17 holes)
ACIDIZED w/ 1000 gal

CIBP 4325

CIBP 5950

PERFS 4281-89 (33 holes)
ACIDIZED w/ 500 gal

CIBP 6130

* Perfs 6012-93 (432 holes)
FRAC'D w/ 12,000#

PERFS 6146-60 (60 holes)
Pur'd Dry - 300' water/hr.



DISTRICT I
P.O. Box 1980, Hobbs, NM 88240

DISTRICT II
P.O. Drawer DD, Artesia, NM 88210

DISTRICT III
1000 Rio Brazos Rd., Aztec, NM 87410

P.O. Box 2088

Santa Fe, New Mexico 87504-2088

WELL LOCATION AND ACREAGE DEDICATION PLAT

All Distances must be from the outer boundaries of the section

Operator BASS ENTERPRISES PRODUCTION COMPANY			Lease BIG EDDY UNIT		Well No. 117
Unit Letter M	Section 25	Township 22 SOUTH	Range 28 EAST	County EDDY	
Actual Footage Location of Well: 330 feet from the SOUTH line and 330 feet from the WEST line					
Ground Level Elev. 3124.9	Producing Formation		Pool	Dedicated Acreage: Acres	

- Outline the acreage dedicated to the subject well by colored pencil or hatchure marks on the plat below.
- If more than one lease is dedicated to the well, outline each and identify the ownership thereof (both as to working interest and royalty).
- If more than one lease of different ownership is dedicated to the well, have the interest of all owners been consolidated by communitization, unitization, force-pooling, etc.?
☐ Yes ☐ No If answer is "yes" type of consolidation _____

If answer is "no" list of owners and tract descriptions which have actually been consolidated. (Use reverse side of this form necessary.)

No allowable will be assigned to the well unit all interests have been consolidated (by communitization, unitization, forced-pooling, otherwise) or until a non-standard unit, eliminating such interest, has been approved by the Division.

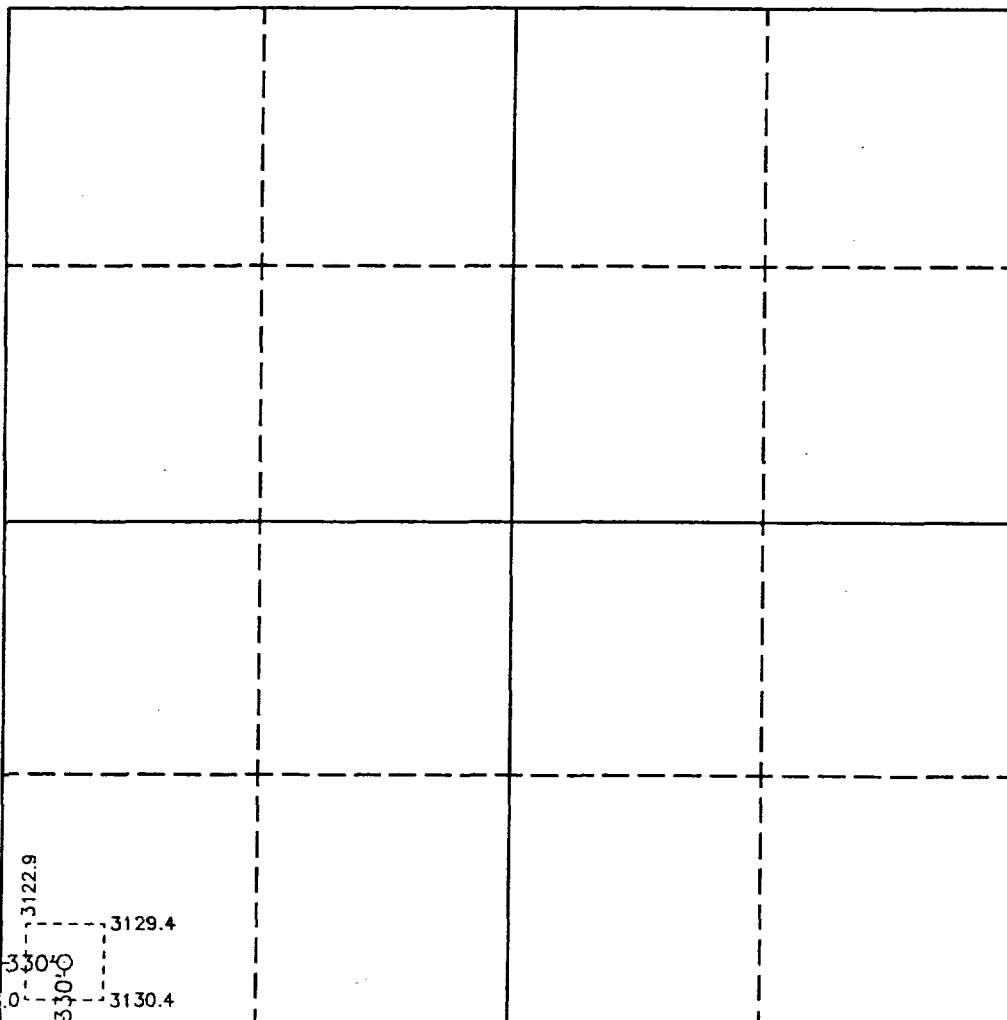

OPERATOR CERTIFICATION

I hereby certify the information contained herein is true and complete to the best of my knowledge and belief.

Signature

Printed Name

Judy Dixon

Position

Production Technician

Company

Fortson Oil Company

Date

12/15/93

SURVEYOR CERTIFICATION

I hereby certify that the well location shown on this plat was plotted from field notes of actual surveys made by me or under my supervision, and that the same is true and correct to the best of my knowledge and belief.

Date Surveyed

OCTOBER 28, 1992

Signature & Seal of
Professional Surveyor

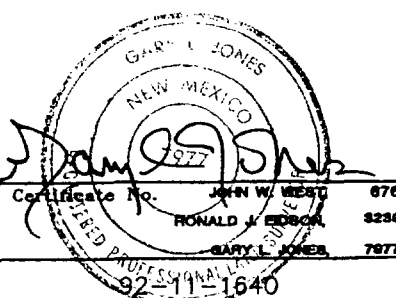

FORM 2800-14
(August 1985)

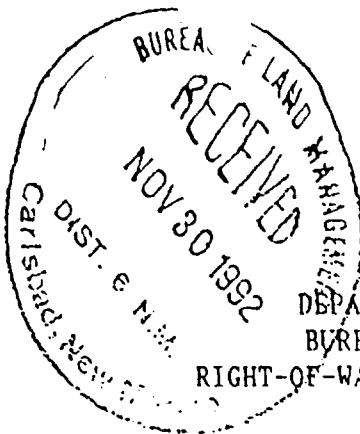

BEPCC - WTD PRODUCTION

DEC - 2 1992

Issuing ~~OFFICE~~ RECEIVED
RDO ~~Carlsbad Resource Area~~

BEU # 117

UNITED STATES
DEPARTMENT OF THE INTERIOR
BUREAU OF LAND MANAGEMENT
RIGHT-OF-WAY GRANT/TEMPORARY USE PERMIT

SERIAL NUMBER: NM NM-89655

1. A right-of-way is hereby granted pursuant to Title V of the Federal Land Policy and Management Act of October 21, 1976 (90 Stat. 2776; 43 U.S.C. 1761).

2. Nature of Interest:

a. By this instrument, the holder:

Bass Enterprises
P.O. Box 2760
Midland, Tx. 79702

receives a right to construct, operate, maintain, and terminate a(n) off lease access road, on public lands described as follows:

T. 22 S., R. 28 E., NMPM
Section 25: SESW1/4
Section 35: SWSE1/4, N1/2SE1/4

The lands described above contain a total length of 0.795 of a mile.

- b. The right-of-way or permit area granted herein is 30 feet wide, 4,200 feet long and contains 2.893 acres, more or less.
- c. This instrument shall terminate on November 30, 2022, 30 years from the effective date of this grant unless prior thereto, it is relinquished, abandoned, terminated, or modified pursuant to the terms and conditions of this instrument or of any applicable Federal law or regulation.
- d. This instrument may be renewed. If renewed, the right-of-way or permit shall be subject to the regulations existing at the time of renewal and any other terms and conditions that the authorized officer deems necessary to protect the public interest.
- e. Notwithstanding the expiration of this instrument or any renewal thereof, early relinquishment, abandonment, or termination, the provisions of this instrument, to the extent applicable, shall continue in effect and shall be binding on the holder, its successors, or assigns, until they have fully satisfied the obligations and/or liabilities accruing herein before or on account of the expiration, or prior termination, of the grant.

Chazine BLM r/w to location on BLM r/w.
No renewal BLM, under new BLM since the year

102	
DCB	
BWC	
GYI	
M521 TEXAS DIVISION FOR	

No RENTAL REQ'D. *KLB*

3. Rental:

For and in consideration of the rights granted, the holder agrees to pay the Bureau of Land Management fair market value rental as determined by the authorized officer unless specifically exempted from such payment by regulation. Provided, however, that the rental may be adjusted by the authorized officer, whenever necessary, to reflect changes in the fair market rental value as determined by the application of sound business management principles, and so far as practicable and feasible, in accordance with comparable commercial practices.

4. Terms and Conditions:

- a. This grant or permit is issued subject to the holder's compliance with all applicable regulations contained in Title 43 Code of Federal Regulations part 2800.
- b. Upon grant termination by the authorized officer, all improvements shall be removed from the public lands within 90 days, or otherwise disposed of as provided in paragraph (4)(d) or as directed by the authorized officer.
- c. Each grant issued for a term of 20 years or more shall, at a minimum, be reviewed by the authorized officer at the end of the 20th year and at regular intervals thereafter not to exceed 10 years. Provided, however, that a right-of-way or permit granted herein may be reviewed at any time deemed necessary by the authorized officer.
- d. The stipulations, plans, maps, or designs set forth in Exhibits A & B, dated 10/20/92, attached hereto, are incorporated into and made a part of this grant instrument as fully and effectively as if they were set forth herein in their entirety.
- e. Failure of the holder to comply with applicable law or any provision of this right-of-way grant or permit shall constitute grounds for suspension or termination thereof.
- f. The holder shall perform all operations in a good and workmanlike manner so as to ensure protection of the environment and the health and safety of the public.

IN WITNESS WHEREOF, The undersigned agrees to the terms and conditions of this right-of-way grant or permit.

Wm. Arthur Hamilton
(Signature of Holder)

Wm. Arthur Hamilton

Vice President

(Title)

November 23, 1992

(Date)

Richard C. Mann
(Signature of Authorized Officer)

Area Manager, Carlsbad Resource Area

(Title)

11/30/92

(Effective Date of Grant)



NMAS

New Mexico Archaeological Services, INC.

P.O. Box 1341

Carlsbad, New Mexico 88221-1341

(505) 887-7646 • FAX (505) 885-2587

BEPCO - WTR PROTECTION

NOV 4 1992

RECEIVED

3 November 1992

Reconnaissance

Excavation

Analysis

Explanation

Curation

Mr. Mike Everett

BASS ENTERPRISES PRODUCTION COMPANY

P.O. Box 2760

Midland, Texas 79702

Dear Mr. Everett:

Enclosed please find NMAS' Archaeological Survey Report for BASS ENTERPRISES PRODUCTION COMPANY's proposed Big Eddy Unit Well No. 117 and its associated access road in Eddy County, New Mexico. One isolated manifestation (IM) and one archaeological site (NMAS 6037) were recorded during this survey. Clearance is suggested provided NMAS 6037 is avoided.

If you have any questions pertaining to this report, please call my office. Thank you for asking NMAS to do this survey.

Yours sincerely,

J. Loring Haskell
Dr. J. Loring Haskell
Principal Investigator

Enclosure

cc: Mr. Michael Kyte, BLM, Carlsbad

as

Archaeological Survey Report
for

BASS ENTERPRISES PRODUCTION COMPANY

Big Eddy Unit Well No. 117 and Access Road

Prepared

By

Dr. J. Loring Haskell

Submitted

By

Dr. J. Loring Haskell
Principal Investigator
New Mexico Archaeological Services, Inc.
Carlsbad, New Mexico

3 November 1992

Permit Number: 14-2920-92-M

Report Number: NMAS-1992-02-N

ABSTRACT

New Mexico Archaeological Services, Inc., representing BASS ENTERPRISES PRODUCTION COMPANY, undertook a Class III survey of Bureau of Land Management land scheduled to be impacted by the construction of a drill location and its associated access road. Field work was conducted under mostly cloudy conditions during the afternoon on 19 September and during mid-day on 2 October under sunny conditions. The proposed location will measure 400 X 400 ft (actual area surveyed 4.44 acres). The access road will measure 100 X 950 ft (actual area surveyed 2.18 acres). Total surveyed acreage 6.62 acres. They will be situated in Section 25, T22S, R28E, NMPM, Eddy County, New Mexico. One isolated manifestation (IM) and one archaeological site (NMAS 6037) were encountered during this survey. Clearance is suggested provided the archaeological site is avoided.

Introduction

On 19 September and 2 October 1992, New Mexico Archaeological Services, Inc., (NMAS), Carlsbad, (Permit Number: 14-2920-92-M), undertook for BASS ENTERPRISES PRODUCTION COMPANY, an archaeological survey of federal land administered by the Bureau of Land Management in Eddy County, New Mexico. Reconnoitered areas will be impacted by the construction of a drill location and its associated access road. These surveys were undertaken by Dr. Haskell.

Survey Technique

For this investigation, BASS ENTERPRISES PRODUCTION COMPANY's proposed location was reconnoitered for evidence of man's past activities by walking it in a series of 8.0 m wide, close interval (15° or less), zigzag transects. In addition, an added zone extending 20 ft on each side of the staked 400 X 400 ft location, and lying outside the bounds of the proposed work area, was reconnoitered by a similar means. Lath is considered to be the center of the proposed road. Methodologically, these procedures served to promote optimal conditions for the visual examination of the areas to be impacted by construction-related activities. Field work was conducted under mostly cloudy conditions during the afternoon on 19 September and during mid-day under sunny conditions on 2 November. Ground visibility ranges between 75 and 85%. Field time 2½ hours.

Big Eddy Unit Well No. 117

Location

The proposed location will measure 400 X 400 ft (actual

area surveyed 4.44 acres) on federal land and will be situated 330 ft from the south line and 330 ft from the west line.

Section 25, T22S, R28E, NMPM, Eddy County, NM

Thus it will be situated in the:

SW $\frac{1}{4}$ SW $\frac{1}{4}$, Section 25, T22S, R28E, NMPM, Eddy County, NM

The associated access road will measure 100 X 950 ft (actual area surveyed 2.18 acres) and will be situated in the:

SW $\frac{1}{4}$ SW $\frac{1}{4}$, Section 25, T22S, R28E, NMPM, Eddy County, NM

SE $\frac{1}{4}$ SW $\frac{1}{4}$, Section 25, T22S, R28E, NMPM, Eddy County, NM

Map Reference: USGS LOVING QUADRANGLE, 7.5 Minute Series, 1985, Prov. Ed.

Environmental Setting

BASS ENTERPRISES PRODUCTION COMPANY's proposed location will be situated on a gently sloping landform due east of the Pecos River. Locally, the coeval surface is distinguished by low, hummocky terrain with microrelief ranging between 0.30 and 0.55 m in height. Interdunal areas are distinguished by outcroppings of croute calcaire and associated highly weathered screes. Soil individuals fall within the Typic Torripsamment subgroup. As a whole, the coeval surface is subject to colluvial movement. Elevation is 3124 ft. Slope is 0.85°. Aspect is multiple (360°). Drainage is by ephemeral sheetwash.

The desert scrub formation is made up of white thorn acacia, juavelina bush, mesquite, purple prickly pear, Englemann prickly pear, bladder pod, range ratany, poverty threeawn, fluff grass, and plains brittle grass.

Cultural Resources

Prefield: 16 September 1992, Section 25 (one archaeological sites), T22S, R28E, Arita K. Slate.

Section 25, T22S, R28E

NMAS 5790 is situated within 4000 ft of the proposed location.

During the course of this survey, one isolated manifestation (IM) and one archaeological site (NMAS 6037) were recorded.

Isolated Manifestation (IM)

This IM, consisting of one, Eastern Jornada Mogollon, Querecho Phase, olive gray (5Y 4/1), cryptocrystalline chert, 30 X 13 X 4 mm, arrow point, is distinguished by slightly convex blade edges, a slender stem (broken) and seemingly wide corner notches (Fig. 1). (The dorsal surface is marked by the build up of a calcareous deposit.) It is situated at a point 250 ft west of the eastern beginning point of the proposed access road. (collected). It is located in the:

SW $\frac{1}{4}$ SW $\frac{1}{4}$ SE $\frac{1}{4}$ SW $\frac{1}{4}$, Section 25, T22S, R28E, NMPM, Eddy County, NM

Map Reference: USGS LOVING QUADRANGLE, 7.5 Minute Series, 1985, Prov. Ed.

Archaeological Site

NMAS 6037

Category 2

Location: NW $\frac{1}{4}$ SE $\frac{1}{4}$ SW $\frac{1}{4}$ SW $\frac{1}{4}$, Section 25, T22S, R28E, NMPM, Eddy County, NM

UTM: Zone 13, N3,580,260; E589,630

Map Reference: USGS LOVING QUADRANGLE, 7.5 Minute Series, 1985, Prov. Ed.

Ownership: Bureau of Land Management Administration



a



b



c

Fig. 1. Eastern Jornada Mogollon Arrow Point, a. dorsal surface, b. in profile and c. ventral surface.

Dimension of Resources: 30 m (E-W) X 30 m (N-S)

Typological Designation: Task Locus

Authorship/Temporality: Unknown

Nature of Cultural Resources: NMAS 6037, a small task locus, is situated on a hummocky landform whose surface is marked by an outcroppings of caliche. Hummocks range between 0.30 and 0.50 m in height. Surficial deposits are made up of sandy clay loams and loamy sands. Drainage is by sheetwash. In general, the surface is subject to colluvial movement. Elevation is 3124 ft. Slope is 0.85°. Aspect is multiple (360°). The desert scrub formation is made up of whitethorn acacia, mesquite, javelina bush, broom snakeweed, leather-leaf croton, bladder pod, poverty threeawn, and plains brittle grass.

Observed cultural resources include two, caliche-type fire hearths, three cryptocrystalline chert flakes (alibates flint?) and sporadic pieces of burned- and fire-cracked, caliche gravels and cobbles. No diagnostic artifacts were noted; consequently, authorship and temporality remain unknown. The site has been termed a task locus as activities focused on a modicum of chipped-stone production and camping. Occupancy was brief. Owing to its partial aeolian setting, there is a good possibility for burial of material cultural remains. NMAS 6037 has not been impacted by mechanical means and is previously unrecorded. No collection was made.

NMAS 6037 is important as it relates to prehistoric

land usage and site selection in the Pecos Valley.

Recommendations

NMAS suggests clearance for BASS ENTERPRISES PRODUCTION COMPANY's proposed Big Eddy Unit Well No. 7 provided NMAS 6037 is avoided (Fig. 2). NMAS suggests that a fence be erected at a point approximately 100 ft east of the center of the location (Fig. 3). Blue- and yellow- flags indicate its location in the field. Men and materiel are to avoid the archeologically sensitive area altogether during all phases of work. Clearance, of course, is granted by the Bureau of Land Management.

LOVING QUADRANGLE
NEW MEXICO-EDDY CO.
7.5 MINUTE SERIES (TOPOGRAPH)

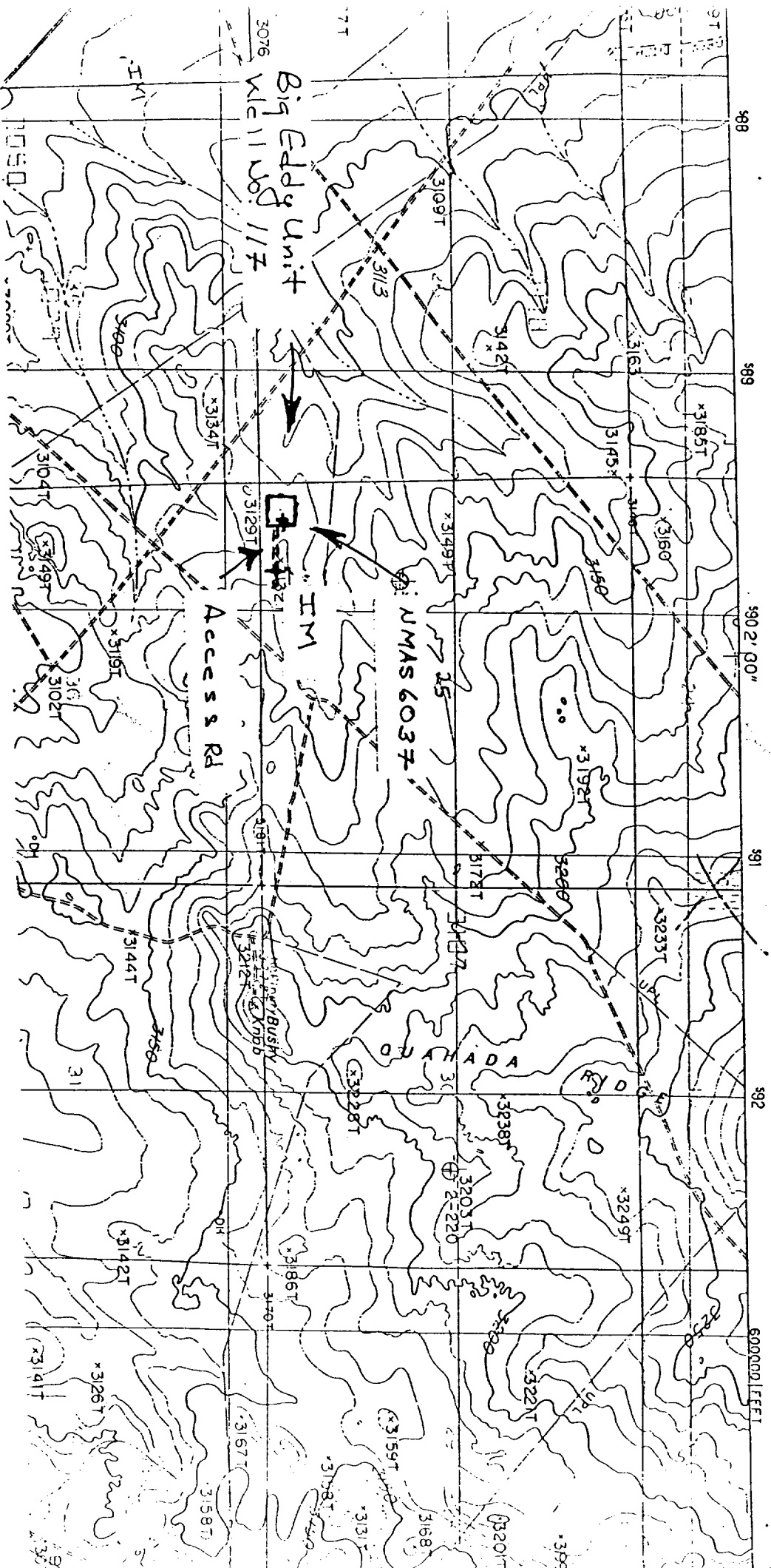

Fig. 2. USGS LOVING QUADRANGLE, 7.5 Minute Series, 1:24,000, 1985, Prov. Ed., showing BASS ENTERPRISES PRODUCTION COMPANY's proposed Big Eddy Unit Well No. 117, 330' FSL, 330' FWL, Section 25, T22S, R28E, NMPM, Eddy County, New Mexico, vis a vis NMAS 6037.

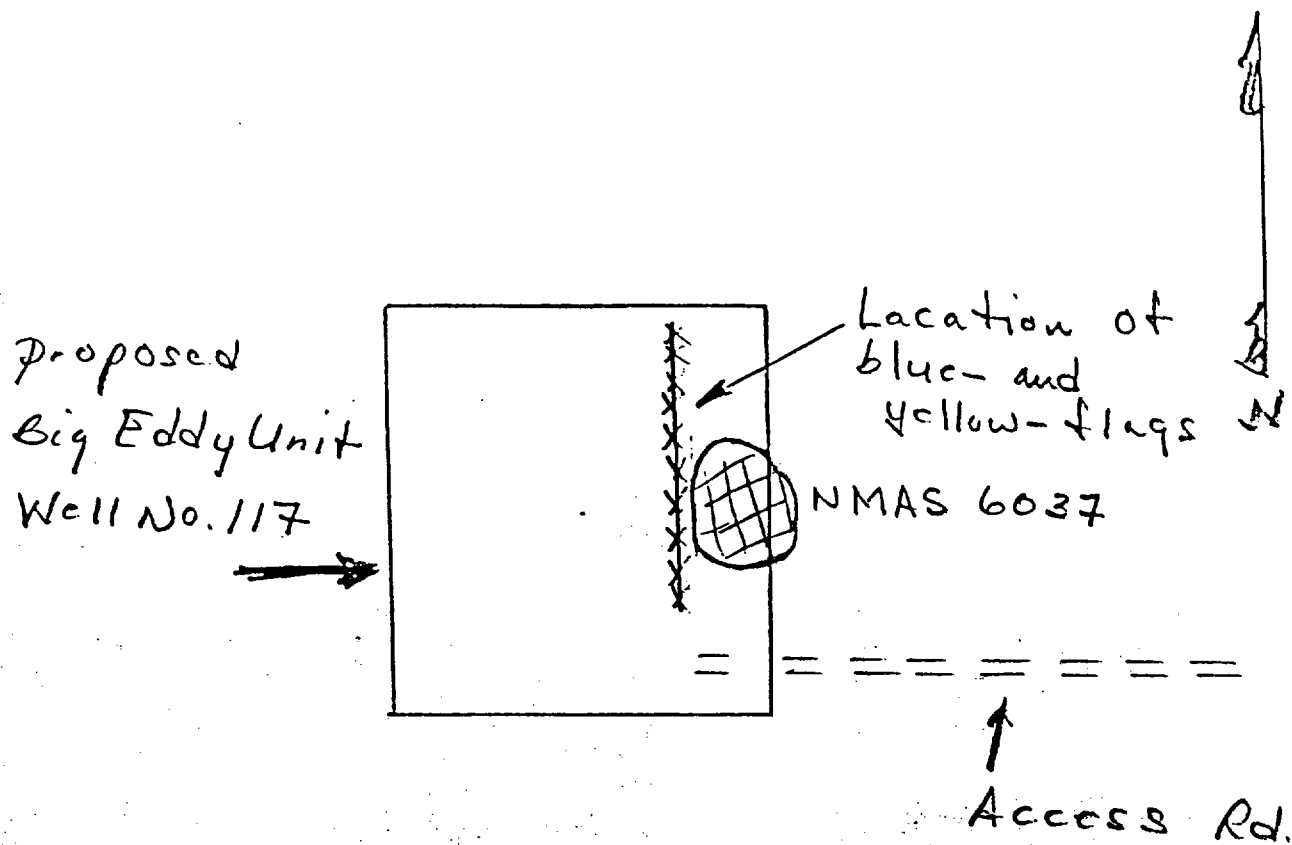

Fig. 3. Schematic representation showing BASS ENTERPRISES PRODUCTION COMPANY's proposed Big Eddy Unit Well No. 117 vis a vis NMAS 6037. As proposed, a fence will be erected at a point 100 ft east of its center thereby providing a barrier between the archaeological site and the location. Yellow- and blue- flags indicate its location in the field.

FORTSON OIL COMPANY
BIG EDDY UNIT NO. 117
EAST HERRADURA BEND FIELD
SECTION 25, T22S, R28E

I. ARCHAEOLOGICAL SURVEY REPORT DATED NOVEMBER 3, 1992. THE
PERMIT NO. IS 14-2920-92-M, REPORT NO. NMAS-1992-02-N.

II. DATE ON PROPOSED OPERATION

AVERAGE DAILY INJECTION RATE - 1200 BWPD
MAXIMUM DAILY INJECTION RATE - 2000 BWPD

AVERAGE INJECTION PRESSURE - 150 PSI
MAXIMUM INJECTION PRESSURE - 500 PSI

APPLICATION FOR AUTHORIZATION TO INJECT

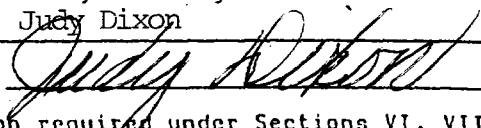
- I. Purpose: ☐ Secondary Recovery ☐ Pressure Maintenance ☒ Disposal ☐ Storage
Application qualifies for administrative approval? ☐ yes ☐ no
- II. Operator: FORTSON OIL COMPANY
Address: 3325 W. WADLEY, SUITE 213, MIDLAND, TX 79707
Contact party: Joe Igo/Judy Dixon Phone: 915-520-4347
- III. Well data: Complete the data required on the reverse side of this form for each well proposed for injection. Additional sheets may be attached if necessary.
- IV. Is this an expansion of an existing project? ☐ yes ☒ no
If yes, give the Division order number authorizing the project _____.
- V. Attach a map that identifies all wells and leases within two miles of any proposed injection well with a one-half mile radius circle drawn around each proposed injection well. This circle identifies the well's area of review.
- * VI. Attach a tabulation of data on all wells of public record within the area of review which penetrate the proposed injection zone. Such data shall include a description of each well's type, construction, date drilled, location, depth, record of completion, and a schematic of any plugged well illustrating all plugging detail.
- VII. Attach data on the proposed operation, including:
1. Proposed average and maximum daily rate and volume of fluids to be injected;
 2. Whether the system is open or closed;
 3. Proposed average and maximum injection pressure;
 4. Sources and an appropriate analysis of injection fluid and compatibility with the receiving formation if other than reinjected produced water; and
 5. If injection is for disposal purposes into a zone not productive of oil or gas at or within one mile of the proposed well, attach a chemical analysis of the disposal zone formation water (may be measured or inferred from existing literature, studies, nearby wells, etc.).
- *VIII. Attach appropriate geological data on the injection zone including appropriate lithologic detail, geological name, thickness, and depth. Give the geologic name, and depth to bottom of all underground sources of drinking water (aquifers containing waters with total dissolved solids concentrations of 10,000 mg/l or less) overlying the proposed injection zone as well as any such source known to be immediately underlying the injection interval.
- IX. Describe the proposed stimulation program, if any.
- * X. Attach appropriate logging and test data on the well. (If well logs have been filed with the Division they need not be resubmitted.)
- * XI. Attach a chemical analysis of fresh water from two or more fresh water wells (if available and producing) within one mile of any injection or disposal well showing location of wells and dates samples were taken.
- XII. Applicants for disposal wells must make an affirmative statement that they have examined available geologic and engineering data and find no evidence of open faults or any other hydrologic connection between the disposal zone and any underground source of drinking water.
- XIII. Applicants must complete the "Proof of Notice" section on the reverse side of this form.
- XIV. Certification
- I hereby certify that the information submitted with this application is true and correct to the best of my knowledge and belief.
- Name: Judy Dixon Title: Production Technician
Signature:  Date: 12/16/93
- * If the information required under Sections VI, VIII, X, and XI above has been previously submitted, it need not be duplicated and resubmitted. Please show the date and circumstance of the earlier submittal. _____

III. WELL DATA

A. The following well data must be submitted for each injection well covered by this application. The data must be both in tabular and schematic form and shall include:

- (1) Lease name; Well No.; location by Section, Township, and Range; and footage location within the section.
- (2) Each casing string used with its size, setting depth, sacks of cement used, hole size, top of cement, and how such top was determined.
- (3) A description of the tubing to be used including its size, lining material, and setting depth.
- (4) The name, model, and setting depth of the packer used or a description of any other seal system or assembly used.

Division District offices have supplies of Well Data Sheets which may be used or which may be used as models for this purpose. Applicants for several identical wells may submit a "typical data sheet" rather than submitting the data for each well.

B. The following must be submitted for each injection well covered by this application. All items must be addressed for the initial well. Responses for additional wells need be shown only when different. Information shown on schematics need not be repeated.

- (1) The name of the injection formation and, if applicable, the field or pool name.
- (2) The injection interval and whether it is perforated or open-hole.
- (3) State if the well was drilled for injection or, if not, the original purpose of the well.
- (4) Give the depths of any other perforated intervals and detail on the sacks of cement or bridge plugs used to seal off such perforations.
- (5) Give the depth to and name of the next higher and next lower oil or gas zone in the area of the well, if any.

XIV. PROOF OF NOTICE

All applicants must furnish proof that a copy of the application has been furnished, by certified or registered mail, to the owner of the surface of the land on which the well is to be located and to each leasehold operator within one-half mile of the well location.

Where an application is subject to administrative approval, a proof of publication must be submitted. Such proof shall consist of a copy of the legal advertisement which was published in the county in which the well is located. The contents of such advertisement must include:

- (1) The name, address, phone number, and contact party for the applicant;
- (2) the intended purpose of the injection well; with the exact location of single wells or the section, township, and range location of multiple wells;
- (3) the formation name and depth with expected maximum injection rates and pressures; and
- (4) a notation that interested parties must file objections or requests for hearing with the Oil Conservation Division, P. O. Box 2088, Santa Fe, New Mexico 87501 within 15 days.

NO ACTION WILL BE TAKEN ON THE APPLICATION UNTIL PROPER PROOF OF NOTICE HAS BEEN SUBMITTED:

NOTICE: Surface owners or offset operators must file any objections or requests for hearing of administrative applications within 15 days from the date this application was mailed to them.

III. WELL DATA

A. The following well data must be submitted for each injection well covered by this application. The data must be both in tabular and schematic form and shall include:

- (1) Lease name; Well No.; location by Section, Township, and Range; and footage location within the section.
- (2) Each casing string used with its size, setting depth, sacks of cement used, hole size, top of cement, and how such top was determined.
- (3) A description of the tubing to be used including its size, lining material, and setting depth.
- (4) The name, model, and setting depth of the packer used or a description of any other seal system or assembly used.

Division District offices have supplies of Well Data Sheets which may be used or which may be used as models for this purpose. Applicants for several identical wells may submit a "typical data sheet" rather than submitting the data for each well.

B. The following must be submitted for each injection well covered by this application. All items must be addressed for the initial well. Responses for additional wells need be shown only when different. Information shown on schematics need not be repeated.

- (1) The name of the injection formation and, if applicable, the field or pool name.
- (2) The injection interval and whether it is perforated or open-hole.
- (3) State if the well was drilled for injection or, if not, the original purpose of the well.
- (4) Give the depths of any other perforated intervals and detail on the sacks of cement or bridge plugs used to seal off such perforations.
- (5) Give the depth to and name of the next higher and next lower oil or gas zone in the area of the well, if any.

XIV. PROOF OF NOTICE

All applicants must furnish proof that a copy of the application has been furnished, by certified or registered mail, to the owner of the surface of the land on which the well is to be located and to each leasehold operator within one-half mile of the well location.

Where an application is subject to administrative approval, a proof of publication must be submitted. Such proof shall consist of a copy of the legal advertisement which was published in the county in which the well is located. The contents of such advertisement must include:

- (1) The name, address, phone number, and contact party for the applicant;
- (2) the intended purpose of the injection well; with the exact location of single wells or the section, township, and range location of multiple wells;
- (3) the formation name and depth with expected maximum injection rates and pressures; and
- (4) a notation that interested parties must file objections or requests for hearing with the Oil Conservation Division, P. O. Box 2088, Santa Fe, New Mexico 87501 within 15 days.

NO ACTION WILL BE TAKEN ON THE APPLICATION UNTIL PROPER PROOF OF NOTICE HAS BEEN SUBMITTED.

NOTICE: Surface owners or offset operators must file any objections or requests for hearing of administrative applications within 15 days from the date this application was mailed to them.

INJECTION WELL DATA SHEET

OPERATOR		LEASE		
FORTSON OIL COMPANY		BIG EDDY UNIT		
WELL NO.	FOOTAGE LOCATION	SECTION	TOWNSHIP	RANGE
117	330' FSL & 330' FWL	26	22S	28E

Schematic

See enclosed wellbore sketch

Tabular Data

Surface Casing

Size 11-3/4 " Cemented with 370 sx/Circ ¹⁵⁰ sx.
 TDC Surface feet determined by circulated 180 sxs
 Hole size 15"

Intermediate Casing

Size 8-5/8" " Cemented with Circ gx.
TDC Surface feet determined by circulated 196 sxs
Hole size 11"

Long string

Size 5-1/2" Cemented with 1st stg. cnt circ
 TOC DV tool @ 4497' TC 2nd st. 2450
feet determined by
 Hole size 7-7/8"

Total depth 6484'

Injection interval

2950-58 2968-72
feet to feet
(perforated or open hole, indicate which)

Tubing size 2-7/8" lined with Salta Line set in a
(material)
Sur-Loc packer at 2800 feet
(brand and model)

(or describe any other casing-tubing seal).

Other Data

Delaware (Brushy Canyon)

1. Name of the injection formation Delaware (Brushy Canyon)
2. Name of Field or Pool (if applicable) East Herradura Bend
3. Is this a new well drilled for injection? ☐ Yes ☒ No
- If no, for what purpose was the well originally drilled? Producer, was not commercial
4. Has the well ever been perforated in any other zone(s)? List all such perforated intervals and give plugging detail (sacks of cement or bridge plug(s) used) CIBP 6130
CIBP @ 5950, 4325, 3050, Perf Intervals 6146-60 (60 holes) 6012-93 (432 holes)
4281-89 (33 holes) 2968-72 (17 holes) 2950-58 (33 holes)
5. Give the depth to and name of any overlying and/or underlying oil or gas zones (pools) in this area. See Paragraph VI

State Well

Big Eddy Lwr P. 117
SW 25-22S-28E

GL 3125

11 3/4 @ 448

CMTD w/ 370 SKS
CIRC w/ 180 SKS

5 1/2" 14 + 15.5 PPF
@ 6484

8 5/8 CSC @ 2670 (CIRC. CAT TO SURF)

CIRC CMT on 1st Stage
TC 2nd Stage ± 2450'

FC @ 6387

DV @ 4497

CIBP 3050

Perfs 2950-58 (33 holes)
2968-72 (17 holes)
ACIDIZED w/ 1000 gal

CIBP 4325

CIBP 5950

PERFS 4281-89 (33 holes)
ACIDIZED w/ 500 gal

CIBP 6130

* Perfs 6012-93 (432 holes)
FRAC'D w/ 12,000 #

PERFS 6146-60 (60 holes)
Prod'd Dry - 300' water/hr.

WELLS/LEASES WITHIN TWO MILES
THAT PENETRATE ZONE OR DEEPER

T22S, R28E, SECTION 26:

BIRD CREEK #1 RML FEDERAL BRUSHY CANYON

T22S, R28E, SECTION 27:

J. C. BARNES #1	LITTLE SQUAW COM	MORROW
J. C. BARNES #32	LITTLE SQUAW	ATOKA

T22S, R28E, SECTION 34:

SANTA FE ENERGY #1 NE LOVING - FEDERAL ATOKA
SANTA FE ENERGY #2 NE LOVING - FEDERAL DELAWARE 3700'

T22S, R28E, SECTION 35:

HANLEY	PETROLEUM	#1	UNION	FEDERAL	ATOKA PB BRUSHY CANYON
HANLEY	PETROLEUM	#2	UNION	FEDERAL	BRUSHY CANYON
HANLEY	PETROLEUM	#3	UNION	FEDERAL	BRUSHY CANYON
HANLEY	PETROLEUM	#4	UNION	FEDERAL	BRUSHY CANYON
HANLEY	PETROLEUM	#5	UNION	FEDERAL	BRUSHY CANYON

RAY WESTFALL #1-8 SANTA FE FEDERAL BRUSHY CANYON

T22S, R28E, SECTION 36:

FORTSON OIL COMPANY #1-11 PINNACLE STATE BRUSHY CANYON

T22S, R29E, SECTION 31:

COLLINS & WARE #1 QUAHADA RIDGE FEDERAL BRUSHY CANYON

T23S, R28E, SECTION 1:

CHEVRON USA #1,2,4,5 LENTINI FEDERAL BRUSHY CANYON

T23S, R28E, SECTION 2:

H. E. YATES	#1 LOVING STATE	BRUSHY CANYON
SANTA FE ENERGY #1-4	WARTHOG STATE	BRUSHY CANYON
BIRD CREEK RESOURCES #1	GO AMOCO STATE	WDW DELAWARE
		CHERRY CANYON

T23S, R28E, SECTION 3:

BIRD CREEK RESOURCES 31, 32 BCR FEDERAL BRUSHY CANYON

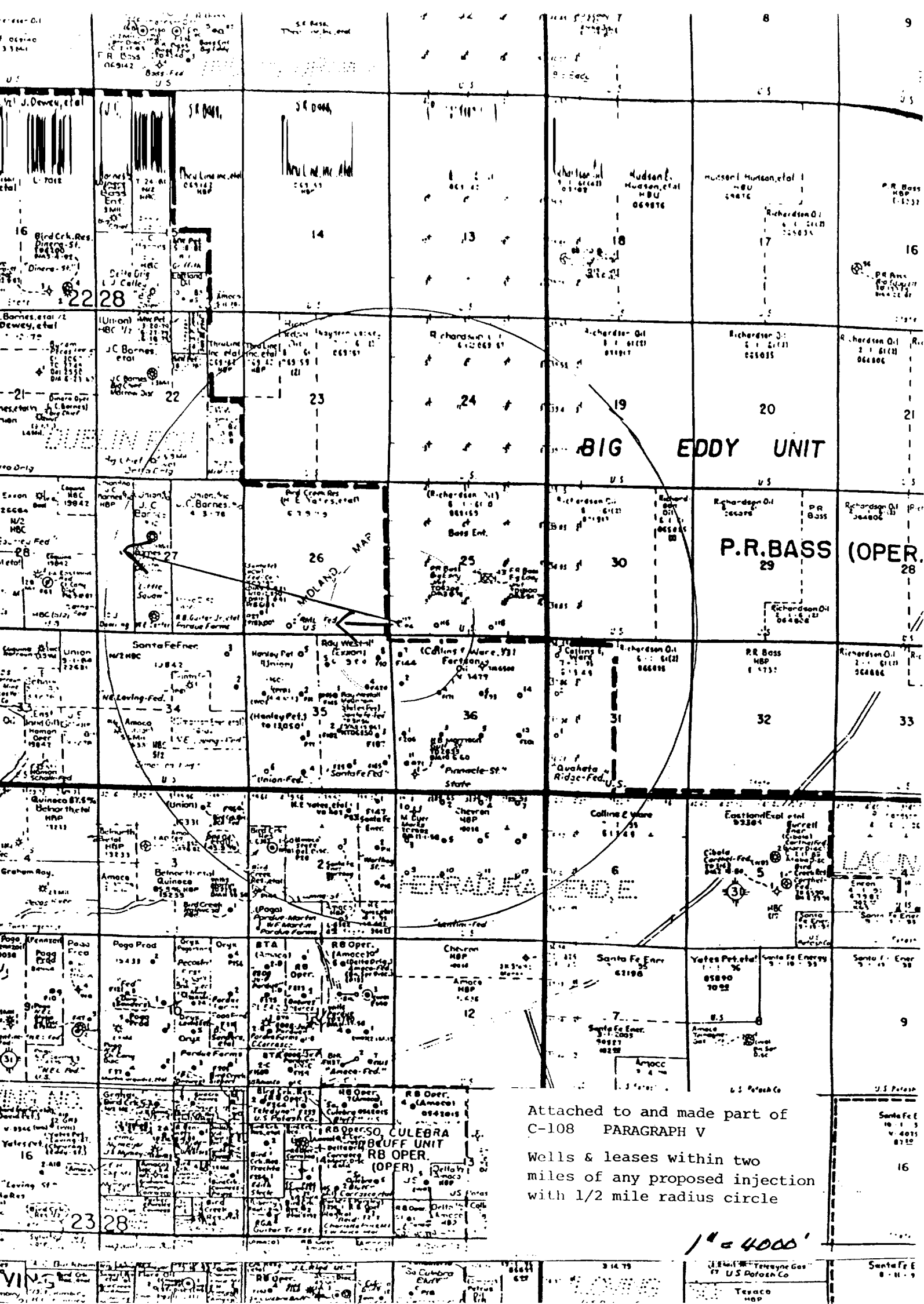

FORTSON OIL COMPANY

BIG EDDY UNIT #117
 Section 25-T22S, R28E, Unit M
 Eddy County, New Mexico
 (330' FSL & 330' FWL)

Tubulated data of all producing wells on public record within area of review.

LEASE	Well NO	(ALL IN T22S, Location R28E)	Well Type	Date Drilled	Depth	Completion Interval
FORTSON OIL COMPANY						
Pinnacle State	2	1650' NL & 330' WL of Sec. 36E,	Oil <i>TOC = 2500'</i>	8/9/92 spud 9/18/92 comp.	6400	6184-6210 5970-6000
Pinnacle State	#4	1980 FN & 1650' WL Sec. 36F	Oil <i>SURFACE</i>	9/3/92 Spud 12/10/92 Comp	6390	6000-6016
Pinacle State	#7	660' FN & 330' WL Sec. 36D	Oil <i>SURFACE</i>	9/30/92 Spud 11/9/92 Comp	6440	6000-6032 6238-6258
Pinnacle State	#8	467' FN & 1650' FWL Sec. 36C	Oil <i>SURFACE</i>	10/13/92 Spud 11/28/92 Comp	6430	6020-6066 6256-6270
RAY WESTFALL						
Santa Fe Fed.	#4	1730' FN & 910' EL of Sec 35H	Oil <i>SURFACE</i>	7/9/92 Spud 8/5/92 Comp	6370	5967-6009 6162-6233
Santa Fe Fed.	#8	760' FN & 460' EL of Sec 35A	Oil <i>SURFACE</i>	10/21/92 Spud 11/16/92 Comp	6350	5996-6060 6170-6250

PARAGRAPH VI

PROPOSED CONVERSION OF BIG EDDY UNIT NO. 117

(SEE ATTACHED C-108 FOR QUESTIONS)

- VII.
1. AVERAGE DAILY INJECTION RATE - (INITIAL) 1200 BWPD
MAXIMUM DAILY INJECTION RATE - (INITIAL) 2000 BWPD
 2. SYSTEM IS CLOSED
 3. PROPOSED AVERAGE DAILY INJECTION PRESSURE -
(INITIAL) 150 PSI

PROPOSED MAXIMUM DAILY INJECTION PRESSURE -
(INITIAL) 500 PSI
 4. WILL BE REINJECTING PRODUCED WATER
 5. WELL IS FOR DISPOSAL PURPOSES
- VIII.
- THE PROPOSED INJECTION ZONE IN THE #117 BIG EDDY UNIT IS THE BELL CANYON MEMBER OF THE DELAWARE MOUNTAIN GROUP. MORE SPECIFICALLY THE PERFORATIONS ARE 2950-58; 2968-72. THE INJECTION ZONE IS A FINE-GRAINED SANDSTONE. IN THIS WELLBORE THE BELL CANYON OCCURS BETWEEN 2812 AND 3612. THERE ARE NO KNOWN FRESH WATER AQUIFERS BELOW THE TOP OF THE RUSTLER AT 454'. FRESH WATER MAY BE PRESENT IN THE ZONE FROM 0-454'.
- IX.
- SEE WELLBORE SKETCH
- X.
- WELL LOGS ALREADY ON FILE WITH NMOCD OFFICE IN ARTESIA
- XI.
- NOT AVAILABLE
- XII.
- DISPOSAL WELL

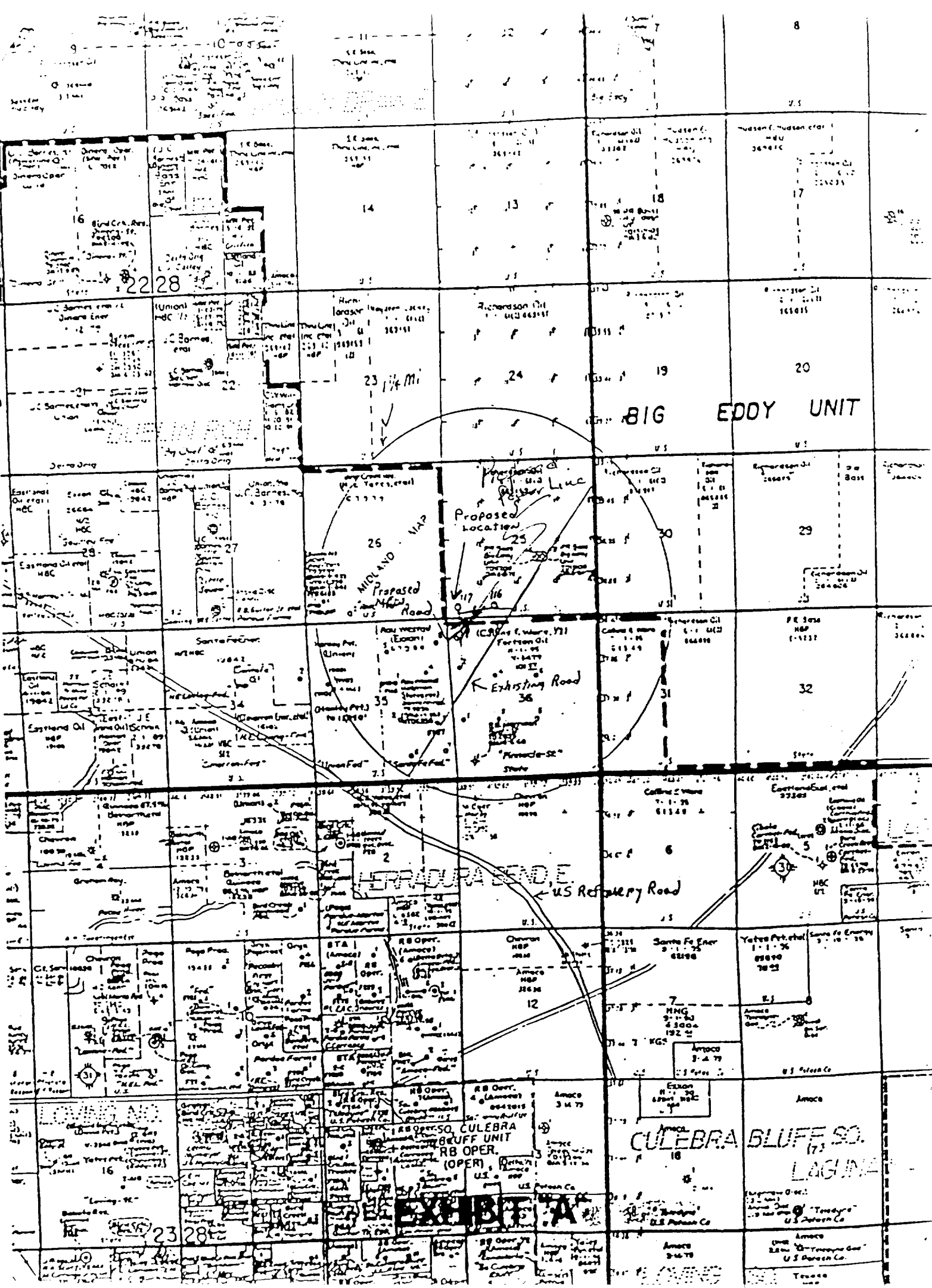

Notice of Application for Salt Water Disposal Well

APPLICANT: Fortson Oil Company
3325 W. Wadley, Suite 213
Midland, Texas 79707
Telephone: (915) 520-4347
Contact: J. W. Dixon

PURPOSE: Convert to Salt Water Disposal Well
Big Eddy Unit No. 117
Location: Sec. 25, T22S, R28E, Unit M
County: Eddy County, NM

OPERATIONAL CHARACTERISTICS: Formation - Delaware
E. Herradura Bend Field
Proposed Interval: 2950-58,
2968-72'

Interested parties may file objections or request a hearing with the Oil Conservation Division, P.O. Box 2088, Santa Fe, New Mexico, 87501, within 15 days of this notice.

DATE: December 22, 1993

Before me, the undersigned authority, on this day personally appeared
Arnell Taylor, the Business Mgr. of
(NAME) (TITLE)
the CARLSBAD CURRENT-ARGUS, INC., a newspaper having general
(NAME OF NEWSPAPER)

circulation in EDDY County, New Mexico, who being by me duly
sworn says that the foregoing attached notice was published in this
newspaper on the following date(s), to wit; December 22, 1993.

Arnell Taylor
(SIGNATURE)

Subscribed and sworn to before me this the 22 day of DECEMBER,
1993, to certify which witness my hand and seal of office.

December 22, 1993

**APPLICATION FOR
AUTHORIZATION FOR SALT
WATER DISPOSAL WELL**

1. Fortson Oil Company, 3325
W. Wedley, Suite 213, Mid-
land, TX 79707 Attn: Judy
Dixon, (915) 520-4347

will apply for permission to
dispose of salt water through
the subject well.

2. **Well Name and Number:**
Big Eddy Unit No. 117
Location: 330' FSL & 330'
FWL Sec. 25
T22S, R28E
Eddy County, New Mexico

3. **Formation Name:** East
Herradura Bend (Delaware)
Injection Interval: 2950-72;
2868-72
Maximum Inj. Rate: 5000
BBL/day/well
Maximum Pressure: 1000
PSI

4. **INTERESTED PARTIES,
WHO CAN SHOW THAT
THEY ARE ADVERSELY AF-
FECTED BY THIS APPLICA-
TION, MUST FILE OBJEC-
TIONS OR REQUESTS FOR
HEARING WITH THE EN-
ERGY AND MINERALS DE-
PARTMENT OR CONSERVA-
TION DIVISION, P.O. BOX
1000, SANTA FE, NEW MEX-
ICO 87504, WITHIN 15 DAYS
AFTER THIS PUBLICATION.**

Rinda J. Martin
NOTARY PUBLIC IN AND FOR

EDDY COUNTY, NM

My commission expires 7/22/96.

OFFSET OPERATORS

Bass Enterprises - Big Eddy Unit #117 Well, located in the SW/4 SW/4 of Section 25, T-22-S, R-28-E, N.M.P.M., Eddy County, New Mexico.

Tract 1 - all of Section 25, T-22-S, R-28-E:

Bass Enterprises Production Co.
201 Main Street, Suite 2900
Fort worth, TX 76102

Tract 2 - Section 36, T-22-S, R-28-E:

Fortson Oil Company
301 Commerce Street, Suite 3301
Fort Worth, TX 76102

Tract 3 - E/2 of Section 35, T-22-S, R-28-E:

Ray Westfall
P.O. Box 4
Loco Hills, NM 88255

Tract 4 - W/2 of Section 35, T-22-S, R-28-E:

Hanley Petroleum, Inc.
415 W. Wall, Suite 1500
Midland, TX 797901

Tract 5 - SW/4 SW/4 of Section 26, T-22-S, R-28-E:

Bird Creek Resources
P.O. Box 21470
Tulsa, OK 74121

Tract 6 - N/2, SE/4, N/2 SW/4, SE/4 SW/4 of Section 26, T-22-S, R-28-E:

Fortson Oil Company
301 Commerce Street, Suite 3301
Fort Worth, TX 76102

Heyco - Harvey E. Yates Company
P.O. Box 1933
Roswell, NM 88201

Tract 7 - W/2 of Section 23, T-22-S, R-28-E:

Bass Enterprises Production Co.
201 Main Street, Suite 2900
Fort Worth, TX 76102

Tract 8 - E/2 of Section 23, T-22-S, R-28-E:

Ownership undetermined, currently being researched.

Tract 9 - Section 24, T-22-S, R-28-E:

Bass Enterprises Production Co.
201 Main Street, Suite 2900
Fort Worth, TX 76102

Tract 10 - Section 19, T-22-S, R-29-E:

Bass Enterprises Production Co.
201 Main Street, Suite 2900
Fort Worth, TX 76102

Tract 11 - Section 11, T-22-S, R-29-E:

Bass Enterprises Production Co.
201 Main Street, Suite 2900
Fort Worth, TX 76102

Tract 12 - W/2 of Section 31, T-22-S, R-29-E:

Collins & Ware
303 W. Wall, Suite 2200
Midland, TX 79701

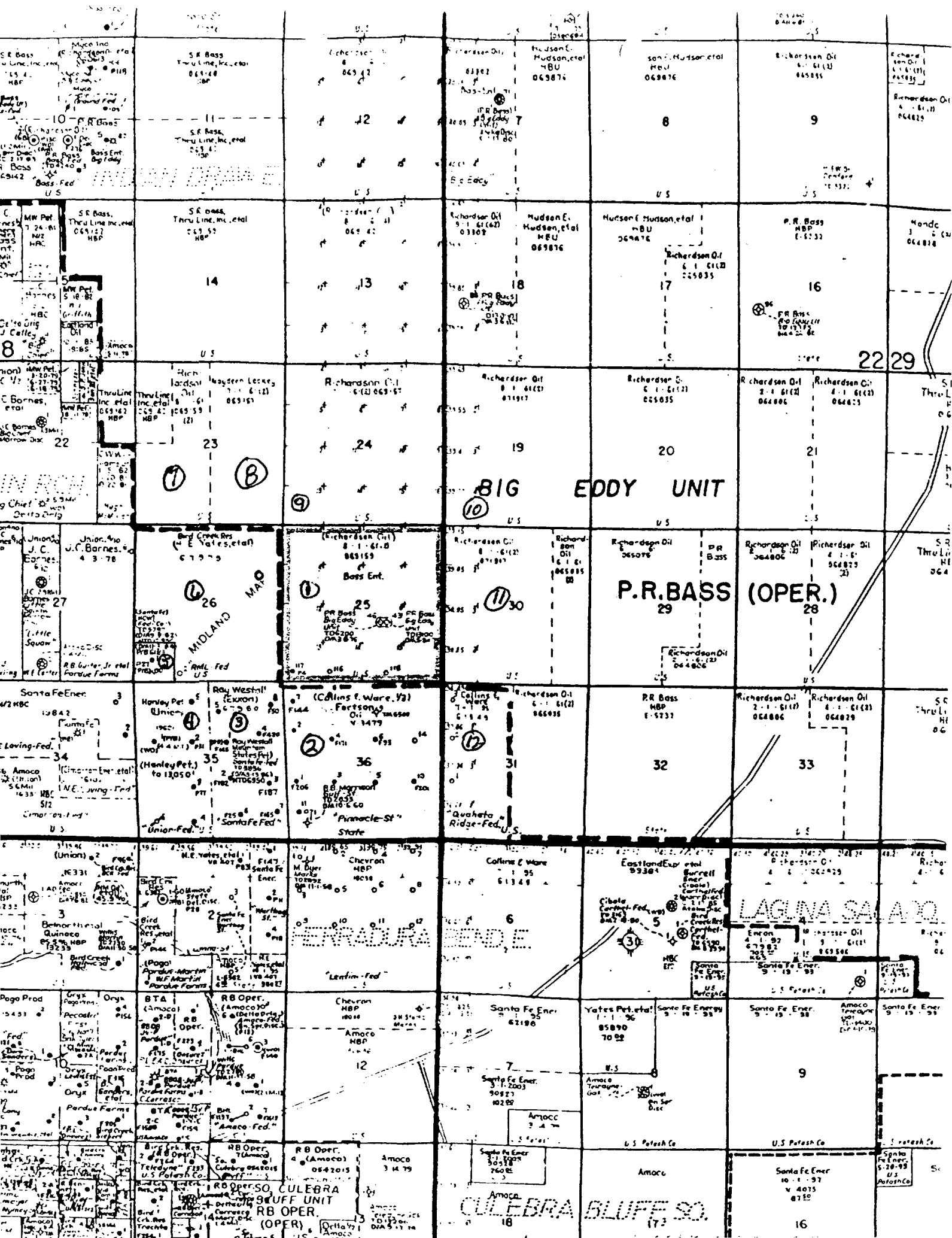

**FORTSON OIL COMPANY
BIG EDDY UNIT WELL NO. 117
SECTION 25, T-22-S, R-28-E
EDDY COUNTY, NEW MEXICO**

This application was sent by certified mail to the surface owner of the land on which the well is located and to each lease operator within one-half mile radius of the well location.

SURFACE OWNERS:

New Mexico Oil Conservation Commission
P.O. Box 2088
Santa Fe, NM 87501
Attn: Ben Stone

Offset Operators:

Bass Enterprises Production Co.
201 Main Street, Suite 2900
Fort Worth TX 76102

Ray Westfall
P.O. Box 4
Loco Hills, NM 88255
Attn: Randy Harris

Hanley Petroleum, Inc.
415 W. Wall, Suite 1500
Midland, TX 79701

Heyco - Harvey E. Yates Company
P.O. Box 1933
Roswell, NM 88201

Mr. Jim Orseth
Collins & Ware
303 W. Wall, Suite 2200
Midland, TX 79701

Bird Creek Resources
P.O. Box 21470
Tulsa, OK 74121

FORTSON OIL COMPANY
3325 W. WADLEY, STE 213
MIDLAND, TX 79707

CERTIFIED - MAIL
RETURN RECEIPT REQUESTED

January 11, 1993

Bass Enterprises Production Co.
201 Main Street, Suite 2900
Fort Worth, TX 76102

NOTICE OF APPLICATION FOR
SALT WATER DISPOSAL WELL
BIG EDDY UNIT NO. 117

Gentlemen:

On November 10, 1993, Fortson Oil Company made application to the Oil Conservation Commission of New Mexico for authority to dispose of salt water through the subject well at an interval of 6012-93. This application was withdrawn and Fortson is now requesting to dispose at an interval of 2950-72.

A copy of this application is furnished to you for your information.

Yours very truly,

FORTSON OIL COMPANY

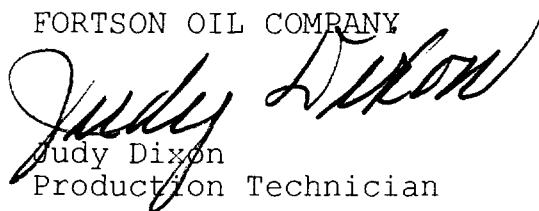
Judy Dixon
Production Technician

JWDixon
Attachments
cc: Oil Conservation Commission (w/attach)

**FORTSON OIL COMPANY
3325 W. WADLEY, STE 213
MIDLAND, TX 79707**

**CERTIFIED - MAIL
RETURN RECEIPT REQUESTED**

January 11, 1993

Ray Westfall
P.O. Box 4
Loco Hills, NM 88255
Attn: Randy Harris

NOTICE OF APPLICATION FOR
SALT WATER DISPOSAL WELL
BIG EDDY UNIT NO. 117

Gentlemen:

On November 10, 1993, Fortson Oil Company made application to the Oil Conservation Commission of New Mexico for authority to dispose of salt water through the subject well at an interval of 6012-93. This application was withdrawn and Fortson is now requesting to dispose at an interval of 2950-72.

A copy of this application is furnished to you for your information.

Yours very truly,

FORTSON OIL COMPANY

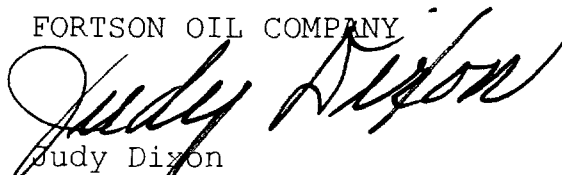
Judy Dixon
Production Technician

JWDixon
Attachments
cc: Oil Conservation Commission (w/attach)

**FORTSON OIL COMPANY
3325 W. WADLEY, STE 213
MIDLAND, TX 79707**

**CERTIFIED - MAIL
RETURN RECEIPT REQUESTED**

January 11, 1993

Hanley Petroleum, Inc.
415 W. Wall, Suite 1500
Midland, TX 79701

NOTICE OF APPLICATION FOR
SALT WATER DISPOSAL WELL
BIG EDDY UNIT NO. 117

Gentlemen:

On November 10, 1993, Fortson Oil Company made application to the Oil Conservation Commission of New Mexico for authority to dispose of salt water through the subject well at an interval of 6012-93. This application was withdrawn and Fortson is now requesting to dispose at an interval of 2950-72.

A copy of this application is furnished to you for your information.

Yours very truly,

FORTSON OIL COMPANY

Judy Dixon
Production Technician

JWDixon
Attachments
cc: Oil Conservation Commission (w/attach)

FORTSON OIL COMPANY
3325 W. WADLEY, STE 213
MIDLAND, TX 79707

**CERTIFIED - MAIL
RETURN RECEIPT REQUESTED**

January 11, 1993

Heyco - Harvey E. Yates Company
P.O. Box 1933
Roswell, NM 88201

NOTICE OF APPLICATION FOR
SALT WATER DISPOSAL WELL
BIG EDDY UNIT NO. 117

Gentlemen:

On November 10, 1993, Fortson Oil Company made application to the Oil Conservation Commission of New Mexico for authority to dispose of salt water through the subject well at an interval of 6012-93. This application was withdrawn and Fortson is now requesting to dispose at an interval of 2950-72.

A copy of this application is furnished to you for your information.

Yours very truly,

FORTSON OIL COMPANY

Judy Dixon
Production Technician

JWDixon
Attachments
cc: Oil Conservation Commission (w/attach)

**FORTSON OIL COMPANY
3325 W. WADLEY, STE 213
MIDLAND, TX 79707**

**CERTIFIED - MAIL
RETURN RECEIPT REQUESTED**

January 11, 1993

Mr. Jim Orseth
Collins & Ware, Inc.
303 W. Wall, Suite 2200
Midland, TX 79701

NOTICE OF APPLICATION FOR
SALT WATER DISPOSAL WELL
BIG EDDY UNIT NO. 117

Gentlemen:

On November 10, 1993, Fortson Oil Company made application to the Oil Conservation Commission of New Mexico for authority to dispose of salt water through the subject well at an interval of 6012-93. This application was withdrawn and Fortson is now requesting to dispose at an interval of 2950-72.

A copy of this application is furnished to you for your information.

Yours very truly,

FORTSON OIL COMPANY

Judy Dixon
Production Technician

JWDixon
Attachments
cc: Oil Conservation Commission (w/attach)

FORTSON OIL COMPANY
3325 W. WADLEY, STE 213
MIDLAND, TX 79707

**CERTIFIED - MAIL
RETURN RECEIPT REQUESTED**

January 11, 1993

Bird Creek Resources
P.O. Box 21470
Tulsa, OK 74122

NOTICE OF APPLICATION FOR
SALT WATER DISPOSAL WELL
BIG EDDY UNIT NO. 117

Gentlemen:

On November 10, 1993, Fortson Oil Company made application to the Oil Conservation Commission of New Mexico for authority to dispose of salt water through the subject well at an interval of 6012-93. This application was withdrawn and Fortson is now requesting to dispose at an interval of 2950-72.

A copy of this application is furnished to you for your information.

Yours very truly,

FORTSON OIL COMPANY.

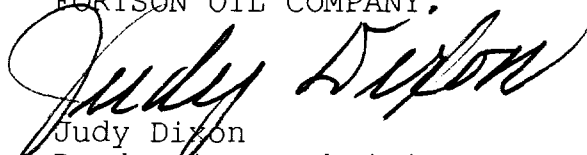
Judy Dixon
Production Technician

JWDixon
Attachments
cc: Oil Conservation Commission (w/attach)

FORTSON OIL COMPANY
3325 W. WADLEY, STE. 213
MIDLAND, TX 79707

County Clerk
P.O. Box 850
Carlsbad, NM 88221

NOTICE OF APPLICATION FOR
SALT WATER DISPOSAL
BIG EDDY UNIT WELL NO. 117
EDDY COUNTY, NEW MEXICO

Gentlemen:

Fortson Oil Company has made application to the Oil Conservation Commission of New Mexico to dispose of produced salt water or other oil and gas waste by well injection into a porous formation not productive of oil or gas.

The Oil Conservation Division requires that the enclosed application be sent to you for public information notice in the county in which the well is located. Please post the attached application as you desire.

Yours very truly,

FORTSON OIL COMPANY

Judy Dixon
Production Technician

JWDixon

Attachments

cc: Oil Conservation Commission (w/attach)

12/15/93 2:00PM Tx time

Talked to Ben Stone- Oil Conservation Division
Our Big Eddy Ut #117 was ~~set~~ up for
hearing 1/6/93 since Westfall and Collins
& Ware were protesting-- therefore, could
not be administratively approved--had to
go to hearing--

I visited with Florene Davidson - *HEARINGS*
(505) 827-5802 or 5803

She withdrew the hearing ~~and~~ *ad* that they would
have ran in the paper--and is pretending
like they don't have it--resubmitting back
to Ben Stone to hold until I resubmit the
other SWD application.



STATE OF NEW MEXICO
ENERGY, MINERALS AND NATURAL RESOURCES DEPARTMENT
OIL CONSERVATION DIVISION



BRUCE KING
GOVERNOR

ANITA LOCKWOOD
CABINET SECRETARY

POST OFFICE BOX 2088
STATE LAND OFFICE BUILDING
SANTA FE, NEW MEXICO 87504
(505) 827-5800

May 18, 1994

Fortson Oil Company
3325 W. Wadley, Suite 213
Midland, TX 79707

Attention: Joe Igo

***RE: Injection Pressure Increase
Big Eddy Unit No. 117
Eddy County, New Mexico***

Dear Mr. Igo:

Reference is made to your request dated May 2, 1994 to increase the surface injection pressure on the Big Eddy Unit Well No. 117. This request is based on a step rate test conducted on the well on April 18, 1994. The results of the test have been reviewed by my staff and we feel an increase in injection pressure on the well is justified at this time.

You are therefore authorized to increase the surface injection pressure on the following well:

Well and Location	Maximum Surface Injection Pressure
Big Eddy Unit No. 117 Unit M, Section 25, Township 22 South, Range 28 East, NMPM, Eddy County, New Mexico.	900 PSIG

The Division Director may rescind this injection pressure increase if it becomes apparent that the injected water is not being confined to the injection zone or is endangering any fresh water aquifers.

Sincerely,

William J. LeMay
Director

WJL/DRC/amg

cc: Oil Conservation Division - Artesia
R. Brown
File: SWD-551