

AMEND SWD 2/18/97

Mid-Continent Region
Production United States



P.O. Box 552
Midland, TX 79702-0552
Telephone 915/682-1626

FEB 18 1997

State of New Mexico
Oil Conservation Division
2040 South Pacheco
Santa Fe, New Mexico
87505
Attn: Mr Ben Stone

Re: Reinstate SWD Permit No. 439
Conversion to SWD in Devonian Formation
Indian Basin "A" Well No. 1
1650' FSL & 1650' FEL UL "J"
Sec 22, T21S, R23E
Eddy County, New Mexico

Dear Sir,

Marathon Oil Company obtained approval to convert the referenced well to SWD 10/28/91 as per the referenced SWD No. 439. The well was not converted and is presently temporarily abandoned. Due to increasing the water associated with our Co Production efforts additional water disposal capacity is urgently needed. Co Production is Marathon's term for artificially lifting large quantities of water to increase gas production.

The well will be completed in the same zone as the original permit but completion method will be different. A well bore diagram with the proposed completion is attached.

A map showing the Area of Review is also attached along. The proposed average and maximum injection rates; are increased to 12,000 BWPD and 15,000 BWPD respectively. The proposed maximum and average injection pressures are 1,000 PSIG and 2,080 PSIG respectively.

Also the original permit included data from the two wells listed below which was not necessary as neither met the conditions of Form 108 as being inside the AOR and penetrating the proposed injection zone. See attached plate showing distance and well TD.

You may call 1-800-351-1417 for clarification of any issues.

Sincerely

A handwritten signature in cursive script, appearing to read 'Thomas M. Price'.

Thomas M. Price
Advanced Engineering Technician

Area of Review

Indian Basin "A" No. 1

Proposed Disposal Well

SWD Permit No. 439

Section 22

Section 23

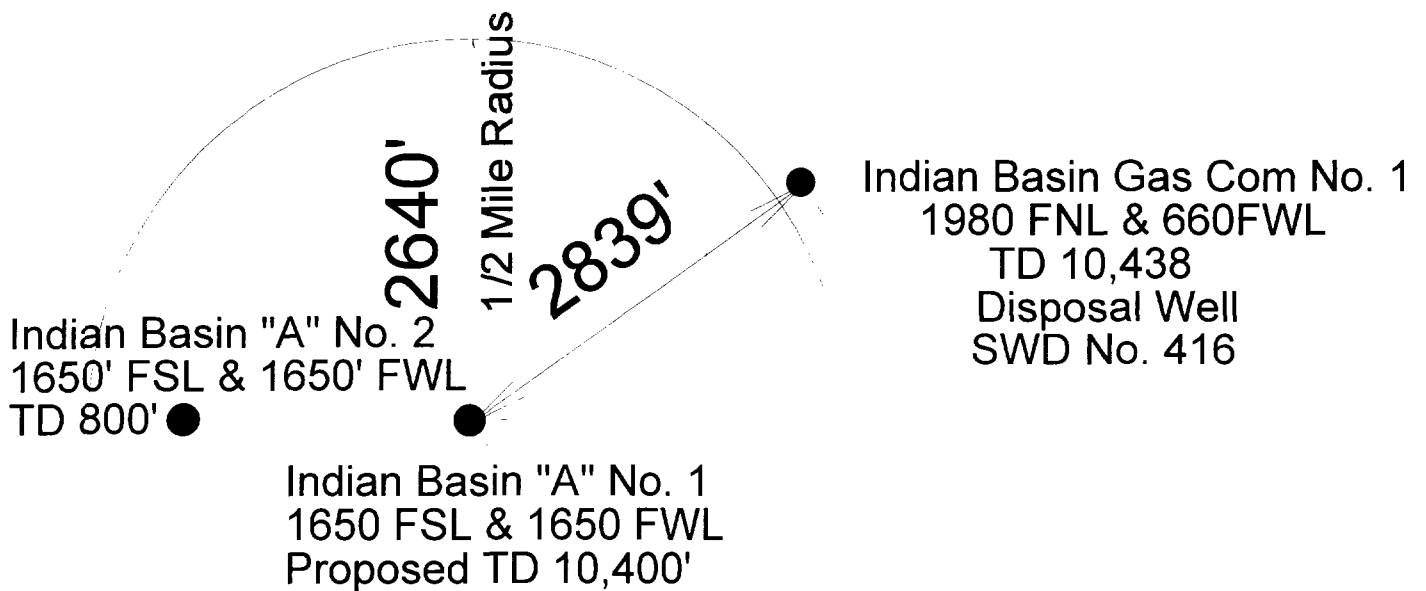

Section 27

Section 26

Marathon Oil Company
 Indian Basin "A" No. 1
 UL "J" 1650' FSL & 1650' FEL
 Sec 22, T21S, R23E
 Eddy Co., NM

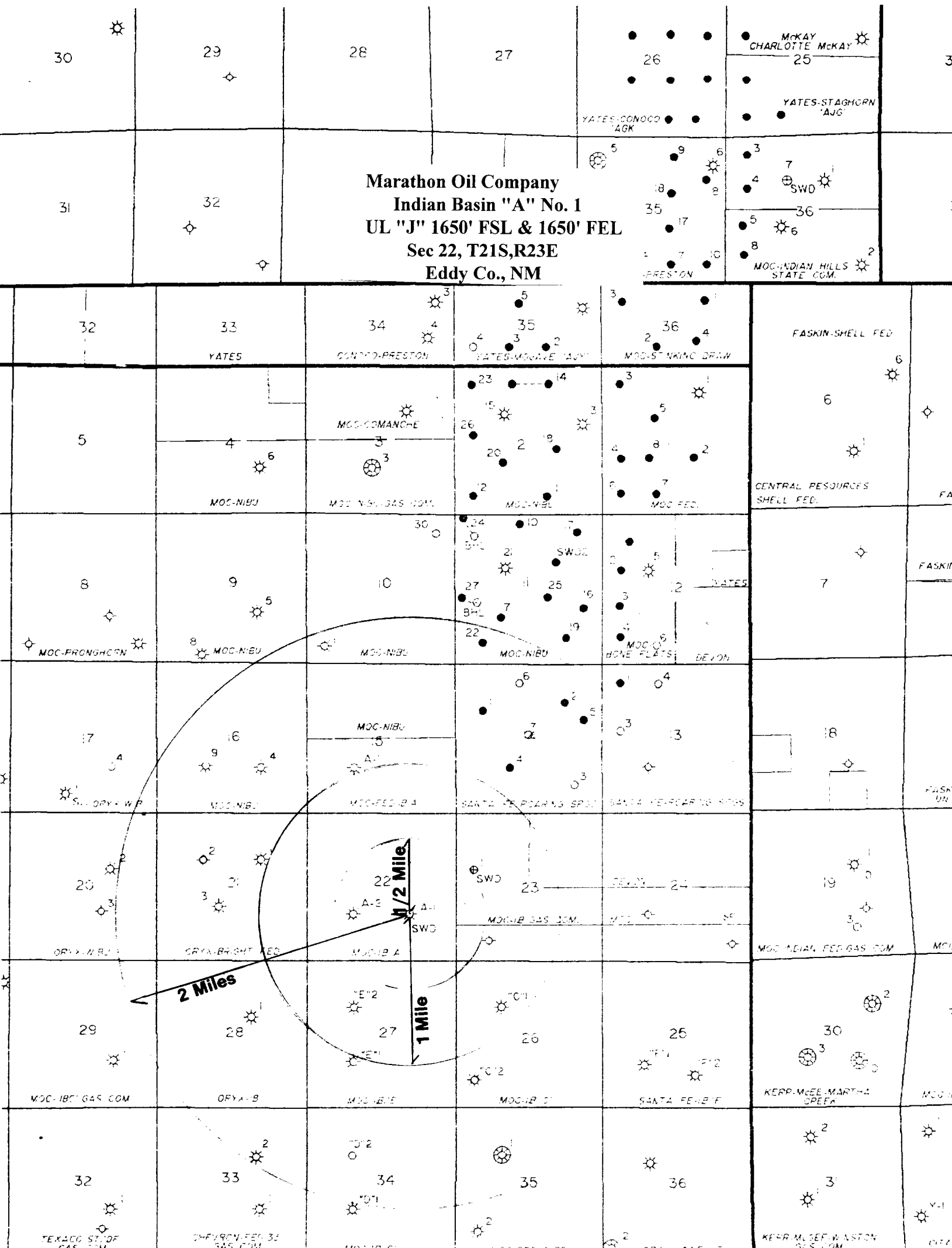

WELL DATA SHEET

INDIAN BASIN A.H. 1222
SECTION 82, T11N & R1E
1650' S & 1450' E
EDDY COUNTY, NEW MEXICO

TD 4450' @ 3800'

9-5/8"
@ 1923'

9-3/8" 12 RI 100' 1200'
1" & 1/2" 60' 1200' 1200'
100' 1200' 1200'

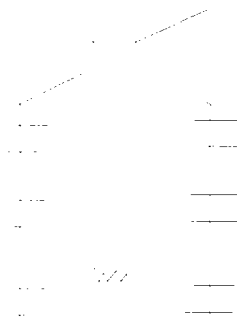

PERFS 7380-81 TAD SQUEEZED W 4000x

PERFS 7360-81 TAD SQUEEZED W 4000x

PERFS: 7374'-84'

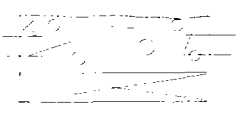

PERFS 7414' 81 TAD SQUEEZED W 4000x



PERFS 7505-81 TAD SQUEEZED W 4000x

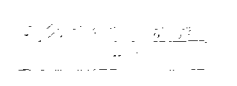

PERFS 9118-31 TAD



PERFS 9988-99 TAD



10-3/8"
@ 1923'

NOTE FISH LEFT IN WELL DRAIN PUMPED OUT BY 11/1/74
TUBING COLLAPSED IN WELL

1000 490 DATA S-EE

INDIAN AREA 4 # 1000
SECTION 107 E. 8 N. 40 W.
1630' 10" & 1000' 10"
EDDY CREEK NEW YORK

9-5/8"
1925'

8-5/8"
1925'

2 3/8" 10 RD 730' 10"
10 & 10' 10" 1000' 10" 1000' 10"
1000' 10" 1000' 10"

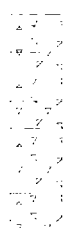

PERFS 7300-82 1000' 10" 1000' 10"

PERFS 7360-82 1000' 10" 1000' 10"

PERFS 7374-81

PERFS 7414-81 1000' 10" 1000' 10"



PERFS 7505-72 1000' 10" 1000' 10"

4 1/2" 1000' 10" 1000' 10" 1000' 10"

4 1/2" 1000' 10" 1000' 10"

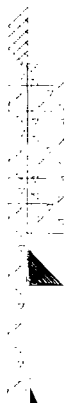
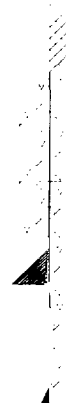

PERFS 9018-81 1000' 10"

PERFS 9256-81 1000' 10"

7380

4 1/2" 1000' 10" 1000' 10"

1000' 10"