

1/18/01	2/7/01		KW	PLC
---------	--------	--	----	-----

ABOVE THIS LINE FOR DIVISION USE ONLY

NEW MEXICO OIL CONSERVATION DIVISION  
- Engineering Bureau -

102245824

ADMINISTRATIVE APPLICATION COVERSHEET

THIS COVERSHEET IS MANDATORY FOR ALL ADMINISTRATIVE APPLICATIONS FOR EXCEPTIONS TO DIVISION RULES AND REGULATIONS

Application Acronyms:

[NSP-Non-Standard Proration Unit] [NSL-Non-Standard Location]  
[DD-Directional Drilling] [SD-Simultaneous Dedication]  
[DHC-Downhole Commingling] [CTB-Lease Commingling] [PLC-Pool/Lease Commingling]  
[PC-Pool Commingling] [OLS - Off-Lease Storage] [OLM-Off-Lease Measurement]  
[WFX-Waterflood Expansion] [PMX-Pressure Maintenance Expansion]  
[SWD-Salt Water Disposal] [IPI-Injection Pressure Increase]  
[EOR-Qualified Enhanced Oil Recovery Certification] [PPR-Positive Production Response]

1633

[1] TYPE OF APPLICATION - Check Those Which Apply for [A]

- [A] Location - Spacing Unit - Directional Drilling  
☐ NSL ☐ NSP ☐ DD ☐ SD

Check One Only for [B] or [C]

- [B] Commingling - Storage - Measurement  
☐ DHC ☐ CTB ☐ PLC ☒ PC ☐ OLS ☒ OLM

- [C] Injection - Disposal - Pressure Increase - Enhanced Oil Recovery  
☐ WFX ☐ PMX ☐ SWD ☐ IPI ☐ EOR ☐ PPR

JAN 18

[2] NOTIFICATION REQUIRED TO: - Check Those Which Apply, or ☐ Does Not Apply

- [A] ☒ Working, Royalty or Overriding Royalty Interest Owners

- [B] ☐ Offset Operators, Leaseholders or Surface Owner

- [C] ☐ Application is One Which Requires Published Legal Notice

- [D] ☒ Notification and/or Concurrent Approval by BLM or SLO

U.S. Bureau of Land Management - Commissioner of Public Lands, State Land Office

- [E] ☒ For all of the above, Proof of Notification or Publication is Attached, and/or,

- [F] ☐ Waivers are Attached

*Letter of Notification is Attached.  
Copies of Certified Return Receipts  
will be forwarded upon receiving*

[3] INFORMATION / DATA SUBMITTED IS COMPLETE - Statement of Understanding

I hereby certify that I, or personnel under my supervision, have read and complied with all applicable Rules and Regulations of the Oil Conservation Division. Further, I assert that the attached application for administrative approval is accurate and complete to the best of my knowledge and where applicable, verify that all interest (WI, RI, ORRI) is common. I further verify that all applicable API Numbers are included. I understand that any omission of data, information or notification is cause to have the application package returned with no action taken.

Note: Statement must be completed by an individual with supervisory capacity.

John D. Roe  
Print or Type Name

*John D. Roe*  
Signature

Engineering Manager  
Title

1-16-01  
Date

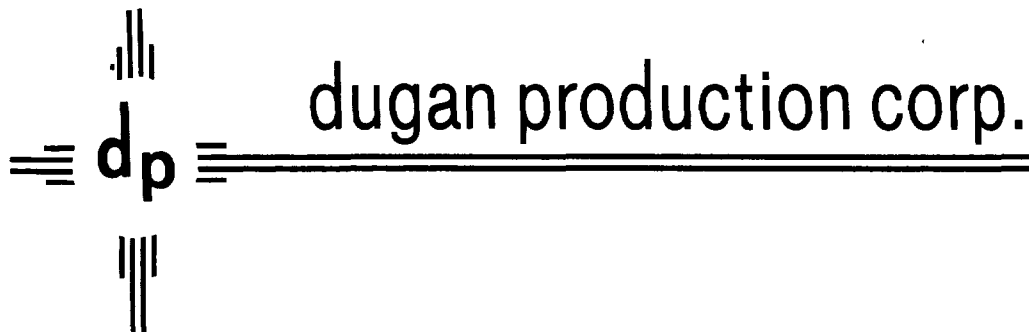

January 17, 2001

Ms. Lori Wrotenbery  
New Mexico Oil Conservation Division  
2040 South Pacheco Street  
Santa Fe, NM 87505

Mr. Lee Otteni  
Bureau of Land Management  
1235 La Plata Highway  
Farmington, NM 87401

Re: Proposed Surface Commingling & Off-lease Measurement  
Dugan Production Corp.'s Cuccia No. 1 (API No. 30-045-10776)  
Dugan Production Corp.'s Cuccia Com No. 90 (API No. 30-045-30247)  
Units G & A, Section 14, T-31N, R-13W  
Federal Leases 024907 & Fee Lease  
Basin Dakota & Basin Fruitland Coal Gas Pools  
San Juan County, NM

Dear Ms. Wrotenbery and Mr. Otteni,

We are writing to request your approvals to surface commingle natural gas produced from the captioned wells plus the off-lease measurement for natural gas produced from the Cuccia Com No. 90. This will allow us to convert the existing natural gas sales meter for the Cuccia No. 1 (El Paso's meter no. 73286) to a central delivery sales meter (CDP) for the Cuccia No. 1 and Cuccia Com No. 90 wells. The spacing unit for each well comprises the east half (316.66 acres) of Section 14 and all interest ownership (working, royalty and overriding royalty) is common. We plan to install continuous recording dry flow meters at each well site which will provide a continuous measurement of all natural gas production from each well. These meters will be maintained to regulatory standards (currently BLM's Onshore Order No. 5) by Dugan Production and will provide the basis for determining allocation factors for the CDP sales volumes. Very little liquid hydrocarbon production is anticipated and any that does occur (along with any water production) will be separated, stored and either sold or disposed of at each well site. There will be no commingling of oil, condensate or water.

Attachment No. 1 was reproduced from the La Plata USGS Quadrangle Topography map and presents the proposed Cuccia CDP along with the subject leases and wells. Attachment No. 2 presents information for each of the wells proposed for this CDP and Attachment No. 3 presents C-102's for each well which also includes the dedicated spacing units. Dugan Production Corp. is the operator of both wells and holds 100% of the working interest. Attachment No. 4 presents the interest ownership for both wells.

The Cuccia No. 1 was completed in the Basin Dakota gas pool on 6-10-62 and had produced 450.0 mmcf of gas plus 1969 bbl condensate as of 12-1-00. The well is currently averaging 14 mcf/d plus very little condensate (a total of 12 bbl during the first 11 months of 2000). The production history is presented on Attachment No. 5. This well has produced fairly marginal rates since completion and is difficult to keep producing with the small volumes of liquids (water and condensate) which tend to accumulate in the wellbore

and log the well off. El Paso's gathering system currently averages  $\pm 325$  psi with pressures periodically approaching 400 psi. From Attachment No. 5, a significant drop in production occurred during 4/00. This was the result of the pipeline pressure increasing from  $\pm 65$  psia to the current  $\pm 375$  psi as a result of a down stream compressor being shut down. We plan to install a compressor at the Cuccia CDP for the commingled gas stream from the No. 1 and 90 wells, which hopefully will help the Cuccia No. 1 to produce more efficiently and at higher gas rates that existed prior to 4/00.

The Cuccia Com No. 90 was spudded on 1-3-01 and 4½" casing cemented at total depth of 2055' on 1-11-01. We plan to complete approximately 5' of Fruitland Coal and anticipate production to initially average 25 to 30 mcf/d plus 50 bwpd. As dewatering progresses, the gas production should increase to 100 to 150 mcf/d. We do not anticipate that the Cuccia Com #90 will have sufficient wellhead pressure to produce into El Paso's pipeline which ranges from 300 to 400 psi and thus wellhead compression will be necessary for the Cuccia Com No. 90 to produce.

All fluid production (water and condensate) will be separated from the gas, and will be stored, sold or disposed of at each well site. Only natural gas will be surface commingled. Each well will be equipped with continuous recording dry flow gas metering equipment and the volumes recorded at each well will be used to determine allocation factors for allocating the volumes recorded at the CDP sales meter to the individual wells. Each allocation meter will be installed and maintained by DPC and the charts from each meter will be integrated monthly by a commercial chart service. The proposed allocation procedures are presented on Attachment No. 6.

Gas production from both wells is believed to be compatible and mixing should not create any operational problems. Attachment No. 7 presents copies of representative gas analyses from both pools to be commingled.

We are sending copies of this application to all interest owners and Attachment No. 8 presents a copy of the transmittal letter.

In summary, we are proposing to convert the existing gas sales meter for Dugan's Cuccia No. 1 to a central delivery sales meter for two wells, Dugan's Cuccia No. 1 and Cuccia Com No. 90. This will require the surface commingling of natural gas production from both wells and off-lease measurement for the Cuccia Com No. 90 (the Cuccia No. 1 will be on-lease). The proposed surface commingling will allow us to install a compressor at the No. 1 well which will be shared by both wells, and will hopefully provide an increase in production for the No. 1 well and will allow the No. 90 well to produce into the pipeline which otherwise will likely not be possible without compression.

Should you have questions or need additional information, please let me know.

Sincerely,

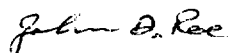

John D. Roe  
Engineering Manager

JDR/tmf

cc: NMOCD- Aztec  
Interest owners

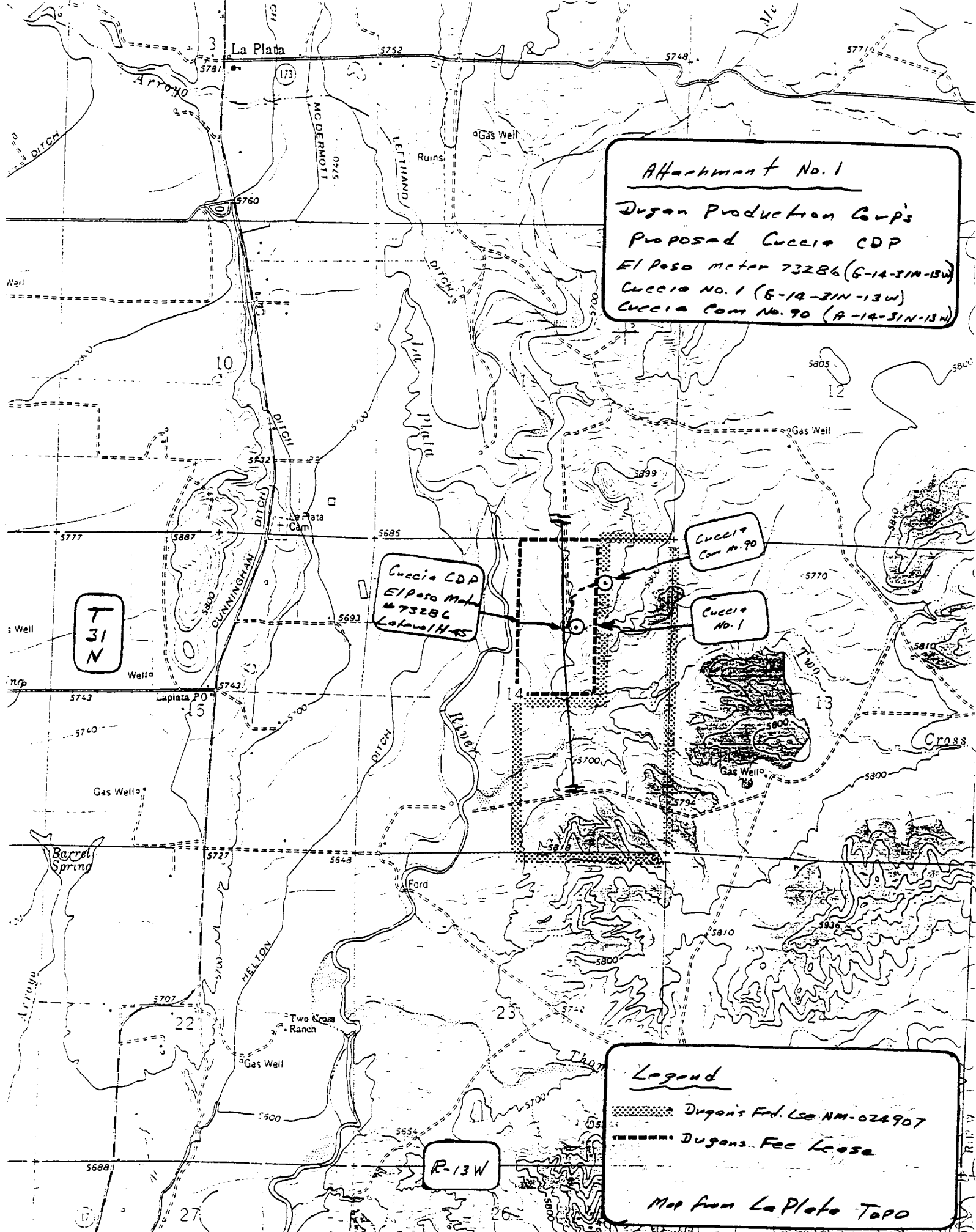

Attachment No. 1

Dugan Production Corp's  
Proposed Cuccia CDP  
El Paso Meter 73286 (G-14-31N-13W)  
Cuccia No. 1 (G-14-31N-13W)  
Cuccia Com No. 90 (R-14-31N-13W)

Cuccia CDP  
El Paso Meter  
# 73286  
Lat/Long H-45

Cuccia  
Com No. 90

Cuccia  
No. 1

Legend

Dugan's Fed. Lse NM-024907  
Dugan's Fee Lease

Map from La Plata TAPD

(FARMINGTON NORTH)  
43571 SW

SCALE 1:24000

ATTACHMENT NO. 2  
DUGAN PRODUCTION CORP.  
PROPOSED CUCCIA CDP (G-14-31N-13W)  
SAN JUAN COUNTY, NEW MEXICO

Well Name	API Number	Well Location			CA Number	Pool	Completion Date	Current Prod.			Spacing Unit	
		Unit	Sec-Twn-Rng	Lease No.				Lease Type	MCFD	BOPD		BWPD
WELLS PROPOSED FOR CDP												
Cuccia #1	30-045-10776	G	14-31N-13W	FEE	FEE	SW5	Basin Dakota	6/10/62	14 (1)	0.03 (1)	0.03 (1)	E/2-316.66A
Cuccia Com #90	30-045-30247	A	14-31N-13W	NM-024907	Federal	pending	Basin Fruitland Coal	Note (2)	Note (2)	Note (2)	Note (2)	E/2-316.66A

Notes:

Note (1) - 3 month average production 9/2000 - 11/2000 @ pipeline pressures of 300 to 400 psia.

Note (2) - Not completed. Well spudded 1-3-01 and 4½" casing cemented @ 2055' on 1-11-01. We anticipate production typical to the Fruitland Coal in this area, initially averaging 25 to 30 mcf plus 50 BWPD increasing to 100 to 150 mcf as dewatering occurs.

c:\tf\johnroel\cucciacdp\datt2

NUMBER	COUNTY
DATE	FILE
LAND OFFICE	TRANSPORTER
REGISTRATION OFFICE	OPERATOR

**NEW MEXICO OIL CONSERVATION COMMISSION**  
**WELL LOCATION AND ACREAGE DEDICATION PLAT**  
 SEE INSTRUCTIONS FOR COMPLETING THIS FORM ON THE REVERSE SIDE

FORM C-128  
Revised 5/1/57

*After 4 months*  
**No. 3**  
*Pg 1 of 2*

**REVISED PLAT**

**SECTION A**

Operator <i>Dugan Production Corp 12/30/77</i> <del>ADOBE OIL COMPANY</del>		Lease <i>CUCCIA</i>	Well No. <i>1</i>
Unit Letter <i>G</i>	Section <i>14</i>	Township <i>31 NORTH</i>	Range <i>13 WEST</i>
Actual Footage Location of Well: <i>1450</i> feet from the <i>NORTH</i> line and <i>1600</i> feet from the <i>EAST</i> line		County <i>SAN JUAN</i>	
Ground Level Elev. <i>5723.0</i>	Producing Formation <i>DAKOTA</i>	Pool <i>Basin Dakota</i>	Dedicated Acreage: <i>316.66</i> Acres

- Ref. GLO Plat dated 9 July 1954
- Is the Operator the only owner in the dedicated acreage outlined on the plat below? YES ☐ NO ☐ ("Owner" means the person who has the right to drill into and to produce from any pool and to appropriate the production either for himself or for himself and another. 155-3-29 (e) NMSA 1935 Comp.)
  - If the answer to question one is "no," have the interests of all the owners been consolidated by communitization agreement or otherwise? YES ☐ NO ☐ If answer is "yes," Type of Consolidation \_\_\_\_\_
  - If the answer to question two is "no," list all the owners and their respective interests below:

Owner	Land Description

**SECTION B**

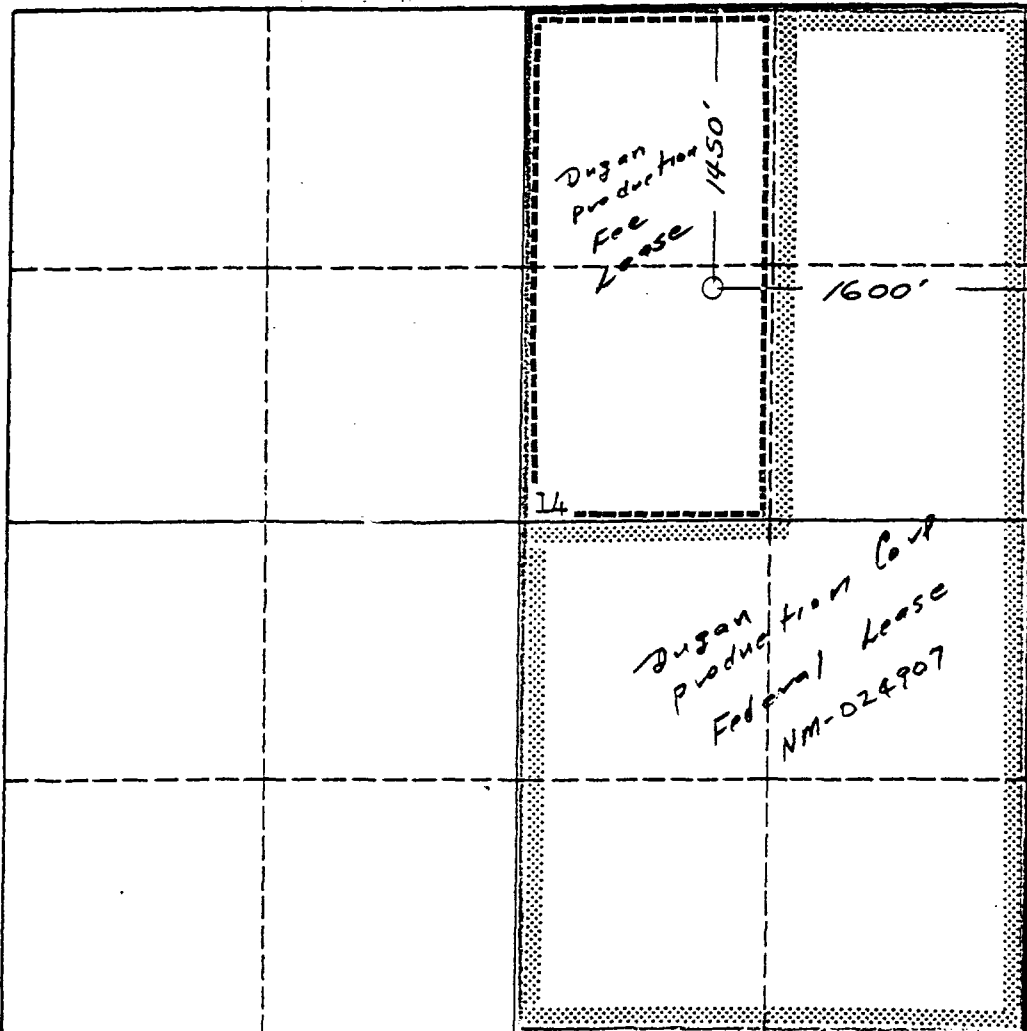

**CERTIFICATION**

I hereby certify that the information in SECTION A above is true and complete to the best of my knowledge and belief.

Name *A. T. Sindel*  
 Position *Vice-President*  
 Company *ADOBE OIL COMPANY*  
 Date *February 26, 1962*

I hereby certify that the well location shown on the plat in SECTION B was plotted from field notes of actual surveys made by me or under my supervision, and that the same is true and correct to the best of my knowledge and belief.

LAND SURVEYOR  
 Date Surveyed *27 October 1962*  
 Registered Professional Engineer and/or Land Surveyor  
*James P. Deese*

Certificate No. *1463*

0 330 660 990 1320 1650 1980 2310 2640 2000 1500 1000 500 0

District I  
PO Box 1980, Hobbs, NM 88241-1980  
District II  
PO Drawer DD, Artesia, NM 88211-0719  
District III  
1000 Rio Brazos Rd., Aztec, NM 87410  
District IV  
PO Box 2088, Santa Fe, NM 87504-2088

State of New Mexico  
Energy, Minerals & Natural Resources Department

OIL CONSERVATION DIVISION  
PO Box 2088  
Santa Fe, NM 87504-2088

Attachment  
No. 3  
Pg 2 of 2

Form C-102  
Revised February 21, 1994  
Instructions on back  
Submit to Appropriate District Office  
State Lease - 4 Copies  
Fee Lease - 3 Copies

☐ AMENDED REPORT

WELL LOCATION AND ACREAGE DEDICATION PLAT

1 APT Number 30 045 30247		1 Pool Code 71629		1 Pool Name Basin Fruitland Coal	
1 Property Code		1 Property Name Cuccia Com			1 Well Number 90
1 OGRID No. 006515		1 Operator Name ...Dugan Production Corporation			1 Elevation 5739'

10 Surface Location

UL or lot no.	Section	Township	Range	Lot Idn	Feet from the	North/South line	Feet from the	East/West line	County
A	14	31N	13W		737'	North	1120	East	San Juan

11 Bottom Hole Location If Different From Surface

UL or lot no.	Section	Township	Range	Lot Idn	Feet from the	North/South line	Feet from the	East/West line	County

12 Dedicated Acres 316.66	13 Joint or Infill	14 Consolidation Code	15 Order No. Will be communitized
------------------------------	--------------------	-----------------------	--------------------------------------

NO ALLOWABLE WILL BE ASSIGNED TO THIS COMPLETION UNTIL ALL INTERESTS HAVE BEEN CONSOLIDATED  
OR-A NON-STANDARD UNIT HAS BEEN APPROVED BY THE DIVISION

16		DPC Fee lease	737' 1120'	17 OPERATOR CERTIFICATION I hereby certify that the information contained herein is true and complete to the best of my knowledge and belief  John Alexander Signature John Alexander Printed Name Vice-president Title May 11, 2000 Date		
					18 SURVEYOR CERTIFICATION I hereby certify that the well location shown on this plat was plotted from field notes of actual surveys made by me or under my supervision, and that the same is true and correct to the best of my belief.  March 27, 2000 Date of Survey Signature and Seal Edgar L. Riser Professional Surveyor 5879 Certificate Number	
					DPC NM 024907	

ATTACHMENT NO. 4

Cuccia #1  
Basin Dakota

Well Location: SWNE (Unit G) 14, T-31N, R-13W  
Spacing Unit: E/2 Section 14, T-31N, R-13W (316.66A)  
San Juan County, New Mexico

Cuccia Com #90  
Basin Fruitland Coal

Well Location: NENE (Unit A) 14, T-31N, R-13W  
Spacing Unit: E/2 Section 14, T-31N, R-13W (316.66A)  
San Juan County, New Mexico

<u>INTEREST OWNER</u>	<u>INTEREST% (Both wells)</u>	
	<u>Gross</u>	<u>Net</u>
<u>Working Interest</u>	100.000000	78.736820
Dugan Production Corp.		
<u>Royalty</u>		
USA - Bureau of Land Management	-0-	9.342040
1235 La Plata Highway		
Farmington, NM 87401		
Harold & Patricia Huggins	-0-	3.157960
Husband & Wife as Joint Tenant		
P. O. Box 217		
La Plata, NM 87418		
<u>Overriding Royalty Interest</u>		
Paul D. Boe	-0-	0.473690
7104 Wonderberry Street		
Las Vegas, NV 87131		
Dorothea J. Caulfield Trust	-0-	0.473690
Dorothea J. Caulfield, Trustee		
14647 Ranchview Terrace		
Chino Hills, CA 91710		
George E. Conley	-0-	5.605220
P. O. Box 99		
Parker, CO 80134		
Debra Ruth Cox	-0-	0.157900
7500 Mesquite Wood Dr.		
Albuquerque, NM 87120		
Cross Timbers Oil Company	-0-	1.894780
P. O. Box 840287		
Dallas, TX 75284-0287		
Margaret Munder Hicks	-0-	0.157900
8719 Woodland Ave., N.E.		
Albuquerque, NM 87112		
<b>TOTAL WELL</b>	<u>100.000000</u>	<u>100.000000</u>



Production  
Oil ———  
Gas - - - -  
Water ·····

DUGAN PRODUCTION CORP.  
Production Rate vs Time  
BB1/Mo or Mcf/Mo vs Months  
CUCCIA NO. 1  
BASIN DAKOTA (G-14-31N-13W)

Attachment  
No. 5  
P310f1

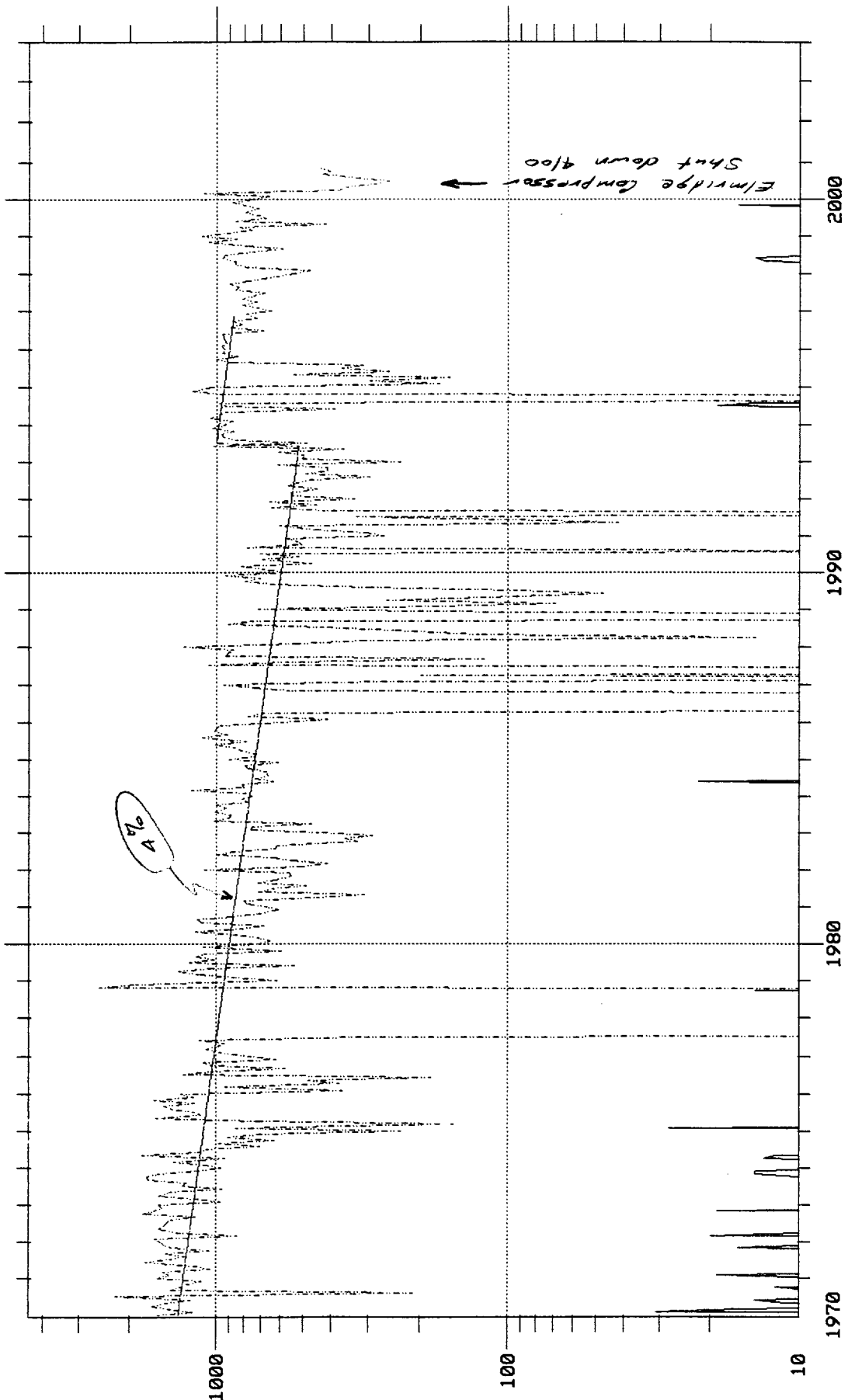

**Attachment No. 6**  
**Proposed Allocation Procedures**  
**Dugan Production Corp.'s**  
**Cuccia CDP**  
**SWNE 14, T-31N, R-13W**  
**San Juan County, New Mexico**

**Base Data for Gas Production, BTU & Revenue Allocations:**

W=Volume (MCF) from Well Allocation Meter

X=Volume (MCF) from CDP Sales Meter

Y=BTU's from CDP Sales Meter

Z=Gas Revenue (\$) from CDP Sales Meter

1. **Allocated Individual Well Production** = A+B+C+D+E

A = Allocated Sales Volume, MCF  
= (W/SUM W) x X

B = Fuel used on lease, MCF. Determined from equipment specifications and operating conditions.

C = Purged and/or vented gas from well and/or lease equipment, MCF. Calculated using equipment specifications and pressures.

D = Allocated fuel from gathering system equipment, MCF. The total fuel required to operate gathering system equipment will be allocated to the individual wells benefitting from the equipment using allocation factors determined by W / Sum W for the wells involved.

E = Allocated volume of gas lost and/or vented from the gathering system and/or gathering system equipment, MCF. The total volume will be determined using industry accepted procedures for the conditions existing at the time of the loss. All volumes corresponding to liquid condensation within the gathering system will also be determined. The total volume lost and/or vented will be allocated to the individual wells affected using factors determined by W / Sum W.

2. **Allocated Individual Well BTU's** = ((W x Individual well BTU) / Sum (W x individual well BTU)) x Y.

Individual well gas heating values to be determined in accordance with BLM regulations (currently Onshore Order No. 5).

3. **Allocated Individual Well Gas Revenues** = (Allocated Individual wells BTU's / Sum Allocated individual well BTU's) x Z

CO.CD 23 EL PASO NATURAL GAS  
CUSTOMER ACCOUNTING SERVICES DEPARTMENT  
VOLUME CALCULATION DIVISION  
POST OFFICE BOX 1492  
EL PASO, TEXAS 79978

CONTACTS:  
EL PASO FIELD SERVICES  
(713) 757-5953  
EL PASO MAINLINE  
(915) 496-2595

DATE 12/04/98

CHROMATOGRAPHIC GAS ANALYSIS REPORT

*Attachment  
No. 7  
pg 1 of 2*

MAILEE  
26750

THOMAS A DUGAN  
P O BOX 420  
FARMINGTON, NM 87499-0420

METER NUMBER 73286 - CUCCIA #1  
OPERATOR 1862 - DUGAN PRODUCTION CORP

ANALYSIS DATE 10/28/98 TYPE CODE 2 - ACTUAL  
SAMPLE DATE 10/26/98 H2S GRAINS 0  
EFFECTIVE DATE 11/01/98 LOCATION F - FARM BECK  
EFFECTIVE FOR 6 MONTHS

COMPONENTS	NORMALIZED MOL %	GPM
CO2	1.45	.000
H2S	.00	.000
N2	.31	.000
METHANE	84.02	.000
ETHANE	8.69	2.325
PROPANE	3.21	.885
ISO-BUTANE	.57	.186
NORM-BUTANE	.80	.252
ISO-PENTANE	.31	.113
NORM-PENTANE	.23	.083
HEXANE PLUS	<u>.41</u>	<u>.172</u>
	100.00	4.023

SPECIFIC GRAVITY .686  
MIXTURE HEATING VALUE  
(BTU @ 14.73 DRY) 1177  
RATIO OF SPECIFIC HEATS .000  
NO TEST SECURED FOR H2S CONTENT



2030 Arton Place  
Farmington, N.M. 87401  
(505) 325-6622

Analysis No. DUG70350  
Cust. No. 23000-10955

Attachment  
No 7  
pg 2 of 2

### WELL/LEASE INFORMATION

Company	: DUGAN PRODUCTION CORP.	Source	: CASING
Well Name	: FIVE OF DIAMONDS 90	Pressure	: 55 PSIG
County	: SAN JUAN	Sample Temp.	: N/A DEG.F
State	: NM	Well Flowing	: N/A
Location	: <u>10L-30N-13W</u>	Date Sampled	: 08/12/97
Fld/Formation	: <u>BASIN FC</u>	Sampled By	: WAYNE JOHNSON
Cust.Stn.No.	:	Foreman/Engr	: TOM BLAIR

Remarks: LEASE: NM 030555A

### ANALYSIS

COMPONENT	MOLE %	GPM**	B.T.U.*	SP.GR.*
NITROGEN	2.225	0.0000	0.00	0.0215
CO2	0.105	0.0000	0.00	0.0016
METHANE	97.454	0.0000	986.53	0.5398
ETHANE	0.112	0.0300	1.99	0.0012
PROPANE	0.057	0.0157	1.44	0.0009
I-BUTANE	0.015	0.0049	0.49	0.0003
N-BUTANE	0.013	0.0041	0.43	0.0003
I-PENTANE	0.004	0.0015	0.16	0.0001
N-PENTANE	0.003	0.0011	0.12	0.0001
HEXANES	0.012	0.0052	0.62	0.0004
TOTAL	100.000	0.0625	991.76	0.5661

\* @ 14.730 PSIA DRY & UNCORRECTED FOR COMPRESSIBILITY

\*\* @ 14.730 & 60 DEG. F

COMPRESSIBILITY FACTOR	(1/Z)	1.0020
BTU/CU.FT. (DRY) CORRECTED FOR	(1/Z)	993.7
BTU/CU.FT. (WET) CORRECTED FOR	(1/Z)	976.5
REAL SPECIFIC GRAVITY		0.5670

ANALYSIS RUN AT 14.730 PSIA & 60 DEGREES F

Since Dugan's Cuccia Com No 90  
has not been completed & a  
Representative gas Sample is Not  
available, it is believed this gas  
Analysis is representative of the  
gas to be produced from the Cuccia No. 90 Foothill Coal

CYLINDER #	: 032
CYLINDER PRESSURE	: 50 PSIG
DATE RUN	: 08/12/97
ANALYSIS RUN BY	: DAVE MARTIN

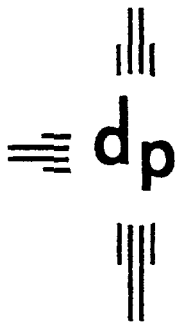

dugan production corp.

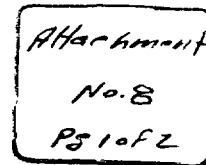

January 17, 2001

CERTIFIED MAIL - RETURN RECEIPT REQUESTED

To: Royalty & Overriding Royalty Interest Owners (Address list attached)

Re: Dugan Production Corp.'s  
Cuccia No. 1 (G-14-31N-13W)  
Cuccia Com No. 90 (A-14-31N-13W)  
San Juan County, New Mexico

Dear Interest Owner,

Attached for your information, review and file is a copy of our application to the New Mexico Oil Conservation Division and the Bureau of Land Management to surface commingle natural gas produced from the captioned wells in which you have a royalty or overriding royalty interest ownership. The proposed surface commingling will allow us to place the recently drilled Cuccia Com No. 90 on production, hopefully will improve production from the Cuccia No. 1 and will allow both wells to share the cost of operating a central compressor.

This proposal should not affect your interest in these wells and should provide an increase in your revenues from these wells.

Should you have any questions, need additional information or have any concern as to our proposal, please let me know. Should you have an objection, please let me know, or you can contact the New Mexico Oil Conservation Division directly at 2040 South Pacheco Street in Santa Fe, New Mexico 87505. Any objection should be filed within 20 days of receiving this letter, and we would appreciate receiving a copy of your objection.

Sincerely,

John D. Roe  
Engineering Manager

JDR/tmf

*Interest Owner List*  
*Dugan Production's Cuccia No. 1 & Cuccia Com No. 90*

*Attachment*  
*No. 8*  
*Pg 2 of 2*

Working Interest Owners

Dugan Production Corp.  
P. O. Box 420  
Farmington, NM 87499-0420

---

Royalty Interest Owners

USA - Bureau of Land Management  
1235 La Plata Highway  
Farmington, NM 87401

Harold & Patricia Huggins  
Husband & Wife as Joint Tenants  
P. O. Box 217  
La Plata, NM 87418

---

Overriding Royalty Interest Owners

Paul D. Boe  
7104 Wonderberry Street  
Las Vegas, NV 87131

Dorothea J. Caulfield Trust  
Dorothea J. Caulfield, Trustee  
14647 Ranchview Terrace  
Chino Hills, CA 91710

George E. Conley  
P. O. Box 99  
Parker, CO 80134

Debra Ruth Cox  
7500 Mesquite Wood Dr.  
Albuquerque, NM 87120

Cross Timbers Oil Company  
P. O. Box 840287  
Dallas, TX 75284-0287

Margaret Munder Hicks  
8719 Woodland Ave., N.E.  
Albuquerque, NM 87112