

WILLIAM N. BEACH - OIL
OIL & GAS PRODUCER
P. O. BOX 3669
MIDLAND, TEXAS 79702

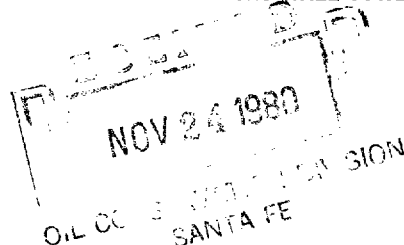

November 20, 1980

Energy and Minerals Dept.
Oil Conservation Division
P. O. Box 2088
Santa Fe, NM 87501

Attn: Dan Nutter

Re: Off-Lease Storage Request
Rule 309C
William N. Beach #1 Latham,
Eddy County, New Mexico

Dear Mr. Nutter:

Please be advised William N. Beach has requested off-lease storage permission for referenced lease. We hereby request the Oil Conservation Division grant William N. Beach approval for off-lease storage in the E/2 NW/4 Section 25, T-16-S, R-28-E, Eddy County, New Mexico.

Please find enclosed copies of the following: letter to the Commissioner of Public Lands (Floyd Prando) requesting off-lease storage, letter from Mr. E. L. Latham, Jr. granting approval of the re-location of the tank battery in accordance with Rule 309C, and copy of plat showing location of proposed flowline.

If I can be of any further assistance, do not hesitate to contact me at the above address.

Your cooperation is greatly appreciated.

Sincerely,

Carl C. Beach
Landman

/mlc

Enclosures as Stated.

WILLIAM N. BEACH - OIL

OIL & GAS PRODUCER

P. O. BOX 3669

MIDLAND, TEXAS 79702

NOV 24 1980

OIL & GAS COMMISSION
SANTA FE

November 3, 1980

Energy and Minerals Dept.
COMMISSION OF PUBLIC LANDS
P. O. Box 1148
Santa Fe, NM 87501

Attn: Floyd Prando

Re: Wm. N. Beach-#1 Latham-State,
Eddy County, New Mexico,
(State Lse. #L-4493)

Gentlemen:

Pursuant to my telephone conversation with Mr. Floyd Prando, William N. Beach requests permission under Rule 309C of New Mexico Energy and Minerals Department to allow off lease storage for the Beach #1 Latham-State, located in SE/4 NW/4 Section 25, T-16-S, R-28-E, Eddy County, New Mexico. This request is made due to the location of well in old lake bed and flooding of the location. If tank battery is put on this location, oil transports and other oilfield vehicles would not be able to have access in and out of lease during rainy weather.

If approved, there will be no commingling or intercommunication of handling of the oil or gas between the Beach #1 Latham-State and the Beach #1 Hinkle-State. Said tank battery will be located on Beach Hinkle-State lease located in the SE/4 SW/4 Section 25, T-16-S, R-28-E, Eddy County, New Mexico. Tank battery will be 350 feet west of Beach #1 Hinkle-State.

Your cooperation is greatly appreciated. If I can be of any further assistance, please let me know.

Sincerely,



Carl C. Beach
Landman

CCB/mlc

Enclosures: Letter of Approval-E. L. Latham, Jr.,
Plat showing proposed location,
Check #3754 covering \$10.00 filing fee.

E. L. LATHAM, JR.
OIL & GAS PROPERTIES
P. O. BOX 1392
HOBBS, NEW MEXICO 88240

October 29, 1980

NOV 24 1980
OIL & GAS DIVISION
SANTA FE

William N. Beach
P. O. Box 3669
Midland, Texas 79701

Re: Location of Tank Battery
of William N. Beach, Latham
State #1, SE $\frac{1}{4}$ NW $\frac{1}{4}$ S25, T16S
R28E, Eddy Co. NM
State Lease L-4493

Attention: William N. Beach

This letter will confirm our telephone conversation in regard to the location of tank storage and separating equipment on the above captioned lease.

Due to flooding of the dry lake bed in times of excess rain on Lease L-4493, I understand it is desirable to locate the tank battery off the lease premises.

I hereby give my approval of the re-location of the tank battery in accordance with Rule 309C of the N.M. Energy and Minerals Department.

Sincerely,

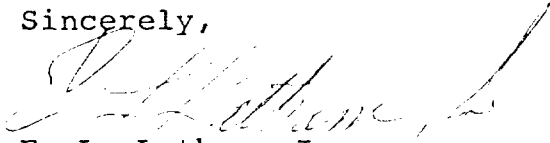
E. L. Latham, Jr.

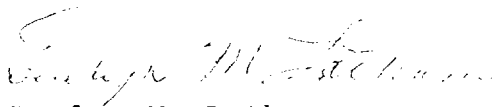
Evelyn M. Latham

NOV 24 1980
OIL COMMISSION
SANTA FE

ILLEGIBLE

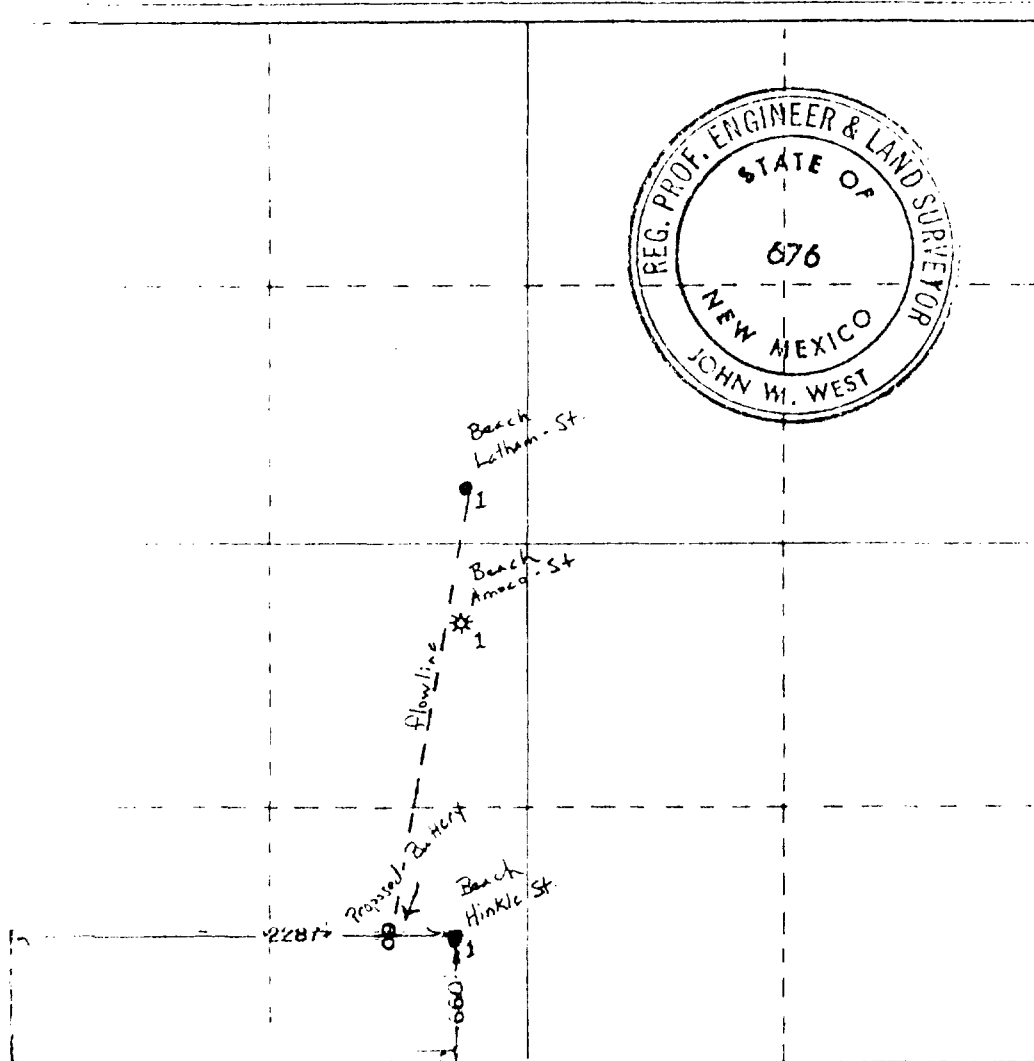
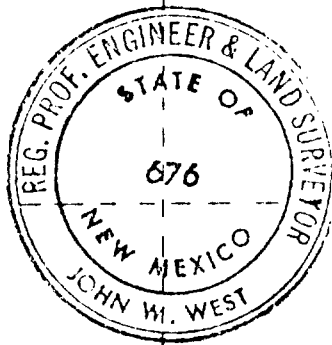

CERTIFICATION

I hereby certify that the information contained herein is true and correct to the best of my knowledge and belief.

Carl C. Beach

CARL C. BEACH

LANDMAN

WILLIAM N. BEACH

6-5-80

I hereby certify that the well shown on this plat was plotted from the notes of actual surveys made by me under my supervision and that the same is true and correct to the best of my knowledge and belief.

Date of survey

June 3, 1980

Registered in the State of New Mexico

John W. West

Certified by JOHN W. WEST
PATRICK A. ROMERO
Herald & Son

132 1680 1681 2310 2640 2000 1500 1000 500