

# State of New Mexico



W.R. HUMPHRIES  
COMMISSIONER



Commissioner of Public Lands

P.O. BOX 1148  
SANTA FE, NEW MEXICO 87504-1148

November 9, 1989

BTA Oil Producers  
105 South Pecos  
Midland, Texas 79701

ATTN: Ms. Dorothy Houghton

RE: Request for Off-Lease Storage and Surface Commingling  
State Leases V-1563 and V-1591  
Sec. 21, T-17-S, R-36-E Lea County, New Mexico

Gentlemen:

Reference is made to your letters of October 5, 1989 and October 31, 1989 wherein you request to commingle production from 8408 JV-P Turner wells No. 1 and 2 located on State Lease V-1563 and 8408 JV-P Turner B well No. 1-B on State Lease V-1591, Section 21, T-17-S, R-36-E in Lea County, New Mexico. We received your complete application package including the \$30.00 filing fee.

Approval is hereby granted to commingle the oil produced from the three wells as described above. Please be advised that any deviation from your proposed request will be grounds to rescind your approval. Our approval is subject to like approval by the New Mexico Oil Conservation Division.

In the future, when submitting a request for commingling application package, please identify the well numbers in each New Mexico State Lease that you want to commingle, the API gravity of produced fluids from each well and the current production rate from each well. We review the commingle applications on a well-by-well basis rather than on a lease basis.

If you have any questions, please do not hesitate to contact Susan Howarth at (505) 827-5791.

Very truly yours,

W.R. HUMPHRIES,  
COMMISSIONER OF PUBLIC LANDS

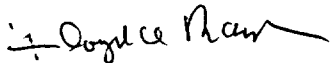
BY: 

FLOYD O. PRANDO, Director  
Oil and Gas Division  
(505) 827-5749

enclosure

cc: OCD

Lease files: V-1591 and V-1563



MIDLAND PARTNERS  
CARLTON BEAL  
CARLTON BEAL, JR.  
BARRY BEAL  
SPENCER BEAL  
KELLY BEAL

DENVER PARTNER  
BARRY BEAL, JR.

BTA OIL PRODUCERS  
104 SOUTH PECOS  
MIDLAND, TEXAS 79701  
AC 915-682-3753

ROCKY MOUNTAIN DIVISION  
555-17TH STREET  
SUITE 835  
DENVER, CO 80202  
AC 303-292-9299

October 4, 1989

Re: Exception to Rule 309-A  
Surface Commingling & Off-Lease Storage  
Lower Double -A- (Abo) Pool  
8408 JV-P Turner  
8408 JV-P Turner -B-  
Sec. 21, T-17-S, R-36-E  
Lea County, New Mexico

---

STATE OF NEW MEXICO  
Energy and Minerals Dept.  
P. O. Box 2088  
Santa Fe, New Mexico 87504-2088

Attention: Mr. William J. LeMay  
Division Director

Gentlemen:

We hereby request authority to permit the surface commingling of oil production and off-lease storage from the above referenced leases.

The 8408 JV-P Turner lease has two producing wells with an average production of 82 B/D. The 8408 JV-P Turner -B- lease has one producing well with an average production of 5 B/D. Both leases are in the Lower Double -A- (Abo) Pool.

The production will be allocated based on monthly well tests.

**RECEIVED**

OCT - 6 1989

OIL CONSERVATION DIV.  
SANTA FE

STATE OF NEW MEXICO  
October 4, 1989  
Page 2

BTA holds 100% Working Interest in these leases. We are applying to the Commissioner of Public Lands for commingling authority and requesting consent from our purchaser, Sun Refining and Marketing.

Should further information be necessary to grant this request, please advise.

Sincerely,

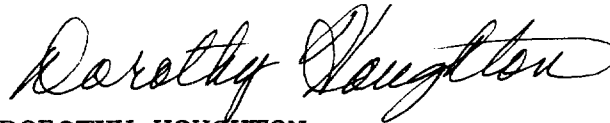
A handwritten signature in cursive script, reading "Dorothy Houghton".

DOROTHY HOUGHTON  
For BTA Oil Producers

DH/wt

Attachment: Plat with wells and Tank Battery

xc: State of New Mexico - Hobbs  
Commissioner of Public Lands  
Sun Refining & Marketing  
Texas New Mexico Pipeline Co.

**MEXICO OIL CONSERVATION COMMISSION**  
**WELL LOCATION AND ACREAGE DEDICATION PLAT**

Form C-102  
 Supersedes C-128  
 Effective 1-1-65

All distances must be from the outer boundaries of the Section.

|   |                                   |                                      |                                      |                                       |                             |
|---|-----------------------------------|--------------------------------------|--------------------------------------|---------------------------------------|-----------------------------|
| Operator<br><b>BTA OIL PRODUCERS</b>                        |                                   |                                      | Lease<br><b>8408 JV-P TURNER "B"</b> |                                       | Well No.<br><b>142, 1-B</b> |
| Unit Letter<br><b>"B"</b>                                   | Section<br><b>21</b>              | Township<br><b>17-S</b>              | Range<br><b>36-E</b>                 | County<br><b>LEA</b>                  |                             |
| Actual Footage Location of Well:                            |                                   |                                      |                                      |                                       |                             |
| feet from the _____ line and _____ feet from the _____ line |                                   |                                      |                                      |                                       |                             |
| Ground Level Elev.<br><b>3851</b>                           | Producing Formation<br><b>ABO</b> | Pool<br><b>DOUBLE A, LOWER (ABO)</b> |                                      | Dedicated Acreage:<br><b>40</b> Acres |                             |

1. Outline the acreage dedicated to the subject well by colored pencil or hachure marks on the plat below.
2. If more than one lease is dedicated to the well, outline each and identify the ownership thereof (both as to working interest and royalty).
3. If more than one lease of different ownership is dedicated to the well, have the interests of all owners been consolidated by communitization, unitization, force-pooling, etc?

☐ Yes   ☐ No   If answer is "yes," type of consolidation \_\_\_\_\_

If answer is "no," list the owners and tract descriptions which have actually been consolidated. (Use reverse side of this form if necessary.) \_\_\_\_\_

No allowable will be assigned to the well until all interests have been consolidated (by communitization, unitization, forced-pooling, or otherwise) or until a non-standard unit, eliminating such interests, has been approved by the Commission.

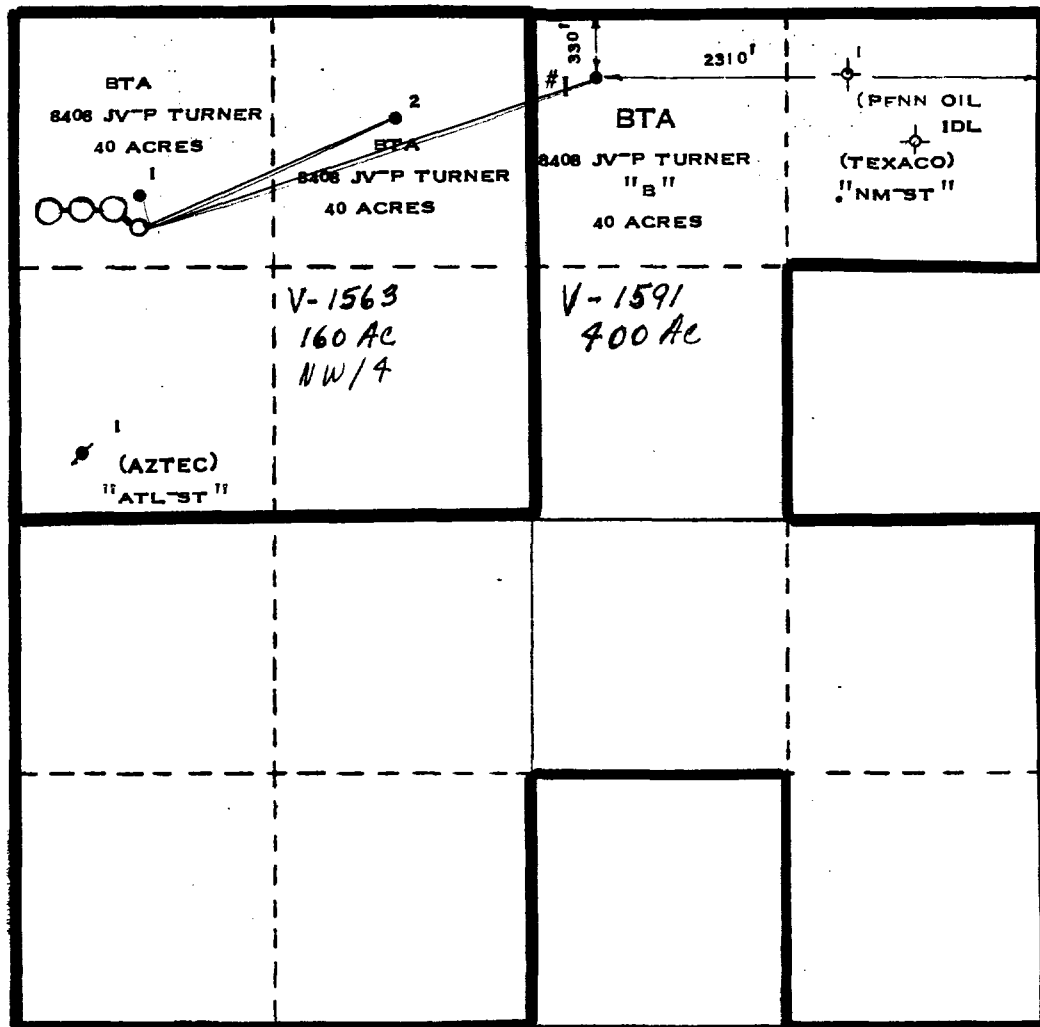

**CERTIFICATION**

I hereby certify that the information contained herein is true and complete to the best of my knowledge and belief.

*Dorothy Houghton*  
 Name

**DOROTHY HOUGHTON**

Position

Regulatory Administrator

Company

**BTA OIL PRODUCERS**

Date

**10/4/89**

I hereby certify that the well location shown on this plat was plotted from field notes of actual surveys made by me or under my supervision, and that the same is true and correct to the best of my knowledge and belief.

Date Surveyed

**SEPTEMBER 11, 1986**

Registered Professional Engineer and Land Surveyor

*Max A. Schumann Jr.*  
**MAX A. SCHUMANN JR.**

Certificate No.

**1510**

