

**OIL CONSERVATION COMMISSION**

P. O. BOX 2088

SANTA FE, NEW MEXICO 87501

March 30, 1973

Millard Deck Oil Company  
P. O. Box 1047  
Eunice, New Mexico 88231

Attention: Mr. Millard Deck

Administrative Order OLS-90

Gentlemen:

Reference is made to your application dated March 26, 1973, for administrative approval to permit off-lease storage of Eumont oil production from your State WE "D" Lease comprising the N/2 SE/4 of Section 27, Township 20 South, Range 36 East, NMPM, Lea County, New Mexico, at a tank battery on your Federal "D" Lease in Unit E of Section 26 of the same township.

Administrative approval of the off-lease storage is hereby granted pursuant to the provisions of Rule 309-C of the Commission Rules and Regulations, provided however, that there shall be no intercommunication of the handling, separating, treating, or storage facilities designated to each lease.

Very truly yours,

A. L. PORTER, Jr.  
Secretary-Director

ALP/DSN/dr

cc: Oil Conservation Commission - Hobbs  
U. S. Geological Survey - Roswell  
State Land Office - Santa Fe



# MILLARD DECK OIL COMPANY

P. O. Box 1047

Phone (505) 394-2249

EUNICE, NEW MEXICO 88231

March 26, 1973

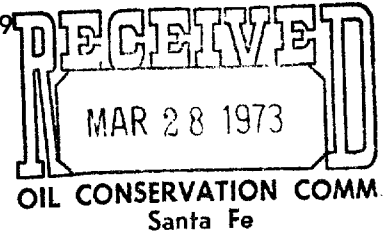

New Mexico Oil Conservation Commission  
P.O. Box 2088  
Santa Fe, New Mexico 87501

Gentlemen:

Approval is being sought for off-lease storage for production from the Millard Deck Oil Company State WE "D" No. 1 located in the NE/4 - SE/4 of Section 27, Township 20 South, Range 36 East, Lea County, New Mexico. It is proposed that for the convenience of the oil and gas pipelines that tank battery facilities be constructed in the SW/4 - NW/4 Section 26, Township 20 South, Range 36 East. An oil and gas pipeline connection is available at the Federal "D" battery but it would require that oil and gas pipelines be laid to a battery on the State WE "D" location. Due to the low oil and gas production rate the pipelines were reluctant to make that expenditure. This proposal is being made in the interest of providing the most beneficial and economical method of producing oil and gas which is needed by the consumer and it will also be providing revenue for the State of New Mexico in the form of royalty and severance taxes.

Our application for off-lease storage follows:

1. Production from the State WE "D" lease is all from one well producing in the Eumont ~~Yates~~ ~~Seven Rivers~~ Queen field.
2. There is no intercommunication possible until the oil and gas is placed into the respective pipeline gathering systems.
3. There will be completely separate handling and storage facilities for the State WE "D" lease and the Federal "D" lease.
4. All parties owning either a working interest or a royalty interest have been sent copies of applications mailed to the United States Department of the Interior and the Commissioner of Public Lands by certified mail. A copy of the certified mail receipts are attached.
5. This off-lease storage proposal has been approved by both the United States Department of the Interior and the Commissioner of Public Lands. Copies of their approval letters are attached.

MILLARD DECK OIL COMPANY

P. O. Box 1047

Phone (505) 394-2249

EUNICE, NEW MEXICO 88231

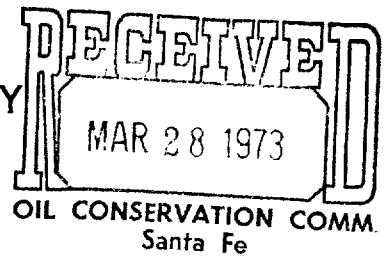

New Mexico Oil Conservation Commission

March 26, 1973 Page 2

Your earliest attention to this off-lease storage approval will be appreciated.

Yours very truly,

MILLARD DECK OIL COMPANY

A handwritten signature in cursive script that reads "Millard Deck".

Millard Deck

MD:sb

Attachment (15)

P. O. Box 1047  
Eunice, New Mexico 88231

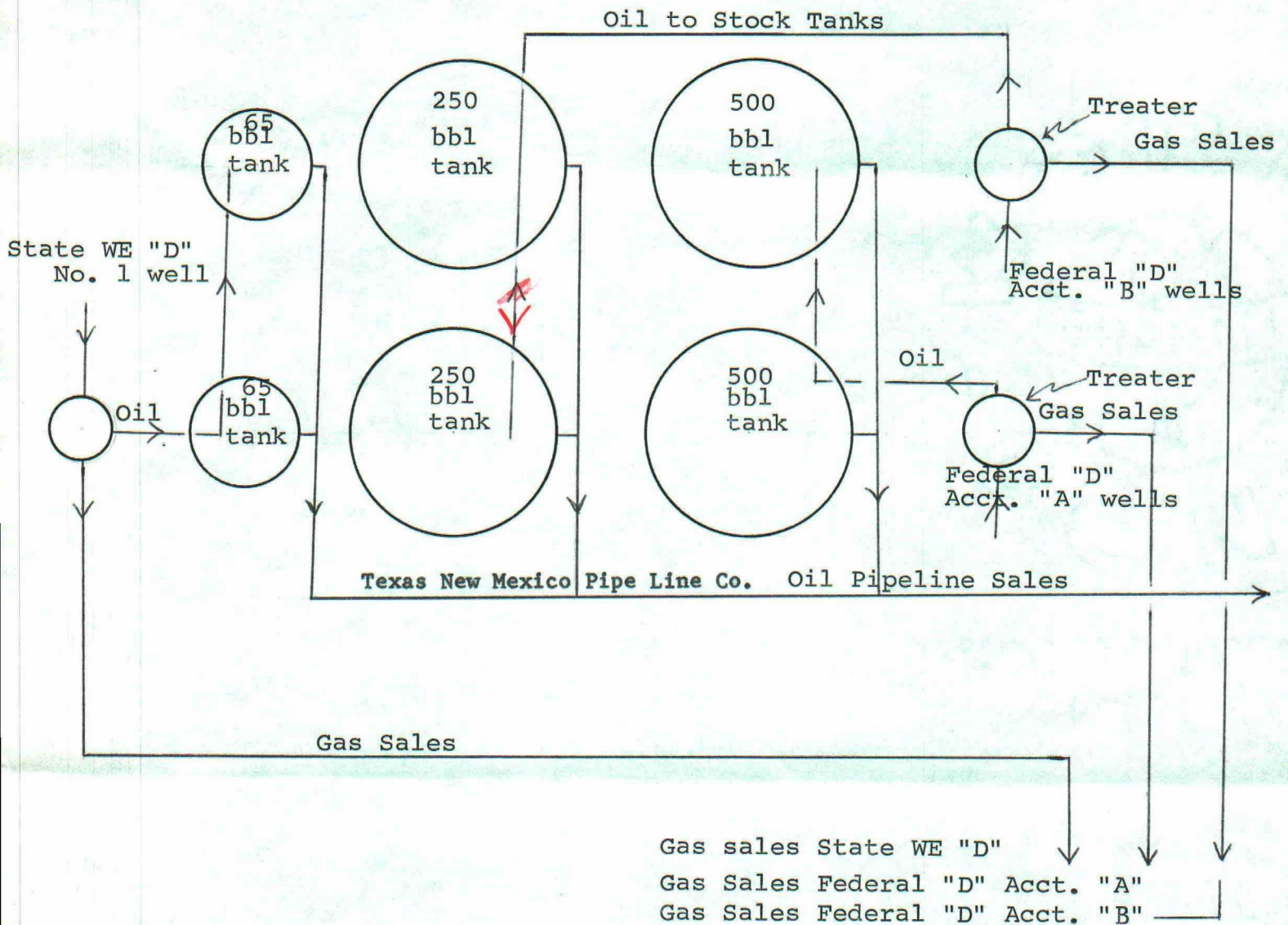

TANK BATTERY FACILITIES  
State WE "D"  
Federal "D" Acct. "A"  
Federal "D" Acct. "B"



NEW MEXICO OIL CONSERVATION COMMISSION  
WELL LOCATION AND ACREAGE DEDICATION PLAT

Form C-102  
Supersedes C-128  
Effective 1-1-65



All distances must be from the outer boundaries of the Section.

Operator <b>Millard Deck</b>		Lease <b>State WE "D"</b>		Well No.	
Unit Letter <b>I</b>	Section <b>27</b>	Township <b>20S</b>	Range <b>36E</b>	County <b>Lea</b>	
Actual Footage Location of Well: <b>1980'</b> feet from the <b>South</b> line and <b>660'</b> feet from the <b>East</b> line					
Ground Level Elev. <b>3586' (DF)</b>	Producing Formation <b>7 Rivers Queen</b>	Pool <b>Eumont Yates</b>		Dedicated Acreage: <b>80</b> Acres	

1. Outline the acreage dedicated to the subject well by colored pencil or hachure marks on the plat below.
2. If more than one lease is dedicated to the well, outline each and identify the ownership thereof (both as to working interest and royalty).
3. If more than one lease of different ownership is dedicated to the well, have the interests of all owners been consolidated by communitization, unitization, force-pooling, etc?

☐ Yes ☐ No If answer is "yes," type of consolidation \_\_\_\_\_

If answer is "no," list the owners and tract descriptions which have actually been consolidated. (Use reverse side of this form if necessary.) \_\_\_\_\_

No allowable will be assigned to the well until all interests have been consolidated (by communitization, unitization, forced-pooling, or otherwise) or until a non-standard unit, eliminating such interests, has been approved by the Commission.

R 36 E

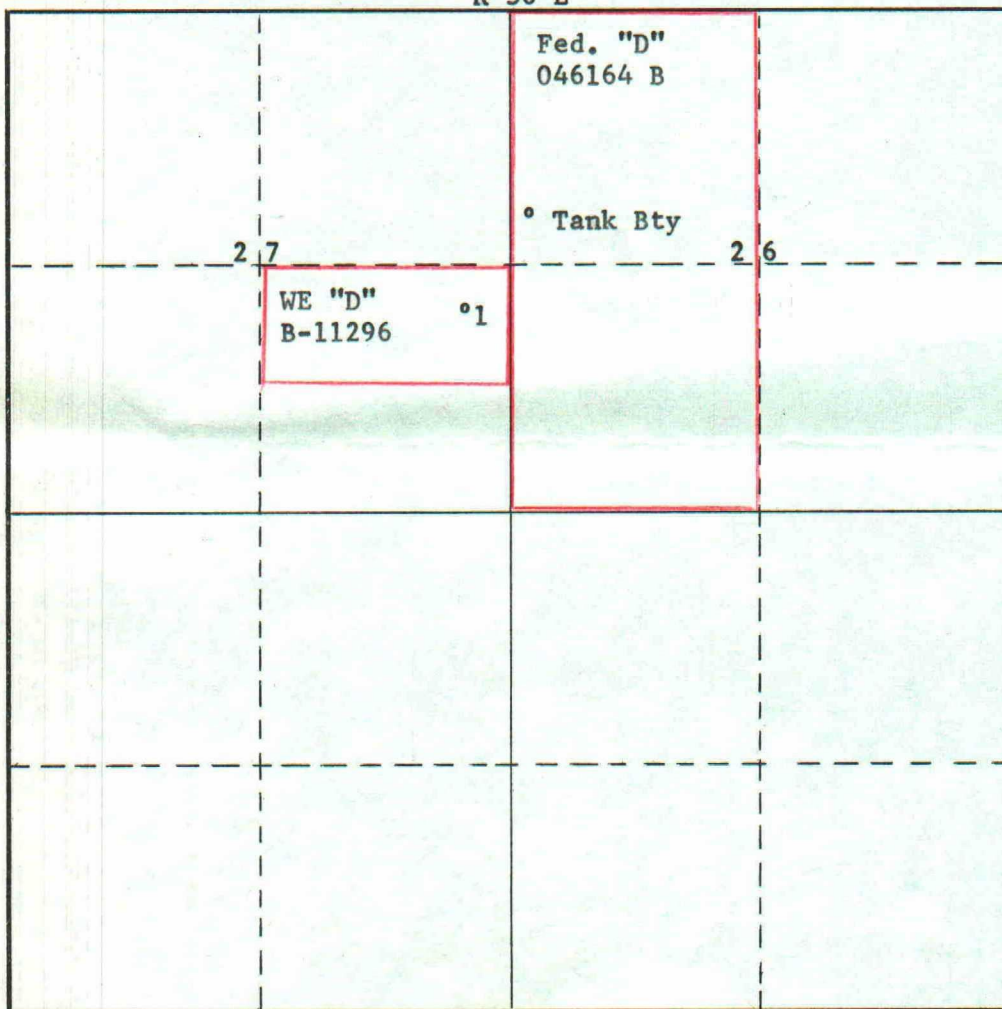

CERTIFICATION

I hereby certify that the information contained herein is true and complete to the best of my knowledge and belief.

Name

Position

**Owner-Operator**

Company

**Millard Deck**

Date

I hereby certify that the well location shown on this plat was plotted from field notes of actual surveys made by me or under my supervision, and that the same is true and correct to the best of my knowledge and belief.

Date Surveyed

Registered Professional Engineer and/or Land Surveyor

Certificate No.

0 330 660 990 1320 1650 1980 2310 2640 2000 1500 1000 500 0

# State of New Mexico



ALEX J. ARMIJO  
COMMISSIONER

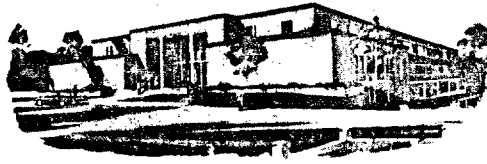

## Commissioner of Public Lands

March 7, 1973

TELEPHONE  
505-827-2748

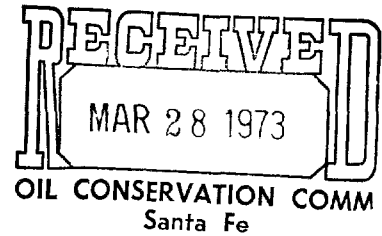

P. O. Box 1148  
SANTA FE, NEW MEXICO

Millard Deck Oil Company  
P. O. Box 1047  
Eunice, New Mexico 88231

Re: Off-Lease Storage

ATTENTION: Mr. Millard Deck

Gentlemen:

Approval is hereby granted for off-lease storage for production from the Millard Deck Oil Company State WE "D" No. 1 located in the NE/4SE/4 of Section 27, Township 20 South, Range 36 East, Lea County, New Mexico. The tank battery being located in the SW/4NW/4 of Section 26, Township 20 South, Range 36 East.

This approval is with the condition that there will be completely separate handling and storage facilities for the State WE "D" lease with no intercommunication possible until the oil and gas is placed into the respective pipeline gathering systems.

We are sending a copy of our letter to the Oil Conservation Commission.

Very truly yours,

*Ray D. Graham*

RAY D. GRAHAM, Director  
Oil and Gas Department

AJA/RDG/s  
encl.

cc: OCC-Santa Fe, New Mexico  
State Lease B-11296



United States Department of the Interior

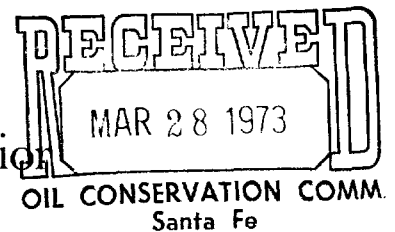

GEOLOGICAL SURVEY  
P. O. Box 1157  
Hobbs, New Mexico 88240

March 13, 1973

Millard Deck Oil Company  
P. O. Box 1047  
Eunice, New Mexico 88231

Attention: Mr. Millard Deck

Dear Mr. Deck:

Your letter of March 1 requests approval to locate the tank battery for your well No. 1 State WE "D" on your Federal "D" lease in the SW $\frac{1}{4}$ NW $\frac{1}{4}$  sec. 26, T. 20 S., R. 36 E., Lea County, New Mexico, lease Las Cruces 046164-B.

We have no objection to you locating the tank battery as proposed provided that oil handling and storage facilities for the State WE "D" are completely separate from oil handling and storage facilities for the Federal "D" lease and provided that both tank batteries are properly identified with appropriate signs.

Our records show that the NW $\frac{1}{4}$  and the S $\frac{1}{2}$  sec. 26 is mineral reserved land and that the surface is privately owned.

Please advise this office when the proposed tank battery is completed so that a field inspection of the facilities can be made.

Sincerely yours,

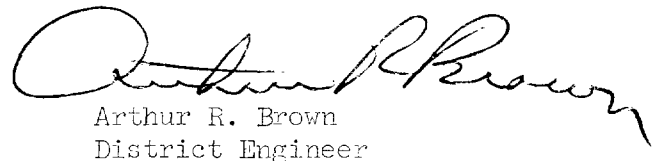
  
Arthur R. Brown  
District Engineer



# RECEIPT FOR CERTIFIED MAIL—30¢ (plus postage)

SENT TO <b>Albuquerque Nat'l Bank Trustee</b>		POSTMARK OR DATE <b>1973 MAR 6</b>
STREET AND NO. <b>c/o Trust Department P.O. Box 1344</b>		
P.O., STATE AND ZIP CODE <b>Albuquerque, New Mexico 87103</b>		
OPTIONAL SERVICES FOR ADDITIONAL FEES		
RETURN RECEIPT SERVICES	<input checked="" type="checkbox"/> 1. Shows to whom and date delivered With delivery to addressee only <input checked="" type="checkbox"/> 2. Shows to whom, date and where delivered With delivery to addressee only <input type="checkbox"/> 3. Shows to whom, date and where delivered With delivery to addressee only	15¢ 30¢ 85¢
DELIVER TO ADDRESSEE ONLY		
SPECIAL DELIVERY (extra fee required)		
PS Form 3800 Nov. 1971		NO INSURANCE COVERAGE PROVIDED— NOT FOR INTERNATIONAL MAIL (See other side) GPO : 1971 O 397-456

# RECEIPT FOR CERTIFIED MAIL—30¢ (plus postage)

SENT TO <b>Penrose Production Company</b>		POSTMARK OR DATE <b>1973 MAR 6</b>
STREET AND NO. <b>1605 Commerce Building</b>		
P.O., STATE AND ZIP CODE <b>Fort Worth, Texas 76102</b>		
OPTIONAL SERVICES FOR ADDITIONAL FEES		
RETURN RECEIPT SERVICES	<input checked="" type="checkbox"/> 1. Shows to whom and date delivered With delivery to addressee only <input checked="" type="checkbox"/> 2. Shows to whom, date and where delivered With delivery to addressee only <input type="checkbox"/> 3. Shows to whom, date and where delivered With delivery to addressee only	15¢ 30¢ 85¢
DELIVER TO ADDRESSEE ONLY		
SPECIAL DELIVERY (extra fee required)		
PS Form 3800 Nov. 1971		NO INSURANCE COVERAGE PROVIDED— NOT FOR INTERNATIONAL MAIL (See other side) GPO : 1971 O 397-456

# RECEIPT FOR CERTIFIED MAIL—30¢ (plus postage)

SENT TO <b>John R. Bryant</b>		POSTMARK OR DATE <b>1973 MAR 6</b>
STREET AND NO. <b>911 Silver Street</b>		
P.O., STATE AND ZIP CODE <b>Hobbs, New Mexico 88240</b>		
OPTIONAL SERVICES FOR ADDITIONAL FEES		
RETURN RECEIPT SERVICES	<input checked="" type="checkbox"/> 1. Shows to whom and date delivered With delivery to addressee only <input checked="" type="checkbox"/> 2. Shows to whom, date and where delivered With delivery to addressee only <input type="checkbox"/> 3. Shows to whom, date and where delivered With delivery to addressee only	15¢ 30¢ 85¢
DELIVER TO ADDRESSEE ONLY		
SPECIAL DELIVERY (extra fee required)		
PS Form 3800 Nov. 1971		NO INSURANCE COVERAGE PROVIDED— NOT FOR INTERNATIONAL MAIL (See other side) GPO : 1971 O 397-456