

**OIL CONSERVATION COMMISSION**

P. O. BOX 2088  
SANTA FE, NEW MEXICO 87501

March 10, 1972

BCO, Inc.  
P. O. Box 669  
Santa Fe, New Mexico 87501

Attention: Mr. Harry R. Bigbee

Administrative Order OLS-81

Gentlemen:

Reference is made to your application for administrative approval for off-lease storage for your Federal 6-22 Well No. 1, located in Unit K of Section 22, Township 24 North, Range 7 West, Escrito-Gallup Pool, Rio Arriba County, New Mexico.

It is our understanding that the tank battery for this well will be located on your Federal Lease No. NM-14925 in the S/2 SW/4 of Section 22, Township 24 North, Range 7 West.

BCO, Inc., is hereby authorized off-lease storage as described above, provided that there shall be no intercommunication of the handling, separating, treating or storage facilities designated to each lease.

Very truly yours,

A. L. PORTER, Jr.  
Secretary-Director

ALP/DSM/esr

cc: Oil Conservation Commission - Aztec  
United States Geological Survey - Roswell

OIL CONSERVATION COMMISSION

P. O. BOX 2088  
SANTA FE, NEW MEXICO 87501

MARCH 10, 1972

3CO, Inc.  
P. O. Box 600  
Santa Fe, New Mexico 87501

Attention: Mr. Harry R. Bishop

Administrative Order OCS-81

Gentlemen:

Reference is made to your application for administrative approval for off-lease storage for your Federal 6-12 well No. 1, located in Unit K of Section 12, Township 24 North, Range 7 West, Section 12, Township 24 North, Range 7 West, Rio Arriba County, New Mexico.

It is our understanding that the tank battery for this well will be located on your Federal Lease No. NM-14225 in the SW 1/4 of Section 12, Township 24 North, Range 7 West.

3CO, Inc., is hereby authorized off-lease storage as described above, provided that there shall be no interference with the operation of the handling, separating, treating or storage facilities designated to each lease.

Very truly yours,

A. L. PORTER, Jr.  
Secretary-Director

AM/EN/ser

cc: Oil Conservation Commission - Added  
United States Geological Survey - Newwell

# BCO, Inc.

OIL WELL OPERATOR  
AND  
TRUCKING DIVISION

SANTA FE, N. M. 87501

AREA CODE 505  
982-4611

P. O. BOX 669

March 8, 1972

New Mexico Oil Conservation Commission  
P.O. Box 2088  
Santa Fe, New Mexico 87501

Attention: Mr. Dan Nutter

Gentlemen:

Pursuant to Rule 309-C we are attaching here-to our letter dated February 25, 1972 requesting approval from the United States Geological Survey for off lease storage on our Federal 6-22 #1 well.

The proposed off lease storage will take advantage of an existing tank battery we currently own, and the savings from not setting up a new battery will make the difference between operating the 6-22 and not operating it. It is a very marginal well at best and would not even justify operating if we didn't already have men in the field to operate it.

As indicated in my letter this is not a request for comingled storage. The necessary steps in the field are currently being taken to physically separate the two tanks at the proposed battery so that there is no possible way for one well to produce into the others battery.

As indicated on the attached plat the only other working interest participant in one well and not in the other is G Stanley Crout who has signed said plat authorizing the off lease storage.

I am also attaching a copy of the USGS approval dated March 3, 1972, for this off lease storage.

Very truly yours,

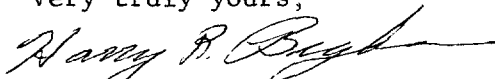
  
Harry R. Bigbee  
President

cc: United States Geological Survey--~~Far~~ <sup>Durango, Colo</sup> ~~min~~ <sup>ington</sup>, N.M.,  
N.M.O.C.C., Aztec, N.M.

# BCO, Inc.

OIL WELL OPERATOR  
AND  
TRUCKING DIVISION

SANTA FE, N. M. 87501.

AREA CODE 505  
982-4611

P. O. BOX 669

February 25, 1972

Mr. Jerry Long  
District Engineer  
United States Geological Survey  
P. O. Box 1809  
Durango, Colorado 81301

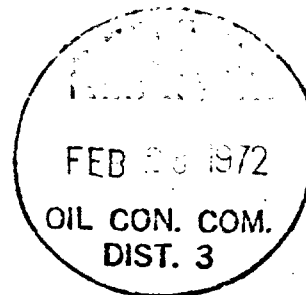

Gentlemen:

The purpose of this letter is to request off lease storage on our Federal 6-22 Well #1 located in Unit Letter K of Section 22 T24N R7W Federal Lease # SF-078974.

We propose to produce it in a tank located in Unit Letter N of Section 22 T24N R7W Federal Lease # NM-14925, which is our Federal 1-22 battery.

Bco, Inc. is the designated operator of both leases concerned, (NM-14925 effective March 1, 1972).

There are two tanks located in Unit N and we intend to produce the 6-22 #1 into one tank and the Federal 1-22 into the other. The equalizing line between the two tanks will be removed from the two tanks so that the leases can not be commingled.

Signs will be placed showing which tank contains lease production from NM-14925 and the other tank will show off lease storage for Lease #SF-078974.

This method of storage will save us a considerable amount of money as well as making hauling of the oil to our LACT unit easier due to the rough location of the 6-22 #1.

We hope you can approve this method of production and we wish to emphasize this is a request for off lease storage and not an authorization to commingle production from two leases.

Very truly yours,

A handwritten signature in cursive script, appearing to read "Harry R. Bigbee".

Harry R. Bigbee

cc: NMOCC Aztec



# United States Department of the Interior

## GEOLOGICAL SURVEY

Drawer 1857  
Roswell, New Mexico 88201

March 3, 1972

BCO, Inc.  
P.O. Box 669  
Santa Fe, New Mexico 87501

Gentlemen:

By letter of February 25, 1972, you requested approval of off-lease storage and measurement of oil to be produced from your No. 1 Federal 6-22 well, located in the NE $\frac{1}{4}$ SW $\frac{1}{4}$  sec. 22, T. 24 N., R. 7 W., lease Santa Fe 078974, Rio Arriba County, New Mexico.

You propose to produce the well into a tank located in the SE $\frac{1}{4}$ SW $\frac{1}{4}$  sec. 22, T. 24 N., R. 7 W., which is a portion of the battery for your lease NM 14925. Your request indicates that the tank to be used for off-lease storage will be separated to prevent commingling of production from the two leases. You also advise that appropriate signs will be posted on the tanks to indicate the proper lease storage.

The off-lease plan of storage is hereby approved. Please notify the District Engineer, P.O. Box 1809, Durango, Colorado 81301, when the installation is completed so that a field inspection can be made.

Sincerely yours,

N. O. FREDERICK  
Regional Oil & Gas Supervisor

RECEIVED MAR 4 1972

Request for off lease storage of Lease #SF-078974 on Lease # NM-14925

Ownership of leases-- Working interest

SF-078974

Harry L. Bigbee

100%

NM-14925

Harry L. Bigbee

95%

G. Stanley Crout

5%

I, G. Stanley Crout, consent to storage for Lease #SF-078974 being placed on Lease #NM-14925 in which I have a 5% interest.

G Stanley Crout  
G Stanley Crout

I, Harry R Bigbee, certify that the above ownership represents 100% of the working interest participants that I am aware of.

Harry R. Bigbee  
Harry R. Bigbee

Attachments:

2-25-72 letter requesting

off lease storage from

USGS indicating physical

hook up to not co-mingle

production.

3-3-72 letter from USGS

approving said plan.

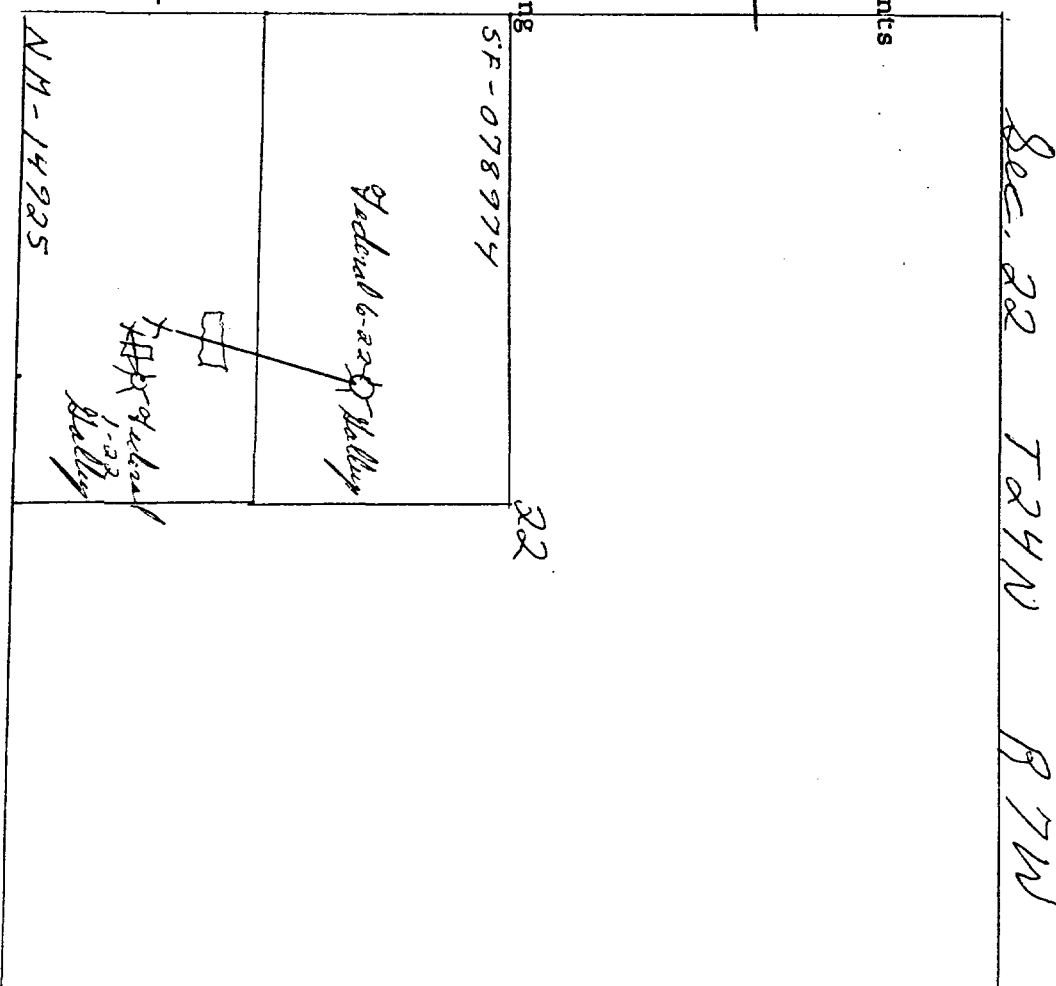

1" = 1056'

X = well

X = 300 bbl. Tank

— = flow line

□ = separator