

Mark K. Mosley
Division Manager
Production Department
Hobbs Division
North American Production

Conoco Inc.
P.O. Box 460
726 E. Michigan
Hobbs, NM 88240
(505) 393-4141

June 15, 1982

JUN 18 1982

New Mexico Oil Conservation Division
Department of Energy and Minerals
State of New Mexico
P. O. Box 2088
Santa Fe, New Mexico 87501

Attention: Mr. Joe D. Ramey

Dear Sir:

Application for Permission to Surface Commingle Production from SEMU No. 120,
Unit B, Section 14, T20S, R37E, Lea County, New Mexico

Conoco Inc. requests administrative approval under the provisions of Rule 303-B to surface commingle Monument Tubb production from SEMU No. 120 into a commingled tank battery located NE/4 SE/4 of Section 15, T20S, R37E, Lea County, New Mexico. Administrative Order PC-249 gave approval to surface commingle Weir Drinkard, Monument Tubb and Undesignated Blinebry (later Weir Blinebry) after separately metering the production from each pool.

Ownership and working interest for all zones is common. Quality of the crude is virtually identical and commingling will not reduce the commercial value.

SEMU No. 120 is currently producing an average of 27 BOPD, 15 BWPD and 375 MCFGPD. The crude from No. 120 has a gravity of 38° and a value of \$31.96 per barrel.

A lease and battery plat are attached for your review and file. The Monument Tubb production from SEMU No. 120 will be allocated on a well test basis.

If you have any questions, please call David G. Smylie, ext. 120 of this office.

Yours very truly,

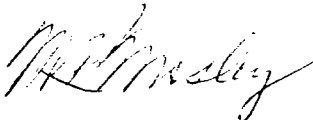

DGS:agd

Attachments

cc: Minerals Management Service
P. O. Box 1857
Roswell, NM 88201

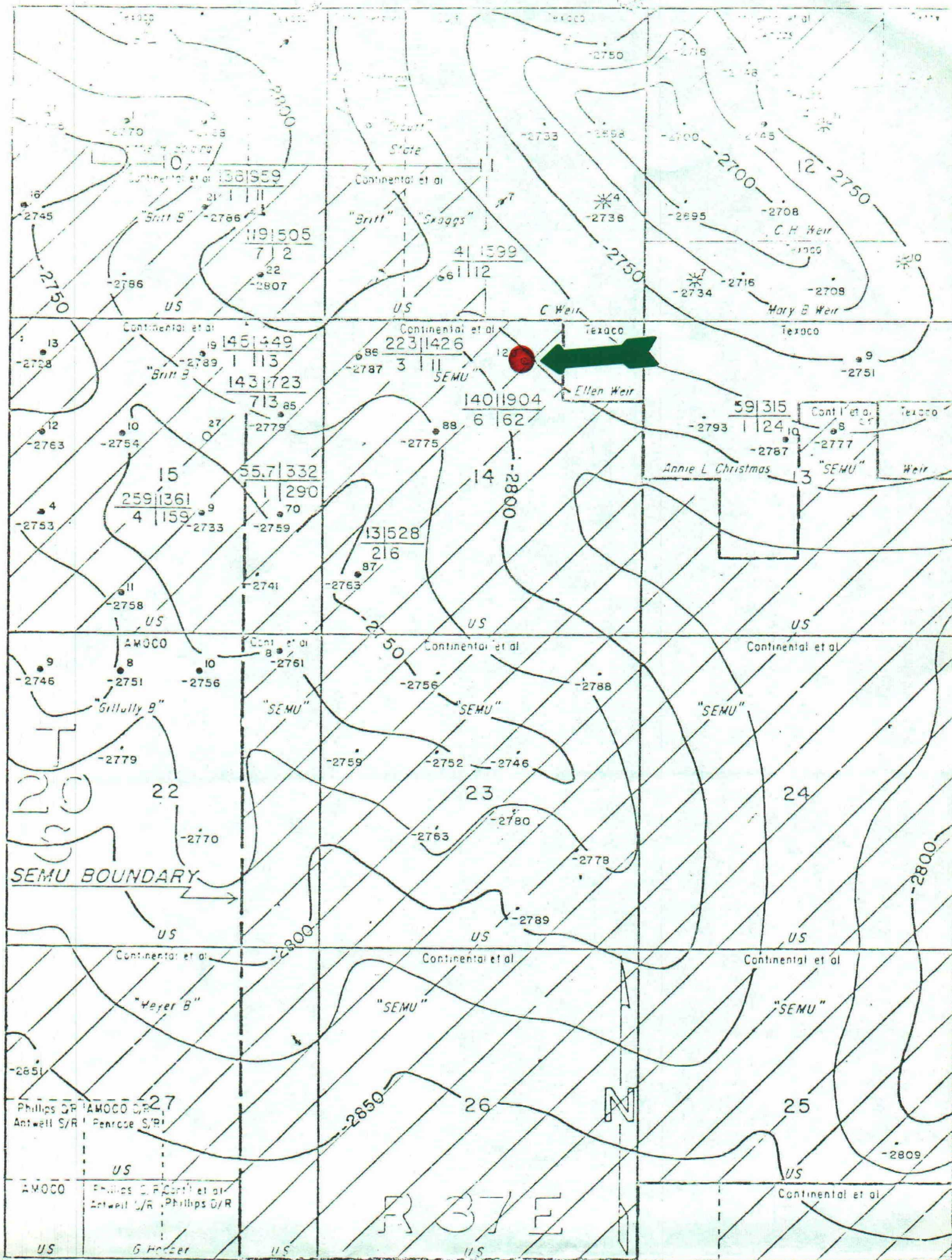

MBO | MMCF
BOPD | MCFPD

CONOCO	
PRODUCTION DEPARTMENT	HOBBS DIVISION
SEMU LEA COUNTY, NEW MEXICO STRUCTURE ON TOP TUBB FM. CI=25' SCALE 0 1000 2000	
EGS 6-80	11n

SEMU DTE BATTERY PROPOSED BATTERY SCHEMATIC

