

AMERICAN TRADING AND PRODUCTION CORPORATION

PETROLEUM LIFE BUILDING  
POST OFFICE DRAWER 992  
MIDLAND, TEXAS 79701

A. C. 915  
MUTUAL 4-4463

April 26, 1968

New Mexico Oil Conservation Commission  
Box 2088  
Santa Fe, New Mexico 87501

Attention: Mr. A. L. Porter, Jr., Secretary-Director

Re: Common Storage Permit  
Southeast Lea Unit #1 (Dual)  
Wolfcamp (Condensate) & Devonian Oil  
Lea County, New Mexico

Gentlemen:

We are submitting an application for administrative approval to commingle the production from the Wolfcamp-condensate and Devonian-oil zones in the referenced well. This well was completed April 1, 1968 as a dual Devonian and Wolfcamp producer and is located in Southeast Lea County, New Mexico. All of the required New Mexico Oil Conservation Commission forms for drilling permits, acreage dedication, request for allowable and authorization to transport oil, well completion reports, and application for multiple completion have been forwarded and approved by the New Mexico Oil Conservation Commission. Forms requesting new pool designation have also been forwarded for approval.

We believe that our field operation will be more economical with common storage facilities for a commonly owned production from two sources of supply which will be accurately measured prior to commingling and dispersion. A schematic diagram of our separating, metering and storage facilities is enclosed for your examination and records. Our other reason for commingling is based on a better market value for the crude due to the slight gravity drop which occurs from mixing 53° API gravity oil with 55° gravity condensate. Pertinent data which follows below is based on Sinclair's area crude price schedule of \$3.11 per barrel for 40-44° gravity with deductions of 2¢ for every degree above or below this posted price:

Devonian-Oil

Gravity: 53° API  
Value per bbl: \$2.93  
Volume per day: 210 bbls.  
Value per day: \$615.30

Wolfcamp-Condensate

Gravity: 55° API  
Value per bbl: \$2.89  
Volume per day: 1200 bbls.  
Value per day: \$3,468.00

The Sum Total: \$4,083.30

New Mexico Oil Conservation Commission  
April 26, 1968  
Page 2

Commingled Liquid

Gravity            51° API  
Value per bbl:    \$2.97  
Volume per day:   1410 bbls.  
Value per day:    \$4,187.70

It is apparent from the data above, that commingling of liquids along with the liquids weathering inside the storage facilities account for a more valuable crude.

We are enclosing required land ownership plats showing the location of the completed well and producing zones for your information and records.

Early consideration of this request will be appreciated. Please notify us if further information is required.

Yours very truly,

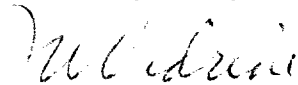
  
J. W. Vidrine  
District Engineer

JWV:rd

Enclosures

cc: O.C.C. Hobbs District

AMERICAN TRADING AND PRODUCTION CORPORATION

SCHEMATIC DIAGRAM OF COMMINGLING FACILITIES  
ON SOUTHEAST LEA UNIT LEASE

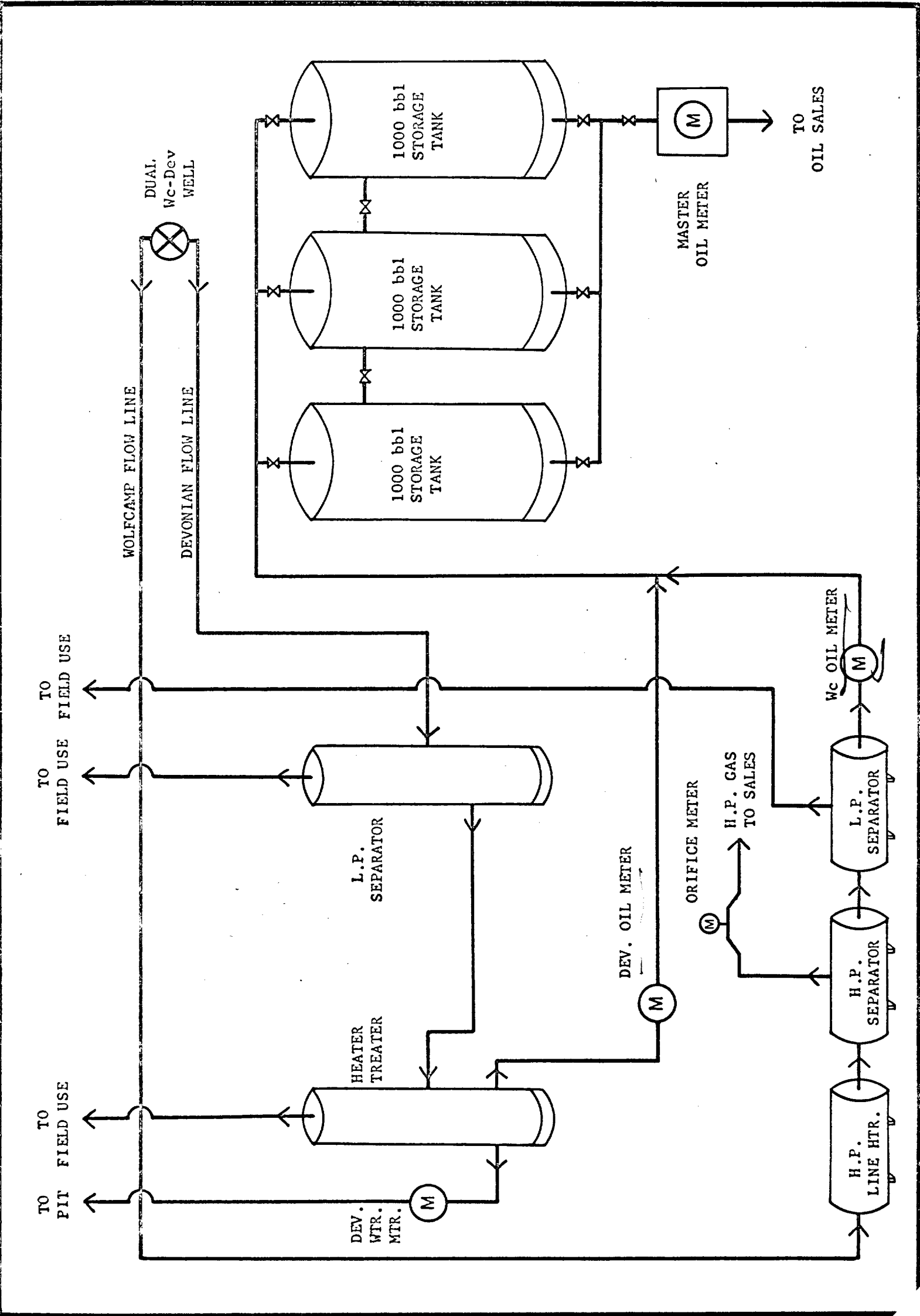

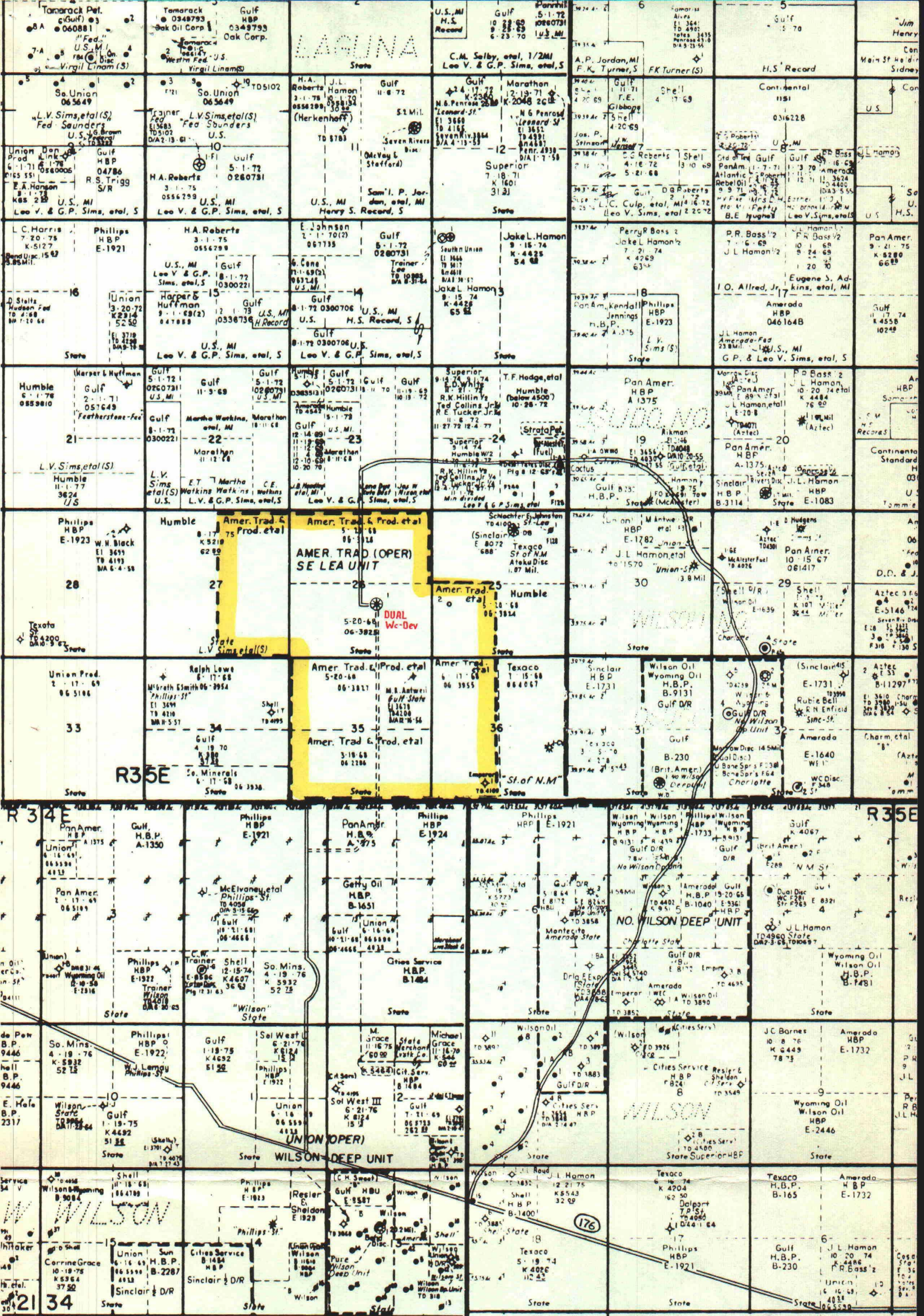

# SOUTHEAST LEA UNIT

## LEA COUNTY, NEW MEXICO

# State of New Mexico



## Commissioner of Public Lands

GUYTON B. HAYS  
COMMISSIONER



P. O. BOX 1148  
SANTA FE, NEW MEXICO

May 7, 1968

Amerikan Trading and Production Corp  
Post Office Drawer 992  
Midland, Texas  
79701

Re: Common Storage Permit  
Southeast Lea Unit #1 (Dual)  
Wolfcamp (Condensate) & Devonian  
Oil - S $\frac{1}{4}$ , Sec 26, T-20-S, R-35-E,  
Lea County, NM. State Lease  
No. OG-3825, LOCO No. 17

Attn: J.W. Vidrine, District Engineer

Gentlemen:

The Commissioner of Public Lands hereby approves your request of May 1, 1968 to commingle production from the Wolfcamp-condensate and Devonian-oil zones in the captioned well, with the reservation that he retain the right to withdraw said approval if, at any time in his discretion, he deems this operation to be adverse to the best interests of the State of New Mexico.

In accordance with the rules and regulations of the State Land Office, there is a \$10.00 filing fee for each commingling action, which you will please remit at your earliest convenience.

Very truly yours,

GUYTON B. HAYS  
Commissioner of Public Lands

By:  
TED BILBERRY, Director  
Oil and Gas Department

TB:jc

cc: New Mexico Oil Conservation Commission  
P. O. Box 2088  
Santa Fe, New Mexico 87501

New Mexico Oil & Gas Accounting Comm  
P.O. Box 2308  
Santa Fe, New Mexico 87501



STAN E. MORTON  
MEMPHIS TENN

1. The first group of persons  
 (100, 100 and 100) and 100  
 2. The second group of persons  
 (100, 100 and 100) and 100  
 3. The third group of persons  
 (100, 100 and 100) and 100  
 4. The fourth group of persons  
 (100, 100 and 100) and 100  
 5. The fifth group of persons  
 (100, 100 and 100) and 100  
 6. The sixth group of persons  
 (100, 100 and 100) and 100  
 7. The seventh group of persons  
 (100, 100 and 100) and 100  
 8. The eighth group of persons  
 (100, 100 and 100) and 100  
 9. The ninth group of persons  
 (100, 100 and 100) and 100  
 10. The tenth group of persons  
 (100, 100 and 100) and 100

[illegible]

~~CONFIDENTIAL~~ DELETED BY [redacted] ON [redacted]

1. 2. 3. 4. 5. 6. 7. 8. 9. 10. 11. 12. 13. 14. 15. 16. 17. 18. 19. 20. 21. 22. 23. 24. 25. 26. 27. 28. 29. 30. 31. 32. 33. 34. 35. 36. 37. 38. 39. 40. 41. 42. 43. 44. 45. 46. 47. 48. 49. 50. 51. 52. 53. 54. 55. 56. 57. 58. 59. 60. 61. 62. 63. 64. 65. 66. 67. 68. 69. 70. 71. 72. 73. 74. 75. 76. 77. 78. 79. 80. 81. 82. 83. 84. 85. 86. 87. 88. 89. 90. 91. 92. 93. 94. 95. 96. 97. 98. 99. 100. 101. 102. 103. 104. 105. 106. 107. 108. 109. 110. 111. 112. 113. 114. 115. 116. 117. 118. 119. 120. 121. 122. 123. 124. 125. 126. 127. 128. 129. 130. 131. 132. 133. 134. 135. 136. 137. 138. 139. 140. 141. 142. 143. 144. 145. 146. 147. 148. 149. 150. 151. 152. 153. 154. 155. 156. 157. 158. 159. 160. 161. 162. 163. 164. 165. 166. 167. 168. 169. 170. 171. 172. 173. 174. 175. 176. 177. 178. 179. 180. 181. 182. 183. 184. 185. 186. 187. 188. 189. 190. 191. 192. 193. 194. 195. 196. 197. 198. 199. 200. 201. 202. 203. 204. 205. 206. 207. 208. 209. 210. 211. 212. 213. 214. 215. 216. 217. 218. 219. 220. 221. 222. 223. 224. 225. 226. 227. 228. 229. 230. 231. 232. 233. 234. 235. 236. 237. 238. 239. 240. 241. 242. 243. 244. 245. 246. 247. 248. 249. 250. 251. 252. 253. 254. 255. 256. 257. 258. 259. 260. 261. 262. 263. 264. 265. 266. 267. 268. 269. 270. 271. 272. 273. 274. 275. 276. 277. 278. 279. 280. 281. 282. 283. 284. 285. 286. 287. 288. 289. 290. 291. 292. 293. 294. 295. 296. 297. 298. 299. 300. 301. 302. 303. 304. 305. 306. 307. 308. 309. 310. 311. 312. 313. 314. 315. 316. 317. 318. 319. 320. 321. 322. 323. 324. 325. 326. 327. 328. 329. 330. 331. 332. 333. 334. 335. 336. 337. 338. 339. 340. 341. 342. 343. 344. 345. 346. 347. 348. 349. 350. 351. 352. 353. 354. 355. 356. 357. 358. 359. 360. 361. 362. 363. 364. 365. 366. 367. 368. 369. 370. 371. 372. 373. 374. 375. 376. 377. 378. 379. 380. 381. 382. 383. 384. 385. 386. 387. 388. 389. 390. 391. 392. 393. 394. 395. 396. 397. 398. 399. 400. 401. 402. 403. 404. 405. 406. 407. 408. 409. 410. 411. 412. 413. 414. 415. 416. 417. 418. 419. 420. 421. 422. 423. 424. 425. 426. 427. 428. 429. 430. 431. 432. 433. 434. 435. 436. 437. 438. 439. 440. 441. 442. 443. 444. 445. 446. 447. 448. 449. 450. 451. 452. 453. 454. 455. 456. 457. 458. 459. 460. 461. 462. 463. 464. 465. 466. 467. 468. 469. 470. 471. 472. 473. 474. 475. 476. 477. 478. 479. 480. 481. 482. 483. 484. 485. 486. 487. 488. 489. 490. 491. 492. 493. 494. 495. 496. 497. 498. 499. 500. 501. 502. 503. 504. 505. 506. 507. 508. 509. 510. 511. 512. 513. 514. 515. 516. 517. 518. 519. 520. 521. 522. 523. 524. 525. 526. 527. 528. 529. 530. 531. 532. 533. 534. 535. 536. 537. 538. 539. 540. 541. 542. 543. 544. 545. 546. 547. 548. 549. 550. 551. 552. 553. 554. 555. 556. 557. 558. 559. 560. 561. 562. 563. 564. 565. 566. 567. 568. 569. 570. 571. 572. 573. 574. 575. 576. 577. 578. 579. 580. 581. 582. 583. 584. 585. 586. 587. 588. 589. 590. 591. 592. 593. 594. 595. 596. 597. 598. 599. 600. 601. 602. 603. 604. 605. 606. 607. 608. 609. 610. 611. 612. 613. 614. 615. 616. 617. 618. 619. 620. 621. 622. 623. 624. 625. 626. 627. 628. 629. 630. 631. 632. 633. 634. 635. 636. 637. 638. 639. 640. 641. 642. 643. 644. 645. 646. 647. 648. 649. 650. 651. 652. 653. 654. 655. 656. 657. 658. 659. 660. 661. 662. 663. 664. 665. 666. 667. 668. 669. 670. 671. 672. 673. 674. 675. 676. 677. 678. 679. 680. 681. 682. 683. 684. 685. 686. 687. 688. 689. 690. 691. 692. 693. 694. 695. 696. 697. 698. 699. 700. 701. 702. 703. 704. 705. 706. 707. 708. 709. 710. 711. 712. 713. 714. 715. 716. 717. 718. 719. 720. 721. 722. 723. 724. 725. 726. 727. 728. 729. 730. 731. 732. 733. 734. 735. 736. 737. 738. 739. 740. 741. 742. 743. 744. 745. 746. 747. 748. 749. 750. 751. 752. 753. 754. 755. 756. 757. 758. 759. 760. 761. 762. 763. 764. 765. 766. 767. 768. 769. 770. 771. 772. 773. 774. 775. 776. 777. 778. 779. 780. 781. 782. 783. 784. 785. 786. 787. 788. 789. 790. 791. 792. 793. 794. 795. 796. 797. 798. 799. 800. 801. 802. 803. 804. 805. 806. 807. 808. 809. 810. 811. 812. 813. 814. 815. 816. 817. 818. 819. 820. 821. 822. 823. 824. 825. 826. 827. 828. 829. 830. 831. 832. 833. 834. 835. 836. 837. 838. 839. 840. 84

1. The Commission of the European Communities (CEC) has been established to coordinate the activities of the member states in the field of economic and social policy. The Commission is composed of representatives of the member states and the European Parliament. The Commission's main task is to ensure the implementation of the Treaty of Rome and to coordinate the activities of the member states in the field of economic and social policy. The Commission is also responsible for the management of the European Community's budget and for the implementation of the European Community's policies in the field of economic and social policy. The Commission is also responsible for the management of the European Community's budget and for the implementation of the European Community's policies in the field of economic and social policy.

At 10:00 AM, 10/10/68, the following information was received from the New York City Police Department (NYCPD) regarding the above captioned case:

2204 VINTAGE

BY THE COURT:

Signed at New York, New York, this \_\_\_\_\_ day of \_\_\_\_\_, 19\_\_\_\_.

indicated, YFV can be transmitted to man. The

24 : 25

DECLASSIFIED AUTHORITY: E.O. 13526  
DATE: 08-01-2017

1975

OIL CONSERVATION COMMISSION

P. O. BOX 2088

SANTA FE, NEW MEXICO 87501

April 29, 1968

*Hand for  
Land Affc OK*

C  
O  
P  
Y  
  
American Trading and Production Corporation  
P. O. Drawer 992  
Midland, Texas 79701

Attention: Mr. J. W. Vidrine

Gentlemen:

Reference is made to your application dated April 26, 1968, for authority to commingle oil and condensate production from your Southeast Lea Unit Well No. 1.

Inasmuch as this well is located on state land, it will be necessary that you obtain the consent of the Commissioner of Public Lands for the State of New Mexico, P. O. Box 1148, Santa Fe, to the proposed commingling.

Upon receipt of his consent, we will be happy to process your application.

Very truly yours,

DANIEL S. NUTTER  
Chief Engineer

DSN/esr

OIL CONSERVATION COMMISSION

P. O. BOX 2088

SANTA FE, NEW MEXICO 87501

April 29, 1964

Dear Sirs: We have received your letter of April 23, 1964, regarding the proposed drilling and production operations on the Santa Fe Indian Reservation, Santa Fe County, New Mexico.

Enclosed for you are two copies of the

Commission's

Recommendation to the Secretary of the Interior, dated April 23, 1964, regarding the proposed drilling and production operations on the Santa Fe Indian Reservation, Santa Fe County, New Mexico.

Inasmuch as this well is located on state land and it will be necessary that you obtain the necessary permits from the State of New Mexico, P. O. Box 1000, Santa Fe, New Mexico, for the proposed drilling and production operations.

Very truly yours,  
Enclosed for your information are two copies of the Commission's

DANIEL R. MURPHY  
Chief Engineer

cc: Mr. [unclear]