

PAN AMERICAN PETROLEUM CORPORATION

Post Office Box 68  
Hobbs, New Mexico

August 28, 1964

File: VES-226-400 x 541.112

Subject: Commingling of Production  
Various Leases  
House San Andres and House Drinkard  
Fields.

Mr. A. L. Porter, Jr. (3)  
Secretary-Director  
New Mexico Oil Conservation Commission  
Post Office Box 871  
Santa Fe, New Mexico

Dear Sir:

Pan American Petroleum Corporation hereby submits application for commingling of oil production from the following wells and oil pools:

<u>Lease &amp; Well</u>	<u>Pool</u>	<u>Location</u>
D.E. House "A" No. 1	House-San Andres	Unit I, Sec. 11, T-19-S, R-38-E
S.C. Bilberry No. 1	House	Unit E, Sec. 6, T-19-S, R-39-E
G.M. Cone "A" No. 1	House	Unit F, Sec. 12, T-19-S, R-38-E
G.M. Cone "B" No. 1	House	Unit J, Sec. 12, T-19-S, R-38-E
State "U" No. 1	House	Unit P, Sec. 2, T-19-S, R-38-E

In support of our request for exception without notice and hearing to Rules 303-A and 309-B, to permit the commingling in common facilities of oil production from leases of diversified ownership having two or more common sources of supply, the following is submitted:

1. A plat of the leases, showing thereon all wells and formation in which each is completed, is attached.
2. Schematic diagram of the proposed commingling facility to be located in the SE/4 of NW/4 Section 12, T-19-S, R-38-E, is attached.

Mr. A. L. Porter, Jr.  
August 28, 1964  
Page 2

3. Production from each lease and each pool will be metered and sampled separately prior to commingling using A. O. Smith T-6 temperature compensated meters equipped with samplers.
4. A BS&W reading will be taken every eight days and the production recorded.
5. Detailed data of liquid hydrocarbons:

<u>Pool</u>	<u>Gravity</u> <u>°API</u>	<u>Value/Bbl</u>	<u>Estimated Annual</u> <u>Production-Bbls</u>
A. House San Andres	32.1	2.79	4,070
B. House Drinkard	35.8	2.85	16,840
C. Commingled	35.1	2.85	20,910

The commercial value of the commingled production is expected to be \$244 per year more than the sum of the values from each common source of supply.

6. All parties owning an interest in these leases and the purchaser of the commingled production have been notified by certified mail.

Yours very truly,



V. E. Staley  
Area Superintendent

Attachments



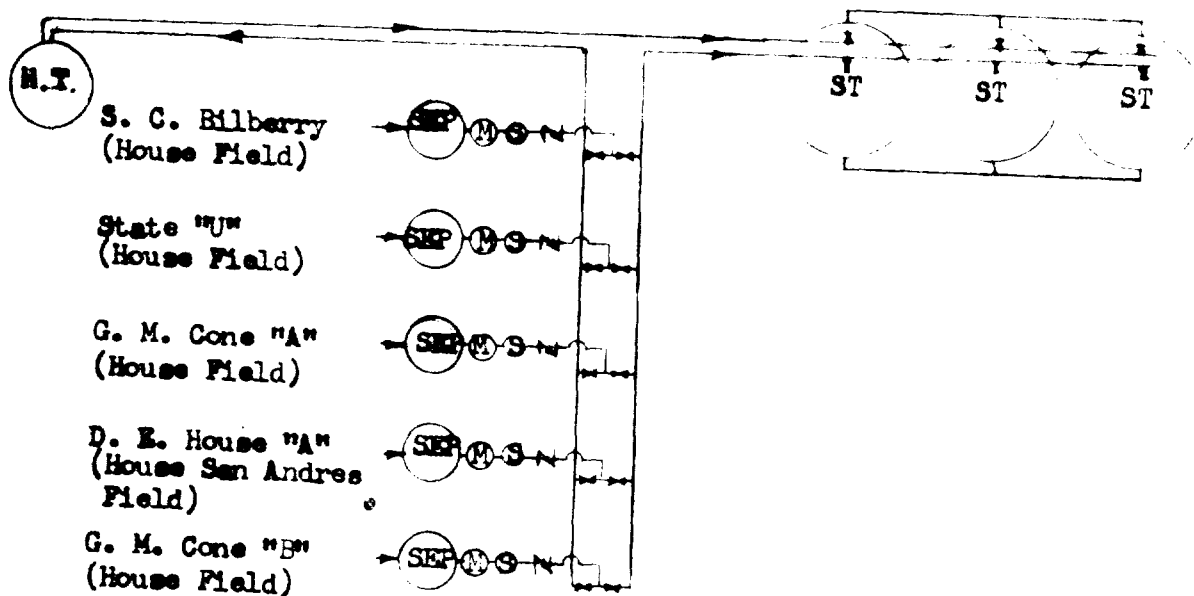

ILLEGIBLE

PAN AMERICAN PETROLEUM CORPORATION

Proposed Gas Central Storage System

Consists of 12, 19-2, 2-33-2

SCALE:

Des.  
No.

The Hefner Company  
P. O. Box 18777  
Oklahoma City, Oklahoma 733118

June D. Speight  
P. O. Box 1687  
Lovington, New Mexico

Roger M. Edler and Janet L. McMinch  
Guardians of the Estate of Arthur C. Edler  
682 Rockdale Drive  
San Francisco 27, California

Lottie Oliver  
25965 Hesperian Boulevard  
Mt. Eden, California

Franklin K. Mason  
2005 East Harris  
Pasadena, Texas

Jean Marie Johansen  
Apartment 201  
305 Grant  
Glendive, Montana

Marilee I. Kyte  
P. O. Box 817  
Los Altos, California

H. B. Fuqua  
Ind. Executor of the Estate of Clifford Mooers, Dec.  
1315 Ft. Worth National Bank Building  
Fort Worth, Texas

Kirby Petroleum Company  
P. O. Box 1745  
Houston 1, Texas

Blanche Oliver  
567 Kingsley Avenue  
Palo Alto, California

Richard H. Sears  
Executor of the Estate of Henry E. Sears  
5110 Cherry Street  
Kansas City 10, Missouri

John L. Pratt III  
c/o R. W. Wakefield  
P. O. Box 707  
Wilmington 99, Delaware

Robert W. Wakefield  
P. O. Box 707  
Wilmington 99, Delaware

David D. Wakefield  
c/o R. W. Wakefield  
P. O. Box 707  
Wilmington 99, Delaware

Andrew Oil and Gas Royalties, Inc.  
3428 Seventy-Sixth Street  
Jackson Heights 72, New York

Helen Chase Bell  
2010 Oakland Avenue  
Peidmont 11, California

George Q. Chase  
37 Lincoln Avenue  
Peidmont 11, California

Helen Dornin Childs  
2011 Oakland Avenue  
Peidmont 11, California

Charles H. Ball  
1589 Carnation Way  
Niles, California

David Bond Kyte  
c/o Bartlett & Pringle  
26 West Figueroa Street  
Santa Barbara, California

Betty Kyte Dressen Trust  
The Bank of California National  
Associate Trustee  
400 California Street  
San Francisco 20, California

Imperial Rochester  
Syndicate Group No. 187 SPL  
Imperial Royalties Company  
c/o Harold F. Callister  
B-14 Courthouse  
Rochester 14, New York

Clarence H. Breuner  
480 Crocker Road  
Sacramento, California

Richard W. Breuner  
515 Miner Road  
Orinda, California

Wallace E. Breuner  
124 Loxford Road  
Peidmont, California

Robert A. Breuner  
P. O. Box 550  
Roseville, California

Gladys Berry  
3101 Daniels  
Dallas, Texas

Lillian Herndon  
808 East Hester Street  
Brownfield, Texas

R. A. Thurmon  
P. O. Box 1547  
Longview, Texas

Ruby R. Fulmer  
3250 Main Street  
Riverside, California

Edwin C. Street  
582 Boulevard Way  
Peidmont 10, California

Effie Virginia Palmer Bray  
P. O. Box 624  
Muleshoe, Texas

Irma B. Schaefer  
3132 H Street  
Sacramento, California

Henry Schaefer, Jr.  
3132 H Street  
Sacramento, California

Irma B. Schaefer and Harold Robinson,  
Guardians of the Estate of Carolyn Schaefer  
3132 H Street  
Sacramento, California

Florence Louise Woods  
5739 East 56th Street  
Tulsa, Oklahoma

Marion D. Schaefer  
3132 H Street  
Sacramento, California

John H. Costello  
305 Andover Street  
Lowell, Massachusetts

Alice C. Hardy  
635 West Fern Avenue  
Redlands, California

Mary Grier Pratt and Lockwood J. Pratt  
c/o Robert W. Wakefield  
P. O. Box 707  
Wilmington 99, Delaware

Irving G. Downs and/or Florence A. Downs  
1130 South Gilpin Street  
Denver 10, Colorado

W. M. Beauchamp  
Guardian of Myron James Mason, A Minor  
322 West Central  
Lovington, New Mexico

Kirby D. Schenck  
P. O. Box 593  
Lovington, New Mexico

J. Hiram Moore and/or Betty Moore  
P. O. Box 1733  
Midland, Texas

J. E. Simmons and Beulah H. Simmons  
P. O. Box 548  
Lovington, New Mexico

Charles R. Turner and Mildred G. Turner  
P. O. Box 1678  
Hobbs, New Mexico

Roy G. Barton and Opal Barton  
P. O. Box 978  
Hobbs, New Mexico

S. C. Bilberry and Daisy Bilberry  
P. O. Box 724  
Hagerman, New Mexico

Betty M. Dressen  
P. O. Box 1  
Roswell, New Mexico

Louis J. Brauner  
5883 Romany Road  
Oakland 18, California

J. G. Catlett Company  
508 Dowall Building  
1579 East 21st Street  
Tulsa 14, Oklahoma

Dr. Edwin Merrithew  
1300 Wallace Avenue  
Martinez, California

Andrew W. Oliver  
Mount Eden, California

Suits E. Stralsinger and Maude Stralsinger  
521 Eureka Street  
Redlands, California

Kenneth E. Ward  
2210 7th Street South  
Moorhead, Minnesota

Joseph F. Woodsum and Grace D. Woodsum  
807 West Commonwealth  
Alhambra, California

Mark Whelan  
3808 Mackland Avenue, N.E.  
Albuquerque, New Mexico

Charles K. Elliott  
R R No. 1 Box 232  
Greenwood, Delaware

Frank A. Elliott, Jr.  
c/o Greenwood Trust Company Bank  
Greenwood, Delaware

Henry Degraffenried Bedford  
P. O. Box 572  
San Clemente, California

Georgiana S. Kane  
922 Prater Way  
Sparks, Nevada

Bella Steiner  
333 12th Street  
Sparks, Nevada

Frances Grier Wakefield and Harold K. Wakefield  
c/o R. W. Wakefield  
P. O. Box 707  
Wilmington 99, Delaware

Marjorie Cone Kastman  
Guardian of the Estate of S. E. Cone  
2806 34th Street  
Lubbock, Texas

J. R. Cone  
P. O. Box 871  
Lubbock, Texas

Myrtle Pevohouse  
Route 5  
Lubbock, Texas

Sinclair Oil & Gas Company  
P. O. Box 521  
Tulsa 2, Oklahoma

C. L. Norsworthy, Jr. and Nona B. Norsworthy  
2737 Republic National Bank Building  
Dallas 1, Texas

Lester Alston  
P. O. Box 188  
Lovington, New Mexico

Amerada Petroleum Corporation  
51 West 51st Street  
New York 19, New York

Constance E. Byers  
Two Miles Road  
Austin, Texas

Robert E. Byers  
212 Austin National Bank Building  
Austin, Texas

Ronald J. Byers  
Two Miles Road  
Austin, Texas

Gordon M. Cone  
P. O. Box 1148  
Lovington, New Mexico

A. C. Holder  
P. O. Box 1476  
Lovington, New Mexico

Paul C. Laird  
Pittsburg, Texas

H. D. Schenck  
P. O. Box 1225  
Lovington, New Mexico

Ione Buckner McAlister  
3613 Overton Park East  
Fort Worth 9, Texas

Clifford B. Lindh and Marie S. Lindh  
5224 York Avenue South  
Minneapolis 10, Minnesota

Francis A. Nicholas and Bernice M. Nicholas  
Route 2 Box 2120  
Loomis, California

Bunice V. Nielsen  
4230 Minnehaha Avenue South  
Minneapolis 6, Minnesota

Harold C. Preston and Elvina Preston  
Route 1 Sibley Memorial Highway  
St. Paul 11, Minnesota

H. B. Dickinson and Alice Bond Dickinson  
409 N. Carrizo  
Midland, Texas

C. M. Linehan  
1208 Harvard Drive  
Midland, Texas

Wayne Moore and Jo Ann Moore  
403 North Marienfeld  
Midland, Texas

Sam Mizel  
614 Kennedy Building  
Tulsa, Oklahoma

Eula L. Howe  
P. O. Box 584  
Hobbs, New Mexico

John D. Bleecker  
800 Midland Bank Building  
Minneapolis, Minnesota

Emil Berglund and Althea M. Berglund As Joint  
Tenants  
1006 Builders Exchange Building  
Minneapolis, Minnesota

Benjamin W. Howe  
P. O. Box 584  
Hobbs, New Mexico

Wesley E. Howe  
1405 West Fox Street  
Carlsbad, New Mexico

Aurilla L. Smith  
616 National Building  
Minneapolis 2, Minnesota

Helen S. Henton  
Olivia, Minnesota

Worldwide Petroleum Corporation  
407 Mutual Savings Building  
Fort Worth, Texas

Lena Mizel, Morris Mizel & Sam Mizel  
Ancillary Executors of the Last Will and  
Testament of Abe Mizel, Deceased.  
c/o Central Supply Company  
210 Midstates Building  
Tulsa, Oklahoma

Bernard A. Ray and Hilda Blair Ray  
Little Marais, Minnesota

John E. Peters and Adelaide W. Peters  
5352 Zenith Avenue South  
Minneapolis 10, Minnesota

Leonard O. Langer and Louise B. Langer  
1260 Northwest Bank Building  
Minneapolis 2, Minnesota

Willard L. Craig and Milta I. Craig  
5720 York Avenue South  
Minneapolis 10, Minnesota

Ralph E. Preston and Mabel A. Preston  
4032 20th Avenue South  
Minneapolis 7, Minnesota



Robert A. Johnson  
3018 Chicago Avenue  
Minneapolis, Minnesota

Roberta B. Hostetler  
2634 Bryant Avenue South  
Minneapolis 8, Minnesota

Muriel F. West  
5329 Dupont Avenue South  
Minneapolis 19, Minnesota

Hayner N. Larson and Hortense Matsen Larson  
1260 Northwest Bank Building  
Minneapolis 2, Minnesota

Theodore H. Witte and Bertha A. Witte  
1821 Washington South  
Minneapolis 4, Minnesota

Loren C. Babcock and Alice C. Babcock  
1041 12th Avenue Southeast  
Minneapolis 14, Minnesota

John D. Elsecker and Zita K. Elsecker  
800 Midland Bank Building  
Minneapolis 1, Minnesota

Frank L. Brunkow and Belva K. Brunkow  
1145 Northwest Bank Building  
Minneapolis, Minnesota

Kossie Long Buckner, Jr.  
3613 Overton Park East  
Fort Worth 9, Texas

OIL CONSERVATION COMMISSION  
P. O. BOX 871  
SANTA FE, NEW MEXICO

September 23, 1964

C  
O  
P  
Y  
  
Pan American Petroleum Corporation  
P. O. Box 68  
Hobbs, New Mexico

Attention: Mr. V. E. Staley

Gentlemen:

Reference is made to your letter of August 28, 1964, requesting authority to commingle House-San Andres and House-Drinkard production from several leases in Lea County, New Mexico.

Inasmuch as State land is involved in this application, it will be necessary for you to secure the approval of the Commissioner of Public Lands for the State of New Mexico before we can approve the application. Upon receipt of the Commissioner's approval, we will be happy to process your application.

Very truly yours,

D. S. Mutter  
Chief Engineer

DSN:sg

cc: State Land Office - Santa Fe

# PAN AMERICAN PETROLEUM CORPORATION

Post Office Box 68  
Hobbs, New Mexico

September 25, 1964

MAIN OFFICE  
SEP 25 1964

File: VES-510-400 x 541.112

Subject: Commingling of Production  
Various Leases  
House, San Andres and House-  
Drinkard Fields  
Lea County, New Mexico

Mr. A. L. Porter, Secretary Director  
New Mexico Oil Conservation Commission  
Post Office Box 871  
Santa Fe, New Mexico

Dear Sir:

Reference is made to our letter dated August 28, 1964, File: VES-226-400 x 541.112, Subject: as above, regarding commingling of production from various leases including the State "U" Lease located in Section 2, T-19-S, R-38-E, Lea County, New Mexico.

Attached, for your records, is a copy of the State of New Mexico, Commissioner of Public Lands' letter approval to commingle the State "U" Lease production.

Yours very truly,



V. E. Staley  
Area Superintendent

Attachment

State of New Mexico



Commissioner of Public Lands



September 17, 1964

E. S. JOHNNY WALKER  
COMMISSIONER

RECEIVED	
PAN AMERICAN	
PETROLEUM CORP.	
SEP 21 1964	
HOBBS, N.M.	
AS	
AC	2 7 21
AE	3
AF1	
AF2	
AAC	
PLH	4
PLH	5
PLH	

BOX 1148  
SANTA FE, NEW MEXICO

DET DET

Pan American Petroleum Corporation  
Post Office Box 68  
Hobbs, New Mexico

Att: V. E. Staley

In RE: Request for permission  
to commingle production  
from State "U" Lease  
B-9652.

Gentlemen:

The State Land Office is willing to give its approval on the above captioned request provided, however, that the production from the State lease be metered before it is commingled with fee leases.

This approval is also given with the provision that the Commissioner of Public Lands reserves the right to amend or withdraw his approval should this installation not be carried out according to the metering system set aside by the Oil Conservation Commission.

Very truly yours,

E. S. JOHNNY WALKER,  
Commissioner of Public Lands

By

A handwritten signature in cursive script, reading "Romulo Martinez".

ROMULO MARTINEZ,  
Oil and Gas Department

ESJW/RM/kcl

w/cc to: Oil Conservation Commission  
Oil and Gas Accounting Commission

OIL CONSERVATION COMMISSION

P. O. BOX 2088

SANTA FE, NEW MEXICO

May 3, 1966

C  
Pan American Petroleum Corporation  
P. O. Box 68  
Hobbs, New Mexico 88240

Attention: Mr. V. E. Staley

AMENDMENT  
Administrative Order PLC-13

O  
Gentlemen:

P  
Y  
Reference is made to your letter dated April 22, 1966, wherein you request authority to include House-San Andres production from your D. E. Howse "B" Well No. 1 located in the SE/4 SE/4 of Section 11, Township 20 South, Range 38 East, Lea County, New Mexico, in the commingling installation authorized by Administrative Order PLC-13 which at present handles production from your D. E. Howse "A", S. C. Bilberry, G. M. Cone "A", G. M. Cone "B", and State "U" Leases in Sections 2, 11, and 12, Township 19 South, Range 38 East, and Section 6, Township 19 South, Range 39 East, Lea County, New Mexico, after separately metering the production from each lease and each pool. It is our understanding that the ownership of the D. E. Howse "A" Lease and the D. E. Howse "B" Lease is identical throughout, and that you therefore propose to commingle the production from each of these leases upstream from the commingling meter, and allocate the production to each of the two leases by means of well tests. This commingled production plus that from the other leases would then be separately metered prior to further commingling.

Administrative Order PLC-13 is hereby amended to permit the inclusion of the aforesaid D. E. Howse "B" Well No. 1 in the commingling installation, with the provision that the installation shall continue to be operated in accordance with the Commission "Manual for the Installation and Operation of Commingling Facilities," including the requirement for non-reset counters on the meters.

Very truly yours,

A. L. PORTER, Jr.  
Secretary-Director

ALP:DSN:sg

cc: Oil Conservation Commission (with enclosure) - Hobbs  
Oil & Gas Engineering Committee - Hobbs  
State Land Office - Santa Fe

PAN AMERICAN PETROLEUM CORPORATION

Post Office Box 68  
Hobbs, New Mexico

APR 1 1966

April 22, 1966

File: VES-122-541.112 x 400

Subject: Commingling of Production  
D. E. Howse "B" Lease  
Into Cone Central Storage Battery  
House San Andres Field  
Lea County, New Mexico

Mr. A. L. Porter, Jr. (3)  
Secretary-Director  
New Mexico Oil Conservation Commission  
Post Office Box 871  
Santa Fe, New Mexico

Dear Sir:

Pan American Petroleum Corporation hereby submits application for the commingling of oil production from the D. E. Howse "B" Well No. 1, located in the SE/4 SE/4, Section 11, Township 20 South, Range 38 East, with the D. E. Howse "B" Well No. 1, House San Andres Field, which is currently part of the Cone Central Storage System, located in Section 12, Township 20 South, Range 38 East.

In support of our request to amend administrative Order PLC-13, to include the D. E. Howse "B" Lease, the following is submitted:

1. Production from the Howse "B" Well No. 1 will be commingled with and through the lease meter serving the Howse "A" Well No. 1 with production from these two leases to be allocated by well test. Well tests will be conducted by alternately shutting in one of the wells while the other well produces, in lieu of separate test facilities.
2. Production from both leases is from a common source of supply, San Andres Formation, House Pool.
3. Plat of the leases showing thereon the wells and the formations in which they are completed is attached.
4. Schematic diagram of the proposed installation is attached.

Page Two

Mr. A. L. Porter, Jr.

April 22, 1966

5. Production from the separate leases is common as to working interest ownership, royalty ownership, and overriding royalty ownership. Each lease has adequate facilities installed to permit determining the producing capacity of each well on each lease at least once per month, in accordance with applicable provisions of the current Commission Manual For the Installation and Operation of Commingling Facilities.

Yours very truly,



V. E. Staley  
Area Superintendent

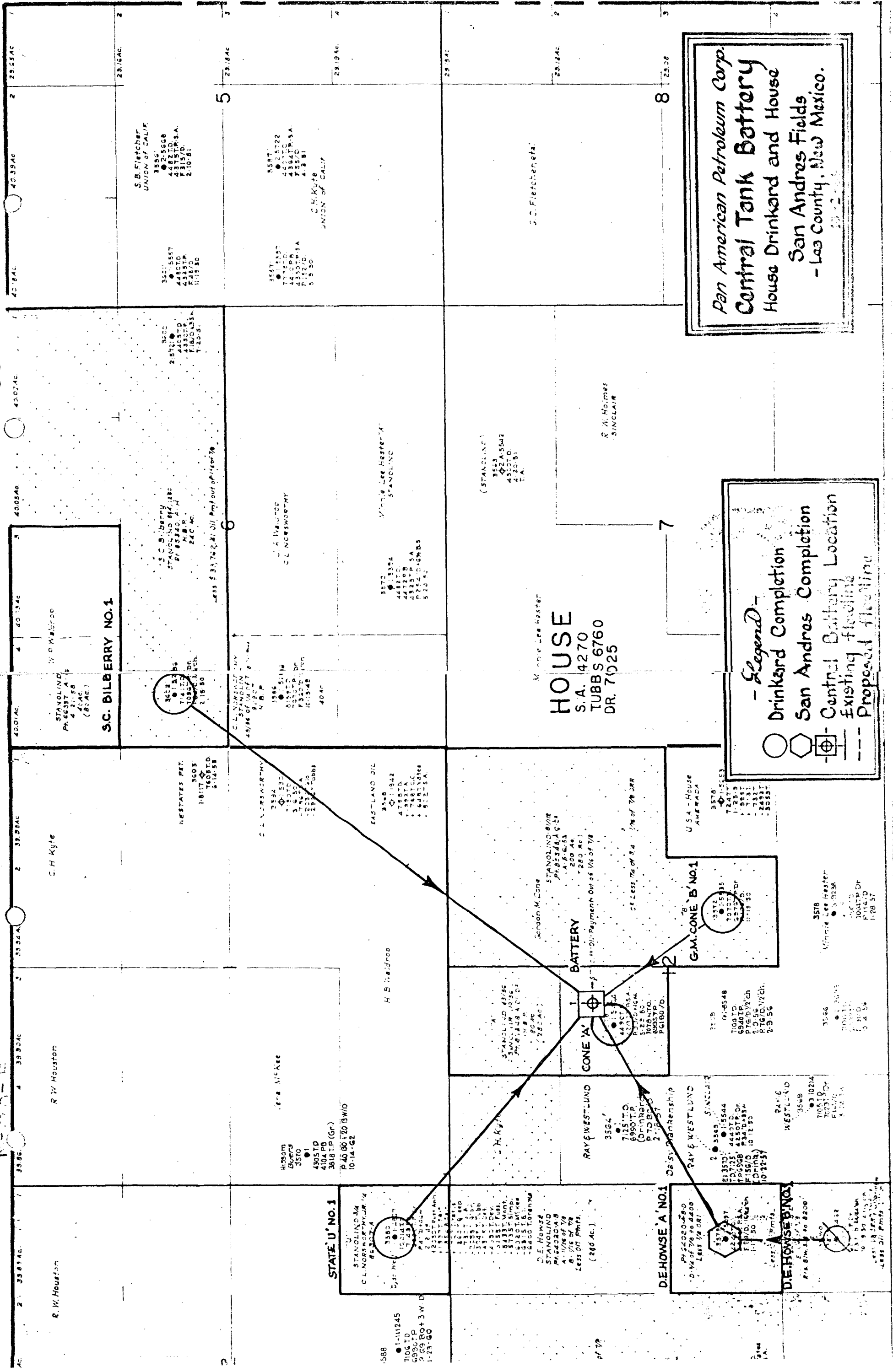



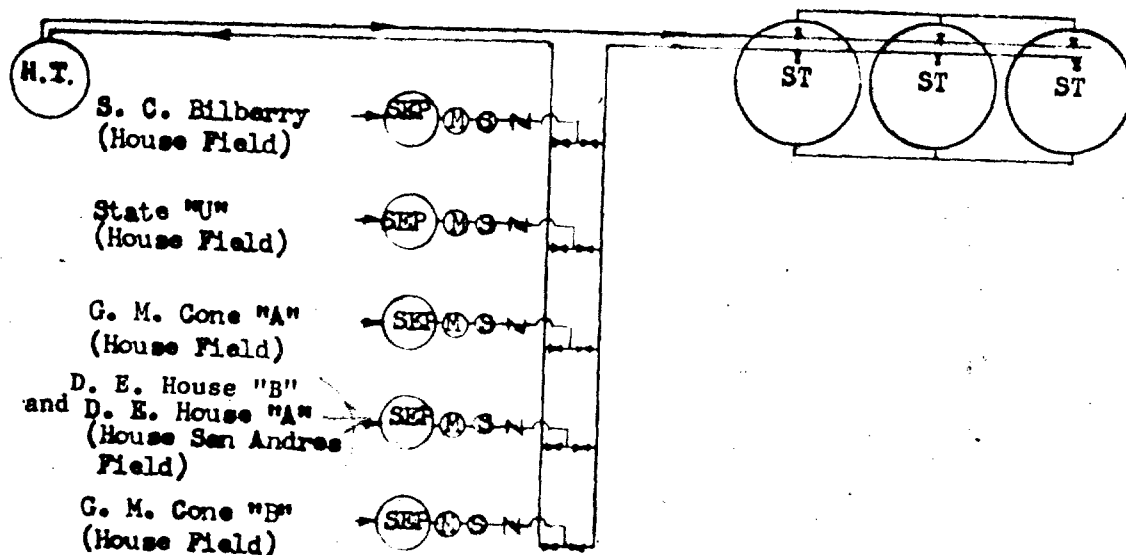

PAN AMERICAN PETROLEUM CORPORATION

Proposed Cone Central Storage System  
 Located: SE 1/4 of NW 1/4 Sec. 12, T-19-S, R-38-E

SCALE:

DRG.  
 NO.

MAIN OFFICE 010

'66 JUN 10 PM 1 09

June 10, 1966

*file 13  
PLH*

Fan American Petroleum Corporation  
P.O. Box 68  
Hobbs, New Mexico

RE: State of New Mexico Lease No.  
B-9652, Your D.E. Howse "B" Lease

Attention: Mr. V.E. Staley  
Area Superintendent

Gentlemen:

In regard to your application to commingle production from the D.E. Howse "B" Well Number 1 located in SE/4 SE/4 of Section 11, Township 20 South, Range 38 East with production from the D.E. Howse "B" Well Number 1 located in Section 12, Township 20 South, Range 38 East, please be advised that the Commissioner of Public Lands has no objection to your proposal.

It is our understanding that the above production is to be commingled in the Cone Storage System which includes production from your State "U" Number 1 Well which is located in the SE/4 SE/4 of Section 2, Township 20 South, Range 38 East. On September 17, 1964, this office extended approval commingle production from the State "U" Well Number 1 into the Cone Central System with the condition that production should be separately metered. We assume that you have installed separate meters and facilities for production from the State "U" Well Number 1. Compliance with that condition is a condition precedent to our approval for expansion of the system.

C  
O  
P  
Y

June 10, 1966

We wish to thank you for your indulgence and cooperation in regard to this matter.

Very truly yours,

GUYTON B. HAYS  
Commissioner of Public Lands

BY:

Ted Bilberry, Director  
Oil and Gas Department

GBH:EB:TB:yds

cc: New Mexico Oil Conservation Commission  
P.O. Box 2088  
Santa Fe, New Mexico

C  
O  
P  
Y

OIL CONSERVATION COMMISSION

P. O. BOX 2088

SANTA FE, NEW MEXICO 87501

June 24, 1968

C Pan American Petroleum Corporation  
P. O. Box 68  
Hobbs, New Mexico

Attention: Mr. V. E. Staley

AMENDMENT

Administrative Order PLC-13

O  
P  
Y  
Gentlemen:

Reference is made to your application dated March 26, 1968, for an amendment to Administrative Order PLC-13 to delete the Drinkard production from the S. C. Bilberry Lease in the commingling installation authorized by said order and to substitute therefor undesignated Abo production from your Howse "C" Well No. 1 located in Unit I of Section 11, Township 20 South, Range 38 East, Lea County, New Mexico. It is our understanding that the installation will continue to be operated in the manner described in our letter regarding this installation dated May 3, 1966.

We have been advised by Mr. Romulo Martinez of the State Land Office that said office has no objection to the proposed substitution in the commingling installation.

Administrative Order PLC-13 is hereby amended to delete the Bilberry production and to substitute therefor the Howse "C" production as described above, with the provision that the installation shall continue to be operated in accordance with the Commission "Manual for the Installation and Operation of Commingling Facilities," including the requirement for non-reset counters on the meters.

Very truly yours,

A. L. PORTER, Jr.  
Secretary-Director

ALP/DSN/esr

cc: Oil Conservation Commission (with enclosure) - Hobbs  
Oil & Gas Engineering Committee - Hobbs  
State Land Office - Santa Fe

# PAN AMERICAN PETROLEUM CORPORATION

Post Office Box 68  
Hobbs, New Mexico

March 26, 1968

File: VES-109-400 x 541.112

Subject: Commingling of Production from  
Howse "C" Lease with Various  
Other Leases Producing into  
Cone Central Storage System  
Various Pools, Lea County,  
New Mexico

---

New Mexico Oil Conservation Commission (3)  
P. O. Box 2088  
Santa Fe, New Mexico 87501

Attn: Mr. A. L. Porter  
Secretary Director

68 MAR 28 PM 1

Gentlemen:

Amendment, dated May 3, 1966, to Administrative Order PLC-13 provides for the commingling of production from the Howse "A" and "B", Bilberry, Cone "A" and "B", State "U" Leases into the Cone Central Storage System. Pools commingled are the House Drinkard and House San Andres Oil Pools.

Subsequent to the above date, the Bilberry Lease (Well No. 1) has been plugged and abandoned.

The Howse "C" Well No. 1, located 1980' FNL x 660' FEL Section 11, T-20-S, R-38-E, Lea County, New Mexico, Undesignated - Abo Oil Pool, has been completed as a marginal well and is currently producing at the rate of approximately 11.8 barrels per day.

This is a request that Administrative Order PLC-13 be revised, eliminating the Bilberry Lease and permit the inclusion and the commingling of the Howse "C" Lease production into the Cone Central Storage System.

A schematic drawing of the Central Storage System, located in Unit F, Section 12, T-20-S, R-37-E, and a plat depicting the leases and wells involved are attached.

Production from the Howse "C" Lease will be separately measured and sampled, and the installation shall be in accordance with the "Manual for the Installation and Operation of Commingling Facilities." Production from other leases shall be in accordance with previous authority.

Any reduction in the commercial value of the Howse "C" production will be negligible, averaging less than 1° in gravity correction, or possibly 3¢ per barrel. At the present time, the lease will produce approximately 25% of the commingled battery production.

All parties owning a working or royalty interest in the applicable leases and the purchaser of the commingled production has been notified of our intention by "Certified Mail".

Yours very truly,



V. E. Staley  
Area Superintendent

RRY/jt

Attachments

MAILING LIST

Laura E. West  
c/o Mrs. Jean J. McVeety  
1007 Soo Line Building  
Minneapolis, Minn. 55402

Florence M. Jorgenson  
c/o Wallace West  
5041 Penn Avenue South  
Minneapolis, Minnesota 55419

Amerada Petroleum Corporation  
51 West 51st Street  
New York 19, New York

Loren C. & Alice C. Babcock  
1041 12th Ave SE  
Minneapolis 14, Minnesota

Emil Berglund & Althea M. Berglund  
1006 Builders Exchange  
Minneapolis, Minnesota

John D. & Zita K Blecker  
800 Midland Bank Building  
Minneapolis, Minnesota

Frank L and Beiva K. Brundow  
1400 Park Avenue  
Minneapolis, Minnesota

Kossie Long Buckner, Jr  
3613 Overton Park East  
Fort Worth 9, Texas

Willard L. & Miffa I Craig  
5720 York Avenue South  
Minneapolis 10, Minnesota

H. B. & Alice Bond Dickinson  
512 E. Franklin Street  
Hillsboro, Texas

Robert B and Helen S. Henton  
P. O. Box 143  
Olivia, Minnesota

Sinclair Oil & Gas Company  
Attn: Treasurer  
P. O. Box 521  
Tulsa 2, Oklahoma

Roberta B Hostetler  
2634 Bryant Avenue So  
Minneapolis 8, Minnesota

Benjamin W. Howse  
P. O. Box 584  
Hobbs, New Mexico

Wesley E. Howse  
1405 West Fox Street  
Carlsbad, New Mexico

Robert A. Johnson  
2327 Arthur Street NE  
Minneapolis Minnesota

Leonard O. & Louise B. Langer  
1260 NW Bank Building  
Minneapolis 2, Minnesota

Hayner N & Hortense Larson  
1260 NW Bank Building  
Minneapolis 2, Minnesota

C. M. Linehan  
P. O. Box 969  
Midland, Texas

Clifford R. & Marie S. Lindh  
5224 York Avenue South  
Minneapolis 10, Minnesota

Sam Missel  
P. O. Box 1777  
Tulsa, Oklahoma

Wayne and Jo Ann Moore  
403 North Marienfeld  
Midland, Texas

Ione Buckner McAlister  
3613 Overton Park East  
Fort Worth 9, Texas

State of New Mexico  
Commissioner of Public Lands  
P. O. Box 1148  
Santa Fe, New Mexico 87501

New Mexico Oil Conservation Commission  
P. O. Box 1980  
Hobbs, New Mexico 88240

G. B. Neal  
c/o The First Natl Bank & Trust Co  
of Tulsa  
Trust Department 242813  
P. O. Box 1227  
Tulsa, Oklahoma

Eunice V. Nielsen  
4230 Minnehaha Avenue S  
Minneapolis 6, Minnesota

John E. & Adelaide W. Peters  
5352 Zenith Avenue So.  
Minneapolis 10, Minnesota

Platco Corporation  
Suite 1118 Tower Building  
1700 Broadway  
Denver, Colorado

Ralph E. & Mabel A. Preston  
4032 20th Ave. S  
Minneapolis 7, Minnesota

Harold C. & Elvina Preston  
3270 Sibley Hy  
St. Paul, Minnesota

Aurilla L. Smith  
R F D 2  
Stillwater, Minnesota

June D. Speight  
Drawer 1687  
Lovington, New Mexico

Muriel F. West  
5329 So. Dupont Avenue  
Minneapolis 19, Minnesota

Theodore H & Bertha A Witte  
1805 Wash So  
Minneapolis, Minnesota

Francis A. and Bernice M. Nicholas  
Route 2, Box 444  
Loomis, California

H. D. Schenck  
Box 1225  
Lovington, New Mexico

Lester Alston  
Box 1595  
Lovington, New Mexico

Amerada Petroleum Corporation  
51 West 51st Street  
New York 19, New York

Constance E. Byers  
Two Niles Road  
Austin, Texas

Ronald J. Byers  
Two Niles Road  
Austin, Texas

Robert E Byers  
212 Austin National Bk Bldg  
Austin, Texas

Cordon M. Cone  
Box 1148  
Lovington, New Mexico

Marjorie Cone Kastman, Guardian  
2806 34th Street  
Lubbock, Texas

J. R. Cone  
Box 871  
Lubbock, Texas

A. C. Holder  
Box 1476  
Lovington, New Mexico

Paul C. Laird  
227 Rusk Street  
Pittsburg, Texas

C. L. Norsworthy, Jr. &  
Nona B. Norsworth  
2737 Republic National Bank Building  
Dallas 1, Texas

Myrtle Pevehouse  
Route 5  
Lubbock, Texas

The Permian Corporation  
P. O. Box 3115  
Midland, Texas 79701



- Pan American Petroleum Corp.  
CONE CENTRAL STORAGE SYST.  
HOUSE DRINKARD, HOUSE SAN ANDRES.  
and HOUSE ABO POOLS  
Lea County, New Mexico  
3-18-68





THE PERMIAN CORPORATION  
MIDLAND, TEXAS

OWNER <u>PAN AMERICAN PET CORP</u>									
WELL NOS.									
LEASE <u>COME CONTRASTG</u>									
STATION NO.		MO.		DAY		YR.		RUN TKT. NO.	
<u>1144</u>		<u>3</u>		<u>9</u>		<u>68</u>		<u>1282859</u>	
LEASE NO.				TANK NO.				FIELD	
<u>562329</u>				<u>66401</u>					
TANK SIZE		OIL LEVEL				CALCULATIONS			
<u>1100</u>						<u>356</u>			
GAUGE		FT. IN. 1/4 IN.				<u>43</u>			
Gau. Ft. In. 1/4 In.						<u>313</u>			
HGT. OF CON.		1ST				<u>17 9 2 1/4</u>			
<u>1 -</u>		2ND				<u>2 1 1/4</u>			
B. S. & W. LEVEL		OBS. GRAVITY				TEMPERATURE			
1ST		<u>36-6</u>				<u>66</u>			
2ND		<u>41.0</u>							
OIL MOVED BY		POWER FURNISHED BY							
Pump Grav. Truck		P. L. Co. Other							
<input type="checkbox"/> <input type="checkbox"/> <input type="checkbox"/>		<u>HOBBS - P</u>				<input type="checkbox"/> <input type="checkbox"/> <input checked="" type="checkbox"/> <u>WOTC</u>			
REMARKS									

TIME		DATE		GAUGER	
<u>7 15 PM</u>		<u>3-9</u>		<u>Emmett Bille</u>	
OFF SEAL		OWNERS WITNESS			
TIME		DATE		GAUGER	
<u>6:30 AM</u>		<u>3-10</u>		<u>H. A. Lawson</u>	
ON SEAL		OWNERS WITNESS			



THE PERMIAN CORPORATION  
MIDLAND, TEXAS

OWNER <u>Pan American Pet. Corp</u>									
WELL NOS.									
LEASE <u>Houma C</u>									
STATION NO.		MO.		DAY		YR.		RUN TKT. NO.	
<u>125</u>		<u>3</u>		<u>12</u>		<u>68</u>		<u>1189617</u>	
LEASE NO.				TANK NO.				FIELD	
				<u>100</u>					
TANK SIZE		OIL LEVEL				CALCULATIONS			
<u>2.5</u>						<u>314</u>			
GAUGE		FT. IN. 1/4 IN.				<u>118</u>			
Gau. Ft. In. 1/4 In.						<u>314</u>			
HGT. OF CON.		1ST				<u>3 1/4</u>			
<u>1 -</u>		2ND				<u>2 1/4</u>			
B. S. & W. LEVEL		OBS. GRAVITY				TEMPERATURE			
1ST		<u>36.4</u>				<u>46</u>			
2ND		<u>36.5</u>							
OIL MOVED BY		POWER FURNISHED BY							
Pump Grav. Truck		P. L. Co. Other							
<input type="checkbox"/> <input type="checkbox"/> <input checked="" type="checkbox"/>		<u>Dock Inter</u>				<input type="checkbox"/> <input type="checkbox"/> <input checked="" type="checkbox"/> <u>WOTC</u>			
REMARKS									

TIME		DATE		GAUGER	
<u>7 30 AM</u>		<u>3-12</u>		<u>Travis Reed</u>	
OFF SEAL		OWNERS WITNESS			
TIME		DATE		GAUGER	
<u>9 AM</u>		<u>3-12</u>		<u>Travis Reed</u>	
ON SEAL		OWNERS WITNESS			

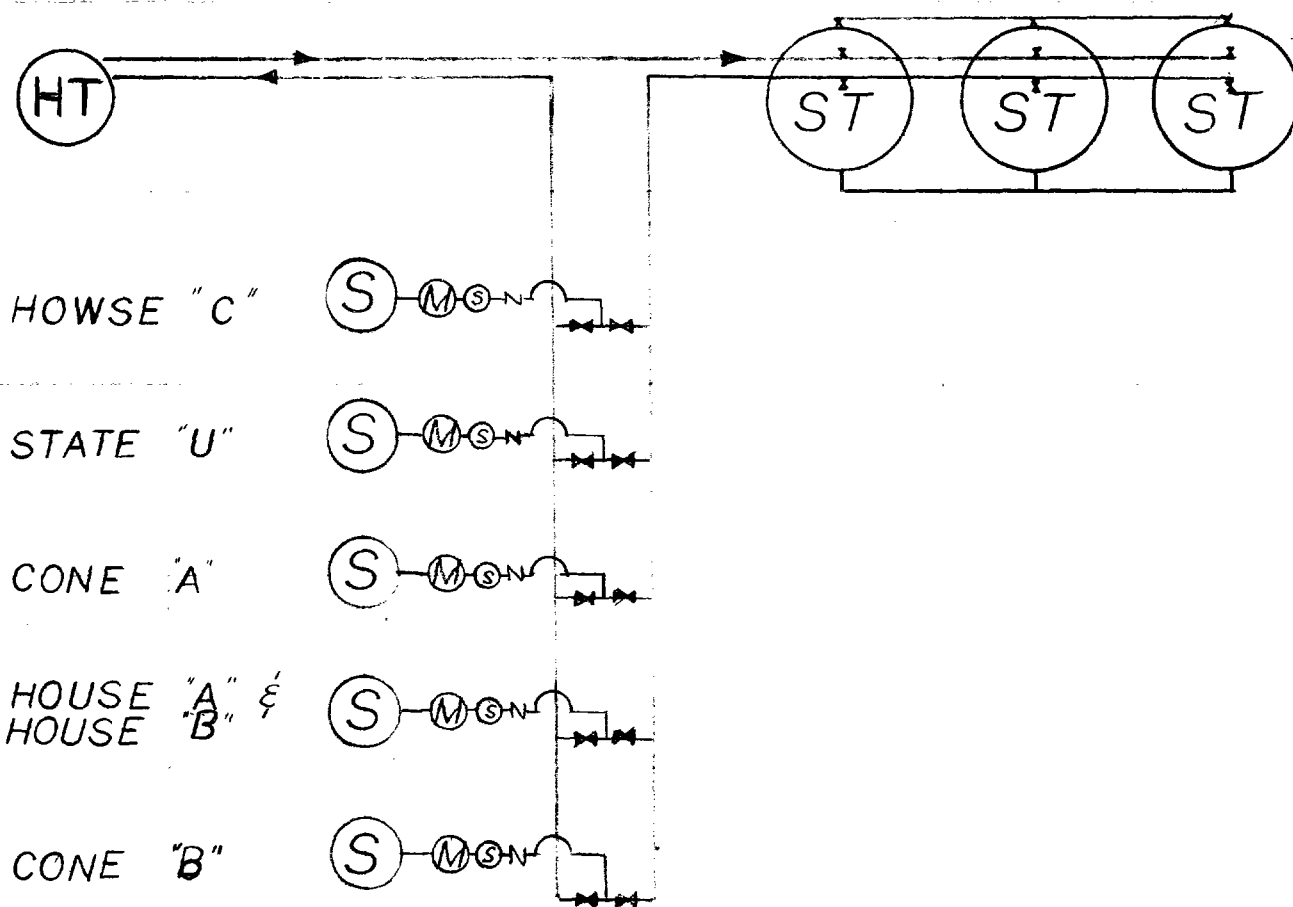

### SCHEMATIC of

PAN AMERICAN PETROLEUM CORPORATION  
 CONE CENTRAL STORAGE SYSTEM  
 (Unit F, Section 12, T-20-S, R-37-E)  
 HOUSE DRINKARD, HOUSE SAN ANDRES  
 UNDESIGNATED ABO, Oil Pools  
 LEA COUNTY, NEW MEXICO

State of New Mexico

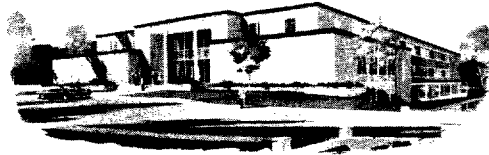

Commissioner of Public Lands

GUYTON B. HAYS  
COMMISSIONER



P. O. BOX 1148  
SANTA FE, NEW MEXICO

April 11, 1968

Pan American Petroleum Corporation  
Post Office Box 68  
Hobbs, New Mexico  
88240

Re: Your file VES-112-400  
Subj: Commingling of Production from  
Howse "C" Lease into the Cone  
Central Storage System  
LOCO #13 (State Lease B-9652)

Attn: V. E. Staley, Area Superintendent

Gentlemen:

Your letter of March 27, 1968, requests that the New Mexico Oil Conservation Commission's Administrative Order PLC-13 be amended to eliminate the Bilberry Lease and permit the commingling of the Howse "C" Lease production into the Cone Central Storage System.

In accordance with Rule No. 52 of the enclosed handbook of Rules and Regulations, we cannot approve commingling of wells on Federal Leases with wells on State Leases.

Your commingling fee of \$10.00, receipt for which is herewith attached, has been applied to the research that resulted in the above decision.

Very truly yours,

GUYTON B. HAYS  
Commissioner of Public Lands

TB:RGM:jc  
Enc-handbook - receipt

cc: New Mex Oil Conservation Comm  
P. O. Box 2088, Santa Fe

New Mexico Oil & Gas Accounting Comm  
P. O. Box 2308, Santa Fe

By: *Handwritten signature*  
TED BILBERRY, Director  
Oil and Gas Department

*Handwritten notes:*  
Howse "C" Lease  
Bilberry Lease  
is OK w/ Rank Office

*Handwritten notes:*  
no Federal  
Leases

*Handwritten notes:*  
APR 12 1968