



NEW MEXICO ENERGY, MINERALS and NATURAL RESOURCES DEPARTMENT

GARY E. JOHNSON

Governor
Jennifer A. Salisbury
Cabinet Secretary

October 25, 2000

Lori Wrotenbery
Director
Oil Conservation Division

Chevron U.S.A. Inc.
P. O. Box 1150
Midland, Texas 79702-1150
Attention: A. M. Howell

Administrative Order NSL-4519

Dear Mr. Howell:

Reference is made to your application dated September 26, 2000 for a non-standard gas well location in the Tubb Oil and Gas Pool for Chevron U.S.A. Inc.'s ("Chevron") existing T. R. Andrews Well No. 5 (API No. 30-025-12186), which was originally drilled by Gulf Oil Corporation ("Gulf") in 1961 to a total depth of 7,150 feet and completed as a dual oil producer in the Blinebry Oil and Gas and Drinkard Pools at a standard oil well location 560 feet from the North line and 660 feet from the East line (Unit A) of Section 32, Township 22 South, Range 38 East, NMPM, Lea County, New Mexico.

It is our understanding that this well's current completion in the South Paddock Pool is to be abandoned and that Chevron will recomplete this well up-hole into the Tubb Oil and Gas Pool upon issuance of this order.

Further, the NE/4 of Section 32 is to be dedicated to this well in order to form a standard 160-acre gas spacing and proration unit; however, pursuant to Rule 2 (b) 1 of the "*Special Rules and Regulations for the Tubb Oil and Gas Pool*," as promulgated by Division Order No. R-8170, as amended, this location is considered to be unorthodox.

This application has been duly filed under the provisions of: (i) Division Rule 104.F, revised by Division Order No. R-11231, issued by the New Mexico Oil Conservation Commission in Case No. 12119 on August 12, 1999; (ii) Division Rule 605; and (iii) the special rules governing the Tubb Oil and Gas Pool.

By the authority granted me under the provisions of Division Rule 104.F (2), as revised, Division Rule 605.B (2) (b), and the applicable provisions of the special pool rules governing the Tubb Oil and Gas Pool, the above-described unorthodox gas well location is hereby approved.

Sincerely,

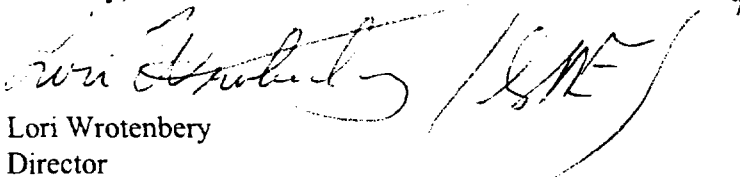

Lori Wrotenbery
Director

LW/MES/kv

cc: New Mexico Oil Conservation Division - Hobbs
New Mexico State Land Office - Santa Fe

DATE IN 9/28/00	SUSPENSE 10/18/00	ENGINEER MS	LOGGED KW	TYPE NSL
--------------------	----------------------	----------------	--------------	-------------

ABOVE THIS LINE FOR DIVISION USE ONLY

29337136

NEW MEXICO OIL CONSERVATION DIVISION
- Engineering Bureau -

ADMINISTRATIVE APPLICATION COVERSHEET

THIS COVERSHEET IS MANDATORY FOR ALL ADMINISTRATIVE APPLICATIONS FOR EXCEPTIONS TO DIVISION RULES AND REGULATIONS

Application Acronyms:

[NSP-Non-Standard Proration Unit] [NSL-Non-Standard Location]
[DD-Directional Drilling] [SD-Simultaneous Dedication]
[DHC-Downhole Commingling] [CTB-Lease Commingling] [PLC-Pool/Lease Commingling]
[PC-Pool Commingling] [OLS - Off-Lease Storage] [OLM-Off-Lease Measurement]
[WFX-Waterflood Expansion] [PMX-Pressure Maintenance Expansion]
[SWD-Salt Water Disposal] [IPI-Injection Pressure Increase]
[EOR-Qualified Enhanced Oil Recovery Certification] [PPR-Positive Production Response]

00 SEP 28 AM 3:35
OIL CONSERVATION DIV

[1] TYPE OF APPLICATION - Check Those Which Apply for [A]

[A] Location - Spacing Unit - Directional Drilling
☒ NSL NSP DD SD

Check One Only for [B] and [C]

[B] Commingling - Storage - Measurement
DHC CTB PLC PC OLS OLM

[C] Injection - Disposal - Pressure Increase - Enhanced Oil Recovery
WFX PMX SWD IPI EOR PPR

[2] NOTIFICATION REQUIRED TO: - Check Those Which Apply, or Does Not Apply

[A] Working, Royalty or Overriding Royalty Interest Owners

[B] ☒ Offset Operators, Leaseholders or Surface Owner

[C] Application is One Which Requires Published Legal Notice

[D] Notification and/or Concurrent Approval by BLM or SLO
U.S. Bureau of Land Management - Commissioner of Public Lands, State Land Office

[E] For all of the above, Proof of Notification or Publication is Attached, and/or,

[F] Waivers are Attached

[3] INFORMATION / DATA SUBMITTED IS COMPLETE - Statement of Understanding

I hereby certify that I, or personnel under my supervision, have read and complied with all applicable Rules and Regulations of the Oil Conservation Division. Further, I assert that the attached application for administrative approval is accurate and complete to the best of my knowledge and where applicable, verify that all interest (WI, RI, ORRI) is common. I understand that any omission of data, information or notification is cause to have the application package returned with no action taken.

Note: Statement must be completed by an individual with supervisory capacity.

A. M. Howell		Sr. Petro. Engineer	9/25/2000
Print or Type Name	Signature	Title	Date

September 26, 2000



Request for Administrative Approval
Unorthodox Well Location
T. R. Andrews # 5
560' FNL & 660' FEL
Unit A, Section 32, T22S, R38E
Lea County, New Mexico

Chevron U.S.A. Production Company
P.O. Box 1150
Midland, TX 79702

New Mexico Oil Conservation Division
Attn: Michael Stogner
2040 South Pacheco
Santa Fe, NM 87505

Dear Mr. Stogner:

Attached is a copy of an administrative application for NMOCD approval for an unorthodox gas well location.

With your approval it is our intention to recompleate the T. R. Andrews # 5 as a gas well in the Tubb formation. The subject well was originally drilled and completed in 1961 as a dual oil producer from the Blinebry and Drinkard Pools, respectively. It is currently shut-in following an unsuccessful recompletion attempt as a single oil producer in the Paddock formation. In order to return T. R. Andrews # 5 to economic production it is proposed to recompleate to the Tubb formation. However, the proposed recompletion will create an unorthodox gas well location. Therefore, NMOCD administrative approval is requested to recompleate and produce T. R. Andrews # 5 as a gas well in the Tubb Oil & Gas Pool.

A copy of this application was mailed via certified mail to all affected offset operators.

If you have any questions concerning this application, please contact Mike Howell at (915) 687-7516.

Sincerely,

A handwritten signature in cursive script that reads "A. M. Howell".

A. M. Howell
Sr. Petroleum Engineer

cc: NMOCD – Hobbs District I
Well File
Janice Ripley
Denise Beckham
Nathan Mouser

District I

1625 N. French Dr., Hobbs, NM 88240

District II

811 South First, Artesia, NM 88210

District III

1000 Rio Brazos Rd., Aztec, NM 87410

District IV

2040 South Pacheco, Santa Fe, NM 87505

State of New Mexico
Energy, Minerals & Natural Resources DepartmentOIL CONSERVATION DIVISION
2040 South Pacheco
Santa Fe, NM 87505Form C-102
Revised March 17, 1999Submit to Appropriate District Office
State Lease - 4 Copies
Fee Lease - 3 Copies☐ AMENDED REPORT

WELL LOCATION AND ACREAGE DEDICATION PLAT

¹ API Number 30-025-12186	² Pool Code 86440	³ Pool Name Tubb Oil & Gas
⁴ Property Code 2566	⁵ Property Name T. R. Andrews	⁶ Well Number 5
⁷ OGRID No. 4323	⁸ Operator Name Chevron U.S.A., Inc.	⁹ Elevation 3374'

¹⁰ Surface Location

UL or lot no.	Section	Township	Range	Lot Idn	Feet from the	North/South line	Feet from the	East/West line	County
A	32	22S	38E		560	North	660	East	Lea

¹¹ Bottom Hole Location If Different From Surface

UL or lot no.	Section	Township	Range	Lot Idn	Feet from the	North/South line	Feet from the	East/West line	County

¹² Dedicated Acres 160	¹³ Joint or Infill	¹⁴ Consolidation Code	¹⁵ Order No.
--------------------------------------	-------------------------------	----------------------------------	-------------------------

NO ALLOWABLE WILL BE ASSIGNED TO THIS COMPLETION UNTIL ALL INTERESTS HAVE BEEN CONSOLIDATED OR A
NON-STANDARD UNIT HAS BEEN APPROVED BY THE DIVISION

16	160-acre proration unit -->		¹⁷ OPERATOR CERTIFICATION I hereby certify that the information contained herein is true and complete to the best of my knowledge and belief
			Signature <u>A. M. Howell</u> Printed Name <u>Sr. Petroleum Engineer</u> Title <u>September 25, 2000</u>
			¹⁸ SURVEYOR CERTIFICATION I hereby certify that the well location shown on this plat was plotted from field notes of actual surveys made by me or under my supervision, and that the same is true and correct to the best of my belief.
			Signature and Seal of Professional Surveyer: Certificate Number

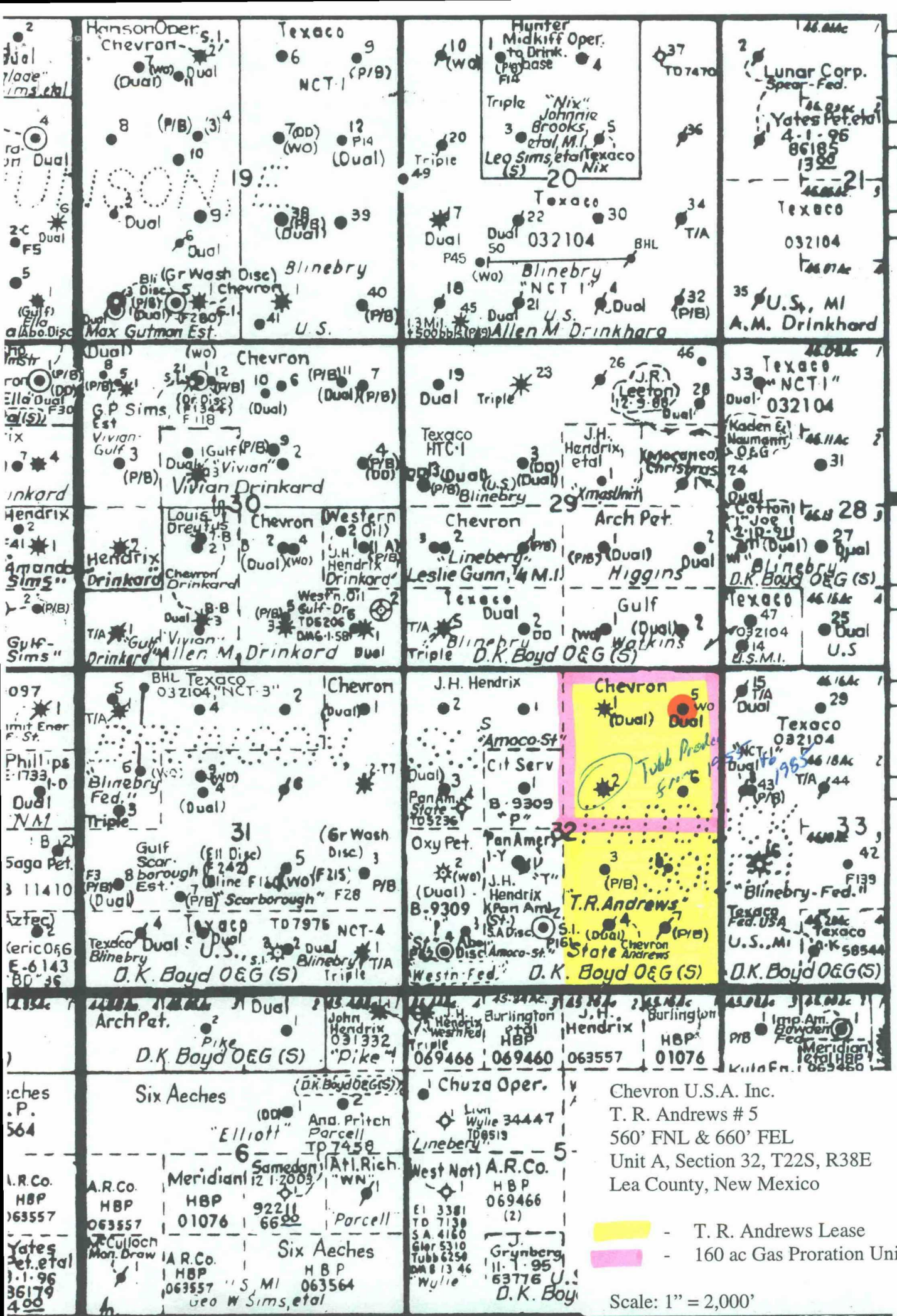

Chevron U.S.A. Inc.
T. R. Andrews # 5
560' FNL & 660' FEL
Unit A, Section 32, T22S, R38E
Lea County, New Mexico

- T. R. Andrews Lease
- 160 ac Gas Proration Unit

Scale: 1" = 2,000'

T. R. Andrews # 5
Chevron U.S.A. Inc.
Unorthodox Gas Well Location
Request For Administrative Approval

List Of Offset Operators:

1. John H. Hendrix Corporation
P. O. Box 3040
Midland, Texas 79702
2. OXY USA, Inc.
P. O. Box 50250
Midland, Texas 79710
3. Texaco Exploration & Production, Inc.
205 E. Bender Blvd.
Hobbs, New Mexico 88240

CMD :
OG5SECTONGARD
INQUIRE LAND BY SECTION10/25/00 16:31:20
OGOMES -TQIS
PAGE NO: 1

Sec : 32 Twp : 22S Rng : 38E Section Type : NORMAL

D 40.00 CS B09612 0001 APACHE CORPORATIO C 04/10/52 A	C 40.00 CS B09612 0001 APACHE CORPORATIO C 04/10/52 A	B 40.00 CS B04467 0001 CHEVRON U S A INC 06/10/45 P	A 40.00 CS B04467 0001 CHEVRON U S A INC 06/10/45 A
E 40.00 CS B09612 0001 APACHE CORPORATIO C 04/10/52 A	F 40.00 CS B09309 0002 OXY USA INC C 09/10/51 A	G 40.00 CS B04467 0001 CHEVRON U S A INC 06/10/45 P	H 40.00 CS B04467 0001 CHEVRON U S A INC 06/10/45 A

PF01 HELP
PF07 BKWDPF02
PF08 FWDPF03 EXIT
PF09 PRINTPF04 GoTo
PF10 SDIVPF05
PF11PF06
PF12

CMD :
OG5SECTONGARD
INQUIRE LAND BY SECTION10/25/00 16:31:25
OGOMES -TQIS
PAGE NO: 2

Sec : 32 Twp : 22S Rng : 38E Section Type : NORMAL

L 40.00 CS B09309 0002 OXY USA INC C 09/10/51 A	K 40.00 CS B09612 0001 APACHE CORPORATIO C 04/10/52 A	J 40.00 CS B04467 0001 CHEVRON U S A INC 06/10/45 A	I 40.00 CS B04467 0001 CHEVRON U S A INC 06/10/45 A
M 40.00 CS B09309 0002 OXY USA INC C 09/10/51 A A	N 40.00 CS B09612 0001 APACHE CORPORATIO C 04/10/52 A	O 40.00 CS B04467 0001 CHEVRON U S A INC 06/10/45 A	P 40.00 CS B04467 0001 CHEVRON U S A INC 06/10/45

PF01 HELP
PF07 BKWDPF02
PF08 FWDPF03 EXIT
PF09 PRINTPF04 GoTo
PF10 SDIVPF05
PF11PF06
PF12

CMD : ONGARD 10/25/00 16:31:48
OG6IWCM INQUIRE WELL COMPLETIONS OGOMES -TQIS

API Well No : 30 25 12186 Eff Date : 09-15-1999 WC Status : P
Pool Idn : 6660 BLINEBRY OIL AND GAS (OIL)
OGRID Idn : 4323 CHEVRON U S A INC
Prop Idn : 2566 T R ANDREWS

Well No : 005
GL Elevation: 3374

	U/L	Sec	Township	Range	North/South	East/West	Prop/Act (P/A)
	---	---	-----	-----	-----	-----	-----
B.H. Locn : A	32	22S	38E	FTG	560 F N	FTG 660 F E	P

Lot Identifier:
Dedicated Acre:
Lease Type : S
Type of consolidation (Comm, Unit, Forced Pooling - C/U/F/O) :

M0025: Enter PF keys to scroll

PF01 HELP	PF02	PF03 EXIT	PF04 GoTo	PF05	PF06
PF07	PF08	PF09	PF10 NEXT-WC	PF11 HISTORY	PF12 NXTREC

CMD : ONGARD 10/25/00 16:31:51
OG6IWCM INQUIRE WELL COMPLETIONS OGOMES -TQIS

API Well No : 30 25 12186 Eff Date : 09-15-1999 WC Status : P
Pool Idn : 7900 BRUNSON;DRINKARD-ABO, SOUTH
OGRID Idn : 4323 CHEVRON U S A INC
Prop Idn : 2566 T R ANDREWS

Well No : 005
GL Elevation: 3374

	U/L	Sec	Township	Range	North/South	East/West	Prop/Act (P/A)
	---	---	-----	-----	-----	-----	-----
B.H. Locn : A	32	22S	38E	FTG	560 F N	FTG 660 F E	P
Lot Identifier:							
Dedicated Acre:							
Lease Type : S							
Type of consolidation (Comm, Unit, Forced Pooling - C/U/F/O) :							

PF01 HELP	PF02	PF03 EXIT	PF04 GoTo	PF05	PF06
PF07	PF08	PF09	PF10 NEXT-WC	PF11 HISTORY	PF12 NXTREC

COUNTY LeaPOOL Tubb

OIL AND GAS

TOWNSHIP 22 SouthRANGE 38 East

NMPM

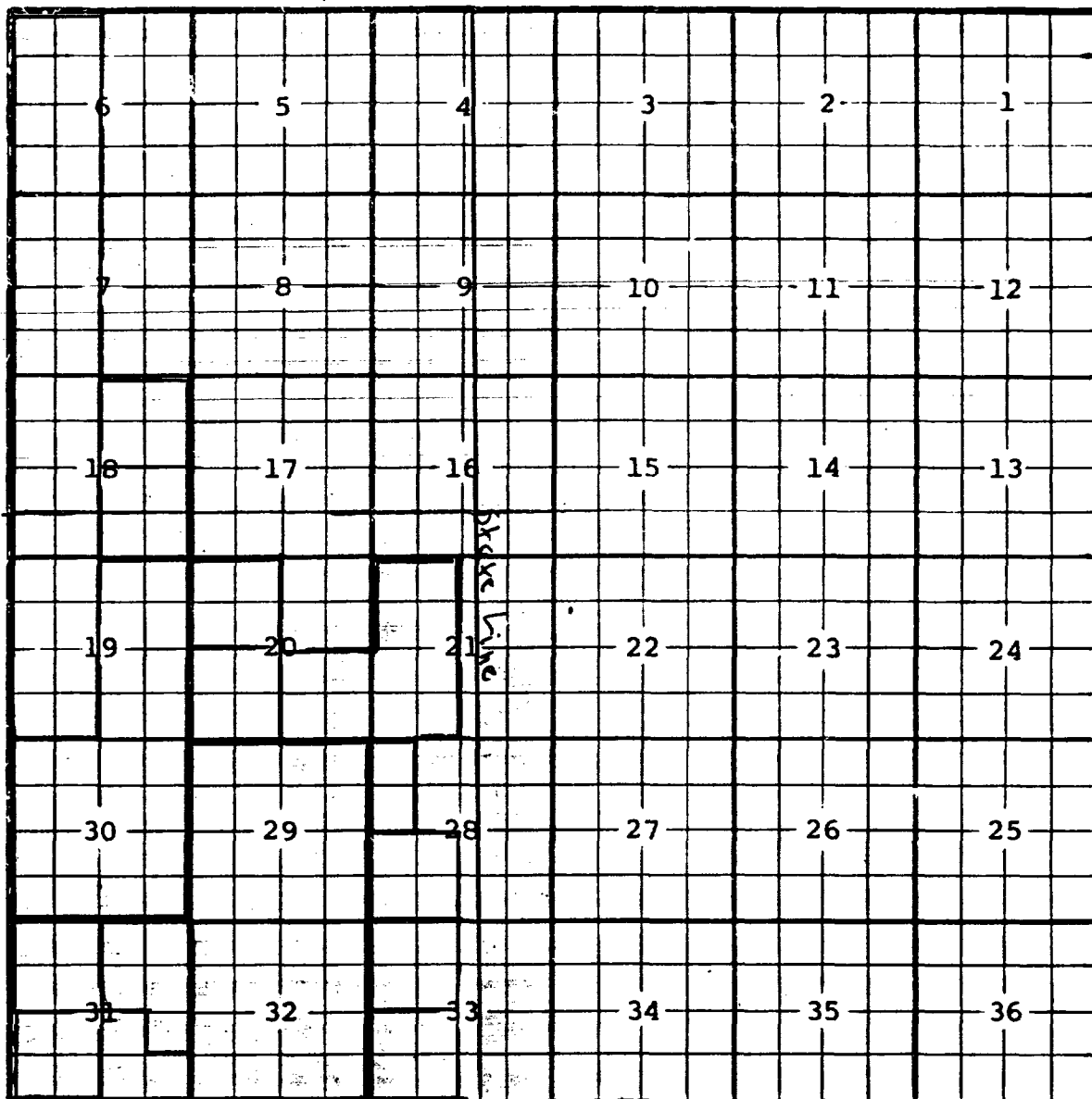

Description: $\frac{W}{2}$ Sec. 6; $\frac{W}{2}$ Sec. 7; $\frac{W}{2}$ Sec. 18; $\frac{W}{2}$ Sec. 19 (R-264, 2-17-58)

Ext: $\frac{E}{2}$ Sec. 19; All Sec. 30 (R-407, 2-10-54) - All Secs. 29 & 32 (R-675, 8-17-55)

- $\frac{NE}{4}$ & $\frac{NE}{4}$ $\frac{SE}{4}$ Sec. 31 (R-1283, 12-1-58) - $\frac{NW}{4}$ Sec. 31 (R-1355, 4-1-59)

- $\frac{SW}{4}$ Sec. 28 (R-1452, 5-1-60) - $\frac{NE}{4}$ Sec. 18 (R-1777, 11-1-60) - $\frac{SE}{4}$ Sec. 18 (R-1824, 12-1-60)

- $\frac{W}{2}$ $\frac{SE}{4}$ & $\frac{SE}{4}$ $\frac{SE}{4}$ Sec. 31; $\frac{NW}{4}$ Sec. 33 (R-2101, 11-1-61) - $\frac{NW}{4}$ Sec. 20; $\frac{SW}{4}$ Sec. 33 (R-2879, 4-1-65)

- $\frac{SW}{4}$ Sec. 20; $\frac{W}{2}$ $\frac{NW}{4}$ Sec. 28 (R-2938, 8-1-65) Extend vertical limits to include entire interval from 100' above Tubb marker to top of Drinkard. (R-4635, 10-1-73) Ext: $\frac{SW}{4}$ Sec. 31 (R-5838, 11-1-78)

CHANGE FROM TUBB GAS TO TUBB OIL AND GAS (R-6012 9-1-79)

Ext: $\frac{SE}{4}$ Sec. 20, $\frac{W}{2}$ Sec. 21 (R-7667, 7-21-84)