

DATE IN	SUSPENSE	ENGINEER	LOGGED IN	TYPE	APP NO. 10222 6668
---------	----------	----------	-----------	------	--------------------

ABOVE THIS LINE FOR DIVISION USE ONLY

NEW MEXICO OIL CONSERVATION DIVISION
 - Engineering Bureau -
 1220 South St. Francis Drive, Santa Fe, NM 87505



ADMINISTRATIVE APPLICATION COVERSHEET

THIS COVERSHEET IS MANDATORY FOR ALL ADMINISTRATIVE APPLICATIONS FOR EXCEPTIONS TO DIVISION RULES AND REGULATIONS WHICH REQUIRE PROCESSING AT THE DIVISION LEVEL IN SANTA FE

Application Acronyms:

[NSL-Non-Standard Location] [NSP-Non-Standard Proration Unit] [SD-Simultaneous Dedication]
[DHC-Downhole Commingling] [CTB-Lease Commingling] [PLC-Pool/Lease Commingling]
[PC-Pool Commingling] [OLS - Off-Lease Storage] [OLM-Off-Lease Measurement]
[WFX-Waterflood Expansion] [PMX-Pressure Maintenance Expansion]
[SWD-Salt Water Disposal] [IPI-Injection Pressure Increase]
[EOR-Qualified Enhanced Oil Recovery Certification] [PPR-Positive Production Response]

[1] TYPE OF APPLICATION - Check Those Which Apply for [A]

[A] Location - Spacing Unit - Simultaneous Dedication
☒ NSL ☐ NSP ☐ SD

Check One Only for [B] or [C]

[B] Commingling - Storage - Measurement
☐ DHC ☐ CTB ☐ PLC ☐ PC ☐ OLS ☐ OLM

[C] Injection - Disposal - Pressure Increase - Enhanced Oil Recovery
☐ WFX ☐ PMX ☐ SWD ☐ IPI ☐ EOR ☐ PPR

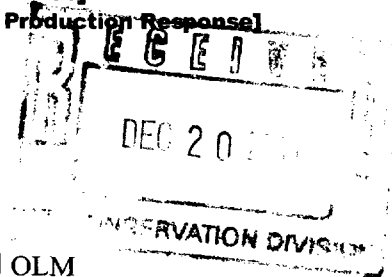

[2] NOTIFICATION REQUIRED TO: - Check Those Which Apply, or Does Not Apply

[A] ☐ Working, Royalty or Overriding Royalty Interest Owners

[B] ☒ Offset Operators, Leaseholders or Surface Owner - WAIVER ATTACHED

[C] ☐ Application is One Which Requires Published Legal Notice

[D] ☐ Notification and/or Concurrent Approval by BLM or SLO
U.S. Bureau of Land Management - Commissioner of Public Lands, State Land Office

[E] ☐ For all of the above, Proof of Notification or Publication is Attached, and/or,

[F] ☐ Waivers are Attached

[3] INFORMATION / DATA SUBMITTED IS COMPLETE - Certification

I hereby certify that I, or personnel under my supervision, have reviewed the applicable Rules and Regulations of the Oil Conservation Division. Further, I assert that the attached application for administrative approval is accurate and complete to the best of my knowledge and where applicable, verify that all interest (WI, RI, ORRI) is common.

I understand that any omission of data (including API numbers, pool codes, etc.), pertinent information and any required notification is cause to have the application package returned with no action taken.

Note: Statement must be completed by an individual with managerial and/or supervisory capacity.

Peggy Cole

Print or Type Name

Signature

Regulatory Supervisor

Title

Date

pbradfield@br-inc.com
 e-mail Address

BURLINGTON RESOURCES

SAN JUAN DIVISION

Sent Federal Express

Mr. Michael Stogner
New Mexico Oil Conservation Division
2040 South Pacheco
Santa Fe, New Mexico 87505

Re: Grenier B #5E
1910'FSL, 1180'FEL Section 6, T-29-N, R-10-W, San Juan County
30-045-30086

Dear Mr. Stogner:

Burlington Resources is applying for administrative approval of an unorthodox gas well location for the Basin Dakota, Blanco Mesaverde and Otero Chacra. This well was originally permitted and approved for all three pools.

Burlington Resources drilled and completed the well as a Mesaverde-Dakota dual during the summer of 2000. We now intend to recompleate the well in 2001, open the Chacra formation and commingle with the Mesaverde and Dakota. Application has been made for the proposed commingling.

In talking with Frank Chavez and Steve Hayden of the Aztec District Office to prepare this application for the Chacra, it was noted that both the Mesaverde and Dakota are also outside the standard windows because of the short half section line which was not originally recognized by either Burlington Resources or the Aztec District Office when we drilled the Mesaverde and Dakota. Therefore, this application is for all three pools.

Production from the Chacra pool is to be included in a 148.90 acre gas spacing and proration unit for the southeast (SE/4) quarter of Section 6.

Production from the Mesaverde pool is to be included in a 312.60 acre gas spacing and proration unit for the south half (S/2) in Section 6

Production from the Dakota pool is to be included in a 312.60 acre gas spacing and proration unit for the south half (S/2) in Section 6 and is to be dedicated to the Grenier B #5 (30-045-20055) located at 1710'FSL, 1040'FWL in Section 6.

Grenier B #5E
Page Two

The following attachments are for your review:

- Completion Report for Mesaverde and Dakota
- Completed C-102 at referenced location.
- Offset operators/owners plats – for Chacra, Mesaverde and Dakota

Three copies of this application are being submitted to offset operators/owners by certified mail with a request that they furnish you with a Waiver of Objection, keep one copy for their files and return one copy to this office. Please let me know if you have any questions about this application.

Sincerely,

BURLINGTON RESOURCES



Peggy Cole
Regulatory Supervisor

WAIVER

Conoco Inc. hereby waives objection to Burlington Resources' application for a non-standard location for the Grenier B #5E as proposed above.

By: _____ Date: _____

xc: NMOCD - Aztec District Office
Bureau of Land Management

DISTRICT III
P.O. Drawer 88, Artesia, N.M. 88211-0719DISTRICT III
1000 Rto. Espana Rd., Aztec, N.M. 87410DISTRICT III
PO Box 2088, Santa Fe, NM 87504-2088

OIL CONSERVATION DIVISION

P.O. Box 2088
Santa Fe, NM 87504-2088

APR 17 PM 1:08

☐ AMENDED REPORT

WELL LOCATION AND ACREAGE DEDICATION PLAT

¹ API Number 30-045-	² Pool Code 71599 82329/72319/	³ Pool Name Basin Dakota Otero Chacra/Blanco Mesaverde/
⁴ Property Code 18532	⁵ Property Name GRENIER B	⁶ Well Number 5E
⁷ GRID No. 14538	⁸ Operator Name BURLINGTON RESOURCES OIL & GAS COMPANY	⁹ Elevation 5835'

¹⁰ Surface Location

UL or lot no.	Section	Township	Range	Lot Idn	Feet from the	North/South line	Feet from the	East/West line	County
1	6	29-N	10-W		1910	SOUTH	1180	EAST	SAN JUAN

¹¹ Bottom Hole Location If Different From Surface

UL or lot no.	Section	Township	Range	Lot Idn	Feet from the	North/South line	Feet from the	East/West line	County

¹² Dedicated Acres Cha-148.90	¹³ Joint or Int'l MV-S	¹⁴ Consolidation Code 281.04	¹⁵ Order No. DK-S/312.60
---	--------------------------------------	--	--

NO ALLOWABLE WILL BE ASSIGNED TO THIS COMPLETION UNTIL ALL INTERESTS HAVE BEEN CONSOLIDATED
OR A NON-STANDARD UNIT HAS BEEN APPROVED BY THE DIVISION

<div>16</div> <div></div>	<div>17 OPERATOR CERTIFICATION</div> <div>I hereby certify that the information contained herein is true and complete to the best of my knowledge and belief</div> <div></div> <div>Signature Peggy Cole Printed Name Regulatory Administrator Title 12-1-99 Date</div> <div>FD. 1967 BLM BC.</div>
<div>18</div> <div></div>	<div>18 SURVEYOR CERTIFICATION</div> <div>I hereby certify that the well location shown on this plat was plotted from field notes of actual surveys made by me or under my supervision, and that the same is true and correct to the best of my belief.</div> <div></div> <div>Date of Survey 8-2-98 Signature and Seal of Professional Surveyor 8894 Certificate Number</div> <div>FD. 1967 BLM BC.</div>

UNITED STATES
DEPARTMENT OF THE INTERIOR
BUREAU OF LAND MANAGEMENT

SUBMIT IN DUPLICATE

(See other In-
structions on
reverse side)

FOR APPROVED

OMB NO. 1004-0137

Expires: December 31, 1991

5. LEASE DESIGNATION AND SERIAL NO.

NM-03561

6. IF INDIAN, ALLOTTEE OR TRIBE NAME

7. UNIT AGREEMENT NAME

8. FARM OR LEASE NAME, WELL NO.

Grenier B #5E

9. API WELL NO.

30-045-30086

10. FIELD AND POOL, OR WILDCAT

Blanco Mesaverde/Basin Dakota

11. SEC., T., R., M., OR BLOCK AND SURVEY
OR AREA

Sec.6, T-29-N, R-10-W

WELL COMPLETION OR RECOMPLETION REPORT AND LOG*

1a. TYPE OF WELL:

OIL
WELL ☐

GAS
WELL ☒

DRY ☐

Other ☐

b. TYPE OF COMPLETION:

NEW
WELL ☒

WORK
OVER ☐

DEEP-
EN ☐

PLUG
BACK ☐

DIFF.
RESVR ☐

Other ☐

2. NAME OF OPERATOR

BURLINGTON RESOURCES OIL & GAS COMPANY

3. ADDRESS AND TELEPHONE NO.

PO BOX 4289, Farmington, NM 87499 (505) 326-9700

4. LOCATION OF WELL (Report location clearly and in accordance with any State requirements)*

At surface 1910°FSL, 1180°FEL

At top prod. interval reported below

At total depth

14. PERMIT NO.

DATE ISSUED

12. COUNTY OR
PARISH

San Juan

13. STATE

New Mexico

15. DATE SPUDDED

5-22-00

16. DATE T.D. REACHED

6-5-00

17. DATE COMPL. (Ready to prod.)

8-25-00

18. ELEVATIONS (DF, RKB, RT, BR, ETC.)*

5835'GL/5847'KB

19. ELEV. CASINGHEAD

20. TOTAL DEPTH, MD & TVD

7130'

21. PLUG, BACK T.D., MD & TVD

7044'

22. IF MULTIPLE COMPL.,
HOW MANY*

23. INTERVALS
DRILLED BY

ROTARY TOOLS

CABLE TOOLS

0-7130'

24. PRODUCTION INTERVAL (S) OF THIS COMPLETION-TOP, BOTTOM, NAME (MD AND TVD)*

6586-6738' Dakota dualled w/Mesaverde

25. WAS DIRECTIONAL
SURVEY MADE

No

26. TYPE ELECTRIC AND OTHER LOGS RUN

PEX/CMR/BCS/GR Spectroscopy/Fullbore Microimager/CBL/GR/CCL

27. WAS WELL CORED

Yes

28. CASING RECORD (Report all strings set in well)

CASING SIZE/GRADE	WEIGHT, LB./FT.	DEPTH SET (MD)	HOLE SIZE	TOP OF CEMENT, CEMENTING RECORD	AMOUNT PULLED
8 5/8"	24#	349'	12 1/4"	425 cu ft	
5 1/2"	17#	7119'	7 7/8"	2634 cu ft	

29. LINER RECORD

SIZE	TOP (MD)	BOTTOM (MD)	SACKS CEMENT*	SCREEN (MD)	SIZE	DEPTH SET (MD)	PACKER SET (MD)
					1 1/2"	6723'	4858'

30. TUBING RECORD

31. PERFORATION RECORD (Interval, size and number)

6586, 6588, 6590, 6620, 6622, 6624, 6644, 6648, 6652,
6656, 6660, 6664, 6708, 6710, 6712, 6714, 6732, 6734,
6736, 6738

32. ACID, SHOT, FRACTURE, CEMENT SQUEEZE, ETC.

DEPTH INTERVAL (MD) AMOUNT AND KIND OF MATERIAL USED
6586-6738' 658 bbl 30# lnr gel, 100,000# 20/40 TLC sand.

33. PRODUCTION

DATE FIRST PRODUCTION		PRODUCTION METHOD (Flowing, gas lift, pumping—size and type of pump)				WELL STATUS (Producing or shut-in)	
		Flowing				SI	
DATE OF TEST	HOURS TESTED	CHOKE SIZE	PROD'N FOR TEST PERIOD	OIL—BBL	GAS—MCF	WATER—BBL	GAS-OIL RATIO
8-25-00			→				
FLOW, TUBING PRESS.	CASING PRESSURE	CALCULATED 24-HOUR RATE	OIL—BBL	GAS—MCF	WATER—BBL	OIL GRAVITY-API (CORR.)	
SI 1419		→		2326 Pitot gauge			

34. DISPOSITION OF GAS (sold, used for fuel, vented, etc.)

To be sold

TEST WITNESSED BY

35. LIST OF ATTACHMENTS

None

ACCEPTED FOR RECORD

36. I hereby certify that the foregoing and attached information is complete and correct as determined from all available records

SEP 19 2000

SIGNED

[Signature]

TITLE

Regulatory Supervisor

DATE

8-30-00

FARMINGTON FIELD OFFICE
BY *[Signature]*

*(See Instructions and Spaces for Additional Data on Reverse Side)

Title 18 U.S.C. Section 1001, makes it a crime for any person knowingly and willfully to make to any department or agency of the United States any false, fictitious or fraudulent statements or representations as to any matter within its jurisdiction.

UNITED STATES
DEPARTMENT OF THE INTERIOR
BUREAU OF LAND MANAGEMENT

SUBMIT IN DUPLICATE*
(See other instructions on reverse side)

FOR APPROVED
OMB NO. 1004-0137

Expires: December 31, 1991

WELL COMPLETION OR RECOMPLETION REPORT AND LOG*

1a. TYPE OF WELL: OIL WELL <input type="checkbox"/> GAS WELL <input checked="" type="checkbox"/> DRY <input type="checkbox"/> Other <input type="checkbox"/>		5. LEASE DESIGNATION AND SERIAL NO. NM-03561
b. TYPE OF COMPLETION: NEW WELL <input checked="" type="checkbox"/> WORK OVER <input type="checkbox"/> DEEP-EN <input type="checkbox"/> PLUG BACK <input type="checkbox"/> DIFF. RESVR <input type="checkbox"/> Other <input type="checkbox"/>		6. IF INDIAN, ALLOTTEE OR TRIBE NAME
2. NAME OF OPERATOR BURLINGTON RESOURCES OIL & GAS COMPANY		7. UNIT AGREEMENT NAME
3. ADDRESS AND TELEPHONE NO. PO BOX 4289, Farmington, NM 87499 (505) 326-9700		8. FARM OR LEASE NAME, WELL NO. Grenier B #5E
4. LOCATION OF WELL (Report location clearly and in accordance with any State requirements)* At surface 1910°FSL, 1180°FEL At top prod. interval reported below At total depth		9. API WELL NO. 30-045-30086
		10. FIELD AND POOL, OR WILDCAT Blanco Mesaverde/Basin Dakota
		11. SEC., T., R., M., OR BLOCK AND SURVEY OR AREA Sec.6, T-29-N, R-10-W

14. PERMIT NO.		DATE ISSUED		12. COUNTY OR PARISH San Juan	13. STATE New Mexico
15. DATE SPUNDED 5-22-00	16. DATE T.D. REACHED 6-5-00	17. DATE COMPL. (Ready to prod.) 8-25-00		18. ELEVATIONS (OF, RKB, RT, BR, ETC.)* 5835'GL/5847'KB	19. ELEV. CASINGHEAD
20. TOTAL DEPTH, MD & TVD 7130'	21. PLUG, BACK T.D., MD & TVD 7044'	22. IF MULTIPLE COMPL. HOW MANY*	23. INTERVALS DRILLED BY	ROTARY TOOLS 0-7130'	CABLE TOOLS
24. PRODUCTION INTERVAL (S) OF THIS COMPLETION-TOP, BOTTOM, NAME (MD AND TVD)* 4120-4772' Mesaverde dualled w/Dakota					25. WAS DIRECTIONAL SURVEY MADE No
26. TYPE ELECTRIC AND OTHER LOGS RUN PEX/CMR/BCS/GR Spectroscopy/Fullbore Microimager/CBL/GR/CCL					27. WAS WELL CORED Yes

28. CASING RECORD (Report all strings set in well)					
CASING SIZE/GRADE	WEIGHT, LB/FT.	DEPTH SET (MD)	HOLE SIZE	TOP OF CEMENT, CEMENTING RECORD	AMOUNT PULLED
8 5/8"	24#	349'	12 1/4"	425 cu ft	
5 1/2"	17#	7119'	7 7/8"	2634 cu ft	
29. LINER RECORD				30. TUBING RECORD	
SIZE	TOP (MD)	BOTTOM (MD)	SACKS CEMENT*	SCREEN (MD)	PACKER SET (MD)
				1 1/2"	4717'
					4858'
31. PERFORATION RECORD (Interval, size and number)			32. ACID, SHOT, FRACTURE, CEMENT SQUEEZE, ETC.		
4120, 4142, 4144, 4146, 4164, 4166, 4170, 4172, 4182, 4184, 4186, 4192, 4206, 4208, 4268, 4270, 4292, 4294, 4296, 4298, 4333, 4426, 4430, 4432, 4434, 4436, 4438, 4440, 4524, 4526, 4536, 4538, 4541, 4543, 4548, 4550, 4561, 4568, 4570, 4584, 4586, 4624, 4638, 4640, 4661, 4663, 4681, 4689, 4691, 4693, 4738, 4741, 4743, 4745, 4770, 4772.			DEPTH INTERVAL (MD)		
			4120-4440'		
			4524-4772'		
			AMOUNT AND KIND OF MATERIAL USED		
			100,000 gal slk wtr, 105,000# 20/40 sand.		
			88,000 gal slk wtr, 80,000# 20/40 sand.		

33. DATE FIRST PRODUCTION		PRODUCTION METHOD (Flowing, gas lift, pumping—size and type or pump)				WELL STATUS (Producing or shut-in)	
		Flowing				SI	
DATE OF TEST 8-25-00	HOURS TESTED	CHOKE SIZE	PROD'N FOR TEST PERIOD	OIL-BBL	GAS-MCF	WATER-BBL	GAS-OIL RATIO
FLOW. TUBING PRESS.	CASING PRESSURE	CALCULATED 24-HOUR RATE	OIL-BBL	GAS-MCF	WATER-BBL	OIL GRAVITY-API (CORR.)	
SI 952	SI 949			4295 Pitot gauge			
34. DISPOSITION OF GAS (Sold, used for fuel, vented, etc.)						TEST WITNESSED BY	
To be sold							

35. LIST OF ATTACHMENTS None		36. I hereby certify that the foregoing and attached information is complete and correct as determined from all available records	
---------------------------------	--	---	--

SIGNED [Signature] TITLE Regulatory Supervisor DATE 8-30-00 SEP 19 2000

ACCEPTED FOR RECORD

*(See Instructions and Spaces for Additional Data on Reverse Side)

FARMINGTON FIELD OFFICE

Title 18 U.S.C. Section 1001, makes it a crime for any person knowingly and willfully to make to any department of agency of the United States any false, fictitious or fraudulent statements or representations as to any matter within its jurisdiction.

OPERATOR

BURLINGTON RESOURCES OIL AND GAS COMPANY

Grenier B #5E
Section 6, T-29-N, R-10-W
OFFSET OPERATOR/OWNER PLAT

Nonstandard Location
Dakota Formation Well

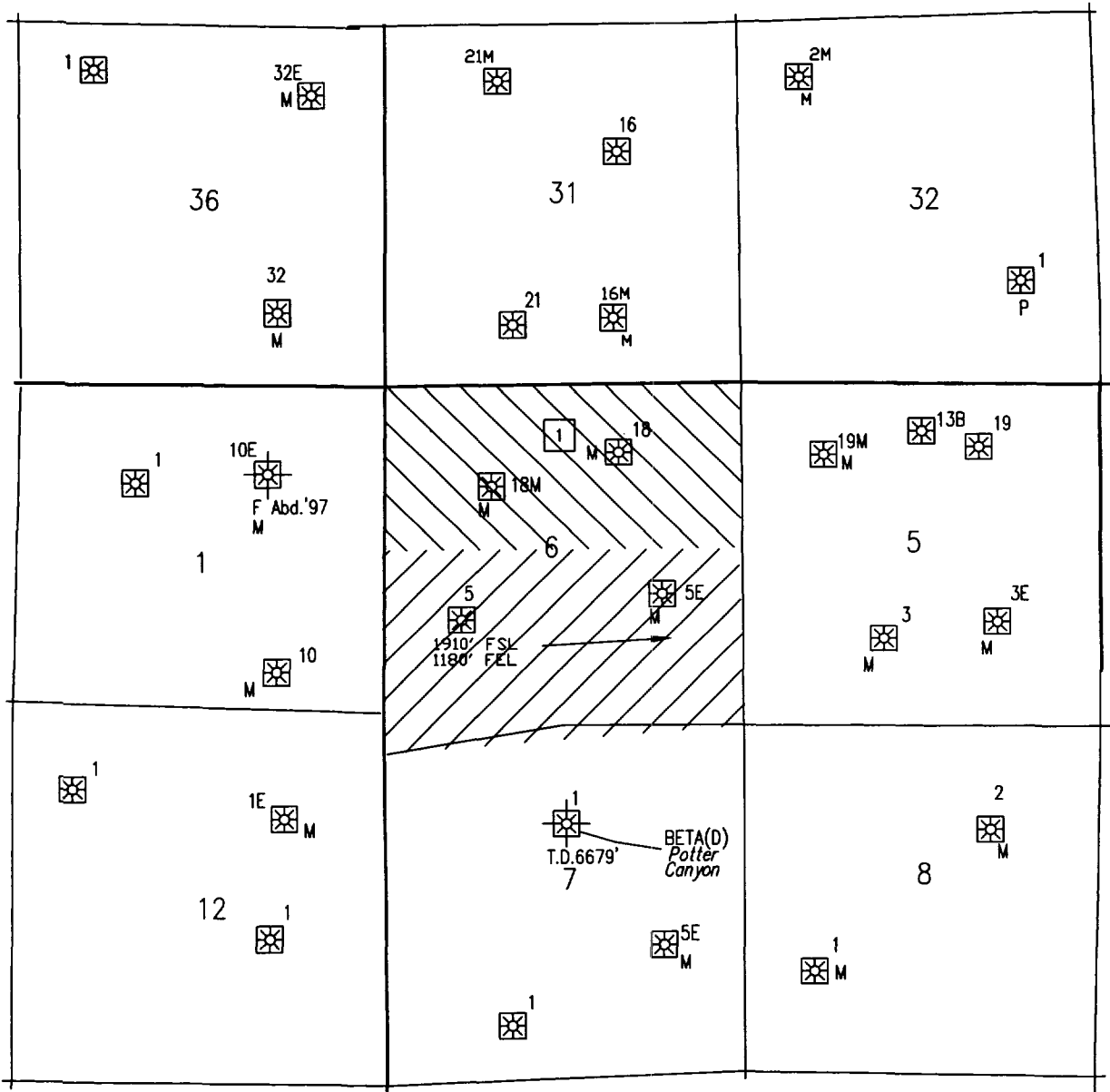

1 Conoco Inc.
Attention: Eva Rodriguez
PO Box 2197
Houston, Texas 77252 - 2197

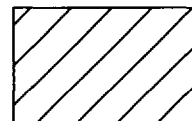

Proposed Well

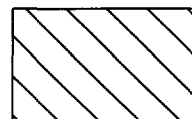

Offset Operator

Grenier B #5E
Section 6, T-29-N, R-10-W
OFFSET OPERATOR/OWNER PLAT



Proposed Well

Offset Operator

BURLINGTON RESOURCES OIL AND GAS COMPANY

Grenier B #5E
Section 6, T-29-N, R-10-W
OFFSET OPERATOR/OWNER PLAT

Nonstandard Location
Chacra Formation Well

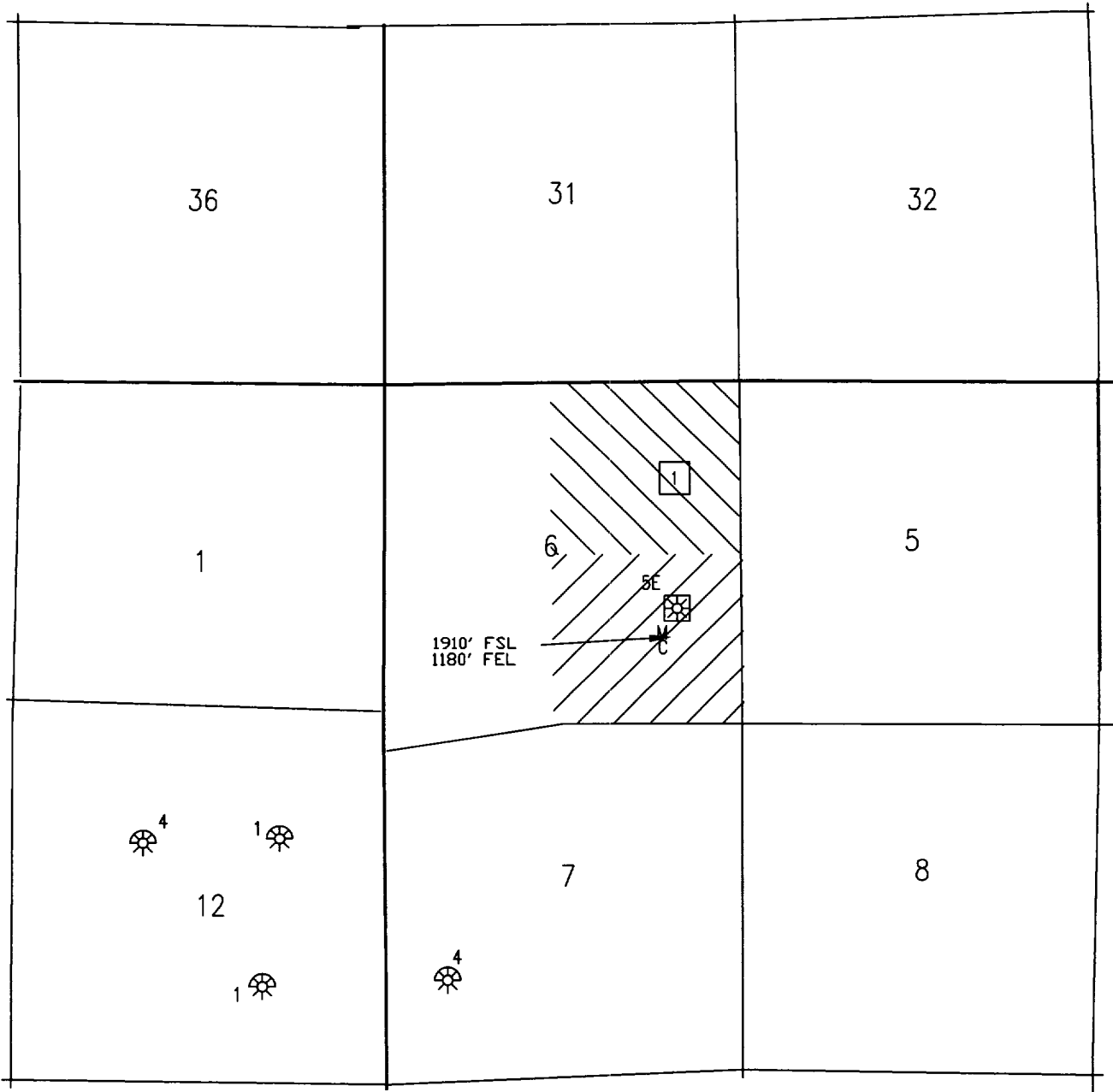

1 Conoco Inc.
Attention: Eva Rodriguez
PO Box 2197
Houston, Texas 77252 - 2197

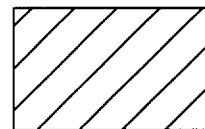

Proposed Well

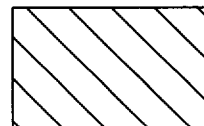

Offset Operator

Re: Grenier B #5E
1910'FSL, 1180'FEL Section 6, T-29-N, R-10-W, San Juan County
30-045-30086

I hereby certify that the following offset operators/owners have been mailed notification of our application for non-standard location.

Conoco Inc.
Att: Eva Rodriguez
PO Box 2197
Houston, TX 77252-2197

A handwritten signature in cursive script, appearing to read "J. J. Call".

BURLINGTON RESOURCES

SAN JUAN DIVISION

Sent Federal Express

Mr. Michael Stogner
New Mexico Oil Conservation Division
2040 South Pacheco
Santa Fe, New Mexico 87505

Re: Grenier B #5E
1910'FSL, 1180'FEL Section 6, T-29-N, R-10-W, San Juan County
30-045-30086

Dear Mr. Stogner:

Burlington Resources is applying for administrative approval of an unorthodox gas well location for the Basin Dakota, Blanco Mesaverde and Otero Chacra. This well was originally permitted and approved for all three pools.

Burlington Resources drilled and completed the well as a Mesaverde-Dakota dual during the summer of 2000. We now intend to recomplete the well in 2001, open the Chacra formation and commingle with the Mesaverde and Dakota. Application has been made for the proposed commingling.

In talking with Frank Chavez and Steve Hayden of the Aztec District Office to prepare this application for the Chacra, it was noted that both the Mesaverde and Dakota are also outside the standard windows because of the short half section line which was not originally recognized by either Burlington Resources or the Aztec District Office when we drilled the Mesaverde and Dakota. Therefore, this application is for all three pools.

Production from the Chacra pool is to be included in a 148.90 acre gas spacing and proration unit for the southeast (SE/4) quarter of Section 6.

Production from the Mesaverde pool is to be included in a 312.60 acre gas spacing and proration unit for the south half (S/2) in Section 6

Production from the Dakota pool is to be included in a 312.60 acre gas spacing and proration unit for the south half (S/2) in Section 6 and is to be dedicated to the Grenier B #5 (30-045-20055) located at 1710'FSL, 1040'FWL in Section 6.

Grenier B #5E
Page Two

The following attachments are for your review:

- Completion Report for Mesaverde and Dakota
- Completed C-102 at referenced location.
- Offset operators/owners plats - for Chacra, Mesaverde and Dakota

Three copies of this application are being submitted to offset operators/owners by certified mail with a request that they furnish you with a Waiver of Objection, keep one copy for their files and return one copy to this office. Please let me know if you have any questions about this application.

Sincerely,

BURLINGTON RESOURCES

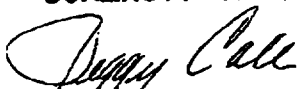

Peggy Cole
Regulatory Supervisor

WAIVER

Conoco Inc. hereby waives objection to Burlington Resources' application for a non-standard location for the Grenier B #5E as proposed above.

By: William W. Smith Date: 12/19/00
SR LAND ADVISOR

xc: NMOCD - Aztec District Office
Bureau of Land Management



NEW MEXICO ENERGY, MINERALS and NATURAL RESOURCES DEPARTMENT

GARY E. JOHNSON
Governor
Jennifer A. Salisbury
Cabinet Secretary

Lori Wrotenbery
Director
Oil Conservation Division

ADMINISTRATIVE ORDER DHC-2726-0

BURLINGTON RESOURCES OIL & GAS
PO BOX 51810
MIDLAND, TX 79710-

	GRENIER B Well No. 5E	
	API No. 30-045-30086-00-00	
	I-6-29N-10W	
	SAN JUAN County, New Mexico	
Pool:	BLANCO-MESAVERDE (PRORATED GAS	72319
	OTERO CHACRA (GAS)	82329

Reference is made to your recent application for an exception to Rule 303.A. of the Division Rules and Regulations to permit the above described well to commingle production from the subject pools in the wellbore.

It appearing that the subject well qualifies for approval for such exception pursuant to the provisions of Rule 303.C., and that reservoir damage or waste will not result from such downhole commingling, and correlative rights will not be violated thereby, you are hereby authorized to commingle the production as described above and any Division Order which authorized the dual completion and required separation of the zones is hereby placed in abeyance.

The applicant shall consult with the supervisor of the District Office of the Division upon completion and testing of the well in order to establish a fixed allocation of production from each of the commingled zones. Upon approval by the Division's District Office, the applicant shall submit the allocation formula to the Santa Fe Office of the Division.

REMARKS: The operator shall notify the District Office of the Division upon implementation of the commingling process.

Pursuant to Rule 303.C.(2), the commingling authority granted herein may be rescinded by the Division Director if conservation is not being best served by such commingling.

Approved at , New Mexico, on this 28th day of April, 2000.

STATE OF NEW MEXICO
OIL CONSERVATION DIVISION

LORI WROTENBERY,
Division Director

LW/DRC

cc: Oil Conservation Division -

CMD :
OG5SECTONGARD
INQUIRE LAND BY SECTION12/22/00 11:25:39
OGOMES -TPG7
PAGE NO: 1

Sec : 06 Twp : 29N Rng : 10W Section Type : NORMAL

11 33.97 Federal owned	10 37.36 Federal owned A	9 38.54 Federal owned A	8 38.11 Federal owned
12 33.35 Federal owned	13 36.46 Federal owned A	14 38.42 Federal owned	15 37.86 Federal owned A A

PF01 HELP
PF07 BKWDPF02
PF08 FWDPF03 EXIT
PF09 PRINTPF04 GoTo
PF10 SDIVPF05
PF11PF06
PF12

CMD :
OG5SECTONGARD
INQUIRE LAND BY SECTION12/22/00 11:25:46
OGOMES -TPG7
PAGE NO: 2

Sec : 06 Twp : 29N Rng : 10W Section Type : NORMAL

19 32.44	18 34.20	17 36.83	16 37.45
Federal owned A	Federal owned A	Federal owned A	Federal owned
20 31.94	21 33.56	22 37.00	23 37.62
Federal owned	Federal owned	Federal owned	Federal owned

PF01 HELP
PF07 BKWDPF02
PF08 FWDPF03 EXIT
PF09 PRINTPF04 GoTo
PF10 SDIVPF05
PF11PF06
PF12

281.04

CMD : ONGARD 12/22/00 11:25:55
OG6IWCM INQUIRE WELL COMPLETIONS OGOMES -TPG7

API Well No : 30 45 20055 Eff Date : 01-01-1996 WC Status : A
Pool Idn : 71599 BASIN DAKOTA (PRORATED GAS)
OGRID Idn : 14538 BURLINGTON RESOURCES OIL & GAS CO
Prop Idn : 18532 GRENIER B

Well No : 005
GL Elevation: 5875

	U/L	Sec	Township	Range	North/South	East/West	Prop/Act (P/A)
B.H. Locn	: 19	6	29N	10W	FTG 1710 F S	FTG 1040 F W	P

Lot Identifier:

Dedicated Acre: 312.60

Lease Type : F

Type of consolidation (Comm, Unit, Forced Pooling - C/U/F/O) :

M0025: Enter PF keys to scroll

PF01 HELP	PF02	PF03 EXIT	PF04 GoTo	PF05	PF06
PF07	PF08	PF09	PF10 NEXT-WC	PF11 HISTORY	PF12 NXTREC

CMD : ONGARD 12/22/00 11:26:16
OG6IWCM INQUIRE WELL COMPLETIONS OGOMES -TPG7

API Well No : 30 45 20368 Eff Date : 01-01-1996 WC Status : A
Pool Idn : 71280 AZTEC PICTURED CLIFFS (GAS)
OGRID Idn : 14538 BURLINGTON RESOURCES OIL & GAS CO
Prop Idn : 18532 GRENIER B

Well No : 007
GL Elevation: 5853

	U/L	Sec	Township	Range	North/South	East/West	Prop/Act (P/A)
	---	---	-----	-----	-----	-----	-----
B.H. Locn	: 18	6	29N	10W	FTG 1830 F S	FTG 1530 F W	P

Lot Identifier:

Dedicated Acre: 160.00

Lease Type : F

Type of consolidation (Comm, Unit, Forced Pooling - C/U/F/O) :

M0025: Enter PF keys to scroll

PF01 HELP	PF02	PF03 EXIT	PF04 GoTo	PF05	PF06
PF07	PF08	PF09	PF10 NEXT-WC	PF11 HISTORY	PF12 NXTREC

CMD :	ONGARD	12/22/00 11:26:34
OG6IWCN	INQUIRE WELL COMPLETIONS	OGOMES -TPG7

API Well No : 30 45 8696 Eff Date : 01-01-1996 WC Status : A
Pool Idn : 71280 AZTEC PICTURED CLIFFS (GAS)
OGRID Idn : 14538 BURLINGTON RESOURCES OIL & GAS CO
Prop Idn : 18532 GRENIER B

Well No : 002
GL Elevation: 5832

	U/L	Sec	Township	Range	North/South	East/West	Prop/Act (P/A)
	---	---	-----	-----	-----	-----	-----
B.H. Locn : 17 6 29N 10W	FTG	1650	F S	FTG	1650	F E	P

Lot Identifier:
Dedicated Acre: 160.00
Lease Type : F
Type of consolidation (Comm, Unit, Forced Pooling - C/U/F/O) :

M0025: Enter PF keys to scroll

PF01 HELP	PF02	PF03 EXIT	PF04 GoTo	PF05	PF06
PF07	PF08	PF09	PF10 NEXT-WC	PF11 HISTORY	PF12 NXTREC

OIL CONSERVATION COMMISSION

P. O. BOX 871

SANTA FE, NEW MEXICO

November 21, 1958

C
O
P
Y
El Paso Natural Gas Company
Box 1492
El Paso, Texas

Attention: Mr. Sam Smith

Administrative Order NWU-317

Gentlemen:

Reference is made to your application for approval of a 313-acre non-standard gas proration unit in the Blanco Mesaverde Gas Pool consisting of the following acreage:

TOWNSHIP 29 NORTH, RANGE 10 WEST, NMPM
Section 6: N/2

It is understood that this unit is to be dedicated to your Ludwick No. 14 Well, located 1650 feet from the North line and 992 feet from the East line of said Section 6.

By authority granted me under the provisions of Rule 1 (b), Section 15 of the Special Rules and Regulations for the Blanco-Mesaverde Gas Pool, as set forth in Order R-128-D, you are hereby authorized to operate the above described acreage as a non-standard gas proration unit, with allowable to be assigned thereto in accordance with the pool rules, based upon the unit size of 313 acres.

Very truly yours,

A. L. PORTER, Jr.,
Secretary-Director

ALP/OEP/og

cc: Oil Conservation Commission - Aztec
U. S. Geological Survey - Farmington

El Paso Natural Gas Company

El Paso, Texas

September 25, 1958

ILLEGIBLE

NWU - 317

(con. water)

Oil Conservation Commission
Of the State of New Mexico
Post Office Box 871
Santa Fe, New Mexico

Re: Application for Exception to Rule 1(a)
of Order No. R-128-C for Non-Standard
Proration Unit, Blanco Mesaverde
Gas Pool, San Juan County, New Mexico

Gentlemen:

El Paso Natural Gas Company hereby submits its application for administrative approval of a non-standard proration unit consisting of the N/2 (Lots 1, 2, 3, 4, 5, SE/4 NW/4, S/2 NE/4) of Section 6, Township 29 North, Range 10 West, San Juan County, New Mexico, and in support thereof states the following facts:

1. The Ludwick #14 Well, located 1650' from the North line and 992' from the East line of Section 6, Township 29 North, Range 10 West, was completed as a gas well from the Mesaverde Formation on November 6, 1956.
2. That the proposed non-standard gas proration unit consists of 313.00 acres, which are contiguous quarter-quarter sections and lots.
3. That the proposed non-standard gas proration unit lies wholly within a single government section.
4. That the proposed non-standard gas proration unit may reasonably be presumed to be productive of gas.
5. That by copy of this letter of application all operators owning interests (a) in the section in which any part of the non-standard proration unit is situated and which acreage is not included in said non-standard gas proration unit, and (b) in acreage offsetting the non-standard gas proration unit, are notified by registered mail of this proposed non-standard gas proration unit.

Therefore, El Paso Natural Gas Company requests that under the provision of Rule 1 (b) of Order No. R-128-C, the Secretary of the Commission grant exception

to Rule 1 (a) without Notice and Hearing and approve the subject non-standard gas proration unit.

Respectfully submitted,

EL PASO NATURAL GAS COMPANY

By:

Sam Smith
Sam Smith
Manager
Land Department

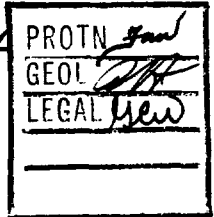

SS:BI:jb

SUBSCRIBED AND SWORN to before me by the said SAM SMITH this 14th day of October, 1958, to certify which witness my hand and seal of office.

My Commission expires:

June 1, 1959

Natalie Taylor
Notary Public in and for El Paso County,
State of Texas

A copy of the foregoing application for non-standard gas proration unit on the Ludwick #14 Well was forwarded by registered mail, return receipt requested, to the following listed parties:

Southern Union Gas Company
1104 Burt Building
Dallas 1, Texas

Pubco Petroleum Corporation
Post Office Box 1419
Albuquerque, New Mexico

H. L. Fannin, Jr.
4912 Roma Avenue, NE
Albuquerque, New Mexico

Ted White
1900 Mercantile Dallas Building
Dallas 1, Texas

Alfred E. McLane
1900 Mercantile Dallas Building
Dallas 1, Texas

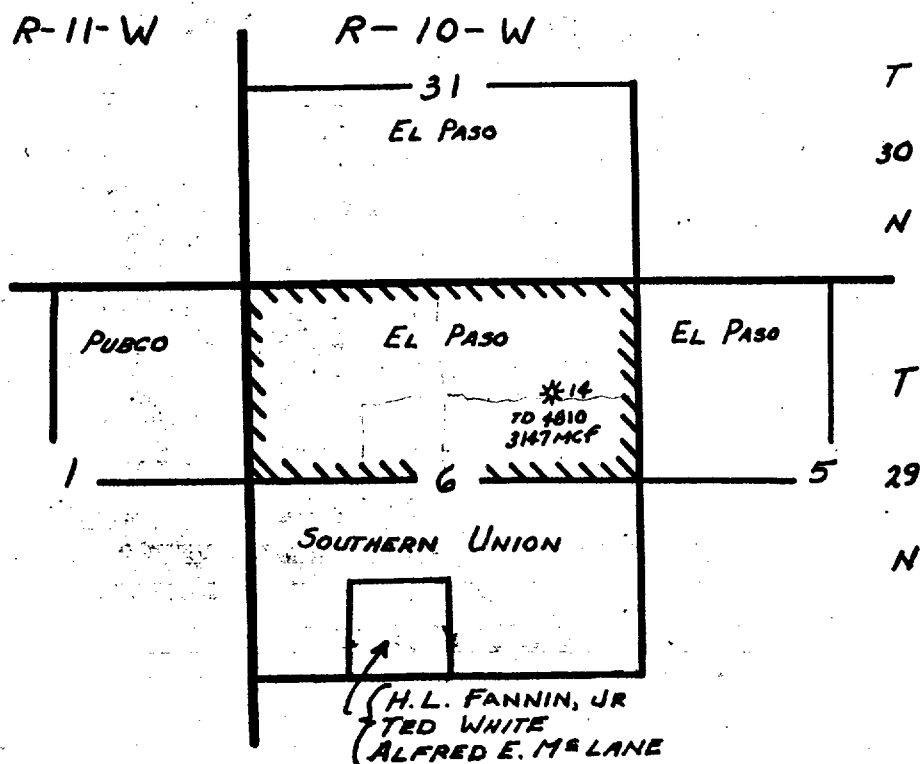

EL PASO NATURAL GAS CO.

SCALE 2" = 1 MILE

PLAT ACCOMPANYING APPLICATION FOR
313.00 ACRE NON-STANDARD GAS UNIT
LUDWICK # 14

OIL CONSERVATION COMMISSION

P. O. BOX 871

SANTA FE, NEW MEXICO

*See NWU-41
for application
from El Paso*

May 3, 1961

El Paso Natural Gas Company
Box 1492
El Paso, Texas

Attention: Mr. Sam Smith

Administrative Order NWU-414

Gentlemen:

Reference is made to your application for approval of a 313.00-acre non-standard gas proration unit in the Basin-Dakota Gas Pool consisting of the following acreage:

TOWNSHIP 29 NORTH, RANGE 10 WEST, NMPM
Section 6: Lots 1, 2, 3, 4, and 5,
SE/4 NW/4 & S/2 NE

It is understood that this unit is to be dedicated to your Ludwick No. 18 located in the NE/4 of said Section 6.

By authority granted me under the provisions of Rule 5 (B) of the Special Rules and Regulations for the Basin-Dakota Gas Pool, as set forth in Order R-1670-C, you are hereby authorized to operate the above described acreage as a non-standard gas proration unit, with allowable to be assigned thereto in accordance with the pool rules, based upon the unit size of 313.00 acres.

Very truly yours,

A. L. PORTER, Jr.,
Secretary-Director

ALP/RSM/og

cc: Oil Conservation Commission - Aztec

C
O
P
Y

OIL CONSERVATION COMMISSION

P. O. BOX 871

SANTA FE, NEW MEXICO

May 3, 1961

El Paso Natural Gas Company
Box 1492
El Paso, Texas

Attention: Mr. Sam Smith

Administrative Order NWU-412

Gentlemen:

Reference is made to your application for approval of a 302.62-acre non-standard gas proration unit in the Basin-Dakota Gas Pool consisting of the following acreage:

TOWNSHIP 28 NORTH, RANGE 9 WEST, NMPM
Section 30: Lots 1 and 2, E/2 NW/4 and NE/4

It is understood that this unit is to be dedicated to your Lackey "B" Well No. 14 located in the NE/4 of said Section 30.

By authority granted me under the provisions of Rule 5 (B) of the Special Rules and Regulations for the Basin-Dakota Gas Pool, as set forth in Order R-1670-C, you are hereby authorized to operate the above described acreage as a non-standard gas proration unit, with allowable to be assigned thereto in accordance with the pool rules, based upon the unit size of 302.62 acres.

Very truly yours,

A. L. PORTER, Jr.,
Secretary-Director

ALP/RSM/og

El Paso Natural Gas Company

El Paso, Texas

April 28, 1961

7700-412

Oil Conservation Commission
Of the State of New Mexico
Capitol Annex Building
Santa Fe, New Mexico

Re: Application for Exception to Rule 5(A)
of Order R-1670-C for a Non-Standard
Proration Unit, Basin-Dakota Gas Pool
San Juan County, New Mexico

Gentlemen:

In accordance with Rule 5(B) of Order R-1670-C, El Paso Natural Gas Company, as Operator, hereby submits its application for administrative approval of the following Non-Standard Proration Units in the Dakota Formation of the Basin-Dakota Gas Pool. The well names, descriptions of the drilling blocks, and the size of the proration units covered by this application are as follows:

<u>Well Name and Drilling Block</u>	<u>Location</u>	<u>No. of Acres</u>	<u>Kind of Well</u>
Lackey "B" No. 14 T-28-N, R-9-W Sec. 30: Lots 1,2, E/2 NW/4, NE/4 (N/2)	NE/4 Sec. 30 T-28-N, R-9-W	302.62	Gas
Michener "A" No. 6 T-28-N, R-9-W Sec. 31: Lots 1,2, E/2 NW/4, NE/4 (N/2)	NE/4 Sec. 31 T-28-N, R-9-W	303.22	Gas
Ludwick No. 18 T-29-N, R-10-W Sec. 6: Lots 1,2,3,4,5, SE/4 NW/4, S/2 NE/4 (N/2)	NE/4 Sec. 6 T-29-N, R-10-W	313.00	Gas

and in support thereof states the following fact:

That each of the above proposed non-standard gas proration units consists of the number of acres shown and is an unorthodox size or shape due to a variation in the legal subdivision of the United States Public Land Survey. (Plats attached)

Therefore, El Paso Natural Gas Company requests that under the provisions of Rule 5(B) of Order R-1670-C, the Secretary of the Commission grant exception to Rule 5(A) without Notice of Hearing and approve the subject non-standard proration units.

Respectfully submitted,

EL PASO NATURAL GAS COMPANY

By *Sam Smith*
Sam Smith, Manager
Land Department

PROTN.	<i>gaw</i>
RES. EXC.	<i>gaw</i>
LEGAL	<i>gaw</i>
<i>24</i>	

SS:GA:js
Attachment

SUBSCRIBED AND SWORN to before me by the said SAM SMITH this 25th day of March, 1961, to certify which witness my hand and seal of office.

Natalie Taylor
Notary Public

My Commission expires:

NATALIE TAYLOR

Notary Public in and for El Paso County, Texas
My Commission Expires June 1, 1961

NM 1006
NM 1010
NM 1116

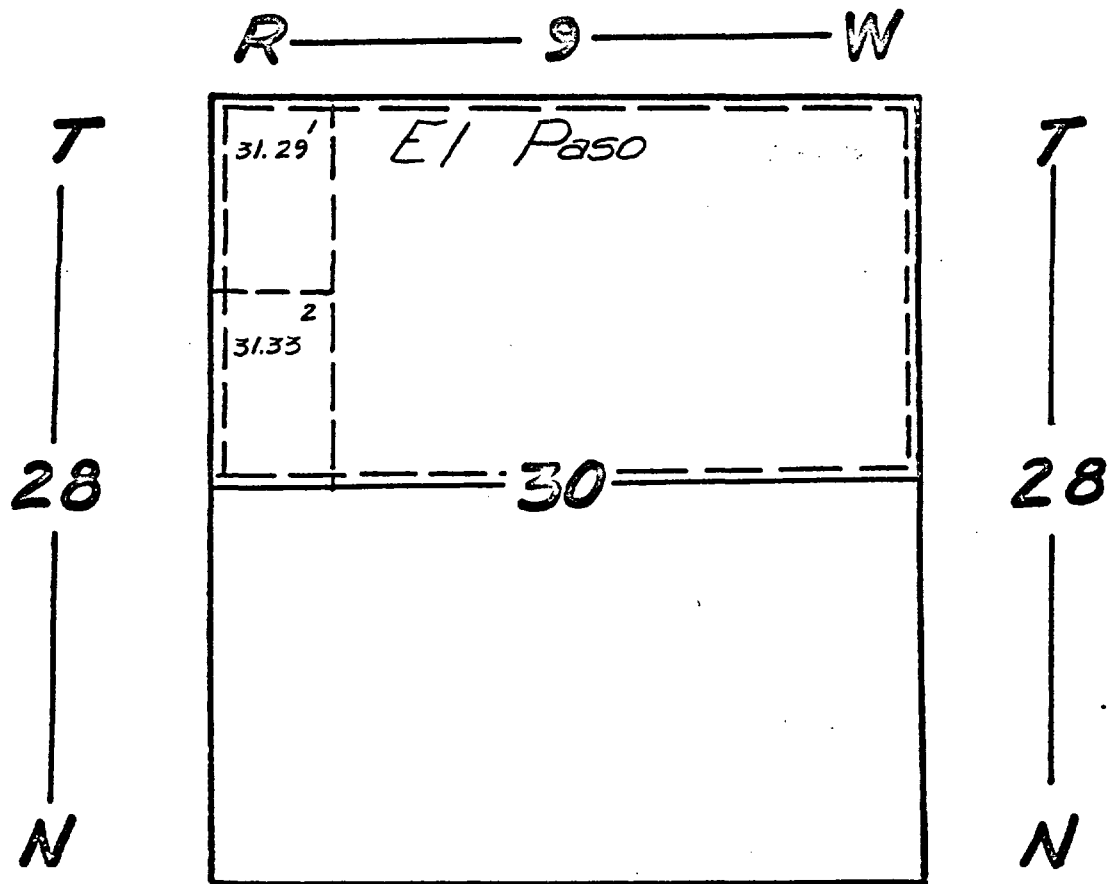

EL PASO NATURAL GAS CO.

*Plat Accompanying Application for
302.62 Acre Non-Standard Gas Unit
Lackey B #14*

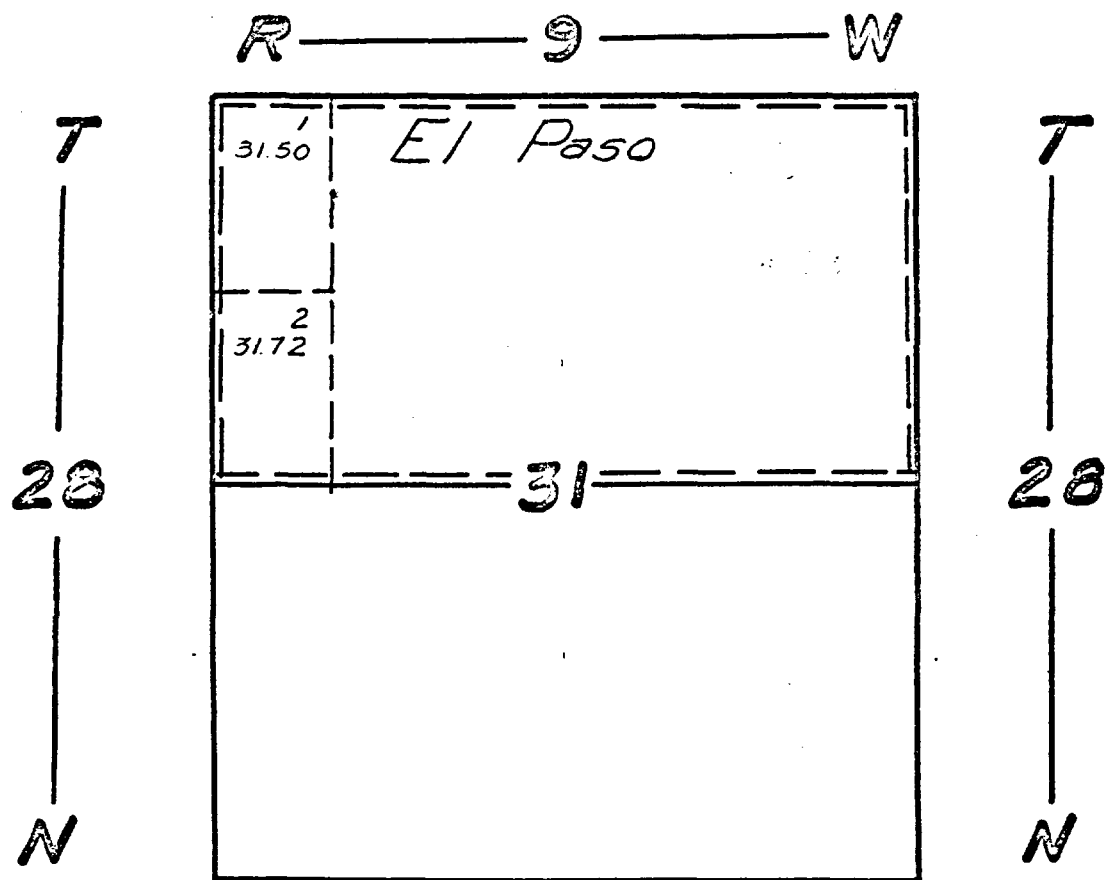

EL PASO NATURAL GAS CO.

*Plat Accompanying Application for
303.22 Acre Non-Standard Gas Unit
Michener "A" #6*



Plat Accompanying Application for
313.00 Acre Non-Standard Gas Unit
Ludwick #18

OIL CONSERVATION COMMISSION

P. O. ~~BOX 2032~~ BOX 2032
SANTA FE, NEW MEXICO

August 17, 1966

El Paso Natural Gas Company
P. O. Box 1492
El Paso, Texas

Attention: Mr. T. W. Bittick

Administrative Order NWU-533

Gentlemen:

Reference is made to your application for approval of a 152.22-acre non-standard gas proration unit in the Aztec-Pictured Cliffs Gas Pool consisting of the following acreage:

SAN JUAN COUNTY, NEW MEXICO
TOWNSHIP 29 NORTH, RANGE 10 WEST, NMPM
Section 6: NW/4 (Lots 3, 4, and 5, and
SE/4 NW/4)

It is understood that this unit is to be dedicated to your Ludwick Well No. 24, located 850 feet from the North line and 1850 feet from the West line of said Section 6.

By authority granted me under the provisions of Order No. R-1670, as amended, you are hereby authorized to operate the above-described acreage as a non-standard gas proration unit.

Very truly yours,

A. L. PORTER, Jr.
Secretary-Director

ALP/GMH/esr

cc: Oil Conservation Commission - Aztec
Oil & Gas Engineering Committee - Hobbs
United States Geological Survey - Farmington
Proration Department, OCC - Santa Fe

NW 0033
Am A
issue 8-17-66
850 N, 1850 W

El Paso Natural Gas Company

El Paso, Texas 79999

July 6, 1966

Oil Conservation Commission
State of New Mexico
Post Office Box 2088
Santa Fe, New Mexico

MAIL OFFICE

'66 JUL 18 AM 7

Re: Application for Exception to
Rule 5 (A) of Order R-1670,
Northwestern New Mexico for
a Non-Standard Proration Unit,
Aztec - Pictured Cliffs Gas Pool
San Juan County, New Mexico

Gentlemen:

In accordance with Rule 5 (B) of Order R-1670 covering Northwestern New Mexico, El Paso Natural Gas Company, as Operator, hereby submits its application for administrative approval of a non-standard proration unit consisting of Lots 3, 4, 5, SE/4 NW/4 (NW/4) Section 6, Township 29 North, Range 10 West, N.M.P.M., San Juan County, New Mexico and in support thereof states the following facts:

1. That the proposed non-standard gas proration unit consists of 152.22 acres which are contiguous quarter quarter sections and lots.
2. That the proposed non-standard gas proration unit lies wholly within a single governmental section.
3. That the proposed non-standard gas proration unit may reasonably be presumed to be productive of gas.
4. That by copy of this letter of application all operators owning interests (a) in the section in which any part of the non-standard proration unit is situated and which acreage is not included in said non-standard gas proration unit and (b) in acreage offsetting the non-standard gas proration unit, are notified by registered mail of this non-standard gas proration unit.

Therefore El Paso Natural Gas Company requests that under the provisions of Rule 5 (B) of Order R-1670 covering Northwestern New Mexico, the Secretary of the Commission grant exception to Rule 5 (A) without Notice and Hearing and approve the subject non-standard gas proration unit.

Respectfully submitted,

EL PASO NATURAL GAS COMPANY

BY:

T. W. Bittick
T. W. Bittick, Manager
Land Department

PROTN.	<i>SAH</i>
Res Eng.	<i>RPZ</i>
LEGAL	<i>HW</i>
	<i>PH</i>

TWB:JRP:kw

SUBSCRIBED AND SWORN to before me by the said T. W. Bittick
this 1st day of July 1966, to certify
which witness my hand and seal of office.

Marian Davis
Notary Public

My Commission Expires:

MARIAN DAVIS

Notary Public in and for El Paso County, Texas

My Commission Expires June 1, 1967

NM-1116

cc: Pubco Petroleum Corporation
Post Office Box 1419
Albuquerque, New Mexico 87103

Texas Pacific Oil Company a Division
of Joseph E. Segram and Sons, Inc.
Post Office Box 747
Dallas, Texas

NW/4 Section 6 Township 29 North Range 10 West

R11W			R10W			
36			31			
Joe Seagram	Pubco	3 36.45	El Paso			
El Paso		4 36.15				T30N
2 32.52	1 32.54	4 35.87	3 40.20	2 40.32	1 40.46	T29N
Pubco		5 36.15	El Paso			
1 Pubco	6 36.25		6			
		7 36.35				

El Paso Natural Gas Company

Plat Accompanying Application
For 152.22 Acre Non Standard
Gas Unit

Ludwick #24
Picured Cliffs Formation



William W. Franklin, CPL
Senior Land Advisor
Lobo/San Juan Business Unit
Exploration Production – North America

Conoco Inc
Dubai 3092
600 North Dairy Ashford (77079-1175)
P. O. Box 2197
Houston, TX 77252-2197
(281) 293-6535

December 19, 2000

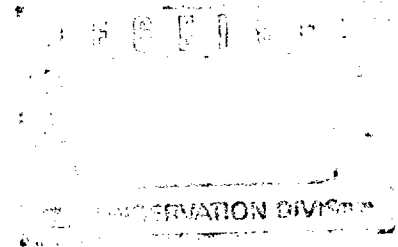

Mr. Michael Stogner
New Mexico Oil Conservation Division
2040 South Pacheco
Santa Fe, New Mexico 87505

Re: Grenier B #5E
1910' FSL, 1180' FEL Section 6-29N-10W
San Juan County, New Mexico

Dear Mr. Stogner:

Enclosed is one Waiver of Objection to the above non-standard location as requested by Burlington Resources.

Please advise if further information is required.

Respectfully,

William W. Franklin

enclosure

BURLINGTON RESOURCES

SAN JUAN DIVISION

Sent Federal Express

Mr. Michael Stogner
New Mexico Oil Conservation Division
2040 South Pacheco
Santa Fe, New Mexico 87505

Re: Grenier B #5E
1910'FSL, 1180'FEL Section 6, T-29-N, R-10-W, San Juan County
30-045-30086

Dear Mr. Stogner:

Burlington Resources is applying for administrative approval of an unorthodox gas well location for the Basin Dakota, Blanco Mesaverde and Otero Chacra. This well was originally permitted and approved for all three pools.

Burlington Resources drilled and completed the well as a Mesaverde-Dakota dual during the summer of 2000. We now intend to recompleate the well in 2001, open the Chacra formation and commingle with the Mesaverde and Dakota. Application has been made for the proposed commingling.

In talking with Frank Chavez and Steve Hayden of the Aztec District Office to prepare this application for the Chacra, it was noted that both the Mesaverde and Dakota are also outside the standard windows because of the short half section line which was not originally recognized by either Burlington Resources or the Aztec District Office when we drilled the Mesaverde and Dakota. Therefore, this application is for all three pools.

Production from the Chacra pool is to be included in a 148.90 acre gas spacing and proration unit for the southeast (SE/4) quarter of Section 6.

Production from the Mesaverde pool is to be included in a 312.60 acre gas spacing and proration unit for the south half (S/2) in Section 6

Production from the Dakota pool is to be included in a 312.60 acre gas spacing and proration unit for the south half (S/2) in Section 6 and is to be dedicated to the Grenier B #5 (30-045-20055) located at 1710'FSL, 1040'FWL in Section 6.

Grenier B #5E
Page Two

The following attachments are for your review:

- Completion Report for Mesaverde and Dakota
- Completed C-102 at referenced location.
- Offset operators/owners plats – for Chacra, Mesaverde and Dakota

Three copies of this application are being submitted to offset operators/owners by certified mail with a request that they furnish you with a Waiver of Objection, keep one copy for their files and return one copy to this office. Please let me know if you have any questions about this application.

Sincerely,

BURLINGTON RESOURCES

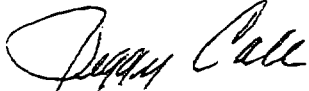

Peggy Cole
Regulatory Supervisor

WAIVER

Conoco Inc. hereby waives objection to Burlington Resources' application for a non-standard location for the Grenier B #5E as proposed above.

By:

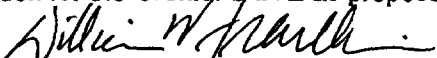
SR LAND ADVISOR

Date:

12/19/00

xc:

NMOCD - Aztec District Office
Bureau of Land Management

Box 1980, Hobbs, N.M. 88241-1980

State of New Mexico
Energy, Minerals & Natural Resources Department

Form C-102

Revised February 21, 1994

Instructions on back

Submit to Appropriate District Office

State Lease - 4 Copies

Fee Lease - 3 Copies

DISTRICT II
P.O. Drawer 99, Arisaca, N.M. 88211-0718

DISTRICT III
1000 E. Higgins Rd., Artes, N.M. 87410

DISTRICT IV
PO Box 2888, Santa Fe, NM 87504-2088

OIL CONSERVATION DIVISION

P.O. Box 2088
Santa Fe, NM 87504-2088

1993 DEC 17 PM 1:08

☐ AMENDED REPORT

WELL LOCATION AND ACREAGE DEDICATION PLAT

*API Number 30-045-		*Pool Code 82329/72319/	*Pool Name Basin Dakota Otero Chacra/Blanco Mesaverde/
*Property Code 18532	*Property Name GRENIER B		*Well Number 5E
*ORD No. 14538	*Operator Name BURLINGTON RESOURCES OIL & GAS COMPANY		*Elevation 5835'

10 Surface Location

UL or lot no.	Section	Township	Range	Lot Idn	Feet from the	North/South line	Feet from the	East/West line	County
1	6	29-N	10-W		1910	SOUTH	1180	EAST	SAN JUAN

11 Bottom Hole Location If Different From Surface

UL or lot no.	Section	Township	Range	Lot Idn	Feet from the	North/South line	Feet from the	East/West line	County

*Dedicated Acres	*Joint or Infill	*Consolidation Code	*Order No.
Cha-148.90	MV-S	281.04	DK-S/312.60

NO ALLOWABLE WILL BE ASSIGNED TO THIS COMPLETION UNTIL ALL INTERESTS HAVE BEEN CONSOLIDATED OR A NON-STANDARD UNIT HAS BEEN APPROVED BY THE DIVISION

<p>16</p>				<p>17 OPERATOR CERTIFICATION</p> <p>I hereby certify that the information contained herein is true and complete to the best of my knowledge and belief.</p> <p><i>Peggy Cole</i> Signature Peggy Cole Printed Name Regulatory Administrator Title 12-1-99 Date</p>	
				<p>18 SURVEYOR CERTIFICATION</p> <p>I hereby certify that the well location shown on this plat was plotted from field notes of actual surveys made by me or under my supervision, and that the same is true and correct to the best of my belief.</p> <p>FD. 1967 BLM BC. S 89-58-44 W 2626.24'</p> <p>FD. 1967 BLM BC. N 01-35-04 E 2,458.51'</p> <p>1180'</p> <p>1910'</p> <p>6</p> <p>USA NM-03561</p> <p>USA SF-078717</p> <p>LAT. = 36° 45.2' N LONG. = 107° 53.2' W</p> <p>8894</p> <p>ROY AGUIRRE NEW MEXICO PROFESSIONAL LAND SURVEYOR 8894</p> <p>Certificate Number</p>	

Stogner, Michael

From: Stogner, Michael
Sent: Wednesday, December 27, 2000 4:36 PM
To: Hayden, Steven
Cc: Johnson, Roy
Subject: Burlington's Grenier "B" #5-E

I know we talked the other day about this application and that I was gonna be hard nosed to Ms. Cole. I guess I was visited over the Christmas weekend by the ghost of: (i) customer service; (ii) we serve industry; and (iii) preferential treatment, and have prepared this order for your review. I'll await your recommendation kind sir...God bless our customers, everyone.



3PLS01.doc