

117154990 NSL

7/10/01

MARTIN YATES, III
1912 - 1985
FRANK W. YATES
1936 - 1986



105 SOUTH FOURTH STREET
ARTESIA, NEW MEXICO 88210-2118
TELEPHONE (505) 748-1471

S. P. YATES
CHAIRMAN OF THE BOARD
JOHN A. YATES
PRESIDENT
PEYTON YATES
EXECUTIVE VICE PRESIDENT
RANDY G. PATTERSON
SECRETARY
DENNIS G. KINSEY
TREASURER

June 13, 2001

JUN 20 2001

New Mexico Oil Conservation Division
2040 South Pacheco Street
Santa Fe, New Mexico 87505

Attention: Mr. Michael E. Stogner

Re: Administrative Application of Yates Petroleum Corporation for
Approval of an Unorthodox Oil/Gas Well Location, Chaves County
New Mexico

Dear Mr. Stogner:

Yates Petroleum Corporation in accordance with Division General Rule 104.F applies to the New Mexico Oil Conservation Division for approval of an unorthodox oil/gas well location for any and all oil or gas production for its existing Rolla TC #2 to be re-completed at an unorthodox oil or gas well location of 1,980' feet from the North line and 2,310' feet from the East line (Unit G) of Section 29, Township 9 South, Range 26 East, NMPM, Chaves County, New Mexico and is dedicated to a 320 acre spacing unit consisting of the N/2 of Section 29, and in support states:

- 1) Pursuant to our phone conversation on June 7, 2001 concerning this well, enclosed is a copy of the application for permit to drill and Form C-102.
- 2) Yates is the operator of subject well and is a working interest owner in the N/2 of Section 29. (See Exhibit # 1 enclosed)
- 3) The Rolla TC was spudded on July 2, 1991, completed in December, 1991 and has continued to produce up to present.
- 4) At the time of drilling the well it was drilled at a legal location, however, since the time of drilling Division General Rule 104.C has been modified making the current well an unorthodox location if it was to be drilled today.
- 5) Yates proposes to re-complete the Rolla TC #2 an unorthodox oil or gas well location of 1,980' feet from the North line and 2,310' feet from the East line (Unit G) of Section 29, Township 9 South, Range 26 East, NMPM, Chaves County, New Mexico.

- 6) The subject well is to be re-completed in an attempt to establish gas production from the Penn formation or additional depths in Wolfcamp formation from the existing wellbore.
- 7) The leases on which the well is located are past their primary term and production is required to continue to maintain the leases.
- 8) The leases on which the well is compose the N/2 of Section 29 and only encroach on these leases. (See Form C-102)
- 9) Since the well only encroaches on this lease, no other operators are affected.

Wherefore, Yates Petroleum Corporation requests an administrative order from the Division that approves the Rolla TC #2 for production from all formations requiring a spacing unit of 320 acres, including the Ordovician, Penn, Cisco and Wolfcamp formations.

Respectfully submitted,

YATES PETROLEUM CORPORATION



Chuck Moran
Landman

Enclosures: Original C-104
Original APD

Submit to Appropriate
District Office
State Lease - 6 copies
Fee Lease - 5 copies

DISTRICT I
P.O. Box 1980, Hobbs, NM 88240

DISTRICT II
P.O. Drawer DD, Artesia, NM 88210

DISTRICT III
1000 Rio Brazos Rd., Aztec, NM 87410

State of New Mexico
Energy, Minerals and Natural Resources Department

OIL CONSERVATION DIVISION

P.O. Box 2088
Santa Fe, New Mexico 87504-2088

Form C-101
Revised 1-1-89

API NO. (assigned by OCD on New Wells)

30-005-62822

5. Indicate Type of Lease

STATE ☐

FEE ☒

6. State Oil & Gas Lease No.

APPLICATION FOR PERMIT TO DRILL, DEEPEN, OR PLUG BACK

1a. Type of Work:

DRILL ☒

RE-ENTER ☐

DEEPEN ☐

PLUG BACK ☐

b. Type of Well:

OIL

WELL ☐

GAS

WELL ☒

OTHER ☐

SINGLE

ZONE ☐

MULTIPLE

ZONE ☐

2. Name of Operator

Yates Petroleum Corporation

3. Address of Operator

105 South Fourth Street, Artesia, NM 88210

7. Lease Name or Unit Agreement Name

McQuiddy "ATH"

Rolla TC

8. Well No.

2

9. Pool name or Wildcat

Wildcat Ordovician

4. Well Location

Unit Letter

G

: 1980

Feet From The

North

Line and

2310

Feet From The

East

Line

Section

29

Township

9 South

Range

26 East

NMPM

Chaves

County

10. Proposed Depth

6200'

11. Formation

Ordovician

12. Rotary or C.T.

Rotary

13. Elevations (Show whether DF, RT, GR, etc.)

3761' GR

14. Kind & Status Plug. Bond

Blanket

15. Drilling Contractor

Undesignated

16. Approx. Date Work will start

ASAP

17.

PROPOSED CASING AND CEMENT PROGRAM

SIZE OF HOLE	SIZE OF CASING	WEIGHT PER FOOT	SETTING DEPTH	SACKS OF CEMENT	EST. TOP
12 1/4"	8 5/8"	24# K-55	Approx. 1000'	600 sacks	Circulate
7 7/8"	5 1/2"	15.5# J-55	TD	450 sacks	

We propose to drill and test the Ordovician and intermediate formations. Approximately 1000' of surface casing will be set and cement circulated to shut off gravel and cavings. If commercial, production casing will be run and cemented with adequate cover, perforated and stimulated as needed for production.

MUD PROGRAM: FW gel & LCM to 1000'; cut brine to 4500'; salt water gel & starch to TD.

BOP PROGRAM: BOP's will be tested daily and installed at the offset.

GAS NOT DEDICATED.

APPROVAL VALID FOR 180 DAYS

PERMIT EXPIRES 7/11/91

UNLESS DRILLING UNDERWAY

IN ABOVE SPACE DESCRIBE PROPOSED PROGRAM: IF PROPOSAL IS TO DEEPEN OR PLUG BACK, GIVE DATA ON PRESENT PRODUCTIVE ZONE AND PROPOSED NEW PRODUCTIVE ZONE. GIVE BLOWOUT PREVENTER PROGRAM, IF ANY.

I hereby certify that the information above is true and complete to the best of my knowledge and belief.

SIGNATURE

Clifton R. May

TITLE

Permit Agent

DATE

1-4-91

TYPE OR PRINT NAME

Clifton R. May

TELEPHONE NO.

748-1471

(This space for State Use) ORIGINAL SIGNED BY

MIKE WILLIAMS

APPROVED BY

SUPERVISOR, DISTRICT II

TITLE

DATE

JAN 11 1991

CONDITIONS OF APPROVAL, IF ANY:

7
Sent to partners. 7-1-91 CS ✓

Submit to Appropriate
District Office
State Lease - 4 copies
Fee Lease - 3 copies

State of New Mexico
Energy, Minerals and Natural Resources Department

Form C-102
Revised 1-1-89

OIL CONSERVATION DIVISION

P.O. Box 2088
Santa Fe, New Mexico 87504-2088

DISTRICT I
P.O. Box 1980, Hobbs, NM 88240

DISTRICT II
P.O. Drawer DD, Artesia, NM 88210

DISTRICT III
1000 Rio Brazos Rd., Aztec, NM 87410

WELL LOCATION AND ACREAGE DEDICATION PLAT

All Distances must be from the outer boundaries of the section

Operator YATES PETROLEUM CORPORATION			Lease Rolla TC McQUIDDY "A1H"		Well No. 2
Unit Letter G	Section 29	Township 9 SOUTH	Range 26 EAST	County CHAVES	
Actual Footage Location of Well: 2310 feet from the EAST line and 1980 feet from the NORTH line					
Ground level Elev. 3761.0	Producing Formation ORDOVICIAN		Pool WILDCAT ORDOVICIAN		Dedicated Acreage: 320 Acres

1. Outline the acreage dedicated to the subject well by colored pencil or hatchure marks on the plat below.

2. If more than one lease is dedicated to the well, outline each and identify the ownership thereof (both as to working interest and royalty).

3. If more than one lease of different ownership is dedicated to the well, have the interest of all owners been consolidated by communitization, unitization, force-pooling, etc.?

☐ Yes

☐ No

If answer is "yes" type of consolidation

If answer is "no" list the owners and tract descriptions which have actually been consolidated. (Use reverse side of this form if necessary.)

No allowable will be assigned to the well until all interests have been consolidated (by communitization, unitization, forced-pooling, or otherwise) or until a non-standard unit, eliminating such interest, has been approved by the Division.

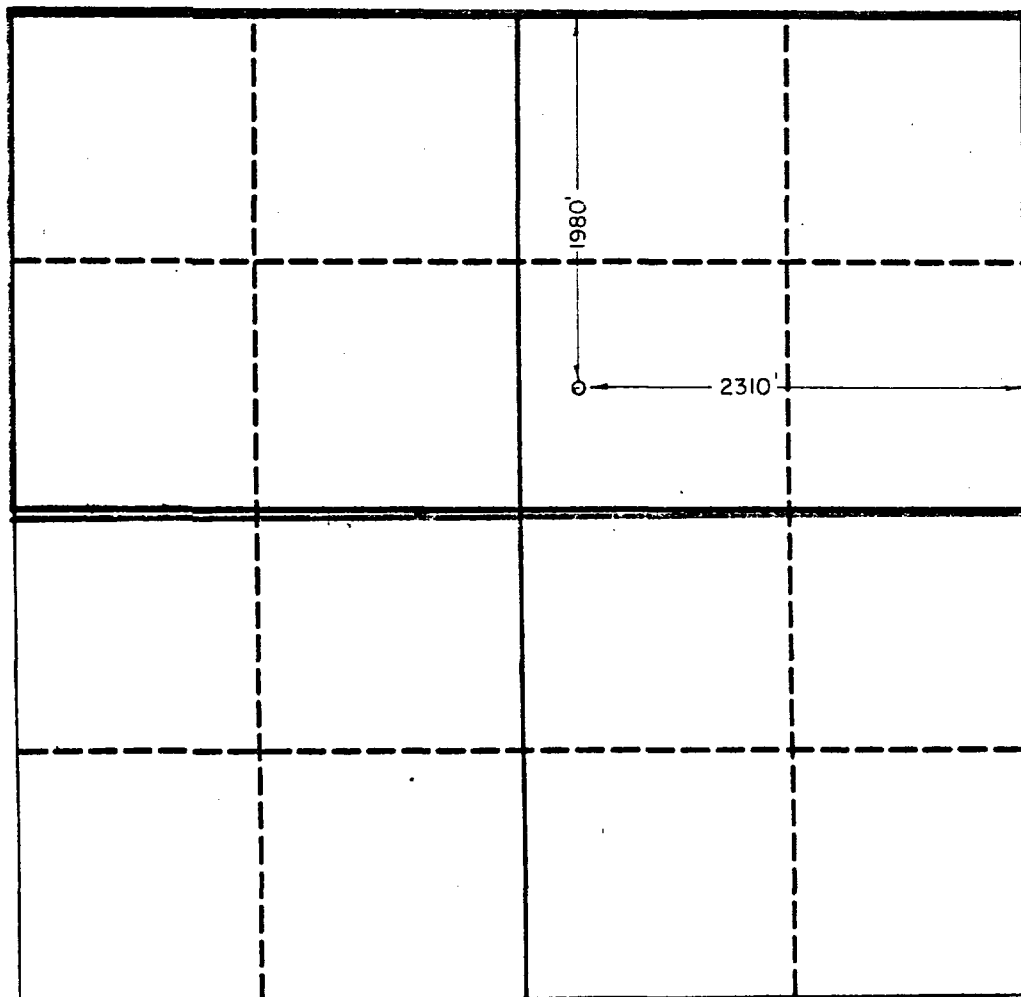

OPERATOR CERTIFICATION

I hereby certify that the information contained herein is true and complete to the best of my knowledge and belief.

Signature

Clifton R. May

Printed Name

Clifton R. May

Position

Permit Agent

Company

Yates Petroleum Corp.

Date

1-4-91

SURVEYOR CERTIFICATION

I hereby certify that the well location shown on this plat was plotted from field notes of actual surveys made by me or under my supervision, and that the same is true and correct to the best of my knowledge and belief.

Date Surveyed

12/22/90

Signature & Seal of
Professional Surveyor

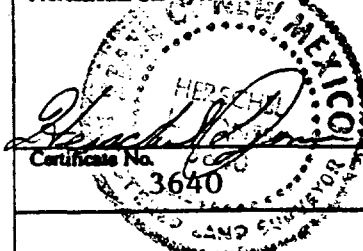

0 330 660 990 1320 1650 1980 2310 2640 2000 1500 1000 500 0

YATES PETROLEUM CORPORATION

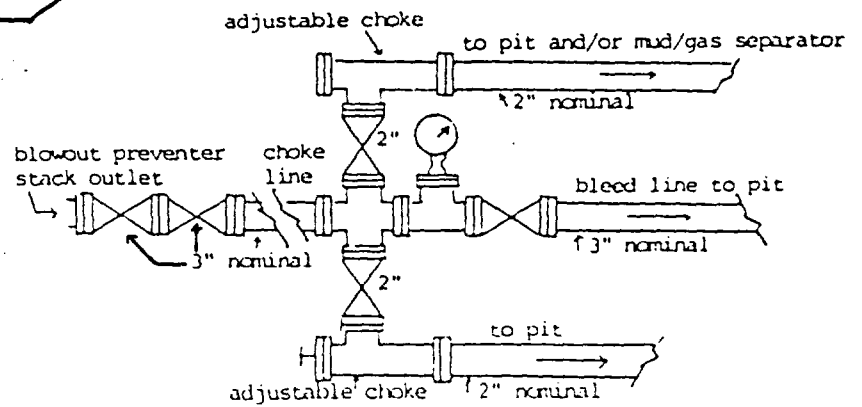
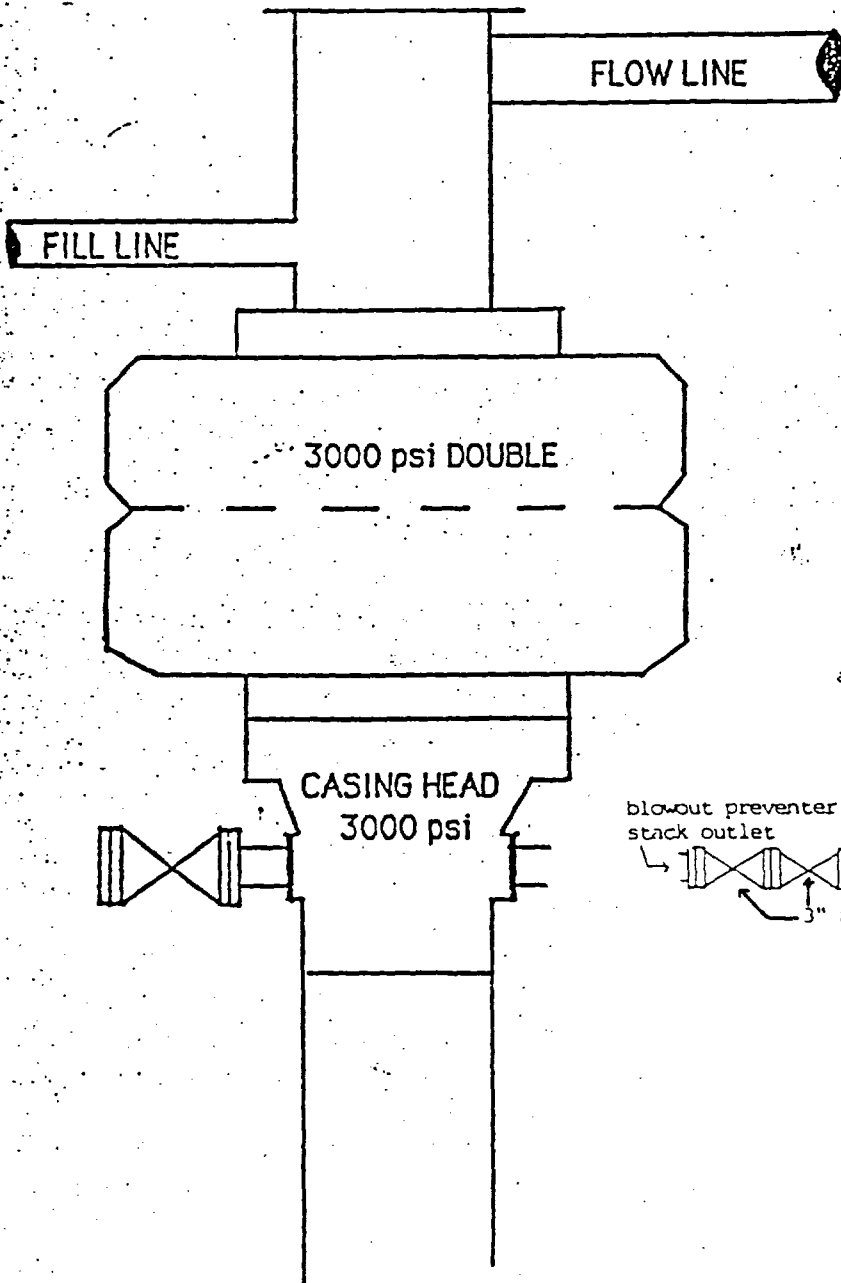

typical choke manifold assembly for 3M rated
working pressure service-surface installation

**BLOWOUT PREVENTER
3M SYSTEM**

Submit to Appropriate
District Office
State Lease - 6 copies
Fee Lease - 5 copies
DISTRICT I
P.O. Box 1980, Hobbs, NM 88240

DISTRICT II
P.O. Drawer DD, Artesia, NM 88210

DISTRICT III
1000 Rio Brazos Rd., Aztec, NM 87410

State of New Mexico
Energy, Minerals and Natural Resources Department

OIL CONSERVATION DIVISION
P.O. Box 2088
Santa Fe, New Mexico 87504-2088

Form C-105
Revised 1-1-89

WELL API NO. 30-005-62822
5. Indicate Type of Lease STATE <input type="checkbox"/> FEE <input checked="" type="checkbox"/>
6. State Oil & Gas Lease No.

WELL COMPLETION OR RECOMPLETION REPORT AND LOG

1a. Type of Well: OIL WELL <input type="checkbox"/> GAS WELL <input checked="" type="checkbox"/> DRY <input type="checkbox"/> OTHER _____		7. Lease Name or Unit Agreement Name Rolla TC	
b. Type of Completion: NEW WELL <input checked="" type="checkbox"/> WORK OVER <input type="checkbox"/> DEEPEN <input type="checkbox"/> PLUG BACK <input type="checkbox"/> DIFF RESVR <input type="checkbox"/> OTHER _____			
2. Name of Operator YATES PETROLEUM CORPORATION (505) 748-1471		8. Well No. 2	
3. Address of Operator 105 South 4th St., Artesia, NM 88210		9. Pool name or Wildcat Undes. Wolfcamp	
4. Well Location Unit Letter <u>G</u> : <u>1980</u> Feet From The <u>North</u> Line and <u>2310</u> Feet From The <u>East</u> Line Section <u>29</u> Township <u>9S</u> Range <u>26E</u> NMPM Chaves County			
10. Date Spudded 7-2-91	11. Date T.D. Reached 7-20-91	12. Date Compl. (Ready to Prod.) 12-30-91	13. Elevations (DF & RKB, RT, GR, etc.) 3761' GR
15. Total Depth 6125'	16. Plug Back T.D. 5540'	17. If Multiple Compl. How Many Zones?	18. Intervals Drilled By Rotary Tools 0-6125' Cable Tools
19. Producing Interval(s), of this completion - Top, Bottom, Name 5041-5046' Wolfcamp			20. Was Directional Survey Made No
21. Type Electric and Other Logs Run CNL/LDT; DLL; LSS			22. Was Well Cored No

CASING RECORD (Report all strings set in well)

CASING SIZE	WEIGHT LB/FT.	DEPTH SET	HOLE SIZE	CEMENTING RECORD	AMOUNT PULLED
20"		53'	26"	150 sx	
9-5/8"	36#	1013'	14-3/4"	750 sx	
5-1/2"	15.5#	6125'	7-7/8"	1880 sx	

LINER RECORD				TUBING RECORD		
SIZE	TOP	BOTTOM	SACKS CEMENT	SIZE	DEPTH SET	PACKER SET
				2-7/8"	4954'	4954'

26. Perforation record (interval, size, and number) 5041-5046' w/10 - .50" Holes	27. ACID, SHOT, FRACTURE, CEMENT, SQUEEZE, ETC.	
	DEPTH INTERVAL	AMOUNT AND KIND MATERIAL USED
	5041-5046'	w/1000g. 7 1/2% NEFE acid.

PRODUCTION							
Date First Production 12-30-91		Production Method (Flowing, gas lift, pumping - Size and type pump) Flowing				Well Status (Prod. or Shut-in) SI-WOPLC	
Date of Test 12-30-91	Hours Tested 24	Choke Size 11/64"	Prod'n For Test Period	Oil - Bbl. -	Gas - MCF 144	Water - Bbl. -	Gas - Oil Ratio -
Flow Tubing Press. 200	Casing Pressure Pkr	Calculated 24-Hour Rate	Oil - Bbl. -	Gas - MCF 144	Water - Bbl. -	Oil Gravity - API - (Corr.) -	

29. Disposition of Gas (Sold, used for fuel, vented, etc.) Vented - will be sold	Test Witnessed By David Weaver
---	-----------------------------------

30. List Attachments
Deviation Survey, Logs, DST

31. I hereby certify that the information shown on both sides of this form is true and complete to the best of my knowledge and belief

Signature Juanita Goodlett Printed Name Juanita Goodlett Title Production Supv. Date 1-6-92

INSTRUCTIONS

This form is to be filed with the appropriate District Office of the Division not later than 20 days after the completion of any newly-drilled or deepened well. It shall be accompanied by one copy of all electrical and radio-activity logs run on the well and a summary of all special tests conducted, including drill stem tests. All depths reported shall be measured depths. In the case of directionally drilled wells, true vertical depths shall also be reported. For multiple completions, Items 25 through 29 shall be reported for each zone. The form is to be filed in quintuplicate except on state land, where six copies are required. See Rule 1105.

INDICATE FORMATION TOPS IN CONFORMANCE WITH GEOGRAPHICAL SECTION OF STATE

Southeastern New Mexico

T. Anhy _____	T. Canyon _____
T. Salt _____	T. Strawn _____
B. Salt _____	T. Atoka _____
T. Yates _____	T. Miss _____ 5741
T. 7 Rivers _____	T. Devonian _____
T. Queen _____	T. Silurian - Ordovician - 5776
T. Grayburg _____	T. Montoya _____
T. San Andres _____ 870	T. Simpson _____
T. Glorieta _____ 2016	T. McKee _____
T. Paddock YESO 2072	T. Ellenburger _____
T. Blinebry _____	T. Gr. Wash _____
T. Tubb _____	T. Delaware Sand _____
T. Drinkard _____	T. Bone Springs _____
T. Abo _____ 4265	T. Precambrian 6042
T. Wolfcamp _____ 4950	T. _____
T. Penn. Clastic 5600	T. _____
T. Cisco (Bough C) _____	T. _____

Northwestern New Mexico

T. Ojo Alamo _____	T. Penn. "B" _____
T. Kirtland-Fruitland _____	T. Penn. "C" _____
T. Pictured Cliffs _____	T. Penn. "D" _____
T. Cliff House _____	T. Leadville _____
T. Menefee _____	T. Madison _____
T. Point Lookout _____	T. Elbert _____
T. Mancos _____	T. McCracken _____
T. Gallup _____	T. Ignacio Otzte _____
Base Greenhorn _____	T. Granite _____
T. Dakota _____	T. _____
T. Morrison _____	T. _____
T. Todilto _____	T. _____
T. Entrada _____	T. _____
T. Wingate _____	T. _____
T. Chinle _____	T. _____
T. Permian _____	T. _____
T. Penn "A" _____	T. _____

OIL OR GAS SANDS OR ZONES

No. 1, from _____ to _____	No. 3, from _____ to _____
No. 2, from _____ to _____	No. 4, from _____ to _____

IMPORTANT WATER SANDS

Include data on rate of water inflow and elevation to which water rose in hole.

No. 1, from _____ to _____ feet
No. 2, from _____ to _____ feet
No. 3, from _____ to _____ feet

LITHOLOGY RECORD (Attach additional sheet if necessary)

From	To	Thickness in Feet	Lithology	From	To	Thickness in Feet	Lithology
0	40	40	Surface, Rock				
40	2004	1964	Anhy, Redbeds				
2004	2853	849	Salt, anhy				
2853	3240	387	Anhy				
3240	3550	310	Dolo, SS, Anhy				
3550	3670	120	Dolo, Sh, Anhy				
3670	3800	130	Dolo, SS, Anhy, Sh				
3800	4000	200	Dolo, Sh, Anhy				
4000	4180	180	Anhy, Dolo, SS				
4180	4230	50	Anhy, Sh, Dolo				
4230	4300	70	Anhy, sh				
4300	4930	630	Sh				
4930	5660	730	Sh, LS				
5660	5780	120	Sh, LS, SS				
5780	6030	250	Dolo, LS, Sh				
6030	6125	95	Gr. Wash, Granite				

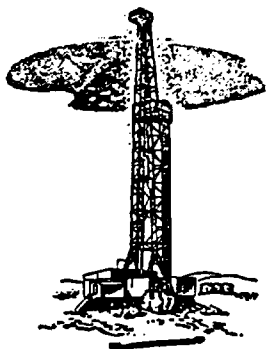

Telephone (505) 748-2205

L & M DRILLING, INC. — Oil Well Drilling Contractors

P. O. BOX 470 / ARTESIA, NEW MEXICO 88210

July 30, 1991

Yates Petroleum Corporation
105 South Fourth Street
Artesia, NM 88210

RE: Rolla TC #2
1980' FNL & 2310' FEL
Sec. 29, T9S, R25E
Chaves County, NM

Gentlemen:

The following is a Deviation Survey for the above captioned well.

DEPTH	DEVIATION
501'	1°
1013'	3/4°
1500'	1/4°
2004'	1/4°
2494'	1/4°
2970'	1/4°
3551'	1/4°
3995'	1°
4526'	1°
5021'	1 1/4°
5522'	1 1/4°
6125'	1 1/4°

Very truly yours,

C. E. LaRue

STATE OF NEW MEXICO §
COUNTY OF EDDY §

The foregoing was acknowledged before
me this 30th day of July, 1991.

NOTARY PUBLIC



YATES PETROLEUM CORPORATION

DRILL STEM TESTS

Rolla TC #2
Unit G, 1980' FNL & 2310" FEL
Sec. 29-T9S-R26E
Chaves County, NM

DST #1 5792-5915' Ordovician: TIMES: 5", 60", 60", 180", 60". RECOVERY:
150' drilling mud - Chl 94000. SAMPLER: .38 cfg, 75 psi @ 80°. Gas only
in sampler. PRESSURES: IHP 3005, IFP 81-102, ISIP 506, 2nd FP 52-86, 2nd
SIP 583, FFP 46-79, FHP 2979.

OIL CONSERVATION DIVISION

P.O. Box 2088
Santa Fe, New Mexico 87504-2088

DISTRICT I
P.O. Box 1980, Hobbs, NM 88240

DISTRICT II
P.O. Drawer DD, Artesia, NM 88210

DISTRICT III
1000 Rio Brazos Rd., Aztec, NM 87410

WELL LOCATION AND ACREAGE DEDICATION PLAT

All Distances must be from the outer boundaries of the section

Operator YATES PETROLEUM CORPORATION			Lease Rolla TC		Well No. 2
Unit Letter G	Section 29	Township 9-S	Range 26-E	County Chaves	
Actual Footage Location of Well: 1980 feet from the North line and 2310 feet from the East line					
Ground level Elev. 3761'	Producing Formation Wolfcamp		Pool Undesignated	Dedicated Acreage: 320 Acres	

1. Outline the acreage dedicated to the subject well by colored pencil or hatchure marks on the plat below.

2. If more than one lease is dedicated to the well, outline each and identify the ownership thereof (both as to working interest and royalty).

3. If more than one lease of different ownership is dedicated to the well, have the interest of all owners been consolidated by communitization, unitization, force-pooling, etc.?

☐ Yes ☐ No If answer is "yes" type of consolidation

If answer is "no" list the owners and tract descriptions which have actually been consolidated. (Use reverse side of this form if necessary.)

No allowable will be assigned to the well until all interests have been consolidated (by communitization, unitization, forced-pooling, or otherwise) or until a non-standard unit, eliminating such interest, has been approved by the Division.

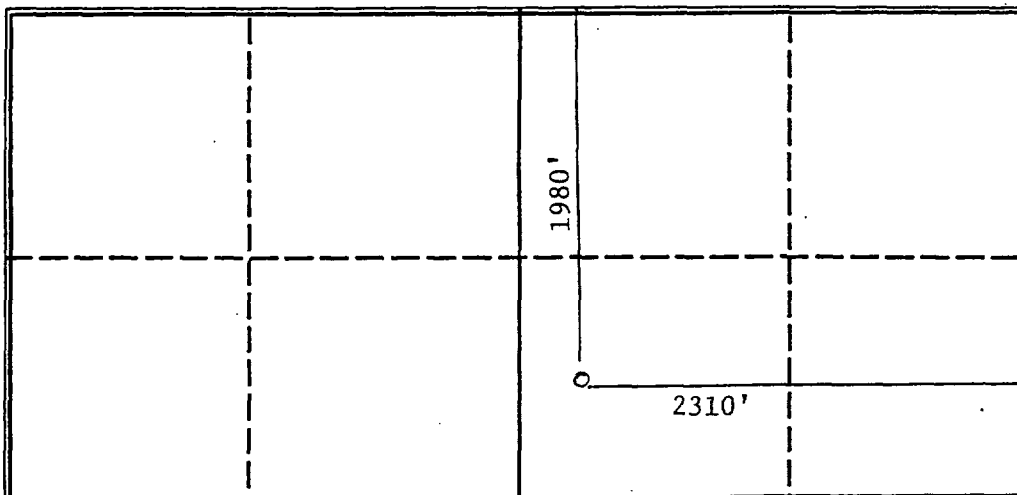

OPERATOR CERTIFICATION

I hereby certify that the information contained herein is true and complete to the best of my knowledge and belief.

Signature

Juanita Goodlett

Printed Name

JUANITA GOODLETT

Position

PRODUCTION SUPERVISOR

Company

YATES PETROLEUM CORPORATION

Date

1-6-92

SURVEYOR CERTIFICATION

I hereby certify that the well location shown on this plat was plotted from field notes of actual surveys made by me or under my supervision, and that the same is true and correct to the best of my knowledge and belief.

Date Surveyed

Refer to original plat

Signature & Seal of dated 12/22/90
Professional Surveyor

Certificate No.

0 330 660 990 1320 1650 1980 2310 2640 2000 1500 1000 500 0

Submit 5 Copies
Appropriate District Office
DISTRICT I
P.O. Box 1980, Hobbs, NM 88240

DISTRICT II
P.O. Drawer DD, Artesia, NM 88210

DISTRICT III
1000 Rio Brazos Rd., Aztec, NM 87410

State of New Mexico
Energy, Minerals and Natural Resources Department

OIL CONSERVATION DIVISION

P.O. Box 2088
Santa Fe, New Mexico 87504-2088

RECEIVED

MAY 29 1992

Form C-104
Revised 1-1-89
See Instructions
at Bottom of Page

REQUEST FOR ALLOWABLE AND AUTHORIZATION TO TRANSPORT OIL AND NATURAL GAS

O. C. D.
ARTESIA OFFICE

Operator YATES PETROLEUM CORPORATION		Well API No. 30-005-62822
Address 105 South 4th St., Artesia, NM 88210		
Reason(s) for Filing (Check proper box) <input type="checkbox"/> Other (Please explain)		
New Well <input checked="" type="checkbox"/>	Change in Transporter of:	
Recompletion <input type="checkbox"/>	Oil <input type="checkbox"/> Dry Gas <input type="checkbox"/>	
Change in Operator <input type="checkbox"/>	Casinghead Gas <input type="checkbox"/> Condensate <input type="checkbox"/>	
If change of operator give name and address of previous operator		

II. DESCRIPTION OF WELL AND LEASE

Lease Name Rolla TC	Well No. 2	Pool Name, Including Formation Undesignated Wolfcamp	Kind of Lease State, Federal or Fee	Lease No.
Location Unit Letter <u>G</u> : 1980 Feet From The <u>North</u> Line and <u>2310</u> Feet From The <u>East</u> Line Section <u>29</u> Township <u>9S</u> Range <u>26E</u> , NMPM, Chaves County				

III. DESIGNATION OF TRANSPORTER OF OIL AND NATURAL GAS

Name of Authorized Transporter of Oil <input type="checkbox"/> or Condensate <input checked="" type="checkbox"/> Navajo Refining Co.	Address (Give address to which approved copy of this form is to be sent) PO Box 159, Artesia, NM 88210	
Name of Authorized Transporter of Casinghead Gas <input type="checkbox"/> or Dry Gas <input checked="" type="checkbox"/> Yates Petroleum Corporation	Address (Give address to which approved copy of this form is to be sent) 105 South 4th St., Artesia, NM 88210	
If well produces oil or liquids, give location of tanks.	Unit G	Sec. 29
	Twp. 9s	Rge. 25e
	Is gas actually connected? Yes	When? 5-26-92

If this production is commingled with that from any other lease or pool, give commingling order number:

IV. COMPLETION DATA

Designate Type of Completion - (X)	Oil Well	Gas Well	New Well	Workover	Deepen	Plug Back	Same Res'v	Diff Res'v
		X	X					
Date Spudded 7-2-91	Date Compl. Ready to Prod. 12-30-91		Total Depth 6125'		P.B.T.D. 5540'			
Elevations (DF, RKB, RT, GR, etc.) 3761' GR	Name of Producing Formation Wolfcamp		Top Oil/Gas Pay 5041'		Tubing Depth 4954'			
Perforations 5041-5046'					Depth Casing Shoe 6125'			
TUBING, CASING AND CEMENTING RECORD								
HOLE SIZE	CASING & TUBING SIZE		DEPTH SET		SACKS CEMENT			
26"			53'		150 sx			
14-3/4"	9-5/8"		1013'		750 sx			
7-7/8"	5-1/2"		6125'		1880 sx			
	2-7/8"		4954'					

V. TEST DATA AND REQUEST FOR ALLOWABLE

OIL WELL (Test must be after recovery of total volume of load oil and must be equal to or exceed top allowable for this depth or be for full 24 hours.)

Date First New Oil Run To Tank	Date of Test	Producing Method (Flow, pump, gas lift, etc.)	
Length of Test	Tubing Pressure	Casing Pressure	Choke Size
Actual Prod. During Test	Oil - Bbls.	Water - Bbls.	Gas- MCF

GAS WELL

Actual Prod. Test - MCF/D 144	Length of Test 24 hrs	Bbls. Condensate/MMCF -	Gravity of Condensate -
Testing Method (pilot, back pr.) Back Pressure	Tubing Pressure (Shut-in) 200	Casing Pressure (Shut-in) Pkr	Choke Size 11/64"

VI. OPERATOR CERTIFICATE OF COMPLIANCE

I hereby certify that the rules and regulations of the Oil Conservation Division have been complied with and that the information given above is true and complete to the best of my knowledge and belief.

Signature
Juanita Goodlett - Production Supvr.
Printed Name
5-26-92
Date
(505) 748-1471
Telephone No.

OIL CONSERVATION DIVISION

Date Approved **JUN 3 1992**

By **ORIGINAL SIGNED BY**
MIKE WILLIAMS
Title **SUPERVISOR, DISTRICT II**

INSTRUCTIONS: This form is to be filed in compliance with Rule 1104

- 1) Request for allowable for newly drilled or deepened well must be accompanied by tabulation of deviation tests taken in accordance with Rule 111.
- 2) All sections of this form must be filled out for allowable on new and recompleted wells.
- 3) Fill out only Sections I, II, III, and VI for changes of operator, well name or number, transporter, or other such changes.
- 4) Separate Form C-104 must be filed for each pool in multiply completed wells.

District I
PO Box 1900, Hobbs, NM 88241-1900

District II
PO Drawer DD, Artesia, NM 88211-0719

District III
1000 Rio Branco Rd., Aztec, NM 87410

District IV
PO Box 2000, Santa Fe, NM 87504-2000

State of New Mexico
Energy, Minerals & Natural Resources Department

Form C-104
Revised February 10, 1994
Instructions on back
Appropriate District Office
5 Copies

OIL CONSERVATION DIVISION
PO Box 2088
Santa Fe, NM 87504-2088

☐ AMENDED REPORT

REQUEST FOR ALLOWABLE AND AUTHORIZATION TO TRANSPORT

Yates Petroleum Corporation 105 South Fourth Street Artesia, NM 88210		OGRID Number 025575
		Reason for FILING Code CG-Effective 10-1-95
AFI Number 30-005-62822	Pool Name Foor Ranch Wolfcamp North	Pool Code 76755
Property Code 12691	Property Name Rolla TC	Well Number 2

II. ¹⁰ Surface Location

U or lot no.	Section	Township	Range	Lot Ida	Feet from the	North/South Line	Feet from the	East/West Line	Cosary
G	29	9S	26E		1980	N	2310	E	Chaves

11 Bottom Hole Location

UL or lot no.	Section	Township	Range	Lot Ida	Feet from the	North/South line	Feet from the	East/West line	County
" Lee Code P	" Producing Method Code F	" Gas Connection Date			" C-129 Permit Number		" C-129 Effective Date		" C-129 Expiration Date

III. Oil and Gas Transporters

" Transporter OGRID	" Transporter Name and Address	" POD	" O/G	" POD ULSTR Location and Description
015694	Navajo Refining Co P.O. Drawer 159 Artesia, NM 88210	2684110	O	Unit G-Section 29-T9S-R26E
147831	Agave Energy Co 105 S. 4th Street Artesia, NM 88210	2684130	G	Unit G-Section 29-T9S-R26E
				AUG 20 1996
				OIL CON. DIV. DIST. 2

IV. Produced Water

POD	POD ULSTR Location and Description
2684150	Unit G - Section 29 - T9S - R26E

V. Well Completion Data

Well Completion Data				
" Spud Date	" Ready Date	" TD	" PBTD	" Perforations
" Hole Size	" Casing & Tubing Size	" Depth Set	" Sacks Cement	

VI. Well Test Data

" Date New Oil	" Gas Delivery Date	" Test Date	" Test Length	" Tbg. Pressure	" Csg. Pressure
" Choke Size	" Oil	" Water	" Gas	" AOF	" Test Method

* I hereby certify that the rules of the Oil Conservation Division have been complied with and that the information given above is true and complete to the best of my knowledge and belief. Signature: <i>Rusty Klein</i>		OIL CONSERVATION DIVISION Approved by: ORIGINAL SIGNED BY TIM W. GUM DISTRICT #1 SUPERVISOR	
Printed name: Rusty Klein		Title:	
Title: Production Clerk		Approval Date: AUG 23 1986	
Date: 8-19-96	Phone: 505-748-1471		
" If this is a change of operator fill in the OGRID number and name of the previous operator			
Previous Operator Signature	Printed Name	Title	Date

CMD :
OG5SECT

ONGARD
INQUIRE LAND BY SECTION

07/16/01 11:45:33
OGOMES -TPSN
PAGE NO: 1

Sec : 29 Twp : 09S Rng : 26E Section Type : NORMAL

D 40.00	C 40.00	B 40.00	A 40.00
Fee owned	Fee owned	Fee owned	Fee owned
E 40.00	F 40.00	G 40.00	H 40.00
Fee owned	Fee owned	Fee owned A	Fee owned

PF01 HELP PF02 PF03 EXIT PF04 GoTo PF05 PF06

PF07 BKWD PF08 FWD PF09 PRINT PF10 SDIV PF11 PF12

CMD :
OG5SECT

ONGARD
INQUIRE LAND BY SECTION

07/16/01 11:45:37
OGOMES -TPSN
PAGE NO: 2

Sec : 29 Twp : 09S Rng : 26E Section Type : NORMAL

L 40.00	K 40.00	J 40.00	I 40.00
Federal owned	Federal owned	Federal owned	Federal owned
M 40.00	N 40.00	O 40.00	P 40.00
Federal owned	Federal owned	Federal owned	Federal owned

PF01 HELP	PF02	PF03 EXIT	PF04 GoTo	PF05	PF06
PF07 BKWD	PF08 FWD	PF09 PRINT	PF10 SDIV	PF11	PF12

CMD : ONGARD 07/16/01 11:45:49
OG6IWCM INQUIRE WELL COMPLETIONS OGOMES -TPSN

API Well No : 30 5 62822 Eff Date : 12-01-1992 WC Status : A
Pool Idn : 76755 FOOR RANCH;WOLFCAMP, NORTH (GAS)
OGRID Idn : 25575 YATES PETROLEUM CORPORATION
Prop Idn : 12691 ROLLA TC

Well No : 002
GL Elevation: 99999

	U/L	Sec	Township	Range	North/South	East/West	Prop/Act (P/A)
	---	---	-----	-----	-----	-----	-----
B.H. Locn : G	29	09S	26E	FTG 1980 F N	FTG 2310 F E		P

Lot Identifier:
Dedicated Acre: 320.00
Lease Type : P
Type of consolidation (Comm, Unit, Forced Pooling - C/U/F/O) :

M0025: Enter PF keys to scroll

PF01 HELP	PF02	PF03 EXIT	PF04 GoTo	PF05	PF06
PF07	PF08	PF09	PF10 NEXT-WC	PF11 HISTORY	PF12 NXTREC

CMD : ONGARD 07/16/01 11:45:57
 OG6ACRE C102-DEDICATE ACREAGE OGOMES -TPSN
 Page No : 1

API Well No : 30 5 62822 Eff Date : 12-01-1992
 Pool Idn : 76755 FOOR RANCH;WOLFCAMP, NORTH (GAS)
 Prop Idn : 12691 ROLLA TC Well No : 002
 Spacing Unit : 47836 OCD Order : Simultaneous Dedication:
 Sect/Twp/Rng : Acreage : 320.00 Revised C102? (Y/N) :
 Dedicated Land:

S	Base	U/L	Sec	Twp	Rng	Acreage	L/W	Ownership	Lot	Idn
	A	29	09S	26E	40.00	N	FE			
	B	29	09S	26E	40.00	N	FE			
	C	29	09S	26E	40.00	N	FE			
	D	29	09S	26E	40.00	N	FE			
	E	29	09S	26E	40.00	N	FE			
	F	29	09S	26E	40.00	N	FE			
	G	29	09S	26E	40.00	N	FE			
	H	29	09S	26E	40.00	N	FE			

E0005: Enter data to modify or PF keys to scroll

PF01 HELP PF02 PF03 EXIT PF04 GoTo PF05 PF06 CONFIRM
 PF07 BKWD PF08 FWD PF09 PF10 LAND PF11 NXTSEC PF12 RECONF

CMD : ONGARD 07/16/01 11:46:06
OG6IPRD INQUIRE PRODUCTION BY POOL/WELL OGOMES -TPSN
Page No: 1

OGRID Identifier : 25575 YATES PETROLEUM CORPORATION
Pool Identifier : 76755 FOOR RANCH;WOLFCAMP, NORTH (GAS)
API Well No : 30 5 62822 Report Period - From : 01 2000 To : 06 2001

API Well No	Property Name	Prodn. Days MM/YY Prod	Production Volumes Gas Oil Water	Well Stat
30 5 62822	ROLLA TC	01 00 16	134	F
30 5 62822	ROLLA TC	02 00 23	202	F
30 5 62822	ROLLA TC	03 00 31	211	F
30 5 62822	ROLLA TC	04 00 30	116	F
30 5 62822	ROLLA TC	05 00 7	85	F
30 5 62822	ROLLA TC	06 00 30	246	F
30 5 62822	ROLLA TC	07 00 31	225	F

Reporting Period Total (Gas, Oil) :

M0025: Enter PF keys to scroll

PF01 HELP	PF02	PF03 EXIT	PF04 GoTo	PF05	PF06 CONFIRM
PF07 BKWD	PF08 FWD	PF09	PF10 NXTPOOL	PF11 NXTOGD	PF12

CMD : ONGARD 07/16/01 11:46:11
 OG6IPRD INQUIRE PRODUCTION BY POOL/WELL OGOMES -TPSN
 Page No: 2

OGRID Identifier : 25575 YATES PETROLEUM CORPORATION
 Pool Identifier : 76755 FOOR RANCH;WOLFCAMP, NORTH (GAS)
 API Well No : 30 5 62822 Report Period - From : 01 2000 To : 06 2001

API Well No	Property Name	Prodn. Days MM/YY Prod	Production Volumes Gas Oil Water	Well Stat
30 5 62822	ROLLA TC	08 00		S
30 5 62822	ROLLA TC	09 00 3	2	F
30 5 62822	ROLLA TC	10 00 31	2	F
30 5 62822	ROLLA TC	11 00 26	265	F
30 5 62822	ROLLA TC	12 00 31	3	F
30 5 62822	ROLLA TC	01 01 31	19	F
30 5 62822	ROLLA TC	02 01 21	84	F

Reporting Period Total (Gas, Oil) :

E0049: User may continue scrolling.

PF01 HELP PF02 PF03 EXIT PF04 GoTo PF05 PF06 CONFIRM
 PF07 BKWD PF08 FWD PF09 PF10 NXTPOOL PF11 NXTOGD PF12

CMD :
OG6IPRD

ONGARD
INQUIRE PRODUCTION BY POOL/WELL

07/16/01 11:46:13
OGOMES -TPSN
Page No: 3

OGRID Identifier : 25575 YATES PETROLEUM CORPORATION
Pool Identifier : 76755 FOOR RANCH;WOLFCAMP, NORTH (GAS)
API Well No : 30 5 62822 Report Period - From : 01 2000 To : 06 2001

API Well No	Property Name	Prodn. Days		Production Volumes			Well
		MM/YY	Prod	Gas	Oil	Water	
30	5 62822 ROLLA TC	03 01	24	3			F
30	5 62822 ROLLA TC	04 01					S

Reporting Period Total (Gas, Oil) :

1597

E0049: User may continue scrolling.

PF01 HELPPF02PF03 EXITPF04 GoToPF05PF06 CONFIRM

PF07 BKWDPF08 FWDPF09PF10 NXTPOOLPF11 NXTOGDPF12



Although the information shown on this map was prepared carefully from official records, Midland Map Company shall in no event be liable for any errors or inaccuracies that occur. A thorough check of County records should be made before purchasing any property.

County Chaves

Pool North Foor Ranch-Wolfcamp Gas

TOWNSHIP

9 South

Range

26 East

NMPM

6	5	4	3	2	1	
7	8	9	10	11	12	
18	17	16	15	14	13	
*						
19	20	21	22	23	24	
30	29	28	27	26	25	
31	32	33	34	35	36	

Description: N/2 Sec. 29 (R-9668, 5-6-92)

County Chaves Pool Foor Ranch-PrePermian Gas

TOWNSHIP 9 South

Range 26 East

NMPM

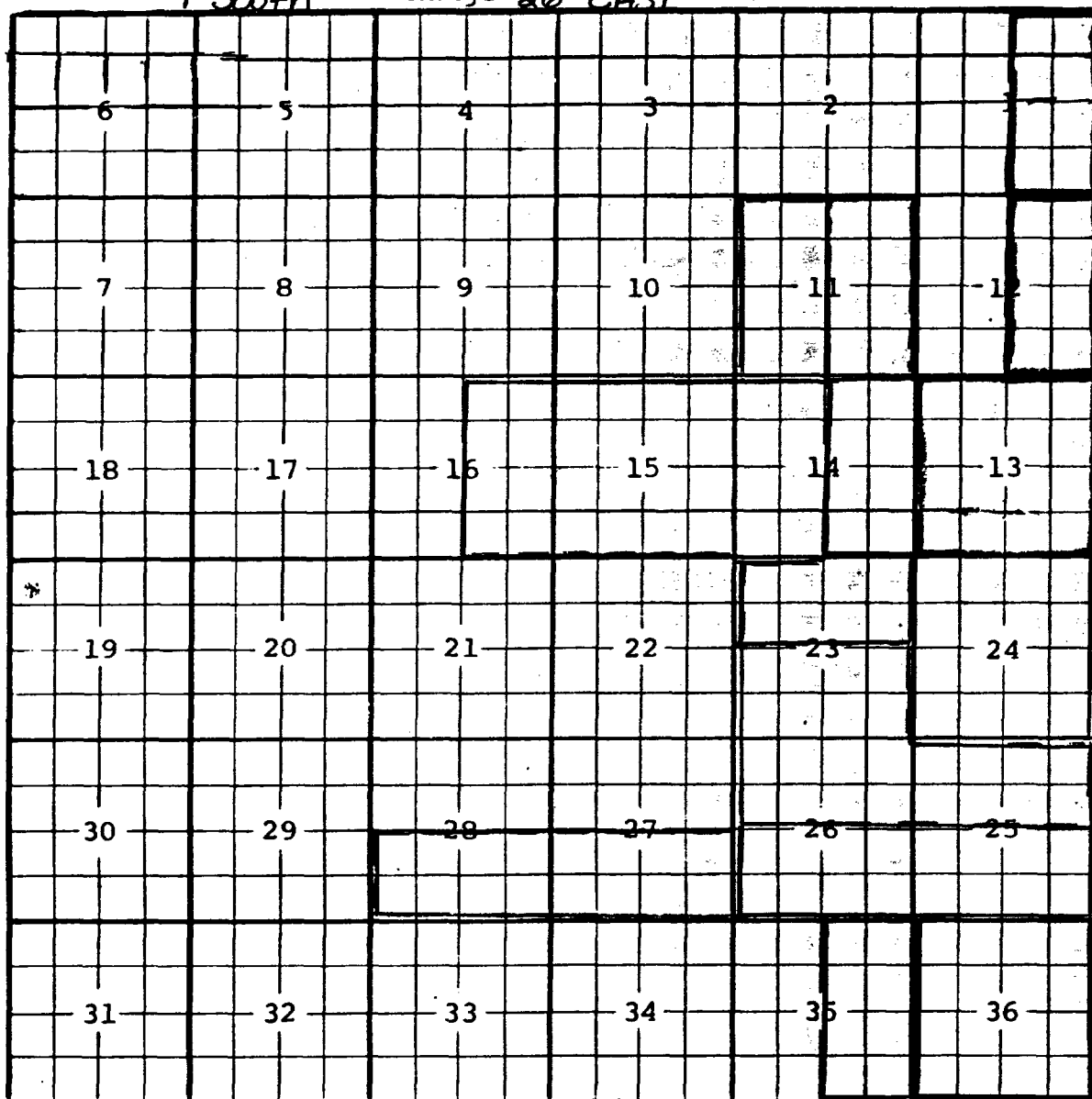

Description: Sec: 1 $\frac{E}{2}$, Sec: 12 $\frac{E}{2}$, Sec: 13 All (R-7048, 8-9-82)
Ext: $\frac{E}{2}$ Sec. 14 (R-7307, 6-14-83) Ext: $\frac{N}{2}$ Sec. 23 (R-7437, 2-6-84)
Ext: $\frac{W}{2}$ Sec. 14, All Sec. 15, $\frac{E}{2}$ Sec. 16 (R-7208, 10-25-84)
Ext: $\frac{E}{2}$ Sec. 11 (R-8592, 1/25/88) Ext: $\frac{W}{2}$ Sec. 11 (R-8665, 6/9/88)
Ext: $\frac{S}{2}$ Sec. 23, $\frac{N}{2}$ Sec. 25, $\frac{N}{2}$ Sec. 26 (R-8747, 9/19/88) Ext: $\frac{S}{2}$ Sec. 25, $\frac{S}{2}$
Sec. 26 (R-8827, 12-22-88) Ext: All Sec. 24 (R-8847, 1-10-89)
Ext: All Sec. 36 (R-8945, 5-31-89) Ext: $\frac{E}{2}$ Sec. 35 (R-8969, 8-1-89)
Ext: $\frac{S}{2}$ Sec. 27, $\frac{S}{2}$ Sec. 28 (R-9326, 11-7-90)

County CHAVES Pool EAST BITTER LAKES - WOLFCAMP GGS

TOWNSHIP

9 South Range 26 East

NMPM

6	5	4	3	2	1
7	8	9	10	11	12
18	17	16	15	14	13
19	20	21	22	23	24
30	29	28	27	26	25
31	32	33	34	35	36

Description: 1/2 Sec. 20 (R-6499, 11-1-80)

District I
PO Box 1988, Hobbs, NM 88241-1988
District II
PO Drawer DD, Artesia, NM 88211-0719
District III
1000 Rio Bravos Rd., Aztec, NM 87410
District IV
PO Box 2088, Santa Fe, NM 87504-2088

State of New Mexico
Energy, Minerals & Natural Resources Department

Form C-104
Revised February 10, 1994
Instructions on back
Submit to Appropriate District Office
5 Copies

OIL CONSERVATION DIVISION
PO Box 2088
Santa Fe, NM 87504-2088

☐ AMENDED REPORT

I. REQUEST FOR ALLOWABLE AND AUTHORIZATION TO TRANSPORT

Operator name and Address Yates Petroleum Corporation 105 South Fourth Street Artesia, NM 88210		OGRID Number 025575
		Reason for Filing Code CG-Effective 10-1-95
API Number 30-005-62822	Pool Name Foor Ranch Wolfcamp North	Pool Code 76755
Property Code 12691	Property Name Rolla TC	Well Number 2

II. Surface Location

UL or lot no.	Section	Township	Range	Lot Ida	Feet from the	North/South Line	Feet from the	East/West line	County
G	29	9S	26E		1980	N	2310	E	Chaves

Bottom Hole Location

UL or lot no.	Section	Township	Range	Lot Ida	Feet from the	North/South line	Feet from the	East/West line	County
Lee Code P	Producing Method Code F	Gas Connection Date		C-129 Permit Number		C-129 Effective Date		C-129 Expiration Date	

III. Oil and Gas Transporters

Transporter OGRID	Transporter Name and Address	POD	O/G	POD ULSTR Location and Description
015694	Navajo Refining Co P.O. Drawer 159 Artesia, NM 88210	2684110	O	Unit G-Section 29-T9S-R26E
147831	Agave Energy Co 105 S. 4th Street Artesia, NM 88210	2684130	G	Unit G-Section 29-T9S-R26E

RECEIVED

AUG 20 1996

OIL CON. DIV.

IV. Produced Water

POD	POD ULSTR Location and Description
2684150	Unit G - Section 29 - T9S - R26E

V. Well Completion Data

Spud Date	Ready Date	TD	PBTD	Perforations
Hole Size	Casing & Tubing Size	Depth Set	Sacks Cement	

VI. Well Test Data

Date New Oil	Gas Delivery Date	Test Date	Test Length	Tbg. Pressure	Cog. Pressure
Choke Size	Oil	Water	Gas	AOF	Test Method

I hereby certify that the rules of the Oil Conservation Division have been complied with and that the information given above is true and complete to the best of my knowledge and belief.

Signature:

Rusty Klein

Printed name:

Rusty Klein

Title:

Production Clerk

Date:

8-19-96

Phone: 505-748-1471

OIL CONSERVATION DIVISION

Approved by:

ORIGINAL SIGNED BY TIM W. GUN

Title:

Approval Date:

AUG 21 1996

If this is a change of operator fill in the OGRID number and name of the previous operator

Previous Operator Signature

Printed Name

Title

Date

Submit 5 Copies
Appropriate District Office
DISTRICT I
P.O. Box 1980, Hobbs, NM 88240

State of New Mexico
Energy, Minerals and Natural Resources Department

Form C-104
Revised 1-1-89
See Instructions
at Bottom of Page

RECEIVED

MAY 29 1992

DISTRICT II
P.O. Drawer DD, Artesia, NM 88210

DISTRICT III
1000 Rio Brazos Rd., Aztec, NM 87410

Santa Fe, New Mexico 87504-2088

O. C. D.
ARTESIA OFFICE

I. REQUEST FOR ALLOWABLE AND AUTHORIZATION

TO TRANSPORT OIL AND NATURAL GAS

Operator YATES PETROLEUM CORPORATION	Well API No. 30-005-62822
Address 105 South 4th St., Artesia, NM 88210	
Reason(s) for Filing (Check proper box) <input type="checkbox"/> Other (Please explain)	
New Well <input checked="" type="checkbox"/>	Change in Transporter of:
Recompletion <input type="checkbox"/>	Oil <input type="checkbox"/> Dry Gas <input type="checkbox"/>
Change in Operator <input type="checkbox"/>	Casinghead Gas <input type="checkbox"/> Condensate <input type="checkbox"/>

If change of operator give name
and address of previous operator

II. DESCRIPTION OF WELL AND LEASE

Lease Name Rolla TC	Well No. 2	Pool Name, including Formation Undesignated Wolfcamp	Kind of Lease State, Federal or Fee	Lease No.
Location Unit Letter <u>G</u> : 1980 Feet From The <u>North</u> Line and <u>2310</u> Feet From The <u>East</u> Line Section <u>29</u> Township <u>9S</u> Range <u>26E</u> , NMPM, Chaves County				

III. DESIGNATION OF TRANSPORTER OF OIL AND NATURAL GAS

Name of Authorized Transporter of Oil Navajo Refining Co.	<input type="checkbox"/> or Condensate <input checked="" type="checkbox"/>	Address (Give address to which approved copy of this form is to be sent) PO Box 159, Artesia, NM 88210				
Name of Authorized Transporter of Casinghead Gas Yates Petroleum Corporation	<input type="checkbox"/> or Dry Gas <input checked="" type="checkbox"/>	Address (Give address to which approved copy of this form is to be sent) 105 South 4th St., Artesia, NM 88210				
If well produces oil or liquids, give location of tanks.	Unit G	Sec. 29	Tw. 9s	Rge. 25e	Is gas actually connected? Yes	When? 5-26-92

If this production is commingled with that from any other lease or pool, give commingling order number:

IV. COMPLETION DATA

Designate Type of Completion - (X)	Oil Well	Gas Well	New Well	Workover	Deepen	Plug Back	Same Res'v	Diff Res'v
		X	X					
Date Spudded 7-2-91	Date Compl. Ready to Prod. 12-30-91		Total Depth 6125'		P.B.T.D. 5540'			
Elevations (DF, RKB, RT, GR, etc.) 3761' GR	Name of Producing Formation Wolfcamp		Top Oil/Gas Pay 5041'		Tubing Depth 4954'			
Perforations 5041-5046'					Depth Casing Shoe 6125'			
TUBING, CASING AND CEMENTING RECORD								
HOLE SIZE	CASING & TUBING SIZE		DEPTH SET		SACKS CEMENT			
26"			53'		150 sx			
14-3/4"	9-5/8"		1013'		750 sx			
7-7/8"	5-1/2"		6125'		1880 sx			
	2-7/8"		4954'					

V. TEST DATA AND REQUEST FOR ALLOWABLE

OIL WELL (Test must be after recovery of total volume of load oil and must be equal to or exceed top allowable for this depth or be for full 24 hours.)

Date First New Oil Run To Tank	Date of Test	Producing Method (Flow, pump, gas lift, etc.)	
Length of Test	Tubing Pressure	Casing Pressure	Choke Size
Actual Prod. During Test	Oil - Bbls.	Water - Bbls.	Gas- MCF

GAS WELL

Actual Prod. Test - MCF/D 144	Length of Test 24 hrs	Bbls. Condensate/MMCF -	Gravity of Condensate -
Testing Method (pilot, back pr.) Back Pressure	Tubing Pressure (Shut-in) 200	Casing Pressure (Shut-in) Pkr	Choke Size 11/64"

VI. OPERATOR CERTIFICATE OF COMPLIANCE

I hereby certify that the rules and regulations of the Oil Conservation
Division have been complied with and that the information given above
is true and complete to the best of my knowledge and belief.

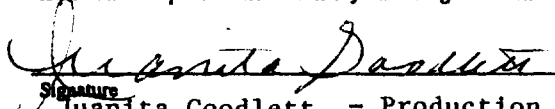
Signature
Juanita Goodlett - Production Supvr.
Printed Name
5-26-92
Date
(505) 748-1471
Title
Telephone No.

OIL CONSERVATION DIVISION

Date Approved JUN 3 1992

By 

Title SUPERVISOR, DISTRICT II

INSTRUCTIONS: This form is to be filed in compliance with Rule 1104

- 1) Request for allowable for newly drilled or deepened well must be accompanied by tabulation of deviation tests taken in accordance with Rule 111.
- 2) All sections of this form must be filled out for allowable on new and recompleted wells.
- 3) Fill out only Sections I, II, III, and VI for changes of operator, well name or number, transporter, or other such changes.
- 4) Separate Form C-104 must be filed for each pool in multiply completed wells.

Submit to Appropriate
District Office
State Lease - 6 copies
Fee Lease - 5 copies
DISTRICT I
P.O. Box 1980, Hobbs, NM 88240

DISTRICT II
P.O. Drawer DD, Artesia, NM 88210

DISTRICT III
1000 Rio Brazos Rd., Aztec, NM 87410

State of New Mexico
Energy, Minerals and Natural Resources Department

Form C-105
Revised 1-1-89

OIL CONSERVATION DIVISION

P.O. Box 2088

Santa Fe, New Mexico 87504-2088

JAN 28 1992

O. C. D.

WELL API NO. 30-005-62822
5. Indicate Type of Lease STATE <input type="checkbox"/> FEE <input checked="" type="checkbox"/>
6. State Oil & Gas Lease No.

WELL COMPLETION OR RECOMPLETION REPORT AND LOG

1a. Type of Well: OIL WELL <input type="checkbox"/> GAS WELL <input checked="" type="checkbox"/> DRY <input type="checkbox"/> OTHER _____		7. Lease Name or Unit Agreement Name Rolla TC	
b. Type of Completion: NEW WELL <input checked="" type="checkbox"/> WORK OVER <input type="checkbox"/> DEEPEN <input type="checkbox"/> PLUG BACK <input type="checkbox"/> DIFF RESVR <input type="checkbox"/> OTHER _____		8. Well No. 2	
2. Name of Operator YATES PETROLEUM CORPORATION / (505) 748-1471		9. Pool name or Wildcat Undes. Wolfcamp	
3. Address of Operator 105 South 4th St., Artesia, NM 88210			
4. Well Location Unit Letter <u>G</u> : <u>1980</u> Feet From The <u>North</u> Line and <u>2310</u> Feet From The <u>East</u> Line Section <u>29</u> Township <u>9S</u> Range <u>26E</u> NMPM Chaves County			
10. Date Spudded 7-2-91	11. Date T.D. Reached 7-20-91	12. Date Compl. (Ready to Prod.) 12-30-91	13. Elevations (DF& RKB, RT, GR, etc.) 3761' GR
14. Elev. Casinghead			
15. Total Depth 6125'	16. Plug Back T.D. 5540'	17. If Multiple Compl. How Many Zones?	18. Intervals Drilled By Rotary Tools 0-6125'
19. Producing Interval(s), of this completion - Top, Bottom, Name 5041-5046' Wolfcamp			20. Was Directional Survey Made No
21. Type Electric and Other Logs Run CNL/LDT; DLL; LSS			22. Was Well Cored No

CASING RECORD (Report all strings set in well)

CASING SIZE	WEIGHT LB/FT.	DEPTH SET	HOLE SIZE	CEMENTING RECORD	AMOUNT PULLED
20"		53'	26"	150 sx	
9-5/8"	36#	1013'	14-3/4"	750 sx	
5-1/2"	15.5#	6125'	7-7/8"	1880 sx	

24. LINER RECORD					25. TUBING RECORD		
SIZE	TOP	BOTTOM	SACKS CEMENT	SCREEN	SIZE	DEPTH SET	PACKER SET
					2-7/8"	4954'	4954'

26. Perforation record (interval, size, and number) 5041-5046' w/10 - .50" Holes	27. ACID, SHOT, FRACTURE, CEMENT, SQUEEZE, ETC.	
	DEPTH INTERVAL	AMOUNT AND KIND MATERIAL USED
	5041-5046'	w/1000g. 7½% NEFE acid.

28. PRODUCTION							
Date First Production 12-30-91		Production Method (Flowing, gas lift, pumping - Size and type pump) Flowing				Well Status (Prod. or Shut-in) SI-WOPLC	
Date of Test 12-30-91	Hours Tested 24	Choke Size 11/64"	Prod'n For Test Period	Oil - Bbl. -	Gas - MCF 144	Water - Bbl. -	Gas - Oil Ratio -
Flow Tubing Press. 200	Casing Pressure Pkr	Calculated 24-Hour Rate	Oil - Bbl. -	Gas - MCF 144	Water - Bbl. -	Oil Gravity - API - (Corr.) -	

29. Disposition of Gas (Sold, used for fuel, vented, etc.) Vented - will be sold	Test Witnessed By David Weaver
---	-----------------------------------

30. List Attachments Deviation Survey, Logs, DST

31. I hereby certify that the information shown on both sides of this form is true and complete to the best of my knowledge and belief

Signature Juanita Goodlett Printed Name Juanita Goodlett Title Production Supv. Date 1-6-92

INSTRUCTIONS

This form is to be filed with the appropriate District Office of the Division not later than 20 days after the completion of any newly-drilled or deepened well. It shall be accompanied by one copy of all electrical and radio-activity logs run on the well and a summary of all special tests conducted, including drill stem tests. All depths reported shall be measured depths. In the case of directionally drilled wells, true vertical depths shall also be reported. For multiple completions, Items 25 through 29 shall be reported for each zone. The form is to be filed in quintuplicate except on state land, where six copies are required. See Rule 1105.

INDICATE FORMATION TOPS IN CONFORMANCE WITH GEOGRAPHICAL SECTION OF STATE

Southeastern New Mexico

T. Anhy _____
 T. Salt _____
 B. Salt _____
 T. Yates _____
 T. 7 Rivers _____
 T. Queen _____
 T. Grayburg _____
 T. San Andres 870
 T. Glorieta 2016
 T. Paddock YESO 2072
 T. Blinbry _____
 T. Tubb _____
 T. Drinkard _____
 T. Abo 4265
 T. Wolfcamp 4950
 T. Penn Clastic 5600
 T. Cisco (Bough C) _____

T. Canyon _____
 T. Strawn _____
 T. Atoka _____
 T. Miss 5741
 T. Devonian _____
 T. Silurian-Ordovician-5776
 T. Montoya _____
 T. Simpson _____
 T. McKee _____
 T. Ellenburger _____
 T. Gr. Wash _____
 T. Delaware Sand _____
 T. Bone Springs _____
 T. Precambrian 6042
 T. _____
 T. _____
 T. _____

Northwestern New Mexico

T. Ojo Alamo _____
 T. Kirtland-Fruitland _____
 T. Pictured Cliffs _____
 T. Cliff House _____
 T. Menefee _____
 T. Point Lookout _____
 T. Mancos _____
 T. Gallup _____
 Base Greenhorn _____
 T. Dakota _____
 T. Morrison _____
 T. Todilto _____
 T. Entrada _____
 T. Wingate _____
 T. Chinle _____
 T. Permian _____
 T. Penn "A" _____

T. Penn. "B" _____
 T. Penn. "C" _____
 T. Penn. "D" _____
 T. Leadville _____
 T. Madison _____
 T. Elbert _____
 T. McCracken _____
 T. Ignacio Otzte _____
 T. Granite _____
 T. _____
 T. _____
 T. _____
 T. _____
 T. _____
 T. _____
 T. _____
 T. _____

OIL OR GAS SANDS OR ZONES

No. 1, from _____ to _____
 No. 2, from _____ to _____
 No. 3, from _____ to _____
 No. 4, from _____ to _____

IMPORTANT WATER SANDS

Include data on rate of water inflow and elevation to which water rose in hole.

No. 1, from _____ to _____ feet
 No. 2, from _____ to _____ feet
 No. 3, from _____ to _____ feet

LITHOLOGY RECORD (Attach additional sheet if necessary)

From	To	Thickness in Feet	Lithology	From	To	Thickness in Feet	Lithology
0	40	40	Surface, Rock				
40	2004	1964	Anhy, Redbeds				
2004	2853	849	Salt, anhy				
2853	3240	387	Anhy				
3240	3550	310	Dolo, SS, Anhy				
3550	3670	120	Dolo, Sh, Anhy				
3670	3800	130	Dolo, SS, Anhy, Sh				
3800	4000	200	Dolo, Sh, Anhy				
4000	4180	180	Anhy, Dolo, SS				
4180	4230	50	Anhy, Sh, Dolo				
4230	4300	70	Anhy, sh				
4300	4930	630	Sh				
4930	5660	730	Sh, LS				
5660	5780	120	Sh, LS, SS				
5780	6030	250	Dolo, LS, Sh				
6030	6125	95	Gr. Wash, Granite				

RECEIVED

JAN 23 1992

U.S. GEOLOGICAL SURVEY

YATES PETROLEUM CORPORATION

DRILL STEM TESTS

Rolla TC #2
Unit G, 1980' FNL & 2310" FEL
Sec. 29-T9S-R26E
Chaves County, NM

DST #1 5792-5915' Ordovician: TIMES: 5", 60", 60", 180", 60". RECOVERY:
150' drilling mud - Chl 94000. SAMPLER: .38 cfg, 75 psi @ 80°. Gas only
in sampler. PRESSURES: IHP 3005, IFP 81-102, ISIP 506, 2nd FP 52-86, 2nd
SIP 583, FFP 46-79, FHP 2979.

OIL CONSERVATION DIVISION

P.O. Box 2088
Santa Fe, New Mexico 87504-2088

RECEIVED

JAN 8 8 1992

DISTRICT I
P.O. Box 1980, Hobbs, NM 88240

DISTRICT II
P.O. Drawer DD, Artesia, NM 88210

DISTRICT III
1000 Rio Brazos Rd., Aztec, NM 87410

WELL LOCATION AND ACREAGE DEDICATION PLAT

All Distances must be from the outer boundaries of the section

Operator YATES PETROLEUM CORPORATION			Lease Rolla TC		Well No. 2
Unit Letter G	Section 29	Township 9-S	Range 26-E	County Chaves	
Actual Footage Location of Well: 1980 feet from the North line and 2310 feet from the East line					
Ground level Elev. 3761'	Producing Formation Wolfcamp		Pool Undesignated	Dedicated Acreage: 320 Acres	

1. Outline the acreage dedicated to the subject well by colored pencil or hatchure marks on the plat below.
2. If more than one lease is dedicated to the well, outline each and identify the ownership thereof (both as to working interest and royalty).
3. If more than one lease of different ownership is dedicated to the well, have the interest of all owners been consolidated by communitization, unitization, force-pooling, etc.?
☐ Yes ☐ No If answer is "yes" type of consolidation _____
If answer is "no" list the owners and tract descriptions which have actually been consolidated. (Use reverse side of this form if necessary.)
No allowable will be assigned to the well until all interests have been consolidated (by communitization, unitization, forced-pooling, or otherwise) or until a non-standard unit, eliminating such interest, has been approved by the Division.

OPERATOR CERTIFICATION

I hereby certify that the information contained herein is true and complete to the best of my knowledge and belief.

Signature

Printed Name

JUANITA GOODLETT

Position

PRODUCTION SUPERVISOR

Company

YATES PETROLEUM CORPORATION

Date

1-6-92

SURVEYOR CERTIFICATION

I hereby certify that the well location shown on this plat was plotted from field notes of actual surveys made by me or under my supervision, and that the same is true and correct to the best of my knowledge and belief.

Date Surveyed

Refer to original plat

Signature & Seal of dated 12/22/90
Professional Surveyor

Certificate No.

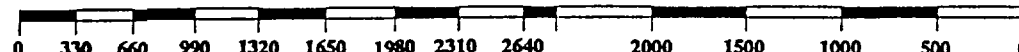
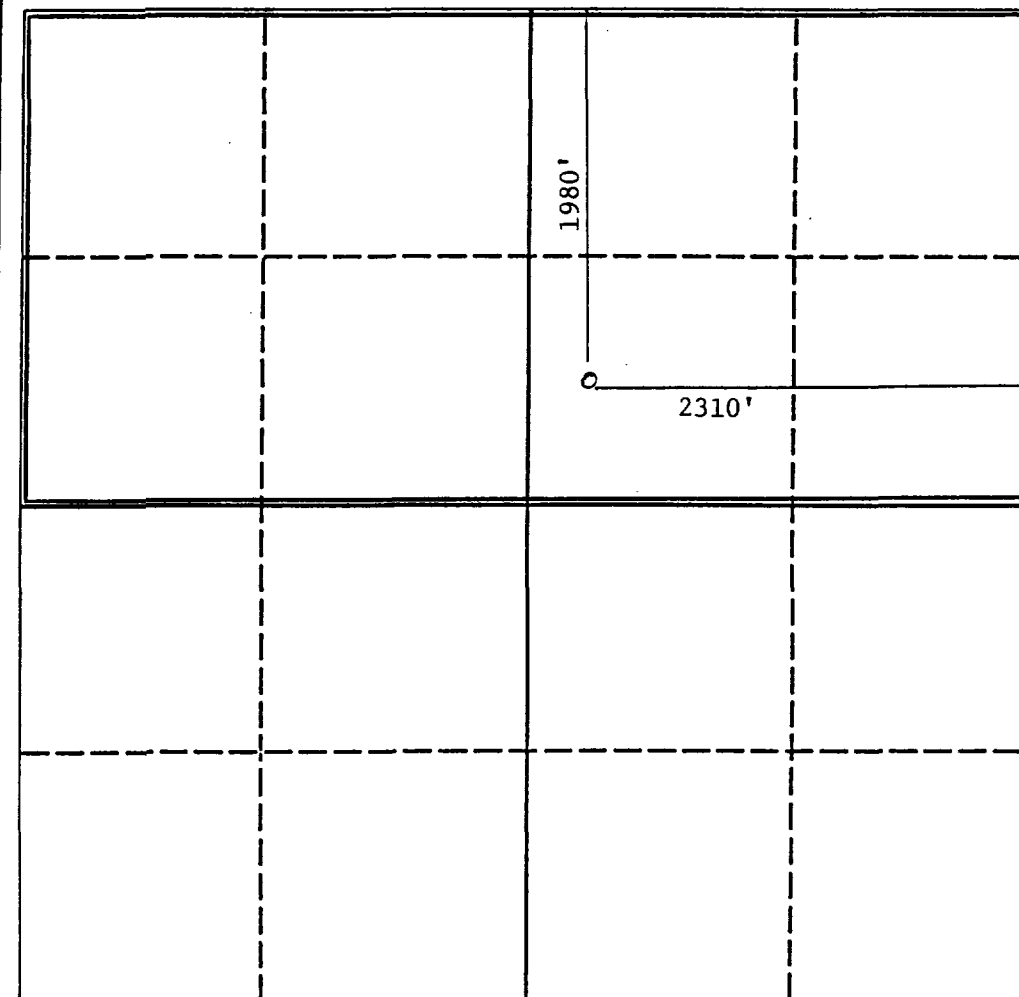

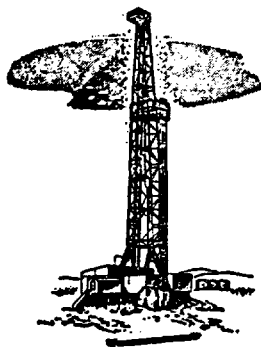

RECEIVED

Telephone (505) 748-2205

L & M DRILLING, INC. — Oil Well Drilling ContractorsO. C. O.
ARTESIA OFFICE

P.O. BOX 470 / ARTESIA, NEW MEXICO 88210

July 30, 1991

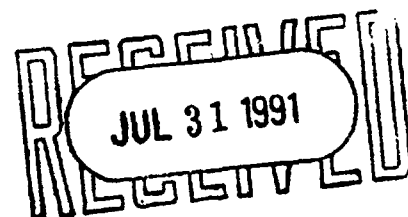
Yates Petroleum Corporation
105 South Fourth Street
Artesia, NM 88210RE: Rolla TC #2
1980' FNL & 2310' FEL
Sec. 29, T9S, R25E
Chaves County, NM

Gentlemen:

The following is a Deviation Survey for the above captioned well.

DEPTH	DEVIATION
501'	1°
1013'	3/4°
1500'	1/4°
2004'	1/4°
2494'	1/4°
2970'	1/4°
3551'	1/4°
3995'	1°
4526'	1°
5021'	1 1/4°
5522'	1 1/4°
6125'	1 1/4°

Very truly yours,

C. E. LaRue

STATE OF NEW MEXICO §
COUNTY OF EDDY §The foregoing was acknowledged before
me this 30th day of July, 1991.
NOTARY PUBLIC

DISTRICT I
P.O. Box 1980, Hobbs, NM 88240

DISTRICT II
P.O. Drawer DD, Artesia, NM 88210

DISTRICT III
1000 Rio Brazos Rd., Aztec, NM 87410

OIL CONSERVATION DIVISION

P.O. Box 2088
Santa Fe, New Mexico 87501-1688

JAN - 7 1992

WELL API NO. 30-005-62822
5. Indicate Type of Lease STATE <input type="checkbox"/> FEE <input checked="" type="checkbox"/>
6. State Oil & Gas Lease No.
7. Lease Name or Unit Agreement Name Rolla TC
8. Well No. 2
9. Pool name or Wildcat Undes. Wolfcamp
10. Elevation (Show whether DF, RKB, RT, GR, etc.) 3761' GR

SUNDY NOTICES AND REPORTS ON WELLS OFFICE
(DO NOT USE THIS FORM FOR PROPOSALS TO DRILL OR TO DEEPEN OR PLUG BACK TO A
DIFFERENT RESERVOIR. USE "APPLICATION FOR PERMIT"
(FORM C-101) FOR SUCH PROPOSALS.)

1. Type of Well: OIL WELL <input type="checkbox"/> GAS WELL <input checked="" type="checkbox"/> OTHER
2. Name of Operator YATES PETROLEUM CORPORATION ✓
3. Address of Operator 105 South 4th St., Artesia, NM 88210
4. Well Location Unit Letter <u>G</u> : <u>1980</u> Feet From The <u>North</u> Line and <u>2310</u> Feet From The <u>East</u> Line Section <u>29</u> Township <u>9S</u> Range <u>26E</u> NMPM Chaves County

11. Check Appropriate Box to Indicate Nature of Notice, Report, or Other Data	
NOTICE OF INTENTION TO:	SUBSEQUENT REPORT OF:
PERFORM REMEDIAL WORK <input type="checkbox"/>	REMEDIAL WORK <input type="checkbox"/>
TEMPORARILY ABANDON <input type="checkbox"/>	ALTERING CASING <input type="checkbox"/>
PULL OR ALTER CASING <input type="checkbox"/>	COMMENCE DRILLING OPNS. <input type="checkbox"/>
OTHER: <input type="checkbox"/>	PLUG AND ABANDONMENT <input type="checkbox"/>
	CASING TEST AND CEMENT JOB <input type="checkbox"/>
	OTHER: <u>Set CIBP, perforate & treat Wolfcamp</u> <input checked="" type="checkbox"/>

12. Describe Proposed or Completed Operations (Clearly state all pertinent details, and give pertinent dates, including estimated date of starting any proposed work) SEE RULE 1103.

10-10-91. Set CIBP at 5575' w/35' cement on top. WIH on wireline and perforated Wolfcamp 5041-5046' w/10 holes (2 SPF) as follows: 5041, 42, 44, 45, and 5046'. Acidized perforations with 1000 gals 1% NEFE acid and 20 ball sealers.

NOTE: CANCEL P&A PROCEDURE PROPOSED 10-31-91 AND APPROVED BY THE NMOC D 11-2-91.

I hereby certify that the information above is true and complete to the best of my knowledge and belief.

SIGNATURE Juanita Goodlett TITLE Production Supervisor DATE 1-6-92
TYPE OR PRINT NAME Juanita Goodlett TELEPHONE NO. 505/748-1471

(This space for State Use)

APPROVED BY [Signature] TITLE SUPERVISOR, DISTRICT II DATE JAN 8 1992

CONDITIONS OF APPROVAL, IF ANY:

DISTRICT I
P.O. Box 1980, Hobbs, NM 88240

DISTRICT II
P.O. Drawer DD, Artesia, NM 88210

DISTRICT III
1000 Rio Brazos Rd., Aztec, NM 87410

OIL CONSERVATION DIVISION

P.O. Box 2088
Santa Fe, New Mexico 87504-2088

NOV 1 1991

O. C. D.

WELL API NO.
30-005-62822

5. Indicate Type of Lease

STATE ☐

FEE ☒

6. State Oil & Gas Lease No.

SUNDRY NOTICES AND REPORTS ON WELLS
(DO NOT USE THIS FORM FOR PROPOSALS TO DRILL OR TO DEEPEN OR PLUG BACK TO A
DIFFERENT RESERVOIR. USE "APPLICATION FOR PERMIT"
(FORM C-101) FOR SUCH PROPOSALS.)

1. Type of Well:

OIL
WELL ☐

GAS
WELL ☐

OTHER P&A

2. Name of Operator

YATES PETROLEUM CORPORATION ✓

3. Address of Operator

105 South 4th St., Artesia, NM 88210

4. Well Location

Unit Letter G : 1980 Feet From The North Line and 2310 Feet From The East Line

Section 29 Township 9S Range 26E NMPM Chaves County

10. Elevation (Show whether DF, RKB, RT, GR, etc.)

3761' GR

11. Check Appropriate Box to Indicate Nature of Notice, Report, or Other Data

NOTICE OF INTENTION TO:

PERFORM REMEDIAL WORK ☐

PLUG AND ABANDON ☒

TEMPORARILY ABANDON ☐

CHANGE PLANS ☐

PULL OR ALTER CASING ☐

OTHER: ☐

SUBSEQUENT REPORT OF:

REMEDIAL WORK ☐ ALTERING CASING ☐

COMMENCE DRILLING OPNS. ☐ PLUG AND ABANDONMENT ☐

CASING TEST AND CEMENT JOB ☐

OTHER: ☐

12. Describe Proposed or Completed Operations (Clearly state all pertinent details, and give pertinent dates, including estimated date of starting any proposed work) SEE RULE 1103.

Propose to plug well as follows:

Set CIBP 5025', spot 10 sx Class "C" Neat from 5025-4925'.

Set 25 sx Class "C" Neat plug across Abo from 4385-4140'.

Set 25 sx Class "C" Neat plug across Glorieta from 2140-1890'.

Set 25 sx Class "C" Neat plug across 9-5/8" shoe from 1065-820'. Tag Shoe plug

Set 10 sx Class "C" Neat plug from 100' to surface.

Use heavy mud between plugs. Set regulation abandonment marker.

NOTIFY NMOCD, ARTESIA, NM, 24 HOURS BEFORE STARTING OPERATIONS.

Verbal approval obtained for plugging procedure from Darrell Moore, NMOCD, Artesia, NM 10-30-91.

I hereby certify that the information above is true and complete to the best of my knowledge and belief.

SIGNATURE

Juanita Goodlett

TITLE

Production Supervisor

DATE

10-31-91

TYPE OR PRINT NAME

Juanita Goodlett

TELEPHONE NO. 505/748-1471

(This space for State Use)

APPROVED BY

[Signature]

TITLE

Field Rep

DATE

11/2/91

CONDITIONS OF APPROVAL, IF ANY:

Notify N.M.O.C.D. in sufficient time to witness

Plugging

DISTRICT I
P.O. Box 1980, Hobbs, NM 88240

DISTRICT II
P.O. Box 1980, Artesia, NM 88210

DISTRICT III
1000 Rio Brazos Rd., Aztec, NM 87410

OIL CONSERVATION DIVISION

P.O. Box 2088
Santa Fe, New Mexico 87504-2088

OCT - 9 1991

O. C. D.

ARTESIA OFFICE

WELL API NO. 30-005-62822
5. Indicate Type of Lease STATE <input type="checkbox"/> FEE <input checked="" type="checkbox"/>
6. State Oil & Gas Lease No.
7. Lease Name or Unit Agreement Name Rolla TC
8. Well No. 2
9. Pool name or Wildcat Wildcat Ordovician

SUNDRY NOTICES AND REPORTS ON WELLS
(DO NOT USE THIS FORM FOR PROPOSALS TO DRILL OR TO DEEPEN OR PLUG BACK TO A DIFFERENT RESERVOIR. USE "APPLICATION FOR PERMIT" (FORM C-101) FOR SUCH PROPOSALS.)

1. Type of Well: OIL WELL <input type="checkbox"/> GAS WELL <input checked="" type="checkbox"/> OTHER
2. Name of Operator YATES PETROLEUM CORPORATION
3. Address of Operator 105 South 4th St., Artesia, NM 88210
4. Well Location Unit Letter <u>G</u> : <u>1980</u> Feet From The <u>North</u> Line and <u>2310</u> Feet From The <u>East</u> Line Section <u>29</u> Township <u>9S</u> Range <u>26E</u> NMPM <u>Chaves</u> County

10. Elevation (Show whether DF, RKB, RT, GR, etc.)

11. Check Appropriate Box to Indicate Nature of Notice, Report, or Other Data

NOTICE OF INTENTION TO:

PERFORM REMEDIAL WORK <input type="checkbox"/>	PLUG AND ABANDON <input type="checkbox"/>
TEMPORARILY ABANDON <input type="checkbox"/>	CHANGE PLANS <input type="checkbox"/>
PULL OR ALTER CASING <input type="checkbox"/>	
OTHER: <input type="checkbox"/>	

SUBSEQUENT REPORT OF:

REMEDIAL WORK <input type="checkbox"/>	ALTERING CASING <input type="checkbox"/>
COMMENCE DRILLING OPNS. <input type="checkbox"/>	PLUG AND ABANDONMENT <input type="checkbox"/>
CASING TEST AND CEMENT JOB <input type="checkbox"/>	
OTHER: Production Casing, perforate, treat <input checked="" type="checkbox"/>	

12. Describe Proposed or Completed Operations (Clearly state all pertinent details, and give pertinent dates, including estimated date of starting any proposed work) SEE RULE 1103.

TD 6125'. Reached TD 7-20-91. Ran 147 joints 5-1/2" 15.5# J-55 LT&C casing set 6125'. Float shoe set 6125', float collar set 6082'. DV tool set 4208'. Cmt'd in two stages: Stage 1: 700 sx "H" w/2.4# salt + 5# Halad 22 + 5% Silicalite + 5% Poz (yield 1.34, wt 15.6). PD 3:30 PM 7-23-91 with 1550 psi. Held OK. Circulate thru DV tool 2-1/2 hrs. Circulated 85 sacks. Stage 2: 980 sx Halliburton Lite with 6# salt + 1/4# Flocele (yield 1.85, wt 12.8). Tailed in w/200 sx Premium Plus Neat (yield 1.32, wt 14.8). PD 6:00 PM 7-23-91 with 2700 psi, OK. Circulated 120 sacks. WOCU 22 days. Drilled out 88' of cement and VT tool at 4208'. Tested casing to 2000 psi, OK. Perforated 5607-5727' w/34 - .40" holes as follows: 5607, 10, 11, 13, 15, 17' (12 shots-2 SPF), 5669, 71, 73, 75, 86, 87, 88' (14 shots-2 SPF), 5723, 25, 26, 27' (8 shots-2 SPF). Acidized perfs 5607-17' w/750 g. 7 1/2% NEFE acid. Attempt to acidize perfs 5723-5727', but communicated up to perfs 5669-88'. Moved packer to 5640' and acidized perfs 5669-5727' w/1250 g. 7 1/2% NEFE acid. Swabbed - recovering load.

I hereby certify that the information above is true and complete to the best of my knowledge and belief.

SIGNATURE Juanita Goodlett TITLE Production Supervisor DATE 10-7-91

TYPE OR PRINT NAME Juanita Goodlett TELEPHONE NO. 505/748-1471

(This space for State Use)

APPROVED BY Mark Williams TITLE SUPERVISOR, DISTRICT II DATE OCT 11 1991

CONDITIONS OF APPROVAL, IF ANY:

DISTRICT I
P.O. Box 1980, Hobbs, NM 88240
DISTRICT II
P.O. Box 1980, Hobbs, NM 88240
DISTRICT III
1000 Rio Brazos Rd., Aztec, NM 87410

OIL CONSERVATION DIVISION
P.O. Box 2088
Santa Fe, New Mexico 87504-2088

WELL API NO. 30-005-62822
5. Indicate Type of Lease STATE <input type="checkbox"/> FEE <input checked="" type="checkbox"/>
6. State Oil & Gas Lease No.
7. Lease Name or Unit Agreement Name Rolla TC
8. Well No. 2
9. Pool name or Wildcat Wildcat Ordovician

SUNDRY NOTICES AND REPORTS ON WELLS (DO NOT USE THIS FORM FOR PROPOSALS TO DRILL OR TO DEEPEN OR PLUG BACK TO A DIFFERENT RESERVOIR. USE "APPLICATION FOR PERMIT" (FORM C-101) FOR SUCH PROPOSALS.)	
1. Type of Well: OIL WELL <input type="checkbox"/> GAS WELL <input checked="" type="checkbox"/> OTHER <input type="checkbox"/>	RECEIVED JUL 10 1991 O. C. D. ARTESIA, OFFICE
2. Name of Operator YATES PETROLEUM CORPORATION	
3. Address of Operator 105 South 4th St., Artesia, NM 88210	
4. Well Location Unit Letter <u>G</u> : <u>1980</u> Feet From The <u>North</u> Line and <u>2310</u> Feet From The <u>East</u> Line Section <u>29</u> Township <u>9S</u> Range <u>26E</u> NMPM <u>Chaves</u> County	
10. Elevation (Show whether DF, RKB, RT, GR, etc.) 3761' GR	

11. Check Appropriate Box to Indicate Nature of Notice, Report, or Other Data	
NOTICE OF INTENTION TO:	SUBSEQUENT REPORT OF:
PERFORM REMEDIAL WORK <input type="checkbox"/>	REMEDIAL WORK <input type="checkbox"/>
TEMPORARILY ABANDON <input type="checkbox"/>	ALTERING CASING <input type="checkbox"/>
PULL OR ALTER CASING <input type="checkbox"/>	COMMENCE DRILLING OPNS. <input checked="" type="checkbox"/>
OTHER: <input type="checkbox"/>	PLUG AND ABANDONMENT <input type="checkbox"/>
	CASING TEST AND CEMENT JOB <input checked="" type="checkbox"/>
	OTHER: <input type="checkbox"/>

12. Describe Proposed or Completed Operations (Clearly state all pertinent details, and give pertinent dates, including estimated date of starting any proposed work) SEE RULE 1103.

Spudded 26" hole 4:50 PM 7-2-91. Notified Mike Williams, NMOCD, Artesia, NM, of spud. Set 53' of 20" conductor. Cmt'd w/150 sx "C" + 2% CaCl2. Circulated 25 sacks. Note: Encountered river gravel at 35'. Hit water at 39'. Drilled to firm formation at 53'. Resumed drilling 14-3/4" hole 8:15 AM 7-5-91. Notified Mike Williams, NMOCD, Artesia, NM. Ran 23 joints 9-5/8" 36# J-55 ST&C casing set 1013'. Guide shoe set 1013', insert float set 969'. Cmt'd w/550 sx Halliburton Lite with 5# Gilsonite + 1/4# Flocele + 2% CaCl2 (yield 1.84, wt 12.8). Tail in w/200 sx "C" with 2% CaCl2 (yield 1.32, wt 14.8). PD 1:30 PM 7-6-91. Bumped plug to 600 psi, float held okay. Circulated 15 sacks to pit. WOC. Drilled out 3:30 AM 7-7-91. WOC 14 hrs. NU and tested to 1000 psi for 30 mintues. Reduced hole to 7-7/8" and resumed drilling. Notified Mike Williams with NMOCD - did not observe.

I hereby certify that the information above is true and complete to the best of my knowledge and belief.

SIGNATURE Juanita Goodlett TITLE Production Supervisor DATE 7-10-91
TYPE OR PRINT NAME Juanita Goodlett TELEPHONE NO. 505/748-1471

(This space for State Use)

APPROVED BY Mike Williams TITLE SUPERVISOR, DISTRICT II DATE JUL 18 1991
CONDITIONS OF APPROVAL, IF ANY:

Submit 3 Copies
to Appropriate
District Office

RECEIVED
OIL CONSERVATION

AN DIVISION

State of New Mexico
Energy, Minerals and Natural Resources Department

Form C-103
Revised 1-1-89

DISTRICT I

P.O. Box 1980, Hobbs, NM 88240

DISTRICT II

P.O. Drawer DD, Artesia, NM 88210

DISTRICT III

1000 Rio Brazos Rd., Aztec, NM 87410

RECEIVED
OIL CONSERVATION DIVISION
P.O. Box 2088
Santa Fe, New Mexico 87504-2088

JUL 08 1991

O. C. D.

WELL API NO.

30-005-62822

5. Indicate Type of Lease

STATE ☐

FEE ☒

6. State Oil & Gas Lease No.

7. Lease Name or Unit Agreement Name

Rolla TC

8. Well No.

2

9. Pool name or Wildcat

Wildcat Ordovician

SUNDRY NOTICES AND REPORTS ON WEARSIES, OFFICE
(DO NOT USE THIS FORM FOR PROPOSALS TO DRILL OR TO DEEPEN OR PLUG BACK TO A
DIFFERENT RESERVOIR. USE "APPLICATION FOR PERMIT"
(FORM C-101) FOR SUCH PROPOSALS.)

1. Type of Well:

OIL
WELL ☐

GAS
WELL ☒

OTHER

2. Name of Operator

YATES PETROLEUM CORPORATION ✓

3. Address of Operator

105 South 4th St., Artesia, NM 88210

4. Well Location

Unit Letter G : 1980 Feet From The North Line and 2310 Feet From The East Line

Section 29 Township 9S Range 26E NMPM Chaves County

10. Elevation (Show whether DF, RKB, RT, GR, etc.)

3761' GR

11. Check Appropriate Box to Indicate Nature of Notice, Report, or Other Data

NOTICE OF INTENTION TO:

PERFORM REMEDIAL WORK ☐

PLUG AND ABANDON ☐

TEMPORARILY ABANDON ☐

CHANGE PLANS ☒

PULL OR ALTER CASING ☐

OTHER: ☐

SUBSEQUENT REPORT OF:

REMEDIAL WORK ☐ ALTERING CASING ☐

COMMENCE DRILLING OPNS. ☐ PLUG AND ABANDONMENT ☐

CASING TEST AND CEMENT JOB ☐

OTHER: ☐

12. Describe Proposed or Completed Operations (Clearly state all pertinent details, and give pertinent dates, including estimated date of starting any proposed work) SEE RULE 1103.

Verbal permission obtained from Mike Williams, NMOCD, Artesia, NM, by Tim Bussell, YPC, to change size of hole and casing as follows:

Hole size: From: 12-1/4"
To: 14-3/4"

Casing size: From: 8-5/8"
To: 9-5/8"

I hereby certify that the information above is true and complete to the best of my knowledge and belief.

SIGNATURE Juanita Goodlett

TITLE Production Supervisor

DATE 7-8-91

TYPE OR PRINT NAME Juanita Goodlett

TELEPHONE NO. 505/748-1471

(This space for State Use)

APPROVED BY Mr. Williams

TITLE

SUPERVISOR, DISTRICT II

DATE

JUL 12 1991

CONDITIONS OF APPROVAL, IF ANY:

Submit to Appropriate
District Office
State Lease - 6 copies
Fee Lease - 5 copies

State of New Mexico
Energy, Minerals and Natural Resources Department

Form C-101
Revised 1-1-89

DISTRICT I
P.O. Box 1980, Hobbs, NM 88240

DISTRICT II
P.O. Drawer DD, Artesia, NM 88210

DISTRICT III
1000 Rio Brazos Rd., Aztec, NM 87410

OIL CONSERVATION DIVISION

P.O. Box 2088
Santa Fe, New Mexico 87504-2088

JAN 4 REC'D

API NO. (assigned by OCD on New Wells)

30-115-62822

5. Indicate Type of Lease

STATE ☐

FEE ☒

6. State Oil & Gas Lease No.

APPLICATION FOR PERMIT TO DRILL, DEEPEN, OR PLUG BACK

ARTESIA, OFFICE

1a. Type of Work:

DRILL ☒

RE-ENTER ☐

DEEPEN ☐

PLUG BACK ☐

b. Type of Well:

OIL
WELL ☐

GAS
WELL ☒

OTHER

SINGLE
ZONE ☐

MULTIPLE
ZONE ☐

2. Name of Operator

Yates Petroleum Corporation

3. Address of Operator

105 South Fourth Street, Artesia, NM 88210

7. Lease Name or Unit Agreement Name

McQuiddy "ATH"

Rohla TC

8. Well No.

#2

9. Pool name or Wildcat

Wildcat Ordovician

4. Well Location

Unit Letter G : 1980 Feet From The North Line and 2310 Feet From The East Line

Section 29

Township 9 South

Range 26 East

NMPM

Chaves

County

10. Proposed Depth

6200'

11. Formation

Ordovician

12. Rotary or C.T.

Rotary

13. Elevations (Show whether DF, RT, GR, etc.)

3761' GR

14. Kind & Status Plug. Bond

Blanket

15. Drilling Contractor

Undesignated

16. Approx. Date Work will start

ASAP

17.

PROPOSED CASING AND CEMENT PROGRAM

SIZE OF HOLE	SIZE OF CASING	WEIGHT PER FOOT	SETTING DEPTH	SACKS OF CEMENT	EST. TOP
12 1/4"	8 5/8"	24# K-55	Approx. 1000'	600 sacks	Circulate
7 7/8"	5 1/2"	15.5# J-55	TD	450 sacks	

We propose to drill and test the Ordovician and intermediate formations. Approximately 1000' of surface casing will be set and cement circulated to shut off gravel and cavings. If commercial, production casing will be run and cemented with adequate cover, perforated and stimulated as needed for production.

MUD PROGRAM: FW gel & LCM to 1000'; cut brine to 4500'; salt water gel & starch to TD.

BOP PROGRAM: BOP's will be tested daily and installed at the offset.

GAS NOT DEDICATED.

APPROVAL VALID FOR 180 DAYS

PERMIT EXPIRES 7/11/91

UNLESS DRILLING UNDERWAY

IN ABOVE SPACE DESCRIBE PROPOSED PROGRAM: IF PROPOSAL IS TO DEEPEN OR PLUG BACK, GIVE DATA ON PRESENT PRODUCTIVE ZONE AND PROPOSED NEW PRODUCTIVE ZONE. GIVE BLOWOUT PREVENTER PROGRAM, IF ANY.

I hereby certify that the information above is true and complete to the best of my knowledge and belief.

SIGNATURE

Clifton R. May

TITLE

Permit Agent

DATE

1-4-91

TYPE OR PRINT NAME

Clifton R. May

TELEPHONE NO.

748-1471

(This space for State Use)

APPROVED BY

Mr. Walker

TITLE

SUPERVISOR, DISTRICT II

DATE

JAN 11 1991

CONDITIONS OF APPROVAL, IF ANY:

Submit to Appropriate
District Office
State Lease - 4 copies
Fee Lease - 3 copies

State of New Mexico
Energy, Minerals and Natural Resources Department

Form C-103
Revised 1-1-89

OIL CONSERVATION DIVISION

P.O. Box 2088
Santa Fe, New Mexico 87504-2088

DISTRICT I
P.O. Box 1980, Hobbs, NM 88240

DISTRICT II
P.O. Drawer DD, Artesia, NM 88210

DISTRICT III
1000 Rio Buenos Rd., Aztec, NM 87410

WELL LOCATION AND ACREAGE DEDICATION PLAT

All Distances must be from the outer boundaries of the section

Operator YATES PETROLEUM CORPORATION			Lease Robla TC McQUIDDY "A1H"		Well No. 2
Unit Letter G	Section 29	Township 9 SOUTH	Range 26 EAST	County CHAVES	
Actual Footage Location of Well: 2310 feet from the EAST line and 1980 feet from the NORTH line					
Ground level Elev. 3761.0	Producing Formation ORDOVICIAN	Pool WILDCAT ORDOVICIAN	Dedicated Acreage: 320 Acres		

- Outline the acreage dedicated to the subject well by colored pencil or hatchure marks on the plat below.
- If more than one lease is dedicated to the well, outline each and identify the ownership thereof (both as to working interest and royalty).
- If more than one lease of different ownership is dedicated to the well, have the interest of all owners been consolidated by communitization, unitization, force-pooling, etc?
☐ Yes ☐ No If answer is "yes" type of consolidation _____
If answer is "no" list the owners and trust descriptions which have actually been consolidated. (Use reverse side of this form if necessary.) _____
No allowable will be assigned to the well until all interests have been consolidated (by communitization, unitization, forced-pooling, or otherwise) or until a non-standard unit, eliminating such interest, has been approved by the Division.

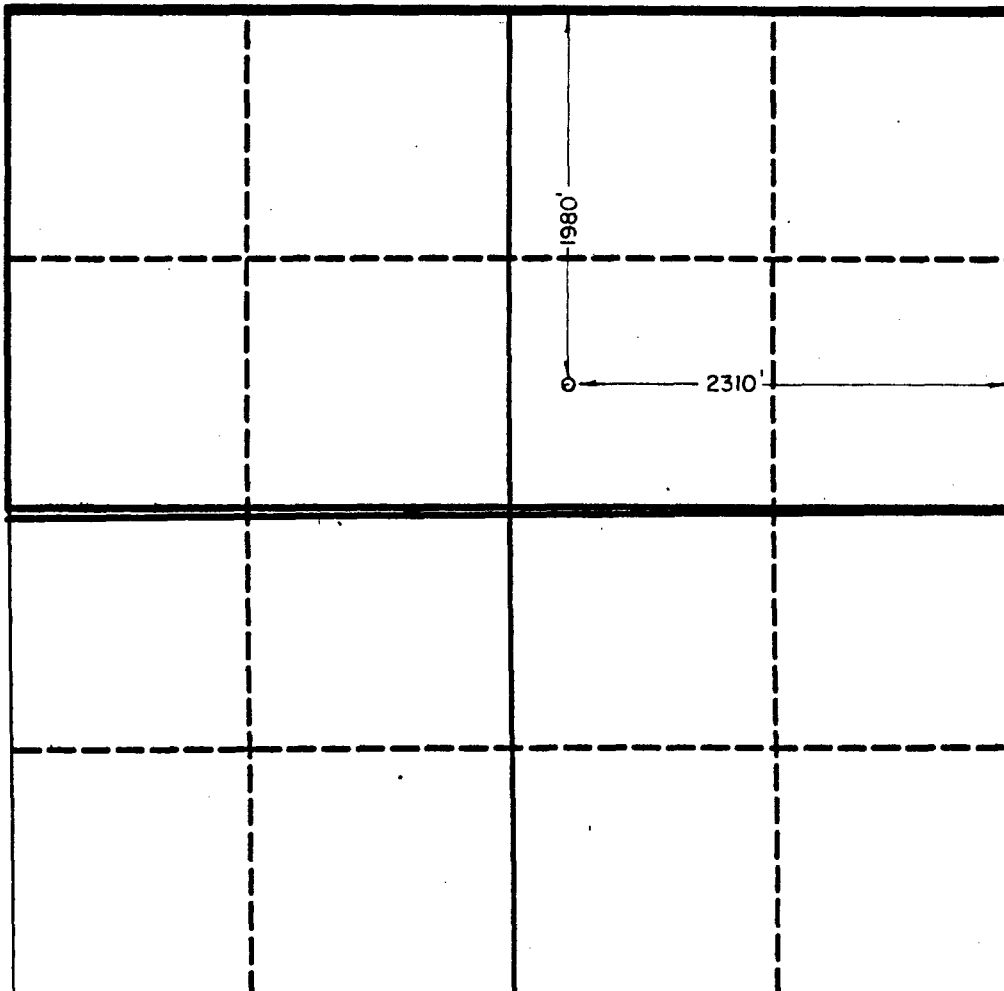

0 330 660 990 1320 1650 1980 2310 2640 2000 1500 1000 500 0

OPERATOR CERTIFICATION

I hereby certify that the information contained herein is true and complete to the best of my knowledge and belief.

Signature
Clifton R. May
Printed Name
Clifton R. May
Position
Permit Agent
Company
Yates Petroleum Corp.
Date
1-4-91

SURVEYOR CERTIFICATION

I hereby certify that the well location shown on this plat was plotted from field notes of actual surveys made by me or under my supervision, and that the same is true and correct to the best of my knowledge and belief.

Date Surveyed
12/22/90
Signature & Seal of Professional Surveyor
HERSCHEL
Certificate No. **3640**
STATE OF NEW MEXICO
REGISTERED LAND SURVEYOR

YATES PETROLEUM CORPORATION

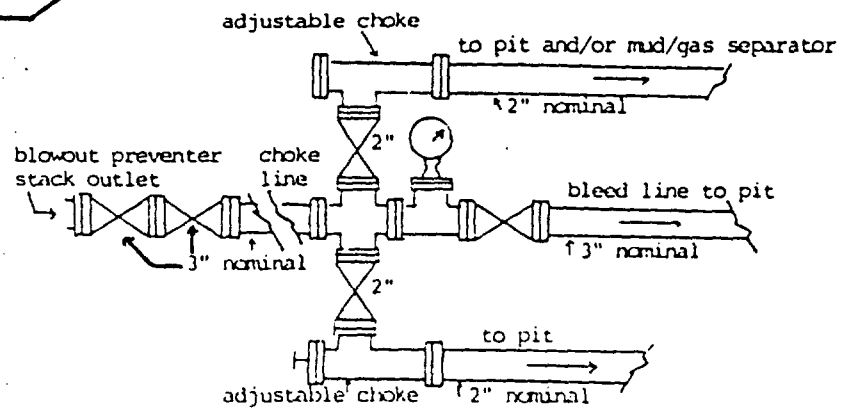
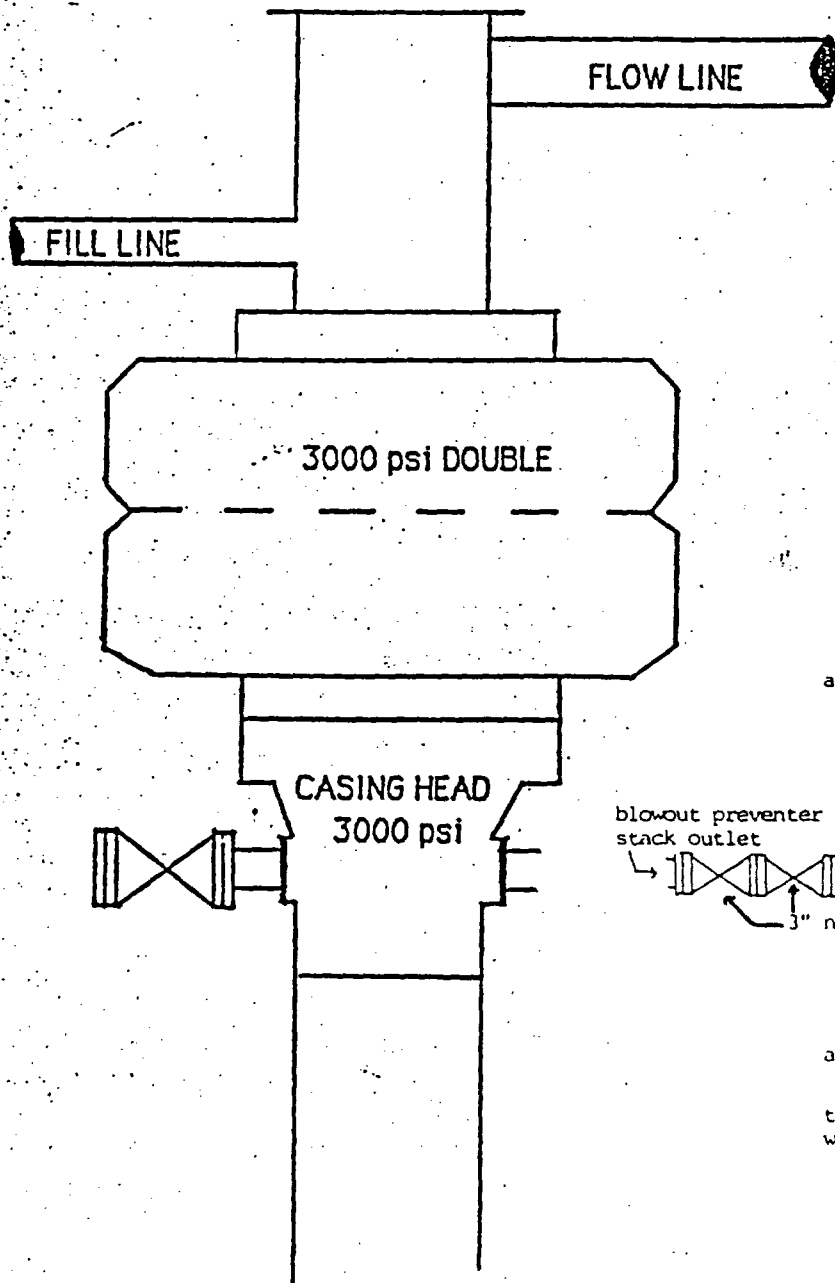

typical choke manifold assembly for 3M rated
working pressure service-surface installation

**BLOWOUT PREVENTER
3M SYSTEM**

WRS COMPLETION REPORTREISSUES SEC 29 TWP 9S RGE 26E
PI# 30-T-0001 06/12/92 30-005-62822-0000 PAGE 1NMEX CHAVES * 1980FNL 2310FEL SEC SW NE
STATE COUNTY FOOTAGE SPOT
YATES PET WD WSD
OPERATOR WELL CLASS INIT FIN2 ROLLA T C
WELL NO. LEASE NAME
3768KB 3761GR FOOR RANCH N
OPER ELEV FIELD POOL AREA
API 30-005-62822-0000LEASE NO. PERMIT OR WELL I.D. NO.
07/02/1991 12/30/1991 ROTARY VERT GAS
SPUD DATE COMP. DATE TYPE TOOL HOLE TYPE STATUS
6200 ORDOVICN L & M DRLG CO 1 RIG SUB 6
PROJ. DEPTH PROJ. FORM CONTRACTOR
DTD 6125 PB 5540 FM/TD PR CMBRN
DRILLERS T.D. LOG T.D. PLUG BACK TO OLD T.D. FORM T.D.**LOCATION DESCRIPTION**18 MI SW ELKINS, NM
1 MI NW/5900 (ORDV) GAS PROD IN FOOR RANCH FLD**WELL IDENTIFICATION/CHANGES**FIELD CHGD FROM WILDCAT
FIELD CHGD FROM CHAVES CO UNDESIGNATED
FINAL CLASS CHGD FROM DG**CASING/LINER DATA**CSG 20 @ 53 W/ 150 SACKS
CSG 9 5/8 @ 1013 W/ 750 SACKS
CSG 5 1/2 @ 6125 W/ 1880 SACKS**TUBING DATA**

TBG 2 7/8 AT 4954

INITIAL POTENTIALIPF 144 MCFD 11/64CK 24HRS
WOLFCAMP PERF W/ 10/IT 5041- 5046
TP 200

GOR DRY

GTY (GAS)-NO DETAILS

CONTINUED IC# 300057000891

COPYRIGHT 1992

**Petroleum Information
Corporation**PI-WRS-GET
Form No 187

REISSUES
 PI# 30-T-0001 06/12/92 SEC 29 TWP 9S RGE 26E
 30-005-62822-0000 PAGE 2

YATES PET WD WSD
 2 ROLLA T C

TYPE	FORMATION	LTH	TOP	DEPTH/SUB	BSE	DEPTH/SUB
LOG	SN ANDRS		870	2891		
LOG	GLORIETA		2016	1745		
LOG	YESO		2072	1689		
LOG	ABO		4265	-504		
LOG	WOLFCAMP		4950	-1189		
LOG	MSSP		5741	-1980		
LOG	ORDOVICN		5776	-2015		
LOG	PR CMBRN		6042	-2281		

SUBSEA MEASUREMENTS FROM GR

FORMATION TEST DATA

DST 1 5792- 5915 ORDOVICN S
 REC 150.0 FT MUD .3 CFT GAS
 INIT OP 5M IFP 81 FFP 102
 FINAL OP 1H IFP 46 FFP 79
 ISIP 506 1H IHP 3005 FHP 2979
 SPL CHAM PRESS FINAL 75
 SPL REC .38 CFT GAS
 OP 5 MINS, SI 1 HR; OP 1 HR, SI 3 HRS; OP 1 HR
 IFP 81-102, 52-86, 46-79
 ISIP 506, 583, #3SIP-NOT TAKEN

PRODUCTION TEST DATA

PNNSYLVN PERF 5607- 5727 GROSS
 PERF 5607- 5617 5669- 5688 5723- 5727
 ACID 5607- 5617 750GALS
 7 1/2% NEFE
 ACID 5669- 5727 1250GALS
 7 1/2% NEFE
 BRPG @ 5575 5607- 5727
 CMT PLUG 5540-5575

WOLFCAMP PERF W/ 10/IT 5041- 5046 GROSS
 PERF 5041, 5042, 5044, 5045, 5046
 ACID 5041- 5046 1000GALS
 7 1/2% NEFE

LOGS AND SURVEYS /INTERVAL,TYPE/

LOGS	CNL	LDT	DLL
------	-----	-----	-----

CONTINUED

REISSUES
PI# 30-T-0001 06/12/92 SEC 29 TWP 9S RGE 26E
PAGE 3

YATES PET
2 ROLLA T C WD WSD

LOGS AND SURVEYS /INTERVAL,TYPE/

LOGS LSS

DRILLING PROGRESS DETAILS

YATES PET
105 S 4TH
ARTESIA, NM 88210
505-748-1471
01/15 LOC/1991/
07/12 DRLG, NO DETAILS
07/16 5642 TD, RMG
07/25 6125 TD, WOCT
10/28 6125 TD, SWBG LD
01/17 6125 TD, PB 5540, WOPT
02/18 LOCAL CALL: PENNSYLVANIAN CLASTIC 5600
TD REACHED 07/20/91 RIG REL 07/23/91
02/18 6125 TD, PB 5540
COMP 12/30/91, IPF 144 MCFGPD, 11/64 CK,
GOR DRY, GTY (GAS) (NR),
FTP 200
PROD ZONE - WOLFCAMP 5041-5046
NO CORES, ONE DST RPTD
06/05 WOLFCAMP DISCOVERY - SHALLOWER POOL
06/05 REISSUED TO CORRECT FIELD, FINAL CLASS
& ADD DISC STMT
REPLACEMENT FOR CT ISSUED 2/21/92