

119737782



CIMARRON

EXPLORATION COMPANY

P.O. Box 1592
Roswell, New Mexico 88202
Phone: (505) 623-9799
Fax: (505) 624-1006

May 16, 2001

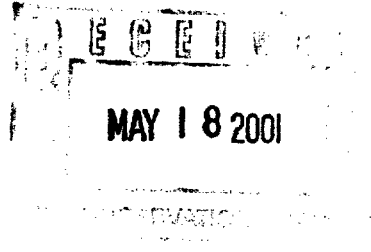

Mr. Michael Stogner
Oil Conservation Division
P.O. Box 6429
Santa Fe, New Mexico 87504

Re: Request For Amendment to Order No. R-8992
West Knowles No. 11
Sec. 34, T-16-s, R-37-E
Lea County, New Mexico

Dear Mr. Stogner:

Cimarron Exploration Company is the operator of the referenced well, which is currently completed in the Shipp Strawn pool. Cimarron desires to re-enter this well at the current location and laterally extend the wellbore in the Strawn formation approximately 1,236 feet to the north-northwest. Based on existing field rules, this will place the bottom of the wellbore at an orthodox location in the NE/4 SE/4 of Section 34, T-16-S, R-37-E. Please refer to the enclosed forms C-101 and C-102 for additional details regarding the proposed operation.

The surface location of this well is currently at an unorthodox location previously approved by Order No. R-8992 issued by the Oil Conservation Division on August 31, 1989. At this time, Cimarron respectfully requests an amendment to this order to allow for the operation as detailed herein.

By copy of this letter, all offset operators are being notified of Cimarron's request herein. The offset operators are shown on the enclosed plat.

Please advise if any additional information is required at this time. Thank you for your consideration of this matter.

Sincerely,

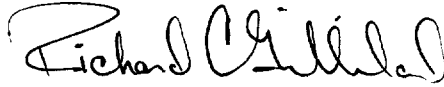
A handwritten signature in black ink, appearing to read "Richard C. Gilliland". The signature is fluid and cursive, with the first name "Richard" being more legible than the last name "Gilliland".

Richard C. Gilliland
Vice President

RCG/jar
Enclosures

cc: Donna Pitzer
OCD – Division I
1625 North French Drive
Hobbs, NM 88240

Amerind Oil Company
415 West Wall, Suite 500
Midland, TX 79701-4467

Chase Oil Corporation
P.O. Box 1767
Artesia, NM 88211-1767

Texland Petroleum – Hobbs, LLC
816 NW County Road
Hobbs, NM 88240

District I
1625 N. French Dr., Hobbs, NM 88240
District II
811 South First, Artesia, NM 88210
District III
1000 Rio Brazos Road, Aztec, NM 87410
District IV
2040 South Pacheco, Santa Fe, NM 87505

State of New Mexico
Energy Minerals and Natural Resources

Oil Conservation Division
2040 South Pacheco
Santa Fe, NM 87505

Form C-101
Revised March 17, 1999

Submit to appropriate District Office
State Lease - 6 Copies
Fee Lease - 5 Copies

☐ AMENDED REPORT

APPLICATION FOR PERMIT TO DRILL, RE-ENTER, DEEPEN, PLUGBACK, OR ADD A ZONE

¹ Operator Name and Address Cimarron Exploration Company P.O. Box 1592, Roswell, New Mexico 88202-1592		² OGRID Number 164726
		³ API Number 30 - 025-30668
⁴ Property Code 021601	⁵ Property Name West Knowles	⁶ Well No. 11

⁷ Surface Location

UL or lot no.	Section	Township	Range	Lot Idn	Feet from the	North/South line	Feet from the	East/West line	County
P	34	16-S	37-E		660	South	330	East	Lea

⁸ Proposed Bottom Hole Location If Different From Surface

UL or lot no.	Section	Township	Range	Lot Idn	Feet from the	North/South line	Feet from the	East/West line	County
I	34	16-S	37-E		1875	South	555	East	Lea

⁹ Proposed Pool 1 Shipp Strawn	¹⁰ Proposed Pool 2
--	-------------------------------

¹¹ Work Type Code	¹² Well Type Code O	¹³ Cable/Rotary Rotary	¹⁴ Lease Type Code P	¹⁵ Ground Level Elevation 3,766
¹⁶ Multiple N	¹⁷ Proposed Depth 11,400' TVD	¹⁸ Formation Strawn	¹⁹ Contractor Key Energy	²⁰ Spud Date Upon Approval

²¹ Proposed Casing and Cement Program

Hole Size	Casing Size	Casing weight/foot	Setting Depth	Sacks of Cement	Estimated TOC
17-1/2"	13-3/8"	48 #/ft	500'	525	Surf.
11"	8-5/8"	32 #/ft	4,735'	1,800	Surf.
7-7/8"	5-1/2"	17 #/ft	11,700'	2,311	Surf.

²² Describe the proposed program. If this application is to DEEPEN or PLUG BACK, give the data on the present productive zone and proposed new productive zone.

Describe the blowout prevention program, if any. Use additional sheets if necessary.

Well is currently completed in the Strawn formation with perforations from 11,292 - 11,456'.

Set CIBP at 11,305' +/- Set whipstock and drill out of 5-1/2" casing with a 4-3/4" bit. Make 75' radius turn to be horizontal in the Strawn formation at 11,380' TVD. Continue horizontal in Strawn approximately 1,236' N-NW to bottom out well at an orthodox location in the NE/4 SE/4, Section 34 (see attached plat for survey of the proposed bottom-hole location).

A 6"-900 series, 3000# manual BOP system will be utilized throughout the operation.

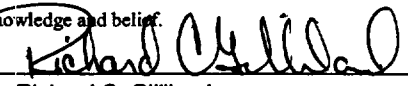
²³ I hereby certify that the information given above is true and complete to the best of my knowledge and belief.		OIL CONSERVATION DIVISION	
Signature: 			
Printed name: Richard C. Gilliland		Approved by:	
Title: Vice President		Title:	
Date: 03/22/01	Phone: (505) 623-9799	Approval Date:	Expiration Date:
		Conditions of Approval: Attached <input type="checkbox"/>	

DISTRICT I
P.O. Box 1980, Hobbs, NM 88241-1980

State of New Mexico
Energy, Minerals and Natural Resources Department

Form C-102
Revised February 10, 1994
Submit to Appropriate District Office
State Lease - 4 Copies
Fee Lease - 3 Copies

DISTRICT II
F.O. Brewer DD, Artesia, NM 86211-0719

OIL CONSERVATION DIVISION

P.O. Box 2088

Santa Fe, New Mexico 87504-2088

DISTRICT III
1000 Rio Brazos Rd., Aztec, NM 87410

DISTRICT IV
P.O. BOX 2068, SANTA FE, N.M. 87504-2068

WELL LOCATION AND ACREAGE DEDICATION PLAT

☐ AMENDED REPORT

API Number 30-025-30668		Pool Code 55695	Pool Name Shipp Strawn
Property Code 021601	Property Name WEST KNOWLES		Well Number 11
OGED No. 164726	Operator Name CIMARRON EXPLORATION COMPANY		Elevation 3766'

Surface Location

UL or lot No.	Section	Township	Range	Lot Idn	Feet from the	North/South line	Feet from the	East/West line	County
P	34	16-S	37-E		660	SOUTH	330	EAST	LEA

Bottom Hole Location If Different From Surface

UL or lot No.	Section	Township	Range	Lot Idn	Feet from the	North/South line	Feet from the	East/West line	County
1	34	16-S	37-E		1875	SOUTH	555	EAST	LEA

Dedicated Acres	Joint or Infill	Consolidation Code	Order No.
80			

NO ALLOWABLE WILL BE ASSIGNED TO THIS COMPLETION UNTIL ALL INTERESTS HAVE BEEN CONSOLIDATED
OR A NON-STANDARD UNIT HAS BEEN APPROVED BY THE DIVISION

						<p>OPERATOR CERTIFICATION</p> <p><i>I hereby certify the the information contained herein is true and complete to the best of my knowledge and belief.</i></p> <p><u>Richard C. Gilliland</u> Signature</p> <p><u>Richard C. Gilliland</u> Printed Name</p> <p><u>Vice President</u> Title</p> <p><u>March 22, 2001</u> Date</p>
						<p>SURVEYOR CERTIFICATION</p> <p><i>I hereby certify that the well location shown on this plat was plotted from field notes of actual surveys made by me or under my supervision, and that the same is true and correct to the best of my belief.</i></p> <p><u>FEBRUARY 8, 2001</u> Date Surveyed</p> <p><u>AWB</u> Signature & Seal of Professional Surveyor</p> <p><u>Barry E. Eason</u> 2/27/01 01-11-0208</p> <p>Certificate No. <u>RONALD J. EIDSON</u> 3230 <u>GARY EIDSON</u> 12841</p>
						<p>NAD 27 NME Y = 684258 X = 838508</p> <p>BOTTOM HOLE LOCATION</p> <p>555"</p> <p>1235.8'</p> <p>5681'</p> <p>330'</p> <p>099'</p> <p>N10°19'31"W</p> <p>SURFACE HOLE LOCATION</p> <p>NAD 27 NME Y = 683044.7 X = 838742.4</p>

LOCATION VERIFICATION MAP

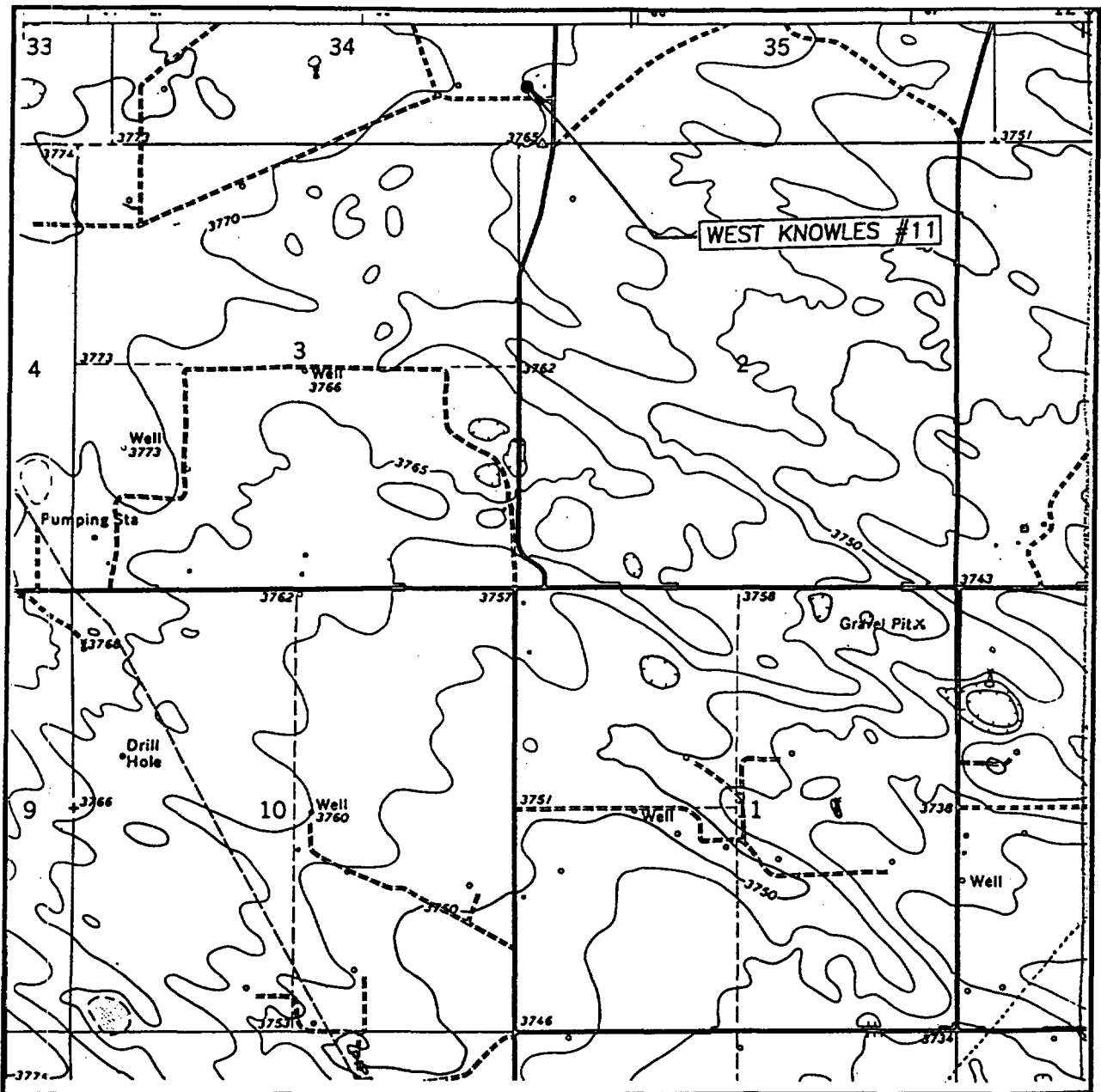

SCALE: 1" = 2000'

CONTOUR INTERVAL: 20'

HUMBLE CITY, N.M.

SEC. 34 TWP. 16-S RGE. 37-E

SURVEY N.M.P.M.

COUNTY LEA

DESCRIPTION 660' FSL & 330' FEL

ELEVATION 3766'

OPERATOR CIMARRON EXPLORATION COMPANY

LEASE WEST KNOWLES, N.M.

U.S.G.S. TOPOGRAPHIC MAP
HUMBLE CITY, N.M.

JOHN WEST SURVEYING
HOBBS, NEW MEXICO
(505) 393-3117

VICINITY MAP

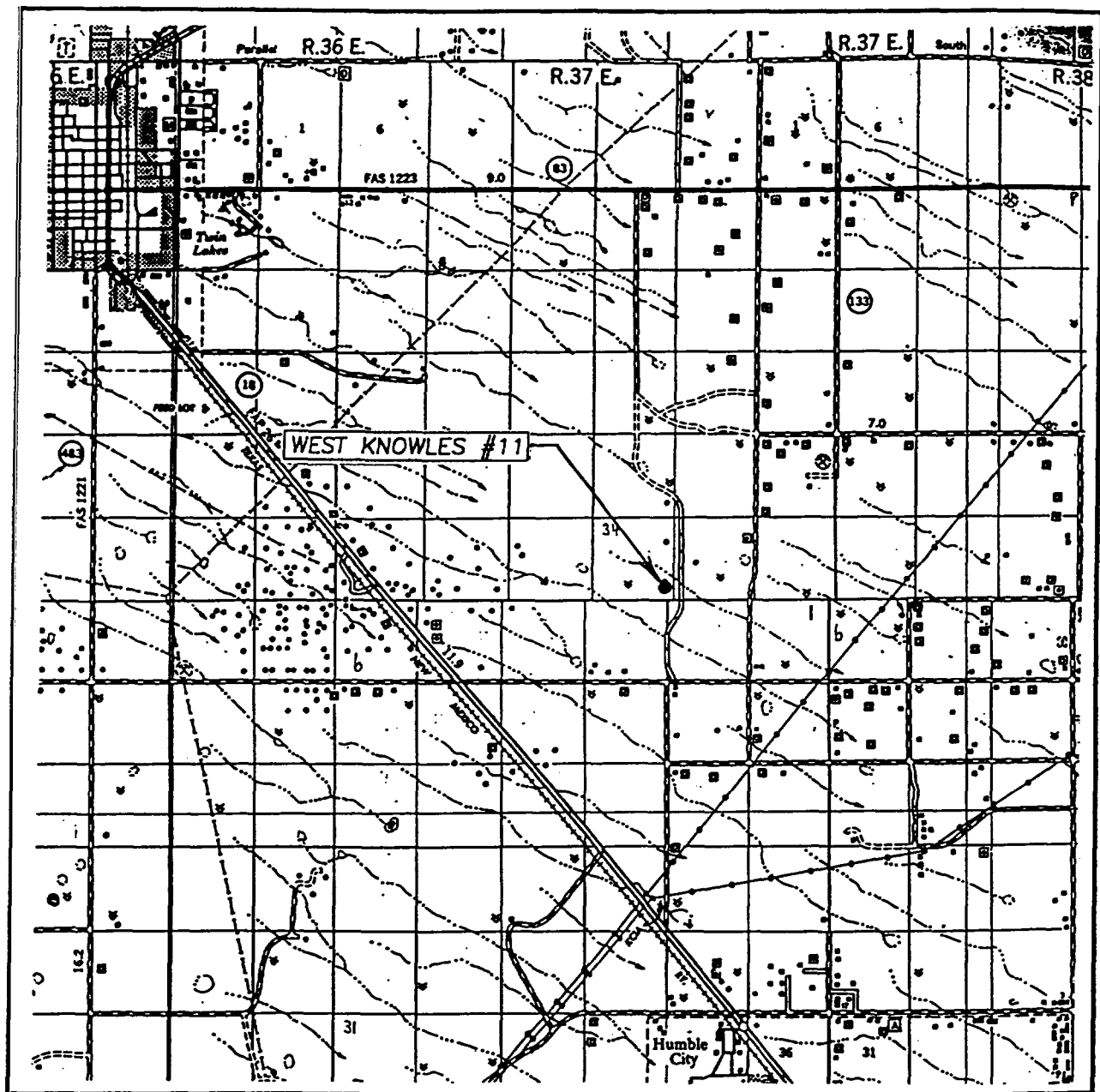

SCALE: 1" = 2 MILES

SEC. 34 TWP. 16-S RGE. 37-E

SURVEY N.M.P.M.

COUNTY LEA

DESCRIPTION 660'FSL & 330'FEL

ELEVATION 3766'

OPERATOR CIMARRON EXPLORATION COMPANY

LEASE WEST KNOWLES, N.M.

JOHN WEST SURVEYING
HOBBS, NEW MEXICO
(505) 393-3117

[illegible]

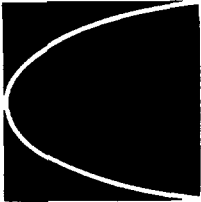

CIMARRON

EXPLORATION COMPANY

P.O. Box 1592
Roswell, New Mexico 88202
Phone: (505) 623-9799
Fax: (505) 624-1006

May 29, 2001

OIL CONSERVATION DIV.
01 MAY 31 PM 1:54

Mr. Michael Stogner
Oil Conservation Division
P.O. Box 6429
Santa Fe, NM 87504

Re: Request for Amendment to Order No. R-8992
West Knowles No. 11
Sec. 34, T-16-S, R-37-E
Lea County, New Mexico

Dear Mr. Stogner:

A letter together with the appropriate forms in regard to the referenced request was mailed to you May 16, 2001 (copy enclosed). Enclosed are four return receipt forms reflecting that each of the offset operators received a copy of that letter and the forms included therewith.

Should you have any questions or need additional information, please let me know. Thank you.

Sincerely,

Janet A. Royal

/jar

Enclosure

cc: Donna Pitzer
OCD – Division I
1625 North French Drive
Hobbs, NM 88240

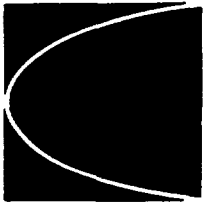

CIMARRON

EXPLORATION COMPANY

P.O. Box 1592
Roswell, New Mexico 88202
Phone: (505) 623-9799
Fax: (505) 624-1006

May 16, 2001

Mr. Michael Stogner
Oil Conservation Division
P.O. Box 6429
Santa Fe, New Mexico 87504

Re: Request For Amendment to Order No. R-8992
West Knowles No. 11
Sec. 34, T-16-s, R-37-E
Lea County, New Mexico

Dear Mr. Stogner:

Cimarron Exploration Company is the operator of the referenced well, which is currently completed in the Shipp Strawn pool. Cimarron desires to re-enter this well at the current location and laterally extend the wellbore in the Strawn formation approximately 1,236 feet to the north-northwest. Based on existing field rules, this will place the bottom of the wellbore at an orthodox location in the NE/4 SE/4 of Section 34, T-16-S, R-37-E. Please refer to the enclosed forms C-101 and C-102 for additional details regarding the proposed operation.

The surface location of this well is currently at an unorthodox location previously approved by Order No. R-8992 issued by the Oil Conservation Division on August 31, 1989. At this time, Cimarron respectfully requests an amendment to this order to allow for the operation as detailed herein.

By copy of this letter, all offset operators are being notified of Cimarron's request herein. The offset operators are shown on the enclosed plat.

Please advise if any additional information is required at this time. Thank you for your consideration of this matter.

Sincerely,

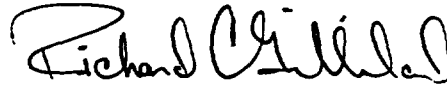
A handwritten signature in black ink, appearing to read "Richard C. Gilliland". The signature is fluid and cursive, with the first name "Richard" being more prominent than the last name "Gilliland".

Richard C. Gilliland
Vice President

RCG/jar
Enclosures

cc: Donna Pitzer
OCD – Division I
1625 North French Drive
Hobbs, NM 88240

Amerind Oil Company
415 West Wall, Suite 500
Midland, TX 79701-4467

Chase Oil Corporation
P.O. Box 1767
Artesia, NM 88211-1767

Texland Petroleum – Hobbs, LLC
816 NW County Road
Hobbs, NM 88240

SENDER: COMPLETE THIS SECTION

- Complete items 1, 2, and 3. Also complete item 4 if Restricted Delivery is desired.
- Print your name and address on the reverse so that we can return the card to you.
- Attach this card to the back of the mailpiece, or on the front if space permits.

1. Article Addressed to:

Michael Stogner
Oil Conservation Division
P.O. Box 6429
Santa Fe, NM 87504

RECEIVED MAY 21 2001

2. Article Number (Copy from service label)

7099 3400 0018 5405 1781

PS Form 3811, July 1999

Domestic Return Receipt

102595-99-M-1789

COMPLETE THIS SECTION ON DELIVERY

A. Received by (Please Print Clearly) B. Date of Delivery

M. Balink MAY 18 2001

C. Signature

xm Balink ☐ Agent ☐ AddresseeD. Is delivery address different from item 1? ☒ Yes ☐ No

If YES, enter delivery address below:

3. Service Type

☒ Certified Mail ☐ Express Mail
☐ Registered ☐ Return Receipt for Merchandise
☐ Insured Mail ☐ C.O.D.

4. Restricted Delivery? (Extra Fee)

☐ Yes

SENDER: COMPLETE THIS SECTION

- Complete items 1, 2, and 3. Also complete item 4 if Restricted Delivery is desired.
- Print your name and address on the reverse so that we can return the card to you.
- Attach this card to the back of the mailpiece, or on the front if space permits.

1. Article Addressed to:

Texland Petroleum
777 Main Street - Suite 3200
Fort Worth, TX 76102

2. Article Number (Copy from service label)

7099 3400 0018 5398 3137

PS Form 3811, July 1999

Domestic Return Receipt

102595-99-M-1789

COMPLETE THIS SECTION ON DELIVERY

A. Received by (Please Print Clearly) B. Date of Delivery

PAUL NEWCOMB 5-23-01

C. Signature

x Paul Newcomb ☐ Agent ☐ AddresseeD. Is delivery address different from item 1? ☐ Yes ☐ No

If YES, enter delivery address below:

3. Service Type

☒ Certified Mail ☐ Express Mail
☐ Registered ☐ Return Receipt for Merchandise
☐ Insured Mail ☐ C.O.D.

4. Restricted Delivery? (Extra Fee)

☐ Yes

SENDER: COMPLETE THIS SECTION

- Complete items 1, 2, and 3. Also complete item 4 if Restricted Delivery is desired.
- Print your name and address on the reverse so that we can return the card to you.
- Attach this card to the back of the mailpiece, or on the front if space permits.

1. Article Addressed to:

Chase Oil Corporation
P.O. Box 1767
Artesia, NM 88211-1767

RECEIVED MAY 21 2001

2. Article Number (Copy from service label)

7099 3400 0018 5405 1798

PS Form 3811, July 1999

Domestic Return Receipt

102595-99-M-1789

COMPLETE THIS SECTION ON DELIVERY

A. Received by (Please Print Clearly) B. Date of Delivery

Sylvia Mills 5-18-01

C. Signature

x Sylvia Mills ☐ Agent ☐ AddresseeD. Is delivery address different from item 1? ☐ Yes ☐ No

If YES, enter delivery address below:

3. Service Type

☒ Certified Mail ☐ Express Mail
☐ Registered ☐ Return Receipt for Merchandise
☐ Insured Mail ☐ C.O.D.

4. Restricted Delivery? (Extra Fee)

☐ Yes

SENDER: COMPLETE THIS SECTION

- Complete items 1, 2, and 3. Also complete item 4 if Restricted Delivery is desired.
- Print your name and address on the reverse so that we can return the card to you.
- Attach this card to the back of the mailpiece, or on the front if space permits.

1. Article Addressed to:

Amerind Oil Company
415 West Wall, Suite 500
Midland, TX 79701-4467

COMPLETE THIS SECTION ON DELIVERY

A. Received by (Please Print Clearly) B. Date of Delivery

Mary Ann Brock 5-17-01

C. Signature

x Mary Ann Brock ☐ Agent ☐ AddresseeD. Is delivery address different from item 1? ☐ Yes ☐ No

If YES, enter delivery address below:

RECEIVED MAY 18 2001

3. Service Type

☒ Certified Mail ☐ Express Mail
☐ Registered ☐ Return Receipt for Merchandise
☐ Insured Mail ☐ C.O.D.

4. Restricted Delivery? (Extra Fee)

☐ Yes

2. Article Number (Copy from service label)

STATE OF NEW MEXICO
ENERGY AND MINERALS DEPARTMENT
OIL CONSERVATION DIVISION

IN THE MATTER OF THE HEARING
CALLED BY THE OIL CONSERVATION
DIVISION FOR THE PURPOSE OF
CONSIDERING:

CASE NO. 8696
Order No. R-8062

APPLICATION OF PENNZOIL COMPANY
FOR POOL CREATION, SPECIAL POOL
RULES, ASSIGNMENT OF DISCOVERY
ALLOWABLE, LEA COUNTY, NEW MEXICO

See Also Order No. R-8062-A

ORDER OF THE DIVISION

BY THE DIVISION:

This cause came on for hearing at 8 a.m. on September 11, 1985, at Santa Fe, New Mexico, before Examiner Gilbert P. Quintana.

NOW, on this 31st day of October, 1985, the Division Director, having considered the testimony, the record, and the recommendations of the Examiner, and being fully advised in the premises,

FINDS THAT:

- (1) Due public notice having been given as required by law, the Division has jurisdiction of this cause and the subject matter thereof.
- (2) The applicant, Pennzoil Company, seeks the creation of a new oil pool for Strawn production in Lea County, New Mexico and the assignment of a discovery allowable to said pool.
- (3) The applicant further seeks the establishment of temporary pool rules, including a provision for 80-acre well spacing and proration units for the proposed pool.
- (4) The evidence presently available indicates that applicant's Viersen Well No. 1, located in Unit I, Section 4, Township 17 South, Range 37 East, Lea County, New Mexico, has discovered a separate common source of supply which should be designated the Shipp-Strawn Pool.
- (5) The vertical limits of the proposed pool should be the Strawn formation as found on the porosity log of the

discovery well, the Vierson Well No. 1, from 11,138 feet to 11,255 feet.

(6) The horizontal limits for the proposed Shipp-Strawn Pool should be as follows:

LEA COUNTY, NEW MEXICO

TOWNSHIP 16 SOUTH, RANGE 37 EAST, NMPM

Section 33: SE/4 and E/2 SW/4

Section 34: S/2

TOWNSHIP 17 SOUTH, RANGE 37 EAST, NMPM

Section 3: All

Section 4: E/2 and E/2 W/2

Section 9: NE/4 and E/2 NW/4

Section 10: N/2

(7) The above described area is adequate to cover the potential expansion of the subject pool and is designed to avoid overlaps and conflicts with other Strawn Pools in the immediate vicinity.

(8) The rules for this pool should be limited to the area described in Finding (6) above and should not apply to wells drilled within a mile of the outer boundary of this pool.

(9) The evidence presented has established that the discovery well has permeability in the range of 43 millidarcies and calculations utilizing this data show the well has the possible capability to drain an area of 80 acres.

(10) The discovery well for the said pool, Vierson Well No. 1, located in Unit I of Section 4, Township 17 South, Range 37 East, NMPM, Lea County, New Mexico is entitled to and should receive a bonus discovery oil allowable in the amount of 55,690 barrels, based upon the top of the perforation in said well at 11,138 feet, to be assigned over a two-year period (77 barrels of oil per day).

(11) In order to prevent the economic loss caused by the drilling of unnecessary wells, to avoid the augmentation of risk arising from the drilling of an excessive number of wells, to prevent reduced recovery which might result from the drilling of too few wells, and to otherwise prevent waste and protect correlative rights, temporary special pool rules and

regulations providing for 80-acre spacing units should be promulgated for the Shipp-Strawn Pool.

(12) The temporary special rules and regulations should provide for specified well locations in order to assure orderly development of the pool and protect correlative rights.

(13) The temporary special rules and regulations should be established for a one-year period in order to allow the operators in the subject pool to gather reservoir information to establish conclusively whether the area can be efficiently and economically drained and developed by one well on 80-acre spacing on a permanent basis.

(14) This case should be reopened by the Division at an examiner hearing in November, 1986, at which time the operators in the subject pool should be prepared to appear and show cause why the Shipp-Strawn Pool should not be developed on other than 40-acre spacing units.

IT IS THEREFORE ORDERED THAT:

(1) A new pool in Lea County, New Mexico is hereby created and designated as the Shipp-Strawn Pool with vertical limits being the Strawn formation as found in the porosity log of the Vierson Well No. 1 from 11,138 feet to 11,255 feet and with horizontal limits described as follows:

LEA COUNTY, NEW MEXICO

TOWNSHIP 16 SOUTH, RANGE 37 EAST, NMPM

Section 33: SE/4 and E/2 SW/4
Section 34: S/2

TOWNSHIP 17 SOUTH, RANGE 37 EAST, NMPM

Section 3: All
Section 4: E/2 and E/2 W/2
Section 9: NE/4 and E/2 NW/4
Section 10: N/2

(2) The Pennzoil Company Vierson Well No. 1 located in Unit I, Section 4, Township 17 South, Range 37 East, Lea County, New Mexico, is hereby authorized an oil discovery allowable of 55,690 barrels to be assigned to said well at the rate of 77 barrels per day in accordance with Rule 509 of the Division Rules and Regulations.

(3) Temporary Special Rules and Regulations for the Shipp-Strawn Pool, Lea County, New Mexico, are hereby promulgated as follows:

SPECIAL RULES AND REGULATIONS
FOR THE
SHIPP-STRAWN POOL

RULE 1. Each well completed or recompleted in the Shipp-Strawn Pool or in the Strawn formation within said pool limits, shall be spaced, drilled, operated and produced in accordance with the Special Rules and Regulations hereinafter set forth.

RULE 2. Each well shall be located on a standard unit containing 80 acres, more or less, consisting of the N/2, S/2, E/2, or W/2 of a governmental quarter section.

RULE 3. The Division Director may grant an exception to the requirements of Rule 2 without notice and hearing when an application has been filed for a non-standard unit and the unorthodox size or shape of the unit is necessitated by a variation in the legal subdivision of the U. S. Public Land Surveys, or the following facts exist and the following provisions are complied with:

- (a) The non-standard unit consists of quarter-quarter sections or lots that are contiguous by a common bordering side.
- (b) The non-standard proration unit lies wholly within a single governmental quarter section.
- (c) The applicant presents written consent in the form of waivers from all offset operators and from all operators owning interests in the quarter section or in which the non-standard unit is situated and which acreage is not included in said non-standard unit.
- (d) In lieu of paragraph (c) of this rule, the applicant may furnish proof of the fact that all of the aforesaid operators were notified by registered or certified mail of his intent to form such non-standard unit. The Director may approve the application if no such operator has entered an objection to the formation of such non-standard unit within 30 days after the Director has received the application.

RULE 4. Each well shall be located no closer than 330 feet to the outer boundary of its spacing unit and not closer than 990 feet to any other well capable of producing from the Strawn formation.

RULE 5. The Division Director may grant an exception to the requirements of Rule 4 without notice and hearing when an application has been filed for an unorthodox location necessitated by topographical conditions or the recompletion of a well previously drilled to another horizon. All operators offsetting the proposed location shall be notified of the application by registered or certified mail, and the application shall certify that such notice has been furnished. The Director may approve the application upon receipt of written waivers from all operators offsetting the proposed location or if no objection to the unorthodox location has been entered within 20 days after the Director has received the application.

RULE 6. An 80-acre proration unit (79 through 81 acres) in the Shipp-Strawn Pool shall be assigned an 80-acre depth bracket allowable of 445 barrels per day and in the event there is more than one well on an 80-acre proration unit, the operator may produce the allowable assigned to the unit from the wells on the unit in any proportion.

The allowable assigned to a non-standard unit shall bear the same ratio to a standard allowable as the acreage in such non-standard unit bears to 80 acres.

RULE 7. The limiting gas-oil ratio for the pool shall be 2,000 cubic feet of gas for each barrel of oil produced.

IT IS FURTHER ORDERED THAT:

(4) The locations of all wells presently drilling to or completed in the Shipp-Strawn Pool are hereby approved.

(5) Pursuant to Paragraph A. Section 70-2-18, NMSA, 1978, contained in Chapter 271, Laws of 1969, existing wells in the Shipp-Strawn Pool shall have dedicated thereto 80 acres in accordance with the foregoing pool rules; or, pursuant to Paragraph C. of said Section 65-3-14.5, existing wells may have non-standard spacing or proration units established by the Division and dedicated thereto.

(6) Failure to file new Forms C-102 with the Division dedicating 80 acres to a well or to obtain a non-standard unit approved by the Division within 60 days from the date of this order shall subject the well to cancellation of allowable.

Until said Form C-102 has been filed or until a non-standard unit has been approved, and subject to said 60-day limitation, each well presently drilling to or completed in the Shipp-Strawn Pool shall receive no more than one-half of a standard allowable for the pool.

(7) This case shall be reopened by the Division at an examiner hearing in November, 1986, at which time the operators in the subject pool may appear and show cause why the Shipp-Strawn Pool should not be developed on other than 40-acre spacing units.

(8) Jurisdiction of this cause is retained for the entry of such further orders as the Division may deem necessary.

DONE at Santa Fe, New Mexico, on the day and year hereinabove designated.

STATE OF NEW MEXICO
OIL CONSERVATION DIVISION

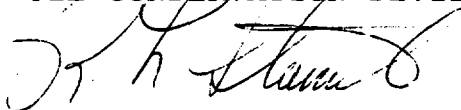

R. L. STAMETS,
Director

S E A L

STATE OF NEW MEXICO
ENERGY AND MINERALS DEPARTMENT
OIL CONSERVATION DIVISION

IN THE MATTER OF THE HEARING
CALLED BY THE OIL CONSERVATION
DIVISION FOR THE PURPOSE OF
CONSIDERING:

CASE NO. 8790
Order No. R-8062-A

APPLICATION OF THE OIL CONSERVATION
DIVISION ON ITS OWN MOTION TO AMEND
DIVISION ORDER NO. R-8062 AND TO
CONTRACT THE HORIZONTAL LIMITS OF THE
EAST LOVINGTON-PENNSYLVANIAN POOL,
LEA COUNTY, NEW MEXICO.

See Also Order No. R-8062

ORDER OF THE DIVISION

BY THE DIVISION:

This cause came on for hearing at 8 a.m. on December 18, 1985, at Santa Fe, New Mexico, before Examiner Michael E. Stogner.

NOW, on this 21st day of January, 1986, the Division Director, having considered the testimony, the record, and the recommendations of the Examiner, and being fully advised in the premises,

FINDS THAT:

(1) Due public notice having been given as required by law, the Division has jurisdiction of this cause and the subject matter thereof.

(2) Division Order No. R-8062 issued on October 31, 1985, in Case No. 8696 classified, created and designated the Shipp-Strawn Pool, promulgated temporary special rules and regulations therefor, and assigned an oil discovery allowable to the Pennzoil Company Viersen Well No. 1, located 2130 feet from the South line and 660 feet from the East line (Unit I) of Section 4, Township 17 South, Range 37 East, NMPM, all in Lea County, New Mexico.

(3) In the present case, the New Mexico Oil Conservation Division (Division) on its own motion seeks the following amendments to Division Order No. R-8062:

- (a) correction of the oil discovery allowable assigned to Pennzoil Company Viersen Well No. 1;

- (b) amendment of the horizontal limits of the pool;
- (c) revision of the well location provisions of the Special Pool Rules to require well locations to be no further than 150 feet from the center of a governmental quarter-quarter section or lot; and
- (d) deletion of the limitation imposed on the pool restricting the applicability of the Special Pool Rules to the area within the pool boundaries.

(4) The Division further seeks to contract the horizontal limits of the East Lovington-Pennsylvanian Pool by the deletion therefrom of the NW/4 NW/4 of Section 4, Township 17 South, Range 37 East, NMPM, Lea County, New Mexico.

(5) The evidence presented in this case indicated that:

- (a) The NW/4 NW/4 of said Section 4 is more properly classified as being in the Shipp-Strawn Pool than the East Lovington-Pennsylvanian Pool;
- (b) there is insufficient evidence at this time to include more than the N/2 and SE/4 of said Section 4 within the boundaries of said Shipp-Strawn Pool;
- (c) the special rules for the Shipp-Strawn Pool should not be limited to that area only within the boundaries of said pool but should apply also within one mile thereof; and,
- (d) rules requiring well locations within 150 feet of the center of the quarter-quarter section would better serve to protect the correlative rights of the owners within said pool.

(6) The evidence presented at this hearing also demonstrated that the discovery allowable assigned to the Pennzoil Company Viersen Well No. 1, located 2130 feet from the South line and 660 feet from the East line of said Section 4, was improperly calculated and should be reduced to 55,595 barrels of oil total.

(7) An order entered amending said discovery allowable, revising said pool boundaries as described above, and incorporating the above described changes in special pool rules

will better protect correlative rights and will not result in waste.

(8) The effective date of this order should be January 21, 1986.

IT IS THEREFORE ORDERED THAT:

(1) The East Lovington-Pennsylvanian Pool as heretofore defined and described is hereby contracted by the deletion therefrom of the NW/4 NW/4 of Section 4, Township 17 South, Range 37 East, NMPM, Lea County, New Mexico.

(2) The horizontal limits of the Shipp-Strawn Pool, as heretofore defined and described in Lea County, New Mexico, are hereby amended to include therein the following described area only:

TOWNSHIP 17 SOUTH, RANGE 37 EAST, NMPM
Section 4: N/2 and SE/4

(3) The temporary Special Rules and Regulations for the Shipp-Strawn Pool are hereby amended to read in their entirety as follows:

"SPECIAL RULES AND REGULATIONS
FOR THE
SHIPP-STRAWN POOL

RULE 1. Each well completed or recompleted in the Shipp-Strawn Pool or in the Strawn formation within one mile of the Shipp-Strawn Pool, and not nearer to or within the limits of another designated Strawn pool shall be spaced, drilled, operated, and prorated in accordance with the Special Rules and Regulations hereinafter set forth.

RULE 2. Each well completed or recompleted in the Shipp-Strawn Pool shall be located on a unit containing 80 acres, more or less, which consists of the N/2, S/2, E/2, or W/2 of a single governmental quarter section; provided, however, nothing contained herein shall be construed as prohibiting the drilling of a well on each of the quarter-quarter sections in the unit.

RULE 3. For good cause shown, the Director may grant an exception to the requirements of Rule 2 without notice and hearing when the application is for a non-standard unit comprising a single quarter-quarter section or lot. All operators offsetting the proposed non-standard unit shall be

notified of the application by registered or certified mail, and the application shall state that such notice has been furnished. The Director may approve the application if, after a period of 30 days, no offset operator has entered an objection to the formation of such non-standard unit.

The allowable assigned to any such non-standard unit shall bear the same ratio to a standard allowable in the Shipp-Strawn Pool as the acreage in such non-standard unit bears to 80 acres.

RULE 4. Each well shall be located within 150 feet of the center of a governmental quarter-quarter section or lot.

RULE 5. The Division Director may grant an exception to the requirements of Rule 4 without notice and hearing when an application has been filed for an unorthodox location necessitated by topographical conditions or the recompletion of a well previously drilled to another horizon. All operators offsetting the proration unit shall be notified of the application by registered or certified mail, and the application shall state that such notice has been furnished. The Director may approve the application upon receipt of written waivers from all operators offsetting the proration unit or if no objection to the unorthodox location has been entered within 20 days after the Director has received the application.

RULE 6. Top unit allowable for a standard proration unit (79 through 81 acres) shall be based on a depth bracket allowable of 445 barrels per day, and in the event there is more than one well on an 80-acre proration unit, the operator may produce the allowable assigned to the unit from the wells on the unit in any proportion.

The allowable assigned to a non-standard proration unit shall bear the same ratio to a standard allowable as the acreage in such non-standard unit bears to 80 acres."

IT IS FURTHER ORDERED THAT:

(4) The location of any well permitted, in drilling to, or completed in the Strawn formation within the boundaries of the Shipp-Strawn Pool prior to January 21, 1986, which location was orthodox under pool rules existing prior to that time and which location is now unorthodox, is hereby approved.

(5) The locations of any other wells presently permitted in, drilling to, or completed in the currently defined Shipp-Strawn Pool or in the Strawn formation within one mile

thereof are hereby approved; the operator of any well having an unorthodox location shall notify the Hobbs District office of the Division in writing of the name and location of the well on or before April 1, 1986.

(6) The amount of the discovery allowable assigned to the Pennzoil Company Viersen Well No. 1 located 2130 feet from the South line and 660 feet from the East line of Section 4, Township 17 South, Range 37 East, NMPM, Lea County, New Mexico, as set out in Division Order No. R-8062 is hereby amended to a total of 55,595 barrels of oil to be produced at a rate not to exceed 76 barrels per day in accordance with Division General Rule 509.

(7) The effective date of this order and of the pool and pool rule changes included herein shall be January 21, 1986.

(8) Pursuant to Paragraph A. of Section 70-2-18, NMSA (1978), existing wells in the Shipp-Strawn Pool shall have dedicated thereto 80 acres in accordance with the foregoing pool rules; or, pursuant to Paragraph C. of said Section 70-2-18, existing wells may have non-standard spacing or proration units established by the Division and dedicated thereto.

Failure to file new Forms C-102 with the division dedicating 80 acres to a well or to obtain a non-standard unit approved by the Division within 60 days from the date of this order shall subject the well to cancellation of allowable. Until said Form C-102 has been filed or until a non-standard unit has been approved, and subject to said 60-day limitation, each well presently drilling to or completed in the Shipp-Strawn Pool or in the Strawn formation within one mile thereof shall receive no more than one-half of a standard allowable for the pool.

(9) This case shall be reopened at an examiner hearing in November, 1986, at which time the operators in the subject pool may appear and show cause why the Shipp-Strawn Pool should not be developed on 40-acre proration units.

(10) Jurisdiction of this cause is retained for the entry of such further orders as the Division may deem necessary.

-6-

Case No. 8790

Order No. R-8062-A

DONE at Santa Fe, New Mexico, on the day and year
hereinabove designated.

STATE OF NEW MEXICO
OIL CONSERVATION DIVISION

A handwritten signature in dark ink, appearing to read "R. L. Stamets", is written over the printed name.

R. L. STAMETS
Director

S E A L

STATE OF NEW MEXICO
ENERGY AND MINERALS DEPARTMENT
OIL CONSERVATION DIVISION

IN THE MATTER OF THE HEARING
CALLED BY THE OIL CONSERVATION
DIVISION FOR THE PURPOSE OF
CONSIDERING:

IN THE MATTER OF CASE NOS. 8696 AND 8790 BEING REOPENED
PURSUANT TO THE PROVISIONS OF ORDER NOS. R-8062 AND
R-8062-A, RESPECTIVELY, WHICH PROMULGATED AND AMENDED
TEMPORARY SPECIAL RULES AND REGULATIONS FOR THE SHIPP-
STRAWN POOL, LEA COUNTY, NEW MEXICO.

CASE NOS. 8696 and 8790
Order No. R-8062-B

ORDER OF THE DIVISION

BY THE DIVISION:

This cause came on for hearing at 8:15 a.m. on November 19, 1986, at Santa Fe, New Mexico, before Examiner David R. Catanach.

NOW, on this 18th day of December, 1986, the Division Director, having considered the testimony, the record, and the recommendations of the Examiner, and being fully advised in the premises,

FINDS THAT:

(1) Due public notice having been given as required by law, the Division has jurisdiction of this cause and the subject matter thereof.

(2) Division Case Nos. 8696 and 8790 were consolidated at the time of the hearing for the purpose of testimony.

(3) By Order No. R-8062 dated October 31, 1985, and issued in Case No. 8696, the Division created, defined, and promulgated temporary special rules and regulations for the Shipp-Strawn Pool, Lea County, New Mexico, including a provision for 80-acre spacing and proration units.

(4) Subsequent to the issuance of said order, the Division, on its own motion, called Case No. 8790 and issued Order No. R-8062-A which amended certain portions of the special rules and regulations promulgated by Order No. R-8062, including well location requirements, horizontal limits, and the area to be governed by said rules.

Cases Nos. 8696 and 8790
Order No. R-8062-B

(5) Pursuant to the provisions of Order Nos. R-8062 and R-8062-A, both cases were reopened to allow the operators in the subject pool to appear and show cause why the Shipp-Strawn Pool should not be developed on 40-acre spacing and proration units.

(6) Inasmuch as the subject matter in both cases is the same, that being the consideration of adopting permanent special rules and regulations for the Shipp-Strawn Pool, one order should be issued for both cases.

(7) The evidence presented at the hearing establishes that one well in the Shipp-Strawn Pool can efficiently and economically drain and develop 80 acres.

(8) The special rules and regulations promulgated by Order No. R-8062 as amended by Order No. R-8062-A have afforded and will afford to the owner of each property in the pool the opportunity to produce his just and equitable share of the oil in the pool.

(9) In order to prevent the economic loss caused by the drilling of unnecessary wells, to avoid the augmentation of risk arising from the drilling of an excessive number of wells, to prevent reduced recovery which might result from the drilling of too few wells, and to otherwise prevent waste and protect correlative rights, the special rules and regulations promulgated by Order No. R-8062 as amended by Order No. R-8062-A should be continued in full force and effect until further order of the Division.

IT IS THEREFORE ORDERED THAT:

(1) The special rules and regulations governing the Shipp-Strawn Pool, Lea County, New Mexico, promulgated by Order No. R-8062 as amended by Order No. R-8062-A, are hereby continued in full force and effect until further order of the Division.

(2) Jurisdiction of this cause is retained for the entry of such further orders as the Division may deem necessary.

DONE at Santa Fe, New Mexico, on the day and year hereinabove designated.

STATE OF NEW MEXICO
OIL CONSERVATION DIVISION

R. L. STAMETS
Director

S E A L
fd/

STATE OF NEW MEXICO
ENERGY, MINERALS, AND NATURAL RESOURCES DEPARTMENT
OIL CONSERVATION DIVISION

IN THE MATTER OF THE HEARING
CALLED BY THE OIL CONSERVATION
DIVISION FOR THE PURPOSE OF
CONSIDERING:

CASE NO. 9728
Order No. R-8992

APPLICATION OF CONOCO INC. FOR
AN UNORTHODOX OIL WELL LOCATION,
LEA COUNTY, NEW MEXICO.

ORDER OF THE DIVISION

BY THE DIVISION:

This cause came on for hearing at 8:15 a.m. on August 23, 1989, at Santa Fe, New Mexico, before Examiner David R. Catanach.

NOW, on this 31st day of August, 1989, the Division Director, having considered the testimony, the record, and the recommendations of the Examiner, and being fully advised in the premises,

FINDS THAT:

(1) Due public notice having been given as required by law, the Division has jurisdiction of this cause and the subject matter thereof.

(2) The applicant, Conoco Inc., seeks approval of an unorthodox oil well location for its proposed West Knowles Well No. 11 to be drilled 660 feet from the South line and 330 feet from the East line (Unit P) of Section 34, Township 16 South, Range 37 East, NMPM, Undesignated Casey-Strawn Pool or Undesignated Shipp-Strawn Pool, Lea County, New Mexico, the S/2 SE/4 of said Section 34 to be dedicated to the subject well forming a standard 80-acre spacing and proration unit for said pool(s).

(3) The subject well is located within one mile of the outer boundaries of both the Casey-Strawn Pool and the Shipp-Strawn Pool, which are both currently governed by Special Rules and Regulations as promulgated by Division Order Nos. R-4992 and R-8062-A, respectively, and both of which require 80-acre spacing and proration units with wells to be located within 150 feet of the center of either quarter-quarter section or lot.

(4) The applicant presented geologic evidence and testimony which indicates that a well drilled at the proposed location should penetrate the Strawn formation at a more structurally advantageous position and in an area of greater porosity development than a well drilled at a standard location thereon, thereby increasing the likelihood of obtaining commercial production.

(5) The evidence further indicates that the affected offset acreage to the east is owned by the applicant.

(6) No other offset operator or interest owner appeared and objected to the proposed unorthodox location.

(7) Approval of the subject application will afford the applicant the opportunity to produce its just and equitable share of the oil in either of the subject pools, will prevent the economic loss caused by the drilling of unnecessary wells, avoid the augmentation of risk arising from the drilling of an excessive number of wells, and will otherwise prevent waste and protect correlative rights.

IT IS THEREFORE ORDERED THAT:

(1) The applicant, Conoco Inc., is hereby authorized to drill its West Knowles Well No. 11 at an unorthodox oil well location 660 feet from the South line and 330 feet from the East line (Unit P) of Section 34, Township 16 South, Range 37 East, NMPM, Undesignated Casey-Strawn Pool or Undesignated Shipp-Strawn Pool, Lea County, New Mexico.

(2) The S/2 SE/4 of said Section 34 shall be dedicated to the above-described well forming a standard 80-acre spacing and proration unit for said pool(s).

CASE NO. 9728
Order No. R-8992
Page -3-

(3) Jurisdiction of this cause is retained for the entry of such further orders as the Division may deem necessary.

DONE at Santa Fe, New Mexico, on the day and year hereinabove designated.

STATE OF NEW MEXICO
OIL CONSERVATION DIVISION

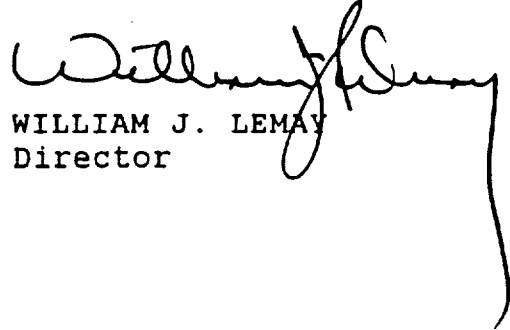
WILLIAM J. LEMAY
Director

S E A L

County Lea Pool Shipp-Strawn

TOWNSHIP 16 South Range 37 East NMPM

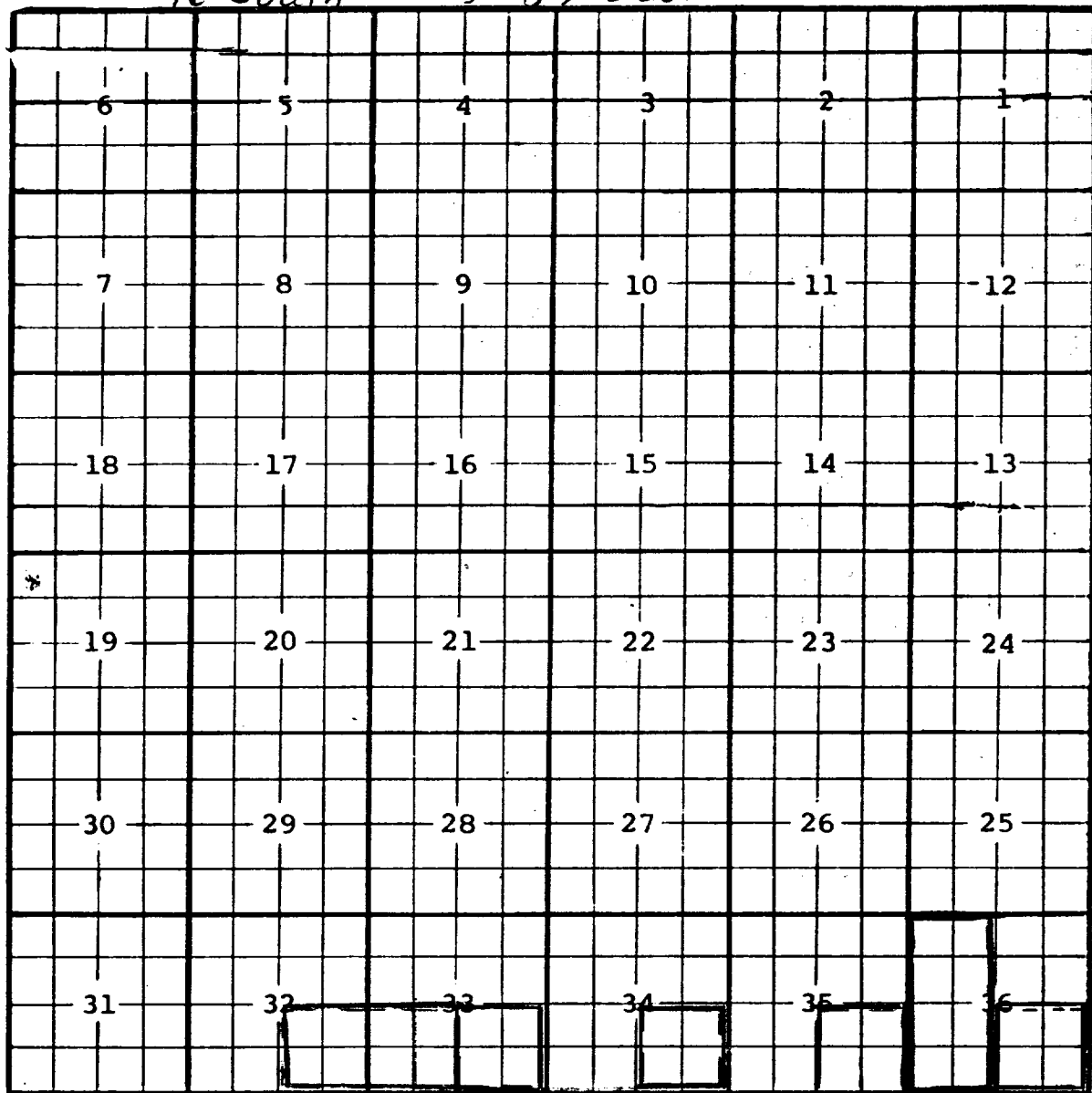

Description: $\frac{SE}{4}$ and $\frac{E}{2}SW\frac{1}{4}$ Sec. 33, $\frac{5}{2}$ Sec. 34 (R-8062, 10-31-85)

Amend horizontal limits to include $\frac{N}{2}$ and $\frac{SE}{4}$ Sec. 4 only, T12S, R37E (R-8062-A, 1-21-86) EXT: $\frac{SE}{4}$ Sec. 33 (R-8513, 9-18-87)

EXT: $\frac{SE}{4}$ SEC 32, $\frac{SW}{4}$ SEC 33 (R-8603, 7/19/88) EXT: $\frac{SE}{4}$ SEC 35 (R-8668, 6/10/88)

EXT: $\frac{SE}{4}$ SEC 36 (R-9741, 9-1-89) EXT: $\frac{SE}{4}$ SEC 34 (R-9120, 3-1-90)

EXT: $\frac{W}{2}$ SEC 36 (R-8772, 11-1-88)

County Lea Pool Shipp-Strawn

TOWNSHIP 17 South Range 32 East NMPM

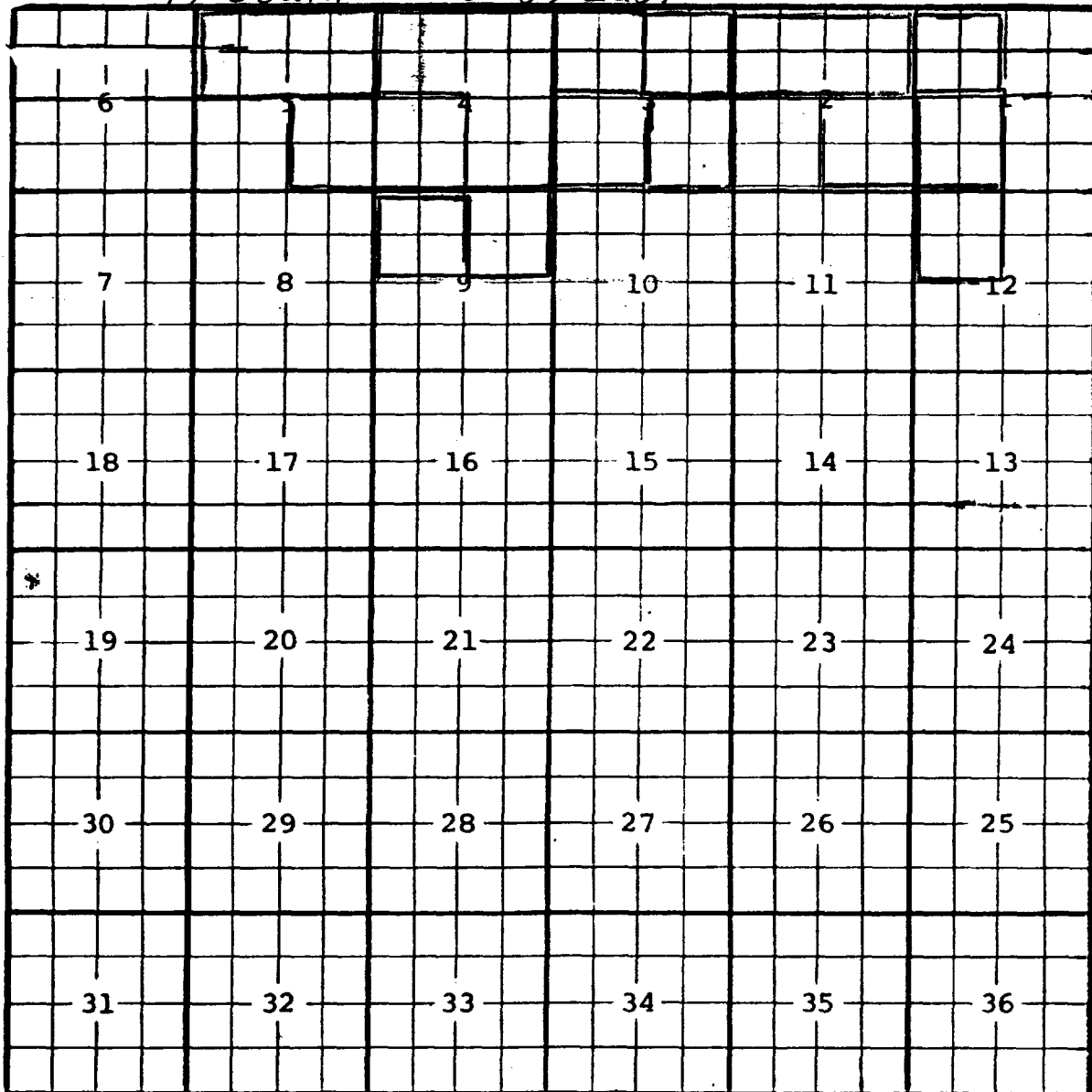

Description: All Sec. 3, E/2 and E/2 W/2 Sec. 4, NE/4 and E/2 NW/4 Sec. 9, N/2 Sec. 10 (R-8062, 10-31-85)

Amend horizontal limits to be N/2 and SE/4 Sec. 4^{un} (R-8062-A, 1-21-86)

Ext: NE/4 Sec. 9 (R-8214, 5-1-86) Ext: NW/4 Sec. 9 (R-8340, 11-3-86)

Ext: NW/4 Sec. 3 (R-8409, 3-7-87) Ext: NE/4 Sec. 3 (R-8451, 6-3-87)

Ext: SE/4 Sec. 3 (R-8533, 10-28-87) Ext: N/2 Sec. 5 (R-8603, 2-1-88)

Ext: N/2 Sec. 2, SW/4 Sec. 3 (R-8626, 4-1-88) Ext: SW/4 Sec. 2 (R-8856, 1-25-89)

Ext: SW/4 Sec. 1 (R-8901, 4-1-89) Ext: SE/4 Sec. 2, NW/4 Sec. 12 (R-9741, 9-1-89)

Ext: NW/4 Sec. 1 (R-8772, 11-1-88) Ext: SW/4 Sec. 4, SE/4 Sec. 5 (R-9472, 4-1-91)

County Lea Pool Shipp-Strawn

TOWNSHIP 16 South Range 37 East NMPM

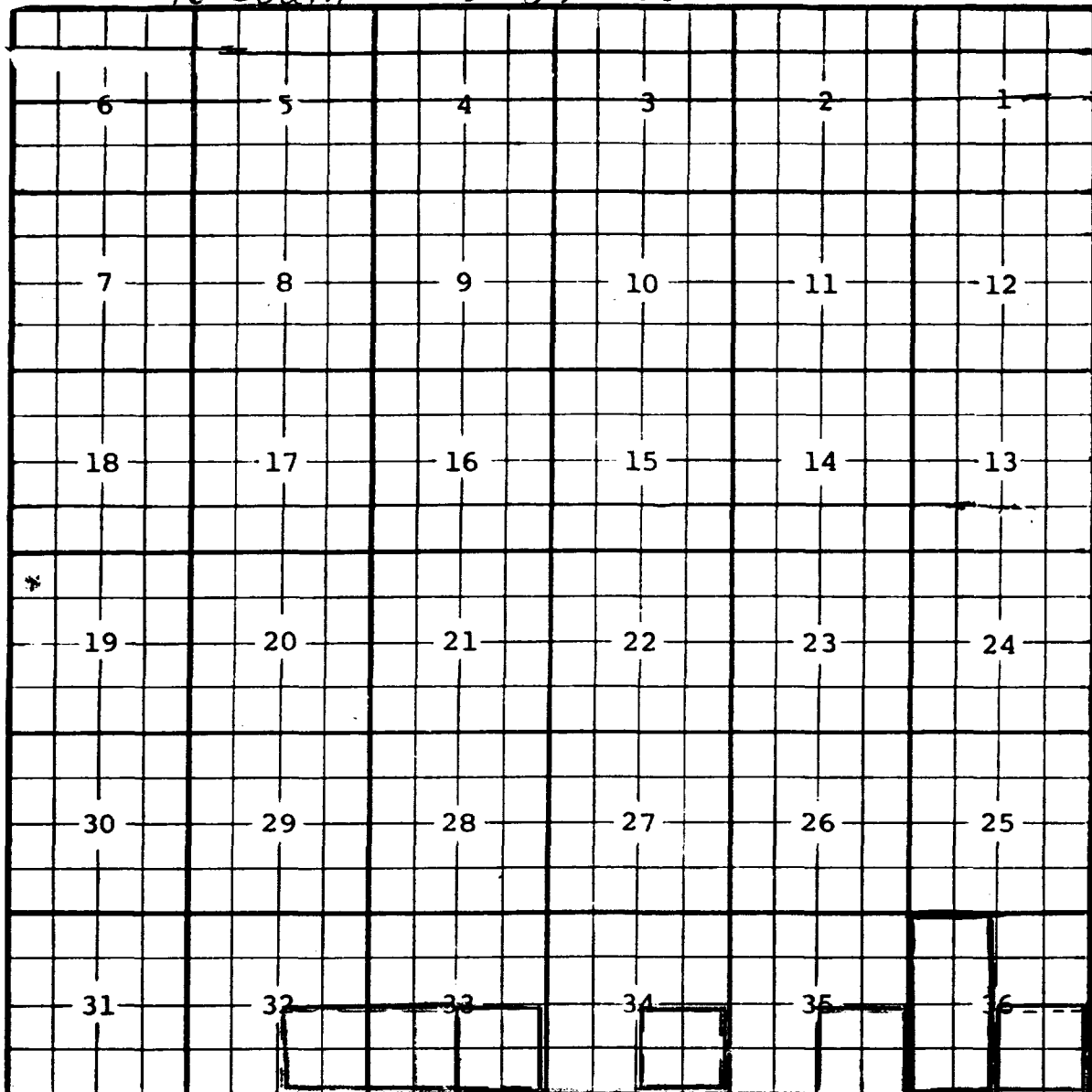

Description: $\frac{SE}{4}$ and $\frac{E}{2}SW\frac{1}{4}$ Sec. 33, $\frac{5}{8}$ Sec. 34 (R-8062, 10-31-85)
Amend horizontal limits to include $\frac{N}{2}$ and $\frac{SE}{4}$ Sec. 4 only, T12S,
R37E (R-8062-A, 1-21-86) EXT: $\frac{SE}{4}$ Sec. 33 (R-8513, 9-18-87)
EXT: $\frac{SE}{4}$ SEC 32, $\frac{SW}{4}$ SEC 33 (R-8603, 2/19/88) EXT: $\frac{SE}{4}$ SEC 35 (R-8668, 6/10/88)
EXT: $\frac{SE}{4}$ SEC 36 (R-9741, 9-1-89) EXT: $\frac{SE}{4}$ SEC 34 (R-9120, 3-1-90)
EXT: $\frac{W}{2}$ SEC 36 (R-8772, 11-1-88)

County LEA Pool SHIPP - STRAWN

TOWNSHIP 16 South, RANGE 38 East, NEW MEXICO PRINCIPAL MERIDIAN

5	6	7	8	9	10	11	12
13	14	15	16	17	18	19	20
21	22	23	24	25	26	27	28
29	30	31	32	33	34	35	36
37	38	39	40	41	42	43	44

EXT: SW/4 sec 31 (R-9741, 9-1-89)

District I
PO Box 1988, Hobbs, NM 88241-1988
District II
PO Drawer DD, Artesia, NM 88211-0719
District III
1000 Rio Brazos Rd., Aztec, NM 87418
District IV
PO Box 2088, Santa Fe, NM 87504-2088

State of New Mexico
Energy, Minerals & Natural Resources Department

OIL CONSERVATION DIVISION
PO Box 2088
Santa Fe, NM 87504-2088

Form C-104
Revised February 10, 1994
Instructions on back
Submit to Appropriate District Office
5 Copies

☐ AMENDED REPORT

I. REQUEST FOR ALLOWABLE AND AUTHORIZATION TO TRANSPORT

Operator name and Address Cimarron Exploration Company P.O. Box 1592 Roswell, NM 88202-1592		OGRID Number 164726
		Reason for Filing Code CH eff 9-1-97
API Number 30 - 0 25-30668	Pool Name Shipp Strawn	Pool Code 55695
Property Code 010020-21601	Property Name West Knowles	Well Number 11

II. ¹⁰ Surface Location

UL or lot no. P	Section 34	Township 16S	Range 37E	Lot Ida	Feet from the 660	North/South Line South	Feet from the 330	East/West Line East	County Lea
--------------------	---------------	-----------------	--------------	---------	----------------------	---------------------------	----------------------	------------------------	---------------

¹¹ Bottom Hole Location

UL or lot no.	Section	Township	Range	Lot Ida	Feet from the	North/South Line	Feet from the	East/West Line	County
Lee Code	Producing Method Code	Gas Connection Date	C-129 Permit Number	C-129 Effective Date	C-129 Expiration Date				

III. Oil and Gas Transporters

Transporter OGRID	Transporter Name and Address	POD	O/G	POD ULSTR Location and Description
734	Amoco Pipeline Intracorporate Transportation & Trucking	2252510	O	P 34 16S 37E
009171	GPM Gas Corporation	2252530	G	P 34 16S 37E

IV. Produced Water

POD 2252550	POD ULSTR Location and Description
----------------	------------------------------------

V. Well Completion Data

Spud Date	Ready Date	TD	PBTD	Perforations
Hole Size	Casing & Tubing Size	Depth Set	Sacks Cement	

VI. Well Test Data

Date New Oil	Gas Delivery Date	Test Date	Test Length	Tbg. Pressure	Csg. Pressure
Choke Size	Oil	Water	Gas	AOF	Test Method

I hereby certify that the rules of the Oil Conservation Division have been complied with and that the information given above is true and complete to the best of my knowledge and belief.

Signature:

Printed name:

Ronald C. Glover

Title:

President

Date:

08/13/97

Phone:

505-623-9799

Approved by:

Title:

Geologist

Approval Date:

SEP 26 1997

If this is a change of operator fill in the OGRID number and name of the previous operator
020311 Santa Fe Exploration Company

Previous Operator Signature

Robert B. Wilson

Printed Name

Robert B. Wilson, Trustee In Possession
of Santa Fe Exploration Company

Title

Date

08/13/97

Submit to Appropriate
District Office
State Lease - 6 copies
Fee Lease - 5 copies

DISTRICT I
P.O. Box 1980, Hobbs, NM 88240

DISTRICT II
P.O. Drawer DD, Artesia, NM 88210

DISTRICT III
1000 Rio Brazos Rd., Aztec, NM 87410

'90 APR 27 6 10 14

OIL CONSERVATION DIVISION

P.O. Box 2088
Santa Fe, New Mexico 87504-2088

WELL API NO.

30-025-30668

5. Indicate Type of Lease

STATE ☐ FEE ☒

6. State Oil & Gas Lease No.

WELL COMPLETION OR RECOMPLETION REPORT AND LOG

1a. Type of Well:

OIL WELL ☐ GAS WELL ☐ DRY ☐ OTHER ☐

b. Type of Completion:

NEW WELL ☒ WORK OVER ☐ DEEPEN ☐ PLUG BACK ☐ DIFF RESVR ☐ OTHER ☐

7. Lease Name or Unit Agreement Name

West Knowles

8. Well No.

#11

9. Pool name or Wildcat

East Shipp Strawn

4. Well Location

Unit Letter P: 660 Feet From The South Line and 330 Feet From The East Line

Section 34 Township 16S Range 37E NMPM Lea County

10. Date Spudded

10-16-89

11. Date T.D. Reached

11-28-89

12. Date Compl. (Ready to Prod.)

1-1-90

13. Elevations (DF & RKB, RT, GR, etc.)

3765' GL

14. Elev. Casinghead

3765'

15. Total Depth

11,704

16. Plug Back T.D.

11,656

17. If Multiple Compl. How

Many Zones? NA

18. Intervals Drilled By

Rotary Tools A11

Cable Tools

19. Producing Interval(s), of this completion - Top, Bottom, Name

Strawn 11,322 - 11,369

20. Was Directional Survey Made

yes

21. Type Electric and Other Logs Run

DLL/MLL/GR, LS-AC/GR, CBIL, DIPLOG, CBL

22. Was Well Cored

yes

CASING RECORD (Report all strings set in well)

CASING SIZE	WEIGHT LB/FT.	DEPTH SET	HOLE SIZE	CEMENTING RECORD	AMOUNT PULLED
13 3/8"	48#	500'	17-1/2"	525 AX Class C	125 AX
8 5/8"	32#	4735'	11"	1550 AX Class C "Lite	125 AX
5 1/2"	17#	11,701	7 7/8"	1st stage 824 AX Class "H"	
				2nd stage 992 AX " " "Lite	
				Tail 495 AX " "	90 AX

24. LINER RECORD

25. TUBING RECORD

SIZE	TOP	BOTTOM	SACKS CEMENT	SCREEN	SIZE	DEPTH SET	PACKER SET
					2 7/8"	11,248	11,233

26. Perforation record (interval, size, and number)

11,322 - 11,369 6 JSPF 3/4" shot diameter

27. ACID, SHOT, FRACTURE, CEMENT, SQUEEZE, ETC.

DEPTH INTERVAL	AMOUNT AND KIND MATERIAL USED
11,322 - 11,369	71 BBL 28% HCL-NE-FE 4 20% HCL

28. PRODUCTION

Date First Production 12-16-89		Production Method (Flowing, gas lift, pumping - Size and type pump) Flowing				Well Status (Prod. or Shut-in) Producing	
Date of Test 12-17-89	Hours Tested 24	Choke Size 24/64	Prod'n For Test Period	Oil - Bbl. 301	Gas - MCF 597	Water - Bbl. 0	Gas - Oil Ratio 1983
Flow Tubing Press. 155 psi	Casing Pressure 0	Calculated 24-Hour Rate	Oil - Bbl. 301	Gas - MCF 597	Water - Bbl. 0	Oil Gravity - API - (Corr.) 45.0	

29. Disposition of Gas (Sold, used for fuel, vented, etc.)

Sell to Phillips

Test Witnessed By

Dennis Paschal

30. List Attachments

31. I hereby certify that the information shown on both sides of this form is true and complete to the best of my knowledge and belief

Signature

W.W. Baker

Printed Name

W.W. Baker

Title Adm. Supervisor

Date 1-4-90

INSTRUCTIONS

This form is to be filed with the appropriate District Office of the Division not later than 20 days after the completion of any newly-drilled or deepened well. It shall be accompanied by one copy of all electrical and radio-activity logs run on the well and a summary of all special tests conducted, including drill stem tests. All depths reported shall be measured depths. In the case of directionally drilled wells, true vertical depths shall also be reported. For multiple completions, Items 25 through 29 shall be reported for each zone. The form is to be filed in quintuplicate except on state land, where six copies are required. See Rule 1105.

INDICATE FORMATION TOPS IN CONFORMANCE WITH GEOGRAPHICAL SECTION OF STATE

Southeastern New Mexico

T. Anhy _____
 T. Salt _____
 B. Salt _____
 T. Yates _____
 T. 7 Rivers _____
 T. Queen _____
 T. Grayburg _____
 T. San Andres 4947
 T. Glorieta 6400
 T. Paddock _____
 T. Blinbry _____
 T. Tubb 812
 T. Drinkard 8244
 T. Abo 9154
 T. Wolfcamp 9908
 T. Penn _____
 T. Cisco (Bough C) _____

T. Canyon _____
 T. Strawn 11,312
 T. Atoka 11,612
 T. Miss _____
 T. Devonian _____
 T. Silurian _____
 T. Montoya _____
 T. Simpson _____
 T. McKee _____
 T. Ellenburger _____
 T. Gr. Wash _____
 T. Delaware Sand _____
 T. Bone Springs _____
 T. _____
 T. _____
 T. _____

Northwestern New Mexico

T. Ojo Alamo _____
 T. Kirtland-Fruitland _____
 T. Pictured Cliffs _____
 T. Cliff House _____
 T. Menefee _____
 T. Point Lookout _____
 T. Mancos _____
 T. Gallup _____
 Base Greenhorn _____
 T. Dakota _____
 T. Morrison _____
 T. Todilto _____
 T. Entrada _____
 T. Wingate _____
 T. Chinle _____
 T. Permian _____
 T. Penn "A" _____

T. Penn. "B" _____
 T. Penn. "C" _____
 T. Penn. "D" _____
 T. Leadville _____
 T. Madison _____
 T. Elbert _____
 T. McCracken _____
 T. Ignacio Otzte _____
 T. Granite _____
 T. _____
 T. _____
 T. _____
 T. _____
 T. _____
 T. _____
 T. _____
 T. _____

OIL OR GAS SANDS OR ZONES

No. 1, from 11,322 to 11,369
 No. 2, from _____ to _____
 No. 3, from _____ to _____
 No. 4, from _____ to _____

IMPORTANT WATER SANDS

Include data on rate of water inflow and elevation to which water rose in hole.

No. 1, from _____ to _____ feet
 No. 2, from _____ to _____ feet
 No. 3, from _____ to _____ feet

LITHOLOGY RECORD (Attach additional sheet if necessary)

From	To	Thickness in Feet	Lithology	From	To	Thickness in Feet	Lithology
				8800	8910		Dolomite + Limestone + Sand
				8910	9000		Limestone
				9000	9030		Shale
				9030	9170		DOLOMITE
				9170	9310		LIMESTONE
				9310	10920		DOLOMITE
				10920	11290		LIMESTONE, SHALE + CHERT
				11290	11612		LIMESTONE
				11612	11675		SHALE
				11675	11700		SAND
4800	4960	160	Anhydrite				
4960	6390		Dolomite				
6390	6400		Sand				
6400	7150		Dolomite				
7150	7170		Sand				
7170	8510		Dolomite				
8510	8800		Limestone (+ some Dolo)				

Received

APR 13 1960

Submit 5 Copies
Appropriate District Office
DISTRICT I
P.O. Box 1980, Hobbs, NM 88240

DISTRICT II
P.O. Drawer DD, Artesia, NM 88210

DISTRICT III
1000 Rio Brazos Rd., Aztec, NM 87410

State of New Mexico
Energy, Minerals and Natural Resources Department

Form C-104
Revised 1-1-89
See Instructions
at Bottom of Page

OIL CONSERVATION DIVISION
P.O. Box 2088, Santa Fe, New Mexico 87504-2088

REQUEST FOR ALLOWABLE AND AUTHORIZATION
TO TRANSPORT OIL AND NATURAL GAS

Operator Santa Fe Exploration Company	Well API No. 30-025-30668
Address P. O. Box 1136, Roswell, NM 88202-1136	
Reason(s) for Filing (Check proper box) <input type="checkbox"/> Other (Please explain)	
New Well <input type="checkbox"/>	Change in Transporter of:
Recompletion <input type="checkbox"/>	Oil <input type="checkbox"/> Dry Gas <input type="checkbox"/>
Change in Operator <input checked="" type="checkbox"/>	Casinghead Gas <input type="checkbox"/> Condensate <input type="checkbox"/>

If change of operator give name and address of previous operator Conoco Inc.

II. DESCRIPTION OF WELL AND LEASE

Lease Name West Knowles	Well No. 11	Pool Name, Including Formation Shipp Strawn	Kind of Lease State, Federal or Fee	Lease No.
Location Unit Letter <u>P</u> : <u>660</u> Feet From The <u>south</u> Line and <u>330</u> Feet From The <u>East</u> Line Section <u>34</u> Township <u>16S</u> Range <u>37E</u> , NMPM, Lea County				

III. DESIGNATION OF TRANSPORTER OF OIL AND NATURAL GAS

Name of Authorized Transporter of Oil <input checked="" type="checkbox"/> or Condensate <input type="checkbox"/> Koch Oil Company	Address (Give address to which approved copy of this form is to be sent) P. O. Box 2239, Wichita, Kansas 67201					
Name of Authorized Transporter of Casinghead Gas <input checked="" type="checkbox"/> or Dry Gas <input type="checkbox"/> Phillips Petroleum	Address (Give address to which approved copy of this form is to be sent) P. O. Box 5400, Bartlesville, OK 74005					
If well produces oil or liquids, give location of tanks.	Unit P	Sec. 34	Twp. 16S	Rge. 37E	Is gas actually connected? Yes	When? Unknown

If this production is commingled with that from any other lease or pool, give commingling order number:

IV. COMPLETION DATA

Designate Type of Completion - (X)	Oil Well	Gas Well	New Well	Workover	Deepen	Plug Back	Same Res'v	Diff Res'v
Date Spudded	Date Compl. Ready to Prod.		Total Depth			P.B.T.D.		
Elevations (DF, RKB, RT, GR, etc.)	Name of Producing Formation		Top Oil/Gas Pay			Tubing Depth		
Perforations						Depth Casing Shoe		
TUBING, CASING AND CEMENTING RECORD								
HOLE SIZE	CASING & TUBING SIZE		DEPTH SET			SACKS CEMENT		

V. TEST DATA AND REQUEST FOR ALLOWABLE

OIL WELL (Test must be after recovery of total volume of load oil and must be equal to or exceed top allowable for this depth or be for full 24 hours.)

Date First New Oil Run To Tank	Date of Test	Producing Method (Flow, pump, gas lift, etc.)	
Length of Test	Tubing Pressure	Casing Pressure	Choke Size
Actual Prod. During Test	Oil - Bbls.	Water - Bbls.	Gas- MCF

GAS WELL

Actual Prod. Test - MCF/D	Length of Test	Bbls. Condensate/MMCF	Gravity of Condensate
Testing Method (pilot, back pr.)	Tubing Pressure (Shut-in)	Casing Pressure (Shut-in)	Choke Size

VI. OPERATOR CERTIFICATE OF COMPLIANCE

I hereby certify that the rules and regulations of the Oil Conservation Division have been complied with and that the information given above is true and complete to the best of my knowledge and belief.

Janet A. Royal
Signature Janet A. Royal Production Analyst
Printed Name January 8, 1992 Title (505) 623-2733
Date Telephone No.

OIL CONSERVATION DIVISION

Date Approved JAN 13 '92

By [Signature]
Title Geologist

INSTRUCTIONS: This form is to be filed in compliance with Rule 1104

- 1) Request for allowable for newly drilled or deepened well must be accompanied by tabulation of deviation tests taken in accordance with Rule 111.
- 2) All sections of this form must be filled out for allowable on new and recompleted wells.
- 3) Fill out only Sections I, II, III, and VI for changes of operator, well name or number, transporter, or other such changes.
- 4) Separate Form C-104 must be filed for each pool in multiply completed wells.

DISTRICT I
P.O. Box 1980, Hobbs, NM 88240

DISTRICT II
P.O. Drawer DD, Artesia, NM 88210

DISTRICT III
1000 Rio Brazos Rd., Aztec, NM 87410

OIL CONSERVATION DIVISION
P.O. Box 2088
Santa Fe, New Mexico 87504-2088

WELL API NO. 30-025-30668
5. Indicate Type of Lease STATE <input type="checkbox"/> FEE <input checked="" type="checkbox"/>
6. State Oil & Gas Lease No.
7. Lease Name or Unit Agreement Name West Knowles
8. Well No. 11
9. Pool name or Wildcat Ship Shawa
10. Elevation (Show whether DF, RKB, RT, GR, etc.)

SUNDRY NOTICES AND REPORTS ON WELLS
(DO NOT USE THIS FORM FOR PROPOSALS TO DRILL OR TO DEEPEN OR PLUG BACK TO A
DIFFERENT RESERVOIR. USE "APPLICATION FOR PERMIT"
(FORM C-101) FOR SUCH PROPOSALS.)

1. Type of Well: OIL WELL <input checked="" type="checkbox"/> GAS WELL <input type="checkbox"/> OTHER
2. Name of Operator Conoco Inc.
3. Address of Operator P.O. Box 460 - Hobbs, NM 88240
4. Well Location Unit Letter P : 1660 Feet From The South Line and 330 Feet From The East Line Section 34 Township 16S Range 37E NMPM Lea County

11. Check Appropriate Box to Indicate Nature of Notice, Report, or Other Data	
NOTICE OF INTENTION TO:	SUBSEQUENT REPORT OF:
PERFORM REMEDIAL WORK <input type="checkbox"/>	REMEDIAL WORK <input type="checkbox"/>
TEMPORARILY ABANDON <input type="checkbox"/>	ALTERING CASING <input type="checkbox"/>
PULL OR ALTER CASING <input type="checkbox"/>	COMMENCE DRILLING OPNS. <input type="checkbox"/>
OTHER: <input type="checkbox"/>	PLUG AND ABANDONMENT <input type="checkbox"/>
	CASING TEST AND CEMENT JOB <input type="checkbox"/>
	OTHER: Test additional pay <input checked="" type="checkbox"/>

12. Describe Proposed or Completed Operations (Clearly state all pertinent details, and give pertinent dates, including estimated date of starting any proposed work) SEE RULE 1103.

3/26/90 MURK. NUBDP. PUGH w/prod. equip. Perf. w/2 JSPF @ 11,442'-11,456', 11,424'-11,436'; 11,404'-11,412' & w/4 JSPF @ 11,375'-11,395'; 11,292'-11,300'. Total 182 holes. Run prod. equipment. Return to production.

I hereby certify that the information above is true and complete to the best of my knowledge and belief.	
SIGNATURE H.A. Ingram	TITLE Conservation Coordinator DATE 4/3/90
TYPE OR PRINT NAME H.A. Ingram	TELEPHONE NO. 397-5800
(This space for State Use)	
APPROVED BY Jerry Sexton	TITLE DISTRICT 1 SUPERVISOR DATE APR 11 1990
CONDITIONS OF APPROVAL, IF ANY:	

(3) OED

Submit 5 Copies
Appropriate District Office
DISTRICT I
P.O. Box 1980, Hobbs, NM 88240

DISTRICT II
P.O. Drawer DD, Artesia, NM 88210

DISTRICT III
1000 Rio Brazos Rd., Aztec, NM 87410

State of New Mexico
Energy, Minerals and Natural Resources Department

OIL CONSERVATION DIVISION

P.O. Box 2088
Santa Fe, New Mexico 87504-2088

Form C-104
Revised 1-1-89
See Instructions
at Bottom of Page

RECEIVED

90 JAN 22 AM 10 33

REQUEST FOR ALLOWABLE AND AUTHORIZATION
TO TRANSPORT OIL AND NATURAL GAS

Operator Conoco Inc.	Well API No. 30-025-30668
Address P. O. Box 460, Hobbs, New Mexico 88240	
Reason(s) for Filing (Check proper box). New Well <input type="checkbox"/> Change in Transporter of: Recompletion <input type="checkbox"/> Oil <input type="checkbox"/> Dry Gas <input type="checkbox"/> To show date gas connected. Change in Operator <input type="checkbox"/> Casinghead Gas <input type="checkbox"/> Condensate <input type="checkbox"/>	
If change of operator give name and address of previous operator	

II. DESCRIPTION OF WELL AND LEASE

Lease Name West Knowles	Well No. 11	Pool Name, Including Formation Undesignated Shipp Strawn	Kind of Lease State, Federal or Fee	Lease No.
Location Unit Letter P : 660 Feet From The S Line and 330 Feet From The E Line Section 34 Township 16S Range 37E, NMPM, Lea County				

III. DESIGNATION OF TRANSPORTER OF OIL AND NATURAL GAS

Name of Authorized Transporter of Oil Koch Oil Company	<input checked="" type="checkbox"/> or Condensate <input type="checkbox"/>	Address (Give address to which approved copy of this form is to be sent) P. O. Box 1558, Breckenridge, Texas 76024				
Name of Authorized Transporter of Casinghead Gas Phillips 66 Natural Gas Company	<input checked="" type="checkbox"/> or Dry Gas <input type="checkbox"/>	Address (Give address to which approved copy of this form is to be sent) 311 Phillips Bldg., Odessa, Texas 79760				
If well produces oil or liquids, give location of tanks.	Unit P	Sec. 34	Twp. 16S	Rge. 37E	Is gas actually connected? Yes	When? 1-16-90

If this production is commingled with that from any other lease or pool, give commingling order number:

IV. COMPLETION DATA

Designate Type of Completion - (X)	Oil Well	Gas Well	New Well	Workover	Deepen	Plug Back	Same Res'v	Diff Res'v
Date Spudded	Date Compl. Ready to Prod.		Total Depth		P.B.T.D.			
Elevations (DF, RKB, RT, GR, etc.)	Name of Producing Formation		Top Oil/Gas Pay		Tubing Depth			
Perforations					Depth Casing Shoe			
TUBING, CASING AND CEMENTING RECORD								
HOLE SIZE	CASING & TUBING SIZE		DEPTH SET		SACKS CEMENT			

V. TEST DATA AND REQUEST FOR ALLOWABLE

OIL WELL (Test must be after recovery of total volume of load oil and must be equal to or exceed top allowable for this depth or be for full 24 hours.)

Date First New Oil Run To Tank	Date of Test	Producing Method (Flow, pump, gas lift, etc.)	
Length of Test	Tubing Pressure	Casing Pressure	Choke Size
Actual Prod. During Test	Oil - Bbls.	Water - Bbls.	Gas- MCF

GAS WELL

Actual Prod. Test - MCF/D	Length of Test	Bbls. Condensate/MMCF	Gravity of Condensate
Testing Method (pilot, back pr.)	Tubing Pressure (Shut-in)	Casing Pressure (Shut-in)	Choke Size

VI. OPERATOR CERTIFICATE OF COMPLIANCE

I hereby certify that the rules and regulations of the Oil Conservation Division have been complied with and that the information given above is true and complete to the best of my knowledge and belief.

Signature
W. W. Baker, Administrative Supervisor
Printed Name
1-16-90 (505) 397-5800
Date Telephone No.

OIL CONSERVATION DIVISION

JAN 18 1990

Date Approved

By

Title DISTRICT 1 SUPERVISOR

INSTRUCTIONS: This form is to be filed in compliance with Rule 1104

- 1) Request for allowable for newly drilled or deepened well must be accompanied by tabulation of deviation tests taken in accordance with Rule 111.
- 2) All sections of this form must be filled out for allowable on new and recompleted wells.
- 3) Fill out only Sections I, II, III, and VI for changes of operator, well name or number, transporter, or other such changes.
- 4) Separate Form C-104 must be filed for each pool in multiply completed wells.

Submit 5 Copies
Appropriate District Office
DISTRICT I
P.O. Box 1980, Hobbs, NM 88240

DISTRICT II
P.O. Drawer DD, Artesia, NM 88210

DISTRICT III
1000 Rio Brazos Rd., Aztec, NM 87410

State of New Mexico
Energy, Minerals and Natural Resources Department

OIL CONSERVATION DIVISION

P.O. Box 2088
Santa Fe, New Mexico 87504-2088

RECEIVED

Form C-104
Revised 1-1-89
See Instructions
at Bottom of Page

REQUEST FOR ALLOWABLE AND AUTHORIZATION
TO TRANSPORT OIL AND NATURAL GAS

Operator Conoco Inc.	Well API No. 30-025-30668
Address P. O. Box 460, Hobbs, New Mexico 88240	
Reason(s) for Filing (Check proper box) New Well <input checked="" type="checkbox"/> Change in Transporter of: Recompletion <input type="checkbox"/> Oil <input type="checkbox"/> Dry Gas <input type="checkbox"/> Change in Operator <input type="checkbox"/> Casinghead Gas <input type="checkbox"/> Condensate <input type="checkbox"/>	

If change of operator give name
and address of previous operator

THIS WELL HAS BEEN PLACED IN THE POOL
DESIGNATED BELOW. IF YOU DO NOT CONCUR
NOTIFY THIS OFFICE.

II. DESCRIPTION OF WELL AND LEASE

Lease Name West Knowles	Well No. 11	Pool Name, Including Formation Undesignated Shipp Strawn	Kind of Lease State, Federal or Fee	Lease No.
Location Unit Letter P : 660 Feet From The S Line and 330 Feet From The E Line Section 34 Township 16S Range 37E, NMPM, Lea County				

III. DESIGNATION OF TRANSPORTER OF OIL AND NATURAL GAS

Name of Authorized Transporter of Oil <input checked="" type="checkbox"/> or Condensate <input type="checkbox"/> Koch Oil Company	Address (Give address to which approved copy of this form is to be sent) P. O. Box 1558, Breckenridge, Texas 76024					
Name of Authorized Transporter of Casinghead Gas <input checked="" type="checkbox"/> or Dry Gas <input type="checkbox"/> Phillips 66 Natural Gas Company	Address (Give address to which approved copy of this form is to be sent) 311 Phillips Bldg., Odessa, Texas 79760					
If well produces oil or liquids, give location of tanks.	Unit P	Sec. 34	Twp. 16S	Rge. 37E	Is gas actually connected? No	When ?

If this production is commingled with that from any other lease or pool, give commingling order number:

IV. COMPLETION DATA

Designate Type of Completion - (X)	Oil Well X	Gas Well	New Well X	Workover	Deepen	Plug Back	Same Res'v	Diff Res'v
Date Spudded 10-16-89	Date Compl. Ready to Prod. 1-1-90	Total Depth 11,704'	P.B.T.D. 11,656'					
Elevations (DF, RKB, RT, GR, etc.) 3765' Gr.	Name of Producing Formation Strawn	Top Oil/Gas Pay 11,322'	Tubing Depth 11,248'					
Perforations 11,322' - 11,369'			Depth Casing Shoe 11,701'					
TUBING, CASING AND CEMENTING RECORD								
HOLE SIZE	CASING & TUBING SIZE	DEPTH SET	SACKS CEMENT					
17-1/2"	13-3/8"	500'	525 Sx.					
11"	8-5/8"	4735'	1550 Sx.					
7-7/8"	5-1/2"	11701'	2311 Sx.					
	2-7/8"	11,248'						

V. TEST DATA AND REQUEST FOR ALLOWABLE

OIL WELL (Test must be after recovery of total volume of load oil and must be equal to or exceed top allowable for this depth or be for full 24 hours.)

Date First New Oil Run To Tank 12-16-89	Date of Test 12-17-89	Producing Method (Flow, pump, gas lift, etc.) Flowing	
Length of Test 24	Tubing Pressure 155 psi	Casing Pressure 0	Choke Size 24/64"
Actual Prod. During Test 301	Oil - Bbls. 301	Water - Bbls. 0	Gas - MCF 597

GAS WELL

Actual Prod. Test - MCF/D	Length of Test	Bbls. Condensate/MMCF	Gravity of Condensate
Testing Method (pilot, back pr.)	Tubing Pressure (Shut-in)	Casing Pressure (Shut-in)	Choke Size

VI. OPERATOR CERTIFICATE OF COMPLIANCE

I hereby certify that the rules and regulations of the Oil Conservation
Division have been complied with and that the information given above
is true and complete to the best of my knowledge and belief.

Signature
W. W. Baker, Administrative Supervisor
Printed Name
1-8-90 (505) 397-5800
Date Telephone No.

OIL CONSERVATION DIVISION

Date Approved JAN 09 1990

By [Signature]
Geologist

Title

INSTRUCTIONS: This form is to be filed in compliance with Rule 1104

- 1) Request for allowable for newly drilled or deepened well must be accompanied by tabulation of deviation tests taken in accordance with Rule 111.
- 2) All sections of this form must be filled out for allowable on new and recompleted wells.
- 3) Fill out only Sections I, II, III, and VI for changes of operator, well name or number, transporter, or other such changes.
- 4) Separate Form C-104 must be filed for each pool in multiply completed wells.

CONOCO INC.

P. O. Box 460
Hobbs, New Mexico

New Mexico Oil Conservation Division
P. O. Box 1980
Hobbs, New Mexico 88240

Gentlemen:

In compliance with New Mexico Oil Conservation Division Rule III, we are submitting below a list of deviation surveys taken on Conoco Inc.'s West Knowles No. 11, located Unit P Section 34, Township 16S, Range 37E, Lea County, New Mexico.

DEPTH	DEGREE	DEPTH	DEGREE	DEPTH	DEGREE
<u>260'</u>	<u>3/4</u>	<u>7656'</u>	<u>2</u>	<u>10242'</u>	<u>2-3/4</u>
<u>500'</u>	<u>1</u>	<u>8092'</u>	<u>1-3/4</u>	<u>10363'</u>	<u>2-3/4</u>
<u>991'</u>	<u>1/2</u>	<u>8349'</u>	<u>1-3/4</u>	<u>10440'</u>	<u>3</u>
<u>1490'</u>	<u>1/2</u>	<u>8595'</u>	<u>1-1/2</u>	<u>10548'</u>	<u>2-1/2</u>
<u>1988'</u>	<u>1/4</u>	<u>8726'</u>	<u>1/4</u>	<u>10663'</u>	<u>2-1/2</u>
<u>2126'</u>	<u>1/2</u>	<u>8757'</u>	<u>1/4</u>	<u>10810'</u>	<u>2-1/2</u>
<u>2625'</u>	<u>3/4</u>	<u>8819'</u>	<u>1/4</u>	<u>10977'</u>	<u>3-1/2</u>
<u>3148'</u>	<u>2</u>	<u>8879'</u>	<u>1/2</u>	<u>11062'</u>	<u>2-1/4</u>
<u>3307'</u>	<u>2</u>	<u>8972'</u>	<u>3/4</u>	<u>11123'</u>	<u>3</u>
<u>3430'</u>	<u>1-1/4</u>	<u>9020'</u>	<u>1-3/4</u>	<u>11246'</u>	<u>1-1/2</u>
<u>3687'</u>	<u>3/4</u>	<u>9112'</u>	<u>2</u>	<u>11656'</u>	<u>1</u>
<u>3937'</u>	<u>1/2</u>	<u>9194'</u>	<u>3.4</u>		
<u>4379'</u>	<u>3/4</u>	<u>9317'</u>	<u>4.1</u>		
<u>4755'</u>	<u>1</u>	<u>9438'</u>	<u>3.9</u>		
<u>5246'</u>	<u>1/2</u>	<u>9515'</u>	<u>3-3/4</u>		
<u>5562'</u>	<u>3/4</u>	<u>9608'</u>	<u>3-1/4</u>		
<u>5966'</u>	<u>3/4</u>	<u>9731'</u>	<u>3-1/4</u>		
<u>6466'</u>	<u>3/4</u>	<u>9780'</u>	<u>2-3/4</u>		
<u>6965'</u>	<u>3/4</u>	<u>9903'</u>	<u>2-3/4</u>		
<u>7124'</u>	<u>1-1/2</u>	<u>10010'</u>	<u>3</u>		
<u>7278'</u>	<u>1</u>	<u>10118'</u>	<u>2-3/4</u>		

Yours very truly,

Cecil O. Hubbard

Subscribed and sworn to before me, a Notary Public, in and for Lea County, New Mexico, this 8th day of January, 1990.

9-12-91
My Commission Expires

Rosa E. Jones
Notary Public

Submit 3 Copies
to Appropriate
District Office

State of New Mexico
Energy, Minerals and Natural Resources Department

Form C-103
Revised 1-1-89

DISTRICT I
P.O. Box 1980, Hobbs, NM 88240

DISTRICT II
P.O. Drawer DD, Artesia, NM 88210

DISTRICT III
1000 Rio Brazos Rd., Aztec, NM 87410

WILDLIFE CONSERVATION DIVISION

RECEIVED P.O. Box 2088

Santa Fe, New Mexico 87504-2088

'90 JAN 12 AM 9 22

WELL API NO. 30-025-30668
5. Indicate Type of Lease STATE <input type="checkbox"/> FEE <input checked="" type="checkbox"/>
6. State Oil & Gas Lease No.

SUNDRY NOTICES AND REPORTS ON WELLS
(DO NOT USE THIS FORM FOR PROPOSALS TO DRILL OR TO DEEPEN OR PLUG BACK TO A
DIFFERENT RESERVOIR. USE "APPLICATION FOR PERMIT"
(FORM C-101) FOR SUCH PROPOSALS.)

7. Lease Name or Unit Agreement Name

West Knowles

8. Well No. *#11*

9. Pool name or Wildcat

Und. Shipp Strawn

1. Type of Well:

OIL
WELL ☒

GAS
WELL ☐

OTHER

2. Name of Operator

Conoco Inc.

3. Address of Operator

P.O. Box 460

4. Well Location

Unit Letter *P* : *660* Feet From The *South* Line and *330* Feet From The *East* Line

Section *34* Township *16S* Range *37E* NMPM *Lee* County

10. Elevation (Show whether DF, RKB, RT, GR, etc.)

3765' B.L.

11. Check Appropriate Box to Indicate Nature of Notice, Report, or Other Data

NOTICE OF INTENTION TO:

SUBSEQUENT REPORT OF:

PERFORM REMEDIAL WORK ☐

PLUG AND ABANDON ☐

REMEDIAL WORK ☐

ALTERING CASING ☐

TEMPORARILY ABANDON ☐

CHANGE PLANS ☐

COMMENCE DRILLING OPNS. ☐

PLUG AND ABANDONMENT ☐

PULL OR ALTER CASING ☐

CASING TEST AND CEMENT JOB ☐

OTHER: ☐

OTHER: *Set intermediate casing* ☒

12. Describe Proposed or Completed Operations (Clearly state all pertinent details, and give pertinent dates, including estimated date of starting any proposed work) SEE RULE 1103.

*10-24-89 Run 116 jts. 8 5/8" 32# csg. to a depth of 4735'.
Cement w/1550 SKS. Class 'C' Lite, circulated 125 SKS.*

I hereby certify that the information above is true and complete to the best of my knowledge and belief.

SIGNATURE

W. W. Baker

TITLE

Administrative Supervisor DATE *1-3-90*

TYPE OR PRINT NAME

W. W. Baker

TELEPHONE NO. *397-5800*

(This space for State Use)

APPROVED BY

Paul J. Hays

TITLE

Geologist

DATE

JAN 09 1990

CONDITIONS OF APPROVAL, IF ANY:

DISTRICT I
P.O. Box 1980, Hobbs, NM 88240

DISTRICT II
P.O. Drawer DD, Artesia, NM 88210

DISTRICT III
1000 Rio Brazos Rd., Aztec, NM 87410

OIL CONSERVATION DIVISION

RECEIVED Box 2088

Santa Fe, New Mexico 87504-2088

'90 JAN 12 AM 9 22

WELL API NO. 30-025-30668
5. Indicate Type of Lease STATE <input type="checkbox"/> FEE <input checked="" type="checkbox"/>
6. State Oil & Gas Lease No.
7. Lease Name or Unit Agreement Name West Knowles
8. Well No. #11
9. Pool name or Wildcat Und. Ship Strawn
10. Elevation (Show whether DF, RKB, RT, GR, etc.) 3765' G.L.

SUNDRY NOTICES AND REPORTS ON WELLS
(DO NOT USE THIS FORM FOR PROPOSALS TO DRILL OR TO DEEPEN OR PLUG BACK TO A
DIFFERENT RESERVOIR. USE "APPLICATION FOR PERMIT"
(FORM C-101) FOR SUCH PROPOSALS.)

1. Type of Well: OIL WELL <input checked="" type="checkbox"/> GAS WELL <input type="checkbox"/> OTHER <input type="checkbox"/>	2. Name of Operator Conoco Inc.
3. Address of Operator P.O. Box 460	4. Well Location Unit Letter P : 660 Feet From The South Line and 330 Feet From The East Line Section 34 Township 16S Range 37E NMPM Sea County
10. Elevation (Show whether DF, RKB, RT, GR, etc.) 3765' G.L.	

11. Check Appropriate Box to Indicate Nature of Notice, Report, or Other Data	
NOTICE OF INTENTION TO:	SUBSEQUENT REPORT OF:
PERFORM REMEDIAL WORK <input type="checkbox"/>	REMEDIAL WORK <input type="checkbox"/>
TEMPORARILY ABANDON <input type="checkbox"/>	ALTERING CASING <input type="checkbox"/>
PULL OR ALTER CASING <input type="checkbox"/>	COMMENCE DRILLING OPNS. <input type="checkbox"/>
OTHER: <input type="checkbox"/>	PLUG AND ABANDONMENT <input type="checkbox"/>
	CASING TEST AND CEMENT JOB <input type="checkbox"/>
	OTHER: Set production casing <input checked="" type="checkbox"/>

12. Describe Proposed or Completed Operations (Clearly state all pertinent details, and give pertinent dates, including estimated date of starting any proposed work) SEE RULE 1103.

11-26-89 Run 5-1/2" 17# N-80/K-55/N-80 casing (270 ft.)
N-80: 0'-2212'
K-55: 2212'-9723'
N-80: 9723'-11,701'
Cementing
1st stage (tower) - 824 s/s Class "H"
2nd stage lead - 992 s/s. Class "H" Lite
Tail - 495 s/s. Class H Circulated 93 s/s.

I hereby certify that the information above is true and complete to the best of my knowledge and belief.

SIGNATURE W.W. Baker TITLE Administrative Sup'r. DATE 1/4/90

TYPE OR PRINT NAME W.W. Baker TELEPHONE NO. 397-5800

(This space for State Use)

APPROVED BY [Signature] TITLE Geologist DATE JAN 09 1990

CONDITIONS OF APPROVAL, IF ANY:

DISTRICT I
P.O. Box 1980, Hobbs, NM 88240

DISTRICT II
P.O. Drawer DD, Artesia, NM 88210

DISTRICT III
1000 Rio Brazos Rd., Aztec, NM 87410

OIL CONSERVATION DIVISION
RECEIVED

OIL CONSERVATION DIVISION

P.O. Box 2088

Santa Fe, New Mexico 87504-2088

90 JAN 12 AM 9 22

WELL API NO.

30-025-30668

5. Indicate Type of Lease

STATE ☐

FEE ☒

6. State Oil & Gas Lease No.

SUNDRY NOTICES AND REPORTS ON WELLS
(DO NOT USE THIS FORM FOR PROPOSALS TO DRILL OR TO DEEPEN OR PLUG BACK TO A
DIFFERENT RESERVOIR. USE "APPLICATION FOR PERMIT"
(FORM C-101) FOR SUCH PROPOSALS.)

1. Type of Well:

OIL
WELL ☒

GAS
WELL ☐

OTHER

2. Name of Operator

Conoco Inc.

3. Address of Operator

P.O. Box 460

4. Well Location

Unit Letter P : 660 Feet From The South Line and 330 Feet From The East Line

Section

34

Township

16S

Range

37E

NMPM

County

Lea

10. Elevation (Show whether DF, RKB, RT, GR, etc.)

3765' G.L.

11. Check Appropriate Box to Indicate Nature of Notice, Report, or Other Data

NOTICE OF INTENTION TO:

SUBSEQUENT REPORT OF:

PERFORM REMEDIAL WORK ☐

PLUG AND ABANDON ☐

REMEDIAL WORK ☐

ALTERING CASING ☐

TEMPORARILY ABANDON ☐

CHANGE PLANS ☐

COMMENCE DRILLING OPNS. ☐

PLUG AND ABANDONMENT ☐

PULL OR ALTER CASING ☐

CASING TEST AND CEMENT JOB ☐

OTHER: ☐

OTHER: Set Surface Casing ☒

12. Describe Proposed or Completed Operations (Clearly state all pertinent details, and give pertinent dates, including estimated date of starting any proposed work) SEE RULE 1103.

Spud well @ 10:30 a.m. 10-16-89. G1H w/13 fts. 13 3/8", 48",
H-40 csg. Cement w/525 SXS w/125 SXS returns.
Surface csg. Set @ 500'.

I hereby certify that the information above is true and complete to the best of my knowledge and belief.

SIGNATURE

W.W. Baker

TITLE

Administrative Sup'r.

DATE

1-3-90

TYPE OR PRINT NAME

W. W. Baker

TELEPHONE NO.

397-5800

(This space for State Use)

APPROVED BY

Paul J. Murphy

TITLE

Geologist

DATE

JAN 09 1990

CONDITIONS OF APPROVAL, IF ANY:

Submit 5 Copies
Appropriate District Office
DISTRICT I
P.O. Box 1980, Hobbs, NM 88240

DISTRICT II
P.O. Drawer DD, Artesia, NM 88210

DISTRICT III
1000 Rio Brazos Rd., Aztec, NM 87410

State of New Mexico
Energy, Minerals and Natural Resources Department

OIL CONSERVATION DIVISION
P.O. Box 2088
Santa Fe, New Mexico 87504-2088

Form C-104
Revised 1-1-89
See Instructions
at Bottom of Page

OIL CONSERVATION DIVISION
RECEIVED

DEC 22 AM 9 31

REQUEST FOR ALLOWABLE AND AUTHORIZATION
TO TRANSPORT OIL AND NATURAL GAS

Operator <u>Conoco Inc.</u>		Well API No. <u>30-025-30668</u>
Address <u>PO Box 460, Hobbs, NM 88240</u>		
Reason(s) for Filing (Check proper box) <input type="checkbox"/> Other (Please explain)		
New Well <input checked="" type="checkbox"/>	Change in Transporter of: Oil <input type="checkbox"/> Dry Gas <input type="checkbox"/> Casinghead Gas <input type="checkbox"/> Condensate <input type="checkbox"/>	We respectfully request a testing allowable of 5400 BO for the month of December, 1989.
Recompletion <input type="checkbox"/>		
Change in Operator <input type="checkbox"/>		
If change of operator give name and address of previous operator _____		

II. DESCRIPTION OF WELL AND LEASE

Lease Name <u>West Knowles</u>	Well No. <u>11</u>	Pool Name, Including Formation <u>Uncl. Shipp Strawn</u>	Kind of Lease State, Federal or Fee	Lease No.
Location Unit Letter <u>P</u> : <u>660</u> Feet From The <u>South</u> Line and <u>330</u> Feet From The <u>East</u> Line Section <u>34</u> Township <u>16S</u> Range <u>37E</u> , NMPM, Lea County				

III. DESIGNATION OF TRANSPORTER OF OIL AND NATURAL GAS

Name of Authorized Transporter of Oil <input checked="" type="checkbox"/> or Condensate <input type="checkbox"/> <u>Koch Oil Company</u>	Address (Give address to which approved copy of this form is to be sent) <u>PO Box 1558, Breckenridge, TX 76024</u>	
Name of Authorized Transporter of Casinghead Gas <input type="checkbox"/> or Dry Gas <input type="checkbox"/>	Address (Give address to which approved copy of this form is to be sent)	
If well produces oil or liquids, give location of tanks.	Unit <u>P</u>	Sec. <u>34</u>
	Twsp. <u>16S</u>	Rge. <u>37E</u>
	Is gas actually connected? <u>No</u>	
	When ?	

If this production is commingled with that from any other lease or pool, give commingling order number: _____

IV. COMPLETION DATA

Designate Type of Completion - (X)	Oil Well	Gas Well	New Well	Workover	Deepen	Plug Back	Same Res'v	Diff Res'v
Date Spudded	Date Compl. Ready to Prod.		Total Depth		P.B.T.D.			
Elevations (DF, RKB, RT, GR, etc.)	Name of Producing Formation		Top Oil/Gas Pay		Tubing Depth			
Perforations					Depth Casing Shoe			
TUBING, CASING AND CEMENTING RECORD								
HOLE SIZE	CASING & TUBING SIZE		DEPTH SET		SACKS CEMENT			

V. TEST DATA AND REQUEST FOR ALLOWABLE

OIL WELL (Test must be after recovery of total volume of load oil and must be equal to or exceed top allowable for this depth or be for full 24 hours.)

Date First New Oil Run To Tank	Date of Test	Producing Method (Flow, pump, gas lift, etc.)	
Length of Test	Tubing Pressure	Casing Pressure	Choke Size
Actual Prod. During Test	Oil - Bbls.	Water - Bbls.	Gas- MCF

GAS WELL

Actual Prod. Test - MCF/D	Length of Test	Bbls. Condensate/MMCF	Gravity of Condensate
Testing Method (pilot, back pr.)	Tubing Pressure (Shut-in)	Casing Pressure (Shut-in)	Choke Size

VI. OPERATOR CERTIFICATE OF COMPLIANCE

I hereby certify that the rules and regulations of the Oil Conservation Division have been complied with and that the information given above is true and complete to the best of my knowledge and belief.

W. W. Baker
Signature
W. W. Baker, Administrative Supervisor
Printed Name
12/18/89 (505) 397-5800
Date Telephone No.

OIL CONSERVATION DIVISION

Date Approved DEC 19 1989

By Paul E. Kunk
Geologist
Title _____

INSTRUCTIONS: This form is to be filed in compliance with Rule 1104

- 1) Request for allowable for newly drilled or deepened well must be accompanied by tabulation of deviation tests taken in accordance with Rule 111.
- 2) All sections of this form must be filled out for allowable on new and recompleted wells.
- 3) Fill out only Sections I, II, III, and VI for changes of operator, well name or number, transporter, or other such changes.
- 4) Separate Form C-104 must be filed for each pool in multiply completed wells.

Submit to Appropriate
District Office
State Lease - 6 copies
Fee Lease - 5 copies

State of New Mexico
Energy, Minerals and Natural Resources Department

Form C-101
Revised 1-1-89

OIL CONSERVATION DIVISION

DISTRICT I
P.O. Box 1980, Hobbs, NM 88240

DISTRICT II
P.O. Drawer DD, Artesia, NM 88210

DISTRICT III
1000 Rio Brazos Rd., Aztec, NM 87410

P.O. Box 2088
Santa Fe, New Mexico 87504-2088

API NO. (assigned by OCD on New Wells)
30-025-30668
5. Indicate Type of Lease
STATE <input type="checkbox"/> FEE <input checked="" type="checkbox"/>
6. State Oil & Gas Lease No.

APPLICATION FOR PERMIT TO DRILL, DEEPEN, OR PLUG BACK					
1a. Type of Work:				7. Lease Name or Unit Agreement Name	
DRILL <input checked="" type="checkbox"/> RE-ENTER <input type="checkbox"/> DEEPEN <input type="checkbox"/> PLUG BACK <input type="checkbox"/>				West Knowles	
b. Type of Well:				8. Well No.	
OIL WELL <input checked="" type="checkbox"/> GAS WELL <input type="checkbox"/> OTHER <input type="checkbox"/> SINGLE ZONE <input checked="" type="checkbox"/> MULTIPLE ZONE <input type="checkbox"/>				#11	
2. Name of Operator				9. Pool name or Wildcat	
Conoco Inc.				Und, Shipp Strawn	
3. Address of Operator					
P.O. Box 460 - Hobbs, NM 88240					
4. Well Location					
Unit Letter P : 660 Feet From The South Line and 330 Feet From The East Line					
Section 34 Township 16S Range 37E NMPM Lea County					
10. Proposed Depth				11. Formation	
11,700'				Strawn	
12. Rotary or C.T.				Rotary	
13. Elevations (Show whether DF, RT, GR, etc.)		14. Kind & Status Plug. Bond		15. Drilling Contractor	
3765' GL		blanket		not available	
16. Approx. Date Work will start		10/23/89			
17. PROPOSED CASING AND CEMENT PROGRAM					
SIZE OF HOLE	SIZE OF CASING	WEIGHT PER FOOT	SETTING DEPTH	SACKS OF CEMENT	EST. TOP
17-1/2"	13-3/8"	48#	500'	330 sx	Toc-surface
11"	8-5/8"	32#	4750'	832 sx	Toc-surface
7-7/8"	5-1/2"	17#	11,700'	1st - 620 sx	Toc- 8500'
				2nd - 1045 sx	Toc- surface

It is proposed to drill a straight hole to a TD of 11,700' and complete as a single Strawn completion. See attachments for a location plat and BOP specs.

Approval for unorthodox location was received on Division Order R-8992.

RECEIVED

SEP 15 1989

OIL CONSERVATION DIV.

IN ABOVE SPACE DESCRIBE PROPOSED PROGRAM: IF PROPOSAL IS TO DEEPEN OR PLUG BACK, GIVE DATA ON PRESENT PRODUCTIVE ZONE AND PROPOSED NEW PRODUCTIVE ZONE. GIVE BLOWOUT PREVENTER PROGRAM, IF ANY.

I hereby certify that the information above is true and complete to the best of my knowledge and belief.

SIGNATURE W W Baker W.W. Baker TITLE Administrative Supervisor DATE September 7, 1989

TYPE OR PRINT NAME

TELEPHONE NO.

(This space for State Use)

APPROVED BY

TITLE

DATE

DISTRICT 1 SUPERVISOR

SEP 11 1989

CONDITIONS OF APPROVAL, IF ANY:

Permit Expires 5 Months From Approval
Date Unless Drilling Underway.

Submit to Appropriate
District Office
State Lease - 4 copies
Fee Lease - 3 copies

State of New Mexico
Energy, Minerals and Natural Resources Department

Form C-102
Revised 1-1-89

OIL CONSERVATION DIVISION

P.O. Box 2088
Santa Fe, New Mexico 87504-2088

DISTRICT I

P.O. Box 1980, Hobbs, NM 88240

DISTRICT II

P.O. Drawer DD, Artesia, NM 88210

DISTRICT III

1000 Rio Brazos Rd., Aztec, NM 87410

WELL LOCATION AND ACREAGE DEDICATION PLAT

All Distances must be from the outer boundaries of the section

Operator Conoco, Inc.			Lease West Knowles		Well No. 11
Unit Letter P	Section 34	Township 16 South	Range 37 East	County Lea	
Actual Footage Location of Well: 660 feet from the South line and 330 feet from the East line					
Ground level Elev. 3765.5	Producing Formation Strawn		Pool Shipp Strawn		Dedicated Acreage: 80 Acres

1. Outline the acreage dedicated to the subject well by colored pencil or hatchure marks on the plat below.
2. If more than one lease is dedicated to the well, outline each and identify the ownership thereof (both as to working interest and royalty).
3. If more than one lease of different ownership is dedicated to the well, have the interest of all owners been consolidated by communitization, unitization, force-pooling, etc.?
☐ Yes ☐ No If answer is "yes" type of consolidation _____
If answer is "no" list the owners and tract descriptions which have actually been consolidated. (Use reverse side of this form if necessary).
No allowable will be assigned to the well until all interests have been consolidated (by communitization, unitization, forced-pooling, or otherwise) or until a non-standard unit, eliminating such interest, has been approved by the Division.

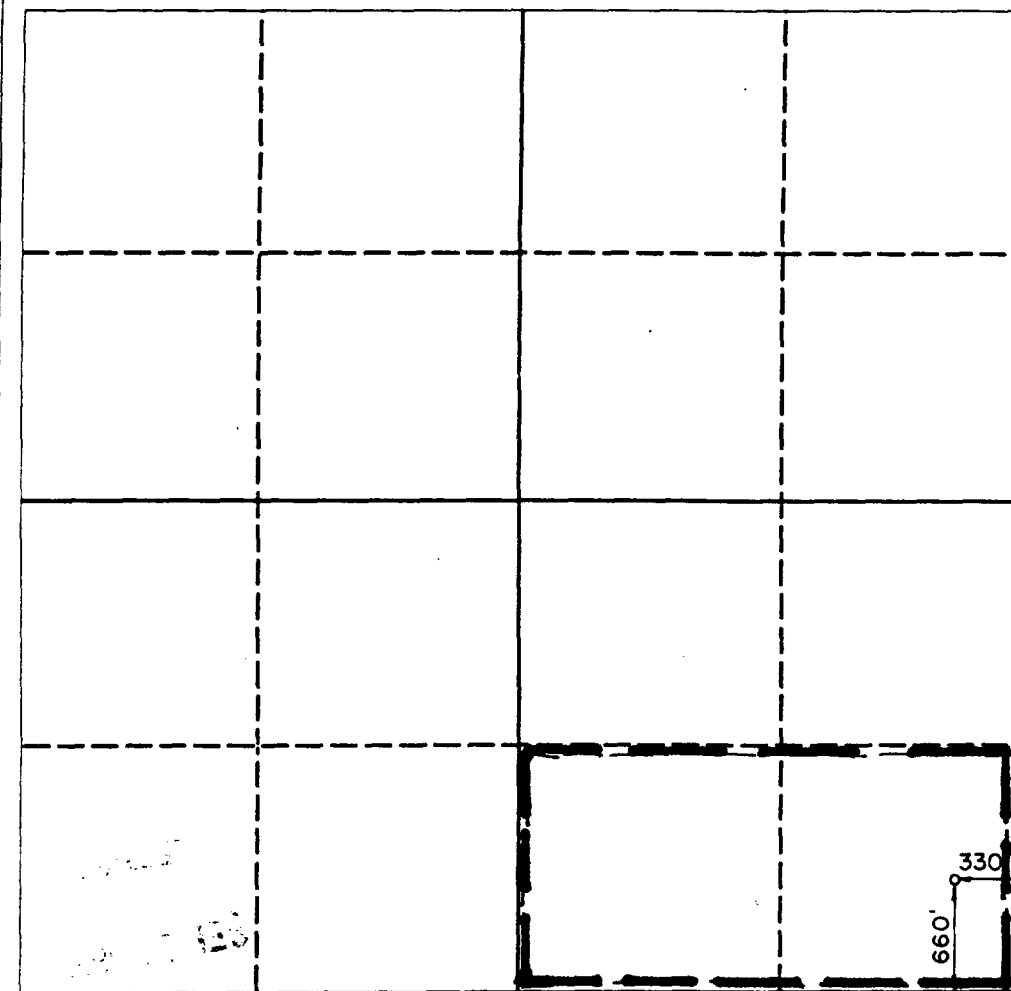

OPERATOR CERTIFICATION

I hereby certify that the information contained herein is true and complete to the best of my knowledge and belief.

Signature
W. W. Baker
Printed Name
W. W. Baker
Position
Administrative Sup'r.
Company
Conoco Inc.
Date
Sept. 7, 1989

SURVEYOR CERTIFICATION

I hereby certify that the well location shown on this plat was plotted from field notes of actual surveys made by me or under my supervision, and that the same is true and correct to the best of my knowledge and belief.

Date Surveyed
June 22, 1989
Signature & Seal of
Professional Surveyor

REGISTERED PROFESSIONAL LAND SURVEYOR
NEW MEXICO
JOHN W. WEST
Certificate No. 676
RONALD J. EIDSON 3239

CONOCO INC.

Blow-out Preventer Specifications

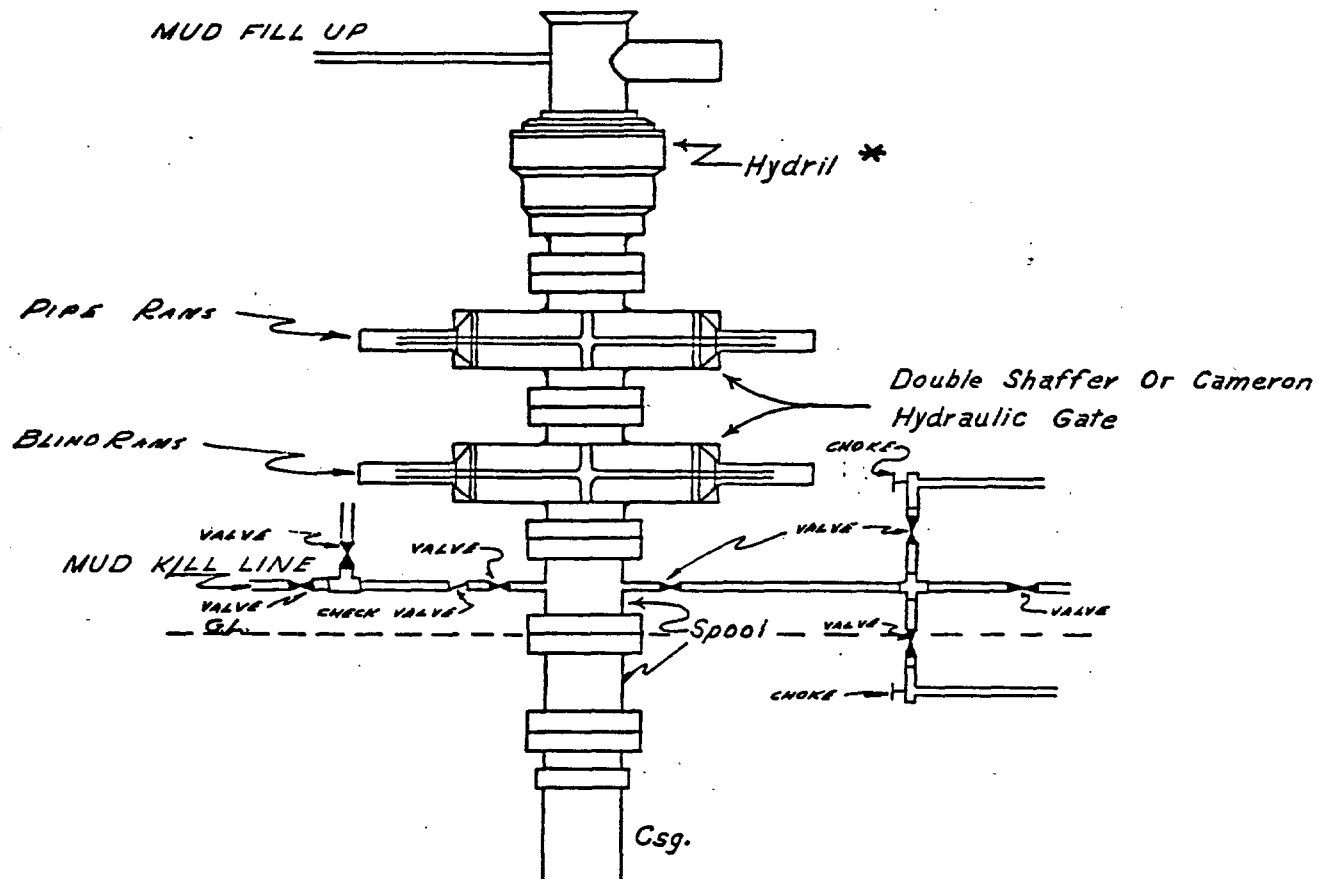

NOTE:

Manual and Hydraulic controls with closing unit no less than 75' from well head.
Remote controls on rig floor.

*

DUE TO SUBSTRUCTURE CLEARANCE, HYDRIL
MAY OR MAY NOT BE USED.

Submit 5 Copies
Appropriate District Office
DISTRICT I
P.O. Box 1980, Hobbs, NM 88240

DISTRICT II
P.O. Drawer DD, Artesia, NM 88210

DISTRICT III
1000 Rio Brazos Rd., Aztec, NM 87410

State of New Mexico
Energy, Minerals and Natural Resources Department

OIL CONSERVATION DIVISION

P.O. Box 2088
Santa Fe, New Mexico 87504-2088

RECEIVED

Form C-104
Revised 1-1-89
See Instructions
at Bottom of Page

REQUEST FOR ALLOWABLE AND AUTHORIZATION
TO TRANSPORT OIL AND NATURAL GAS

Operator Santa Fe Exploration Company	Well API No. 30-025-30668
Address P. O. Box 1136, Roswell, NM 88202-1136	
Reason(s) for Filing (Check proper box) New Well <input type="checkbox"/> Change in Transporter of: Recompletion <input type="checkbox"/> Oil <input type="checkbox"/> Dry Gas <input type="checkbox"/> Change in Operator <input checked="" type="checkbox"/> Casinghead Gas <input type="checkbox"/> Condensate <input type="checkbox"/> Other (Please explain) <input type="checkbox"/>	
If change of operator give name and address of previous operator Conoco Inc.	

II. DESCRIPTION OF WELL AND LEASE

Lease Name West Knowles	Well No. 11	Pool Name, including Formation Shipp Strawn	Kind of Lease State, Federal or Fee	Lease No.
Location Unit Letter <u>P</u> : <u>660</u> Feet From The <u>south</u> Line and <u>330</u> Feet From The <u>East</u> Line Section <u>34</u> Township <u>16S</u> Range <u>37E</u> , <u>NMPM</u> Lea County				

III. DESIGNATION OF TRANSPORTER OF OIL AND NATURAL GAS

Name of Authorized Transporter of Oil Koch Oil Company	<input checked="" type="checkbox"/> or Condensate <input type="checkbox"/>	Address (Give address to which approved copy of this form is to be sent) P. O. Box 2239, Wichita, Kansas 67201				
Name of Authorized Transporter of Casinghead Gas Phillips Petroleum	<input checked="" type="checkbox"/> or Dry Gas <input type="checkbox"/>	Address (Give address to which approved copy of this form is to be sent) P. O. Box 5400, Bartlesville, OK 74005				
If well produces oil or liquids, give location of tanks.	Unit P	Sec. 34	Twp. 16S	Rge. 37E	Is gas actually connected? Yes	When? Unknown

If this production is commingled with that from any other lease or pool, give commingling order number:

IV. COMPLETION DATA

Designate Type of Completion - (X)	Oil Well	Gas Well	New Well	Workover	Deepen	Plug Back	Same Res'v	Diff Res'v
Date Spudded	Date Compl. Ready to Prod.		Total Depth			P.B.T.D.		
Elevations (DF, RKB, RT, GR, etc.)	Name of Producing Formation		Top Oil/Gas Pay			Tubing Depth		
Perforations						Depth Casing Shoe		
TUBING, CASING AND CEMENTING RECORD								
HOLE SIZE		CASING & TUBING SIZE		DEPTH SET		SACKS CEMENT		

V. TEST DATA AND REQUEST FOR ALLOWABLE

OIL WELL (Test must be after recovery of total volume of load oil and must be equal to or exceed top allowable for this depth or be for full 24 hours.)

Date First New Oil Run To Tank	Date of Test	Producing Method (Flow, pump, gas lift, etc.)	
Length of Test	Tubing Pressure	Casing Pressure	Choke Size
Actual Prod. During Test	Oil - Bbls.	Water - Bbls.	Gas - MCF

GAS WELL

Actual Prod. Test - MCF/D	Length of Test	Bbls. Condensate/MMCF	Gravity of Condensate
Testing Method (pilot, back pr.)	Tubing Pressure (Shut-in)	Casing Pressure (Shut-in)	Choke Size

VI. OPERATOR CERTIFICATE OF COMPLIANCE

I hereby certify that the rules and regulations of the Oil Conservation Division have been complied with and that the information given above is true and complete to the best of my knowledge and belief.

Signature Janet A. Royal Production Analyst
Printed Name Janet A. Royal Title (505) 623-2733
Date January 8, 1992 Telephone No.

OIL CONSERVATION DIVISION

Date Approved JAN 13 '92

By Paul Kautz
Geologist

Title

INSTRUCTIONS: This form is to be filed in compliance with Rule 1104

- 1) Request for allowable for newly drilled or deepened well must be accompanied by tabulation of deviation tests taken in accordance with Rule 111.
- 2) All sections of this form must be filled out for allowable on new and recompleted wells.
- 3) Fill out only Sections I, II, III, and VI for changes of operator, well name or number, transporter, or other such changes.
- 4) Separate Form C-104 must be filed for each pool in multiply completed wells.

WRS COMPLETION REPORTCOMPLETIONS SEC 34 TWP 16S RGE 37E
PI# 30-T-0012 02/15/90 30-025-30668-0000 PAGE 1NMEX LEA * 660FSL 330FEL SEC SE SE
STATE COUNTY FOOTAGE SPOTCONOCO INC D DO
OPERATOR WELL CLASS INIT FIN11 WEST KNOWLES
WELL NO. LEASE NAME3780KB 3765GR SHIPP
OPER ELEV FIELD POOL AREA
API 30-025-30668-0000LEASE NO PERMIT OR WELL I.D. NO
10/16/1989 12/17/1989 ROTARY VERT OILSPUD DATE COMP. DATE TYPE TOOL HOLE TYPE STATUS
11700 STRAWN WILLBROS DRLG 6 RIG SUB 14PROJ. DEPTH PROJ. FORM CONTRACTOR
DTD 11704 PB 11656 FM/TD STRAWN

DRILLERS T.D. LOG T.D. PLUG BACK TD OLD T.D. FORM T.D.

LOCATION DESCRIPTION

7 MI SE LOVINGTON, NM

CASING/LINER DATACSG 13 3/8 @ 500 W/ 525 SACKS
CSG 8 5/8 @ 4735 W/ 1550 SACKS
CSG 5 1/2 @ 11701 W/ 2311 SACKS**TUBING DATA**

TBG 2 7/8 AT 11248

INITIAL POTENTIALIPF 301BOPD 597 MCFD 24/64CK 24HRS
STRAWN PERF 11322-11369
GOR, GTY-NO DETAIL
FTP-NO DETAILS
FCP-NO DETAILS**PRODUCTION TEST DATA**PTP 110BOPD 196 MCFD 123BW 24HRS
STRAWN PERF 11322-11369
TREATMENT-NO DETAILS

CONTINUED IC# 300257023789

Copyrighted 1990
Reproduction
Prohibited**Petroleum Information**PI-WRS-GE
Form No. 18**BB** a company of
The Dun & Bradstreet Corporation

COMPLETIONS SEC 34 TWP 16S RGE 37E
PI# 30-T-0012 02/15/90 30-025-30668-0000 PAGE 2

CONOCO INC
11

WEST KNOWLES

D DO

DRILLING PROGRESS DETAILS

CONOCO INC
BOX 460
HOBBS, NM 88240
505-393-4141
09/11 LOC/1989/
10/17 DRLG 500
10/27 DRLG 4653
11/02 DRLG 7822
11/07 DRLG 8701
11/14 DRLG 9483
11/17 DRLG 10670
11/28 11704 TD, RDRT
12/07 11704 TD, WOCT
01/26 11704 TD, PB 11656, WOPT
02/13 DEVIATION SURVEYS @ 260 (3/4 DEG), 500 (1 DEG),
991 (1/2 DEG), 1490 (1/2 DEG), 1988 (1/4 DEG),
2126 (1/2 DEG), 2625 (3/4 DEG), 3148 (2 DEG),
3307 (2 DEG), 3430 (1 1/4 DEG), 3687 (3/4 DEG),
3937 (1/2 DEG), 4379 (3/4 DEG), 4755 (1 DEG),
5246 (1/2 DEG), 5562 (3/4 DEG), 5966 (3/4 DEG),
6466 (3/4 DEG), 6965 (3/4 DEG), 7124 (1 1/2
DEG), 7278 (1 DEG), 7656 (2 DEG), 8092 (1 3/4
DEG), 8349 (1 3/4 DEG), 8595 (1 1/2 DEG), 8726
(1/4 DEG), 8757 (1/4 DEG), 8819 (1/4 DEG), 8879
(1/2 DEG), 8972 (3/4 DEG), 9020 (1 3/4 DEG),
9112 (2 DEG), 9194 (3.4 DEG), 9317 (4.1 DEG),
9438 (3.9 DEG), 9515 (3 3/4 DEG), 9608 (3 1/4
DEG), 9731 (3 1/4 DEG), 9780 (2 3/4 DEG), 9903
(2 3/4 DEG), 10010 (3 DEG), 10118 (2 3/4 DEG),
10242 (2 3/4 DEG), 10363 (2 3/4 DEG), 10440 (3
DEG), 10548 (2 1/2 DEG), 10663 (2 1/2 DEG),
10810 (2 1/2 DEG), 10977 (3 1/2 DEG), 11062 (2
1/4 DEG), 11123 (3 DEG), 11246 (1 1/2 DEG),
11656 (1 DEG)
TD REACHED 11/26/89 RIG REL 11/28/89
02/13 11704 TD, PB 11656
COMP 12/17/89, IPF 301 BO, 597 MCFGPD,
24/64 CHK, GOR (NR), GTY
(NR), FTP (NR), FCP (NR)
PROD ZONE - STRAWN 11322-11369
NO CORES OR DSTS RPTD