

DATE 1/22/02	SUSPENSE 2/11/02	ENGINEER MS	LOGGED IN KN	TYPE NSL	APP NO 202435463
-----------------	---------------------	----------------	-----------------	-------------	---------------------

ABOVE THIS LINE FOR DIVISION USE ONLY

NEW MEXICO OIL CONSERVATION DIVISION
 - Engineering Bureau -
 1220 South St. Francis Drive, Santa Fe, NM 87505



ADMINISTRATIVE APPLICATION CHECKLIST

THIS CHECKLIST IS MANDATORY FOR ALL ADMINISTRATIVE APPLICATIONS FOR EXCEPTIONS TO DIVISION RULES AND REGULATIONS WHICH REQUIRE PROCESSING AT THE DIVISION LEVEL IN SANTA FE

Application Acronyms:

[NSL-Non-Standard Location] [NSP-Non-Standard Proration Unit] [SD-Simultaneous Dedication]
[DHC-Downhole Commingling] [CTB-Lease Commingling] [PLC-Pool/Lease Commingling]
[PC-Pool Commingling] [OLS - Off-Lease Storage] [OLM-Off-Lease Measurement]
[WFX-Waterflood Expansion] [PMX-Pressure Maintenance Expansion]
[SWD-Salt Water Disposal] [IPI-Injection Pressure Increase]
[EOR-Qualified Enhanced Oil Recovery Certification] [PPR-Positive Production Response]

[1] **TYPE OF APPLICATION - Check Those Which Apply for [A]**

[A] Location - Spacing Unit - Simultaneous Dedication
☒ NSL ☐ NSP ☐ SD

Check One Only for [B] or [C]

[B] Commingling - Storage - Measurement
☐ DHC ☐ CTB ☐ PLC ☐ PC ☐ OLS ☐ OLM

[C] Injection - Disposal - Pressure Increase - Enhanced Oil Recovery
☐ WFX ☐ PMX ☐ SWD ☐ IPI ☐ EOR ☐ PPR

[D] Other: Specify _____

[2] **NOTIFICATION REQUIRED TO: - Check Those Which Apply, or Does Not Apply**

- [A] ☐ Working, Royalty or Overriding Royalty Interest Owners
- [B] ☒ Offset Operators, Leaseholders or Surface Owner
- [C] ☐ Application is One Which Requires Published Legal Notice
- [D] ☐ Notification and/or Concurrent Approval by BLM or SLO
U.S. Bureau of Land Management - Commissioner of Public Lands, State Land Office
- [E] ☐ For all of the above, Proof of Notification or Publication is Attached, and/or,
- [F] ☐ Waivers are Attached

[3] **SUBMIT ACCURATE AND COMPLETE INFORMATION REQUIRED TO PROCESS THE TYPE OF APPLICATION INDICATED ABOVE.**

[4] **CERTIFICATION:** I hereby certify that the information submitted with this application for administrative approval is **accurate** and **complete** to the best of my knowledge. I also understand that **no action** will be taken on this application until the required information and notifications are submitted to the Division.

Note: Statement must be completed by an individual with managerial and/or supervisory capacity.

CLIFTON R. MAY
 Print or Type Name

Clifton R. May
 Signature

REGULATORY AGENT
 Title

1/18/02
 Date

landdept@ypc.com
 e-mail Address

MARTIN YATES, III
1912 - 1985
FRANK W. YATES
1936 - 1986

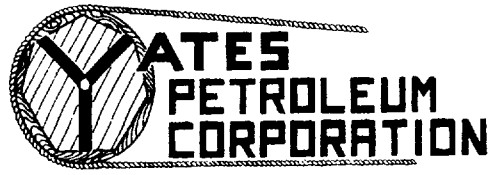

105 SOUTH FOURTH STREET
ARTESIA, NEW MEXICO 88210-2118
TELEPHONE (505) 748-1471

S. P. YATES
CHAIRMAN OF THE BOARD
JOHN A. YATES
PRESIDENT
PEYTON YATES
EXECUTIVE VICE PRESIDENT
RANDY G. PATTERSON
SECRETARY
DENNIS G. KINSEY
TREASURER

January 18, 2002

Mr. Michael Stogner, Chief Hearing Officer
New Mexico Oil Conservation Division
1220 South St. Francis Drive
Santa Fe, NM 87505

RE: Application for Unorthodox Location
Buried Canyon "AZN" State #1, Re-entry
2093' FSL and 2128' FEL
Section 19-T5S-R26E
Chaves County, New Mexico
Lease #VA-2482

RECEIVED
JAN 22 2002
NEW MEXICO
OIL CONSERVATION DIVISION

Dear Mr. Stogner:

Yates Petroleum Corporation respectfully requests administrative approval for the unorthodox gas well location captioned above. The affected pools are the Wildcat Mississippian at 5700' +/-, Wildcat Penn at 5272' +/-, and the Wildcat Wolfcamp at 4660' +/- . All three pools call for 320 acre spacing. Yates will designate the south half of Section 19-T5S-R26E as the dedicated acreage for each pool.

Yates Petroleum Corporation is the leaseholder of Lease #VA-2482 which this well is located on. Yates are also the leaseholder of Lease #VA-2473 that is being encroached on to the North. Therefore, Yates requests administrative approval at your earliest convenience.

Re-entering this well bore would be in the best interest of conservation and also more economical than drilling a new well. Enclosed, please find a copy of the lease plat, C-101, and C-102s for the Wildcat Mississippian, Wildcat Penn, and Wildcat Wolfcamp.

Should you need anything further, please contact me at the above address or by phone at (505) 748-4347.

Sincerely

YATES PETROLEUM CORPORATION

Clifton R. May

Clifton R. May
Regulatory Agent

CRM/rca

Enclosure(s)

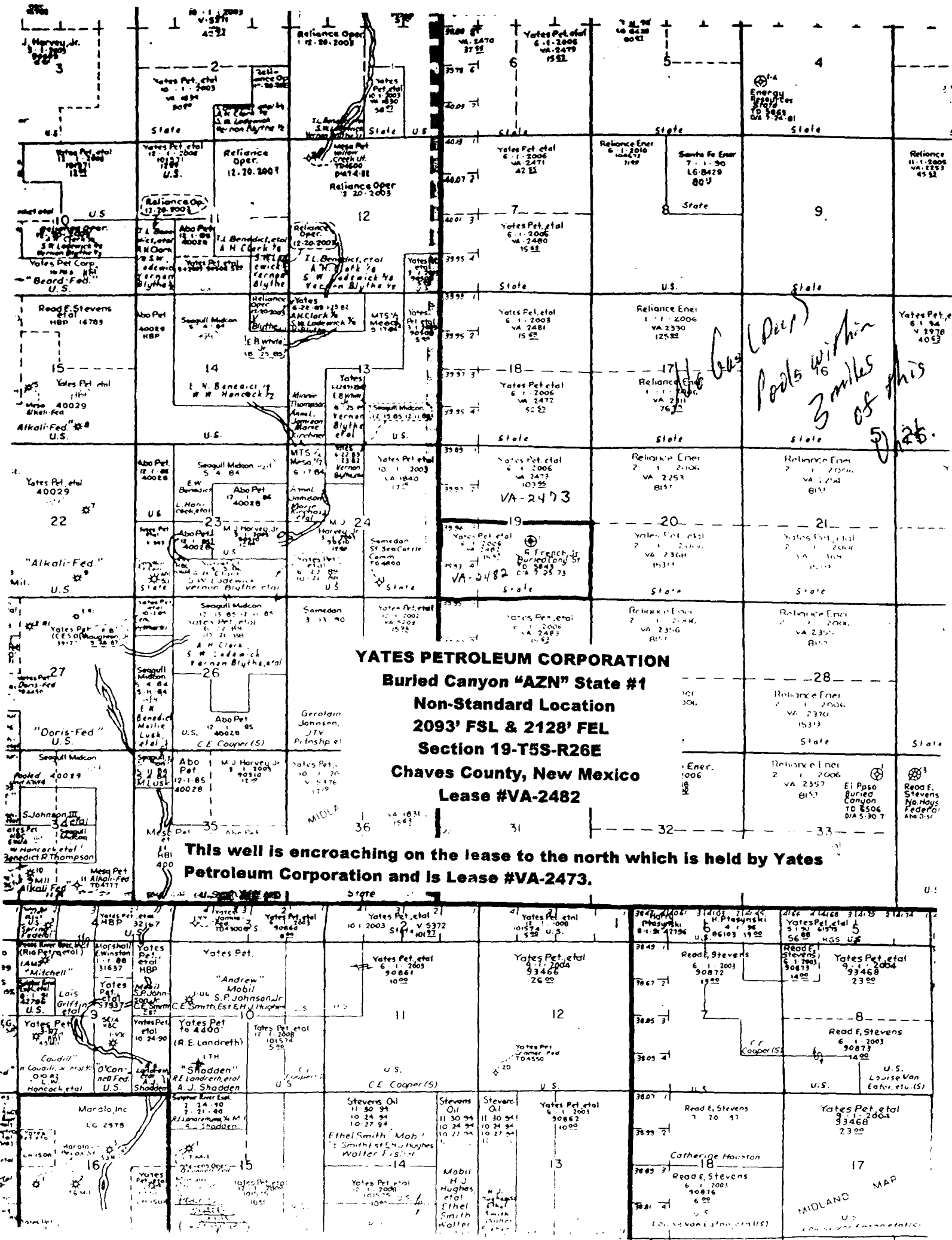

DISTRICT I
1625 N. French Dr., Hobbs, NM 88240

State of New Mexico
Energy, Minerals and Natural Resources Department

Form C-101
Revised March 17, 1999
Instructions on back
Submit to appropriate District Office
State Lease - 6 Copies
Fee Lease - 5 Copies

DISTRICT II
811 South First, Artesia, NM 88210

OIL CONSERVATION DIVISION

DISTRICT III
1000 Rio Brazos Rd., Aztec, NM 87410

PO BOX 2088
Santa Fe, NM 87504-2088

DISTRICT IV
2040 South Pacheco, Santa Fe, NM 87501

☐ AMENDED REPORT

APPLICATION FOR PERMIT TO DRILL, RE-ENTER, DEEPEN, PLUGBACK, OR ADD A ZONE

¹ Operator Name and Address Yates Petroleum Corporation 105 South Fourth Street Artesia, New Mexico 88210		² OGRID Number 025575
		³ API Number 30 30-005-60266
⁴ Property Code	⁵ Property Name Buried Canyon "AZN" State	⁶ Well No. 1

⁷ Surface Location

UL or lot no.	Section	Township	Range	Lot Idn	Feet from the	North/South Line	Feet from the	East/West Line	County
J	19	5S	26E		2093	South	2128	East	Chaves

⁸ Proposed Bottom Hole Location If Different From Surface

UL or lot no.	Section	Township	Range	Lot Idn	Feet from the	North/South Line	Feet from the	East/West Line	County
⁹ Proposed Pool 1 Wildcat Mississippi					¹⁰ Proposed Pool 2				

¹¹ Work Type Code E	¹² Well Type Code G	¹³ Cable/Rotary R	¹⁴ Lease Type Code S	¹⁵ Ground Level Elevation 3758'
¹⁶ Multiple No	¹⁷ Proposed Depth 5914'	¹⁸ Formation Mississippian	¹⁹ Contractor Not Determined	²⁰ Spud Date ASAP

²¹ Proposed Casing and Cement Program

Hole Size	Casing Size	Casing weight/feet	Setting Depth	Sacks of Cement	Estimated TOC
20"	13 3/8	48#	40'-in place	2 yds redi-mix	Circulate
12 1/4"	8 5/8"	32#	1203'-in place	540 sx	Circulate
7 7/8"	5 1/2"	15.5#	5914'	500 sx	TOC-3000'

²² Describe the proposed program. If this application is to DEEPEN or PLUG BACK give the data on the present productive zone and proposed new productive zone. Describe the blowout prevention program, if any. Use additional sheets if necessary.

See Attached Sheets for additional information. An application for an administrative approval of a non-standard location is being applied for.

²³ I hereby certify that the information given above is true and complete to the best of my knowledge and belief. Signature: <i>Clifton R. May</i>		OIL CONSERVATION DIVISION	
Printed name: Clifton R. May		Approved by:	
Title: Regulatory Agent		Title:	
Date: 01/18/02		Approval Date:	Expiration Date:
Phone: (505) 748-1471		Conditions of Approval Attached <input type="checkbox"/>	

YATES PETROLEUM CORPORATION

Buried Canyon "AZN" State #1 Re-entry

2093' FSL & 2128' FEL

Section 19-T5S-R26E

Chaves County, New Mexico

Lease #VA-2482

Drilling Plans: This well was originally drilled by L. R. French, Jr. as the Buried Canyon State #1. It was plugged and abandoned in July 1973. Yates Petroleum Corporation plans to re-enter this well bore using a pulling unit and a reverse unit to drill out the cement plugs in the 8 5/8" casing and the 7 7/8" open hole to the old total depth of 5914'. A new suite of open hole logs will be ran. After circulating the hole clean a string of 5 1/2" will be ran to the total depth and cemented with enough cement to bring the top of cement to approximately 3,000'. The mud program to be used will be 9.5-9.7 ppg brine water with a 55-70 viscosity. A 3,000# BOPE will be installed on the 8 5/8" casing.

The well will be completed using a pulling unit. The well will be completed and tested in the Mississippian, and/or Penn, and/or the Wolfcamp.

WELLNAME: Red Canyon State 1 (1.R.1.m.d) FIELD: Wildcat
 LOCATION: 2093' 15' 2128' NE 17-55-26E Claves County
 GL: 3,758' ZERO: _____ AGL: _____ KB: 3,769.7'
 SPUD DATE: _____ COMPLETION DATE: _____
 COMMENTS: P&A 7/24/73

CASING PROGRAM	
SIZE/WT/GR/CONN	DEPTH SET
13 3/8" 48.7	40'
8 5/8" 32 H, J-55, STJC	1203'

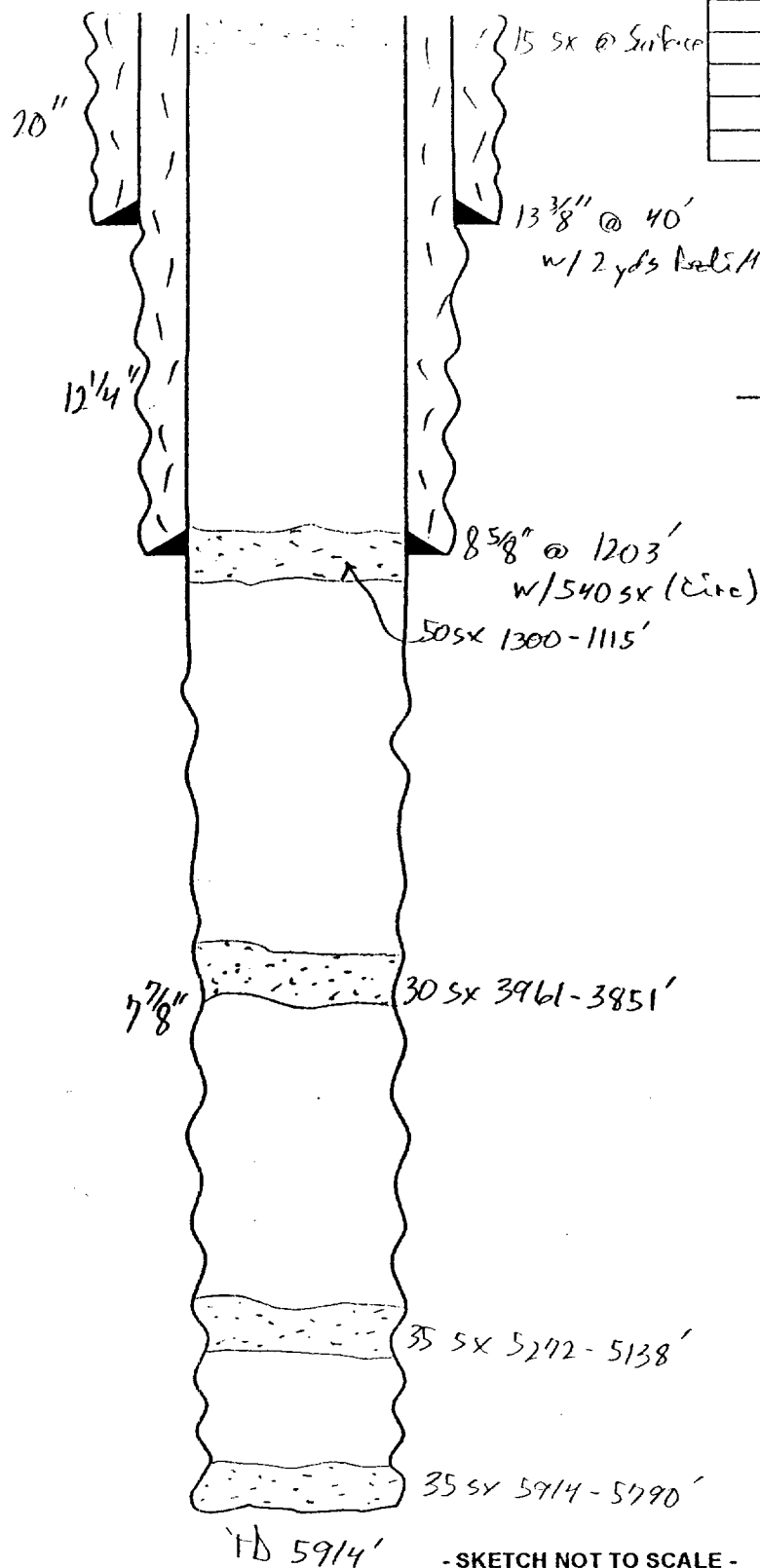

Tops: Yates	80'
7 Rurs	160'
Auren	300'
San Andres	765'
Glaireta	1870'
Tubb	3294'
Albo	3958'
Volfcamp	4660'
Penn	5272'
Hiss	5700'
Montoya	5806'
Granite	5834'

- SKETCH NOT TO SCALE -

DATE: 5-31-01 SD

WELLNAME: Painted Canyon "AZN" 'Late #1 FIELD: Wildcat
 LOCATION: 2093' TSL4 - 2128' FEL 19-55-26E Chaves County
 GL: 3,758' ZERO: _____ AGL: _____ KB: 3,769.7'
 SPUD DATE: _____ COMPLETION DATE: _____
 COMMENTS: POA 7/24/73

CASING PROGRAM	
SIZE/WT/GR/CONN	DEPTH SET
13 3/8" 48#	40'
8 5/8" 32# J-55, ST&C	1203'
5 1/2" 15.50 #/ft J-55, LT&C	5,914'

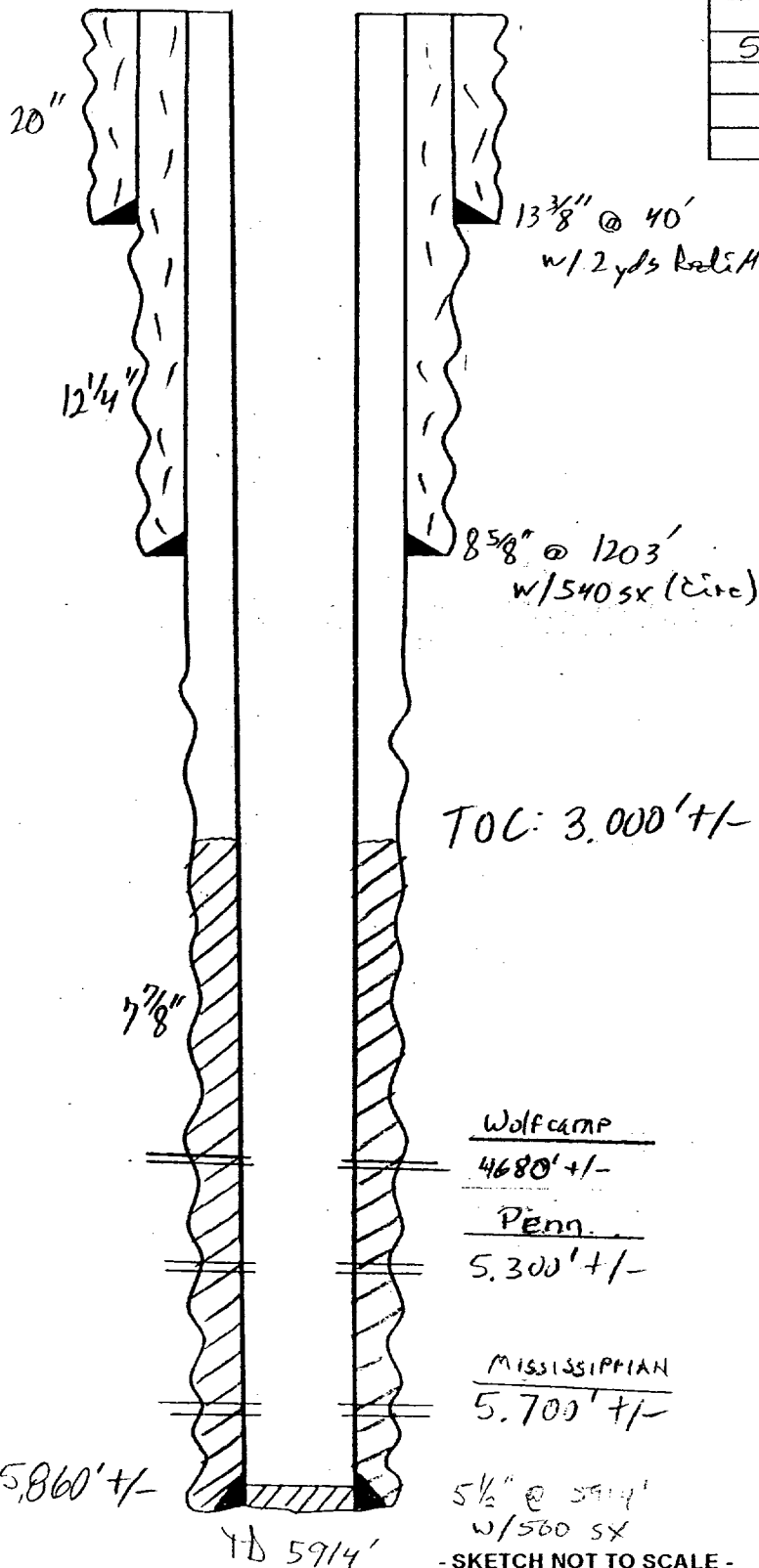

After

Tops: Yates	80'
7Rus	160'
Queen	300'
San Andres	765'
Glaireta	1870'
Tubb	3294'
Abo	3958'
Wolfcamp	4660'
Penn	5292'
Miss	5700'
Montoya	5806'
Granite	5834'

DATE: 5-31-01 SD
6/4/01 JWP

GENERAL SURVEYING COMPANY

NE EXICO OIL CONSERVATION COMMISSION
WELL LOCATION AND ACREAGE DEDICATION PLAT

Form C-102
Supersedes C-128
Effective 1-1-65

All distances must be from the outer boundaries of the Section.

Operator L. R. French, Jr.		Lease Buried Canyon State		Well No. 1
Unit Letter J	Section 19	Township 5 South	Range 26 East	County Chaves
Actual Footage Location of Well:				
2093.0 feet from the south line and		2128.0 feet from the east line		
Ground Level Elev: 3758'	Producing Formation Devonian	Pool Wildcat	Dedicated Acreage: 40 Acres	

1. Outline the acreage dedicated to the subject well by colored pencil or hachure marks on the plat below.
2. If more than one lease is dedicated to the well, outline each and identify the ownership thereof (both as to working interest and royalty).
3. If more than one lease of different ownership is dedicated to the well, have the interests of all owners been consolidated by communitization, unitization, force-pooling, etc?

☐ Yes ☐ No If answer is "yes," type of consolidation Not applicable

If answer is "no," list the owners and tract descriptions which have actually been consolidated. (Use reverse side of this form if necessary.)

No allowable will be assigned to the well until all interests have been consolidated (by communitization, unitization, forced-pooling, or otherwise) or until a non-standard unit, eliminating such interests, has been approved by the Commission.

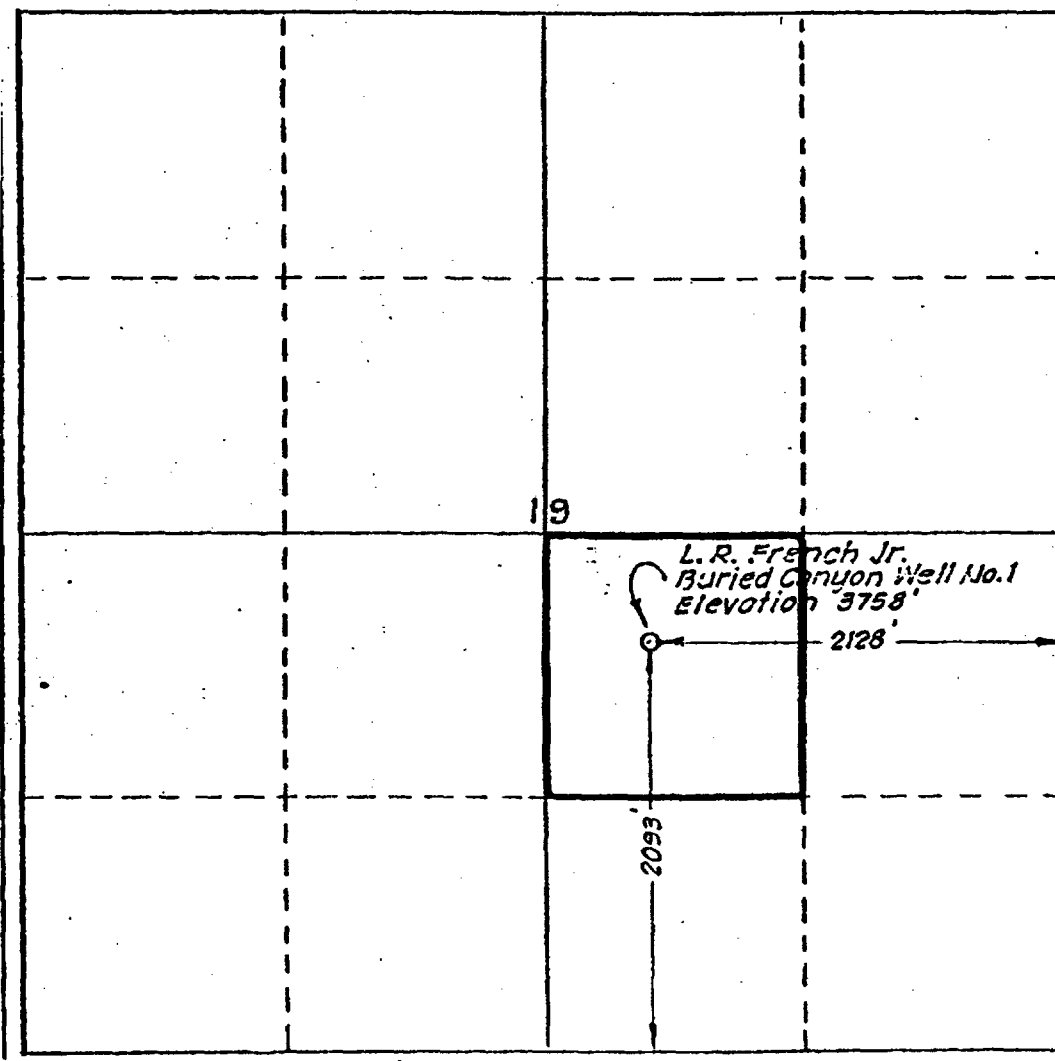

CERTIFICATION

I hereby certify that the information contained herein is true and complete to the best of my knowledge and belief.

David H. Donaldson

Name

David H. Donaldson

Position

Engineer

Company

L. R. FRENCH, JR.

Date

6-6-73

I hereby certify that the well location shown on this plat was plotted from field notes of actual surveys made by me or under my supervision, and that the same is true and correct to the best of my knowledge and belief.

June 4, 1973

Date Surveyed

Registered Professional Engineer and/or Land Surveyor

SW Howell

Certificate No.

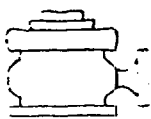

Yates Petroleum Corporation

BOP-3

Typical 3,000 psi Pressure System Schematic Annular with Double Ram Preventer Stack

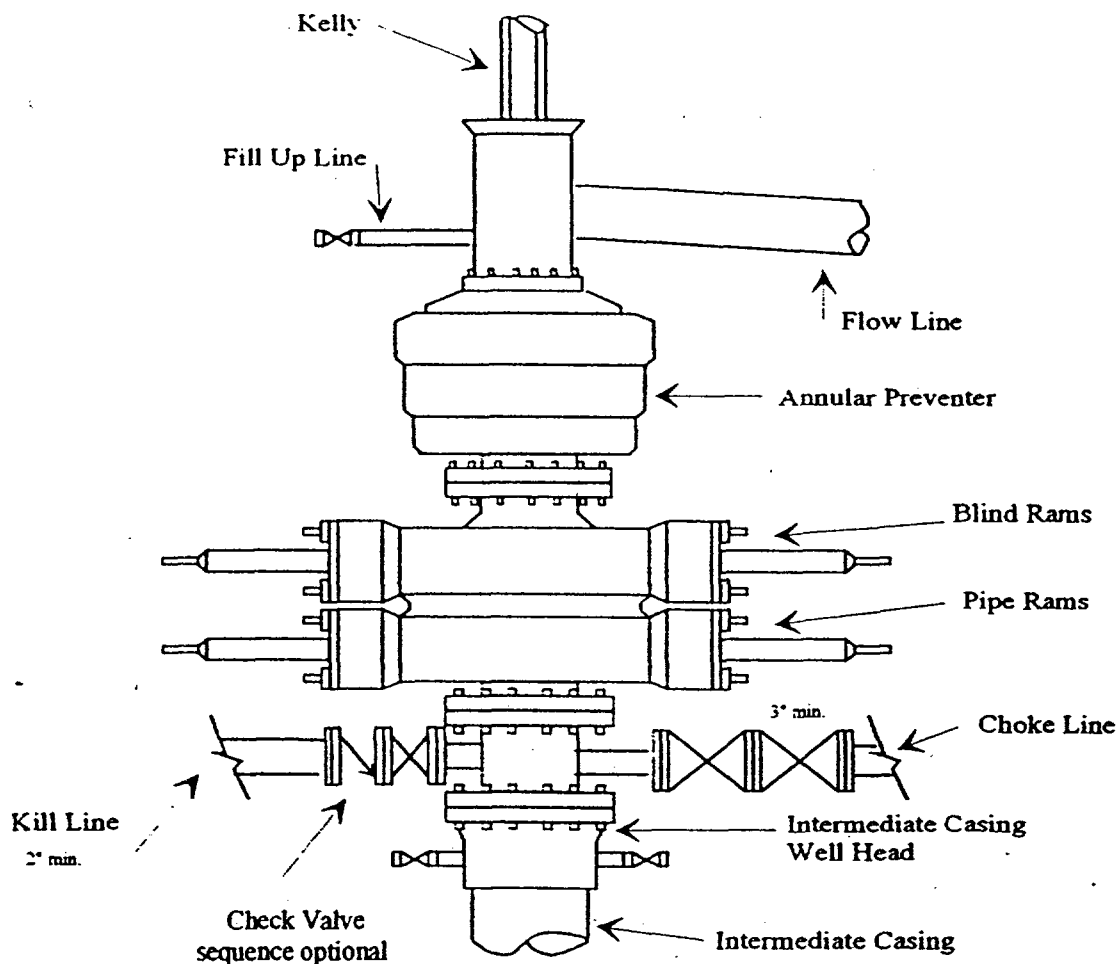

Typical 3,000 psi choke manifold assembly with at least these minimum features

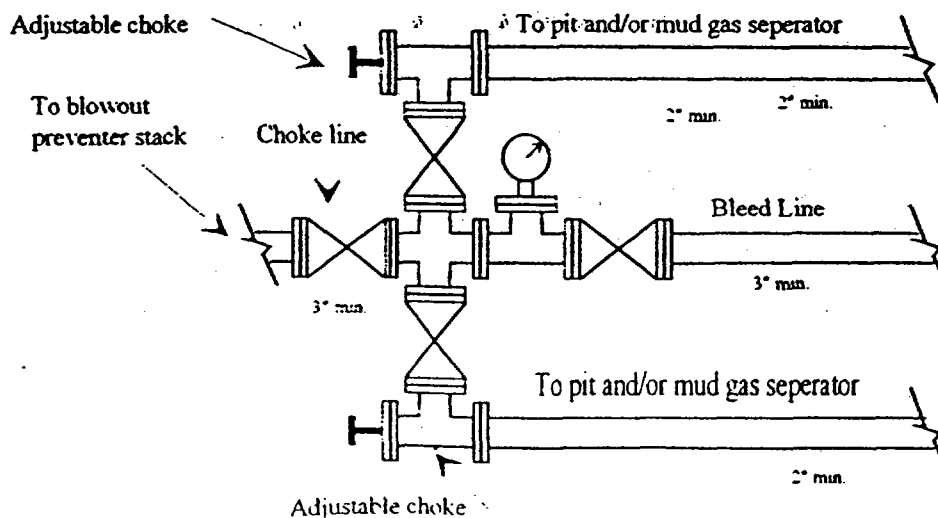

DISTRICT II
611 South First, Artesia, NM 88210

DISTRICT III
1000 Rio Brazos Rd., Aztec, NM 87410

DISTRICT IV
2040 South Pacheco, Santa Fe, NM 87506

OIL CONSERVATION DIVISION

P.O. Box 2088
Santa Fe, New Mexico 87504-2088

☐ AMENDED REPORT

WELL LOCATION AND ACREAGE DEDICATION PLAT

API Number		Pool Code	Pool Name Wildcat Penn
Property Code	Property Name Buried Canyon "AZN" State		Well Number 1
OGWD No. 025575	Operator Name YATES PETROLEUM CORPORATION		Elevation 3758'

Surface Location

UL or lot No.	Section	Township	Range	Lot Idn	Feet from the	North/South line	Feet from the	East/West line	County
J	19	5S	26E		2093	South	2128	East	Chaves

Bottom Hole Location If Different From Surface

UL or Lot No.	Section	Township	Range	Lot Idn	Feet from the	North/South line	Feet from the	East/West line	County
Dedicated Acres 319.88	Joint or Infill	Consolidation Code	Order No.						

**NO ALLOWABLE WILL BE ASSIGNED TO THIS COMPLETION UNTIL ALL INTERESTS HAVE BEEN CONSOLIDATED
OR A NON-STANDARD UNIT HAS BEEN APPROVED BY THE DIVISION**

				<p>OPERATOR CERTIFICATION</p> <p><i>I hereby certify that the information contained herein is true and complete to the best of my knowledge and belief.</i></p> <p style="font-size: 1.2em;"><i>Clifton R. May</i></p> <p><u>Signature</u></p> <p>Clifton R. May</p> <p><u>Printed Name</u></p> <p>Regulatory Agent</p> <p><u>Title</u></p> <p>January 18, 2002</p> <p><u>Date</u></p>
VA-2482				<p>SURVEYOR CERTIFICATION</p> <p><i>I hereby certify that the well location shown on this plat was plotted from field notes of actual surveys made by me or under my supervision, and that the same is true and correct to the best of my belief.</i></p> <p style="text-align: center;">Refer to Original Plat</p> <p><u>Date Surveyed</u></p> <p><u>Signature & Seal of Professional Surveyor</u></p>
				<p>Certificate No. Herschel L. Jones RLS 3640</p> <p style="text-align: right; font-size: 0.8em;">GENERAL SURVEYING COMPANY</p>

DISTRICT II
611 South First, Artesia, NM 88210

DISTRICT III
1000 Rio Brazos Rd., Aztec, NM 87410

DISTRICT IV
2040 South Pacheco, Santa Fe, NM 87506

OIL CONSERVATION DIVISION

P.O. Box 2088
Santa Fe, New Mexico 87504-2088

☐ AMENDED REPORT

WELL LOCATION AND ACREAGE DEDICATION PLAT

API Number		Pool Code	Pool Name Wildcat Wolfcamp	
Property Code	Property Name Buried Canyon "AZN" State			Well Number 1
OCRID No. 025575	Operator Name YATES PETROLEUM CORPORATION			Elevation 3758'



Surface Location

UL or lot No.	Section	Township	Range	Lot Idn	Feet from the	North/South line	Feet from the	East/West line	County
J	19	5S	26E		2093	South	2128	East	Chaves

Bottom Hole Location If Different From Surface

UL or lot No.	Section	Township	Range	Lot Idn	Feet from the	North/South line	Feet from the	East/West line	County
Dedicated Acres 319.88	Joint or Infill	Consolidation Code	Order No.						

**NO ALLOWABLE WILL BE ASSIGNED TO THIS COMPLETION UNTIL ALL INTERESTS HAVE BEEN CONSOLIDATED
OR A NON-STANDARD UNIT HAS BEEN APPROVED BY THE DIVISION**

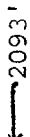
VA-2482			 2128'
		 2093'	

OPERATOR CERTIFICATION

I hereby certify that the information contained herein is true and complete to the best of my knowledge and belief.

Clifton R. May

Signature _____

Clifton R. May

Printed Name _____

Regulatory Agent

Title _____

January 18, 2002

Date _____

SURVEYOR CERTIFICATION

I hereby certify that the well location shown on this plat was plotted from field notes of actual surveys made by me or under my supervision, and that the same is true and correct to the best of my belief.

Refer to Original Plat

Date Surveyed _____

Signature & Seal of Professional Surveyor _____

Certificate No. Herschel L. Jones RLS 3640

GENERAL SURVEYING COMPANY

CMD :
OG5SECT

ONGARD
INQUIRE LAND BY SECTION

01/24/02 15:54:
OGOMES -TP
PAGE NO:

Sec : 19 Twp : 05S Rng : 26E Section Type : NORMAL

1 39.99 CS VA2473 0000 YATES PETROLEUM C 06/01/06	C 40.00 CS VA2473 0000 YATES PETROLEUM C 06/01/06	B 40.00 CS VA2473 0000 YATES PETROLEUM C 06/01/06	A 40.00 CS VA2473 0000 YATES PETROLEUM 06/01/0
2 39.97 CS VA2473 0000 YATES PETROLEUM C 06/01/06	F 40.00 CS VA2473 0000 YATES PETROLEUM C 06/01/06	G 40.00 CS VA2473 0000 YATES PETROLEUM C 06/01/06	H 40.00 CS VA2473 0000 YATES PETROLEUM 06/01/0

PF01 HELP	PF02	PF03 EXIT	PF04 GoTo	PF05	PF06
PF07 BKWD	PF08 FWD	PF09 PRINT	PF10 SDIV	PF11	PF12

CMD :
OG5SECTONGARD
INQUIRE LAND BY SECTION01/24/02 15:54:
OGOMES -TP
PAGE NO:

Sec : 19 Twp : 05S Rng : 26E Section Type : NORMAL

3 39.95 CS VA2482 0000 YATES PETROLEUM C 06/01/06	K 40.00 CS VA2482 0000 YATES PETROLEUM C 06/01/06	J 40.00 CS VA2482 0000 YATES PETROLEUM C 06/01/06	I 40.00 CS VA2482 0000 YATES PETROLEUM 06/01/0
4 39.93 CS VA2482 0000 YATES PETROLEUM C 06/01/06	N 40.00 CS VA2482 0000 YATES PETROLEUM C 06/01/06	O 40.00 CS VA2482 0000 YATES PETROLEUM C 06/01/06	P 40.00 CS VA2482 0000 YATES PETROLEUM 06/01/0

PF01 HELP
PF07 BKWDPF02
PF08 FWDPF03 EXIT
PF09 PRINTPF04 GoTo
PF10 SDIVPF05
PF11PF06
PF12

79.88

8
159.8816
319.88

Petroleum Information
Corporation
GEO-FICHE™

SS-26E-19-10 (NW SE)
NEW MEXICO NM

WELL: BURIED CANYON ST 1
OPER: FRENCH L JR
CNTY: CHAVES

API: 30-005-60266
ISSUE: A12/85
CARD: 1+

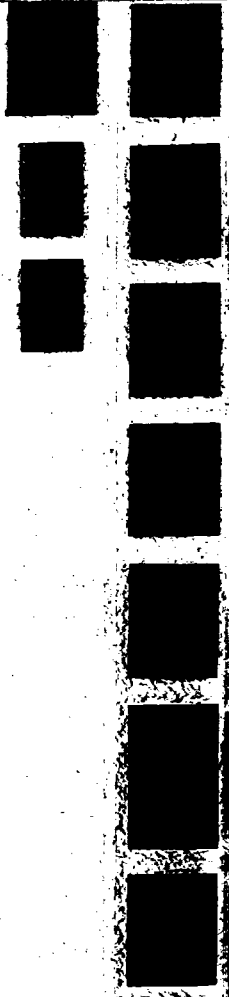

Stogner, Michael

From: Stogner, Michael
Sent: Thursday, January 24, 2002 5:16 PM
To: Clifton R. May (E-mail)
Cc: William F. Carr (E-mail)
Subject: Buried Canyon AZN State No. 1 (API #30-005-60266)

For clarification of your application dated Jan. 18, 2002 for an exception to Division Rule 104.C (2) (a), it was stated that Yates is the **leaseholder** of state Leases No. VA-2482 and VA-2473. Does this mean that Yates owns 100% of the working interest in both leases? If not please identify each interest owner in both leases and show their percentage in each lease.



NEW MEXICO ENERGY, MINERALS and NATURAL RESOURCES DEPARTMENT

GARY E. JOHNSON
Governor
Jennifer A. Salisbury
Cabinet Secretary

February 1, 2002

Lori Wrotenbery
Director
Oil Conservation Division

Yates Petroleum Corporation
105 South Fourth Street
Artesia, New Mexico 88210-2118

Attention: Clifton R. May

Re: Administrative application for an exception to Division Rule 104.C (2) (a) for the recompletion of the plugged and abandoned Buried Canyon State Well No. 1 (API No. 30-005-60266), to be redesignated the Buried Canyon "AZN" State Well No. 1, located 2093 feet from the South line and 2128 feet from the East line (Unit J) of Section 19, Township 5 South, Range 26 East, NMPM, Chaves County, New Mexico.

Dear Mr. May:

This letter acknowledges: (i) my e-mail message to you on Thursday, January 24, 2002 (see copy attached); and (ii) your administrative application dated December 4, 2001 for an unorthodox deep gas well location for the above described well. The Division received this application on January 22, 2002, and assigned it NMOCD application reference No. *pKRV0-202435463*. Please refer to this number in future correspondence with the Division.

Our preliminary review indicates that the information provided in the application is not sufficient to process an administrative order at this time. It appears that your application may be incomplete with respect to notice. It was stated in this application that Yates is the **leaseholder** of state Leases No. VA-2482 and VA-2473. For clarification, does this mean that Yates owns 100% of the working interest in both leases? If not please identify each interest owner in both leases and show their percentage in each lease.

Since the submitted information is insufficient to review, the application was ruled as incomplete on January 24, 2002. Please submit the above stated information by Friday, February 8, 2002.

The Division cannot proceed with your application until the required information is submitted. Upon receipt, the Division will continue to process your application. The additional information can be faxed to (505) 476-3471, or mailed to the Division in Santa Fe. If the necessary information is not submitted, your application will be returned to you.

Should you have any questions concerning this matter, please contact me in Santa Fe at (505) 476-3465 or e-mail me at "mstogner@state.nm.us." Thank you.

Sincerely,

Michael E. Stogner
Chief Hearing Officer/Engineer

cc: New Mexico Oil Conservation Division – Artesia
William F. Carr, Legal Counsel for Yates Petroleum Corporation - Santa Fe

Stogner, Michael

From: Stogner, Michael
Sent: Thursday, January 24, 2002 5:16 PM
To: Clifton R. May (E-mail)
Cc: William F. Carr (E-mail)
Subject: Buried Canyon AZN State No. 1 (API #30-005-60266)

For clarification of your application dated Jan. 18, 2002 for an exception to Division Rule 104.C (2) (a), it was stated that Yates is the **leaseholder** of state Leases No. VA-2482 and VA-2473. Does this mean that Yates owns 100% of the working interest in both leases? If not please identify each interest owner in both leases and show their percentage in each lease.

Stogner, Michael

From: Stogner, Michael
Sent: Monday, February 04, 2002 4:26 PM
To: Clifton R. May (E-mail)
Subject: Buried Canyon AZN State #1

Re: pKRV0-202435463

Received your telefax this afternoon regarding my letter of Feb. 1, 2002. The information provided is sufficient and a hard copy will not be necessary. I should have an order out in the morning. Thanks.

2001

* AUGUST *
S M T W T F S
1 2 3 4
5 6 7 8 9 10 11
12 13 14 15 16 17 18
19 20 21 22 23 24 25
26 27 28 29 30 31

* SEPTEMBER *
S M T W T F S
1
2 3 4 5 6 7 8
9 10 11 12 13 14 15
16 17 18 19 20 21 22
23 24 25 26 27 28 29
30

* OCTOBER *
S M T W T F S
1 2 3 4 5 6
7 8 9 10 11 12 13
14 15 16 17 18 19 20
21 22 23 24 25 26 27
28 29 30 31

* NOVEMBER *
S M T W T F S
1 2 3
4 5 6 7 8 9 10
11 12 13 14 15 16 17
18 19 20 21 22 23 24
25 26 27 28 29 30

* DECEMBER *
S M T W T F S
1
2 3 4 5 6 7 8
9 10 11 12 13 14 15
16 17 18 19 20 21 22
23 24 25 26 27 28 29
30 31

2002

* JANUARY *
S M T W T F S
1 2 3 4 5
6 7 8 9 10 11 12
13 14 15 16 17 18 19
20 21 22 23 24 25 26
27 28 29 30 31

* FEBRUARY *
S M T W T F S
1 2
3 4 5 6 7 8 9
10 11 12 13 14 15 16
17 18 19 20 21 22 23
24 25 26 27 28

* MARCH *
S M T W T F S
1 2
3 4 5 6 7 8 9
10 11 12 13 14 15 16
17 18 19 20 21 22 23
24 25 26 27 28 29 30
31

* APRIL *
S M T W T F S
1 2 3 4 5 6
7 8 9 10 11 12 13
14 15 16 17 18 19 20
21 22 23 24 25 26 27
28 29 30

* MAY *
S M T W T F S
1 2 3 4
5 6 7 8 9 10 11
12 13 14 15 16 17 18
19 20 21 22 23 24 25
26 27 28 29 30 31

* JUNE *
S M T W T F S
1
2 3 4 5 6 7 8
9 10 11 12 13 14 15
16 17 18 19 20 21 22
23 24 25 26 27 28 29
30

* JULY *
S M T W T F S
1 2 3 4 5 6
7 8 9 10 11 12 13
14 15 16 17 18 19 20
21 22 23 24 25 26 27
28 29 30 31

YATES PETROLEUM CORPORATION

105 South 4th Street
ARTESIA, NEW MEXICO 88210

MR. MICHAEL STOGNER

OIL CONSERVATION DIVISION

1220 SOUTH ST. FRANCIS DRIVE

SANTA FE, NEW MEXICO 87505

Post-It® Fax Note

7671

Date	2-4-02	# of pages	1
To	MR. STOGNER	From	CLIFFORD MAY
Co./Dept.	OC	Co.	YAC
Phone #		Phone #	(505) 748-4347
Fax #	(505) 476-3462	Fax #	(505) 748-4572

RE: BURIED CANYON AZN STATE No. 1 (p KRYO-202435-463)

DEAR MR. STOGNER:

I DID NOT RECEIVE YOUR JANUARY 24, 2002 EMAIL AS I GAVE YOU AN INCOMPLETE ADDRESS. IT SHOULD BE landdept@ypcfirm.com. THE INFORMATION YOU HAVE REQUESTED IS AS FOLLOWS:

LEASE VA 2482

PERCENTAGE

ABO PETROLEUM CORPORATION

.10000000

MYCO INDUSTRIES, INC

.10000000

YATES DRILLING COMPANY

.10000000

YATES PETROLEUM CORPORATION

.70000000

1.00000000

LEASE VA-2473

ABO PETROLEUM CORPORATION

.10000000

MYCO INDUSTRIES, INC

.10000000

YATES DRILLING COMPANY

.10000000

YATES PETROLEUM CORPORATION

.70000000

1.00000000

A HARD COPY WILL BE MAILED TO YOU LATER. THANK YOU.

Clifford R. May

MARTIN YATES, III
1912 - 1985
FRANK W. YATES
1936 - 1986



105 SOUTH FOURTH STREET
ARTESIA, NEW MEXICO 88210-2118
TELEPHONE (505) 748-1471

S. P. YATES
CHAIRMAN OF THE BOARD
JOHN A. YATES
PRESIDENT
PEYTON YATES
EXECUTIVE VICE PRESIDENT
RANDY G. PATTERSON
SECRETARY
DENNIS G. KINSEY
TREASURER

NSL-4694

February 5, 2002

Mr. Michael Stogner
Oil Conservation Division
1220 South St. Francis Drive
Santa Fe, NM 87505

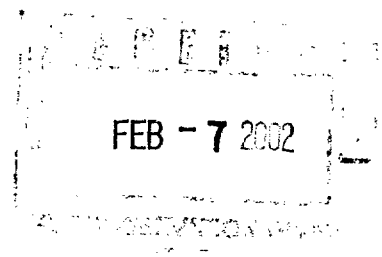

RE: Buried Canyon "AZN" State #1 (pKRVO-202435463)

Dear Mr. Stogner:

I did not receive your January 24, 2002 E-mail as I gave you an incomplete address. It should be landdept@ypcnm.com. The information you have requested is as follows:

<u>Lease VA-2482</u>	<u>Percentage</u>
Abo Petroleum Corporation	.10000000
MYCO Industries, Inc.	.10000000
Yates Drilling Company	.10000000
Yates Petroleum Corporation	.70000000
	1.00000000

<u>Lease VA-2473</u>	<u>Percentage</u>
Abo Petroleum Corporation	.10000000
MYCO Industries, Inc.	.10000000
Yates Drilling Company	.10000000
Yates Petroleum Corporation	.70000000
	1.00000000

A hard copy will be mailed to you later.

Thank you.

Sincerely,

YATES PETROLEUM CORPORATION

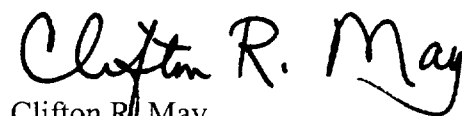
Clifton R. May
Regulatory Agent

CRM/rca

PKRVO-202435463

New Mexico Oil Conservation Division---Enginnering Bureau
Administrative Application Process Documentation

Date Application Received: 1-22-02

Date of Preliminary Review: 1-24-02
(Note: Must be within 10-days of received date)

Results: Application Complete ☒ Application Incomplete

Date Incomplete ^{e-mail} Letter Sent: 1-24-02

Deadline to Submit Requested Information: * ~~1-28-02~~ 2-1-02

Phone Call Date: NA
(Note: Only applies is requested data is not submitted within the 7-day deadline)

Phone Log Completed? Yes No

Date Application Processed: 2-5-02

Date Application Returned: _____
(Note: Only as a last resort & only after repeated attempts by the Division to obtain the necessary information to process the application)

* will mail my letter if no response by next
Friday

Date Incomplete letter sent 2-15-2002

Deadline to Submit requested info. 2-8-02