

CONTINENTAL OIL COMPANY

Roswell, New Mexico  
March 13, 1957

New Mexico Oil Conservation Commission  
Box 871  
Santa Fe, New Mexico

Attention: Mr. A. L. Porter, Jr., Secretary-Director

Re: Continental Oil Company  
Application for Authority to  
effect a Eunice Oil - Eumont  
Gas dual completion on its  
Reed B-24 well No. 2 located  
in Section 24, T-20S, R-36E,  
Lea County, New Mexico; and  
for approval of a 160-acre  
non-standard gas proration  
unit consisting of the SW/4  
Section 24, T-20S, R-36E.

Gentlemen:

Continental Oil Company respectfully requests administrative approval under the provisions of statewide rule 112-A to dually complete in the Eunice oil pool and the Eumont gas pool its Reed B-24 well No. 2, located 1980' from the South line and 1980' from the West line of Section 24, T-20S, R-36E, NMPM, Lea County, New Mexico. A plat attached hereto shows the manner in which the dual completion is proposed to be accomplished. The Eumont gas will be produced through the casing-tubing annulus while Eunice oil is being produced through the tubing. The fluids from the two reservoirs will be completely separated by appropriate packers, and the well will be so equipped that the reservoir pressure of each of the two pools may be determined separately. Well head equipment will include all necessary connections to permit accurate measurement of fluids produced by each pool as may be required by the Commission.

We further respectfully request approval under the provisions of Rule No. 5 (b) of the Special Rules and Regulations for the Eumont Gas Pool of Order No. R-520 of a 160-acre non-standard gas proration unit consisting of the SW/4 of the said Section 24 to be allocated to the said well No. 2. In support of this request we should like to point out that the

proposed unit conforms with the requirements of said Rule 5

(b) in all aspects as follows:

1. Said unit consists of contiguous quarter-quarter sections (and/or lots).
2. Said unit lies wholly within a single governmental section.
3. The entire proposed unit may be reasonably presumed to be productive of gas.
4. The length or width of said unit does not exceed 5,280 feet.
5. Copies of this application have been furnished this date by registered mail to all offset operators and all operators within 1,500 feet of said well, as required by the provision of said Rule 5 (b) and said rule No. 112-A.

A plat is attached hereto showing to the best of our knowledge and belief the proposed unit, the location of the No. 3 well and other wells on the lease, offset wells and ownership thereof.

The granting of this application is in the interest of preventing waste and the protection of correlative rights.

In view of the facts set out herein it is respectfully requested that the Commission enter an order approving the proposed dual completion and non-standard unit both as described above.

  
R. L. Adams  
Division Superintendent  
of Production  
New Mexico Division

RLA-BC

Copies to:

Phillips Petroleum Corporation  
Hobbs, New Mexico

Pan American Petroleum Corp.  
P. O. Box 899  
Roswell, New Mexico

Skelly Oil Company  
Hobbs, New Mexico

Atlantic Refining Company  
Box 871  
Midland, Texas

Sinclair Oil and Gas Company  
Box 1470  
Hobbs, New Mexico

New Mexico Oil Conservation Commission

STATE OF NEW MEXICO    )  
                              )  
COUNTY OF CHAVES       ) ss.

R. L. Adams, being first duly sworn on behalf of the applicant in the above application, says: That he is the Division Superintendent, of applicant, and as such is authorized to make said application; that he has read the foregoing application, knows the contents thereof, and that the same are true as he is reliably informed and believes.

*R. L. Adams*  
(Signature)

Subscribed and sworn to before me this 13<sup>th</sup> day of March, 1957.  
~~1956~~

*Louis B. Houston*  
Notary Public

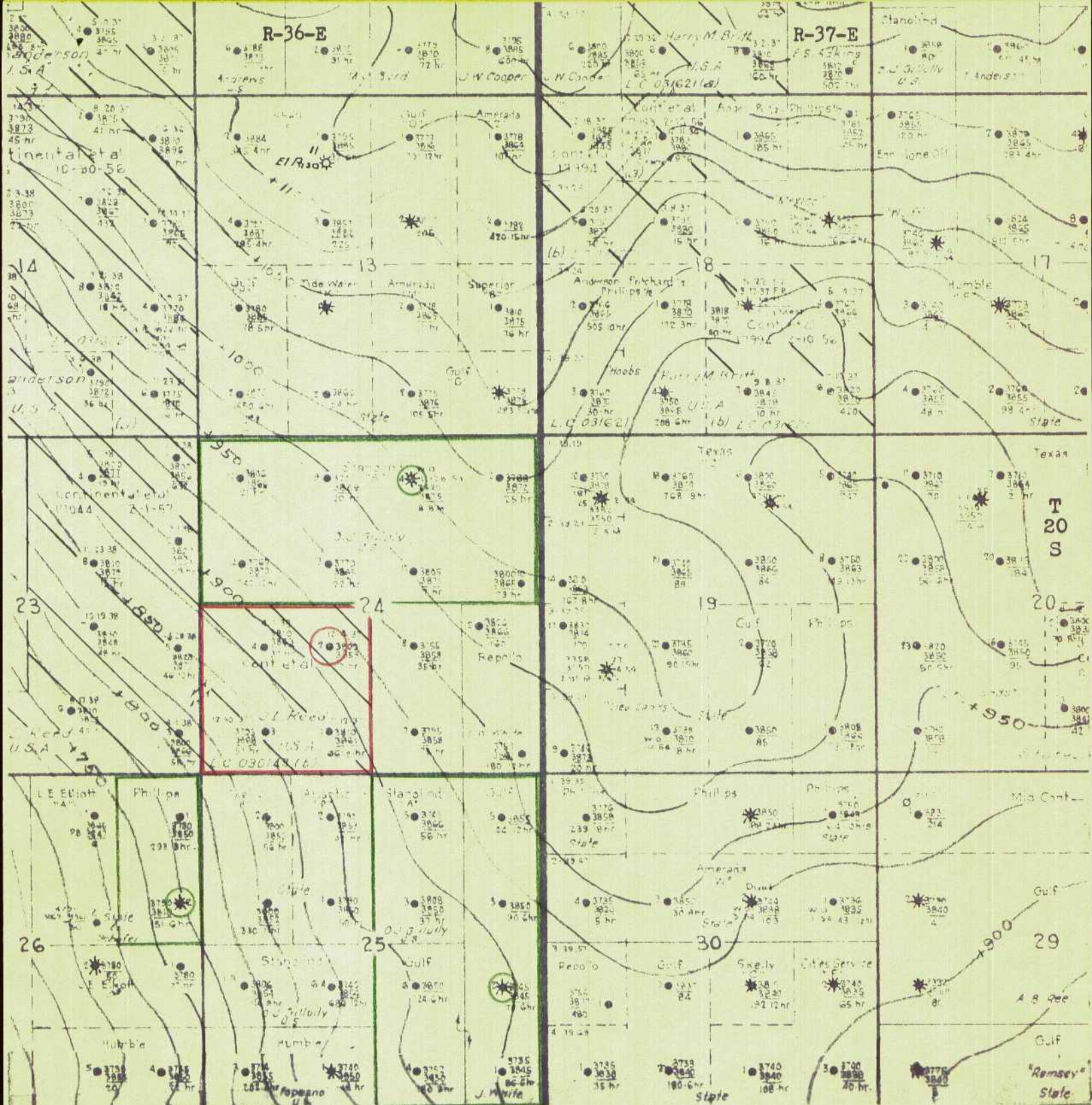

My Commission Expires:  
May 25, 1960





CONTINENTAL OIL COMPANY  
AREA OF EUMONT POOL  
scale: 1"=2,000'

Contour Int: 25'

Yates Contours

 Proposed Gas Well  
 Proposed Gas Unit

 Offset Gas Well  
 Offset Gas Unit

2/20/57



# CONTINENTAL OIL COMPANY

## PROPOSED METHOD OF DUAL COMPLETION

REED B-24 NO.2

Elev: 3559'

