

HUMBLE OIL & REFINING COMPANY
HUMBLE DIVISION

Hobbs, New Mexico
April 19th, 1963

Re: Request for Re-Allocation
of Acreage Dedicated to
New Mexico State "V"-11,
Blinebry Gas Well

New Mexico Oil Conservation Commission
P. O. Box 871
Santa Fe, New Mexico

Mr. A. L. Porter, Jr.

Dear Sir:

Humble Oil and Refining Company respectfully requests re-allocation of the acreage dedicated to it's New Mexico State "V"-11, Blinebry Gas Well, located in Unit K, Section 10, T-21-S, R-37-E to include only the NE/4 of the SW/4 of Section 10. This reduction in dedicated acreage from 80 acres to 40 acres is the result of the re-completion of Humble's New Mexico State "V"-7, located in Unit N of Section 10, T-21-S, R-37-E, as a Blinebry Oil Well.

Very truly yours,

HUMBLE OIL & REFINING COMPANY

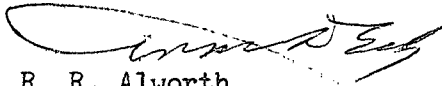
R. R. Alworth
District Superintendent

DFL/akf

Attach.

cc: New Mexico Oil Conservation Commission
Box 2045
Hobbs, New Mexico
cc: Continental Oil Company
Box 68
Eunice, New Mexico
cc: Gulf Oil Corporation
Box 2167
Hobbs, New Mexico
cc: Pan American Petroleum Corporation
Box 68
Hobbs, New Mexico
cc: Tidewater Oil Company
Box 547
Hobbs, New Mexico
cc: Mr. J. E. Pinkerton, Midland
cc: File

*NSP-646
30 days
Effective date oil
well allowable was
assigned to New Mexico
State "V"-7
JRM
Due 5-23*

NUMBER OF COPIES RECEIVED	
DISTRIBUTION	
SANTA FE	
FILE	
U.S.G.S.	
LAND OFFICE	
TRANSPORTER	OIL GAS
PRODUCTION OFFICE	
OPERATOR	

NEW MEXICO OIL CONSERVATION COMMISSION
WELL LOCATION AND ACREAGE DEDICATION PLAT
 SEE INSTRUCTIONS FOR COMPLETING THIS FORM ON THE REVERSE SIDE

FORM C-128
 Revised 5/1/57

SECTION A

Operator HUMBLE OIL & REFINING COMPANY			Lease New Mexico State "V"		Well No. 11-U
Unit Letter K	Section 10	Township T-21-S	Range R-37-E	County Lea	
Actual Footage Location of Well: 500 feet from the South line and 1880 feet from the West line					
Ground Level Elev.	Producing Formation Blinbry-Gas	Pool Blinbry Oil	Dedicated Acreage: 40 Acres		

1. Is the Operator the only owner in the dedicated acreage outlined on the plat below? YES ☒ NO ____ . ("Owner" means the person who has the right to drill into and to produce from any pool and to appropriate the production either for himself or for himself and another. (65-3-29 (e) NMSA 1935 Comp.)
2. If the answer to question one is "no," have the interests of all the owners been consolidated by communitization agreement or otherwise? YES ____ NO ____ . If answer is "yes," Type of Consolidation _____
3. If the answer to question two is "no," list all the owners and their respective interests below:

Owner	Land Description

SECTION B

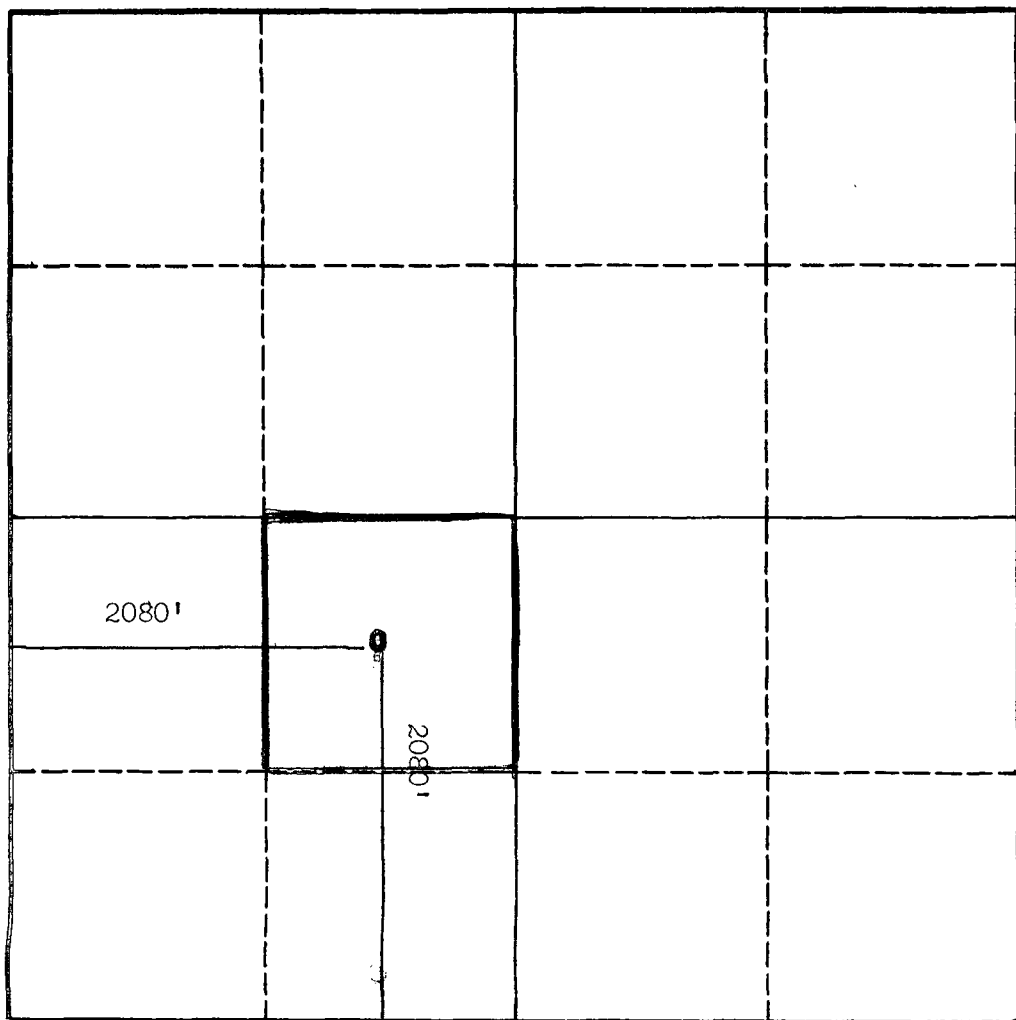

CERTIFICATION

I hereby certify that the information in SECTION A above is true and complete to the best of my knowledge and belief.

Name _____
 Position _____
 Agent _____
 Company
 HUMBLE OIL & REFINING CO.
 Date
 April 19th, 1963

I hereby certify that the well location shown on the plat in SECTION B was plotted from field notes of actual surveys made by me or under my supervision, and that the same is true and correct to the best of my knowledge and belief.

Date Surveyed _____
 Registered Professional Engineer
 and/or Land Surveyor

Certificate No. _____

0 330 660 990 1320 1650 1980 2310 2640 2000 1500 1000 500 0