

NSP - 849  
issue 1-5-72  
Auth - Rule 5(C) of R-1670, as amended



PETROLEUM PRODUCTS

RECEIVED

DEC - 6 1971

OFF CONSERVATION COMM.

TEXACO INC.  
DRAWER 728  
HOBBS, NEW MEXICO 88240

December 2, 1971

New Mexico Oil Conservation Commission  
P. O. Box 2088  
Santa Fe, New Mexico 87501

Re: Change of Well Classification  
Blinebry Gas Pool  
NMOCC Order No. R-1670  
TEXACO Inc.  
A. H. Blinebry Federal (NCT-3) No. 1  
Lea County, New Mexico

Attention: Mr. A. L. Porter, Jr.

Gentlemen:

*George's  
dept.*

TEXACO Inc.'s A. H. Blinebry Federal (NCT-3) Well No. 1, located in Unit D of Section 31, T-22-S, R-38-E, is producing with a GOR in excess of the 32,000 SCF/STB limit for an oil well in the Blinebry oil pool and has been re-classified as a gas well. It is requested that an additional 40 acres, being Unit C of the same section, be assigned to the subject well as per Rule 29 of Order R-1670. This will result in a non-standard gas proration unit of 80 acres which is one-half of the standard Blinebry gas proration of 160 acres. Attached is a lease plat indicating the requested non-standard unit. The ownership of the subject two 40-acre units is common throughout.

*Chris  
dept.*

The A. H. Blinebry Federal (NCT-3) No. 1 is not capable of producing into a high pressure separator and your permission is requested to continue producing the well into the low pressure gas line and to continue producing the liquids into the battery as per Rule 34 (E) of Order R-1670. An additional separator will be set for the subject well and the gas will be metered separately prior to sales. Attached is a diagrammatic sketch of the proposed tank battery installation.

Your cooperation in this matter will be appreciated.

Yours very truly,

*W. E. Morgan*

W. E. Morgan  
District Superintendent

CPC:jg  
MASJr.  
NMOCC-Hobbs  
Offset Operators

NEW MEXICO OIL CONSERVATION COMMISSION  
WELL LOCATION AND ACREAGE DEDICATION PLAT

RECEIVED

Form C-102  
Supersedes C-128  
Effective 1-1-65

DEC - 6 1971

All distances must be from the outer boundaries of the Section.

Operator TEXACO Inc.		Lease A. H. Blinebry NCT-3		Well No. 1	
Unit Letter D	Section 31	Township 22 South	Range 38 East	County Lea	
Actual Footage Location of Well: 660' feet from the North line and 660' feet from the West line Sec. 31					
Ground Level Elev. 3308'	Producing Formation Blinebry	Pool Blinebry		Dedicated Acreage 80 Acres	

1. Outline the acreage dedicated to the subject well by colored pencil or hachure marks on the plat below.
2. If more than one lease is dedicated to the well, outline each and identify the ownership thereof (both as to working interest and royalty).
3. If more than one lease of different ownership is dedicated to the well, have the interests of all owners been consolidated by communitization, unitization, force-pooling, etc?

☐ Yes ☐ No If answer is "yes," type of consolidation \_\_\_\_\_

If answer is "no," list the owners and tract descriptions which have actually been consolidated. (Use reverse side of this form if necessary.) \_\_\_\_\_

No allowable will be assigned to the well until all interests have been consolidated (by communitization, unitization, forced-pooling, or otherwise) or until a non-standard unit, eliminating such interests, has been approved by the Commission.

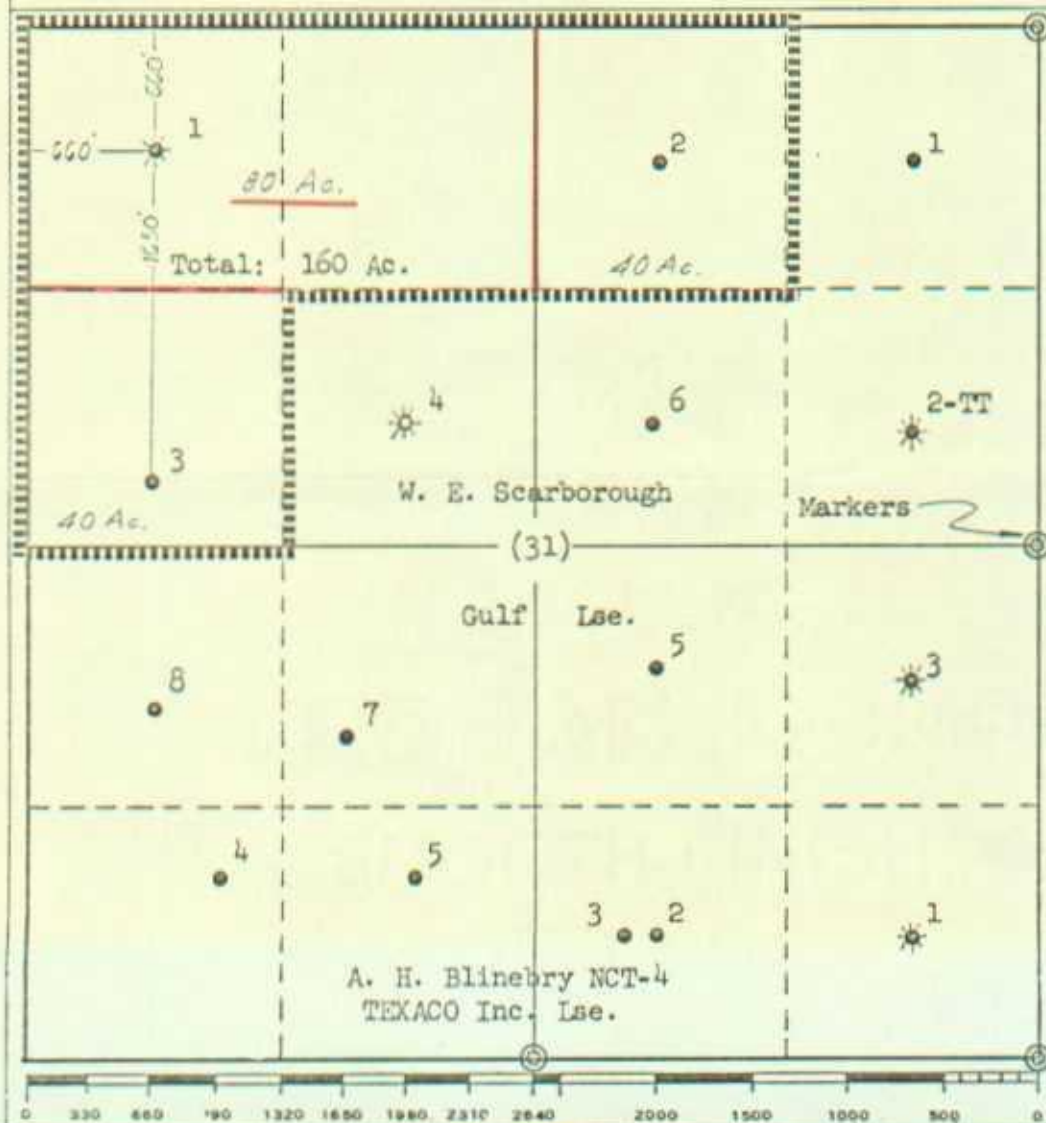

CERTIFICATION

I hereby certify that the information contained herein is true and complete to the best of my knowledge and belief.

*B. L. Eiland*

Name  
B. L. Eiland  
Position  
Registered Land Surveyor  
Company  
TEXACO Inc.

Date  
12/1/71

I hereby certify that the well location shown on this plat was plotted from field notes of actual surveys made by me or under my supervision, and that the same is true and correct to the best of my knowledge and belief.

Date Surveyed  
7/15/58  
Registered Professional Engineer and/or Land Surveyor

*B. L. Eiland*  
B. L. Eiland

Certificate No.  
4386

RECEIVED  
DEC - 6 1971  
CONSERVATION COMMISSION

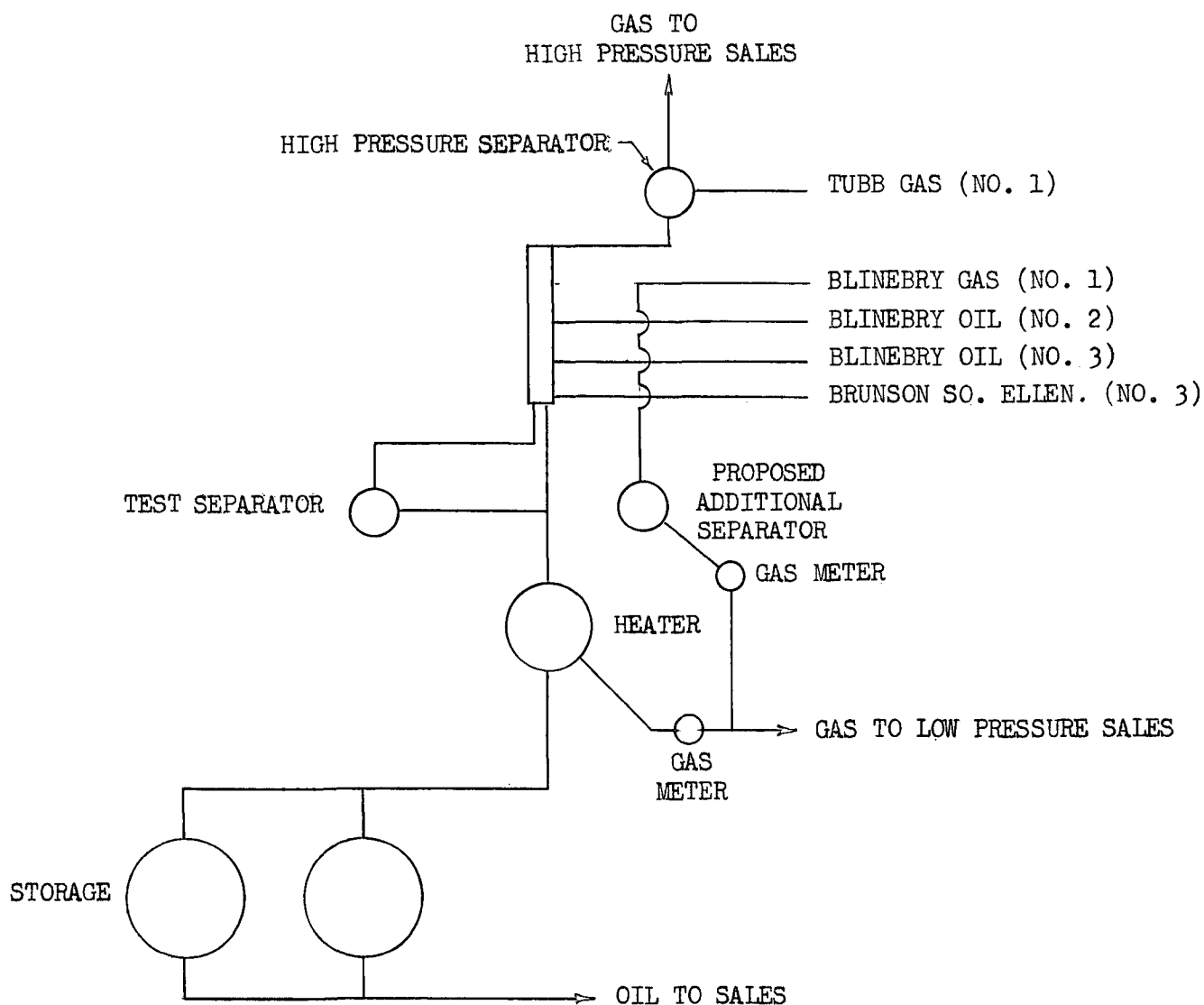

TEXACO Inc.

PRODUCTION BATTERY  
A. H. BLINEBRY FEDERAL (NCT-3) LEASE  
LEA COUNTY, NEW MEXICO

CPC/FMR 12-1-71

RECEIVED  
DEC - 6 1971  
CONSERVATION COMM

Change of Well Classification  
Blinebry Gas Pool  
NMOCC Order No. R-1670  
TEXACO Inc.  
A. H. Blinebry Federal (NCT-3) No. 1  
Lea County, New Mexico

List of Offset Operators  
Notified of Texaco's Request  
12-2-71

Aztec Oil & Gas Company  
P. O. Box 847  
Hobbs, New Mexico 88240

Gulf Oil Company  
P. O. Box 670  
Hobbs, New Mexico 88240

Phillips Petroleum Company  
4th & Washington  
Odessa, Texas 79760

Western Oil Producers, Inc.  
P. O. Box 2055  
Roswell, New Mexico 88201