

January 9, 1980



RECEIVED

JAN 17 1980

MESA-PED

DEPCO, Inc.
402 Western United Life Bldg.
Midland, Texas 79701

RE: Mesa Petroleum Co
Derrick Federal #2
2160' FNL & 660' FEL
Lot 9, Sec 5, T16S, R28E
Eddy County, New Mexico

Gentlemen:

Mesa Petroleum Co intends to file for an administrative approval for a non-standard gas proration unit for subject captioned well. The well location itself may or may not be orthodox being 2160' from the north and 1980' from the south end lines and 660' from the nearest side boundary and 330' from section lines as far as can be determined as illustrated by the attached diagram. 270.5 acres are being dedicated to this well from the northeast part of the section due to the survey anomalies of lots 1, 2, 7, 8, 9, 10, 15, and 16.

It is requested that you signify having no objections to approval of the unit or location by signing this letter and returning same to Mesa Petroleum Co in the envelope provided.

Thank you for your kind assistance.

Yours truly,

A handwritten signature in cursive script that reads 'R.E. Mathis'.

R.E. Mathis
Regulatory Coordinator

The undersigned has no objections to the proposal outlined above.

R.B. Ranum Vice President 1-14-80
Name/Title Date
DEPCO, Inc.
Company

REM/vlh
Attch

January 9, 1980



Gulf Oil Corporation
P. O. Box 1150
Midland, Texas 79702

RE: Mesa Petroleum Co
Derrick Federal #2
2160' FNL & 660' FEL
Lot 9, Sec 5, T16S, R28E
Eddy County, New Mexico

Gentlemen:

Mesa Petroleum Co intends to file for an administrative approval for a non-standard gas proration unit for subject captioned well. The well location itself may or may not be orthodox being 2160' from the north and 1980' from the south end lines and 660' from the nearest side boundary and 330' from section lines as far as can be determined as illustrated by the attached diagram. 270.5 acres are being dedicated to this well from the northeast part of the section due to the survey anomalies of lots 1, 2, 7, 8, 9, 10, 15, and 16.

It is requested that you signify having no objections to approval of the unit or location by signing this letter and returning same to Mesa Petroleum Co in the envelope provided.

Thank you for your kind assistance.

Yours truly,

R.E. Mathis
Regulatory Coordinator

The undersigned has no objections to the proposal outlined above.

D. T. Berlin -Manager-Engineering 1-17-80
D. T. Berlin Name/Title Date

Gulf Oil Corporation
Company

REM/vlh
Attch

RECEIVED

JAN 21 1980



J. R. Barnett
Regional Engineering
Manager

January 18, 1980

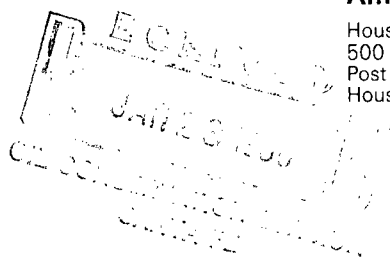

Amoco Production Company

Houston Region
500 Jefferson Building
Post Office Box 3092
Houston, Texas 77001

File: JCA-986.51NM-230

Re: Non-Standard Gas Proration Unit
Mesa Petroleum Co.
Derrick Federal No. 2
2160' FNL and 660' FEL
Lot 9, Sec. 5, T-16S, R-28E
Eddy County, New Mexico

Mr. Joe D. Ramey
New Mexico Oil Conservation Commission
P. O. Box 2088
Santa Fe, NM 87501

Gentlemen:

Mesa Petroleum Company intends to file for an administrative approval for a non-standard gas proration unit for the subject well. The proposed location being 2160' from the north and 1980' from the south end lines and 660' from the nearest side boundary and 330' from the section lines. 270.5 acres are being dedicated to this well from the northeast part of the section.

As an offset operator, Amoco Production Company has no objections to this unit or location.

Yours very truly,

J.R. Barnett
mcc

MCL/dgh
91/E

cc: Mesa Petroleum Company
1000 Vaughn Building
Midland, TX 79701



January 23, 1980

Mr. Joe D. Ramey, Director
Oil Conservation Division
P. O. Box 2088
Santa Fe, New Mexico 87501

Re: (Mesa Petroleum Co
Derrick Federal #2
2160' FNL & 660' FEL
Lot 9, Sec 5, T16S, R28E
Eddy County, New Mexico

Dear Mr. Ramey:

Application is hereby made for an administrative approval of a 270.5 acre non-standard gas proration unit under Rule 104DII for the above captioned well. Application is necessitated by the unorthodox survey lines pertaining to the north third of subject section, namely Lots 1 and 2 which only contain 15.25 acres as outlined in the attached diagram (2). It should be noted that this location may or may not be orthodox due to these survey anomalies.

All off-set operators to the proposed unit have offered no objections as attested by the enclosed letters-of-consent and as identified by the attached land map and location plat (C-102).

Expeditious handling of this request and issuance of appropriate administrative order is appreciated.

Yours truly,

R. E. Mathis
Regulatory Coordinator

REM/vlh

Attach (2)
Encl (3)

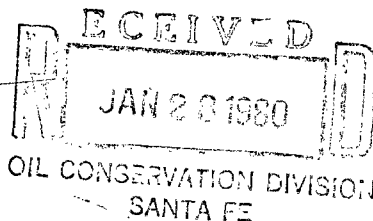

NSP-1176
Rule 104 D. II
Immediate
Lot 1 & 2, S 1/2 NE 1/4
and SE 1/4
Lots 1, 2, 9, 10,
15 & 16 and
SE 1/4

**NEW MEXICO OIL CONSERVATION COMMISSION
WELL LOCATION AND ACREAGE DEDICATION PLAT**

Form C-102
Supersedes C-128
Effective 1-1-85

All distances must be from the outer boundaries of the Section

Operator Mesa Petroleum Co.			Lease Derrick Federal		Well No. 2
Unit Letter 1	Section 5	Township 16 South	Range 28 East	County Eddy	
Actual Frontage Location of Well: 2160 feet from the North line and 660 feet from the East line					
Ground Level Elev. 3652.2	Producing Formation Atoka - Morrow	Pool Undesignated	Dedicated Acreage: 271 Acres		

1. Outline the acreage dedicated to the subject well by colored pencil or hatchure marks on the plat below.
2. If more than one lease is dedicated to the well, outline each and identify the ownership thereof (both as to working interest and royalty).
3. If more than one lease of different ownership is dedicated to the well, have the interests of all owners been consolidated by communitization, unitization, force-pooling, etc?

☐ Yes ☐ No If answer is "yes," type of consolidation _____

If answer is "no," list the owners and tract descriptions which have actually been consolidated. (Use reverse side of this form if necessary.) _____

No allowable will be assigned to the well until all interests have been consolidated (by communitization, unitization, forced-pooling, or otherwise) or until a non-standard unit, eliminating such interests, has been approved by the Commission.

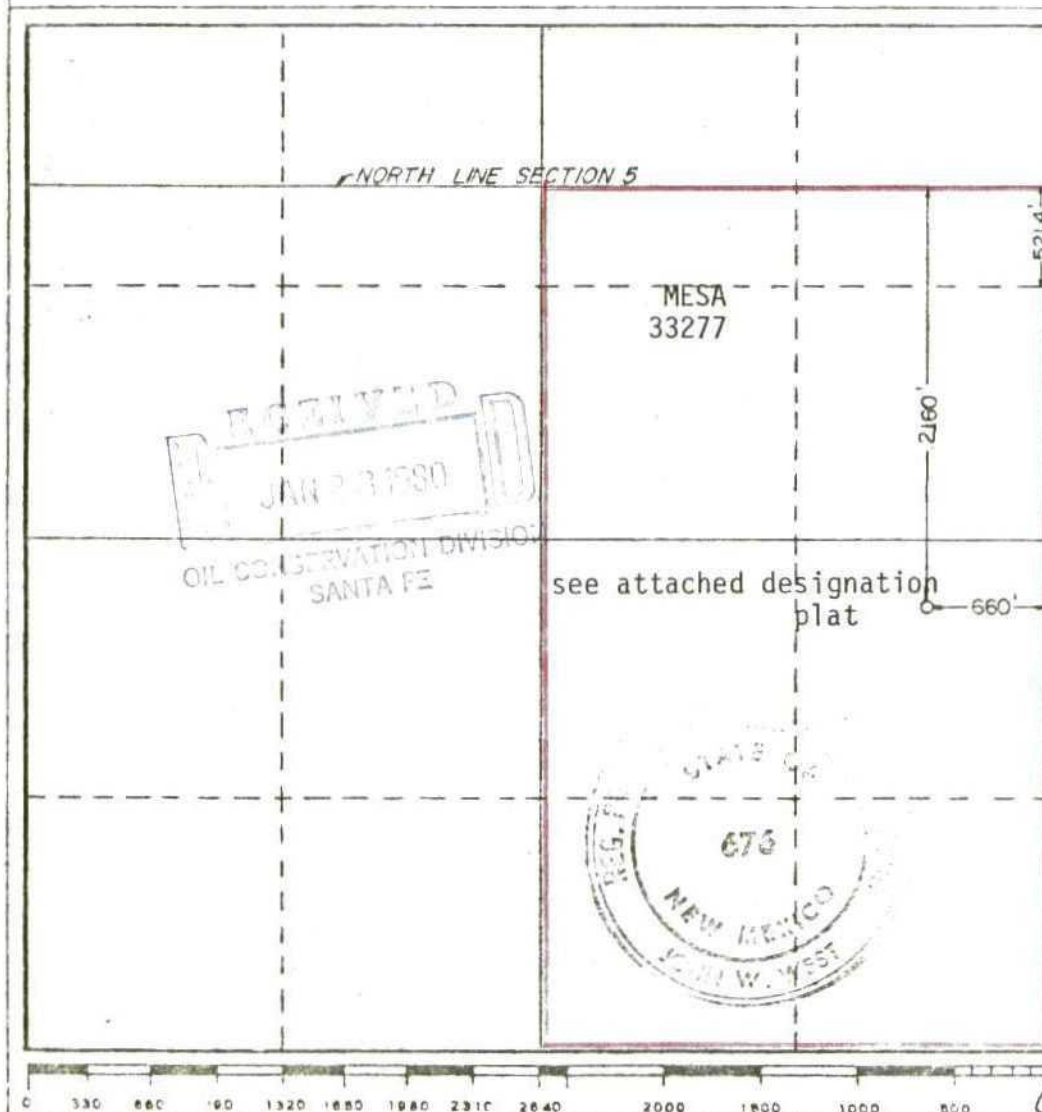

CERTIFICATION

I hereby certify that the information contained herein is true and complete to the best of my knowledge and belief.

Name
R. E. Mathis

Position
Regulatory Coordinator

Company
Mesa Petroleum Co

Date
January 15, 1980

I hereby certify that the well location shown on this plat was plotted from field notes of actual surveys made by me or under my supervision, and that the same is true and correct to the best of my knowledge and belief.

Date Surveyed
January 9, 1980

Registered Professional Engineer and/or Land Surveyor

John W. West

Certificate No. **JOHN W. WEST 676**
PATRICK A. ROMERO 6668
Ronald J. Eidson 3239

ATTACHMENT (1)

R 27 E

MESA

35

AMOCO

36

T 15 S

GULF

6

DEPCO
NW 16100

15.05 AC.

4

16.16 AC.

5

3

15.23 AC.

MESA
NW 33277

2

15.23 AC.

5

CHAVES CO.
EDDY CO.

DEPCO

T 16 S

40 AC.

12

MESA
NW 33277

Mesa
Derrick Fed. Com. 1

11

40 AC.

10

40 AC.

Mesa
Derrick Fed.
No. 2

9

40 AC.

13

40 AC.

14

40 AC.

15

40 AC.

16

40 AC.

40 AC.

40 AC.

40 AC.

R 28 E



MESA
PETROLEUM CO.



PERMIAN BASIN DIVISION

Acreage Allocation Plat
For Proposed

DERRICK, FEDERAL #2

2160' FNL & 660' FEL
Sec. 5, T 16 S, R 28 E
Eddy County, New Mexico

ATTACHMENT (2)