



L. P. Thompson
Division Manager

John R. Kemp
Assistant Division Manager

Production Department
Hobbs Division
North American Production

Conoco Inc.
P. O. Box 460
1001 North Turner
Hobbs, NM 88240
(505) 393-4141

NSP - 1185
Rule 5 C 3
Order R-1670
4-16-80

March 6, 1980

New Mexico Oil and Gas Conservation Commission
P.O. Box 2088
Santa Fe, NM 87501

Attention: Mr. Joe D. Ramey, Secretary Director

Gentlemen:

Request for NSP Unit - SEMU Eumont No. 118, 1750' FNL & 660' FEL of Section 27, T-20S, R-37E, Lea County, New Mexico

Conoco Inc. respectfully requests administrative approval of a 160 acre non-standard proration unit for its SEMU Eumont No. 118 well, Eumont Queen Gas Pool. The well is located in Unit Letter H, Section 27, T-20S, R-37E, Lea County, New Mexico. The proposed NSP unit will consist of the E/2 NE 1/4, E/2 SE 1/4 of Section 27.

E/2 E/2

The proposed unit will conform to regulatory standards in the following ways:

- (1) Said unit consists of contiguous quarter-quarter sections (and/or lots).
- (2) Said unit lies wholly within a single governmental section.
- (3) The entire proposed unit may be reasonably presumed to be productive of gas.
- (4) The length or width of said unit does not exceed 5,280 feet.
- (5) Copies of this application have been furnished by certified mail to all offset operators and all operators within said section.

RECEIVED
MAR 17 1980
OIL CONSERVATION
SANTA FE

Administrative approval is requested under R-1670 of the Special Rules and Regulations for the Eumont Queen Gas Pool.

HKW:bep
Attach

cc: New Mexico Oil Conservation Division
P.O. Box 1980
Hobbs, NM 88240

NMOCC - Santa Fe
March 6, 1980
Page 2

cc: W.I. Owners

Amoco Production Company
P.O. Box 68
Hobbs, NM 88240

Atlantic Richfield
P.O. Box 1710
Hobbs, NM 88240

Chevron, USA
P.O. Box 1660
Midland, TX 79701

Offset Operators (other than Working Interest Owners)

Petro-Lewis Corporation
P.O. Box 2250
Denver, CO 80202

Phillips Petroleum Company
5 B4 Phillips Building
Natural Resources Group
Bartlesville, OK 74004

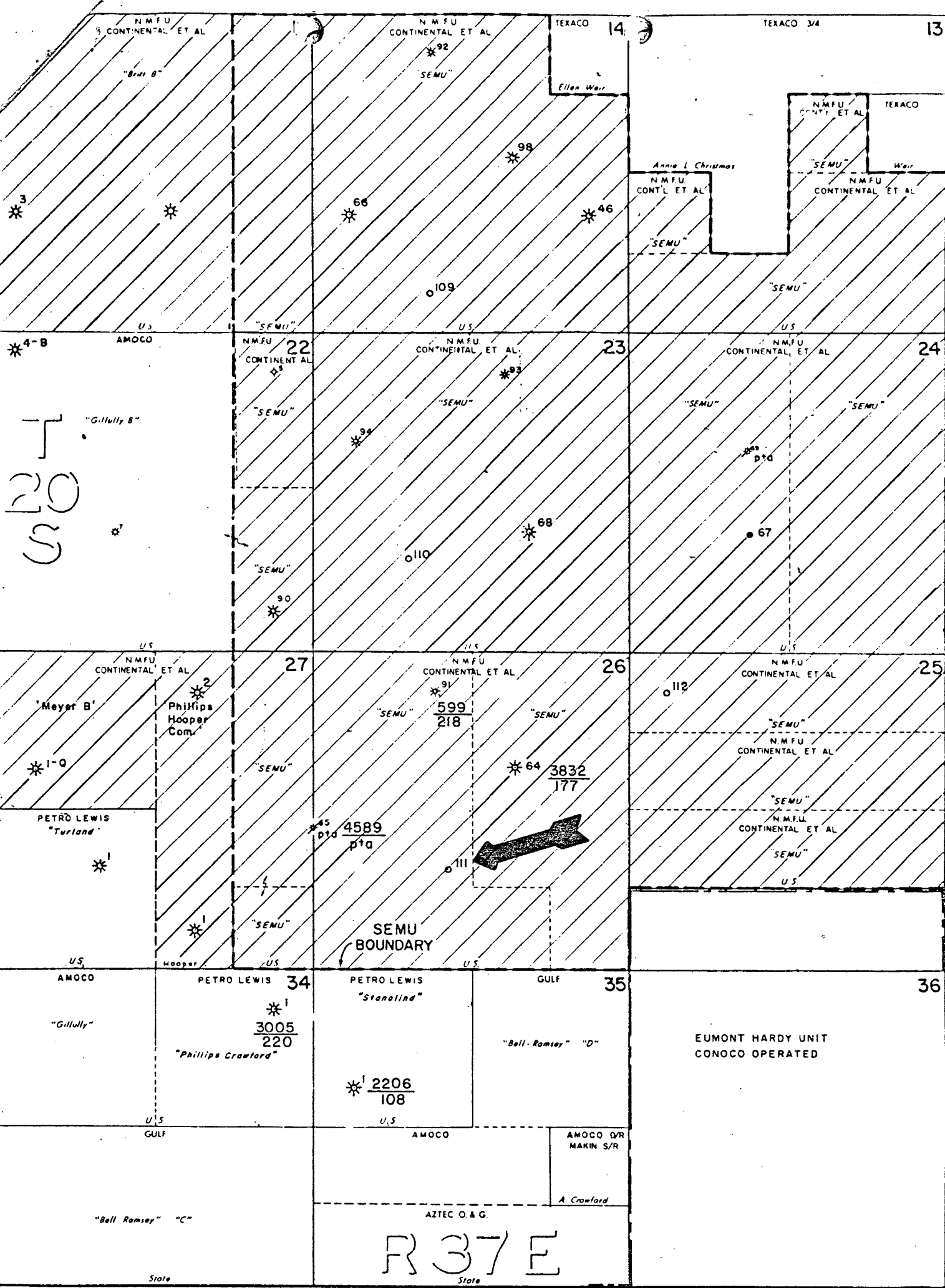

MMCFG
MCFGPD

ONLY EUMONT GAS WELLS SHOWN

conoco

PRODUCTION DEPARTMENTHOBBS DIVISION

LEA COUNTY, NEW MEXICO

SCALE0100020001-80

LEGEND:

- LOCATION
- OIL WELL
- ✱ GAS WELL

- ✱ DRY HOLE
- ▲ INJECTION WELL
- ✱ ABANDONED WELL
- ✱ SHUT-IN WELL

- ⊕ SALT WATER DISPOSAL WELL
- DEEPER WELL
- ZONE UNTESTED

UNITED STATES
DEPARTMENT OF THE INTERIOR
GEOLOGICAL SURVEY

APPLICATION FOR PERMIT TO DRILL, DEEPEN, OR PLUG BACK

1a. TYPE OF WORK

DRILL ☒

DEEPEN ☐

PLUG BACK ☐

b. TYPE OF WELL

OIL WELL ☐

GAS WELL ☒

OTHER

SINGLE ZONE ☒

MULTIPLE ZONE ☐

2. NAME OF OPERATOR

Conoco Inc.

3. ADDRESS OF OPERATOR

P.O. Box 460, Hobbs, N.M. 88240

4. LOCATION OF WELL (Report location clearly and in accordance with any State requirements.)*

At surface

1750 1650' FNL & 660' FEL

At proposed prod. zone

same

14. DISTANCE IN MILES AND DIRECTION FROM NEAREST TOWN OR POST OFFICE*

15. DISTANCE FROM PROPOSED*

LOCATION TO NEAREST PROPERTY OR LEASE LINE, FT. (Also to nearest drlg. unit line, if any)

16. NO. OF ACRES IN LEASE

17. NO. OF ACRES ASSIGNED TO THIS WELL

18. DISTANCE FROM PROPOSED LOCATION* TO NEAREST WELL, DRILLING, COMPLETED, OR APPLIED FOR, ON THIS LEASE, FT.

19. PROPOSED DEPTH

20. ROTARY OR CABLE TOOLS

21. ELEVATIONS (Show whether DF, RT, GR, etc.)

3512.2' GR

22. APPROX. DATE WORK WILL START*

23. PROPOSED CASING AND CEMENTING PROGRAM

SIZE OF HOLE	SIZE OF CASING	WEIGHT PER FOOT	SETTING DEPTH	QUANTITY OF CEMENT
12 1/4"	8 5/8"	24#	1300'	630 sx.
7 7/8"	5 1/2"	15.5#	3770'	794 sx.

It is proposed to drill a straight hole to a TD of 3770' & complete it as a Eumont Queen gas well.

See attachments for 10-point well plan & 13-pt. surface use plan.

Acceage is dedicated to a purchaser.

IN ABOVE SPACE DESCRIBE PROPOSED PROGRAM: If proposal is to deepen or plug back, give data on present productive zone and proposed new productive zone. If proposal is to drill or deepen directionally, give pertinent data on subsurface locations and measured and true vertical depths. Give blowout preventer program, if any.

24.

SIGNED

W. A. B. B. B.

TITLE Administrative Supervisor

DATE

2/4/80

(This space for Federal or State office use)

PERMIT NO.

APPROVAL DATE

APPROVED BY

TITLE

DATE

CONDITIONS OF APPROVAL, IF ANY:

USGS-6

NMFA-4

JFB-2

FILE

*See Instructions On Reverse Side

ATTACHMENT TO FORM 9-331 C
APPLICATION FOR PERMIT TO DRILL

Conoco Inc.
SEMU Eumont No. 118
Sec. 27, T-20S, R-37E
Lea County, New Mexico

1. The geologic name of the surface formation is Pleistocene Sand.
2. The estimated tops of important geologic markers are shown on the attached Proposed Well Plan.
3. The estimated depths at which anticipated water, oil, gas or other mineral-bearing formations to be encountered are shown on attached Proposed Well Plan.
4. The proposed casing program is as follows:

0' - 1300'	8 5/8",	24# ,	K-55,	ST&C
0' - 3770'	5 1/2",	15.5#,	K-55,	ST&C
5. A drawing of an API Series 900 Blowout Preventer Specification is attached. Pipe rams and blinds will be checked to 1,000 PSI for 30 minutes when BOP is installed. BOP will be checked when casing string is set and operated daily for checks.
6. The proposed mud program is as follows:

0' - 1300'	8.5 - 9.0 ppg	Spud mud
1300' - 3770'	9.0 - 10.0 ppg	Salt gel
7. The auxiliary equipment to be used is:
 - (1) kelly cocks
 - (2) floats at the bit
8. It is proposed to run GR CAL CNL FDC PDC logs at selected intervals.
9. No abnormal pressures or temperatures are expected to be encountered in this well.
10. The anticipated starting date is March 21, 1980 with a duration of approximately 7 days.

**NEW MEXICO OIL CONSERVATION COMMISSION
WELL LOCATION AND ACREAGE DEDICATION PLAT**

Form C-102
Supersedes C-12
Effective 1-1-65

All distances must be from the outer boundaries of the Section

Operator CONOCO, INC.			Lease SEMU Eumont		Well No. 118
Tract Letter H	Section 27	Township 20 South	Range 37 East	County Lea	
Actual Footage Location of Well: 1750 feet from the North line and 660 feet from the East line					
Ground Level Elev. 3512.2	Producing Formation Eumont		Pool Eumont Queen Gas		Estimated Acreage 160 Acres

1. Outline the acreage dedicated to the subject well by colored pencil or hachure marks on the plat below.
2. If more than one lease is dedicated to the well, outline each and identify the ownership thereof (both as to working interest and royalty).
3. If more than one lease of different ownership is dedicated to the well, have the interests of all owners been consolidated by communitization, unitization, force-pooling, etc?

☐ Yes ☐ No If answer is "yes," type of consolidation _____

If answer is "no," list the owners and tract descriptions which have actually been consolidated. (Use reverse side of this form if necessary.) _____

No allowable will be assigned to the well until all interests have been consolidated (by communitization, unitization, forced-pooling, or otherwise) or until a non-standard unit, eliminating such interests, has been approved by the Commission.

CERTIFICATION

I hereby certify that the information contained herein is true and complete to the best of my knowledge and belief.

Name **Wm. A. Butterfield**
Position _____

Admin. Supervisor

Company
Conoco Inc.

Date
11/24/80

I hereby certify that the well location shown on this plat was plotted from field notes of actual surveys made by me or under my supervision, and that the same is true and correct to the best of my knowledge and belief.

Date Surveyed
January 19, 1980

Registered Professional Engineer and/or Land Surveyor

John W. West

Certificate No. **JOHN W. WEST 676**
PATRICK A. ROMERO 6888
Ronald J. Eidson 3239

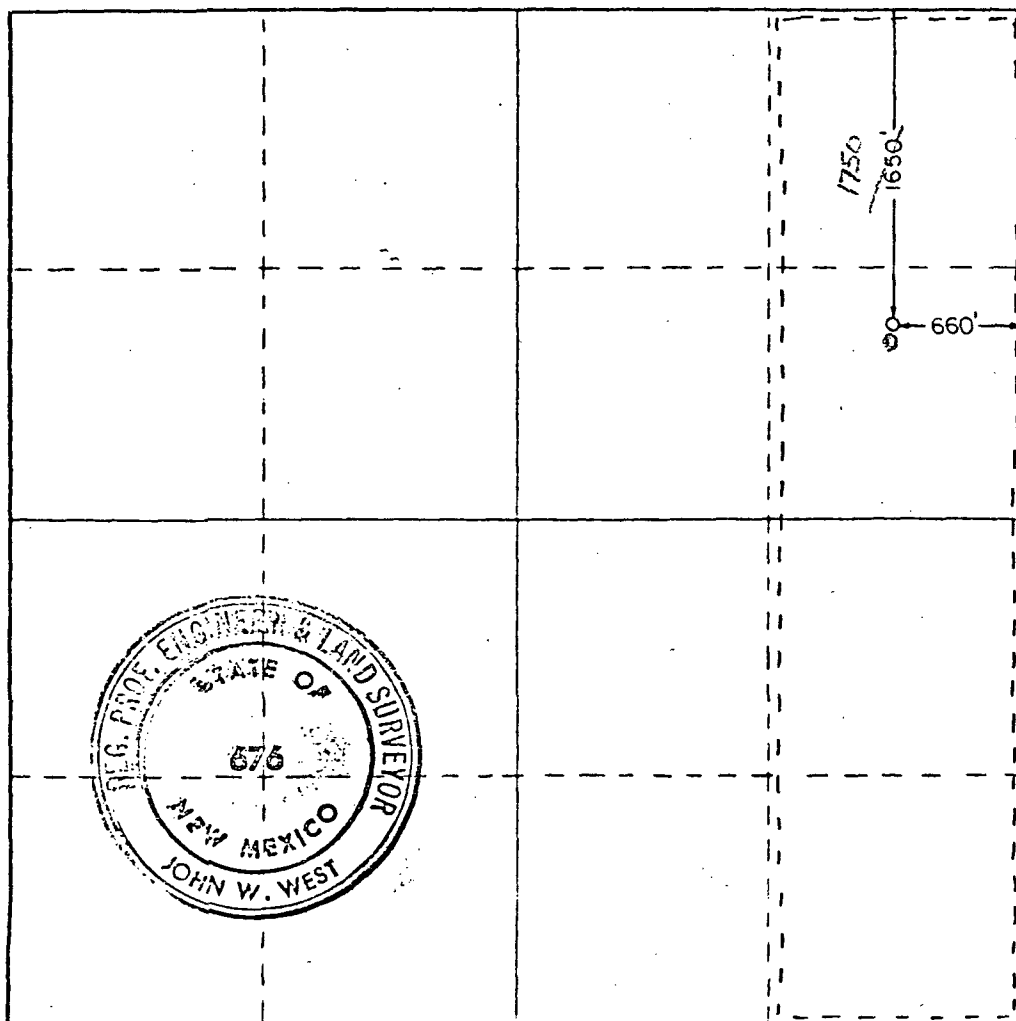

0 330 660 990 1320 1650 1980 2310 2640 2970 3300 3630 3960 4290 4620 4950 5280 5610 5940 6270 6600



L. P. Thompson
Division Manager

John R. Kemp
Assistant Division Manager

Production Department
Hobbs Division
North American Production

Conoco Inc.
P. O. Box 460
1001 North Turner
Hobbs, NM 88240
(505) 393-4146

RECEIVED
JAN 12 1981
CONSERVATION DIVISION
SANTA FE

*Amend NSP 1185
No wa. log
change of dedicated
well*

January 5, 1981

New Mexico Oil and Gas Conservation Division
P.O. Box 2088
Santa Fe, New Mexico 87501

Attention: Mr. Joe D. Ramey, Secretary Director

Gentlemen:

Request to Transfer Administrative Order NSP-1185, SEMU Eumont No. 118 to
SEMU Eumont No. 118Y

Conoco Inc. respectfully requests administrative approval to transfer the 160 acre proration unit approved by Order NSP-1185 to the SEMU Eumont Well, No. 118Y located 1750' FNL and 710' FEL of Section 27, T-20S, R-37E, Lea County, New Mexico.

The subject order was approved for the SEMU Eumont Well No. 118, but a dropped logging tool made it impractical to complete the well. Therefore, a second well, SEMU Eumont No. 118Y, was drilled 50 feet east of the first location.

Attached are a location map and plat showing the dimension of the proration unit.

Administrative approval of the name and location change of the proration unit approved by order NSP-1185 is requested.

L. P. Thompson
Division Manager

MJJ/pls
Attachment

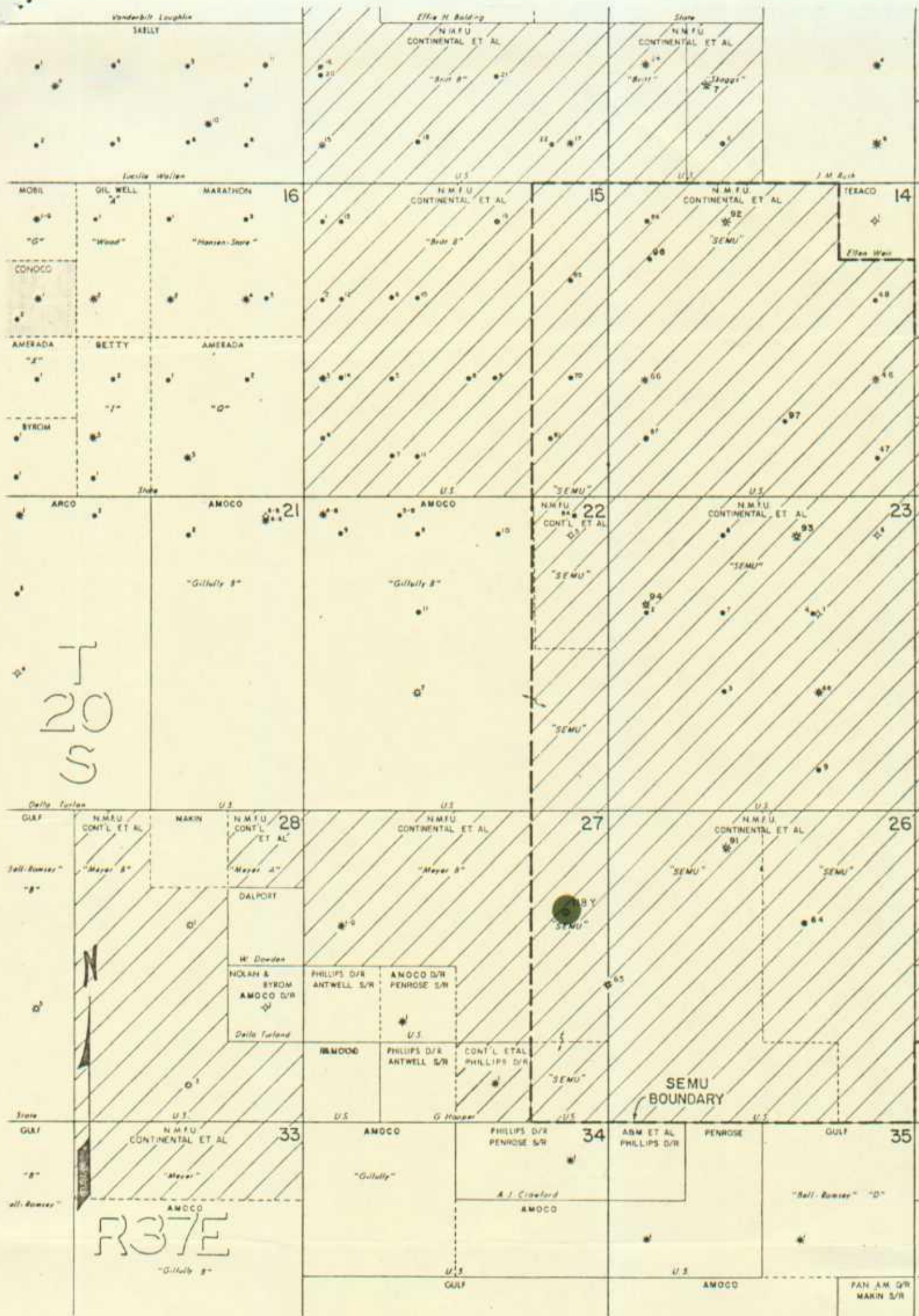

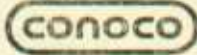

PRODUCTION DEPARTMENT HOBBS DIVISION

LEA COUNTY, NEW MEXICO

SCALE
0' 1000' 2000'

NEW MEXICO OIL CONSERVATION COMMISSION
WELL LOCATION AND ACREAGE DEDICATION PLAT

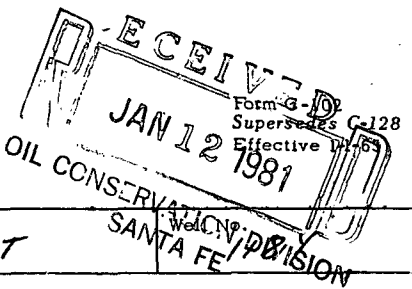

All distances must be from the outer boundaries of the Section.

Operator CONOCO INC.		Lease SEM U EUMONT	
Unit Letter H	Section 27	Township 20 S	Range 37 E
		County LEA	
Actual Footage Location of Well: 1750 feet from the NORTH line and 710 feet from the EAST line			
Ground Level Eley. 3508'	Producing Formation EUMONT	Pool EUMONT Queen GAS	Dedicated Acreage: 160 Acres

1. Outline the acreage dedicated to the subject well by colored pencil or hachure marks on the plat below.
2. If more than one lease is dedicated to the well, outline each and identify the ownership thereof (both as to working interest and royalty).
3. If more than one lease of different ownership is dedicated to the well, have the interests of all owners been consolidated by communitization, unitization, force-pooling, etc?

☐ Yes ☐ No If answer is "yes," type of consolidation _____

If answer is "no," list the owners and tract descriptions which have actually been consolidated. (Use reverse side of this form if necessary.) _____

No allowable will be assigned to the well until all interests have been consolidated (by communitization, unitization, forced-pooling, or otherwise) or until a non-standard unit, eliminating such interests, has been approved by the Commission.

CERTIFICATION

I hereby certify that the information contained herein is true and complete to the best of my knowledge and belief.

Name **Jane A. Nier**

Position **Adm. Supervisor**

Company **CONOCO INC.**

Date

I hereby certify that the well location shown on this plat was plotted from field notes of actual surveys made by me or under my supervision, and that the same is true and correct to the best of my knowledge and belief.

Date Surveyed

Registered Professional Engineer and/or Land Surveyor

			118Y