

NSP-1278
Rule 104 D II
Immediate

NORTHWEST PIPELINE CORPORATION

PRODUCTION & DRILLING
P.O. BOX 90
FARMINGTON, NEW MEXICO 87401
5110.1-126-81

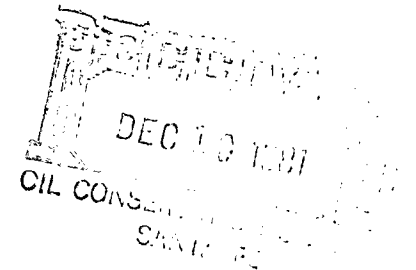

December 7, 1981

Joe Ramey
NMOCD
P.O. Box 2088
Santa Fe, New Mexico 87501

Re: Application for Non-Standard
Gas Proration Unit
San Juan 30-5 Unit #77
E/2 ~~AAA~~ Sec 36, T30N, R5W

220.76 acres

Dear Mr. Ramey:

Basin DK

Northwest Pipeline Corp requests permission to produce the above captioned well as a Non-Standard Gas Unit. The unorthodox size of this unit is necessitated by a variation in the legal subdivision of the U.S. Public Land Survey. The offset operators have been notified of our intentions by certified mail and they will forward any objections directly to your office. Copies of these letters along with the receipts for certified mail are enclosed.

Sincerely,

Paul C. Thompson

Paul C. Thompson
Drilling Engineer

PCT:djb
Enclosure.

NORTHWEST PIPELINE CORPORATION

PRODUCTION & DRILLING
P.O. BOX 90
FARMINGTON, NEW MEXICO 87401
5110.1-131-81

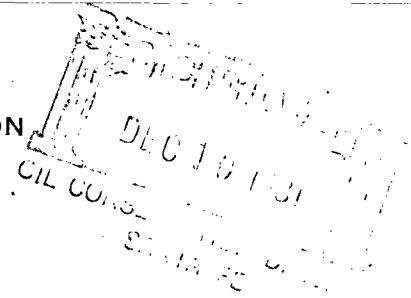

December 8, 1981

AMOCO Production
Attn: Bob Schroeder
501 Airport Drive
Farmington, N.M. 87401

Re: Non-Standard Gas
Proration Unit
San Juan 30-5 Unit #77
NW/4 Sec 36, T30N, R5W

Dear Mr. Schroeder:

Northwest Pipeline has requested permission from the New Mexico Oil & Gas Conservation Division to produce the above captioned well as a Non-Standard Gas Unit. Our records show you to be an offset operator. If you have any objections to this request, notify Joe Ramey with the NMOCD in Santa Fe within 30 days. This letter is being sent by certified mail in accordance with NMOCD regulations.

Sincerely,

Paul C. Thompson
Drilling Engineer

PCT:djb

NORTHWEST PIPELINE CORPORATION

PRODUCTION & DRILLING
P.O. BOX 90
FARMINGTON, NEW MEXICO 87401
5110.1-130-81

December 7, 1981

John A. Ahlm
El Paso Natural Gas Company
P.O. Box 289
Farmington, N.M. 87401

Re: Non-Standard Gas
Proration Unit
San Juan 30-5 Unit #77
NE/4 Sec 36, T30N, R5W

Dear Mr. Ahlm:

Northwest Pipeline has requested permission from the New Mexico Oil & Gas Conservation Division to produce the above captioned well as a Non-Standard Gas Unit. Our records show you to be an offset operator. If you have any objections to this request, notify Joe Ramey with the NMOCD in Santa Fe within 30 days. This letter is being sent by certified mail in accordance with NMOCD regulations.

Sincerely,

Paul C. Thompson
Paul C. Thompson
Drilling Engineer

PCT:djb

NORTHWEST PIPELINE CORPORATION

PRODUCTION & DRILLING
P.O. BOX 90
FARMINGTON, NEW MEXICO 87401
5110.1-129-81

December 7, 1981

Southland Royalty
Attn: Larry VanRyan
P.O. Drawer 570
Farmington, N.M. 87401

Re: Non-Standard Gas
Proration Unit
San Juan 30-5 Unit #77
NW/4 Sec 36, T30N, R5W

Dear Mr. VanRyan:

Northwest Pipeline has requested permission from the New Mexico Oil & Gas Conservation Division to produce the above captioned well as a Non-Standard Gas Unit. Our records show you to be an offset operator. If you have any objections to this request, notify Joe Ramey with the NMOCD in Santa Fe within 30 days. This letter is being sent by certified mail in accordance with NMOCD regulations.

Sincerely,

Paul C. Thompson
Paul C. Thompson
Drilling Engineer

PCT:djb

All distances must be from the outer boundaries of the Section.

Operator NORTHWEST PIPELINE CORPORATION			Lease SAN JUAN 30-5 UNIT PRODUCTION AND DRILLING		Well No. 77
Unit Letter G	Section 36	Township 30N	Range 5W	County RIO ARriba	
Actual Footage Location of Well:					
1640 feet from the North line and		870 feet from the East line			
Ground Level Elev. 7364	Producing Formation Dakota	Pool Basin Dakota	Dedicated Acreage: 220.76 Acres		

1. Outline the acreage dedicated to the subject well by colored pencil or hatchure marks on the plat below.
2. If more than one lease is dedicated to the well, outline each and identify the ownership thereof (both as to working interest and royalty).
3. If more than one lease of different ownership is dedicated to the well, have the interests of all owners been consolidated by communitization, unitization, force-pooling, etc?

☒ Yes ☐ No If answer is "yes," type of consolidation Unitization

If answer is "no," list the owners and tract descriptions which have actually been consolidated. (Use reverse side of this form if necessary.)

No allowable will be assigned to the well until all interests have been consolidated (by communitization, unitization, forced-pooling, or otherwise) or until a non-standard unit, eliminating such interests, has been approved by the Commission.

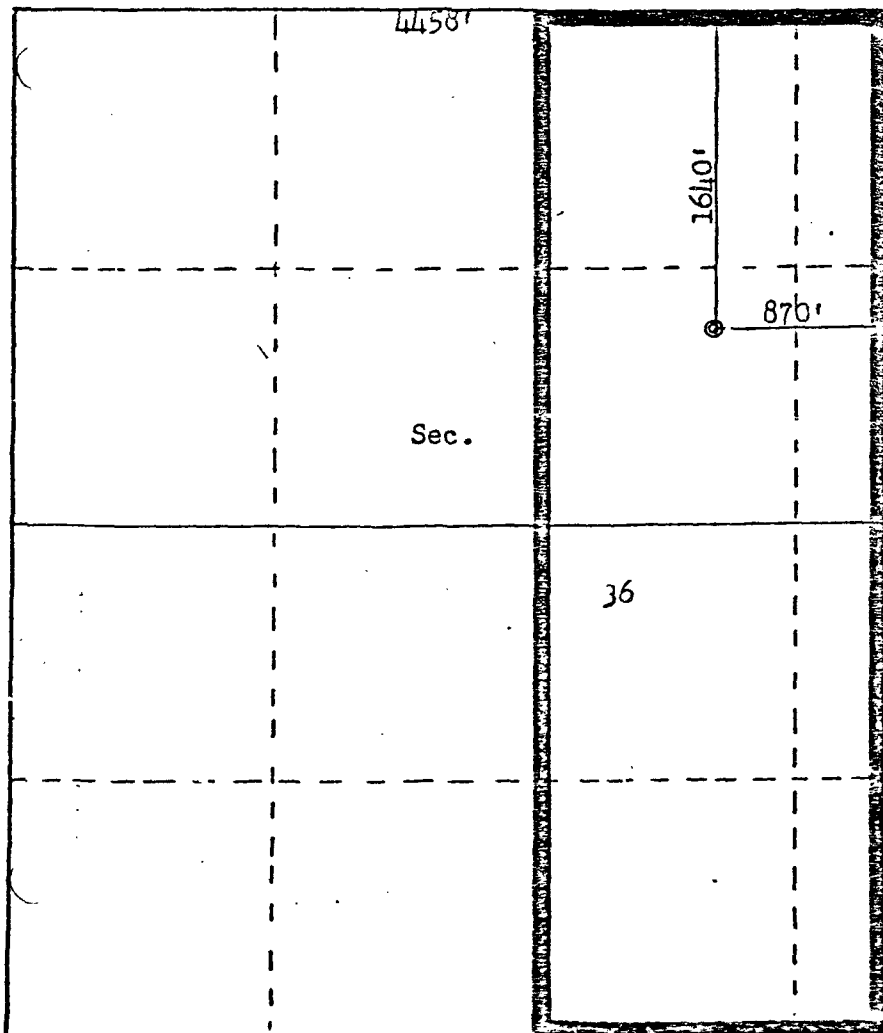

Scale: 1"=1000'

CERTIFICATION

I hereby certify that the information contained herein is true and complete to the best of my knowledge and belief,

Paul C. Thompson

Name

Paul C. Thompson

Position

Drilling Engineer

Company

Northwest Pipeline Corp

Date

March 6, 1981

I hereby certify that the well location shown on this plat was plotted from field notes of actual surveys made by me or under my supervision, and that the same is true and correct to the best of my knowledge and belief.

Date Surveyed

March 2, 1981

Registered Professional Engineer and Land Surveyor

Fred B. Kerra
Fred B. Kerra

Certificate No. 3950

3950

FRED B. KERRA, JR.

P22 0273635

RECEIPT FOR CERTIFIED MAIL

NO INSURANCE COVERAGE PROVIDED—
NOT FOR INTERNATIONAL MAIL
(See Reverse)

SENT TO	
John Ahlm	
STREET AND NO.	
P.O. Box 289	
P.O. STATE AND ZIP CODE	
Farmington, N.M. 87401	
POSTAGE	\$.20
CERTIFIED FEE	.75
SPECIAL DELIVERY	c
RESTRICTED DELIVERY	c
OPTIONAL SERVICES	
RETURN RECEIPT SERVICE	
SHOW TO WHOM AND DATE DELIVERED	c
SHOW TO WHOM, DATE, AND ADDRESS OF DELIVERY	c
SHOW TO WHOM AND DATE DELIVERED WITH RESTRICTED DELIVERY	c
SHOW TO WHOM, DATE AND ADDRESS OF DELIVERY WITH RESTRICTED DELIVERY	c
TOTAL POSTAGE AND FEES	\$.95
POSTMARK OR DATE	

P22 0273634

RECEIPT FOR CERTIFIED MAIL

NO INSURANCE COVERAGE PROVIDED—
NOT FOR INTERNATIONAL MAIL
(See Reverse)

SENT TO	
Southland Royalty	
STREET AND NO.	
P.O. Drawer 570	
P.O. STATE AND ZIP CODE	
Farmington, N.M. 87401	
POSTAGE	\$.20
CERTIFIED FEE	.75
SPECIAL DELIVERY	c
RESTRICTED DELIVERY	c
OPTIONAL SERVICES	
RETURN RECEIPT SERVICE	
SHOW TO WHOM AND DATE DELIVERED	c
SHOW TO WHOM, DATE, AND ADDRESS OF DELIVERY	c
SHOW TO WHOM AND DATE DELIVERED WITH RESTRICTED DELIVERY	c
SHOW TO WHOM, DATE AND ADDRESS OF DELIVERY WITH RESTRICTED DELIVERY	c
TOTAL POSTAGE AND FEES	\$.95
POSTMARK OR DATE	

P22 0273638

RECEIPT FOR CERTIFIED MAIL

NO INSURANCE COVERAGE PROVIDED—
NOT FOR INTERNATIONAL MAIL
(See Reverse)

SENT TO	
AMOCO Production	
STREET AND NO.	
501 Airport Drive	
P.O. STATE AND ZIP CODE	
Farmington, N.M. 87401	
POSTAGE	\$.20
CERTIFIED FEE	.75
SPECIAL DELIVERY	c
RESTRICTED DELIVERY	c
OPTIONAL SERVICES	
RETURN RECEIPT SERVICE	
SHOW TO WHOM AND DATE DELIVERED	c
SHOW TO WHOM, DATE, AND ADDRESS OF DELIVERY	c
SHOW TO WHOM AND DATE DELIVERED WITH RESTRICTED DELIVERY	c
SHOW TO WHOM, DATE AND ADDRESS OF DELIVERY WITH RESTRICTED DELIVERY	c
TOTAL POSTAGE AND FEES	\$.95
POSTMARK OR DATE	

PS Form 3800, Apr. 1976 S.J. 30-5 Unit #77

PS Form 3800, Apr. 1976 S.J. 30-5 Unit #77

PS Form 3800, Apr. 1976 San Juan 30-5 Unit #77

UNITED STATES
GEOLOGICAL SURVEY
WATER RESOURCES DIVISION
CIRCULAR 1143
1971

SAN JUAN 30-5 UNIT #77
BASIN DAKOTA

