

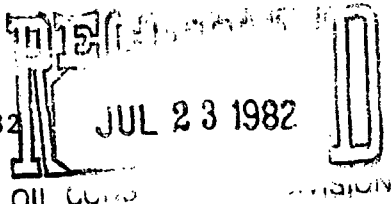

Mark K. Mosley
 Division Manager
 Production Department
 Hobbs Division
 North American Production

Conoco Inc.
 P. O. Box 460
 726 E. Michigan
 Hobbs, NM 88240
 (505) 393-4141

*NSP 123
 Two separate NSP's
 40 & 160
 Rule 5 G.S. R 1670
 8-14-82
 Blinbry Oil & Gas Pool*



July 15, 1982

JUL 23 1982

State of New Mexico
 Energy and Minerals Department
 Oil Conservation Division
 P. O. Box 2088
 Santa Fe, New Mexico 87501

Attention: Mr. Joe D. Ramey

Gentlemen:

Request for Cancellation of that Part of NSP Order R-4439 That Applies to our M.E. Wantz Well No. 11, and Cancellation of Administrative Order NSP-1230 Which Applies to our M.E. Wantz Well No. 8 and Establishment of Two New Non-standard Proration Units in the Blinbry Oil and Gas Pool.

*NSP
 Wantz's well in Bl = 20 acres
 Done Aug 12
 Also place R4439 in
 abeyance and
 supersede NSP 1230*

NSP Order R-4439 created a non-standard proration unit of 120 acres which was dedicated to our M.E. Wantz Well No. 11, located in Unit L, Section 21, T-21S, R-37E. We respectfully request that the existing NSP (W/2 and NE/4 of SW/4) be cancelled and a new 40 acre NSP, consisting of the NW/4 of the SW/4 of Section 21 (Unit Letter L), be approved.

Administrative Order NSP-1230 created a 120 acre NSP which was dedicated to our M. E. Wantz Well No. 8, located in Unit O, Section 21, T-21S, R-37E. This well is now classified as an oil well and thus has only 40 acres dedicated, therefore we request that Administrative Order NSP-1230 be cancelled.

Additionally, our M.E. Wantz Well No. 1, located in Unit N, Section 21, T-21S, R-37E, is currently classified an oil well, but due to recent G.O.R. tests, we have submitted a C-116 form requesting reclassification as a gas well. This well was originally drilled as an oil well and is an unorthodox gas well location (440' FSL & 2310' FWL). We respectfully request that a NSP of 160 acres be created to be dedicated to this well. The NSP will consist of the E/2 and the SW/4 of the SW/4 and the NW/4 of the SE/4 of Section 21, Unit Letters J, K, M, and N.

Each of the proposed units will conform to regulatory requirements as stated in order No. R-1670 N:

- 1) The unit will consist of contiguous quarter-quarter sections.
- 2) The unit consists of not more than 164 acres and lies wholly within a single governmental section.

Handwritten notes and scribbles on the left margin, including "1230" and "2".



State of New Mexico

July 14, 1982

Page 2

- 3) The entire proposed unit may be reasonably presumed to be productive of gas.
- 4) Copies of this application have been furnished by certified mail to all offset operators and all operators within the section.

Yours very truly,



M. K. Mosley
Division Manager

MEG:agd

Attachment

cc: N.M.O.C.D., Hobbs
Offset Operators (See attached address list)

Atlantic Richfield Company
P. O. Box 1710
Hobbs, NM 88240

Hunt Energy Corp.
2500 1st National Bank
Dallas, TX 75202

Sun Exploration and Production
P. O. Box 2880
Dallas, TX 75221

J. R. Cone
P. O. Box 871
Lubbock, TX 79408

Marathon Oil Company
Broadmoor Building
Hobbs, NM 88240

Getty Oil Company
P. O. Box 730
Hobbs, NM 88240

Gulf Oil Corporation
P. O. Box 670
Hobbs, NM 88240

Shell Oil Company
P. O. Box 1950
Hobbs, NM 88240

NEW MEXICO OIL CONSERVATION COMMISSION
WELL LOCATION AND ACREAGE DEDICATION PLAT

Form C-102
Supersedes C-128
Effective 1-1-65

All distances must be from the outer boundaries of the Section.

Operator Conoco Inc.		Lease M. E. Wantz		Well No. 11	
Unit Letter L	Section 21	Township 21 S	Range 37 E	County Lea	
Actual Footage Location of Well: 1,900 feet from the South line and 660' feet from the West line					
Ground Level Elev.	Producing Formation Blinebry	Pool Blinebry Oil + Gas	Dedicated Acreage: 40 Acres		

1. Outline the acreage dedicated to the subject well by colored pencil or hachure marks on the plat below.
2. If more than one lease is dedicated to the well, outline each and identify the ownership thereof (both as to working interest and royalty).
3. If more than one lease of different ownership is dedicated to the well, have the interests of all owners been consolidated by communitization, unitization, force-pooling, etc?

Yes No If answer is "yes," type of consolidation _____

If answer is "no," list the owners and tract descriptions which have actually been consolidated. (Use reverse side of this form if necessary.) _____

No allowable will be assigned to the well until all interests have been consolidated (by communitization, unitization, forced-pooling, or otherwise) or until a non-standard unit, eliminating such interests, has been approved by the Commission.

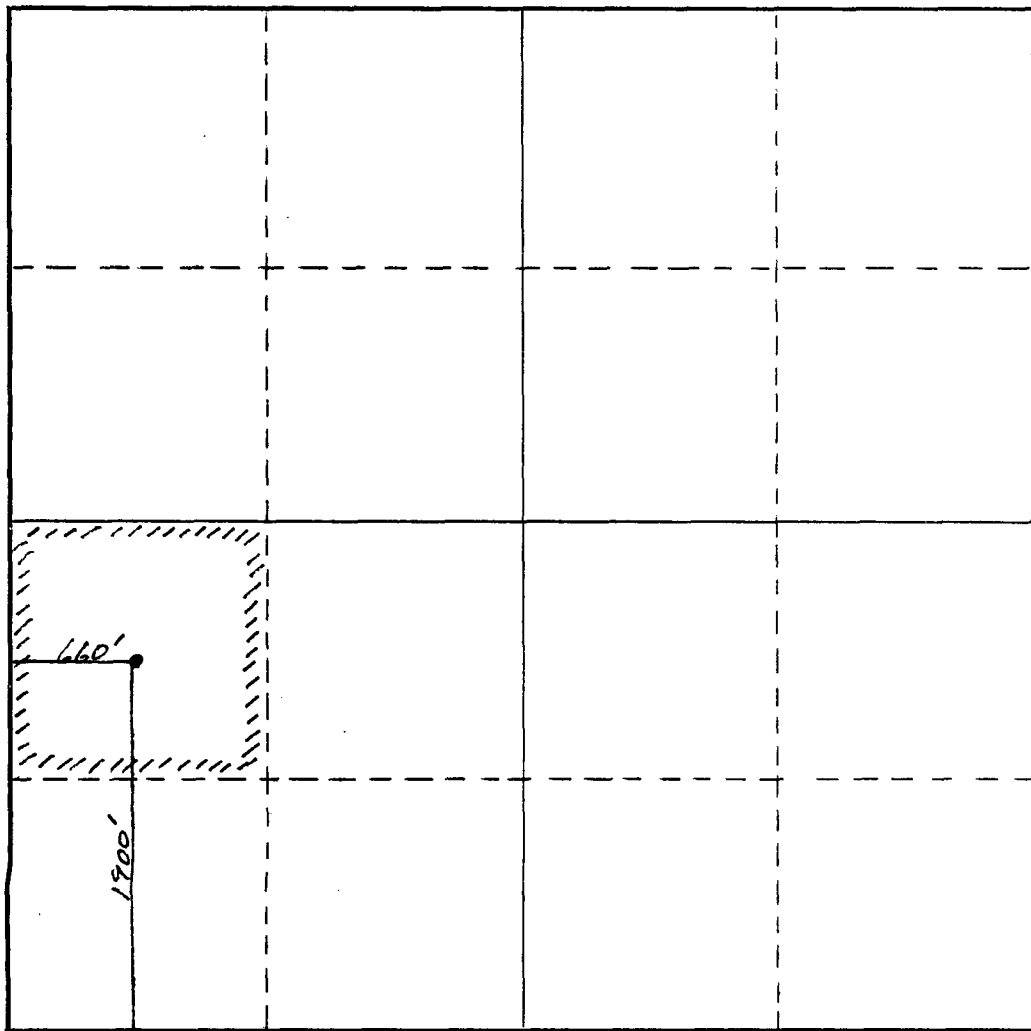

CERTIFICATION

I hereby certify that the information contained herein is true and complete to the best of my knowledge and belief.

Name
[Signature]
Position
Administrative Supervisor
Company
Conoco Inc.
Date
7-13-82

I hereby certify that the well location shown on this plat was plotted from field notes of actual surveys made by me or under my supervision, and that the same is true and correct to the best of my knowledge and belief.

Date Surveyed
Registered Professional Engineer and/or Land Surveyor

Certificate No.

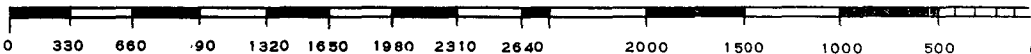

NEW MEXICO OIL CONSERVATION COMMISSION
WELL LOCATION AND ACREAGE DEDICATION PLAT

Form C-102
Supersedes C-128
Effective 1-1-65

All distances must be from the outer boundaries of the Section.

Operator <i>CONOCO INC.</i>		Lease <i>M.E. Wanty</i>			Well No. <i>1</i>
Unit Letter <i>N</i>	Section <i>21</i>	Township <i>21S</i>	Range <i>37E</i>	County <i>Lea</i>	
Actual Footage Location of Well: <i>440'</i> feet from the <i>South</i> line and <i>2,310'</i> feet from the <i>West</i> line					
Ground Level Elev.	Producing Formation <i>Blinebry</i>	Pool <i>Blinebry Oil and Gas</i>	Dedicated Acreage: <i>160</i> Acres		

1. Outline the acreage dedicated to the subject well by colored pencil or hachure marks on the plat below.
2. If more than one lease is dedicated to the well, outline each and identify the ownership thereof (both as to working interest and royalty).
3. If more than one lease of different ownership is dedicated to the well, have the interests of all owners been consolidated by communitization, unitization, force-pooling, etc?

Yes No If answer is "yes," type of consolidation _____

If answer is "no," list the owners and tract descriptions which have actually been consolidated. (Use reverse side of this form if necessary.) _____

No allowable will be assigned to the well until all interests have been consolidated (by communitization, unitization, forced-pooling, or otherwise) or until a non-standard unit, eliminating such interests, has been approved by the Commission.

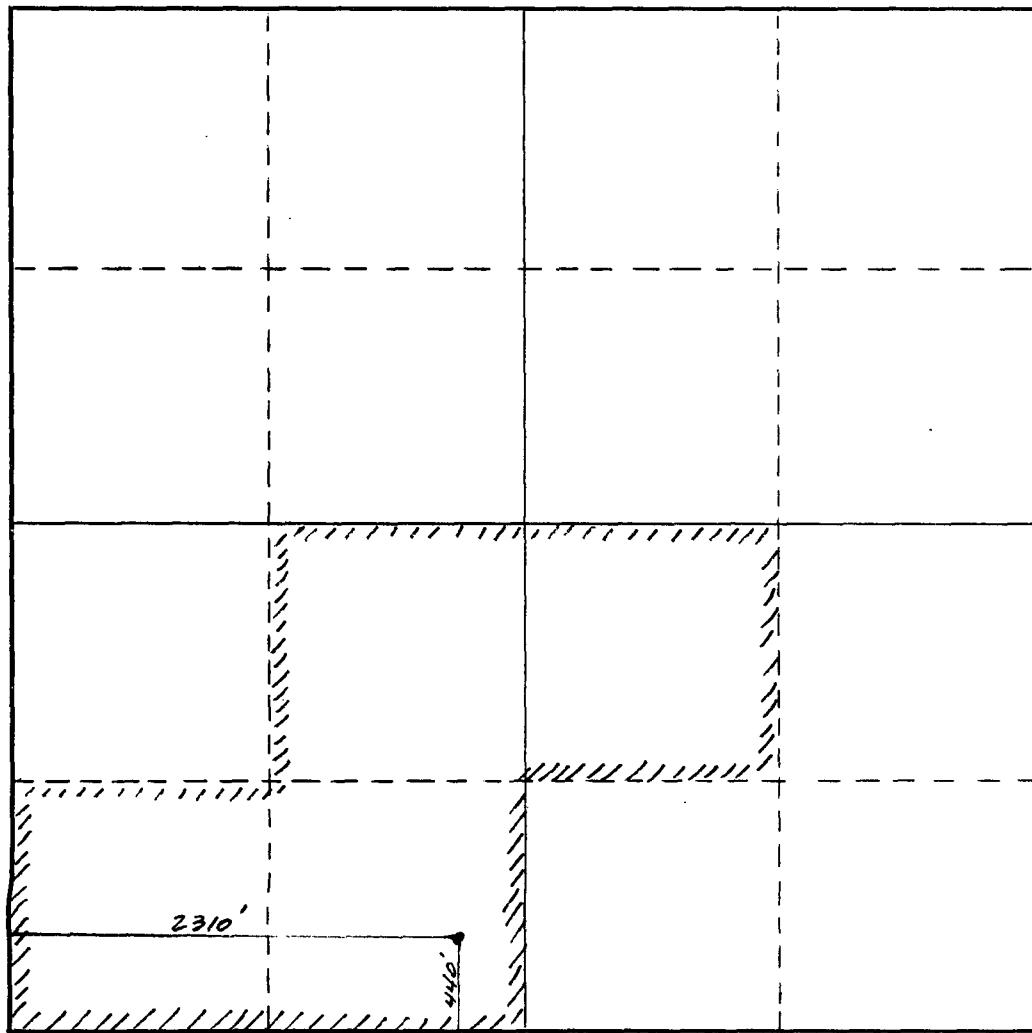

CERTIFICATION

I hereby certify that the information contained herein is true and complete to the best of my knowledge and belief.

Name
[Signature]
Position
Administrative Supervisor
Company
CONOCO INC.

Date
7-13-82

I hereby certify that the well location shown on this plat was plotted from field notes of actual surveys made by me or under my supervision, and that the same is true and correct to the best of my knowledge and belief.

Date Surveyed

Registered Professional Engineer and/or Land Surveyor

Certificate No.

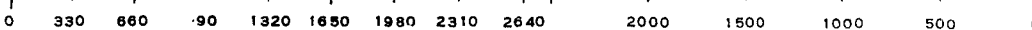

CONT-HARY UNIT State 22 23 CONTINENTAL OPER.		Dallas McCasland (S) Two States Cont'l. Hill Dallas McCasland (S)		Elk Oil 31-81 32-5		A-154 32-5 State		Hendrix Dekalb-St. U.S.		Warren Unit U.S.M.L. O. McCasland (S)		Warren Unit U.S. 11 Dallas McCasland (S)		Warren Unit U.S. 11 Will N. Terry et al 3	
30 Getty (She)		27 Amoco		25 Cont'l. Hill Dallas McCasland (S)		24 Shell 2512 U.S.		23 Shell 2512 U.S.		22 Shell 2512 U.S.		21 Shell 2512 U.S.		20 Shell 2512 U.S.	
19 Amoco		18 Amoco		17 Amoco		16 Amoco		15 Amoco		14 Amoco		13 Amoco		12 Amoco	
11 Amoco		10 Amoco		9 Amoco		8 Amoco		7 Amoco		6 Amoco		5 Amoco		4 Amoco	
3 Amoco		2 Amoco		1 Amoco		0 Amoco		0 Amoco		0 Amoco		0 Amoco		0 Amoco	

Whocce - south of

PRESENT

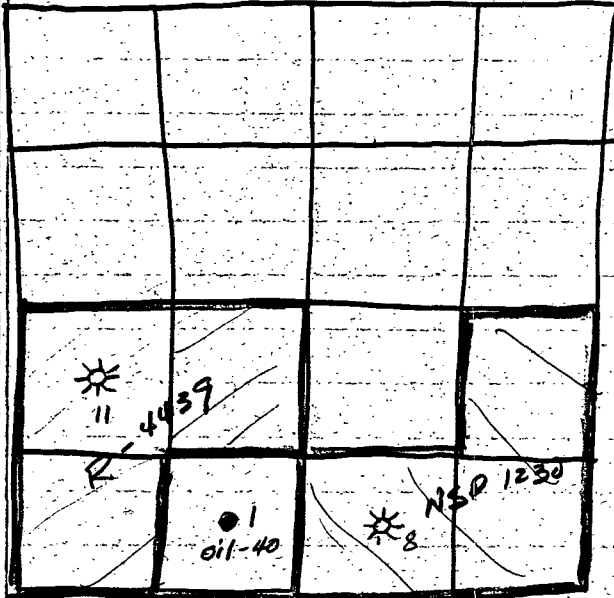

AS REQUESTED

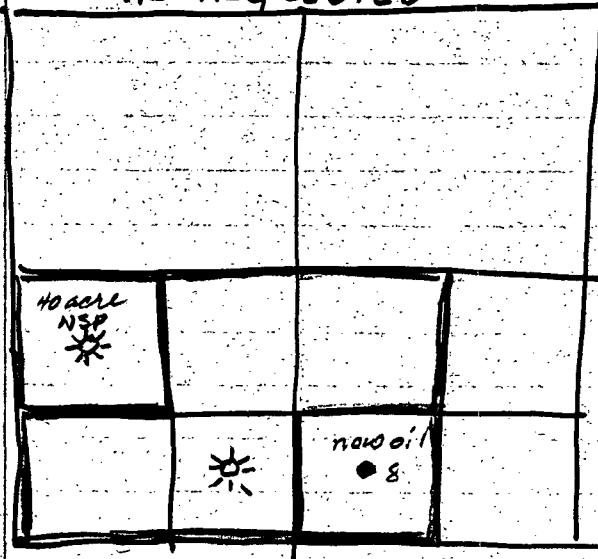

Cancellation
NSP 1230

put in abeyance
R-4439

approve 40 acre
NSP for # 11
(NW 1/4 SW 1/4)

approve 160 acre
NSP (E 1/2 SW 1/4 SW 1/4 SW 1/4
and NW 1/4 SE 1/4)