

By LRP

# Gulf Oil Exploration and Production Company

R. C. Anderson  
PRODUCTION MANAGER  
HOBBS AREA

June 15, 1984

P. O. Box 670  
Hobbs, NM 88240

NSP - 1427  
16503  
RULE ~~END~~ ORDER R-1670  
RELEASE JULY 25, 1984

Re: Application for a 120-Acre  
Non-Standard Gas Proration  
Unit, Blinebry Gas Pool,  
Comprising the N/2 of NE/4  
and SE/4 of NE/4 of Section  
14-T22S-R37E

Mr. Joe D. Ramey  
Oil Conservation Division  
P. O. Box 2088  
Santa Fe, New Mexico 87501

Gentlemen:

Gulf Oil Corporation requests administrative approval for a 120-Acre Non-Standard Gas Proration Unit in the Blinebry Gas Pool, comprising the N/2 of NE/4 and SE/4 of NE/4 of Section 14-T22S-R37E, Lea County, New Mexico, to be assigned to Gulf's Hugh #6 well. In support thereof, Gulf Oil Corporation states the following facts:

1. The proposed Non-Standard Gas Proration Unit will meet the requirements of Rule 5(c) of the Oil Conservation Division Order No. R-1670 as follows:
  - a. The proposed Non-Standard 120-Acre Proration Unit consists of less acreage than a standard 160-acre proration unit.
  - b. The Non-Standard Gas 120-Acre Proration Unit consists of contiguous quarter-quarter sections.
  - c. The Non-Standard 120-Acre Proration Unit lies wholly within a single government section in the Blinebry Gas Pool with 160-acre standard proration units.
  - d. The entire Non-Standard 120-Acre Gas Proration Unit may be reasonably presumed to be productive of gas from the Blinebry Pool.
  - e. The length or width of the Non-Standard Gas Proration Unit does not exceed 5280 feet.
  - f. This letter will serve as notification to all operators owning interest in the section containing the proposed Non-Standard 120-Acre Proration Unit and all operators within 1500 feet of the Hugh #6 well.

1980' ENL  
260' FEL



A DIVISION OF GULF OIL CORPORATION

OIL CONSERVATION DIVISION  
SANTA FE

Joe D. Ramey

-2-

6-15-84

In view of the above facts, Gulf Oil Corporation requests that administrative approval of the subject 120-Acre Non-Standard Proration Unit be granted.

Yours very truly,



R. C. ANDERSON

DCE/skc

cc: OCD-Hobbs

REGISTERED MAIL - RETURN RECEIPT REQUESTED

Samedan Oil Corporation  
2207 Wilco Bldg.  
Midland, Texas 79702

Sohio Petroleum Company  
P. O. Box 3167  
Midland, Texas 79702

Sun Production Company  
901 W. Wall  
Midland, Texas 79702

NEW MEXICO OIL CONSERVATION COMMISSION  
WELL LOCATION AND ACREAGE DEDICATION PLAT

Form C-102  
Supersedes C-128  
Effective 1-1-65

All distances must be from the outer boundaries of the Section.

Operator <u>Gulf Oil Corp.</u>			Lease <u>Hugh</u>		Well No. <u>6</u>
Unit Letter <u>H</u>	Section <u>14</u>	Township <u>22S</u>	Range <u>37E</u>	County <u>Lea</u>	
Actual Footage Location of Well: <u>1980</u> feet from the <u>North</u> line and <u>760</u> feet from the <u>East</u> line					
Ground Level Elev. <u>3343</u>	Producing Formation <u>Blinbury</u>		Pool <u>Blinbury Gas</u>	Dedicated Acreage: <u>120</u> Acres	

1. Outline the acreage dedicated to the subject well by colored pencil or hatchure marks on the plat below.
2. If more than one lease is dedicated to the well, outline each and identify the ownership thereof (both as to working interest and royalty).
3. If more than one lease of different ownership is dedicated to the well, have the interests of all owners been consolidated by communitization, unitization, force-pooling, etc?

☐ Yes ☐ No If answer is "yes," type of consolidation \_\_\_\_\_

If answer is "no," list the owners and tract descriptions which have actually been consolidated. (Use reverse side of this form if necessary.) \_\_\_\_\_

No allowable will be assigned to the well until all interests have been consolidated (by communitization, unitization, forced-pooling, or otherwise) or until a non-standard unit, eliminating such interests, has been approved by the Commission.

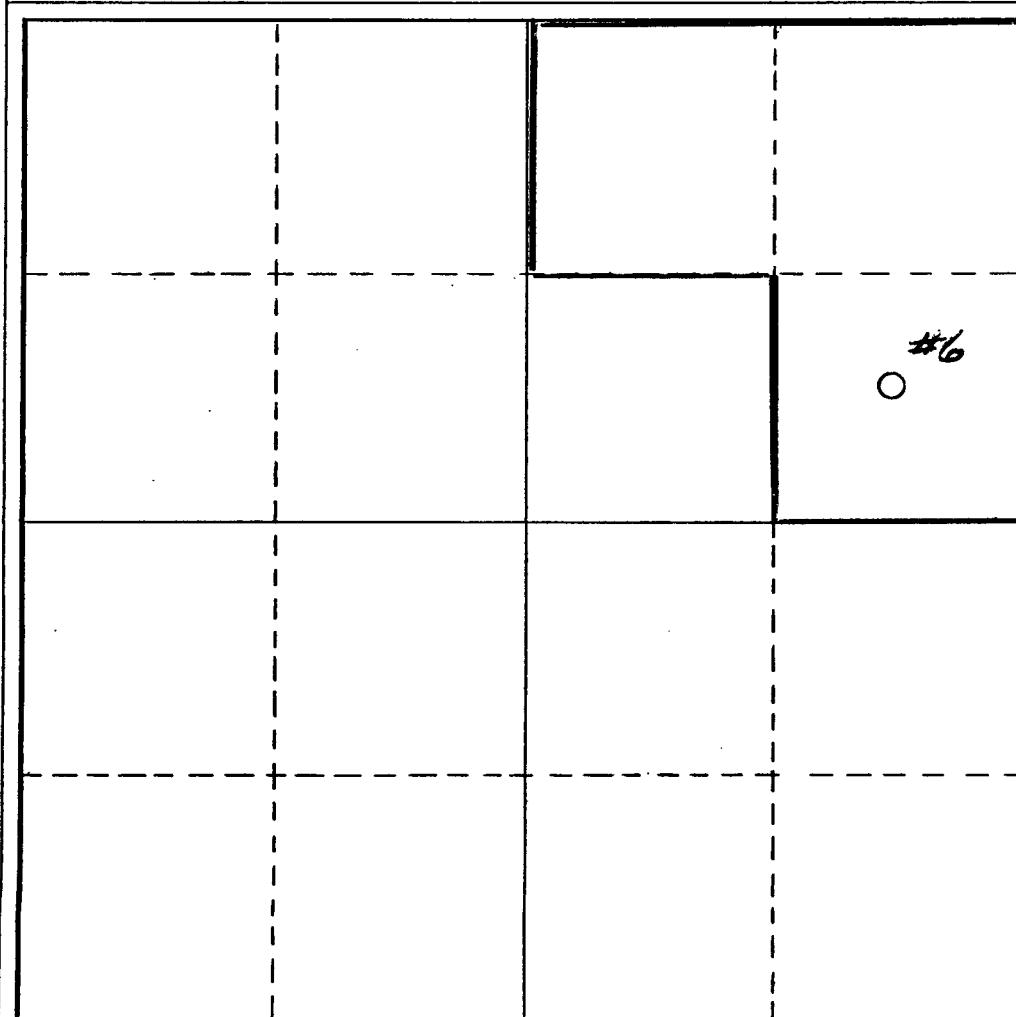

**CERTIFICATION**

I hereby certify that the information contained herein is true and complete to the best of my knowledge and belief.

R.D. Pitre

Name

R.D. PITRE

Position

AREA ENGINEER

Company

GULF OIL CORP

Date

6-14-84

I hereby certify that the well location shown on this plat was plotted from field notes of actual surveys made by me or under my supervision, and that the same is true and correct to the best of my knowledge and belief.

Date Surveyed

Registered Professional Engineer  
and/or Land Surveyor

Certificate No.

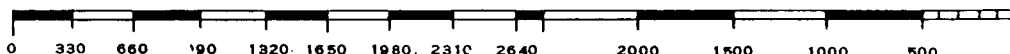



PLAT  
HUGH LEASE  
BLINEBRY GAS POOL  
Lea County, New Mexico

- LEGEND -

Pertinent Well



Proposed Non-Standard Unit

